

JAWAR SPS-K INSTALLATION MANUAL

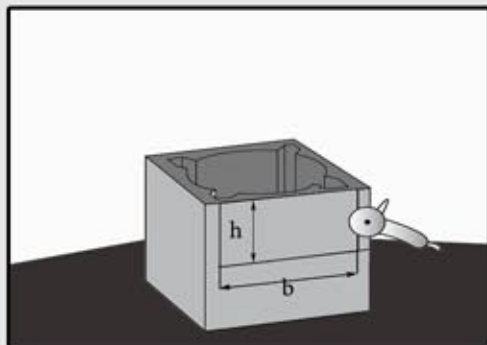

1. Place damp-insulation on the foundation. Remember to consider the „0” level. Use a grinder to cut an opening (h=12cm, b=22cm) in the top part of the first block..

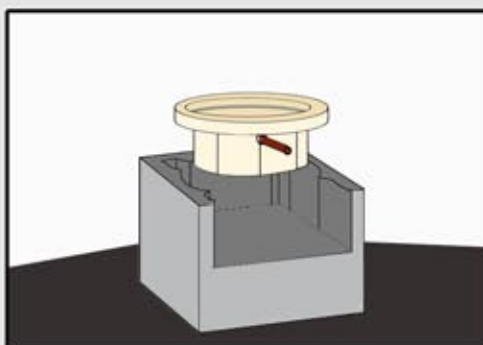

2. Place the first block and fill it with concrete up to the opening. After the concrete has set, put the condensate tray into it, front towards the opening.

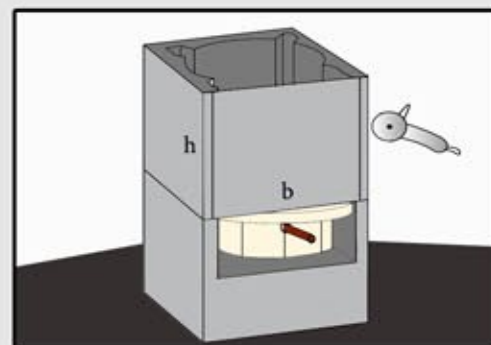

3. Before placing the second block, cut an opening size h=26cm (attention: the block height is 24cm, the remaining part should be cut from the next block), b=26cm. Place the block on the first block using grout.

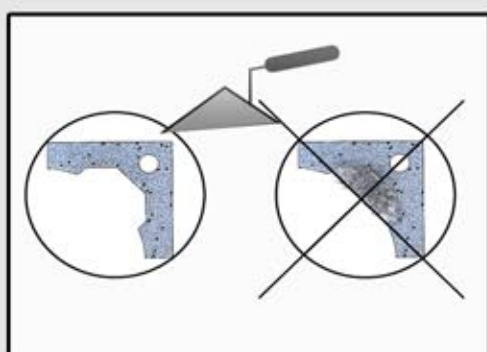

4. Remember not to block the air-channels when putting grout.

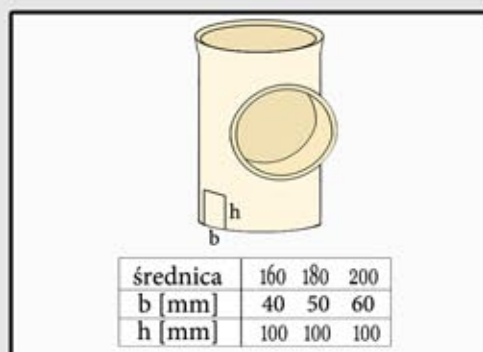

5. Cut a pressure equalizing opening (size b x h) in the bottom of the inspection tee.



6. Prepare the pipe glue in a ratio 7:1 (7 x glue / 1 x water)

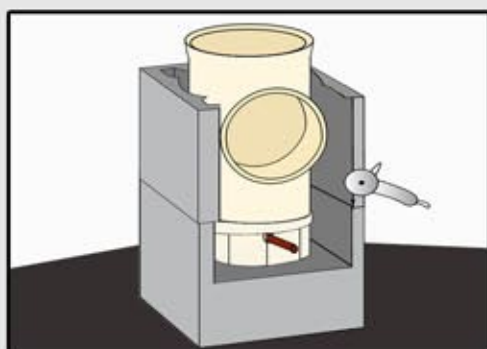

7. Put glue on the cleaned, moistured edge of the condensate tray. Next, place the tee and center it exactly.

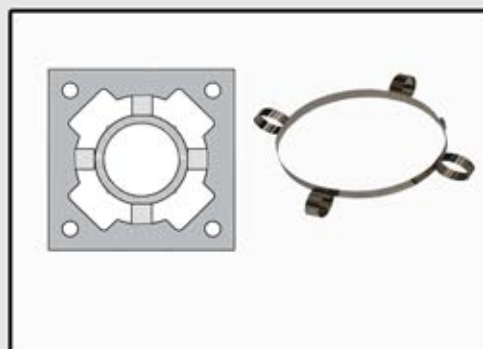

8. Center the tee using stabilising rings – at least 1 ring per 1m.

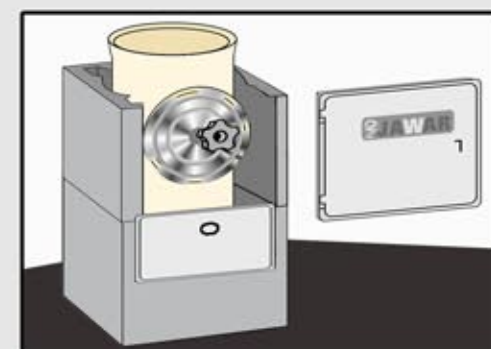

9. Place the locking plug in the tee branch.

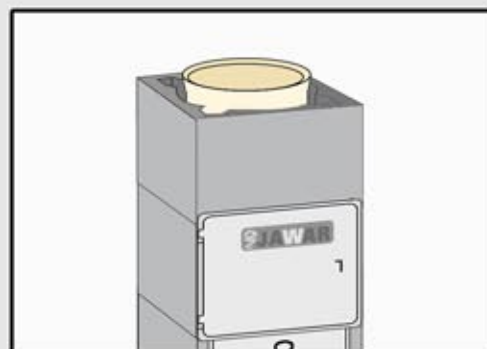

10. Next, place the chimney door and the condensate tray cover. Installation of the chimney door can be also made after building the whole chimney.



11. Place the needed number of pipes and blocks until the demanded connection height is reached. Remove the excessive pipe glue using a moist sponge.

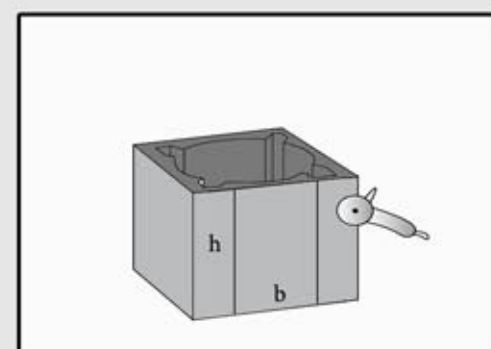

12. Cut on opening size h=24cm, b=20cm in a block for the gas connection.

JAWAR SPS-K INSTALLATION MANUAL

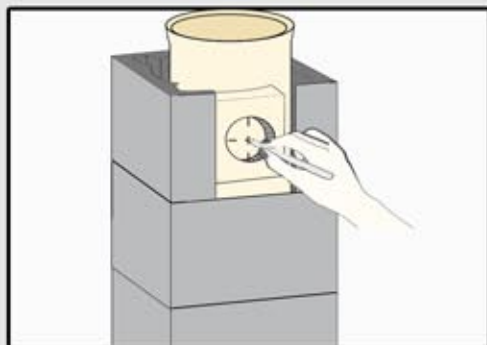

13. Place the block with the opening and a pipe without glue and grout. Next, using the connection frame, mark a place for connection opening in the pipe.

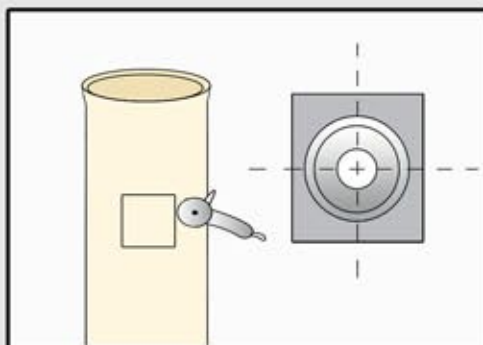

14. Remove the block and the pipe. Cut an opening according to the drawn dimensions and glue the connection branch into the pipe.

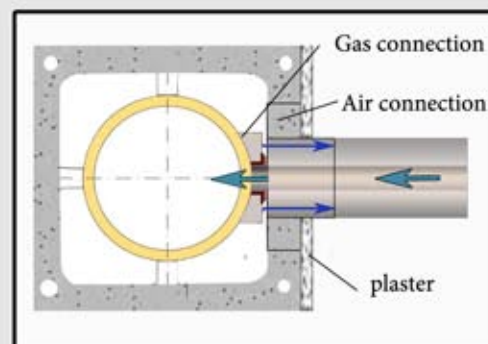

15. Use pipe glue to paste the connection branch into the pipe. Use grout to paste the outer air connection element into the block, centering it towards the gas connection branch.

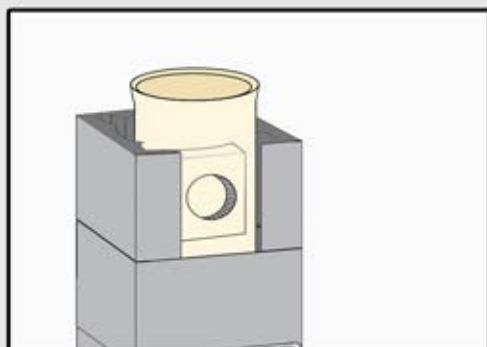

16. Place the block using grout. Put pipe glue on the bottom part of the pipe and place it on the tee. Next, place the stabilising rings.

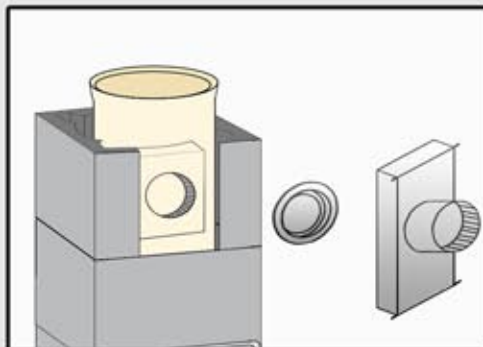

17. After the pipe glue has set, insert gas membrane into the connection branch. In case of 2 connections on one storey, the height difference between the connections' axes should be at least 30cm.

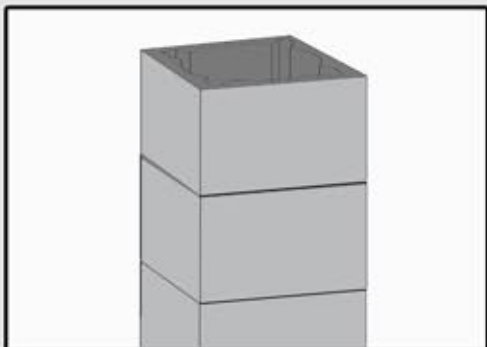

18. Use grout to place next blocks, until the demanded chimney height is reached.

Chimney top

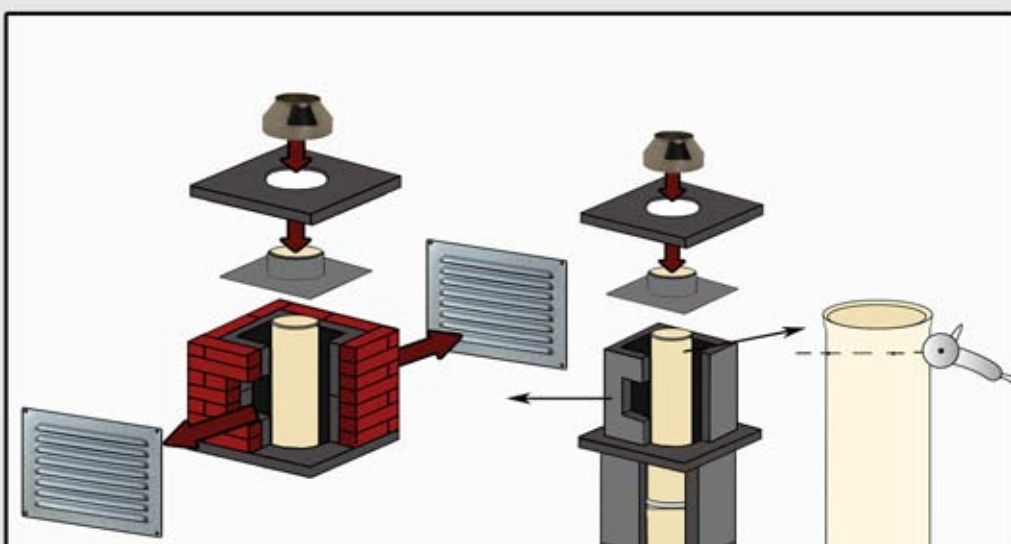

Cut two opposite openings size 17x20cm for ventilation checks in the last block. Place the block using grout. Next, place the covering plate. Remember to center the opening towards the pipe.

End cone is the last element of the chimney. Mount it onto the last pipe, which should stick out above the covering plate.

