

Installation Manual for Double DIN kit

Compatible with these Pioneer devices

Pioneer Navigation

- Seat Ibiza (6J) 2008->

Colour	Part-No. <i>Standard</i>	Part-No. <i>Rubber-Touch</i>
Azabache Black (AL6)	381328-06-1	391328-06-1
Nit Black (AN1)	381328-06-2	391328-06-2
Conemara Grey (AS2)	381328-06-3	391328-06-3
Dublin Grey (AM1)	381328-06-4	391328-06-4

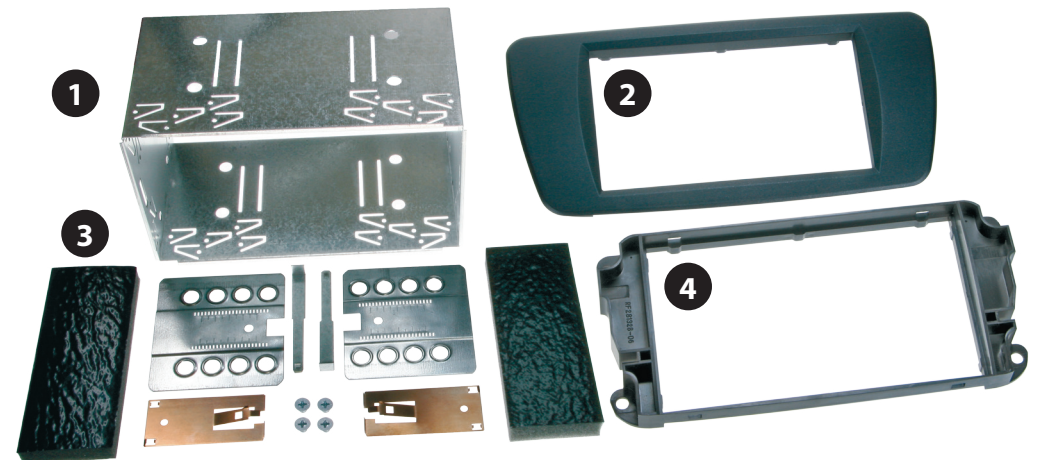

Double DIN kit

- Metal frame (1)
- Facia plate (2)
- Installation kit (3)
- Mounting Frame (4)



Special tools like radio release keys may be required.

1. Remove the original trim frame (surrounding the radio)
- 1a. unscrew the 4 screws fixing the OEM-Radio. (keep the screws, they will be needed for further installation) Disconnect all wires connected with the OEM-Radio and finally remove it.

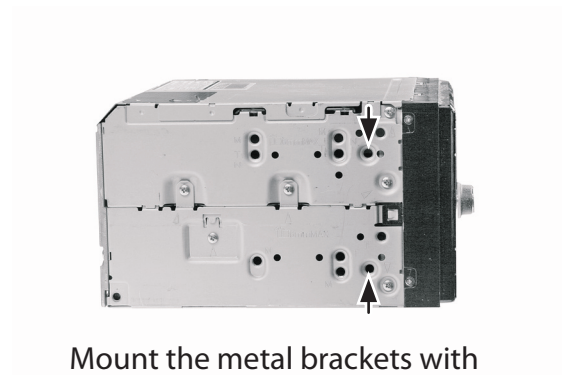

Mount the metal brackets with the double DIN head unit



2. Place the new mounting frame (see photo) into the dashboard.

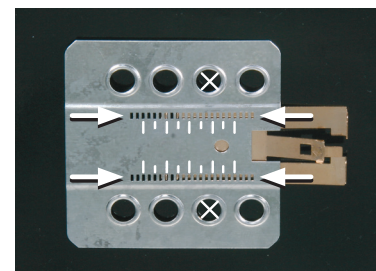

The position of the copper coloured holder can be adjusted to your needs for perfect fit. (see sample)

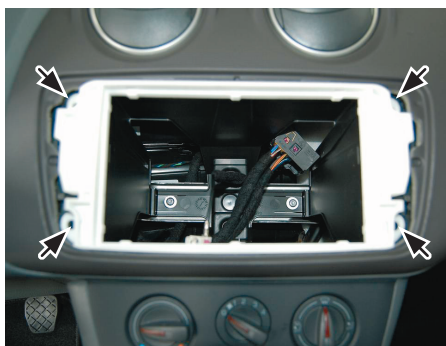

3. Fix the new mounting frame with the 4 original screws.
- 3.a Place the metal frame inside the mounting frame



4. Connect all required circuit points and push the double DIN head unit until it snaps in.
5. Place the facia plate to finish installation.