

Nokia X1-01 User Guide

Issue 1.0

Contents

Safety 3

Get started 4

Your dual SIM device 4

Insert the SIM card and battery 4

Insert or remove a memory card 6

Charge the battery 6

Switch on or off 7

Your phone 8

Keys and parts 8

Set which SIM card to use 9

Make a call 10

Text input 10

Send a message 11

Save a name and phone number 12

Save numbers in five separate
phonebooks 12

Listen to music 13

FM Radio 14

Flashlight 15

Support 15

Nokia original accessories 15

Practical rules about accessories 16

Battery 16

Product and safety information 16

Index 21

Safety

Read these simple guidelines. Not following them may be dangerous or illegal. Read the complete user guide for further information.

SWITCH OFF IN RESTRICTED AREAS



Switch the device off when mobile phone use is not allowed or when it may cause interference or danger, for example, in aircraft, near medical equipment, fuel, chemicals, or blasting areas.

ROAD SAFETY COMES FIRST



Obey all local laws. Always keep your hands free to operate the vehicle while driving. Your first consideration while driving should be road safety.

INTERFERENCE



All wireless devices may be susceptible to interference, which could affect performance.

QUALIFIED SERVICE



Only qualified personnel may install or repair this product.

BATTERIES AND OTHER ACCESSORIES



Use only batteries, chargers and other accessories approved by Nokia for use with this device. Do not connect incompatible products.

KEEP YOUR DEVICE DRY



Your device is not water-resistant. Keep it dry.

PROTECT YOUR HEARING



Listen to a headset at a moderate level, and do not hold the device near your ear when the loudspeaker is in use.

Get started

Your dual SIM device

You can insert two SIM cards.

Some benefits of a dual SIM device

- You can make savings when you use services from different service providers.
- Use one phone number for personal calls and another for work, but carry only one device.
- Avoid network coverage variation between service providers.

Both SIM cards can be connected to the network at the same time, but while one SIM card is active, for example, making a call, sending or receiving a message, or transferring data, the other is unavailable.

Insert the SIM card and battery

 **Note:** Switch the device off and disconnect the charger and any other device before removing any covers. Avoid touching electronic components while changing any covers. Always store and use the device with any covers attached.

 **Important:** Do not use a mini-UICC SIM card, also known as a micro-SIM card, a micro-SIM card with an adapter, or a SIM card that has a mini-UICC cutout (see figure) in this device. A micro SIM card is smaller than the standard SIM card. This device does not support the use of micro-SIM cards and use of incompatible SIM cards may damage the card or the device, and may corrupt data stored on the card.



 **Important:** To prevent damage to the SIM card, always remove the battery before you insert or remove the card.

The SIM card and its contacts can be easily damaged by scratches or bending, so be careful when handling, inserting, or removing the card.

You can use your phone with one or two SIM cards inserted.

- 1 Place your finger in the recess at the bottom of the phone, and carefully lift and remove the back cover (1).
- 2 If the battery is inserted, lift the battery out (2).

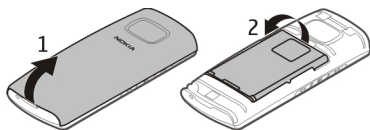

- 3 If inserting only one SIM card, open the SIM 1 card holder (3). Make sure the contact area is facing down, and insert the SIM card (4). Close the holder.



- 4 To insert a second SIM card, open the SIM 2 card holder (5). Make sure the contact area is facing down, and insert the SIM card (6). Close the holder.

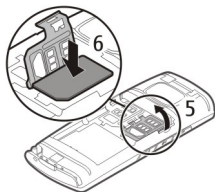

- 5 Line up the contacts of the battery and the battery compartment, and insert the battery (7). To replace the back cover, direct the top locking catches toward their slots (8), and press down until the cover locks into place (9).

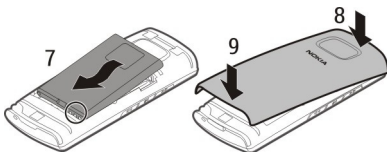

This phone is intended for use with the BL-5J battery.

Insert or remove a memory card

Use only compatible memory cards approved by Nokia for use with this device. Incompatible cards may damage the card and the device and corrupt data stored on the card.

Memory cards may be available separately.

Your device supports microSD cards with a capacity of up to 16 GB.



Insert a memory card

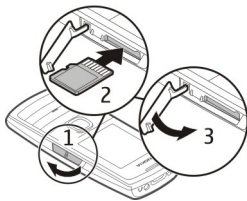

- 1 Open the cover of the memory card slot.
- 2 Insert the memory card. Push the card in, until it locks into place. Make sure the contact area is facing up.
- 3 Close the slot cover.

You can remove or replace the memory card without switching the device off.

Remove the memory card

 **Important:** Do not remove the memory card when an application is using it. Doing so may damage the memory card and the device, and corrupt data stored on the card.

- 1 Open the cover of the memory card slot.
- 2 Push the card in gently, until it is released, and pull the card out.
- 3 Close the slot cover.

Charge the battery

Your battery has been partially charged at the factory, but you may need to recharge it before you can switch on your device for the first time.

If the device indicates a low charge, do the following:

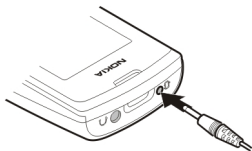

- 1 Connect the charger to a wall outlet.
- 2 Connect the charger to the device.
- 3 When the device indicates a full charge, disconnect the charger from the device, then from the wall outlet.

Tip: To save energy, unplug the charger when the battery is fully charged.

You do not need to charge the battery for a specific length of time, and you can use the device while it is charging.

If the battery is completely discharged, it may take several minutes before the charging indicator appears on the display or before any calls can be made.

If the battery has not been used for a long time, to begin charging, you may need to connect the charger, then disconnect and reconnect it.

It may take longer than expected before the device is fully charged, due to the large capacity of the BL-5J battery.

Switch on or off

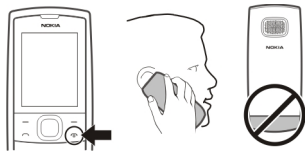

Press and hold the end key.

Use the phone only in its normal operating position.

Avoid touching the antenna area unnecessarily while the antenna is transmitting or receiving. Contact with antennas affects the communication quality and may cause a higher power level during operation and may reduce the battery life.

Your phone

Keys and parts

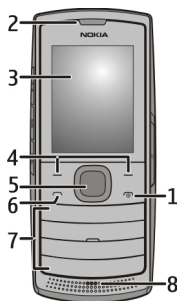

- 1 End/Power key
- 2 Earpiece
- 3 Display
- 4 Selection keys
- 5 Navi™ key (scroll key)
- 6 Call key
- 7 Keypad
- 8 Microphone

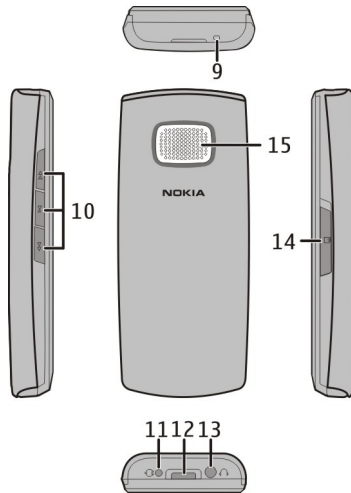

- 9 Wrist strap hole
- 10 Music keys
- 11 Charger connector
- 12 Flashlight
- 13 Headset connector/Nokia AV Connector (3.5 mm)
- 14 Memory card slot
- 15 Loudspeaker

Set which SIM card to use

You can set which SIM card to use for outgoing calls or messages. If you name your SIM cards, you can see at a glance which is, for example, for work and which is for personal use.

Select **Menu** > **Settings** > **Dual SIM settings**.

1 Select from the following:

Default SIM for calls — Set which SIM card to use for outgoing calls.

Default SIM for msgs — Set which SIM card to use for outgoing messages.

Standby mode — Set which SIM card to be active for all incoming and outgoing communications.

10 Your phone

- 2 Select **SIM1** or **SIM2**. To be prompted to select a SIM card before, for example, making a call or sending a text message, select **Ask every time**.

Rename a SIM card

Select **SIM name**.

Tip: To quickly change the default SIM card, on the home screen, press and hold *****.

Make a call

- 1 Enter the phone number, including the country code and area code, if necessary.
- 2 Press the call key.
- 3 If prompted, select the SIM card to use.
- 4 To end the call, press the end key.

Tip: If you have set the default SIM card used for making calls, you can still select which SIM card to use. After entering the phone number, instead of pressing the call key, select **Options > Call**.

When you receive a call, the SIM card in use is indicated.

Use the loudspeaker or earpiece

During a call, select **Loudsp.** or **Hands..**

Change the volume

During a call, scroll left or right.

Text input

Write text

To enter text, you can use traditional or predictive text input. Not all languages are supported by predictive text input.

Use traditional text input

Press a key repeatedly until the desired letter is displayed.

Activate predictive text input

Select **Options > Dictionary** and the desired language.

Deactivate predictive text input

Select **Options > Dictionary > Dictionary off**.

When using predictive text input, press each key once for a single letter. If the desired word is displayed, press **0**, and start writing the next word. If ? is displayed after the word, the word is not in the dictionary.

Change a word

Press * repeatedly until the desired word is displayed.

Add a word

Select **Spell**, enter the word using traditional text input, and select **OK**.

Add a space

Press **0**.

Change text input method

Press # repeatedly, and check the indicator at the top of the display.

Add a number

Press and hold the desired number key.

Add a special character

Press * when using traditional text input; press and hold * when using predictive text input.

Clear a whole message

Select **Options** > **Clear text**.

You can undo the clearing of a whole message, but only right after you have selected **Clear text**.

Undo clearing of a whole message

Select **Options** > **Undo clear**.

Send a message

Keep in touch with your family and friends with text messages.

Select **Menu** > **Messages**.

- 1 Select **Create message**.
- 2 Write the message. The message length indicator shows how many characters you can enter in the message.
- 3 Select **Options** > **Send**.
- 4 If prompted, select the SIM card to use.

12 Your phone

- 5 Enter the recipient's phone number, or select it from the contacts list, and select **OK**.

Tip: If you have set the default SIM card used for sending messages, after writing your message, instead of selecting **Options > Send**, you can press the call key.

Delete a message

Select **Delete messages**, the appropriate folder, and the message.

Delete all messages

Select **Delete messages > All read**.

You can send text messages that are longer than the character limit for a single message. Longer messages are sent as two or more messages. Your service provider may charge accordingly.

Characters with accents, other marks, or some language options, take more space, and limit the number of characters that can be sent in a single message.

Save a name and phone number

You can save names and phone numbers on the SIM card and in the phone memory. Up to 500 contacts can be stored in the phone memory.

Select **Menu > Contacts**.

- 1 Select **Add contact**.
- 2 Select where to save the contact.
- 3 Enter the name and phone number.

You can also select a picture for the contact.

Tip: To quickly view your contacts, on the home screen, scroll down.

Save numbers in five separate phonebooks

Want to share a phone with your family members or friends? You can separate your contacts using up to five separate phonebooks.

Select **Menu > Contacts > Settings > Multi-Phonebook**.

You can only assign the contacts saved in the phone memory to Multi-phonebook.

A contact can belong to one or several phonebooks.

- 1 Select **Phonebook style > Multi-Phonebook**.

- 2 Select **Current phonebook** and a phonebook. The phonebook is set as the current phonebook.
- 3 Select **Manage contacts** and a contact.
- 4 Mark the current phonebook. If you mark **Shared contacts**, this contact is shared by all phonebooks.
- 5 Select **Done**.

To open Contacts, on the home screen, press down. Only the contacts in the current phonebook are visible.

Rename a phonebook

Select **Rename phonebooks**.

Turn off Multi-phonebook

Select **Phonebook style > Normal**.

Listen to music

You can listen to your MP3 music files with the music player.

Select **Menu > Music > Mp3 Music player**.

To play music, you need to store the music files on a memory card.

Your device supports standard MP3 formats from 32kbps up.

Start or pause playback

Press .

Skip to the previous song

Press .

Skip to the next song

Press .

Change the volume

Scroll left or right.

Set the music player to play in the background

Press the end key.

Close the music player when it is playing in the background

Press and hold the end key.

FM Radio

Listen to the radio

Enjoy your favourite FM radio stations on the go!

- 1 Attach a compatible headset to the device.
- 2 Select **Menu > Music > Radio**.

Change the volume

Scroll left or right.

Listen using the headset or the loudspeaker

Select **Options > Loudspeaker** or **Options > Headset**.

Close the radio

Select **Options > Switch off**.

Set the radio to play in the background

Press the end key.

Close the radio when it is playing in the background

Press and hold the end key.

Find and save a radio station

Search for your favourite radio stations, and save them, so you can easily listen to them later.

Select **Menu > Music > Radio**.

- 1 Select **Options > Auto tuning**.
To change the frequency manually, scroll up or down.
- 2 To enter a frequency manually, select **Options > Set frequency**.
- 3 To save the found station, select **Options > Save channel**.

Listen to a saved station

Press the number key that matches the station location.

Rename or delete a station

When the station is playing, select **Options > Rename** or **Delete channel**.

Set the clock radio

Want to wake up to the sound of the radio?

You need to have saved at least one radio station.

- 1 Attach a compatible headset to the phone.
- 2 Select **Menu** > **Music** > **Radio**.
- 3 Select **Options** > **Clock radio**.
- 4 Set the wake up time, and select **OK**.

Make sure you keep the headset connected and that the radio is not on.

Flashlight

Turn the flashlight on

Scroll up twice in the standby mode, or select **Menu** > **Extras** > **Flashlight** > **On**.

Turn the flashlight off

Scroll up once in the standby mode, or select **Menu** > **Extras** > **Flashlight** > **Off**.

Do not point the flashlight at anyone's eye.

Support

When you want to learn more about how to use your product or you are unsure how your device should function, go to www.nokia.com/support, or using a mobile device, nokia.mobi/support.

If this does not resolve your issue, do one of the following:

- Reboot your device. Switch off the device, and remove the battery. After about a minute, replace the battery, and switch on the device.
- Restore the original factory settings.

If your issue remains unsolved, contact Nokia for repair options. Go to www.nokia-asia.com/repair. Before sending your device for repair, always back up your device data.

Nokia original accessories

For availability of approved accessories, check with your dealer.



16 Product and safety information

An extensive range of accessories is available for your device. For more details, see www.nokia-asia.com/accessories.

Practical rules about accessories

- Keep all accessories out of the reach of small children.
- When you disconnect the power cord of any accessory, grasp and pull the plug, not the cord.
- Check regularly that accessories installed in a vehicle are mounted and are operating properly.
- Installation of any complex car accessories must be made by qualified personnel only.

Battery

Type: BL-5J

Talk time:

Up to 13.1 hours.

Standby:

Up to 1032 hours.



Important: Battery talk and stand-by times are estimates and only possible under optimal network conditions. Actual battery talk and standby times depend on SIM cards, features used, battery age and condition, temperatures to which battery is exposed, network conditions, and many other factors, and may be significantly shorter than those specified above. Ringing tones, hands free call handling, use in digital mode, and other features will also consume the battery, and the amount of time a device is used for calls will affect its stand-by time. Likewise, the amount of time that the device is turned on and in the standby mode will affect its talk time.

Product and safety information

Network services and costs

Your device is approved for use on the (E)GSM 900 and 1800 MHz networks. To use the device, you need a subscription with a service provider.

Using network services and downloading content to your device may result in data traffic costs. Some product features require support from the network, and you may need to subscribe to them.

Take care of your device

Handle your device, battery, charger and accessories with care. The following suggestions help you protect your warranty coverage.

- Keep the device dry. Precipitation, humidity, and all types of liquids or moisture can contain minerals that corrode electronic circuits. If your device gets wet, remove the battery, and allow the device to dry.
- Do not use or store the device in dusty or dirty areas. Moving parts and electronic components can be damaged.
- Do not store the device in high temperatures. High temperatures can shorten the life of the device, damage the battery, and warp or melt plastics.
- Do not store the device in cold temperatures. When the device warms to its normal temperature, moisture can form inside the device and damage electronic circuits.
- Do not attempt to open the device other than as instructed in the user guide.
- Unauthorised modifications may damage the device and violate regulations governing radio devices.
- Do not drop, knock, or shake the device. Rough handling can break internal circuit boards and mechanics.
- Only use a soft, clean, dry cloth to clean the surface of the device.
- Do not paint the device. Paint can clog the moving parts and prevent proper operation.
- Switch off the device and remove the battery from time to time for optimum performance.
- Keep your device away from magnets or magnetic fields.
- To keep your important data safe, store it in at least two separate places, such as your device, memory card, or computer, or write down important information.

Recycle

Always return your used electronic products, batteries, and packaging materials to dedicated collection points. This way you help prevent uncontrolled waste disposal and promote the recycling of materials. Check product environmental information and how to recycle your Nokia products at www.nokia.com/werecycle, or with a mobile device, nokia.mobi/werecycle.

Batteries and chargers

Battery and charger information

This device is intended for use with a BL-5J rechargeable battery. Nokia may make additional battery models available for this device. Always use original Nokia batteries.

This device is intended for use when supplied with power from the following chargers: AC-3. The exact charger model number may vary depending on the type of plug. The plug variant is identified by one of the following: E, X, AR, U, A, C, K, or B.

The battery can be charged and discharged hundreds of times, but it will eventually wear out. When the talk and standby times are noticeably shorter than normal, you need to replace the battery.



Important: Talk and standby times are estimates only. Actual times are affected by, for example, network conditions, device settings, features being used, battery condition, and temperature.

Battery safety

Always switch the device off and disconnect the charger before removing the battery. When you unplug a charger or an accessory, hold and pull the plug, not the cord.

When your charger is not in use, unplug it from the electrical plug and the device. Do not leave a fully charged battery connected to a charger, as overcharging may shorten the battery's lifetime. If left unused, a fully charged battery will lose its charge over time.

Always keep the battery between 15°C and 25°C (59°F and 77°F). Extreme temperatures reduce the capacity and lifetime of the battery. A device with a hot or cold battery may not work temporarily.

Accidental short-circuiting can happen when a metallic object touches the metal strips on the battery, for example, if you carry a spare battery in your pocket. Short-circuiting may damage the battery or the connecting object.

18 Product and safety information

Do not dispose of batteries in a fire as they may explode. Dispose of batteries according to local regulations. Recycle when possible. Do not dispose as household waste.

Do not dismantle, cut, open, crush, bend, puncture, or shred cells or batteries. If a battery leaks, do not let battery liquid touch skin or eyes. If this happens, immediately flush the affected areas with water, or seek medical help.

Do not modify, remanufacture, attempt to insert foreign objects into the battery, or immerse or expose it to water or other liquids. Batteries may explode if damaged.

Use the battery and charger for their intended purposes only. Improper use, or use of unapproved batteries or chargers may present a risk of fire, explosion, or other hazard, and may invalidate any approval or warranty. If you believe the battery or charger is damaged, take it to a service centre for inspection before continuing to use it. Never use a damaged battery or charger. Only use the charger indoors.

Additional safety information

Emergency calls

Make an emergency call

- 1 Ensure the device is switched on.
- 2 Check for adequate signal strength. You may also need to do the following:
 - Insert a SIM card.
 - Remove call restrictions you have activated for your device, such as call barring, fixed dialling, or closed user group.
 - Ensure your device is not in an offline or flight profile.
- 3 To clear the display, press the end key as many times as needed.
- 4 Enter the official emergency number for your present location. Emergency call numbers vary by location.
- 5 Press the call key.
- 6 Give the necessary information as accurately as possible. Do not end the call until given permission to do so.



Important: Activate both cellular and internet calls, if your device supports internet calls. The device may attempt to make emergency calls both through cellular networks and through your internet call service provider. Connections in all conditions cannot be guaranteed. Never rely solely on any wireless device for essential communications like medical emergencies.

Small children

Your device, its battery and accessories are not toys. They may contain small parts. Keep them out of the reach of small children.

Medical devices

Operation of radio transmitting equipment, including wireless phones, may interfere with the function of inadequately protected medical devices. Consult a physician or the manufacturer of the medical device to determine whether they are adequately shielded from external RF energy. Switch off your device when regulations posted instruct you to do so, for example, in hospitals.

Implanted medical devices

Manufacturers of medical devices recommend a minimum separation of 15.3 centimetres (6 inches) between a wireless device and an implanted medical device, such as a pacemaker or implanted cardioverter defibrillator, to avoid potential interference with the medical device. Persons who have such devices should:

- Always keep the wireless device more than 15.3 centimetres (6 inches) from the medical device.
- Not carry the wireless device in a breast pocket.
- Hold the wireless device to the ear opposite the medical device.
- Turn the wireless device off if there is any reason to suspect that interference is taking place.

- Follow the manufacturer directions for the implanted medical device.

If you have any questions about using your wireless device with an implanted medical device, consult your health care provider.

Accessibility solutions

Nokia is committed to making mobile phones easy to use for all individuals, including those with disabilities. For more information, visit the Nokia website at www.nokiaaccessibility.com.

Hearing



Warning:

When you use the headset, your ability to hear outside sounds may be affected. Do not use the headset where it can endanger your safety.

Some wireless devices may interfere with some hearing aids.

Operating environment

This device meets RF exposure guidelines in the normal use position at the ear or at least 1.5 centimetres (5/8 inch) away from the body. Any carry case, belt clip, or holder for body-worn operation should not contain metal and should position the device the above-stated distance from your body.

To send data files or messages requires a quality connection to the network. Data files or messages may be delayed until such a connection is available. Follow the separation distance instructions until the transmission is completed.

Vehicles

Radio signals may affect improperly installed or inadequately shielded electronic systems in motor vehicles such as electronic fuel injection, electronic antilock braking, electronic speed control, and air bag systems. For more information, check with the manufacturer of your vehicle or its equipment.

Only qualified personnel should install the device in a vehicle. Faulty installation or service may be dangerous and may invalidate your warranty. Check regularly that all wireless device equipment in your vehicle is mounted and operating properly. Do not store or carry flammable liquids, gases, or explosive materials in the same compartment as the device, its parts, or accessories. Remember that air bags inflate with great force. Do not place your device or accessories in the air bag deployment area.

Switch off your device before boarding an aircraft. The use of wireless devices in an aircraft may be dangerous to the operation of the aircraft and may be illegal.

Potentially explosive environments

Switch off your device in any area with a potentially explosive atmosphere. Obey all posted instructions. Sparks in such areas could cause an explosion or fire resulting in bodily injury or death. Switch off the device at refuelling points such as near gas pumps at service stations. Observe restrictions in fuel depots, storage, and distribution areas; chemical plants; or where blasting operations are in progress. Areas with a potentially explosive atmosphere are often, but not always, clearly marked. They include areas where you would be advised to turn off your vehicle engine, below deck on boats, chemical transfer or storage facilities and where the air contains chemicals or particles such as grain, dust, or metal powders. You should check with the manufacturers of vehicles using liquefied petroleum gas (such as propane or butane) to determine if this device can be safely used in their vicinity.

Certification information (SAR)

This mobile device meets guidelines for exposure to radio waves.

Your mobile device is a radio transmitter and receiver. It is designed not to exceed the limits for exposure to radio waves recommended by international guidelines. These guidelines were developed by the independent scientific organisation ICNIRP and include safety margins designed to assure the protection of all persons, regardless of age and health.

20 Copyright and other notices

The exposure guidelines for mobile devices employ a unit of measurement known as the Specific Absorption Rate or SAR. The SAR limit stated in the ICNIRP guidelines is 2.0 watts/kilogram (W/kg) averaged over 10 grams of tissue. Tests for SAR are conducted using standard operating positions with the device transmitting at its highest certified power level in all tested frequency bands. The actual SAR level of an operating device can be below the maximum value because the device is designed to use only the power required to reach the network. That amount changes depending on a number of factors such as how close you are to a network base station.

The highest SAR value under the ICNIRP guidelines for use of the device at the ear is 1.28 W/kg.

Use of device accessories may result in different SAR values. SAR values may vary depending on national reporting and testing requirements and the network band. Additional SAR information may be provided under product information at www.nokia.com.

Copyright and other notices

DECLARATION OF CONFORMITY

CE 0434

Hereby, NOKIA CORPORATION declares that this RM-713 product is in compliance with the essential requirements and other relevant provisions of Directive 1999/5/EC. A copy of the Declaration of Conformity can be found at http://www.nokia.com/phones/declaration_of_conformity/.

© 2011 Nokia. All rights reserved.

Nokia and Nokia Connecting People are trademarks or registered trademarks of Nokia Corporation. Nokia tune is a sound mark of Nokia Corporation. Other product and company names mentioned herein may be trademarks or tradenames of their respective owners.

Reproduction, transfer, distribution, or storage of part or all of the contents in this document in any form without the prior written permission of Nokia is prohibited. Nokia operates a policy of continuous development. Nokia reserves the right to make changes and improvements to any of the products described in this document without prior notice.

To the maximum extent permitted by applicable law, under no circumstances shall Nokia or any of its licensors be responsible for any loss of data or income or any special, incidental, consequential or indirect damages howsoever caused.

The contents of this document are provided "as is". Except as required by applicable law, no warranties of any kind, either express or implied, including, but not limited to, the implied warranties of merchantability and fitness for a particular purpose, are made in relation to the accuracy, reliability or contents of this document. Nokia reserves the right to revise this document or withdraw it at any time without prior notice.

The availability of products, features, applications and services may vary by region. For more information, contact your Nokia dealer or your service provider. This device may contain commodities, technology or software subject to export laws and regulations from the US and other countries. Diversion contrary to law is prohibited.

/Issue 1.0 EN

Index**A**

alarm clock	14
-------------	----

B

battery	4
— charging	6

C

calls	10
clock radio	14
contacts	12

F

flashlight	15
FM radio	14

K

keys and parts	8
----------------	---

M

memory card	6
messages	11
multi-phonebook	12
music	13

N

Nokia original accessories	15
Nokia support information	15

P

powering device on/off	7
------------------------	---

R

radio	14
-------	----

S

SIM card	4, 9
support	15

switching device on/off	7
-------------------------	---

T

Text input	10
text input	10
text messages	11
turning device on/off	7