

Copyright

Copyright © 1998 by this company. All rights reserved. No part of this publication may be reproduced, transmitted, transcribed, stored in a retrieval system, or translated into any language or computer language, in any form or by any means, electronic, mechanical, magnetic, optical, chemical, manual or otherwise, without the prior written permission of this company.

Disclaimer

This company makes no representations or warranties, either expressed or implied, with respect to the contents hereof and specifically disclaims any warranties, merchantability or fitness for any particular purpose. Any software described in this manual is sold or licensed "as is". Should the programs prove defective following their purchase, the buyer (and not this company, its distributor, or its dealer) assumes the entire cost of all necessary servicing, repair, and any incidental or consequential damages resulting from any defect in the software. Further, this company reserves the right to revise this publication and to make changes from time to time in the contents hereof without obligation to notify any person of such revision or changes.

All brand and product names mentioned in this manual are trademarks and/or registered trademarks of their respective holders.

Contents

1. General Description	1
2. Feature & Specification	2
3. Assembly Drawing	3
4. Packing Detail	4
5. Installation	
Preface Note	5
PART A	
PART B	6
PART C	
Appendix	7
6. Product Family	8
7. Hardware Limited Warranty	9
8. FCC Radio Frequency	
Interference Statement	10

General Description

The removable storage enclosure is easily integrated with storage racks allow you easily remove a 3.5 " or 5 1/4 " device from your **PC, MAC,** workstation or disk array sub-system. It is also the perfect solution for protecting your valuable data.

The device provide a simple and valuable way to transport data between computers, and is also useful for on line backup and storage of critical files. Sensitive information can be easily removed and secured. The device designed for use in hot swap and hot removable environment, thus making it ideal for **RAID** applications.

The device is available in ultra wide, ultra 2 wide, 80 pin SCA2 connector type.

Feature & SPECIFICATION

	SI-151C	SI-152C	SI-153C	SI-154C	SI-155C	SI-156C	SI-157C
1.Dimension (LxWxH)	208 × 149 × 42	208 × 149 × 42	208 × 149 × 42	208 × 149 × 42	208 × 149 × 42	208 × 149 × 42	208 × 149 × 42
2.Weight	0.9kg	0.9kg	0.9kg	0.9kg	0.9kg	0.9kg	0.9kg
3.Temperature Operating: Non-Operating:	5°C~60°C -25°C~80°C	5°C~60°C -25°C~80°C	5°C~60°C -25°C~80°C	5°C~60°C -25°C~80°C	5°C~60°C -25°C~80°C	5°C~60°C -25°C~80°C	5°C~60°C -25°C~80°C
4.Humidity Operating: Non-Operating:	20%~80% 15%~90%	20%~80% 15%~90%	20%~80% 15%~90%	20%~80% 15%~90%	20%~80% 15%~90%	20%~80% 15%~90%	20%~80% 15%~90%
5. Power	Green LED	Green LED	Green LED	Green LED	Green LED	Green LED	Green LED
5. HDD Access	Yellow LED	Yellow LED	Yellow LED	Yellow LED	Yellow LED	Yellow LED	Yellow LED
5. HDD Fail	RED LED	RED LED	RED LED	RED LED	RED LED	RED LED	RED LED
5. SCSI ID		LCD	7 Segment LED		LCD	7 Segment LED	
5. LCD		YES			YES		
6.Cooling	Cooling Fan 4 × 4 × 1 1 option in front of bezel	Cooling Fan 4 × 4 × 1 1 option in front of bezel	Cooling Fan 4 × 4 × 1 1 option in front of bezel	Cooling Fan 4 × 4 × 1 1 option in front of bezel	Cooling Fan 4 × 4 × 1 1 option in front of bezel	Cooling Fan 4 × 4 × 1 1 option in front of bezel	Cooling Fan 4 × 4 × 1 1 option in front of bezel
7.Power input	+5V +12V	+5V +12V	+5V +12V	+5V +12V	+5V +12V	+5V +12V	+5V +12V
8.Power output	+5V 3A +12V 4A	+5V 3A +12V 4A	+5V 3A +12V 4A	+5V 3A +12V 4A	+5V 3A +12V 4A	+5V 3A +12V 4A	+5V 3A +12V 4A
9.Interface	SCA2 LVD	SCA2 LVD	SCA2 LVD	SCA2 LVD	SCA2 LVD	SCA2 LVD	SCA2 LVD
	1	1	1	1	1	1	1

ASSEMBLY DIAGRAM

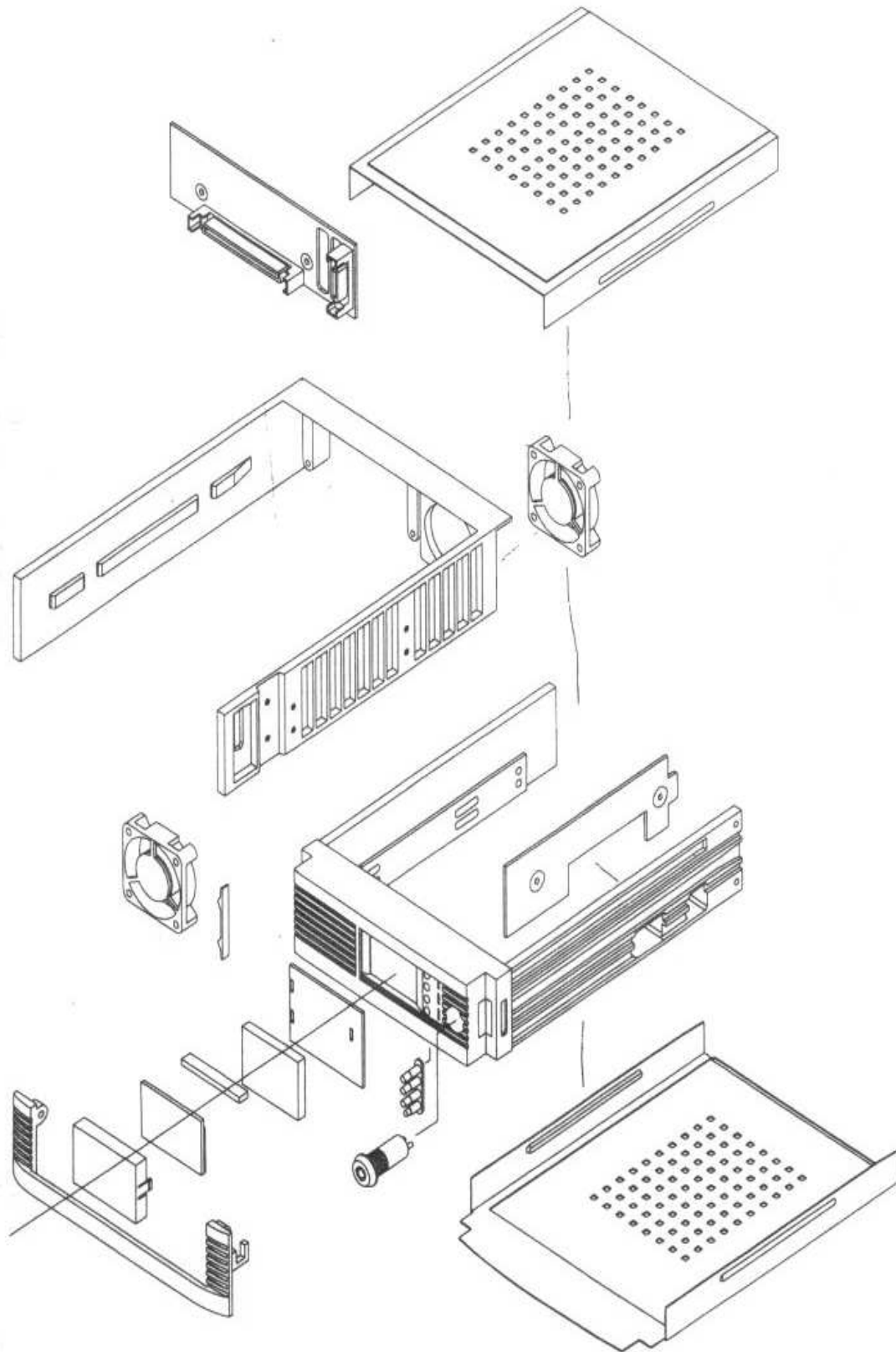

PACKING DETAIL

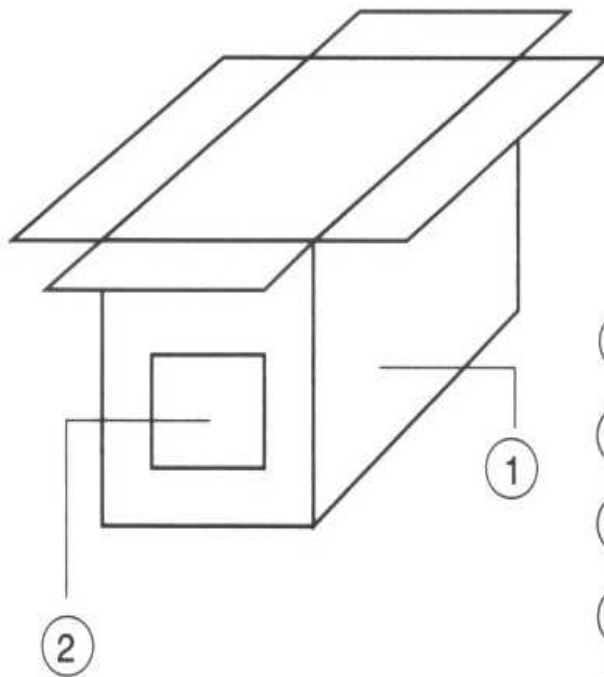
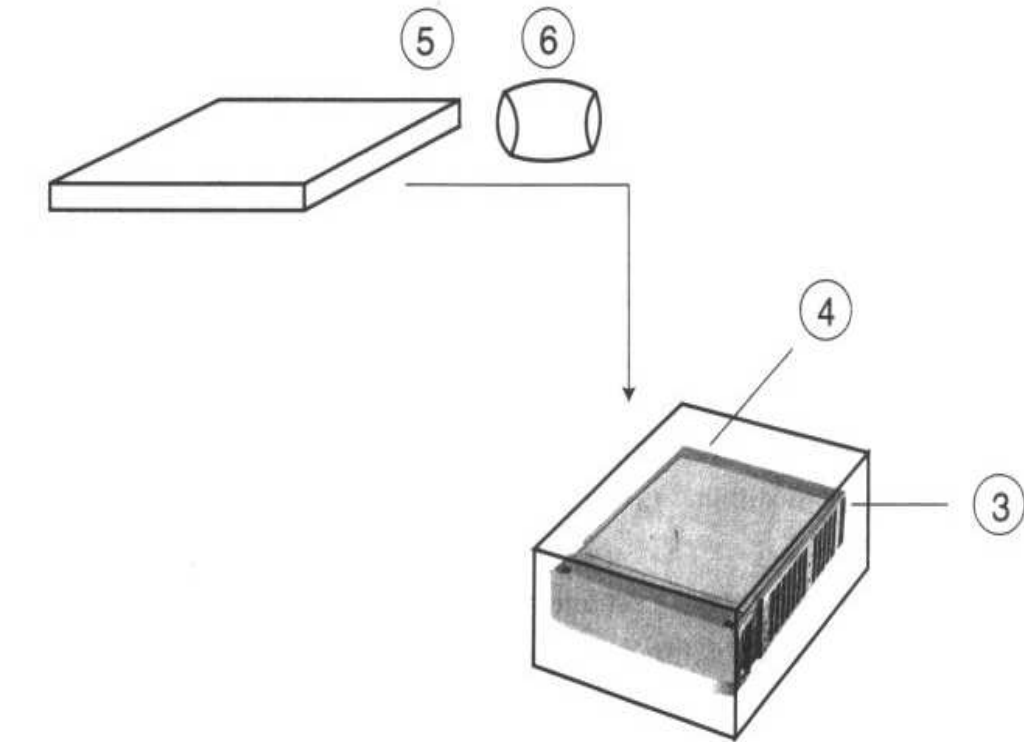

MATERIAL LIST

①	EXPORT CARTON	x1
②	SIDE MARK	x1
③	PVC	x1
④	PRODUCT	x1
⑤	MANUAL	x1
⑥	ACCESSORY PACK	x1

INSTALLATION

Preface Note:

Hard disk is a sensitive storage device. And you may have vital data on the hard disk. To prevent accidentally data loss or hard disk damage, you should take care during the installation. Before touching any electrical equipment, ground yourself by touching the metal parts of the computer chassis. This may prevent static discharge damages. Be sure the power cord of the connection the socket is correct.

Following steps should be taken care after you have installed the SI-15x

1. Turn the key lock to ON position before you turn on your computer.
2. Check the LCD panel, or LED to make sure they are correct.
3. IF you experience problem, check the cable connection first, and the bus terminator.
4. Remove hard disk tray while computer is running is not recommended. If you want to do so, make sure the hard disk access action is stopped, turn the keylock to OFF position. Wait at least 10 seconds until the drive slow down and the head is parked.

SSI is not liable for any loss of data. IT is the user's responsibility to take care of the hard disk drive to safeguard the data.

PART A. Mounting Hard Disk Drive Into Removable tray.

1. Open the top and bottom cover. (fig.2-1)
2. Insert SCA HDD and screw up. (fig.2-2)

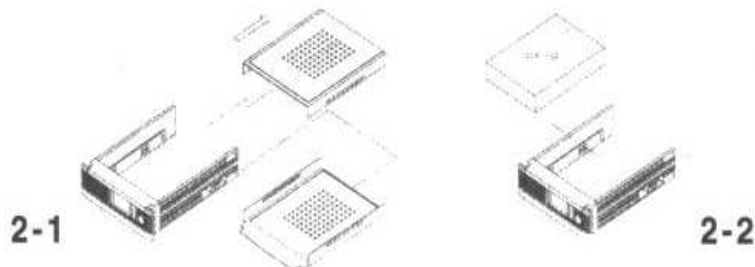

PART B. Mounting the Fixed Rack Into computer Bystem.

1. Disconnect computer power source, open computer cover, insert the fixed Rack into 5 1/4" bay. (flg1-1)
2. Connect 5V/12V power cord and signal cable to the back side of the Fixed Rack See (fig.1-2) for detail description.
3. After all necessary cables are properly connected, tighten the screws and closed the cover. (fig.1-3)
4. Place the hard disk in postion and tightenthe fixed screws.

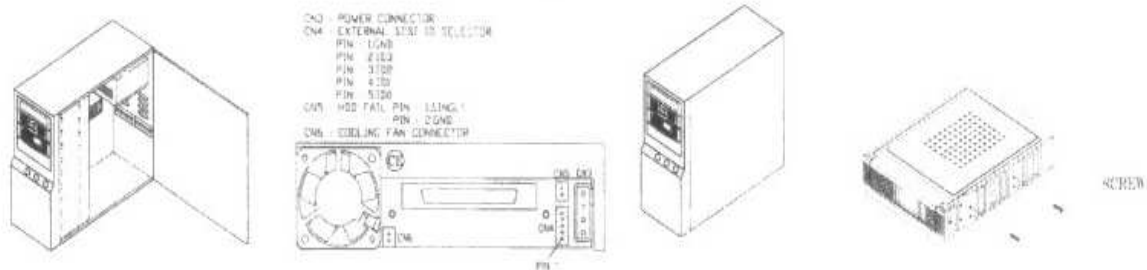

PART C. Set up LCD display panel controller (SL-152 / 155 only)

The built In controller has following function

1. Record MTBF in days & hours.
2. Set SCSI ID number.
3. Measure hard disk temperature and using front Fan to regulate user-presetted temperature.
4. Monitoring operating voltage and indicating HDD access.

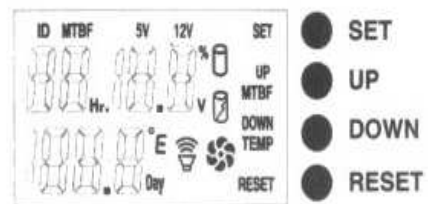

SETTING CYCLE

START

- ID** STEP1: Press "SET" key, the ID will blnk.
STEP2: Press "UP" key lo Increase SCSI ID number
STEP3: Press "DOWN" key to decrease SCSI ID number.
- BUZZER** STEP1: Press "Set" key again, the buzzer sign ◀ will blink.
STEP2: "UP" or "DOWN" key to select buzzer mode:
MODE ◀ :Press any key to disable the buzzer when error happens. And will beep one lime perminule until the error corrected,or when new error happens.
MODE ◀ :Press any key to disbale the buzzer when error happens, and will beep only new error happens
- MTBF** STEP1: Press "SET" key again, the "88 Hr" and "1888 Day" will blnk
STEP2: Press "UP" or "DOWN" key to clear MTBF as "Ohr" and Oday"
- TEMP** STEP1: Press "SET" key again, the temperature digits will blnk
STEP2: Press "UP" key to Increase temperature setting
STEP3: Press: "DOWN" key to decrease temperature setting
- Voltage** STEP1: Press "SET: key again.
STEP2: Press "UP" or "DOWN" key to choose voltage deteoting moed
MODE 5%: Detecting input voltage as the loterance of 5% only,the buzzer will beep when the voltage is higher or lower 5% than standard, Suitable for industrial environment.
MODE 10% Detecting Input voltage as the tolerance of 10% only, the buzzer will beep when the voltage is higher or lower 10% than standard,Suitable for normal environment.
MODE 0%: Detecting Input voltage only.
- END** Exit setting cycle 11 any key un-pressed longer than 8 seconds.

Appendix:

B.SCSI bus terminator

If you want to connect more than one SCSI device on the same Controller, the SCSI bus terminator has to be taken care. Following Diagram shows a typical application SCSI bus terminator

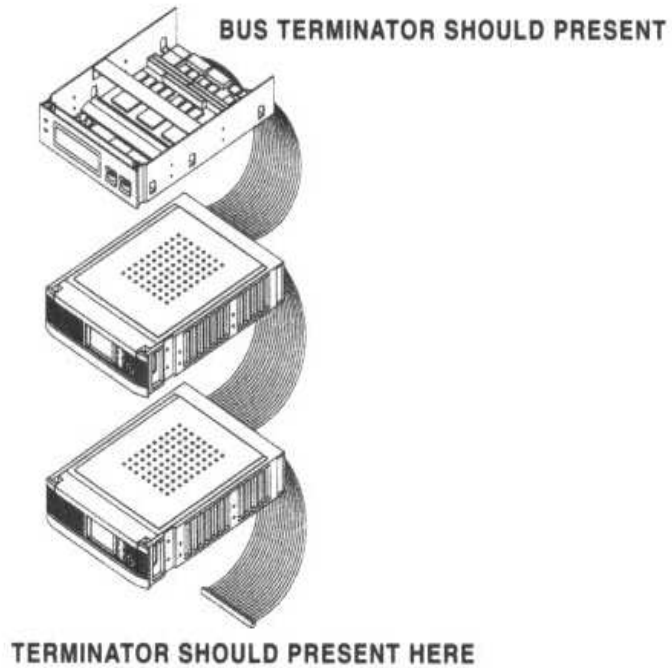

The terminator resistor pack should be located on both end of the bus cable. Diagram below shows the bus terminator location if you use an external SCSI device on the same SCSI controller.

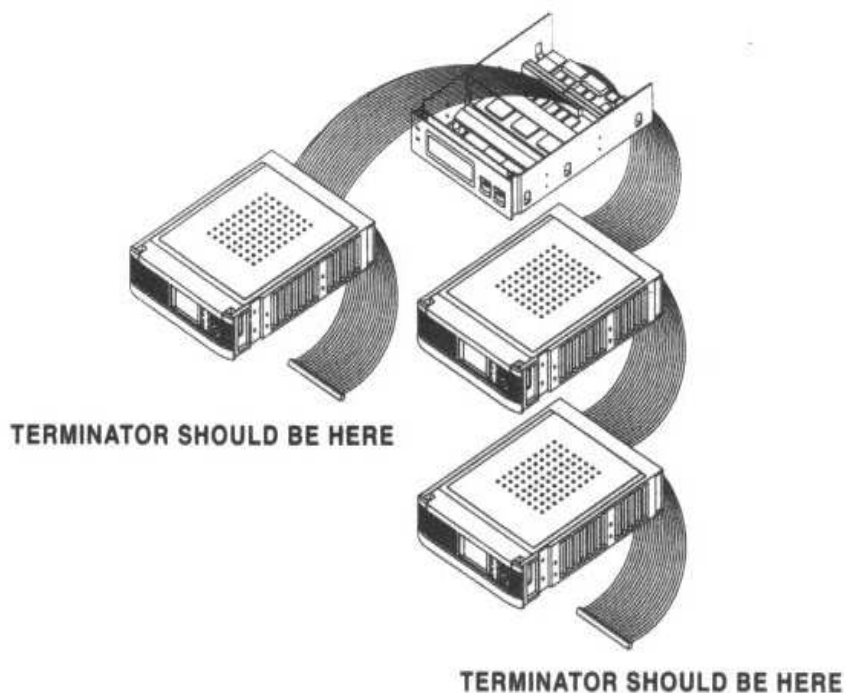

Product Family

		SI-151C	SI-152C	SI-153C	SI-154C	SI-155C	SI-156C	SI-157C
I N T E R F A C E	IDE							
	SCSI							
	WIDE SCSI							
	SCA	✓	✓	✓	✓	✓	✓	✓
FRONT FAN		Option	✓	Option	Option	✓	Option	
BACK FAN		✓	✓	✓	✓	✓	✓	✓
FAN DETECT		✓	✓	✓	✓	✓	✓	
ID-DISPLAY			✓	✓		✓	✓	
LCD			✓			✓		
HDD FAILURE LIGHT INDICATOR		✓	✓	✓	✓	✓	✓	✓
TEMPERATURE DETECT			✓			✓		
FORCELESS HANDLE		✓	✓	✓	✓	✓	✓	✓

Hardware Limited Warranty

Our imaging DEVICE are warranted to be free from failures due to defects in material and workmanship for one years from the date of original purchase as evidenced by a copy of the purchase receipt. During the warranty period, at sole discretion, will repair or replace at no charge, the product which, in its opinion, is defective.

The original purchaser is responsible for packing the product for shipment and for the charges to ship the failed product to its responsible distributor. If any charge to you is involved, the replacement product will be shipped C.O.D.

If the failed product has been modified in any way without the consent of SSI or if the failure is the result of misuse, abuse, or misapplication, SSI has no obligation to repair or replace the failed product.

EXCEPT AS EXPRESSLY PROVIDED ABOVE, THE HARDWARE AND ACCOMPANYING WRITTEN MATERIALS (INCLUDING THE USER 'S GUIDE) ARE PROVIDED "AS IS" WITHOUT WARRANTY OF ANY KIND INCLUDING THE IMPLIED WARRANTIES OF MERCHANTABILITY AND FITNESS FOR A PARTICULAR PURPOSE. SSI SPECIFICALLY DOES NOT WARRANT THE OPERATION OF THE HARDWARE AND WILL NOT BE LIABLE FOR ANY DIRECT, INDIRECT, CONSEQUENTIAL OR INCIDENTAL DAMAGES ARISING OUT OF THE USE OR INABILITY TO USE SUCH PRODUCT EVEN IF HAS BEEN ADVISED OF THE POSSIBILITY OF SUCH DAMAGES. SOME COUNTRIES DO NOT ALLOW THE EXCLUSION OR INCIDENTAL DAMAGE, SO THE ABOVE LIMITATION MAY NOT APPLY.

FCC Class B Radio Frequency Interference Statement

Note:

This equipment has been tested and found to comply with the limits for a Class B digital device, pursuant to Part 15 of FCC Rules. These limits are designed to provide reasonable protection against harmful interference in a residential installation. This equipment generates, uses, and can radiate radio frequency energy and, if not installed and used in accordance with the instructions, may cause harmful interference to radio communications. However, there is no guarantee that interference will not occur in a particular installation. If this equipment does cause harmful interference to radio or television reception, which can be determined by turning the equipment off and on, the user is encouraged to try to correct the interference by one or more of the following measures:

1. Reorient or relocate the receiving antenna.
2. Increase the separation between the equipment and receiver.
3. Connect the equipment into an outlet on a circuit different from that to which the receiver is connected.
4. Consult the dealer or an experienced radio/television technician for help.

Notice 1:

The changes or modifications not expressly approved by the party responsible for compliance could void the user's authority to operate the equipment.

Notice 2:

Shielded interface cables, if any, must be used in order to comply with the emission limits.