



# NA1550 AV Media Receiver User Manual



Enjoy the Lifestyle of In-Car Entertainment

# CONTENTS

## Contents

Thank you for purchasing a Nakamichi products.

Please read all instructions carefully before operation, to ensure your complete understanding and to obtain the best possible performance from the unit.

### INTRODUCTIONS

What's in the box.....	2
Installation .....	3
Wiring diagram .....	4
Overview the unit .....	5
Basic operations.....	6

### AV MEDIA

Listening to the radio.....	7
Playing of USB/SD/DISC.....	8
Playing of Music.....	9
Enjoying the movie.....	10
Viewing the photo.....	11

### AUDIO ADJUSTMENT

Speaker/Subwoofer.....	12
Equalizer.....	13

### BLUETOOTH

Using bluetooth.....	14
----------------------	----

### MIRROR PHONE

Smart Phone Mirroring - AV System.....	15
----------------------------------------	----

### REFERENCE

Specifications.....	16
---------------------	----

# INTRODUCTIONS

## What's in the box

---

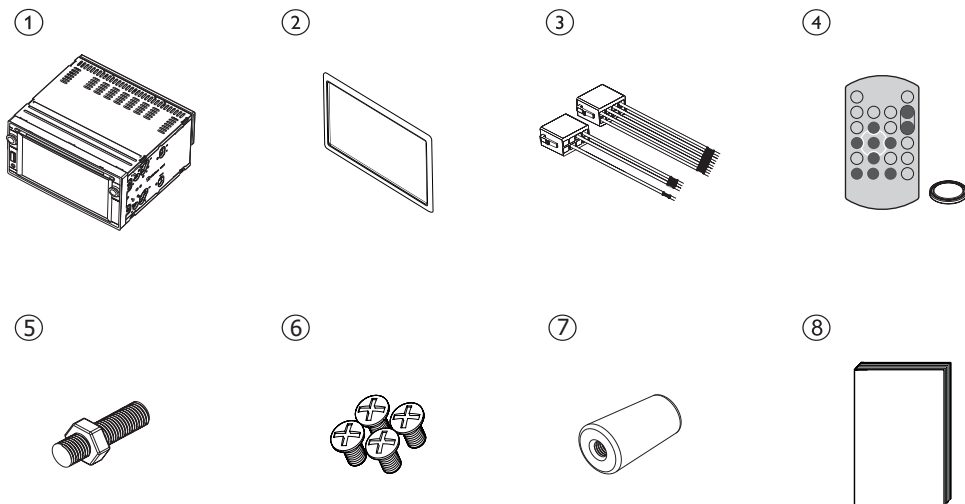

### Check and identify the contents of the package:

- |                            |                        |
|----------------------------|------------------------|
| 1 Main unit                | 5 Hexagon head screw   |
| 2 Trim plate               | 6 Screw X 4 (M5 x 8mm) |
| 3 ISO male connector X 2   | 7 Rubber cushion       |
| 4 Remote control & battery | 8 User manual          |

# INTRODUCTIONS

## Installation

The following illustration shows a typical installation. If you have any question or require information regarding installation kits, consult your customer car audio dealer or a company supplying kits.

If you are not sure how to install this unit correctly, have it installed by a qualified technician.

Mount in the dashboard:

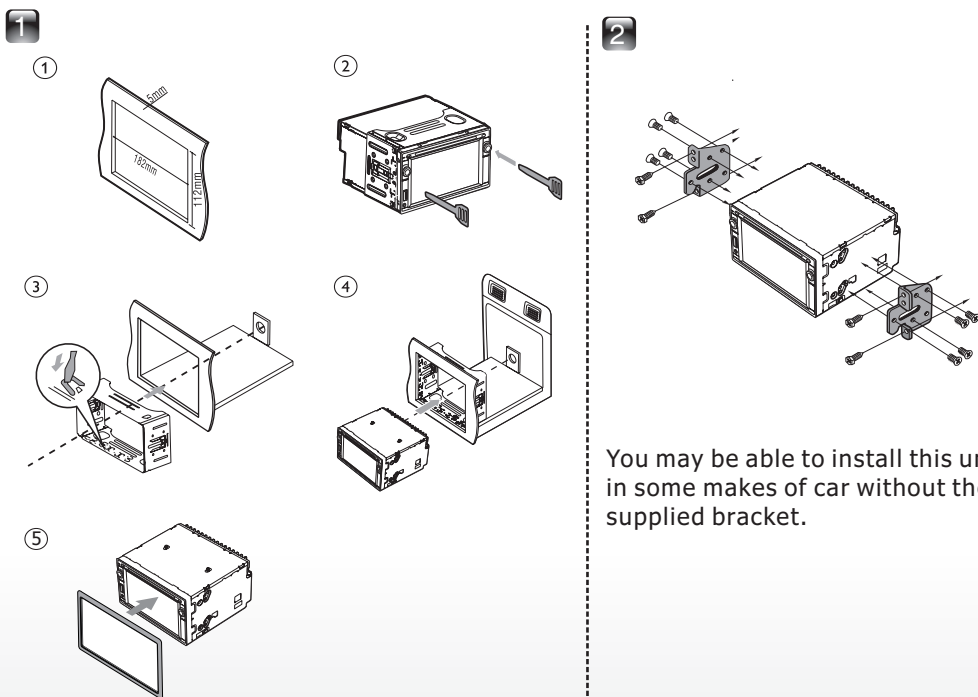

1. Make sure that the car dashboard opening is within these measurements.
2. Remove the mounting sleeve with the supplied disassembly tools.
3. Install the sleeve into the dashboard and bend the tabs outward to fix the sleeve.
4. Slide the unit into the sleeve until you hear a "click".
5. Attach the trim plate.

You may be able to install this unit in some makes of car without the supplied bracket.



All the mounting sleeve & screw are not included in this packing.

# INTRODUCTIONS

## Wiring diagram

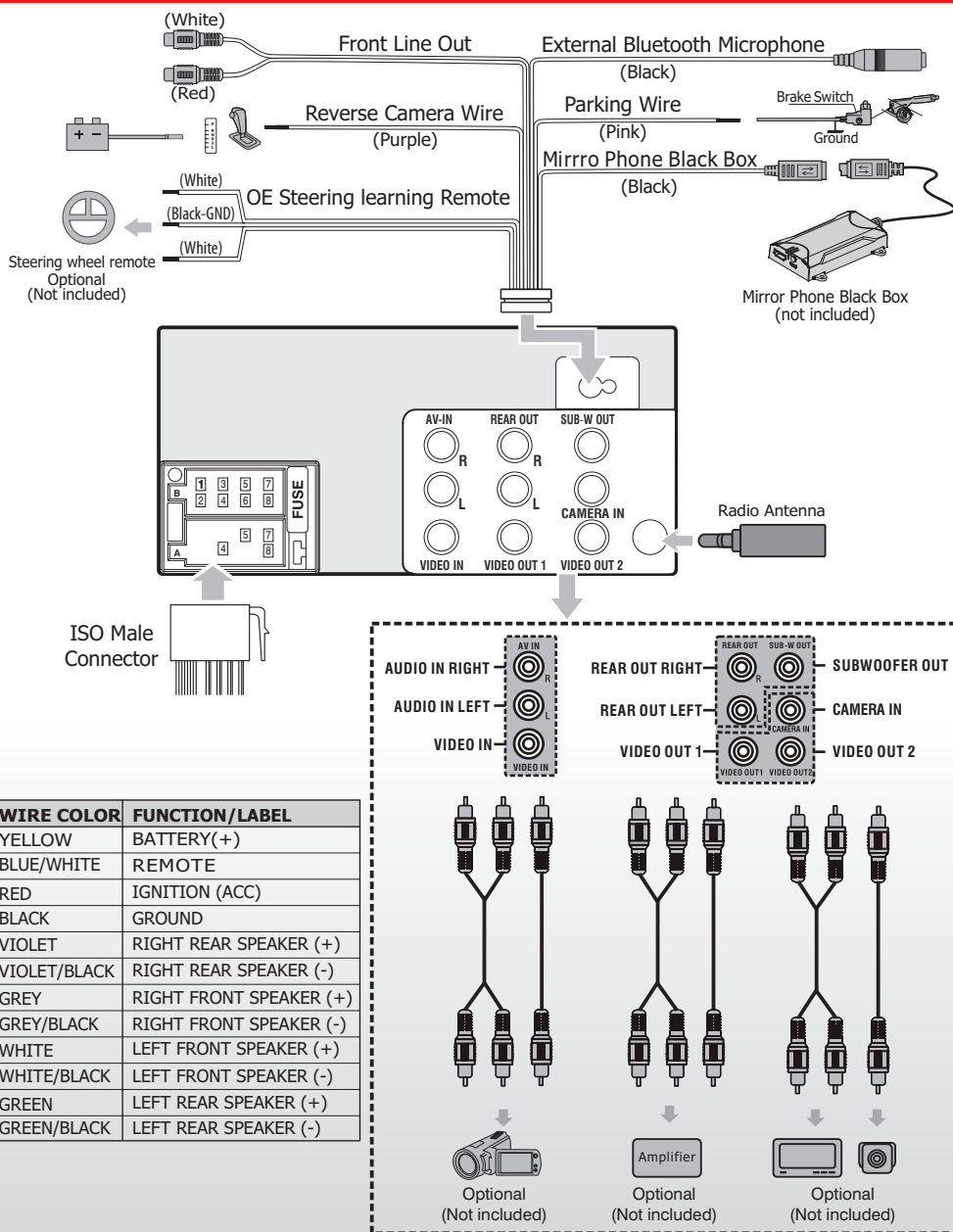

# INTRODUCTIONS

## Overview the unit

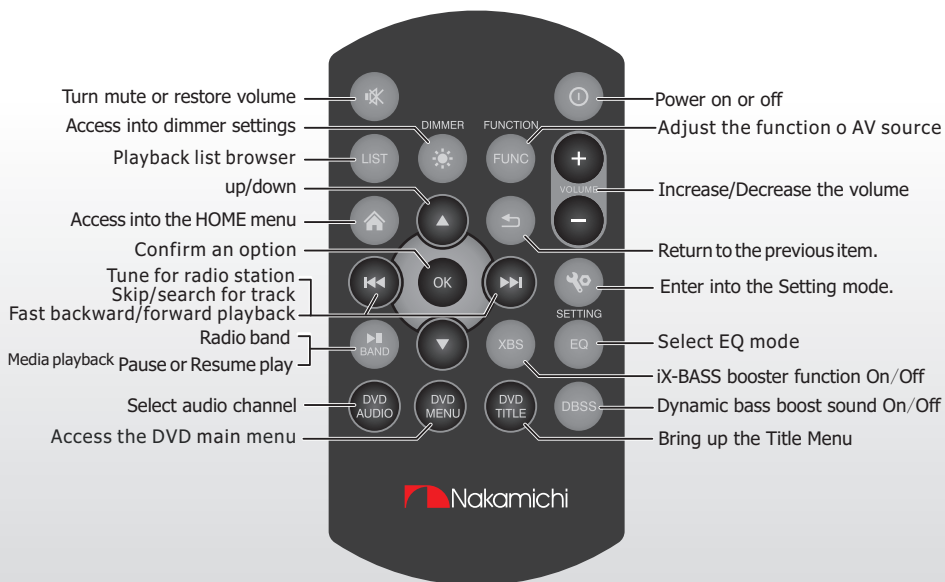

# INTRODUCTIONS

## Basic operations



Access to HOME

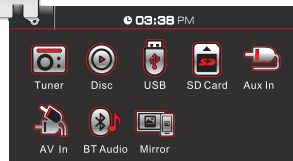

Access to CLOCK



Audio Control



Adjust the brightness



Access to Setup Menu

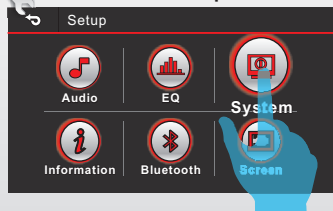

Access to system settings

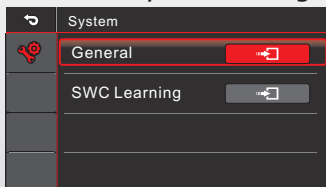

Access to General settings

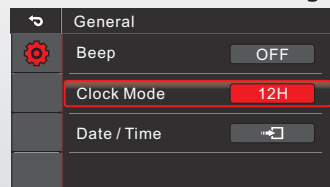

# AV MEDIA

## Listening to the radio

Tap on  button on the TFT screen access into the tuner function.

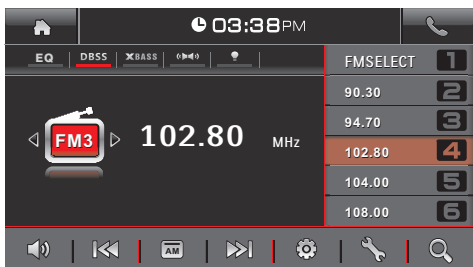

Tap on  button into the Tuner Function menu.

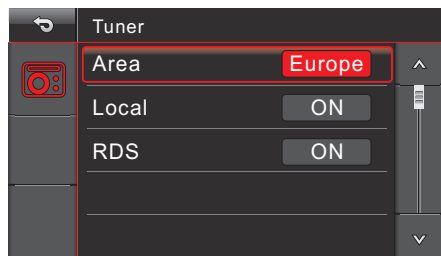

Tap BAND to change to FM or AM



Press to AUTO SEEK  
Press and hold to MANUAL SEEK

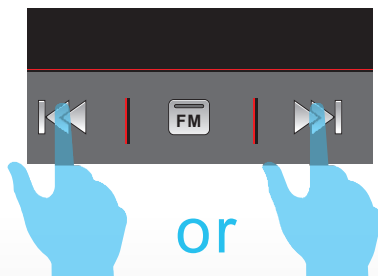

Tap to Auto Store



Press and hold to Store stations



Preset List





# AV MEDIA

## Playing of USB/SD/DISC

You can use this system to listen to audio, watch videos, and view photos that are stored on a disc, USB storage device, or SD/SDHC card.

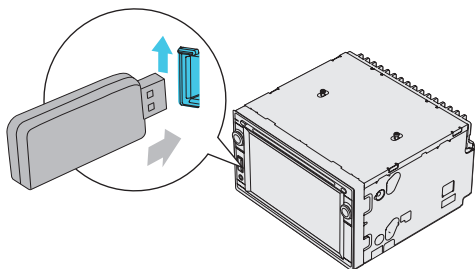
### Play a USB device:



Tap  to start playback of the source.

### Play a SD/SDHC device:

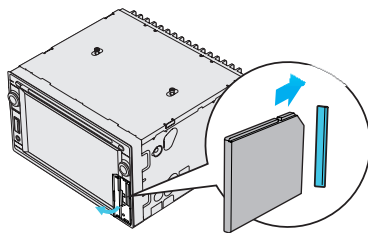

Tap  to start playback of the source.

### Load a disc:

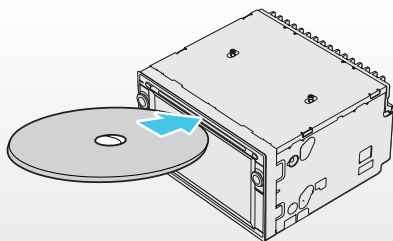

Tap  to start playback of the source.

### Play external audio/video input:

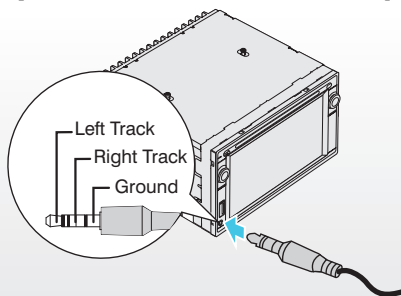

Tap  to start playback of the source.

# AV MEDIA

## Playing of Music



### Audio Control



### Mute/ Up/play or Pause/down



### Play file list browser

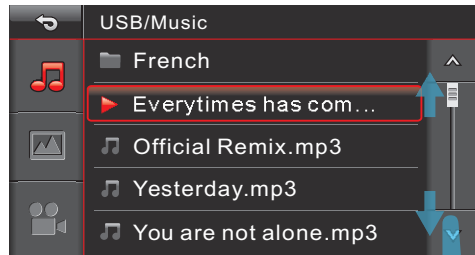

### Adjust the different Repeat mode

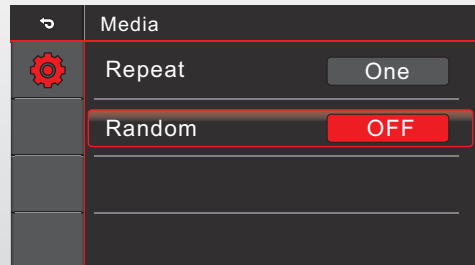

# AV MEDIA

## Enjoying the movie

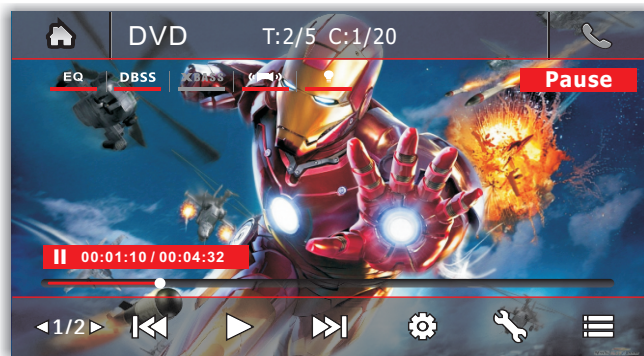

	Home menu
1/2 2/2	Change function bar
	Previous, Pause /Play, Next
	Media function menu.
	access to system menu
	Top Menu or Browser
	Select the audio type. (For DVD-VR:Select the audio channel)
	Repeat playback mode
<b>GOTO</b>	Access into the search mode (DVD only).
	Up/Down/Left/Right
	Zoom the video & photo
<b>4:3 16:9</b>	Select aspect ratio

# AV MEDIA

## Viewing the photo

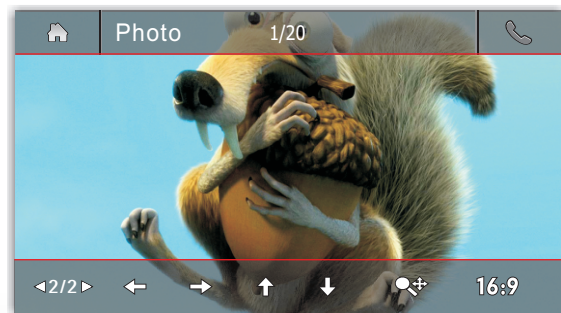

1/2    2/2	Change function bar
☰	Top Menu or Browser
←	Move left the zooming frame
↑	Move up the zooming frame
↓	Move down the zooming frame
→	Move right the zooming frame
🔍+	Zoom the photo

# AUDIO ADJUSTMENT

## Speaker/Subwoofer

### Access to System Menu

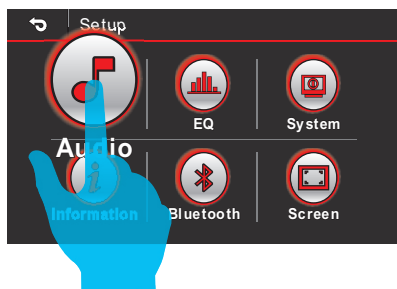

### Access to Audio Menu

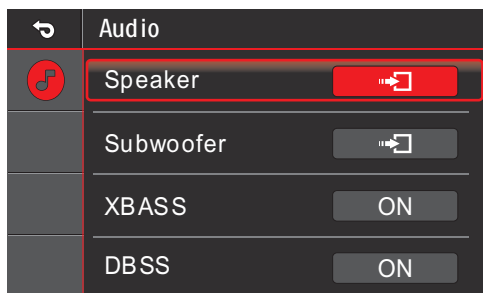

### Speaker settings

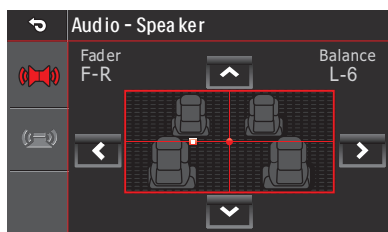

Adjust Fader/Balance Value From -12 to +12.

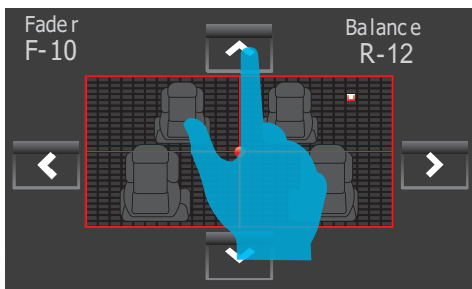

### SUB-WOOFER settings

Touch to turn On / Off the subwoofer  
Tap on / buttons to adjust value of subwoofer level.

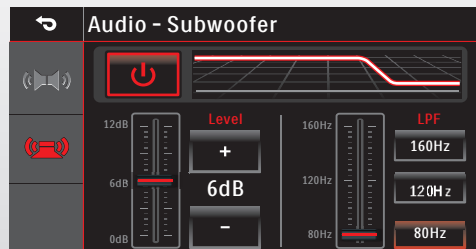

Low Pass Filter Transfer Function



# AUDIO ADJUSTMENT

## Equalizer

### 6 Preset EQUALIZER

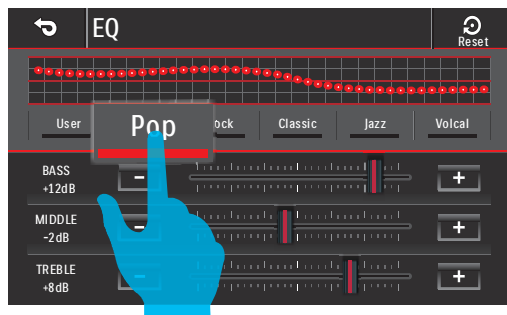

Tap on **+/-** button to adjust the level:

- [BASS]: bass level range -15dB to +15dB.
- [MIDDLE]: middle level range -15dB to +15dB.
- [TREBLE]: treble level range -15dB to +15dB.



 Resume to factory default value

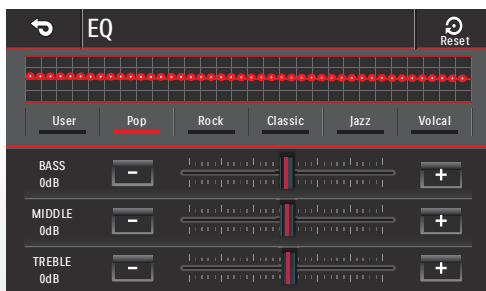
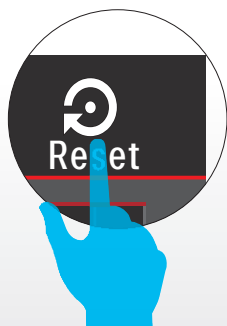

# BLUETOOTH

## Using bluetooth

How to pair & connect device ?



Pairing code "0000"

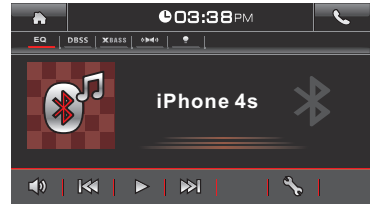

Connecting

Making A Call

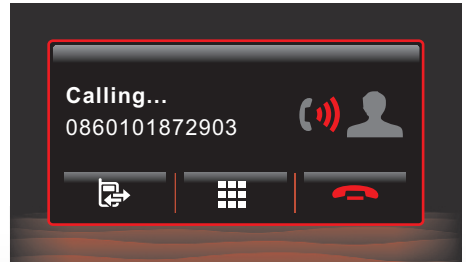
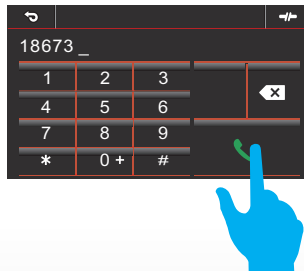

Call Transfer

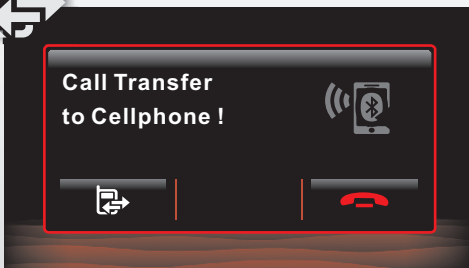

# MIRROR PHONE

## Smart Phone Mirroring - AV System

This model supports MIRROR PHONE BOX function, It can mirror your smart phone screen to CarMirror-AV system instantly.

It can also support 2-way control between your smart phone & CarMirror-AV system after the free CarMirror app is downloaded & installed.

### Mirroring

As long as the Mirror Phone Box is connected, it can project or "MIRROR" your smart phone screen to the display panel of the CarMirror-AV system smoothly.

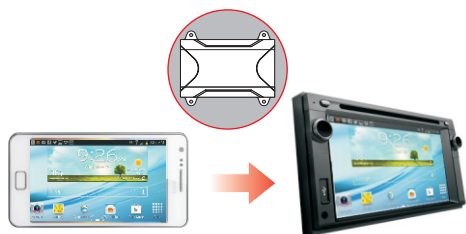

### 2-Way Control

After installing the free app of CarMirror from Google Play Store, you can operate your Smart Phone directly on the CarMirror-AV system screen and vice versa.



### Virtual Buttons:

Press and hold the "App" button on the CarMirror-AV system, and the virtual control buttons for the smart phone will pop up automatically.



	Smart phone "Menu" button
	Smart phone "Home" button
	Smart phone "Return" button



This function only available when an external mirror box(not supplied) is connected with the system.



# REFERENCE

## Specifications

### TFT Monitor section

Screen Size	:6.2 inches
Display Resolution	:800x480 dots
Contrast Ratio	:500

### Disc player section

Disc System	:DVD/CD/VCD
Disc Diameter	:12cm
Frequency Response	:20Hz - 20kHz
Signal/Noise Ratio	:>75 dB
Total Harmonic Distortion	:Less than 0.3%
Channel Separation	:>55 dB
Video Signal Format	:NTSC/PAL
Video Output	:1+/-0.2V p-p

### USB interface section

USB Standard	:USB 2.0 Full Speed
File System	:FAT 16/32
Maximum Current	:DC 5V= 1A
D/A Converter	:24Bit
Video Decoder	:MPEG1/MPEG2
Audio Decoder	:MP3

### Memory Card section

Memory Cards	:SD/SDHC
Maximum Capacity	:32G

### Bluetooth section

Communication System	: Bluetooth Standard version 2.0
Output	: Bluetooth Standard Power Class 2
Maximum Communication Range	: Approx. 5meters
Frequency Band	: 2.4 GHz
Compatible Bluetooth Profiles	: HFP/HSP/A2DP/AVRCP
Supported Codecs	: SBC (Sub Band Codec)

### Radio section

Frequency FM range	: 87.5 - 108.0 MHz
Frequency AM(MW) range	: 522-1620 KHz
Usable sensitivity	: 2 uV (FM) : 80 uV (AM)(MW)

### Video section

Color System of External Video Input	: NTSC/PAL/SCEAM
External Video Input (RCA/3.5m Jack)	: 1 Vp-p /75Ω

### Audio section

Maximum Power	: 50Wx4
Continuous Power Output (RMS)	: 22 Wx4
Preout Level (V)	: 2 V/10kΩ
Preout Impedance	: ≤ 600Ω
Speaker Impedance	: 4-8 Ω
External Audio Input Level (RCA)	: 1 V/10KΩ
External Audio Input Level (3.5mm Jack)	: 600mv/10KΩ ( <1%THD)

### General

Operating Voltage	: 14.4V(10.5-16 V)
Dimension(WxHxD)	: 178x102x172mm
Operational Temperature Range	: -10°C-+60°C
Weight	: 1.93 kg



Design and specifications are subject to change  
without notice

© 2013 Nakamichi  
[www.nakamichicaraudio.com](http://www.nakamichicaraudio.com)

