

kojack™

Model No. KJ4000

Hydraulic Caravan Bottle Jack & Levelling Aid



User Manual



KJ4000-UM-0708

General Safety



Important Safety Instructions

Read this User Manual carefully before use. Failure to comply with these rules could result in serious injury or damage to property.

1. Read ALL of this User manual and become familiar with the product's application, limitations and possible hazards.
2.  
These symbols identify important safety precautions. They mean **CAUTION!** **WARNING!** **SAFETY FIRST!**
3. Keep work area clean and free from obstruction.
4. Keep children at a safe distance of apparatus whilst in operation.
5. Only use adapters and accessories that are supplied or recommended by the manufacturer.
6. Keep the apparatus clean and in good operating condition.
7. Inspect the bottle jack each time you use it. Ensure that there are no loose, bent or missing parts. **Never attempt to use the jack if it is in any way defective.**
8. Do not operate the jack if you are under the influence of drugs, alcohol or any medication that could impair your ability to use the equipment safely.

Product Identification

1. Handle Socket
2. Slotted Saddle
3. Oil Filler Plug
4. Release Valve
5. Handle
6. Chassis Brackets
7. Bracket Fixings
8. Spirit Levels
9. Mounting Holes
10. Lifting Arm
11. Pump

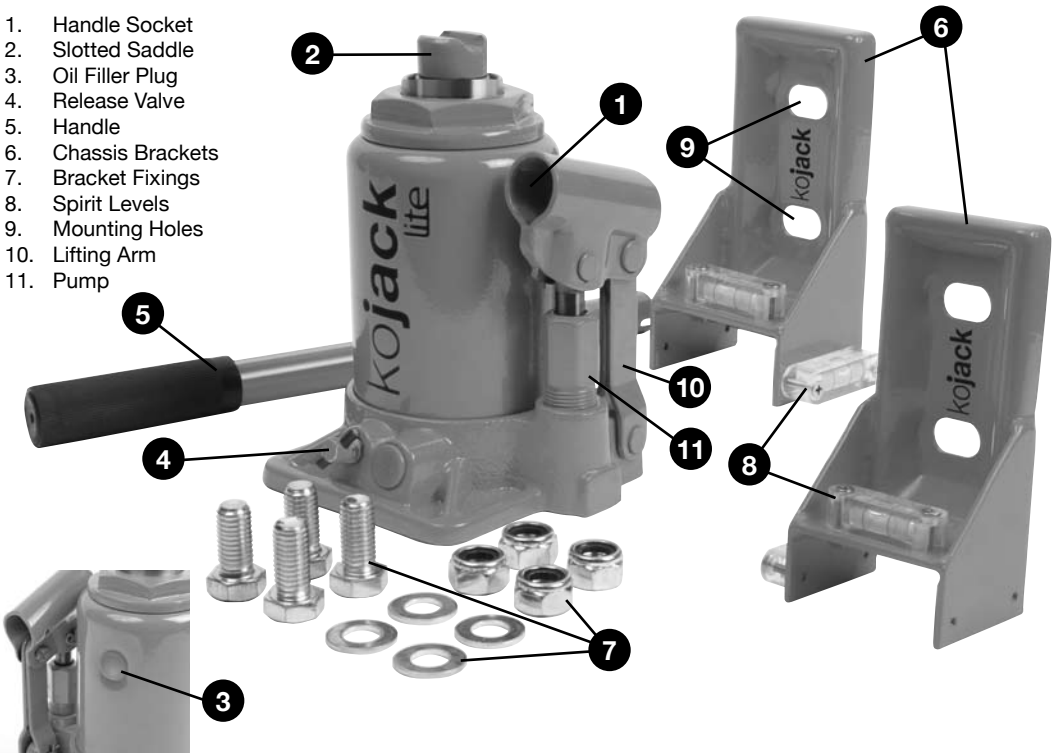

Oil filler plug on rear of bottle jack

Installation & Operation



CAUTION!

This jack is designed for lifting purposes only.

After jacking, always use safety stands to support load before making any repairs. For your safety, do not overload beyond rated capacity and do not adjust safety valve.



Never over extend the second section of the jack. When the red indicator line appears STOP pumping. Over exertion may damage the jack.



Chassis Bracket Installation

1. The chassis brackets are suitable for AL-KO caravan chassis manufactured after 1992 that have pre-drilled mounting holes already on the chassis.
2. The chassis brackets can be mounted onto single and twin-axle caravans, behind the axles on both sides. The brackets are marked 'OFF-SIDE' for installation on the 'driver's' side of the caravan when hitched and 'NEAR-SIDE' for installation on the door side (UK) of the caravan. The brackets can be installed onto continental caravans by reversing the brackets.
3. 2 sets of bolts, washers and nylock nuts are supplied for fixing each bracket onto both sides of the caravan.
4. Line-up the holes on the bracket with the pre-drilled chassis holes and secure using the supplied nuts and bolts. *The bolt heads and washers must be on the outside of the chassis with the nylock nuts on the inside.* Ensure that the brackets are, as close as possible, at 90° degrees to the horizontal floor of the caravan. Careful fitting at this stage, ensures that the spirit levels will give a true reading to aid accurate levelling.
5. Ensure that the bolts are sufficiently tightened up to 86Nm.

Levelling Aid

1. The inclusion of 2 spirit level vials per bracket (one for the length of the caravan and one for width) provides the caravanner with accurate guidance in determining and adjusting the level of the caravan.
2. With the aid of the easy to use hydraulic jack, the level of the caravan can be adjusted simply and chocked accordingly with suitable platforms.

Hydraulic Jack Operation

1. Before jacking, the caravan must be attached to the towing vehicle and the handbrake must be applied on both the caravan and the vehicle.
2. Chock the caravan wheel (back & front) on the opposite side to the wheel to be lifted/changed. Place the jack in-line with the bracket on the side of the caravan to be raised. If the ground surface is soft, a board, plank or similar should be placed underneath the jack.



Only use the jack on a flat, hard surface.



Gloves should be used to avoid hand injury.

3. Tighten release valve on base of jack by turning the valve (4) clockwise, firmly.
 4. Insert the operating handle (5) into the handle socket (1) and pump the handle up and down until the slotted saddle (2) is aligned with the base of the chassis bracket (6).
 5. Once correctly aligned, continue to pump handle to raise the caravan to the required height. Use smooth, full strokes for best results.
 6. To lower the caravan, remove the handle (5) from the handle socket (1), then use the flattened end of the handle to turn the release valve (4), **carefully and slowly**, anti-clockwise - never more than two full turns.
- (cont.)

Operation



Do not raise the caravan more than necessary; only raise until the wheel is sufficiently clear of the ground.



Do not lie underneath the caravan whilst it is jacked up as this could result in serious injury.

Care and Maintenance

1. Do not totally unscrew and remove the Release Valve (4) as this may unseat the rubber seal from the bottom of the housing.
2. When not in use the lifting arm (10) and pump (11) should be in the lowest position.
3. Keep pivot points well lubricated.
4. Store handle with jack, in the supplied carry case, to avoid loss.
5. Change hydraulic oil at least once a year.
6. **To change oil:**
 - a. With the lifting arm (10) in the lowest position, remove oil filler plug (3) on rear of body.
 - b. Tip jack to allow fluid to drain out of reservoir completely, dispose of oil ONLY in accordance with local authority regulations.
 - c. With jack upright, fill reservoir until level with the oil filler plug hole. Fill with high quality hydraulic jack oil only. DO NOT use brake fluid, transmission oil or turbine oil.
 - d. Reinstall the oil filler plug (3).
7. **To purge trapped air:**
 - a. Open release valve (4) - Never more than two full turns.
 - b. Hold down the lifting arm (10) and
 - c. Operate pump handle (5) rapidly several times.
 - d. Depress the rubber oil filler plug (3) just enough for any air to escape. If you hear a hiss of escaping air, you have succeed in purging the system. Repeat as necessary.
8. Clean the jack with a soft cloth and mild detergent or solvent.

Product Specification

Specifications				
SWL (Kg)	Minimum Height (mm)	Maximum Height (mm)	Overall dimension (retracted) (mm)	Net Weight (Kg)
2000	170	390	170 x 122 x 115	4.5



© Copyright 2008. Purple Line Limited, 2 Lady Lane Industrial Estate, Hadleigh, Suffolk, IP7 6BQ, England
www.purpleline.co.uk

Photographs for illustration purposes only. Actual product may differ slightly.
Purple Line Limited reserve the right to alter product specification without prior notice.