

User Manual

Solar Lamp

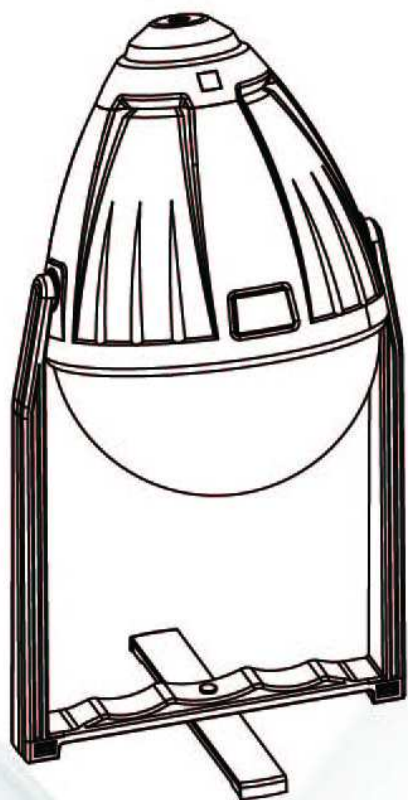

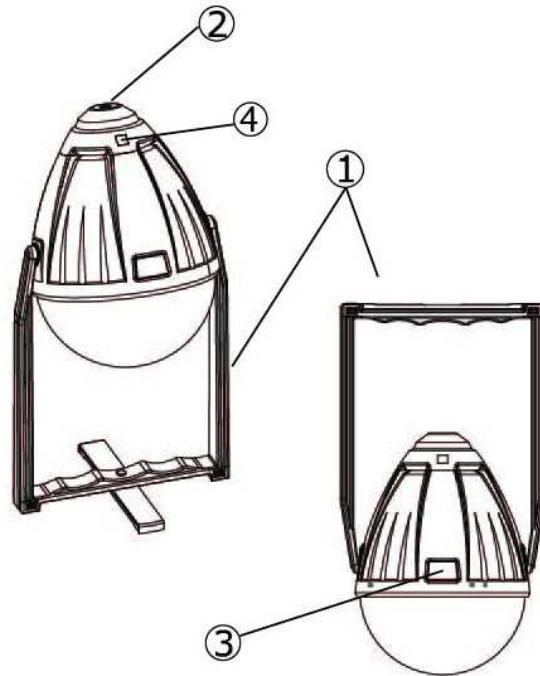

-
- ① ABS Stand/Hook
 - ② DC-IN/OUT
 - ③ On/Off Button
 - ④ LED charging indicator

Product Features:

Multi-use Solar Lamp:

1. Carry it as a lantern
2. Hang it up as a pendant lamp
3. Place it on the table as a table lamp
4. 2 or more LED lamps in series for different Room or area lighting.

Popular for rural regions where the power supply is irregular and scarce, or in the urban as backup lighting during power cuts.

Charging time for mobile phone 4-6 hours.

Electrical Characteristics:

1.Li-ion battery:

- 3.7V / 2200mAh (1W LED)
- 3.7V / 4400mAh (3W LED)

2.LED: Temperature color 6000-6500K

- 100LM (1W LED)
- 300LM (3W LED)

3.100% super Bright lighting time:

- 1W LED, 8-9 hours
- 3W LED, 5-6 hours

4.Input: 5V/500mA

Output: 5V/500mA

Operating Instructions

1.Charging LED lamp by using the USB charging cable

Please connect the USB charging cable to the DC in/out socket of the lamp, then connect the other end of the USB charging cable to your PC's USB port, the LED indicator is red during charging, when it's fully charged, the LED indicator will be off.

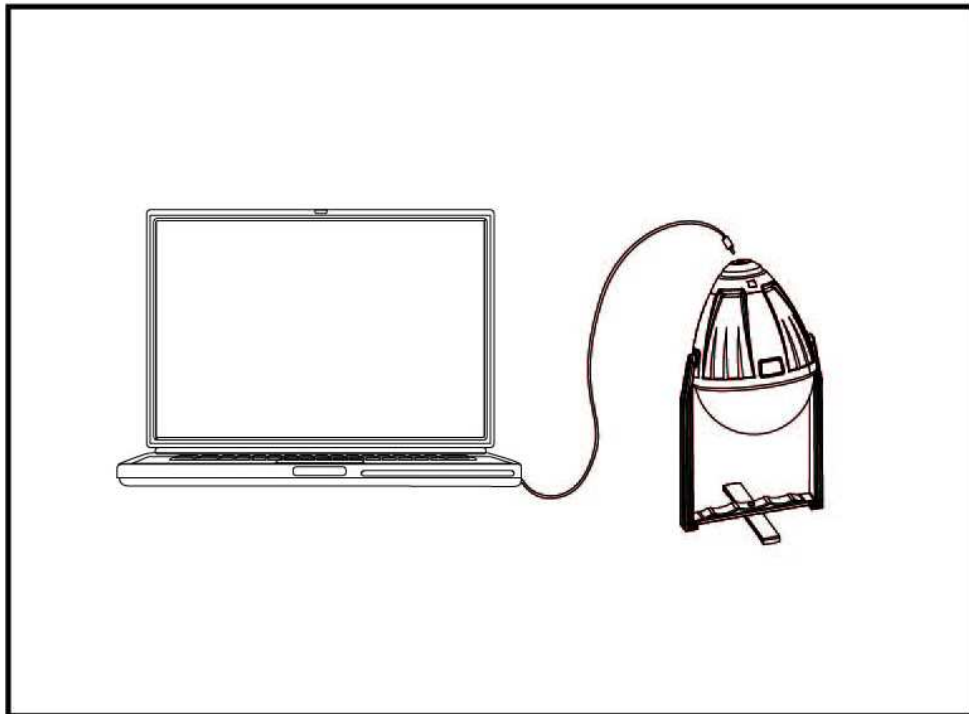

2. How to use the LED Lamp

1. Carry it as a lantern for camping
2. Hang it up as a pendant lamp
3. Place it on the table as a table lamp
4. 2 or more LED lamps in series for different Room or area lighting.

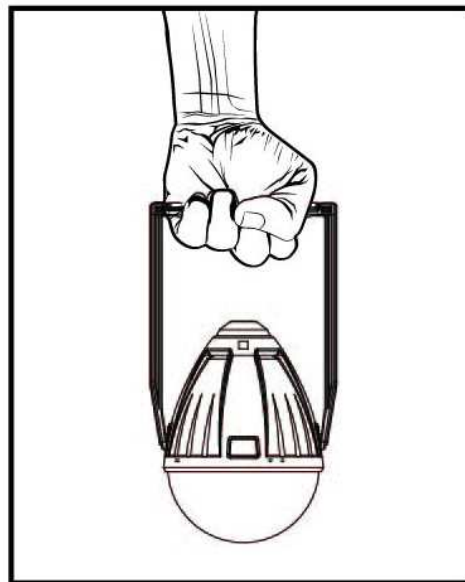
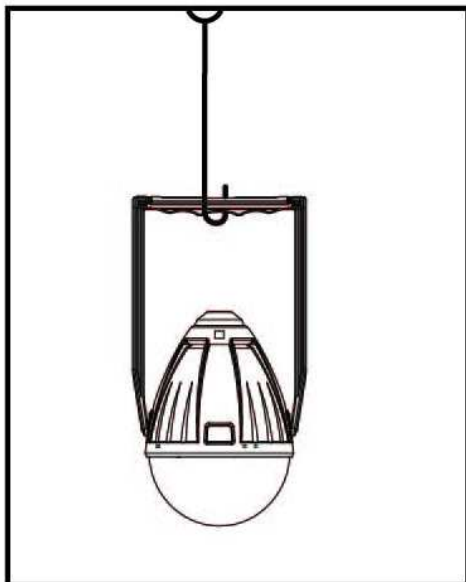
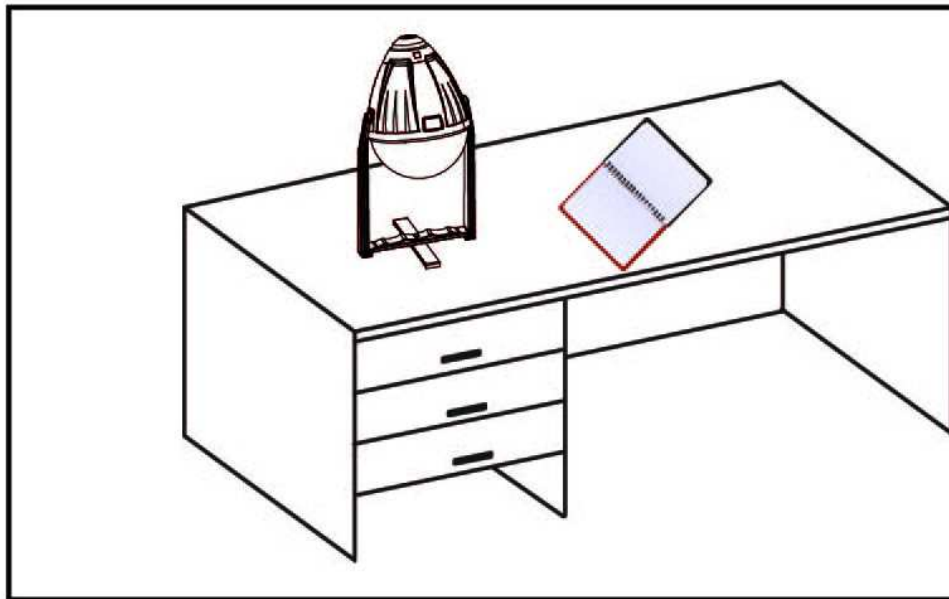

3. Charge mobile phones and other digital devices:

Please connect charging cable to the DC In/out socket of the lamp, then select the right connector for your mobile phone and connect to the other end of the charging cable, then plug to mobile phone for charging, the LED indicator is red during charging, and off when it's finished charging.(Special notice: users can buy the charging cable and connectors from electronic supermarkets or through local distributors.)

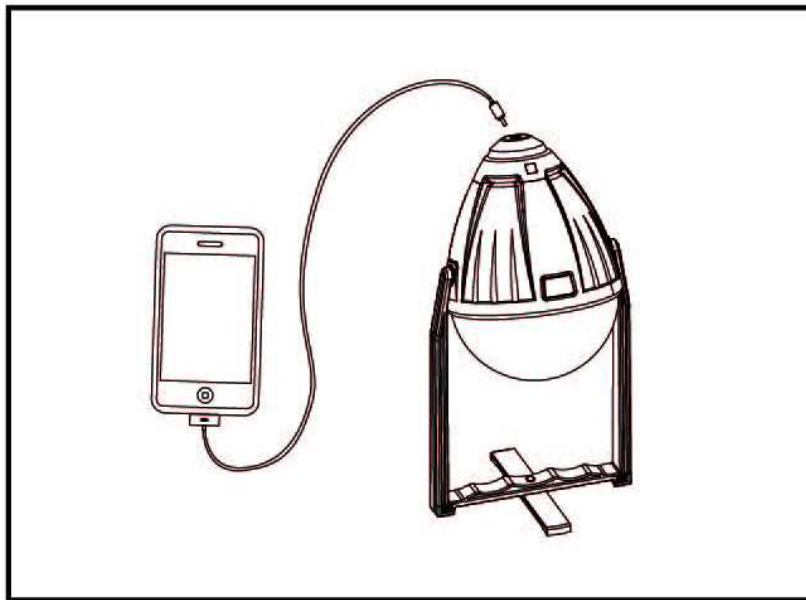

Warning

1. Keep the device away from fire, water and moist places in order to avoid explosion, leakage, moisture;
2. Any severe shock to the charger is not recommended;
3. No one except professional technicians should attempt to disassemble the charger in order to avoid damaging the charger;

Special Note:

1. Please fully charge device before first use;
2. Please perform full charge and discharge of the charger at least once a month;
3. If the cell phone is not charged by SLP-04, don't worry, you can push the button for activating the output for charging again.

Components included:

- LED lamp 1pc
 - ABS stand 1pc
 - Charging cable 1pc
 - USB charging cable 1pc
- Connectors (Apple, Mini USB, Micro USB, USB Female Type A)