

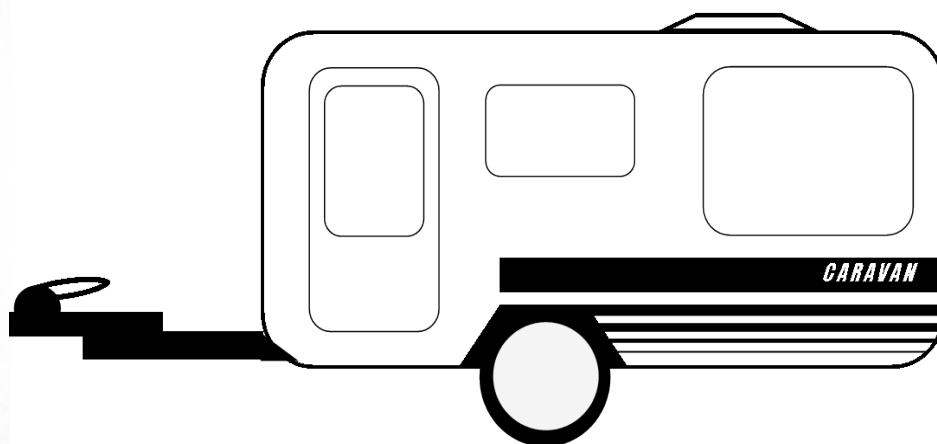

Quick Release Power Mover

**Move and rotate
recreational vehicles
with the push of a
button.**



PATENT PENDING

USER MANUAL



purpleline®

design...innovate...improve

Purple Line Document Reference EQR130-1308





PACKAGED CONTENTS IMAGES:

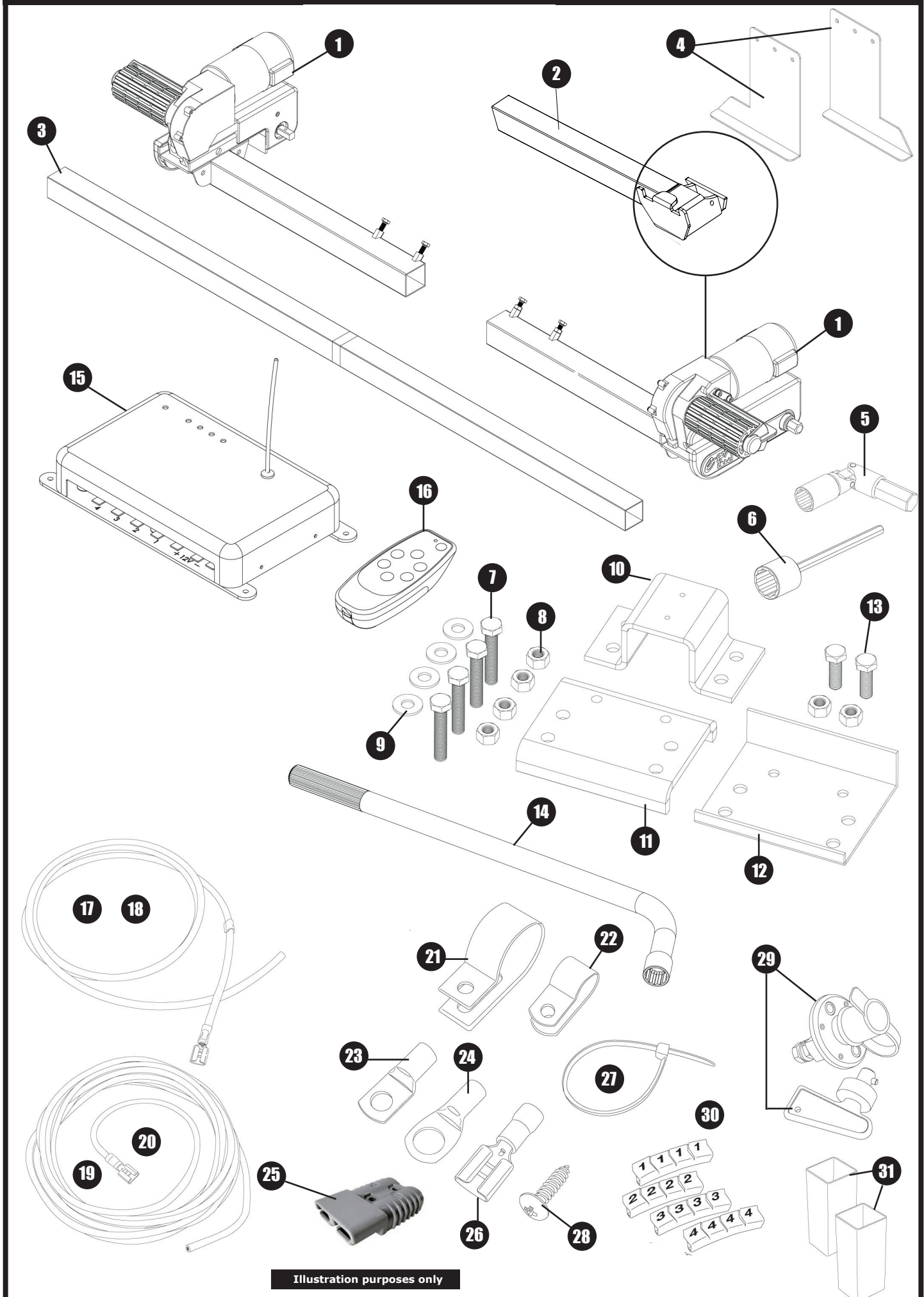

TABLE OF CONTENTS:

Packaged Contents Images	Page 2
Packaged Contents List	Page 3
Introduction	Page 4
Specifications	Page 4
Installation Safety Guidelines	Page 4
Installation Pre-Check Guidelines	Page 5
Ego QuicKEY™ Power Mover	Page 5
Mechanical Assembly and Installation - Images	Page 6
Mechanical Assembly and Installation - Instructions	Page 7
Electrical Wiring Diagram	Page 8
Remote Control Handset	Page 9
Pairing the Remote	Page 10
Electronic Control Unit Operation	Page 10
Single Axle and Dual Axle Configurations	Page 11
Battery Configuration using Four Motors	Page 11
Jockey Wheels	Page 11
Operating Safety Guidelines	Page 12
Operating Instructions	Page 13
Trouble Shooting	Page 14
Maintenance Instructions	Page 15
Warranty	Page 15
Registration	Page 15
Purple Line Address Details	Page 16

PACKAGED CONTENTS LIST:

Item	Qty	Description	Item	Qty	Description
1	2	Power Movers	19	1	Positive (+) Red Motor Cable 5M
2	2	Quick Release Mount	20	1	Negative (-) Black Motor Cable 5M
3	1	Cross Bar	21	10	Cable Trunking P-Clips 19.2mm
4	2	Chassis Plates	22	10	Cable P-Clips 10.4mm
5	1	Universal Joint	23	2	Battery Terminal Connector 6mm
6	1	19mm Drill Socket	24	4	Battery Terminal Connector 8mm
7	8	Chassis Clamp Bolts M10x55	25	2	Anderson Plug and Socket
8	8	Chassis Nylock Nuts M10	26	6	Cable Spade Connectors
9	8	Washers	27	8	Cable Ties 2x70
10	2	Chassis U-Plate	28	20	P-Clip Screws M4x15
11	2	Upper Chassis Clamp Plate	29	1	Isolation Switch and Key
12	2	Lower Chassis Clamp Plate	30	3	Cable Number Tags (1,2,3 & 4)
13	2	Chassis Stop Bolts and Nuts (2 pairs)	31	2	Roller vs Wheel Spacer 20mm
14	1	Engagement Handle	32	3	AAA Batteries (Not Illustrated)
15	1	Electronic Control Unit	33	1	User Manual (Not Illustrated)
16	1	Remote Handset			
17	1	Positive (+) Red Battery Cable 1.8M			
18	1	Negative (-) Black Battery Cable 1.8M			

INTRODUCTION:

Thank you for choosing the Purple Line **Ego QuickKEY™** Quick Release Power Mover. The revolutionary **Ego QuickKEY™** Quick Release Power Mover (Patent Pending) is designed to manoeuvre recreational vehicles via a remote control handset effortlessly, enabling navigation in restricted areas minimising the risk of damage to your vehicle. It will also aid in hitching and de-hitching the vehicle from the tow vehicle. **Ego QuickKEY™** features a quick release mount that allows the Power Mover to be swiftly installed and un-installed. When un-installed you can then and only then undertake river crossings. It can also be removed whilst the vehicle is under tow to prevent damage to the Power Movers and secure the unit from theft.

Ego QuickKEY™ has been engineered to the highest standards, manufactured according to the highest quality assurance processes and is guaranteed for 2 years from date of purchase.

This user manual will enable you to install the **Ego QuickKEY™** and operate it correctly. Accordingly, please read this manual thoroughly and follow all safety guidelines, prior to installation and usage.

SPECIFICATIONS:

Performance	SGO130
Voltage	12V DC
Average Current Consumption	*25 Ampere
Maximum Current Consumption	*76 Ampere
Maximum Speed	*12cm per second
Weight including all fixtures and fittings	*37Kg
Safe Working Load (SWL) Two Motors (Twin Configuration)	2250Kg
Safe Working Load (SWL) Four Motor (Quad Configuration)	3500Kg
Minimum Width (Recreational Vehicle)	1800mm
Maximum Width (Recreational Vehicle)	2500mm
Power Source	12V DC

Prefix * indicates an approximation

Average Current Consumption using approximately a 1100Kg loaded single axle boat trailer on a hard level surface.

Maximum Current Consumption using approximately a 1100Kg loaded single axle boat trailer ascending a 1:4 (25%) gradient.

INSTALLATION SAFETY GUIDELINES:



CAUTION



The symbols to the left identify important safety notices or precautions.

They mean;

- **CAUTION!**
- **WARNING!**
- **SAFETY FIRST!**
- **IMPORTANT INFORMATION**

Wheel Chock

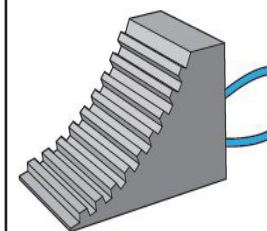

Worn Tyre

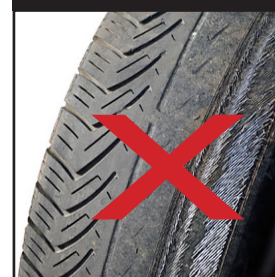

BEFORE COMMENCING WORK ON THE VEHICLE

READ	the owners manual supplied with the vehicle.
READ	this user manual thoroughly before installation and use, to avoid personal injury and damage to property.
CHECK	the condition of the chassis and replace any damaged or worn components.
CHECK	the condition of the tyres and pressure, and if worn replace.
SECURE	all wheels with wheel chocks.
DO NOT	install or operate the unit if you are under the influence of alcohol, drugs or medication that could impair your ability to use this equipment.

INSTALLATION - PRE CHECK GUIDELINES:



These instructions are of a general guidance as installation will vary according to the make and model of the recreational vehicle. To aid you with the installation a video is available for viewing at www.purpleline.com.au. If in doubt regarding the installation of **Ego QuickKEY™** contact the dealer it was purchased from and seek instruction before proceeding.

1. Prior to commencing the installation clean, and de-rust if required, all areas on the chassis of the recreational vehicle where components will be affixed.
2. If the chassis requires de-rusting apply an anti-corrosion compound, then an anti-rust primer to the surface and apply an epoxy finish for protection. Follow the instructions on the packaging of any product purchased to clean and protect the surface.
3. Place the recreational vehicle on a dry and hard level surface, preferably over an assembly pit for ease of access and enhanced personal safety.
4. Ensure the handbrake is on.
5. If you need to raise the recreational vehicle off the ground to aid fitting the Cross Bar use a jack similar to the Kojack Hydra Jack and follow the instructions in the user manual. **It is not safe to work under a recreational vehicle unless it is correctly secured by Prop-Jacks, Axle Stands or Ramps and Wheel Chocks.** Use an appropriate jacking product.
6. Unpack all the **Ego QuickKEY™** components and ensure all are accounted for by checking them against the Packaged Contents List and Images, as featured on Pages 2 and 3.
7. Record on the the guarantee section at the end of this manual, the serial numbers located on the inside edge of the gearbox attached to the Power Movers and register **Ego QuickKEY™** online

EGO QUICKKEY

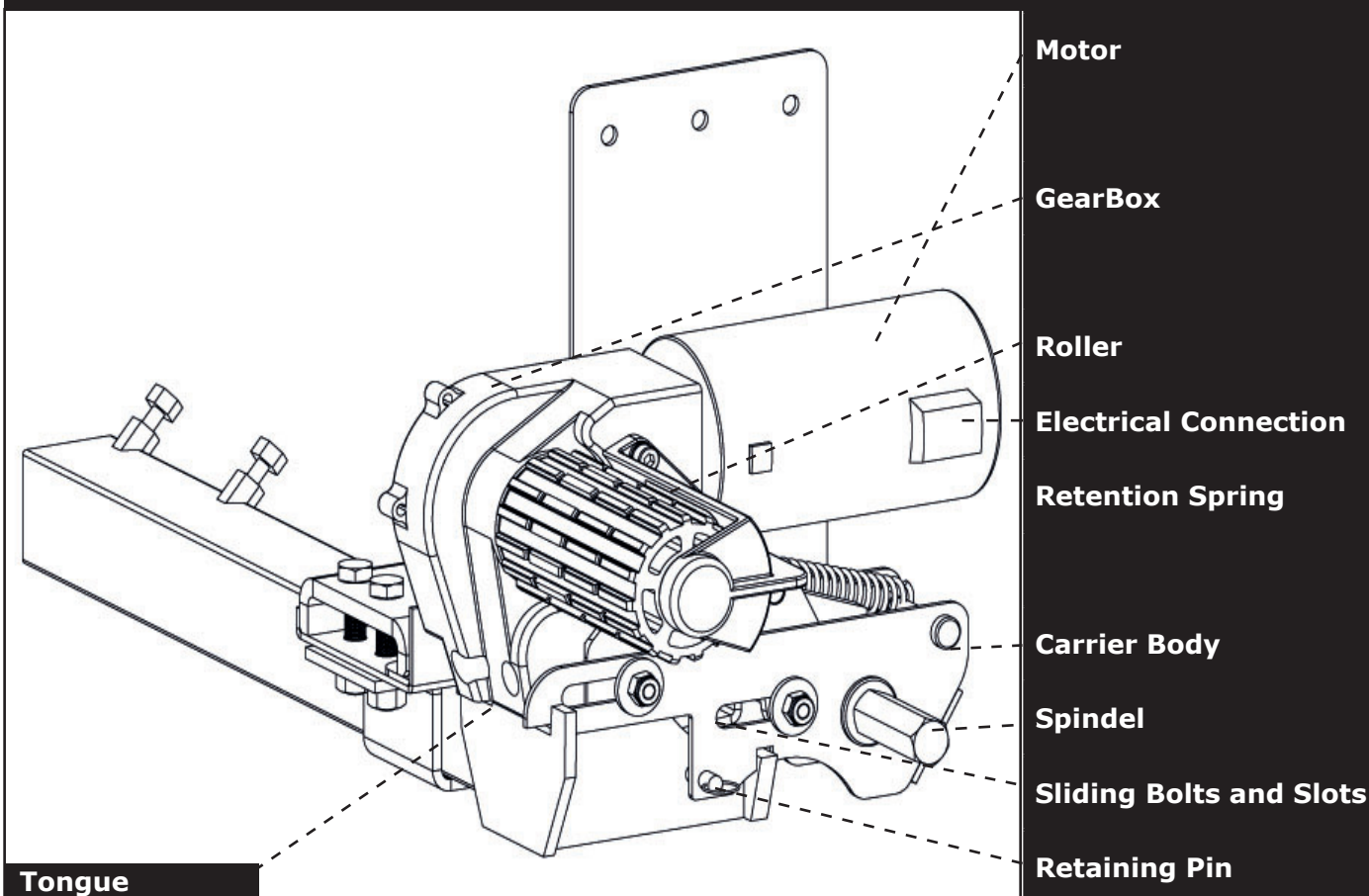



MECHANICAL ASSEMBLY and INSTALLATION DIAGRAMS:

Diagram 1: Ego QuickKEY in the Disengaged Position

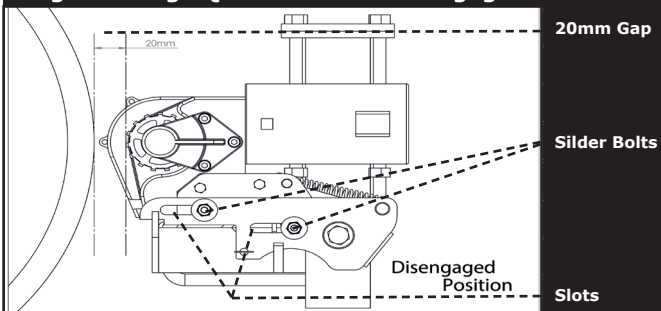

Diagram 1a: Ego QuickKEY from Roller

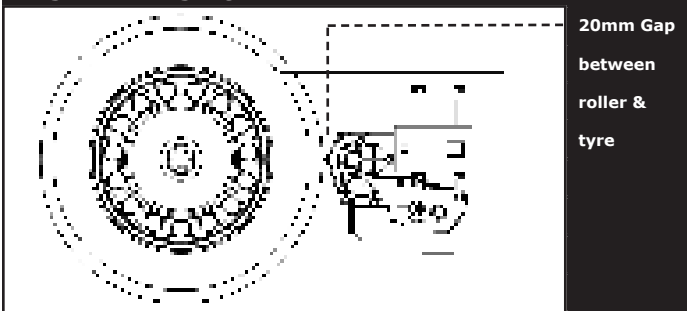

Diagram 2: Ego QuickKEY - to Disengaged

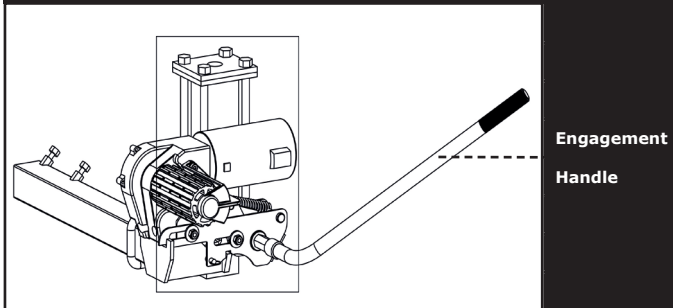

Diagram 4: Mounting Explorer

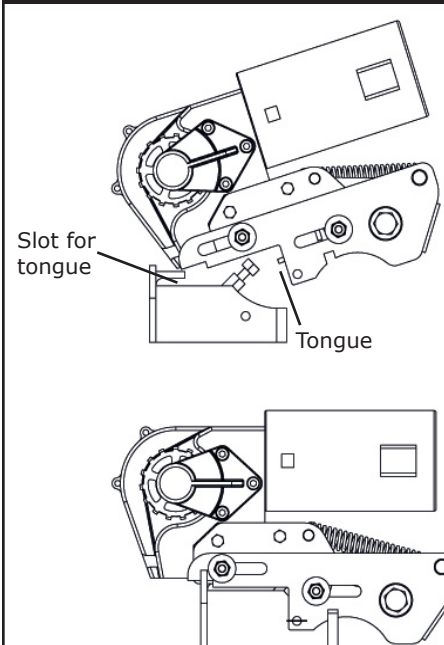

Diagram 3: Assembly Power Movers, Cross Bar and QR Mounts

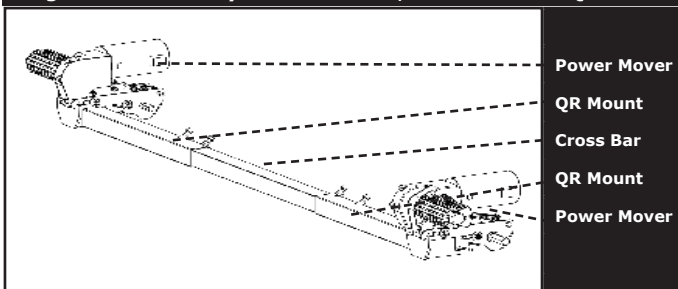
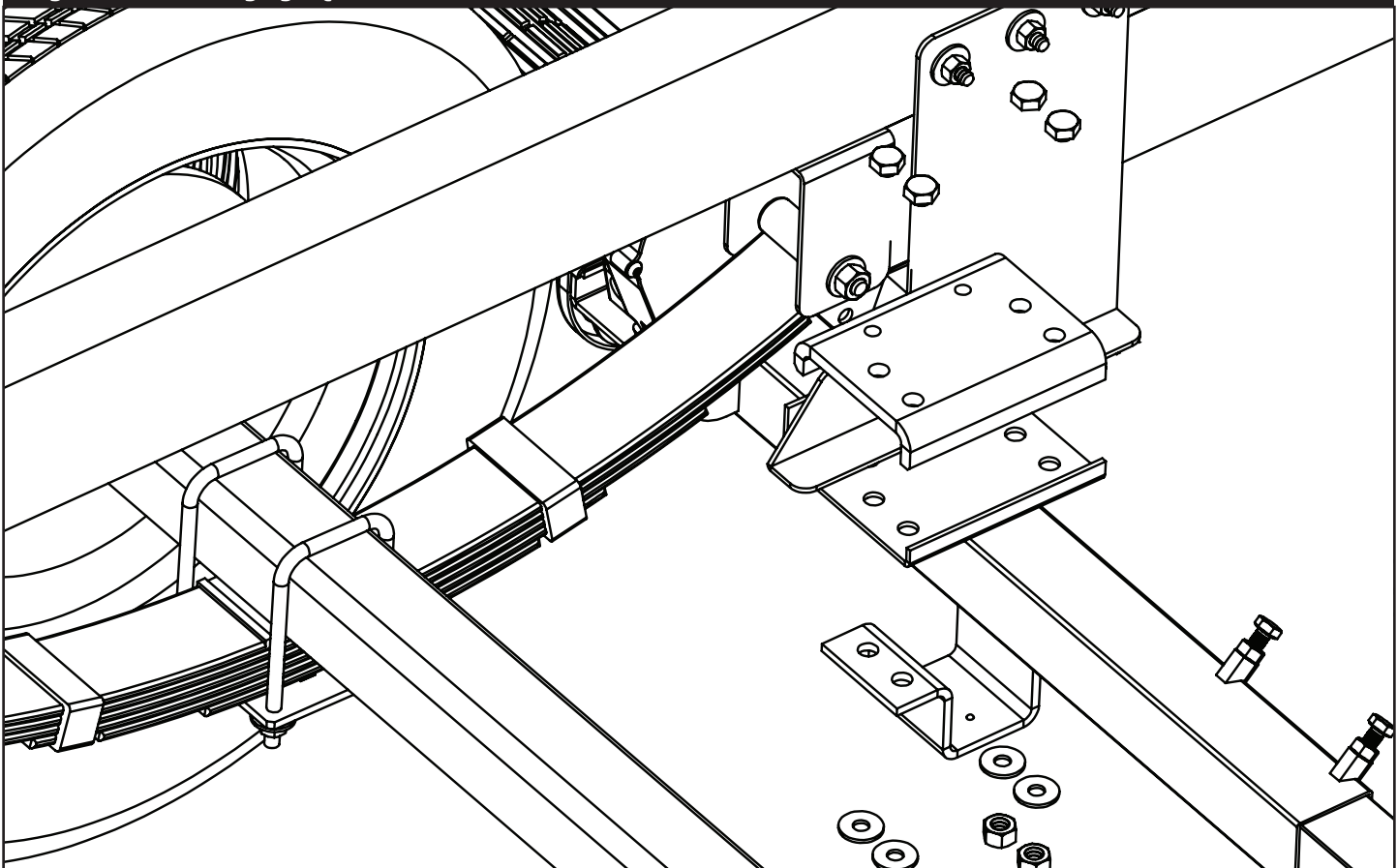

Diagram 5: Installing Ego QuickKEY





MECHANICAL ASSEMBLY and INSTALLATION INSTRUCTIONS:

The Chassis Plates supplied with Ego QuicKEY™ are suitable for most recreational vehicles. However some recreational vehicles require non-standard plates. Check with the dealer to ensure you have the correct Chassis Plates to fit Ego QuicKEY™

1. Prior to commencing assembly, check **Ego QuicKEY™** is set in the disengaged position. **Ego QuicKEY™** is set in the disengaged position when the Slider Bolts are positioned to the right of the Slots. Refer Diagrams 1, 1a and 2.
2. If **Ego QuicKEY™** is set in the engaged position, insert the Handle (Item 14) into the Spindle and rotate clock-wise. Refer Diagram 2.
3. Take the Quick Release Mounts (Item 2) and the Cross Bar (Item 3) and join together as per Diagram 3. Loosely tighten the nuts, as you will be required to adjust these later.
4. Clip the Power Movers (Item 1) onto the Quick Release Mounts as per Diagram 4. This can be achieved by tilting the back of the Power Mover upwards and slotting the tongue on the Carrier Body into the slot on the Quick Release Mount. Once it is slotted in, lower the rear of the Power Mover. There is no need at this stage to insert the Retaining Pin.
5. Place the Motor and Cross Bar Assembly, Diagram 3, on a mat and drag under the recreational vehicle with the Rollers facing the wheels.
6. Raise the Assembly so that the centre axis of the Rollers is equal in height to the centre axis of the Wheels and rest on a block of wood etc.
7. Tape the 20mm Spacers (item 31) to the Rollers at centre axis point.
8. Then move the assembly so that the Rollers with the Spacers attached are hard against the tyres.
9. Referring to Diagram 5, position one of the Chassis Plates (Item 4 - Left and Right hand version supplied) on the inside of the recreational vehicle's chassis so it is sitting slightly above the Cross Bar with the lip facing inward.
10. Mark where the holes on the Chassis Plate align with the chassis on the recreational vehicle.
11. Remove the Chassis Plate and drill 3 holes sufficient for the three 70mm Bolts to be inserted.
12. Install the Chassis Plate and tighten the 70mm nuts and bolts.
13. Repeats Steps 9, 10, 11 and 12 for the other side ensuring that both Chassis Brackets are in the same position on each side of the recreational vehicle's chassis.
14. Loosely fit the Chassis U-Plate (Item 10), the Upper Chassis Clamp Plate (Item 11) and the Lower Chassis Clamp Plate (Item 12) to the Chassis Plate and Cross Bar with the Bolts, Nuts and Washers supplied (Items 7, 8 and 9 and 13) as per Diagram 5.
15. Ensure the assembly is aligned on all points as mention previously, all components aligned with the Chassis on the recreational vehicle, the Roller centre axis is equal to the centre axis of the Wheel and each Roller identically spaced 20mm from the tyre. The Cross Bar can slide forward and backwards on the Chassis Clamp Plates to enable you to achieve a 20mm spacing.
16. Ensure that each Power Mover is free to move forward and backward and does not obstruct the shock absorbers or any other obstacle that is likely to interfere with their operation. Also ensure that the gearbox on the Power Movers has a minimum distance of 10mm to the inner surface of the tyre when in the engaged position.
17. Once correctly aligned tighten all Bolts and Nuts (Items 7, 8 and 9) to a torque setting of 55Nm.
18. Check the alignments of all assembled components and if correct tighten the Chassis Stop Bolts and Nuts (Items 13) to a torque setting of 55Nm. The Chassis Stop Bolts and Nuts grip the lip of the Chassis Bracket helping prevent the Power Movers from sliding along the chassis.
19. Fit the Retaining Pins to the Power Mover.



ELECTRICAL WIRING DIAGRAM:

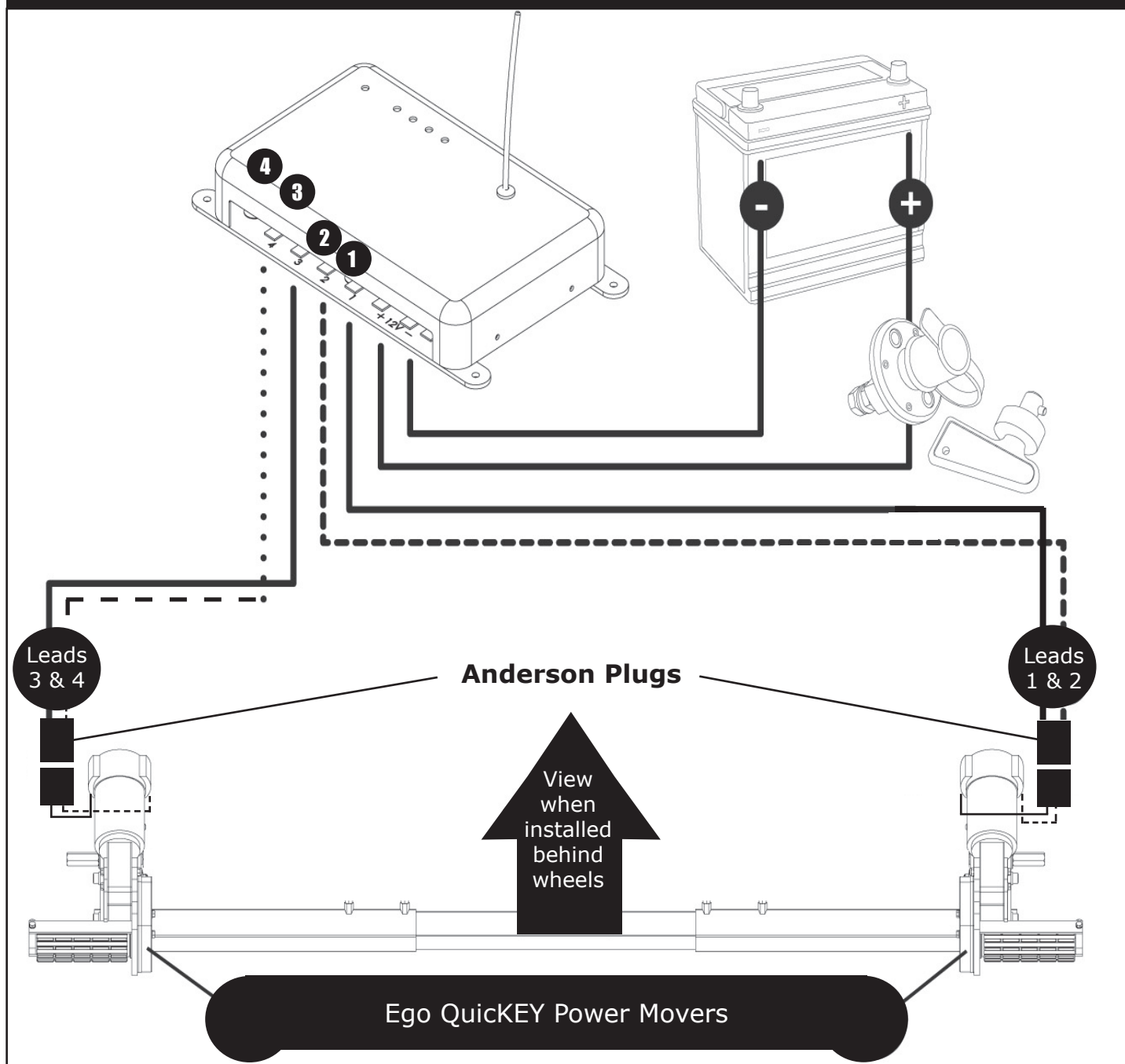

Ego QuickKEY™ is supplied with a Battery Wiring Loom designed to connect the Electronic Control Module, Isolation Switch and Battery. Additionally, it has two wiring looms that connect the Electronic Control Module, which include an Anderson Plug at one end which connects to the Anderson Plug on the Power Mover/s.

1. Take one of the wiring looms with the Anderson Plug and plug the terminals at the other end into terminals 1 & 2 on the Electronic Control Unit.
2. Feed the lead through the recreational vehicle then Plug the Anderson Plug into the Anderson Plug of the Power Mover as per the above diagram. Repeat for the other Power Mover and secure the leads with the P-Clips and Screws supplied. The Anderson Plug on the Power Mover can be inserted under the elasticised band on the motor.
3. Take the Red Battery Terminal Lead (+) and connect to the Isolation Switch. Then connect the lead from the Isolation Switch to the positive terminal on the Control Unit and secure the switch and leads.
4. Take the Black Battery Terminal Lead (-) and connect to negative terminal on the Control Unit and secure the lead.
5. Engage the Power Movers and Isolation Switch and Ego QuickKEY™ is powered and ready to operate.



Ensure to connect all terminals correctly.

REMOTE CONTROL HANDSET OPERATION:

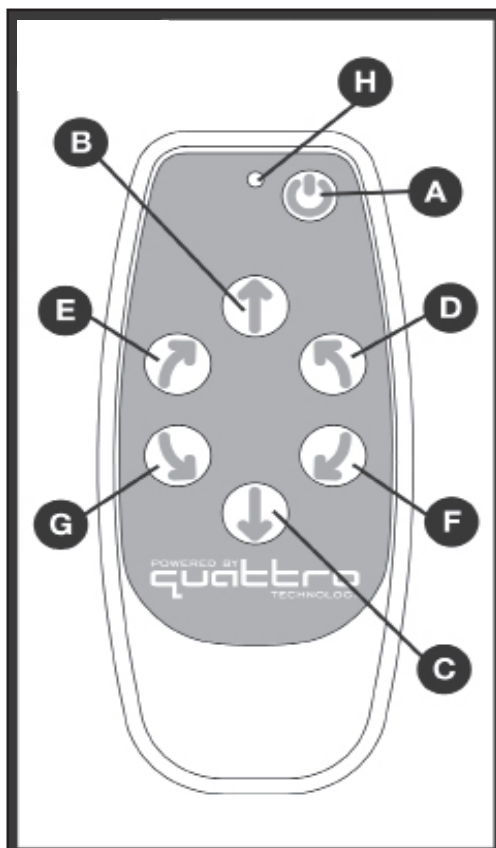

Ego QuickKEY™ is supplied with a Remote Control Handset powered by three 'AAA' 1.5V batteries. The Remote is activated by pressing the Power Button (A) twice within 1 second. Once activated the Green LED will illuminate indicating the directional control buttons can be pressed to move the Recreational Vehicle. The Remote will automatically turn off if not used for 60 seconds.

A - Power Button: press twice within one second to activate Remote.

Green LED: will illuminate when Remote is functioning.

B - Forward Button: will propel the recreational vehicle in a forward direction.

C - Reverse Button: will propel the recreational vehicle in a reverse direction.

D - Forward Left Button: will propel the right wheels in a forward direction.

E - Forward Right Button: will propel the left wheels in a forward direction.

F - Reverse Left: will propel the right wheels in a reverse direction.

G - Reverse Right: will propel the left wheels in a reverse direction.

To rotate the recreational vehicle on its axis in a clockwork direction press the 'left forward' (D) and 'right reverse' (G) buttons simultaneously. To rotate the recreational vehicle on its axis in a anti-clockwork direction press the 'right forward' (E) and 'left reverse' (F) buttons simultaneously.

Note: This function is disabled when the Control Unit is configured to operate in twin axle mode (Page 11)

When pressing a directional button on the Remote, the recreational vehicle will start slowly at first and reach its full speed within 2.5 seconds, to minimise stress on the trailer.



REMOTE HANDSET BATTERIES:

Turn the Remote over and gently push and slide the battery access panel in the direction of the arrow head (below diagram A). Insert three new 'AAA' 1.5V batteries and replace the battery access panel by sliding it into the Remote in the opposite direction to open it. When replacing old batteries, please dispose of these according to guidelines published by your local authority. Note batteries are considered a hazardous material. Check the condition of the batteries regularly to ensure they are in prime condition and not leaking. Damage to the Remote caused by leaking batteries is not covered under warranty.

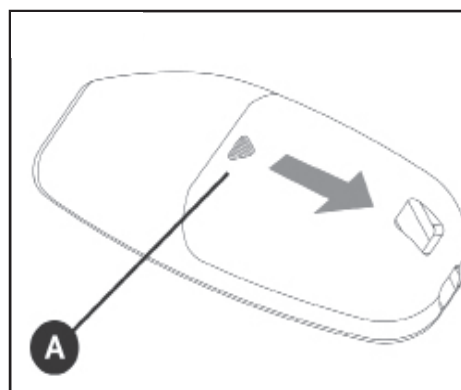

PAIRING THE REMOTE:

Ego QuicKEY™ is supplied by the factory with the Remote already paired to operate in single axle mode. Should you ever need to replace a Remote or set it up to operate in Dual Axle mode, follow these instructions.

SINGLE AXLE MODE: Switch on the Isolation Switch and the Control Unit LED's will flash for ten seconds. Using the Aerial press the Reset Button on the Control Unit and the Green LED will flash. Whilst the Green LED is flashing press the Power Button on the Remote twice. The Green LED on the Control Unit will remain on.

DUAL AXLE MODE: For Dual Axle configurations repeat the foregoing process with the Remote for both Control Units.

After completing these procedures the **Ego QuicKEY™** will operate after pressing one of the directional buttons once activated.

ELECTRONIC CONTROL UNIT OPERATION:

The **Electronic Control Unit** controls the motors via the Remote.

The Control Unit has three LED lights (Fig 6) and one recessed button (Fig 6A).

When turning the Isolation Switch on, the Control Unit will perform a self-test automatically. All the LED's will illuminate for 0.2 seconds and then cease, which indicates the Control Unit is functioning correctly.

If there is a fault, the Control Unit LED's will flash accordingly:

Green LED: Will illuminate when the Remote is turned on. If the Remote is out of range the LED will flash. (Maximum range of signal is 100 metres without obstruction)

Blue LED: Will illuminate when the temperature of the control unit exceeds its operational limit or when battery voltage is too low or too high.

Red LED: Will illuminate indicating the following errors;

- Voltage too low <10V: LED will flash twice slowly.
- Voltage too high >15V: LED will flash fast five times.
- Electric current is too high (= or >120A) LED will constantly flash.
- Temperature is too high >80C: LED will illuminate permanently

Reset Button: Used for pairing the Remote.

The Control unit will automatically turn off if no button on the Remote is pressed within 60 seconds or the Power Mover is working constantly in one direction for longer than three minutes. This is a built in safety feature to preserve battery power and prevent the Control Unit from overheating.

ELECTRONIC CONTROL UNIT:



SINGLE AXLE AND DUAL AXLE CONFIGURATIONS:



IMPORTANT NOTICE

The Electronic Control Unit supplied with Ego QuicKEY™ features Quattro Electronics, designed to operate in single or dual axle modes.

As advised per the previous page, the Electronics Unit with **Ego QuicKEY™** is supplied by the factory to operate in single axle mode. The following procedures instruct you how to set the Remote to operate in either single or dual axle modes.

CONFIGURING THE REMOTE TO OPERATE IN SINGLE AXLE MODE.

1. Remove any one of the AAA batteries from the Remote you have paired to the Control Unit.
2. Hold down button 'E' on the Remote and keep it down whilst replacing the battery. The Remote will sound single beeps.
3. Continue to hold down button 'E' until the beeping stops. Once the beeping stops **Ego QuicKEY™** is ready to operate in single axle mode.

CONFIGURING THE REMOTE TO OPERATE IN QUATTRO MODE (DUAL AXLE MODE)

1. Remove any one of the AAA batteries from the Remote you have paired to the two Control Units.
2. Hold down button 'G' on the Remote and keep it down whilst replacing the battery. The Remote will sound double beeps.
3. Continue to hold down button 'G' until you hear a long beep and the beeping stops. Once the beeping stops **Ego QuicKEY™** is ready to operate in dual axle mode.
4. Repeat these steps for the second Remote if required.

Note: In dual axle mode you will not be able to hold down Buttons 'G' and 'D' or buttons 'E' and 'F' on the Remote simultaneously to rotate the recreational vehicle on its axis. Pressing these buttons together will not activate the Power Movers. However, any of the buttons on the Remote pressed individually will propel the Recreational Vehicle in the direction indicated.

BATTERY CONFIGURATION USING FOUR MOTORS:

Set Up for Two Batteries When Using a Four Motor System

Setting up in this way ensures that both batteries work together. Both batteries should be of identical type, preferably from the same batch number.

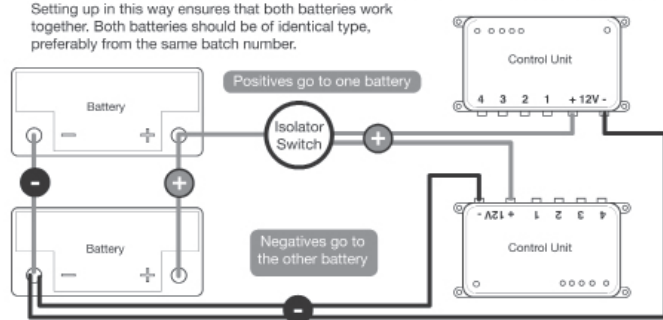

To maximise the performance of **Ego QuicKEY™** using four motors a battery output of 100AH is required. If your current battery does not possess this capacity a second battery will be needed.

If connecting two batteries together it is important that each battery has the same capacity and they are connected as per the diagram to the left.

If unsure on how to connect two 12V batteries consult with an auto-electrician.

JOCKEY WHEELS:

Single Wheel



Twin Wheel

















The type of jockey wheel used with your recreational vehicle can impact on the manoeuvrability of **Ego QuicKEY™**.

Ideally a Jockey Wheel with a 90 degree wheel bracket (as featured - single wheel) is the most ideal configuration for a recreational vehicles fitted with single axles.

For recreational vehicles fitted with dual axles the use of a twin jockey wheel (as featured) is recommended. Single jockey wheels have a tendency to stick or dig in when used with four Power Movers fitted, due to the heavy ball weight.

OPERATING SAFETY GUIDELINES:

The following safety guidelines will enable you to gain maximum benefit when using Ego QuicKEY™ and be able to operate safely. Accordingly please note the guideline and warnings.

-  Before use check that there is no damage to the recreational vehicle or go Ego QuicKEY™ that could affect its performance.
-  Before use check that there is no corrosion, dirt or grime that could effect the operation of Ego QuicKEY™.
-  Before use check the battery is fully charged.
-  Be aware attaching the Power Movers will increase the weight of the recreational vehicle potentially impacting on the performance of the tow vehicle and available carrying capacity of the vehicle.
-  Do not exceed the safe working load of Ego QuicKEY™.
-  Ensure that other persons especially children, pets and other obstacles are removed and kept away from the recreational vehicle whilst it is being manoeuvred.
-  To maintain signal strength, always ensure that during manoeuvring the distance between the Remote and Control Unit is within 5 metres.
-  When manoeuvring the recreational vehicle ensure you remain close enough to engage the handbrake at any time in case of mechanical failure, especially on uneven terrain or gradients.
-  Do not rely on Ego QuicKEY™ to act as a brake.
-  Do not tow or manually manoeuvre the recreational vehicle with the Rollers engaged.
-  Apply the handbrake after manoeuvring the recreational vehicle.
-  Ensure either the Power Movers are removed or the Rollers disengaged when not in use. This will ensure the tyres do not develop a flat spot and release pressure on the Rollers.
-  After using Ego QuicKEY™ turn off the Isolation Switch.
-  Do not make any modifications or alterations to Ego QuicKEY™. This is not only dangerous but will void the warranty and all liability claims.

**REMOVE THE POWER MOVERS
BEFORE ATTEMPTING A RIVER
CROSSING.**

**FAILURE TO DO THIS WILL DESTROY
THE POWER MOVERS VOIDING YOUR
WARRANTY**

OPERATING INSTRUCTIONS:



PLEASE READ THE MANUFACTURER'S HANDBOOK THOROUGHLY BEFORE OPERATING THE RECREATIONAL VEHICLE AND EGO QUICKKEY™.



PLEASE READ THE SAFETY GUIDELINES SUPPLIED THOROUGHLY BEFORE OPERATING EGO QUICKKEY™.



ENSURE THE BATTERY TO BE USED TO POWER EGO QUICKKEY™ IS IN GOOD CONDITION, FULLY CHARGED AND OPERATING WITHIN SAFE GUIDELINES.



ENSURE THE HAND BRAKE ON THE RECREATIONAL VEHICLE IS FULLY ENGAGED AND IT IS UNHITCHED FROM THE TOW VEHICLE BEFORE FITTING THE EGO QUICKKEY™ POWER MOVERS.



REMOVE THE EGO QUICKKEY™ POWER MOVERS BEFORE ATTEMPTING A RIVER CROSSING. NOTE: IMMERSING THE POWER MOVERS IN WATER WILL DESTROY THE MOTORS.



DISENGAGE THE ROLLERS AFTER HITCHING THE RECREATIONAL VEHICLE TO THE TOW VEHICLE.

1. Park the recreational vehicle in safe and appropriate position that will allow you to install the **Ego QuickKEY™** Power Movers and manoeuvre the recreational vehicle.
2. Apply the hand brake on the recreational vehicle.
3. Unhitch the recreational vehicle from the tow vehicle.
4. Fit the **Ego QuickKEY™** Power Movers to the Quick Release Mounts and secure each with the Retaining Pin.
5. Engage both Rollers, by inserting the Handle into the Spindle on each Power Mover and cranking it anti-clockwise until it is locked into position.
6. Connect the Anderson Plug from the Control Unit onto the Anderson Plug on the Power Mover. Repeat for the other Power Mover.
7. Release the Hand Brake on the recreational vehicle.
8. Turn the Isolation Switch on and press the Power Button on the Remote twice within one second. The LED light on the Remote and Green LED on the Control Unit will illuminate, which indicates **Ego QuickKEY™** is operational.
9. To move the recreational vehicle press the appropriate directional button on the Remote. The recreational vehicle will stop as soon as any of the directional buttons are released.
10. **Ego QuickKEY™** will move the recreational vehicle at one speed (12cm per second) after an initial soft start. The speed may increase a little when descending and decrease a little when ascending. Note **Ego QuickKEY™** is slightly more effective at reversing the recreational vehicle up an incline than moving it forward up an incline.
11. Once the recreational vehicle has been manoeuvred into position, turn off the Remote by pressing the power button once. The Green LED on the Remote and the Green LED on the Electronic Control Unit will both extinguish.
12. Apply the hand brake on the recreational vehicle.
13. Turn off the Isolation Switch.
14. Disconnect the Anderson Plug from Control Unit from the Anderson Plugs on the Power Movers.
15. Disengage the Rollers by inserting the Handle into the Spindle on each Power Mover and cranking them clockwise.
16. Remove the Retaining Pins and Power Movers, for safe storage or prior to crossing a river.

TROUBLE SHOOTING:

UNIT FAILS TO OPERATE:

Check the Isolation Switch (29) is in the on position.

Check that the batteries have been installed in the remote correctly and work. If not, install or replace the three 'AAA' batteries. Refer page 10 to install batteries in the remote.

Check that the 12V Battery used to power **Ego QuicKEY™** is fully charged. The Control Unit will indicate if the charge in the battery is low when the Blue LED is on and the Red LED is flashing twice slowly. If the charge is low, recharge the battery or if this fails to improve the level of charge in the battery, replace it.

Check the Remote is 'paired' with the Control Unit. Refer page 11 to pair the Remote.

BATTERY VOLTAGE:

Automotive batteries are rated at 12V, however a fully charged battery will deliver a charge closer to 13V. A Voltmeter reading of 12.7V or higher indicates that the battery is 100% charged, 12.5V is three quarters charged and 12.4V can indicate the battery is only 50% charged. Ego QuicKEY requires an output of at least 12.5V to function.

Check the power cable is connected to the battery.

Check the condition of the power cable and terminals. If the cable or terminals are damaged replace and if the terminals are corroded clean.

Check that the battery is not overloaded. The Control Unit will indicate the battery is overloaded when the Blue LED is on and the Red LED is flashing continuously. If the Control Unit indicates the battery is overloaded, firstly check your charger to ensure it is operating correctly. Secondly connect a 12V device to discharge the battery to the optimum level. If the steps do not rectify the matter replace the battery.

REMOTE CONTROL:

The Remote Control is programmed to operate within a distance of 0-5 metres from the Control Unit. If there is no signal between the Remote and the Control Unit **Ego QuicKEY™** will not operate even though the LED on the Remote is illuminated.

UNIT OPERATES INTERMITTENTLY:

Check the points detailed in 'UNIT FAILS TO OPERATE' and rectify where necessary.

With the rollers engaged, check how much the voltage drops with a voltmeter when the Remote is activated. If the voltage immediately drops below 10 volts, recharge or replace the battery.

ROLLERS SLIP ON WHEELS:

Check that the rollers and tyres are clean, especially free of oil and grime. If contaminated, clean with an appropriate cleaner.

Check the tyre pressure on both wheels and where below the recommended pressure inflate. Refer to the manufacturer's handbook for the recommended tyre pressure.

Check that the distance between the Roller and first point of contact with the tyre is 20mm on both sides. If not adjust the distance between the rollers and the tyres as detailed in the Mechanical Assembly and Installation instructions.

ERROR MESSAGES:

All error messages will reset automatically after 40 seconds. If this does not occur, switch off the Remote, then switch off the Isolation Switch for a least 15 seconds. Switch on the Isolation Switch then switch on the Remote by pressing the power button twice within 1 second.



IF IN DOUBT OR IN THE EVENT THE FOREGOING TROUBLE SHOOTING INSTRUCTIONS FAIL TO RECTIFY THE ISSUE, CONTACT THE DEALER EGO QUICKEY™ WAS PURCHASED FROM OR PURPLE LINE.



Immersing the components used to mount **Ego QuicKEY™** will result in them becoming corroded. It is important that the recreational vehicle and components used to mount **Ego QuicKEY™** are checked on a regular basis and if any corrosion is present this be rectified.

- If the battery used to power **Ego QuicKEY™** is not going to be used for long periods and is not charged by a trickle charger, it is recommended that the battery be disconnected from the Control Unit to prevent it from becoming completely discharged.
- Prior to using the **Ego QuicKEY™** ensure the battery is fully charged to provide maximum power.
- Regularly check that the rollers on the drive units are free from corrosion, dirt and grime, or other contaminants that could impair their operation. If the rollers are contaminated in any way clean them with a brisk brush or appropriate cleaner.
- Prior to engaging **Ego QuicKEY™** (whilst still in the disengaged position) check that the rollers are a minimum of 20mm from the contact point of the tyre. This distance may increase over time as the tyre wears, resulting in a loss of traction. If the distance is greater than 20mm and the loss of traction becomes an issue, you will either need to fit new tyres or adjust the distance of the Motor Unit to the contact point of the tyre. The procedure to effect this is detailed on page 7.
- Prior to using **Ego QuicKEY™** check that all bolts and nuts are tight, all moving parts/joints are free of corrosion and lubricated and, all electric cables are in good condition including the integrity of the insulation.



If you are uncertain regarding these maintenance instructions or are experiencing problems with the operation of the unit, contact the dealer Ego QuicKEY™ was purchased from and seek further advice.

WARRANTY:

Ego QuicKEY™ (The Goods) is guaranteed for 2 years from date of purchase and subject to Australian Consumer Law.

Purple Line: Warrants **Ego QuicKEY™** is supplied free of defects.

Refund: The Goods will be refunded if not fit for purpose.

Replaced: The Goods will be replaced if defects were apparent upon purchase or a major failure occurs, which cannot be repaired.

Repair: The Goods will be repaired in the event of failure. Goods presented for repair may be repaired or replaced with refurbished goods or parts of a similar type.

Contacts: To make a warranty claim first contact the retailer the Goods were purchased from and if purchased online Purple Line <http://www.purpleline.com.au/contact/php>

REGISTRATION:

Please register your purchase of **Ego QuicKEY™** online within 14 days of purchase. Registration is quick and simple, go to ***www.purpleline.com.au/product-registration.php***. Please retain your original purchase receipt.

Please complete the details below and retain this manual for future reference.

Serial Number	<input type="text"/> <input type="text"/> <input type="text"/> <input type="text"/> <input type="text"/> <input type="text"/> <input type="text"/> <input type="text"/> <input type="text"/> + <input type="text"/> <input type="text"/> <input type="text"/> <input type="text"/> <input type="text"/> <input type="text"/> <input type="text"/> <input type="text"/> <input type="text"/>
Date of Purchase	<input type="text"/>
Name of Dealer	<input type="text"/>



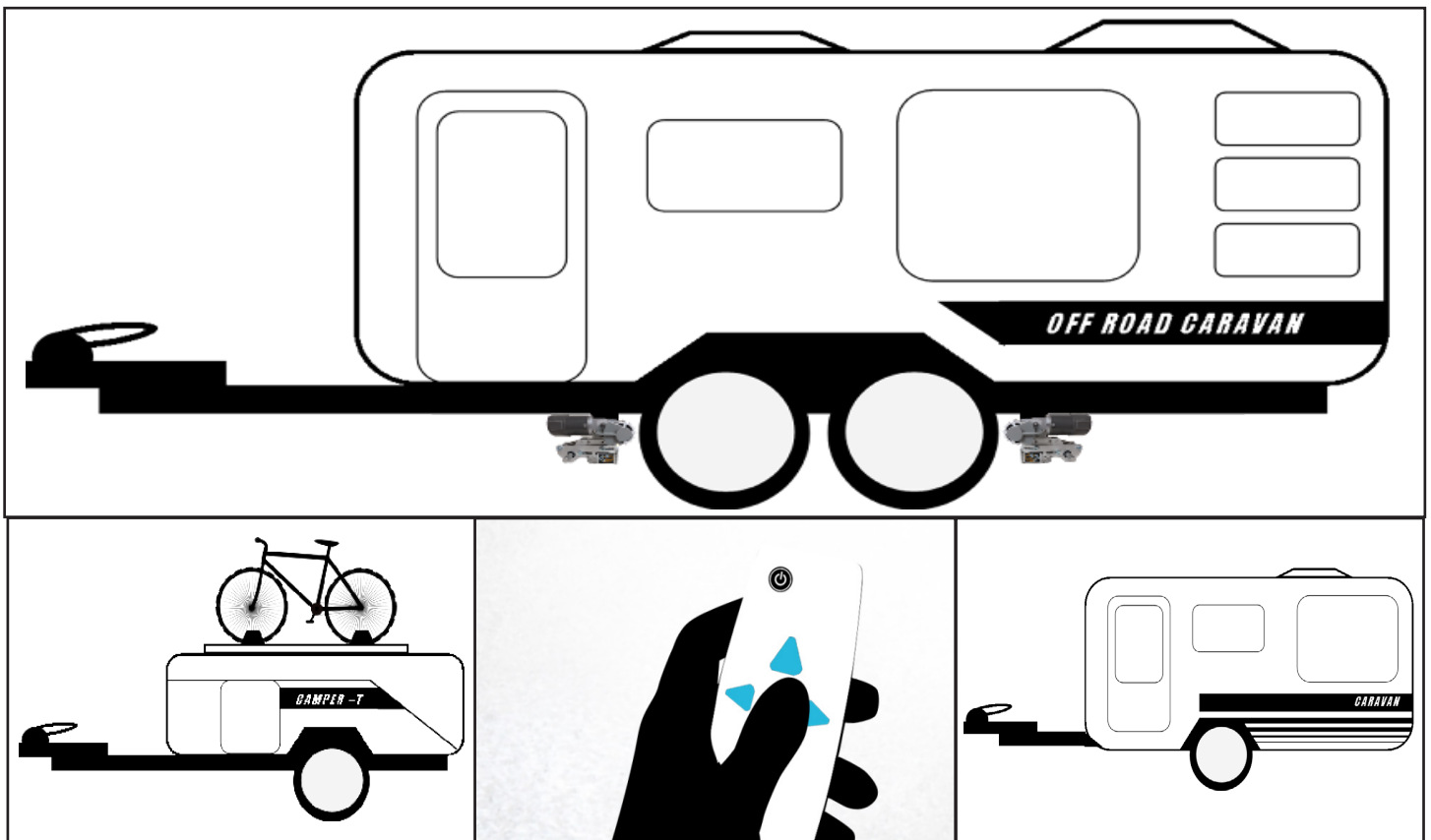

purpleline®

design...innovate...improve

5/238 Governor Road, Braeside, VIC 3195

+61 (3) 9588 2959

enquiries@purpleline.com.au

www.purpleline.com.au