

Printer Installation Guide



Thermal mini printer **A10**

Unpacking

After unpacking the box, make sure all items shown below are in the box.

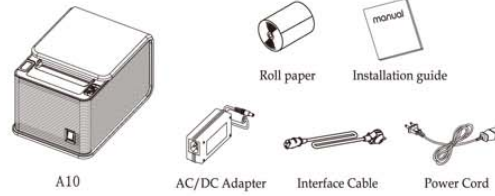

Features

- High performance CPU (ARM 9, 32bit)
- Ultra fast printing speed to 220mm/sec
- Specially designed font provides high readability. (1 Byte : 14 x 28dot / 2 Byte : 28 x 28dot)
- High resolution to 203dpi
- Support various interface (RS232C/Parallel/USB/Ethernet)
- Support unicode, 34 type of character set.
- Built in Buzzer
- Available Extension Melody or Extension Voice
- Windows, OPOS drivers
- Compatible with EPSON or STAR cash drawer by Dip switch setting.

Connecting the cables

1. Make sure the printer and the host computer are turned off
2. Connect the power cord to the adapter, and then connect the adapter to the printer.
3. Check the interface at the rear side of the printer and connect the interface connector cable accordingly.
4. Connect drawer kick_out cable to the drawer kick_out connector on the printer.

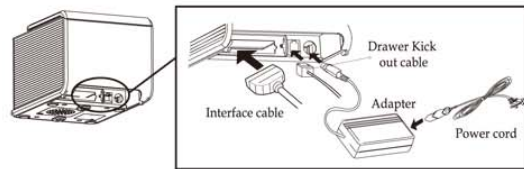

Installing the paper roll

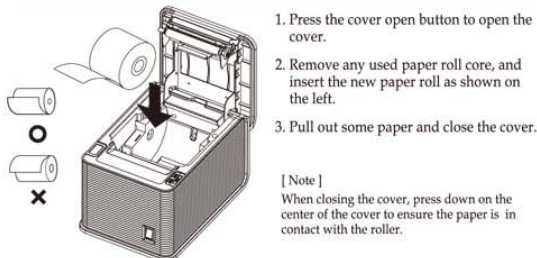

Control Panel

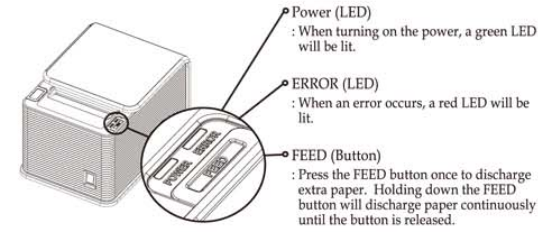

Paper JAM

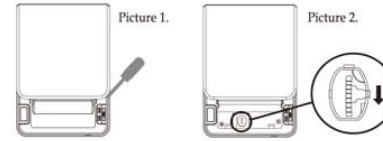

1. When the paper is jammed with cutter, stop printing.
2. Open the top cover and remove the jammed paper.
3. In case the top cover is stuck, repeat power on and off several times.
4. If the top cover is still struck, remove the cutter cover as shown on picture 1. using flat screwdriver.
5. You will see the roller as shown on picture 2. Please keep moving the roller into (↓) direction until the jammed paper is released.
6. After the jammed paper is removed, turn back on the printer.

Self Test

1. Make sure the paper roll is installed properly.
2. While holding down the FEED button, turn on the printer to begin self test.
3. The self test prints out the current ROM version and DIP switch settings.
4. Release the FEED button when self test is finished.
5. The printer is ready to receive data as soon as it completes the self-test.

DIP Switch Tables

Make sure that power off when changing DIP switch setting.

SW1

No	Fuction	Setting			Default
		SW1-3	SW1-2	SW1-1	
1	RS232-C Transmission Speed	2400BPS	OFF	OFF	9600BPS
		4800BPS	OFF	OFF	
		9600BPS	OFF	ON	
		19200BPS	OFF	ON	
		38400BPS	ON	OFF	
		57600BPS	ON	OFF	
		115200BPS	ON	ON	OFF
2	RS232-C (Handshaking)		SW1-4		DTR/DSR
		DTR/DSR	OFF		
		XON/XOFF	ON		

3	SOUND		SW1-6	SW1-5	NO SOUND
		No Sound	OFF	OFF	
		Internal Buzzer	OFF	ON	
		Extension Melody	ON	OFF	
		Extension Voice	ON	ON	
4	Print Density		SW1-8	SW1-7	LOW
		LOW	OFF	OFF	
		NORMAL	OFF	ON	
		NORMAL	ON	OFF	
		HIGH	ON	ON	

SW2

No	Language	Code Page	Default Setting : English					
			SW2-6	SW2-5	SW2-4	SW2-3	SW2-2	SW2-1
1	USA, Standard Europe	CP-437	OFF	OFF	OFF	OFF	OFF	OFF
2	Japanese	Katakana	OFF	OFF	OFF	OFF	OFF	ON
3	Multilingual	CP-850	OFF	OFF	OFF	OFF	ON	OFF
4	Portuguese	CP-860	OFF	OFF	OFF	OFF	ON	ON
5	Canadian-French	CP-863	OFF	OFF	OFF	ON	OFF	OFF
6	Nordic	CP-865	OFF	OFF	OFF	ON	OFF	ON
7	Latin I	CP-1252	OFF	OFF	OFF	ON	ON	OFF
8	Cyrillic Russian	CP-866	OFF	OFF	OFF	ON	ON	ON
9	Latin II	CP-852	OFF	OFF	ON	OFF	OFF	OFF
10	Euro	CP-858	OFF	OFF	ON	OFF	OFF	ON
11		Thai-42	OFF	OFF	ON	OFF	ON	OFF
12	Thailand character	Thai-11	OFF	OFF	ON	OFF	ON	ON
13		Thai-14	OFF	OFF	ON	ON	OFF	OFF

14		Thai-16	OFF	OFF	ON	ON	OFF	ON
15	Thailand character	Thai-18	OFF	OFF	ON	ON	ON	OFF
16		Thai-874	OFF	OFF	ON	ON	ON	ON
17	Greek	CP-737	OFF	ON	OFF	OFF	OFF	OFF
18	Baltic	CP-775	OFF	ON	OFF	OFF	OFF	ON
19	Cyrillic	CP-855	OFF	ON	OFF	OFF	ON	OFF
20	Turkish	CP-857	OFF	ON	OFF	OFF	ON	ON
21	Icelandic	CP-861	OFF	ON	OFF	ON	OFF	OFF
22	Hebrew	CP-862	OFF	ON	OFF	ON	OFF	ON
23	Arabic	CP-864	OFF	ON	OFF	ON	ON	OFF
24	Greek II	CP-869	OFF	ON	OFF	ON	ON	ON
25	Cyrillic	CP-1251	OFF	ON	ON	OFF	OFF	OFF
26	Greek	CP-1253	OFF	ON	ON	OFF	OFF	ON
27	Turkish	CP-1254	OFF	ON	ON	OFF	ON	OFF
28	Hebrew	CP-1255	OFF	ON	ON	OFF	ON	ON
29	Arabic	CP-1256	OFF	ON	ON	ON	OFF	OFF
30	Baltic	CP-1257	OFF	ON	ON	ON	OFF	ON
31	Vietnames	CP-1258	OFF	ON	ON	ON	ON	OFF
32	Traditional Chinese Big5	CP-950	ON	ON	ON	ON	OFF	OFF
33	Simplified Chinese GBK	CP-936	ON	ON	ON	ON	OFF	ON
34	Japanese Shift-JIS	CP-932	ON	ON	ON	ON	ON	OFF
35	Korean	CP-949	ON	ON	ON	ON	ON	ON

Printing Method	Direct thermal	
Printing Speed	220mm/sec	
Dot Density (DPI)	203.2 DPI	
Dot Pitch (mm)	0.125*0.125 mm	
Effective Printing Width	74mm, 588dots	
Printing Direction	Unidirectional with friction feed	
Character/Line	Font A	(14*28) 42 columns
	Font B	(10*20) 58 columns
Paper	Type	Thermal paper
	Width	79.5mm (±0.5mm)
	Thickness	0.07mm
	Roll diameter	83 ∅ mm
Reliability	TPH Life	100km
	MCBF	60,000,000 lines
Character/Set	Alphanumeric character	95
	Extended graphic	128 x 35 page
Barcode	EAN-8, EAN-13, CODE39, CODE93, CODE128, ITF, UPC-A, UPC-E, CODABAR	
Emulation	ESC/POS command compatible	TM-T88III
Driver	Windows / OPOS	
Interface	Serial / Parallel / USB / Ethernet / USB+Serial combo	
Power	24 VDC / 2.5A	
Data Buffer	4 Kbyte	
Cutting	Life	1,000,000 cuts
	Cutting method	Partial cut
Temperature	Operation	0 ~ 40℃
	Storage	-20 ~ 60℃

[Note]
* 1) Printing speed may be slower depending on the data transmission speed and the control commands.
* 2) The above values are calculated under printing low with recommended paper at normal temperature. The values may vary with environment temperature, printing level, etc.