

OPERATING INSTRUCTIONS:

- 1** Batteries to be changed only by an adult. Unscrew door, lift off door, and replace batteries. Replace door and turn screw to lock. Requires 8 AA (1.5V) batteries (not included).

Turn this way to open.

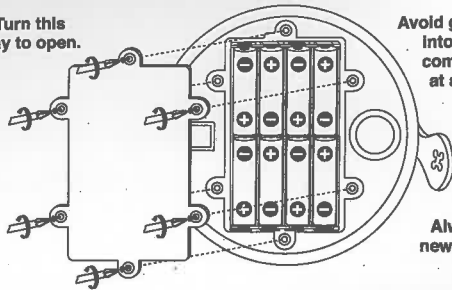

Avoid getting water into batteries compartment at all times.

Always use new batteries!

IMPORTANT BATTERY INSTRUCTIONS:

- Do not mix old and new batteries.
- Do not mix alkaline, standard (carbon-zinc) or rechargeable (nickel-cadmium) batteries.
- Remove batteries if item will not be used for a long period of time.
- Non-rechargeable batteries are not to be recharged.
- Rechargeable batteries are to be removed from the toy before being charged.
- Rechargeable batteries are only to be charged under adult supervision.
- Only batteries of the same or equivalent type as recommended are to be used.
- Batteries are to be inserted with the correct polarity.
- Exhausted batteries are to be removed from the toy.
- The supply terminals are not to be short-circuited.
- Dispose of batteries responsibly.
- Do not dispose of in fire.

WARNING

Never insert fingers into rotating parts inside the bubble machine. Keep bubble machine away from heads, eyes, faces, and hair.

Play only under competent adult supervision.

The bubble machine may make surfaces slippery. Never walk or play on those surfaces.

Remove all packaging ties before playing. Keep packaging ties away from children.

Important: Wipe and clean bubble machine after use with damp cloth. Never immerse unit into water and never get the motor wet.

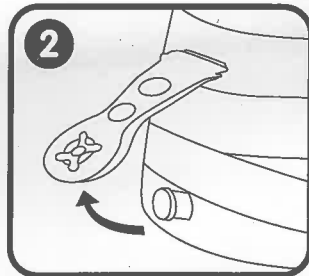

Open the strap.

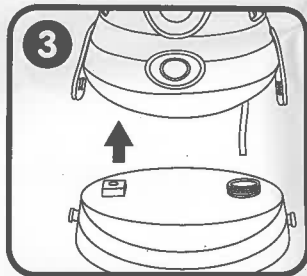

Line up the machine unit on top of the solution container.

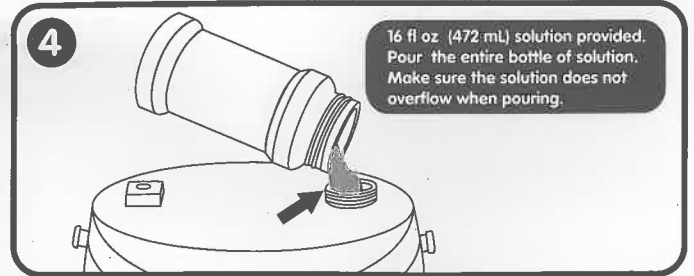

16 fl oz (472 mL) solution provided. Pour the entire bottle of solution. Make sure the solution does not overflow when pouring.

Slowly pour solution into the machine's solution container.

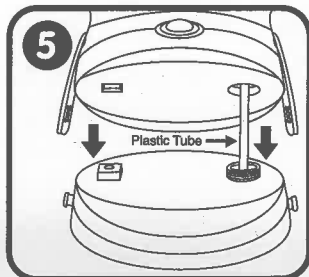

Be sure the plastic tube is inside the container.

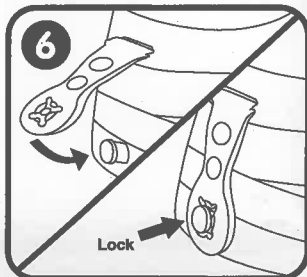

Tighten the strap and Locked.

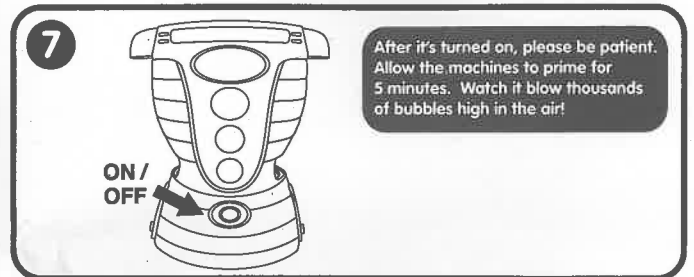

After it's turned on, please be patient. Allow the machines to prime for 5 minutes. Watch it blow thousands of bubbles high in the air!

Push button to start or stop, to make thousands of bubbles.

CLEANING:

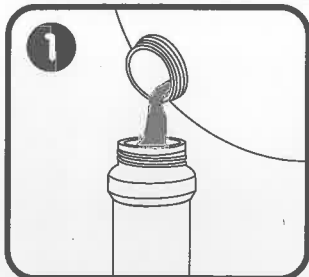

After each play, pour all solution out of the machine.

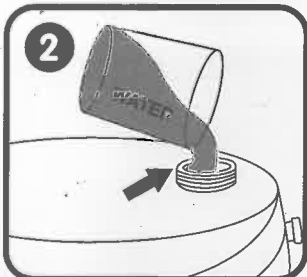

Slowly pour clean water into the machine's solution container.

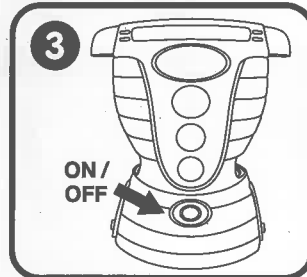

Turn ON the machine for 3 minutes, allow the machine to self-clean the inside. (This prevents the inside tubes and pump from clogging up.)

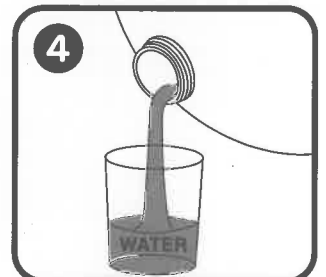

Turn OFF the machine, pour all the water out.

PRECAUTIONS:

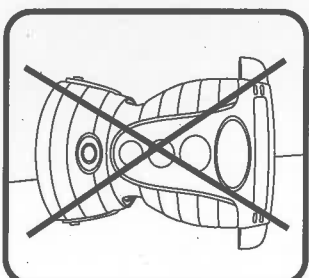

Always keep bubble machine upright, do not tilt over bubble machine, it will damage the machine.



Always lift by the machine by the two handles on the side.

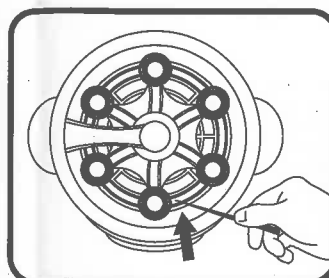

Always use a narrow tool, like a toothpick to remove the bubble solution residue retained on the wands (bubble solution will leave a residue on the wands if the machine is not properly cleaned after play) and then clean the machine as instructed in the cleaning section.

Play only under competent adult supervision. Remove all packaging ties before playing. Keep packaging ties away from children.

Product color and contents may differ from photos shown. Conforms to ASTM F963 at date of manufacture.

Caution: Prolonged contact can cause slight irritation. Wash affected skin thoroughly with soap and water.

KMART AUSTRALIA LTD
690 SPRINGVALE ROAD MULGRAVE VICTORIA
3170 AUSTRALIA
KMART NEW ZEALAND REGIONAL OFFICE C/O
KMART PAPATOETOE STORE HUNTERS PLAZA
GREAT SOUTH ROAD PAPATOETOE AUCKLAND
NEW ZEALAND



MADE IN CHINA
TM and © PLACO
MONTEREY PARK,
CA 91754-0449
E-mail: placo@netvigator.com