



www.tourman.com.au



CAMERA SENSOR

**USER GUIDE AND
OPERATIONS MANUAL**



CONTENTS

<u>IMPORTANT INFORMATION</u>	4
1. Understanding Your TOURMAN Camera / Sensor	5
1.1 Standard Packing List TOURMAN –	5
1.2 Standard Packing List TOURMAN <i>Plus</i> –	5
1.3 Optional Accessories	5
1.3 Specifications	6
2. To Program the device to your mobile phone.	7
2.1 Converting the Factory Default Value of your TOURMAN to install your mobile phone number to the device	7
2.2 Re-Programing the 1st Telephone Number (P1)	8
2.3 To change the Password of the TOURMAN	9
2.4 To program the additional (2nd, 3rd & 4th) Telephone Numbers into your device	10
2.5 Programming of Date and Time of your device	11
3. To operate your TOURMAN Camera / Sensor Security Device	12
3.1 Operating Modes available with the device:	12
3.2 SMS confirmation	13
3.3 To operate the Remote Control	13
3.4 Programming the device mode via your mobile phone.	14
4. Communication Process	15
4.1 Communication process of the device when ACTIVATED	15
4.2 Communication to the device from your mobile phone	16
4.3 Mobile commands while video call is connected	17
4.4 MicroSD card Memory Status Reminder	17
4.5 LED Indicator	18
5. OPERATING COSTS - Simcard	18
6. MAINTENANCE	19
6.1 Testing	19
6.2 FAQ's	19

CONTENTS

6.3	HOW THE TOURMAN WILL WORK FOR YOU !	19
6.3.1	MODES of OPERATION	20
6.3.2	ACTIVATION and NOTIFICATION	21
6.3.3	SUGGESTED INSTALLATION AND USE	22
7.	ASSEMBLY	23
7.1	Your TOURMAN Sensor Camera	23
7.2	Assembly of the TOURMAN	25
7.2.1	Remove Front Cover	25
7.2.2	Insert Micro SD memory card	25
7.2.3	Insert SIM card	26
7.2.4	Insert battery pack	26
7.2.5	Plug in AC/DC power adaptor	27
7.2.6	Confirm preparation	28
7.2.7	Charge battery pack	28
7.3	To configure your TOURMAN	29
7.3.1	Learn/ Delete accessories	29
7.3.2	Options for the connection of TOURMAN accessories	29
7.3.3	Sample of Learn/ Delete process for the Remote Control	30
7.3.4	Delete Process	32
7.3.5	Reset Procedure	33
8.	Accessories List	34

IMPORTANT INFORMATION

Your TOURMAN product has been assembled complete with the Simcard and memory card together with the additional accessories including the Remote Controls and the Door/Window Sensor having being linked (learned in) to the device.

This operations guide can be read in conjunction with the pre-assembly and installation guide associated with this TOURMAN Camera/Sensor device, item 7 Assembly. It will enable you to link additional devices to extend your security system.

NOTES

1. The **ICU11168 Security Camera / PIR Sensor** is also called the **"TOURMAN"** or the **"Device"**
2. The SIM Card included has been linked to your device and cannot be substituted without the manufacturer's approval. Should you remove the SIM Card, your device will not operate. Please contact www.tourman.com.au for assistance.
3. **(4) Four Telephone Numbers** can be set into the Device, and the **FIRST Telephone Number** has been assigned to have specific authorization and function. In this manual, it is called either **"the 1st Telephone Number"** or **"P1"** or **"Administrator"**.

1. Understanding Your TOURMAN Camera / Sensor

1.1 Standard Packing List TOURMAN –

- TOURMAN Camera/ Sensor PIR Device: 1 unit
- Rechargeable Battery Pack: 1 set
- AC/DC Adaptor: 1 unit
- 4 Metre connector cable
- Swivel Mounting Bracket and Base Stand: 1 set
- Micro SD Memory Card 4Gb: 1 unit
- Remote Control – 2 units
- Window / Door Sensor – 1 unit
- Simcard: 1 unit

1.2 Standard Packing List TOURMAN Plus –

- TOURMAN Camera/ Sensor PIR Device: 1 unit
- Rechargeable Battery Pack: 1 set
- AC/DC Adaptor: 1 unit
- 4 Metre connector cable
- Swivel Mounting Bracket and Base Stand: 1 set
- Micro SD Memory Card 4Gb: 1 unit
- Remote Control – 2 units
- Window / Door Sensor – 1 unit
- Smoke Sensor
- Gas Sensor
- Simcard: 1 unit

Note: The Simcard has been installed as an essential part of your device. You will be required to register it in order to activate your device and enable the Warranty period to commence. The instructions are shown on the leaflet included with your pack, which refers you to the Website to complete the process.

1.3 Optional Accessories

- Panic Button
- Door/Window Contact
- Siren/Flasher unit
- Remote Control
- PIR Detector
- Smoke Sensor
- Gas Sensor

While the standard TOURMAN device is equipped with 2 x Remote Controls and 1 x Door/Window Sensor, you are able to add an additional seven (7) accessories as listed above available from the Website PRODUCTS page.

1.3 Specifications

TOURMAN	ICU11168 Security Monitor
Mains Power:	12V DC1A
Back up Battery:	7.2 rechargeable – Stand by time 2hr ≈ 4hr
Telecom Network:	3G WCDMA 900MHz / 2100MHz
Memory:	Support Micro SD Card 512MB≈Up to 4BG
LED:	All networks
RF Frequency:	434 MHz
Range (coupled devices):	30m in free space
PIR Capacity:	Temperature 35° C Detecting range 10m Angle 100°
Camera Angle:	55°± 3°
Working Temperature:	-10° ≈ +45° C
Picture Format:	Pictures 640 x 480 jpeg
Video Format:	QCIF 144 x 196
Dimensions:	120 x 70 x 50mm



GSM/3G Security Monitor
ICUVG168 – 434MHz
EYE CU Security Technology
Atick Compliant

2. To Program the device to your mobile phone.

Note: When you have completed the activation via the Website, this process is undertaken automatically. Go to Page 9.

2.1 Converting the Factory Default Value of your TOURMAN to install your mobile phone number to the device

When commencing your First use of the device, it will require you to initiate and record your mobile telephone number in its memory. Please use your nominated PRIMARY mobile phone (example: 0421 123456) to send the following SMS to the telephone number of the SIM Card inserted in the device:



The TOURMAN will reply with an SMS Message confirming the details of the confirmation of the mobile phone number to the Factory Default Value and **the number 0421 123456 will be assigned as P1 (First receiver) and administrator.**

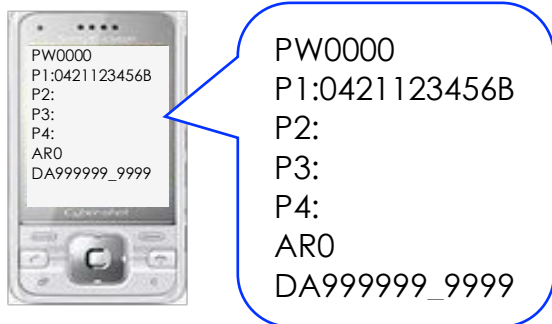

Your TOURMAN is now activated with your primary Mobile phone (P1) as the first receiver and the administrator of the device.

2.2 Re-Programming the 1st Telephone Number (P1)

Should you wish to change the primary mobile phone receiver (example: 0421 123456) to another mobile phone (new example: 0421555554) you will need to undertake the following procedure:

Send, from your original mobile phone (e.g. 0421 123456), the following SMS Message to the device:



PW0000
P1:042155554B

The TOURMAN will reply with an SMS Message displaying the details of the new mobile phone (e.g. 0421 555554) and **it will be reassigned as P1 (First receiver) automatically.**

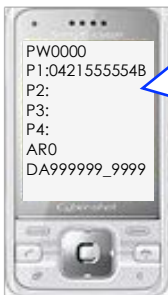

PW0000
P1:042155554B
P2:
P3:
P4:
AR0
DA999999_9999

Your new mobile phone 0421555554 has been **reassigned as P1 (First Receiver) and Administrator of the device.**

A NOTE OF CAUTION!

The TOURMAN should only respond to the correct SMS Message above to confirm this has taken place.

Whenever you send an SMS Message to the device, the contents must include the correct Password, e.g. PW0000; otherwise, the device will treat it as being invalid/incorrect with no reply!

2.3 To change the Password of the TOURMAN

Only the mobile phone with the (P1) Administrator status can change the device Password. Should you wish to undertake this, proceed as follows:

The new password can be 4 - 6 numbers (example: 123456) Send, via your primary mobile phone, the following SMS Message to the device:



The TOURMAN shall return, via SMS Message, the updated programmed value of Main Unit to your mobile phone, e.g.

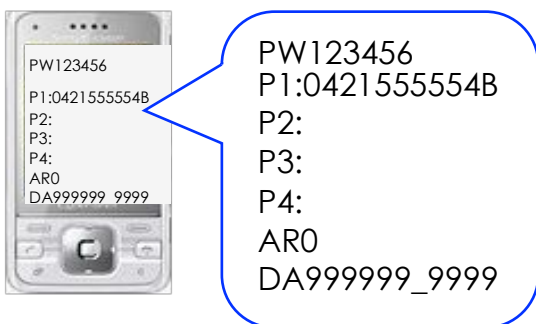

NOTE! The Password in the device has been changed, however the device does NOT send the password confirmation back to your mobile phone. Please make a note of the new password for your records, as it may be critical to future changes to your security setup and preferences. Please also advice admin@tourman.com.au, so we may update your records for any future needs.

2.4 To program the additional (2nd, 3rd & 4th) Telephone Numbers into your device

Undertake this in one SMS message and have the phone numbers ready to proceed. Send an SMS as follows:

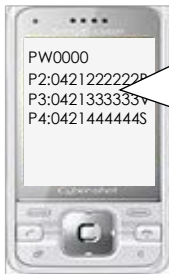

PW0000
P2: 0421222222B
P3: 0421333333V
P4: 0421444444S

The TOURMAN shall return the SMS confirmation as follows:

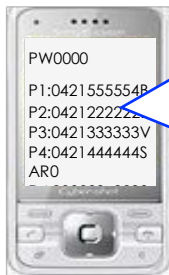

PW0000
P1: 0421555554B
P2: 0421222222B
P3: 0421333333V
P4: 0421444444S
ARO
DA9999999_9999

All telephone numbers are now available for contact in sequence should a higher preference mobile(s) be switched off.

Please be aware that every telephone number receives a text. This may impact on your activation plan and incur additional costs.

2.5 Programming of Date and Time of your device

In normal circumstances, the TOURMAN will automatically update "Date and Time" when located in 3G(WCDMA) networks. In the case of network issues, the date and time can be re-programmed as follows:

Send an SMS as follows, where the following applies:

YY = year - eg. 11

MM = month – eg. 06

DD = day – eg. 09

HH = hour – eg. Use 24 hour numbers – 16 is 4 pm.

MM = minute eg. 23

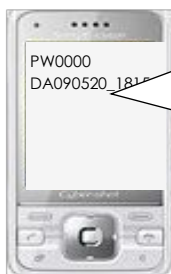

PW0000
DAYMMDD_HHMM

The device shall return an SMS message as programmed and as follows:

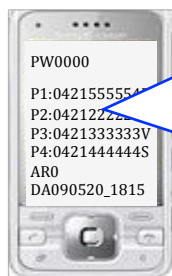

PW0000
P1: 042155554B
P2: 042122222B
P3: 042133333V
P4: 042144444S
AR0
DAYMMDD_HHMM

3. To operate your TOURMAN Camera / Sensor Security Device

The TOURMAN camera/sensor device has been forwarded to you with the package including accessories already linked (learned) to the device. Where additional accessories have been ordered, please ensure that they have been linked to the device to enable the security to perform as a total system. Linking (learning) procedures are illustrated in Section 8. ASSEMBLY of this guide. Should you have any problems please email us at admin@tourman.com.au

Congratulations, you are now able to enjoy the convenience and efficiency of your personalized features of the device.

Most of the ON/OFF functions of the device can be undertaken through the Remote Control, and some of them can be operated by the SMS Message via mobile phone, however be aware that text messaging may affect your Simcard cost.

In this chapter, these functions will be explained in detail:

3.1 Operating Modes available with the device:

(1) **DISARM (Stay) Mode (AR0)**

☞ When disarmed the reporting system will be limited to Panic Button, Smoke Sensor and Gas Sensor text and video alarm.

(2) **ARM (Away) Mode (AR1)**

☞ When armed, all security features are ready to report any breach via text and video to the Administrators mobile phone.

(3) **NOT ACTIVE Mode (AR2)**

☞ In the NOT ACTIVE Mode the PIR will be disabled, however Smoke, Gas and Panic Accessories will still operate 24/7. The NOT ACTIVE mode is designed to deactivate the CAMERA/SENSOR inbuilt PIR during times when it is convenient to do so. We do not recommend that you operate the sensor camera in this mode. Please be aware that you may disable the PIR sensor which will in turn disable its ability to detect movement.

3.2 SMS confirmation



In all modes, the device will report by SMS the following notifications:

SMS	REASON
• Panic Alarm (time & date)	Panic button activated
• PIR Trigger (time & date)	PIR within camera detection of movement
• Burglary Alarm (time & date)	Activation of PIR and Door Sensor
• AC Power fail ! (time & date)	Connected power off
• AC Restore (time & date)	Power reconnected
• Periodic Test Report (time & date)	30 day in service report
• Tamper Alarm (time & date)	Opening of Sensor cover while activated
• Fire Alarm (time & date)	Fire Alarm activated
• SD Card Abnormal (time & date)	When removing the SD Card
• SD Card Normal (time & date)	When re-inserting the SD Card
• Battery Low (time & date)	Warning the camera will stop working in 30 minutes

3.3 To operate the Remote Control

Description of the Remote Buttons:



- 【  】 DISARM Mode
- 【  】 ARM (AWAY) Mode
- 【  】 NOT ACTIVE Mode

By pressing the appropriate button the device can be activated or deactivated from a reasonable distance from the premises – 150 metres approx. The disarm/active mode is instant and the arm mode takes 30 seconds to deploy. This ensures you can arm the premises before leaving and disarm on arrival without the need for a dedicated control panel.

The Remote is ideal to be incorporated as a key ring and can be operated from inside or outside of the premises being monitored.

The Panic button will automatically send text and video alerts to your mobile phone

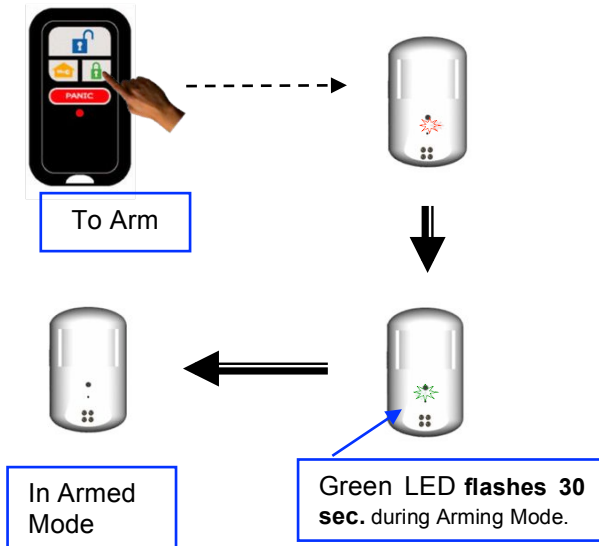

3.4 Programming the device mode via your mobile phone.

You are able to engage any of the operating modes via your mobile phone. Each mode has an AR code. These are:

AR0 ~ 【  | DISARM Mode

AR1 ~ 【  】 ARM (AWAY) Mode

AR2 ~ 【  】 NOT ACTIVE Mode

To activate any of the modes indicated above, send an SMS Message, via the P1 mobile phone, to your device that corresponds with any of the operational modes you wish to deploy:

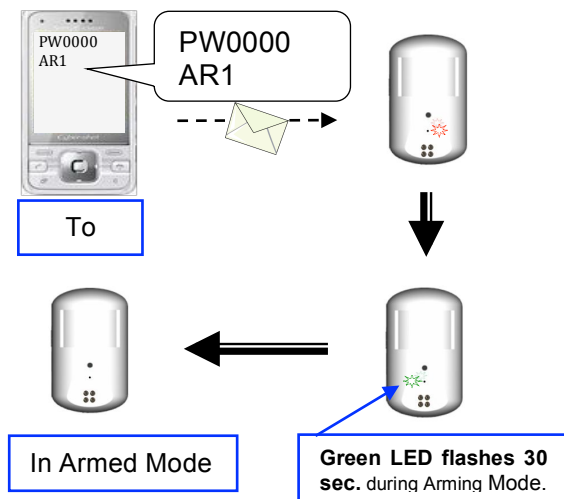

The TOURMAN does not return an SMS for any of these Instructions.

4. Communication Process

4.1 Communication process of the device when ACTIVATED

When activated in the ARMED or PANIC mode, the device shall always:

1. Send an SMS – (Example) Panic Alarm
2. Take 3 still photos of the location
3. Send video to your mobile phone.

(1) When the Video Call has been generated (To answer the video call Press the **5** key) you are able to watch real time video that will broadcast about 20 seconds continually. During this display, it will be recorded on the memory card within the device.

(2) By another Press of the **5** key within the initial 20-second video period, the monitoring on this video call will be extended for another 5 minutes. However, if the Video call is disconnected before the expiry of the extended 5 minutes, the Device will continue to record for an additional 3 minutes.

(3) Should you disconnect the phone by accident or turn it off for any reason, the device will attempt to send video on 3 successive calls to your mobile phone.

(4) The device will (only) always send an SMS to the Administrators mobile phone. It will also direct the video call to the Administrators phone.

(5) Should the Administrators phone be turned off, the video call will automatically default to the second (P2) mobile number and in turn to the remaining numbers (P3, P4) in sequence, should the higher phones be turned off

(6) The still photos and the video footage will be recorded on the memory card located in the device.

(7) Should the memory card have recorded video from accidental or previous activation, it will automatically discard the former footage from memory once the status of 70% full

4.2 Communication to the device from your mobile phone

(1) Engage video from a remote location.

You can access the device at any time via your mobile phone by video dialing the Simcard phone number installed in the device. When the call is answered you will need to access the Keypad and key in your password. No additional charges will be caused should you elect to call your device for observation, or to arm or disarm it by SMS at any time. Those call costs will be directed to your mobile phone. The default password as indicated in Section 2.3 of this Manual is:

0000

Use your changed password if appropriate. You have 20 seconds to complete this action. Any of the nominated phones can access the Device remotely.

(2) **Engage Two-way Communication while connected**

Your device is fitted with a speaker, and you can engage in two-way conversation by pressing the **3** key during the video transmission. You are also able to terminate the communication by pressing **#3**.

(3) More specified functions are available based on the requirement from individual users upon request. Please go to the Website www.tourman.com.au and email us from the CONTACT page.

4.3 Mobile commands while video call is connected

Command	Function
3	Enable two-way communication
#3	Disable two-way communication
5	Start Recording
#5	Stop Recording
*6	Turn on LED Lights
#6	Turn off LED Lights
*8	Turn on Siren Alarm
#8	Turn off Siren Alarm
*9	Turn on the Relay
#9	Turn off the Relay

4.4 MicroSD card Memory Status Reminder

The photos and videos will occupy storage space in MicroSD card. The user can download the images and video from this card. The MicroSD card memory will cause the device to send the following notifications:

- (1) When 75% of storage is reached:
"SD will be running out of size memory, please manage the SD card ASAP"
- (2) When 80% of storage is reached:
"All files in SD card will be deleted anytime, please manage the SD card ASAP"

4.5 LED Indicator

The 4 LED indicators will turn on automatically when pictures or video is being recorded. The LED indicators can also be turned on by the administrator's mobile phone.

- (1) When the PIR triggers, the TOURMAN will automatically turn on the LEDs and take 3 pictures. The LED indicators will then automatically switch off.
- (2) When video calling, you can switch the LEDs on and off by pressing “*6” or “#6”.

5. OPERATING COSTS - Simcard

The cost of maintaining the Simcard will be affected by any activation of the Device by security breach whether accidental or emergency.

Be careful to understand the arming and disarming process to avoid unnecessary or accidental activation of your Simcard. Remember that it generally takes 30 seconds for the device to activate in the ARMED mode, so there is generally enough time on arrival or on leaving the premises to select the appropriate mode on your remote.

Your Simcard telecommunications cost may be affected by over or accidental use and depending upon your arrangements may increase your monthly charges.

6. MAINTENANCE

6.1 Testing

Following the first months operation it is advisable to test the devices workability by undertaking the following procedures:

- Call the device from your phone to activate the video
- Test the device by activating the Panic Button to receive both text and video
- Remove the Memory Card and check the photos and video recorded on your PC. Remove the data from the memory card and replace it in the device. Check that the texts relating to that procedure are received ie. a) microSD card is Abnormal & b) microSD card is Normal
- Re-enter the Date & Time – refer item 2.5
- Turn off the Power and check the text receipt – AC Power Fail ! Turn the power back on and check the text receipt – AC Restore

Should any test not register the correct response, please contact us by email immediately for advice and remedy – info@tourman.com.au We will respond to you within 24 hours.

6.2 FAQ's

An explanation of the workings of the device is shown on the FAQ's Page of our Website www.tourman.com.au The information displayed there-in will give you a comprehensive understanding of the Device and it's features. Should you have any problems please contact us at - info@tourman.com.au We will respond to you within 24 hours.

6.3 HOW THE TOURMAN WILL WORK FOR YOU !

The TOURMAN requires activation of the Simcard/Telephony to be operational. The following information and descriptions with ensure that you have an understanding of the most appropriate workings the device can deliver to help your security.

6.3.1 MODES of OPERATION

To ARM: You are able to use the REMOTE CONTROL from within or in close vicinity of the site or the boat etc. – by pressing the green lock button the system will immediately arm itself. You have 30 seconds to vacate the area of surveillance.

To DISARM: Again, by using the REMOTE CONTROL you are able to disarm the system via the blue unlock button. This should be undertaken prior to entering the area of surveillance. It can also be used to immediately disarm the device when activated unintentionally.

The REMOTE CONTROL also has a yellow home button that disables the surveillance capacity of the device when it may not be required.

It also has a panic button that can be used in times of emergency. It will activate whether the device is armed or disarmed.

The dedicated HELPMAN panic button also activates the TOURMAN by pressing the button for 3 seconds. It is one of two devices that are hand operated.

Once you have selected the mode of operation the device will remain in that mode until changed. Some ACCESSORIES however will activate 24/7. These are the SMOKE SENSOR (automatic), PANIC BUTTON (by specific activation), GAS SENSOR (Automatic), BILGEMAN (Automatic), TAMPER (automatic). The status of the 240v power connection will also activate if disrupted. These will activate whether the device is armed or disarmed.

6.3.2 ACTIVATION and NOTIFICATION

The TOURMAN will provide text and video notification for the following reasons:

SMS ONLY	REASON
<ul style="list-style-type: none">• Periodic Test Report (time & date)• AC Power fail ! (time & date)• AC Restore (time & date)• Battery Low (time & date)• SD Card Abnormal (time & date)• SD Card Normal (time & date)	<ul style="list-style-type: none">30 day in service reportConnected power offPower reconnectedWarning the camera will stop working in 30 minutesWhen removing the SD CardWhen re-inserting the SD Card
SMS & VIDEO	REASON
<ul style="list-style-type: none">• Panic Alarm (time & date)• PIR Trigger (time & date)• Burglary Alarm (time & date)• Tamper Alarm (time & date)• Fire Alarm (time & date)	<ul style="list-style-type: none">Panic button activatedPIR within camera detection of movementActivation of PIR and Door SensorOpening of Sensor cover while activatedFire Alarm activated

All texts will be forwarded to each linked phone simultaneously.

For SMS and Video activations, the text shall be immediately followed by a live video call that will rotate to the other phones in sequence (up to 4) until answered. The video call will rotate 3 times and if unanswered will then cease. When answered the video will display for a period of 20 seconds. You can then extend the video for a period of up to 10 minutes or until you cancel the call. The camera will cease to record when the call is cancelled.

Once the Video call is answered the camera will take between 2 and 4 still photos of the location and store them on the Memory Card. Following the extension of the video call, the camera will record the video for the nominated period until the call is cancelled.

At times of emergency or any unexpected activation the operator may by accident cancel the call or fail to activate the video recording. The device may then be called and the video activated to record footage by instruction as required for up to 10 minutes.

Accidental activation will cause text notification automatically. When the video call is displayed the device can be disarmed immediately (as above).

You can also ARM and DISARM the TOURMAN via your mobile phone. You are also able to dial into the TOURMAN and survey the location 24/7 at no cost to your TOURMAN Simcard.

6.3.3 SUGGESTED INSTALLATION AND USE

The installation of the device should be undertaken so as not focus on windows or internal elements with a high lighting value from sunlight penetration of the area in focus. High contrast lighting in view of the camera will diminish the effectiveness of the pictures and video.

Focussing the camera on open doors or windows where there is movement outside will cause the device to activate. This is particularly relevant when travelling.

Locate the device in view of the length of the vehicle and facing the door at the side so as to capture movement once the door has been opened away from the camera. The camera can pan to a width of 55 degrees, so it will be able to capture most of the facilities within the vehicle and report any irregularities with clarity of detail.

Securely mount the device with the screws provided by attaching the clamp to a solid structure within the vehicle. Ensure that the clamp-mounting bracket is screwed to the back of the Device to prevent separation while travelling.

You may connect the device to the 3 pin plug within your vehicle, however when moving location from powered sites (unless you have an inverter) the device will register "Power Fail" and the camera sensor will become inoperative within one hour.

For best results the device should be powered from a 12 volt battery (preferably dedicated) to eliminate power fail and also minimise the SMS registrations on your Simcard. The 4 metre connector cable provided in the pack will allow you to install the device this way. The power pack can also be used elsewhere should you wish to use the device in an alternative location.

7. ASSEMBLY

7.1 Your TOURMAN Sensor Camera

-Illustration of Front View and Back View

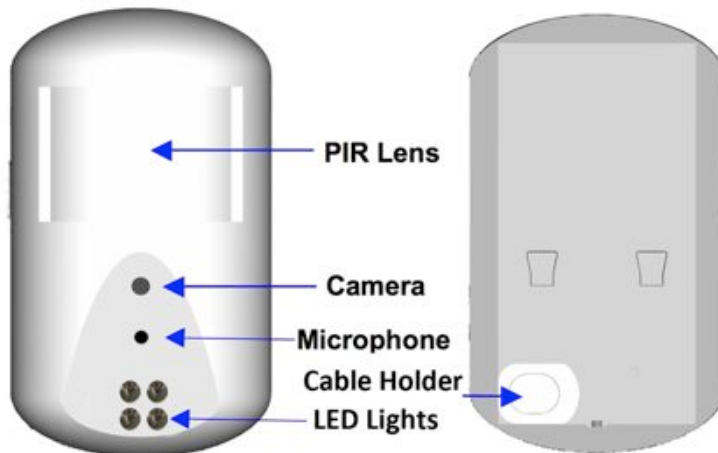

-Illustration of Right and Left Side View

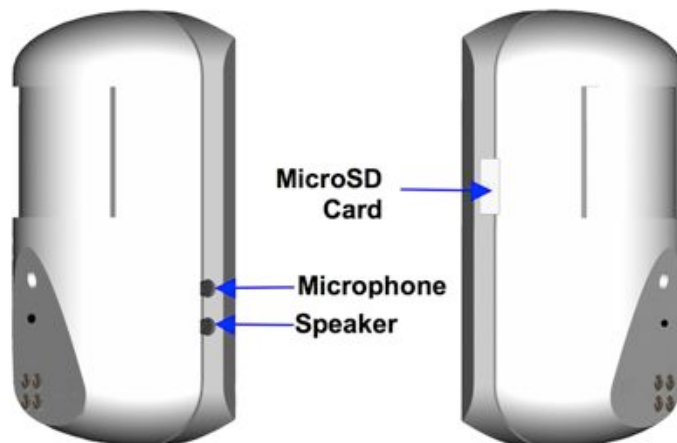
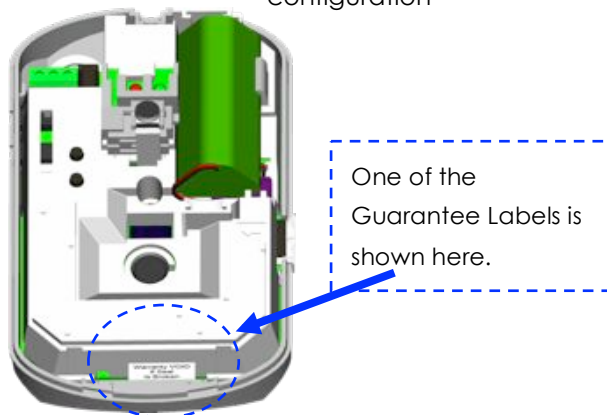
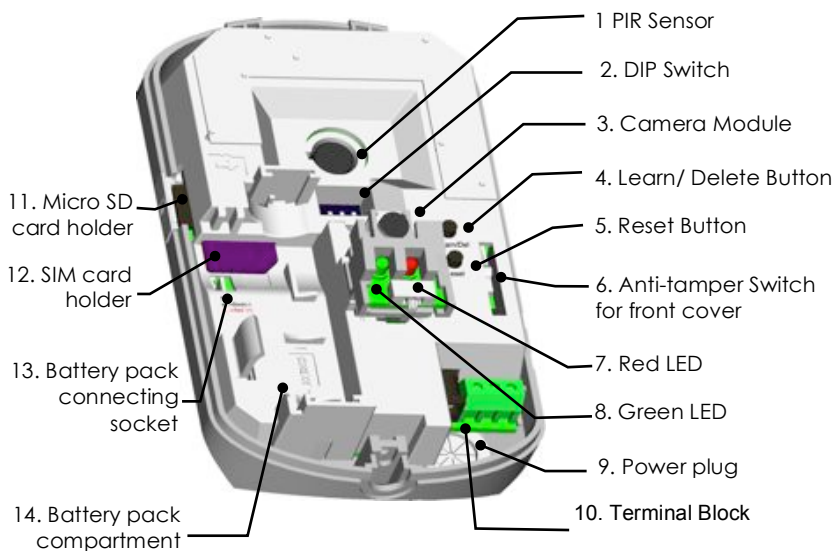

Illustration of internal configuration

- (1) Removed front cover of TOURMAN reveals internal configuration



- (2) The details of the internal configuration of TOURMAN is explained below.



7.2 Assembly of the TOURMAN

- 7.2.1 Remove front cover
- 7.2.2 Insert Micro SD memory card
- 7.2.3 Insert SIM card
- 7.2.4 Insert battery pack
- 7.2.5 Plug in AC/DC power adaptor
- 7.2.6 Confirm preparation
- 7.2.7 Charge battery pack

NOTE: Do not alter the sequence of any of the above steps

7.2.1 Remove Front Cover

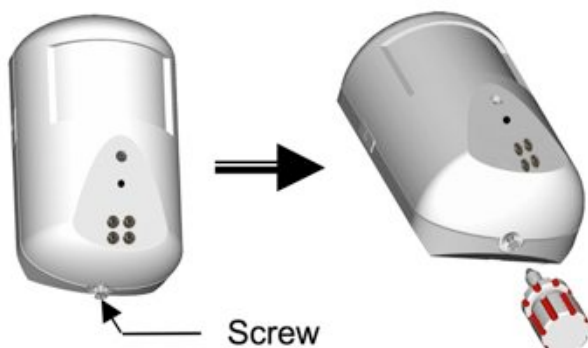

7.2.2 Insert Micro SD memory card

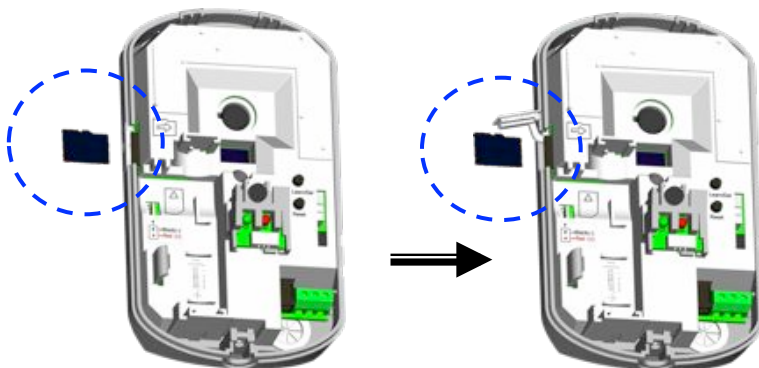

7.2.3 Insert SIM card

- Insert the SIM card or USIM card into WCDMA network as per illustration below

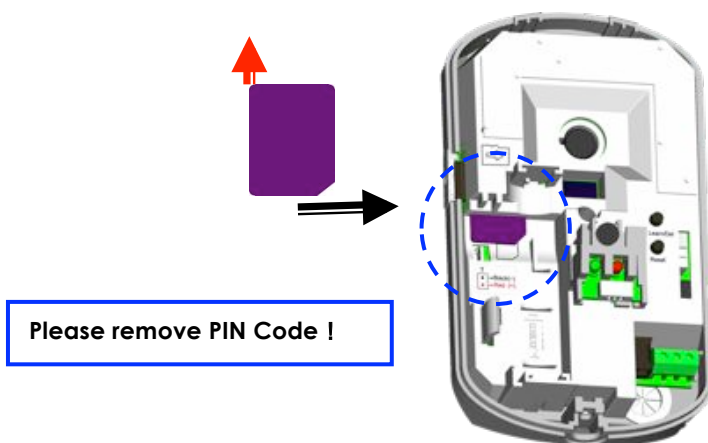

7.2.4 Insert battery pack

- Plug the battery cable into the socket (red cable lower) and insert the battery pack in the compartment, as illustrated

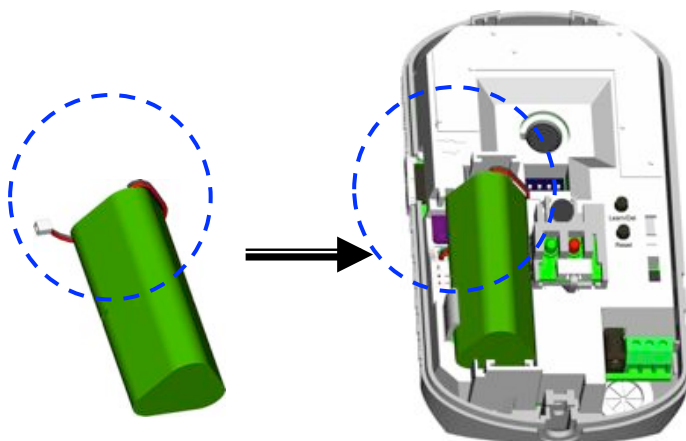

7.2.5 Plug in AC/DC power adaptor

As illustrated, insert the power cable with plug (2) of AC/DC adaptor, through the cable holder, from the backside of TOURMAN device (1) Hold the cable with plug (2) forward carefully and insert the plug into the power socket (3)

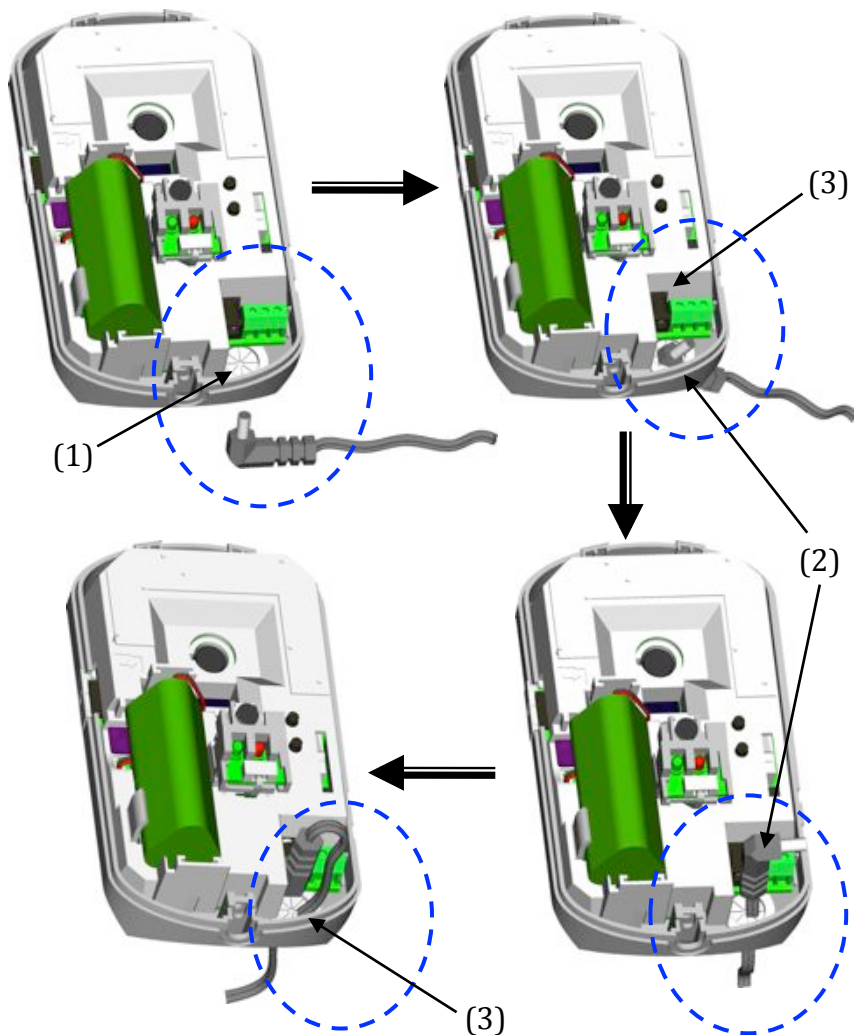

7.2.6 Confirm preparation

Switch power on, the Green LED and Red LED located in the front side will start flashing alternatively for 40 seconds, as shown below in the left illustration. The Red LED will then stop.

The Green LED of the TOURMAN keeps flashing once every 10 seconds to confirm that the basic preparation of the device is completed and operating in the Standby Mode.

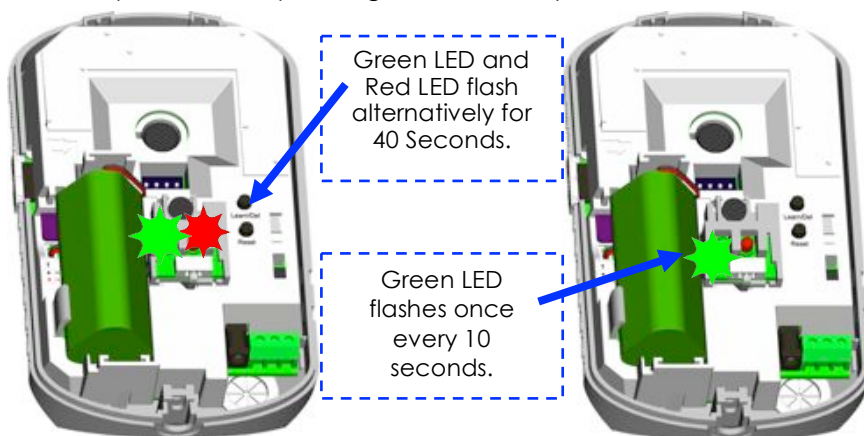

NOTE: SIM card must be activated to register Green LED confirmation. If the Green and Red LED flash alternatively, this indicates the SIM card hasn't been activated, or there is no network connection.

7.2.7 Charge battery pack

The rechargeable battery pack supplied, must be charged for more than 10 continuous hours to reach the full capacity.

Whenever the main AC power is disconnected, the TOURMAN will notify the user with an SMS message. (AC Power Fail!) In case the battery voltage drops to the low battery level, the device will notify the user an SMS message that the TOURMAN will stop its working mode in 30 minutes (Low Battery! System will STOP working within 30 minutes.) Whenever the main AC power is reconnected, the TOURMAN will notify the user with the SMS message (AC Power Restore!)

7.3 To configure your TOURMAN

- 7.3.1 Learn/ Delete accessories
- 7.3.2 Options for Learn/ Delete accessories
- 7.3.3 Sample of Learn/ Delete process for the Remote Control
- 7.3.4 Reset Process

7.3.1 Learn/ Delete accessories

When the TOURMAN is prepared ready, all accessories should be coupled with the TOURMAN singularly; only when the learning of the accessories have been undertaken correctly can they interact normally with the TOURMAN and thus create your unique TOURMAN Security System.

Each TOURMAN can support 10 accessory units. If any accessories have been pre-learned, the former data will be replaced by the latter one.

If a re-learning process is required for any reason, you must delete all the learned data in the TOURMAN device and recommence the process.

The TOURMAN device will interact with all wireless sensors, sirens, remote controls, etc.

Refer website for details of additional accessories.

7.3.2 Options for the connection of TOURMAN accessories

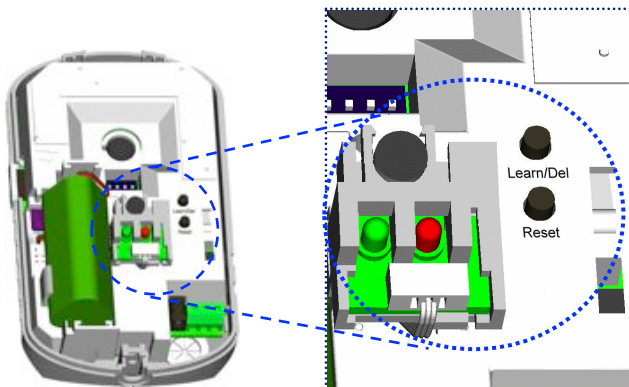

With reference to the diagram on page 27, in order to attach the accessories to your TOURMAN camera sensor device, you will need to undertake the following:

By pressing the Learning Key, the left hand Red LED will engage and stay alight until a singular accessory is learned to the device.

Each accessory requires individual learning to the device. Follow the example over page that will explain the process. The Red LED will turn off automatically when an accessory is attached to the device. In other circumstances, to terminate the Red LED, press the Learning Key again or it will turn off within 2 minutes.

7.3.3 Sample of Learn/ Delete process for the Remote Control

- Appearance and Function of a remote control is shown below:



1. To start Learning

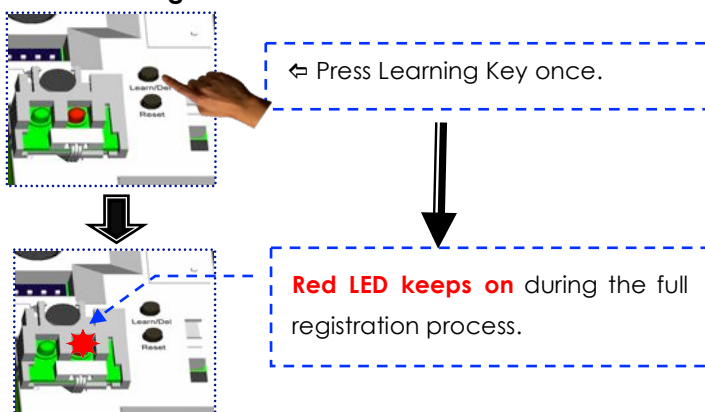

2. To Transmit ID Code

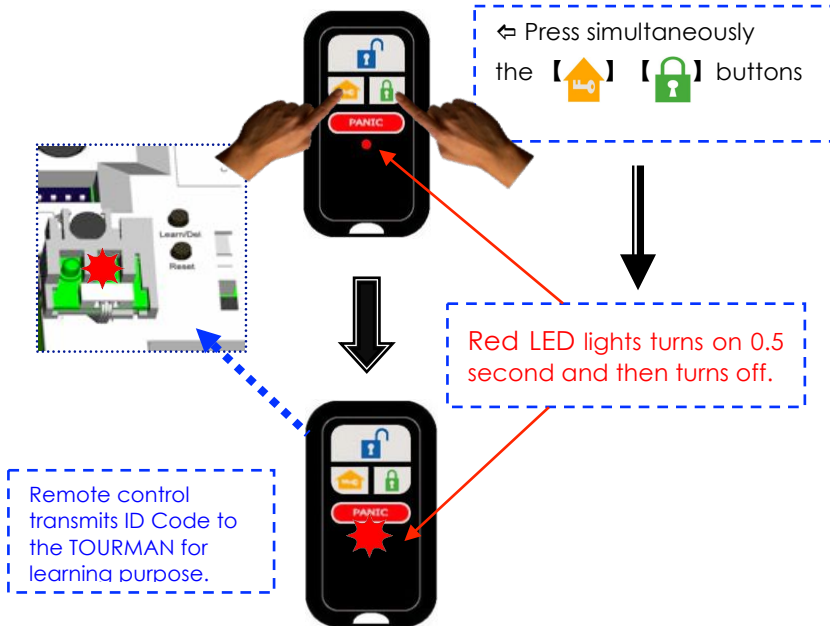

3. To confirm the learning

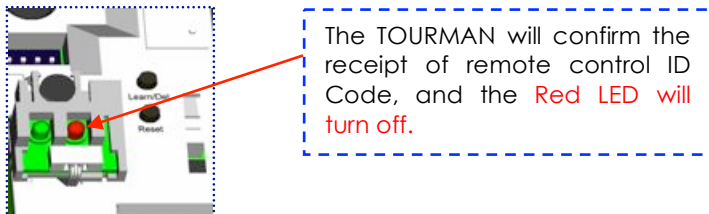

7.3.4 Delete Process

- (1) In the event that the accessories are required to be reset to factory specifications, the Deleting Process needs to be executed. ALL learned ID Code of the accessories will be erased. **Please be cautious before executing this process!**
- (2) The black colour DELETE button, also called Learn/ Del button, is located on the right hand side of the TOURMAN

To start Deleting

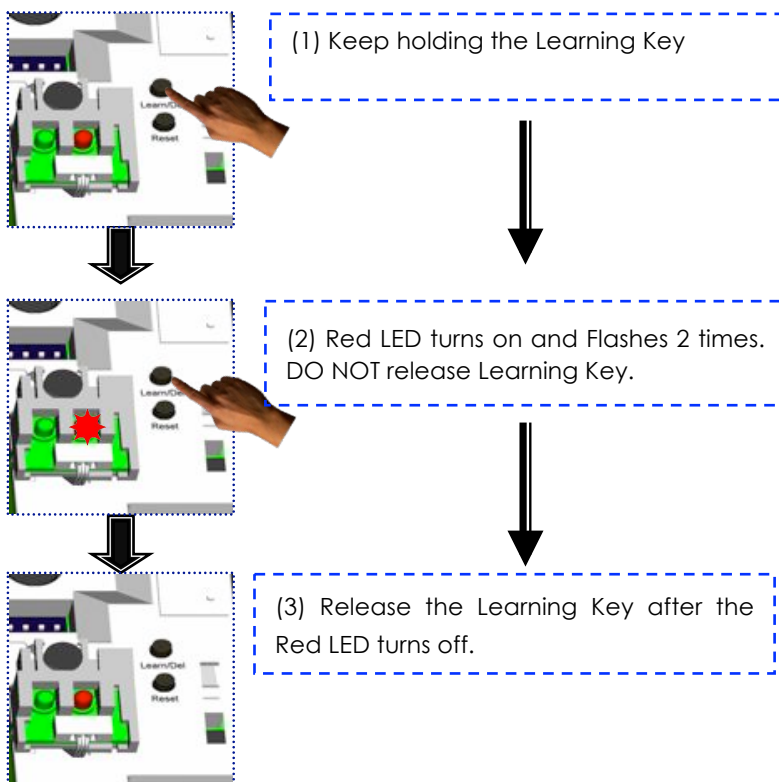

Deletion Completed. All ID codes of accessories are erased.

7.3.5 Reset Procedure

- (1) Use the screw driver to open the front cover of the TOURMAN camera sensor

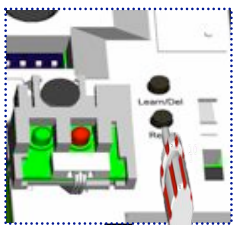

- (2) With power connected, use a sharp tool to PRESS & HOLD the reset button



- (3) PRESS & HOLD Learning Key, Release the reset button. The Green and Red LED will flash in turn quickly



- (4) Green & Red LED will stop flashing and Red LED will flash along several times.



- (5) The Green & Red LED will flash in turn again. Release the learning key.

**Reset Completed. All data has been cleared.
Wait for the 3G network to be reconnected.**

8. Accessories List



The TOURMAN



Smoke Sensor



PIR Sensor



Panic Button



Gas Sensor



Bilge Sensor



Remote Control



Door/Window Sensor

