

# CCTV LCD Monitor

## User Manual

For modes:

EL-97MA1RE



# Contents

<b>1. Introduction</b> .....	1
<b>2. Work Safety Information</b> .....	2
2.1. Product Safety Precautions information.....	2
2.2. Safety Guidelines.....	3
2.3. Important Notice Concerning Power Cord Selection.....	3
2.3.1 For the United States and Canada.....	3
2.3.2 For European Countries.....	3
2.3.3 For the United Kingdom.....	4
<b>3. Standards and Guidelines</b> .....	5
3.1. FCC Requirements.....	5
3.2. FCC Warning .....	5
3.3 CE Conformity.....	5
3.4 RoHS Compliance Statement.....	5
3.5 Information on Disposal for Your Old Product.....	6
<b>4. Hardware Installation</b> .....	7
4.1 Checking the Accessories Supplied.....	7
4.2 VESA bracket installation .....	7
<b>5. Buttons and Connections</b> .....	7
5.1 Buttons.....	7
5.2 Connections.....	8
<b>6. ID Remote Controller</b> .....	9
<b>7. OSD Setup</b> .....	10
<b>8. Troubleshooting Guide</b> .....	17
<b>9. Applicable Video Timing for PC- analog Video</b> .....	18
<b>10. Technical Data</b> .....	19

# 1 Introduction

---

Thank you for purchasing the professional CCTV LCD Monitor and welcome to a fantastic new technology that will completely change the way you look at monitors. The following sections describe just a few of the major advantages of this LCD monitor. You'll discover more of its wonderful features as you use it.

Please note that this manual is used with many similar monitor models. Please check the model number on the carton and on the back of the unit to make sure if the user manual is applicable to your machine.

1. The LCD monitor is used in the same way as the CRT monitor. There is no need to change the hardware of your computer, just plug it in and it is ready for use.
2. The monitor will accept and display analog video (NTSC or PAL) , PC-type video and Digital video sources .
3. Low radiation and reduced flickering compared to traditional CRT monitors that minimizes eyestrain and health hazards.
4. The compact size makes transportation easier and allows to use in many applications.
5. This LCD monitor can support PC-VGA, Composite , S-Video signals.
6. The composite video input ports accept different signal sources, e.g. Camera, DVR .. etc.
7. The design allows VESA wall mounting installation.
8. This monitor includes special functions for 3D comb filter, De-interlace, Anti burn-in mode, auto impedance switch for looping video connection .
9. The remote controller has 9999 ID code to control individual monitor on the wall. (Remote controller is an optional device)

## 2 Work Safety Information

---

### Caution and Warning

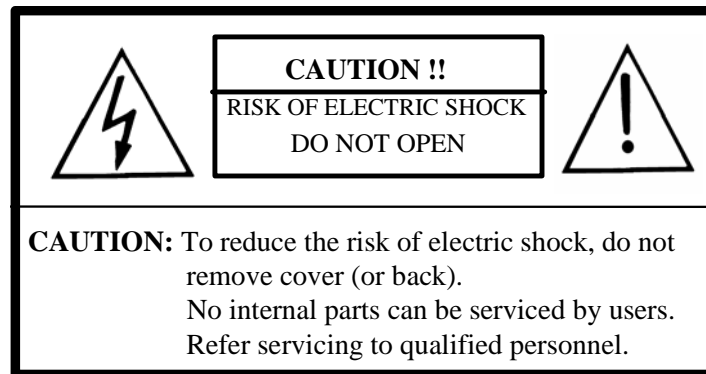

### WARNING

TO PREVENT FIRE OR SHOCK HAZARD, DO NOT EXPOSE THIS CCTV LCD MONITOR TO RAIN OR MOISTURE.

"HIGH VOLTAGE EXISTS ON THE BACK LIGHT POWER LEAD OF THIS CCTV LCD MONITOR. BEFORE SERVICING, DETERMINE THE PRESENCE OF HIGH VOLTAGE BY CONNECTING THE H.V. METER BETWEEN THE BACK LIGHT POWER LEAD AND CHASSIS ONLY"

---

### 2.1 Product Safety Precautions

---

Follow all warnings and instructions marked on the product.

1. Do not use this product near water.
2. This LCD monitor should be installed on a stable horizontal base.
3. When cleaning, use only a neutral detergent cleaner with a soft damp cloth. Do not spray with liquid or aerosol cleaners.
4. Do not expose this LCD monitor to direct sunlight or heat. Hot air may cause damage to the cabinet and other parts.
5. Adequate ventilation must be maintained to ensure reliable and continued operation and to protect the LCD monitor from overheating. Do not block ventilation slots and openings with objects or install the LCD monitor in a place where ventilation may be obstructed.
6. Do not install this LCD monitor near a motor or transformer where strong magnetism is generated. Images on the LCD monitor will be distorted and the color irregular.
7. Do not allow metal pieces or objects of any kind fall into the LCD monitor through ventilation holes.
8. Do not attempt to service this unit yourself. Removal of the LCD monitor cover may expose you to dangerous voltage or other hazards. Refer all servicing to qualified service personnel.
9. Unplug this product from the wall outlet and refer servicing to qualified service personnel in the event that:
  - Liquid is spilled onto the product or the product is exposed to rain or water.
  - The product does not operate normally when the operating instructions are followed.
  - The product has been dropped or the cabinet has been damaged.
  - The product exhibits a distinct change in performance, indicating a need for service.
  - The power cord or plug is frayed or damaged.
  - Has referred to Troubleshooting Tips and problems still can't be solved.

## 2.2 Safety Guidelines



**WARNING**

This device must be operated with the original power supply.



**CAUTION**

The socket outlet should be installed near the equipment and should be easily accessible.



**CAUTION**

Use a power cord that is properly grounded. Always use the appropriate AC power cord that is certified for the individual country. Some examples are listed below:

USA.....UL	Switzerland.....SEV
Canada.....CSA	Britain.....BASE/BS
Germany.....DE	Japan.....Electric Appliance Control Act.

## 2.3 Important Notice Concerning Power Cord Selection

The power cord set for this unit has been enclosed and has been selected according to the country of destination. It must be used to prevent electric shock. Use the following guidelines if it is necessary to replace the original cord set, or if the cord set is not enclosed.

The female receptacle of the cord set must meet IEC-60320 requirements and may look like this (Figure A1 below):



Figure A1



Figure A2

### 2.3.1 For the United States and Canada

In the United States and Canada the male plug is a NEMA5-15 style (Figure A2, above), UL Listed, and CSA Labeled. For units which are mounted on a desk or table, SVT or SJT type cord sets may be used. For units which sit on the floor, only SJT type cord sets may be used. The cord set must be selected according to the current rating for your unit. Please consult the table below for the selection criteria for power cords used in the United States and Canada.

Code Type	Size of Conductors in Cord	Maximum Current Rating of Unit
SJT	18 AWG	10 Amps
	16 AWG	12 Amps
	14 AWG	12 Amps
SVT	18 AWG	10 Amps
	17 AWG	12 Amps

### 2.3.2 For European Countries

In Europe you must use a cord set which is appropriate for the receptacles in your country. The cord set is HAR-Certified, and a special mark that will appear on the outer sheath, or on the insulation of one of the inner conductors.

## 2.3.3 For the United Kingdom

---

For your safety please read the following text carefully.

If the fitted molded plug is unsuitable for the socket outlet, then the plug should be cut off and disposed of safely.



---

**DANGER**

Do not plug the cut-off plug into a socket outlet! There is a danger of severe electrical shock!

---

If a new plug is to be fitted, please observe the wiring code as shown below. In case of doubt, please consult a qualified electrician.



---

**WARNING**

This appliance must be earthed (grounded).

---



---

**IMPORTANT**

The wires in this mains lead are colored in accordance with the following codes:

- Green-and-Yellow : Ground (Earth)
  - Blue : Neutral
  - Brown : Live
- 

If the colored wires of the mains lead of this appliance do not correspond with the colored markings identifying the terminals in your plug, proceed as follows:

The wire which is colored GREEN-AND-YELLOW must be connected to the terminal in the plug which is marked by the letter E or by the Earth symbol or colored GREEN or GREEN-AND-YELLOW.

The wire which is colored BLUE must be connected to the terminal in the plug which is marked with the letter N or colored BLACK.

The wire which is colored BROWN must be connected to the terminal in the plug which is marked with the letter L or colored RED.

If you have any questions concerning the proper power cord to use, please consult the dealer from whom you purchased the product.

## 3 Standards and Guidelines

### 3.1 FCC Requirements

---

This device complies with Part 15 of the FCC Rules and Regulations. Operation is subject to the following two conditions: (1) This device may not cause harmful interference, and (2) this device must tolerate any interference encountered, including interference that may cause improper operation.

The equipment has been tested and found to comply with the requirements stipulated in Part 15 of FCC regulations for a Class B digital device. These requirements are designed to provide reasonable protection against harmful interference in a residential installation. This equipment generates, uses and can radiate radio frequency energy and, if not installed and used in strict compliance with the instructions, may disrupt radio communications. However, there is no guarantee that interference will not occur in a particular installation. If this equipment does cause detrimental interference with radio or television reception, which can be determined by turning the equipment off and on, the user is encouraged to try to correct the interference by taking one or more of the following measures:

- Reorienting or relocating the receiving antenna.
- Increasing the separation between the equipment and the receiver.
- Connecting the equipment into an outlet on a circuit different from the one which the receiver is connected.
- Consulting the dealer or an experienced radio/TV technician for help.

Shielded interconnected cables and shielded power cords must be used with this equipment to ensure compliance with the pertinent RFD emission limits governing this device.

Changes or modifications not expressly approved by the manufacturer could void the user's right to operate the equipment.

#### **Notice of Compliance with Canadian Interference-causing Equipment Regulations**

This Class B digital apparatus meets all requirements of the Canadian Interference-Causing Equipment Regulations.

### 3.2 FCC Warning

---

To ensure continued FCC compliance, the user must use a grounded power supply cord and the shielded video interface cord with bonded ferrite cores provided. If a BNC cable is going to be used, use only a shielded BNC (5) cable. Also, any unauthorized changes or modifications not expressly approved by the party responsible for compliance could void the user's authority to operate this device.

### 3.3 CE Conformity

---



The device complies with the requirements of the directive 2004/108/EC with regard to "Electromagnetic compatibility"

## 3.4 RoHS Compliance Statement

---

This display defined in this user manual is 100% RoHS compliant and meets all the requirements set forth in European Union Directive 2002/95/EC, Restriction of the Use of Certain Hazardous Substances in Electrical and Electronic Equipment.

## 3.5 Information on Disposal for Your Old Product

---



Used electrical and electronic equipment must be treated separately and in accordance with legislation that requires proper treatment, recovery and recycling of used electrical and electronic equipment. When this crossed-out wheeled bin symbol is attached to a product, it means the product is covered by the European Directive 2002/979/EC. If you wish to discard of this product, please contact your local authorities and ask the correct method of disposal. The correct disposal of your old product will help prevent potential negative consequences for the environment and human health.

Attention: if you want to dispose of this equipment, please do not use this ordinary dust bin!



## 4. Hardware

---

This chapter will guide you through the correct installation procedures for the LCD monitor.

### 4.1. Checking the Accessories Supplied

---

- LCD monitor body + Desk Stand x 1 pc
- AC power cord x 1 pc
- Adaptor x 1 pc
- D-Sub 15-pin cable (1.8 Meter) x 1 pc
- Ø 3.5mm audio line (1.5 Meter) x 1 pc
- User manual (CD) x 1 pc
- Remote controller x 1 pc (Optional)
- Battery (AAA) x 2 pc (Optional)

### 4.2 VESA bracket installation

---

If you want to install the LCD Monitor on the wall , please purchase the bracket that meet the VESA standard (100x 100 mm). Please install the bracket on the VESA hole that reserved on the back of cabinet, then install to the wall.

## 5. Buttons and Connections

---

### 5.1 Buttons

---

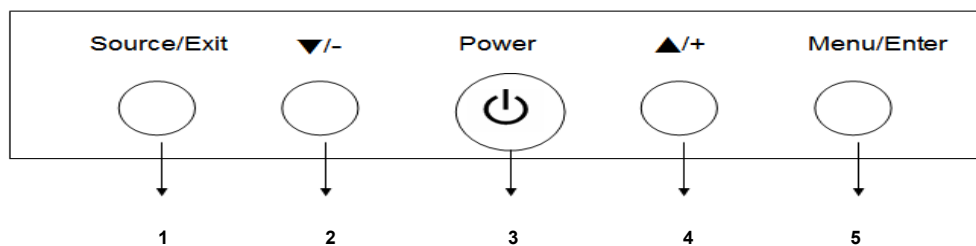

#### 1 “Source/Exit”

1. To select the input signal source when the OSD menu is Off. The available signal source will be shown in the following order: PC,AV1,S-Video1 .
2. To exit the menu when you finish the setting.

#### 2 “ /-” Down/Decrease:

To move the cursor downwards or to switch over the setting items or to decrease the figure of the setting selected.

#### 3 Power :

Press button to turn the power on and press again to turn the power off.

④ ” /+” **Up/Increase** :

To move the cursor upwards or to switch over the setting items or to increase the figure of the setting selected.

⑤ **“Menu/Enter”** :

To Enter the OSD menu or confirm the setting.

## 5.2 Connections

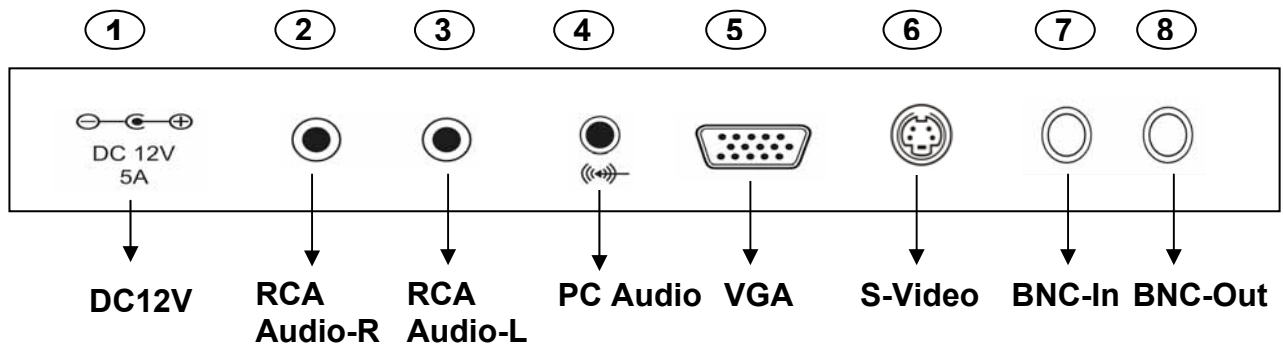

Item	Connector	Function
1	DC 12 Input	Please use DC 12V, 5A Power Adaptor
2 3	Stereo RCA Audio Input (R/L)	Stereo audio input , “R” is right channel (Red) of audio connector, “L” is the left channel(White) of the audio of connector.
4	PC Audio Input (Ø 3.5mm)	Connect to the audio output of your computer
5	D-Sub (VGA) Input	Connect to the VGA output of your computer or DVR
6	S-Video Input	Connect the S-Video(4-pin DIN) connector from the DVR or AV equipment to the Monitor .
7 8	Composite Video Input and Output (BNC type)	This Video input and output are used for CVBS input and output. This monitor also supports the“ auto looping” function, permitting the connection of another monitor from the output connector.

## 6. ID Remote Controller (Optional)

(The ID function is only applicable for some specific models )

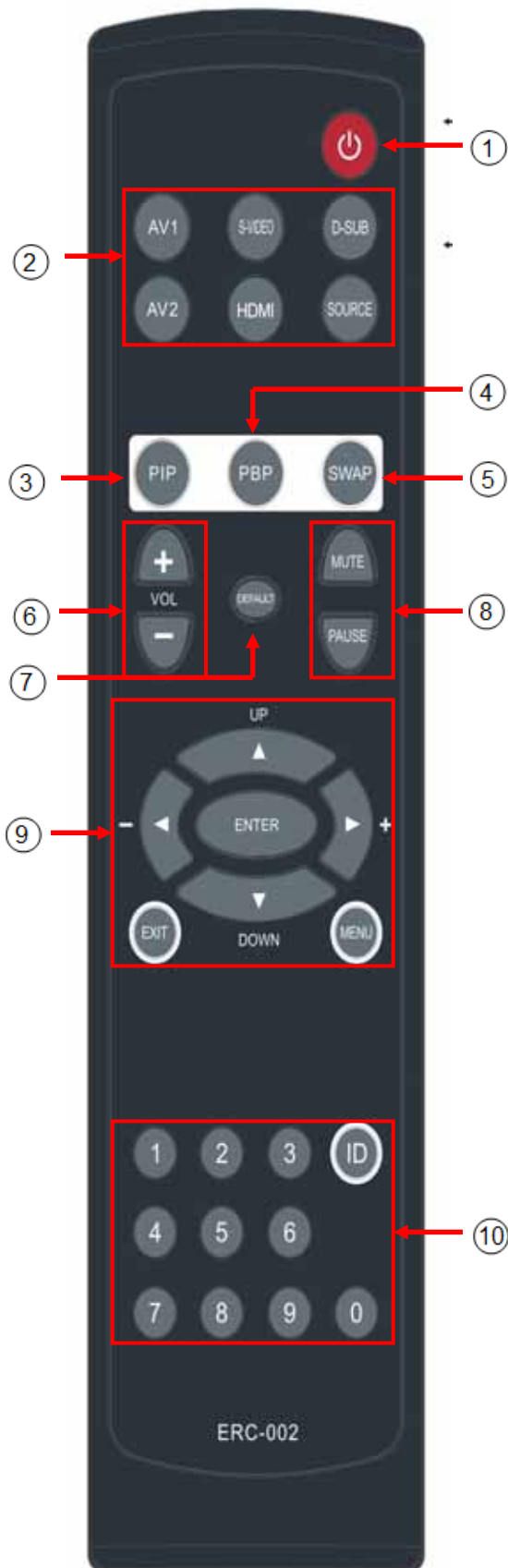

### ①. POWER switch.

Press to turn ON or turn OFF the LCD Monitor.

### ②. VIDEO SIGNAL Selection:

Press the “AV1”, “AV2”, “S-VIDEO”, “D-SUB”, “HDMI” button to enter the selected video source or press the “SOURCE” button to have the cycle video selection. (PS. AV2 and HDMI buttons are only applicable for specific models with AV2 and HDMI connector).

### ③. PIP Hot Key:

Press PIP button to enter “PIP” setup .

### ④. PBP Hot Key:

Press PBP button to enter the PBP setup

### ⑤. SWAP Hot Key:

Press SWAP button to exchange the main and sub screen.

### ⑥. VOL:

Press “+” to increase volume and press “-” to decrease volume.

### ⑦. DEFAULT :

Press “Default” to clear all the setting and return to factory default.

### ⑧. MUTE and PAUSE :

Press “MUTE” to mute the sound and press “PAUSE” to pause the video.

### ⑨. OSD setup:

a. Press the “MENU” to enter the OSD menu and press “ UP” or “ DOWN” to select setting item and press “ ▶ ” RIGHT” to increase or “ ◀ ”LEFT” to decrease the “blue bar” to adjust the setting.

b. Press the “EXIT” to exit the menu and confirm the setting.

c. Press the “ENTER” to confirm the ID number setting.

### ⑩. ID and Number Key:

#### Step 1: Setup the Monitor ID No.

Press “MENU” to enter the OSD menu and press “ ▶ /+” button to select the “Function” menu and press “ DOWN” to choose “ID “ setup.

To press 4 digit (0001~9999) as the monitor ID No. and press “ENTER” to confirm the input. When you press the “ID” button, the screen will show “ ID : 0001 (when you input ” 0001”)



## Step 2: Control the monitor with ID No.

Press "ID" button, the screen will display the "ID NO.", input 4 same digit on "ID" and press "ENTER" to confirm the input. Then you can control the monitor.



### For example:

When you setup the Monitor "ID NO" is "0001", you press the "ID" button and input 0001 and press "ENTER" to confirm the input. You can control the monitor with ID No.0001 only. You are not able to control other monitors unless you setup all monitors ID No. is "0001" or the "ID" setup function is on "Off" status.

Notice !!!

Please don't setup the 4 digit No. as "0000", If you setup the Monitor ID No. as "0000", the ID function will be on "Off" status.

## 7. OSD Setup

### Picture (Video Mode)

1. Press the "Menu" key on the buttons to call out the OSD Menu. Press "▲/+" or "▼/-" to select "Picture" mode and press "Menu" key again to select the "Picture" option.
2. Various picture settings are available from the "Picture" menu. Use "▲/+" or "▼/-" to select item that you want to adjust and press "Menu" key again until grey bar changes to blue color and press "▲/+" or "▼/-" increase or decrease the figure that you wish. Press "Exit" key to return to menu and confirm the setting. Press two times of "Exit" to exit all the menu.



### Brightness

Press "▲/+" or "▼/-" to increase/decrease the "Blue bar" to adjust brightness. Adjusting brightness to enhance the level of dark area in the video picture such as night scenes and shadow scenes. Increasing brightness will make dark areas more visible.

### Contrast

Press "▲/+" or "▼/-" to increase/decrease the "Blue bar" to adjust contrast. Increasing contrast will make white area of the video picture brighter. Contrast works in conjunction with "Brightness".

### Backlight

Press "▲/+" or "▼/-" to increase/decrease the "Blue bar" to adjust backlight. Increasing the figure will enhance the backlight. Decreasing the figure will reduce backlight.

### Sharpness

Press "▲/+" or "▼/-" to increase/decrease the "Blue bar" to adjust sharpness. Using sharpness to adjust the detail enhancement to the video picture. Increasing the figure will enhance the edges of objects in the video picture. Decreasing the figure will reduce enhancement.

## Tint

Press “▲/+” or “▼/-“ to increase/decrease the “Blue bar” to adjust hue. Using hue to adjust the color of flesh tones. Increasing figure will make the picture with more red in appearance. Decreasing figure will shift the picture with more green in appearance.

## Saturation

Press “▲/+” or “▼/-“ to increase/decrease the “Blue bar” to adjust color saturation. Increasing color figure will make the color more intense. Reducing color figure will make the color less intense.

## Color Temp.

Select the Color Temp.” for white balance. Press “Menu” to enter “OK” mode. There are six settings to choose from (1)Standard (2). Cold (3).Warm (4) User. To select “User” you may press “▲/+” or “▼/-“ to increase/decrease the “Blue bar” to adjust color of Red, Green and Blue.

## Sound (Video Mode)

1. Press the “Menu” key on the buttons to call out the OSD “Menu” .Press “▲/+” or “▼/-“ to select “Sound” option and press “Menu” key again to select the “Sound” mode. There are 2 sound modes to choose from (1) Standard (2) User.
2. To select “User” you may press “▲/+” or “▼/-“ to select item that you want to adjust



## Bass

Press “▲/+” or “▼/-“ to increase/decrease the “Blue bar” to enhance the bass or reduce the bass.

## Treble

Press “▲/+” or “▼/-“ to increase/decrease the “Blue bar” to increase the treble or reduce the treble.

## Balance

Press “▲/+” or “▼/-“ to increase/decrease the “Blue bar” to enhance right speaker or enhance the left speaker. Put the figure on “0” will keep the balance of right speaker and left speaker.

## Speaker Enhance

Press “▲/+” or “▼/-“ to switch On or switch Off the speaker enhancement.

## Volmue

Just press “▲/+” or “▼/-“ to increase/decrease the “Blue bar” to adjust volume when “OSD” Menu is Off mode.

## PIP (Video Mode)

Press the “Menu” key on the buttons to call out the OSD “Menu” . Press “▲/+” or “▼/-“ to select “PIP” mode and press “Menu” key again to select the “PIP” option.



### Sub Source

Press the "Menu" key to enter the Sub Source and press "▲/+" or "▼/-" to select PC as the sub-screen .

### Sub Size

Press the "Menu" key to enter the Sub Size and press "▲/+" or "▼/-" to select the size of sub-screen . There are 4 size to select (1).Small (2).Medium (3).Large (4) PBP or select Off to close PIP setting.

### Swat

Press "▲/+" or "▼/-" key to enter the Swat and press "Enter" to activate "OK" and swat the main screen and sub-screen.

### Sub Position

Press the "Menu" key to enter the Sub Position and press "▲/+" or "▼/-" to select 0~4 as the position of sub-screen 0 : Top left 1: Bottom left 2: Central 3: Top right 4: Bottom right

## Display (Video Mode)

Press the "Menu" key on the buttons to call out the OSD "Menu" . Press "▲/+" or "▼/-" to select "Display" mode and press "Menu" key again to select the "Display" option.



### H-Position

Use to change horizontal position of the picture. You may press "▲/+" or "▼/-" key to select "H-Position" and press "▲/+" key to increase "Blue bar" to shift the picture to right or press "▼/-" to decrease "Blue bar" to shift the picture to left.

### V-Position

Use to change vertical position of the picture. You may press "▲/+" or "▼/-" key to select "V-Position" and press "▲/+" key to increase "Blue bar" to shift the picture up or press "▼/-" to decrease "Blue bar" to shift the picture down.

### Image Ratio (Video mode)

In order to meet different applications in video output, there are 5 image ratio to choose (1) 4:3 Full (2) 16:9 Full (3). 4:3 Over-1 (4). 16:9 Over-1 (5). 4:3 Over-2. Press "▲/+" or "▼/-" key to select the format ratio you want.

#### 1. 4:3 Full

The 9.7" panel is 4:3 format, this mode will make the image fully fills up the screen on both "Vertical" and "Horizontal" lines when you connect to DVR and Camera.

#### 2. 16:9 Full

This mode just zoom out the 4:3 Full format to provide a 16:9 format to display 16:9 signal .

### 3. 4:3 Over-1

The format is over scan mode to make the image fill up the screen and cut about 2% on “Vertical” and 2% on “Horizontal” lines..

### 4. 16:9 Over-1

This mode just zoom out the 4:3 Over-1 format to provide a 16:9 format to display 16:9 signal .

12

### 5. 4:3 Over-2

The format is over scan mode to make the image fill up the screen and cut about 4% on “Vertical” and 4% on “Horizontal” lines

## Image Optimize

Select the “ Image Optimize” for best image setting. Press “Menu” to enter “OK” mode. To select DNR (Dynamic Noise Reduction), the DNR will reduce the noise level and improve the video quality. There are four levels to select (1) Low (2) Medium (3) High (4) Off. Press “▲/+” or “▼/-“ key to select the level.

## Function (Video Mode)

Press the “Menu” key on the buttons to call out the OSD “Menu” . Press “▲/+” or “▼/-“ to select “Function” mode and press “Menu” key again to select the “Function” option.



## Language

The default language is English, you may press the “Enter” key and press “▲/+” or “▼/-“ key to select language you want. There are 6 languages to select (1) English (2) French (3) Germany (4) Spanish (5) Italian (6).Chinese

## OSD Time

If you want the OSD Menu to stay longer on the screen, you may press “▲/+” or “▼/-“ key to select “OSD Time” and press “Enter” key to adjust the time , it can be adjusted from 5 second to 60 second.

## OSD Blend

If you want to change the background color of OSD Menu, you may press “▲/+” or “▼/-“ key to select “ Background color” . Press “Enter” key and press “▲/+” or “▼/-“ key to increase/decrease the “Blue bar”, the color will change from light blue to dark blue.

## Sleep Time

The function will make the monitor in sleep mode to save the power when monitor is in standby mode. To press “Enter” to enter the option and press “▲/+” or “▼/-“ key again to select (1). 10 Min (2). 20 Min. (3).30 Min (4). 60 Min (5).90 Min (6).120 Min (7).150 (8).180 (9) Off. To select 10 Min that means the monitor will enter sleep mode when monitor is in standby mode for more than 10 Min. The other time options are the same rule.

## Anti Burn-in

The function can prevent the LCD panel from burn-in when camera or DVR is always displaying the same picture source at all times. Press “▲/+” or “▼/-“ key to select “ Anti Burn-in” and press “Enter” to enter the option and press “▲/+” or “▼/-“ key again to select (1). 30 Min (2). 60 Min. (3).90 Min (4).120 Min (5).150 Min (6).Off. To select 30 Min. the image will move left for one pixel for every 30 minutes, to select 60 Min, the image will move left for one pixel for every 60 minutes, the other options are the same regulation.

## ID

The ID function is only applicable for some specific models, if the model you brought has the ID function, Please check the ID setup procedure on page 9.

13

## Default

If you want to back to factory default, press “▲/+” or “▼/-“ key to select “ Default” “ and press “Enter” key to activate “OK”

## Exit

Press the “Menu” key and press “▲/+” or “▼/-“ to select “Exit” to exit the OSD menu.



## Picture (PC/VGA Mode)

1. Press the “Menu” key on the buttons to call out the OSD“Menu” . Press “▲/+” or “▼/-“ to select “Picture” Mode and press “Menu” key again to select the “Picture” option.
2. Various picture settings are available from the “Picture” menu. Use“▲/+” or “▼/-“ to select item that you want to adjust and press “Menu” key again until grey bar changes to blue color and press “▲/+” or “▼/-“ increase or decrease the figure that you wish . Press “Exit” key to return to menu and confirm the setting. Press two times of “Exit” to exit the menu.



## Brightness

Press“▲/+” or “▼/-“ to increase/decrease the “Blue bar” to adjust brightness. Adjusting brightness to enhance the level of dark area in the video picture such as night scenes and shadow scenes. Increasing brightness will make dark areas more visible.

## Contrast

Press “▲/+” or “▼/-“ to increase/decrease the “Blue bar” to adjust contrast. Increasing contrast will make white area of the video picture brighter. Contrast works in conjunction with “Brightness”.



## Backlight

Press “▲/+” or “▼/-“ to increase/decrease the “Blue bar” to adjust backlight. Increasing the figure will enhance the backlight. Decreasing the figure will reduce backlight.

## Color Temp.

Select the Color Temp.” for white balance. Press “Menu” to enter “OK” mode. There are 4 settings to choose from (1)Standard (2). Cold (3).Warm (4) User. To select “User” you may press “▲/+” or “▼/-“ to increase/decrease the “Blue bar” to adjust color of Red, Green and Blue.

14

## Sound (PC/VGA Mode)

The setup is the same as page No.11 for sound setup of “Video Mode”.



## PIP (PC/VGA Mode)

The setup is the same as page No. 11 for PIP setup of “Video Mode”.

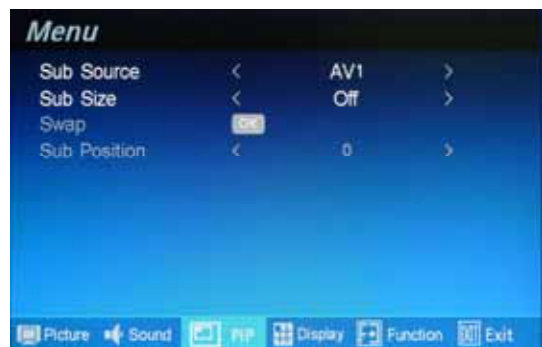

## Display (PC/VGA Mode)

Press the “Menu” key on the buttons to call out the OSD “Menu”. Press “▲/+” or “▼/-“ to select “Display” mode and press “Menu” key again to Select the “Display” option.



## H-Position

Use to change horizontal position of the picture. You may press “▲/+” or “▼/-“ key to select “H-Position” and press “▲/+” key to increase “Blue bar” to shift the picture to right or press “▼/-“ to decrease “Blue bar” to shift the picture to left.

## V-Position

Use to change vertical position of the picture. You may press “▲/+” or “▼/-” key to select “V-Position” and press “▲/+” key to increase “Blue bar” to shift the picture up or press “▼/-” to decrease “Blue bar” to shift the picture down.

### Image Ratio(PC/VGA Mode)

In order to meet different applications in video output, there are 2 image ratio to choose (1) 4:3 (2) 16:9 Press “▲/+” or “▼/-” key to select the ratio you want.

#### 1. 4:3

9.7” panel is 4:3 format, this mode to make the image fully fills up the screen on both “Vertical” and “Horizontal” lines.

#### 2. 16:9

This mode to make the format as 16:9 to support the 16:9 signal input from PC.

### Image Optimize

Select the “Image Optimize” for best image setting. Press “Menu” to enter “OK” mode. To select the Auto Color, The monitor will auto fine-tune the color as default.

### Phase

Use phase to fine-tune the monitor to perfectly ADC clock phase synchronize to the video signal source under RGB mode. Press “▲/+” or “▼/-” to increase/decrease the “Blue bar” to adjust the Phase.

### Clock

Use Clock to fine-tune the monitor when phase value is wrong. Press “▲/+” or “▼/-” to increase/decrease the “Blue bar” to adjust the Clock..

### Auto Adjust

Use “Auto Adjust” to fine-tune the display to perfectly synchronize to the video signal source under RGB mode. Press “Menu” to enter “OK” mode to activate the Auto Adjust function.

### Function (PC/VGA Mode)

The setup is the same as page 12 for Function adjustment of “Video Mode”.



### Exit

Press the “Menu” key and press “▲/+” or “▼/-” to select “Exit” to exit the OSD menu.



## 8. Troubleshooting Guide

---

When you experience issues with the CCTV LCD Monitor , before contacting your retailer where you made your purchase, please check the following items. The most common issue is with the connection of AV equipment or graphic card. We recommend that at the same time of troubleshooting, also refer to the AV equipment or graphic card user manual. Please do not use a higher refresh rate than the maximum specified by the CCTV LCD Monitor.

Issue	Troubleshooting
<b>No image appears on the LCD Monitor screen</b>	Check if the computer or AV equipment power cord is securely connected to the wall socket, or to the extension cord. Check if the LCD Monitor power switch is at the “on” position and the LED on the front of LCD Monitor is in still green. Check if the computer or AV equipment video (signal) cables are properly secured.
<b>Abnormal image</b>	Check and make sure the computer or AV equipment video (signal) cables are properly and securely connected to the sockets on back of the LCD Monitor.
<b>Abnormal image colors on the screen</b>	Check and make sure the LCD Monitor video (signal) cables are properly and securely connected to the D-Sub, BNC, RCA sockets on back of the computer.
<b>Interference appearing on the screen</b>	Please refer to Chapter “Function” to check if there is any improper adjustment or setting.
<b>Can only hear audio, but no image on the screen</b>	Please make sure both video inputs are properly connected (BNC /RCA/ /S-Video and D-Sub).
<b>Can only see video, but no audio</b>	Please make sure both audio inputs are properly connected, the audio input plugs are RCA and Ø 3.5mm audio line-in. Check if the volume is at the lowest level.



## 9. Applicable Video Timing for PC- analog Video

---

The following table list are the better display quality modes for analogy signal (PC) supported by this LCD monitor. The LCD monitor will stop working or has poor picture quality when other modes out of below list input.

**D-sub Mode timing :**

Mode	Resolution	Refresh Rate (Hz)	Horizontal	Vertical	Nominal Pixel Clock (MHz)
			Nominal Frequency +/- 0.5 kHz	Nominal Frequency +/- 1 Hz	
DOS	720*400	70	31.469	70.087	28.322
VGA	640*480	60	31.469	59.940	25.175
	640*480	72	37.861	72.809	31.500
	640*480	75	37.500	75.000	31.500
SVGA	800*600	56	35.156	56.250	36.000
	800*600	60	37.879	60.017	40.000
	800*600	72	48.077	72.188	50.000
	800*600	75	46.875	75.000	49.500
XGA	1024*768	60	48.363	60.004	65.000
	1024*768	70	56.476	70.069	75.000
	1024*768	75	60.023	75.029	78.750
XGA+	1152x864	75	67.500	75.000	108.000
SXGA	1280*1024	60	63.981	60.020	108.00
	1280*1024	75	79.976	75.025	135.00
	1360*768	60	47.712	60.015	85.500
	1280*720	60	45.000	60.000	74.250
	1920*1080	60	67.500	60.000	148.500

Note : 1360 x 768 for D-sub mode only

# 10. Technical Data

<b>Model</b>	<b>EL-97MA1RE</b>	
<b>System</b>		
Panel Size	9.7" LCD (LED Backlight)	
Resolution	1024 x 768	
Pixel Pitch (H xV)	0.192(H) x 0.1924(V)	
Contrast Ratio	600:1	
Luminance	200 cd/m <sup>2</sup>	
Aspect Ratio	4:3	
Response Time	Tr+Tf=35 ms	
Video Signal	Analog RGB Signal , composite signal 1.0Vpp/75 ohm, Y:1Vp-p, C:0.3Vp-p	
Video Color System	NTSC/PAL auto detection switch	
Scan Frequency	H:31K~81KHz, V:56~75Hz	
<b>Operation Interfaces</b>		
Front Panel Controls	Menu/Enter, Power,+/- ,Source/Exit	
OSD Control	Yes	
OSD Language	English, Francais, Deutsch, Espanol, Italiano,Russian,Chinese(7)	
<b>Input / Output Connector</b>		
Input Connector	D-sub(VGA)	x 1
	S-Video	x 1
	Video Input(BNC Jack)	x 1
	RCA Audio (R+L)	x 1 sets
	PC Audio Input (Ø3.5 Jack)	x 1
	Power Input (DC 12V, 5A)	x 1
Output Connector	Video Output(BNC) x 1	
<b>Mechanical &amp; Electrical Design</b>		
PIP & PBP	Yes	
Video Output Looping	Yes	
3D Comb Filter	Yes	
De-Interlace	Yes	
Power Failure Auto Recovery	Yes	
Anti Burn-in	Yes	
Digital Noise Reduction	Yes	
Pro 5 Image Ratio	Yes	
VESA Mounting	100 x 100 mm	
Front Bezel Material	Metal	
Back Cabinet Material	Metal	
Stand Material	Metal	
Speaker Output	2W x 2	
Power Input	DC12V, 5A	
Power Consumption	15W(Max)	
Working Temperature	5~+40	
Working Humidity	20% ~ 85%RH	
Unit Dimension(WxHxD)	259 x 221 x 89 mm	
Packing Dimension(WxHxD)	390 x 403 x 178 mm	
Net Weight	1.88Kg	
Gross Weight	3.7Kg	
Regulatory	CE,FCC,RoHS	
Color	Black	
<b>Accessory</b>		
Power Cable	1	
Power Adaptor	1	
D-Sub (VGA) Cable	1	
3.5mm audio Cable	1	
User Manual (CD)	1	