

SM-200/SM-300 Marine Audio Housing for MP-3 Player and iPhone/iTouch/iPod

Installation Manual

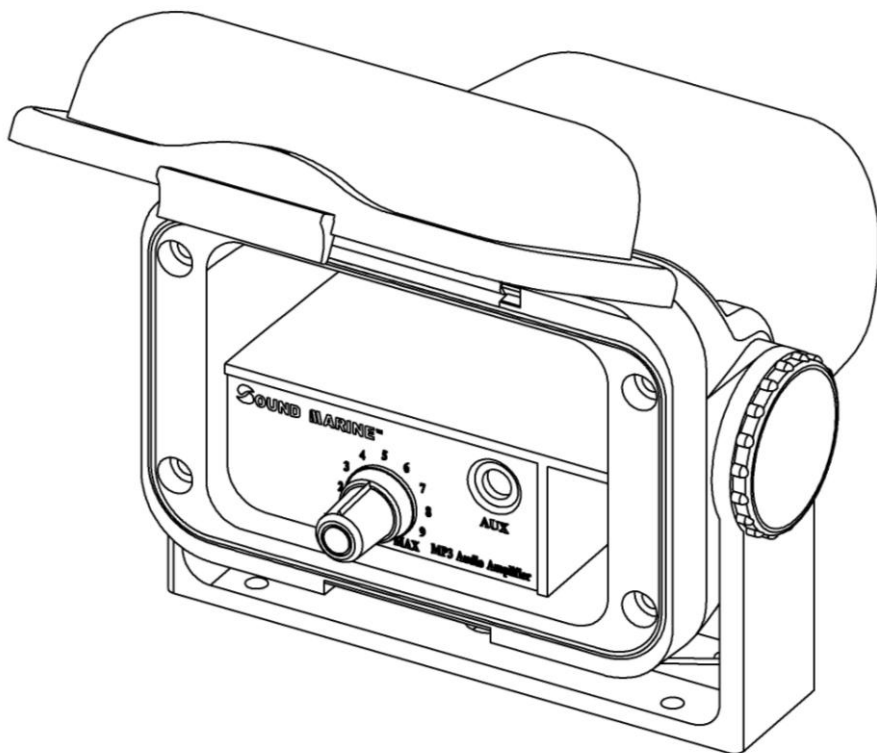

Contents

Introduction	1
Applications	1
Safety Precaution	1
Specification	2
Parts list	2
Select the best location for mounting	3
Installation Manual	3

1. Introduction

The SM-200 and SM-300 are designed to provide the maximum waterproof protection to your audio/MP-3 player. The housings are compatible with most of the audio devices with a 3.5mm plug and they are intended for use in a marine environment. There is a built-in microphone which would allow you to have a voice conversation while still the front cover is down. The housings are designed to be waterproof with IP 65 rating. However, direct submersion of the housing under water may induce damage to the unit and your audio/MP-3 player.

Keep the front cover down to provide the maximum protection. After any user operation, close the front cover and ensure the seal is complete. The unit will provide protection against splashes of water, dust, sand and other substances.

2. Applications

SM-200 and SM-300 are built to withstand tough challenges in different outdoor / marine environments. They can be installed at locations with high humidity and high chance of water splashes (SPA room, sauna, swimming pool, etc). Vehicles suitable for SM-200/SM-300 installation include:

- | | |
|-----------------------------|------------------------------|
| ➤ Motorbike | ➤ Utility task vehicle (UTV) |
| ➤ Personal watercraft (PWC) | ➤ Golf car |
| ➤ All terrain vehicle (ATV) | ➤ Recreational vehicle (RV) |
| ➤ Snowmobile | ➤ Watercraft / boat |

3. Safety Precaution

- Read the manual before installation. It contains important information for all users.
- Turn off the electricity supply before beginning the installation
- For electric drill, ensure it is connected to the ground properly and the area is free of any liquid.
- If any problem occurs during the installation, please contact your local dealer for advice before proceeding. Contract professionals if necessary.

4. Specification

- Waterproof Amplifier Audio Housing for iPod/iPhone/MP3 player
- Small and deft design for multiple applications as motorcycle
- Waterproof and corrosion-proof plastic housing and bracket
- Waterproof fuse holder
- Adjustable ON/OFF volume control
- AUX 3.5 mm jack
- Handsfree mini MIC for iPhone
- Accessories : 4 pins 3.5 plug cable, stainless hardware, packing/gasket, U-type bracket and thumbwheel screws
- 600 hrs UV Stabilized(ASTM D4329 & ASTM D2244)
- 400 hrs Saltwater Spray Test (ASTM B117)
- IP 65 Rating
- RoHS confirmed
- CE Certificate
- FCC Certificate
- Power supply : 13.8V / DC 12V
- Max power handling : 40W
- Impedance : 4 ohms
- Frequency response : 20Hz – 20K Hz

5. Parts List

Please check the parts and their quantity before installing SM-200 / SM-300. Contact your local dealer if anything is missing as soon as possible.

<i>Item</i>	<i>Qty</i>	<i>Description</i>
A	1	SM-200 audio housing
B	8	Mounting screw
C	1	Audio cable with 3.5mm 4-pin plugs
D	2	Thumbwheel screw
E	1	Housing holder
F	1	Bracket

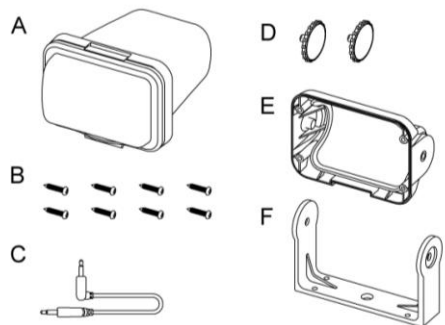

Table 1 lists all the parts included in the SM-200 package.

Figure 1. Parts of SM-200. (A) SM-200 audio housing (B) mounting screw $\times 8$ (C) audio cable with 3.5mm 4-pin plugs (D) thumbwheel screw $\times 2$ (E) housing holder (F) Bracket

<i>Item</i>	<i>Qty</i>	<i>Description</i>
A	1	SM-300 audio housing
B	4	Mounting screw
C	1	Gasket
D	1	Audio cable with 3.5mm 4-pin plugs

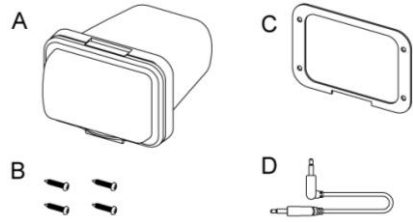

Figure 2. Parts of SM-300. (A) SM-300 audio housing (B) mounting screw ×4 (C) gasket (D) audio cable with 3.5mm 4-pin plugs

6. Select the best location for mounting

Be aware that SM-200 and SM-300 have different mounting styles and each follows a separate set of installation instructions. SM-200 is designed to stand on top of a strong surface (Figure 5); SM-300 is intended to be installed into a sturdy panel (Figure 6).

The surface/panel you select should have the appropriate strength to hold the unit firmly in place after installation. Apart from the strength, consider the effects of shock, vibration, shear pressure and movement in different directions have on the mounting surface/panel. If the surface is not sturdy enough, the housing may be dislocated from its original position and it may be damaged. If you are uncertain about the location of your choice, contact the local dealer for advice.

7. Installation Manual

Read the following installation manual carefully before proceeding. If you are unfamiliar with wiring electronic devices, consult your local dealer or contract professionals. False wiring could damage the amplifier and the rest of audio system.

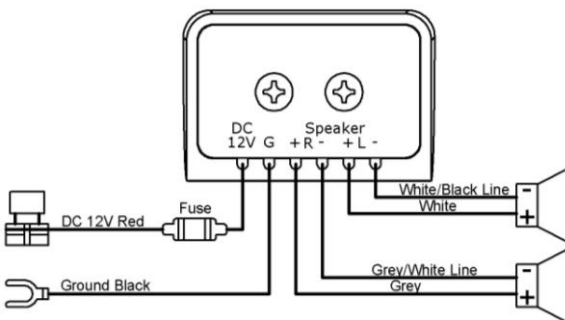

Figure 3. Wiring diagram of SM-200 / SM-300. Connect the red and the black wires to DC 12V the main power supply and ground respectively. Connect the other wires to the speakers according to the wiring plan. Connect the grey wire to the positive terminal and the grey/white wire to the negative terminal of the right speaker. Connect the white wire to the positive terminal and the white/black wire to the negative terminal of the right speaker.

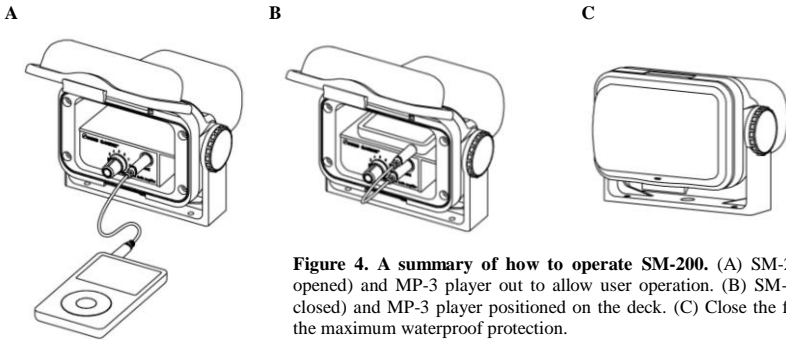

Figure 4. A summary of how to operate SM-200. (A) SM-200 unit (front cover opened) and MP-3 player out to allow user operation. (B) SM-200 unit (front cover closed) and MP-3 player positioned on the deck. (C) Close the front cover to provide the maximum waterproof protection.

SM-200 installation manual

Step 1 – Install the mounting bracket to the mounting surface

- 1) Using the mounting bracket as a template, mark four holes to mount the bracket.
 - 2) Drill the holes using a 1/6" / 3.2mm drill bit.
 - 3) Hold the bracket against the mounting surface. Insert and tighten four mounting screws until the bracket is securely mounted.
- If you are in doubt with the stability of the mounting surface, please consult your local dealer.

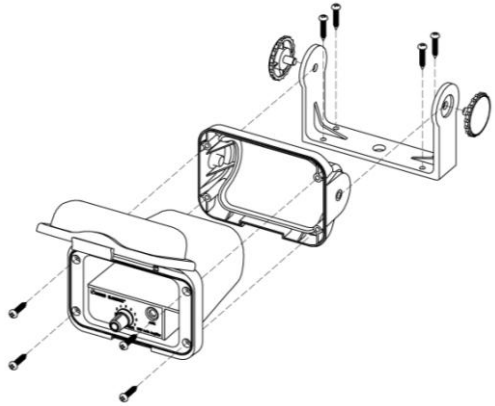

Figure 5. A summary of SM-200 installation.

Step 2– Assemble SM-200 audio housing unit with the holder

Insert the housing unit into the housing holder and hold them firmly together. Insert and tighten four mounting screws via the holes on the front panel of the housing unit as shown in Figure 5.

Step 3 – Assemble SM-200 audio housing unit with its bracket

Align the housing holder with the holes in the mounting bracket as demonstrated in Figure 5. Insert and tighten the thumbwheel screw into the housing unit.

Step 4 – Wire SM-200 unit to the main power supply and speakers

Identify each color-coded wire and connect each wire to the corresponding terminal as instructed in Figure 3. Finally use cable ties to secure the wires out of harms way to complete the installation.

SM-300 installation manual

Step 1 – Prepare the mounting surface for SM-300 installation

- 1) Using the gasket as a template, mark the positions of the four screw holes plus the hole used to insert the housing on the mounting surface.
- 2) Cut out the surface marked for housing insertion.
- 3) Drill the holes using a 1/6" / 3.2mm drill bit.

If you are in doubt with the stability of the mounting surface, please consult your local dealer.

Step 2 – Position the gasket into the back of SM-300 unit

The groove can be found on the back of the audio housing unit. Trace the groove with the gasket and align the gasket with the holes on the front panel of the housing unit as shown in Figure 6.

Step 3 – Connect the wires to the corresponding terminals

Identify each color-coded wire and connect each wire to the corresponding terminal as instructed in Figure 3.

Step 4 – secure the housing unit on the mounting surface

Align the housing unit with the holes on the mounting surface as shown in Figure 6. Insert and tighten the mounting screws into the mounting surface to complete the installation.

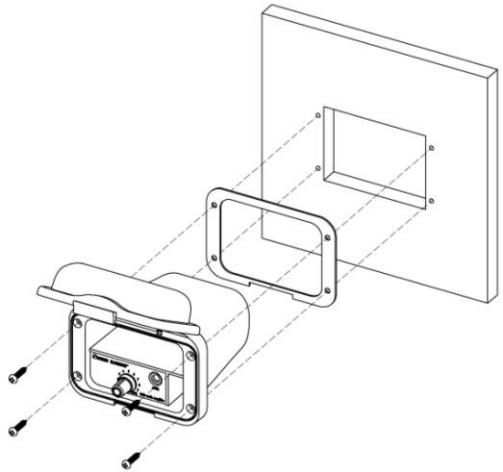

Figure 6. A summary of SM-300 installation.

Greness Enterprise Co., Ltd.

1F, 19-1. Lane39. Sec2. Jianguo South Road, Taipei, Taiwan, R.O.C

TEL: +886-2-2707-5741 FAX: +886-2-2707-4992

Website: www.greness.com.tw

©Copyright 2011 Greness Enterprise Co., Ltd. All rights reserved.,

All content subjects to modification without notice.