

Waterproof Marine Audio Kit for MP-3 Player and iPhone/iTouch/iPod

Installation Manual

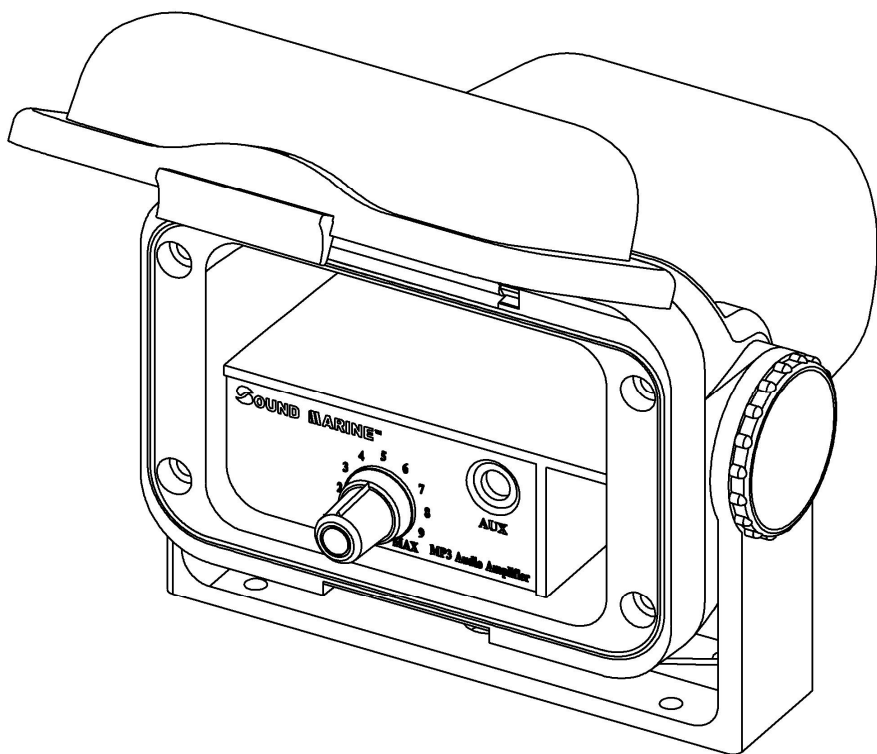

Contents

Introduction1
Applications1
Safety precaution1
Specification2
Parts list2
Select the best location for mounting3
Amplifier installation manual3
Loudspeaker installation manual6

1. Introduction

The SM-200 and SM-300 are designed to provide the maximum waterproof protection to your audio/MP-3 player. The housings are compatible with most of the audio devices with a 3.5mm plug and they are intended for use in a marine environment. There is a built-in microphone which would allow you to have a voice conversation while still the front cover is down. The housings are designed to be waterproof with IP 65 rating. However, direct submersion of the housing under water may induce damage to the unit and your audio/MP-3 player.

Keep the front cover down to provide the maximum protection. After any user operation, close the front cover and ensure the seal is complete. The unit will provide protection against splashes of water, dust, sand and other substances.

2. Applications

SM-200 and SM-300 are built to withstand tough challenges in different outdoor / marine environments. They can be installed at locations with high humidity and high chance of water splashes (SPA room, sauna, swimming pool, etc). Vehicles suitable for SM-200/SM-300 installation include:

- Motorbike
- Personal watercraft (PWC)
- All terrain vehicle (ATV)
- Snowmobile
- Utility task vehicle (UTV)
- Golf car
- Recreational vehicle (RV)
- Watercraft / boat

3. Safety Precaution

- Read the manual before installation. It contains important information for all users.
- Turn off the electricity supply before beginning the installation
- For electric drill, ensure it is connected to the ground properly and the area is free of any liquid.
- If any problem occurs during the installation, please contact your local dealer for advice before proceeding. Contract professionals if necessary.

4. Specification

- Waterproof Amplifier Audio Housing for iPod/iPhone/MP3 player
- Small and deft design for multiple applications as motorcycle
- Waterproof and corrosion-proof plastic housing and bracket
- Waterproof fuse holder
- Adjustable ON/OFF volume control
- AUX 3.5 mm jack
- Handsfree mini MIC for iPhone
- Accessories : 4 pins 3.5 plug cable, stainless hardware, packing/gasket, U-type bracket and thumbwheel screws
- 600 hrs UV stabilized (ASTM D4329 & ASTM D2244)
- 400 hrs Saltwater Spray Test (ASTM B117)
- IP 65 Rating
- RoHS confirmed
- Power supply : 13.8V / DC 12V
- Max power handling : 30W
- Impedance : 4 ohms
- Frequency response : 20Hz – 20kHz

5. Audio Housing Parts List

Please check the parts and their quantity before installing SM-200 / SM-300. Contact your local dealer if anything is missing as soon as possible.

<i>Item</i>	<i>Qty</i>	<i>Description</i>
A	1	SM-200 audio housing
B	8	Mounting screw
C	1	Audio cable with 3.5mm 4-pin plugs
D	2	Thumbwheel screw
E	1	Housing holder
F	1	Bracket

Table 1 lists all the parts included in the SM-200 package.

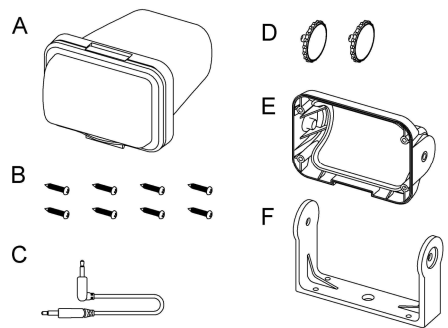

Figure 1. Parts of SM-200. (A) SM-200 audio housing (B) mounting screw ×8 (C) audio cable with 3.5mm 4-pin plugs (D) thumbwheel screw ×2 (E) housing holder (F) Bracket

<i>Item</i>	<i>Qty</i>	<i>Description</i>
A	1	SM-300 audio housing
B	4	Mounting screw
C	1	Gasket
D	1	Audio cable with 3.5mm 4-pin plugs

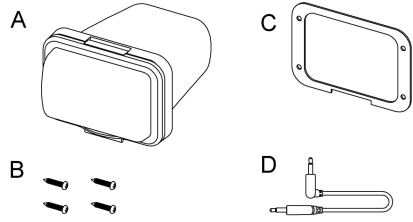

Table 2 lists all the parts included in the SM-300 package.

Figure 2. Parts of SM-300. (A) SM-300 audio housing (B) mounting screw ×4 (C) gasket (D) audio cable with 3.5mm 4-pin plugs

6. Select the best location for mounting

Be aware that SM-200 and SM-300 have different mounting styles and each follows a separate set of installation instructions. SM-200 is designed to stand on top of a strong surface (Figure 5); SM-300 is intended to be installed into a sturdy panel (Figure 6).

The surface/panel you select should have the appropriate strength to hold the unit firmly in place after installation. Apart from the strength, consider the effects of shock, vibration, shear pressure and movement in different directions have on the mounting surface/panel. If the surface is not sturdy enough, the housing may be dislocated from its original position and it may be damaged. If you are uncertain about the location of your choice, contact the local dealer for advice.

7. Amplifier Installation Manual

Read the following installation manual carefully before proceeding. If you are unfamiliar with wiring electronic devices, consult your local dealer or contract professionals. False wiring could damage the amplifier and the rest of audio system.

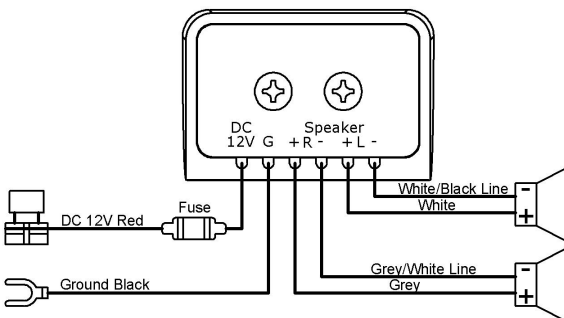

Figure 3. Wiring diagram of SM-200 / SM-300. Connect the red and the black wires to DC 12V the main power supply and ground respectively. Connect the other wires to the speakers according to the wiring plan. Connect the grey wire to the positive terminal and the grey/white wire to the negative terminal of the right speaker. Connect the white wire to the positive terminal and the white/black wire to the negative terminal of the right speaker.

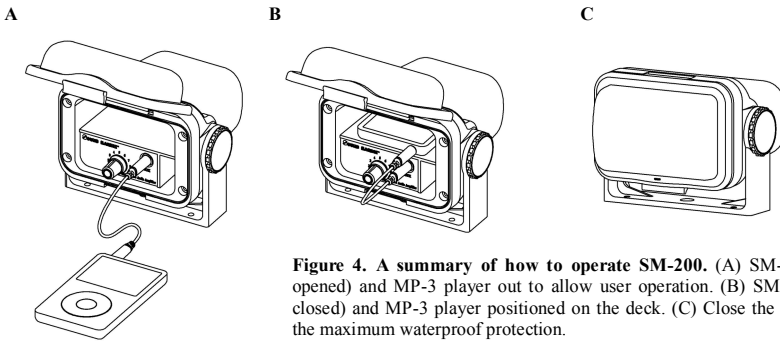

Figure 4. A summary of how to operate SM-200. (A) SM-200 unit (front cover opened) and MP-3 player out to allow user operation. (B) SM-200 unit (front cover closed) and MP-3 player positioned on the deck. (C) Close the front cover to provide the maximum waterproof protection.

In-dash installation manual

Step 1 – Install the mounting bracket to the mounting surface

- 1) Using the mounting bracket as a template, mark four holes to mount the bracket.
 - 2) Drill the holes using a 1/6" / 3.2mm drill bit.
 - 3) Hold the bracket against the mounting surface. Insert and tighten four mounting screws until the bracket is securely mounted.
- If you are in doubt with the stability of the mounting surface, please consult your local dealer.

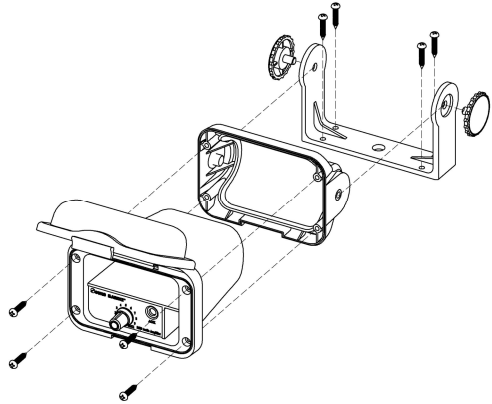

Figure 5. A summary of SM-200 installation.

Step 2– Assemble SM-200 audio housing unit with the holder

Insert the housing unit into the housing holder and hold them firmly together. Insert and tighten four mounting screws via the holes on the front panel of the housing unit as shown in Figure 5.

Step 3 – Assemble SM-200 audio housing unit with its bracket

Align the housing holder with the holes in the mounting bracket as demonstrated in Figure 5. Insert and tighten the thumbwheel screw into the housing unit.

Step 4 – Wire SM-200 unit to the main power supply and speakers

Identify each color-coded wire and connect each wire to the corresponding terminal as instructed in Figure 3. Finally use cable ties to secure the wires out of harms way to complete the installation.

Surface installation manual

Step 1 – Prepare the mounting surface for SM-300 installation

- 1) Ensure the mounting location has a minimum of 120 mm depth and is free of cables and fuel lines. Using the gasket as a template, mark the positions of the four screw holes plus the hole used to insert the housing on the mounting surface.
- 2) Cut out the surface marked for housing insertion.
- 3) Drill the holes using a 1/6" / 3.2mm drill bit.

If you are in doubt with the stability of the mounting surface, please consult your local dealer.

Step 2 – Position the gasket into the back of SM-300 unit

The groove can be found on the back of the audio housing unit. Trace the groove with the gasket and align the gasket with the holes on the front panel of the housing unit as shown in Figure 6.

Step 3 – Connect the wires to the corresponding terminals

Identify each color-coded wire and connect each wire to the corresponding terminal as instructed in Figure 3.

Step 4 – secure the housing unit on the mounting surface

Align the housing unit with the holes on the mounting surface as shown in Figure 6. Insert and tighten

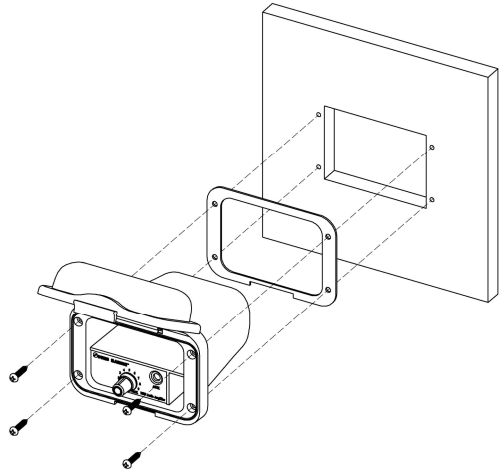

Figure 6. A summary of SM-300 installation.

8. Loudspeaker Installation Manual

Read the following installation manual carefully before proceeding. If you are unfamiliar with wiring electronic devices, consult your local dealer or contract professionals. False wiring could damage the amplifier and the rest of audio system.

Jet-engine speaker installation manual

- 1) Mount the plastic bracket on the chosen flat surface with the screws provided in the package
- 2) Hold the jet-engine speaker in position and secure the mounting with a screw and a nut
- 3) Adjust the projecting angle of the speaker and tighten the screw

If you are in doubt with the stability of the mounting surface, please consult your local dealer.

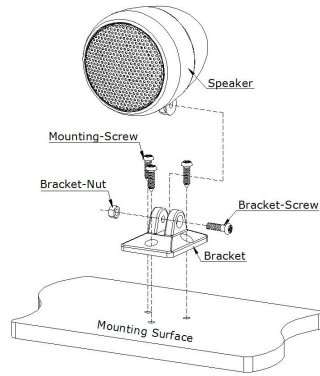

Flush-mount speaker installation manual

- 1) Select a mounting location which will allow the speaker to lay flat and has adequate space.
 - 2) Use the supplied template to mark the mounting holes. See Figure1.
 - 3) Drill a starter hole in the center of the mounting hole and use a hacksaw blade or a similar tool, cut the mount hole.
 - 4) Drill the four 1/8" mounting holes.
 - 5) Connect the speaker wire to the speaker terminals and route to stereo. Be sure stripe wire is connected to the positive (+) terminal of speaker. See Figure2.
 - 6) Slide the four U-Clips over the mounting holes and press to hold in place. See Figure3.
 - 7) Place a bead of RTV sealant (or equivalent) around the back rim of speaker basket.
 - 8) Secure the unit with provided screws for integrated speakers. Or for flush-mount speakers, tighten the screws to secure the unit first before fitting the cover grille onto the speaker.
- If you are in doubt with the stability of the mounting surface, please consult your local dealer.

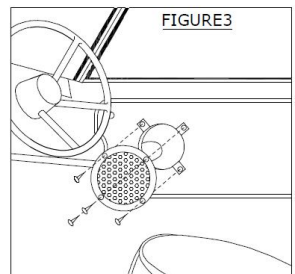
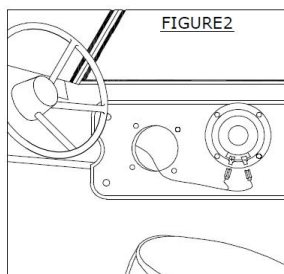
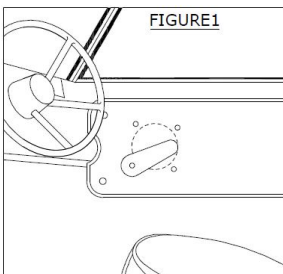

Greness Enterprise Co., Ltd.

1F, 19-1. Lane 39. Sec2. Jianguo South Road, Da' an Dist., Taipei, Taiwan, R.O.C

TEL: +886-2-2707-5741 FAX: +886-2-2707-4992

Website: www.greness.com.tw

©Copyright 2010 Greness Enterprise Co., Ltd. All rights reserved.

All content subjects to modification without notice.