

# Operating Instructions and Installation Instructions

Personal Hygiene System

Model: ***HI-6000 (Regular)***  
***HI-6001 (Elongated)***

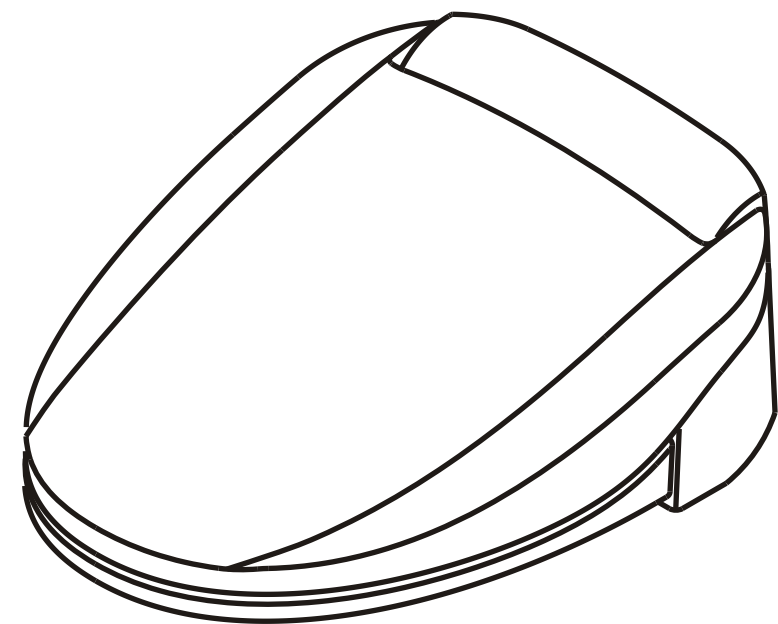

Read all operating and installation instructions before use.

# Contents

*Important Safeguards*..... 1  
*Grounding Instructions*..... 2  
*Precautions*..... 3-5  
*Unpack Your Electronic Bidet*..... 6-7  
*Installation Instructions*..... 8-9  
*Main Body Operations*..... 10  
*Remote Control Features*..... 11  
*Remote Control Operations*..... 12-13  
*Operation Notices*..... 14  
*Maintenance*..... 15-18  
*Troubleshooting* ..... 19  
*Specifications*..... 20

## !!!! IMPORTANT !!!!

**Warranty card must have serial number to be valid  
Serial number located on back panel**

Model No:

Serial No:

Date of Purchase:

Installer's Name/Phone:

Dealer's Name:

The serial number may be found on the name plate of the unit. You should note the model number and the serial number of this unit and retain this book as permanent record of your purchase for future reference.

# Specifications

Model No.		HI-6000 (Regular Type)	HI-6001 (Elongated Type)
Power Supply		AC120V , 60Hz	
Power Consumption		510W	
Power Cord Length		4ft.(1.2M)	
Water Feature	Warm Water Tank	870ml	
	Water Temperature	Adjustable in 4 steps; Room Temp./ 95°F(35°C)/ 99.5°F(37.5°C)/ 104°F(40°C)	
	Safety Devices	Thermal cutoff switch, float equipped w/stop valve and vacuum switch breaker	
	Water Flow	Adjustable in 5 steps; Approx. 0.3/min	
Heated Seat	Surface	Adjustable in 4 steps; Room Temp./ 93°F(34°C)/ 99°F(37.5°C)/ 104°F(40°C)	
	Power Consumption	60W	
	Safety Devices	Build-in Thermal cutoff	
Water Supply Pressure		10psi - 100psi	
Safety Devices		Ground fault detection circuit breaker, Seat switch	
Dryer	Dryer Temperature	Adjustable in 3 steps; 86°F(30°C) ~ 158°F(70°C)	
	Power Consumption	230W	
Net Weight		9.0lbs (4.1Kgs)	10.0lbs (4.5Kgs)

# Bidet Dimensions

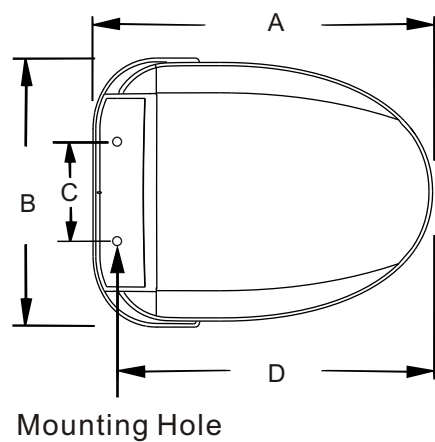

Model	HI-6000 (Regular Type)	HI-6001 (Elongated Type)
A	18-13/16" (478mm)	20" (508mm)
B	15-3/4" (400mm)	
C	5-1/2" ~ 6-11/16" (140 ~ 170mm)	
D	17-1/4" (438mm)	18-7/16" (468mm)

# Important Safeguards

This product is generally a safe system, having met or exceeded UL (Underwriters Laboratories) standards for safety. When using electrical products, especially in presence of children, safety precautions shall always be followed.

**Read all instructions before operating the system!**

**Danger!** To reduce the risk of electrical shock:

1. Do not use bidet while body is wet.
2. Remove power plug before retrieving fallen objects from the toilet.
3. Do not place or store product where it can fall or be pulled into a tub or sink.
4. Do not place in or drop into water or other liquid.
5. Do not reach for a product that has fallen into water. Unplug immediately.

**Warning!** To reduce the risk of burns, electrical shock, fire, or injury to users:

1. Supervise closely when product is operated by or near children or the mentally/ physically challenged.
2. Use the bidet ONLY for the intended use as described by this manual.
3. Immediately return to the manufacturer for examination/repair if any of the following occurs:
  - The unit has a damaged cord or plug.
  - The unit does not operate properly.
  - The unit is dropped on a hard surface.
  - The unit is dropped in water.
  - If power light is blinking.
4. Keep the cord away from hot surfaces.
5. Never block the air openings of the bidet or place it on a soft surface, when the air openings may be blocked. Keep the air opening free of lint, hair, and dirt.
6. Do not insert any object into openings or tubes of the system.
7. Do not operate outdoors.
8. Do not operate in vicinity of aerosol products or high purity oxygen.
9. Connect the bidet to a properly grounded outlet; UL approved **ground fault circuit interrupter receptacle** recommended (GFI)(See Grounding instructions).
10. Never use while sleeping or drowsy.
11. **Do Not Use Malfunctioning Product**  
Unplug unit from wall outlet and close the shut off valve if -
  - Water leaks develop
  - Unit develops strange odor or noise
  - Unit is hotter than normal
  - Unit is cracking
  - Unit is smoking
  - Using a malfunctioning unit may result in electrical shock, fire or water damage

# Grounding Instructions

This appliance is an electrical appliance connected to a water source.

## For products using power cords with integral grounding plugs:

This product must be grounded. In the event of an electrical short circuit, grounding reduces the risk of electric shock by providing an escape wire for the electric current. This bidet is equipped with a cord having a grounding wire with a grounding plug. The plug must be plugged into an outlet that is properly installed and grounded (GFI).

### **DANGER** Improper use of the grounding plug can result in a risk of electric shock.

If repair or replacement of the cord or plug is necessary, do not connect the grounding wire to either flat blade terminal. The wire with insulation having an outer coating that is green with or without yellow stripes is the grounding wire.

Check with a qualified electrician if the grounding instructions are not completely understood, or if in doubt as to whether the product is properly grounded.

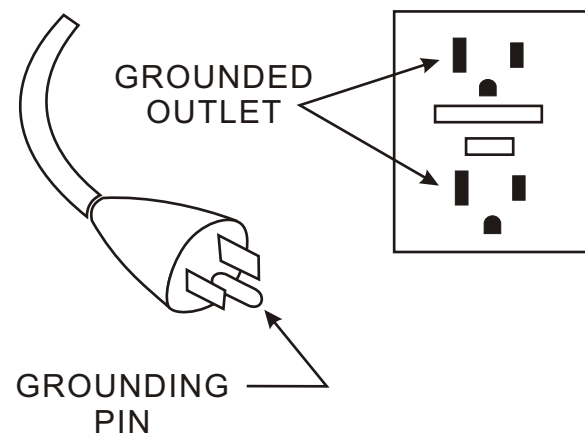

**For you safety**, this bidet has a built in GFI, it can be reset by removing the power cord plug from the wall mounted power receptacle, then plug it back in.

# Troubleshooting

Issue	Cause	Solution
Water Flow is low	Filter clogged with debris	Clean or replace filter
Nozzle wand cannot extend	1. Debris on side of nozzle wand	Clean nozzle wand and head
	2. Filter clogged with debris	Clean or replace filter
Nozzle extends 1/2 way out	Nozzle wand dirty	Clean nozzle wand and head
No front or back wash	Sitting too far forward	Sit to the center and back of the seat
Unit shuts off while washing	1. Wash more than 5 minutes	Restart wash function
	2. Power light off	Unplug unit and plug in unit after 15 seconds
Seat Temp. low	Insufficient warm up time	Preset seat temperature
Water temp low	1. Insufficient warm up time	Preset water temperature
	2. Washing more than 1 min.	Allow water tank to reheat
No function from remote	1. Transmitter covered	Uncover transmitter
	2. Battery power low (indicated on display)	Change batteries
	3. Positioned out of range	Change position of remote
Dryer problems	1. Temp too hot/cold	Adjust temperature
	2. Dryer cuts off	After 5 min. need to restart
	3. Dryer not working	Sit to the center and back of the seat
Deodorizer will not function	1. Carbon Cartridge dirty	Clean or replace filter
	2. Air intake holes dirty	Clean intake holes

**If the above do not help please contact customer service**

# Maintenance

## Removal of filter for cleaning

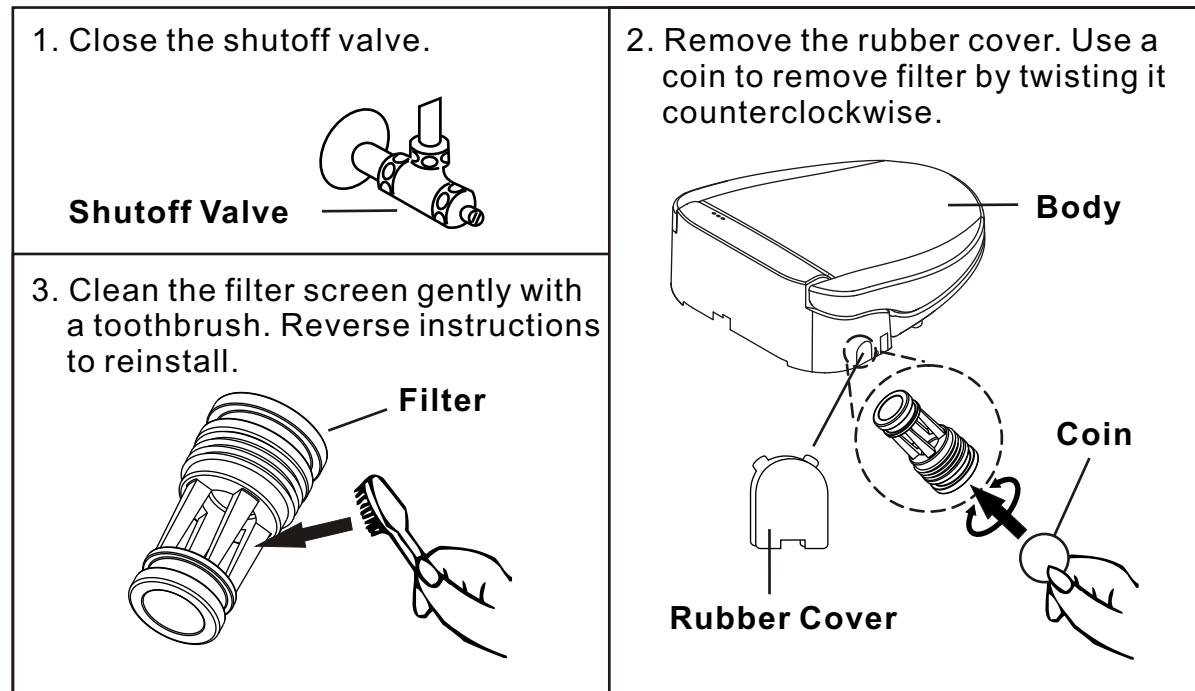

**Unplug power before servicing the bidet.**

### Procedure for draining long unused bidet seats (2 months or more)

- Option 1 (Power must be on)  
Push the Back Wash button and cover the black window by the power light to trip the occupied seat sensor. Allow the nozzle to spray. It will take about one minute to drain the old water (the system will automatically refill itself as the water sprays)
- Option 2  
Unplug the power and close the shut off valve  
Remove the drain plug on the bottom of the main body to drain. When water is completely drained, replace the drain plug. (See Figure below)  
Replace bidet

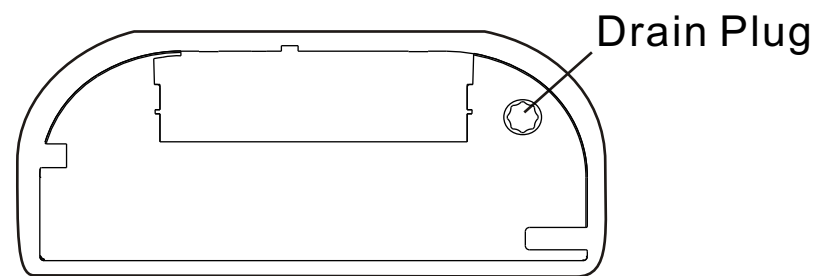

Bottom view of main body

# Precautions

To avoid electrical shock, fire, personal injury, please observe the following precautions:

1. Do not splash water on the system. (Fig. 1)

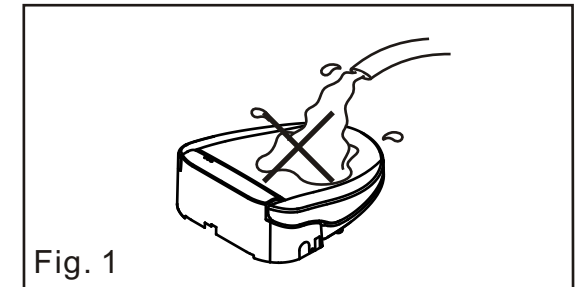

2. Do not immerse cord or plug in water. (Fig. 2)

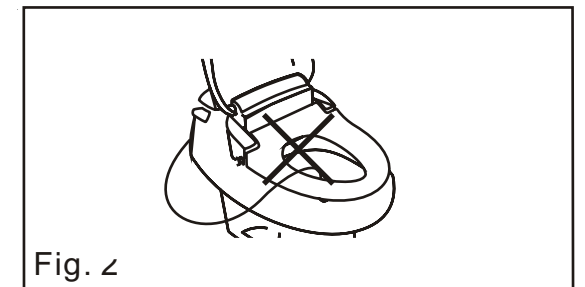

3. Do not slam the lid violently. (Fig. 3)

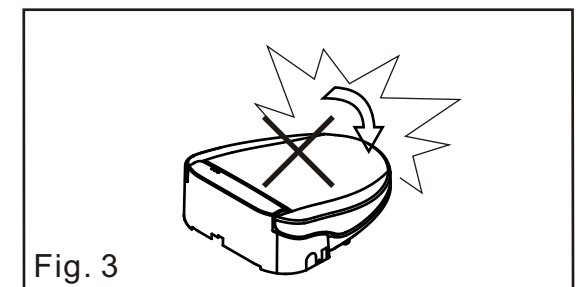

4. Do not step or sit on the lid.  
(this sector of the system is not designed to support a user's weight) (Fig. 4)



5. Do not use the lid as a back rest. (Fig. 5)

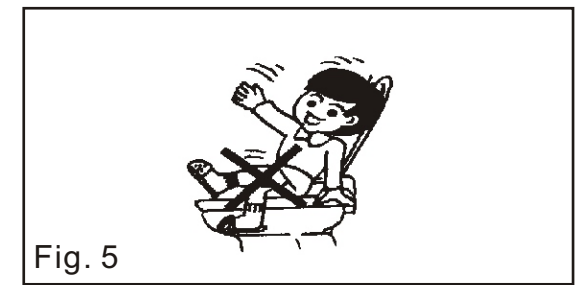

## Precautions

6. Set the seat temperature to "LOW" to prevent irritation/low temperature burn\* to sensitive skin. (Fig. 6)

\*Low temperature burn-Usually, a burn is caused by contact with a high temperature surface, however, sensitive skin( especially skin of someone in fragile physical state) can be burned when in contact with relatively low heated surfaces for long periods of time.

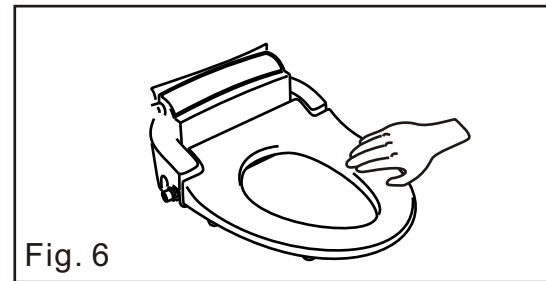

7. Do not cover heated seat as this may cause of the disruption of the temperature control mechanism. (Fig. 7)

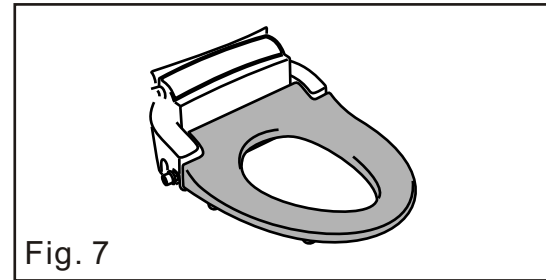

8. Unplug the unit, if the system is to be idle for long periods of time. (Fig. 8)

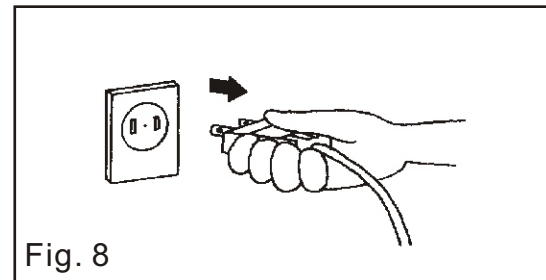

9. Drain water from the system if system is to be idle for long periods of time. (Fig. 9) (See page 18).

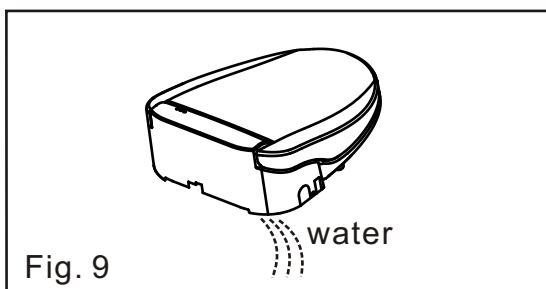

10. Do not allow water in the system to freeze. (Will NOT happen if system is powered) (Fig 10)

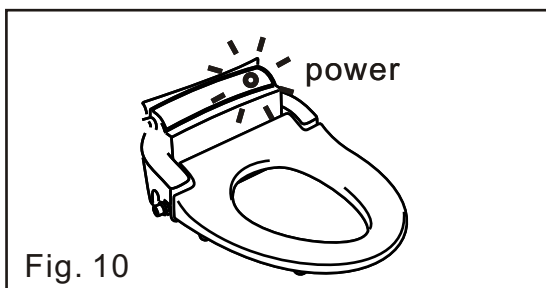

## Maintenance

### Removal of seat rim for cleaning

1. While seat rim is up, push up in the quick release lever.
2. Lift seat away from main body.
3. Swivel seat rim away from the main body to gain access for cleaning. Be sure not to pull on the wire running into the seat.
4. Reverse instructions to reinstall.

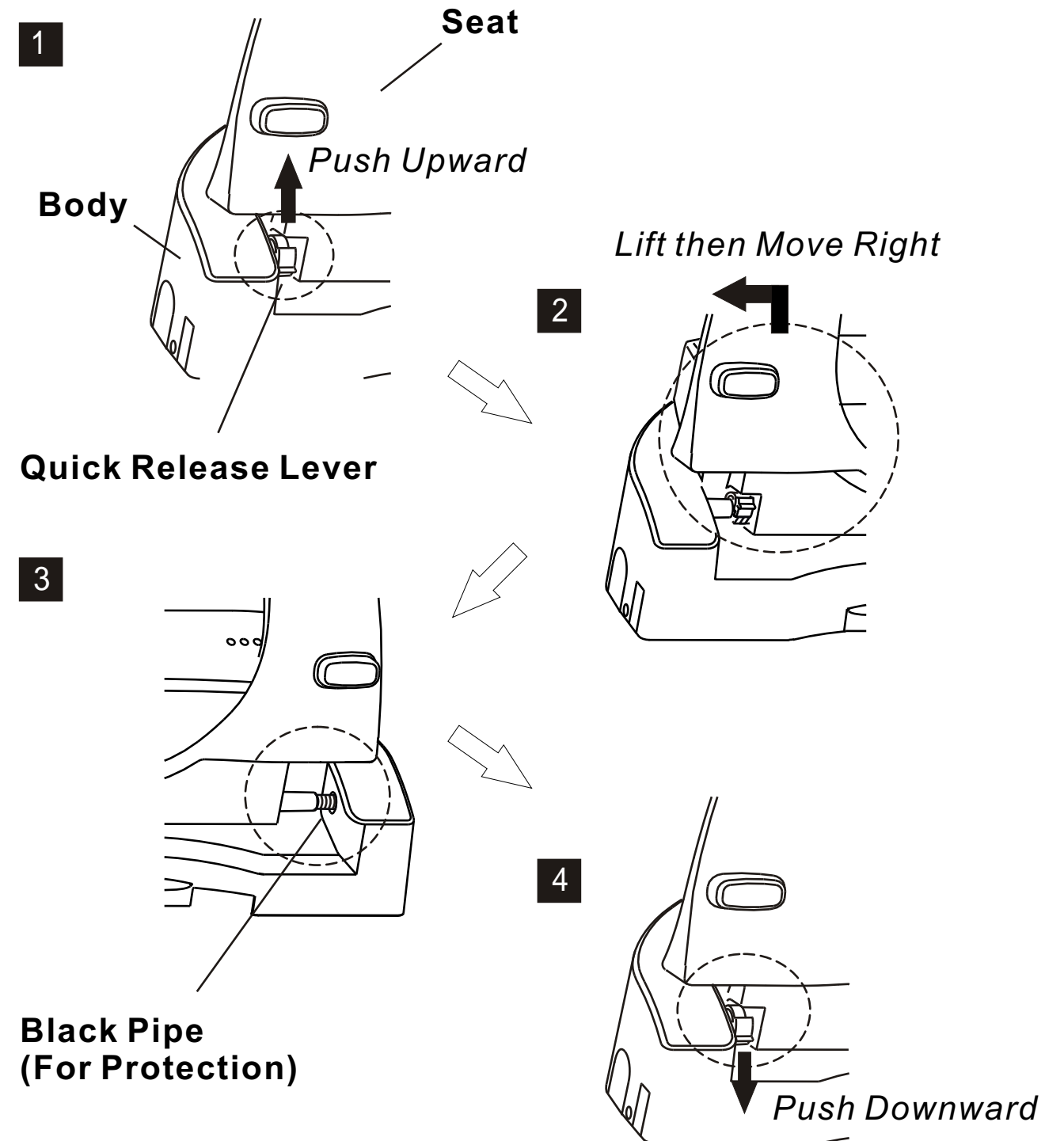

# Maintenance

## Removal of lid for cleaning

1. While lid is in the up position, push up on the quick release lever.
2. Push lid away from post.
3. Push lid assembly to the right.
4. Reverse to reinstall.

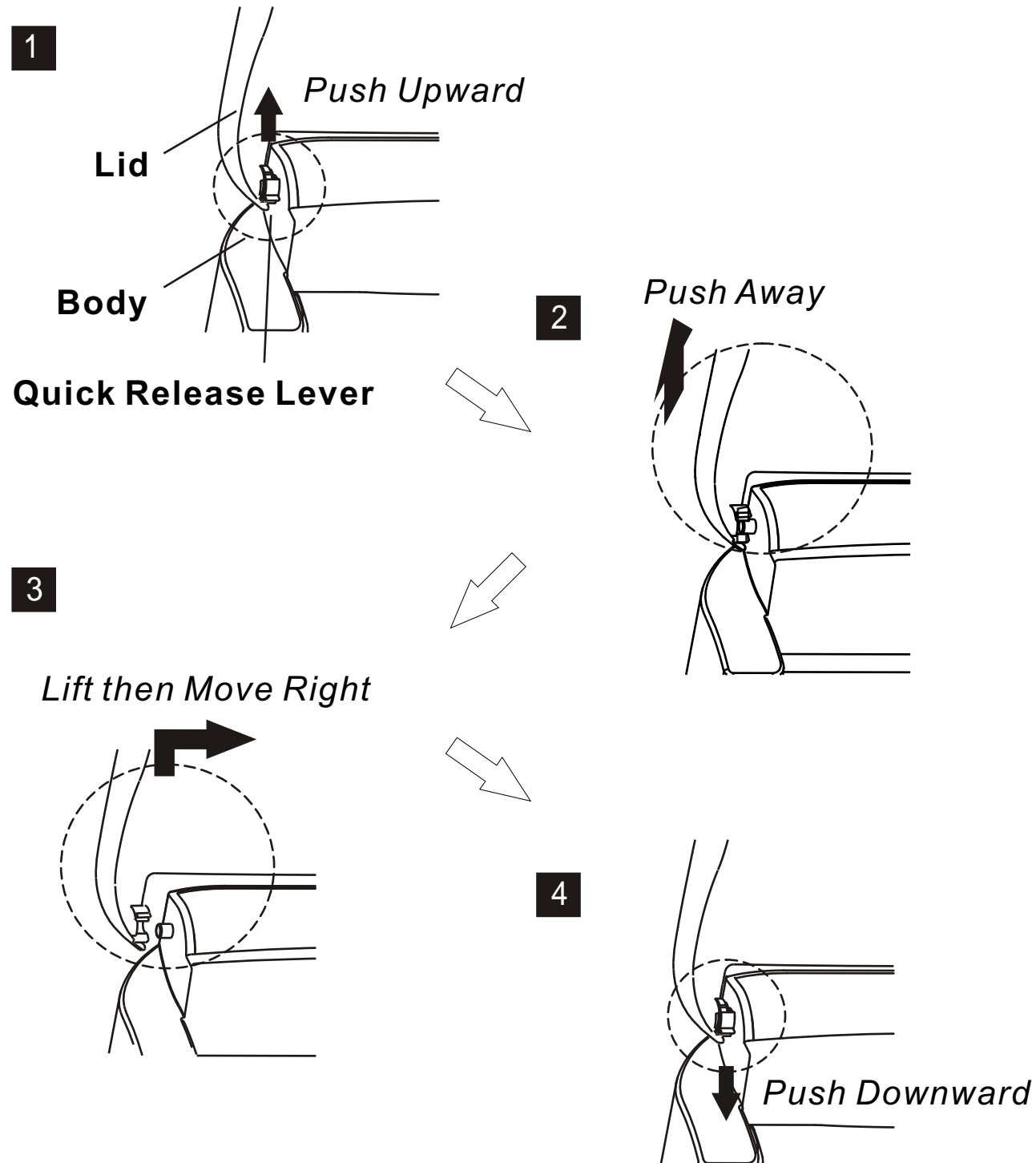

# Precautions

11. Do not expose the system to direct sunlight, to prevent damage to the plastic casing. (Fig. 11)

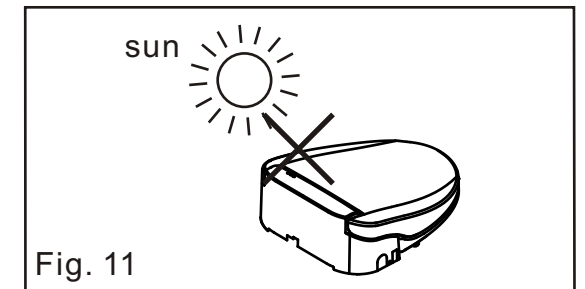

12. Do not plug the system to a loose electrical outlet to prevent electrical shock and fire. (Fig. 12)

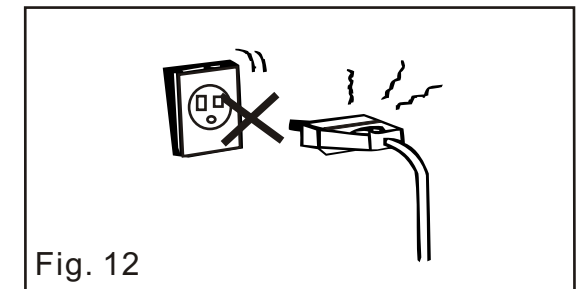

13. Do not exert force on the water hose to prevent leakage. (Fig. 13)

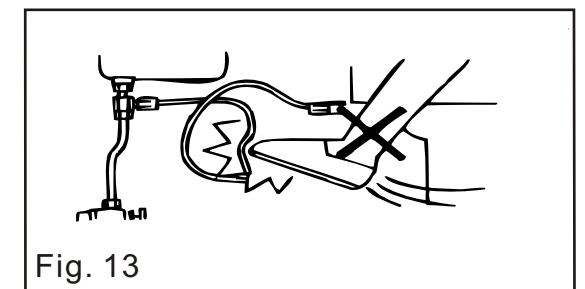

14. Do not apply excessive force to the nozzle. (Fig. 14)

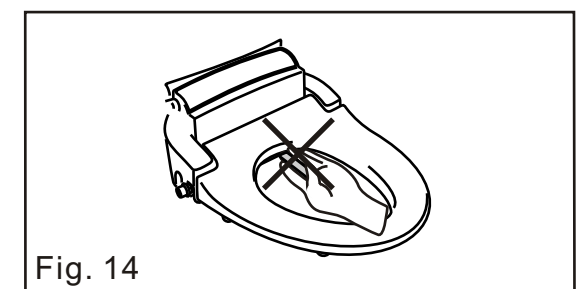

15. Do not use harsh cleansers, cleanser with high acid content, or thinner to clean any part of the seat (Fig. 15).

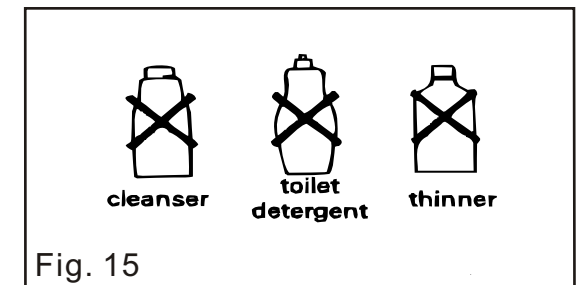

# Unpacking Your Electronic Bidet

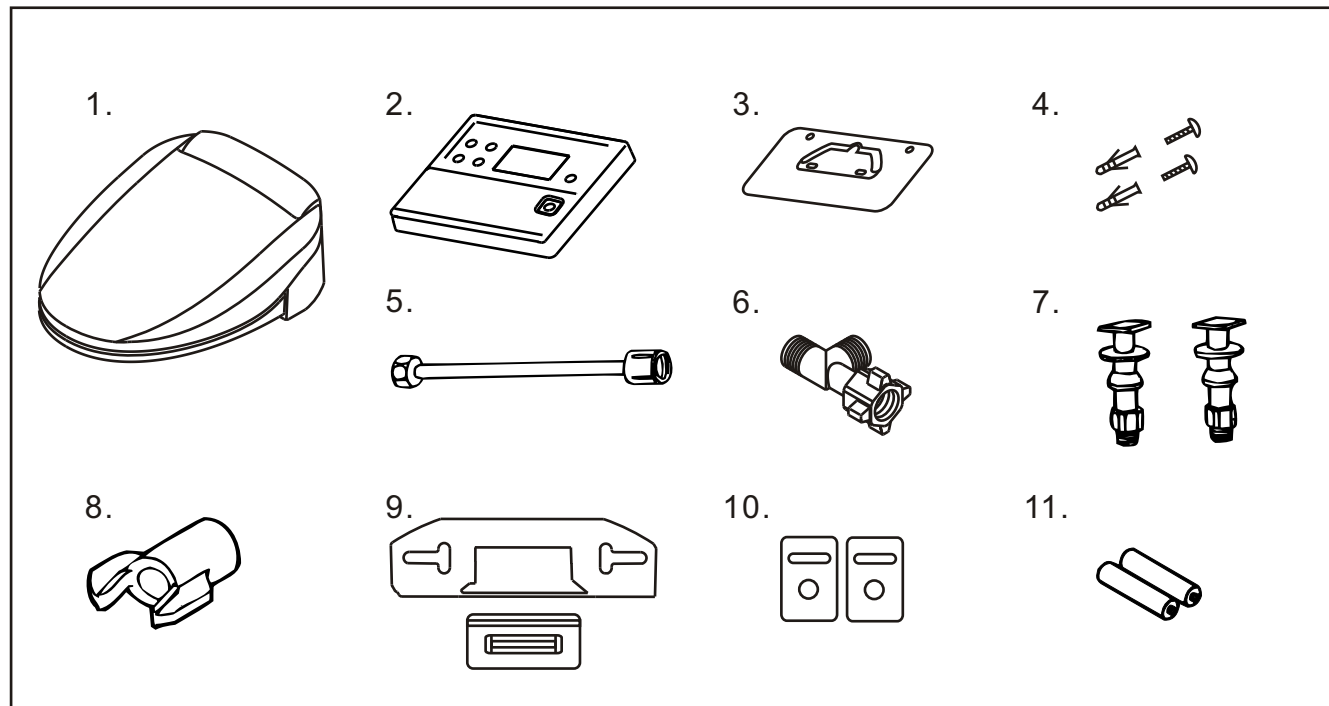

Unpack the unit and check the contents. You should have the following items:

1. Bidet Assembly (1)
2. Remote Control (1)
3. Wall Mount Plate (1)
4. Wall Mount Screw Set (1)
5. Flexible connecting water hose (1)
6. T connector (1)
7. Mounting bolt set (2)
8. Plastic wrench for tightening the nuts on the mounting bolt set (1)
9. Mounting plate (1) + Rectangular rubber washer (1)
10. Metal Washer (2), not required if installation uses plastic mounting bolt (Item 7)
11. Battery (2)

## Tools Required

Please prepare the following tools for installation:

1. Adjustable Pliers
2. Adjustable Wrench
3. Straight Slot Screwdriver

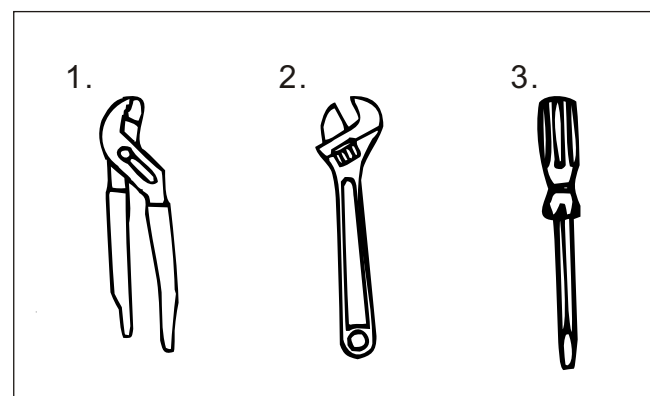

# Maintenance

**Unplug power before servicing the bidet.**

When cleaning plastic parts of the bidet unit, use only mild washing detergents. Do not use highly corrosive acidic and alkaline powder, detergents and thinners to clean the bidet: plastic parts will be damaged.

- Cleaning the seat, lid and body
  - Wipe them with a damp cloth to remove dust; then use a detergent dampened cloth to sanitize them.
  - Dry off the detergent with a dry cloth.
  - If spray nozzle is stained, Pull it forward and clean gently with a toothbrush. Use a mild detergent if necessary.

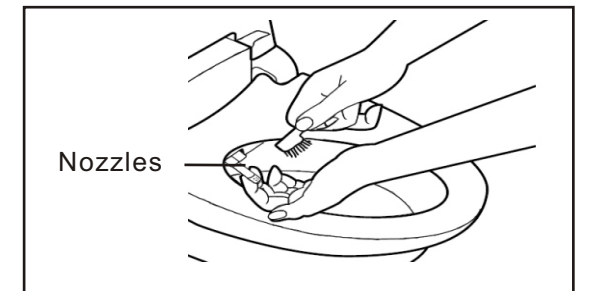
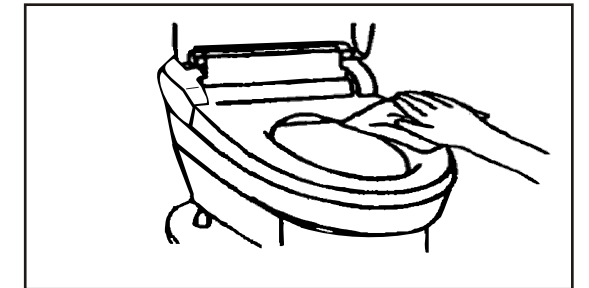

- Cleaning the Deodorizer
  1. Remove filter by pulling filter handle
  2. Use Vacuum to clean debris from the charcoal filter
  3. Use a toothbrush to clean air intake ports on underside of main body

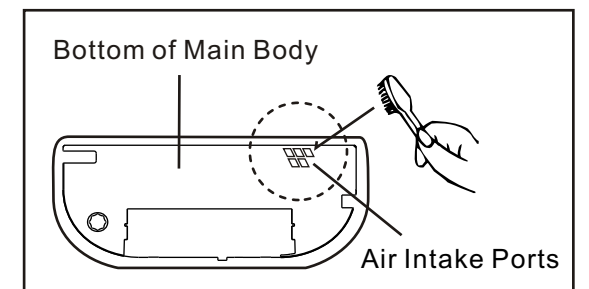
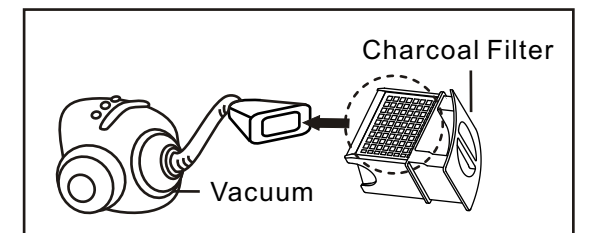
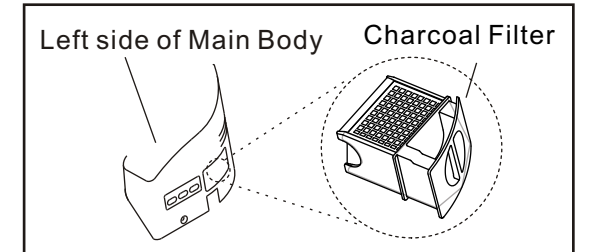



**Warning! Do not use water to clean charcoal filter**  
 \*Clean once a month  
 \*If effectiveness decreases, clean the filter



# Operation Notice

## Warning

- 1 As it takes time for the seat and water to heat, we recommend that you preset the seat and water temperature to the desired temperature.
- 2 You must sit well back into the seat to activate the seat occupied sensor. Functions will not work unless sensor is activated.
- 3 If seat will not be used for an extended period of time we recommend unplugging the unit and turning off the water supply valve at the wall.
- 4 During wash, an overflow of water into the toilet bowl is normal.
- 5 Unit is set to wash for 5 minutes. If you require more washing after 5 minutes press the function on button to start wash again.
- 6 Nozzles self clean for 10 seconds after you stand up.
- 7 After standing up, the deodorizer will run for 1 minute. If you would like to use the deodorizer while sitting, you can push the  deodorizer button.
- 8 Dryer will run for 5 minutes after pushing the dryer function button . If you require longer drying time, push the dryer function button to restart.
- 9 After pushing OFF button , the dryer fan will continue to run for 15 Sec.
- 10 Seat can be released on the left hand side for cleaning. Do not pull on the right hand side as you could damage wires running into the seat.
- 11 Use a quarter sized coin to unscrew the Drain Hole Cover or the Filter, as screwdrivers and other tools can damage the plastic.
- 12 Energy Saver function will only work while seat and/or water heater is on.

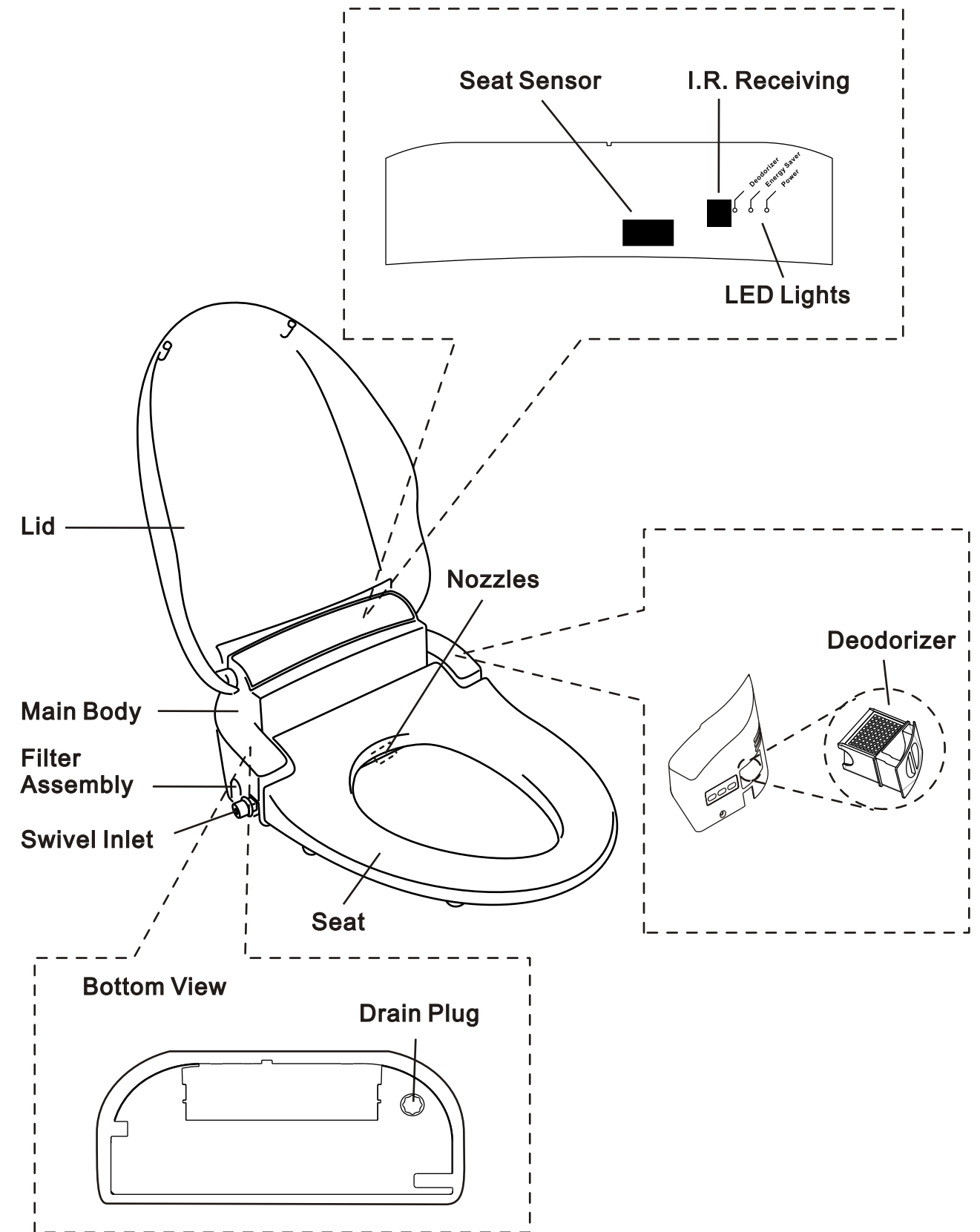

# Installation Instructions

**Do NOT plug the system in before completing the installation.**

1. Loosen the nuts on the mounting bolts and remove the toilet seat assembly.

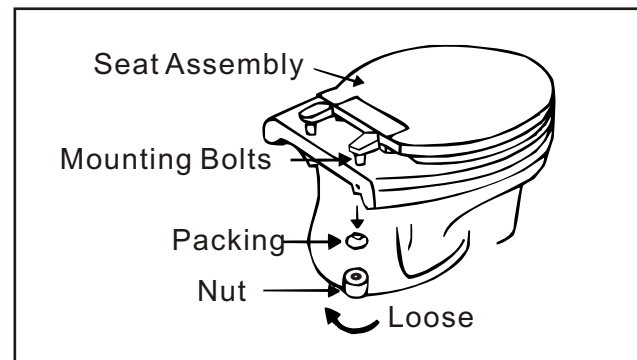

2. First, Insert Rectangular Rubber Washer under Base B (circled area) then place the two bolts into the Base B then through rubber washer A. Insert bolt into seat mounting hole and fasten with rubber washer B and nuts.

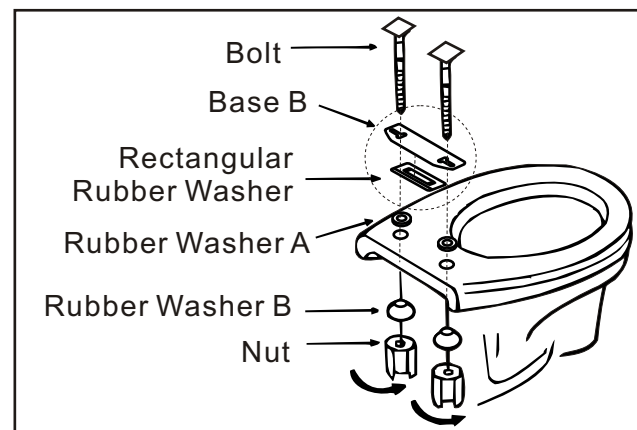

3. Push the bidet system onto slide plate following the arrow (see figure). When secure a click will sound.

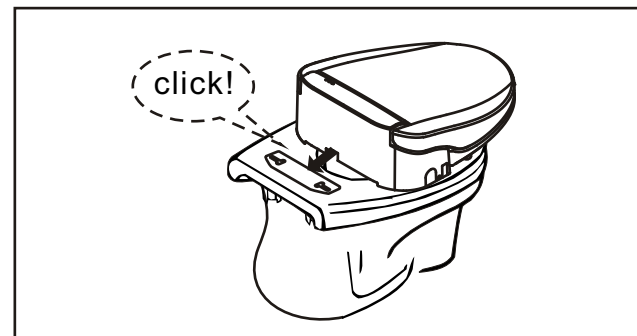

To Uninstall: push seat release button (see figure) and slide off the bidet unit.

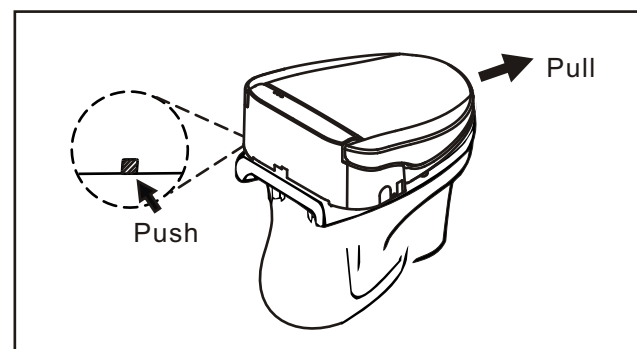

## Caution!

1. The operational water pressure range required is between 12-100 Pound per Square Inch (PSI). Although this system can function with water pressure below 12 psi, the water stream pressure of the shower will be affected.
2. Do not turn on the water and power to this system until installation is completed.

# Remote Control Operations

## Remote Control Operation (Step 2)

1

1. Press Dryer function button  to activate the dryer. Press Dryer Temperature button  to set dryer at desired temperature.

2. Dryer will run for 5 minutes and the automatically shut off. To continue use press Dryer function button again.
3. Press Off button to stop dryer function. After pressing the Off button, the dryer fan will continue to run for 15 seconds.

2

1. Press the Deodorizer button  for 3 minutes of deodorizer run time. Deodorizer will also automatically run for 1 minute when you stand up from the seat.
2. Indicator light on the main body will light while the unit is in deodorizer mode.

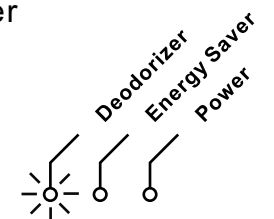

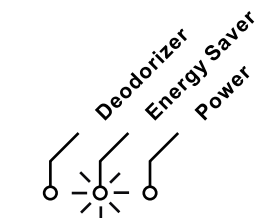

3

1. Press Energy Save button  1 time for 6-hour energy save timer. Press 1 more time for 9-hour energy save timer. Energy save indicator light on main body will light while unit is in energy save mode.
2. The energy save will turn off if you sit on the seat or you press the energy save function once more while energy save is set at 9 hours.



4

1. Alarm button  is for emergency use. Do not press unless you are calling for assistance.
2. Press the Alarm button  to start the in seat beeper.
3. Stop the alarm function by pressing the Off button on the remote control or the Power Off button on the main body.

## Notice!

1. When Low Battery  appears on the LED display, it is time to change the battery. After changing the battery, you will need to reset your personal settings.
2. Insure that nothing is covering the transmitters.

# Remote Control Operations

## Remote Control Operation (Step 1)

1



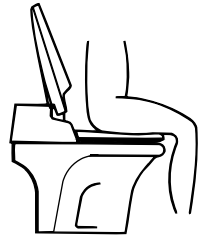

1. Sit on Seat. Make sure you sit to the center and back of the seat to insure activation of the optical sensor.
2. Press Seat Temperature button  to select you desired seat temperature.
3. Keep seat set at desired temperature for best comfort.



2

1. Press the Water Temperature button  to select you desired water temperature.
2. Keep water set at desired temperature for best comfort.
3. As it may take a few minutes for water to heat up, we recommend that you keep the water set at you desired temperature.

3

1. Press Back Wash button  to activate back wash.
2. Press Front Wash button  to activate front wash.
3. While wash cycle is on, adjust water flow/pressure by pressing the Water Flow  arrows. Use the up to arrow increase pressure and down arrow to decrease pressure.
4. While wash cycle is on, press the Massage button  to activate the massage feature. Press the Massage button again to turn off the message feature.
5. After wash is complete press Off button to turn off wash. Wash will also stop after 5 minutes.
6. Use tissue to pat dry.
7. The deodorizer will automatically run for 1 minute after leaving the seat.

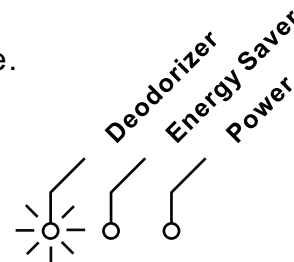

### Remote Control Time Setting:

1. Press the Off button for 5 seconds, until hour LED display starts blinking.
2. Adjust the hour by using the Front Wash button to increase and Back Wash to decrease.
3. Press Off button once more so minute LED is flashing. Adjust time with Front Wash button increasing time and the Back Wash decreasing time.
4. After time is set, touch any other button once to complete time set. Clock will also set if you do not touch any buttons for 5 seconds.

# Installation Instructions

4. Shut off water supply valve (located at the bottom of the wall) and flush the toilet to empty water tank. Remove the water hose from the bottom of the water tank (Ball Cock).

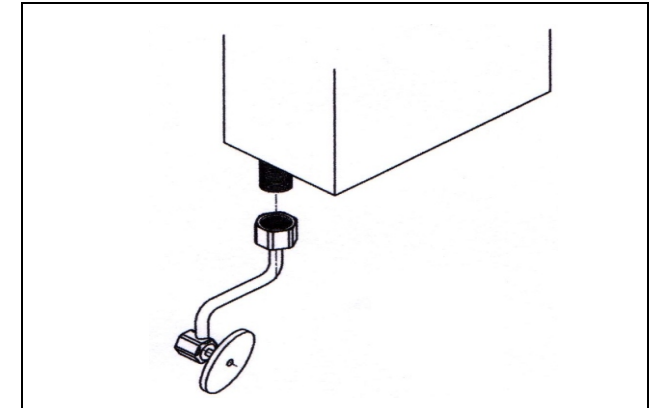

5. Attach T connector (provided) to the bottom of the water tank. Teflon tape is not required for installation. Keep all connections aligned and do not over tighten, as this may damage connections.

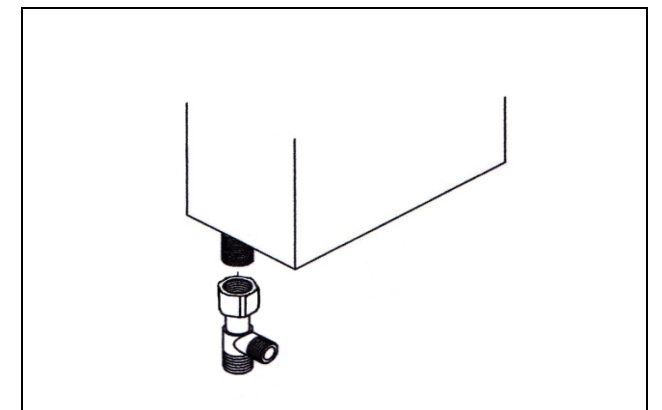

6. Connect water hose to T connector. (7/8" threaded side)

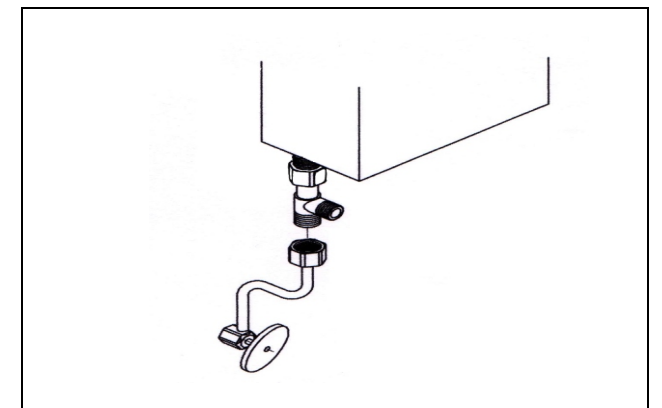



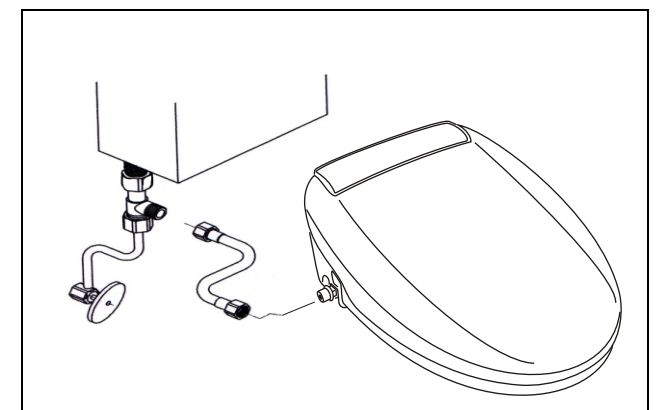

7. Connect flexible water hose (provided) from T connector (1/2" threaded side) to swivel inlet (located on the left-hand while facing the unit).

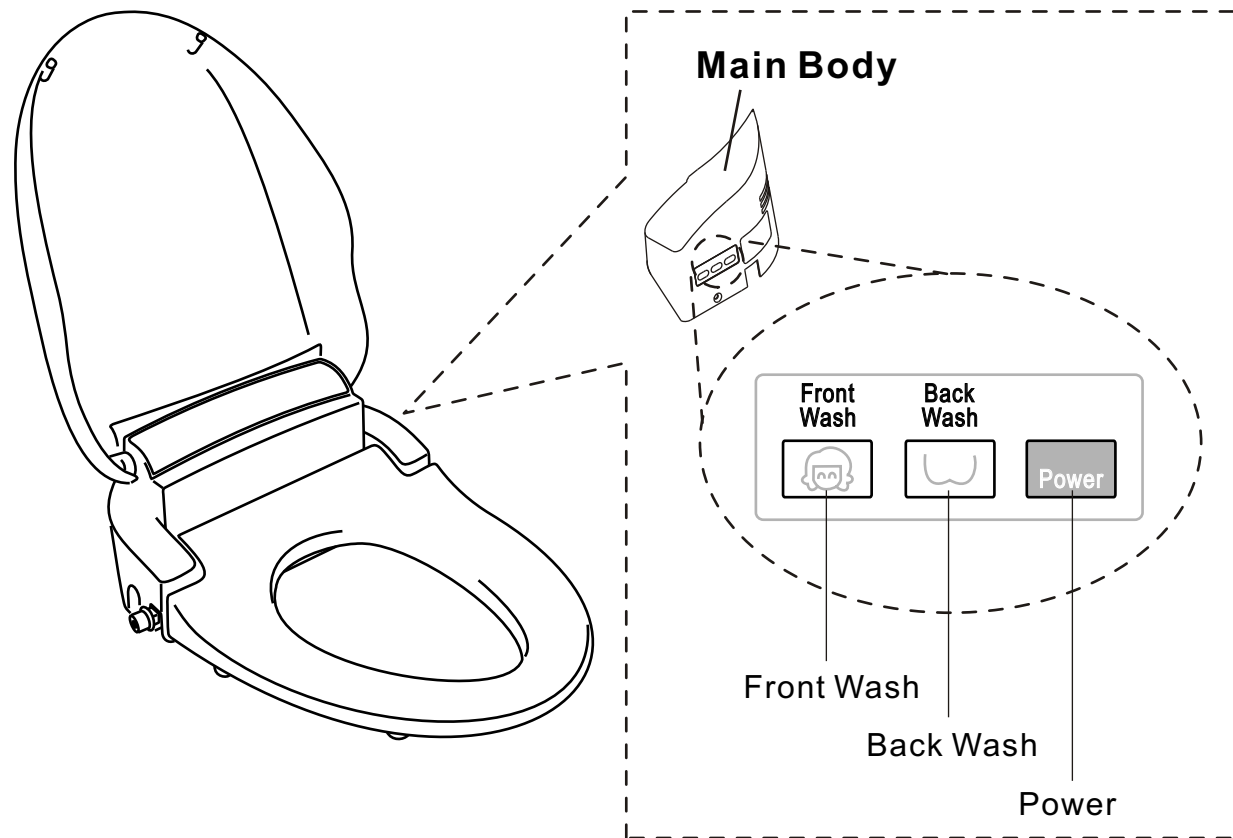

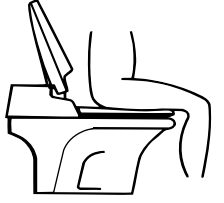
# Main Body Operations

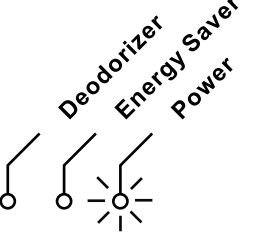

<p><b>1</b></p> <p>Make sure you sit to the center and back of the seat to insure activation of the optical sensor.</p> 	<p><b>2</b></p> <p>1. Press Back Wash button  to activate back wash. Press Back Wash button again to turn off function.</p> <p>2. Press Front Wash button  to activate the front wash. Press Front Wash button again to turn off function.</p> <p>3. The deodorizer will run for 1 minute after leaving the seat.</p>
<p><b>3</b></p> <p>1. Push Power button  to turn off power. Power indicator light will turn off.</p> <p>2. Push Power button again to turn power on.</p>	

# Remote Control Features

## Remote Controller

Note: Remote control is shipped with a protective skin covering the display and buttons. This skin is removable.

### View 1

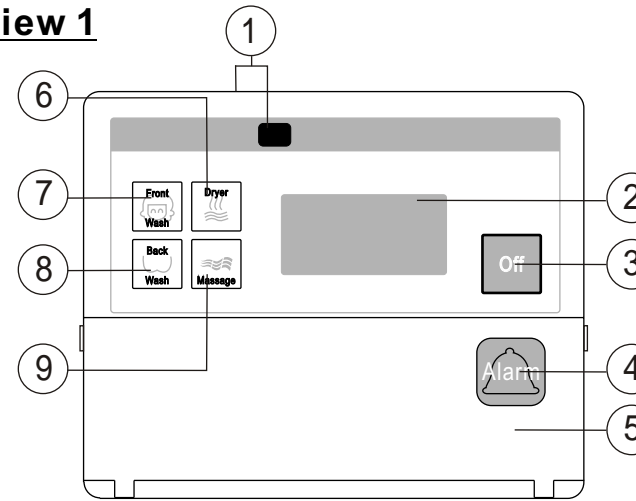

### View 2

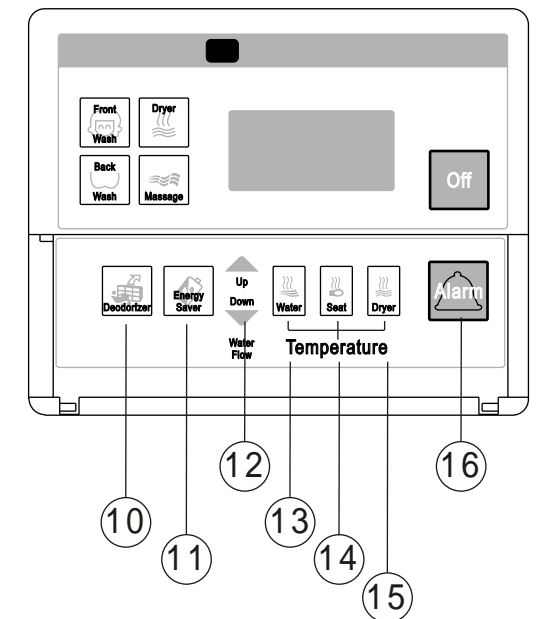

### View 1 : While cover is closed

- 1 Remote Control Transmitter** - Infrared Signal Transmitter
- 2 Display Window** - Shows function status
- 3 Function Off** - Turns off functions
- 4 Emergency Alarm** - Sounds beeper in main body
- 5 Cover** - Covers setting buttons
- 6 Dryer Function** - Starts dryer function
- 7 Front Wash** - Starts front wash function
- 8 Back Wash** - Starts back wash function
- 9 Message** - Activates message while wash on

### View 2 : While cover open

- 10 Deodorizer** - Activates deodorizer for 3 Minutes
- 11 Energy Saver** - Powers off temperature controls for 6 or 9 hours
- 12 Water Flow** - Adjusts water flow in 5 steps during wash
- 13 Water Temperature** - Adjusts water temperature in 4 steps
- 14 Seat Temperature** - Adjusts seat temperature in 4 steps
- 15 Dryer Temperature** - Adjusts dryer Temperature in 3 steps
- 16 Emergency Alarm** - Sounds beeper in main body

For operation instructions refer to page 12 & 13