



Filter Systems

OPERATING INSTRUCTIONS

MG400

Filter system

FOR A BETTER WORKBENCH ENVIRONMENT



Filter Systems

FILTRONIC

Hissgatan 2, Box 2284, SE-531 02 LIDKÖPING

Tel: +46 510 208 10, Fax: +46 510 201 40

e-mail: office@filtronic.se

www.filtronic.se

Version 1



Table of contents

1.	Introduction	2
2.	Content	2-3
3.	Safety instruction	4
4.	Put into operation	4
5.	Troubleshooting	5
6.	Maintenance and service	6-8
7.	Technical data	9
8.	Article number	10
9.	Warranty	11

1. Introduction

MG400 is a mobile filter unit for elimination of particles and gases in polluted process air from soldering, gluing, cleaning, laser, printing processes etc.

2. Content

1. Inlet pipe (Ø 160 mm)
2. Lid
3. Lock
4. Pre filter box
5. Main filter 4 pcs
6. Outlet pipe (Ø 125 mm)
7. Control panel
8. Power intake with fuse

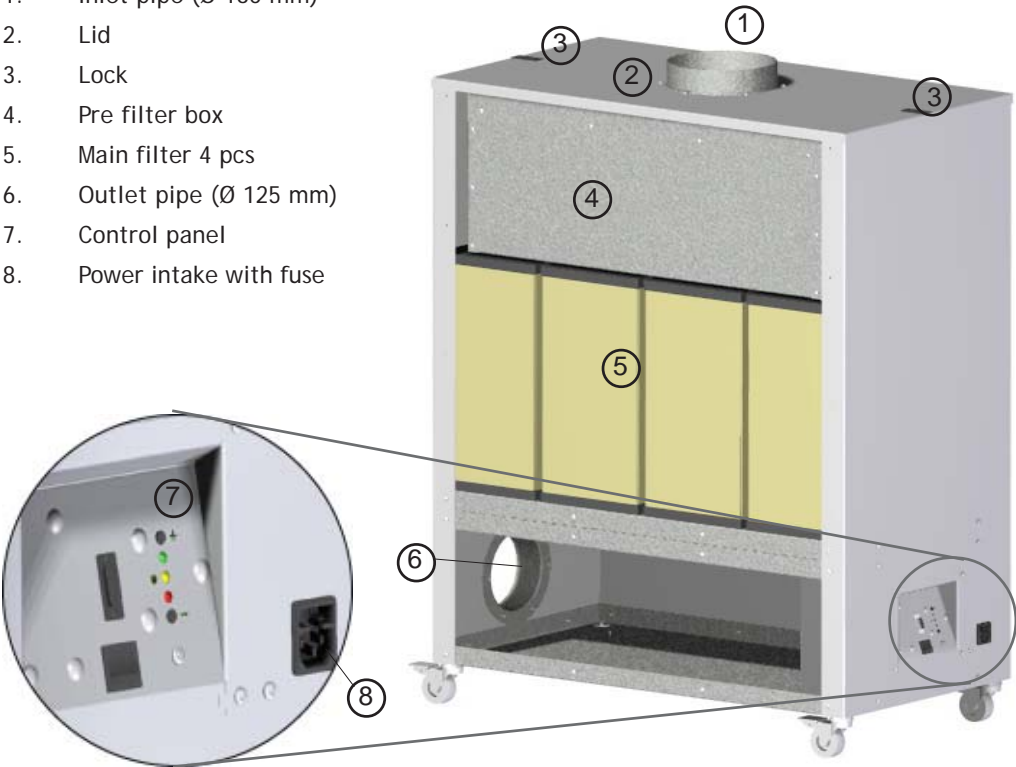

10. Warranty

General conditions according to ORGALIME S 2000.

Filtronic guarantees the product for manufacturing failures for a time period of two (2) years on filter units and accessories, consumptions not enclosed. The time is measured from date of invoice.

Only use genuine Filtronic consumables and spare parts in order to ensure reliable function and to maintain the unit's warranty. Repairs must be performed by personnel trained by Filtronic.

The information given is not binding and does not free the user from his or her responsibility to check the equipment before using it.

Filtronic reserves the right to introduce technical changes in the course of product development.

Always contact the supplier before return a product.
The invoice has to be shown at the time of the complaint.

8. Article number

Filter system MG400	450-1000-ESD
Micro/Gas filter, Standard (4 pcs)	450-2000-ESD
Micro/Gas filter, Cleanroom (4 pcs)	450-2002-ESD
Micro/Gas filter, MEK (4 pcs)	450-2003-ESD
Micro/Gas filter, Ammonia (4 pcs)	450-2006-ESD
Micro/Gas filter, Solvents/VOC (4 pcs)	450-2012-ESD
Pre filter (2 pcs)	450-4000
Remote control with cable	700-3057-L
Remote control (battery) IR	700-3058

Control panel

- 9. Push button - decrease
- 10. LED indicator - low airflow
- 11. LED indicator - filter time exceeded
- 12. LED indicator - operation
- 13. Push button - increase
- 14. Intake for remote control
- 15. Circuit breaker

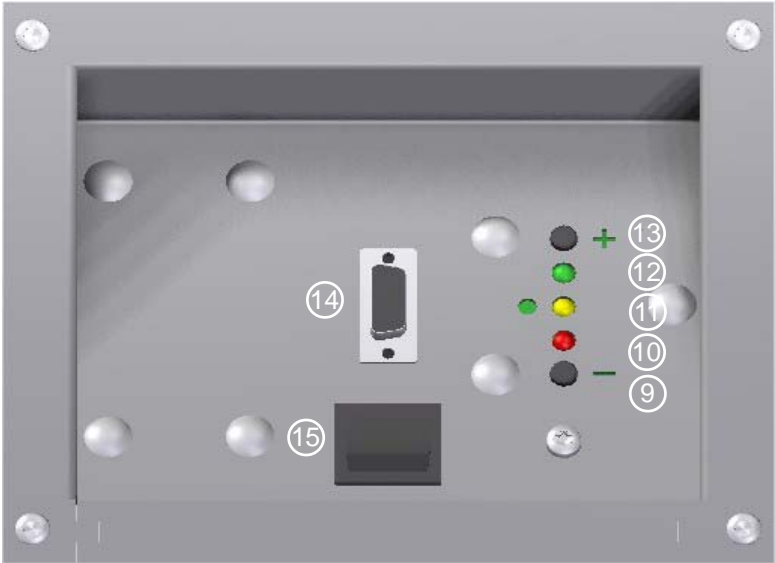

Remote control:

- 16. Push button - start/stop
- 17. Push button - filter monitoring
- 18. Push button - decrease
- 19. Push button - increase



3. Safety instruction

The unit must not be exposed to temperatures exceeding 50° C, open flames or condensated solvents.

Switch off the filter unit when changing filter.

4. Put into operation

- The best possible gas filtration will be achieved if:
- Process air temperature in the gas filter < 38 °C
 - Relative humidity < 60 %
 - Gas molecules > 30 g / mol (filtration is better with larger molecules)
 - Boiling temperature of gas molecules > 0 °C



NOTE! The unit may dust some from the main filter after transportation. Make sure the starting of the unit is made in an appropriate room.

Connect the suction hose or suction tube at the inlet pipe (1). Connect the power cord. Connect the remote control (14). Switch on the filter unit (15) and thereafter the remote control on push button (16).

When delivered the filter monitoring is programmed for normal load of the filter (step 3). If you want to change the program, press the button for filter monitoring (17).

Step	Indication	Hours	Application example
1		500	Heavy smoke formation, gluing
2		1000	
3		1500	Inspection, repair (set by delivery)
4		2000	
5		2500	
6		3000	

7. Technical data MG400

Width x height x depth	796 x 1016 x 402 mm (31,3 x 40 x 15,9 inch)
Weight	68 kg (150 lb)
Sound level at 1 meter	<55 dB(A)
Voltage	115 or 230 Volt
Effect	300 Watt
Glass tube fuse	2 x 6,3 AT, 250 V
Maximum suction capacity	400 m³/h (235 CFM)
Blower capacity	450 m³/h (264 CFM)
Micro filter - Separation degree, MPPS	>99,95 %
Gas filter - Separation degree	>95 %
Filter monitoring system	Yes
Warranty (excl. filter)	2 years
CE-guidelines	89/336, 2004/108, 2006/95
RoHS	Yes

When a new main filter is mounted, the filter monitoring needs to be set to zero. This can be done in two different ways.

Via the control panel:

1. Switch off the circuit breaker (15).
2. Switch on the circuit breaker (15) at the **same time** as the buttons (9) and (13) are pressed down. A ready signal sounds and the LED indicators die down.



Via the remote control:

1. Switch off the circuit breaker on the filter unit (15).
2. Switch on the circuit breaker on the filter unit (15) at the **same time** as the push buttons (18) and (19) are pressed down. A ready signal sounds and the LED indicators die down.



5. Troubleshooting



Do not modify the filter unit. Repairs must be performed by personnel trained by Filtronic.

- If the filter unit is out of order, please check:
 - the electricity supply is connected in a correct way.
 - the fuse 6,3 AT is whole.

- If yellow indicator (11) flashes:

Recommended filter lifetime of main filter is exceeded.

See "Exchange of main filter" under headline 6 "Maintenance and service".

- If red indicator (10) shines and alarm is heard:

Inferior suction capacity.

Switch off the filter unit. Check that pre filter, extraction arm or nozzle not are covered. Clean extraction arm and nozzle if necessary. Change pre filter if necessary.

See "Exchange of pre filter" under headline 6 "Maintenance and service".

If the alarm remains, change the main filter. See "Exchange of main filter" under headline 6 "Maintenance and service".

If the alarm not is taken care of, the filter unit will stop within five minutes to protect against overheating.

The main filter should be changed at least once a year to guarantee the separation degree on gases. At inspection/repair, appr. seven pre filters are used before changing main filter.

6. Maintenance and service

Exchange of pre filter:

1. Switch off the circuit breaker (15).
2. Unlock the lid and remove it (2).
3. Remove the pre filter carefully (20).
4. Mount the new pre filter.
5. Replace and lock the lid (2).



Exchange of main filter:

For optimal filter lifetime and filter economy always change pre filter when changing main filter.

1. Switch off the circuit breaker (15).
2. Unlock the lid and remove it (2).
3. Remove the pre filter carefully (20).
4. Loosen the wheel (21) and lift up the pre filter box (4).
5. **NOTE!** The new filter has to be marked with the date of change (11).
6. Exchange the four main filters (5).
7. Replace the pre filter box (4) and mount the wheel (21).
8. Mount the new pre filter.
9. Replace and lock the lid (2).
10. Set the filter monitoring to zero, see instruction at page 8.

