

SWITCH-IGNITION

REMOVAL

The ignition switch attaches to the lock cylinder housing on the end opposite the lock cylinder. For ignition switch terminal and circuit identification, refer to the Wiring Diagrams section.

1. Disconnect negative cable from battery.
2. Remove the Instrument Panel Center Bezel, (Refer to 23 - BODY/INSTRUMENT PANEL/CLUSTER BEZEL - REMOVAL) Chrysler and (Refer to 23 - BODY/INSTRUMENT PANEL/CLUSTER BEZEL - REMOVAL) Dodge.

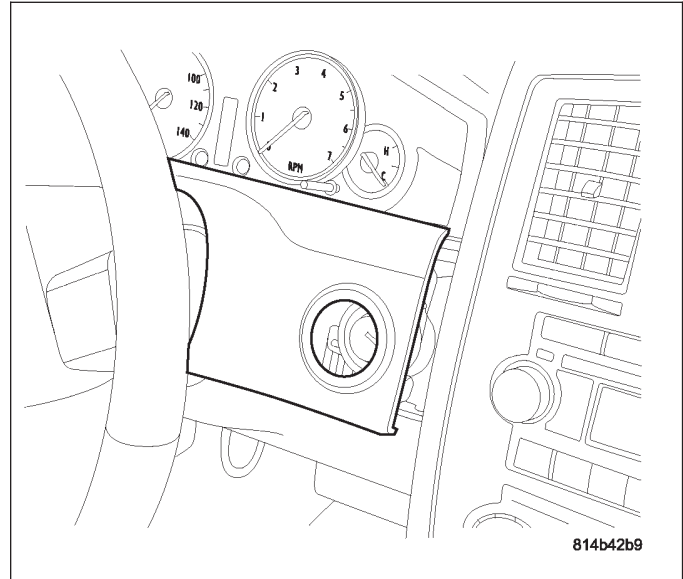

3. Bezel cluster removed.

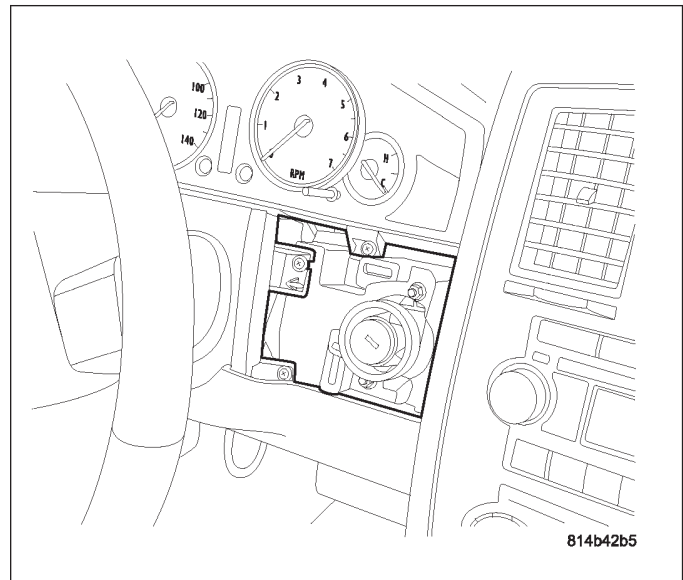

4. Remove side trim panel to steering column cover.

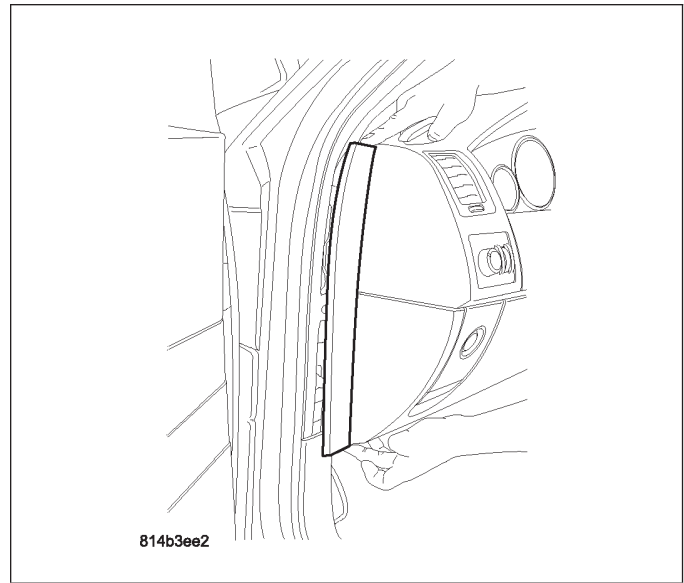

- 5. Remove the screws that secure the steering column cover to the instrument panel and relocate panel.
- 6. Pull the steering column cover rearward at the top and right side of the cover to release the snap retainers from the instrument panel.
- 7. Remove the screws that secure the instrument panel steering column cover reinforcement to bracket and remove reinforcement from the vehicle.

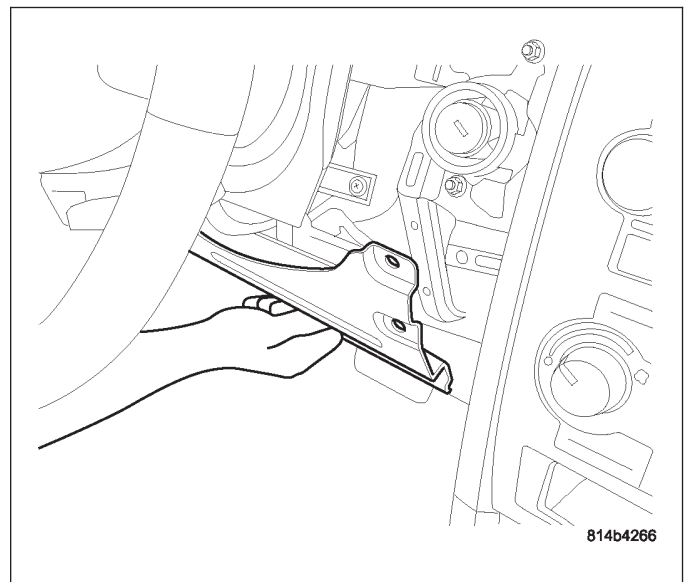
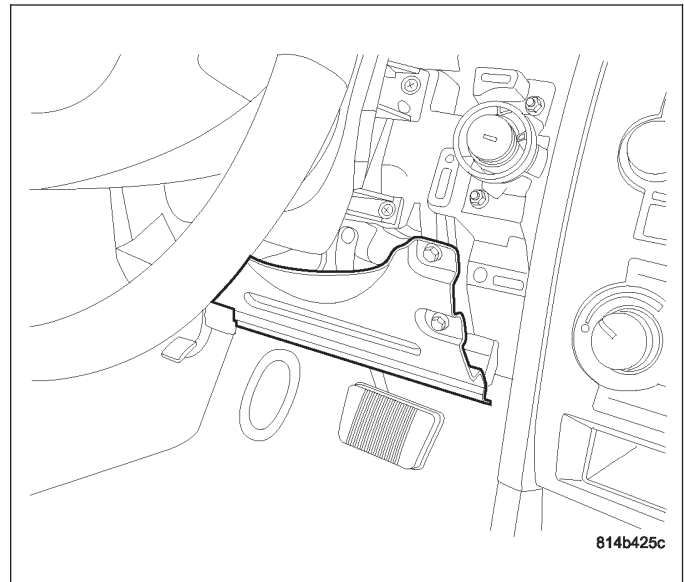

8. Remove the 2 front mounting nuts.

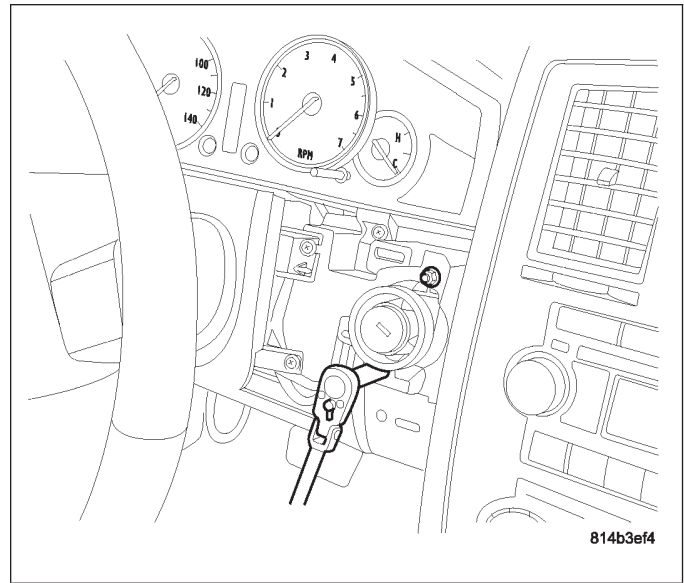

9. Remove the lower mounting nut.

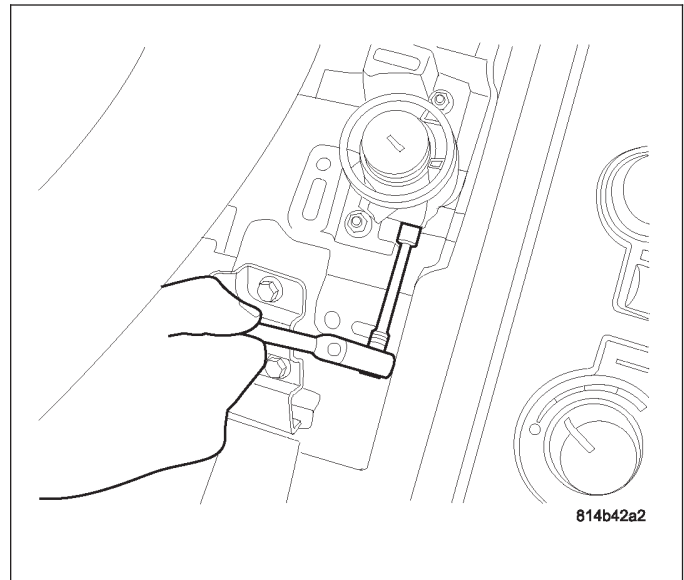

10. Slide the assembly rearward into the instrument panel and down to gain access to switch.

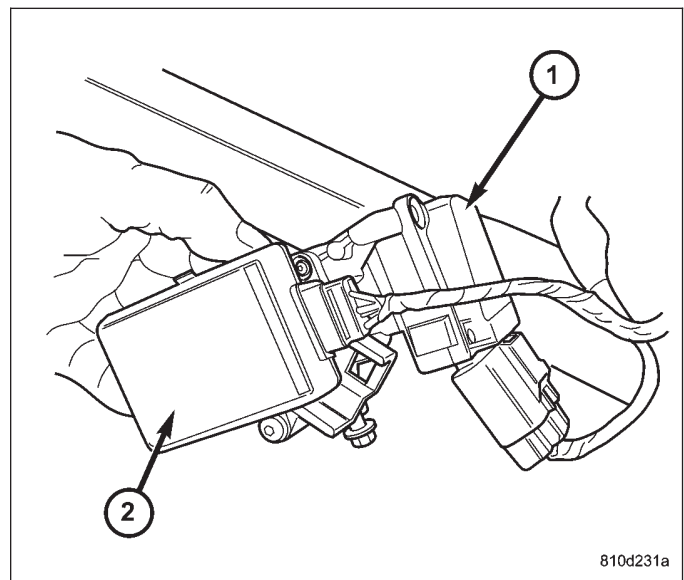

11. Disconnect the electrical connector from the ignition Switch and SKREEM Module.

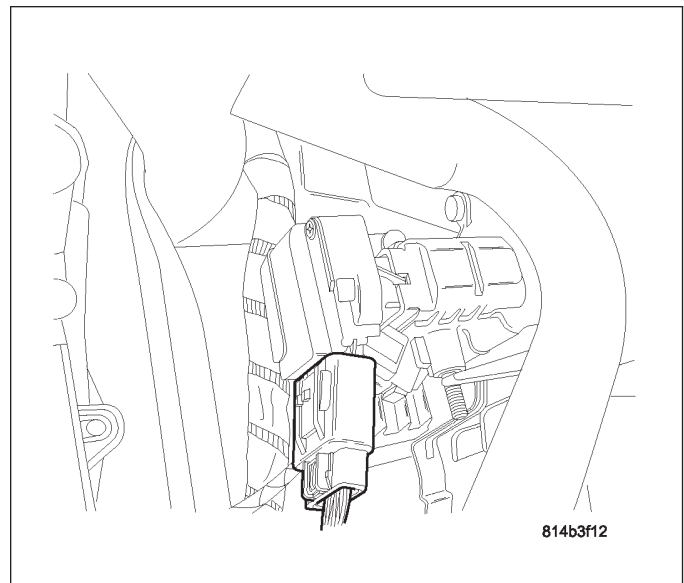

12. Remove the interlock cable by depressing the locking tab and pulling straight out.

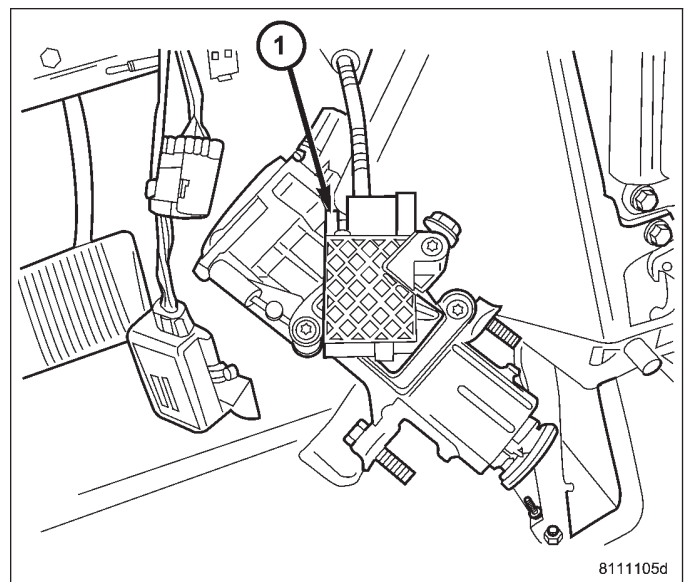
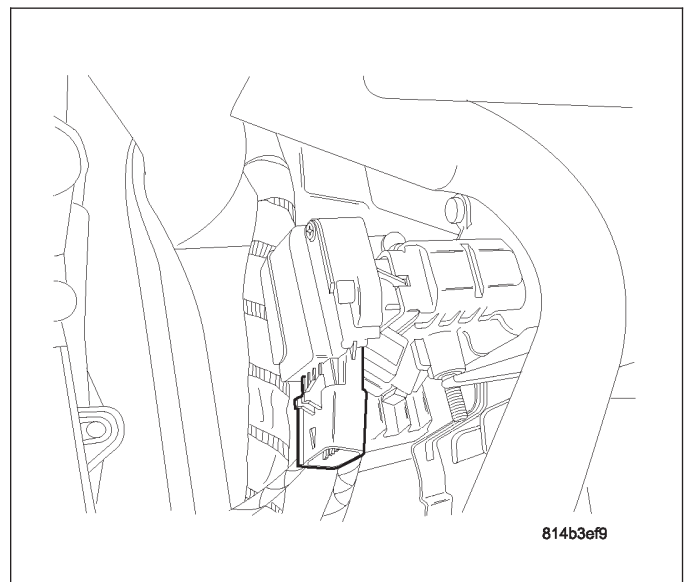

13. Interlocking cable removed.

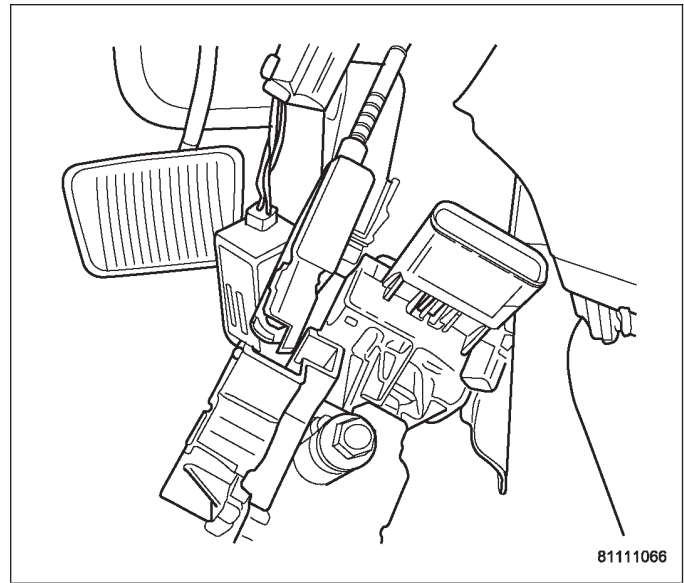

14. Remove ignition switch mounting screw.
15. Squeeze the 2 locking tabs to remove ignition switch from the lockhousing.

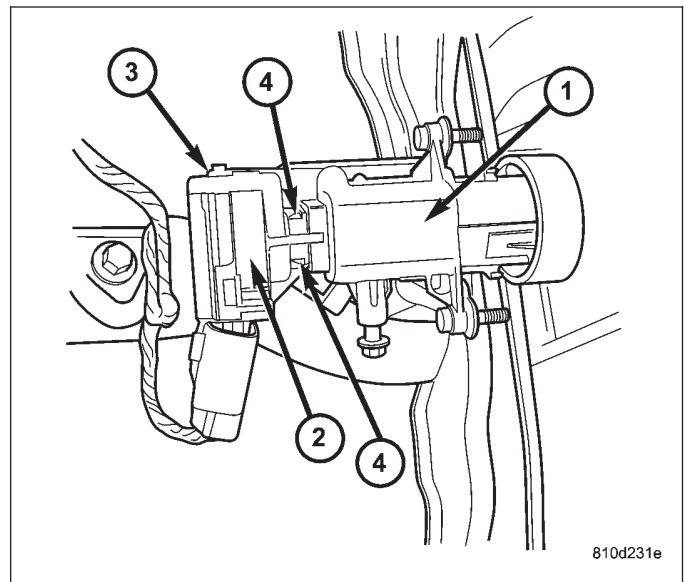

- 1 - Ignition Key Housing
2 - Ignition Switch
3 - Ignition Switch Mounting Screws
4 - Locking Tabs

INSTALLATION

The ignition switch attaches to the lock cylinder housing on the end opposite the lock cylinder. For ignition switch terminal and circuit identification, refer to the Wiring Diagrams section.

1. A tab on the ignition switch indexes to a notch in the lock cylinder housing. Also, a slot in the end of the ignition switch fits over the shaft in the end of the lock cylinder housing. Use the ignition key to rotate the lock cylinder to align the ignition switch with lock cylinder housing. Insert ignition switch into lock housing until locking tabs are seated into openings on lock housing.
2. Install ignition switch mounting screw.

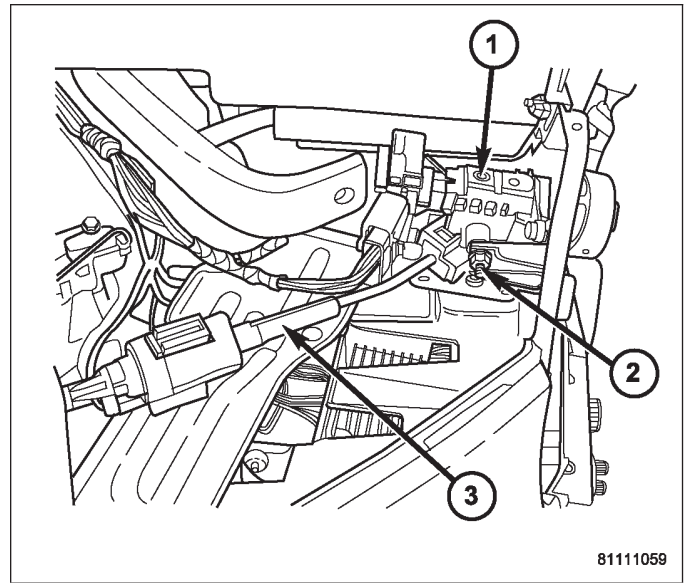

3. Install the interlock cable into the switch assembly.

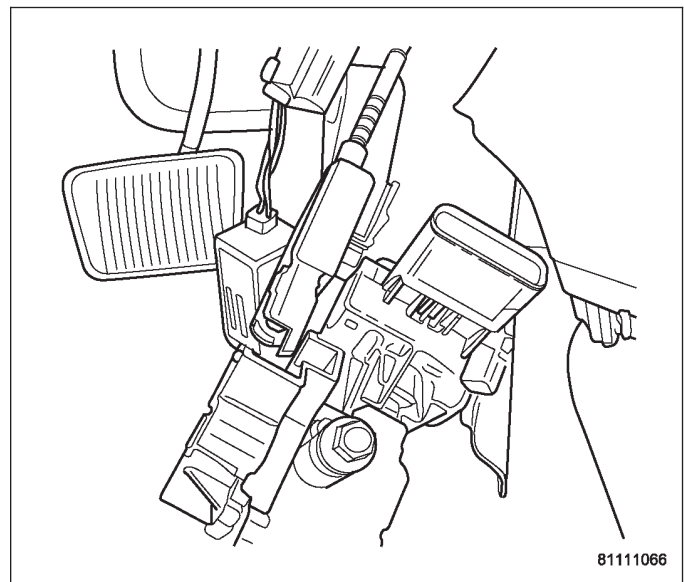
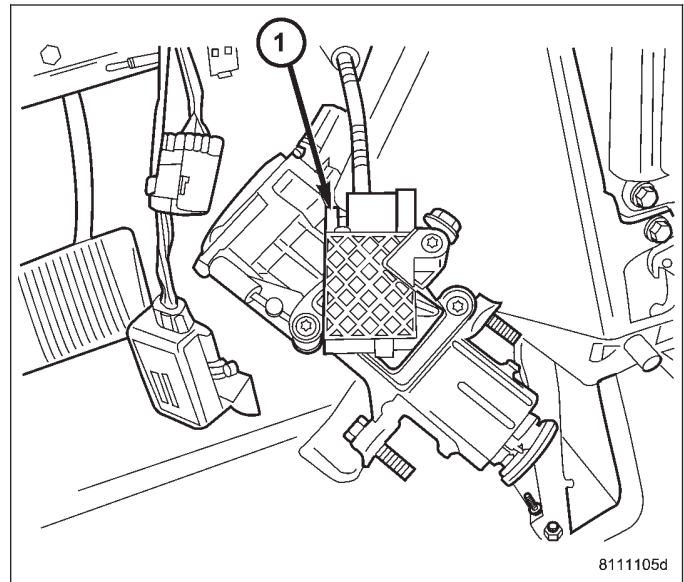

4. Attach electrical connector to SKREEM Module.

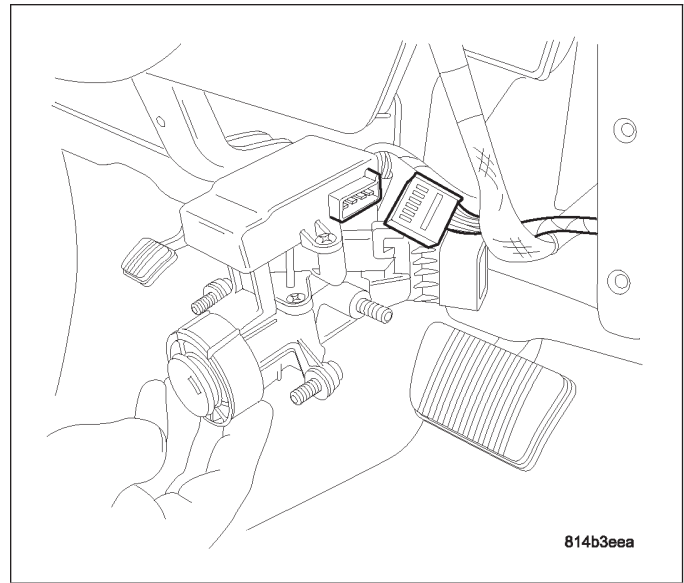

5. Install switch assembly into Instrument Panel.

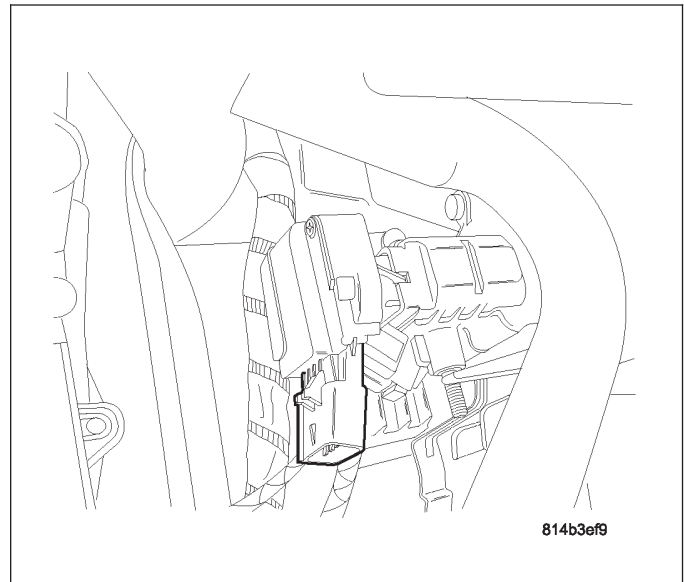

6. Attach electrical connector to ignition switch.

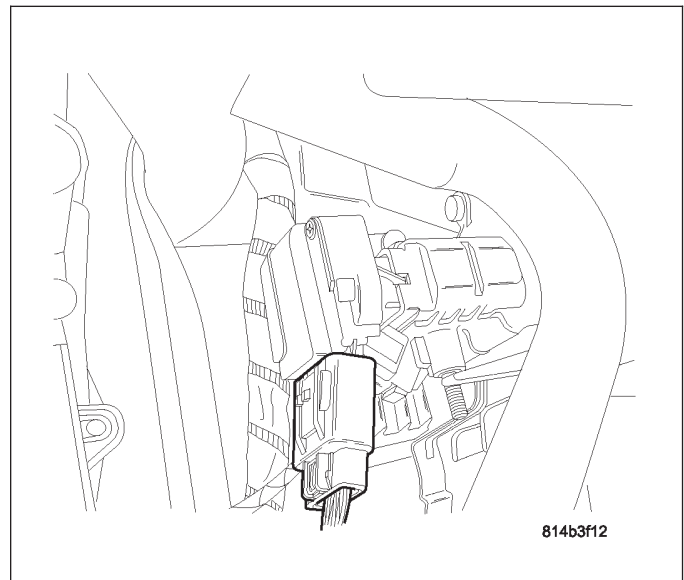

7. Tighten the 2 mounting nuts.

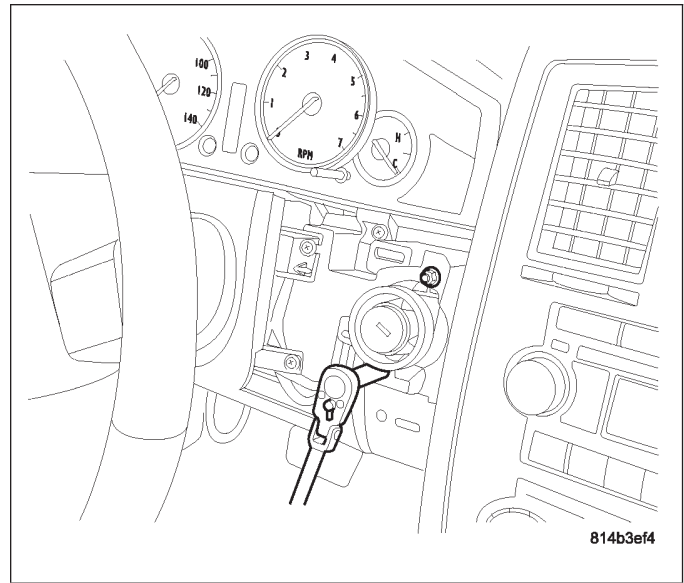

8. Tighten the lower mounting nut.

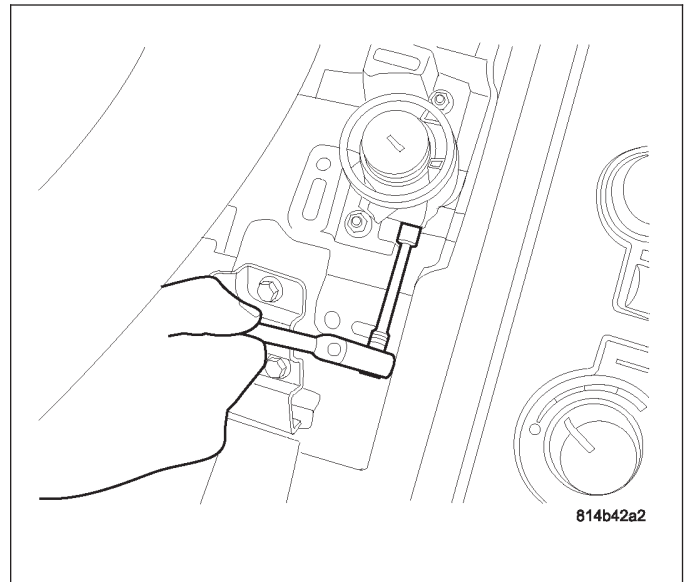

9. Install steering column reinforcement.

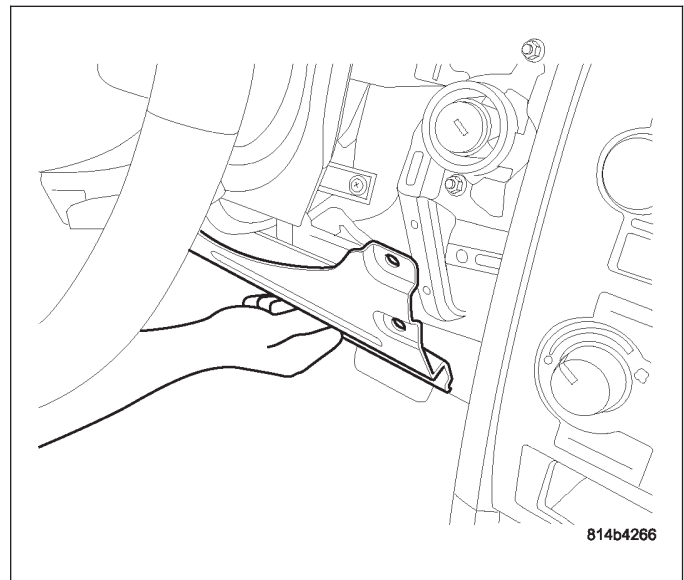

10. Steering column reinforcement installed.

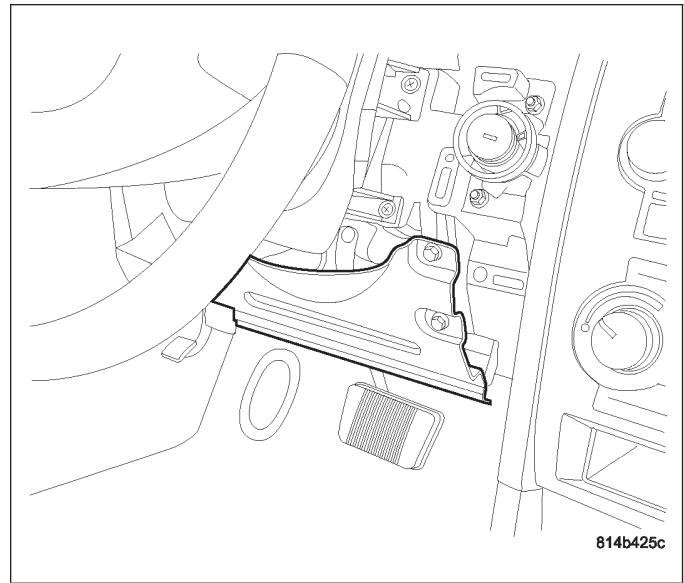

11. Install the Steering column reinforcement cover.

12. Install trim panel end.

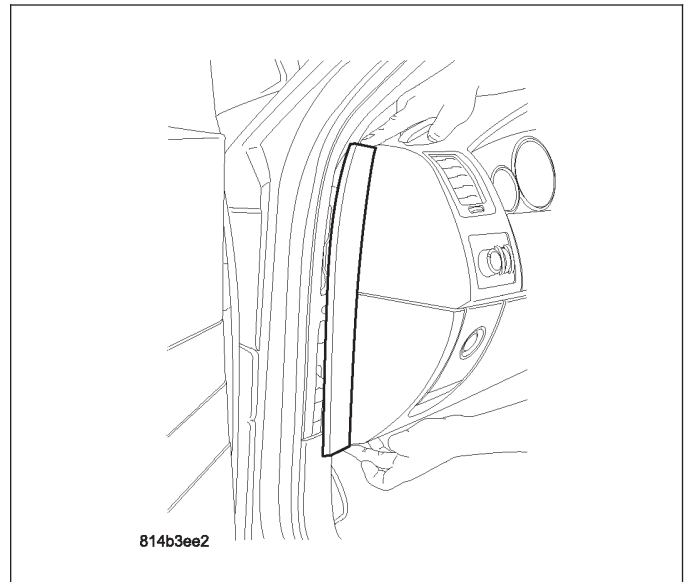

13. Install the Bezel cluster.

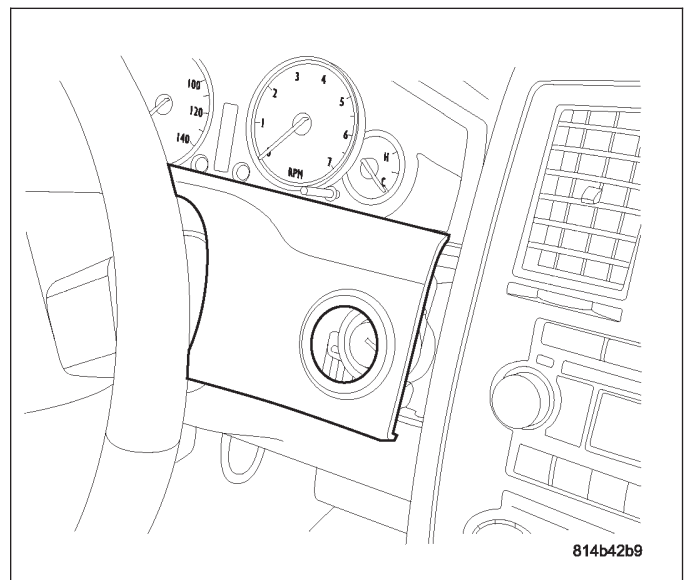

14. Install the ignition switch bezel ring.
15. Connect the negative battery cable.

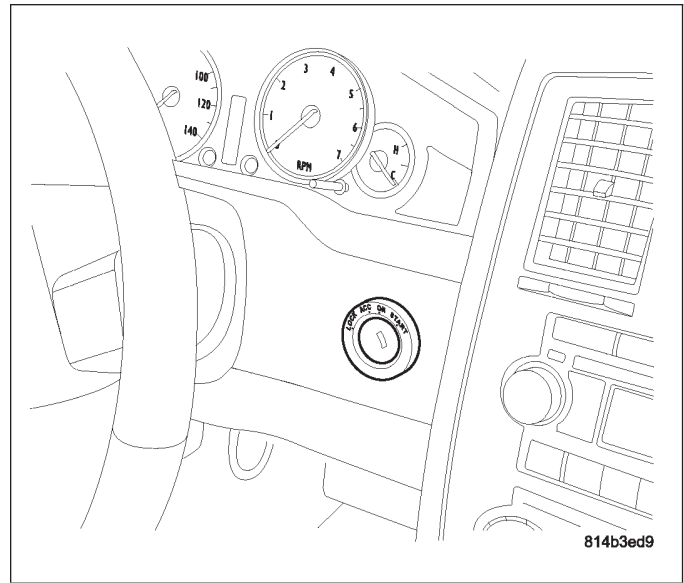

CYLINDER-IGNITION KEY AND LOCK

REMOVAL

1. Disconnect the negative battery cable.
2. Remove bezel ignition switch ring.
3. Pull center console bezel loose from instrument panel.
4. Insert ignition key and turn to the "ON" position.
5. Depress the locking tab on the ignition switch housing.
6. Pull the key cylinder from the ignition switch housing.

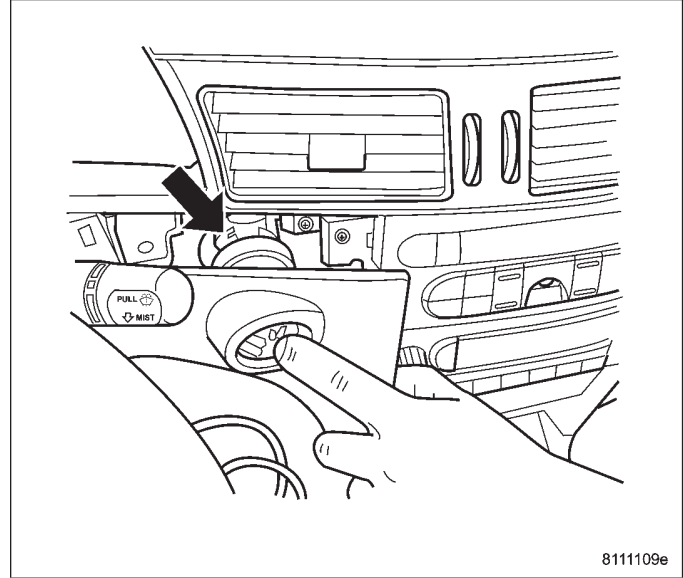

8111109e

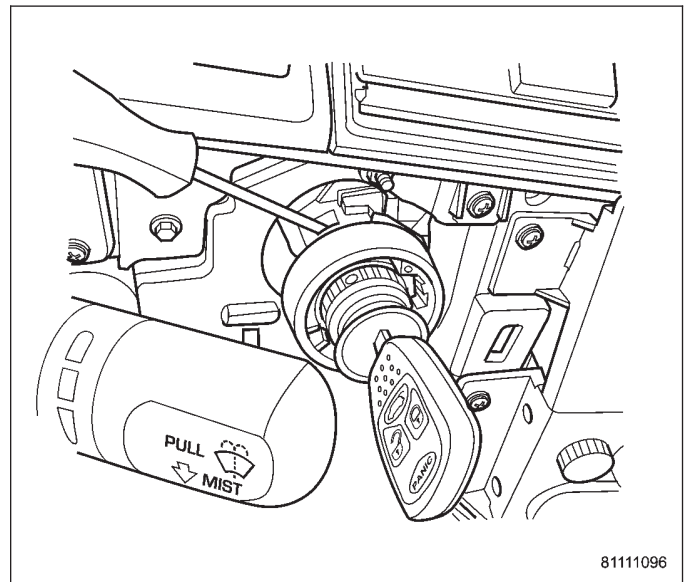

81111096

INSTALLATION

1. Install key in lock cylinder. Turn key to "ON" position (retaining tab on lock cylinder can be depressed).
2. The shaft at the end of the lock cylinder aligns with the socket in the end of the housing. To align the socket with the lock cylinder, ensure the socket is in the "ON" position.
3. Align the lock cylinder with the grooves in the housing. Slide the lock cylinder into the housing until the tab sticks through the opening in the housing.

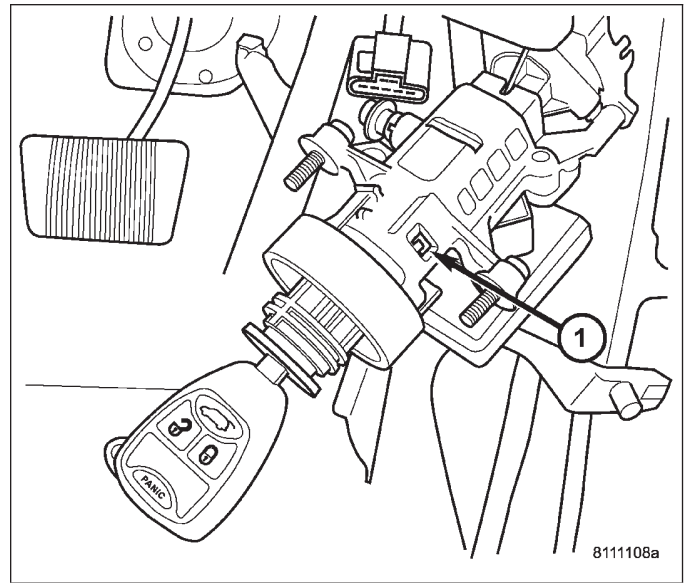

4. Turn key to Off position and remove key.

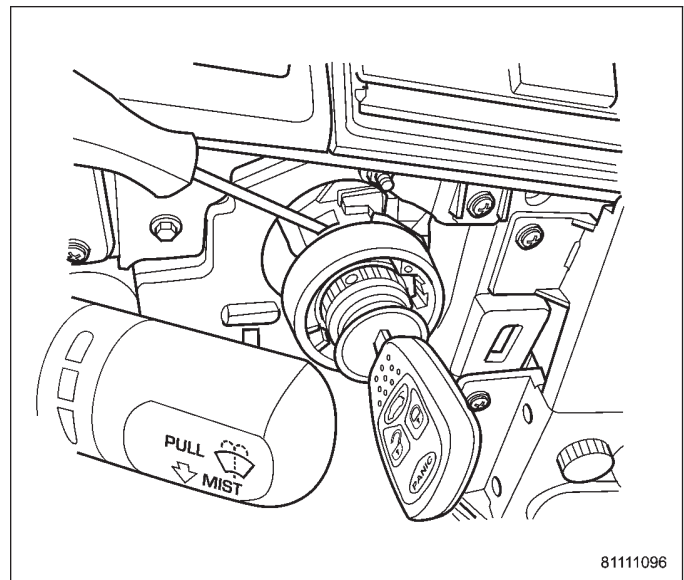
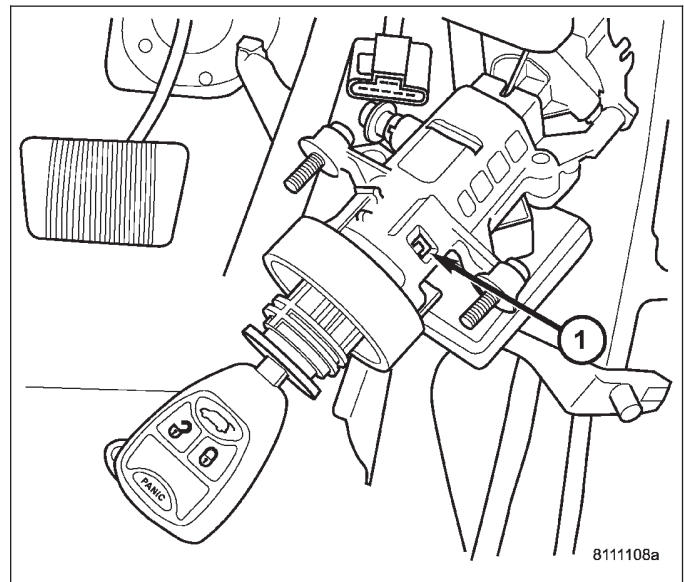

5. Install center console bezel to instrument panel.
6. Install bezel ignition switch ring.
7. Connect the negative battery cable.

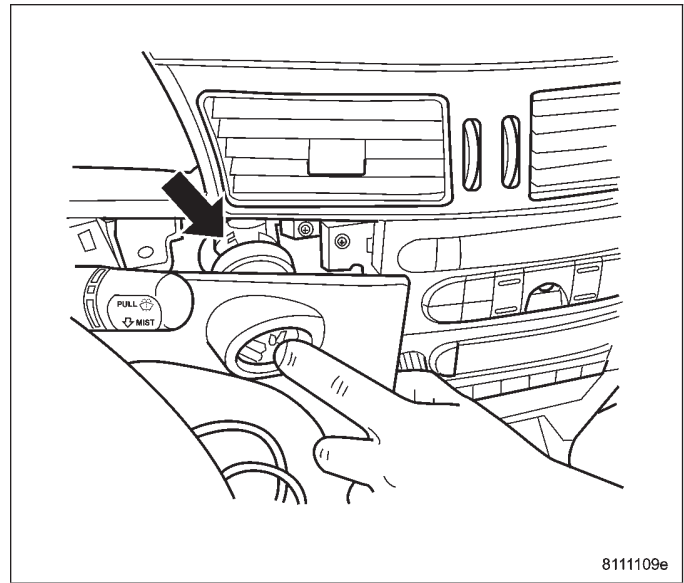

8111109e