

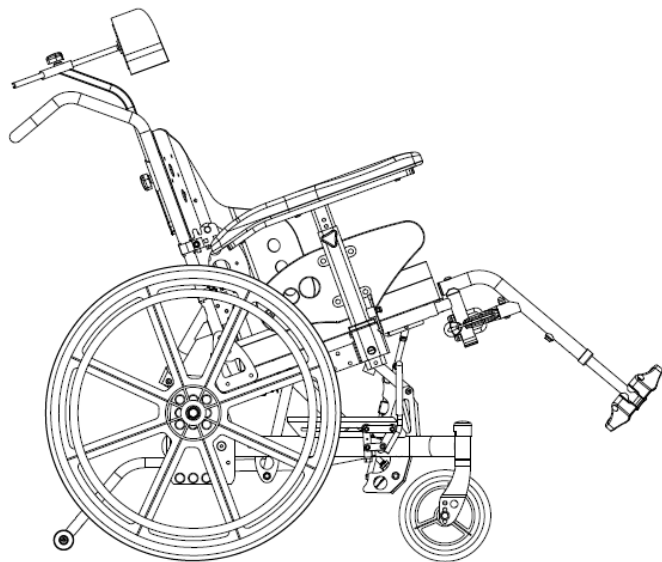

FUTURE
MOBILITY HEALTHCARE INC.



470 – ORION II
REV03 REV
08/14/2013



USER MANUAL

| | | |
|---|--|----|
| 1 | General..... | 5 |
| | Operating Safety Warnings | 6 |
| | Features..... | 7 |
| | Safety Inspection Checklist..... | 8 |
| | Troubleshooting | 10 |
| | Labels..... | 11 |
| 2 | T-Style Knob Release Arm Rests..... | 12 |
| | Installing and removing T-Style arm rests [Figure 1] | 12 |
| 3 | Flip-up Arm Rests | 13 |
| | Engaging/Disengaging and Adjusting Flip-Up Style Arm Rest [Figure 2] | 13 |
| 4 | T-Style Pin Release Arm Rests..... | 14 |
| | Adjusting and Installing T-Style Pin Release Armrests [Figure 3] | 14 |
| 5 | Pin Style Swingaway Leg Rest | 15 |
| | Installing and adjusting pin style leg rests and foot plate [Figure 4] | 15 |
| 6 | Center Pivot Swingaway Legrest | 16 |
| | Installing and removing center pivot swingaway leg rests and foot plate [Figure 5] | 16 |
| 7 | Center Pivot Dual Swingaway Legrest..... | 17 |
| | Installing and adjusting center pivot dual swingaway leg rests [Figure 6] | 17 |
| 8 | Center Pivot Swingaway Elevating Legrest | 18 |

| | |
|--|----|
| Installing and adjusting leg rests and foot plate [Figure 7, Figure 8] | 18 |
| 9 Fixed Back/Cane Stroller Bar | 20 |
| Adjusting back angle [Figure 9, Figure 10] | 20 |
| 10 Fold Down Back Cane/Stroller Bar | 21 |
| Adjusting angle and folding down back [Figure 11, Figure 12] | 21 |
| 11 Recline Back Cane Stroller/Bar | 22 |
| Reclining the Back [Figure 13, Figure 14] | 22 |
| 12 Hinged Stroller Bar (Angle Adjustable) | 23 |
| Adjusting angle of stroller bar [Figure 15] | 23 |
| 13 Recline Cylinder Installation | 24 |
| Installing recline cylinder [Figure 16] | 24 |
| 14 Rear Wheel Positioning | 25 |
| Installing and positioning rear wheels [Figure 17-19] | 25 |
| 15 Wheel Locks | 27 |
| Operating wheel locks [Figure 20, Figure 21] | 27 |
| 16 Adjusting the Patient Operated Wheel Locks | 28 |
| 17 Front Casters | 29 |
| Installing and removing forks and casters [Figure 22 - Figure 25] | 29 |

CONTENTS

| | | |
|----|---|----|
| 18 | Anti-Tippers..... | 33 |
| | Installing/ adjusting anti-tippers [Figure 26, Figure 27] | 33 |
| 19 | Cable Adjustment Procedure | 36 |
| | Adjusting recline cable [Figure 28, Figure 29] | 36 |
| 20 | Cleaning Instructions..... | 38 |
| 21 | Warranty | 39 |

1 General

NOTICE: Information contained within this document is subject to change without notice.

WARNING: DO NOT install this equipment without first reading and understanding this instruction booklet. If you are unable to understand these instructions, contact a healthcare professional, dealer or technical personnel before attempting to install this equipment - otherwise, injury or damage may occur.

NOTE: Check all parts for shipping damages before using. In case of damage, **DO NOT** use the equipment.
Contact the Equipment Supplier for further instructions.

Operating Safety Warnings

Please read and obey all instructions and warnings listed in this manual, ignoring these warnings could result in serious injury to the patient or attendants.

- Ensure anti-tippers are always installed in the correct position when using the wheelchair.
- **Never** lift the wheelchair by the armrests or front rigging.
- Any change of seat depth may require repositioning of the rear wheels; always test the stability of the chair before use.
- **Never** stand on the footplates during transfers in and out of the wheelchair.
- Ensure wheel locks are fully engaged while stopped on any incline/decline and while patient is transferring to and from the wheelchair.
- **Never** tilt the wheelchair on two wheels without assistance. When in any tilt or recline position, this chair must be operated by an attendant.
- **Never** use the wheel locks to stop a moving wheelchair.
- It is not recommended to transport users in vehicles of any kind while seated in the wheelchair. Do not use any kind of wheelchair Tie-Down restraints that are not approved by the FDA.

Features

FEATURES

- 3-48 degrees of tilt
- 6-36 degrees of recline (optional)
- Incredible low 13^{1/4} seat-to-floor height
- Orion back with 1" depth adjustability and Prism Ideal Cushion
- Aluminum seat pan
- Multi adjustable axle plate
- Removable rear wheels with stainless steel or plastic coated hand rims
- Arms heights: 9^{1/2}" – 14" (adjustable), Gel padding
- 70 degree pin style front rigging
- Aluminum or composite foot plates
- Adjustable rear anti tippers
- Padded lap tray
- Locking collar (optional)
- Heel loops
- Power tilt (optional upgraded version)

SPECIFICATIONS

- Seat Widths: 15" - 24"
- Seat Depths: 15" - 24"
- Overall Seat Width: Seat width + 9.5 including (hand rim to hand rim)
- Seat to floor height: 13^{1/4} – 20"
- Rear Wheel: 12", 20", 22" or 24" composite urethane
- Orion back (16", 18", 20" H). Low or tall push canes with stroller bars
- Adjustable back angle: -7°, 0°, 7°, 14°, 21°
- Arm Style: Full length adjustable height t-style (gel or vinyl), full length adjustable height pin release (t-style), full length adjustable height flip back (gel or vinyl)
- Front Rigging: Pin style, swing-away, dual swing-away, elevating leg rests or dual elevating leg rests.
- Weight capacity: 350lbs (159 kg)
- Product weight: 65lbs (including seating system)
- Frame Material: Steel
- Frame Colours: Black or Silver

Safety Inspection Checklist

Initial adjustments should be made to suit your personal body structure needs and preference. Thereafter follow these maintenance procedures:

| Item | Initially | Weekly | Monthly | Periodically |
|--|------------------|---------------|----------------|---------------------|
| <u>GENERAL</u> | | | | |
| Wheelchair rolls straight (no excessive drag or pull to one side) | X | | X | |
| <u>FRAME AND CROSSING TUBES</u> | | | | |
| Inspect for loose or missing hardware | X | | | X |
| Inspect for bent frame or cross-tubes | X | | | X |
| <u>WHEEL LOCKS</u> | | | | |
| Do not interfere with tires when rolling | X | | X | |
| Pivot points free of wear and looseness | X | | X | |
| Wheel locks easy to engage | X | | | X |
| Wheel locks prevent chair from moving when engaged | X | X | | |
| <u>SEAT AND BACK</u> | | | | |
| Inspect for rips or sagging | X | | | X |
| Inspect for loose or broken hardware | X | | X | |
| Inspect cane and hand grips for wear/looseness | X | | X | |
| <u>TIRES</u> | | | | |
| Inspect for flat spots, cracks and wear Caution: as with any vehicle, the wheels and tires should be | X | X | | X |

| | | | | |
|--|---|---|---|---|
| checked periodically for cracks and wear and should be replaced. | | | | |
| <u>REAR WHEELS</u> | | | | |
| If equipped, quick-release axles lock properly | X | X | | |
| No excessive side movement or binding when lifted and spun | X | | | X |
| Inspect for cracked, bent or broken spokes | X | X | | |
| <u>HANDRIMS</u> | | | | |
| Inspect for signs of rough edges or peeling | X | | | X |
| <u>FRONT CASTERS/FORKS</u> | | | | |
| Inspect caster fork assembly for proper tension by spinning caster; caster should come to a gradual stop | X | X | | |
| Adjust bearing system if wheel wobbles or binds to a stop. Ensure wheel bearings are clean and free of moisture. | X | | X | X |
| Check stem caster journal and lock nut for tightness | X | | X | |
| Inspect casters for cracks and wear | X | | | X |
| Inspect for cracked, bent or broken spokes | X | X | | |
| <u>CLEANING</u> | | | | |
| Clean upholstery and armrests | X | | | X |

Troubleshooting

| Chair Veers Right/Left | Wheels Drift | Sluggish Turn or Performance | Caster Flutter | Squeaks and Rattles | Looseness in Chair | |
|------------------------|--------------|------------------------------|----------------|---------------------|--------------------|---|
| | | X | X | X | X | Solutions |
| | | | | | | Check for loose nuts and bolts |
| X | X | | X | | | Check angle adjustable caster assembly |
| X | X | | | | | Check that rear wheels are equally spaced away from seat frame. |

Labels

ORION II

WARNING

**DO NOT OPERATE WITHOUT
THE ANTI-TIP MECHANISM
IN PLACE**

WEIGHT CAPACITY

**350 LBS. (159 kgs)
REFER TO OWNER'S MANUAL**

CAUTION

**MOVING THE REAR AXLE TO
THE FORWARD POSITION MAY
DECREASE THE STABILITY OF
THE WHEEL CHAIR**

2 T-Style Knob Release Arm Rests

Installing and removing T-Style arm rests [Figure 1]

Installing And Removing T-Style Armrest

1. Push armrest into arm socket until lock is engaged into slot.
2. For removal, push and hold release lever ('A'), while lifting armrest from arm socket.

Frame Adjustment Position

1. Remove armrest from the chair.
2. Remove the three inside bolts holding the arm socket to the seat frame ('B').
3. Move the arm socket to the forward mounting position ('C') and replace the three bolts ('B').
4. Re-install the armrest in the arm socket.

Arm Height Adjustment

1. Loosen knob ('D').
2. Lift armrest until desired position is acquired (ranges from 9 ½" – 14" in ½" increments).
3. "Re-tighten" knob ('D').

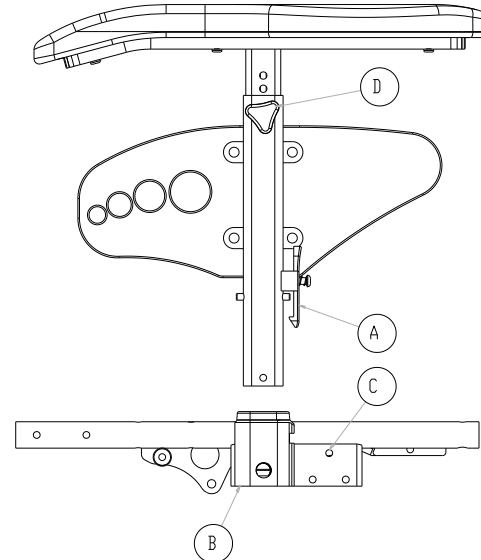

Figure 1

3 Flip-up Arm Rests

Engaging/Disengaging and Adjusting Flip-Up Style Arm Rest [Figure 2]

Engaging And Disengaging Flip-Up Style Armrest

1. To engage, push armrest into arm socket until release lever ('A') is engaged into slot.
2. For flip-up, push and hold release lever ('A'), while lifting armrest from arm socket.

Arm Height Adjustment

1. Loosen knob ('B').
2. Lift armrest until desired position is acquired (ranges from 9 ½" – 14" in ½" increments).
3. "Re-tighten" knob ('B').

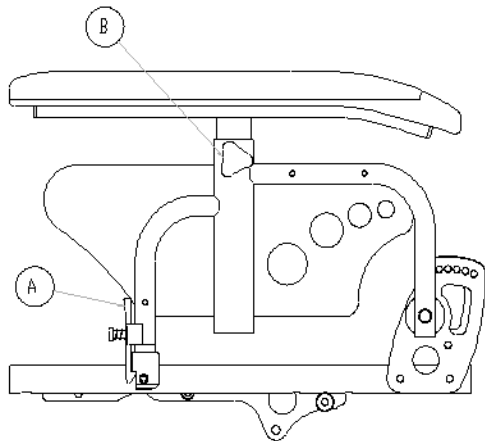

Figure 2

4 T-Style Pin Release Arm Rests

Adjusting and Installing T-Style Pin Release Armrests [Figure 3]

Installing And Removing T-Style Armrest

1. Push armrest into arm socket until lock is engaged into slot.
2. For removal, push and hold release lever while lifting armrest from arm socket.

Arm Height Adjustment

1. Swing out the height adjustment latch lever to disengage the holding pin.
2. Lift armrest until desired position is acquired (ranges from 9" – 13" in ½" increments).
3. Swing in the height adjustment latch lever to engage the holding pin.
4. Repeat this procedure for the opposite T-style arm assembly.

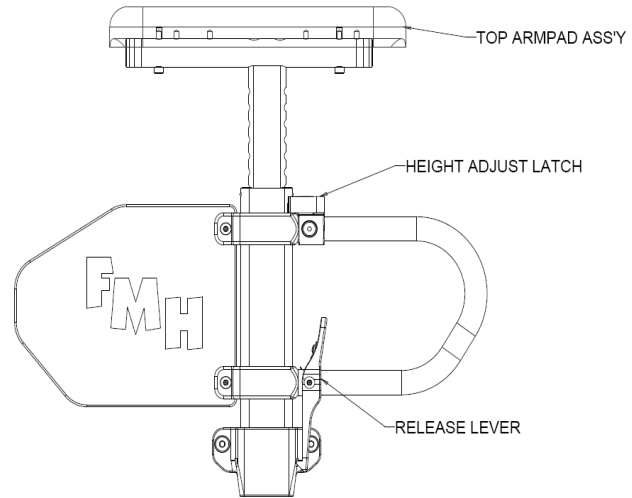

Figure 3

5 Pin Style Swingaway Leg Rest

Installing and adjusting pin style leg rests and foot plate [Figure 4]

Installing And Removing Pin-Style Legrests

1. Position pin style swing-away legrest tabs onto leg rest hanger pins ensuring footplate is facing inward.
2. Swing the legrest inwards such that the legrest latch 'clicks' into place.
3. For removal, push the legrest latch to release the legrest from the locked position and swing outwards. Lift the legrest assembly off the legrest hanger pins.

Footplate Adjustment

1. Remove bolt which holds the footrest extension tube in place. Slide footrest extension tube up or down to desired height.
2. "Re-tighten" bolt.

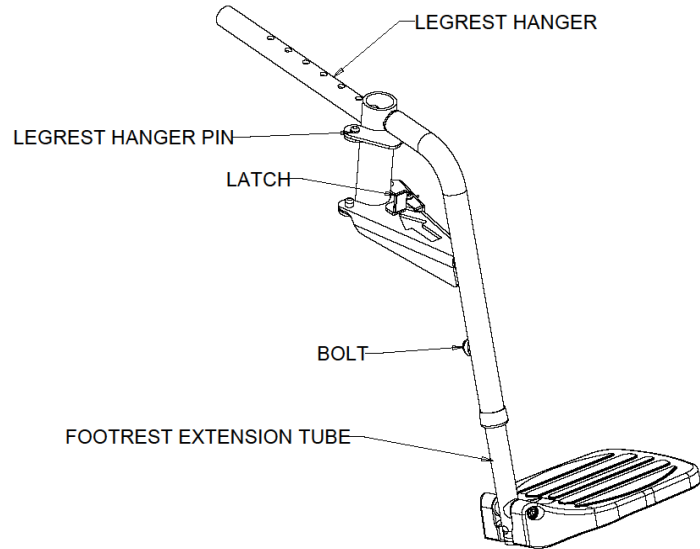

Figure 4

6 Center Pivot Swingaway Legrest

Installing and removing center pivot swingaway leg rests and foot plate [Figure 5]

Installing And Removing Center Pivot Swingaway Legrests

1. Position center pivot swing-away leg rest onto hanger insuring pivot plug sits flush onto hanger tube.
2. Swing the leg rest inwards such that the swingaway latch assembly 'clicks' into place onto the u-bolt.
3. To remove leg rest pull handle releasing the latch mechanism from the u-bolt and swing leg rest outward.

Footplate Length Adjustment

1. Remove bolt which holds the footrest extension tube in place. Slide footrest extension tube up or down to desired height.
2. "Re-install" bolt.

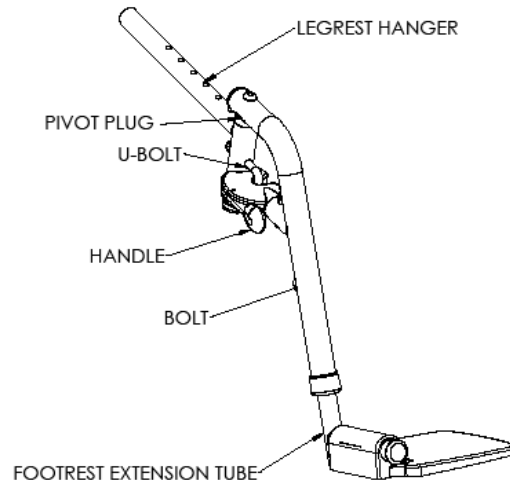

Figure 5

7 Center Pivot Dual Swingaway Legrest

Installing and adjusting center pivot dual swingaway leg rests [Figure 6]

Installing And Removing Center Pivot Dual Swingaway Legrests

1. Position center pivot dual swing-away leg rest onto hanger insuring pivot plug sits flush onto hanger tube.
2. Swing the leg rest such that the dual swingaway latch assembly 'clicks' into place onto the dual swingaway base
3. To remove leg rest pull up on handle releasing the dual swingaway latch mechanism and swing leg rest outward or inwards.

Footplate Length Adjustment

1. Remove bolt which holds the footrest extension tube in place. Slide footrest extension tube up or down to desired height.
2. "Re-install" bolt.

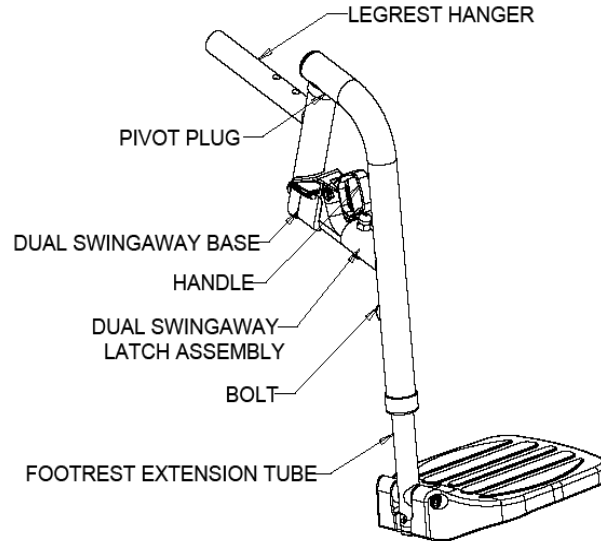

Figure 6

8 Center Pivot Swingaway Elevating Legrest

Installing and adjusting leg rests and foot plate [Figure 7, Figure 8]

Installing And Removing Center Pivot Swingaway Elevating Legrests

1. Insert the elevating leg rest adjustable hanger into the opening of the seat frame tube.
2. Position the elevating leg rest swing-away section onto the hanger by dropping the pivot plug into the open end of the hanger vertical tube.
3. Swing inwards until the swingaway latch engages and locks into the "U – Bolt".
4. Slide the assembly horizontally until the pivot of the leg rest is inline "horizontally" with the user's knee pivot.
5. Loosen the front bolts on the elevating leg rest hanger and slide the vertical post until the pivot of the leg rest is inline "vertically" with the user's knee pivot.
6. Re-tighten bolts on hanger side.
7. Adjust footplate and calf pad position to

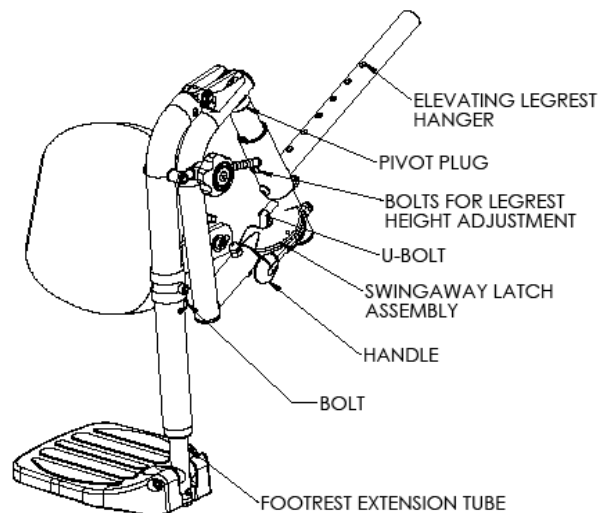

Figure 7

fit user's leg length.

8. To remove elevating leg rest pull handle releasing the latch mechanism from the u-bolt and swing leg rest outward.

Footplate Length Adjustment

1. Remove bolt which holds the footrest extension tube in place. Slide footrest extension tube up or down to desired height.
2. "Re-install" bolt.

Elevating Leg Rest Operation (Refer To Figure 8)

1. To adjust the angle of the elevating leg rest, turn the handle knob counter-clockwise to disengage from the index rod.
2. Lift the leg rest to the desired angle.
3. Re-tighten the handle knob such that the leg rest arm remains firmly in position.

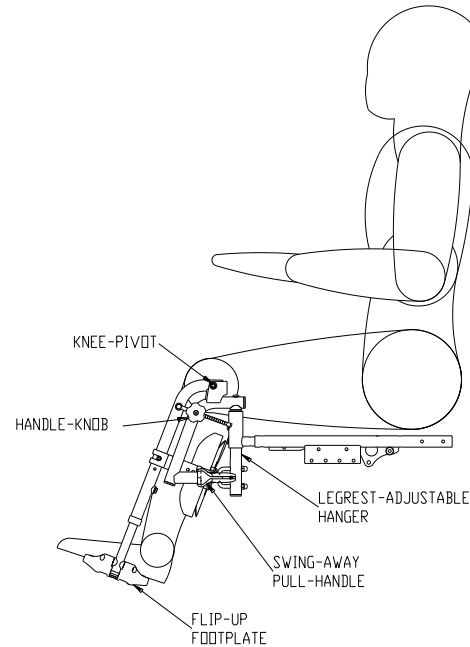

Figure 8

9 Fixed Back/Cane Stroller Bar

Adjusting back angle [Figure 9, Figure 10]

To Adjust Angle

Manufacturer's setting is 90 degrees, with each hole representing 7 degree increments (holes range from 83 degrees to 111 degrees).

1. Remove nut and screw from the top side of the outer and inner mounting plates.
2. Move fixed back cane to desired angle and insert nuts and bolts making sure the coved spacers are in place.

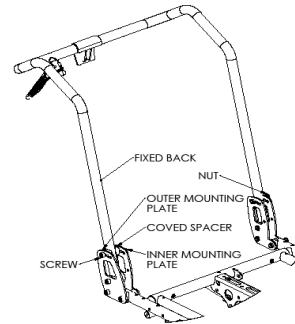

Figure 9

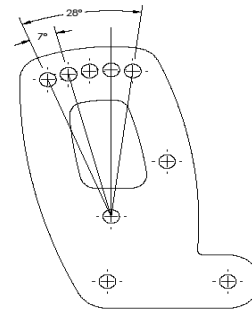

Figure 10

10 Fold Down Back Cane/Stroller Bar

Adjusting angle and folding down back [Figure 11, Figure 12]

To Adjust Angle

Manufacturer's setting is 90 degrees, with each hole representing 7 degree increments (holes range from 83 degrees to 111 degrees). Please note for fixed cane and stroller only angle can be adjusted via locking and unlocking bolts.

1. Remove nut and bolt from the top side of the outer and inner mounting plates.
2. Move fold down back cane to desired angle and insert nuts and bolts making sure the coved spacers are in place.

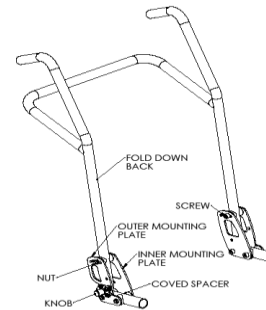

Figure 11

To Fold Down Back

1. Push up knob on the left side to disengage pin in the locked position.
2. Push and hold up the knob on the right side to release back post forward.
3. To return back to an upright position, lift back posts up ensuring right side locks into place and pulling left knob out and down.

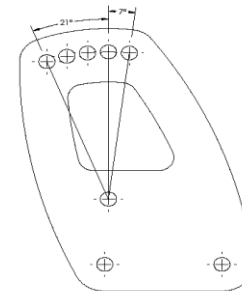

Figure 12

11 Recline Back Cane Stroller/Bar

Reclining the Back [Figure 13, Figure 14]

To Recline Stroller/Cane And Cane Bar

1. To recline the Orion II depress the lever as depicted in Figure 13 and gently force the pushbar in a downward motion to allow the recline.
2. Figure 14 shows a pushbar stroller on an Orion II model without the levers.
3. There are two levers on the handle pushbar. One handle is for tilt of the full wheel chair and the other allows for a recline of the back seat.
4. **WARNING:** If Orion II comes without cylinder assembly attached then make sure to install the cylinder on the frame before depressing the levers on the handle.

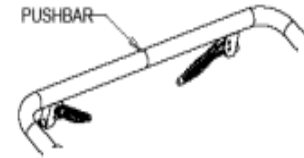

Figure 13

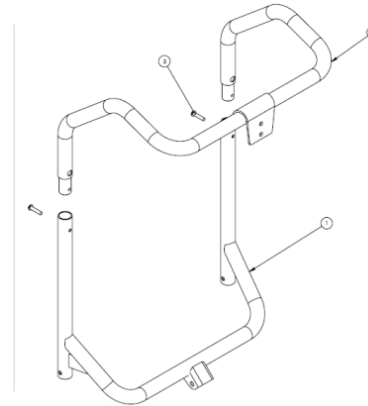

Figure 14

12 Hinged Stroller Bar (Angle Adjustable)

Adjusting angle of stroller bar [Figure 15]

To Adjust Angle Of Stroller Bar

1. Place each hand on the push bar hinge assembly button.
2. Push the bottom inwards to activate the hinge assembly mechanism and rotate the stroller bar to the desired angle for the attendant.
3. Release the buttons to lock the hinge assembly mechanism in place.

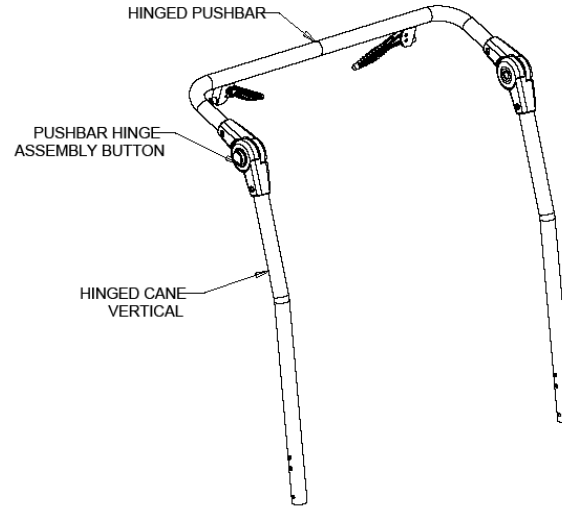

Figure 15

13 Recline Cylinder Installation

Installing recline cylinder [Figure 16]

Please follow the bill of materials listed below when installing the recline back, recline cylinder and mounting brackets.

Assemble recline mount bracket #14 & #15 onto seat frame and fasten with hardware items #3, #4, #6.

1. Assemble recline back cane #2 onto recline mount brackets and fasten with hardware items #4, #5, #6.
2. Assemble stabilis actuator and gas cylinder assembly (#9, #13) onto seat frame bracket using hardware item #11.

Assemble gas cylinder (#9) onto recline back cane using hardware items #7, #8, #10, #12.

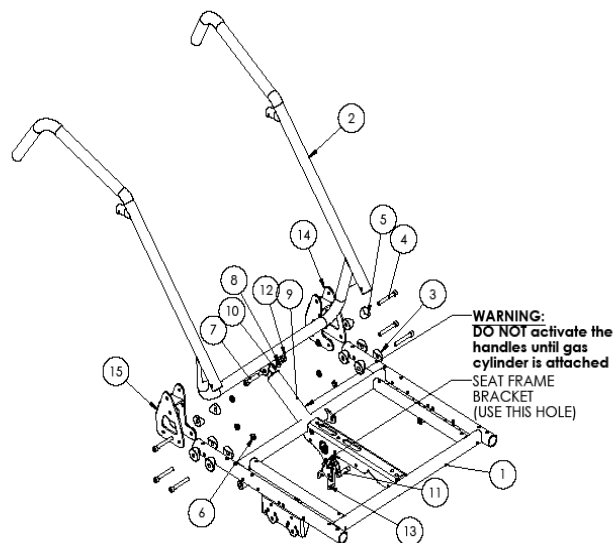

Figure 16

14 Rear Wheel Positioning

Installing and positioning rear wheels [Figure 17-19]

WARNING

After **ANY** adjustments, repair or service and **BEFORE** use, make sure all attaching hardware is tightened securely – otherwise injury or damage may occur.

REMOVING/INSTALLING THE REAR WHEELS

WARNING

If changing the size of the rear wheel or a change in the seat-to-floor height is desired, this procedure **MUST** be performed by a qualified technician.

1. Push in the detent pin of the quick-release axle (with wheel) and pull the axle out through the opening in the center of the rear wheel and shaft spacer.
2. Push in the detent pin of the quick-release axle again and pull the axle out of the rear wheel.
3. To reinstall the rear wheel onto the wheelchair, reverse steps 1 to 2.
4. Repeat this procedure for the other rear wheel assembly

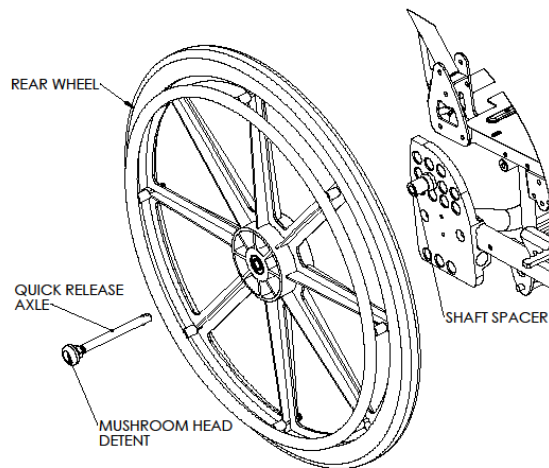

Figure 17

if required.

5. If using the Push-to-Lock or Pull-to-Lock mechanism ensure the wheel locks properly. See the section ADJUSTING THE WHEEL LOCKS.

WARNING

1. Make sure the detent pin and locking pins of the quick-release axle are fully released BEFORE operating the wheelchair.
2. The locking pins MUST be protruding past the inside of the rear wheel axle bushing for a positive lock.
3. Keep locking pins clean.
4. Future Mobility Healthcare Inc. recommends Inserting quick-release axles with the detent pin to the inside of the wheelchair to prevent accidental release during contact activities.

14 REAR WHEEL POSITIONING

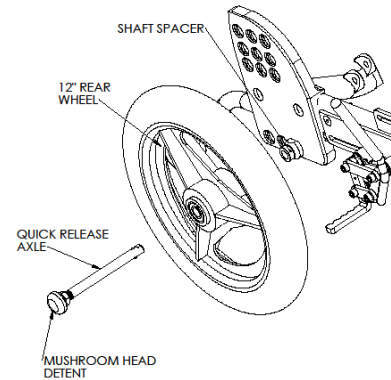

Figure 18

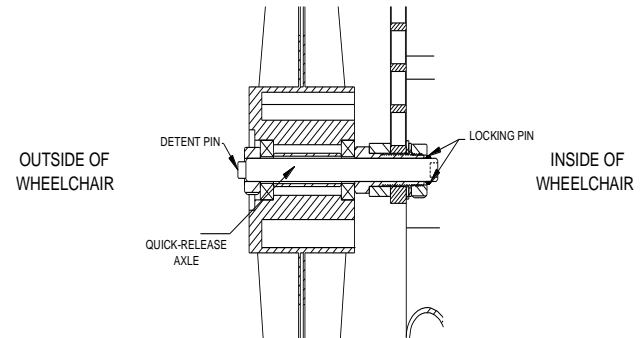

Figure19

15 Wheel Locks

Operating wheel locks [Figure 20, Figure 21]

| |
|----------------|
| WARNING |
|----------------|

DO NOT attempt to stop a moving wheelchair with the wheel locks. **WHEEL LOCKS ARE NOT BRAKES** – otherwise injury or damage may occur.

1. Ensure the wheelchair is not moving before engaging the wheel locks.
2. Perform one (1) of the following:
 - a. Push-to-Lock – to engage, push the wheel lock handle ('A') forward
 - b. Pull-to-Lock – to engage, pull the wheel lock handle ('A') backward
3. Disengage the wheel locks by reversing STEP 2.

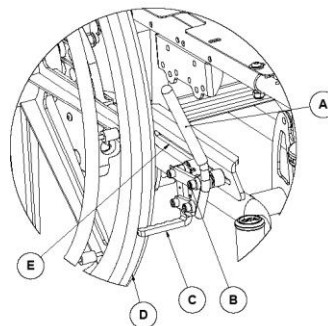

Figure 20

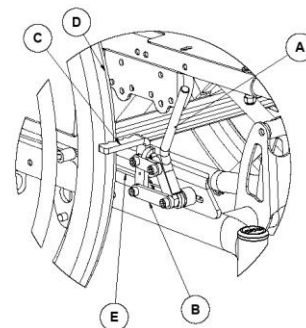

Figure 21

16 Adjusting the Patient Operated Wheel Locks

See [Figure 20, Figure 21]

1. Disengage the wheel locks ('A').
2. Loosen the two (2) locknuts which hold the wheel lock link 1 ('B') shown in the above figure that secure the wheel lock to the wheelchair frame.
3. Reposition the wheel lock along the brake mount plate ('E') so that when engaged, the wheel lock brake shoe ('C') embeds the tire ('D') 1/8" (3/16" for pneumatic tires) and **HOLDS** the occupied wheelchair in place when pushed.
4. Securely tighten the two locknuts securing the wheel lock to the wheelchair frame.
5. Engage the wheel lock.
6. Measure the distance the wheel lock is embedded into the tire
7. Repeat STEPS 1 to 6 until the wheel lock brake shoe embeds the tire and **HOLDS** the occupied wheelchair in place when pushed.
8. Engage both wheel locks and ensure the occupied wheelchair is held in place when pushed.

17 Front Casters

Installing and removing forks and casters [Figure 22 - Figure 25]

WARNING

After **ANY** adjustments, repair or service and **BEFORE** use, make sure all attaching hardware is tightened securely – otherwise injury or damage may occur.

Installing/Replacing Front Casters And Forks

Replacing/Installing Front Casters – Refer To Figure 22

Note: *This procedure can be performed if replacing the exact same size front caster.*

1. Remove the nut ('A'), bolt ('B') and spacers ('C') (not shown) which secure the caster to the fork assembly ('D').
2. Remove the front caster ('E').
3. Slide in the new 4, 5, 6, 7 or 8 inch front caster into the space between the fork.
4. Tighten the nut, bolt and spacers to secure the caster into place.
5. Repeat this procedure for the other front caster wheel assembly if required.
6. To properly tighten caster journal system and guard against flutter, perform the following check:
 - a. Tip back of wheelchair to floor
 - b. Pivot both forks and casters to top of their arc simultaneously.
 - c. Let casters drop to bottom of arc (wheels should swing once to

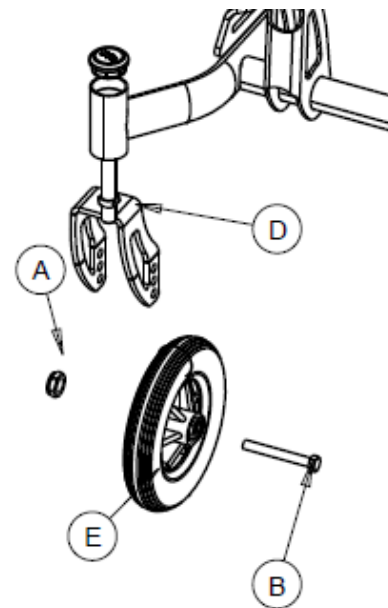

Figure 22

- one-side, then immediately rest in a straight downward position).
- d. Adjust locknuts according to freedom of caster swing.
7. Test wheelchair for maneuverability.
 8. Re-adjust locknuts if necessary and repeat STEPS 6 to 7 until correct.
 9. Snap dust cover over the locknut and stem.

Replacing/Installing Front Forks – Refer To Figure 23

1. Remove the locknut and the cap (E) which secures the caster stem bolt ('D') to the caster housing right under ('E').
2. Drop the front caster and fork assembly out of the caster housing.
3. Remove the locknut ('B') which secures the caster stem to the fork ('C').
4. Follow REPLACING/INSTALLING FRONT CASTERS guide in this section to remove the front caster from the fork assembly.
5. Place the caster in the new fork and assemble with the caster nut and bolt and spacer.
6. Secure the new fork and caster assembly in place by using the locknut and caster stem bolt.
7. Follow steps 5 to 9 of REPLACING/INSTALLING FRONT CASTERS guide to properly install the new fork assembly and prevent fluttering.

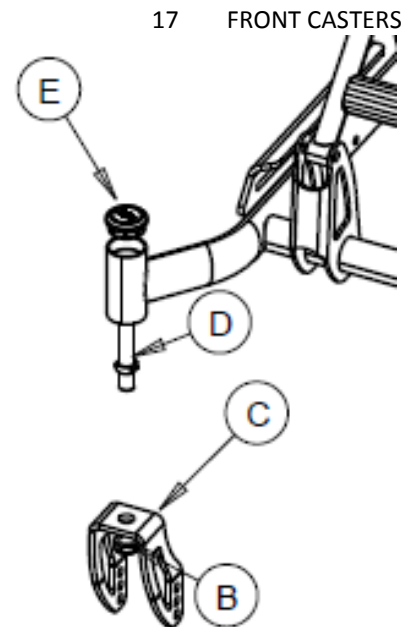

Figure 23

Seat To Floor

1. Follow the values in the tables in Figure 24 and Figure 25 to achieve the desired seat to floor height
2. Ensure that no weight is on the wheelchair while performing the operations
3. Ensure after changing the seat to floor height that the wheelchair is still operational and that no wheel flutter or instability occurs.
4. The wheel should be inserted in the middle hole on the axle plate to achieve the seat to floor heights listed below. In case the user requires more stability the wheel can be inserted in the hole furthest to the back of the chair and if the user requires more maneuverability then the wheel can be inserted in the hole closest to the front of the chair

| FRONT STF | REAR WHEEL | AXEL POS. |
|-----------|------------|-----------|
| 13.25 | 20" | SUPERLOW |
| 13.25 | 16" | 2 |
| 14.5 | 20" | 1 |
| 14.5 | 16" | 3 |
| 15.0 | 20" | 2 |
| 15.5 | 22" | 1 |
| 15.5 | 12" | 4 |
| 16.0 | 24" | 1 |
| 16.0 | 22" | 2 |
| 16.0 | 20" | 3 |
| 16.0 | 12" | 4 |
| 16.5 | 24" | 1 |
| 16.5 | 22" | 2 |
| 16.5 | 24" | 1 |
| 17.0 | 24" | 2 |
| 17.0 | 22" | 3 |
| 18.0 | 16" | 4 |
| 18.0 | 24" | 3 |
| 19.0 | 24" | 3 |
| 20.0 | 24" | 3 |

*

**

* 1" RISER BLOCK REQUIRED

** 2" RISER BLOCK REQUIRED

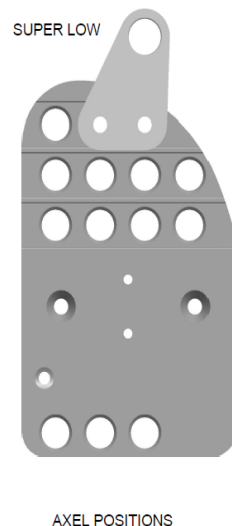
**Figure 24**

| FRONT STF | CASTER | FORK HOLE | STEM LENGTH |
|-----------|--------|-----------|-------------|
| 13.25 | 4" | 1 | X-SHORT |
| | | | |
| 14.5 | 5" | 1 | SHORT |
| 15.0 | 5" | 2 | SHORT |
| 15.5 | 5" | 3 | SHORT |
| 16.0 | 6" | 3 | SHORT |
| 16.5 | 7" | 3 | SHORT |
| | | | |
| 16.0 | 5" | 3 | LONG |
| 16.5 | 6" | 3 | LONG |
| 17.0 | 7" | 3 | LONG |
| 17.0 | 8" | 3 | LONG |
| | | | |
| 18.0 | 8" | 4 | LONG |
| | | | |
| 19.0 | 8" | 4 | LONG |
| | | | |
| 20.0 | 8" | 4 | LONG |

*

**

* 1" RISER BLOCK REQUIRED

** 2" RISER BLOCK REQUIRED

CASTER FORK
X-SHORTCASTER FORK
SHORTCASTER FORK
LONG

Figure 25

18 Anti-Tippers

Installing/ adjusting anti-tippers [Figure 26, Figure 27]

WARNING

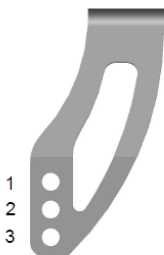
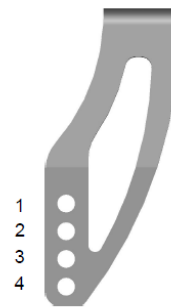
After **ANY** adjustments, repair or service and **BEFORE** use, make sure all attaching hardware is tightened securely – otherwise injury or damage may occur.

Installing/Adjusting The Anti-Tippers

WARNING

Anti-tippers are specific to the different seat-to floor angles and/or seat-to-floor heights. Refer to the chart in this section of the manual for correct usage and adjustment. If these requirements **CANNOT** be achieved, **DO NOT** use the wheelchair. Contact a qualified technician. If changing the seat-to-floor height with or without a change to seat-to-floor angle, the correct anti-tippers **MUST** be used to maintain a 1 ½" to 2" ground clearance.

Seat-to-floor angle of 3 degrees to 6 degrees: if so equipped, anti-tippers **MUST** be attached at all times. In as much as the anti-tippers are an option on this wheelchair (you may order with or without the anti-tippers), Future Mobility Healthcare Inc. strongly recommends ordering the anti-tippers as a safeguard for 470 REVO03REV DATE: 08/14/13

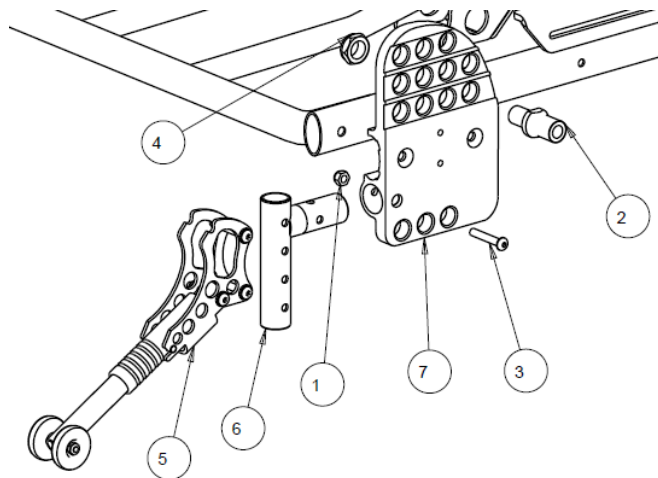

Figure 26

the wheelchair user.

Anti-tippers **MUST** be fully engaged and snap buttons fully protruding out of adjustment holes.

Ensure both anti-tippers are adjusted to the same mounting hole.

Installing Anti-Tippers

1. Insert anti-tipper (5) into the tube weldment (6) as show in Fig 26 making sure to align the two holes of the anti-tipper to the tube weldment.
2. Screw two bolts to secure the anti-tipper (5) to the tube weldment (6).
3. Insert the tube weldment into the hole of the axle plate (7).
4. While inserting the tube into the axle plate align the two holes on the axle plate and the tube.
5. Once the holes are aligned, screw bolt (3) and nut (1) through the holes to secure anti-tipper to the wheel chair.
6. Once properly assembled anti-tippers are ready to use.
7. Refer to **FLIPPING THE ANTI-TIPPERS** below for flip up and flip down instructions.

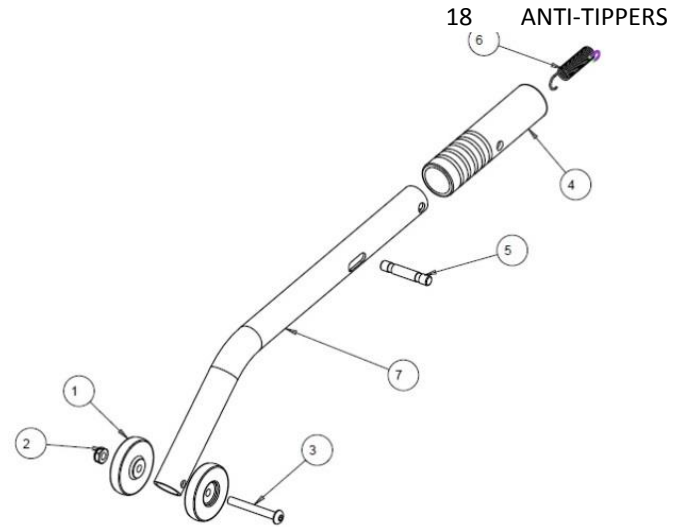

Figure 27

8. The height of the anti-tippers can be changed by aligning the two holes on the tube weldment and the anti-tipper. Refer to item (6) in Fig 26.
9. If you are having difficulty attaching the anti-tipping assembly to the wheel chair please call a certified health care technician for more help.

Note: A 1 ½ “to 2” clearance between the bottom of the anti-tipper wheels and the ground/floor MUST be maintained at all times.

Flipping The Anti-Tippers

1. Press the snap button on the anti-tip assembly and adjust the anti-tip slide tube up or down until a 1 ½ “to 2” clearance from the ground is achieved.
2. Check to make sure that the snap buttons are fully engaged in the adjustment holes.

19 Cable Adjustment Procedure

Adjusting recline cable [Figure 28, Figure 29]

1. Insert the cable (upper) completely into the release lever housing.
2. Feed the longer lower cable through the cable bracket as shown.
3. Insert a 7/32 retaining clip onto the groove on the adapter cable to fix the Mec Lock to the cable.
4. Push the cable holder down to compress the spring and place the ball end of the cable through the slotted arm of the cable holder and into the groove of the ball lock cylinder as shown in Figure 28.
5. Release the cable holder to keep the ball end cable in place as shown in Figure 29.
6. To adjust the cable, loosen both lower lock nuts and move the adaptor to shorten or lengthen the cable adjustment length as needed. If this length is decreased too much slippage of the lock may occur. This must be avoided.
7. Actuate the release lever to assure that the mechanical lock operates correctly and does not slip without actuating the release

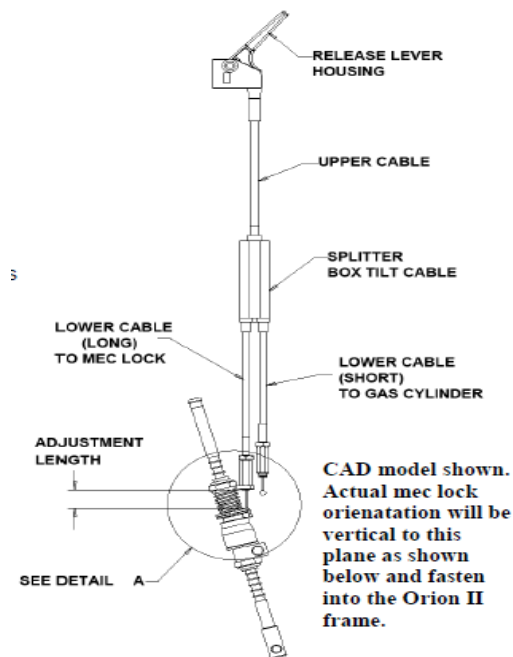

Figure 28

lever.

8. After the proper adjustment is obtained, tighten the lower lock nuts on the adapter cable. Use the minimum amount of torque necessary to lock it into position – (1/4 turn of wrench is maximum).

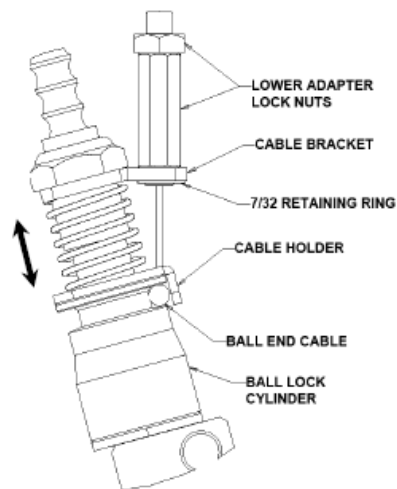

Figure 29

20 Cleaning Instructions

Seat and Back

- Remove the outer and inner cover if required and hand wash with a small amount of detergent
 - Hang to dry, do not machine dry or wring out
- Use multipurpose disinfectant to spray seat, scrub with soft brush.
 - Test an inconspicuous area first for colour-fastness
- **DO NOT USE HOT AIR FOR DRYING.**
- **DO NOT IMMERSE** the cushion or back foam in water or cleaning solution.
- Some colour leeching from the cover and dying the foam is normal and cannot be washed out

Frame, Armrest, Footrests And Other Components

- Spray the frame and components with multi-purpose disinfecting detergent, scrub with **soft** brush.
- Rinse well and dry with a soft cloth.
- **DO NOT USE HOT AIR FOR DRYING.**

By wiping down with a soft cloth after rinsing mildew buildup will be minimized.

IMPORTANT:

DO NOT USE ABRASIVE POWDERS OR SCOURING PADS ON PAINTED SURFACES

DO NOT SUBMERGE CHAIR IN WATER

RINSE WITH A DAMP RAG AFTER CLEANING TO ENSURE THAT ANY SOAP RESIDUE IS REMOVED

DO NOT USE CLEANING PRODUCTS WITHOUT CONSULTING THE PRODUCTS' INSTRUCTIONS AND TAKING APPROPRIATE PRECAUTIONS FOR HUMAN EXPOSURE TO CHEMICALS

21 Warranty

This warranty is extended only to the original purchaser/user of our products.

Future Mobility Healthcare Inc. ("FMHI") warrants its Orion II Wheelchair parts and miscellaneous components for a period of one year from date of purchase to be free from defects in material and workmanship. The frame is warranted for the lifetime of the original purchaser/user. The Orion Back is warranted for two (2) years and the upholstery for 90 days, upon normal usage by original purchaser. If within this warranty period the product shall be proven to be defective, such product shall be repaired or replaced, at FMHI discretion. FMHI's sole obligation and your exclusive remedy under this warranty shall be limited to the repair and/or replacement of the product or its parts. This warranty does not include any labour or shipping charges incurred in replacement part installation or repair of any product.

For warranty service, please contact the dealer from whom you purchased your FMHI product. In the event you do not receive satisfactory warranty service, please write directly to FMHI. Provide the dealer's name, address, model number, date of purchase and indicate the nature of the defect.

DO NOT return products to FMHI without our prior consent. The defective unit or parts must be returned for warranty inspection within thirty (30) days of the return authorization date. (FMHI will issue a return authorization number). Please prepay all shipping charges; C.O.D. shipments will be refused.

LIMITATIONS and EXCLUSIONS: This warranty shall not apply to problems arising from normal wear or failure to adhere to the enclosed instructions. Products subjected to negligence, accident, improper usage, maintenance or storage; or products modified without FMHI written consent including, but not limited to: modification through the use of any unauthorized parts or attachments; products damaged by reason or repairs made to any component without the specific consent of FMHI, or products repaired by anyone other than a FMHI dealer. Such evaluation shall be determined by FMHI.

The foregoing warranty is exclusive and in lieu of all other expressed warranties. It shall not extend beyond the duration of the expressed warranty provided herein and the remedy for violations of any implied warranty shall be limited to repair or replacement of the defective product pursuant to the terms contained herein. FMHI shall not be liable for any consequential or incidental damages whatsoever.

Cut below this line

Warranty Registration Form

To validate your Future Mobility HealthCare warranty, please complete the below form and return it the address at the end of this form. Visit online at www.futuremobility.ca for more Future Mobility Products.

Name: _____
Street Address: _____
City/Country/Postal Code: _____
Telephone: _____
Purchased Date: _____
Purchased From (Dealer Name and Address): _____
Product Purchased: _____
Serial Number: _____

Print and Mail it to:
Future Mobility Healthcare Products
3223 Orlando Drive
Mississauga, Ontario, L4V 1C5
Fax: 905-671-3377

CANADA

Future Mobility Healthcare Inc.

3223 Orlando Drive

Mississauga, ON, L4V 1C5

Ph: 905-671-1661 - 1 888 737 - 4011

Fax: 905-671-3377

e-mail: customerservice@futuremobility.ca

www.futuremobility.ca



FUTURE
MOBILITY HEALTHCARE INC.

USA

Future Mobility Products US LLC

1 Buffalo River Place

Buffalo, NY, 14210

Ph: 716-783-9130 - 1 855-938-8873

Fax: 716-783-9236

e-mail: customerservice@futuremobility.com

www.futuremobility.com



FUTURE
MOBILITY PRODUCTS