

[www.fishman.com](http://www.fishman.com)

***FISHMAN***

**USER GUIDE  
PRESYS PLUS ONBOARD PREAMP**

# Presys Plus Quick Start

---

- 1. Set the controls** • Set **volume** and **notch** off. Set the **bass, middle, treble** and **brilliance** controls to center.
- 2. Plug in** • Connect the Presys Plus to an amplifier or PA with a ¼-inch instrument cable. The battery light (**batt**) will flash once quickly to indicate it has switched on.
- 3. Turn up** • Raise the **volume** and adjust the **bass, middle, treble** and **brilliance** controls to your liking.

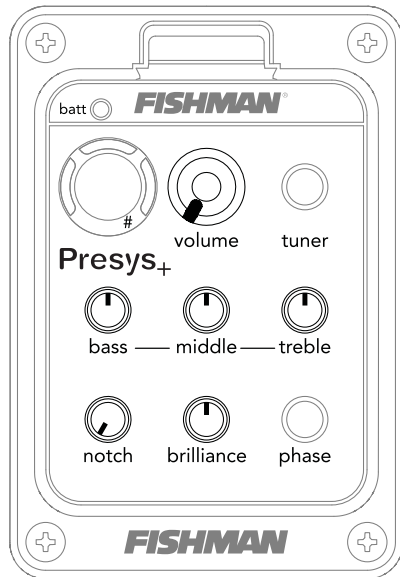

# Presys Plus Controls

---

**Volume** • For the cleanest signal, set the **volume** knob as high as possible, without causing distortion or feedback.

**Bass** • Boost here to add depth and weight to the sound of the guitar.

**Middle** • Turn the **middle** knob all the way left for a smooth “scooped out” tone at high volume levels. Raise the **middle** knob to the right of center to add midrange “bite” to the sound.

**Treble** • Boost to cut through the mix. Cut to mellow and subdue the sound.

**Brilliance** • This slider can add shimmer and sparkle to your sound. It zeros in on crisp high frequency tones, the realm of harmonics and acoustic string sound. Lower the **brilliance** slider to reduce finger noise and fret buzz.

**Notch** • Tune the **notch** filter to remove low-end feedback. Raise the **volume** until feedback occurs, then slowly turn the **notch** to the right until the feedback is eliminated.

**Phase** • Use the **phase** switch to improve bass response at low volume and suppress feedback at high volume.

**Tuner** • Use the tuner lights as shown below to tune your instrument.



"A" note  
below pitch



"A" note  
in tune



"A" note  
above pitch



"A#" note  
in tune

**Battery** • When the **batt** indicator lights steadily it is time to change the battery. To conserve power, unplug the instrument and turn off the tuner when not in use. Replace the battery by flipping open the preamp body using the latch located above the Fishman logo. Be sure to observe the correct polarity during this installation.

# Sample EQ Settings

---

## Fingerstyle

This will add fullness to the bass and definition to the treble.

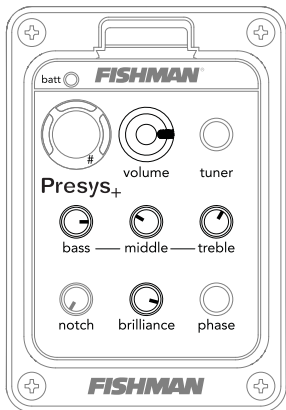

## “Scooped” Mid

This setting emphasizes extreme bass and treble

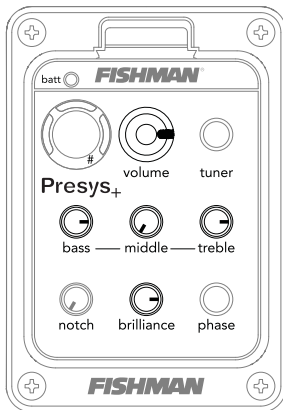

---

## Strummer

A good setting for strumming chords.

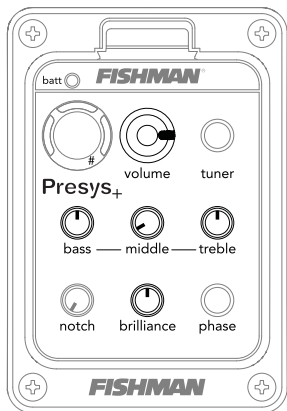

## Cut Through the Mix

When you need to be heard through a loud band.

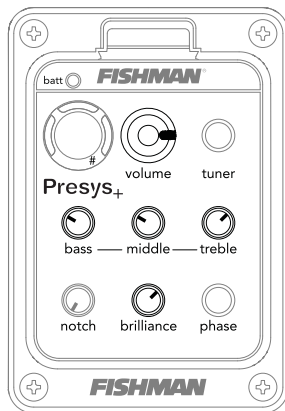

***FISHMAN***

[www.fishman.com](http://www.fishman.com)



PRESYS PREAMP  
CUT-OUT TEMPLATE

www.fishman.com

**FISHMAN**

NOTE: When using mounting brackets,  
screw holes should be .093" [2.38mm]

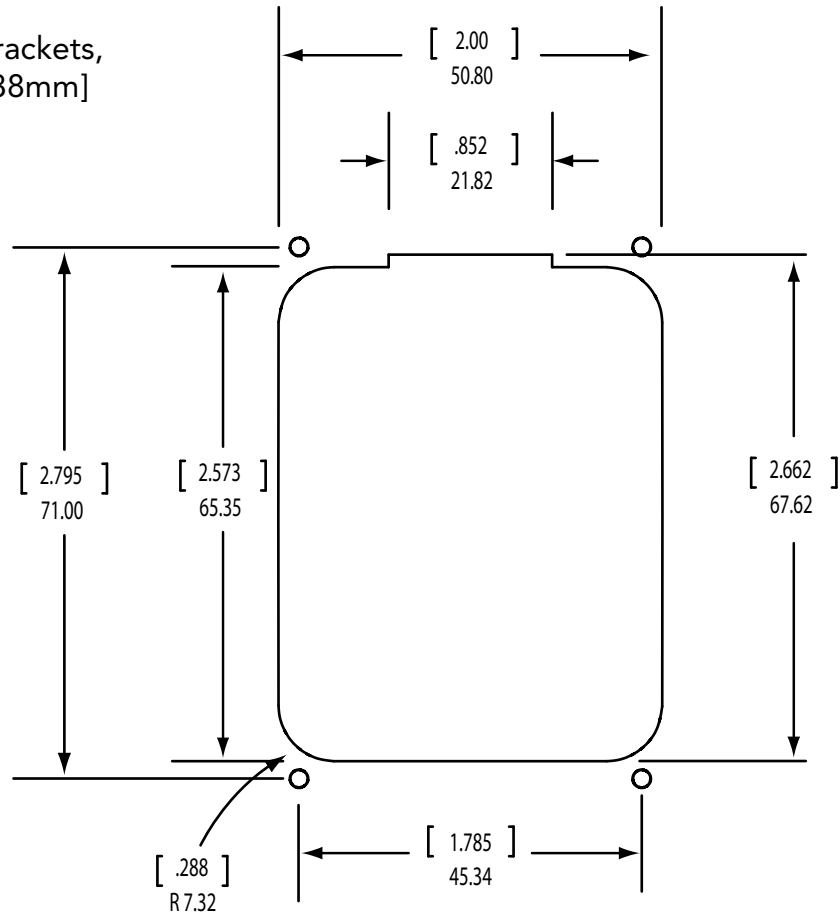

**FISHMAN**<sup>®</sup>  
www.fishman.com

## Step 1: Endpin Jack Installation

Widen the endpin hole to  $15/32$ " (11.9mm) to accommodate the endpin output jack. Refer to [Endpin Jack installation guide](#) for further details.

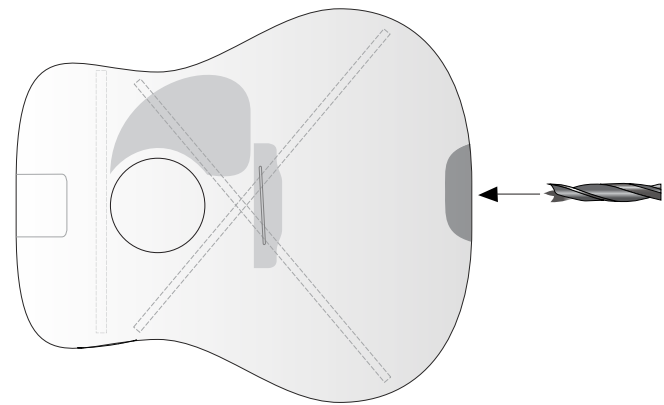

## Step 2: Sonicore Pickup Installation

Drill a  $3/32$ " hole (2.4mm) in the saddle slot for the pickup wire, no less than  $.100$ " (2.5mm) from nearest string. Refer to [Sonicore installation guide](#) for further details.

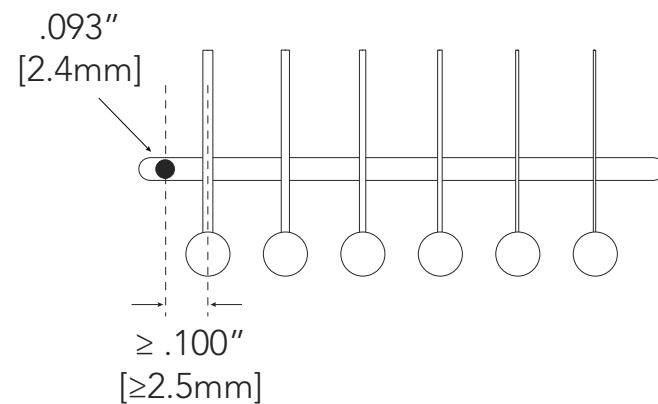

## Step 3: Preamp Location

Position the preamp on the flattest convenient surface on the side of the instrument that also allows internal clearance. Cut out cavity for preamp using supplied template.

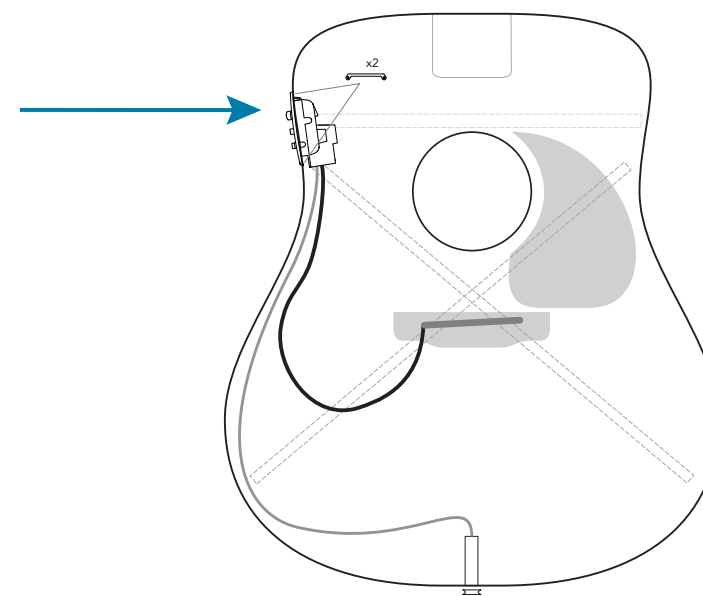

## Step 4: Attach Preamp

Attach the preamp to the guitar using the supplied screws and mounting brackets.

