



WF8624AH(A/C/D/F/G/H/R/S/T/V/W/Z) WF8624NH(A/C/D/F/G/H/R/S/T/V/W/Z)
WF8622AH(A/C/D/F/G/H/R/S/T/V/W/Z) WF8622NH(A/C/D/F/G/H/R/S/T/V/W/Z)
WF8620AH(A/C/D/F/G/H/R/S/T/V/W/Z) WF8620NH(A/C/D/F/G/H/R/S/T/V/W/Z)
WF8502AH(A/C/D/F/G/H/R/S/T/V/W/Z) WF8502NH(A/C/D/F/G/H/R/S/T/V/W/Z)
WF8500AH(A/C/D/F/G/H/R/S/T/V/W/Z) WF8500NH(A/C/D/F/G/H/R/S/T/V/W/Z)
WF8508AH(A/C/D/F/G/H/R/S/T/V/W/Z) WF8508NH(A/C/D/F/G/H/R/S/T/V/W/Z)
WF8624AM(A/C/D/F/G/H/R/S/T/V/W/Z) WF8624NM(A/C/D/F/G/H/R/S/T/V/W/Z)
WF8622AM(A/C/D/F/G/H/R/S/T/V/W/Z) WF8622NM(A/C/D/F/G/H/R/S/T/V/W/Z)
WF8620AM(A/C/D/F/G/H/R/S/T/V/W/Z) WF8620NM(A/C/D/F/G/H/R/S/T/V/W/Z)
WF8502AM(A/C/D/F/G/H/R/S/T/V/W/Z) WF8502NM(A/C/D/F/G/H/R/S/T/V/W/Z)
WF8500AM(A/C/D/F/G/H/R/S/T/V/W/Z) WF8500NM(A/C/D/F/G/H/R/S/T/V/W/Z)
WF8508AM(A/C/D/F/G/H/R/S/T/V/W/Z) WF8508NM(A/C/D/F/G/H/R/S/T/V/W/Z)

Washing Machine

user manual



100%
Recycled Paper

This manual is made with 100% recycled paper.

imagine the possibilities

Thank you for purchasing this Samsung product.
To receive more complete service, please register
your product at

www.samsung.com/register



features of your new samsung washing machine

Your new washing machine will change the way you feel about doing laundry. From its super-size capacity to its energy efficiency, the Samsung washing machine has all the features to turn a mundane chore into a pleasure.

- **Baby Care System**

Your Samsung washing machine includes wash programs that adds protection to the clothing of children with sensitive skin.

These programs reduce skin irritation in children by minimizing detergent residue. In addition, these programs classify laundry into various types and the wash is performed according to the laundry characteristics so that children feel refreshingly clean whenever they put on their clothes.

- **Child Lock**

The Child Lock function ensures that curious little hands are kept out of your washing machine.

This safety feature stops your children from playing with the operation of the washing machine, and alerts you when it is activated.

- **Delay End**

Delay a cycle for up to 19 hours in one-hour increments and increase the convenience of using your washing machine especially when you have to go out.

- **Quick Wash**

No time to lose! Less than 30 minutes wash will give you time to run out before it's too late.

Our 29 minute Quick Wash program can be the solution to your busy life. Now you can wash your favourite clothes in only 29 minutes!

- **Hand Wash Program**

Special care can be determined by the appropriate temperature, the gentle wash action and the appropriate amount of water.

- **Ceramic Heater for Durability & Energy Saving (selected models)**

Our truly innovative Ceramic Heater is twice as durable as regular heaters.

That saves you money on repairs. Plus, it eliminates the scale of hard water and save energy.

- **Wide door**

Extra wide door aperture for convenient viewing! Easily add and remove laundry, especially for large sized laundry items such as bedding, towels etc.

This manual contains important information on the installation, use, and care of your new Samsung washing machine. Refer to it for descriptions of the control panel, instructions on how to use the washing machine, and tips for making the most of its state-of-the-art features and functions. The “**Troubleshooting and information codes**” section on page 33 tells you what to do if something goes wrong with your new washing machine.

safety information

Congratulations on your new Samsung ActivFresh™ washer. This manual contains important information on the installation, use and care of your appliance. Please take time to read this manual to take full advantage of your washer's many benefits and features.

WHAT YOU NEED TO KNOW ABOUT SAFETY INSTRUCTIONS











Please read this manual thoroughly to ensure that you know how to safely and efficiently operate the extensive features and functions of your new appliance and retain it at a safe place near the appliance for your future reference. Use this appliance only for its intended purpose as described in this instruction manual.

Warnings and Important Safety Instructions in this manual do not cover all possible conditions and situations that may occur. It is your responsibility to use common sense, caution, and care when installing, maintaining, and operating your washer.

Because these following operating instructions cover various models, the characteristics of your washer may differ slightly from those described in this manual and not all warning signs may be applicable. If you have any questions or concerns, contact your nearest service center or find help and information online at www.samsung.com.

IMPORTANT SAFETY SYMBOLS AND PRECAUTIONS

What the icons and signs in this user manual mean:

 WARNING	Hazards or unsafe practices that may result in severe personal injury, death and/or property damage.
 CAUTION	Hazards or unsafe practices that may result in personal injury and/or property damage.
 CAUTION	To reduce the risk of fire, explosion, electric shock, or personal injury when using your washer, follow these basic safety precautions:
	Do NOT attempt.
	Do NOT disassemble.
	Do NOT touch.
	Follow directions explicitly.
	Unplug the power plug from the wall socket.
	Make sure the machine is grounded to prevent electric shock.
	Call the service centre for help.
	Note

These warning signs are here to prevent injury to you and others.

Please follow them explicitly.

After reading this section, keep it in a safe place for future reference.

-  Read all instructions before using the appliance.

As with any equipment using electricity and moving parts, potential hazards exist. To safely operate this appliance, become familiar with its operation and exercise care when using it.



This appliance is not intended for use by persons (including children) with reduced physical, sensory or mental capabilities, or lack of experience and knowledge, unless they have been given supervision or instruction concerning use of the appliance by a person responsible for their safety.

Children should be supervised to ensure that they do not play with the appliance.

If the plug (power supply cord) is damaged, it must be replaced by the manufacturer or its service agent or a similarly qualified person in order to avoid a hazard.

This appliance should be positioned to be accessible to the power plug, the water supply tabs and the drain pipes.

For washing machines with ventilation openings in the base, ensure that the opening is not obstructed by carpet or any other obstacles.

Use the new hose-sets and old hose-sets should not be reused.

INSTRUCTION ABOUT THE WEEE MARK



Correct Disposal of This Product (Waste Electrical & Electronic Equipment)

(Applicable in the European Union and other European countries with separate collection systems)

This marking on the product, accessories or literature indicates that the product and its electronic accessories (e.g. charger, headset, USB cable) should not be disposed of with other household waste at the end of their working life. To prevent possible harm to the environment or human health from uncontrolled waste disposal, please separate these items from other types of waste and recycle them responsibly to promote the sustainable reuse of material resources.

Household users should contact either the retailer where they purchased this product, or their local government office, for details of where and how they can take these items for environmentally safe recycling.

Business users should contact their supplier and check the terms and conditions of the purchase contract. This product and its electronic accessories should not be mixed with other commercial wastes for disposal.

safety information



SEVERE WARNING SIGNS FOR INSTALLATION



The installation of this appliance must be performed by a qualified technician or service company.

- Failure to do so may result in electric shock, fire, an explosion, problems with the product, or injury.

The appliance is heavy, take care upon lifting it

Plug the power cord into an AC 220V/50Hz/15A wall socket or higher and use the socket for this appliance only. In addition, do not use an extension cord.

- Sharing a wall socket with other appliances using a power strip or extending the power cord may result in electric shock or fire.
- Ensure that the power voltage, frequency and current are the same as those of the product specifications. Failure to do so may result in electric shock or fire. Failure Plug the power plug into the wall socket firmly.

Remove all foreign substances such as dust or water from the power plug terminals and contact points using a dry cloth on a regular basis.

- Unplug the power plug and clean it with a dry cloth.
- Failure to do so may result in electric shock or fire.

Plug the power plug into the wall socket in the right direction so that the cord runs towards the floor.

- If you plug the power plug into the socket in the opposite direction, the electric wires within the cable may be damaged and this may result in electric shock or fire.

Keep all packaging materials well out of the reach of children, as packaging materials can be dangerous to children.

- If a child places a bag over its head, it may result in suffocation.

When the appliance or power plug or power cord is damaged, contact your nearest service centre.



This appliance must be properly grounded.

Do not ground the appliance to a gas pipe, plastic water pipe, or telephone line.

- This may result in electric shock, fire, an explosion, or problems with the product
- Never plug the power cord into a socket that is not grounded correctly and make sure that it is in accordance with local and national codes.



Do not install this appliance near a heater, inflammable material.

Do not install this appliance in a humid, oily or dusty location, in a location exposed to direct sunlight and water (rain drops).

Do not install this appliance in a location of low temperature

- Frost may cause tubes to burst

Do not install this appliance in a location where gas may leak.

- This may result in electric shock or fire.

Do not use an electric transformer.

- It may result in electric shock or fire.

Do not use a damaged power plug, damaged power cord or loose wall socket.

- This may result in electric shock or fire.

Do not pull or excessively bend the power cord.

Do not twist or tie the power cord.

Do not hook the power cord over a metal object, place a heavy object on the power cord, insert the power cord between objects, or push the power cord into the space behind the appliance.

- This may result in electric shock or fire.

Do not pull the power cord, when unplugging the power plug.

- Unplug the power plug by holding the plug.
- Failure to do so may result in electric shock or fire.

Do not lay the power cord and tubes where you may fall over them.



CAUTION SIGNS FOR INSTALLATION



This appliance should be positioned in such a way that it is accessible to the power plug.

- Failure to do so may result in electric shock or fire due to electric leakage.

Install your appliance on a level and hard floor that can support its weight.

- Failure to do so may result in abnormal vibrations, moves, noise, or problems with the product.



SEVERE WARNING SIGNS FOR USING



If the appliance is flooded, cut the water supply and power immediately and contact your nearest service centre.

- Do not touch the power plug with wet hands
- Failure to do so may cause electric shock

If the appliance generates a strange noise, a burning smell or smoke, unplug the power plug immediately and contact your nearest service centre.

- Failure to do so may result in electric shock or fire.

In the event of a gas leak (such as propane gas, LP gas, etc.), ventilate immediately without touching the power plug. Do not touch the appliance or power cord.

- Do not use a ventilating fan.
- A spark may result in an explosion or fire.

Do not let children play in or on the washer. In addition, when disposing of the appliance, remove the washer door lever.

- If trapped inside, the child may become trapped and suffocate to death.

Make sure to remove the packaging (sponge, styrofoam) attached to the bottom of the washer before using it.

safety information



Do not wash items contaminated with gasoline, kerosene, benzene, paint thinner, alcohol or other flammable or explosive substances.

- This may result in electric shock, fire or an explosion.

Do not open the washer door by force while it is operating (high-temperature washing/drying/spinning).

- Water flowing out of the washer may result in burns or cause the floor to be slippery.

This may result in injury.

- Opening the door by force may result in damage to the product or injury.

Do not insert your hand under the washer.

- This may result in injury.

Do not touch the power plug with wet hands.

- This may result in electric shock.

Do not turn the appliance off by unplugging the power plug while an operation is in progress.

- Plugging the power plug into the wall socket again may cause a spark and result in electric shock or fire.

Do not let children or infirm persons use this washer unsupervised. Do not let children climb in the appliance

- Failure to do so may result in electric shock, burns or injury.

Do not insert your hand or a metal object under the washer while it is operating.

- This may result in injury.

Do not unplug the appliance by pulling at the power cord, always grip plug firmly and pull straight out from the outlet.

- Damage to the cord may cause short-circuit, fire and/or electric shock



Do not attempt to repair, disassemble, or modify the appliance yourself.

- Do not use any fuse (such as copper, steel wire, etc.) other than the standard fuse.
- When repairing or reinstalling the appliance is required, contact your nearest service centre.
- Failure to do so may result in electric shock, fire, problems with the product, or injury.



If any foreign substance such as water has entered the appliance, unplug the power plug and contact your nearest service centre.

- Failure to do so may result in electric shock or fire.

When the water supply hose comes loose from the faucet and floods the appliance, unplug the power plug.

- Failure to do so may result in electric shock or fire.

Unplug the power plug when the appliance is not being used for long periods of time or during a thunder/lightning storm.

- Failure to do so may result in electric shock or fire.



CAUTION SIGNS FOR USING



When the washer is contaminated by a foreign substance such as detergent, dirt, food waste, etc., unplug the power plug and clean the washer using a damp and soft cloth.

- Failure to do so may result in discoloration, deformation, damage or rust.

The front glass may be broken by a strong impact. Take care when using the washer.

- When the glass is broken, it may result in injury.

After a water supply failure or when reconnecting the water supply hose, open the faucet slowly.

Open the faucet slowly after a long period of non-use.

- The air pressure in the water supply hose or the water pipe may result in damage to a part or in water leakage.

If a drain error occurs during an operation, check if there is a draining problem.

- If the washer is used when it is flooded because of a draining problem, it may result in electric shock or fire due to electric leakage.

Insert the laundry into the washer completely so that laundry does not get caught in the door.

- If laundry gets caught in the door, it may result in damage to the laundry or the washer, or result in water leakage.

Ensure that the faucet is turned off when the washer is not being used.

- Ensure that the screw on the water supply hose connector is properly tightened.
- Failure to do so may result in property damage or injury.

Check if the rubber seal is not contaminated by foreign substances (waste, thread, etc).

- If the door is not closed completely, it may result in water leakage.

Open the faucet and check if the water supply hose connector is firmly tightened and that there is no water leaking before using the product.

- If the screws or the water supply hose connector are loose, it may result in water leakage.

To reduce the risk of fire or explosion:

- Under certain conditions, hydrogen gas may be produced in a hot water system such as your hot water heater that has not been used for two weeks or more. **HYDROGEN GAS IS EXPLOSIVE.** If your hot water system has not been used for two weeks or more, turn on all hot water taps in your home, and let the water flow for several minutes before using your washing machine. This will release any hydrogen gas build-up. Since hydrogen gas is flammable, do not smoke or light an open flame during this time. Ventilate immediately without touching the power plug if there is a gas leak.

The product you have purchased is designed for domestic use only.

The use for business purposes qualifies as product misuse.

In this case, the product will not be covered by the standard warranty provided by Samsung and no responsibility can be attributed to Samsung for malfunctions or damages resulting from such misuse.

safety information



Do not stand on top of the appliance or place objects (such as laundry, lighted candles, lighted cigarettes, dishes, chemicals, metal objects, etc.) on the appliance.

- This may result in electric shock, fire, problems with the product, or injury.

Do not spray volatile material such as insecticide onto the surface of the appliance.

- As well as being harmful to humans, it may also result in electric shock, fire or problems with the product.

Do not place an object that generates a electromagnetic field near the washer.

- This may result in injury due to a malfunction.

Since the water drained during a high-temperature wash or drying cycle is hot, do not touch the water.

- This may result in burns or injury.

Do not wash, spin or dry water-proof seats, mats or clothing (*) unless your appliance has a special program for washing these items.

- Do not wash thick, hard mats even if the washer mark is on the care label.
- This may result in injury or damage to the washer, walls, floor or clothing due to abnormal vibrations.

* Woollen bedding, rain covers, fishing vests, ski pants, sleeping bags, diaper covers, sweat suits, and bicycle, motor cycle, car covers, etc.

Do not operate the washer when the detergent box is removed.

- This may result in electric shock or injury due to water leakage.

Do not touch the inside of the tub during or just after drying as it is hot.

- This may result in burns.

Do not insert your hand into the detergent box after opening it.

- This may result in injury as your hand may be caught by the detergent input device. Do not place any objects (such as shoes, food waste, animals) other than laundry into the washer.
- This may result in damage to the washer, or injury and death in the case of pets due to the abnormal vibrations.

Do not press the buttons using sharp objects such as pins, knives, fingernails, etc.

- This may result in electric shock or injury.

Do not wash laundry contaminated by oils, creams or lotions usually found in skincare shops or massage clinics.

- This may result in the rubber seal becoming deformed and water leakage.

Do not leave metal objects such as a safety pin or hair pin, or bleach in the tub for long periods of time.

- This may cause the tub to rust.
- If rust starts appearing on the surface of the tub, apply a cleansing agent (neutral) to the surface and use a sponge to clean it. Never use a metal brush.

Do not use dry cleaning detergent directly and do not wash, rinse, or spin laundry contaminated by dry cleaning detergent.

- This may result in spontaneous combustion or ignition due to the heat of the oxidation of the oil.

Do not use hot water from water cooling/heating devices.

- This may result in problems with the washer.

Do not use natural hand-washing soap for the washer.

- If it hardens and accumulates inside the washer, it may result in problems with the product, discoloration, rust or bad odors.

Do not wash large laundry items such as bedding in the washing net.

- Place socks and brassieres into the washing net and wash them with the other laundry.
- Failure to do so may result in injury due to abnormal vibrations.

Do not use hardened detergent.

- If it accumulates inside the washer, it may result in water leakage.

For washing machines with ventilation openings in the base, ensure that the opening is not obstructed by carpet or any other obstacles.

Make sure that the pockets of all clothing to be washed are empty.

- Hard, sharp objects, such as coins, safety pins, nails, screws, or stones can cause extensive damage to the appliance.

Do not wash clothing with large buckles, buttons, or other heavy metal.



SEVERE WARNING SIGNS FOR CLEANING



Do not clean the appliance by spraying water directly onto it.

Do not use benzene, thinner or alcohol to clean the appliance.

- This may result in discoloration, deformation, damage, electric shock or fire.

Before cleaning or performing maintenance, unplug the appliance from the wall socket.

- Failure to do so may result in electric shock or fire.

contents

SETTING UP YOUR WASHING MACHINE	13	
	13	Checking the parts
	14	Meeting installation requirements
	14	Electrical supply and grounding
	14	Water Supply
	15	Drain
	15	Flooring
	15	Surrounding temperature
	15	Alcove or closet installation
	15	Installing your washing machine
WASHING A LOAD OF LAUNDRY	21	
	21	Washing for the first time
	21	Basic instructions
	22	Using the control panel
	24	Child lock
	24	Delay end
	25	Washing clothes using the cycle selector
	26	Washing clothes manually
	26	Laundry guidelines
	28	Detergent and additives information
	28	Which detergent to use
	28	Detergent drawer
CLEANING AND MAINTAINING YOUR WASHING MACHINE	29	
	29	Draining the washing machine in an emergency
	29	Cleaning the exterior
	30	Cleaning the detergent drawer and drawer recess
	31	Cleaning the debris filter
	31	Cleaning the water hose mesh filter
	32	Repairing a frozen washing machine
	32	Storing your washing machine
TROUBLESHOOTING AND INFORMATION CODES	33	
	33	Check these points if your washing machine...
	34	Information codes
CALIBRATING YOUR WASHING MACHINE	34	
	34	Calibration mode
CYCLE CHART	35	
	35	Cycle chart
APPENDIX	36	
	36	Fabric care chart
	36	Protecting the environment
	36	Declaration of conformity
	37	Specifications
	39	Sheet of household washing machines (EU only)

setting up your washing machine

Be sure to have your installer follow these instructions closely so that your new washing machine works properly and so that you're not at risk of injury when doing laundry.

CHECKING THE PARTS

Carefully unpack your washing machine, and make sure you've received all of the parts shown below. If your washing machine was damaged during shipping, or if you do not have all of the parts, contact Samsung Customer Service or your Samsung dealer.

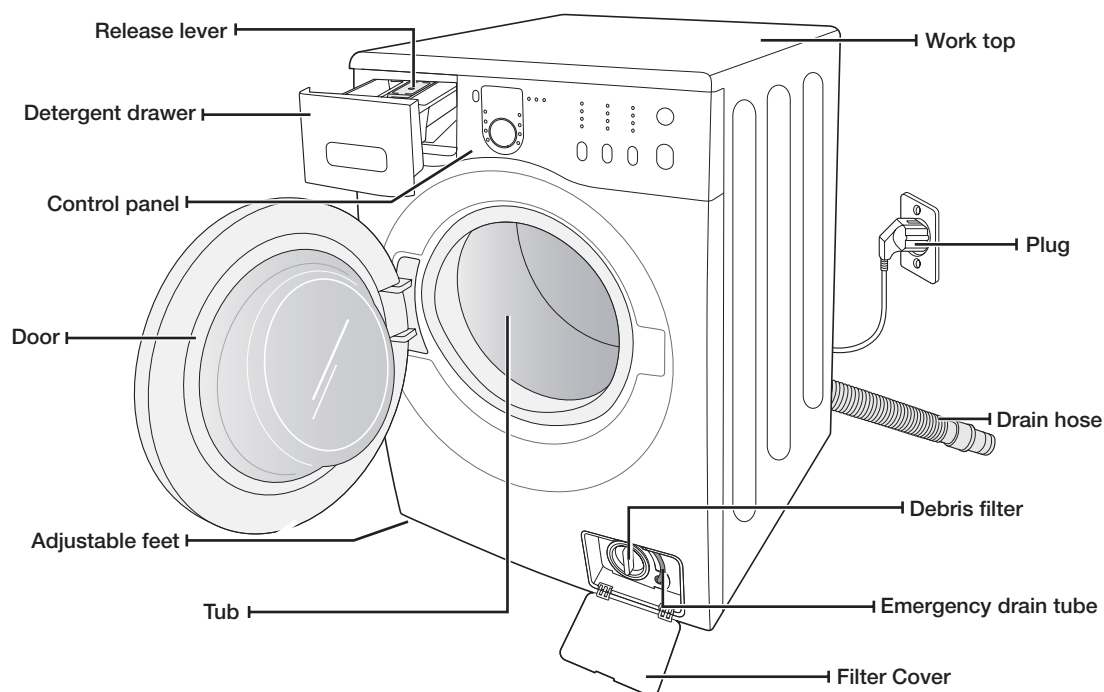

Spanner

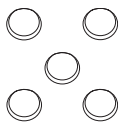

Bolt hole covers



Water supply hose

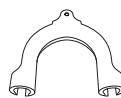

Hose guide



Cap fixer

setting up your washing machine

MEETING INSTALLATION REQUIREMENTS

Electrical supply and grounding

To prevent unnecessary risk of fire, electrical shock, or personal injury, all wiring and grounding must be done in accordance with the National Electrical Code ANSI/FNPA, No. 70 Latest Revision and local codes and ordinances. It is the personal responsibility of the appliance owner to provide adequate electrical service for this appliance.

 **WARNING** Never use an extension cord.
Use only the power cord that comes with your washing machine.

When preparing for installation, ensure that your power supply offers:

- 220V~240V 50Hz 15 AMP fuse or circuit breaker
- Individual branch circuit serving only your washing machine

Your washing machine must be grounded. If your washing machine malfunctions or breaks down, grounding will reduce the risk of electric shock by providing a path of least resistance for the electric current.

Your washing machine comes with a power cord having a three-prong grounding plug for use in a properly installed and grounded outlet.

 Never connect the ground wire to plastic plumbing lines, gas lines, or hot water pipes.

Improperly connecting the equipment-grounding conductor can result electrical shock. Check with a qualified electrician or serviceman if you are unsure if the washing machine is properly grounded. Do not modify the plug provided with the washing machine. If it does not fit the outlet, have a proper outlet installed by a qualified electrician.

Water Supply

Your washing machine will fill properly when your water pressure is 50 kPa ~ 800 kPa. Water pressure less than 50 kPa may cause water valve failure, not allowing the water valve to shut off completely. Or, it may take the washing machine longer to fill than what the controls allow, resulting in your washing machine turning off. (A fill-time limit, designed to prevent overflows/flooding if an internal hose becomes loose, is built into the controls.)

The water taps must be within 4 feet (122cm) of the back of your washing machine for the provided inlet hoses provided to reach your washing machine.

 Most plumbing supply stores sell inlet hoses of various lengths up to 10 feet (305cm) long.

You can reduce the risk of leaks and water damage by:

- Making water taps easily accessible.
- Turning off taps when the washing machine is not in use.
- Periodically checking for leaks at water inlet hose fittings.

 **WARNING** Before using your washing machine for the first time, check all connections at the water valve and taps for leaks.

Drain

Samsung recommends a standpipe height of 18 in (46 cm). The drain hose must be routed through the drain hose clip to the standpipe. The standpipe must be large enough to accept the outside diameter of the drain hose. The drain hose is attached at the factory.

Flooring

For best performance, your washing machine must be installed on a solidly constructed floor. Wood floors may need to be reinforced to minimize vibration and/or unbalanced loads. Carpeting and soft tile surfaces are contributing factors to vibrations and the tendency for your washing machine to move slightly during the spin cycle.

Never install your washing machine on a platform or poorly supported structure.

Surrounding temperature

Do not install your washing machine in areas where water may freeze, since your washing machine always retains some water in its water valve, pump, and hose areas. Frozen water in the lines can cause damage to belts, the pump, and other components.

Alcove or closet installation

To operate safely and properly, your new washing machine requires minimum clearances of:

Sides – 25 mm

Rear – 51 mm

Top – 25 mm

Front – 465 mm

If both the washing machine and a dryer are installed together, the front of the alcove or closet must have at least 465 mm unobstructed air opening. Your washing machine alone does not require a specific air opening.

INSTALLING YOUR WASHING MACHINE

STEP 1

Selecting a location



Before you install the washing machine, make sure the location:

- Has a hard, level surface without carpeting or flooring that may obstruct ventilation
- Is away from direct sunlight
- Has adequate ventilation
- Will not be freezing (below 32 °F or 0 °C)
- Is away from heat sources such as oil or gas
- Has enough space so that the washing machine doesn't stand on its power cord

setting up your washing machine

STEP 2

Removing the shipping bolts

Before installing the washing machine, you must remove the five shipping bolts from the back of the unit.

1. Loosen all the bolts with the supplied wrench.

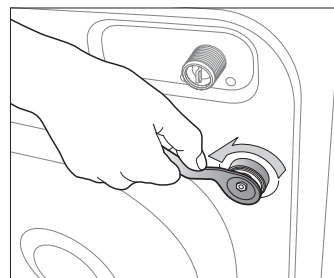

2. Hold the bolt with the spanner and pull it through the wide section of the hole. Repeat for each bolt.

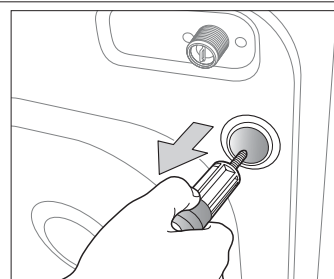

3. Fill the holes with the supplied plastic covers.

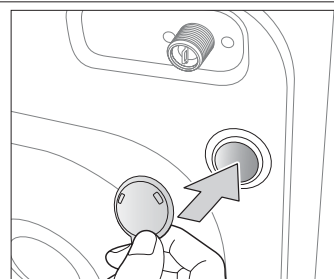

4. Store the shipping bolts away safely in case you have to move the washing machine in the future.

 **WARNING** Packaging materials can be dangerous to children; keep all packaging material (plastic bags, polystyrene, etc.) well out of the reach of children.

-  Insert the cap fixer, (one of the accessories in the vinyl pack), into the hole from which you removed the power cord at the back of the product.

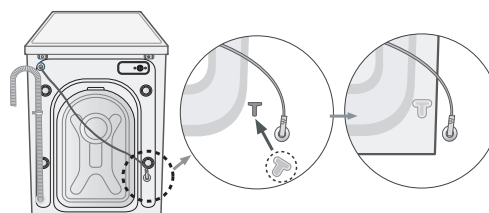

STEP 3

Adjusting the levelling feet

 When installing your washing machine, ensure that the power plug, the water supply and the drain are easily accessible.

1. Slide the washing machine into position.

2. Level your washing machine by turning the levelling feet in and out as necessary by hand.

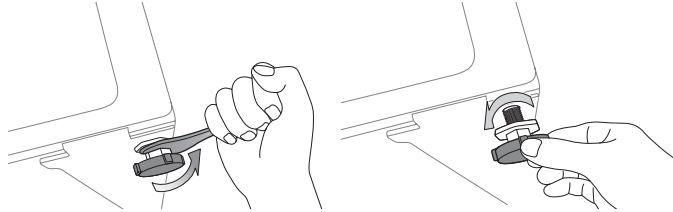

3. When your washing machine is level, tighten the nuts using the wrench supplied with your washing machine.

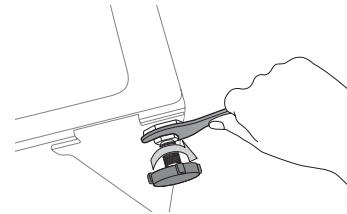

STEP 4

Connecting the water and drain

Connecting the water supply hose

1. Take the L-shaped arm fitting for the cold water supply hose and connect it to the cold water supply intake on the back of the machine. Tighten by hand.

 The water supply hose must be connected to the washing machine at one end and to the water tap at the other. Do not stretch the water supply hose. If the hose is too short, replace the hose with a longer, high pressure hose.

2. Connect the other end of the cold water supply hose to your sink's cold water tap and tighten it by hand. If necessary, you can reposition the water supply hose at the washing machine end by loosening the fitting, rotating the hose, and retightening the fitting.

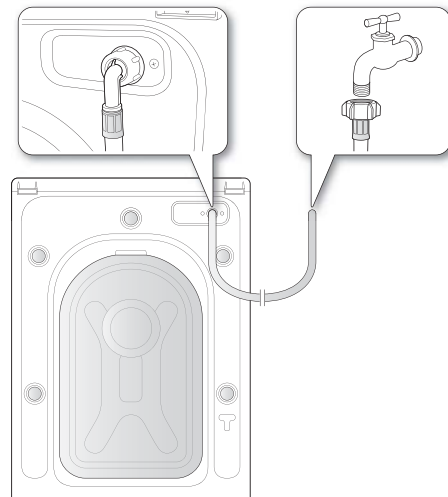

For selected models with an additional hot water intake:

1. Take the red L-shaped arm fitting for the hot water supply hose and connect it to the hot water supply intake on the back of the machine. Tighten by hand.
2. Connect the other end of the hot water supply hose to your sink's hot water tap and tighten it by hand.
3. Use a Y-piece if you only want to use cold water.

setting up your washing machine

Connecting the water supply hose (selected models)

1. Remove the adaptor from the water supply hose.

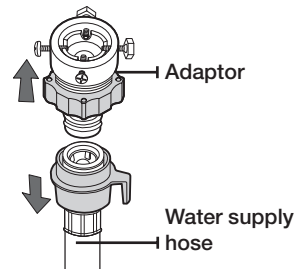

2. First, using a '+' type screwdriver, loosen the four screws on the adaptor. Next, take the adaptor and turn part (2) following the arrow until there is a 5 mm gap.

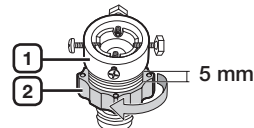

3. Connect the adaptor to the water tap by tightening the screws firmly while lifting the adaptor upwards. Turn part (2) following the arrow and connect (1) and (2).

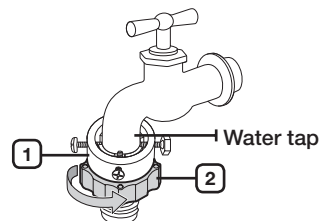

4. Connect the water supply hose to the adaptor. When you release part (3), the hose automatically connects to the adaptor making a 'click' sound.

 After you have connected the water supply hose to the adaptor, ensure that it is connected correctly by pulling the water supply hose downwards.

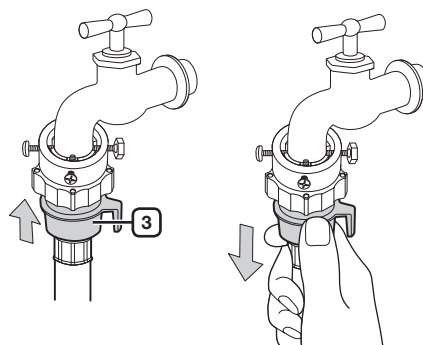

5. Connect the other end of the water supply hose to the inlet water valve at the rear of the washing machine. Screw the hose clockwise all the way in.

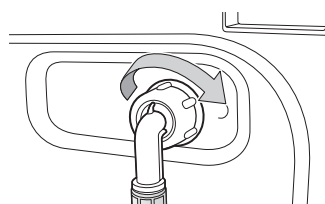

6. Turn on the water supply and ensure that no water leaks from the water valve, tap or adaptor. If there is a water leak, repeat the previous steps.



WARNING Do not use your washing machine if there is a water leak. This may cause electric shock or injury.

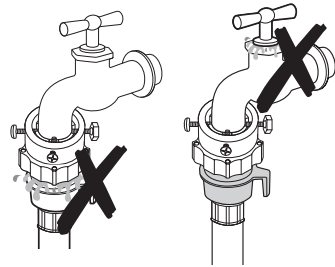

- If the water tap has a screw type tap, connect the water supply hose to the tap as shown.

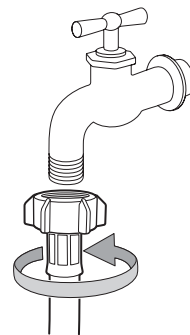

- ☞ Use the most conventional type of tap for the water supply. In case the tap is square or too big, remove the spacing ring before inserting the tap into the adaptor.

setting up your washing machine

Connecting the drain hose

The end of the drain hose can be positioned in three ways:

1. **Over the edge of a wash basin:** The drain hose must be placed at a height of between 60 and 90 cm. To keep the drain hose spout bent, use the supplied plastic hose guide. Secure the guide to the wall with a hook or to the tap with a piece of string to prevent the drain hose from moving.

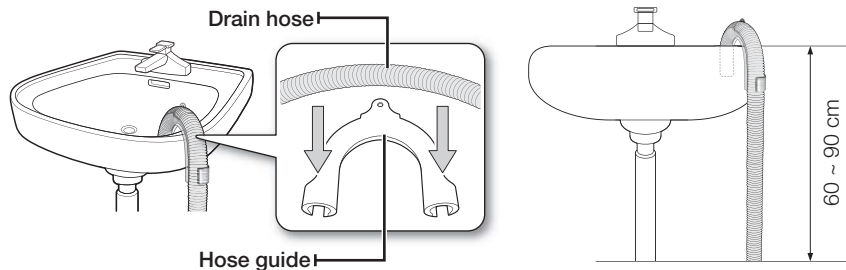

2. **In a sink drain pipe branch:** The drain pipe branch must be above the sink siphon so that the end of the hose is at least 60 cm above the ground.
3. **In a drain pipe:** We recommend using a 65 cm high vertical pipe; it must be no shorter than 60 cm and no longer than 90 cm.

STEP 5



Powering your washing machine

Plug the power cord into a wall sockets, a 230 volt 50 Hz approved electrical outlet protected by a 15-amp fuse or comparable circuit breaker. (For more information on electrical and grounding requirements, see page 14.)

washing a load of laundry

With your new Samsung washing machine, the hardest part of doing laundry will be deciding which load to wash first.

WASHING FOR THE FIRST TIME

-  Before washing laundry for the first time, you must run a complete empty cycle (i.e. no laundry).
1. Press the **Power**(⏻) button.
 2. Add a little detergent to the detergent compartment ② in the detergent drawer.
 3. Turn on the water supply to the washing machine.
 4. Press the **Start/Pause**(⏻) button.
-  This will remove any water that might be left over in the machine from the manufacturer's test run.

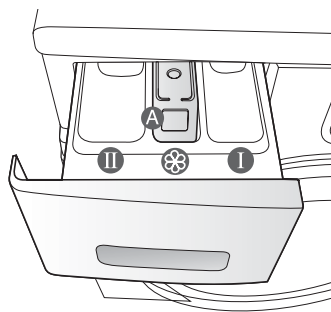

Compartment ①: Detergent for prewash, or starch.

Compartment ②: Detergent for the main wash, water softener, pre-soaking agent, bleach and stain removal product.

Compartment *: Additives, e.g. fabric softener or former (fill no higher than lower edge (MAX) of "A")

BASIC INSTRUCTIONS

1. Load your laundry into the washing machine.

 **WARNING** Do not overload the washing machine. To determine the load capacity for each type of laundry, refer to the chart on page 27.







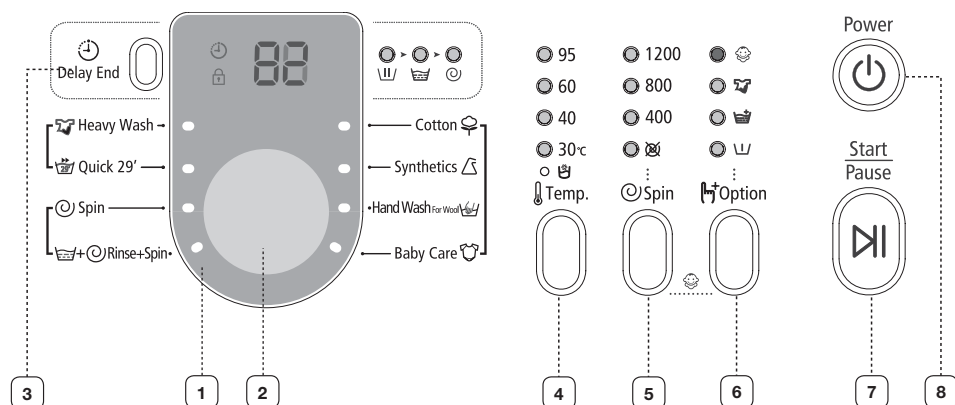









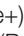

-  • Make sure that laundry is not caught in the door, as this may cause a water leak.
- Washing detergent may remain in the front rubber part of the washer after a wash cycle. Remove any remaining detergent, as they may cause a water leak.
- Do not wash water-proofed items.
2. Close the door until it latches.
 3. Turn the power on.
 4. Add detergent and additives to the dispenser drawer.
 5. Select the appropriate cycle and options for the load.
The Wash Indicator light will illuminate and the estimated cycle time will appear in the display.
 6. Press the **Start/Pause**(⏻) button.

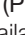
washing a load of laundry

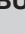
USING THE CONTROL PANEL

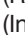

1 DIGITAL GRAPHIC DISPLAY	Displays the remaining wash cycle time, all cycle information, and error messages.
2 CYCLE SELECTOR	<p>Select the tumble pattern and spin speed for the cycle.</p> <p> For detailed information, refer to “Washing clothes using the cycle selector” (see page 25) .</p> <p>Cotton(☼) - For averagely or lightly soiled cotton, bed linen, table linen, underwear, towels, shirts, etc.</p> <p>Synthetics(△) - For averagely or lightly soiled blouses, shirts, etc., made of polyester (diolen, trevira), polyamide (perlon, nylon) or other similar blends.</p> <p>Hand Wash For Wool(☼) - Only for machine-washable wool. A load should be less than 2.0 kg.</p> <p>Baby Care(☺) - High temperature wash and extra rinses ensure that no washing powder remains to mark your thin clothes.</p> <p>Heavy Wash(☼) - Stained or heavy soiled cottons, bed linen, table linen, underwear, towels, shirts, jeans, etc.</p> <p>Quick 29'(☼) - For lightly soiled garments that you require quickly.</p> <p>Spin(☼) - Performs an additional spin cycle to remove more water.</p> <p>Rinse + Spin(☼+☼) - Use for a load that needs rinsing only or to add rinse-added fabric softener to a load.</p>
3 DELAY END (🕒) SELECTION BUTTON	<p>Press this button repeatedly to cycle through the available Delay End options (from 3 hours to 19 hours in one hour increments).</p> <p>The hour displayed indicates the time when the wash cycle will be finished.</p>
4 TEMPERATURE (🌡️) SELECTION BUTTON	<p>Press this button repeatedly to cycle through the available water temperature options:</p> <p>(Cold, 30 °C, 40 °C , 60 °C and 95 °C).</p>

5	SPIN (⌚) SELECTION BUTTON	Press the button repeatedly to cycle through the available speeds for the spin cycle.	
		WF8624	All Lamps Turn Off,  , 400, 800, 1400 rpm
		WF8622 / WF8502	All Lamps Turn Off,  , 400, 800, 1200 rpm
		WF8620 / WF8500	All Lamps Turn Off,  , 400, 800, 1000 rpm
		WF8508	All Lamps Turn Off,  , 400, 800, 800+ rpm
<p>“No spin ” - The laundry remains in the drum and no spin cycle is performed after the final drain.</p> <p>“Rinse Hold (All Lamps Turn Off)” -The laundry remains soaking in the final rinse water. Before the laundry can be unloaded, either a Drain or Spin cycle must be performed.</p>			
6	OPTION (⌚) SELECTION BUTTON	<p>Press this button repeatedly to cycle through the wash options: ⌚ (Pre-Wash) →  (Rinse+) →  (Intensive) → ⌚ (Pre-Wash) +  (Rinse+) → ⌚ (Pre-Wash) +  (Intensive) →  (Rinse+) +  (Intensive) → ⌚ (Pre-Wash) +  (Rinse+) +  (Intensive) → (off)</p> <p>⌚ (Pre-Wash): Press this button to select Pre-Wash. Pre-wash is only available with: Cotton(), Synthetics(), Baby Care(), Heavy Wash().</p> <p> (Rinse+): Press this button to add additional rinse cycles.</p> <p> (Intensive): Press this button when the laundry is heavily soiled and needs to be washed intensively. The cycle time is increased for each cycle.</p>	
7	START/PAUSE (⏮) SELECTION BUTTON	Press to pause and restart a cycle.	
8	POWER (⏻) BUTTON	<p>Press it once to turn your washing machine on, press it again to turn your washing machine off.</p> <p>If the washing machine is left on for more than 10 minutes without any buttons being touched, the power automatically turns off.</p>	

washing a load of laundry

Child lock

The Child Lock function allows you to lock the buttons so that the wash cycle you've chosen can't be changed.

Activating/Deactivating

If you want to activate or deactivate the Child Lock function, press the **Spin**(☺) and **Option**(⚙) buttons at the same time for 3 seconds. The "Child Lock" (🔒) will be lit when this feature is activated.

✍ When the Child Lock function is activated, only the **Power**(🔌) button works. The Child Lock function remains on even after the power is turned on and off or after the disconnecting and reconnecting the power cord.

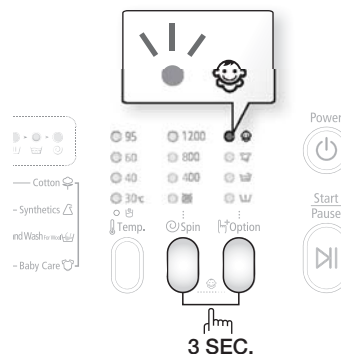

Delay end

You can set the washing machine to finish your wash automatically at a later time, choosing a delay of between 3 to 19 hours (in 1 hour increments). The hour displayed indicates the time at which the wash will be finished.

1. Manually or automatically set your washing machine according to the type of laundry you are washing.
2. Press the **Delay End**(🕒) button repeatedly until the delay time is set.
3. Press the **Start/Pause**(▶||) button. The "Delay End" (🕒) indicator will be lit, and the clock will begin counting down until it reaches the set time.
4. To cancel a Delay End function, press the **Power**(🔌) button and then turn the washing machine on again.

Washing clothes using the cycle selector

Your new washing machine makes washing clothes easy, using Samsung's "Fuzzy Control" automatic control system. When you select a wash program, the machine will set the correct temperature, washing time, and washing speed.

1. Turn on your sink's water tap.
2. Press the **Power**(⏻) button.
3. Open the door.
4. Load the articles one at a time loosely into the drum, without overfilling it.
5. Close the door.
6. Add detergent, softener, and pre-wash detergent (if necessary) into the appropriate compartments.



Pre-wash is only available when selecting the Cotton(☺), Synthetics(△), Baby Care(☺), and Heavy Wash(☹) cycles. It is only necessary if your clothing is heavily soiled.

7. Use the **Cycle Selector** to select the appropriate cycle according to the type of material: Cotton(☺), Synthetics(△), Hand Wash For Wool(☹), Baby Care(☺), Heavy Wash(☹), Quick 29'(⚡). The relevant indicators will illuminate on the control panel.
8. At this time, you can control the wash temperature, the amount of rinses, the spinning speed, and the delay time by pressing the appropriate option(⏸) button.
9. Press the **Start/Pause**(▶||) button and the wash will begin. The process indicator will light up and the remaining time for the cycle will appear in the display.

Pause Option

Within 5 minutes of starting a wash, it is possible to add/remove laundry items.

1. Press the **Start/Pause**(▶||) button to unlock the door.



The door cannot be opened when the water is too HOT or the water level is too HIGH.

2. After closing the door, press the **Start/Pause**(▶||) button to restart the wash.

When the cycle is finished:





After the total cycle has finished, the power will turn off automatically.

1. Open the door.
2. Remove laundry.

washing a load of laundry

Washing clothes manually

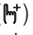
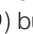
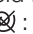
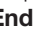
You can wash clothes manually without using the Cycle Selector.

1. Turn the water supply on.
2. Press the **Power**() button on the washing machine.
3. Open the door.
4. Load the articles loosely into the drum one at a time, without overfilling it.
5. Close the door.
6. Add detergent and, if necessary, softener or prewash detergent, into the appropriate compartments.
7. Press the **Temp.**() button to select the temperature. (Cold() , 30 °C, 40 °C, 60 °C, 95 °C)
8. Press the **Option**() button to select the required number of rinse cycles.
The maximum number of rinse cycles is five.
The wash duration is increased accordingly.
9. Press the **Spin**() button to select the spin speed.
The rinse hold function allows you to remove items that are still wet from the washing machine. ( : No Spin (All Lamps Turn Off): Rinse Hold)
10. Press the **Delay End**() button repeatedly to cycle through the available Delay End options (from 3 hour to 19 hours in one hour increments). The hour displayed indicates the time at which the wash will be finished.
11. Press the **Start/Pause**() button and the machine will begin the cycle.

LAUNDRY GUIDELINES

Follow these simple guidelines for the cleanest laundry and the most efficient wash.

 Always check the Care label on clothing before washing.

Sort and wash your laundry according to the following criteria:

- Care Label: Sort laundry into cottons, mixed fibres, synthetics, silks, wools and rayons.
- Colour: Divide whites and colours. Wash new colour items separately.
- Size: Placing items of different sizes in the same load will improve the wash action.
- Sensitivity: Wash delicate items separately, using the Delicate wash cycle for pure, new woollen items, curtains and silk articles. Check the labels on the items you are washing or refer to the fabric care chart in the appendix.

Emptying pockets

Before each wash, empty all the pockets of your laundry. Small, irregularly shaped hard objects, such as coins, knives, pins, and paperclips could damage your washing machine. Do not wash clothing with large buckles, buttons, or other heavy metal objects.

Metal on clothing may damage your clothing as well as the tub. Turn clothing with buttons and embroidered clothes inside out before washing them. If zips of pants and jackets are open while washing, the spin basket may be damaged. Zips should be closed and fixed with a string before washing.

Clothing with long strings may become entangled with other clothes damaging them. Be sure to fix the strings before starting the wash.

Prewashing cotton

Your new washing machine, combined with modern detergents, will give perfect washing results, thus saving energy, time, water and detergent. However, if your cotton is particularly dirty, prewash with a protein-based detergent.

Determining the load capacity

Do not overload the washing machine or your laundry may not wash properly. Use the chart below to determine the load capacity for the type of laundry you are washing.

Fabric Type	Load Capacity	
Model	WF8624 WF8622 / WF8620	WF8502 WF8500 / WF8508
Cotton (☺) - average/lightly soiled - heavily soiled	6.2 kg	5.0 kg
Synthetics (△)	2.5 kg	2.5 kg
Hand Wash For Wool (☹)	2.0 kg	1.5 kg



- When the laundry is unbalanced ("UE" lights up on the display), redistribute the load. If the laundry is unbalanced, the spin efficiency may be degraded.
- When washing Bedding or Duvets, the wash time may be lengthened or the spin efficiency may be degraded.
- For Bedding or Duvets, the recommended load capacity is 1.8(kg) or less.



Make sure to insert brassieres (water washable) into a laundry net (to be purchased additionally).

- The metal parts of the brassieres may break through the material and damage the laundry. Therefore make sure to place them inside a fine laundry net.
- Small, light clothing such as socks, gloves, stockings and handkerchiefs may become caught around the door. Place them inside a fine laundry net.

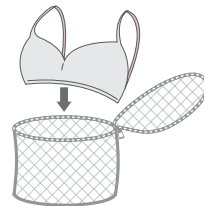

Do not wash the laundry net by itself without other laundry. This may cause abnormal vibrations that could move the washing machine and cause an accident resulting in injury.

washing a load of laundry

DETERGENT AND ADDITIVES INFORMATION

Which detergent to use

The type of detergent you should use is based on the type of fabric (cotton, synthetics, items, Hand Wash For Wool), colour, wash temperature, and degree of soiling. Always use "low suds" laundry detergent, which is designed for automatic washing machines.

Follow the detergent manufacturer's recommendations based on the weight of the laundry, the degree of soiling, and the hardness of the water in your area. If you do not know how hard your water is, enquire at your local water authority.

-  Do not use detergent that has hardened or solidified as the detergent may remain in the rinse cycle. It may cause your washing machine to not rinse properly or result in the overflow becoming blocked.

Detergent drawer

Your washing machine has separate compartments for dispensing detergent and fabric softener. Add all laundry additives to the correct compartment before starting your washing machine.

-  Do NOT open the detergent drawer when your washing machine is running.

1. Pull out the detergent drawer on the left side of the control panel.
2. Add the recommended amount of laundry detergent directly into the detergent compartment ② before starting your washing machine.
3. Add the recommended amount of fabric softener into the softener compartment ③ if required.

 **CAUTION** Do NOT add any powder/liquid **detergent** to the softener compartment ③.

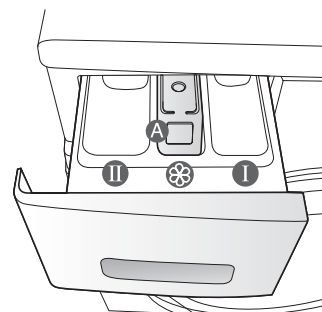
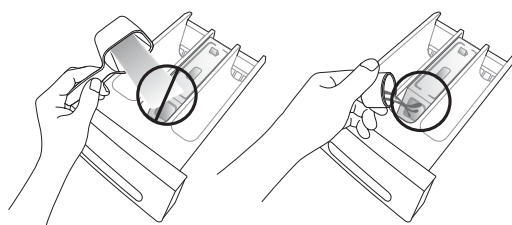

4. When using the Prewash option, add the recommended amount of laundry detergent into the prewash compartment ①.

-  When washing large items do NOT use the following detergent types.

- Tablet and capsule type detergents
- Detergents using a ball and net

-  Concentrated or thick fabric softener and conditioner must be diluted with a little water before being poured into the dispenser (prevents the overflow from becoming blocked.)

-  Be careful that the fabric softener does not overflow, when you close the detergent drawer after adding fabric softener into the rinse detergent compartment.

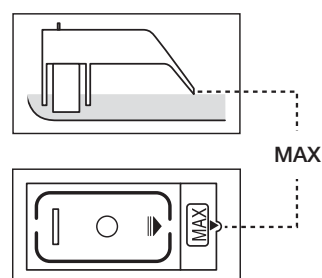

cleaning and maintaining your washing machine

Keeping your washing machine clean improves its performance, wards off unnecessary repairs, and lengthens its life.

DRAINING THE WASHING MACHINE IN AN EMERGENCY

1. Unplug the washing machine from the power supply.
2. Open the filter cover using a coin or a key.

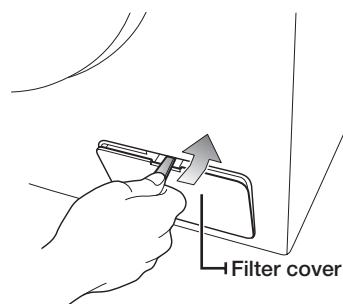

3. Pull forward the emergency drain tube to separate it from the guide hook.

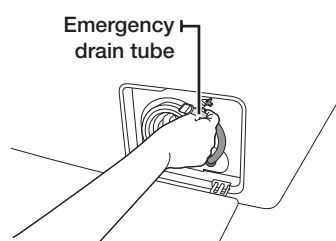

4. Take off the emergency drain cap closing the emergency drain tube.
5. Allow all the water to flow into a bowl.
-  Remain water maybe more than you expected. Prepare larger bowl.
6. Re-attach the cap to the emergency drain tube and then fix the emergency drain tube to the guide hook.
7. Replace the filter-cover.



CLEANING THE EXTERIOR

1. Wipe the washing machine surfaces, including the control panel, with a soft cloth using a nonabrasive household detergent.
2. Use a soft cloth to dry the surfaces.
3. Do not pour water onto the washing machine.

cleaning and maintaining your washing machine

CLEANING THE DETERGENT DRAWER AND DRAWER RECESS

1. Press the release lever on the inside of the detergent drawer and pull the drawer out.
2. Remove the liquid detergent divider from the detergent drawer

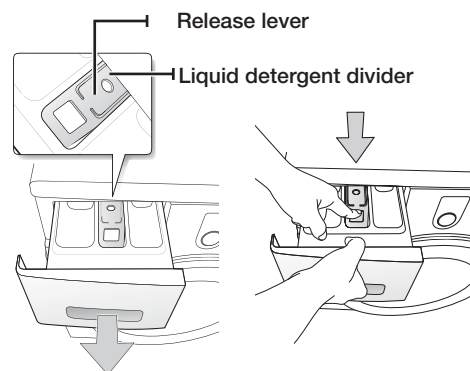

3. Wash all parts under running water.

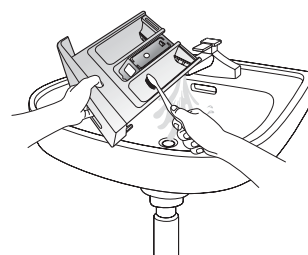

4. Clean the drawer recess with an old toothbrush.
5. Replace the liquid detergent divider by pushing it firmly into the drawer.
6. Push the drawer back into place.
7. To remove any remaining detergent, perform a rinse cycle without any laundry in the drum.

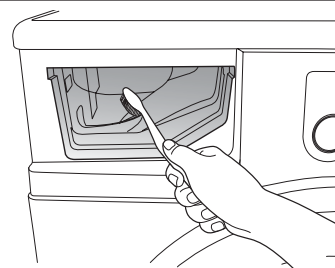

CLEANING THE DEBRIS FILTER

We recommend cleaning the debris filter 5 or 6 times a year, or when the error message of “5E” is displayed. (Refer to “Draining the washing machine in an emergency” in the previous page.)



Before cleaning the debris filter, make sure to unplug the power cord.

1. Remove the remaining water first (refer to “Draining the washing machine in an emergency” on page 29.)
2. If you separate the filter without draining the remaining water, the remaining water may trickle out.
3. Open the filter cover by using a key or coin.
4. Unscrew the emergency drain cap by turning it to the left and drain off all the water.
5. Unscrew the debris filter cap.
6. Wash any dirt or other material from the debris filter. Make sure the drain pump propeller behind the debris filter is not blocked.
7. Replace the debris filter cap.
8. Replace the filter cover.

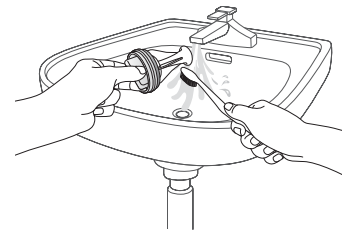
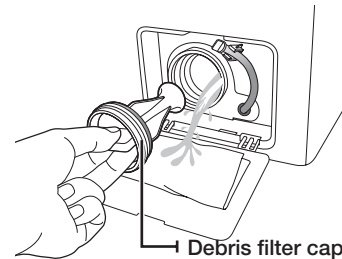

Do not open the debris filter cap while the machine is running or hot water may flow out.



- Make sure to replace the filter cap after the filter cleaning. If the filter is out of the machine, your washing machine may malfunction or leak water.
- The filter should be fully assembled after the filter cleaning.

CLEANING THE WATER HOSE MESH FILTER

You should clean the water hose mesh filter at least once a year, or when the error message of “4E” is displayed:

1. Turn off the water supply to the washing machine.
2. Unscrew the hose from the back of the washing machine. To prevent water from gushing out due to the air pressure in the hose, cover the hose with a cloth.
3. Gently pull out the mesh filter from the end of the hose using a pair of pliers and rinse it under water until clean. Also clean inside and outside the threaded connector.
4. Push the filter back into place.
5. Screw the hose back onto the washing machine.
6. Make sure the connections are watertight and turn on the tap.

cleaning and maintaining your washing machine

REPAIRING A FROZEN WASHING MACHINE

If the temperature drops below freezing and your washing machine is frozen:

1. Unplug the washing machine.
2. Pour warm water over the tap to loosen the water supply hose.
3. Remove the water supply hose and soak it in warm water.
4. Pour warm water into the washing machine drum and let it sit for 10 minutes.
5. Reconnect the water supply hose to the water tap and check if the water supply and drain are operating normal.

STORING YOUR WASHING MACHINE

If you need to store your washing machine for an extended time, it's better to drain and disconnect it. Washing machines can be damaged if water is left in the hoses and internal components before storage.

1. Select the Quick 29' cycle and add bleach to the bleach compartment. Run your washing machine through the cycle without a load.
 2. Turn the water taps off and disconnect the inlet hoses.
 3. Unplug your washing machine from the electrical outlet, and leave your washing machine door open to allow air to circulate inside the tumbler.
-  If your washing machine has been stored in below-freezing temperatures, allow time for any leftover water in your washing machine to thaw out before using it.

troubleshooting and information codes

CHECK THESE POINTS IF YOUR WASHING MACHINE...

PROBLEM	SOLUTION
Will not start	<ul style="list-style-type: none">• Make sure your washing machine is plugged in.• Make sure the door is firmly closed.• Make sure the water source tap(s) are turned on.• Make sure to press the Start/Pause button.
Has no water or not enough water	<ul style="list-style-type: none">• Turn the water tap on fully.• Make sure the water source hose is not frozen.• Straighten the water intake hoses.• Clean the filter on the water intake hose.
Has detergent remains in the detergent drawer after the wash cycle is complete	<ul style="list-style-type: none">• Make sure your washing machine is running with sufficient water pressure.• Make sure the detergent is added to the center of the detergent drawer.
Vibrates or is too noisy	<ul style="list-style-type: none">• Make sure your washing machine is on a level surface. If the surface is not level, adjust the washing machine feet to level the appliance.• Make sure that the shipping bolts are removed.• Make sure your washing machine is not touching any other object.• Make sure the laundry load is balanced.
The washing machine does not drain and/or spin	<ul style="list-style-type: none">• Straighten the drain hose. Eliminate kinked hoses.• Make sure the debris filter is not clogged.
Door is locked shut or will not open.	<ul style="list-style-type: none">• Make sure all the water in your drum is drained out.• Make sure the door lock light is off. Door lock light will off after drained.

If the problem persists, contact your local Samsung Customer Service.

troubleshooting and information codes

INFORMATION CODES

When your washing machine malfunctions, you may see an information code on the display. If that happens, check this table and try the suggested solution before calling Customer Service.

CODE SYMBOL	SOLUTION
dE	<ul style="list-style-type: none">• Make sure the door is firmly closed.• Make sure that laundry is not caught in the door.
4E	<ul style="list-style-type: none">• Make sure the source water tap is turned on.• Check the water pressure.
5E	<ul style="list-style-type: none">• Clean the debris filter.• Make sure the drainage hose is installed correctly.
UE	<ul style="list-style-type: none">• The laundry load is unbalanced. Redistribute the load. If only one item of clothing needs washing, such as a bathrobe or pair of jeans, the final spin result might be unsatisfactory and an "UE" error message will be shown in the display window.
cE/3E	<ul style="list-style-type: none">• Call the after-sales service.
Sd	<ul style="list-style-type: none">• This occurs when too much foaming is detected. It is also displayed while foaming is removed. When the removal is finished, the normal cycle proceeds.(This is one of the normal operations. It is an error for preventing non-sensing faults.)
Uc	<ul style="list-style-type: none">• If the voltage of the supplied power is instable, the washing machine will be paused to protect its electric devices.• If the correct voltage is supplied, the cycle will resume automatically.

For any codes not listed above, or if the suggested solution doesn't fix the problem, call your Samsung Service Centre or local Samsung dealer.

calibrating your washing machine

CALIBRATION MODE

Samsung washing machine detects the laundry weight automatically. For more accurate weight detection, please run Calibration Mode after the installation. Calibration mode is done by following the steps below.

1. Remove laundry or any contents in the machine and turn off the machine.
2. Press the **Temp** button and **Delay End** button simultaneously, and press the **Power** button in addition. Then the machine turns on.
3. Press the **Start** button to activate "Calibration Mode".
4. The drum rotates clockwise and counterclockwise approximately for 3 minutes.
5. When "Calibration Mode" is finished, "End(En)" appears on the display, and the machine automatically turns off. The washing machine is now ready for use.

cycle chart

CYCLE CHART

(● user option)

PROGRAM	Max load(kg)		DETERGENT			Max Temp (°C)	Spin Speed(MAX) rpm				Delay end
	WF8624 WF8622 WF8620	WF8502 WF8500 WF8508	Pre-wash	wash	Soft-ener		WF8624	WF8622 WF8502	WF8620 WF8500	WF8508	
Cotton(☉)	6.2	5.0	●	yes	●	95	1400	1200	1000	800+	●
Synthetics(△)	2.5	2.5	●	yes	●	60	800	1200	1000	800+	●
Hand Wash For Wool(☼)	2.0	1.5	-	yes	●	40	800	800	800	800	●
Baby Care(☺)	3.0	2.5	●	yes	●	95	1400	1200	1000	800+	●
Heavy Wash(☼)	3.0	2.5	●	yes	●	60	1400	1200	1000	800+	●
Quick 29'(☼)	2.0	2.0	-	yes	●	60	1400	1200	1000	800+	●

























1. A cycle with a prewash takes approx. 15 minutes longer.
2. The cycle duration data has been measured under the conditions specified in Standard IEC 60456 / EN 60456.
Please run Calibration Mode after the installation(see page 34).
3. Course time in individual homes may differ from the values given in the table due to variations in the pressure and temperature of the water supply, the load and the type of laundry.
4. When the Intensive Wash function is selected, the cycle time is increased for each cycle.

appendix

FABRIC CARE CHART

The following symbols provide garment care directions. The care labels include four symbols in this order: washing, bleaching, drying and ironing, and dry cleaning when necessary.

The use of symbols ensures consistency among garment manufacturers of domestic and imported items. Follow the care label directions to maximize garment life and reduce laundering problems.

	Resistant material		Can be ironed at 100 °C max
	Delicate fabric		Do not iron
	Item may be washed at 95 °C		Can be dry cleaned using any solvent
	Item may be washed at 60 °C		Dry clean with perchloride, lighter fuel, pure alcohol or R113 only
	Item may be washed at 40 °C		Dry clean with aviation fuel, pure alcohol or R113 only
	Item may be washed at 30 °C		Do not dry clean
	Item may be hand washed		Dry flat
	Dry clean only		Can be hung to dry
	Can be bleached in cold water		Dry on clothes hanger
	Do not bleach		Tumble dry, normal heat
	Can be ironed at 200 °C max		Tumble dry, reduced heat
	Can be ironed at 150 °C max		Do not tumble dry

PROTECTING THE ENVIRONMENT

- This appliance is manufactured from recyclable materials. If you decide to dispose of this appliance, please observe local waste disposal regulations. Cut off the power cord so that the appliance cannot be connected to a power source. Remove the door so that animals and small children cannot get trapped inside the appliance.
- Do not exceed the detergent quantities recommended in the detergent manufacturers' instructions.
- Use stain removal products and bleaches before the wash cycle only when strictly necessary.
- Save water and electricity by only washing full loads (the exact amount depends upon the program used).

DECLARATION OF CONFORMITY

This appliance complies with European safety standards, EC directive 93/68 and EN Standard 60335.

SPECIFICATIONS

TYPE			FRONT LOADING WASHER		
DIMENSION			WF8624 / WF8622 / WF8620		
			W600mm X D550mm X H850mm		
WATER PRESSURE			50 kPa ~ 800 kPa		
WATER VCLUME			48ℓ		
NET WEIGHT			WF8624	WF8622 / WF8620	
			59 kg	58 kg	
WASH AND SPIN CAPACITY			6.2 kg		
POWER CONSUMPTION	MODEL		WF8624 / WF8622 / WF8620		
	WASHING		220 V	150 W	
			240 V	150 W	
	WASH AND HEATING		220 V	2000 W	
			240 V	2400 W	
	SPIN	MODEL	WF8624	WF8622	WF8620
		230V	580 W	530 W	500 W
PUMPING		34 W			
PACKAGE WEIGHT	MODEL		WF8624 / WF8622 / WF8620		
	PAPER		1.0 kg		
	PLASTIC		1.0 kg		
SPIN REVOLUTIONS	MODEL		WF8624	WF8622	WF8620
	rpm		1400	1200	1000

The appearance and specifications of the product are subject to change without prior notice for purposes of product enhancement.

appendix

SPECIFICATIONS

TYPE			FRONT LOADING WASHER				
DIMENSION			WF8502 / WF8500 / WF8508				
			W600mm X D450mm X H850mm				
WATER PRESSURE			50 kPa ~ 800 kPa				
WATER VOLUME			40ℓ				
NET WEIGHT			WF8502	WF8500 / WF8508			
			53 kg	52 kg			
WASH AND SPIN CAPACITY			5.0 kg				
POWER CONSUMPTION			MODEL	WF8502 / WF8500 / WF8508			
			WASHING		220 V	150 W	
					240 V	150 W	
			WASH AND HEATING		220 V	2000 W	
					240 V	2400 W	
			SPIN	MODEL	WF8502	WF8500	WF8508
				230V	550 W	500 W	430 W
PUMPING		34 W					
PACKAGE WEIGHT			MODEL	WF8502 / WF8500 / WF8508			
			PAPER	1.0 kg			
			PLASTIC	1.0 kg			
SPIN REVOLUTIONS			MODEL	WF8502	WF8500	WF8508	
			rpm	1200	1000	800	

The appearance and specifications of the product are subject to change without prior notice for purposes of product enhancement.

SHEET OF HOUSEHOLD WASHING MACHINES (EU ONLY)

According to Regulation (EU) No. 1061/2010

Samsung				
Model Name		WF8624	WF8622	WF8620
Capacity	kg	6.2		
Energy Efficiency				
A+++ (highest efficiency) to D (least efficient)		A+	A+	A+
Energy Consumption				
Annual Energy Consumption (AE_C) ¹⁾	kWh/yr	195	195	195
Energy Consumption (E_t.60) Cotton 60 °C at full load	kWh	1.14	1.14	1.14
Energy Consumption (E_t.60.1/2) Cotton 60 °C with partial load	kWh	0.77	0.77	0.77
Energy Consumption (E_t.40.1/2) Cotton 40 °C with partial load	kWh	0.65	0.55	0.55
Weighted power off-mode (P_o)	W	0.45	0.45	0.45
Weighted power in left-on mode (P_l)	W	5	5	5
Annual water consumption (AW_c) ²⁾	L/yr	8580	8580	8580
Spin efficiency class ³⁾				
A (most efficient) to G (least efficient)		B	B	C
Maximum Spin Speed	rpm	1400	1200	1000
Residual moisture	%	53	53	62
Programs to which the information on the label and the Sheet relate		Cotton 60 °C and 40 °C + Intensive ⁴⁾		
Program duration of the standard program				
Cotton 60 °C at full load	min	165	165	165
Cotton 60 °C for partial load	min	118	118	118
Cotton 40 °C with partial load	min	113	113	113
Weighted time in left-on mode	min	2	2	2
Airborne noise emissions				
Wash	dB (A) re 1 pW	57	57	57
Spin	dB (A) re 1 pW	79	77	74
Dimensions				
Unit dimensions	Height	mm	850	
	Width	mm	600	
	Depth ⁵⁾	mm	550	
Net weight	kg	59	58	58
Gross weight	kg	61	60	60
Package weight	kg	2	2	2
Water Pressure	kPa	50-800		
Electrical connection				
Voltage	V	220-240		
Power consumption	W	2000-2400		
Frequency	Hz	50		
Supplier name		Samsung Electronics Co., Ltd.		



- Annual energy consumption is based on 220 standard washing cycles for cotton programs at 60 °C and 40 °C at full and partial load, and the consumption of off and left-on modes. Actual energy consumption will depend on how the appliance is used.
- Annual water consumption is based on 220 standard washing cycles for cotton programs at 60 °C and 40 °C at full and partial load. Actual water consumption will depend on how the appliance is used.
- Spin extraction is very important when you use a clothes dryer to dry your clothes.
The energy for drying costs much higher than the energy for washing.
Washing with the high spin saves more energy in drying your clothes in a clothes dryer.
- The 'standard cotton 60 °C program' and 'standard cotton 40 °C program', which can be selected by adding the Intensive option to the cotton 60 °C and cotton 40 °C program, are suitable to clean normally soiled cotton laundry and they are the most efficient (concerning water and energy consumption) for this type of laundry.
Please run Calibration Mode after the installation (see page 34).
In these programs the actual water temperature may differ from the declared temperature.
- Distance to the wall from the unit is not included in the depth dimension.

appendix

SHEET OF HOUSEHOLD WASHING MACHINES (EU ONLY)

According to Regulation (EU) No. 1061/2010

Samsung				
Model Name		WF8502	WF8500	WF8508
Capacity	kg	5		
Energy Efficiency				
A+++ (highest efficiency) to D (least efficient)		A+	A+	A+
Energy Consumption				
Annual Energy Consumption (AE_C) ¹⁾	kWh/yr	168	168	168
Energy Consumption (E_t.60) Cotton 60 °C at full load	kWh	0.93	0.93	0.93
Energy Consumption (E_t.60.1/2) Cotton 60 °C with partial load	kWh	0.75	0.75	0.75
Energy Consumption (E_t.40.1/2) Cotton 40 °C with partial load	kWh	0.47	0.46	0.47
Weighted power off-mode (P_o)	W	0.45	0.45	0.45
Weighted power in left-on mode (P_l)	W	5	5	5
Annual water consumption (AW_c) ²⁾	L/yr	7150	7150	7150
Spin efficiency class ³⁾				
A (most efficient) to G (least efficient)		B	C	D
Maximum Spin Speed	rpm	1200	1000	800
Residual moisture	%	53	62	71
Programs to which the information on the label and the Sheet relate		Cotton 60 °C and 40 °C + Intensive ⁴⁾		
Program duration of the standard program				
Cotton 60 °C at full load	min	165	165	165
Cotton 60 °C for partial load	min	138	138	138
Cotton 40 °C with partial load	min	133	133	133
Weighted time in left-on mode	min	2	2	2
Airborne noise emissions				
Wash	dB (A) re 1 pW	57	57	57
Spin	dB (A) re 1 pW	78	74	72
Dimensions				
Unit dimensions	Height	mm	850	
	Width	mm	600	
	Depth ⁵⁾	mm	450	
Net weight	kg	53	52	52
Gross weight	kg	55	54	54
Package weight	kg	2	2	2
Water Pressure	kPa	50-800		
Electrical connection				
Voltage	V	220-240		
Power consumption	W	2000-2400		
Frequency	Hz	50		
Supplier name		Samsung Electronics Co., Ltd.		



1. Annual energy consumption is based on 220 standard washing cycles for cotton programs at 60 °C and 40 °C at full and partial load, and the consumption of off and left-on modes. Actual energy consumption will depend on how the appliance is used.
2. Annual water consumption is based on 220 standard washing cycles for cotton programs at 60 °C and 40 °C at full and partial load. Actual water consumption will depend on how the appliance is used.
3. Spin extraction is very important when you use a clothes dryer to dry your clothes.
The energy for drying costs much higher than the energy for washing.
Washing with the high spin saves more energy in drying your clothes in a clothes dryer.
4. The 'standard cotton 60 °C program' and 'standard cotton 40 °C program', which can be selected by adding the Intensive option to the cotton 60 °C and cotton 40 °C program, are suitable to clean normally soiled cotton laundry and they are the most efficient (concerning water and energy consumption) for this type of laundry.
Please run Calibration Mode after the installation(see page 34).
In these programs the actual water temperature may differ from the declared temperature.
5. Distance to the wall from the unit is not included in the depth dimension.

memo

memo

memo



Contact SAMSUNG WORLD WIDE

If you have any questions or comments relating to Samsung products, please contact the SAMSUNG customer care center.