

LED TV

user manual

Figures and illustrations in this User Manual are provided for reference only and may differ from actual product appearance. Product design and specifications may be changed without notice.

Still image warning

- Avoid displaying still images (live jpg picture files) or still image element (like TV programme logo, panorama or 4:3 image format, stock or news bar at screen bottom etc.) on the screen. Constant displaying of still picture can cause ghosting of LED screen, which will affect image quality. To reduce risk of this effect, please follow below recommendations:
- Avoid displaying the same TV channel for long periods.
- Always try to display any image on full screen, use TV set picture format menu for best possible match.
- Reduce brightness and contrast values to minimum required to achieve desired picture quality, exceeded values may speed up the burnout process.
- Frequently use all TV features designed to reduce image retention and screen burnout, refer to proper user manual section for details.

For India Only

This product is RoHS compliant.

Correct Disposal of This Product
(Waste Electrical & Electronic Equipment)
This marking on the product & accessories literature indicates that the product and its electronic accessories (e.g. charger, headset, USB cable) should not be disposed of with other household waste at the end of their working life. To prevent possible harm to the environment or human health from uncontrolled waste disposal, please separate these items from other types of waste and recycle them responsibly to promote the sustainable reuse of material resources. House hold users should contact either the retailer where they purchased this product, or their local government office, for details of where and how they can take these items for environmentally safe recycling. Business user should contact their supplier and check the terms and conditions of the purchase contract. This product and its electronic accessories should not be mixed other commercial wastes for disposal.

For more information on safe disposal and recycling visit our website www.samsung.com/in or contact our helpline number - 18002668282, 180030008282

For personal and non-commercial use only.
Usage is subject to following the guidelines in the User Manual and may not be available in all regions.

For more information on safe disposal and recycling visit our website www.samsung.com/in or contact our helpline number - 18002668282, 180030008282

For personal and non-commercial use only.
Usage is subject to following the guidelines in the User Manual and may not be available in all regions.



BN68-06938A-00

Country	Customer Care Centre	Web Site
VIETNAM	1800 588 889	www.samsung.com/vn/support
THAILAND	0-2668-3232	www.samsung.com/th/support
MYANMAR	01-2398888	www.samsung.com/my/support
MALAYSIA	1800-88-9999	www.samsung.com/my/support
INDIA	1800 3000 8282 - Toll Free 1800 266 8282 - Toll Free	www.samsung.com/in/support
BAKGLADESH	961200300	www.samsung.com/in/support
SRI LANKA	009411740540 009411590000	www.samsung.com/support
EGYPT	0800-726786	www.samsung.com/eg/support
ALGERIA	021 36 11 00	www.samsung.com/af/ica/support
IRAN	021-8255	www.samsung.com/iran/support
SAUDI ARABIA	92021230	www.samsung.com/sa_en/support
PAKISTAN	0800-Samsung (726786)	www.samsung.com/pk/support
TUNISIA	800-1000-12	www.samsung.com/af/ica/support
U.A.E	800-SAMSUNG (800 - 726 7864)	www.samsung.com/ae/support
OMAN	800-SAMSUNG (800 - 726 7864)	www.samsung.com/ae/support
KUWAIT	183-CALL (183-2255)	www.samsung.com/ae/support
BAHRAIN	800-CSAM (800-4726)	www.samsung.com/ae/support
QATAR	183-CALL (183-2255)	www.samsung.com/ae/support
JORDAN	0800-2275	www.samsung.com/Levant/support
SYRIA	06 5777444	www.samsung.com/Levant/support
MOROCCO	080 100 22 55	www.samsung.com/af/ica/support
SOUTH AFRICA	0800 SAMSUNG (726 7864)	www.samsung.com/support
BOTSWANA	8007260000	www.samsung.com/support
NAMIBIA	08 197 267 864	www.samsung.com/support
ZAMBIA	0211 363700	www.samsung.com/support
MOZAMBIQUE	847267864 / 827267864	www.samsung.com/support
GHANA	0800-726-7864	www.samsung.com/af/ica_support
NIGERIA	0800-10077	www.samsung.com/af/ica_support
Senegal	0800-10077	www.samsung.com/af/ica_support
Cameroon	7095-0077	www.samsung.com/af/ica_support
Kenya	0800 545 545	www.samsung.com/support
UGANDA	0800 300 300	www.samsung.com/support
TANZANIA	0800 745 745	www.samsung.com/support
RWANDA	9999	www.samsung.com/support
BURUNDI	200	www.samsung.com/support
DRC	499999	www.samsung.com/support
SUDAN	1969	www.samsung.com/support

Important Safety Instructions

Warning! Important Safety Instructions

(Please read the safety instructions below before installing and using the product.)

CAUTION
RISK OF ELECTRIC SHOCK; DO NOT OPEN
CAUTION: TO REDUCE THE RISK OF ELECTRIC SHOCK, DO NOT REMOVE COVER (OR BACK). THERE ARE NO USER SERVICEABLE PARTS INSIDE. REFER ALL SERVICING TO QUALIFIED PERSONNEL.

This symbol indicates that high voltage is present inside. It is dangerous to make any kind of contact with any internal part of the product.

This symbol indicates that important literature concerning operation and maintenance has been included with this product.

- The slots and openings in the cabinet and in the back or bottom are provided for necessary ventilation. To ensure reliable operation of this apparatus, and to protect it from overheating, these slots and openings must never be blocked or covered.
- Do not cover the slots and openings with a cloth or other materials.
- Do not block the slots and openings by placing this apparatus on a bed, sofa, rug or other similar surface.
- Do not place this apparatus in a confined space, such as a bookcase or built-in cabinet, unless proper ventilation is provided.
- Do not place this apparatus near or over a radiator or heat register, or where it is exposed to direct sunlight.
- Do not place a vessel containing water (vase etc.) on this apparatus, as this can result in a risk of fire or electric shock.
- Do not expose the apparatus to rain or place it near water (near a bathtub, washbowl, kitchen sink, or laundry tub, in a wet basement, or near a swimming pool etc.). If this apparatus accidentally gets wet, unplug it and contact an authorized dealer immediately.
- Make sure to pull out the power cord from the outlet before cleaning.
- This apparatus uses batteries. In your community, there might be regulations that require you to dispose of these batteries properly to protect the environment. Please contact your local authorities for disposal or recycling information.
- Do not overload wall outlets, extension cords, or adapters beyond their capacity, since this can result in fire or electric shock.
- Power-supply cords should be routed so that they are not likely to be walked on or pinched by items placed upon or against them. Pay particular attention to cords at the plug end, where connected to adapters, and at the point where they exit from the apparatus.
- To protect this apparatus from a lightning storm, or when it is left unattended and unused for long periods of time, unplug it from the wall outlet and disconnect the antenna or cable system. This will prevent damage to the set due to lightning and power line surges.
- Before connecting the AC power cord to the DC adaptor outlet, make sure the voltage designation of the DC adaptor corresponds to the local electrical supply. (depending on the model)
- Never insert anything metallic into the open parts of this apparatus. Doing so may create a danger of electric shock.
- To avoid electric shock, never touch the inside of this apparatus. Only a qualified technician should open this apparatus.
- Make sure to plug the power cord in until it is firmly inserted. Pull on the plug, not the cord, when removing the power cord from the outlet. Do not touch the power cord with wet hands.
- If this apparatus does not operate normally - in particular, if there are any unusual sounds or smells coming from it - unplug it immediately and contact an authorized dealer or service center.
- Be sure to pull the power plug out of the outlet if the TV is to remain unused or if you are to leave the house for an extended period of time (especially when children, elderly or disabled people will be left alone in the house).
- Accumulated dust can cause an electric shock, an electric leakage, or a fire by causing the power cord to generate sparks and heat, or cause the insulation to deteriorate.
- Be sure to contact an authorized service center, when installing your set in a location with heavy dust, high or low temperatures, high humidity, chemical substances or where it will operate for 24 hours a day such as in an airport, a train station, etc. Failure to do so may cause serious damage to your set.
- Use only a properly grounded plug and receptacle.
- An improper ground may cause electric shock or equipment damage. (Class I Equipment only).
- To turn off the apparatus completely, you must pull the power plug out of the wall socket. Consequently, the power plug should be readily accessible at all times.
- Do not allow children to hang onto the product.
- Store the accessories (batteries, etc.) in a location safely out of the reach of children.
- Do not install the product in an unstable location such as a shelf, a slanted floor, or a location exposed to vibration.
- Do not drop or impart a shock to the product. If the product is damaged, disconnect the power cord and contact a service center.
- To clean the product, unplug the power cord from the power outlet and wipe the product using a soft, dry cloth. Do not use any chemicals such as wax, benzene, alcohol, thinners, insecticides, air freshener, lubricant or detergent. This may damage the appearance or erase the printing on the product.
- Do not expose the apparatus to dripping or splashing.
- Do not dispose of batteries in a fire.
- Do not short circuit, disassemble, or overheat the batteries.
- Do not short circuit, disassemble, or overheat the batteries.
- There is a danger of explosion if you replace the batteries with the wrong type of battery. Replace only with the same or equivalent type.
- WARNING - TO PREVENT THE SPREAD OF FIRE, KEEP CANDLES OR OTHER OPEN FLAMES AWAY FROM THIS PRODUCT AT ALL TIMES.

Changing the Input Source

Source List

- Use to select TV or other external input sources such as DVD / Blu-ray players / cable box / STB satellite receiver connected to the TV.
- 1. Press the SOURCE button.
- 2. Select a desired external input source.
- TV / AV / Component / HDMI1 / HDMI2/DVI

When you only choose external devices that are connected to the TV, in the Source List, connected inputs will be highlighted.

Remote Control

This remote control has Braille points on the Power, Channel, and Volume buttons and can be used by visually impaired persons.

Turns the TV on and off.

Press to directly access to channels.

Alternately select Teletext ON, Double, Mix or OFF.

Adjusts the volume.

Displays the channel list on the screen.

Views the Media Play.

Quickly select frequently used functions.

Selects the on-screen menu items and changes the values seen on the menu.

Returns to the previous menu.

Exit the menu.

Use these buttons according to the direction on screen.

Use these buttons in a specific feature.

E-MANUAL: Not available.

SPORTS: Turns the Soccer Mode on or off.

Displays and selects the available video sources.

Returns to the previous channel.

Cuts off the sound temporarily.

Changes channels.

Displays the main on-screen menu.

Provides an optimal picture and sound for the popular content in your geographical area.

Displays information on the TV screen.

Display Modes (HDMI/DVI Input)

Optimal resolution
4 series: 1366 x 768@60Hz / 5 series: 1920 x 1080@60Hz

Mode	Resolution	Horizontal Frequency (Hz)	Vertical Frequency (Hz)	Pixel Clock Frequency (MHz)	Sync Polarity (H / V)	1366 x 768	1920 x 1080
IBM	720 x 400	31.469	70.087	28.322	+/-	✓	✓
	640 x 480	35.000	60.667	30.240	✓	✓	✓
	832 x 624	49.725	74.551	57.284	✓	✓	✓
MAC	1152 x 870	68.881	75.062	100.000	✓	✓	✓
	640 x 480	31.469	59.940	25.175	-/-	✓	✓
	640 x 480	37.881	72.809	31.500	✓	✓	✓
	640 x 480	37.500	75.000	31.500	✓	✓	✓
	800 x 600	37.879	60.217	40.000	✓	✓	✓
	800 x 600	48.077	72.198	50.000	✓	✓	✓
	800 x 600	48.875	75.000	48.500	✓	✓	✓
	1024 x 768	48.875	60.004	65.000	✓	✓	✓
	1024 x 768	56.478	70.069	75.000	-/-	✓	✓
	1024 x 768	60.023	75.023	78.750	✓	✓	✓
VESA DMT	1152 x 864	67.500	75.000	109.000	+/-	✓	✓
	1280 x 720	45.000	60.000	74.250	✓	✓	✓
	1280 x 800	49.702	59.810	83.000	-/-	✓	✓
	1280 x 1024	63.981	60.000	108.000	✓	✓	✓
	1280 x 1024	75.976	75.025	135.000	+/-	✓	✓
	1366 x 768	47.712	59.780	85.500	✓	✓	✓
	1440 x 900	55.935	59.887	106.500	✓	✓	✓
	1600 x 900P60	60.000	60.000	108.000	+/-	✓	✓
	1680 x 1050	65.290	59.954	146.250	-/-	✓	✓
	1920 x 1080	67.500	60.000	148.500	+/-	✓	✓

Installing batteries (Battery size: AAA)

NOTE

- Use the remote control within 7 m from TV.
- Bright light may affect the performance of the remote control. Avoid using nearby special fluorescent light or neon signs.
- The Colour and shape may vary depending on the model.

Getting Started

Accessories

- Remote Control & Batteries (AAA x 2)
- User Manual
- Warranty Card / Regulatory Guide (Not available in some locations)
- Power Cord

- Only for UA4100:
- Bracket-Wall
- Wall-Mount Kit
- Spacer-Felt

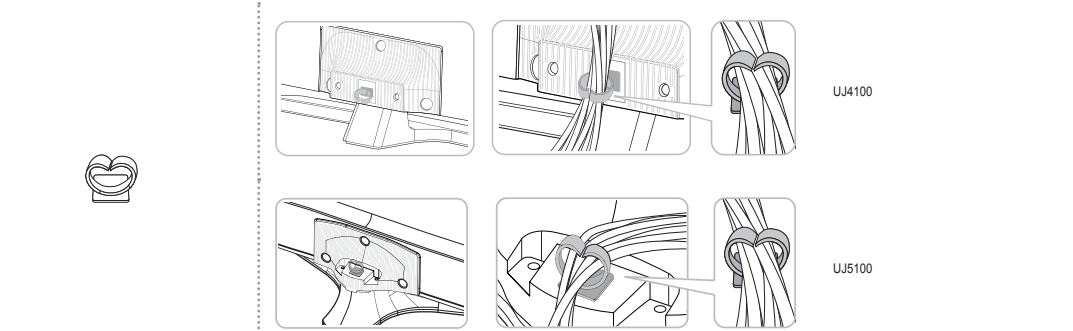

Assembling the Cable Holder

Input Cables (Sold Separately)

- Composite (AV)
- Coaxial (RF)
- HDMI-DVI
- Component
- HDMI

TV Controller (Panel Key)

Selecting the Media Play

Selecting the Menu

Selecting a Source

Power off

Function menu

Remote control sensor

TV Controller

The image is drawn by facing the front side of the TV.

To close the **Menu**, **Media Play** list, or **Source** List, press the Controller for more than 1 second.

When selecting the function by moving the controller to the up/down/left/right directions, be sure not to press the controller. If you press it first, you cannot operate it to move the up/down/left/right directions.

Plug & Play (Initial Setup)

- When you turn the TV on for the first time, a sequence of screens and on-screen prompts will assist you in configuring the TV's basic settings. Plug the power cord into a wall outlet, and then press the POWER button to turn on the TV. Set the initial setup following instructions that the TV guides.
- If you are not using a cable box or satellite box, make you sure have connected the TV to an Aerial or cable connection before you turn on the TV.
- Connecting the power cord and antenna. (refer to "Connections")

Connections

- For better picture and audio quality, connect to a digital device using an HDMI cable.
- The picture may not display normally if at all or the audio may not work if an external device that uses an older version of HDMI mode is connected to the TV. If such a problem occurs, ask the manufacturer of the external device about the HDMI version and, if out of date, request an upgrade.
- Be sure to purchase a certified HDMI cable. Otherwise, the picture may not display or a connection error may occur.
- PC / DVI AUDIO IN input is not supported.
- For HDMI/DVI cable connection, you must use the HDMI IN 2 (DVI) port.
- Connecting through the HDMI cable may not be supported depending on the PC.
- If an HDMI to DVI cable is connected to the HDMI IN 2 (DVI) port, the audio does not work.
- For Set-top box connection using HDMI cable, we highly recommend you to connect the HDMI IN 1 (STB) port.

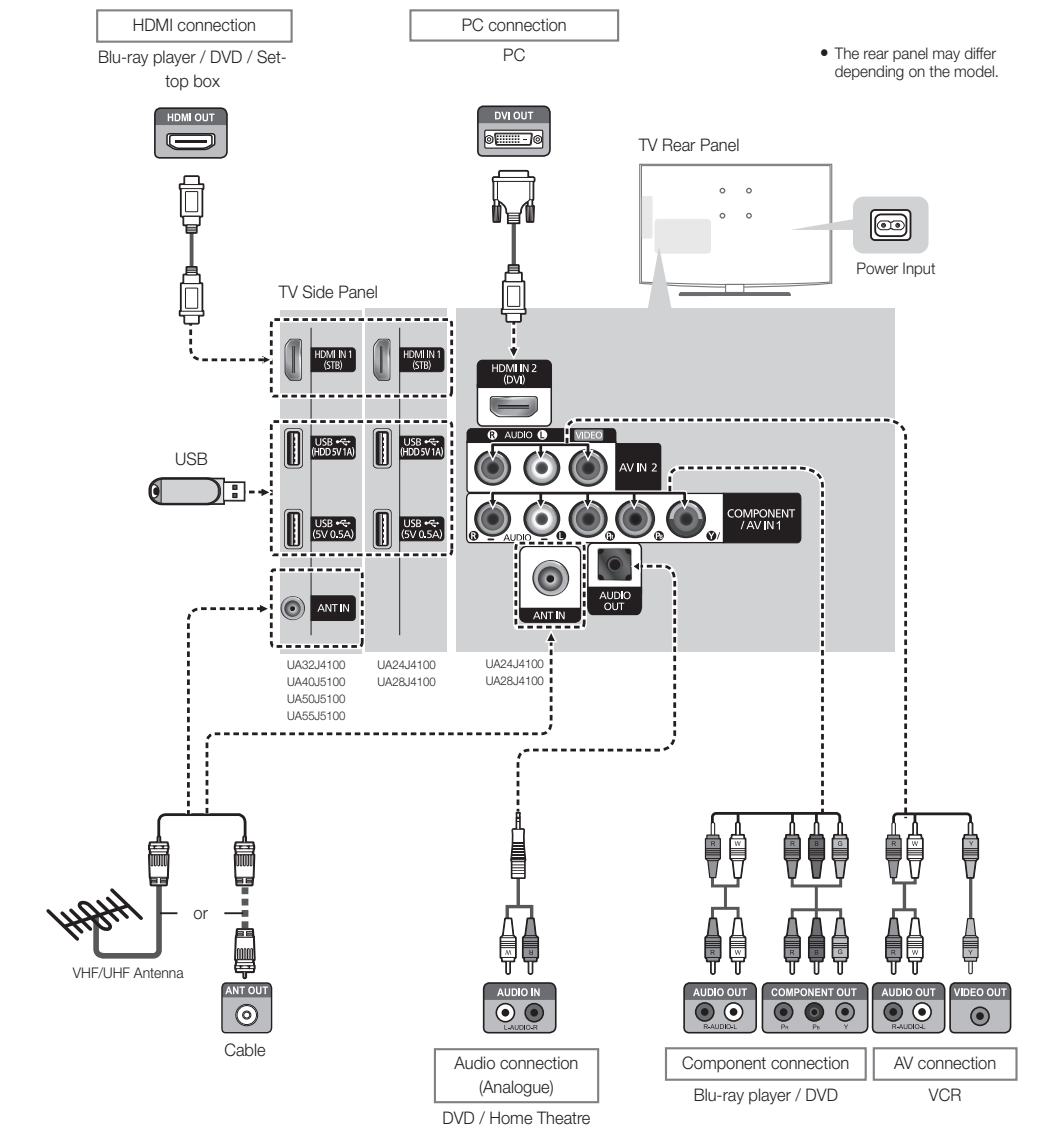

Support Menu

Using the Media Play

Enjoy photos, music and/or movie files saved on a USB Mass Storage Class (MSC) device.

Connecting a USB Device

- Turn on your TV.
- Connect a USB device containing photo, music and/or movie files to the **USB** jack on the side of the TV.
- When USB is connected to the TV, you can select **Media Play**.
 - The maximum displayed number of partition is 4.

Using the Media Play Menu

- Press the MENU button. Press the **▲** or **▼** button to select **Support**, then press the ENTER **↵** button.

- Press the **▲** or **▼** button to select **Media Play (USB)**, then press the ENTER **↵** button.
- Press the **◀** or **▶** button to select an icon (**Videos**, **Music**, **Photos**, **Story Replay**), then press the ENTER **↵** button.

It might not work properly with unlicensed multimedia files.

If you want to view detailed information of the file being played, press TOOLS button in the file list, and then select **Information**.

Need-to-Know List before using **Media Play (USB)**

- Supported file systems are FAT and NTFS.
- Certain types of USB Digital camera and audio devices may not be compatible with this TV.

- Media Play** only supports USB Mass Storage Class (MSC) devices. MSC is a Mass Storage Class Bulk-Only Transport device. Examples of MSC are Thumb drives and Flash Card Readers. Devices should be connected directly to the TV's USB port. (LED 4100, 5100 series: USB HDD power supported limitation is 1A.) Does not support smart devices connected in MTP or PTP protocol.

- Before connecting your device to the TV, please back up your files to prevent them from damage or loss of data. SAMSUNG is not responsible for any data file damage or data loss.

- A USB device that requires high power may not be supported. (LED 4100, 5100 series and above: 1A)

- Do not disconnect the USB device while it is loading.

- The higher the resolution of the image, the longer it takes to display on the screen.

- The maximum supported JPEG resolution is 15360 x 8640 pixels.

- If a file is corrupted or the TV does not support the file type, the "Not Supported File Format" message appears.

- If a USB extension cable is used, the USB device may not be recognised or the files on the device may not be read.

- The TV cannot play MP3 files with DRM that have been downloaded from a for-pay site. Digital Rights Management (DRM) is a technology that supports the creation, distribution, and management of digital content in an integrated and comprehensive way, including protecting the rights and interests of content providers, preventing illegal copying of contents, and managing billings and settlements.

- PTP device is not supported.

- If an over-power warning message is displayed while you are connecting or using a USB device, the device may not be recognised or may malfunction.

- The power-saving mode of some external hard disk drives may be released automatically when you connect them to the TV.
- If a USB device connected to the TV is not recognised, the list of files on the device is corrupted, or a file in the list is not played, connect the USB device to a PC, format the device, and check the connection.

- If a file you deleted from the PC is still found when you run **Media Play**, use the "Empty the Recycle Bin" function on the PC to permanently delete the file.

- Photos** only supports sequential jpeg format.

- The scene search and thumbnail functions are not supported in the **Videos**.

- If the number of files and folders saved on a USB storage device is approximately over 4000, the files and folders may not appear and some folders may not be opened.

- The maximum displayed number of files, including sub folders, in one folder of USB storage device is 1000.

- The media may not be playing smoothly when using the device higher than USB 2.0.

- The maximum displayed number of partition is 4.

- The file name only works in supported menu language. The other language is not displayed properly.

Videos

- Press the **◀** or **▶** button to select **Videos**, then press the ENTER **↵** button in the **Media Play** menu.

- Press the **◀/▶/▲/▼** buttons to select the desired video in the file list.

- Press the ENTER **↵** button or **⏮** (Play) button.

- The selected file is displayed on the top with its playing time.

- If video time information is unknown, playing time and the progress bar are not displayed.

- During video playback, you can search using the **◀** and **▶** button.

- You can use **⏮** (REW) and **⏭** (FF) buttons during playback.

Supported Subtitle Formats

- External

Name	File extension
MPEG-4 timed text	.ttd
Subrip	.art
SubViewer	.sub
Micro DVD	.sub or .txt
SubStation Alpha	.ssa
Advanced SubStation Alpha	.ass

- Internal

Name	Container	Format
Sub	AVI	Picture Format
SubStation Alpha	MKV	Text Format
Advanced SubStation Alpha	MKV	Text Format
Subrip	MKV	Text Format
MPEG-4 Timed text	MP4	Text Format

Supported Video Formats

File Extension	Container	Video Codec	Resolution	Frame rate/Hz	Bit rate/mbps	Audio Codec
*.mp4	MP4	DNx 3.11A, 12.5, xHEVC	1080x1080	6-30	20Mbps	MP3 / AAC / M / AAC
		H.264	1080x1080	6-30	20Mbps	
		VC1	1080x1080	6-30	20Mbps	
		MPEG2	4096x4096	6-30	10Mbps	
*.avi	AVI	DNx 3.11A, 12.5, xHEVC	1080x1080	6-30	20Mbps	MP3 / AAC / LPCM / ADPCM / DTS
		H.264	1080x1080	6-30	20Mbps	
		MPEG2	4096x4096	6-30	10Mbps	
*.asf	ASF	DNx 3.11A, 12.5, xHEVC	1080x1080	6-30	20Mbps	MP3 / AAC / LPCM / ADPCM / M / A / AAC
		H.264	1080x1080	6-30	20Mbps	WMA / WMA Pro
*.ts	TS	MPEG2-TS	1080x1080	6-30	20Mbps	AC3 / AAC / DTS
*.h264		H.264	1080x1080	6-30	20Mbps	
*.m2ts		MPEG2	1080x1080	6-30	20Mbps	AC3 / MPEG2
*.m2ts	PS	MPEG2	1080x1080	6-30	20Mbps	AC3 / MPEG2
*.h264		H.264	1080x1080	6-30	20Mbps	
*.h264	3GPP	MPEG2 12/14	1080x1080	6-30	20Mbps	MP3
*.h264		H.264	1080x1080	6-30	20Mbps	
*.h264	h264 format	Sorenson H.263	1080x1080	6-30	20Mbps	MP3

Other Restrictions

- Video content will not play, or not play correctly, if there is an error in the content or the container.

- Sound or video may not work if the contents have a standard bit rate/frame rate above the compatible frame/sizes listed in the table above.

- If the Index Table is in error, the Seek (Jump) function is not supported.

- The menu may take longer to appear if the video's bit rate exceeds 10Mbps.

- Video content can not be played, if there are many contents in one file.

- You can use **⏮** (REW) and **⏭** (FF) buttons during playback.

- In this mode, you can play movie clips contained in a game, but you cannot play the game itself.

Supported Subtitle Formats

- External

Name	File extension
MPEG-4 timed text	.ttd
Subrip	.art
SubViewer	.sub
Micro DVD	.sub or .txt
SubStation Alpha	.ssa
Advanced SubStation Alpha	.ass

- Internal

Name	Container	Format
Sub	AVI	Picture Format
SubStation Alpha	MKV	Text Format
Advanced SubStation Alpha	MKV	Text Format
Subrip	MKV	Text Format
MPEG-4 Timed text	MP4	Text Format

Music

- Press the **◀** or **▶** button to select **Music**, then press the ENTER **↵** button in the **Media Play** menu.

- Press the **◀/▶/▲/▼** buttons to select the desired Music in the file list.

- Press the ENTER **↵** button or **⏮** (Play) button.

- During music playback, you can search using the **◀** and **▶** button.

- ⏮** (REW) and **⏭** (FF) buttons do not function during play.

- Only displays the files with MP3 file extension. Other file extensions are not displayed, even if they are saved on the same USB device.

- If the need to change **Equalizer** - when playing MP3, then exit **Media Play**, adjust the **Equalizer** in the **Sound** menu. (An over-modulated MP3 file may cause a sound problem.)

Photos

- Press the **◀** or **▶** button to select **Photos**, then press the ENTER **↵** button in the **Media Play** menu.

- Press the **◀/▶/▲/▼** buttons to select the desired photo in the file list.

- Press the ENTER **↵** button or **⏮** (Play) button.

NOTE

- While a photo list is displayed, press the **⏮** (Play) / ENTER **↵** button on the remote control to start the slide show.

- All files in the file list section will be displayed in the slide show.

- During the slide show, files are displayed in order.

- During the slide show, you can adjust the slide show speed using **⏮** (REW) or **⏭** (FF) button.

- You can move to other file using **◀** or **▶** button.

- Press TOOLS button and select **Background Music**. Music files can be automatically played during the Slide Show if the **Background Music** is set to On.

- The **Mode** in **Background Music** cannot be changed until the BGM has finished loading.

Supported Photo Formats

Image	Photo	Resolution
JPEG	Base-line	15360 x 8704
	Progressive	1024 x 768

Other Restrictions

- CMYK, YCCOK Colour space JPEG are not supported.

Playing Multiple Files

Selected video/music/photo files

- Press the Yellow button in the file list to select the desired file.
- Repeat the above operation to select multiple files.

NOTE

- The **✓** mark appears to the left of the selected files.
- To cancel a selection, press the Yellow button again.
- To deselect all selected files, press the TOOLS button and select **Deselect All**.

Playing the video/music/photo file group

- While a file list is displayed, move to any file in desired group.

Copying the files to the other USB device For 4100 / 5100 models

- Press the **⏮** button in the file list to select the desired file.
- When you press the **⏮** button, the selected files copy to the other USB device.

- Available only when both USB devices are connected to the TV.

- The FAT32 file system cannot copy the file which size is more than 4GB.

- Copy is only available for 4100/5100 models.

- The maximum number of marked files for one folder is 999, if to be continued, 1 more files can be marked in another folder.

USB	Support File System
Play (Read)	NTFS, FAT, FAT32
Copy & Capture	FAT, FAT32
Delete	NTFS, FAT, FAT32
Format	NTFS, FAT, FAT32

- All file system format will be transformed to FAT32 system after formatting.

Media Play - Additional Functions

Videos/Music/Photos Play Option menus

When playing a file, press the TOOLS button.

Category	Operation	Videos	Music	Photos
Repeat Mode	You can play movie and music files repeatedly.	✓	✓	
Picture Size	You can adjust the picture size to your preference.	✓		
Picture Mode	You can adjust the picture setting.	✓		✓
Sound Mode	You can adjust the sound setting.	✓	✓	✓
Subtitle Settings	You can play the video with Subtitles. This function only works if the subtitles are the same file name as the video.	✓		
Audio language	You can change the audio language if the video has more than one language.	✓		
Stop Slide Show / Start Slide Show	You can start or stop a Slide Show.			✓
Slide Show Speed	You can select the slide show speed during the slide show.			✓
Background Music	You can set and select background music when watching a Slide Show.			✓
Zoom	You can zoom into images in full screen mode.			✓
Rotate	You can rotate images in full screen mode.			✓
Information	You can see detailed information about the played file.	✓	✓	✓

Using the Sports Mode

Sports Mode TOOLS

This mode provides optimized condition for watching sports games.

A Zoom: Pause playback and dived the picture into 9 parts. Select a part to zoom it in. Press this button again to resume.

- When **Sports Mode** is On, the picture and sound modes are set to **Stadium** automatically.

- If you turn the TV off while watching **Sports Mode**, the **Sports Mode** will be disable.

- Mode name may vary depending on nations. **Cricket Mode**, **Soccer Mode**, **Sports Mode**.

African Cinema Mode

Using the African Cinema Mode

When you set **African Cinema Mode** to On, the TV provides an optimal picture and sound for popular content.

- This function is only available on certain models in specific geographical areas.

Using the More TV Feature

More TV Feature

This mode provides a way to capture the images and audio.

- Only available for UJ4100/5100.

- Press **⏮** and the **More TV Feature** mode will be turned on, or press MENU button, enter Support Menu select **More TV Feature**. Press **⏮** again the **More TV Feature** mode will be turned off.

- Before enabling the **More TV Feature** mode, the USB device should be connected first.

- Media Play** mode not available.

- Sports Mode** and **Game Mode** and **Cinema Mode** can not be operated at the same time.

Screen Capture

After turning on the **More TV Feature** mode, press **⏮** to make a current screen capture.

Items are stored in **Photos** folder in **Media Play**.

Sound Recording

After turning on the **More TV Feature** mode, press **⏮** to make a recording of the current sound, press **⏮** again to stop the recording.

Items are stored in **Music** folder in **Media Play**.

Story Replay

- To Story Replay Replay while watching TV, press **⏮**. This records audio in real-time, and captures the screen every 5 seconds in the meanwhile.

- A pop-up window will appear on the screen while recording is in progress.

- To stop Story Replay, press **⏮**. The recording is stored as a .plt file on the USB device connected to the TV. Thumbnails of the story recordings are then shown on the screen.

- Select the thumbnail screen to play the saved files on Media Play.

- You cannot change the channel or source to an external device. To change the channel or the source to an external device, first stop story recording.

Story Replay feature is just an application provided by Samsung and Samsung does not take any responsibility of its use by the user. The use/ intended use of the application is for the personal or private use of the user only. User shall be responsible for complying with all other laws of the land while using the application and shall further be liable for any damage, penalty, legal action arising out of misuse of application, including without limitation, infringement of Intellectual Property Rights.

View Content

Press **⏮** to get into **Media Play**.

- Press **⏮** or **▶** button to select **Music** and **Story Replay** for items of recording or **Photos** for items of capturing.

- More TV Feature** are for personal use only, not for commercial purpose and/or communication to the public.

- The user may not use these features for commercial purposes without prior approval from the copyright owners and/or to use it unlawfully.

- Samsung does not accept responsibility for any misuse of the service.

Default Recording Device

- You can set the default device for saving captured image files and recorded audio files.

- This function is only available when the USB device is connected the TV, and **More TV Feature** mode is on.

Software Upgrade

Software Upgrade can be performed by downloading the latest firmware from "www.samsung.com" to a USB memory device.

Changing the Use Mode

Select the **Use Mode** suitable for your place. We strongly recommend you select **Home Use**.

- Home Use:** Home Use is the default setting.
- Store Demo:** **Store Demo** is for retail environments only. If you select **Store Demo**, some functions will not work, and the picture settings will be reset every 5 minutes.

DivX® Video On Demand

Shows the registration code authorised for the TV. If you connect to the DivX web site and register with 10-digit registration code, you can download the VOD activation file. Once you play it using **Media Play**, the registration is completed.

- For more information on DivX® VOD, visit <http://vod.divx.com>.

HD Connection Guide

You can read a guide to connect external devices for HD sources.

Contact Samsung

View this information when your TV does not work properly or when you want to upgrade the software. You can find information regarding our call centres, and how to download products and software.

Changing the Use Mode

Select the **Use Mode** suitable for your place. We strongly recommend you select **Home Use**.

- Home Use:** Home Use is the default setting.
- Store Demo:** **Store Demo** is for retail environments only. If you select **Store Demo**, some functions will not work, and the picture settings will be reset every 5 minutes.

Other Information

Installing the Wall Mount

- Installing the Wall Mount kit with the GUIDE-STAND supplied by SAMSUNG, Please refer to the "Wall Mount Quick Setup Guide" (Only for UJ4100)

- Installing other Wall Mount Kits, Please refer as follow:

The wall mount kit (sold separately) allows you to mount the TV on the wall. For detailed information on installing the wall mount, see the instructions provided with the wall mount. Contact a technician for assistance when installing the wall mount bracket. We do not advice you to do it yourself.

Samsung Electronics is not responsible for any damage to the product or injury to yourself or others if you select to install the TV on your own.

Wall Mount Kit Specifications (VESA)

- The wall mount kit is not supplied, sold separately.

- Install your wall mount on a solid wall perpendicular to the floor. When attaching to other building materials, please contact your nearest dealer. If you install the TV on a ceiling or slanted wall, it may fall and result in severe personal injury.

- NOTE**

- Standard dimensions for wall mount kits are shown in the table below.

- When purchasing our wall mount kit, a detailed installation manual and all parts necessary for assembly are provided.