



AH68-02158Y

MM-DG25

PERSONAL MICRO COMPONENT
SYSTEM
user manual

imagine the possibilities

Thank you for purchasing a Samsung product.

To receive a more complete service,
please register your product at
www.samsung.com/global/register





Safety Warnings

CAUTION
RISK OF ELECTRIC SHOCK.
DO NOT OPEN

TO REDUCE THE RISK OF ELECTRIC SHOCK, DO NOT REMOVE REAR COVER (or BACK). NO USER SERVICEABLE PARTS INSIDE. REFER SERVICING TO QUALIFIED SERVICE PERSONNEL.

CLASS 1 LASER PRODUCT
KLASSE 1 LASER PRODUKT
LUOKAN 1 LASER LAITE
KLASS 1 LASER APPARAT
PRODUCTO LASER CLASE 1



This symbol indicates “dangerous voltage” inside the product that presents a risk of electric shock or personal injury.



This symbol indicates important instructions accompanying the product.

CLASS 1 LASER PRODUCT

This Compact Disc player is classified as a CLASS 1 LASER product.

Use of controls, adjustments or performance of procedures other than those specified herein may result in hazardous radiation exposure.

CAUTION : INVISIBLE LASER RADIATION WHEN OPEN AND INTERLOCKS DEFEATED, AVOID EXPOSURE TO BEAM.

WARNING : To reduce the risk of fire or electric shock, do not expose this appliance to rain or moisture.

CAUTION : TO PREVENT ELECTRIC SHOCK, MATCH WIDE BLADE OF PLUG TO WIDE SLOT, FULLY INSERT.

- This apparatus shall always be connected to a AC outlet with a protective grounding connection.
- To disconnect the apparatus from the mains, the plug must be pulled out from the mains socket, therefore the mains plug shall be readily operable.

CAUTION

- Apparatus shall not be exposed to dripping or splashing and no objects filled with liquids, such as vases, shall be placed on the apparatus.
- The Mains plug is used as a disconnect device and shall stay readily operable at any time.

[Saudi Arabian Standards Organisation only]

THIS APPLIANCE IS FITTED WITH 220V SASO APPROVED PLUG.THE CUSTOMER IS ENTITLED TO A FREE SASO APPROVED 127V PLUG FROM THE LOCAL DEALER.



Precautions

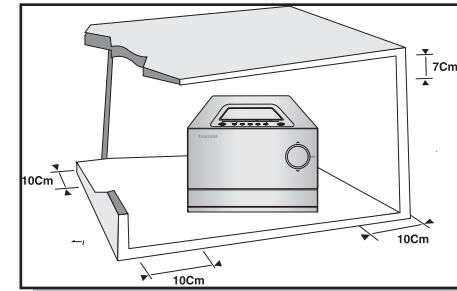

Ensure that the AC power supply in your house complies with the identification sticker located on the back of your player. Install your player horizontally, on a suitable base (furniture), with enough space around it for ventilation (3~4inches). Make sure the ventilation slots are not covered. Do not stack anything on top of the player. Do not place the player on amplifiers or other equipment which may become hot. Before moving the player, ensure the disc tray is empty. This player is designed for continuous use. Switching off the DVD player to the stand-by mode does not disconnect the electrical supply. In order to disconnect the player completely from the power supply, remove the main plug from the wall outlet, especially when left unused for a long period of time.

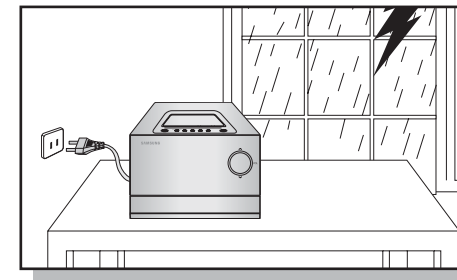
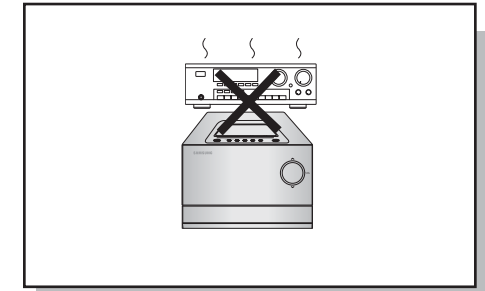

During thunderstorms, disconnect AC main plug from the wall outlet.
Voltage peaks due to lightning could damage the unit.

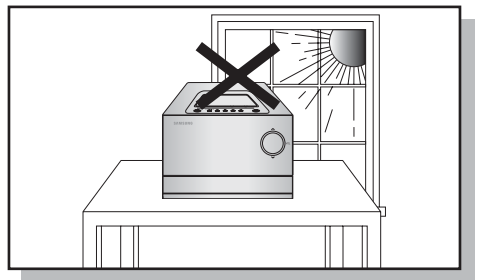

Do not expose the unit to direct sunlight or other heat sources.
This could lead to overheating and malfunction of the unit.

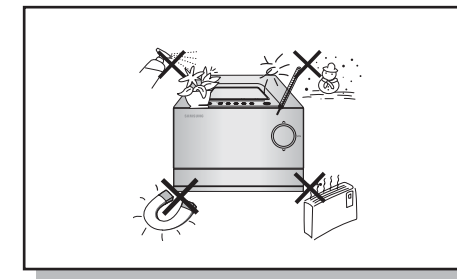

Protect the player from moisture(i.e. vases) , and excess heat(e. g.fireplace) or equipment creating strong magnetic or electric fields (i. e.speakers...). Disconnect the power cable from the AC supply if the player malfunctions. Your player is not intended for industrial use.
Use of this product is for personal use only.
Condensation may occur if your player or disc have been stored in cold temperatures.
If transporting the player during the winter, wait approximately 2 hours until the unit has reached room temperature before using.

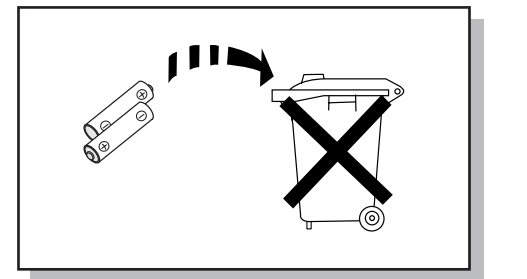

The battery used with this product contain chemicals that are harmful to the environment.
Do not dispose of batteries in the general household trash.



Features

● Multi-Disc Playback & FM Tuner

The MM-DG25 combines the convenience of multi-disc playback capability, including DVD, CD, MP3-CD, CD-R, CD-RW, DivX, JPEG and DVD-R/RW, with a sophisticated FM tuner, TAPE, USB HOST all in a single player.

● TV Screen Saver Function

The MM-DG25 automatically brightens and darkens the brightness of the TV screen after 3 minutes in the stop mode.
The MM-DG25 automatically switches itself into the power saving mode after 20 minutes in the screen saver mode.

● Power Saving Function

The MM-DG25 automatically shuts itself off after 20 minutes in the stop mode(only for USB, DVD).



DVD (Digital Versatile Disc) offers fantastic audio and video, thanks to Dolby Digital surround sound and MPEG-2 video compression technology. Now you can enjoy these realistic effects in the home, as if you were in a movie theater or concert hall.



DVD players and the discs are coded by region. These regional codes must match in order for the disc to play. If the codes do not match, the disc will not play.
The Region Number for this player is given on the rear panel of the player.
(Your DVD player will only play DVDs that are labeled with identical region codes.)

Copy Protection

- Many DVD discs are encoded with copy protection. Because of this, you should only connect your DVD player directly to your TV, not to a VCR. Connecting to a VCR results in a distorted picture from copy-protected DVD discs.
- This product incorporates copyright protection technology that is protected by methods claims of certain U.S. patents and other intellectual property rights owned by Macrovision Corporation and other rights owners. Use of this copyright protection technology must be authorized by Macrovision Corporation, and is intended for home and other limited viewing uses only unless otherwise authorized by Macrovision Corporation. Reverse engineering or disassembly is prohibited.



Contents

● PREPARATION

Safety Warnings	1
Precautions	2
Features	3
Description	5

● CONNECTIONS

Connecting the Speakers	9
Connecting to a TV	10
P.SCAN(Progressive Scan) Function	12
Connecting External Components	13
Connecting the FM Antennas	14
Setting the Clock	15

● OPERATION

Disc Playback	16
MP3/WMA-CD Playback	17
JPEG File Playback	18
DivX Playback	19
Playing Media Files using the USB feature	21
Displaying Disc Information	23
Fast/Slow Playback	24
Skipping Scenes/Songs	25
Angle Function	26
Repeat Playback	27
A-B Repeat Playback	28
Zoom Function	29
Selecting Audio/Subtitle Language	30
Moving Directly to a Scene/Song	31
Using Disc Menu	32
Using the Title Menu	33

● SETUP

Setting the Language	34
Setting TV Screen type	35
Setting Parental Controls (Rating Level)	37
Setting the Password	38
Setting the DRC (Dynamic Range Compression)	39
AV SYNC Setup	40

● RADIO OPERATION

Listening to Radio	41
Presetting Stations	42

● TAPE

Listening to a Cassette	43
Recording a Radio Program	44
Recording a Compact Disc	45

● MISCELLANEOUS

CD RIPPING Function	47
Timer Function	48
Canceling the Timer	49
POWER SOUND/Treble Level/Bass Level Function	50
DSP/EQ Function/Power Bass Function	51
Sleep Timer Function / Mute Function	52
DEMO Function / DIMMER Function / ECO function	53
Connecting Headphones	54
Cautions on Handling and Storing Discs	55
Precautions When Using Audio Cassettes	55
Before Calling for Service	56
Notes on Discs	58
Notes on Terminology	59
Specifications	60



Description

—Front Panel—

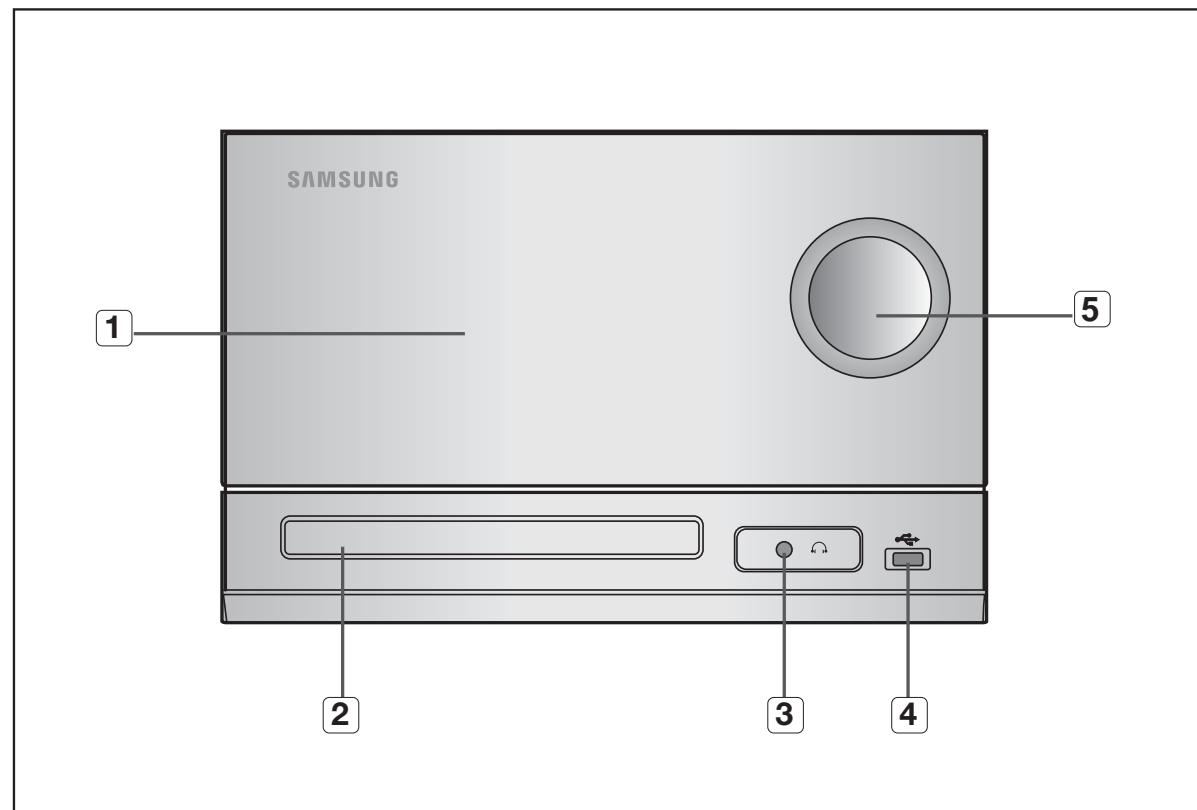

- | | |
|-----------------------------|-------------|
| 1. WINDOW DISPLAY | 4. USB JACK |
| 2. COMPACT DISC COMPARTMENT | 5. VOLUME |
| 3. HEADPHONE JACK | |

WHAT'S INCLUDED

Check for the supplied accessories below.

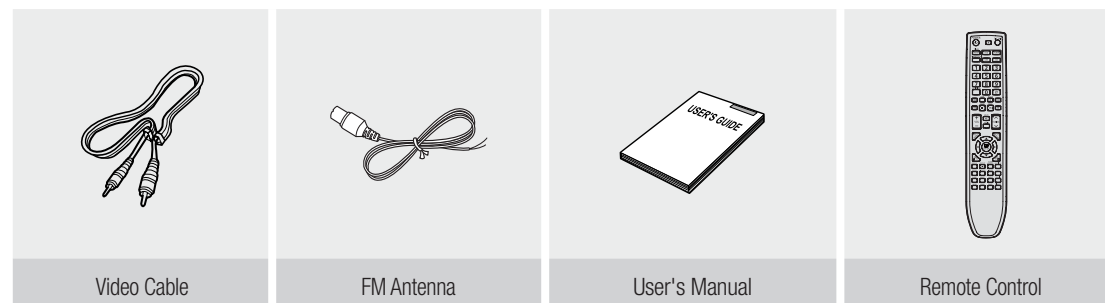

Video Cable

FM Antenna

User's Manual

Remote Control

—Top Panel—

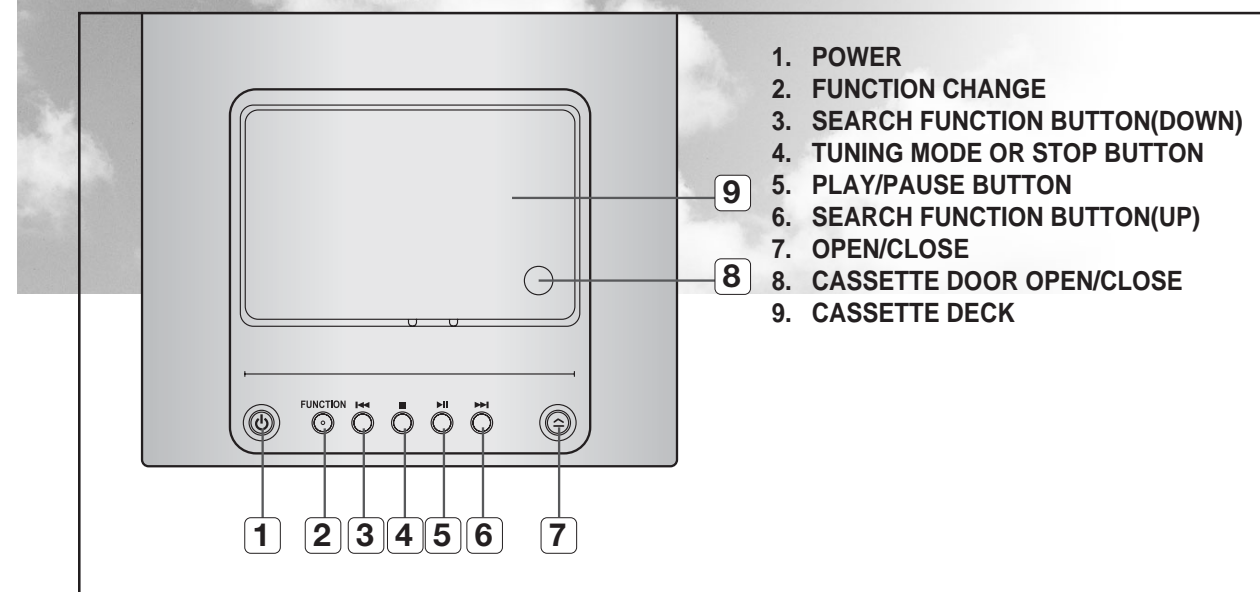

1. POWER
2. FUNCTION CHANGE
3. SEARCH FUNCTION BUTTON(DOWN)
4. TUNING MODE OR STOP BUTTON
5. PLAY/PAUSE BUTTON
6. SEARCH FUNCTION BUTTON(UP)
7. OPEN/CLOSE
8. CASSETTE DOOR OPEN/CLOSE
9. CASSETTE DECK

—Rear Panel—

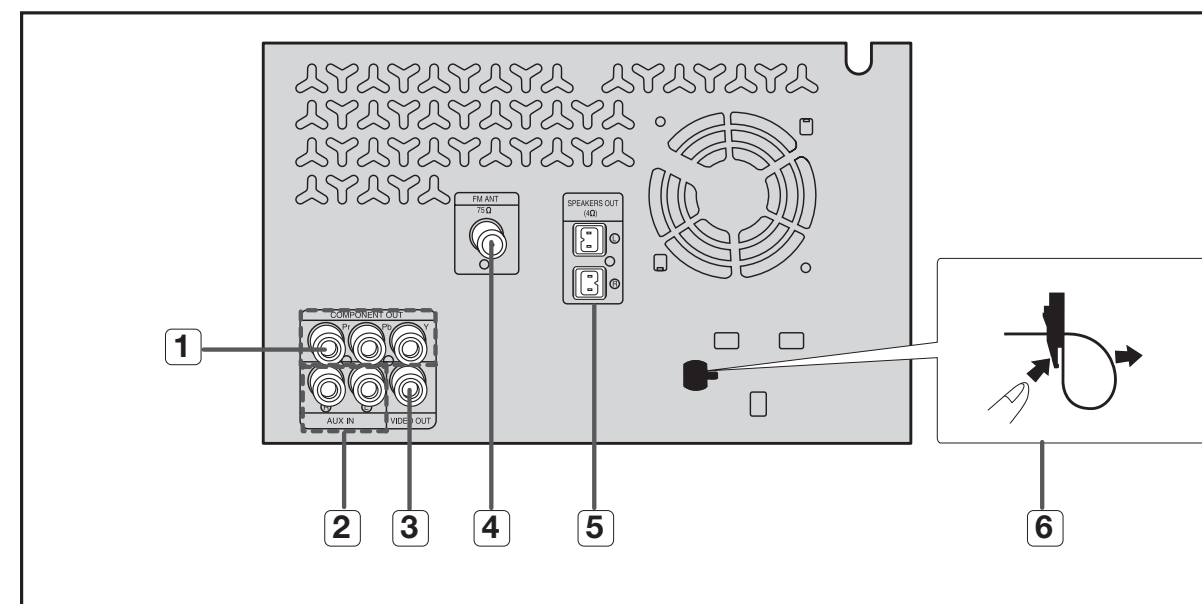

1. **Component Output Connectors**
Connect a TV with component video input jacks to these jacks.
2. **AUX IN**
3. **Video Output Connector**
Connect the TV's video input jacks (VIDEO IN) to the VIDEO OUT connector.
4. **FM Antenna Connector**
5. **Speaker Connector Terminals**
6. **Clamp-Wire (Fasten the speaker wires.)**



Description

—Remote Control—

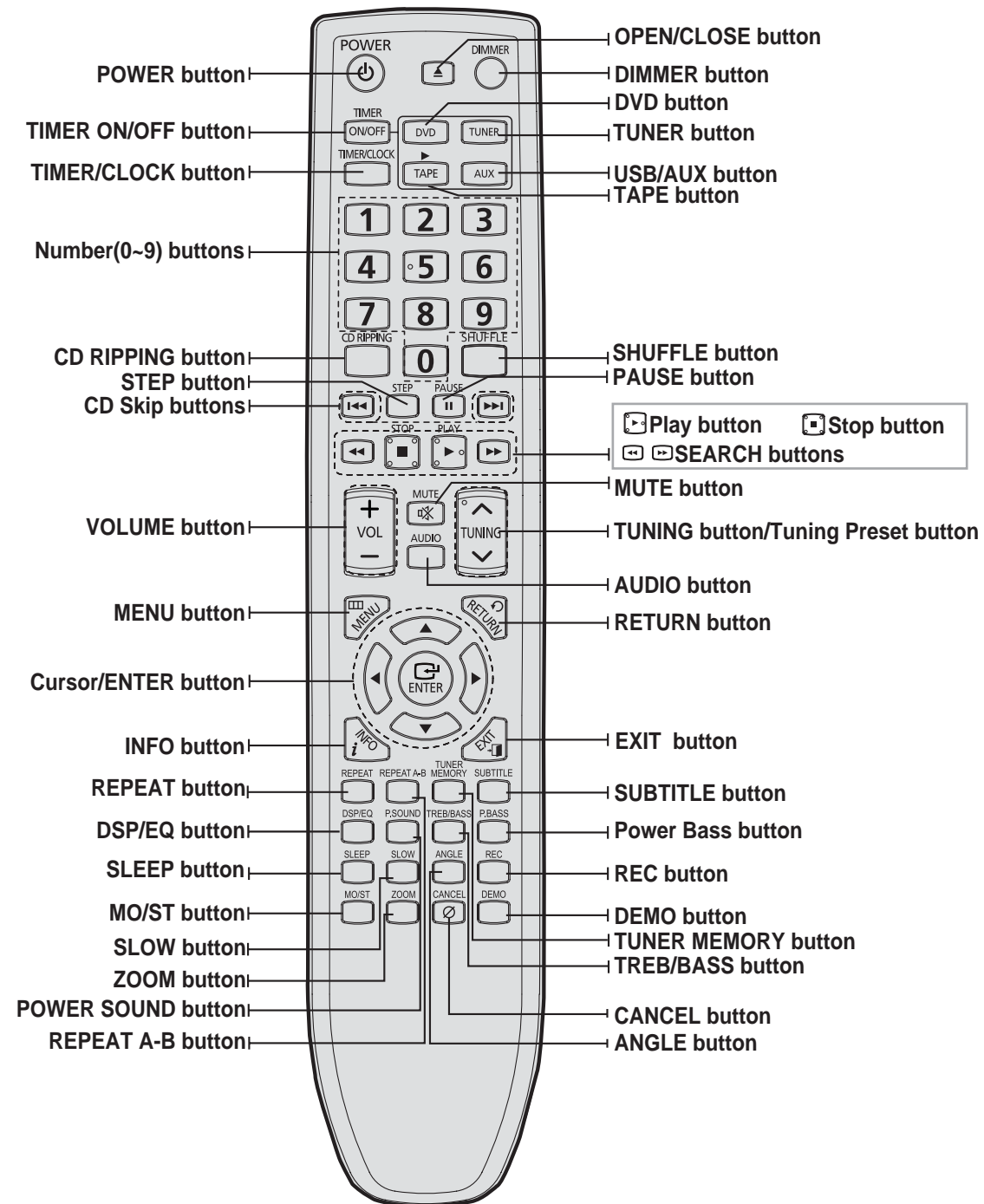

Insert Remote Batteries

1 Remove the battery cover in the direction of the arrow.

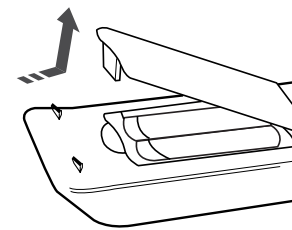

2 Insert two 1.5V AAA batteries, paying attention to the correct polarities (+ and -).

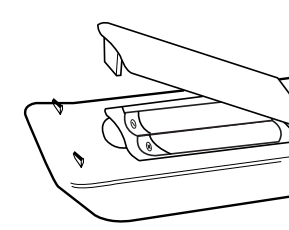

3 Replace the battery cover.

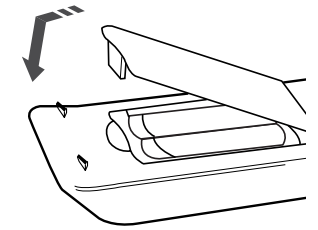

Caution

Follow these precautions to avoid leaking or cracking cells:

- Place batteries in the remote control so they match the polarity:(+) to (+)and (-)to (-).
- Use the correct type of batteries.Batteries that look similar may differ in voltage.
- Always replace both batteries at the same time.
- Do not expose batteries to heat or flame.

Range of Operation of the Remote Control

The remote control can be used up to approximately 23 feet/7 meters in a straight line. It can also be operated at a horizontal angle of up to 45° from the remote control sensor.

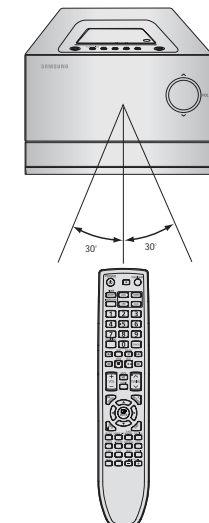



Connecting the Speakers

Before moving or installing the product, be sure to turn off the power and disconnect the power cord.

The loudspeaker connector terminals are located on the rear of the system.

There are two terminals on the system:

- ◆ left speaker (marked L)
- ◆ right speaker (marked R)

To achieve the correct sound quality, insert those speaker connector cables to the speaker connector terminals of the system.

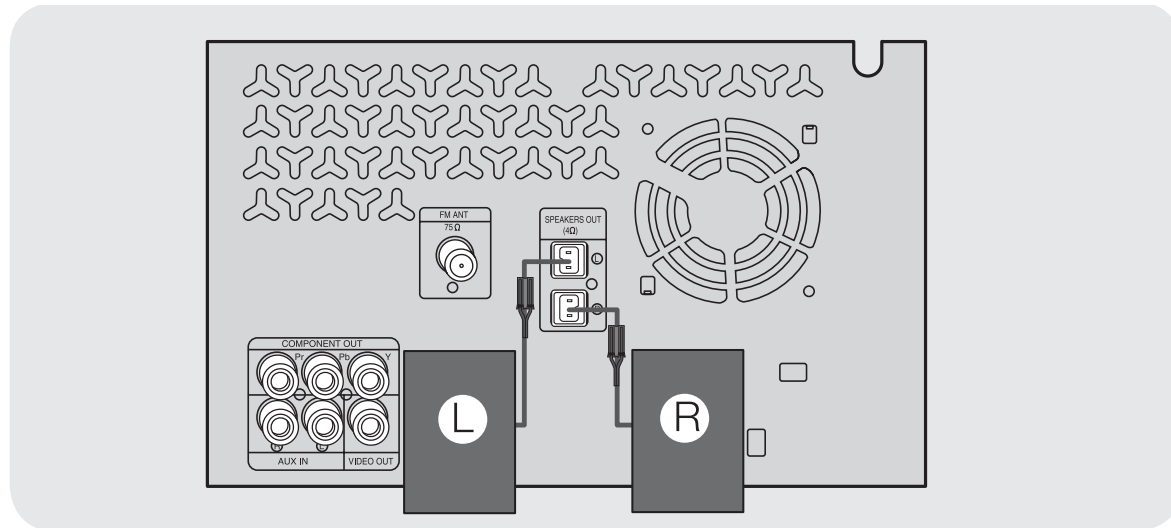

Position of the DVD Player

- Place it on a stand or cabinet shelf, or under the TV stand.

Selecting the Listening Position

The listening position should be located about 2.5 to 3 times the distance of the TV's screen size away from the TV. Example: For 32" TVs 2~2.4m (6~8feet)
For 55" TVs 3.5~4m (11~13feet)

Front Speakers L R

- Place these speakers in front of your listening position, facing inwards (about 45°) toward you.
- Place the speakers so that their tweeters will be at the same height as your ear.

Directions in Installing Speaker

- Installation in a place near heating apparatus, under direct lay of light or with high humidity may cause performance degradation of the speaker.
- Do not install on the wall or on a high place of pole or other unstable place to prevent any safety accident caused by falling of the speaker.
- Do not take the speaker near from TV or computer monitor.
The speaker near the TV or computer monitor may influence the quality of the screen display.



Connecting to a TV

Please be sure to turn off the power and unplug the power cord before moving or installing this unit.

Please choose one video connection method.

Method 1 Using Video Out (Good Quality)

- 1 Connect Video Out on the player to Video In on your TV.
- 2 Press the TV/VIDEO button on the remote of TV control to set the TV to "VIDEO".

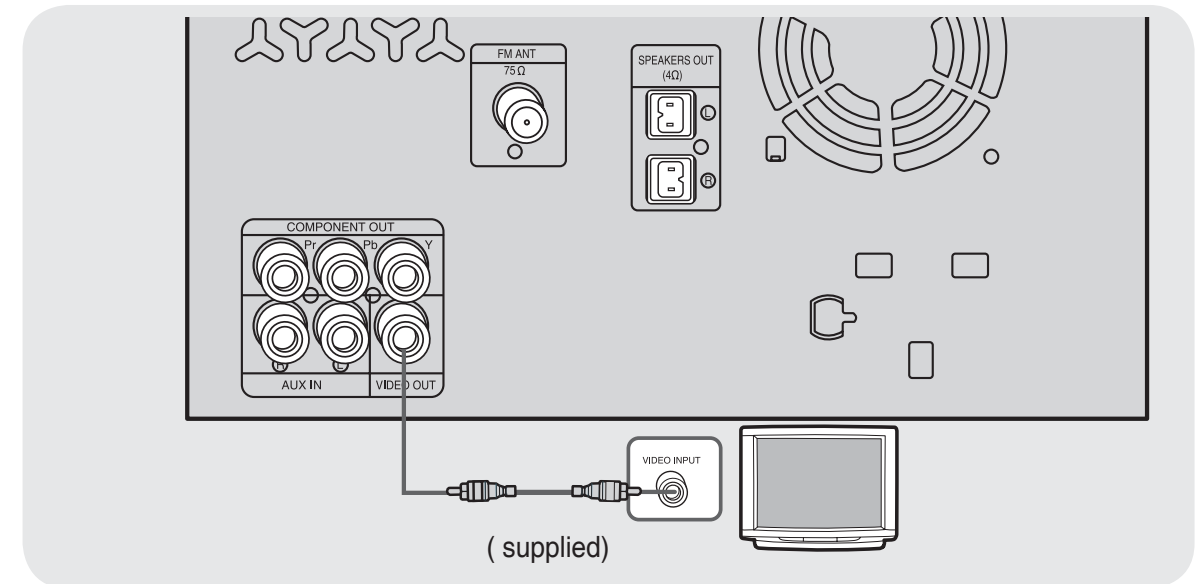

Note

- Composite Video: A single video signal that is a composite of the black-and-white information (Y) and the color information (C).

Connecting to a TV(Con't)

Please be sure to turn off the power and unplug the power cord before moving or installing this unit.
Please choose one video connection method.

Method 2 Component Video (Best Quality)

Use this method if your TV have Pr,Pb andY jacks.

If your television is equipped with Component Video inputs,connect a component video cable from the Pr,Pb and Y jacks on the back panel of the system to the corresponding jacks on your television.

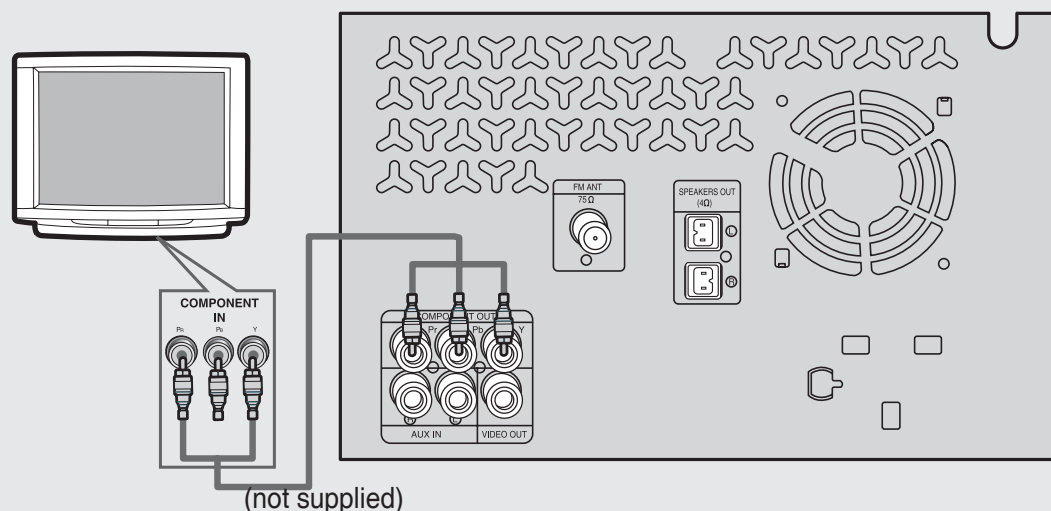

P-SCAN (Progressive Scan) Function

ENG

Unlike regular Interlace Scan, in which two fields of picture information alternate to create the entire picture (odd scan lines, then even scan lines), Progressive Scan uses one field of information (all lines displayed in one pass) to create a clear and detailed picture without visible scan lines.

You can select "Progressive Scan" or "Interlace Scan" for you TV.
Please go to <Setup>→<Display Setup>→<Video Output> and set I-SCAN or P-SCAN.
(see the page 35.)

What is Progressive (or Non-Interlaced) Scanning?

Interlaced Scan (1 FRAME = 2 FIELDS)	Progressive Scan (FULL FRAME)
<p>In interlaced-scan video, a frame consists of two interlaced fields (odd and even), where each field contains every other horizontal line in the frame. The odd field of alternating lines is displayed first, and then the even field is displayed to fill in the alternating gaps left by the odd field to form a single frame. One frame, displayed every 1/25th of a second, contains two interlaced fields, thus a total of 50 fields are displayed every 1/50th of a second. The interlaced scanning method is intended for capturing a still object.</p>	<p>The progressive scanning method scans one full frame of video consecutively down the screen, line by line. An entire image is drawn at one time, as opposed to the interlaced scanning process by which a video image is drawn in a series of passes. The progressive scanning method is desirable for dealing with moving objects.</p>

Note

- This function works only on TVs equipped with component video inputs (Y, Pr, Pb) that support Progressive Video. (It does not work on TVs with conventional component inputs, i.e., non-progressive scan TVs.)
- Depending on the brand and model of your TV, this function may not work.



Connecting External Components

Connecting an External Analog Component

Example: Analog signal components such as a VCR, Camcorder, and TV.

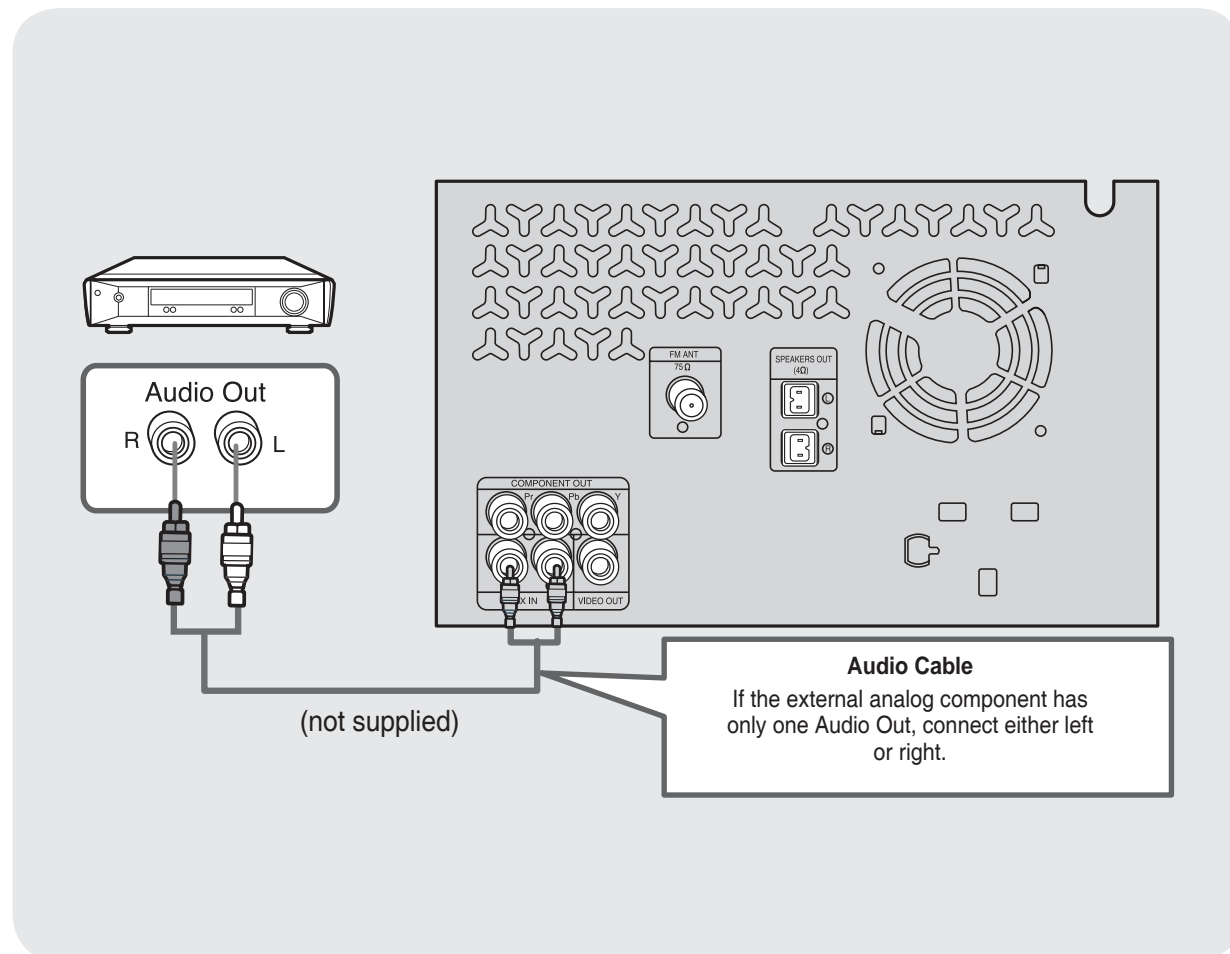

- 1 Connect AUX IN on the player to Audio Out on the external analog component.
 - Be sure to match connector colors.
- 2 Press **AUX** to select AUX.
 - 'AUX' appears in the display.



Connecting the FM Antennas

ENG

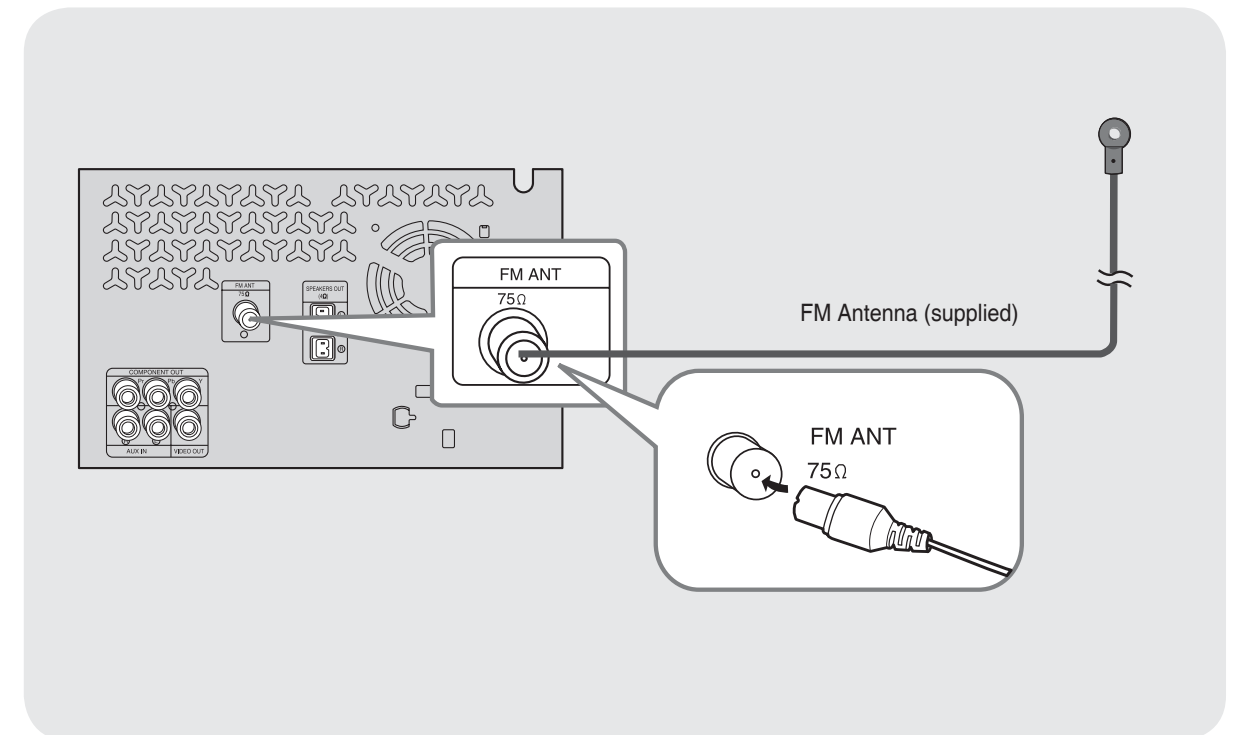

- 1 Connect the FM antenna supplied to the FM 75Ω COAXIAL Jack.
- 2 Slowly move the antenna wire around until you find a location where reception is good, then fasten it to a wall or other rigid surface.

Note

- This unit does not receive AM broadcasts.

CONNECTIONS

Setting the Clock

For each step, you have a few seconds to set the required options.
If you exceed this time, you must start again.

1 Switch the system on by pressing **POWER** button.

2 Press **TIMER/CLOCK** twice.

- "CLOCK" is displayed.

3 Press **ENTER**.
The hour flashes.

- Increase the hours : ►
- Decrease the hours : ◀

4 When the correct hour is displayed, press **ENTER**.
The minutes flash.

- Increase the minutes : ►
- Decrease the minutes : ◀

5 When the correct time is displayed, press **ENTER**.

- "TIMER" appears in the display.
- The current time is now set.

- Note**
- You can display the time, even when you are using another function, by pressing **TIMER/CLOCK** once.
 - You can also use ◀▶ on the panel front instead of ◀ ► buttons in step 3,4.

Disc Playback

1 Press **OPEN/CLOSE** button to open the disc tray.

2 Load a disc.
• Place a disc gently into the tray with the disc's label facing up.

3 Press **OPEN/CLOSE** button to close the disc tray.

Note

- For mixed discs, the play order is as below:MP3/WMA → DIVX → JPEG.
- Depending on the content of the disc, the initial screen may appear different.
- Depending on the recording mode, some MP3-CDs cannot be played.
- For CD discs, you can press the numeric buttons to select the track, when you press the numeric buttons after 3 seconds, the playback starts automatically.
- Table of contents of a MP3-CD varies depending on the MP3 track format recorded on the disc.
- DTS Audio is not supported.
- DVD Audio Disc is not supported.

To stop playback, press **STOP** button during playback.

- If pressed once, the stop position will be stored in memory. If **PLAY** (►) button is pressed, playback resumes from the stop position. (This function works only with DVDs.)
- If pressed twice, "STOP" is displayed, and if **PLAY** (►) button is pressed, playback starts from the beginning.

To temporarily pause playback, press **PAUSE** button during playback.

- To resume playback, press **PLAY** (►) button again.

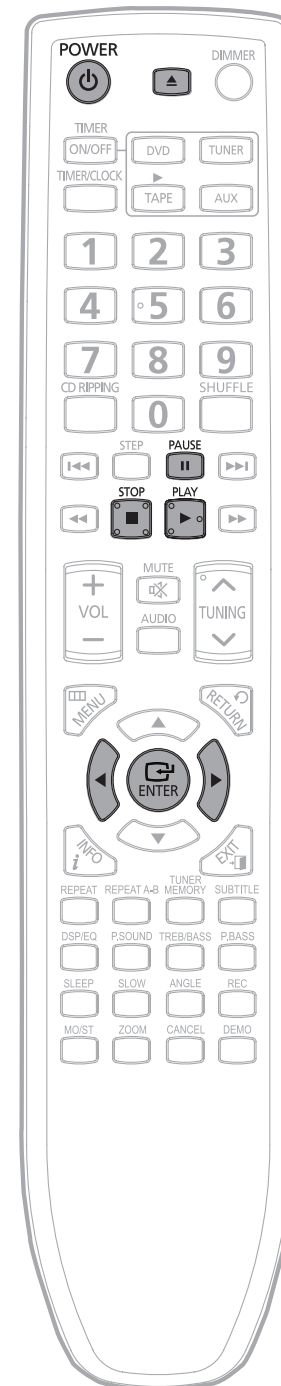

MP3/WMA-CD Playback

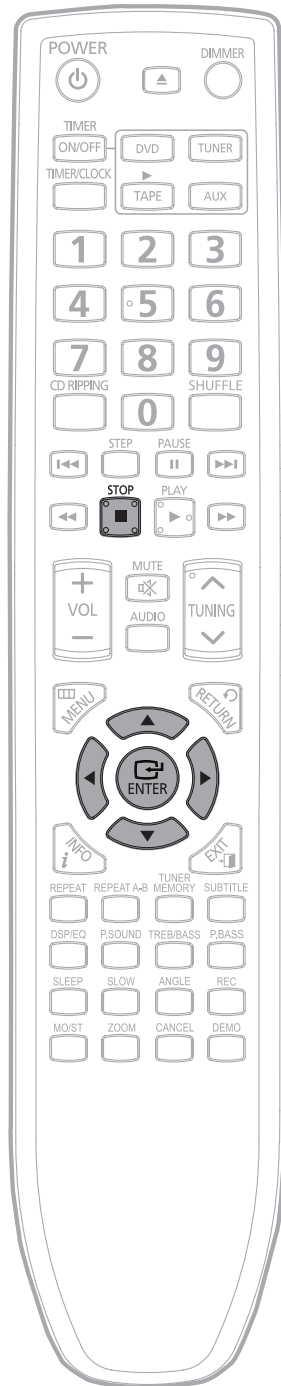

1 Load the MP3/WMA disc.

- The MP3/WMA menu screen will appear and playback will start.
- The appearance of the menu depends on the MP3/WMA disc.
- WMA-DRM files cannot be played.



2 Use to select the album, and then press the **ENTER** button.

- Use  to select the track.

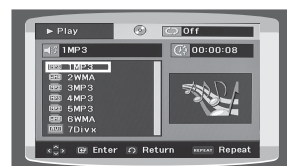

3 To change the album, use to select another album in Stop mode, and then press the **ENTER** button.

- To select another album and track, repeat Steps 2 and 3 above.

Note

- Depending on the recording mode, some MP3/WMA-CDs may not be played.
- Table of contents of a MP3-CD varies depending on the MP3/WMA track format recorded on the disc.

JPEG File Playback

Images captured with a digital camera or camcorder, or JPEG files on a PC can be stored on a CD and then played back with this DVD player.

Rotate/Flip Function



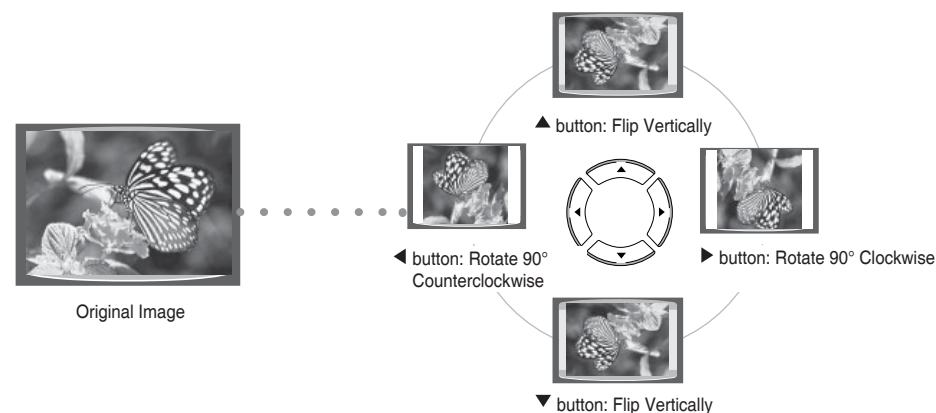



Press Cursor  buttons during playback.

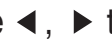

Zoom/Auto play Function

Press **INFO** button during playback, TV displays as below:



1. Use  to select  icon, and then press **ENTER** button, each time you press the button, your selection will rotate as clockwise.
2. Use  to select  icon, and then press **ENTER** button, each time you press the button, your selection will change as below: x2 → x4 → x2 → Off.
3. Use  to select  icon, and then press **ENTER** button, TV displays as below:



- Press **ENTER** button to select the time space for playing the pictures.
4. Press **STOP** button to cancel this function.



DivX Playback

Skip Forward/Back

During playback, press the **⏮️⏭️** button.

- Go to the next file whenever you press **⏭️** button, if there are over 2 files in the disk.
- Go to the previous file whenever you press **⏮️** button, if there are over 2 files in the disk.

Fast playback

Press **⏮️⏭️** button.

- Each time the button is pressed during playback, the playback speed changes as follows:

⏮️ x2

⏮️ x4

⏮️ x8

⏭️ x2

⏭️ x4

⏭️ x8

- To resume normal playback, press **▶️** button.

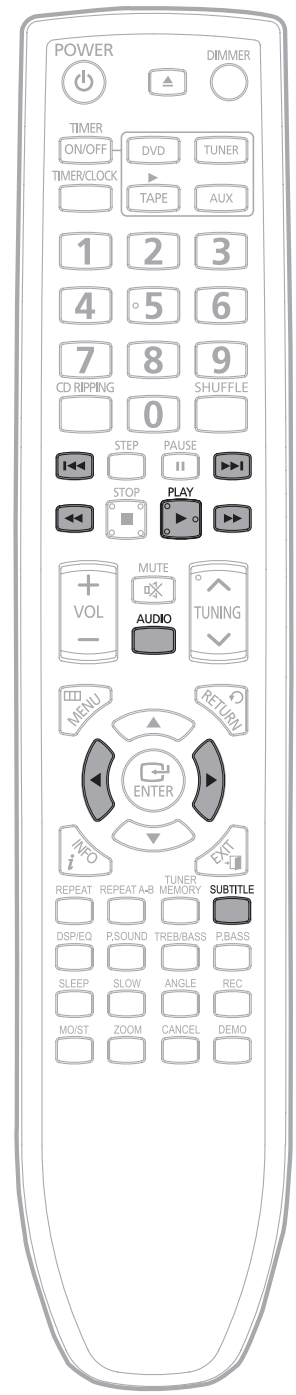

5 Minutes Skip function

During playback, press the **⏮️, ▶️** button.

- Go to the screen 5 minutes after whenever you press **▶️** button.
- Go to the screen 5 minutes earlier whenever you press **⏮️** button.

Note • For MPG format files, 5 minute skip function is not supported.

Audio Display

Press the **AUDIO** button.

- If there are multiple audio tracks on a disc, you can toggle between them.
- Each time you press the button, your selection will toggle between **AUDIO(OFF, 1/1, 1/2 ...)**.

Subtitle Display

Press the **SUBTITLE** button.

- Each time you press the button, your selection will changed as below:

KOR

SUBTITLE

➡️

Off

SUBTITLE

- If the disc has only one subtitle file, it will be played automatically.
- Up to 8 subtitle languages are supported.

DivX Feature Table

DivX Supported

Avi files are used to contain the audio and video data; these must be stored on CD in the ISO 9660 format.

		SPEC
VIDEO Compatibility	DivX3.11	Up to the latest VERSION
AUDIO Compatibility	MP3	CBR : 8kbps~320kbps
	AC3	CBR : 32kbps~640kbps
	WMA	CBR1:Stereo case:48kbps~384kbps CBR2:Mono case:64kbps~192kbps

MPEGs containing DivX can be divided into Video and Audio.

- **Video compatibility** : All versions of DivX later than 3.11 (including the latest 5.1) are supported. In addition, XviD is supported.
- **Audio compatibility** : MP3s encoded at bit rates from 8kbps to 320kbps, AC3s from 32kbps to 640kbps, and WMAs from 48kbps to 384kbps are supported.
- **In addition, for subtitles, this unit will support Text format (SMI).**

Note

- When playing the DivX disk, you can play the file with extension of AVI only.
- Among the available DivX audio formats, DTS Audio is not supported.
- When burning a subtitle file to a CD-ROM with your PC, be sure to burn it as an SMI file.
- MPEG 1 Layer 1 (MP1) is not supported.

Playing Media Files using the USB feature

You can connect and play files from external USB storage devices such as MP3 players, USB flash memory, etc. using the player's USB function.

1 Connect the USB cable.

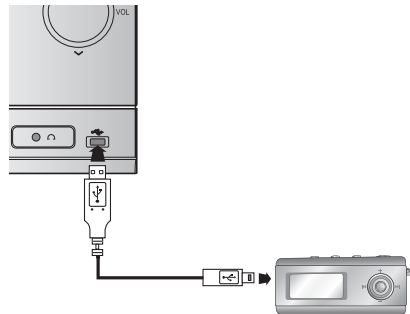

2 Press the **FUNCTION** button on the main set or the **AUX** button on the remote control to select the USB mode.

- "USB" appears on the display screen and then disappear.
- USB SORTING screen appears on the TV screen and the saved file is played.



To stop playback, press the **STOP** (■) button.

- Note**
- Video files (DivX, MPEG, etc.) are supported.
 - To prevent the loss of data saved in the USB device, please turn the unit off or switch it to another mode before disconnecting the USB cable.
 - The play order is as follow: MP3/WMA → DIVX → JPEG.

Skip Forward/Back

During playback, press the **⏮** or **⏭** button.

- When there is more than a file, when you press the **⏭** button, the next file is selected.
- When there is more than a file, when you press the **⏮** button, the previous file is selected.

Fast playback

To play back the disc at a faster speed, press **⏮** or **⏭** button during playback.

- Each time you press either button, the playback speed will change as follows:

⏮ x 2 → ⏮ x 4 → ⏮ x 8 or ⏭ x 2 → ⏭ x 4 → ⏭ x 8
- To resume normal playback, press **PLAY** (▶) button.

USB Host Specification

USB Host Specification	<ul style="list-style-type: none"> • Supports USB 1.1 or USB 2.0 compliant devices. • Supports devices connected using the USB A type cable. • Supports UMS (USB Mass Storage Device) V1.0 compliant devices. • Supports the device of which the connected drive is formatted in the FAT(FAT, FAT16, FAT32) file system.
Non-compliance	<ul style="list-style-type: none"> • Does not support a device that requires installing a separate driver on the PC (Windows). • Does not support connection to a USB hub. • A USB device that is connected using the USB extension cable may not be recognized. • A USB device requiring a separate power source needs to be connected to the player with the separate power connection.
Operational Limitations	<ul style="list-style-type: none"> • If the connected device has multiple drives (or partitions) installed, only one drive (or partition) can be connected. • A device supporting USB 1.1 alone may cause a difference in the picture quality, depending on the device.

Compliant Devices

1. USB Storage Device
2. MP3 Player
3. Digital Camera
4. Removable HDD
 - Removable HDDs equipped with less than 160 Gbytes are supported. Removable HDDs equipped with 160Gbytes or more may not be recognized, depending on the device.
 - If the connected device does not work due to insufficient power supply, you can use a separate power cable to supply power so that it can work properly. The connector of the USB cable may differ, depending on the manufacturer of the USB device.
5. USB card Reader: One slot USB card reader and Multi slot USB card reader.
 - Depending on the manufacturer. the USB card reader may not be supported.
 - If you install multiple memory devices into a multi card reader, you may experience problems.

Compliant File Formats

Format	File name	File extension	Bit rate	Version	Pixel	Sampling Frequency
Still Picture	JPG	JPG .JPEG	—	—	640x480	—
Music	MP3	.MP3	8~320kbps	—	—	44.1kHz
	WMA	.WMA	Stereo:48~384kbps Mono:64~192kbps	V8	—	44.1kHz
Movie	DivX	.AVI	4Mbps	DivX3.11~ DivX5.1, XviD	720x480	44.1KHz~48KHz

- CBI (Control/Bulk/Interrupt) is not supported.
- Digital Cameras that use PTP protocol or require additional program installation when connected to a PC are not supported.
- A device using NTFS file system is not supported. (Only FAT 16/32 (File Allocation Table 16/32) file system is supported.)
- Does not operate with Janus enabled MTP (Media Transfer Protocol) devices.
- MPEG 1 Layer 1 (MP1) is not supported.

Displaying Disc Information

You can view playback information on the disc on the TV screen.

Press INFO button.

- Press Cursor \blacktriangle , \blacktriangledown buttons select the desired item.

DVD

DVD	
Title	002
Chapter	001
Time	00:00:07
Audio	KOR 2 CH
Subtitle	Off
Enter	



Display disappears

Note

- Depending on the disc, the disc information display may appear different.

Fast/Slow Playback

Fast Playback DVD CD MP3

Press \lll \ggg buttons.

- Each time you press either button during playback, the playback speed changes as follows:

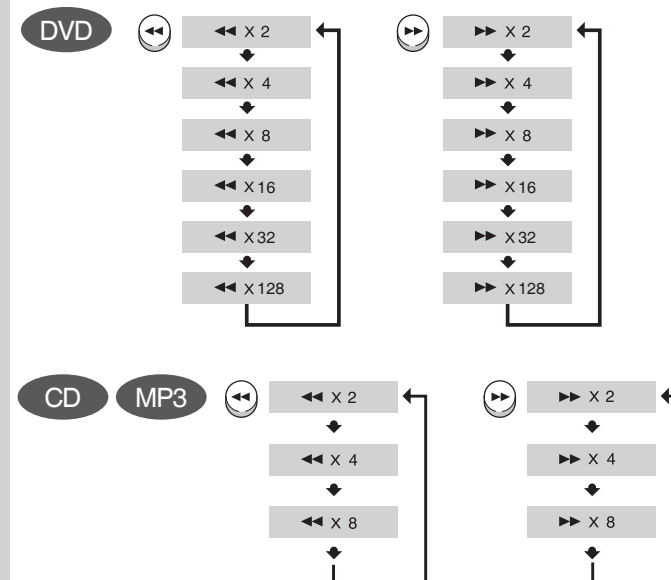

- To resume normal playback, press PLAY (\blacktriangleright) button.

Slow Playback

Press **SLOW** button.

- Each time the button is pressed during playback, the playback speed changes as follows:

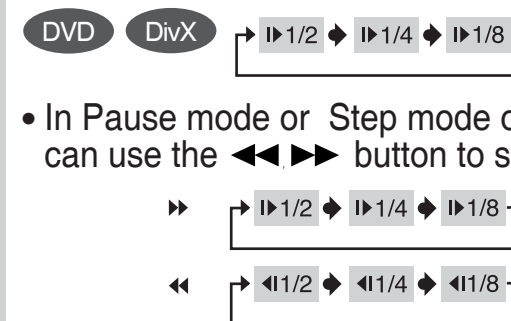

- In Pause mode or Step mode or Slow mode, you can use the \lll \ggg button to select as below:

- To resume normal playback, press PLAY (\blacktriangleright) button.

Note

- During fast playback of a CD or MP3-CD, sound is not heard.
- No sound is heard during slow playback and step motion playback.



Skipping Scenes/Songs

DVD

MP3

CD

Briefly press **⏮⏭**.

- Each time the button is pressed briefly during playback, the previous or next chapter, track, or directory (file) will be played.
- But, you cannot skip chapters consecutively.

DVD



MP3



CD



Playing Frame by Frame

DVD

DivX

Press **STEP** button.

- The picture moves forward one frame each time the button is pressed during playback.

Step

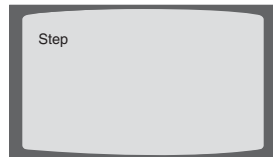

Angle Function

This function allows you to view the same scene in different angles.

DVD

1 Press **ANGLE** button.

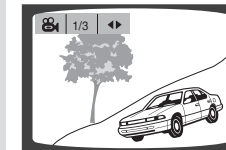

2 Press Cursor **◀▶** buttons or numeric buttons to select the desired angle.

- Each time the button is pressed, the angle changes as follows:

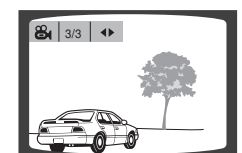
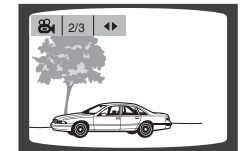
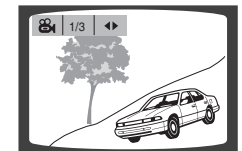

Note

- The Angle function works only with discs on which multiple angles have been recorded.

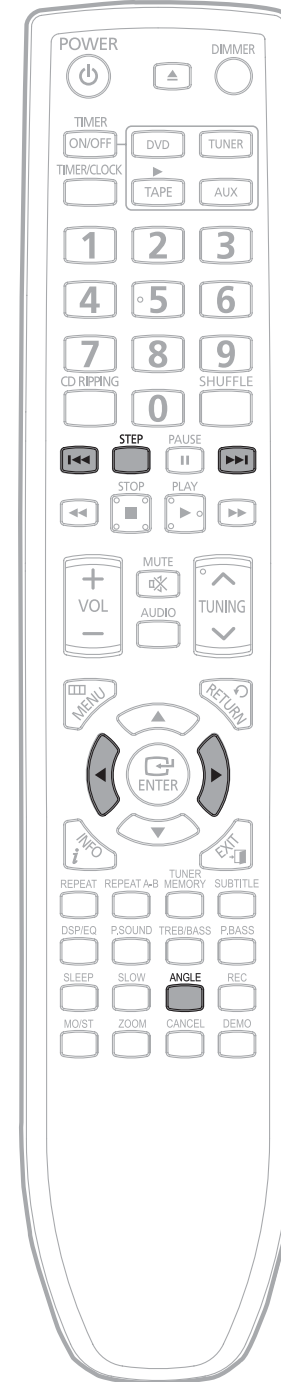

OPERATION



Repeat Playback

Repeat playback allows you to repeatedly play a chapter, title, track (song), or directory (MP3 file).

DVD CD MP3 DIVX

Press **REPEAT** button.

- Each time the button is pressed during playback, the repeat playback mode changes as follow:

DVD

Off 01 02 A-B ENTER REPEAT

- Press the REPEAT button or cursor ◀, ▶ button to select one mode then press ENTER button.
- Select Off : Cancel Repeat playback.
- Select 01 : Repeat playback one Chapter.
- Select 02 : Repeat playback one Title.
- Select A-B : Repeat playback A-B.

DIVX

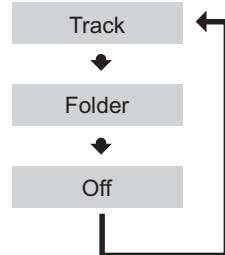

MP3

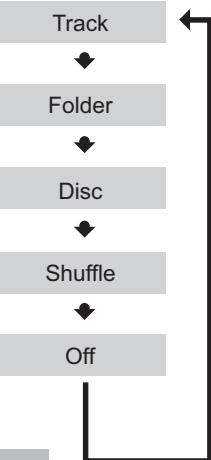

CD

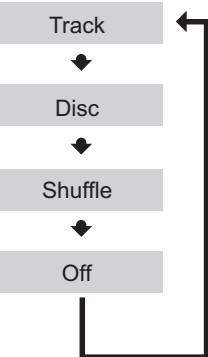

Repeat Playback Options

Track

Repeatedly plays the selected track.

Folder

Repeatedly plays all tracks in the selected folder.

Disc

Repeatedly plays the entire disc.

Shuffle

Plays tracks in random order.
(Each track can be played one time.)

Off

Cancels Repeat Playback.



- For a CD, MP3, DIVX disc, you can press SHUFFLE button to play tracks in random order.(Each track can be played one time.)



A↔B Repeat Playback

ENG

DVD CD MP3 DIVX

- Press the **REPEAT A-B** button at the point where you want repeat play to start (A).

'RPT A-' is displayed.

- Press the **REPEAT A-B** button at the point where you want repeat play to stop (B).

'RPT A-B' is displayed.

- To return to normal play, press the **REPEAT A-B** button again.

'RPT OFF-' is displayed.



- The A-B Repeat function does not operate with JPEG disc.
- The time space of point A and B should be more than 5 seconds.

Zoom Function

This function allows you to enlarge a particular area of the displayed image.

Zoom (Screen Enlarge) Function

DVD DivX JPEG

1 Press **ZOOM** button.

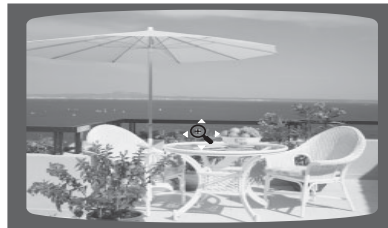

2 Press Cursor **▲, ▼, ◀, ▶** buttons to move to the area you want to enlarge.

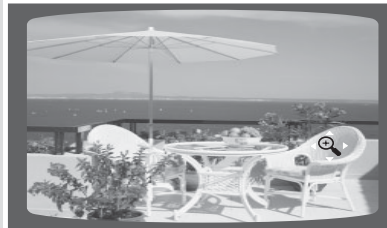

3 Press **ENTER** button.

- Each time the button is pressed, the zoom level changes as follow:

DVD 2 x → 4 x → OFF.

DivX JPEG 2 x → 4 x → 2 x → OFF.

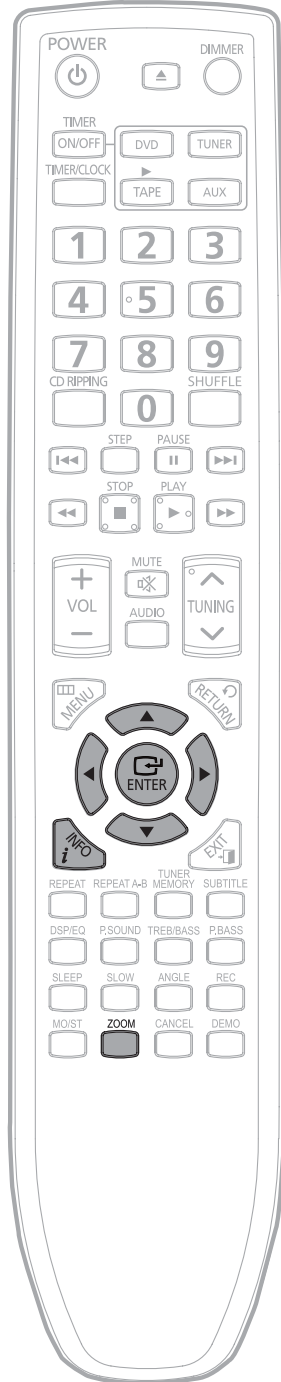

Selecting Audio/Subtitle Language

Audio Language Selection Function DVD

1 Press **INFO** button.

DVD	
Title	002
Chapter	001
Time	00:00:07
Audio	KOR 2 CH
Subtitle	Off
Enter	

2 Press Cursor **▲, ▼** buttons to select the Audio and then press **ENTER** button.

DVD	
Title	002
Chapter	001
Time	00:00:07
Audio	KOR 2 CH
Subtitle	Off
Enter	

3 Press Cursor **◀, ▶** or numeric buttons to select the desired Audio language and then press **ENTER** button.

DVD	
Title	002
Chapter	001
Time	00:00:07
Audio	KOR 2 CH
Subtitle	Off
Enter	

Note

- Depending on the number of languages on a DVD disc, a different audio language (ENGLISH, SPAIN,FRENCH, etc.) is selected each time the button is pressed.

Subtitle Language Selection Function DVD

1 Press **INFO** button.

DVD	
Title	002
Chapter	001
Time	00:00:07
Audio	KOR 2 CH
Subtitle	Off
Enter	

2 Press Cursor **▲, ▼** buttons to select the Subtitle and then press **ENTER** button.

DVD	
Title	002
Chapter	001
Time	00:00:07
Audio	KOR 2 CH
Subtitle	Off
Enter	

3 Press Cursor **◀, ▶** or numeric buttons to select the desired Subtitle language and then press **ENTER** button.

DVD	
Title	002
Chapter	001
Time	00:00:07
Audio	KOR 2 CH
Subtitle	Off
Enter	

Note

- You can use the AUDIO or SUBTITLE button on the remote control to select an audio or subtitle language.
- Depending on the disc, the Subtitle and Audio Language functions may not work.
- When you use AUDIO button to select "DTS", sound is not heard, and the TV displays as below:





Moving Directly to a Scene /Song

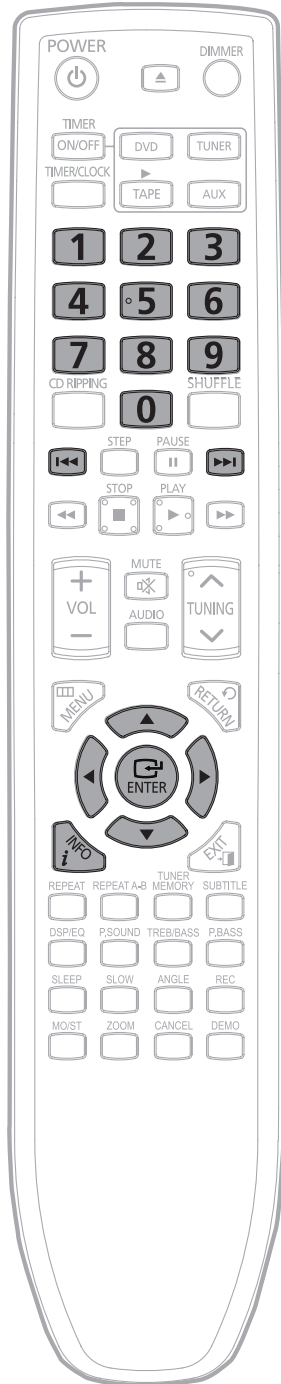

DVD

1 Press **INFO** button.

DVD	
Title	002
Chapter	001
Time	00:00:07
Audio	KOR 2 CH
Subtitle	Off
Enter	

Moving to a Title/Chapter

2 Press Cursor **▲**, **▼** buttons to select the Title/Chapter.

DVD	
Title	002
Chapter	001
Time	00:00:07
Audio	KOR 2 CH
Subtitle	Off
Enter	

Moving to a Title/Chapter

3 Press Cursor **◀**, **▶** or numeric buttons to select the desired part and then press **ENTER** button.

DVD	
Title	002
Chapter	001
Time	00:00:07
Audio	KOR 2 CH
Subtitle	Off
Enter	

Moving to a Specific Time

4 Press Cursor **▲**, **▼** buttons to select the Time.

DVD	
Title	002
Chapter	001
Time	00:00:07
Audio	KOR 2 CH
Subtitle	Off
Enter	

Moving to a Specific Time

5 Press the numeric buttons to select the desired time and then press **ENTER** button.

Note

- You can press **◀◀▶▶▶▶** on the remote control to move directly to the desired title, chapter.
- Depending on the disc, you may not be able to move to the selected title or time.



Using Disc Menu

You can use the menus for the audio language, subtitle language, profile, etc.
DVD menu contents differ from disc to disc.

DVD

1 In stop mode, press **MENU** button.



2 Press Cursor **▲**, **▼** buttons to move to 'DISC MENU' and then press **ENTER** button.



3 Press Cursor **▲**, **▼** buttons to select the desired item and then press **ENTER** button.



4 Press Cursor **▲**, **▼** buttons to select the desired item and then press **ENTER** button.



Press **RETURN** button to return to the previous level.

Press **MENU** button to exit the setup screen.

Press **EXIT** button to exit the setup screen.

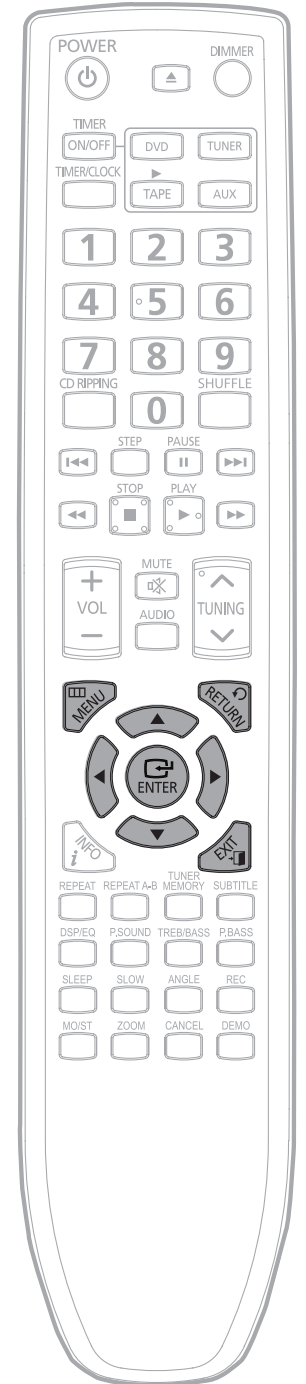

Using the Title Menu

For DVDs containing multiple titles, you can view the title of each movie.
Depending on the disc, this function may either not work at all or may work differently.

DVD

1 In stop mode, press **MENU** button.



2 Press Cursor **▲**, **▼** button to move to 'Title Menu' and then press **ENTER** button.



3 Press Cursor **▲**, **▼** buttons to select the desired item and then press **ENTER** button.



4 Press Cursor **▲**, **▼**, **◀**, **▶** buttons to select the desired item and then press **ENTER** button.

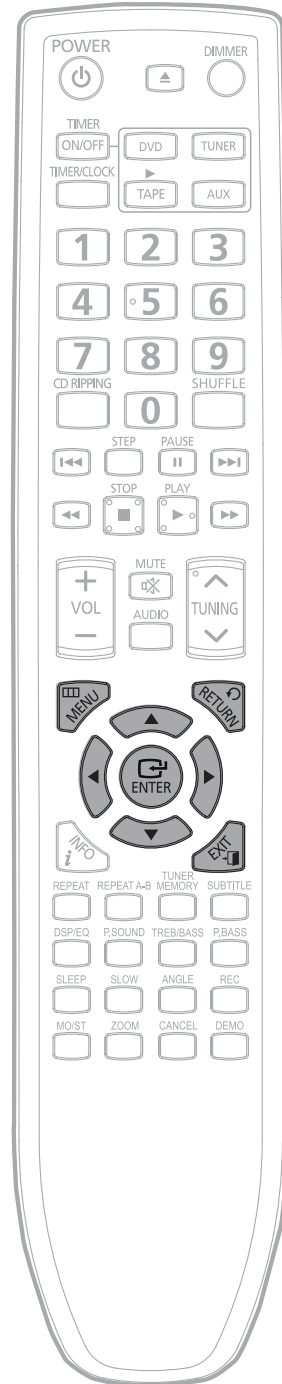

Press **RETURN** button to return to the previous level.

Press **MENU** button to exit the setup screen.

Press **EXIT** button to exit the setup screen.

Setting the Language

OSD language is set to English by default.

1 In stop mode, press **MENU** button.



2 Press Cursor **▲**, **▼** button to move to 'Setup' and then press **ENTER** button.



3 Press Cursor **▲**, **▼** button to select the desired item and then press **ENTER** button.



4 Press Cursor **▲**, **▼** button to select the desired language and then press **ENTER** button.

- Once the setup is complete, if the language was set to English, OSD will be displayed in English.



Selecting the Player Menu Language



Selecting the Disc Menu Language (recorded on the disc)

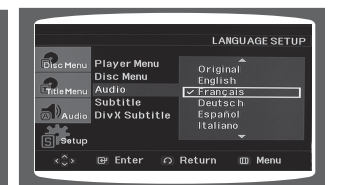

Selecting the Audio Language (recorded on the disc)



Selecting the Subtitle Language (recorded on the disc)



Selecting the Subtitle Language (recorded on the disc)

* If the language you selected is not recorded on the disc, menu language will not change even if you set it to your desired language.

Press **MENU** or **EXIT** button to exit the setup screen.

Press **RETURN** button to return to the previous level.

ENG

OPERATION



Setting TV Screen type

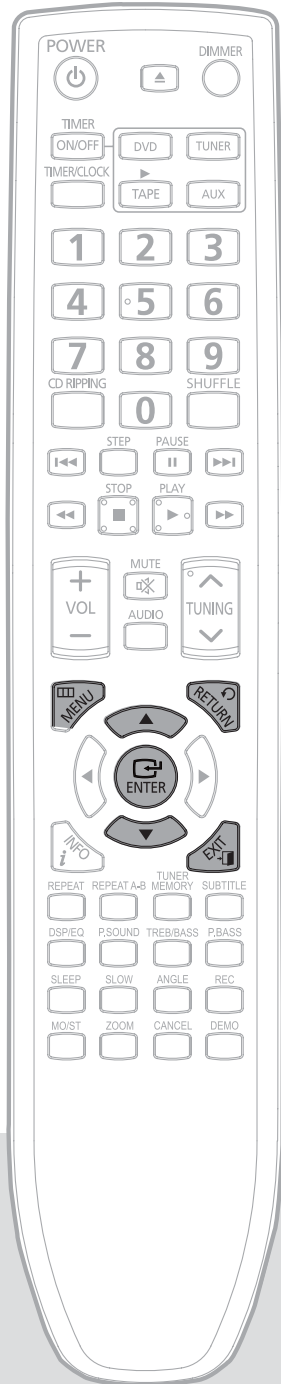

1 In stop mode, press **MENU** button.



2 Press Cursor \blacktriangle \blacktriangledown button to move to 'Setup' and then press **ENTER** button.



3 Press Cursor \blacktriangle , \blacktriangledown button to move to 'Display Setup' and then press **ENTER** button.

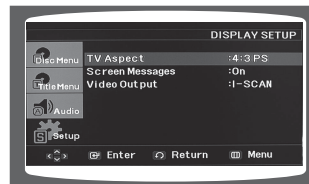

4 Press Cursor \blacktriangle , \blacktriangledown button to 'Tv Aspect' and then press **ENTER** button.

• You can select '4:3 Letter Box', '4:3 Pan&Scan' or '16:9 Wide' mode for your TV.



5 Press Cursor \blacktriangle , \blacktriangledown button to move to 'Screen Messages' and then press **ENTER** button.

• You can select 'On' or 'Off'.
On: you can see the screen messages.
Off: you can't see the screen messages.



6 Press Cursor \blacktriangle , \blacktriangledown button to 'Video Output' and then press **ENTER** button.

• You can select 'I-SCAN' or 'P-SCAN'. (see the page 12 about P-SCAN or I-SCAN mode.)



Adjusting the TV Aspect Ratio (Screen Size)

The horizontal to vertical screen size ratio of conventional TVs is 4:3, while that of wide screen and high definition TVs is 16:9. This ratio is called the aspect ratio. When playing DVDs recorded in different screen size, you should adjust the aspect ratio to fit your TV or monitor.

* For a standard TV, select either "4:3LB" or "4:3PS" option according to personal preference. Select "16:9" if you have a wide screen TV.

16:9 Wide

: Select this to view a 16:9 picture in the full-screen mode on your wide screen TV.
• You can enjoy the wide screen aspect.



4:3LB (4:3 Letter box)

: Select this to play a 16:9 picture in the letter box mode on a conventional TV.
• Black bars will appear at the top and bottom of the screen.



4:3PS (4:3 Pan&Scan)

: Select this to play a 16:9 picture in the pan & scan mode on a conventional TV.
• You can see the central portion of the screen only (with the sides of the 16:9 picture cut off).



Note

- If a DVD is in the 4:3 ratio, you cannot view it in wide screen.
- Since DVD discs are recorded in various image formats, they will look different depending on the software, the type of TV, and the TV aspect ratio setting.

Press **RETURN** button to return to the previous level.

Press **MENU** button to exit the setup screen.

Press **EXIT** button to exit the setup screen.



Setting Parental Controls (Rating Level)

Use this to restrict playback of adult or violent DVDs you do not want children to view.

1 In stop mode, press **MENU** button.



2 Press Cursor **▲▼** button to move to 'Setup' and then press **ENTER** button.



3 Press Cursor **▼** button to move to 'Parental Setup' and then press **ENTER** button.

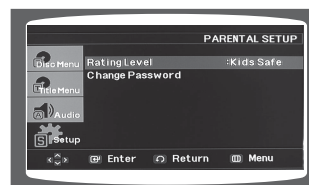

4 Press Cursor **▲,▼** button to select the 'Rating Level' and then press **ENTER** button.

- If you have selected Level 6, you cannot view DVDs with Level 7 or higher.
- The higher the level, the closer the content is to violent or adult material.

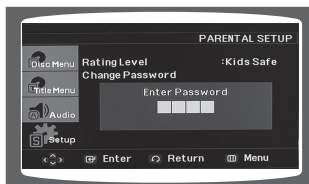

5 Enter the password and then press **ENTER** button.

- The password is set to "7890" by default.
- Once the setup is complete, you will be taken to the previous screen.

Note

- This function works only if a DVD disc contains the rating level information.

Press **RETURN** button to return to the previous level.

Press **MENU** button to exit the setup screen.

Press **EXIT** button to exit the setup screen.



Setting the Password

You can set the password for the Parental (rating level) setting.

1 In stop mode, press **MENU** button.



2 Press Cursor **▲▼** button to move to 'Setup' and then press **ENTER** button.



3 Press Cursor **▼** button to move to 'Parental Setup' and then press **ENTER** button.

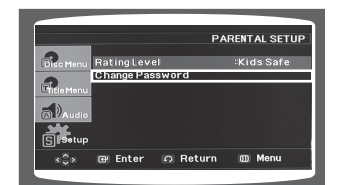

4 Press Cursor **▲,▼** button to select the 'Change Password' and then press **ENTER** button.

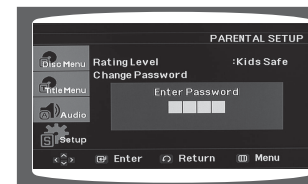

5 Enter the password and then press **ENTER** button.

- Enter the old password, a new password, and confirm new password.
- The setting is complete.

Press **RETURN** button to return to the previous level.

Press **CANCEL** button to cancel the error numeric when you inputting password.

Press **MENU** button to exit the setup screen.



Setting the DRC (Dynamic Range Compression)

You can use this function to enjoy Dolby Digital sound when watching movies at low volume at night.

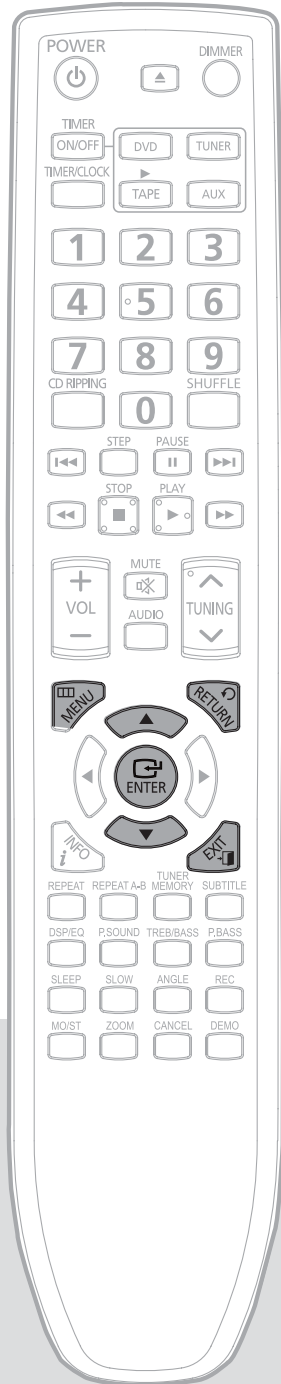

1 In stop mode, press **MENU** button.



2 Press Cursor **▲▼** button to move to 'Audio' and then press **ENTER** button.



3 Press Cursor **▲,▼** button to select the 'DRC' and then press **ENTER** button.

4 Press Cursor **▲,▼** to adjust the 'DRC'.

- You can set the DRC between 0 and 8. Set it to the optimal status.



Press **RETURN** button to return to the previous level.

Press **MENU** button to exit the setup screen.

Press **EXIT** button to exit the setup screen.



AV SYNC Setup

Video may look slower than the audio if it is connected with digital TV. In this case, adjust the delay time of audio to optimal status to fit the video.

1 In stop mode, press **MENU** button.



2 Press Cursor **▲, ▼** buttons to move to 'Audio' and then press **ENTER** button.



3 Press Cursor **▲, ▼** buttons to move to 'AV-SYNC' and then press **ENTER** button.

4 Press Cursor **▲, ▼** buttons to select the Delay Time of AV-SYNC and then press the **ENTER** button.

- You can set the audio delay time between 0 ms and 300 ms. Set it to the optimal status.



Press **RETURN** button to return to the previous level.

Press **MENU** button to exit the setup screen.



Listening to Radio

You can listen to the chosen band (FM broadcast stations) by using either the automatic or manual tuning operation.

Remote Control Unit

1 Press **TUNER** button.

2 Tune in to the desired station.

Automatic Tuning 1 Press the **STOP** (■) button to select PRESET and then press **TUNING** ^ or v button to select the preset station.

Automatic Tuning 2 Press the **STOP** (■) button to select "AUTO" and then press **TUNING** ^ or v button to automatically search the band.

Manual Tuning Press **STOP** (■) to select MANUAL and then briefly press **TUNING** ^ or v to tune in to a lower or higher frequency.

Main Unit

1 Press the **FUNCTION** button to select the FM band.

2 Select a broadcast station.

Automatic Tuning 1 Press the **STOP** (■) button to select PRESET and then press **I<<>>I** button to select the preset station.

Automatic Tuning 2 Press the **STOP** (■) button to select "AUTO" and then press **I<<>>I** button to automatically search the band.

Manual Tuning Press **STOP** (■) to select MANUAL and then briefly press **I<<>>I** to tune in to a lower or higher frequency.



Press **MO/ST** button to listen in Mono/Stereo.
(This applies only when listening to an FM station.)

- Each time the button is pressed, the sound switches between "STEREO" and "MONO".
- In a poor reception area, select MONO for a clear, interference-free broadcast.



Presetting Stations

You can store up to:
◆ 15 FM stations

Example: Presetting FM 89.1 in the memory

1 Press the **TUNER** button and select the FM band.



2 Press **TUNING** ^ or v to select "89.10".

- Refer to Step 2 on page 41 to automatically or manually tune in to a station.



3 Press the **TUNER MEMORY** button.



4 Press **TUNING** ^ or v to select preset number.

- You can select between 1 and 15.

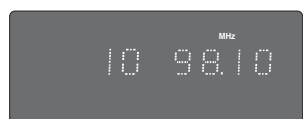

5 Press the **TUNER MEMORY** button.

- If you can't press "TUNER MEMORY" in 5 seconds, the preset disappears and "FM" displays.



6 To preset another station, repeat steps 2 to 5.



Listening to a Cassette

Always treat your cassettes with care; refer, if necessary, to the section entitled "Precautions When Using Audio Cassettes" on page 55.

1 Switch the system on by pressing **POWER**.

2 Press **FUNCTION** on the player or **TAPE** on the remote control to select the Tape function.

3 Open the cassette door and insert a cassette.

- Insert a cassette with the recording/playback side facing the cassette holder, and then push the cassette door shut.

4 Press the ► button on the remote control. The cassette starts playing.

5 Press the ◀▶ button if necessary.

- Rewind the cassette ◀ button.
- Fast-forward the cassette ▶▶ button.

6 When you have finished playback, press **STOP** button.

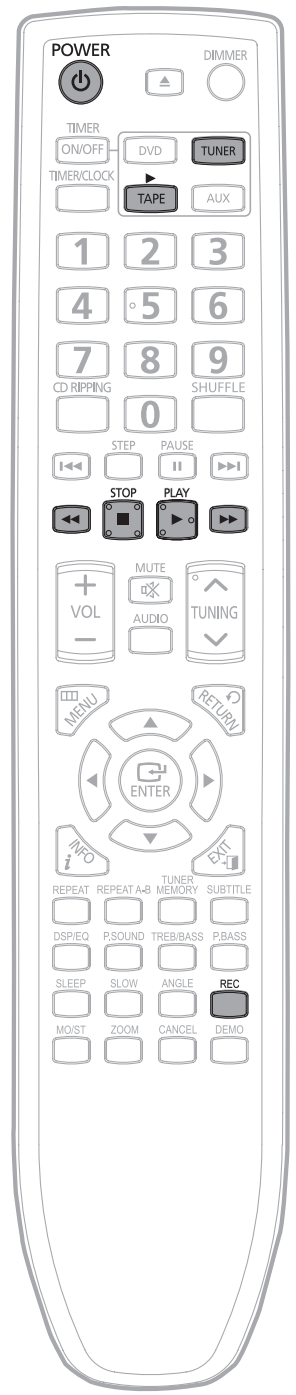

Recording a Radio Program

ENG

You can record a radio program of your choice.
You do not need to adjust the volume, as it has no effect on the recording.

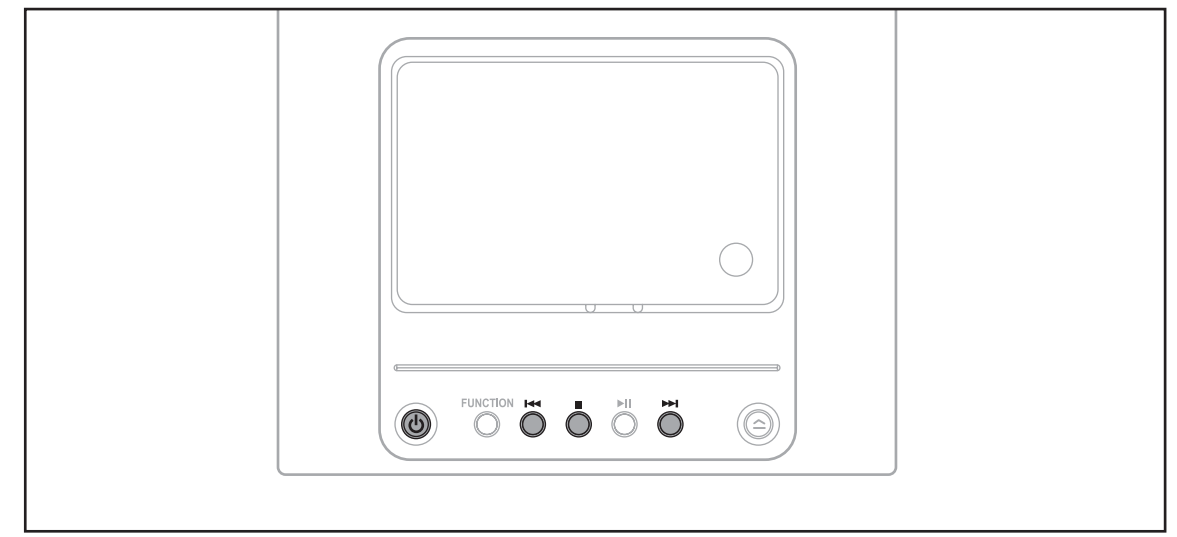

1 Switch the system on by pressing **POWER**.

2 Insert a blank cassette in Deck.

3 Select the **TUNER** function by pressing **TUNER**.

4 Select the radio station that you wish to record by pressing ◀▶▶ button .

5 Press **REC** button.
• **REC** is displayed in red and recording starts.

6 To stop recording, press ■ button.



Recording a Compact Disc

You can record a compact disc on a cassette in two different ways:

Synchronized recording

This feature enables you to synchronize the start of the recording with the start of the disc or track of your choice.

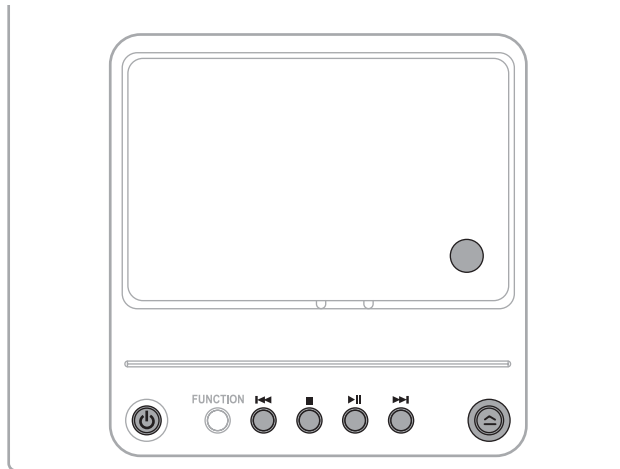

1 Switch the system on by pressing **POWER**.

2 Insert a blank cassette in Deck.

- Open the cassette door, insert a cassette, and then close the cassette door.
- Insert the cassette with the safety tabs.

3 Load a compact disc.

- Press the **OPEN/CLOSE** button to open the CD door.
- Insert a CD and press the **OPEN/CLOSE** button to close the CD door.

4 Press the **PLAY/PAUSE** (▶||) button.

- Use the CD selection (◀◀▶▶) buttons to select the desired song.

5 Press and hold **REC** button.

- "CD SYNC" displays in the window display.
- When stopped, press the button to start the recording from the first piece of music.
- Press and hold **REC** button during the playback of CD to start the recording from the first part of the music being played.

6 To stop recording, press ■ button.

Note

- Synchronized recording Function is available for CD only.

Direct recording

The direct recording mode enables you to start recording with any track on the compact disc.

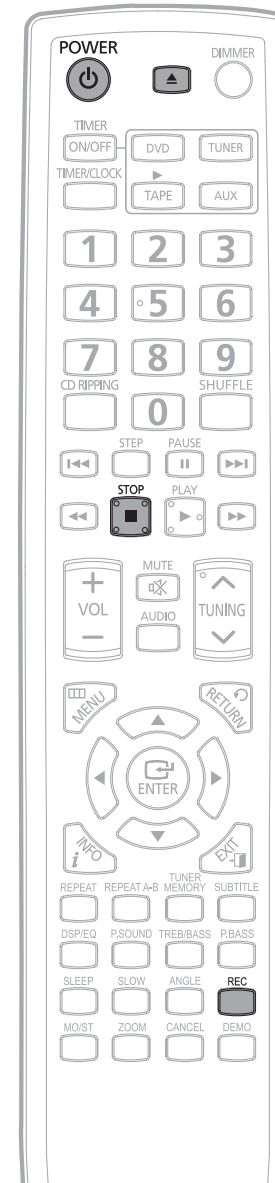

1 Switch the system on by pressing **POWER**.

2 Insert a blank cassette in Deck.

- Open the cassette door, insert a cassette, and then close the cassette door.
- Insert the cassette with the safety tabs.

3 Load a compact disc.

- Press the **OPEN/CLOSE** button to open the CD door.
- Insert a CD and press the **OPEN/CLOSE** button to close the CD door.

4 Press the **PLAY/PAUSE** (▶||) button.

- Use the CD selection (◀◀▶▶) buttons to select the desired song.

5 Press **REC** button.

- Recording will begin.
- To stop recording, press ■ button.

6 To stop recording, press ■ button.

Note

- The cassette tape you want to record on must have the safety tabs intact.

CD RIPPING Function

You can rip a compact disc as a MP3 file on the USB

This feature enables you to ripping with the start of the disc or track of your choice.

1 Switch the system on by pressing **POWER**.

2 Connect the USB.

3 Load a compact disc(Digital Audio).

- ◆ Press the **OPEN/CLOSE** button to open the CD door.
- ◆ Insert a CD and press the **OPEN/CLOSE** button to close the CD door.
- ◆ Use the CD selection (**◀◀ ▶▶**) buttons to select the desired song.

4 Press **CD RIPPING** button on remote control to starting ripping.

- ◆ If the system is playing state, press this button, "TRACK RIPPING" is displayed and CD RIPPING starts.
- ◆ If the system is playing state, press and hold this button, "FULL CD RIPPING" is displayed and CD RIPPING starts.
- ◆ During CD ripping, do not disconnect USB device.

5 To stop ripping, press **STOP** button, and then automatically create and save as the MP3 file.

After CD-Ripping, a directory named "RIPPING FOLDER" will be created in your device. The file name is same with the disc.

Note

- ◆ Don't disconnected USB and AC Cord during CD-Ripping. This may cause the file damage. If you want to stop CD-Ripping during CD-Ripping, you must press stop Key first and after the CD Stopped, then you can remove the USB device.
- ◆ If you disconnected USB device when CD Ripping, the main unit will be power off and you may not delete the ripped file. In this case, please connect the USB on the PC and backup the USB data on the PC first and then format the USB device.
- ◆ When the USB memory is not enough, it will be displayed "RIPPING ERROR".
- ◆ DTS-CD can't for CD Ripping.
- ◆ With external HDD, FAT format the USB can be CD Ripping, but not NTFS. The CD Ripping function of this product does not support all USB devices.
- ◆ When you use CD high speed search function or in the Pause or Stop mode, the CD Ripping can't work.
- ◆ During CD Ripping, do not deal impact. If is shocked while CD Ripping, CD Ripping maybe disengage.
- ◆ Sometimes, some of USB devices, CD Ripping time is long.
- ◆ In program mode, you can't use CD RIPPING function.
- ◆ When CD Ripping completes or Stops, the CD will reload.



Timer Function

- The timer enables you to switch the system on or off at specific times.
- If you no longer want the system to be switched on or off automatically, you must cancel the timer.
- Before setting the timer, check that the current time is correct.
- For each step, you have a few seconds to set the required options. If you exceed this time, you must start again.

Example: You wish to wake up to music every morning.

1 Switch the system on by pressing **POWER**.

2 Press **TIMER/CLOCK** until **TIMER** is displayed.

3 Press the **ENTER** button.

- **ON TIME** is displayed (instead of the equalizer symbols) for a few seconds, followed by any switch-on time already set; you can set the timer switch-on time.

4 Set the timer switch-on time.

- Set the hour by pressing **◀** or **▶** button.
- Press **ENTER**.
 - The minutes flash.
- Set the minutes by pressing **◀** or **▶** button.
- Press **ENTER**.
 - **OFF TIME** is displayed (instead of the equalizer symbols) for a few seconds, followed by any switch-off time already set; you can now set the timer switch-off time.

5 Set the timer switch-off time.

- Set the hour by pressing **◀** or **▶** button.
- Press **ENTER**.
 - The minutes flash.
- Set the minutes by pressing **◀** or **▶** button.
- Press **ENTER**.
 - **VOL 10** is displayed, where 10 corresponds to the volume already set.

6 Press **◀** or **▶** button to adjust the volume level and press **ENTER**.

- The source to be selected is displayed.

7 Press **◀** or **▶** button to select the source to be played when the system switches on.

- **TUNER (radio)** :
 - Press **ENTER**.
 - Select a preset station by pressing **◀** or **▶**.
- **DVD/CD (compact disc)** : Load on or more compact disc.
- **TAPE (cassette)** : Insert a cassette tape.
- **USB** : Insert a USB.

8 Press **ENTER** to confirm the timer.

9 Press **POWER** to set the system to standby mode.

- ☀ is displayed to the top right of the time, indicating that the timer has been set.
- The system will switch on and off automatically at the required times.

Note

- If the timer switch on and off times are identical, the word **ERROR** is displayed.
- If there is no tape, disc or usb, when you select the "DVD/CD, USB, it will automatically change to "TUNER".



Canceling the Timer

After having set the timer, it will start automatically as shown by the **TIMER** indication on the display. If you no longer wish to use the timer, you must cancel it.

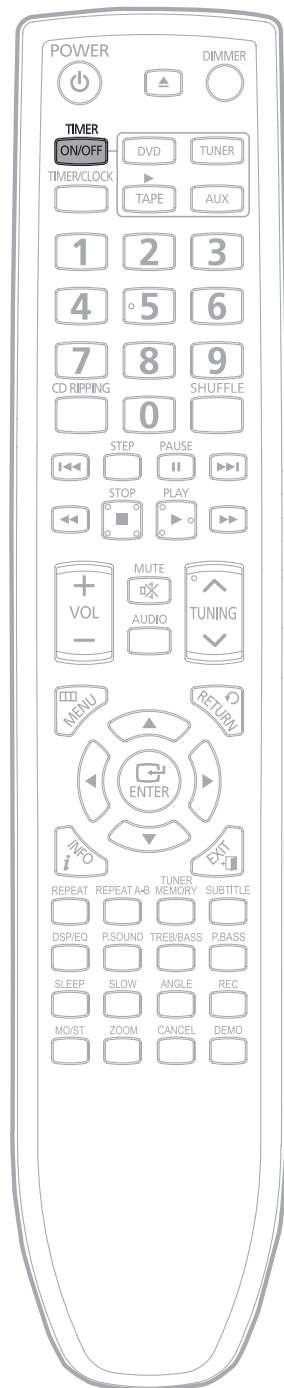

To cancel the timer, press **TIMER ON/OFF** once.

- is no longer displayed.

To resume the timer, press **TIMER ON/OFF** again.

- is displayed again.

Note

- You can cancel the timer while the power is on or while the player is in standby.



Power Sound/Treble Level/Bass Level Function

ENG

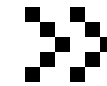

POWER SOUND Function

Your mini-compact system is equipped with the function of **POWER SOUND** mode .

The function of **POWER SOUND** mode amplifies bass and improves high key or bass twice as much for you to appreciate powerful real sound.

Press the **P.SOUND** button.

➤ When CD Ripping,the P.SOUND function can't work and the P.SOUND automatically covert to "OFF" mode.

Each time the button is pressed, the selection changes as follows: P.SOUND → OFF

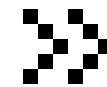

Treble Level Function

Treble Control function stresses high tones providing thudding sound effects.

Press **TREB/BASS** button ,
TREB 00 is displayed.

- Press the **TUNING** , button to select from TREB -04 to TREB 04.
- You can select the level of high tones you desire.

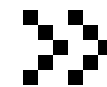

Bass Level Function

BASS function stresses low tones providing thudding sound effects.

Press **TREB/BASS** button ,
BASS 00 is displayed.

- Press the **TUNING** , button to select from **BASS -04** to **BASS 04**.
- You can select the level of low tones you desire.

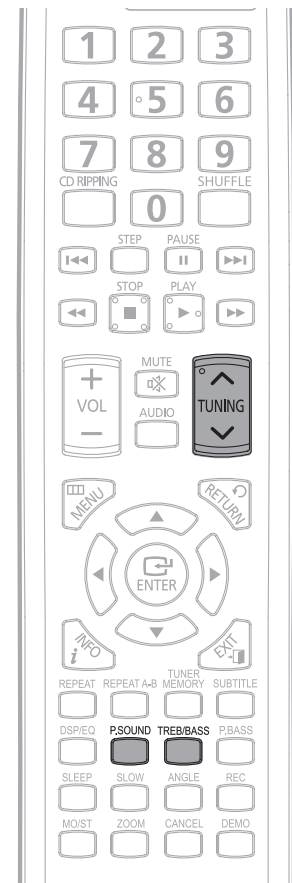

DSP/EQ Function / Power Bass Function

Selecting DSP/EQ

Your mini-compact system is equipped with a preset equalizer that allows you to choose the most appropriate balance between treble and bass frequencies, according to the type of music you are listening to.

Press **DSP/EQ** on the remote control until the required option is selected.

To obtain a...	Select...
Normal balance (linear)	PASS
Balance suitable for pop music	POP
Balance suitable for rock music	ROCK
Balance suitable for class	CLASSIC
Balance suitable for jazz	JAZZ
Balance suitable for s.bass	S.BASS

➤ When CD Ripping, the DSP/EQ function can't work and the DSP/EQ automatically convert to "PASS" mode.

Selecting Power Bass

Your micro-compact system has a bass amplification function called **SBS (Super Bass Sound)**. This function makes the sound more powerful and real.

Press **P.BASS** button on the remote control.

Result: "P. BASS" is displayed.

To cancel this function, press **P.BASS** again, "OFF" is displayed for a few seconds.

Sleep Timer Function / Mute Function

Sleep Timer Function

You can set the time that the DVD player will shut itself off.

Press **SLEEP** button.

- Each time the button is pressed, the selection changes as follows:
90 MIN → 60 MIN → 45 MIN → 30 MIN → 15 MIN → SLEEPOFF.

90 MIN

To confirm the sleep timer setting, press **SLEEP** button.

- The remaining time before the DVD player will shut itself off is displayed.
- Pressing the button again changes the sleep time from what you have set earlier.

To cancel the sleep timer, press **SLEEP** button until SLEEPOFF appears on the display.

Mute Function

This is useful when answering a doorbell or telephone call.

Press **MUTE** button.

- 'MUTE' appears in the display.
- To switch the sound back on, press MUTE again or press the VOLUME buttons.

MUTE



DEMO Function / DIMMER Function / ECO Function

DEMO Function

You can view the various functions available on your system.

Press **DEMO** button.

- The various functions available are listed in turn on the display.
- All these functions are described in detail in this booklet. For instructions on how to use them, refer to the appropriate sections.

DIMMER Function

You can adjust the brightness of the display on the main unit so it won't interfere with your movie viewing.

Press **DIMMER** button.

- Each time the button is press, the brightness changes as follows: **DIMMER ON(Dim)** → **DIMMER OFF(Bright)**.

Note

Press any buttons to cancel DEMO function.
When you turn off the main unit, DEMO function will be auto start after 10 seconds. if you want to cancel this DEMO function, press DEMO button again.

ECO Function

You can save the power consumption while the unit is turned off (on standby)

In Standby/on mode, press and hold the **POWER** button for longer than 3 seconds.

- Result: ECO displays and the main set automatically switches itself into the power saving mode.

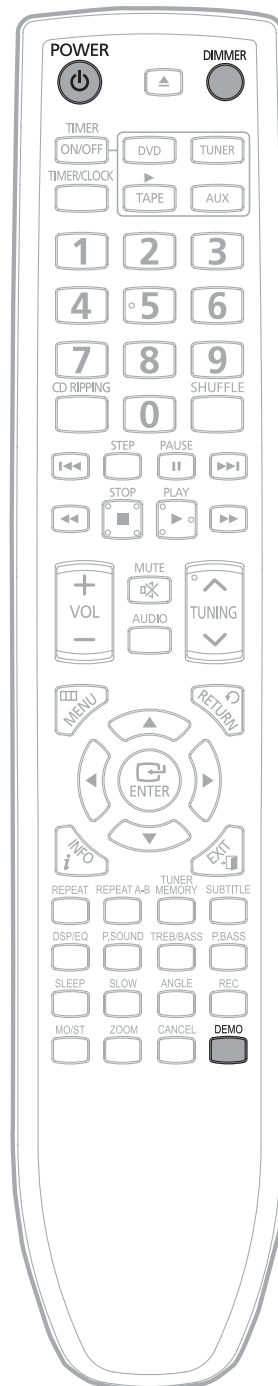

Connecting Headphones

ENG

You can connect a set of headphones to your micro component system so that you can listen to music or radio programmers without disturbing other people in the room. The headphones must have a 3.5ø jack or an appropriate adapter.

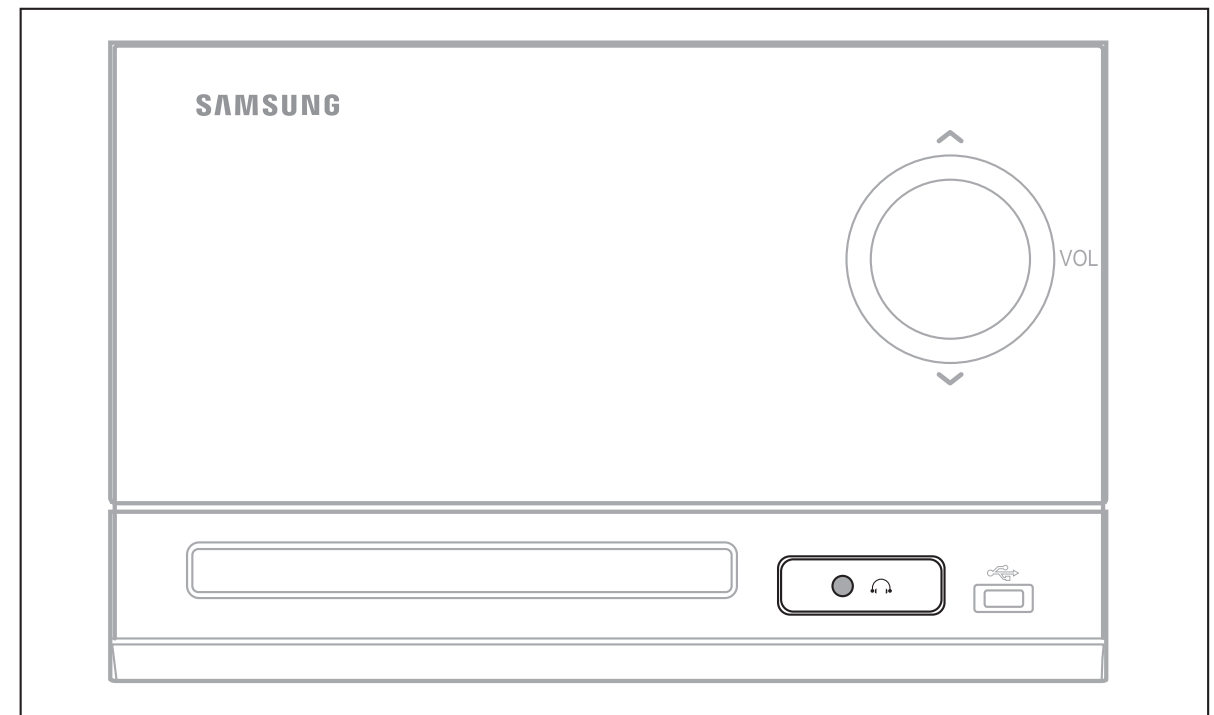

Connect the headphones to the **PHONES** jack on the front panel.

- The loudspeakers are no longer used to output the sound.

Note

- Prolonged use of headphones at a high volume may damage your hearing.

MISCELLANEOUS



Cautions on Handling and Storing Discs

Small scratches on the disc may reduce sound and picture quality or cause breaks in playback. Be especially careful not to scratch discs when handling them.

● Handling discs



Do not touch the playback side of the disc. Hold the disc by the edges so that fingerprints will not get on the surface.
Do not stick paper or tape on the disc.

● Handling and Storing Discs

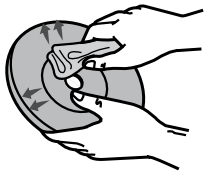

When you get fingerprints or dirt on the disc, clean it with a mild detergent diluted in water and wipe with a soft cloth.

- When cleaning, wipe gently from the inside to the outside of the disc.

Note

- Condensation may form if warm air comes into contact with cold parts inside the player. When condensation forms inside the player, the player may not operate correctly. If this occurs, remove the disc and let the player stand for 1 or 2 hours with the power on.

● Precautions When Using Audio Cassettes

- Check that the tape in the cassette is sufficiently taut.
- To prevent erasing a cassette that you wish to keep, remove the safety tab on the upper edge of the cassette. To record a cassette, where the tab has been broken, simply cover the opening with adhesive tape.
- When you have finished playing a cassette, always put it back in its case.
- Store your cassettes in a clean place, out of direct sunlight, where they will not be exposed to high temperatures.
- Avoid using 120-minute cassettes as they place unnecessary strain on the tape mechanism.

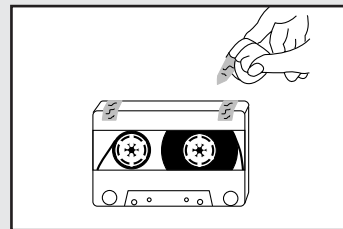
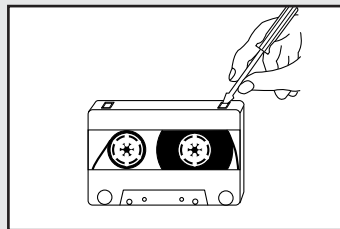
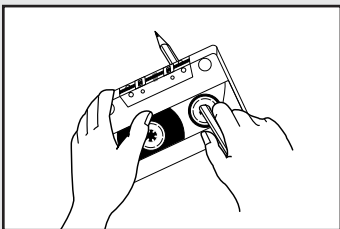

Before Calling for Service

ENG

Refer to the chart below when this unit does not function properly. If the problem you are experiencing is not listed below or if the instruction below does not help, turn off the unit, disconnect the power cord, and contact the nearest authorized dealer or Samsung Electronics Service Center.

Symptom	Check/Remedy
Disc tray does not open.	<ul style="list-style-type: none">• Is the power cord plugged securely into the outlet?• Turn off the power and then turn it back on.
Playback does not start.	<ul style="list-style-type: none">• Check the region number of the DVD. DVD discs purchased from abroad may not be playable.• CD-ROMs and DVD-ROMs cannot be played on this DVD player.• Make sure that the rating level is correct.
The remote control does not work.	<ul style="list-style-type: none">• Is the remote control being operated within its operation range of angle and distance?• Are the batteries exhausted?
Playback does not start immediately when the Play/Pause button is pressed.	<ul style="list-style-type: none">• Are you using a deformed disc or a disc with scratches on the surface?• Wipe the disc clean.
Sound is not produced.	<ul style="list-style-type: none">• No sound is heard during fast playback, slow playback, and step motion playback.• Are the speakers connected properly? Is the speaker setup correctly customized?• Is the disc severely damaged?
Picture does not appear, sound is not produced, or the disc tray opens 2 to 5 seconds later.	<ul style="list-style-type: none">• Was the DVD player suddenly moved from a cold place to a warm one? When condensation forms inside the player, remove the disc and let the player stand for 1 or 2 hours with the power on. (You can use the player again after condensation disappears.)
<ul style="list-style-type: none">• Disc is rotating but no picture is produced.• Picture quality is poor and picture is shaking.	<ul style="list-style-type: none">• Is the TV power on?• Are the video cables connected properly?• Is the disc dirty or damaged?• A poorly manufactured disc may not be playable.



Notes on Discs

ENG

Symptom	Check/Remedy
Audio language and subtitles do not work.	<ul style="list-style-type: none">• Audio language and subtitles will not work for DVDs not containing them. And depending on the disc, they may work differently.
Menu screen does not appear even when the menu function is selected.	<ul style="list-style-type: none">• Are you using a disc that does not contain menus?
Aspect ratio cannot be changed.	<ul style="list-style-type: none">• You can play 16:9 DVDs in 16:9 WIDE mode, 4:3 LETTER BOX mode, or 4:3 PAN SCAN mode, but 4:3 DVDs can be seen in 4:3 ratio only. Refer to the DVD disc jacket and then select the appropriate function.
The tape does not start playing	<ul style="list-style-type: none">• The TAPE function has not been selected.• The cassette has not been inserted correctly.• The cassette player has not been closed.• The tape is either slack or broken.
The volume falls off The cassette is not erased correctly There is excessive wow and flutter	<ul style="list-style-type: none">• The audio heads are dirty.• The rollers or drive capstans are dirty.• The tape is worn.
Can't receive radio broadcast.	<ul style="list-style-type: none">• Is the antenna connected properly?• If the antenna's input signal is weak, install an external FM antenna in an area with good reception.
<ul style="list-style-type: none">• The main unit is not working. (Example: The power goes out or strange noise is heard.)• The DVD player is not working normally.	<ul style="list-style-type: none">• Turn off the power and hold the STOP ■ button on the main unit for longer than 5 seconds. <p>Using the RESET function will erase all stored settings. Do not use this unless necessary.</p>
The password for rating level has been forgotten.	<ul style="list-style-type: none">• While the player is in the No Disc mode, hold the main unit's STOP ■ button for longer than 5 seconds. "INITIAL" appears on the display and all settings will return to the default values.• Press the POWER button. <p>Using the RESET function will erase all stored settings. Do not use this unless necessary.</p>

Disc Recording Format

This product does not support Secure (DRM) Media files.

CD-R Discs

- Some CD-R discs may not be playable depending on the disc recording device (CD-Recorder or PC) and the condition of the disc.
- Use a 650MB/74 minute CD-R disc. Do not use CD-R discs over 700MB/80 minute as they may not be played back.
- Some CD-RW (Rewritable) media, may not be playable.
- Only CD-Rs that are properly "closed" can be fully played. If the session is closed but the disc is left open, you may not be able to fully play the disc.

CD-R MP3 Discs

- Only CD-R discs with MP3 files in ISO 9660 or Joliet format can be played.
- MP3 file names should be 8 characters or less in length and contain no blank spaces or special characters (. / = +).
- Use discs recorded with a compression/decompression data rate greater than 128Kbps.
- Only files with the ".mp3" and ".MP3" extensions can be played.
- Only a consecutively written multisession disc can be played. If there is a blank segment in the Multisession disc, the disc can be played only up to the blank segment.
- If the disc is not closed, it will take longer to begin playback and not all of the recorded files may be played.
- For files encoded in Variable Bit Rate (VBR) format, i.e. files encoded in both low bit rate and high bit rate (e.g., 32Kbps ~ 320Kbps), the sound may skip during playback.
- A maximum of 500 tracks can be played per CD.
- A maximum of 300 folders can be played per CD.

CD-R JPEG Discs

- Only files with the ".jpg" extensions can be played.
- If the disc is not closed, it will take longer to start playing and not all of the recorded files may be played.
- Only CD-R discs with JPEG files in ISO 9660 or Joliet format can be played.
- JPEG file names should be 8 characters or less in length and contain no blank spaces or special characters (. / = +).
- Only a consecutively written multisession disc can be played. If there is a blank segment in the multisession disc, the disc can be played only up to the blank segment.
- A maximum of 9,999 images can be stored on a single CD.
- When playing a Kodak/Fuji Picture CD, only the JPEG files in the picture folder can be played.
- Picture discs other than Kodak/Fuji Picture CDs may take longer to start playing or may not play at all.



DVD±R/RW, CD-R/RW DivX Discs

- Software updates for incompatible formats are not supported.
(Example : QPEL, GMC, resolution higher than 720 x 480 pixels, etc.)
- Sections with a high frame rate might not be played while playing a DivX file.

DivX® is a digital video format created by DivX, Inc. This is an official DivX Certified or DivX Ultra Certified device that plays DivX video.



Notes on Terminology

ANGLE	Recorded onto some DVD discs are scenes which have been simultaneously shot from a number of different angles (the same scene is shot from the front, from the left , from the right , etc.). With such discs, the Angle button can be used to change the angle of view for specific scenes.
CHAPTER NUMBER	These numbers are recorded on DVD discs. A Title is subdivided into many sections, each of which is numbered, and specific parts of the video can be searched quickly using these numbers.
DVD	A high-density optical disc on which high-quality pictures and sound have been recorded by means of digital signals. Incorporating a new video compression technology (MPEG-2) and high-density recording technology, a DVD disc comprises two 0.6 mm thick discs bonded together.
PCM	An acronym for Pulse Code Modulation - another name for digital audio.
PBC (PLAYBACK CONTROL)	This is recorded on a video CD (version 2.0). Selected scenes or information can be chosen from the menu displayed on the TV monitor.
REGION NUMBER	Both the DVD player and DVD discs are encoded with a region number. If the region number on the DVD disc does not correspond to the region number of the DVD player, the player cannot play the disc.
SUBTITLES	Translated appearing at the bottom of the screen. A DVD disc can contain up to 32 subtitle languages.
TITLE NUMBER	These numbers are recorded on DVD discs. When a disc contains two or more movies, these movies are numbered as Title 1, Title 2, etc.
TRACK NUMBER	These numbers are assigned to the tracks which are recorded on video and audio CDs. They enable specific tracks to be located quickly.
VIDEO CD	Contains recordings of pictures and sound whose quality is roughly comparable to that of video tape. This player also supports video CDs with playback control (version 2.0).
 DOLBY DIGITAL	5.1 (or 6) Channel Digital Surround sound reproduced from DVDs and LDs recorded as a digital signals (with  disc marking). With better sound quality, dynamic range, and directionality than traditional Dolby surround technology, you can enjoy dynamic, realistic sound.



Specifications

ENG

RADIO

FM

Signal/noise ratio	62 dB
Usable sensitivity	10 dB
Total harmonic distortion	0.4 %

COMPACT DISC PLAYER

Capacity	1 disc
Frequency range	20 Hz - 20 KHz (± 1 dB)
Signal/noise ratio	90 dB (at 1 KHz) with filter
Distortion	0.1 % (at 1 KHz)
Channel separation	75 dB
Disc sizes	Diameter: 120 or 80 mm. Thickness: 1.2 mm

TAPE

Frequency range	125 Hz ~ 10 KHz
Signal/noise ratio	40 dB
Channel separation	35 dB
Erasing effect	50 dB(without filter)

AMPLIFIER

Output power	
Front Speaker(4 Ω)	60W/CH RMS,IEC (total harmonic distortion: 10 %)
Channel separation	60 dB
Signal/noise ratio	70 dB

GENERAL

Power consumption	35W
Dimensions	251(D) x 154 (H) x 230 (W) mm
Weight	2.2 Kg

MISCELLANEOUS

Contact SAMSUNG WORLD WIDE

If you have any questions or comments relating to Samsung products, please contact the SAMSUNG customer care centre.

Region	Country	Customer Care Center ☎	Web Site
North America	CANADA	1-800-SAMSUNG(726-7864)	www.samsung.com/ca
	MEXICO	01-800-SAMSUNG(726-7864)	www.samsung.com/mx
	U.S.A	1-800-SAMSUNG(726-7864)	www.samsung.com/us
Latin America	ARGENTINE	0800-333-3733	www.samsung.com/ar
	BRAZIL	0800-124-421, 4004-0000	www.samsung.com/br
	CHILE	800-SAMSUNG(726-7864)	www.samsung.com/cl
	NICARAGUA	00-1800-5077267	www.samsung.com/latin
	HONDURAS	800-7919267	www.samsung.com/latin
	COSTA RICA	0-800-507-7267	www.samsung.com/latin
	ECUADOR	1-800-10-7267	www.samsung.com/latin
	EL SALVADOR	800-6225	www.samsung.com/latin
	GUATEMALA	1-800-299-0013	www.samsung.com/latin
	JAMAICA	1-800-234-7267	www.samsung.com/latin
	PANAMA	800-7267	www.samsung.com/latin
	PUERTO RICO	1-800-682-3180	www.samsung.com/latin
	REP. DOMINICA	1-800-751-2676	www.samsung.com/latin
	TRINIDAD & TOBAGO	1-800-SAMSUNG(726-7864)	www.samsung.com/latin
	VENEZUELA	0-800-100-5303	www.samsung.com/latin
	COLOMBIA	01-8000112112	www.samsung.com.co
Europe	BELGIUM	02 201 2418	www.samsung.com/be
	CZECH REPUBLIC	800-726-786 (800 - SAMSUNG)	www.samsung.com/cz
	DENMARK	70 70 19 70	www.samsung.com/dk
	FINLAND	030-6227 515	www.samsung.com/fi
	FRANCE	01 48 63 00 00	www.samsung.com/fr
	GERMANY	01805 - SAMSUNG(726-7864) (€ 0,14/Min)	www.samsung.de
	HUNGARY	06-80-SAMSUNG(726-7864)	www.samsung.com/hu
	ITALIA	800-SAMSUNG(726-7864)	www.samsung.com/it
	LUXEMBURG	02 261 03 710	www.samsung.com/lu
	NETHERLANDS	0900-SAMSUNG (726-7864) (€ 0,10/Min)	www.samsung.com/nl
	NORWAY	815-56 480	www.samsung.com/no
	POLAND	0 801 1SAMSUNG(0-801172 678)	www.samsung.com/pl
	PORTUGAL	80820-SAMSUNG(726-7864)	www.samsung.com/pt
	SLOVAKIA	0800-SAMSUNG(726-7864)	www.samsung.com/sk
	SPAIN	902-1-SAMSU(72678)	www.samsung.com/es
	SWEDEN	0771-400 200	www.samsung.com/se
	U.K	0845 SAMSUNG (7267864)	www.samsung.com/uk
	EIRE	0818 717 100	www.samsung.com/ie
	AUSTRIA	0800-SAMSUNG(726-7864)	www.samsung.com/at
	SWITZERLAND	0800-SAMSUNG(726-7864)	www.samsung.com/ch
CIS	RUSSIA	8-800-555-55-55	www.samsung.ru
	KAZAKHSTAN	8-10-800-500-55-500	www.samsung.com/kz_ru
	UZBEKISTAN	8-10-800-500-55-500	www.samsung.com/kz_ru
	KYRGYZSTAN	00-800-500-55-500	
	TADJIKISTAN	8-10-800-500-55-500	
	UKRAINE	8-800-502-0000	www.samsung.ua
	LITHUANIA	8-800-77777	www.samsung.lt
	LATVIA	8000-7267	www.samsung.com/lv
	ESTONIA	800-7267	www.samsung.ee
Asia Pacific	AUSTRALIA	1300 362 603	www.samsung.com/au
	NEW ZEALAND	0800 SAMSUNG (0800 726 786)	www.samsung.com/nz
	CHINA	800-810-5858, 400-810-5858, 010-6475 1880	www.samsung.com/cn
	HONG KONG	3698-4698	www.samsung.com/hk
	INDIA	3030 8282, 1800 110011, 1-800-3000-8282	www.samsung.com/in
	INDONESIA	0800-112-8888	www.samsung.com/id
	JAPAN	0120-327-527	www.samsung.com/jp
	MALAYSIA	1800-88-9999	www.samsung.com/my
	PHILIPPINES	1800-10-SAMSUNG(726-7864)	www.samsung.com/ph
	SINGAPORE	1800-SAMSUNG(726-7864)	www.samsung.com/sg
	THAILAND	1800-29-3232, 02-689-3232	www.samsung.com/th
	TAIWAN	0800-329-999	www.samsung.com/tw
	VIETNAM	1 800 588 889	www.samsung.com/vn
Middle East & Africa	TURKEY	444 77 11	www.samsung.com/tr
	SOUTH AFRICA	0860-SAMSUNG(726-7864)	www.samsung.com/za
	U.A,E	800-SAMSUNG (726-7864), 8000-4726	www.samsung.com/ae