

CE 0168

Your phone displays the following status indicators on the top of the screen:

Icon	Description	Icon	Description
	No signal		New multimedia message (MMS)
	Signal strength ¹		New email message
	Network searching		New configuration message
	GPRS network connected		New push message
	EDGE network connected		New voice mail message
	Call in progress		Wi-Fi AP connected
	Browsing the web		Open Wi-Fi APs available
	Connecting to secured web page		Normal profile activated
	Roaming (outside of normal service area)		Silent profile activated
	Call diverting activated		Battery power level
	No SIM card		Current time
	Bluetooth activated		
	Alarm activated		
	Memory card inserted		
	New text message (SMS)		

Lock or unlock the keys

- In Idle mode, press and hold [Alt] to lock the keys.
- In Idle mode, press and hold [] to lock or unlock the keys.

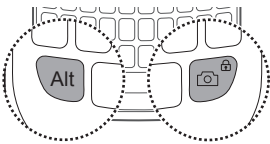

Switch to Silent mode

In Idle mode, press and hold [] to mute or unmute your phone.

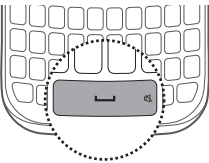

Install the SIM cards and battery

1. Remove the back cover and insert the SIM cards.

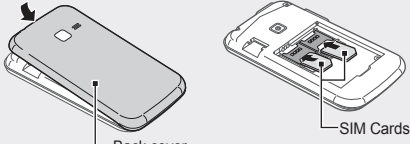

2. Insert the battery and replace the back cover.

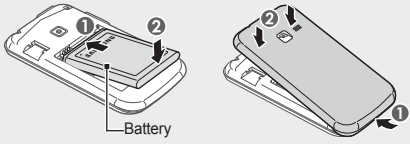

Charge the battery

1. Plug a travel adapter into the multifunction jack.
2. When charging is finished, unplug the travel adapter.

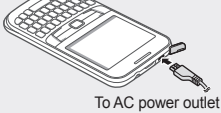

- Do not remove the battery from the phone before unplugging the travel adapter first. Otherwise, the phone may be damaged.
- To save energy, unplug the travel adapter when not in use. The travel adapter does not have a power switch, so you must unplug the travel adapter from the electrical socket when not in use to avoid wasting power. The device should remain close to the electrical socket while charging.

Insert a memory card (optional)

Your phone accepts microSD™ or microSDHC™ memory cards up to 32 GB (depending on memory card manufacturer and type).

- Formatting the memory card on a PC may cause incompatibility with your phone. Format the memory card only on the phone.
- Frequent writing and erasing of data will shorten the life span of memory cards.

1. Remove the back cover.
2. Insert a memory card with the gold-coloured contacts facing down.

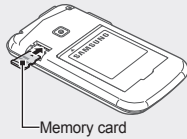

3. Push the memory card in the memory card slot until it locks in place.
4. Replace the back cover.

Instructional icons

	Note: notes, usage tips, or additional information
	Followed by: the order of options or menus you must select to perform a step; for example: In Menu mode, select Messages → Create message (represents Messages , followed by Create message)
	Square brackets: phone keys; for example: [] (represents the Power/End key)
	Angled brackets: softkeys that control different functions at each screen; for example: < Save > (represents the Save softkey)

Turn your phone on or off

To turn your phone on,

1. Press and hold [].
2. Enter your PIN and press <**Confirm**> (if necessary).

- If the battery remains fully discharged or removed from the device, the time and date will be reset.

To turn your phone off, repeat step 1 above.

Use the optical track pad

To select the highlighted menu option or confirm an input, press the track pad.

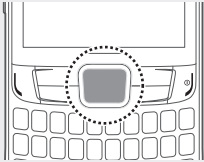

To scroll through menu options, drag your finger up, down, left or right on the track pad.

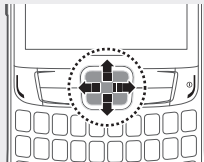

- If you leave your device under direct sunlight for an extended period of time, it may cause the trackpad to malfunction or freeze. Try to use your device in a shady place out of direct sunlight.

Manage your SIM cards

Your phone supports Dual SIM mode that enables you to use two SIM cards at the same time without changing them. Learn to activate SIM cards and change the card settings.

To switch networks

In Idle mode, press [] to switch between networks.

To activate SIM cards

1. In Menu mode, select **Settings** → **SIM cards management**.
You can also press and hold [] in Idle mode.
2. Select **Network** and scroll left or right to a SIM card.
3. Press <**Change**> to activate the card.

To switch SIM cards automatically

1. In Menu mode, select **Settings** → **SIM cards management**.
2. Select **SIM auto switch**.
3. Press <**Change**> to activate the auto switch feature.
4. Select a SIM card and set the starting and ending time to switch to the SIM card.
5. Press <**Save**>.
6. Repeat steps 4-5 for another SIM card.

To register SIM cards

1. In Menu mode, select **Settings** → **SIM cards management**.
2. Select **Register card**.
3. Scroll left or right to a SIM card.
4. Press <**Select**> and change the name and the icon of the card.

Access menus

To access your phone's menus,

1. In Idle mode, press <**Menu**> to access Menu mode.

- You may need to press the optical track pad to access Menu mode depending on your region or service provider.

2. Use the optical track pad to scroll to a menu or option.
3. Press **Select** or the optical track pad to confirm the highlighted option.
4. Press <**Back**> to move up one level; Press [] to return to Idle mode.

- When you access a menu requiring the PIN2, you must enter the PIN2 supplied by the SIM card. For details, contact your service provider.
- Samsung is not responsible for any loss of passwords or private information or other damages caused by illegal software.

Make a call

1. In Idle mode, enter an area code and a phone number.
2. Press [] to dial the number.
3. To end the call, press [].

Answer a call

1. When a call comes in, press [].
2. To end the call, press [].

Call a recently dialled number

1. In Idle mode, press [] to display a list of recent numbers.
2. Scroll left or right to select a call type.
3. Scroll up or down to select a number or name.
4. Press the track pad to view details of the call or [] to dial the number.

Adjust the volume

To adjust the volume of the ringtone

1. In Menu mode, select **Settings** → **Sound profiles**.
2. Scroll to the profile you are using.
3. Press <**Edit**> → **Volume**.
4. Scroll to **Call alert**.
5. Scroll left or right to adjust the volume level and press <**Save**>.

To add items to the smart home screen

1. In Menu mode, select **Settings** → **Display** → **Smart home**.
2. Press <**Edit**>.
3. Select the items to display on the smart home screen.
For the shortcuts toolbar, you can add or delete the shortcuts as desired. Press <**Options**> → **Edit shortcuts**.
4. Press <**Options**> → **Save**.
5. Press the track pad.

- You can change the idle screen to another style. In Menu mode, select **Settings** → **Display** → **Smart home** and scroll left or right to a style you want.

To access the smart home items

Drag on the track pad to scroll through the items on the smart home screen and press the track pad to select an item.

Enter text

Press appropriate alphanumeric keys to enter characters, numbers, and symbols. To enter characters on the upper half of the keys, press [Alt].

To change the text input mode

- Press <**Options**> → **Writing options** → **Writing language** to change the input language.
- Press <**Options**> → **Writing options** → **Auto capitalisation off** to turn automatic capitalising off.
- Press [Alt] and [] at the same time to open the symbol panel.

Press an appropriate alphanumeric key until the character you want appears on the display.

To use other features for text input

- To move the cursor, scroll left or right.
- To change case, press []
- To delete characters one by one, press []. To delete words quickly, press and hold [].
- To insert a space between characters, press [].
- To start a new line, press [].

Add a new contact

1. In Idle mode, enter a phone number and press <**Save**>.
2. Select **Create contact** → a memory location (if necessary).
3. Select a number type (if necessary).
4. Enter contact information.
5. Press the track pad.

Send and view messages

To send a text message or multimedia message

1. In Menu mode, select **Messages** → **Create message**.
2. Enter a recipient number and scroll down.
3. Enter the message text. *See "Enter text."*
For sending as a text message, skip to step 5. For attaching multimedia, continue with step 4.
4. Press <**Options**> → **Add multimedia** and add an item.
5. Press the track pad to send the message.

To view a text or multimedia messages

1. In Menu mode, select **Messages** → **Inbox**.
2. Select a text or multimedia message.

Make fake calls

You can simulate an incoming call when you want to get out of meetings or unwanted conversations.

To activate the fake call feature

In Menu mode, select **Settings** → **Call** → **Fake call** → **Fake call hot key** → **On**.

To make a fake call

In Idle mode, press and hold the Volume down key.

Activate and send an SOS message

In an emergency, you can send SOS messages to your family or friends for help.

To activate the SOS message

1. In Menu mode, select **Messages** → **Settings** → **SOS messages** → **Sending options**.
2. Press <**Change**> to select **On**.
3. Scroll down and press the track pad to open the recipient list.
4. Press <**Search**> to open your contact list.
5. Select a contact.
6. Select a number (if necessary).
7. Press the track pad to save the recipients.
8. Scroll down and set the number of times to repeat the SOS message.
9. Press <**Back**> → <**Yes**>.

To send an SOS message

1. With the keys locked, press either end of the volume key four times to send an SOS message to preset numbers.
The phone switches to SOS mode and sends the preset SOS message.
2. To exit SOS mode, press [].

SAMSUNG ELECTRONICS

Declaration of Conformity (R&TTE)
We, **Samsung Electronics**
declare under our sole responsibility that the product

GSM BT/Wi-Fi Mobile Phone : GT-S3572

to which this declaration relates, is in conformity with the following standards and/or other normative documents.

SAFETY	EN 60950-1 : 2006 +A1 : 2010
SAR	EN 50360 : 2001 / AC 2006 EN 62209 - 1 : 2006 EN 62209 - 2 : 2010 EN 62479 : 2010 EN 62311 : 2008
EMC	EN 301 489-01 V1.8.1 (04-2008) EN 301 489-07 V1.3.1 (11-2005) EN 301 489-17 V2.1.1 (05-2009)
RADIO	EN 301 511 V9.0.2 (03-2003) EN 300 328 V1.7.1 (10-2006)

We hereby declare that [all essential radio test suites have been carried out and that] the above named product is in conformity to all the essential requirements of Directive 1999/5/EC.

The conformity assessment procedure referred to in Article 10 and detailed in Annex[IV] of Directive 1999/5/EC has been followed with the involvement of the following Notified Body(ies):

BABT, Forsyth House, Churchfield Road, Walton-on-Thames, Surrey, KT12 2TD, UK* Identification mark: 0168	
The technical documentation kept at : Samsung Electronics QA Lab.	

which will be made available upon request.
(Representative in the EU)

Samsung Electronics Euro QA Lab. Blackbushe Business Park, Saxony Way, Yateley, Hampshire, GU46 6GG, UK* 2012.07.05	
(place and date of issue)	Joong-Hoon Choi / Lab Manager (name and signature of authorised person)

* It is not the address of Samsung Service Centre. For the address or the phone number of Samsung Service Centre, see the warranty card or contact the retailer where you purchased your product.