

SAMSUNG

Operating Instructions

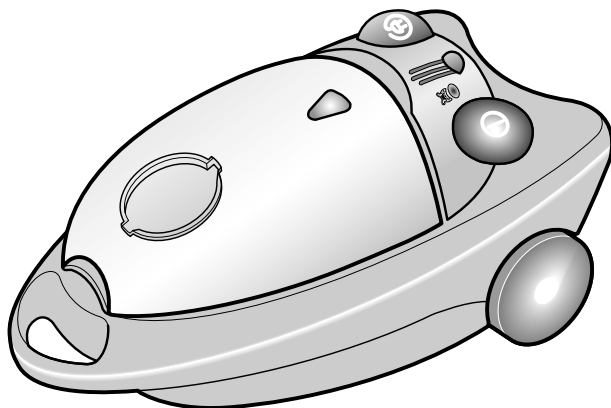

VACUUM CLEANER



✿ Before operating this unit, please read the instructions carefully.

Register your product at www.samsung.com/global/register

IMPORTANT SAFEGUARDS

- ▶ This appliance must be connected to the same voltage of electrical power supply as shown on your vacuum-cleaner's rating plate.
- ▶ Do not use your vacuum-cleaner on a wet surface. It cannot be used to remove liquids.
- ▶ Carpets treated with a liquid cleaner must be allowed to dry before being cleaned with the unit.
- ▶ Never operate the vacuum-cleaner without a dust bag.
- ▶ If a dust bag is not inserted, the cover cannot be closed, please don't close forcibly.
- ▶ Keep children away from your vacuum-cleaner. It must not be used on people or animals.
- ▶ Never use your vacuum-cleaner to vacuum matches, glowing embers, or cigarette-ends. Avoid vacuuming hard, pointed objects, since they may damage the appliance or dust bag.
- ▶ Consult the trouble shooting guide in this manual if your vacuum-cleaner fails to operate properly. Contact an authorized service agent if the problem persists.
- ▶ If the main cable is defective, the complete cable winder must be replaced by a service agent.
- ▶ Don't use your vacuum-cleaner outdoors.

Protecting the environment

- ▶ When you have unpacked the unit, do not simply throw the packing into the household waste.
- ▶ Take them to an appropriate collecting points for the recycling.

This Vacuum cleaner is approved the following.

EMC Directive : 89/336/EEC , 92/31/EEC and 93/68/EEC

Low Voltage Safety Directive : 73/23/EEC and 93/68/EEC

IDENTIFICATION OF PARTS

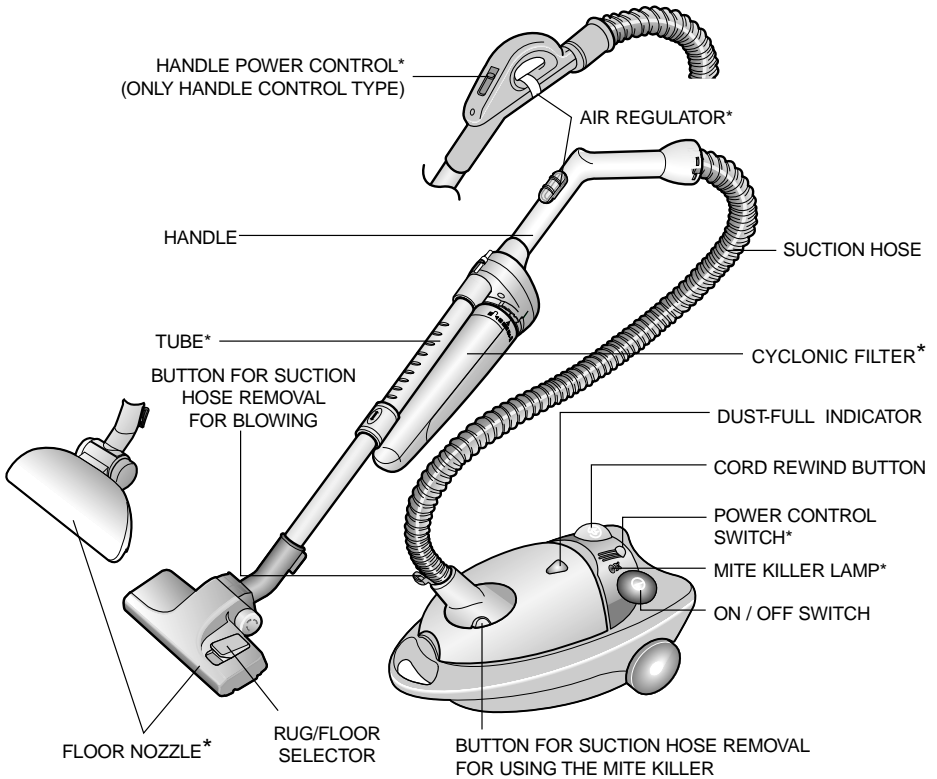

► Features marked * may vary according to model.

HANDLE CONTROL OPERATION (ONLY HANDLE CONTROL TYPE)

The suction capacity can be regulated steplessly by moving the side "A" to the desired position.

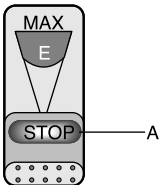

SLIDE IN THE STOP POSITION

Vacuum-cleaner switches off (stand by mode)

SLIDE TOWARDS MAX

Suction capacity increases steplessly up to max.

POWER CONTROL (ONLY SLIDING REGULATOR TYPE)

Vacuuming power can be adjusted to suit different situations using the power control.



MIN = For delicate fabrics, like curtains. **MAX** = For difficult floors and heavily soiled carpets.

DUST-FULL INDICATOR

If the "Dust-Full" indicator switches to "RED" while you are cleaning, the dust bag requires replacement.

NOTE: If the "Dust - Full" indicator continues to display "RED" even after changing the dust bag, turn the cleaner off to see if the hose, tube or nozzle is clogged.

ASSEMBLING THE VACUUM-CLEANER SO THAT IT IS READY FOR USE

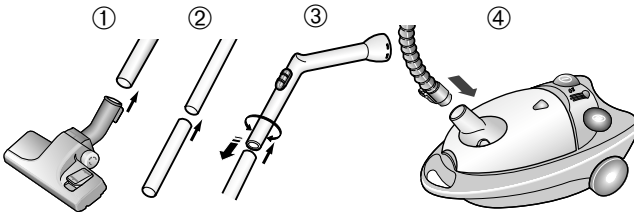

1. Slide the free end of the extension wand into the nozzle tube.
2. Slide the narrow end of one extension wand into the other extension wand.
3. Slide the extension wand into the handle end of the hose.
4. Slide the hose clamp into the suction inlet of the unit.

* **Option** ① Assemble the CYCLONIC FILTER with the handle and extension wand (depending on model).
② Adjusting the telescopic tubes (depending on model).

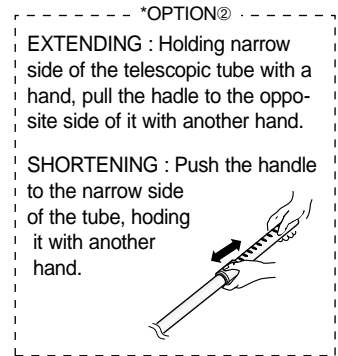
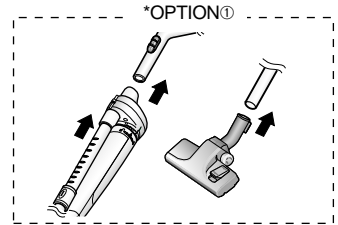

POWER CORD

1) PULLING OUT

The long power cord can be drawn out for your convenience.

2) REWINDING

After disconnecting the plug from the electrical outlet, press the cord rewind button lightly with your toe. The cord will automatically rewind.

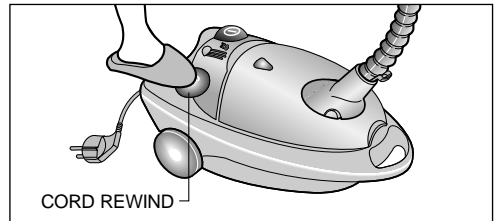

NOTE: When removing the power cord from the electrical outlet, grasp the plug, not the cord.

ON/OFF SWITCH

You can start or stop your vacuum cleaner by pressing the on/off switch lightly with your toe.

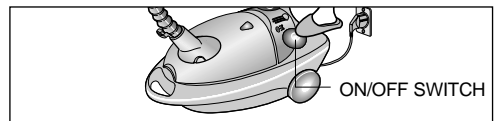

USING THE BLOWER (EXCEPT HANDLE CONTROL TYPE)



To blow out dust in crevices or corners you can use this function for your convenience.

Located on the rear side of the cleaner.

- 1) Disconnect the hose clamber from the body of the cleaner.

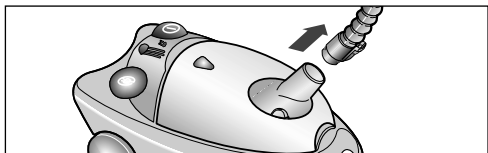

- 2) Open the tool storage cover.

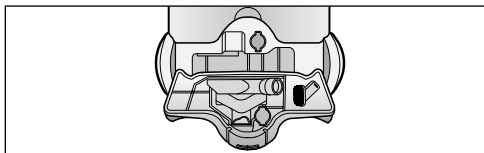

- 3) Remove the blow hole cap from the body of the cleaner.

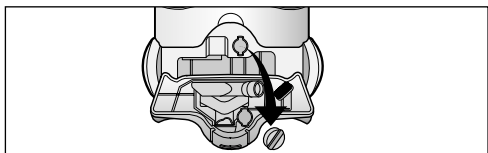

- 4) Connect the hose clamber to the blow hole.

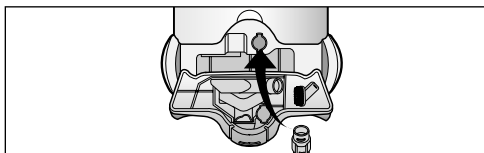

NOTE: Don't use your vacuum-cleaner outdoors.

USING THE MITE KILLER (OPTIONAL)

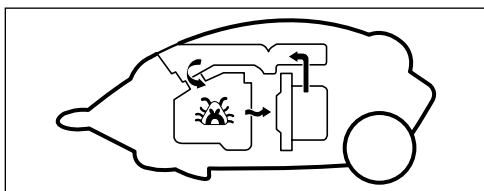

- 1) Disconnect the body connector from the body of the cleaner.

- 2) Shut the hose connection cover until tone is heard.

- Your vacuum-cleaner is not malfunctioning if it starts to operate when the hose connection cover is closed. This will happen if the vacuum-cleaner was on when the hose was removed.

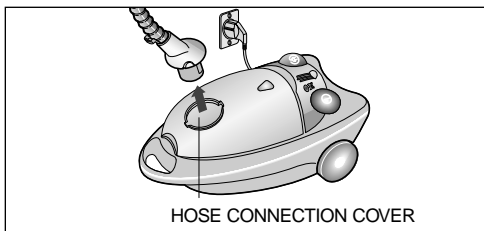

- 3) Mite killer lamp on.

Insect and germ killing work is started. It will continue for 2 to 5min and the process stops automatically.

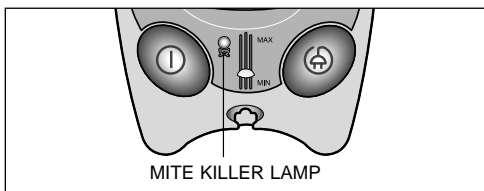

- 4) If you want to stop the machine while operating, you can either open hose connection cover, press On/off button or unplug the plug.

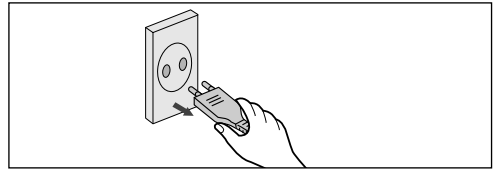

USING THE ACCESSORIES

Press the tool storage cover downward.

- * Crevice tool for radiators, crevice, corners, between cushions.
- * Upholstery brush for cushions and drapery.
- * Dusting brush for furniture, shelves, books, etc.

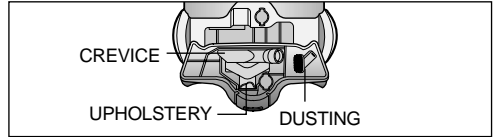

CREVICE

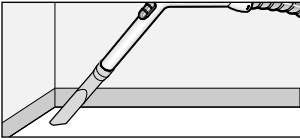

UPHOLSTERY

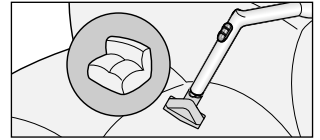

DUSTING

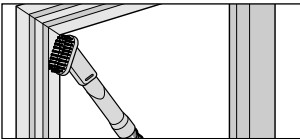

DUSTING

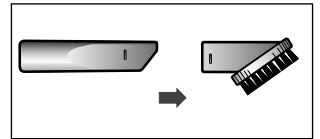

- * Before use, assemble the dusting brush to the crevice tool

PARK POSITION

Located in the top rear side of the vacuum-cleaner, there is a nozzle support that can be used to park the nozzle during pauses in cleaning.

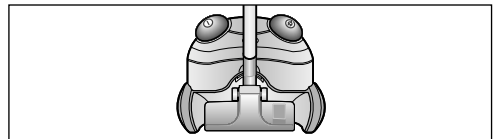

TRANSPORTING AND STORING THE VACUUM CLEANER

For easy storage and transportation, this vacuum-cleaner has a clip system built into the body, which will keep the tube, hose and nozzle in a vertical position.

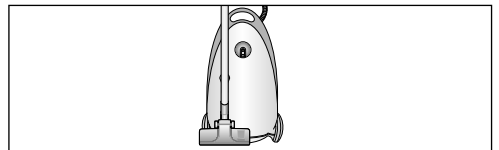

REPLACING THE DUST BAG

- 1) To open the dust cover of the dust bag compartment press the clamber upward
(The clamber is located at the front of the dust cover)

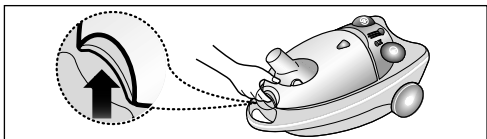

- 2) Remove the carrying bag from the cleaner.

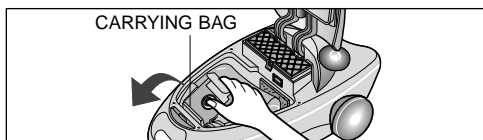

- 3) After removing the used dust bag, insert the cardboard bag collar of the new dust bag into the carrying bag.

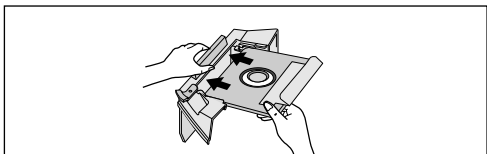

- 4) Press the dust cover down gently until the clamber relocks.

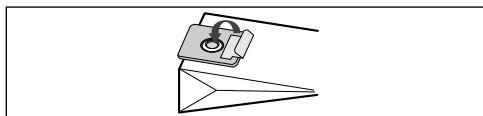
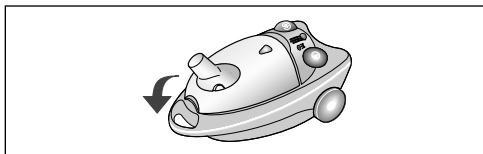

NOTE: Used dust bag can be sealed by removing the film from the paper and sticking the latter over the suction opening. (ONLY PAPER BAG)

FOR CLOTH FILTER BAG

After using, if the cloth filter bag is full of dust, clean the cloth filter bag and use it again.

MAINTENANCE OR REPLACEMENT OF THE FILTERS

1) INLET-FILTER.

- * Open the dust cover.
- * After detaching the filter, wash it lightly with water, dry it in the shade, and then insert it in its original position.
- * Close the dust cover.

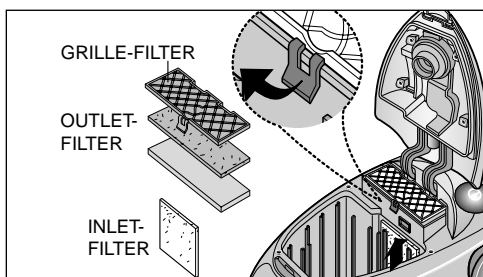

2) OUTLET-FILTER.

- * The outlet-filter which the air comes out from the vacuum-cleaner.
- * Open the dust cover, and then pull the hook upward.(The hook is located at the front of the dust cover)
- * Remove and replace the exhausted outlet-filter.
- * Close the grille filter, and then close the dust cover.

RUG/FLOOR SELECTOR

Before use, make sure that the position of the selector button is in the right position for the type of surface to be cleaned. * In order to maintain best cleaning efficiency, clean floor brush using crevice tool after use.

Push to side ① when cleaning the carpets.

Push to side ② when cleaning the floor, tile, mat, etc.

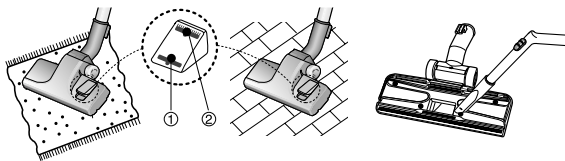

CYCLONIC FILTER

You can use a dust bag in your cleaner for a long time thanks to the Cyclonic Filter system and it maintain the maximum cleaning efficiency.

The larger particle of dust filtered from Cyclonic Filter remain in Dust Barrel when suctioned air and dust revolves in the Cyclonic Filter. So the dust bag contains only smaller ones.

When the Dust Barrel is filled with dust up to the indicating line, it needs disposing and cleaning. Dust Barrel can be cleaned in water.

1. Turn the Dust Barrel to the left and pull it.
2. Disconnect the Cyclonic Filter from extension wand and handle.
3. Remove thread and hair tangled around the net.
4. After cleaning the Dust Barrel and Cyclonic Filter, connect the Cyclonic Filter with extension wand and handle (washed part should be dried in the shade thoroughly before assembling).
5. Push and turn the Dust Barrel to the right.
Adjust indicating marks each other carved on Dust Barrel and Cyclonic Filter.

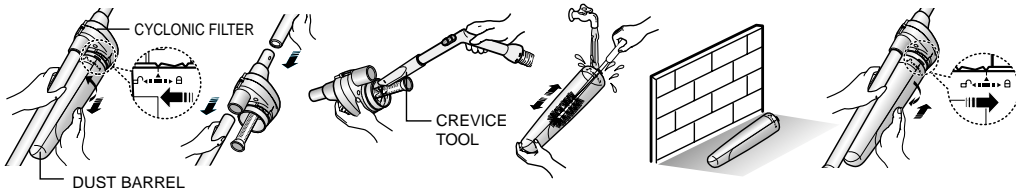

TROUBLE SHOOTING

PROBLEM	CAUSE	REMEDY
Motor does not start.	No power supply.	Check cable, plug and socket.
Suction force is gradually decreasing.	Filter, nozzle, suction hose or tube is blocked.	Remove the object.
Cord does not rewind fully.	Check that the cord is not twisted or wound unevenly.	Pull the cord out 2~3m & push down the cord rewind button.

If you have any comments or questions regarding a Samsung products, contact the SAMSUNG customer care center.

Country	Customer Care Center ☎	Web Site
U.K	0870 242 0303	www.samsung.com/uk
SOUTH AFRICA	0860 7267864 (SAMSUNG)	www.samsung.com/za