



INTERIOR AUDIO S-2000

Instruction Manual



Safety Warnings

CLASS 1 LASER PRODUCT
KLASSE 1 LASER PRODUKT
LUOKAN 1 LASER LAITE
KLASS 1 LASER APPARAT
PRODUCTO LASER CLASE 1

Use of controls, adjustments or performance of procedures other than those specified herein may result in hazardous radiation exposure.

CAUTION-INVISIBLE LASER RADIATION WHEN OPEN AND INTER LOCKS DEFEATED, AVOID EXPOSURE TO BEAM.

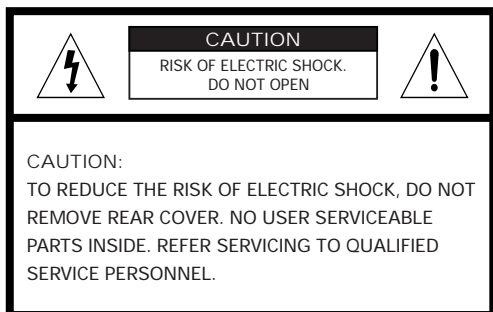

This symbol indicates that dangerous voltage which can cause electric shock is present inside this unit.



This symbol alerts you to important operating and maintenance instructions accompanying the unit.

WARNING: To reduce the risk of fire or electric shock, do not expose this appliance to rain or moisture.

CLASS 1 LASER PRODUCT

This Compact Disc player is classified as a CLASS 1 LASER product.

CAUTION: TO PREVENT ELECTRIC SHOCK, MATCH WIDE BLADE OF PLUG TO WIDE SLOT, FULLY INSERT.

Wiring the Main Power Supply Plug(UK Only)

IMPORTANT NOTICE

The main lead on this equipment is supplied with a moulded plug incorporating a fuse. The value of the fuse is indicated on the pin face of the plug and if it requires replacing, a fuse approved to BS1362 of the same rating must be used.

Never use the plug with the fuse cover removed. If the cover is detachable and a replacement is required, it must be of the same colour as the fuse fitted in the plug. Replacement covers are available from your dealer.

If the fitted plug is not suitable for the power points in your house or the cable is not long enough to reach a power point, you should obtain a suitable safety approved extension lead or consult your dealer for assistance.

However, if there is no alternative to cutting off the plug, remove the fuse and then safely dispose of the plug. Do not connect the plug to a main socket as there is a risk of shock hazard from the bared flexible cord.

Never attempt to insert bare wires directly into a main socket. A plug and fuse must be used at all times.

IMPORTANT

The wires in the main lead are coloured in accordance with the following code:–

BLUE = NEUTRAL BROWN = LIVE

As these colours may not correspond to the coloured markings identifying the terminals in your plug, proceed as follows:–

The wire coloured BLUE must be connected to the terminal marked with the letter N or coloured BLUE or BLACK.

The wire coloured BROWN must be connected to the terminal marked with the letter L or coloured BROWN or RED.

WARNING: DO NOT CONNECT EITHER WIRE TO THE EARTH TERMINAL WHICH IS MARKED WITH THE LETTER E OR BY THE EARTH SYMBOL , OR COLOURED GREEN OR GREEN AND YELLOW.

Contents

Thank you for buying this
SAMSUNG Audio system.

Please take time to read these instructions.
They will allow you to operate your
system with ease and take full advantage
of its features.

GB

◆ SAFETY WARNINGS	2
◆ INSTALLING YOUR MINI-COMPACT SYSTEM	
■ Front Panel View	4
■ Rear Panel View	5
■ Connecting the AM Aerial	6
■ Connecting the FM Aerial	6
■ Setting the Clock	7
◆ CD-PLAYER	
■ Listening to a Compact Disc	8
■ Selecting a Track	9
■ Searching for a Specific Music Passage on a CD	9
■ Repeat Function	10
■ Programming the Order of Playback	11
■ Checking or Changing Programmed Tracks	12
◆ TUNER	
■ Searching for and Storing the Radio Stations	13
■ Selecting a Stored Station	14
■ Improving Radio Reception	14
◆ OTHER FUNCTIONS	
■ About RDS broadcasting	15
■ Timer Function	18
■ Cancelling the Timer	19
■ Power Sound Function	19
■ Snooze Function	20
■ Setting the System to Switch Off Automatically	21
■ Selecting an Equalizer Preset	21
■ Connecting Headphones	22
◆ RECOMMENDATIONS FOR USE	
■ Precautions When Using Compact Discs	22
■ Safety Precautions	23
■ Before Contacting the After-Sales Service	24
■ Technical Specifications	25

Symbols



Front Panel View

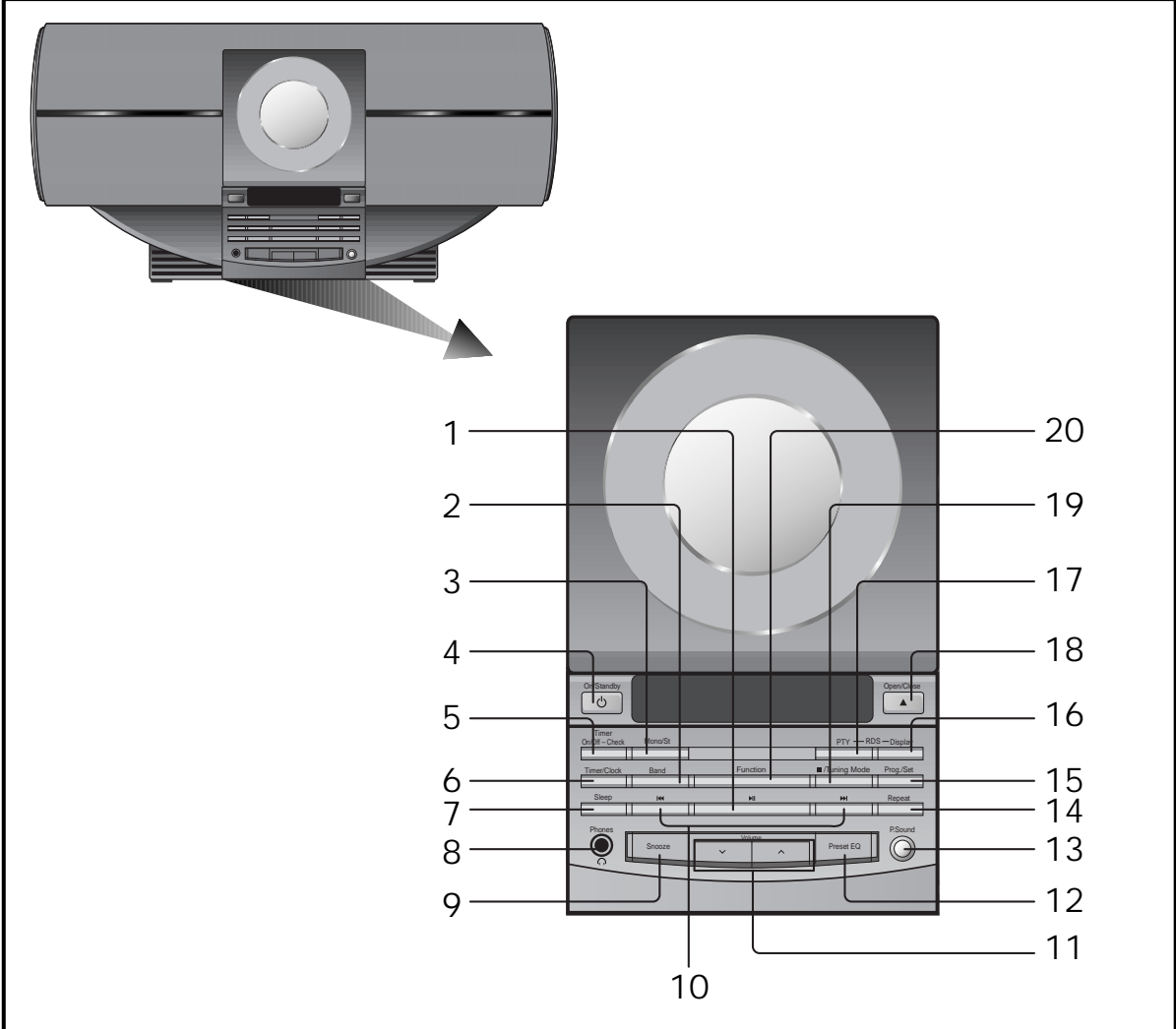

- | | |
|--------------------------------------|-----------------------------|
| 1. Play/Pause button | 11. Volume button |
| 2. Band button | 12. Preset EQ button |
| 3. Mono/St button | 13. Power Sound button |
| 4. On/Standby button | 14. Repeat button |
| 5. Timer On/Off – Check button | 15. Prog./Set button |
| 6. Timer/Clock button | 16. Display (RDS) |
| 7. Sleep button | 17. PTY (RDS) |
| 8. Headphone Jack Connector | 18. Open/Close button |
| 9. Snooze button | 19. Stop/Tuning Mode button |
| 10. CD Track or Radio Station Search | 20. Function button |

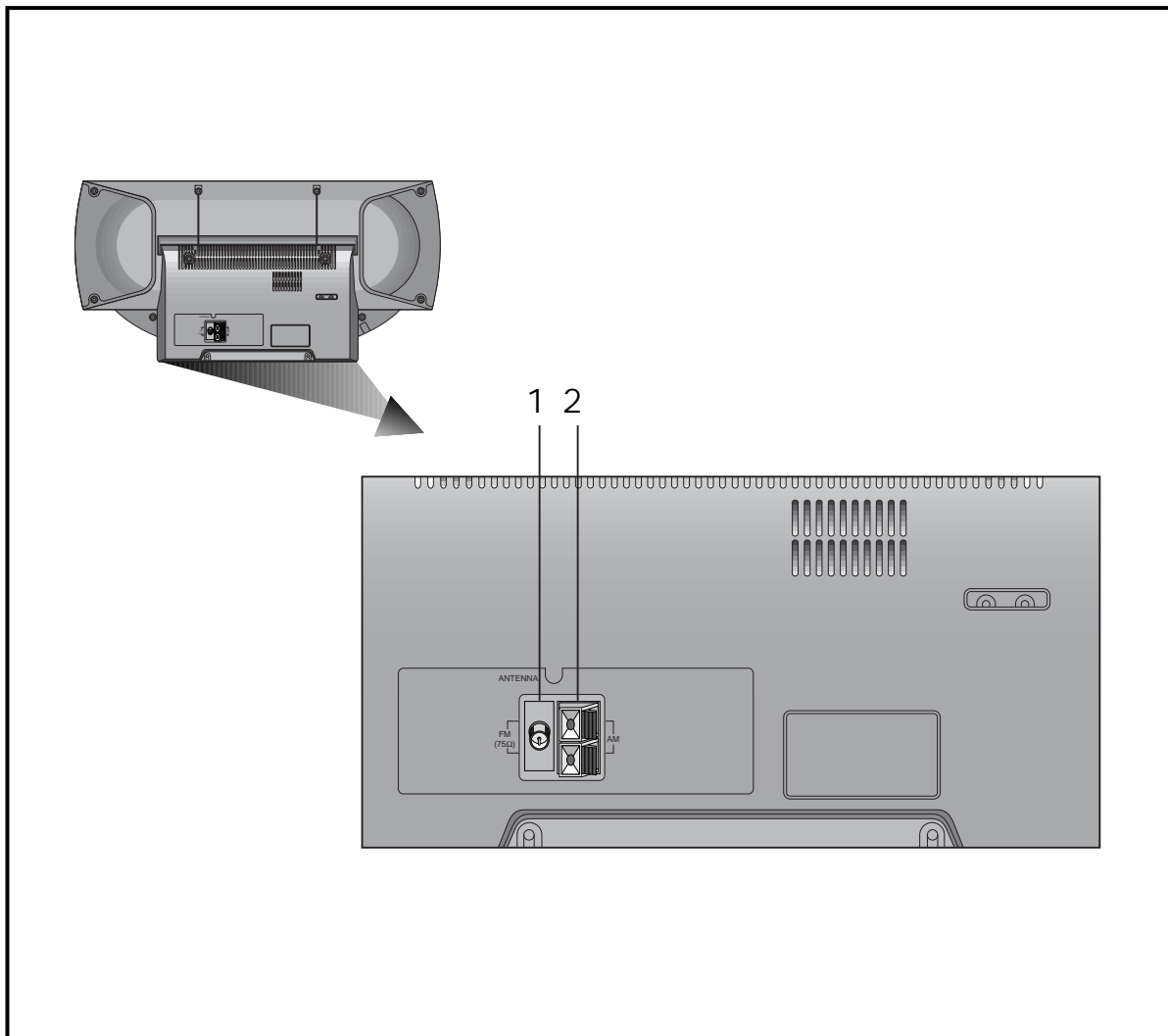

1. FM Aerial Connector Terminal

2. AM Aerial Connector Terminal

Connecting the AM Aerial

The AM aerial (for long and medium waves) can be:

- ◆ Placed on a stable surface
- ◆ Fixed to the wall (you must first remove the base)

- 1 To connect a wire, push the terminal tab downwards and hold it in position
- 2 Insert the wire, up to the plastic sheathing, in the hole.
- 3 Release the tab

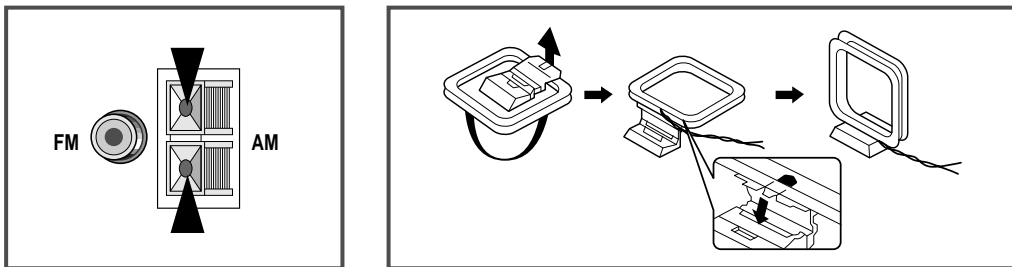

Connecting the FM Aerial

How to connect a COAXIAL TYPE aerial.

- ◆ Connect a 75Ω antenna to the **FM** antenna terminal.
- ◆ Plug the connector on the **FM** aerial supplied into the coaxial socket (75Ω) marked **FM** on the rear of the system.
- ◆ Follow the instructions given on Page 13 to tune into a radio station, and determine the best position for the aerial.
- ◆ If reception is poor, you may need to install an outdoor aerial.
To do so, connect an outdoor **FM** aerial to the **FM** socket on the rear of the system using a 75Ω coaxial cable (not supplied).

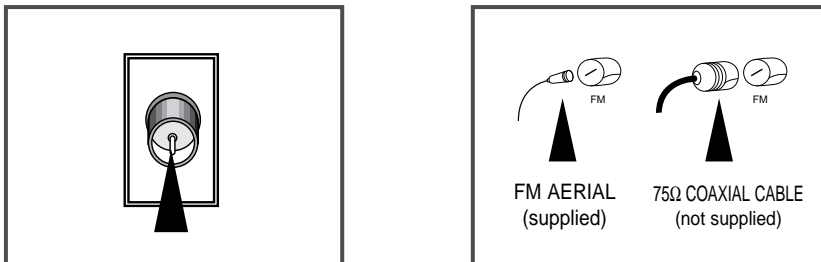

Setting the Clock

Your system is equipped with a clock which allows you to turn your system on and off automatically. You should set the clock:

- ◆ When you purchase the audio system
 - ◆ After a power failure
 - ◆ After unplugging the unit
- ☛ ◆ Remember to reset the time when the clock changes from winter to summer time and vice versa.
- ◆ For each step, you have a few seconds to set the required options. If you exceed this time, you must start again.

1 Switch the system on by pressing **On/Standby**.

2 Press **Timer/Clock** twice.
Result: **CLOCK** is displayed.

3 Press **Prog./Set**.
Result: The hour flashes.

To...	Press...
Increase the hours	▶▶
Decrease the hours	◀◀

5 When the correct hour is displayed, press **Prog./Set**.
Result: The minutes flash.

To...	Press...
Increase the minutes	▶▶
Decrease the minutes	◀◀

7 When the correct time is displayed, press **Prog./Set**.
Result: The clock starts and is displayed, even when the system is in standby mode.

➤ You can display the time, even when you are using another function, by pressing **Timer/Clock** once.

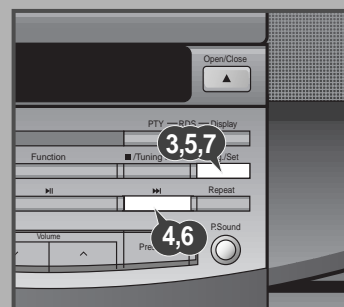
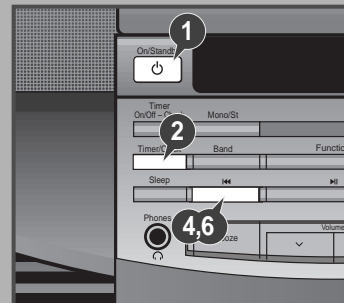

Listening to a Compact Disc

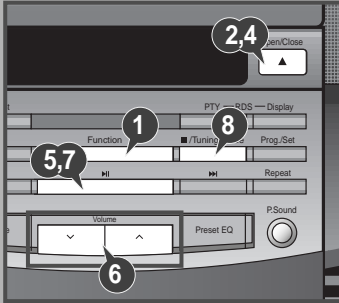

When you have loaded a compact disc into the player, you can begin playback.

➤ Always treat your compact discs with care; refer, if necessary, to the section entitled “**Precautions When Using Compact Discs**” on page 22.

- 1 Select the CD function by pressing **Function** on the front panel.
- 2 Press the **Open/Close** button.
Result: The compartment opens.
- 3 Place your disc in the compartment, with the label on the disc facing upwards.
- 4 Close the compartment by pressing the **Open/Close** button.
- 5 Press **Play/Pause** (▶||) to start playing the disc.
Result: The display indicates the selected track and elapsed playing time.
- 6 Adjust the **volume** as required by:
 - ◆ Pressing the **Volume** ^ and v buttons.
- 7 To pause during playback, press **Play/Pause** (▶||).
 - Press **Play/Pause** (▶||) again to continue playing the disc.
- 8 Press **Stop** (■) when you have finished.

➤ ◆ If you press Play/Pause (▶||) when no disc is loaded, the “**NO DISC**” indication is displayed.

Selecting a Track

You can select the track you wish to listen to, either when the compact disc player is stopped or when a disc is playing.

To start playback at the beginning of the...	Press...
Next track	▶▶ once
Current track	◀◀ once
Previous track	◀◀ twice
Track of your choice	◀◀ or ▶▶ the appropriate number of times.

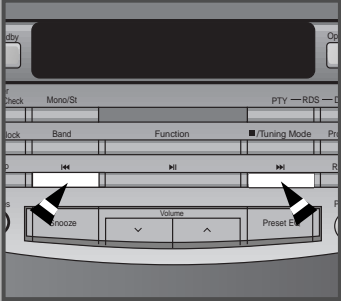

Searching for a Specific Music Passage on a CD

When listening to a compact disc, you can quickly search for a specific music passage on a track.

To search through the tracks...	Press and hold down...
Forwards	▶▶ for at least one second
Backwards	◀◀ for at least one second

➤ It is recommended that you turn the volume down before using this function.

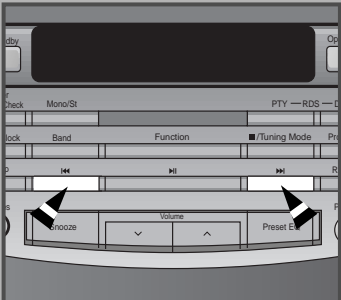

Repeat Function

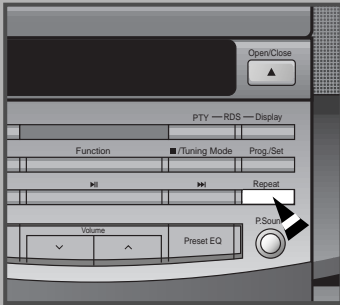

You can repeat:

- ◆ A specific track on a compact disc.
- ◆ All tracks on the compact disc.

➤ This function is not available when playing a disc in a random sequence.

1 Press the **Repeat** button.

To repeat the...	Press Repeat..
Current track indefinitely	Once (RPT 1 is displayed)
Disc	Twice (RPT ALL is displayed)

2 When you wish to stop the Repeat function, press **Repeat** a third time.
Result: **RPT OFF** is displayed.

Programming the Order of Playback

You can decide:

- ◆ The order in which you listen to the tracks on the discs loaded
 - ◆ Which tracks you do not wish to listen to
- ◆ You can programme up to 24 tracks.
- ◆ You must stop the compact disc player before selecting the tracks.
 - ◆ This feature can be combined with the Repeat function.

1 If the CD function is selected, stop the player by pressing **Stop** (■).

2 Press **Prog./Set**.

Result: The following indications are displayed:

P01 --

(P01 = Programme No., -- = Track No. on the disc)

3 Select the required track by pressing:

- ◆ ◀◀ to move back through the tracks
- ◆ ▶▶ to move forward through the tracks

4 Press **Prog./Set** to confirm your selection.

Result: The selection is stored and P02 -- is displayed.

5 To select other tracks, repeat Steps 3 to 4.

6 Press **Play/Pause** (▶||) to listen to the track selection in the order programmed.

To...	Press...
Listen to the current track again	◀◀ once
Listen to the previous track	◀◀ twice
Listen to the next track	▶▶ once
Skip forwards or backwards	▶▶ or ◀◀ the appropriate number of times

8 To cancel the selection, press **Stop** (■).

- ◆ Once if the compact disc player is stopped
- Result: **PROGRAM** is no longer displayed.

➤ If you open the compartment, the selection is cancelled.

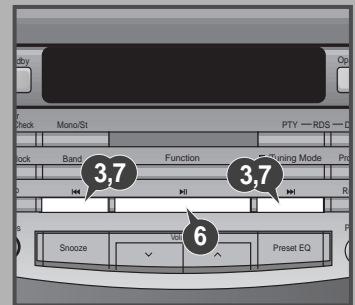
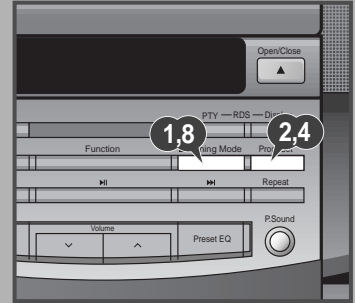

Checking or Changing Programmed Tracks

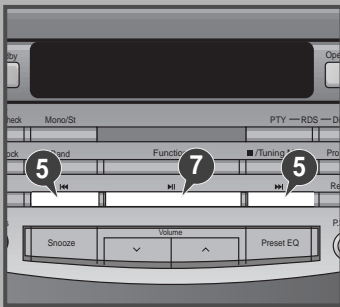
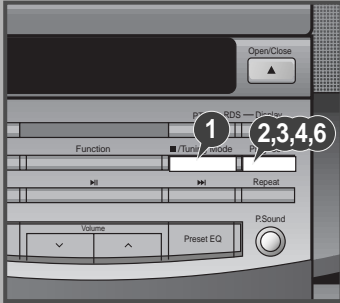

You can check or change your selection of tracks at any time.

- 1 Press **Stop** (■) once if you have started listening to the selection.
- 2 Press **Prog./Set**.
Result: The following indications appear: | --
 (C = Check, 01=Program NO., -- = Track No. on the disc)
 ➤ If you have already programmed 24 tracks, **C** is displayed instead of **P** when you press **Prog./Set**.
- 3 Press **Prog./Set** again.
Result: The first track selected is displayed, together with the letter **C** (Change).
- 4 Press **Prog./Set** one or more times until the track to be changed is displayed.
- 5 Press **◀◀** and **▶▶** to select a different track.
- 6 Press **Prog./Set** to confirm your change.
- 7 Press **CD** (▶) to start listening to the selection.
Result: The first track selected is played.

Searching for and Storing the Radio Stations

You can store up to:

- ◆ 15 FM stations
- ◆ 8 MW station
- ◆ 7 LW station

- 1 Switch the system on by pressing **On/Standby**.
- 2 Select the TUNER function by pressing **Function** on the front panel.
- 3 Select the required frequency band by pressing **Band** again on the front panel.

Result: The appropriate indication is displayed:

- | | |
|-----------------|----------------------|
| ◆ FM | Frequency Modulation |
| ◆ AM(MW) | Medium Wave |
| ◆ LW | Long Wave |

- 4 To search for a station... Press Tuning Mode on the front panel

Manually	One or more times until MANUAL is displayed.
Automatically	One or more times until AUTO is displayed.

- 5 Select the station to be stored by:
 - ◆ Pressing **◀** or **▶** on the front panel
 - ◆ To scroll through the frequencies faster when searching manually, hold down the **◀** or **▶** buttons.
 - ◆ The automatic search procedure may stop on a frequency that does not correspond to a radio station. If this happens, use the manual search mode.

- 6 Adjust the volume by:
 - ◆ Pressing the **Volume** **^** or **v** buttons.

- 7 Select the stereo or mono mode by pressing **Mono/St.**

- 8 If you do not want to store the radio station found, revert to Step 4 and search for another station.

Otherwise:

- a Press **Prog./Set**.
- b Press **◀** and **▶** to assign a programme number between 1 and 15.
- c Press **Prog./Set** to store the radio station.

- 9 To store any other radio frequencies required, repeat Steps 3 to 8.

➤ The PROGRAM function can be used to assign a new station to an existing programme number.

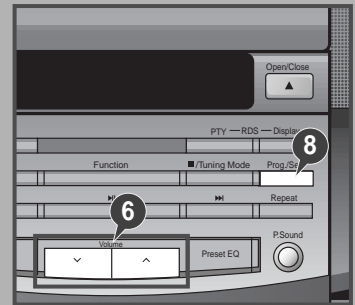
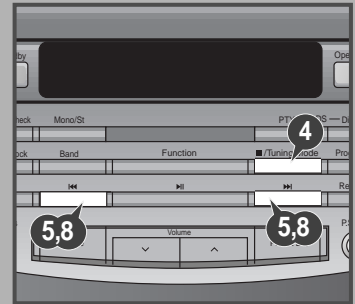
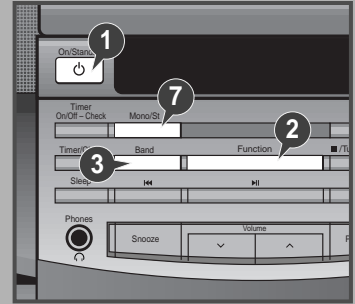

Selecting a Stored Station

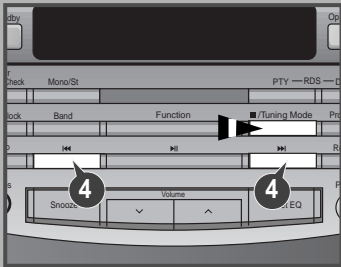
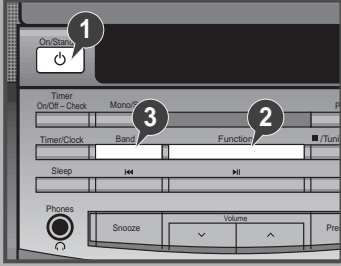

You can listen to a stored radio station as follows:

- 1 Switch the system on by pressing **On/Standby**.
- 2 Select the TUNER function by pressing **Function** on the front panel.
- 3 Select the required frequency band by pressing **Band** on the front panel.
- 4 Select the radio station as follows.

To listen to...	Press...
A stored station	a Press Tuning Mode until " PRESET " is displayed.
	b TUNING ◀◀ and ▶▶ to select the required programme.
Another station	TUNING ◀◀ and ▶▶ until the required frequency is displayed.

➤ Press **Tuning Mode** again to exit the stored station selection function.

Improving Radio Reception

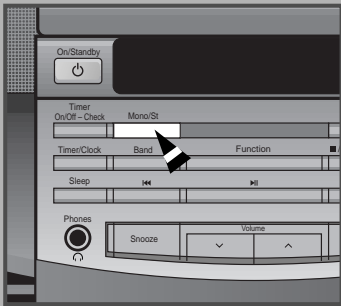

You can improve the quality of radio reception by:

- ◆ Rotating the **FM** or **AM(MW)** aerial
 - ◆ Testing the positions of the **FM** and **AM(MW)** aerials before fixing them permanently
- If reception from a specific **FM** radio station is poor, press **Mono/St** to switch from stereo mode to mono. The quality of the sound will be improved.

About RDS broadcasting

This unit has the RDS (Radio Data System) function, which enables for the various information such as broadcasting station, radio text, time and 17 types of programs (News, Rock, Classic, etc.) to be received from the FM RDS station together with normal radio signal.

- 1 Press the **On/Standby ON** button.
- 2 Receive the **FM** radio.
 - ◆ See the radio receiving method on the page 13.
 - ◆ FM and frequency are shown on the display
 - ◆ If the received station transmit the RDS information, 'RDS' appears automatically on the display.
- 3 Press the **RDS Display** button to select the desired RDS mode.
 - ◆ Whenever the button is pressed, RDS mode changes as follows.

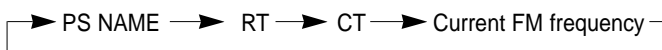

◆ The RDS function is available only on **FM** broadcasts.

➤ Description on RDS function

1. **PTY** (Program Type) : Displays the type of programme currently being broadcast
 2. **PS NAME** (Program Service Name) : Indicates the name of broadcasting station and is decodes (if any) composed of 8 characters.
 3. **RT** (Radio Text) : The text broadcast by a station and composed of maximum 64 characters.
 4. **CT** (Clock Time) : Decodes the real time clock from the FM frequency.
- Some stations may not transmit PTY, RT or CT information therefore this may not be displayed in all cases.
5. **TP** (Traffic Program) : Indicates that the turned station is capable of transmitting traffic broadcasts.
 6. **TA** (Traffic Announcement) : When this symbol flashes it shows that the traffic announcement is in progress.
 7. **EON** (Enhanced Other Networks Information) : Offers the RDS information on other networks.

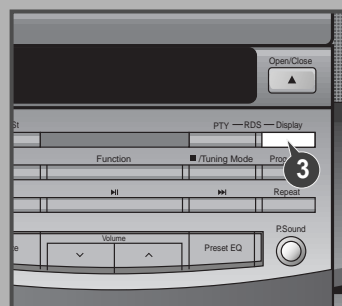
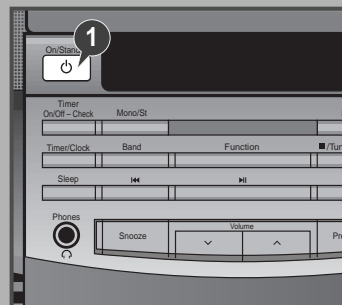

About RDS DISPLAY function

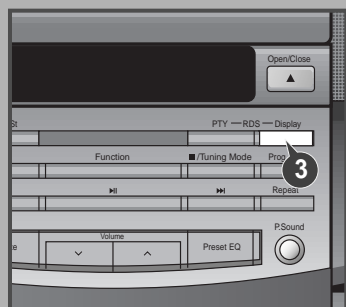

About "PS NAME" MODE

- Displays the name of broadcasting station.

Press the **RDS Display** button to select the PS NAME.

- ◆ "PS NAME" appears on the display.
- ◆ If the PS information is being received, the PS name (BBC, AFO, NDR, etc.) is shown on the display.
- ◆ If the PS information isn't received, the original FM frequency is shown.

- ☞ Even though no **RDS Display** button is pressed, the reception of PS information ensures the PS name is displayed.

About 'RT' MODE

- Displays the character transmitted from the broadcasting station.

Press the **RDS Display** button to select the RT MODE.

- ◆ "RT" appears on the display.
- ◆ If the RT information is being received, the received information is shown on the display.
- ◆ If the RT information isn't received, the "NO RT" is shown. On the display.

About CT(Clock Time)

- Sets the time of the RDS clock.

To select the CT time, set the **RDS Display** button to CT MODE.

- ☞ ◆ The CT information will take up to 2 minutes to be decoded therefore the clock isn't displayed immediately.
- ◆ If there is no available CT information, "NO CT" is displayed.
- The CT RDS clock does not update the system clock.

PTY (Program Type) indication and PTY-SEARCH function (Continue)

- ◆ The PTY information is composed of an identification symbol, which helps the FM radio to recognize the program type of each **FM** station.
- ◆ The 17 PTY modes are shown in the display by pressing the **PTY** button.

Display	Program Type
NEWS	• News including an announced opinion and report
AFFARIS	• Several matters including a current incident, documentary, discussion and analysis.
INFO	• Information including weights and measures, returns and forecast, matters interesting the customer, medical information, etc.
SPORT	• Sports
EDUCATE	• Education
DRAMA	• Drama-Radio serial, etc.
CULTURE	• Culture-National or local culture including the religious problem, social science, language, theater, etc.
SCIENCE	• Natural science and technology
VARIED	• Others-Speech, amusing program (quiz, game), interview, comedy and satirical play, etc.
POP M	• Pop music
ROCK M	• Rock music
M.O.R.M	• M.O.R- Comfortable music, occasionally vocal
LIGHT M	• Light classical music- Classical music and instrumental and chorus music
CLASSIC	• Heavy classical music-Orchestra music, symphony, chamber music and opera
OTHER M	• Other music - Jazz, R&B, country music
ALARM	• Alarm
TRAFFIC	• Traffic information

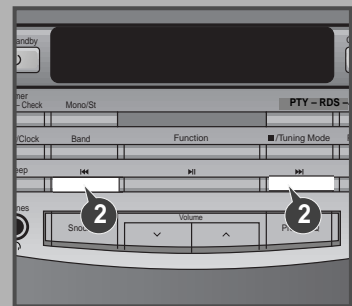
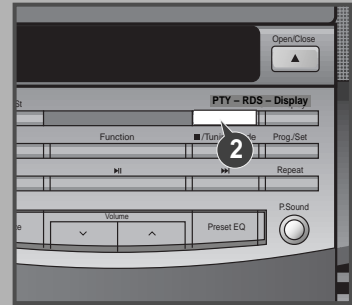

About PTY-SEARCH

- 1 Tuned to an **FM** station broadcasting a PTY MODE.
 - ◆ See the **FM** receiving method on the page 13.
 - ◆ If the received station is transmitting the RDS information, "RDS" lights up.
 - 2 Press the **PTY** button.
 - ◆ The PTY MODE(NEWS, AFFARIS, etc) appears on the display.
 - ◆ Press the **◀** or **▶** button to select the desired PTY MODE.
- ◆ If the station is transmitting no PTY information, 'NO PTY' shows on the display.
 - ◆ When the PTY MODE is selected(The PTY MODE is shown in the display), press the PTY KEY once again to convert into PTY-SEARCH MODE and auto-search the station sequentially.
 - ◆ If a station is found broadcasting required PTY MODE then the search stops and the stop is selected.
 - ◆ If the PTY MODE isn't found it is returned to the original station frequency at beginning the PTY SEARCH and auto-search and PTY SEARCH are suspended.

Timer Function

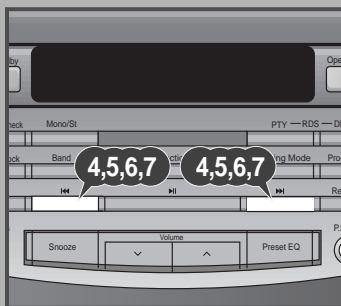
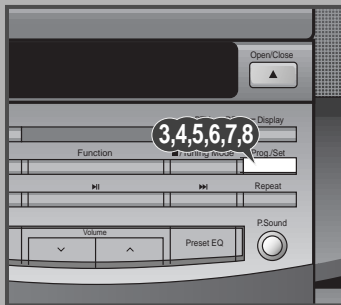
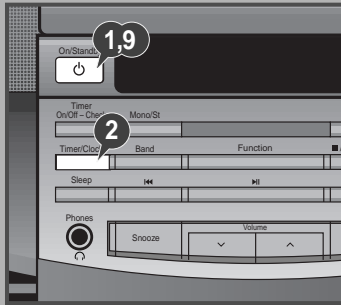

The timer enables you to switch the system on or off at specific times.
Example: You wish to wake up to music every morning.

- If you no longer want the system to be switched on or off automatically, you must cancel the timer.
- ◆ Before setting the timer, check that the current time is correct.
- ◆ For each step, you have a few seconds to set the required options. If you exceed this time, you must start again.

- 1 Switch the system on by pressing **On/Standby**.
- 2 Press **Timer/Clock** until **TIMER 1** or **TIMER 2** is displayed.
 - Two timers (**TIMER1**, **TIMER2**) can be set in this equipment.
- 3 Press **Prog./Set**.
Result: **ON TIME** is displayed (instead of the equalizer symbols) for a few seconds, followed by any switch-on time already set; you can set the timer switch-on time.
- 4 Set the timer switch-on time.
 - a Set the hour by pressing ◀◀ and ▶▶.
 - b Press **Prog./Set**.
Result: The minutes flash.
 - c Set the minutes by pressing ◀◀ and ▶▶.
 - d Press **Prog./Set**.
Result: **OFF TIME** is displayed (instead of the equalizer symbols) for a few seconds, followed by any switch-off time already set; you can now set the timer switch-off time.
- 5 Set the timer switch-off time.
 - a Set the hour by pressing ◀◀ and ▶▶.
 - b Press **Prog./Set**.
Result: The minutes flash.
 - c Set the minutes by pressing ◀◀ and ▶▶.
 - d Press **Prog./Set**.
Result: **VOL XX** is displayed, where **XX** corresponds to the volume already set.
- 6 Press ◀◀ and ▶▶ to adjust the volume level and press **Prog./Set**.
Result: The source to be selected is displayed.
- 7 Press ◀◀ and ▶▶ to select the source to be played when the system switches on.

If you select..	You must also...
TUNER (radio)	<ol style="list-style-type: none"> a Select the FM or AM frequency band by pressing ◀◀ and ▶▶. b Press Prog./Set. c Select a preset station by pressing ◀◀ and ▶▶.
CD (compact disc)	<ol style="list-style-type: none"> a Load a compact disc.

- 8 Press **Prog./Set** to confirm the timer.
- 9 Press **On/Standby** to set the system to standby mode.
Result: **TIMER** is displayed to the bottom left of the time, indicating that the timer has been set. The system will switch on and off automatically at the required times.

➤ If the timer switch on and off times are identical, the word **ERROR** is displayed.

Cancelling the Timer

After having set the timer, it will start automatically as shown by the TIMER indication on the display. If you no longer wish to use the timer, you must cancel it.

- You can stop the timer at any time (system on or in standby mode).

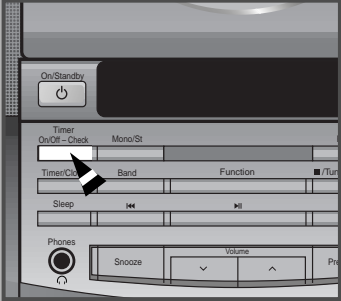

To...	Press Timer On/Off-Check...
-------	-----------------------------

Cancel the timer	⌚ XX is no longer displayed.
------------------------	-------------------------------------

Restart the timer	⌚ XX is displayed again.
-------------------------	---------------------------------

- To switch to the Timer Check mode, press and hold the Timer On/Off-Check button for a while.

Power Sound Function

This audio system is equipped with the function of Power Sound, which amplifies bass and improves high key or bass twice as much for you to appreciate powerful real surround-sound.

- 1 Press **P. Sound** button on the front panel.
Result: ♦ The **P. Sound** button on the front panel lights up green.
 ♦ **P SOUND** is displayed for a few seconds.
 ♦ A more powerful resonant sound is diffused.
- 2 To cancel this function, press **P. Sound** again.

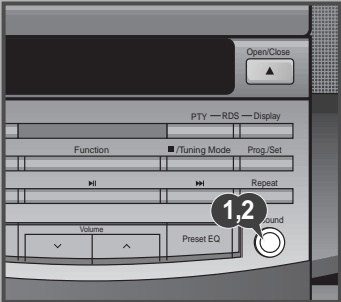

Snooze Function

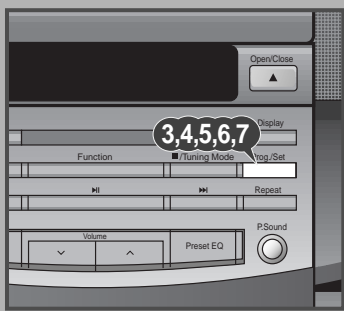
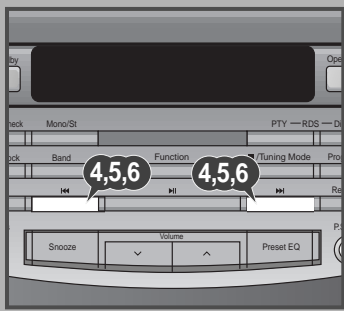
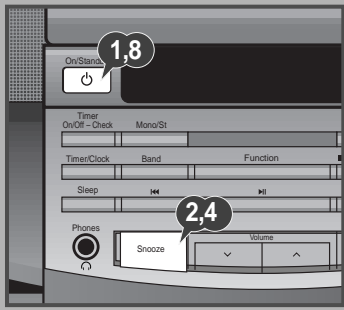

While in the Snooze mode, the volume increases 5 levels every 5 minutes.

Example: This feature can be used for a morning call.

- In 30 minutes after the Snooze mode starts, the power turns off automatically.
- ✦ Before setting the Snooze, check that the current time is correct.
- ✦ For each step, you have a few seconds to set the required options. If you exceed this time, you must start again.
- ✦ While in the Snooze mode, the other buttons will not work. The power can be turned off only using the Snooze button.

- 1 Switch the system on by pressing **On/Standby**.
 - 2 Press the **Snooze** button for 2 sec or longer.
Result: "SNOOZE" appears on the display and the button light comes on and flashes.
 - 3 Press **Prog./Set**.
Result: **ON TIME** is displayed (instead of the equalizer symbols) for a few seconds, followed by any switch-on time already set; you can set the timer switch-on time.
 - 4 Set the snooze switch-on time.
 - a Set the hour by pressing ◀◀ and ▶▶.
 - b Press **Prog./Set**.
Result: The minutes flash.
 - c Set the minutes by pressing ◀◀ and ▶▶.
 - d Press **Prog./Set**.
 - 5 Press ◀◀ and ▶▶ to adjust the volume level and press **Prog./Set**.
Result: The source to be selected is displayed.
 - 6 Press ◀◀ and ▶▶ to select the source to be played when the system switches on.
- | If you select... | You must also... |
|-------------------------|--|
| TUNER (radio) | <ol style="list-style-type: none"> a Select the FM or AM frequency band by pressing ◀◀ and ▶▶. b Press Prog./Set. c Select a preset station by pressing ◀◀ and ▶▶. |
| CD (compact disc) | <ol style="list-style-type: none"> a Load a compact disc. |
- 7 Press **Prog./Set** to confirm the Snooze.
 - 8 Press **On/Standby** to set the system to standby mode.

- ✦ The Snooze function cannot be combined with the Timer function.
- ✦ When the Snooze button is pressed for 2 sec or longer, it is ready to be set.

Setting the System to Switch Off Automatically

While listening to a compact disc or a cassette, you can set the system to switch off automatically.

Example: You wish to go to sleep to music.

- 1 Press **Sleep**.
Result: Playback starts and the following indications are displayed:

SLEEP
90 MIN

- 2 Press **Sleep** one or more times to indicate how long the system should continue playing before it switches off:

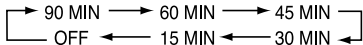

- At any time, you can:
 - ◆ Check the remaining time by pressing **Sleep**.
 - ◆ Change the remaining time by repeating steps **1** and **2**.

- 3 Press **Sleep** one or more times until **SLEEP** is displayed.
Result: The system will automatically switch off at the end of disc or cassette.
- 4 To cancel Sleep function, press **SLEEP** one or more times until **OFF** is displayed.

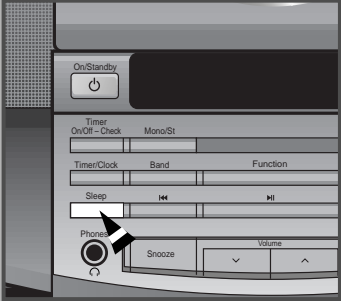

Selecting an Equalizer Preset

Your audio system is equipped with a preset equalizer that allows you to choose the most appropriate balance between treble and bass frequencies, according to the type of music you are listening to.

Press **Preset EQ** on the front panel until the required option is selected.

To obtain a...	Select...
Normal balance (linear)	PASS
Balance suitable for classic music.....	CLASSIC
Balance suitable for rock music	ROCK
Balance suitable for pop music	POP

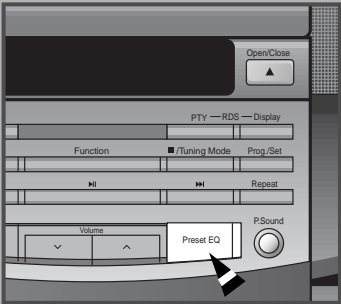

Connecting Headphones

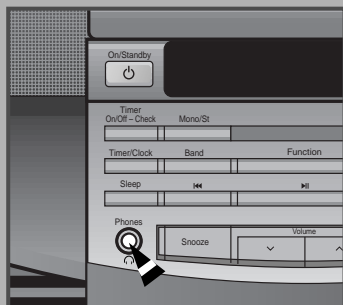

You can connect a set of headphones to your Audio system so that you can listen to music or radio programmes without disturbing other people in the room. The earphones must have a 3.5 mm jack or an appropriate adapter.

Connect the headphones to the **Phones**  jack on the front panel.

Result: The loudspeakers are no longer used to output the sound.

-  Prolonged use of headphones at a high volume may damage your hearing.

Precautions When Using Compact Discs

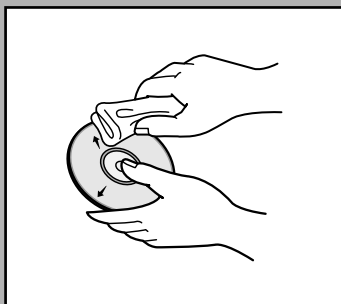

- ◆ Handle your compact discs with care. Always hold them by the edges to avoid leaving fingerprints on the shiny surface.
- ◆ When you have finished playing a compact disc, always put it back in its case.
- ◆ Do not fix paper or adhesive tape to the discs and do not write on the label.
- ◆ Clean them with a special-purpose cloth.
- ◆ Store your compact discs in a clean place, out of direct sunlight, where they will not be exposed to high temperatures.
- ◆ Always use compact discs marked  .

Safety Precautions

The following diagrams illustrate the precautions to be taken when using or moving your audio system.

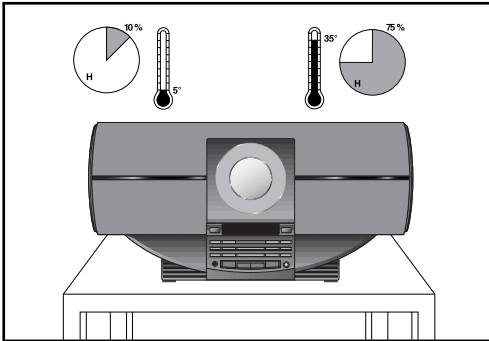

Ambient operating conditions:
Ambient temperature 5°C-35°C
Humidity 10-75%

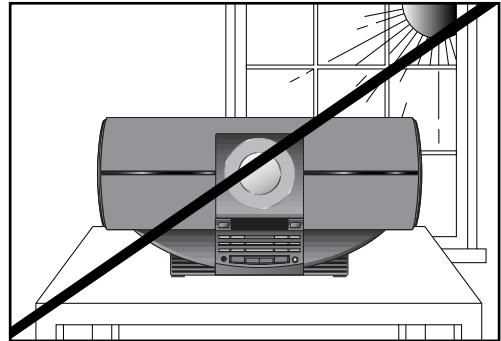

Do not expose the unit to direct sun radiation or other heat sources. This could lead to overheating and malfunction of the unit.

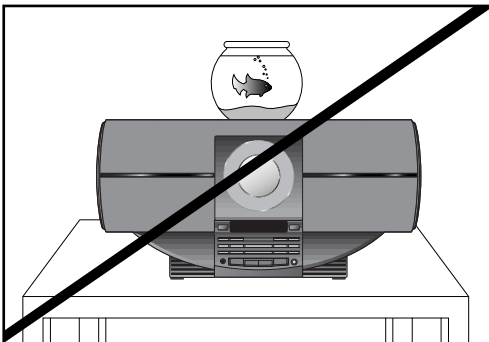

Do not place potted plants or vases on top of the unit. Moisture entering the unit could lead to dangerous electric shock and can cause equipment damage. In such events immediately disconnect the main plug from the socket.

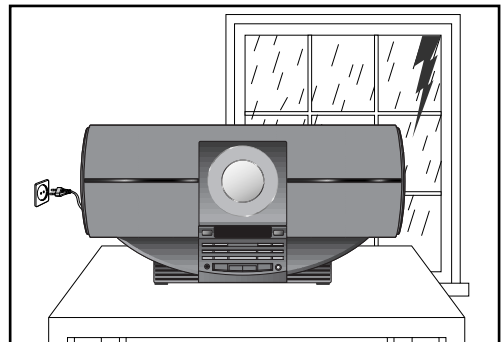

During thunderstorms, disconnect the main plug from the socket. Main voltage peaks due to lightning could damage the unit.

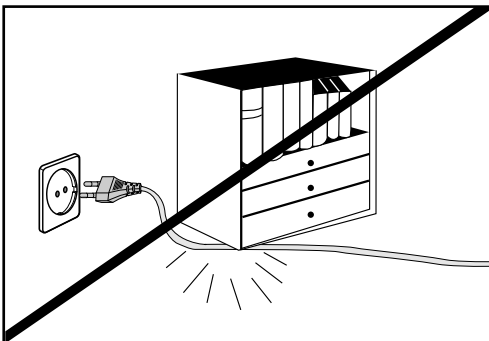

Do not place heavy items on the main lead. Main cable damage can lead to damage of the equipment (fire hazard) and can cause electric shock.

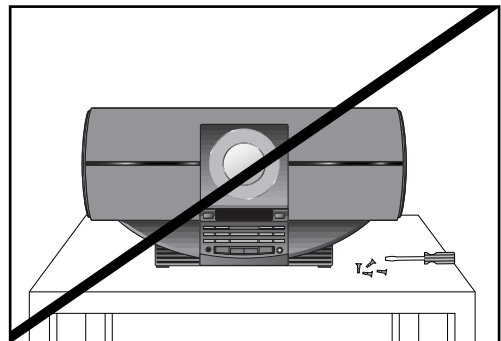

Do not remove any equipment panels. The inside of the unit contains live components, which cause electric shock.

Before Contacting the After-Sales Service

It always takes a little time to become familiar with a new appliance. If you have any of the problems listed below, try the solutions given. They may save you the time and inconvenience of an unnecessary service call.

	Problem	Checks/Explanation
G E N E R A L	The system does not work	<ul style="list-style-type: none"> • The main lead is not correctly plugged into a wall socket or the wall socket is not switched on. • The On/Standby button has not been pressed.
	There is no sound	<ul style="list-style-type: none"> • The volume has been completely turned down. • The correct function (TUNER, CD, AUX) has not been selected. • You have connected a set of earphones.
	Incase it is not worked, even the action is taken as above.	<ul style="list-style-type: none"> • Press the Preset EQ button for 5 seconds in power 'OFF'(standby), then it is returned the original position (RESET)
	The Timer does not work	<ul style="list-style-type: none"> • The timer has been stopped by pressing Timer on/off.
C D	The compact disc player does not start playing	<ul style="list-style-type: none"> • The CD function has not been selected. • The disc has been inserted face down or is either dirty or scratched. • The laser sensor is dirty or dusty. • The system has not been installed on a flat, horizontal surface. • Condensation has formed in the player; leave the system in a warm, airy room for at least one hour.
R A D I O	Reception is poor or no radio stations are received at all	<ul style="list-style-type: none"> • The TUNER function has not been selected. • The radio frequency has not been correctly selected. • The aerial has been disconnected or is not facing the right way. Turn it until you find the best orientation. • You are in a building that blocks radio waves; you must use an outside aerial.

If the above guidelines do not allow you to solve the problem, take a note of:

- ◆ The model and serial numbers, normally printed on the rear of the system
- ◆ Your warranty details
- ◆ A clear description of the problem

Then contact your local dealer or SAMSUNG after-sales service.

Technical Specifications

SAMSUNG strives to improve its products at all times. Both the design specifications and these user instructions are thus subject to change without notice.

RADIO

LW

Usable sensitivity 60 dB

MW (AM)

Signal/noise ratio 35 dB

Usable sensitivity 56 dB

Total harmonic distortion 2 %

FM

Signal/noise ratio 45 dB

Usable sensitivity 10 dB

Total harmonic distortion 0.3 %

COMPACT DISC PLAYER

Frequency range 20 Hz - 20 KHz (\pm 1 dB)

Signal/noise ratio 90 dB (at 1 KHz) with filter

Distortion 0.05 % (at 1 KHz)

Channel separation 80 dB

Disc sizes Diameter: 120 or 80 mm. Thickness: 1.2 mm

AMPLIFIER

Output power (3.2 Ω) 2 x 5 Watts RMS (total harmonic distortion: 10 %)

Channel separation 55 dB

Signal/noise ratio 70 dB

GENERAL

Dimensions 563 (W) x 277 (H) x 142 (D) mm

THIS APPLIANCE IS MANUFACTURED BY:

