

SAMSUNG

Owner's Instructions

SW10C1S(P) / SW10C1(P)



Before operating the unit, please read this manual thoroughly, and retain for future reference.

FEATURES	1
DESCRIPTION OF PARTS	2
SAFETY INSTRUCTIONS	3
INSTALLATION & MAINTENANCE	4
Environment	4
Connecting the drain hose	4
In case of pump-drained washer	4
How to connect water supply hose	4
Cleaning the filter net	5
How to add the detergent	5
How to add the fabric softener	5
Cleaning the filter	5
Only for the model with plastic basket	5
Levelling	5
Make sure to keep the following to prevent electric shocks and leakage	6
WASHING INSTRUCTIONS	6
WASHING PROCEDURE	7
Fuzzy course	7
Heavy Duty course	7
Econo Wash course	7
Wool course	7
Blanket course	8
TROUBLESHOOTING	8
MANUAL FUNCTIONS	9
SPECIFICATIONS	

FEATURES

FUZZY CONTROL

Fuzzy control operates with best washing course by sensing the washload like artificial intelligence.

TRANSPARENT WINDOW -Option

This Transparent Window is the new concept to solve the curiosity of users to see inside of washing machine while operation. While operation, the laundry progress inside of washing machine can be checked by looking through the transparent window.

BOOMERANG PULSATOR

The Boomerang Pulsator helps water and detergent to go through fabrics efficiently while providing both the powerful water action to clean larger and heavier clothes and the gentle water action to clean all delicates with less wear and tear on clothes.

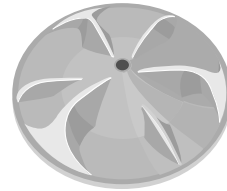

WATERFALL FLOW

The Waterfall Flow injected from under the pulsator cascades with full force back into the tub, pushing down any clothes that float right under the water surface. It is this Waterfall Flow that enables this washing machine to effectively wash large and heavy items, such as bluejeans and blankets.

MAGIC FILTER

This unique magic Filter ensures that all the lint inside the tub is captured for top quality filtering results to deliver consistently effective cleaning results.

SOFTENER DISPENSER

The Softener Dispenser releases the fabric softener at the appropriate time when the last rinsing proceeds.

DESCRIPTION OF PARTS

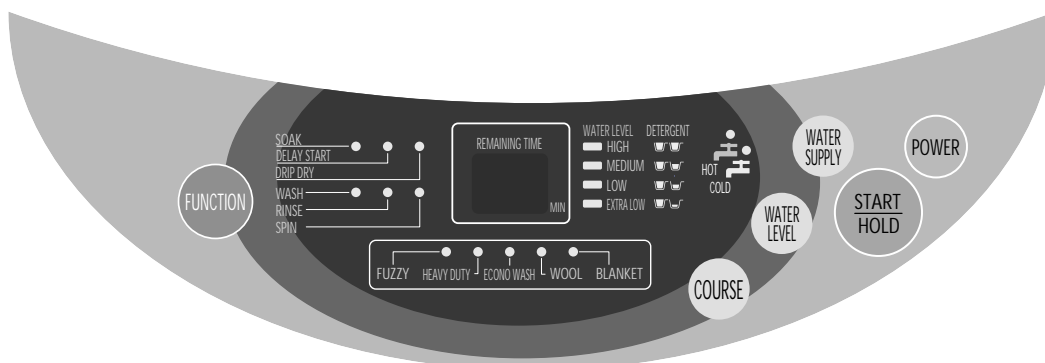
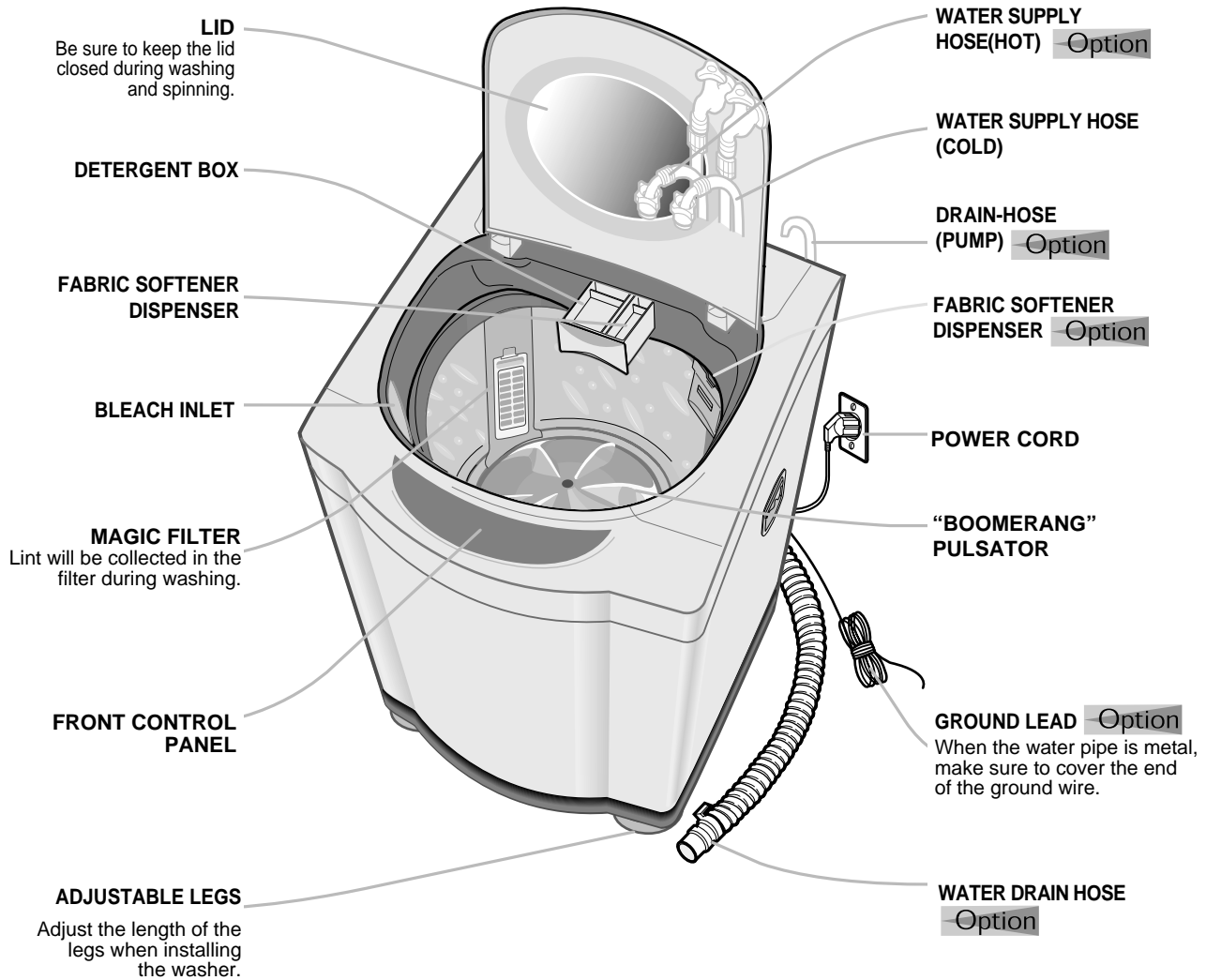

CONTROL PANEL

SAFETY INSTRUCTIONS

WARNING!

To reduce the risk of fire, electric shock, or injury to persons when using your appliance, take care to adhere to the following precautions.

- **Where an unearthed power cord is not fitted, be sure that the washer is grounded.**

To avoid electrical shock use metal piping for the ground connection.

Take care not to ground the washer to gas pipes or telephone cables due to the danger of explosion from lightning strikes.

- **During spinning, don't put your hand in the spin basket.**

Because the spin basket is rotating at the high speed, rotating parts may injure your hand.



- **Openings must not be obstructed by carpeting when the washing machine is installed on a carpeted floor.**

- **Turn off water taps when the washer is not in use to avoid water pressure damage to the pump.**

- **To minimize the possibility of electric shock, unplug this appliance from the power supply or disconnect the washer at the household distribution panel by removing the fuse or switching off the circuit breaker before attempting any maintenance or cleaning.**

- **The appliance is not intended for use by young children or infirm persons without supervision.**

- **Young children should be supervised to ensure that they do not play with the appliance.**

- **If the power supply cord is damaged, it must be replaced by the manufacturer or its service agent or a similiary qualified person in order to avoid a hazard.**

- **Place clothes evenly into the washer as unevenly distributed laundry may cause excessive out-of-balance noise and vibration.**

- **Don't use excessively hot water. (65°C or more)**

Plastic parts may be deformed or damaged. Also, clothing may be deformed or bleached.

- **Before washing, check all pockets.**

If nails or pins remain in pockets, they may damage the washer or clothes.

- **Don't press the control panel with a sharp object.**

Panel damaged or malfunction may occur.

If the control panel for this washer is damaged, it must be replaced by a repair shop appointed by the manufacturer, as special purpose tools are required.

- **Do not operate this appliance if it is damaged, malfunctioning, partially disassembled, or has missing or broken parts, including a damaged cord or plug.**

- **Do not store or use gasoline or other flammable vapors and liquids in the vicinity of this or any other appliance.**

- **The instructions for use shall specify the maximum mass or dry cloth in kg, for which the appliance is designed.**

- **If the appliance is supplied from a cord extension set or electrical portable outlet device the cord extension set or electrical portable outlet device should be positioned so it is not subject to splashing or ingress**

INSTALLATION & MAINTENANCE

ENVIRONMENT

Leave some space

Maintain at least 10cm between the washer and the wall.

Place the washer on a sturdy flat surface.

If the washer is placed on an uneven or weak surface, noise or vibration occurs. (Allowable is 1°)

Adjust the legs for even placement.

Never install the washer near water.

Do not place the washer in steamy rooms or where the washer is directly exposed to rain. Moisture may destroy the electrical insulation causing an electrical shock hazard.

Avoid direct sunlight or heaters.

As plastic and electrical components are affected by direct heat, never place the washer near furnaces, boilers, etc. Do not place under direct sunlight.

CONNECTING THE DRAIN HOSE

Option

After pressing the joint ring(a), insert the drain hose(b) to drain direction.

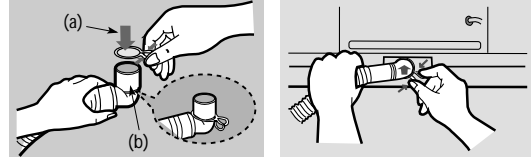

IN CASE OF PUMP-DRAINED WASHER

Option

- Take out the cap-hose and connect the outlet-hose.
- Be sure to join tightly the drain hose into the drain-outlet on the back of the machine.
- Install the drain hose in the position of about 70~80cm above the ground.

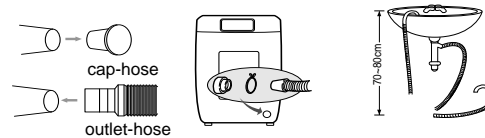

HOW TO CONNECT WATER SUPPLY HOSE

A tap of ordinary type is desirable



ORDINARY TAP



SQUARE TAP

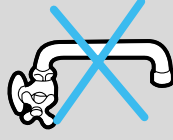

ROTATING TAP

In case of square tap

- <Take out the internal part of the connector and join it in the following way.

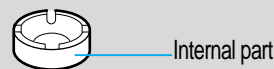

1. Remove the adaptor from the water supply hose.

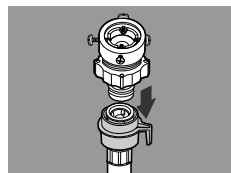

2. First, using a "+" type screw driver, loosen the four screws on the adaptor. Next, take the adaptor and turn part(b) following the arrow for gap about 5mm between them.

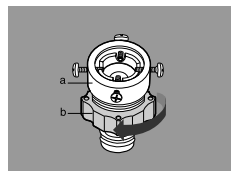

3. Connect adaptor to the water tap by tightening the screws firmly. Then, turn part (b) following the arrow and put (a) and (b) together.

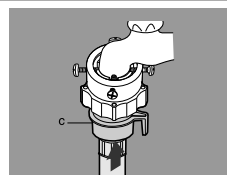
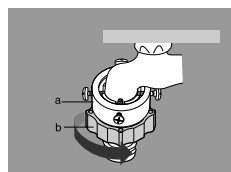

4. Connect the water supply hose to the adaptor. Pull down the part (c) of the water supply hose. When you release part (c) the hose is automatically connects to the adaptor making a 'click' sound.

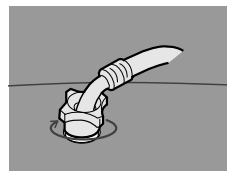

5. Connect the other end of the water supply hose to the inlet water valve at the top of the washer. Screw the hose clockwise all the way in.

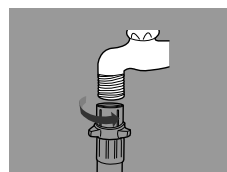

6. If the water tap is a screw type, assemble a water supply hose that fits to the tap as shown.

CLEANING THE FILTER NET

1. Push the upper part of the filter and pull in.
2. Open the cover as shown in the figure.
3. Clean the filter.
4. Close the cover and insert the lower part of the filter in the basket first and then push the filter with "click" sound.

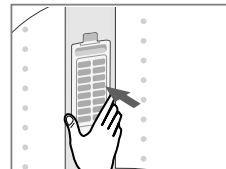
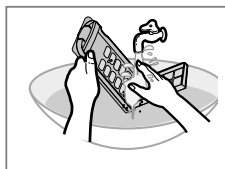
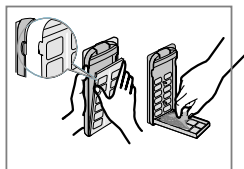
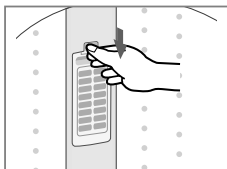

HOW TO ADD THE DETERGENT

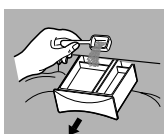

1. Open the detergent box by pulling in the direction of the arrow as shown in the figure.
2. Add the amount of detergent for one washing evenly in the box so that the detergent does not overflow the box.

HOW TO ADD THE FABRIC SOFTENER

- When a proper amount of fabric softener is stored in the box, it is automatically added in at the final rinse cycle.
- In case the hot water only is connected, this function will not be operated.

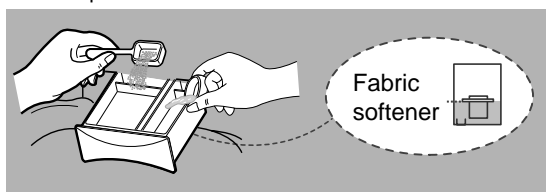

- When too much softener is stored above the base line, it may not be operated properly.

CLEANING THE FILTER Option (pump drained washer)

1. Place a rag under washer filter not to wet the floor.
2. Turn the filter-cap to the left.
3. Take the filter out and remove dirt.
4. Reassemble in reverse order.

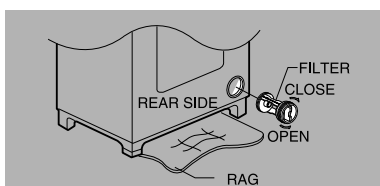

ONLY FOR THE MODEL WITH PLASTIC BASKET. Option

- When a proper amount (one time does) of fabric softener is stored in the softener inlet, it is automatically put in at the last rinsing cycle.
- Before operating the washing machine, make sure if some water is remained in softener case or not. In case of water remained, take out this case and remove water.

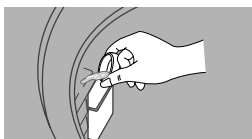

LEVELLING

- Adjust the height control legs to make even.

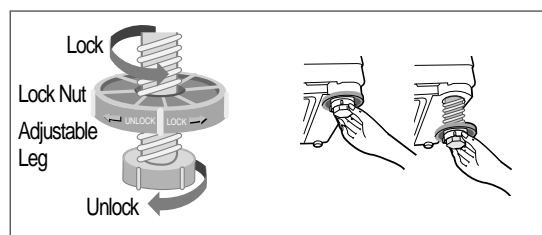

- After slightly lifting up the machine, rotate the adjustable leg counter-clockwise and pull as much as need to adjust the height.

- After putting down the machine after adjustment.

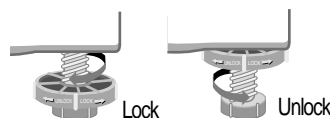

- Adjust the height and secure.
- Secure the lock nut by rotating it firmly.
- If the lock nut is not secured, the adjustable leg may be release.

SEE IF THE MACHINE IS PLACED LEVEL BY CHECKING THE POSITION OF THE WASHING TUB.

- Open the lid of the machine, pour water into the tub up to the level just below the pulsator, and adjust the legs so that the pulsator is positioned at the center of the water as shown in the figure.
- Place the machine more than 10cm away from the wall.

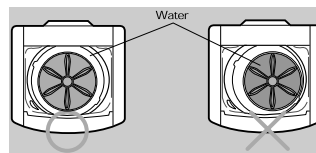

- Adjust the legs on feet for levelling. Loosen  Lock

MAKE SURE TO KEEP THE FOLLOWING TO PREVENT ELECTRIC SHOCKS AND LEAKAGE! Option

Earthing is necessary to prevent leakage or electric shocks caused by the electric currents leaked from the machine.

How to earth with an outlet with earthing terminals

Outlet with earthing terminals:

- Even when the internal wires of the earthing terminals are joined, be to connect the earthing conductor (green) of the machine to the tap.

When connecting to a metal water pipe:

- There is no earthing effect in case the water pipe is made of synthetic resin(plastic)

When using an extension cord and a boosting transformer:

- Make sure that the earthing conductor is connected.

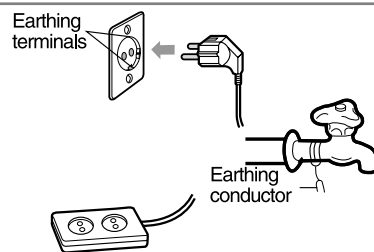

Other earthing methods

When connecting to a copper plate:

- Connect the earthing conductor to a copper plate and bury it 25cm deep in the wet ground.

When installing at a place where earthing is impossible:

- Connect a standard leakage breaker to the outlet.

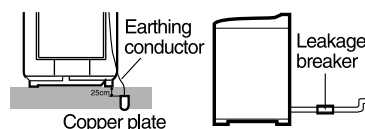

Never make an earthing to

- The telephone line, lightning rod, or gas pipe as it is extremely dangerous in case of lightning strikes.

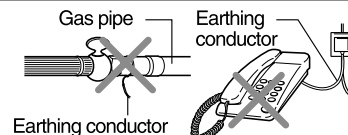

WASHING INSTRUCTION

PROCEDURE

1. Sort the laundry into separate wash loads.

Each load of washing should contain clothing which needs the same washing conditions.
For example, you should not wash delicate clothes with very dirty work clothes.

2. Load the laundry into washing.

Before load, check all pockets, and close zippers, hooks and eyes.

3. Add the detergent. (see page 5)

4. Add the fabric softener. (see page 5)

5. Press power button.

6. Choose the course button. (see page 7)

If you choose "FUZZY" program you don't need to select water level.

Water level is set automatically at "FUZZY" program. Press straight the START/HOLD button.

7. Choose the water level.

Before choose water level, remember following things. When you choose FUZZY, HEAVY-DUTY, ECONO WASH, WOOL, BLANKET program, water level is selected automatically, but if you want to choose water level manually you can select. EXTRA LOW, LOW, MEDIUM, HIGH

8. Choose the water temperature.

Before choose water temperature, remember following things.

1) You can choose HOT, HOT+COLD, COLD to all programs except for and delicate program.

HOT is hot wash and cold rinse. WARM is warm wash and cold rinse. COLD is cold wash and cold rinse.

2) When you choose or delicate program, water temperature is selected warm wash and warm rinse automatically.

9. Press the START/ HOLD button.

10. Close the lid.

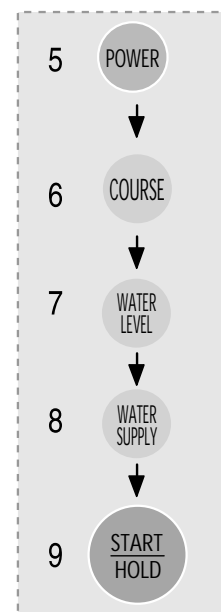

WASH PROGRAM

	FUZZY	HEAVY DUTY	ECONO WASH	WOOL	BLANKET
Wash Time	15 min	18 min	5 min	15 min	6 min
Wash Action	Normal	Normal	Gentle	Gentle	Gentle
Wash Temp	Cold - Cold + Hot - Hot				Cold
Deep Rinse	Cold	Cold	Cold	Cold	Cold
Spin Time	5 min	5 min	3 min	5 min	1 min

WASHING PROCEDURE

Before starting washing, check the following;

Connect the water supply hose to the water tap. Leave a tap open.

Plug the power cord in. Make sure to lay down the drain hose. (In case no drain pump)

Put the laundry into the washer and add detergent, too.

Be careful not to overload. Use right detergent for the fabrics you are washing.

FUZZY COURSE *Selects the best washing course automatically.*

1. Press the POWER Button to "ON".

The remaining time indicator should show "--"



2. Press the START/HOLD button.

Water level is selected automatically.

Washing, rinsing, and spinning follow.

If you want to pause, press the START/HOLD button again. You can change the course when paused.



3. Close the lid.

HEAVY DUTY COURSE

1. Press the power button to "ON".



2. Press the course select button once.



3. Press the START/HOLD button

Water level is selected automatically.

Washing, rinsing, and spinning follow.

If you want to pause, press the START/HOLD button again. You can change the course when paused.



4. Close the lid.

ECONO WASH COURSE *Because washing is ECONO WASH, it is good for light or less stained laundry.*

1. Press the power button to "ON".



2. Press the course select button twice.



3. Press the START/HOLD button

Water level is selected automatically.

Washing, rinsing, and spinning follow.

If you want to pause, press the START/HOLD button again. You can change the course when paused.

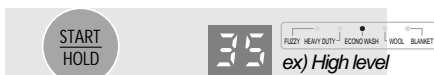

4. Close the lid.

WOOL COURSE

Extra low water level is not available. Cold water is selected.

1. Press the power button to "ON".



2. Press the course select three times.



3. Press the START/HOLD button.

Washing, rinsing, and spinning follow.

If you want to pause, press the START/HOLD button again. You can change the course when paused.

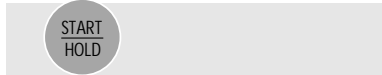

4. Close the lid.

CAUTION . . .

- Do not use water above 30° ... for WOOL washing.
- Refer to the tag attached on the clothes for washing information.
- Fasten buttons and turn inside out before washing.
- Use the detergent indicated in the laundry.
- When the degree of dirt is extreme, soak the laundry in warm water for about 10 minutes before pressing the WOOL course button in order to enhance washing efficiency.

BLANKET COURSE

1. Press the power button to "ON".



2. Press the course select four times.



3. Press the START/HOLD button.

Washing, rinsing, and spinning follow.
If you want to pause, press the START/HOLD button again. You can change the course when paused.

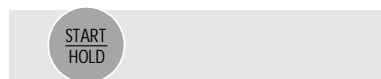

4. Close the lid.

TROUBLESHOOTING

Washing machine won't work

- Is the water tap opened?
- Is the washer plugged in?
- Is the power cut off?
- Is the fuse all right?
- Is there enough water?



Water is not supplied

- Is the water tap opened?
- Is the water cut off?
- Is the water supply hose or hose connection clogged?
- Is the water tap frozen?

If water is not supplied in 60 minutes, a buzzer will sound, and the remaining time indicator will show "7E".

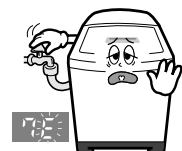

Water does not drain

- Is the drain hose down? (No pump)
- Is the drain hose frozen?
- Is the drain hose clogged?

If the water does not drain in 15 minutes, a buzzer will sound, and the remaining time indicator will show "E".

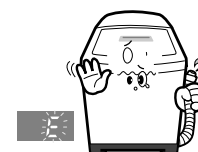

Spining does not work

- Is the laundry spread out evenly in the washer?
- Is the washer set on a sturdy flat surface?
- Is the lid closed?

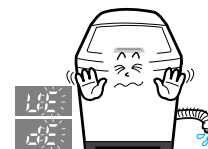





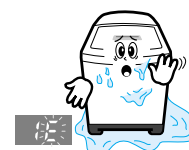



Water supply does not stop

- Close the water tap.
- Disconnect the power supply cord.
- Call to service center or agency.



MANUAL FUNCTIONS

FUNCTION	BUTTON
SOAK FUNCTION (Including WASH, RINSE, SPIN) Press the POWER button. Select the course(Press the course button). ● FUZZY, HEAVY DUTY, ECONO WASH, WOOL, BLANKET. Press the FUNCTION SELECT button once. Press the START/HOLD button once. <i>Water level is selected automatically.</i> <i>Washing, rinsing, and spinning follow.</i>	 <p>Function Button once</p>
DELAY START Press the POWER button. Select the course(Press the course button). ● FUZZY, HEAVY DUTY, ECONO WASH, WOOL, BLANKET. Press the FUNCTION SELECT button twice. Press the START/HOLD button once.	 <p>Function Button twice</p>
DRIP DRY Press the POWER button. Select the course(Press the course button). ● FUZZY, HEAVY DUTY, ECONO WASH, WOOL, BLANKET. Press the FUNCTION SELECT button three times. Press the START/HOLD button once. <i>When the FUNCTION button is pressed during washing, the wash time can be changed to between 3 and 25 minutes in duration.</i>	 <p>Function Button three times</p>
WASH ONLY Press the POWER button. Press the FUNCTION SELECT four times. Press the START/HOLD button once. Washing goes on for 18 minutes. <i>When the FUNCTION button is pressed during washing, the wash time can be changed to between 3 and 25 minutes in duration.</i>	 <p>Function Button four times</p>
RINSE ONLY Press the FUNCTION button five times. Press the START/HOLD button once. Rinsing goes on for 15 minutes. <i>When the FUNCTION button is pressed during rinsing, the rinse times can be changed to between 1 and 5 times in duration.</i>	 <p>Function Button five times</p>
SPIN ONLY Press the FUNCTION button six times. Press the START/HOLD button once. Spin drying goes on for 10 minutes. <i>When the FUNCTION button is pressed during spinning, the spin time can be changed to from 5 to 11 minutes.</i>	 <p>Function Button six times</p>
WASH AND RINSE Press the FUNCTION button seven times. Press the START/HOLD button once. Washing and rinsing goes on for 38 minutes. <i>When the FUNCTION button is pressed during working, the rinse times can be changed to between 1 and 5 times in duration.</i>	 <p>Function Button seven times</p>
RINSE AND SPIN Press the FUNCTION button eight times. Press the START/HOLD button once. Rinsing and spin drying goes on for 23 minutes. <i>When the FUNCTION button is pressed during working, the rinse times can be changed to between 1 and 5 times in duration.</i>	 <p>Function Button eight times</p>

IN CASE THE NEED FOR SERVICING ARISES.

Don't hesitate to call any agency nearby with your name, address and telephone number when anything wrong with your product occurs.

-If the power supply cord is damaged, it must be replaced by the manufacturer or its service agent or a similary qualified person in order to avoid a hazard.

SPECIFICATIONS

RATED POWER CONSUMPTION	WASH	426W	STANDARD WATER LEVEL	HIGH	75 l
	SPIN	270W		MED	55 l§
DIMENSIONS		W607xD677xH900mm		LOW	42 l§
				MIN	31 l§
WEIGHT		47kg	WATER USAGE		202 l§
WATER PRESSURE		0.05~0.78 MPa 0.5 ~ 8.0 kg-f/cm²	PULSATOR ROTATING SPEED		102rpm
WASHING TYPE		Stirring Type	SPINNING TUB ROTATING SPEED		690rpm

CODE NO. : DC68-00078A