

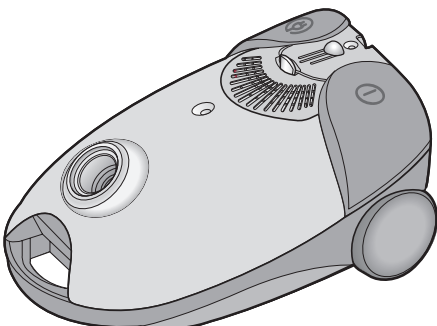

Operating Instructions

VACUUM CLEANER



* Before operating this unit, please read the instructions carefully.

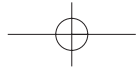

IMPORTANT SAFEGUARDS

- ▶ This appliance must be connected to the same main voltage as shown on the rating plate.
- ▶ This vacuum cleaner is not suitable for removing any kind of liquid.
- ▶ Carpets treated with a liquid cleaner must be allowed to dry before being cleaned with the unit.
- ▶ Never operate the vacuum cleaner without a dust bag.
- ▶ The cover cannot be closed if a dust bag is inserted. Please do not close forcibly.
- ▶ Keep children away from this vacuum cleaner. It must not be used on people or animals.
- ▶ Never use your appliance to vacuum matches, glowing embers, or cigarette-ends. Avoid vacuuming hard, pointed objects, since they may damage the appliance or dust bag.
- ▶ If your vacuum cleaner has a fault, please contact your electrical retailer or an authorized service agent.
- ▶ If the main cable is defective, the complete cable winder must be replaced by a service agent.

PROTECTING THE ENVIRONMENT

- ▶ Once you have unpacked the unit, do not simply throw the packing into the household waste.
- ▶ Take them to the appropriate collecting points for recycling.

IDENTIFICATIONS OF PARTS

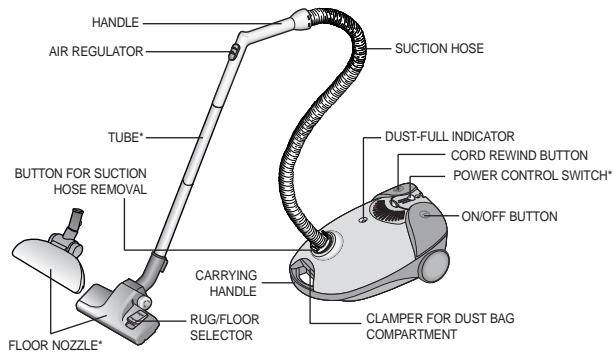

► Features marked with * may vary according to model.

ASSEMBLING THE VACUUM - CLEANER READY FOR USE

1) Connect the suction hose to the suction tube.

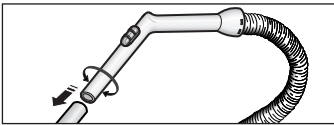

2) Connect the suction tubes together (depending on model).

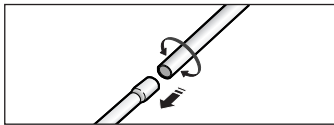

3) Connect the nozzle to the suction tube.

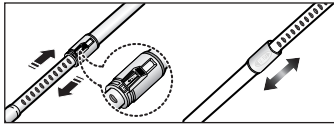
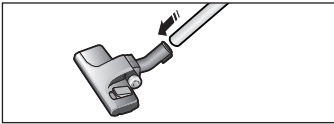

4) Connect the body connector to the body of the cleaner.

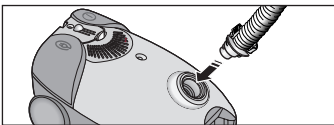

OPTION : Adjusting the telescopic tube (depending on model).

POWER CORD

1) PULLING OUT

The power cord is long enough to be drawn out for convenience.

2) REWINDING

When you have finished cleaning, disconnect the plug from the electrical outlet and simply press the cord rewind button lightly with your toe.

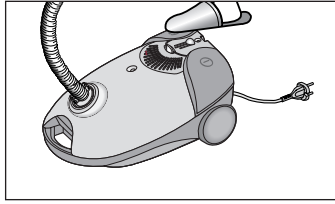

NOTE : When removing the power cord from the electrical outlet, grasp the plug, not the cord.

ON / OFF SWITCH

With the cord plugged into an electrical outlet, start or stop the vacuum cleaner by pushing lightly downward on the switch with your toe.

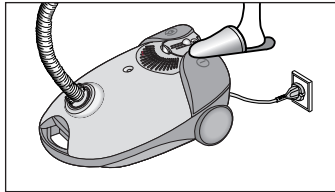

POWER CONTROL(VARIABLE CONTROL TYPE ONLY)

The vacuuming power can be adjusted to suit any situation with the electrical power control.

MIN = For delicate fabrics, e.g.net curtains.

MAX = For hard floors and heavily soiled carpets.

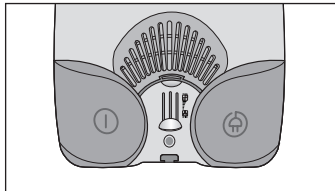

DUST-FULL INDICATOR

If the "Dust-Full" indicator changes to "RED" while you are cleaning, the dust bag requires replacement.

NOTE : If the "Dust-Full" indicator continues to display "RED" even after changing the dust bag, turn the cleaner off and check whether the hose, tube or nozzle is clogged.

USING THE ACCESSORIES

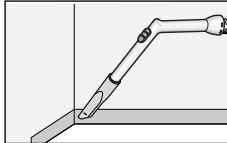
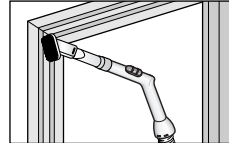
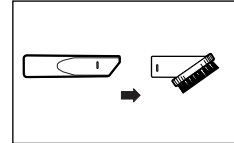
CREVICE	DUSTING	
		
<ul style="list-style-type: none">• Crevice tool for radiators, crevice, corners, between cushions.	<ul style="list-style-type: none">• Dusting brush for furniture, shelves, books, etc.	<ul style="list-style-type: none">• Before use, assemble the dusting brush to the crevice tool.

TOOL STORAGE

Your cleaner features a tool storage device. Assemble the accessory hanger on to the extension tube. It can be used to store the cleaning tools while they are not in use. This tool can be separated into two parts.

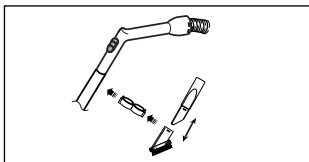

USING THE BLOWER

Located on the left rear side of the cleaner.
1) Disconnect the hose from the body of the cleaner.
2) Connect the hose clamber to the blow hole.

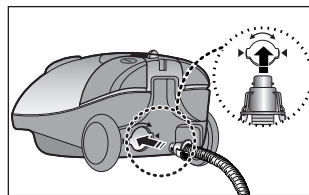

PARK POSITION

Located in the top rear side of the vacuum-cleaner, there is a nozzle support that can be used to park the nozzle during pauses in cleaning.

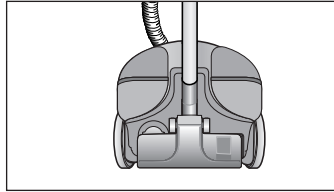

TRANSPORTING AND STORING THE VACUUM CLEANER

For easy storage and transportation, this vacuum cleaner has a clip system built onto the body, which will keep the tube, hose and nozzle in a vertical position.

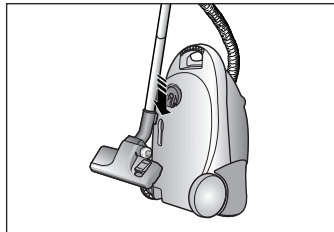

REPLACING THE DUST BAG

1) To open the dust cover of the dust bag compartment, press the clamber upward.
(The clamber is located at the front of the dust cover)

2) Remove the carrying bag from the cleaner.

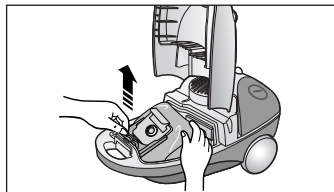
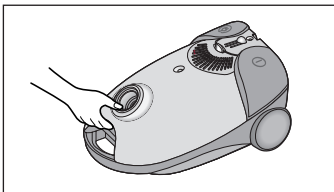

3) After removing the used dust bag, insert the cardboard bag collar of the new dust bag into the carrying bag.

4) Press the dust cover down gently until the clamper rellocks.

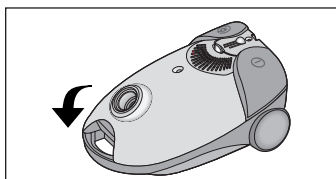
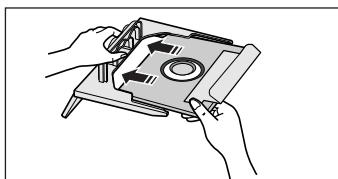

NOTE : Used dust bag can be sealed by removing the film from the paper and sticking the latter over the suction opening. (ONLY PAPER BAG)

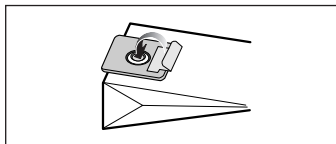

FOR CLOTH FILTER BAG

After using, if the cloth filter bag is full of dust, clean the cloth filter bag and use it again.

MAINTENANCE OR REPLACEMENT OF THE FILTERS

1) INLET-FILTER.

- Open the dust cover.
- After detaching the filter, wash it lightly with water, dry it in the shade, and then insert it in its original position.
- Close the dust cover.

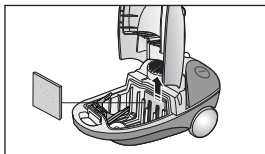

2) OUTLET-FILTER.

- To open the filter cover, press front and pull it simultaneously.
- Remove and replace the dirty microfilter.
- Close the cover.

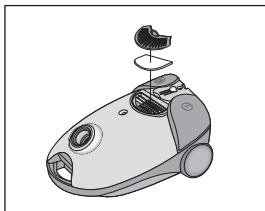

USAGE OF FLOOR NOZZLE

FOR RUG / FLOOR SELECTOR

Before use make sure that the position of the selector is in the right position for the type of surface to be cleaned.

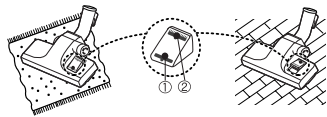

Select the carpet indicator ① when cleaning carpets..

Select flat surface indicator ② when cleaning the floors, tiles, etc.

FOR UNIVERSAL BRUSH

Use the floor nozzle for all cleaning surfaces.

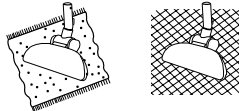

NOTE : For optimum efficiency, clean floor brush with crevice tool.

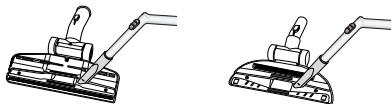

TROUBLE SHOOTING

PROBLEM	CAUSE	REMEDY
Motor does not start.	No power supply.	Check cable, plug and socket.
Suction force is gradually decreasing.	Filter, nozzle, suction hose or tube is blocked.	Remove the object.
Cord does not rewind fully.	Check that the cord is not twisted or wound unevenly.	Pull the cord out 2~3m & push down the cord rewind button.