

SAMSUNG

MICRO COMPONENT SYSTEM

MM-X7

THIS APPLIANCE IS MANUFACTURED BY:

SAMSUNG

ELECTRONICS

Instruction Manual

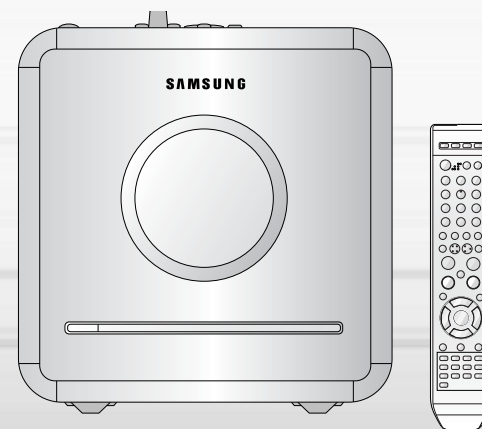

Safety Warnings

CLASS 1 LASER PRODUCT
KLASSE 1 LASER PRODUKT
LUOKAN 1 LASER LAITE
KLASS 1 LASER APPARAT
PRODUCTO LASER CLASE 1



CAUTION:
 TO REDUCE THE RISK OF ELECTRIC SHOCK, DO NOT REMOVE REAR COVER. NO USER SERVICEABLE PARTS INSIDE. REFER SERVICING TO QUALIFIED SERVICE PERSONNEL.

CLASS 1 LASER PRODUCT

This Compact Disc player is classified as a CLASS 1 LASER product.

(Saudi Arabian Standards Organization)

THIS APPLIANCE IS FITTED WITH 220V SASO APPROVED PLUG.THE CUSTOMER IS ENTITLED TO A FREE SASO APPROVED 127V PLUG FROM THE LOCAL DEALER.

Use of controls, adjustments or performance of procedures other than those specified herein may result in hazardous radiation exposure.

CAUTION-INVISIBLE LASER RADIATION WHEN OPEN AND INTERLOCKS DEFEATED, AVOID EXPOSURE TO BEAM.



This symbol indicates that dangerous voltage which can cause electric shock is present inside this unit.



This symbol alerts you to important operating and maintenance instructions accompanying the unit.

WARNING: To reduce the risk of fire or electric shock, do not expose this appliance to rain or moisture.

CAUTION: TO PREVENT ELECTRIC SHOCK, MATCH WIDE BLADE OF PLUG TO WIDE SLOT, FULLY INSERT.

Precautions

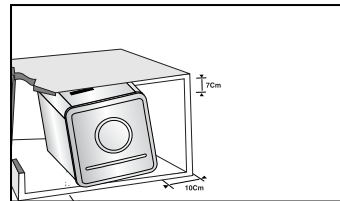

Ensure that the AC power supply in your house complies with the identification sticker located on the back of your player. Install your player horizontally, on a suitable base (furniture), with enough space around it for ventilation (3-4inches). Make sure the ventilation slots are not covered. Do not stack anything on top of the player. Do not place the player on amplifiers or other equipment which may become hot. Before moving the player, ensure the disc tray is empty. This player is designed for continuous use. Switching off the CD player to the stand-by mode does not disconnect the electrical supply. In order to disconnect the player completely from the power supply, remove the main plug from the wall outlet, especially when left unused for a long period of time.

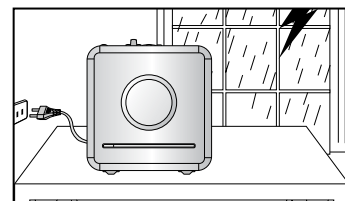

During thunderstorms, disconnect AC main plug from the wall outlet.
 Voltage peaks due to lightning could damage the unit.

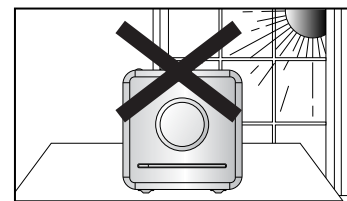

Do not expose the unit to direct sunlight or other heat sources.
 This could lead to overheating and malfunction of the unit.

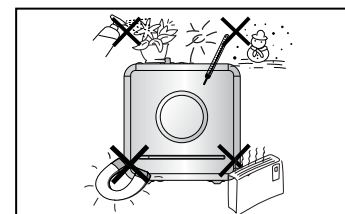

Protect the player from moisture(i.e. vases) , and excess heat(e.g.fireplace) or equipment creating strong magnetic or electric fields (i.e.speakers...). Disconnect the power cable from the AC supply if the player malfunctions. Your player is not intended for industrial use. Use of this product is for personal use only. Condensation may occur if your player or disc have been stored in cold temperatures. If transporting the player during the winter, wait approximately 2 hours until the unit has reached room temperature before using.

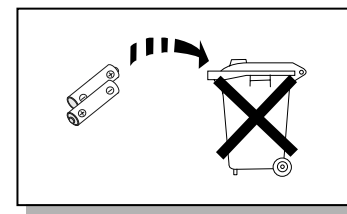

The battery used with this product contain chemicals that are harmful to the environment.
 Do not dispose of batteries in the general household trash.



Features

● Multi-Disc Playback & AM/FM Tuner, TAPE

The MM-X7 combines the convenience of multi-disc playback capability, including CD, DivX, WMA, MP3-CD, CD-R and CD-RW, with a sophisticated AM/FM tuner, TAPE, all in a single player.

● TV Screen Saver Function

If the main unit remains in stop mode for 3 minutes, Samsung logo appears on TV Screen.

● Power Saving Function

The MM-X7 automatically shuts itself off after 20 minutes in the stop .



Contents

- **PREPARATION**
 - Safety Warnings.....1
 - Precautions.....2
 - Features.....3
 - Description.....5
- **CONNECTIONS**
 - Connecting the Speakers.....9
 - Connecting to a TV.....10
 - Connecting to External Components.....10
 - Connecting the FM and AM(MW) Antennas.....11
 - Setting the Clock.....12
- **OPERATION**
 - Disc Playback.....13
 - Mp3/WMA-CD Playback.....14
 - DivX Playback.....15
 - Displaying Disc Information.....17
 - Fast/Slow Playback.....18
 - Skipping Scenes/Songs.....19
 - Repeat Playback.....20
 - Moving Directly to a Scene/Song.....22
 - JPEG File Playback.....23
- **USB**
 - Playing USB.....24
 - Selecting a Track from USB Device.....25
 - To use high speed search.....26
- **RADIO OPERATION**
 - Listening to Radio.....27
 - Presetting Stations.....28
- **TAPE DECK**
 - Listening to a Cassette.....29
 - Selecting the cassette Playback Mode/Repeat A→B Function.....30
 - Tape Counter Function.....30
- **MISCELLANEOUS**
 - Timer Function.....31
 - Cancelling the Timer.....32
 - Recording a Compact Disc.....33
 - Recording a Radio Program.....35
 - EQ/Sound Mode/Treble/Bass Function.....36
 - Sleep Timer Function / Mute Function.....37
 - DEMO / COLOR Function.....38
 - Connecting Headphones/Microphone(option).....39
 - Key Control Function.....39
 - Cautions on Handling and Storing Discs.....40
 - Notes on Discs.....41
 - Before Calling for Service.....42
 - Specifications.....43
 - USB Feature Supported Player.....44

Description

—Top Panel—

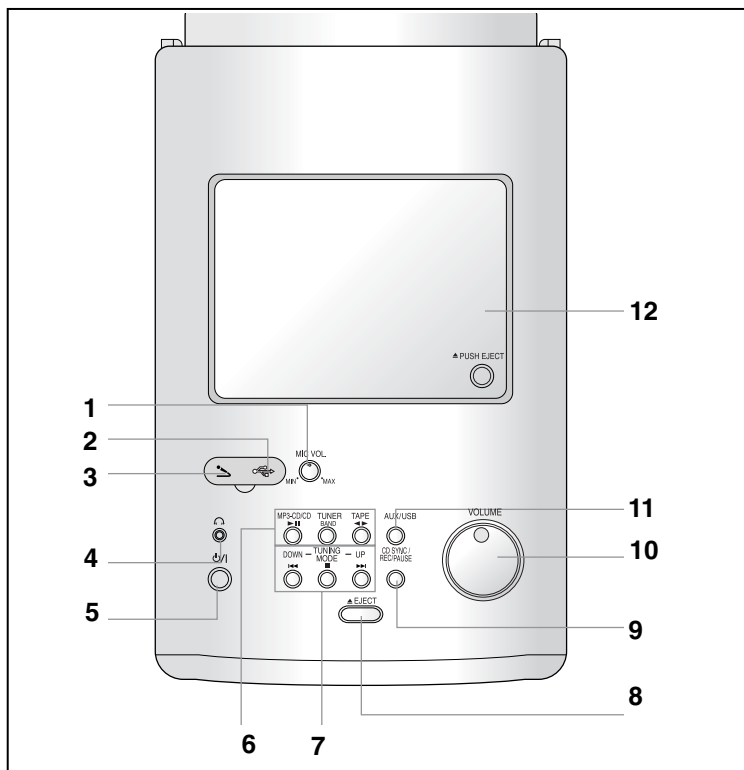

- | | |
|--|---------------------------|
| 1. MIC VOL | 8. EJECT |
| 2. USB JACK | 9. CD SYNCHRO / REC/PAUSE |
| 3. MIC JACK | 10. VOLUME CONTROL |
| 4. HEADPHONE JACK CONNECTOR | 11. AUX/USB |
| 5. STANDBY/ON | 12. CASSETTE DECK |
| 6. FUNCTIONS (MP3-CD/CD/TUNER/TAPE) | |
| 7. SEARCH FUNCTION BUTTONS
TUNING MODE OR STOP BUTTON | |

—Rear Panel—

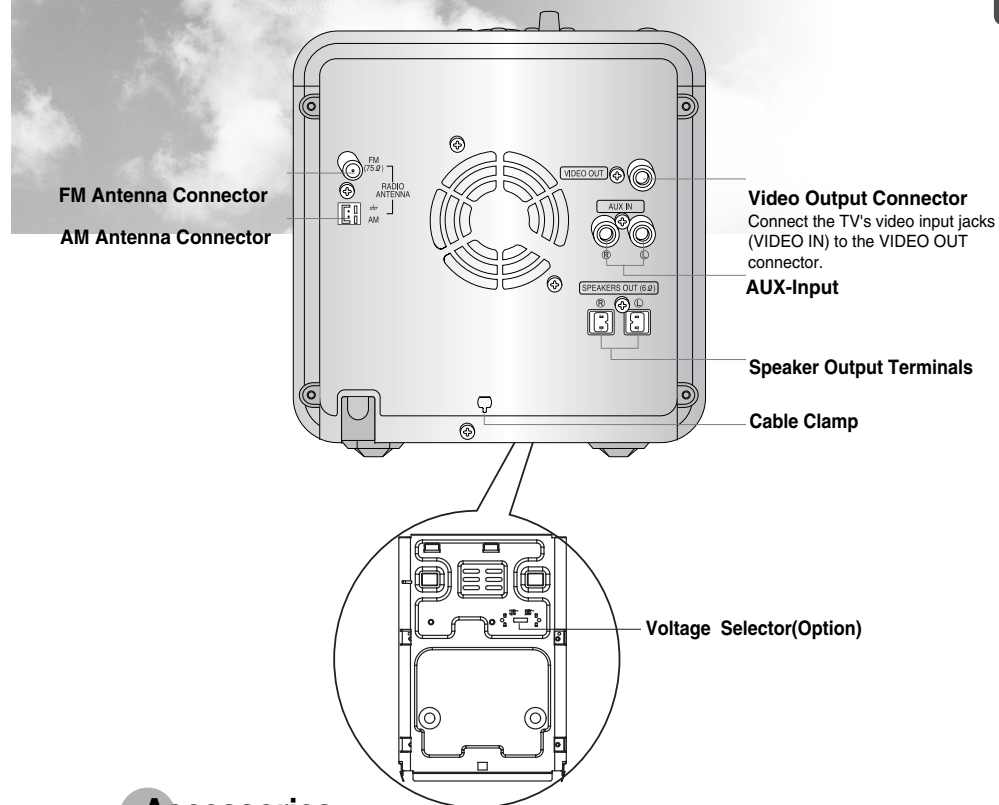

Accessories

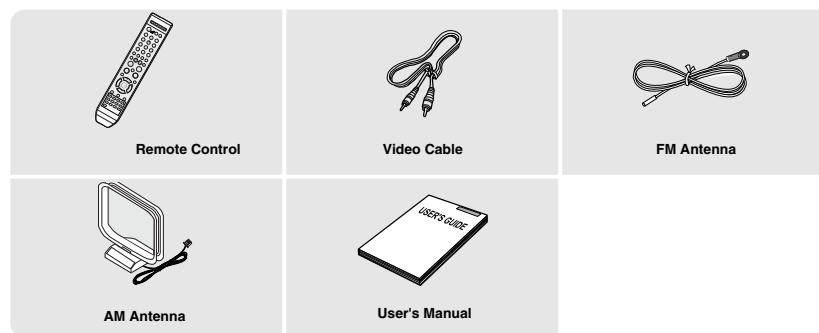

Description

—Remote Control—

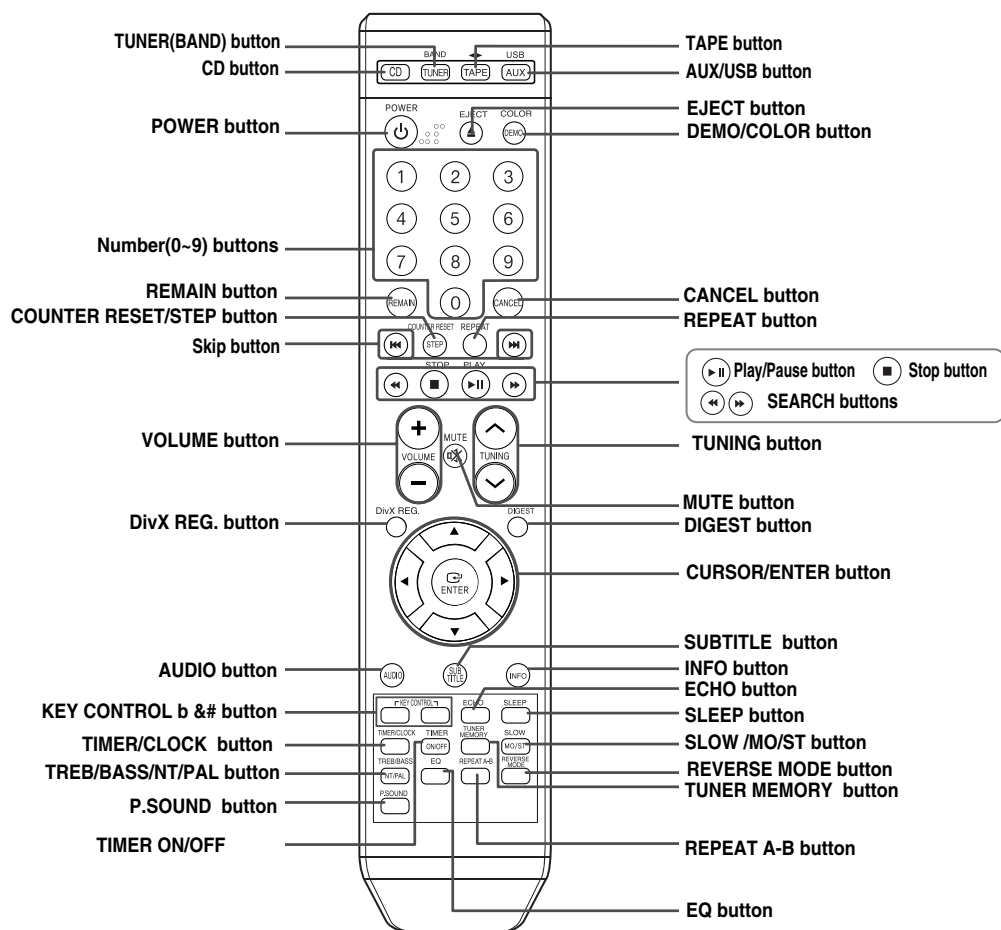

Insert Remote Batteries

- 1 Remove the battery cover on the back of the remote by pressing down and sliding the cover in the direction of the arrow.
- 2 Insert two 1.5V AAA batteries, paying attention to the correct polarities (+ and -).
- 3 Replace the battery cover.

Caution

Follow these precautions to avoid leaking or cracking cells:

- Place batteries in the remote control so they match the polarity:(+) to (+)and (-)to (-).
- Use the correct type of batteries.Batteries that look similar may differ in voltage.
- Always replace both batteries at the same time.
- Do not expose batteries to heat or flame.

Range of Operation of the Remote Control

The remote control can be used up to approximately 23 feet/7 meters in a straight line. It can also be operated at a horizontal angle of up to 30° from the remote control sensor.

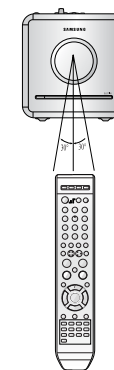



Connecting the Speakers

Before moving or installing the product, be sure to turn off the power and disconnect the power cord.

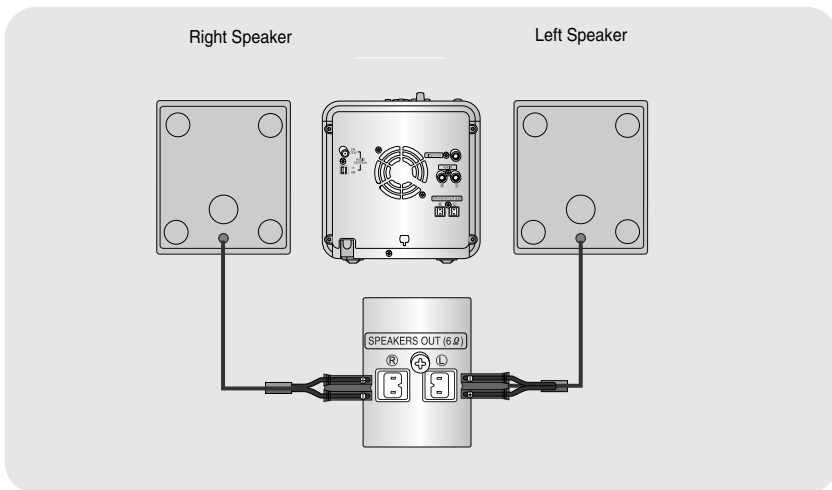

Loudspeakers L R

- Place these speakers in front of your listening position, facing inwards (about 45°) toward you.
- Place the speakers so that their tweeters will be at the same height as your ear.

Selecting the Listening Position

The listening position should be located about 2.5 to 3 times the distance of the TV's screen size away from the TV. Example: For 32" TVs 2~2.4m (6~8feet)
For 55" TVs 3.5~4m (11~13feet)

Directions in Installing Speaker

- Installation in a place near heating apparatus, under direct lay of light or with high humidity may cause performance degradation of the speaker.
- Do not install on the wall or on a high place of pole or other unstable place to prevent any safety accident caused by falling of the speaker.
- Do not take the speaker apart from TV or computer monitor.
The speaker near the TV or computer monitor may influence the quality of the screen display.



Connecting to a TV

Please be sure to turn off the power and unplug the power cord before moving or installing this unit.

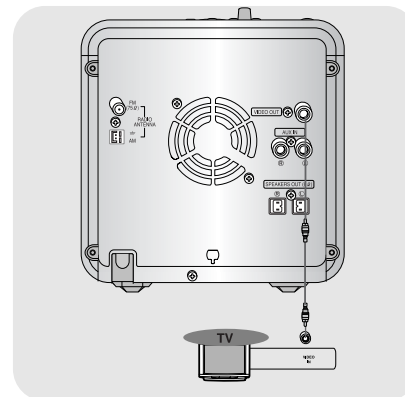

Composite Video Good Quality

Connect the supplied video cable from the VIDEO OUT jack on the back panel of the system to the VIDEO IN jack on your television.

CONNECTIONS



Connecting to External Components

Connecting to an External Analog Component

Example: Analog signal components such as a VCR, Camcorder, and TV.

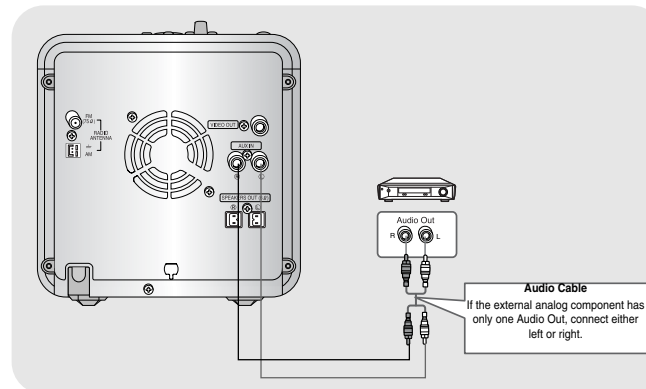

- 1 Connect Audio In on the CD player to Audio Out on the external analog component.
• Be sure to match connector colors.
- 2 Press **AUX** to select AUX.
• 'AUX' appears in the display.

Connecting the FM and AM(MW) Antennas

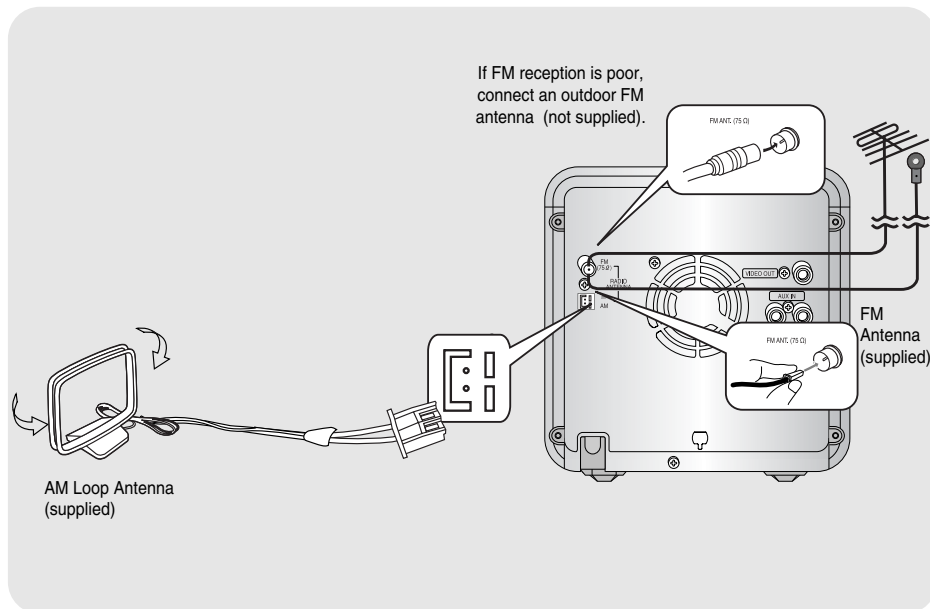

FM antenna connection

1. Connect the FM antenna supplied to the FM 75Ω COAXIAL terminal as a temporary measure.
2. Slowly move the antenna wire around until you find a location where reception is good, then fasten it to a wall or other rigid surface.

- If reception is poor, connect an outdoor antenna. Before attaching a 75Ω coaxial cable (with a standard type connector), disconnect the supplied FM antenna.

AM(MW) antenna connection

1. Connect the AM loop antenna supplied to the AM and MW terminals.
2. If reception is poor, connect an outdoor single vinyl-covered wire to the AM terminal. (Keep the AM loop antenna connected).

Setting the Clock

For each step, you have a few seconds to set the required options. If you exceed this time, you must start again.

- 1 Switch the system on by pressing **POWER** button.

- 2 Press **TIMER/CLOCK** twice.

- **CLOCK** is displayed.

- 3 Press **ENTER**. The hour flashes.

- Increase the hours :
- Decrease the hours :

Note

- You can display the time, even when you are using another function, by pressing **TIMER/CLOCK** once.

- 4 When the correct hour is displayed, press **ENTER**. The minutes flash.

- Increase the minutes :
- Decrease the minutes :

- 5 When the correct time is displayed, press **ENTER**.

- "TIMER" appears in the display.
- The current time is now set.

Selecting the Video Format

Turn off the main unit and then press and hold **NT/PAL** button on the remote controller for over 5 seconds .

- By default, the video format is set to "PAL".
- "NTSC" and "PAL" will appear in the display. At this time, press the NT/PAL button shortly to select between "NTSC" and "PAL".
- Each country has a different video format standard.
- For normal playback, the video format of the disc must be the same as the video format of your TV.

Checking the Remaining Time

Press the **REMAIN** button.

- For checking the total and remaining time of a title or chapter being played.

Each time the **REMAIN** button is pressed

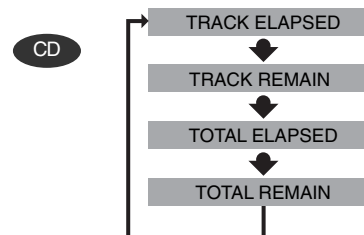



Disc Playback



- 1 Load a disc.
 - Insert a disc that the disc's label facing up.

- 2 To eject the disc, press **EJECT** button

CD

- Playback starts automatically.

MP3 DivX JPEG

- Playback starts automatically.
- If the TV is on, a list of MP3s on the CD will appear on the TV screen.



Note

- Depending on the content of the disc, the initial screen may appear different.
- Depending on the recording mode, some MP3-CDs cannot be played.
- Table of contents of a MP3-CD varies depending on the MP3 track format recorded on the disc.

To stop playback, press **STOP** during playback.

- If pressed once, "STOP" is displayed, and if **PLAY/PAUSE** (▶||) button is pressed, playback starts from the beginning.

To temporarily pause playback, press **PLAY/PAUSE** during playback.

- To resume playback, press **PLAY/PAUSE** button again.



MP3/WMA-CD Playback

Data CDs (CD-R, CD-RW) encoded in MP3/WMA format can be played.

- 1 Load the MP3/WMA disc.

- The MP3/WMA menu screen will appear and playback will start.
- The appearance of the menu depends on the MP3/WMA disc.
- WMA-DRM files cannot be played.



- 3 To change the album, use ◀ ▶ ▲ ▼ to select another album in Stop mode, and then press the **ENTER** button.

- To select another album and track, repeat Steps 2 and 3 above.

Note

- Depending on the recording mode, some MP3/WMA-CDs may not play.
- Table of contents of a MP3-CD varies depending on the MP3/WMA track format recorded on the disc.

- 2 In Stop mode, use ◀ ▶ ▲ ▼ to select the album, and then press the **ENTER** button.

- Use ▲ ▼ to select the track.



- 4 Press the **STOP** button to stop playback.

|| To play a file icon in the screen,

Press the ◀ ▶ ▲ ▼ button when it is in stop status and select a desired icon from the top part of the menu.

- To play music files only, select the icon.
- To view image files only, select the icon.
- To view movie files only, select the icon.
- To select all files select the icon.

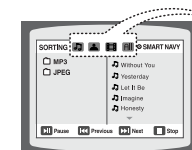

- Music File Icon
- Image File Icon
- Movie File Icon
- All File Icon

DivX Playback

Skip Forward/Back

During playback, press the **◀▶** button.

- Go to the next file whenever you press **▶▶** button, if there are over 2 files in the disk.
- Go to the previous file whenever you press **◀◀** button, if there are over 2 files in the disk.

Fast playback

Press **◀▶** button.

- Each time the button is pressed during playback, the playback speed changes as follows:

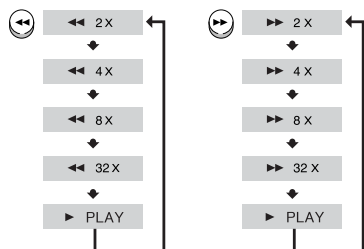

DivX(R) registration

In stop mode, Press the **DivX REG.** button.

- Please use the Registration code to register this player with the DivX(R) video on demand format.
- To learn more, go to www.divx.com/vod.

5 Minute Skip function

During playback, press the **◀, ▶** button.

- Go to the screen about 5 minutes after whenever you press **▶** button.
- Go to the screen about 5 minutes earlier whenever you press **◀** button.

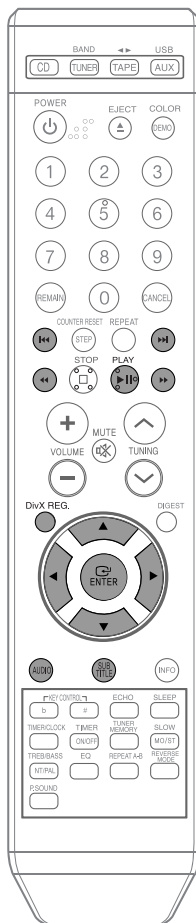

Audio Display

Press the **AUDIO** button.

- If there are multiple audio tracks on a disc, you can toggle between them.
- Each time you press the button, your selection will toggle between "AUDIO(1/1, 1/2 ...)" and "👉".

Note • "👉" is displayed when there is one supported language in the disc.

Subtitle Display

In Power off, Press and hold the **SUBTITLE** button.

- Each time you press the button, your selection will toggle between "CODE 1", "CODE 2", "CODE 3", "CODE 4" and "CODE 5".
- If the disc has only one subtitle file, it will be played automatically.
- Up to 8 subtitle languages are supported. CODE 1 instead of :english and korean, CODE 2 instead of :english and latin(such as French, German), CODE 3 instead of :english and Latin2(such as Hungarian), CODE 4 instead of :Cyrillic(such as Russian, Bulgarian) and CODE 5 Instead of Polish.

Note • When the disc is playing, you can not select the subtitle display.

DivX Feature Table

DivX Supported

Avi files are used to contain the audio and video data; these must be stored on CD in the ISO 9660 format.

		SPEC
VIDEO Compatibility	DivX3.11	Up to the latest VERSION
AUDIO Compatibility	MP3	CBR : 80kbps-320kbps
	AC3	CBR : 128kbps-448kbps
	WMA	CBR : 56kbps-160kbps

MPEGs containing DivX can be divided into Video and Audio.

- **Video compatibility** : All versions of DivX later than 3.11 (including the latest 5.1) are supported. In addition, XviD is supported. But can not support XviD Gmc.
- **Audio compatibility** : MP3s encoded at bitrates from 80kbps to 320kbps, AC3s from 128kbps to 448kbps are supported.
- **In addition, for subtitles, this unit will support Text format (SMI).**

- Note**
- When playing the DivX disc, you can play the file with extension of AVI only.
 - When burning a subtitle file to a CD-ROM with your PC, be sure to burn it as an SMI file.
 - Some DivX, XviD files depending on coding mode and used codec, may be displayed not correct. For example, not in full size.

Displaying Disc Information

You can view playback information on the disc on the TV screen.

Press **INFO** button.

- Each time the button is pressed, the display changes as follows:

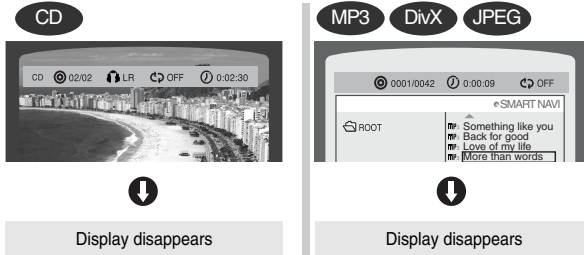

Note

- Depending on the disc, the disc information display may appear different.
- appears on the TV screen!**
If this symbol appears on the TV screen while buttons are being operated, that operation is not possible with the disc currently being played.
- What is a Track (File)?**
A section of video or a music file recorded on a CD, or MP3-CD.

Screen Display

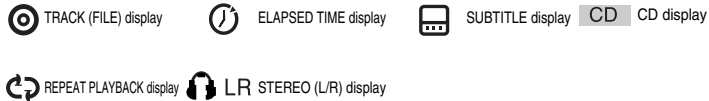

Fast/Slow Playback

Fast Playback

CD MP3

Press **◀▶** button.

- Each time the button is pressed during playback, the playback speed changes as follows:

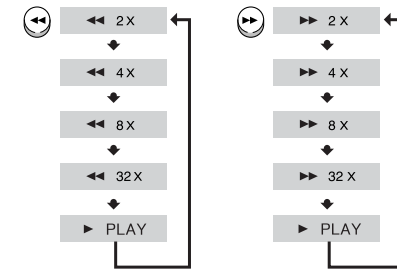

Slow Playback

Press **SLOW** button.

- Each time the button is pressed during playback, the playback speed changes as follows:

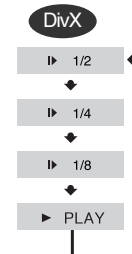

Note

- Reverse slow playback does not work with DivX.
- No sound is heard during slow playback and step motion playback.

Skipping Scenes/Songs

Briefly press **⏮️⏭️** button .

- Each time the button is pressed briefly during playback, the previous or next chapter, track, or directory (file) will be played.
- But, you cannot skip chapters consecutively.

MP3



Playing Frame by Frame **DivX**

Press **STEP** button.

- The picture moves forward one frame each time the button is pressed during playback.

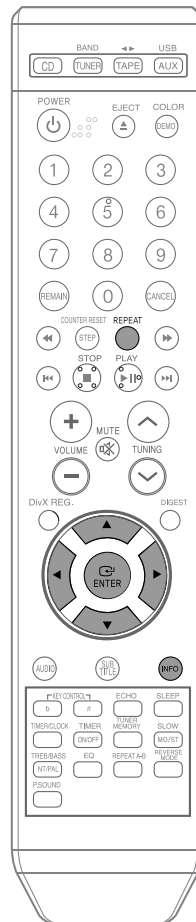

Repeat Playback

Repeat playback allows you to repeatedly play a chapter, title, track (song), or directory (MP3 file).

CD MP3 JPEG

Press **REPEAT** button.

- Each time the button is pressed during playback, the repeat playback mode changes as follows:

CD

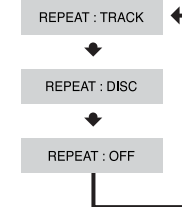

MP3 JPEG

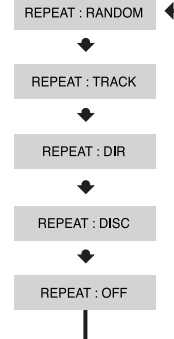

Repeat Playback Options

RANDOM

Plays tracks in random order.
(A track that has already been played may be played again.)

TRACK

Repeatedly plays the selected track.

DIR

Repeatedly plays all tracks in the selected folder.

DISC

Repeatedly plays the entire disc.

OFF

Cancels Repeat Playback.

OPERATION

CD To Select a Repeat Playback Mode in the Disc Information Screen

1 Press **INFO** button twice.

For a CD, Press INFO button once.

CD 02/02 LR OFF 0:02:30

2 Press Cursor **▶** button to move to REPEAT PLAYBACK display.

CD 02/02 LR OFF 0:02:30

3 Press Cursor **▼** button to select the desired Repeat Playback mode.

4 Press **ENTER** button.

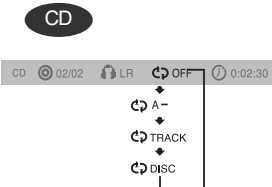

Note

- For MP3 and JPEG discs, you cannot select Repeat Play from the information display screen.

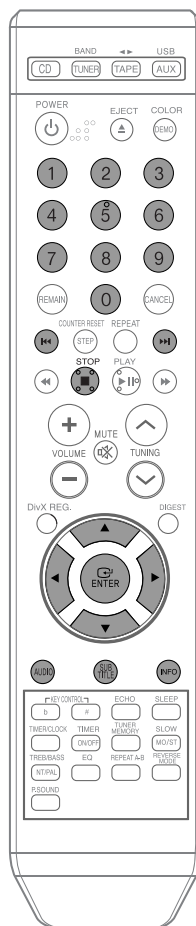

Moving Directly to a Scene/Song

CD

1 Press **INFO** button.

CD 02/02 LR OFF 0:02:30

Moving to a Specific Time

3 Press Cursor **◀, ▶** buttons to move to time display.

CD 02/02 LR OFF 0:02:30

MP3 JPEG

Press the numeric buttons.

- The selected file will be played.
- An MP3 or JPEG disc cannot be moved from the disc information screen.
- When playing an MP3 or JPEG disc, you cannot use **▲, ▼** to move a folder. To move a folder, press **■** (Stop) and then press **▲, ▼**.

Moving to a Track

2 Press Cursor **▲, ▼** buttons or numeric buttons to select the desired title/track and then press **ENTER** button.

Moving to a Specific Time

4 Press the numeric buttons to select the desired time and then press **ENTER** button.

CD 02/02 LR OFF 0:02:30

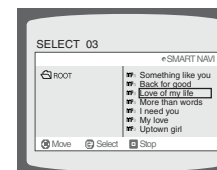

Note

- You can press **◀◀▶▶** on the remote control to move directly to the desired track.
- Depending on the disc, you may not be able to move to the selected time.

JPEG File Playback JPEG

Images captured with a digital camera or camcorder, or JPEG files on a PC can be stored on a CD and then played back with this CD player.

Digest Function

You can view 9 JPEG images on the TV screen.

1 Load the JPEG disc.

2 Press DIGEST button during playback.

- JPEG files will be shown in 9 windows.



3 Press Cursor ▲, ▼, ◀, ▶ buttons to select the desired image and then press ENTER button.

- The selected image is played for 5 seconds before moving to the next image.



To view the previous or next image with 9 windows, press ◀▶▶▶▶.

Rotate/Flip Function

Press Cursor ▲, ▼, ◀, ▶ buttons during playback.

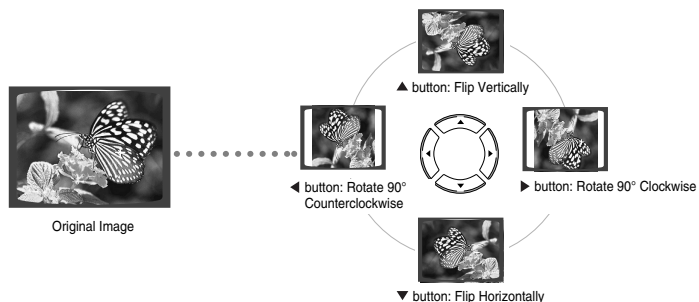

Playing USB

You can play MP3 files by connecting to various external USB storage devices such as USB flash memory or HDD.

1 Connect the external USB storage device to your player.

2 Select USB function by using the USB button.

- The first track of the first directory plays automatically.
- Do not connect USB charging device to the USB connection port of the player, because it may cause damage to the product.

To stop playing

- Press the Stop (■) button to stop.

Please be aware of the following before using USB.

- Depending on the type of external USB storage device, it may not work even if it's connected to the player.
- With external HDD, FAT format can be played, but not NTFS format.
- With USB 2.0 HDD, connect to a separate power source. If it's not connected to a separate power source, it may not work.
- If memory of an external USB storage device is segmented into several parts, MP3 files of only the first hard disk drive can be played.
- Regarding directories, up to fourth directory can be played.
- DRM applied files are not played.
- Digital Rights Management: Technology and service that protect the profit and rights of copyright owners by disallowing unauthorized use of digital contents.
- Even if the file name ends with .mp3, the file does not play if actual file format is MPEG layer 1 or 2.
- Disconnect the external USB storage device only in safe removal mode("USB REMOVE" display ON/OFF). Otherwise, internal file can be damaged.
- Press the Stop (■) button more than 2 times to get into the safe removal mode.
- If you want to play files in the safe removal mode, disconnect and reconnect the external USB storage device.
- USB hub will not be recognized.
- Directory names are shown up to 14 letters, and MP3 file names up to 30 letters.

Delay

- When selecting USB function, depending of the speed of the external USB storage device, reading (READ-IN) internal information can take several minutes.
- When playing a USB device, recording or finding next track may introduce some delay. Especially with a mass storage device such as HDD, depending on the type and the number of files, the delay might be several minutes.
- Even with the external USB storage devices of same capacity, depending on the speed of each product, the amount of operating time can vary.

Note

- It can't play DIVX/XVID and WMV file when playing USB.
- The USB function of this product does not support all USB devices. For the information on the supported devices, please see the page 44.

Selecting a Track from USB Device

You can select a desired directory and an MP3 file during the play or when it stopped.

- Before you begin!** ♦ Connect the external USB storage device to your player.
♦ Select USB function by using the USB button.

1 Press the Cursor ▲, ▼ buttons to move the directory.

- Each time you press the button, it will move to the directory before or after.
- This function works only in the remote control.

2 If you want to move the file, press the ◀◀, ▶▶ button shortly.

- It moves the file within the directory.
- If you press the ◀◀, ▶▶ button more times than the number of the files in the directory, it will move over to the next directory.

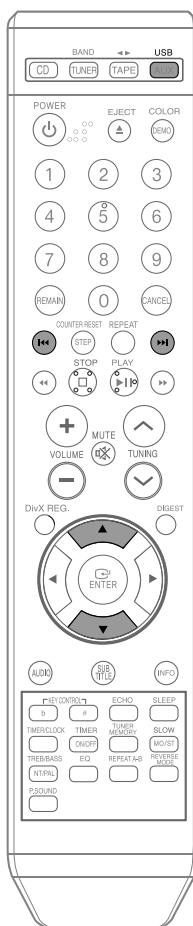

To use high speed search

- Before you begin!** ♦ Connect the external USB storage device to your player.
♦ Select USB function by using the USB button.

You can search the part you want quickly during the play

Press the ◀◀, ▶▶ button.

- Whenever you press the button, you can search backward or forward 2X → 4X → 8X → 32X
→ OFF times quickly.

To repeat

Press the **REPEAT** button during the play.

- REPEAT RANDOM : Plays tracks in random order.
(A track that has already been played may be played again.)
- REPEAT 1 : repeat play one track only.
- REPEAT Dir : repeat play the folder .
- REPEAT ALL : repeat play the entire directories.





Listening to Radio

You can listen to the chosen band (FM, AM broadcast stations) by using either the automatic or manual tuning operation.

Remote Control Unit

1 Press **TUNER/BAND** button.

2 Tune in to the desired station.

Automatic Tuning 1 Press the **STOP** (■) button to select PRESET and then press to select the preset station.

Automatic Tuning 2 Press the **STOP** (■) button to select "AUTO" and then press to automatically search the band.

Manual Tuning Press the **STOP** (■) button to select "MANUAL". Briefly press to increase or decrease the frequency incrementally.

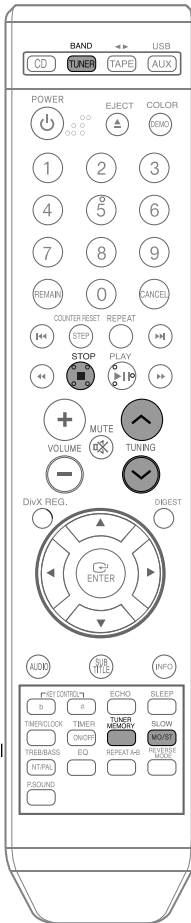

Main Unit

1 Press the **Function** button to select the desired band (FM/AM).

2 Select a broadcast station.

Automatic Tuning 1 Press the **STOP** (■) button to select PRESET and then press to select the preset station.

Automatic Tuning 2 Press the **STOP** (■) button to select "AUTO" and then press to automatically search the band.

Manual Tuning Press **STOP** (■) to select MANUAL and then briefly press to tune in to a lower or higher frequency.

Press **MO/ST** button to listen in Mono/Stereo.
(This applies only when listening to an FM station.)

- Each time the button is pressed, the sound switches between "STEREO" and "MONO".
- In a poor reception area, select MONO for a clear, interference-free broadcast.



Presetting Stations

You can store up to:

- ◆ 15 FM stations
- ◆ 15 AM stations

- FM Frequency Modulation
- AM(MW) Medium Wave

Example: Presetting FM 89.1 in the memory

1 Press the **TUNER(BAND)** button and select the FM band.



2 Press to select "89.10".

- Refer to Step 2 on page 27 to automatically or manually tune in to a station.



3 Press the **TUNER MEMORY** button.

- "PRGM" flashes in the display.



4 Press to select preset number.

- You can select between 1 and 15.



5 Press the **TUNER MEMORY** button.

- Press the **TUNER MEMORY** button before 'PRGM' disappears from the display.
- 'PRGM' disappears from the display and the station is stored in memory.

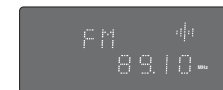

6 To preset another station, repeat steps 2 to 5.

To tune in to a preset station, press on the remote control to select a channel.

Listening to a Cassette

Always treat your cassettes with care; refer, if necessary, to the section entitled "Precautions When Using Audio Cassettes" on page 40.

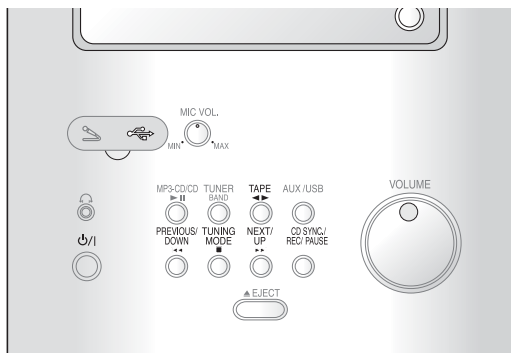

1 Switch the system on by pressing **POWER**.

2 Press **TAPE** on the player to select the Tape function.

3 Press the **PUSH EJECT** (▲) of the cassette deck to open the cassette door and insert a cassette.

- Insert a cassette with the recording/playback side facing the cassette holder, and then push the cassette door shut.

4 Press the ◀▶ button or ▶/II on the remote control. The cassette starts playing.

- Side A : Tape (◀▶) button once.
- Side B : Tape (▶/II) button twice.

5 Press the |◀◀, ▶▶| button or ◀◀, ▶▶ button on the remote control if necessary.

- Rewind the cassette |◀◀/ DOWN button.
- Fast-forward the cassette UP / ▶▶| button.

6 When you have finished playback, press **STOP** button.

Selecting the cassette Playback Mode/Repeat A↔B /Tape Counter Function

Selecting the Cassette Playback Mode

Your micro component system has three cassette playback modes which enable you to listen to both sides of a cassette automatically. .

Press **REVERSE MODE** until the appropriate symbol is displayed.

- : One side of the selected cassette and then stops.
- : One side of the cassette.
The other side of the cassette and then stops.
- : Both sides of the cassette indefinitely until you press stop.

REPEAT A↔B Function

Press **REP. A↔B** button.

- Use this to listen to a specific section again during playback.
- Set the start and end points of the section you want to repeat 3 times.
- This is a useful when learning a foreign language.
- The TAPE REPEAT function can be used only on sections that are longer than 7 seconds.

Note

- You cannot set the end point (B) within 7 seconds after setting the start point (A).
- Repeat A-B Function is available for TAPE only.

Tape Counter

When playing a cassette , a counter is displayed to enable you to take note of the counter value at the start of each track to start playback at the beginning of the track to which you wish to listen.

- Before starting to record a cassette for which you wish to take note of the counter values at the beginning of each track, reset the counter by pressing and hold **COUNTER RESET** .

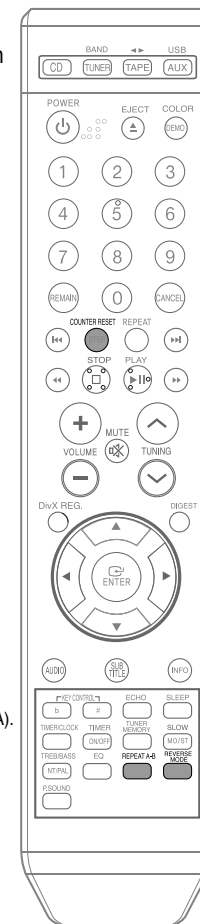

TAPE DECK



Timer Function

- The timer enables you to switch the system on or off at specific times.
- If you no longer want the system to be switched on or off automatically, you must cancel the timer.
- Before setting the timer, check that the current time is correct.
- For each step, you have a few seconds to set the required options.
If you exceed this time, you must start again.

Example: You wish to wake up to music every morning.

1 Switch the system on by pressing **POWER**.

2 Press **TIMER/CLOCK** until **TIMER** is displayed.

3 Press the **ENTER** button.

- **ON TIME** is displayed (instead of the equalizer symbols) for a few seconds, followed by any switch-on time already set; you can set the timer switch-on time.

4 Set the timer switch-on time.

- Set the hour by pressing ◀ or ▶ button.
- Press **ENTER**.
 - The minutes flash.
- Set the minutes by pressing ◀ or ▶ button.
- Press **ENTER**.
 - **OFF TIME** is displayed (instead of the equalizer symbols) for a few seconds, followed by any switch-off time already set; you can now set the timer switch-off time.

5 Set the timer switch-off time.

- Set the hour by pressing ◀ or ▶ button.
- Press **ENTER**.
 - The minutes flash.
- Set the minutes by pressing ◀ or ▶ button.
- Press **ENTER**.
 - **VOL 10** is displayed, where 10 corresponds to the volume already set.

7 Press ◀ or ▶ button to select the source to be played when the system switches on.

- **TAPE** (cassette) : Insert a cassette tape.
- **TUNER** (radio) : **a** Press **ENTER**.
b Select a preset station by pressing Tuning ◀ or ▶.
- **CD** (compact disc) : Load a compact disc.
- **USB** : Connect the USB.

8 Press **ENTER** to confirm the timer.

9 Press **POWER** to set the system to standby mode.

- ☰ is displayed to the top-right of the time, indicating that the timer has been set.
- The system will switch on and off automatically at the required times.

Note

- If the timer switch on and off times are identical, the word **ERROR** is displayed.



Cancelling the Timer

After having set the timer, it will start automatically as shown by the **TIMER** indication on the display. If you no longer wish to use the timer, you must cancel it.

To cancel the timer, press **TIMER ON/OFF** once.

- ☰ is no longer displayed.

To resume the timer, press **TIMER ON/OFF** again.

- ☰ is displayed again.

Note

- You can cancel the timer while the power is on or while the player is in standby.

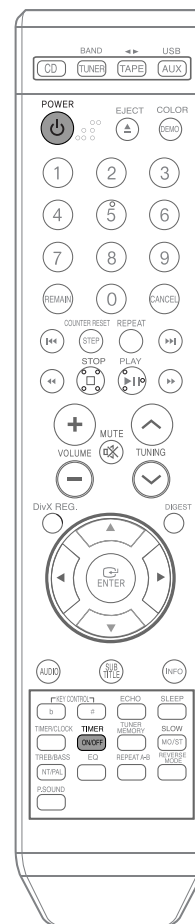



Recording a Compact Disc

You can record a compact disc on a cassette in two different ways:

Synchronized recording

This feature enables you to synchronize the start of the recording with the start of the disc or track of your choice.

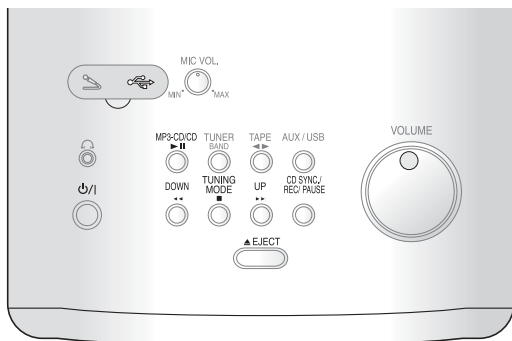

1 Switch the system on by pressing **POWER**.

2 Insert a blank cassette in Deck.

- Press the **PUSH/EJECT** button (▲) to open the cassette door, insert a cassette, and then close the cassette door.
- Insert the cassette with the safety tabs.

3 Load a compact disc.

4 Press the **MP3-CD/CD** (▶||) button.

- Use the CD selection (◀◀, ▶▶) buttons to select the desired song.

5 Press and hold **CD SYNC** button.

- When stopped, press the button to start the recording from the first piece of music.
- Press and hold **CD SYNC** button during the playback of CD to start the recording from the first part of the music being played.

6 To stop recording, press ■ button.

Note

- Synchronized recording Function is available for CD only.
- Depending on the Key control Mode, synchronized recording can not work, but then you can press the OPEN button and repeat step 5, 6 return to Synchronized recording.

Direct recording

The direct recording mode enables you to start recording with any track on the compact disc.

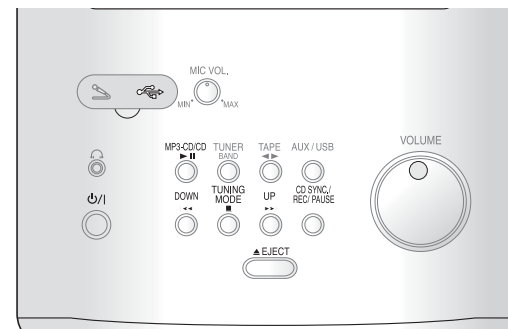

1 Switch the system on by pressing **POWER**.

2 Insert a blank cassette in Deck.

- Press the **PUSH/EJECT** button (▲) to open the cassette door, insert a cassette, and then close the cassette door.
- Insert the cassette with the safety tabs.

3 Load a compact disc.

4 Press the **MP3-CD/CD** (▶||) button.

- Use the CD selection (◀◀, ▶▶) buttons to select the desired song.

5 Press **REC/ PAUSE** button.

- Recording will begin.
- To stop recording, press ■ button.

Note

- The cassette tape you want to record on must have the safety tabs intact.



Recording a Radio Program

You can record a radio program of your choice.
You do not need to adjust the volume, as it has no effect on the recording.



1 Switch the system on by pressing **POWER**.

2 Insert a blank cassette in Deck.

3 Select the **TUNER** function by pressing **TUNER/BAND**.

4 Select the radio station that you wish to record by pressing **◀◀/DOWN** or **UP/▶▶** button.

5 Press **REC/PAUSE** button.

• REC is displayed and recording starts.

6 To stop recording, press **■** button.



EQ/Sound Mode/Treble/Bass Function

Your micro component system is equipped with a preset equalizer that allows you to choose the most appropriate balance between treble and bass frequencies, according to the type of music you are listening to.

The function of Power Sound amplifies bass and improves high key or bass twice as much for you to appreciate powerful real sound.

EQ Function

Press **EQ** control until the required option is selected.

- Press the button repeatedly to select "**PASS→POP→ROCK→CLASS→JAZZ→S.BASS**".
- **S.BASS Function** : S.Bass function emphasizes the bass sound to produce the effect of explosion or booms.

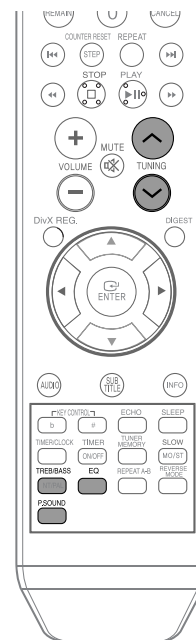

Selecting SOUND MODE

Press **P.SOUND** button until the required option is selected.

- Press the button repeatedly to select "**P.SOUND→OFF**".
- **P.SOUND Function** : You can experience the powerful and realistic sound by amplifying bass and improving the sound quality of high- and low-pitched sounds by two-fold.

Treble Level Function Bass Level Function

Treble Control function stresses high tones providing thudding sound effects.

BASS function stresses low tones providing thudding sound effects.

Press **▲▼** button until **TREB 0** is displayed.

- Please press **TREB/BASS** button and then press **▲▼** to select from **TREB -4** to **TREB 4**.
- You can select the level of high tones you desire.

Press **▲▼** button until **BASS 0** is displayed.

- Please press **TREB/BASS** button and then press **▲▼** to select from **BASS -4** to **BASS 4**.
- You can select the level of low tones you desire.



Sleep Timer Function / Mute Function

Sleep Timer Function

You can set the time that the CD player will shut itself off.

Press **SLEEP** button.

- Each time the button is pressed, the selection changes as follows:
90 MIN → 60 MIN → 45 MIN → 30 MIN → 15 MIN → OFF.



To confirm the sleep timer setting, press **SLEEP** button.

- The remaining time before the CD player will shut itself off is displayed.
- Pressing the button again changes the sleep time from what you have set earlier.

To cancel the sleep timer, press **SLEEP** button until OFF appears on the display.

Mute Function

This is useful when answering a doorbell or telephone call.

Press **MUTE** button.

- 'MUTE' appears in the display.
- To turn off mute, press the button again.

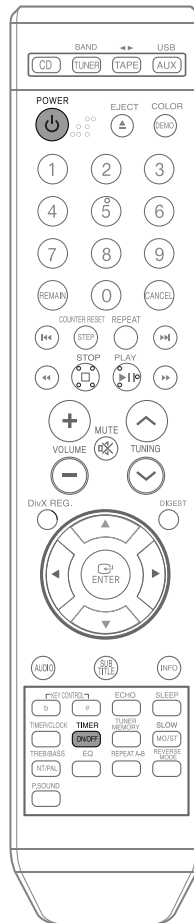

DEMO / COLOR Function

DEMO Function

You can view the various functions available on your system.

Press and hold **DEMO/COLOR** button.

- The various functions available are listed in turn on the display.
- All these functions are described in detail in this booklet. For instructions on how to use them, refer to the appropriate sections.

COLOR Function

You can adjust the color of the display on the main unit so it won't interfere with your movie viewing.

Press **DEMO/COLOR** button.

- Each time the button is press, the colors changes as follows: **AUTO→CYAN→GREEN→RED→BLUE→VIOLET→Y.GREEN→WHITE→OFF.**

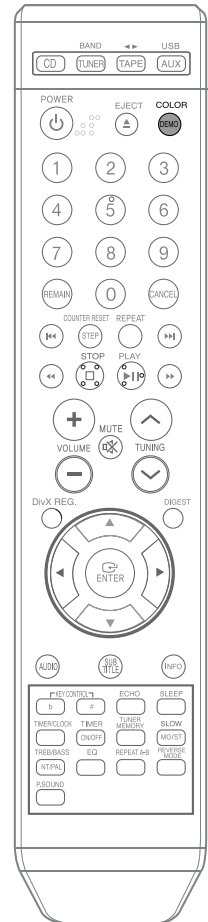

Connecting Headphones/Microphone(option)

You can connect a set of headphones to your micro component system so that you can listen to music or radio programmers without disturbing other people in the room.
The earphones must have a 3.5ø jack or an appropriate adapter.

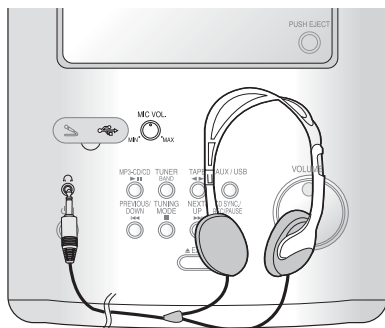

Connect the headphones to the **PHONES** jack on the top panel.

- The loudspeakers are no longer used to output the sound.

Note

- Prolonged use of headphones at a high volume may damage your hearing.



Plug the microphone with a 3.5ø MIC jack into microphone terminal.

- Connect the Microphone.
- Push the **MIC LEVEL** knob first and then Turn it to adjust the **MIC** level.
- Press the **ECHO** button to select ECHO1,ECHO2,and ECHO OFF.
- During using the microphone ,you can press the **REC/PAUSE** button to record your favorite.

Key Control

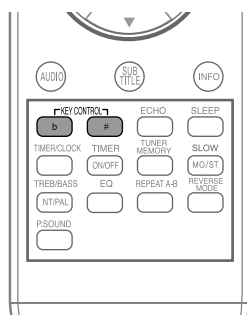

Press the **KEY CONTROL** button to adjust the key to your voice. The (-3~+3)7 steps key control you can select .

Result: Each time the **KEY CONTROL #, b** button is pressed, the following appears on the TV screen:

b : Low-Pitched
: High-Pitched

- Each time **#** button is pressed, the key is increased, and each time **b** button is pressed, the key is decreased .
- The function only can available for CD in stop mode when microphone is connect,it can not available for MP3 .
- The function for "key control" can not disappear immediately if you unplugged MIC.

Cautions on Handling and Storing Discs

Small scratches on the disc may reduce sound and picture quality or cause breaks in playback. Be especially careful not to scratch discs when handling them.

Handling discs

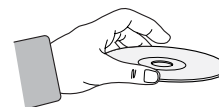

Do not touch the playback side of the disc. Hold the disc by the edges so that fingerprints will not get on the surface.
Do not stick paper or tape on the disc.

Handling and Storing Discs



When you get fingerprints or dirt on the disc, clean it with a mild detergent diluted in water and wipe with a soft cloth.

- When cleaning, wipe gently from the inside to the outside of the disc.

Note

- Condensation may form if warm air comes into contact with cold parts inside the player. When condensation forms inside the player, the player may not operate correctly. If this occurs, remove the disc and let the player stand for 1 or 2 hours with the power on.

Precautions When Using Audio Cassettes

- Check that the tape in the cassette is sufficiently taut.
- To prevent erasing a cassette that you wish to keep, remove the safety tab on the upper edge of the cassette. To record a cassette, where the tab has been broken, simply cover the opening with adhesive tape.
- When you have finished playing a cassette, always put it back in its case.
- Store your cassettes in a clean place, out of direct sunlight, where they will not be exposed to high temperatures.
- Avoid using 120-minute cassettes as they place unnecessary strain on the tape mechanism.

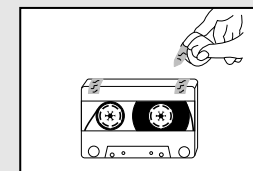
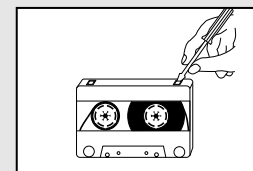
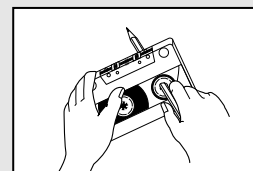



Notes on Discs

Disc Recording Format

CD-R Discs

- Depending on the disc recording device (CD-Recorder or PC) and the condition of the disc, some CD-R discs may not be playable.
- Use a 650MB/74 minute CD-R. Avoid CD-R media, as they may not be playable.
- If possible, do not use CD-RW (Rewritable) media, as they may not be playable.
- Only the CD-Rs that are properly "closed" can be fully played. If the session is closed but the disc is left open, you may not be able to fully play the disc.

CD-R MP3 Discs

- Only CD-R discs with MP3 files in ISO 9660 or Joliet format can be played.
- MP3 file names should be 8 characters or less in length and contain no blank spaces or special characters (. / = +).
- If the name of a file is in Korean, the name will be displayed on the TV screen in Korean and * will be shown in the display of the main unit.
- Use discs recorded with a compression/decompression data rate greater than 128Kbps.
- Only files with the ".mp3" and ".MP3" extensions can be played.
- Only a consecutively written Multisession disc can be played. If there is a blank segment in the Multisession disc, the disc can be played only up to the blank segment.
- If the disc is not closed, it will take longer to begin playback and not all of the recorded files may be played.
- For files encoded in Variable Bit Rate (VBR) format, i.e. files encoded in both low bit rate and high bit rate (e.g., 32Kbps ~ 320Kbps), the sound may skip during playback.
- If more than 500 tracks are recorded on a single CD, a maximum of 500 tracks can be played.
- If more than 300 folders are recorded on a single CD, a maximum of 300 folders can be played.

What is MP3?

MP3 is short for MPEG-1 Audio Layer 3 and MPEG is an acronym for Moving Pictures Experts Group. MP3 is a file format with compression ratio of 1:12 (128 Kbps) That is, you can use MP3 format to record about 12 times the usual amount of data on a regular CD.

CD-R JPEG Discs

- Only files with the ".jpeg" and ".JPEG" extensions can be played.
- If the disc is not closed, it will take longer to start playing and not all of the recorded files may be played.
- Only CD-R discs with JPEG files in ISO 9660 or Joliet format can be played.
- JPEG file names should be 8 characters or less in length and contain no blank spaces or special characters (. / = +).
- Only a consecutively written multisession disc can be played. If there is a blank segment in the multisession disc, the disc can be played only up to the blank segment.
- A maximum of 9,999 images can be stored on a single CD.
- When playing a Kodak/Fuji Picture CD, only the JPEG files in the picture folder can be played.
- Picture discs other than Kodak/Fuji Picture CDs may take longer to start playing or may not play at all.



Before Calling for Service

Refer to the chart below when this unit does not function properly. If the problem you are experiencing is not listed below or if the instruction below does not help, turn off the unit, disconnect the power cord, and contact the nearest authorized dealer or Samsung Electronics Service Center.

Symptom	Check/Remedy
The system does not work	<ul style="list-style-type: none">• The main lead is not correctly plugged into a wall socket or the wall socket is not switched on.• The remote control batteries need replacing or the polarity has not been respected.• The button has not been pressed.
There is no sound	<ul style="list-style-type: none">• The volume has been completely turned down.• The correct function (TUNER, MP3-CD/CD, TAPE, AUX) has not been selected.• You have connected a set of earphones.• The loudspeaker wires have been disconnected.• The MUTE button has been pressed.
The Timer does not work	<ul style="list-style-type: none">• The timer has been stopped by pressing TIMER ON/OFF.
In case it does not work, even the action is taken as above.	<ul style="list-style-type: none">• Press the STOP () button for 5 seconds in power 'OFF'(standby), then it is returned the original position (RESET)
The compact disc player does not start playing	<ul style="list-style-type: none">• The CD function has not been selected.• The disc has been inserted face down or is either dirty or scratched.• The laser sensor is dirty or dusty.• The system has not been installed on a flat, horizontal surface.• Condensation has formed in the player; leave the system in a warm, airy room for at least one hour.
The tape does not start playing	<ul style="list-style-type: none">• The TAPE function has not been selected.• The cassette has not been inserted correctly.• The cassette player has not been closed.• The tape is either slack or broken.
The volume falls off The cassette is not erased correctly There is excessive wow and flutter	<ul style="list-style-type: none">• The audio heads are dirty.• The rollers or drive capstans are dirty.• The tape is worn.
Reception is poor or no radio stations are received at all	<ul style="list-style-type: none">• The TUNER function has not been selected.• The radio frequency has not been correctly selected.• The aerial has been disconnected or is not facing the right way. Turn it until you find the best orientation.• You are in a building that blocks radio waves; you must use an outside aerial.



Specifications

GENERAL	Power consumption	60W
	Weight	4.3Kg
	Dimensions (W x H x D)	170 x 175 x 292 mm
	Operating Temperature Range	+5°C~+35°C
	Operating Humidity Range	10%~75%
FM TUNER	Usable Sensitivity	10dB
	S/N Ratio	55dB
	Distortion	0.8%
MW TUNER	Usable Sensitivity	56dB
	S/N Ratio	40dB
	Distortion	2%
VIDEO OUTPUT	Composite Video	1.0Vp-p(75Ω load)
AMPLIFIER	Speaker output	20W/CH
	Frequency range	20Hz~20kHz
	S/N Ratio	75dB
	Channel separation	50dB
	Input sensitivity	(AUX)500mV
SPEAKER	Impedance	6Ω x 2
	Frequency range	20 Hz - 20 KHz (± 1 dB)
	Output sound pressure level	84dB/W/M
	Rated input	20W
	Maximum input	40W
	Dimensions (W x H x D)	170(W) x 160(H) x 175(D) mm
	Weights	1.4 Kg

USB Feature Supported Player

Digital Camera

Product	Company	Type
Finepix-A340	Fuji	Digital Camera
Finepix-F810	Fuji	Digital Camera
Finepix-F610	Fuji	Digital Camera
Finepix-f450	Fuji	Digital Camera
Finepix S7000	Fuji	Digital Camera
Finepix A310	Fuji	Digital Camera
KD-310Z	Konica	Digital Camera
Finecam SL300R	Kyocera	Digital Camera
Finecam SL400R	Kyocera	Digital Camera
Finecam S5R	Kyocera	Digital Camera
Finecam Xt	Kyocera	Digital Camera
Dimage-Z1	Minolta	Digital Camera
Dimage Z1	Minolta	Digital Camera
Dimage X21	Minolta	Digital Camera
Coolpix4200	Nikon	Digital Camera
Coolpix4300	Nikon	Digital Camera
Coolpix 2200	Nikon	Digital Camera
Coolpix 3500	Nikon	Digital Camera
Coolpix 3700	Nikon	Digital Camera
Coolpix 4100	Nikon	Digital Camera
Coolpix 5200	Nikon	Digital Camera
Stylus 410 digital	Olympus	Digital Camera
300-digital	Olympus	Digital Camera
U300	Olympus	Digital Camera
X-350	Olympus	Digital Camera
C-760	Olympus	Digital Camera
C-5060	Olympus	Digital Camera
X1	Olympus	Digital Camera
U-mini	Olympus	Digital Camera
Lumix-FZ20	Panasonic	Digital Camera
DMC-FX7GD	Panasonic	Digital Camera
Lumix LC33	Panasonic	Digital Camera
LUMIX DMC-F1	Panasonic	Digital Camera
Optio-S40	Pentax	Digital Camera
Optio-S50	Pentax	Digital Camera
Optio 33LF	Pentax	Digital Camera
Optio MX	Pentax	Digital Camera
Digimax-420	Samsung	Digital Camera
Digimax-400	Samsung	Digital Camera
Sora PDR-T30	Toshiba	Digital Camera
Coolpix 5900	Nikon	Digital Camera
Coolpix S1	Nikon	Digital Camera
Coolpix 7600	Nikon	Digital Camera
DMC-FX7	Panasonic	Digital Camera
Dimage Xt	Minolta	Digital Camera
AZ-1	Olympus	Digital Camera

USB Flash Disk

Product	Company	Type
Cruzer Micro	Sandisk	USB 2.0 USB Flash Drive 128M
Cruzer Mini	Sandisk	USB 2.0 128M
Cruzer Mini	Sandisk	USB 2.0 256M
SONY Micro Vault	Sony	USB 2.0 64MB
FLEX DRIVE	Serotech	USB 2.0 32MB
AnyDrive	A.L tech	USB 2.0 128MB
XTICK	LG	USB 2.0 128M
Micro Mini	lomega	USB 2.0 128MB
iFlash	Imation	USB 2.0 64M
LG	XTICK(M)	USB 2.0 64M
RiDATA	EZDrive	USB 2.0 64M

MP3 Player

Product	Company	Type
Creative MuVo NX128M	Creative	128 MB MP3 Player
Iriver H320	Iriver	20G HDD MP3 Player
YH-920	Samsung	20G HDD MP3 Player
YP-T7	Samsung	MP3 Player
YP-MT6	Samsung	MP3 Player
YP-T6	Samsung	MP3 Player
YP-53	Samsung	MP3 Player
YP-ST5	Samsung	MP3 Player
YP-T5	Samsung	MP3 Player
YP-60	Samsung	MP3 Player
YP-780	Samsung	MP3 Player
YP-35	Samsung	MP3 Player
YP-55	Samsung	MP3 Player
iAUDIO U2	Cowon	MP3 Player
iAUDIO G3	Cowon	MP3 Player
iAudio M3	Cowon	HDD MP3 Player
SI-M500L	Sharp	256MB MP3 Player
H10	Iriver	MP3 Player
YP-T5 VB	Samsung	MP3 Player
YP-53	Samsung	256MB MP3 Player

USB External HDD

Product	Company	Type
MOMOBAY UX-2	Dvico	USB 2.0

Contact SAMSUNG WORLD WIDE

If you have any questions or comments relating to Samsung products, please contact the SAMSUNG customer care center.

Region	Country	Customer Care Center	Web Site
North America	CANADA	1-800-SAMSUNG (7267864)	www.samsung.com/ca
	MEXICO	01-800-SAMSUNG (7267864)	www.samsung.com/mx
	U.S.A	1-800-SAMSUNG (7267864)	www.samsung.com
Latin America	ARGENTINE	0800-333-3733	www.samsung.com/ar
	BRAZIL	0800-124-421 4004-0000	www.samsung.com/br
	CHILE	800-726-7864 (SAMSUNG)	www.samsung.com/cl
	COSTA RICA	0-800-507-7267	www.samsung.com/latin
	ECUADOR	1-800-10-7267	www.samsung.com/latin
	EL SALVADOR	800-6225	www.samsung.com/latin
	GUATEMALA	1-800-299-0013	www.samsung.com/latin
	JAMAICA	1-800-234-7267	www.samsung.com/latin
	PANAMA	800-7267	www.samsung.com/latin
	PUERTO RICO	1-800-682-3180	www.samsung.com/latin
	REP. DOMINICA	1-800-751-2676	www.samsung.com/latin
	TRINIDAD & TOBAGO	1-800-7267-864	www.samsung.com/latin
	VENEZUELA	0-800-100-5303	www.samsung.com/latin
Europe	COLOMBIA	01-8000112112	www.samsung.com.co
	BELGIUM	02 201 2418	www.samsung.com/be
	CZECH REPUBLIC	844 000 844 Distributor pro Českou republiku : Samsung Zrt., česká organizační složka Vyskočilova 4, 14000 Praha 4	www.samsung.com/cz
	DENMARK	38 322 887	www.samsung.com/dk
	FINLAND	09 693 79 554	www.samsung.com/fi
	FRANCE	3260 SAMSUNG or 08 25 08 65 65 (€ 0,15/Min)	www.samsung.com/fr
	GERMANY	01805 - 121213 (€ 0,14/Min)	www.samsung.de
	HUNGARY	06-80-SAMSUNG (7267864)	www.samsung.com/hu
	ITALIA	800-SAMSUNG (7267864)	www.samsung.com/it
	LUXEMBURG	0032 (0)2 201 24 18	www.samsung.lu
	NETHERLANDS	0900 20 200 88 (€ 0,10/Min)	www.samsung.com/nl
	NORWAY	231 627 22	www.samsung.com/no
	POLAND	0 801 801 881	www.samsung.com/pl
	PORTUGAL	80 8 200 128	www.samsung.com/pt
	SLOVAKIA	0800-SAMSUNG (726786)	www.samsung.com/sk
	SPAIN	902 10 11 30	www.samsung.com/es
	SWEDEN	08 585 367 87	www.samsung.com/se
	U.K	0870 SAMSUNG (7267864)	www.samsung.com/uk
	Republic of Ireland	0818 717 100	www.samsung.com/uk
	Switzerland	0800-7267864	www.samsung.com/ch
CIS	RUSSIA	8-800-200-0400	www.samsung.ru
	KAZAHSTAN	8-800-080-1188	www.samsung.kz
	UZBEKISTAN	8-800-120-0400	www.samsung.uz
	UKRAINE	8-800-502-0000	www.samsung.com/ur
	LITHUANIA	8-800-77777	www.samsung.lt
	LATVIA	800-7267	www.samsung.com/lv/index.htm
	ESTONIA	800-7267	www.samsung.ee
Asia Pacific	AUSTRALIA	1300 362 603	www.samsung.com/au
	CHINA	800-810-5858, 010-6475 1880	www.samsung.com.cn
	HONG KONG	3698 - 4698	www.samsung.com/hk
	INDIA	3030 8282 1800 110011	www.samsung.com/in
	INDONESIA	0800-112-8888	www.samsung.com/id
	JAPAN	0120-327-527	www.samsung.com/jp
	MALAYSIA	1800-88-9999	www.samsung.com/my
	PHILIPPINES	1800-10-SAMSUNG (7267864)	www.samsung.com/ph
	SINGAPORE	1800-SAMSUNG (7267864)	www.samsung.com/sg
	THAILAND	1800-29-3232 02-689-3232	www.samsung.com/th
	TAIWAN	0800-329-999	www.samsung.com/tw
	VIETNAM	1 800 588 889	www.samsung.com/vn
Middle East & Africa	SOUTH AFRICA	0860 7267864 (SAMSUNG)	www.samsung.com/za
	U.A.E	800SAMSUNG (7267864) 8000-4726	www.samsung.com/mea