

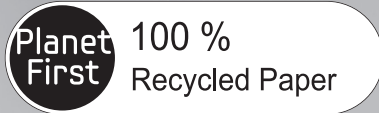

Refrigerator user manual



This manual is made with 100 % recycled paper.

English

imagine the possibilities

Thank you for purchasing this Samsung product.

Free Standing Appliance



safety information

SAFETY INFORMATION

- Before operating the appliance, please read this manual thoroughly and retain it for your reference.
- Use this appliance only for its intended purpose as described in this instruction manual. This appliance is not intended for use by persons (including children) with reduced physical, sensory or mental capabilities, or lack of experience and knowledge, unless they have been given supervision or instruction concerning use of the appliance by a person responsible for their safety.
- This appliance can be used by children aged from 8 years and above and persons with reduced physical, sensory or mental capabilities or lack of experience and knowledge if they have been given supervision or instruction concerning use of the appliance in a safe way and understand the hazards involved.

Children shall not play with the

appliance.

Cleaning and user maintenance shall not be made by children without supervision.

- Warnings and Important Safety Instructions in this manual do not cover all possible conditions and situations that may occur.

It is your responsibility to use common sense, caution, and care when installing, maintaining, and operating your appliance.

- Because these following operating instructions cover various models, the characteristics of your refrigerator may differ slightly from those described in this manual.

R-600a or R-134a is used as a refrigerant. Check the compressor label on the rear of the appliance or the rating label inside the fridge to see which refrigerant is used for your refrigerator. When this product contains flammable gas (Refrigerant R-600a),

contact your local authority in regard to safe disposal of this product.

- In order to avoid the creation of a flammable gas-air mixture if a leak in the refrigerating circuit occurs, the size of the room in which the appliance may be sited depends on the amount of refrigerant used.
 - Never start up an appliance showing any signs of damage. If in doubt, consult your dealer. The room must be 1 m³ in size for every 8 g of R-600a refrigerant inside the appliance. The amount of refrigerant in your particular appliance is shown on the identification plate inside the appliance.
 - Refrigerant squirting out of the pipes could ignite or cause an eye injury. When refrigerant leaks from the pipe, avoid any naked flames and move anything flammable away from the product and ventilate the room immediately.
- Failing to do so may result in fire or explosion.

Important safety symbols and precautions:

	<p>Hazards or unsafe practices that may result in severe personal injury or death.</p>
	<p>Hazards or unsafe practices that may result in minor personal injury or property damage.</p>
	<p>Do NOT attempt.</p>
	<p>Do NOT disassemble.</p>
	<p>Do NOT touch.</p>
	<p>Follow directions carefully.</p>
	<p>Unplug the power plug from the wall socket.</p>
	<p>Make sure the machine is grounded to prevent electric shock.</p>
	<p>Call the contact center for help.</p>
	<p>Note.</p>

These warning signs are here to prevent injury to you and others.

Please follow them carefully. After reading this section, keep it in a safe place for future reference.

CE Notice

This product has been determined to be in compliance with the Low Voltage Directive (2006/95/EC), the Electromagnetic Compatibility Directive (2004/108/EC), RoHS Directive (2011/65/EU), Commission Delegated Regulation (EU) No 1060/2010 and the Eco-Design Directive(2009/125/EC) implemented by Regulation (EC) No 643/2009 of the European Union. (For products sold in European Countries only)



SEVERE WARNING SIGNS FOR TRANSPORTATION AND SITE

- ★ • When transporting and installing the appliance, care should be taken to ensure that no parts of the refrigerating circuit are damaged.
- Refrigerant leaking from the pipe work could ignite or cause an eye injury. If a leak is detected, avoid any naked flames or potential sources of ignition and air the room in

which the appliance is standing for several minutes.

- This appliance contains a small amount of isobutane refrigerant(R-600a), a natural gas with high environmental compatibility that is, however, also combustible. When transporting and installing the appliance, care should be taken to ensure that no parts of the refrigerating circuit are damaged.



SEVERE WARNING SIGNS FOR INSTALLATION

- ☐ • Deteriorated insulation of electrical parts may cause an electric shock or fire.
- Do not place this refrigerator in direct sunlight or expose to the heat from stoves, room heaters or other appliance.
- Do not plug several appliances into the same multiple power board. The refrigerator should always be plugged into its own individual electrical outlet which has a voltage rating that matched the rating plate.
- This provides the best

performance and also prevents overloading house wiring circuits, which could cause a fire hazard from overheated wires.

- If the wall socket is loose, do not insert the power plug.
- There is a risk of electric shock or fire.
- Do not use a cord that shows cracks or abrasion damage along its length or at either end.
- Do not pull or excessively bend the power cord.
- Do not twist or tie the power cord.
- Do not hook the power cord over a metal object, place a heavy object on the power cord, insert the power cord between objects, or push the power cord into the space behind the appliance.
- When moving the refrigerator, be careful not to roll over or damage the power cord.
- This may result in an electric shock or fire.
- Do not use aerosols near the refrigerator.
- Aerosols used near the refrigerator may cause an

explosion or fire.

- Do not bend the power cord excessively or place heavy articles on it.



- This refrigerator must be properly installed and located in accordance with the manual before it is used.
- Do not install the refrigerator in a damp place or place where it may come in contact with water.
- Deteriorated insulation of electrical parts may cause an electric shock or fire.
- Connect the power plug in proper position with the cord hanging down.
- If you connect the power plug upside down, wire can get cut off and a cause fire or an electric shock.
- Make sure that the power plug is not squashed or damaged by the back of the refrigerator.
- When moving the refrigerator, be careful not to roll over or damage the power cord.
- This constitutes a fire hazard.
- Keep the packing materials out of reach of children.

- There is a risk of death from suffocation if children put them on their head.
- This appliance should be positioned in such a way that it is accessible to the power plug.
- Failing to do so may result in an electric shock or fire due to electric leakage.
- Do not install this appliance near a heater, inflammable material.
- Do not install this appliance in a humid, oily or dusty location, in a location exposed to direct sunlight and water (rain drops).
- Do not install this appliance in a location where gas may leak.
- This may result in an electric shock or fire.
- If any dust or water is in the refrigerator, pull out power plug and contact your Samsung Electronics service center.
- Otherwise there is a risk of fire.
- Do not stand on top of the appliance or place objects (such as laundry, lighted candles, lighted cigarettes, dishes, chemicals, metal objects, etc.) on the appliance.
- This may result in an electric

shock, fire, problems with the product, or injury.



- This appliance must be properly grounded.
- Do not ground the appliance to a gas pipe, plastic water pipe, or telephone line.
- You must ground the refrigerator to prevent any power leakages or electric shocks caused by current leakage from the refrigerator.
- This may result in an electric shock, fire, explosion, or problems with the product.
- Never plug the power cord into a socket that is not grounded correctly and make sure that it is in accordance with local and national codes.



- If the power cord is damaged, have it replaced immediately by the manufacturer or its service agent.
- The fuse on the refrigerator must be changed by a qualified technician or service company.
- Failing to do so may result in an electric shock or personal injury.



CAUTION SIGNS FOR INSTALLATION

- ★ • Keep ventilation opening in the appliance enclosure or mounting structure clear of obstruction.
- Allow the appliance to stand for 2 hours after installation.
- The installation or any service of this appliance is recommended by a qualified technician or service company.
- Failing to do so may result in an electric shock, fire, explosion, problems with the product, or injury.



SEVERE WARNING SIGNS FOR USING

- ☐ • Do not touch the power plug with wet hands.
- This may result in an electric shock.
- Do not store articles on the top of the appliance.
- When you open or close the door, the articles may fall and cause a personal injury and/or material damage.
- Do not put items filled with water on the refrigerator.
- If spilled, there is a risk of fire or electric shock.

- Do not touch the inside walls of the freezer or products stored in the freezer with wet hands.
 - This may cause frostbite.
- Do not use or place any substances sensitive to temperature such as inflammable sprays, inflammable objects, dry ice, medicine, or chemicals near the refrigerator.

Do not keep volatile or inflammable objects or substances (benzene, thinner, propane gas, alcohol, ether, LP gas and other such products etc.) in the refrigerator.

 - This refrigerator is for storing food only.
 - This may result in a fire or an explosion.
- Do not store pharmaceuticals products, scientific materials or temperature-sensitive products in the refrigerator.
- Products that require strict temperature controls must not be stored in the refrigerator.
- Do not place or use electrical appliance inside the refrigerator/freezer, unless they are of a type recommended by the manufacturer.

- If you smell pharmaceutical or smoke, pull out power plug immediately and contact your Samsung Electronics service center.
- If any dust or water is in Refrigerator, pull out power plug and contact your Samsung Electronics service center.
- Otherwise there is a risk of fire.
- If gas leak is detected, avoid any naked flames or potential sources of ignition and air the room in which the appliance is standing for several minutes.
- Do not use mechanical devices or any other means to accelerate the defrosting process, other than those recommended by the manufacturer.
- Do not damage the refrigerant circuit.
- Do not spray volatile material such as insecticide onto the surface of the appliance.
- As well as being harmful to humans, it may also result in an electric shock, fire or problems with the product.
- Do not use a hair dryer to dry the inside of the refrigerator.

Do not place a lighted candle in the refrigerator for removing bad odours.

- This may result in an electric shock or fire.
- Fill the water tank, ice tray, water cubes only with potable water.
- Do not let children hang on the door.
If not, a serious injury may occur.
- Risk of children entrapment.
Do not let children enter inside the refrigerator.
- Do not leave the doors of the refrigerator open while the refrigerator is unattended and do not let children enter inside the refrigerator.
- Do not allow babies or children go inside the drawer.
- It can cause death from suffocation by entrapment or personal injury.
- Do not sit on the Freezer door.
- The door may be broken and cause a personal injury.
- To prevent children entrapment, you must reinstall the divider using provided screws after cleaning or other actions if you removed the

divider from the drawer.

- Do not use mechanical devices or any other means to accelerate the defrosting process, other than those recommended by the manufacturer.
- Do not damage the refrigerant circuit.



- In the event of a gas leak (such as propane gas, LP gas, etc.), ventilate immediately without touching the power plug. Do not touch the appliance or power cord.
 - Do not use a ventilating fan.
 - A spark may result in an explosion or fire.
- Use only the LED Lamps provided by manufacturer or service agent.
- Children should be supervised to ensure that they do not play with the appliance.
- Keep fingers out of “pinch point” areas; clearances between the doors and cabinet are necessarily small.
- Do not let children hang on the door.
If not, a serious injury may occur.

- There is a Risk of children entrapment.
Do not let children enter inside the refrigerator.
- Bottles should be stored tightly together so that they do not fall out.
- This product is intended only for the storage of food in a domestic environment.
- Do not insert hands, feet or metal objects (such as chopsticks, etc.) into the bottom or the back of the refrigerator.
 - This may result in an electric shock or injury.
 - Any sharp edges may cause a personal injury.



- Do not attempt to repair, disassemble, or modify the appliance yourself.
 - Do not use any fuse (such as cooper, steel wire, etc.) other than the standard fuse.
 - When repairing or reinstalling the appliance is required, contact your nearest service center.
 - Failing to do so may result in an electric shock, fire, problems with the product, or injury.

-
-  • If the appliance generates a strange noise, a burning or smell or smoke, unplug the power plug immediately and contact your nearest service center.
 - Failing to do so may result in an electric or fire hazards.
 - Pull the power plug out of the socket before changing the interior lamps of the refrigerator
 - Otherwise, there is a risk of electric shock.
 - If you experience difficulty when changing the light, contact service agent.
 - If the products is equipped with the LED Lamp, do not disassemble the Lamp Cover and LED Lamp by yourself.
 - Please contact your service agent.
 - Plug the power plug into the wall socket firmly. Do not use a damaged power plug, damaged power cord or loose wall socket.
 - This may result in an electric shock or fire.
 - Do not put a container filled with water on the appliance.

- If spilled, there is a risk of fire or electric shock.
- Never stare directly at the UV LED lamp for long periods of time.
- This may result in eye strain due to the ultraviolet rays.



CAUTION SIGNS FOR USING

-
-  • To get best performance from the product,
 - Do not place foods too closely in front of the vents at the rear of the appliance as it can obstruct free air circulation in the refrigerator compartment.
 - Wrap the food up properly or place it in airtight containers before putting it into the refrigerator.
 - Do not put any newly introduced food for freezing near to already existing food.
 - Do not place glass or bottles or carbonated beverages into the freezer.
 - The container may freeze and break, and this may result in injury.
 - Please observe maximum storage times and expiry dates of frozen goods.

- There is no need to disconnect the refrigerator from the power supply if you will be away for less than three weeks. But, remove all the food if you are going away for the three weeks or more. Unplug the refrigerator and clean it, rinse and dry.
- Do not place carbonated or fizzy drinks in the freezer compartment.
Do not put bottles or glass containers in the freezer.
- When the contents freeze, the glass may break and cause personal injury and property damage.
- Do not change or modify the functionality of the refrigerator.
- Changes or modifications may result in a personal injury and/or property damage.
Any changes or modifications performed by a 3rd party on this completed appliance are neither covered under Samsung warranty service, nor is Samsung responsible for safety issues and damages that result from 3rd party modifications.
- Do not block air holes.
- If the air holes are blocked,

especially with a plastic bag, the refrigerator can be over cooled. If this cooling period lasts too long, the water filter may break and cause water leakage.

- Wipe excess moisture from the inside and leave the doors open.
- Otherwise, odor and mold may develop.
- When the refrigerator got wet by water, pull out the power plug and contact your Samsung Electronics service center.



CAUTION SIGNS FOR CLEANING AND MAINTENANCE

- ★ • Do not spray cleaning products directly on the display.
- Printed letters on the display may come off.
- If any foreign substance such as water has entered the appliance, unplug the power plug and contact your nearest service center.
- Failing to do so may result in an electric shock or fire.
- Remove all foreign substances

such as dust or water from the power plug terminals and contact points using a dry cloth on a regular basis.

- Unplug the power plug and clean it with a dry cloth.
- Failing to do so may result in an electric shock or fire.
- Do not clean the appliance by spraying water directly onto it.
- Do not use benzene, thinner, or Clorox, Chloride for cleaning.
- They may damage the surface of the appliance and may cause a fire.



- Before cleaning or performing maintenance, unplug the appliance from the wall socket.
- Failing to do so may result in an electric shock or fire.



SEVERE WARNING SIGNS FOR DISPOSAL



- Leave the shelves in place so that children may not easily climb inside.
- Ensure that none of the pipes on the back of the appliance are damaged prior to disposal.
- R-600a or R-134a is used as a refrigerant. Check the compressor label on the rear of the appliance or the rating label inside the refrigerator to see which refrigerant is used for your refrigerator.

When this product contains flammable gas (Refrigerant R-600a), contact your local authority in regard to safe disposal of this product.

Cyclopentane is used as an insulation blowing gas.

The gases in insulation material require special disposal procedure.

Please contact your local authorities in regard to the environmentally safe disposal of this product. Ensure that none of the pipes on the back of the appliances are damaged prior to disposal.

The pipes shall be broken in the open space.

- It is hazardous for anyone other than an Authorised Service Person to service this appliance. In Queensland – the authorized Service Person MUST hold a Gas Work Authorisation or Licence for hydrocarbon refrigerants, to carry out Servicing or repairs which involve the removal of covers. (For Australia only)
- When disposing of this or other refrigerator/s, remove the door/door seals, door latch so that children or animals cannot become trapped inside. Children should be supervised to ensure that they do not enter and play with the appliance.
- If trapped inside, the child may become injury and suffocate to death.
- Please dispose of the packaging material for this product in an environmentally friendly manner.
- Keep all packaging materials well out of the reach of children, as packaging materials can be dangerous to children.
- If a child places a bag over its head, it may result in

suffocation.



ADDITIONAL TIPS FOR PROPER USAGE

- In the event of a power failure, call the local office of your Electricity Company and ask how long it is going to last.
- Most power failures that are corrected within an hour or two will not affect your refrigerator temperatures. However, you should minimize the number of door openings while the power is off.
- But should the power failure last more than 24 hours, remove all frozen food.
- If keys are provided with the refrigerator, the keys should be kept out of the reach of children and not be in the vicinity of the appliance.
- The appliance might not operate consistently (possibility of defrosting of contents or temperature becoming too warm in the frozen food compartment) when sited for an extended period of time below the cold end of the range of temperature for which the refrigerating appliance is designed.

- Do not store food which goes bad easily at low temperature, such as bananas, melons.
- Your appliance is frost free, which means there is no need to manually defrost your appliance, as this will be carried out automatically.
- Temperature rise during defrosting can comply with ISO requirements.
But if you want to prevent an undue rise in the temperature of the frozen food while defrosting the appliance, please wrap the frozen food up in several layers of newspaper.
- Any increase in temperature of frozen food during defrosting can shorten its storage life.
- Do not re-freeze frozen foods that have thawed completely.

Saving Energy Tips

- Install the appliance in a cool, dry room with adequate ventilation.
Ensure that it is not exposed to direct sunlight and never put it near a direct source of heat (radiator, for example).
- Never block any vents or grilles on the appliance.
- Allow warm food to cool down before placing it in the appliance.
- Put frozen food in the refrigerator to thaw.
You can then use the low temperatures of the frozen products to cool food in the refrigerator.
- Do not keep the door of the appliance open for too long when putting food in or taking food out. The shorter time for which the door is open, the less ice will form in the freezer.
- Allow clearance to the right, left, back and top when installing.
This will help reduce power consumption and keep your energy bills lower.
- For the most efficient use of energy, please keep the all inner fittings such as

baskets, drawers, shelves
on the position supplied by
manufacturer.

**This appliance is intended
to be used in household and
similar applications such as**

- staff kitchen areas in shops,
offices and other working
environments;
- farm houses and by clients
in hotels, motels and other
residential type environments;
- bed and breakfast type
environments;
- catering and similar non-retail
applications.

contents

SETTING UP YOUR REFRIGERATOR.....	16
OPERATING YOUR SAMSUNG REFRIGERATOR	21
TROUBLESHOOTING.....	25

setting up your refrigerator

GETTING READY TO INSTALL THE REFRIGERATOR

Congratulations on your purchase of the Samsung refrigerator. We hope you enjoy the state-of-art features and efficiencies that this new appliance offers.

Selecting the best location for the Refrigerator

Choose :

- A location with easy access to the water supply.
- A location without direct exposure to sunlight.
- A location with level (or nearly level) flooring.
- A location with enough space for the refrigerator doors to open easily.
- A location that allows sufficient space to the right, left, back, and top for air circulation. If the refrigerator does not have enough space, the internal cooling system may not work properly.
- A location that allows you to move the refrigerator easily if it needs maintenance or service.
- Do not install the refrigerator in locations where the temperature is over 43 °C or below 5 °C.

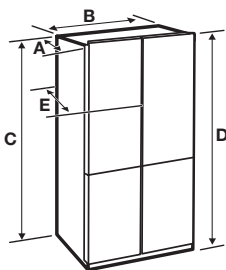

Depth "A"	908 mm
Width "B"	908 mm
Height "C"	1822 mm
Overall Height "D"	1850 mm

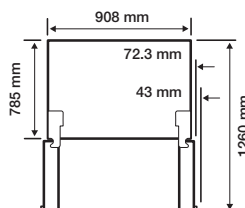
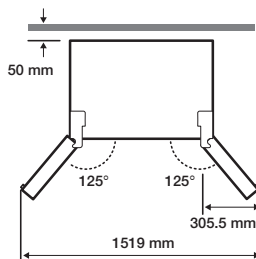

- Each measurement based on the design dimension, so it may differ depending on the measuring method.



When moving your refrigerator

To prevent floor damage, be sure the front leveling legs are in the up position (above the floor).

Refer to "HOW TO LEVEL THE REFRIGERATOR" in the manual on page 19.

FLOORING

For proper installation, you must place this refrigerator on a level, hard surface that is the same height as the rest of the floor.

This surface should be strong enough to support a fully loaded refrigerator.

To protect the finish of the flooring, cut a large section of the cardboard carton and place it under the refrigerator where you are working. When moving the refrigerator, you need to pull and push it straight forwards or back. Do not wiggle it from side to side.

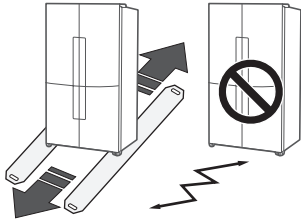

REMOVING THE REFRIGERATOR DOORS

If the refrigerator is too large to pass through your doorway easily, you can remove the refrigerator doors.

Tools you will need (Not provided)

Phillips screwdriver (+)	Flat-blade screwdriver (-)	Socket wrench (10 mm)
Pliers	Allen wrench (4 mm)	Allen wrench (5 mm)

WARNING Disconnect power to the refrigerator before removing the doors or drawers.



- Be careful not to drop, damage or scratch the doors/drawers while removing them.
- Use care when you remove the doors/drawers. The doors are heavy and you could injure yourself.
- Re-attach the doors/drawers properly to avoid:
 - Moisture from air leakage.
 - Uneven door alignment.
 - Wasting energy due to improper door seal.

DISASSEMBLE THE REFRIGERATOR DOORS

1. With the door closed, remove the 3 screws holding the Top Cover (A) with a Phillips (+) Screwdriver, and then remove the Top Cover with the entire wire-harnesses attached.

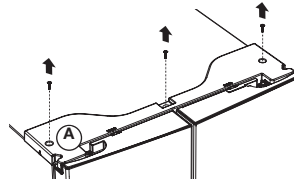

2. Disconnect the two wire-harnesses on the left door and one on the right door. (It may differ by models.)

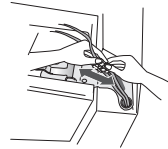

3. Pull up the Fixer Lever (B), and then pull it forward.

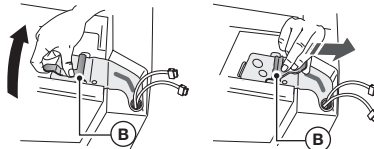

4. Remove the Hinge (C).

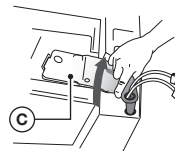

5. Lift up the Fridge Door and take it off.



- While disassembling and reassembling the door, make sure that the electric wires are not peeled off.
- Do not let the door fall down.

DISASSEMBLE THE FREEZER DOORS



- Be sure to remove the Fridge Door before removing the Freezer Door.
- Be careful with the wires attached to the bottom of the Freezer Door while disassembling.

1. With the door open, remove the screw holding the cover (A) of the Adjustable Leg at the bottom of the door with a Phillips (+) Screwdriver, and then disassemble the Connector (B).

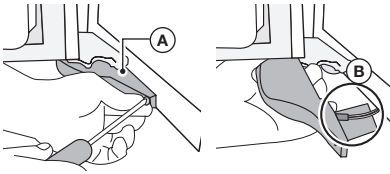

2. Lift up and remove the Mid Hinge Cap (C) on the Door Hinge above the Freezer Door.

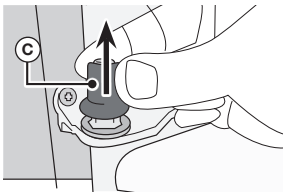

3. While pushing the door in the direction of the arrow, lift up the Mid Hinge Shaft (D).

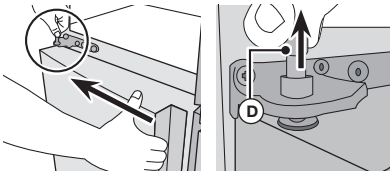

4. Being careful that the door does not touch the Mid Hinge (E), tilt the Door forward a little, and then lift it up to remove.

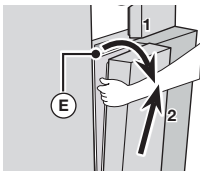

RE-ATTACHING THE REFRIGERATOR DOORS



- Be sure to re-attach the Freezer Door before re-attaching the Fridge Door.
- Before re-attaching, make sure that all the wire connectors at the bottom of the Freezer Door are connected.

How to Re-attach the Freezer Door

1. Insert the door into the lower hinge (A) in the direction of (1) and then push the door in the direction of (2). Take care not to scratch the door with the Mid-Hinge (B).

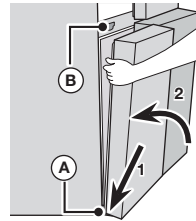

- Be careful not to damage the wires on the bottom of the door. Avoid stepping on them, etc.

2. Insert the Hinge Shaft (C) into the Mid Hinge Hole (D) and put on the Hinge Cap (E).



- When assembling the Hinge Shaft and the Hinge Cap, be sure to assemble them in the correct direction.

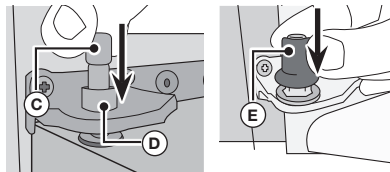

3. With the door open, join the connectors on the bottom of the door.

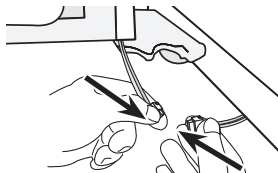

- Be careful not to step on or damage the connectors.

4. Attach the Adjustable Leg Cover using a Phillips (+) Screwdriver.

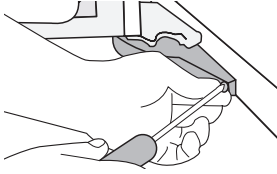

How to Assemble Fridge Door

1. Attach the detached Fridge Door to the Mid Hinge.



2. Slide the Fridge Hinge (C) into the fixing slot, and then press it down so that it is aligned with the hole in the door.

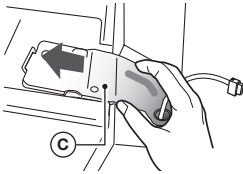

3. Inserting the Fixer Lever (B) in the direction of the arrow, and then flip it down to assemble.

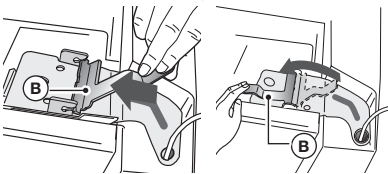

4. Assemble the Wire Connector.

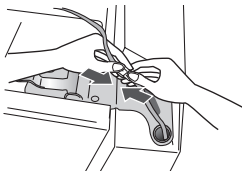

5. Connect the Water Tube [E]. If the model has red clips, attach them now to the Coupler [F]. Connect the connector [G] on the left door and the connector [H] on the right door.

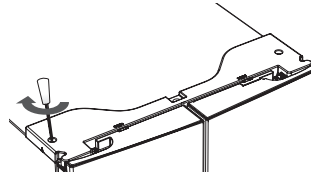

- Assemble the Door in the reverse order of the disassembling. It is the same for both of the Fridge and the Freezer Doors.
- When the Wire Connectors are being cross-assembled, the display may not work normal.

LEVELING THE REFRIGERATOR AND ADJUSTING HEIGHT AND GAP OF THE DOORS

HOW TO LEVEL THE REFRIGERATOR

If the Refrigerator is put on a floor that is not level, it can cause a height difference between the doors.

- Insert a Flat-Head (-) Screwdriver into the slot in the Leveling Leg Control Lever and adjust the level by turning the Control Lever clockwise or counter-clockwise. When you rotate the Lever clockwise, you raise the refrigerator. When you rotate the Lever counter-clockwise, you lower the refrigerator.

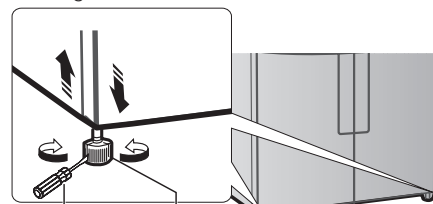

flat-blade screwdriver(-)

Control Lever



- If the Refrigerator is not level back and front, put a solid panel (such as a plastic panel, a plastic ruler, etc.) on the floor where the rear legs will rest, and then fix it in place with plastic tape. When you push in the Refrigerator, make sure the rear legs rest on the panel.
- If you have a wooden floor or similar soft floor, take care not to damage the floor when pushing the Refrigerator into place.

HOW TO ADJUST THE DOOR HEIGHT

If any one of the doors is lower than the other:

- Check if the Refrigerator is level before adjusting the door.
- Adjust the door height difference by inserting a Snap Ring (1) as shown between the door and the hinge. You can use the rings on the right side door of the fresh food compartment and both sides of the freezer compartment.

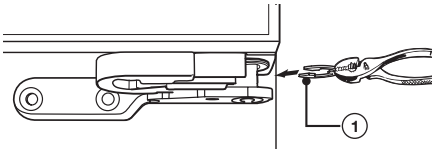
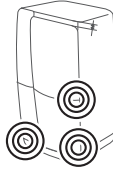

- After checking the height difference, select one Snap Ring with a suitable thickness. Insert one Snap Ring only, Inserting two or more Snap Rings may cause the Snap Rings to slip out or make a rubbing noise.
- Lift up the lower door and insert the Snap Ring into the space between the Door and the Hinge.



- To avoid injury, insert or remove Snap Rings carefully.
- Keep the Snap Rings out of the reach of children and make sure that children do not play with them or put them into their mouths.



- 1 mm, 1.5 mm, 2 mm, and 2.5 mm Snap Rings come with the Refrigerator.
- If the Refrigerator is level before you load it with food, the Refrigerator may become unbalanced due to the weight of the food. If this occurs, adjust the level again using the same procedure.
- If you raise the door too far, it can rub against the Top Cover.

Snap Rings included with the refrigerator:

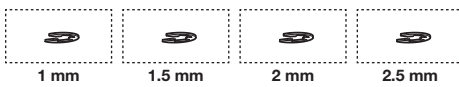

HOW TO ADJUST THE DOOR GAP

If the gap between the left and right fridge compartment doors is not even.

- You can adjust the gap by turning the bolt at the top right of the cold storage compartment door.
- Do not turn the bolt too far. You can break it.

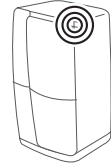

1. With the doors closed, remove the 3 screws holding the top cover using a Phillips screwdriver, and then lift it off together with the connected cables.

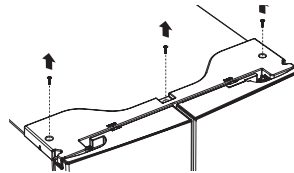

2. Turn the bolt with a 4 mm hexagonal L-wrench to adjust the gap. (Not provided)

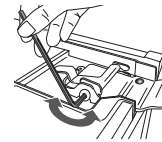

3. Turn the bolt clockwise (↻) to widen the gap. Turn the bolt counter clockwise (↺) to narrow the gap.

operating your samsung refrigerator

USING THE CONTROL PANEL

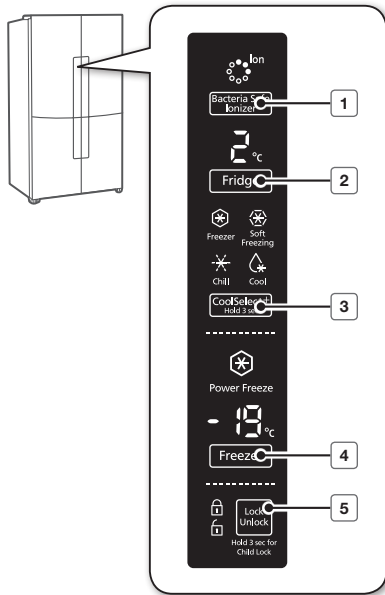

1 Bacteria Safe Ionizer (Optional)

Press the Bacteria Safe Ionizer button to remove any floating or attached germs. Press this button to turn the function on or off.

If you press the Bacteria Safe Ionizer button, () is turned on.

2 Fridge

Press the Fridge button to set the fridge to desired temperature from the range between 1 °C and 7 °C. Default set temperature is set on 3 °C and each time you press the Fridge button, temperature will change in following order and temperature indicator will display the desired temperature.

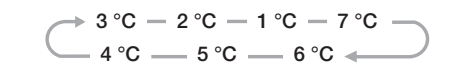

3 CoolSelect+ (Cool Select Room)

The CoolSelect button lets you set the Cool Select Room on the bottom right of your refrigerator to one of four settings: Freezer, Soft Freezing, Chill, or Cool. Press the CoolSelect button for three seconds to activate the Cool Select Room function, and then select one of the four settings.

Freezer ❄️

Select Freezer to set the Cool Select Room to the same temperature as the freezer.

- Use this setting to keep frozen food fresh.

Soft Freezing ❄️

- Select Soft Freezing to set the temperature in the Cool Select Room to -5 °C. This feature helps keep meat and fish fresh longer.

Chill ❄️

- Select Chill to set the temperature of the Cool Select Room to -1 °C.

Cool ❄️

- Select Cool to set the temperature of the Cool Select Room to 5 °C. You can keep water, juice, soft drinks, beer, etc. cold.



- When shifting its function after using the [Freezer] function, meat blood or water may come out of meat or water containing food.

- If meat or fish is stored at the [Fridge] setting, it may get deteriorated. When food is not stored according to the settings of the Cool Select Room, the food may get frozen or deteriorated.



- When the button does not work, check if it is set to the Lock. When it is locked, press the Lock/Unlock button for 3 seconds or more until the Unlock Icon () lights on. And then, change the setting by pressing the Cool Select Room for 3 seconds or more.
- When the setting is complete, check the display one more time to see if the setting is correct.

4 Freezer

Press the Freezer button to set the freezer to desired temperature from the range between -15°C and -23°C . Default set temperature is set on -19°C and each time you press the Freezer button, temperature will change in following order and temperature indicator will display the desired temperature.

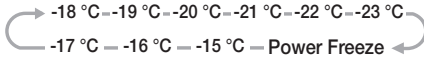

The Freezer or Fridge temp indicator will blink when the temperature in the fridge or freezer compartment goes up dramatically.

(Freezer or Fridge temperature indicator will stop blinking when temperature in the Freezer or Fridge becomes normal. If temperature indicator does not stop blinking after several hours, please contact your service center.

Power Freeze

The Power Freeze function substantially speeds up the freezer compressor, causing the freezer to cool down rapidly to a temperature you choose. This icon will light up when you press and hold the Freezer button for 3 seconds.

Power Freeze is useful if you need to quick freeze an item, to make a large quantity of ice, or to cool the freezer rapidly if it has warmed dramatically (for example, if the door was left open).

To turn the Power Freeze function off manually, press the Freezer button, and then re-set the Freezer temperature. Power Freeze turns off automatically after 50 hours to decrease energy consumption. When the Power Freeze function stops automatically, it automatically sets the Freezer temperature to -19°C . Re-set the temperature if necessary. When you use this function, the energy consumption of the refrigerator will increase. If you need to freeze large amounts of food, activate the Power Freeze function at least 20 hours before.

5 Lock Unlock

Pressing this button for 3 seconds locks the all buttons so the buttons can not be used.

Also, press this button again for 3 seconds unlocks the all buttons.

PARTS AND FEATURES

Use this page to become more familiar with the parts and features of the Refrigerator.

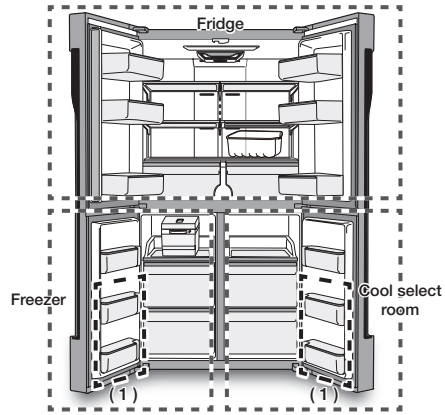

The door guards in the freezer of this model are the two star sections except the top guard, so the temperature in two star sections are slightly higher than other freezer compartment. 1 is two star section.

FEATURES OF THE BACTERIA SAFE IONIZER (OPTIONAL)

- Each time you open and close the refrigerator door, invisible airborne germs make their way inside your refrigerator. These germs attach themselves to the walls and surfaces inside the refrigerator. Bacteria Safe Ionizer, which features advanced SPI - 2 (Super Plasma Ion II) technology, eliminates these germs effectively.
- Bacteria Safe Ionizer also features a solar power deodorizer with more than twice the standard deodorization power. Bacteria Safe Ionizer can be used semi-permanently without the need to replace or clean its parts.

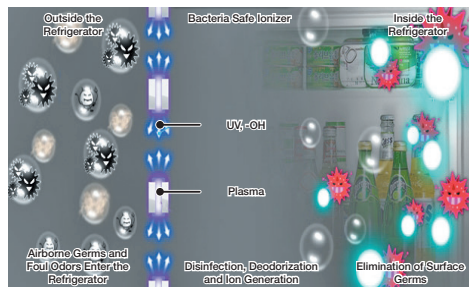

ICE STORAGE BOX

It is to store ice cubes. When there is no ice consumption, take the container out of the refrigerator to get more storage room.

How to Use the Ice Storage Box

1. Support Ice Tray

Support Ice Tray it prevents any foreign substances from entering into ice.

2. Ice Tray

It is used to make ice cubes.

3. Ice Bin

It is used to store ice cubes being made.

- Store the ice cubes being made by turning the Ice Tray knob clockwise (↻).
- All the ice cubes may not get separated from the tray at once. If so, twist the Ice Tray multiple times.
- Frozen green tea or milk may be difficult to separate from the Ice Tray.
- Lift up the ice bin and pull it out to remove it.



- Do not pour water into the transparent Ice Bin for the storage of the ice cubes. The Ice Bin may get cracked.

- There is a water drain hole in the bottom of the transparent Ice Bin which is designed to prevent water from being held inside.
- When storing the ice cubes at the above-zero temperature, ice may get melt down flowing out of the Ice Bin.
- Ice may get melt down flowing out of the Ice Bin due to power outage for a while. Also, when the melt water gets frozen again, it may break the Ice Bin. (Use the Ice Bin after removing melt water.)

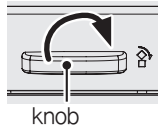

FRIDGE MULTI-PURPOSE DOOR BIN

A detachable divider makes it convenient to store food.

Food products can be stored by items.

- Put the divider in place when storing slim-size condiment bottles and canned drinks together.
- Take out the divider when storing carton-size milks or drinks.

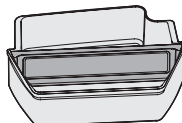

REMOVING THE REFRIGERATOR ACCESSORIES

1. Door Bins Compartment

To remove - Simply lift the bin up and pull straight out.

To relocate - Slide it in above the desired location and push down until it stops.



Injuries can occur if the door bins are not firmly attached to the doors. Do not allow children to play with bins. Sharp corners of the bins may cause injury.



Do not adjust a bin full of food. Remove the food first.

Dust removal method - Remove the guard and wash in water.

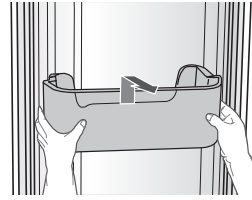

2. Tempered Glass shelves

To remove - Tilt up the front of the shelf in the direction shown (1) and lift it up vertically (2). Pull the shelf out.

To relocate - Tilt the front of the shelf up and guide the shelf hooks into the slots at a desired height. Then, lower the front of the shelf so that the hooks can drop into the slots.



The Tempered Glass shelves are heavy. Use special care when removing them.

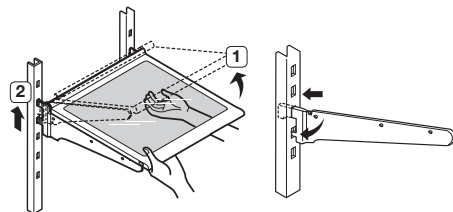

3. Vegetable & Fruit Drawers (EZ Fresh Zone)

Holding the drawer with one hand, lift it up a little bit while pulling it forward, and then pull it out of the refrigerator.

-  Remove the door bins before removing the drawer to prevent damage to the door bins.

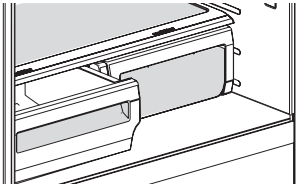

4. Deodorizer
 - Clean the deodorizer every 2 years or when odors are no longer effectively removed.

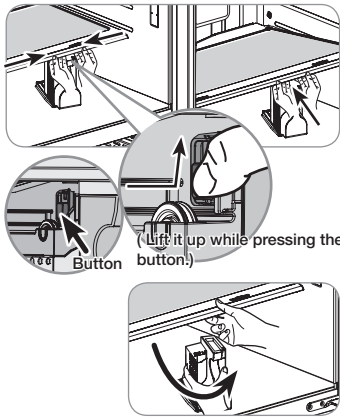

- Remove the entire EZ fresh Zone and lift the EZ fresh Zone shelf up to remove the deodorizer cover.
- To lift the EZ fresh Zone shelf up, lift it up pressing the buttons indicated on both sides.
- Hold the EZ fresh Zone shelf with one hand and remove the deodorizer cover by lifting it slightly. (There is a hook at the bottom).
- Remove the deodorizer below the deodorizer cover, dry it in the sun for approximately 24 hours and reassemble it in the reverse order of the disassembly.



- Reassembly is in the reverse order of the disassembly. Once it is properly assembled, it clicks into place.
- Reassemble the parts confirming that the deodorizer cover and the EZ fresh Zone shelf are properly assembled.

CLEANING THE REFRIGERATOR



Do not use benzene, thinner, Clorox, or car detergent to clean the refrigerator. They can damage the surface of the appliance and may cause a fire.

Do not spray the refrigerator with water while it is plugged in. This can cause an electric shock. To clean the refrigerator, follow these steps:

1. Unplug the power cord of the refrigerator.
2. Slightly dampen a soft lint-free cloth or paper towel with water.



Do not use any kind of detergent to clean the refrigerator because that can discolor or damage the refrigerator.

3. Wipe the inside and outside of refrigerator until it is clean and dry.
4. Plug the power cord of the refrigerator back in.

CHANGING THE INTERIOR LIGHTS

Freezer / Fridge LED Lamp

- If the LED Lamp Cover is stained with foreign substances, the LED lamp may not look bright. Wipe the surface cover with clean dry cloth to return the light to full brightness.



Do not disassemble or replace the LED type lighting yourself. To replace the LED lights, contact a Samsung service center or your authorized Samsung dealer.



If you attempt to replace the LED lamps yourself, you risk subjecting yourself to an electric shock or serious personal injury.

troubleshooting

PROBLEM	SOLUTION
The refrigerator does not work at all or it does not chill sufficiently.	<ul style="list-style-type: none"> • Check that the power plug is properly connected. • Check if the set temperature on the digital display is warmer than the freezer or fridge inner temperature. If it is, set the freezer or fridge to a colder temperature. • Is the refrigerator in direct sunlight or located near a heat source? • Is the back of the refrigerator too close to the wall, preventing proper ventilation?
The food in the fridge is frozen.	<ul style="list-style-type: none"> • Check if the set temperature on the digital display is too low. • Try setting the refrigerator to a warmer temperature. • Is the temperature in the room too low? Set the refrigerator warmer. • Did you store the food which is juicy in the coldest part of the refrigerator? Try moving those items to the other shelves in fridge instead of keeping them in the colder areas or bins.
You hear unusual noise or sounds.	<ul style="list-style-type: none"> • Check that the refrigerator is level and stable. • Is the back of the refrigerator too close to the wall, preventing proper ventilation? Try moving the back of the refrigerator at least 50 mm from the wall. • Was anything dropped behind or under the refrigerator? • A “ticking” sound is heard from inside the refrigerator. It is normal and occurs because various accessories are contracting or expanding in response to temperature changes in the refrigerator interior. • If it sounds as if something is hitting something else inside the refrigerator, this is normal. The sound is caused by the compressor operating at high capacity.
The cabinet-door sealing area of the appliance is hot and condensation is occurring.	<ul style="list-style-type: none"> • Some heat is normal as anti-condensators are installed in the vertical hinged section of the refrigerator to prevent condensation. • Is the refrigerator door ajar? Condensation can occur when you leave the door open for a long time.
You can hear water bubbling in the refrigerator.	<ul style="list-style-type: none"> • This is normal. The bubbling comes from refrigerant circulating through the refrigerator.
There is a bad smell in the refrigerator.	<ul style="list-style-type: none"> • Check for spoiled food. • Foods with strong odors (for example, fish) should be tightly covered. • Clean out your freezer periodically and throw away any spoiled or suspicious food.
Frost forms on the walls of the freezer.	<ul style="list-style-type: none"> • Is the air vent blocked? Remove any obstructions so air can circulate freely. • Allow sufficient space between the stored food for efficient air circulation. • Is the freezer drawer closed properly?

memo

Ambient Room Temperature Limits

This refrigerator is designed to operate in ambient temperatures specified by its temperature class marked on the rating plate.

Class	Symbol	Ambient Temperature range (°C)	
		IEC 62552 (ISO 15502)	ISO 8561
Extended Temperate	SN	+10 to +32	+10 to +32
Temperate	N	+16 to +32	+16 to +32
Subtropical	ST	+16 to +38	+18 to +38
Tropical	T	+16 to +43	+18 to +43



Internal temperatures may be affected by such factors as the location of the fridge/freezer, ambient temperature and the frequency with which you open the door.

Adjust the temperature as required to compensate for these factors.

English



Correct Disposal of This Product (Waste Electrical & Electronic Equipment)

(Applicable in countries with separate collection systems)

This marking on the product, accessories or literature indicates that the product and its electronic accessories (e.g. charger, headset, USB cable) should not be disposed of with other household waste at the end of their working life. To prevent possible harm to the environment or human health from uncontrolled waste disposal, please separate these items from other types of waste and recycle them responsibly to promote the sustainable reuse of material resources.

Household users should contact either the retailer where they purchased this product, or their local government office, for details of where and how they can take these items for environmentally safe recycling.

Business users should contact their supplier and check the terms and conditions of the purchase contract. This product and its electronic accessories should not be mixed with other commercial wastes for disposal.

Contact SAMSUNG WORLD WIDE

If you have any questions or comments relating to Samsung products, please contact the SAMSUNG customer care center.

COUNTRY	CALL	Web site
AUSTRIA	0800 - SAMSUNG (0800 - 7267864)	www.samsung.com/at/support
COLOMBIA	Bogotá 600 12 72 Gratis desde cualquier parte del país 01 8000 112 112 ó desde su celular #SAM(726)	www.samsung.com/co/support
EIRE	0818 717100	www.samsung.com/ie/support
HONG KONG	(852) 3698-4698	www.samsung.com/hk/support (Chinese) www.samsung.com/hk_en/support (English)
INDIA	1800 3000 8282 - Toll Free 1800 266 8282 - Toll Free	www.samsung.com/in/support
MALAYSIA	1800-88-9999 603-77137477 (Overseas contact)	www.samsung.com/my/support
NEW ZEALAND	0800 726 786	www.samsung.com/nz/support
PANAMA	800-7267 800-0101	www.samsung.com/latin/support (Spanish) www.samsung.com/latin_en/support (English)
PHILIPPINES	1-800-10-7267864 [PLDT] 1-800-8-7267864 [Globe landline and Mobile] 02-4222111 [Other landline]	www.samsung.com/ph/support
SINGAPORE	1800-SAMSUNG(726-7864)	www.samsung.com/sg/support
SOUTH AFRICA	0860 SAMSUNG (726 7864)	www.samsung.com/support
UK	0330 SAMSUNG (7267864)	www.samsung.com/uk/support



DA68-02836F-06