

WF8600NG(A/C/D/F/G/H/R/S/T/V/W/Z)

Washing Machine

user manual

imagine the possibilities

Thank you for purchasing this Samsung product.
To receive more complete service, please register
your product at

www.samsung.com/hk

SAMSUNG

features of your new samsung washing machine

Your new washing machine will change the way you feel about doing laundry. From its super-size capacity to its energy efficiency, the Samsung washing machine has all the features to turn a mundane chore into a pleasure.

- **Standard/ Intensive**

This program has a unique apperceiving function. It can apperceive the laundry weight automatically to select an appropriate water level, and so that saves more energy.

- **Child Lock**

The Child Lock function ensures that curious little hands are kept out of your washing machine.

This safety feature stops your children from playing with the operation of the washing machine, and alerts you when it is activated.

- **Delay End**

Delay a cycle for up to 19 hours in one-hour increment and increase the convenience of using your washing machine especially when you have to go out.

- **Quick Wash**

No time to lose! Less than 30 minutes wash will give you time to run out before it's too late.

Our 28 minute Quick Wash program can be the solution to your busy life. Now you can wash your favourite clothes in only 28 minutes!

- **Delicates & Hand Wash Program**

Special care can be determined by the appropriate temperature, the gentle wash action and the appropriate amount of water.

- **Enzyme**

Selecting Enzyme can keep the wash temperature 40~95 °C, which is the best condition for wash.

- **Ceramic Heater for Durability & Energy Saving (selected models)**

Our truly innovative Ceramic Heater is twice as durable as regular heaters.



That saves you money on repairs. Plus, it eliminates the scale of hard water and save energy.

- **Wide door**

Extra wide door aperture for convenient viewing! Easily add and remove laundry, especially for large sized laundry items such as bedding, towels etc.











This manual contains important information on the installation, use, and care of your new Samsung washing machine. Refer to it for descriptions of the control panel, instructions on how to use the washing machine, and tips for making the most of its state-of-the-art features and functions. The “**Troubleshooting and information codes**” section on page 29 tells you what to do if something goes wrong with your new washing machine.

safety information

Throughout this manual, you'll see Warning  and Caution  notes. These warnings, cautions, and the important safety instructions that follow do not cover all possible conditions and situations that may occur. It's your responsibility to use common sense, caution, and care when installing, maintaining, and operating your washing machine. Samsung is not liable for damages resulting from improper use.

IMPORTANT SAFETY SYMBOLS AND PRECAUTIONS

What the icons and signs in this user manual mean:

 WARNING	Hazards or unsafe practices that may result in severe personal injury or death .
 CAUTION	Hazards or unsafe practices that may result in minor personal injury or property damage .
 CAUTION	To reduce the risk of fire, explosion, electric shock, or personal injury when using your washing machine, follow these basic safety precautions:
	Do NOT attempt.
	Do NOT disassemble.
	Do NOT touch.
	Follow directions explicitly.
	Unplug the power plug from the wall socket.
	Make sure the machine is grounded to prevent electric shock.
	Call the service center for help.
	Notice

These warning signs are here to prevent injury to you and others.

Please follow them explicitly.

After reading this section, keep it in a safe place for future reference.

 Read all instructions before using the appliance.

As with any equipment using electricity and moving parts, potential hazards exist. To safely operate this appliance, become familiar with its operation and exercise care when using it.

Install and store your washing machine inside, away from exposure to weather.

Install and level your washing machine on a floor that can support its weight.

 Your washing machine must be properly grounded. Never plug it into an ungrounded outlet.



To reduce the risk of fire or explosion:

- Do not wash items that have been washed, soaked, or treated with gasoline, dry cleaning solvents, or other flammable or explosive substances. They give off vapors that could ignite or explode. Rinse by hand any material that has been exposed to cleaning solvent or other flammable liquids or solids before putting in your washing machine. Be sure that all traces of such liquids, solids, and fumes have been removed. Dangerous substances include acetone, denatured alcohol, gasoline, kerosene, certain liquid household cleaners and spot removers, turpentine, waxes, and wax removers.
- Do not put gasoline, dry cleaning solvents, or other flammable or explosive substances into the washing machine.
- Under certain conditions, hydrogen gas may be produced in a hot water system—such as your hot water heater -- that has not been used for two weeks or more. **HYDROGEN GAS IS EXPLOSIVE.** If your hot water system has not been used for two weeks or more, turn on all hot water taps in your home, and let the water flow for several minutes before using your washing machine. This will release any hydrogen gas build-up. Since hydrogen gas is flammable, do not smoke or light an open flame during this time.

Ventilate immediately without touching the power plug if there is a gas leak.



Unplug the power cord before servicing your washing machine.

Before each wash, empty the pockets of your laundry. Small, irregularly shaped hard objects, such as coins, knives, pins, and paperclips could damage your washing machine. Do not wash clothing with large buckles, buttons, or other heavy metal metal.

Do not open the door of the washing machine if you can still see water. Check that the water has drained before opening the door.



Do not repair, replace, or service any part of your washing machine yourself unless you fully understand the recommended user-repair instructions and have the skills to carry them out. Work done by an unauthorized person may void your warranty.

Connect the washing machine to the water mains using the new set of hoses. Do not reuse the old set of hoses.

Water inlet hoses deteriorate over time. Check the hoses periodically for bulges, kinks, cuts, wear, and leaks, and replace them as needed and at least every five years.

All packaging and shipping bolts must be removed before the appliance is used. Serious damage may occur if they are not removed. See page 12 "Removing the shipping bolts".



Before washing clothes for the first time, you must run a complete cycle without clothes. See "Washing for the first time".

safety information

The appliance is designed for home use only.



Make sure that water and electrical connections are made by qualified technicians, observing the user manual (see “Installing your washing machine”) and local safety regulations.



Before cleaning or carrying out maintenance, unplug the appliance from the electrical outlet.

Always unplug the appliance and turn off the water after use.

Make sure that the pockets of all clothing to be washed are empty.

Hard, sharp objects, such as coins, safety pins, nails, screws, or stones can cause extensive damage to the appliance.

Never allow pets and children to play on or in the appliance. It may cause injury or suffocate them.

The glass door becomes very hot during the washing cycle. Never touch on the glass door while it is in use.



Do not attempt to repair the appliance yourself. Repairs made by inexperienced or unqualified persons may cause injury and/or make more serious repairs to the appliance necessary.

If the plug (power supply cord) is damaged, it must be replaced by the manufacturer or its service agent or a similarly qualified person in order to avoid a hazard.

This appliance should only be serviced by our authorized service center, and only rated spare parts should be used.



Do not let children (or pets) play on or in your washing machine. The washing machine door does not open easily from the inside, and children may be seriously injured if trapped inside.



This appliance is not intended for use by persons (including children) with reduced physical, sensory or mental capabilities, or lack of experience and knowledge, unless they have been given supervision or instruction concerning use of the appliance by a person responsible for their safety.

Children should be supervised to ensure that they do not play with the appliance.

To use this appliance safely, the user should become familiar with the instructions for operation of the appliance and always take extra care when using it.

This appliance should be positioned to be accessible to the power plug, the water supply tabs and the drain pipes.



Packing materials can be dangerous to children; keep all packing material (plastic bags, polystyrene, etc.) well out of the reach of children.

Do not use processed water containing oil, cream or lotion, which is usually found in skincare shops or massage clinics.

- Otherwise this will cause the packing to be deformed, which causes a malfunction or water leak.

A stainless washing tub does not usually rust. However if some metal such as a hair pin is left in the tub for an extended time, the tub could rust.

- Do not leave water or bleach containing chlorine in the tub for an extended period of time.
- Do not regularly use or leave water containing iron in the tub for an extended period of time. If rust starts appearing on the surface of the tub, apply a cleansing agent (neutral) to the surface and use a sponge or soft cloth to clean it. (Under no circumstances use a metal brush)

For washing machines with ventilation openings in the base, ensure that the opening is not obstructed by carpet or any other obstacles.

Use the new hose-sets and old hose-sets should not be reused.

Instruction about the WEEE mark



This marking shown on the product or its literature, indicates that it should not be disposed with other household wastes at the end of its working life. To prevent possible harm to the environment or human health from uncontrolled waste disposal, please separate this from other types of wastes and recycle it responsibly to promote the sustainable reuse of material resources.

Household users should contact either the retailer where they purchased this product, or their local government office, for details of where and how they can take this item for environmentally safe recycling.

Business users should contact their supplier and check the terms and conditions of the purchase contract. This product should not be mixed with other commercial wastes for disposal.

contents

SETTING UP YOUR WASHING MACHINE

9

- 9 Checking the parts
- 10 Meeting installation requirements
- 10 Electrical supply and grounding
- 10 Water Supply
- 11 Drain
- 11 Flooring
- 11 Surrounding temperature
- 11 Alcove or closet installation
- 11 Installing your washing machine

WASHING A LOAD OF LAUNDRY

17

- 17 Washing for the first time
- 17 Basic instructions
- 18 Using the control panel
- 20 Child lock
- 20 Sound off
- 20 Delay end
- 21 Washing clothes using fuzzy logic
- 22 Washing clothes manually
- 22 Laundry guidelines
- 24 Detergent and additives information
- 24 Which detergent to use
- 24 Detergent drawer

CLEANING AND MAINTAINING YOUR WASHING MACHINE

25

- 25 Draining the washing machine in an emergency
- 25 Cleaning the exterior
- 26 Cleaning the detergent drawer and drawer recess
- 27 Cleaning the debris filter
- 27 Cleaning the water hose mesh filter
- 28 Repairing a frozen washing machine
- 28 Storing your washing machine

TROUBLESHOOTING AND INFORMATION CODES

29

- 29 Check these points if your washing machine...
- 30 Information codes

CYCLE CHART

31

- 31 Cycle chart

APPENDIX

32

- 32 Fabric care chart
- 32 Protecting the environment
- 32 Declaration of conformity
- 33 Specifications

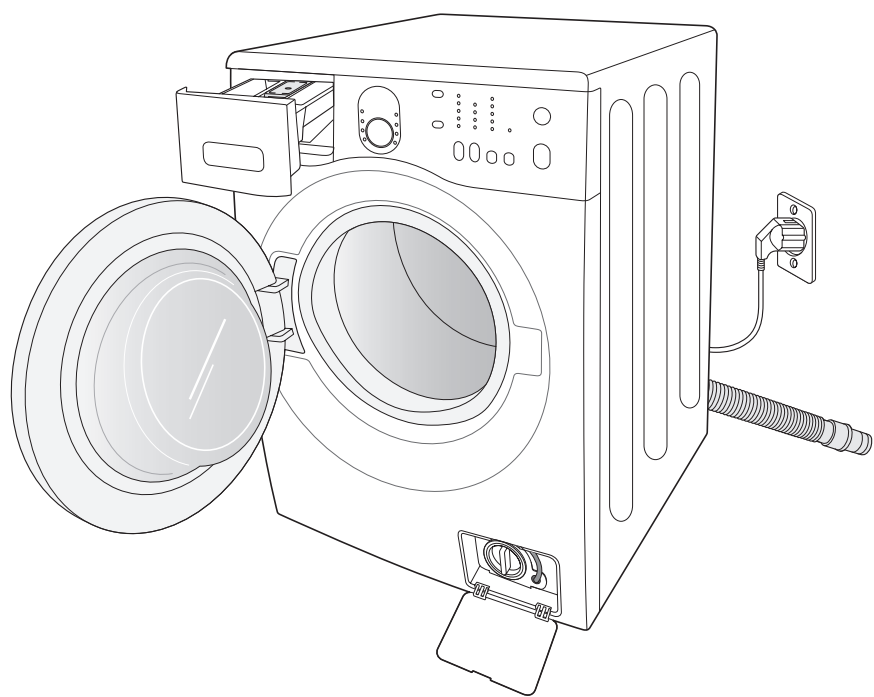

setting up your washing machine

MEETING INSTALLATION REQUIREMENTS

Electrical supply and grounding

To prevent unnecessary risk of fire, electrical shock, or personal injury, all wiring and grounding must be done in accordance with the National Electrical Code ANSI/FNPA, No. 70 Latest Revision and local codes and ordinances. It is the personal responsibility of the appliance owner to provide adequate electrical service for this appliance.



Never use an extension cord.
WARNING Use only the power cord that comes with your washing machine.

When preparing for installation, ensure that your power supply offers:

- 220V~240V 50Hz 15 AMP fuse or circuit breaker
- Individual branch circuit serving only your washing machine

Your washing machine must be grounded. If your washing machine malfunctions or breaks down, grounding will reduce the risk of electric shock by providing a path of least resistance for the electric current.

Your washing machine comes with a power cord having a three-prong grounding plug for use in a properly installed and grounded outlet.



Never connect the ground wire to plastic plumbing lines, gas lines, or hot water pipes.

Improperly connecting the equipment-grounding conductor can result in electrical shock. Check with a qualified electrician or serviceman if you are unsure if the washing machine is properly grounded. Do not modify the plug provided with the washing machine. If it does not fit the outlet, have a proper outlet installed by a qualified electrician.

Water Supply

Your washing machine will fill properly when your water pressure is 50 kPa ~ 800 kPa. Water pressure less than 50 kPa may cause water valve failure, not allowing the water valve to shut off completely. Or, it may take the washing machine longer to fill than what the controls allow, resulting in your washing machine turning off. (A fill-time limit, designed to prevent overflows/flooding if an internal hose becomes loose, is built into the controls.)

The water taps must be within 4 feet (122cm) of the back of your washing machine for the provided inlet hoses provided to reach your washing machine.



Most plumbing supply stores sell inlet hoses of various lengths up to 10 feet (305cm) long.

You can reduce the risk of leaks and water damage by:

- Making water taps easily accessible.
- Turning off taps when the washing machine is not in use.
- Periodically checking for leaks at water inlet hose fittings.



WARNING Before using your washing machine for the first time, check all connections at the water valve and taps for leaks.

Drain

Samsung recommends a standpipe height of 18 in (46 cm). The drain hose must be routed through the drain hose clip to the standpipe. The standpipe must be large enough to accept the outside diameter of the drain hose. The drain hose is attached at the factory.

Flooring

For best performance, your washing machine must be installed on a solidly constructed floor. Wood floors may need to be reinforced to minimize vibration and/or unbalanced loads. Carpeting and soft tile surfaces are contributing factors to vibrations and the tendency for your washing machine to move slightly during the spin cycle.

Never install your washing machine on a platform or poorly supported structure.

Surrounding temperature

Do not install your washing machine in areas where water may freeze, since your washing machine always retains some water in its water valve, pump, and hose areas. Frozen water in the lines can cause damage to belts, the pump, and other components.

Alcove or closet installation

To operate safely and properly, your new washing machine requires minimum clearances of:

Sides – 25 mm

Rear – 51 mm

Top – 25 mm

Front – 465 mm

If both the washing machine and a dryer are installed together, the front of the alcove or closet must have at least 465 mm unobstructed air opening. Your washing machine alone does not require a specific air opening.

INSTALLING YOUR WASHING MACHINE

STEP 1

Selecting a location



Before you install the washing machine, make sure the location:

- Has a hard, level surface without carpeting or flooring that may obstruct ventilation
- Is away from direct sunlight
- Has adequate ventilation
- Will not be freezing (below 32 °F or 0 °C)
- Is away from heat sources such as oil or gas
- Has enough space so that the washing machine doesn't stand on its power cord

setting up your washing machine

STEP 2

Removing the shipping bolts

Before installing the washing machine, you must remove the five shipping bolts from the back of the unit.

1. Loosen all the bolts with the supplied wrench.

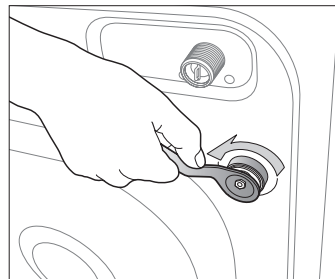

2. Hold the bolt with the spanner and pull it through the wide section of the hole. Repeat for each bolt.

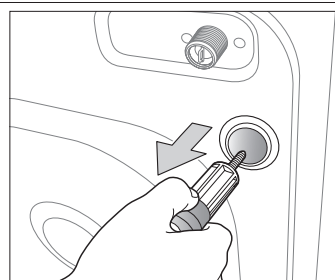

3. Fill the holes with the supplied plastic covers.

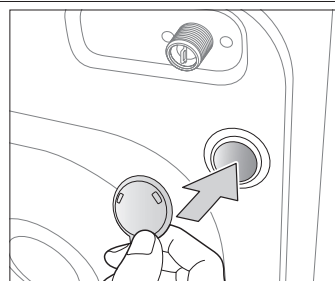

4. Store the shipping bolts away safely in case you have to move the washing machine in the future.



WARNING

Packaging materials can be dangerous to children; keep all packaging material (plastic bags, polystyrene, etc.) well out of the reach of children.



Insert the cap fixer, (one of the accessories in the vinyl pack), into the hole from which you removed the power cord at the back of the product.

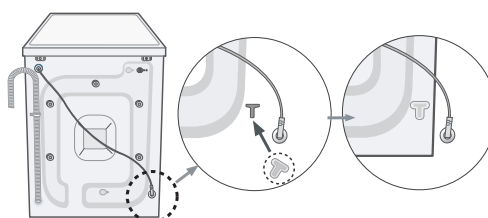

STEP 3

Adjusting the levelling feet

 When installing your washing machine, ensure that the power plug, the water supply and the drain are easily accessible.

1. Slide the washing machine into position.

2. Level your washing machine by turning the levelling feet in and out as necessary by hand.

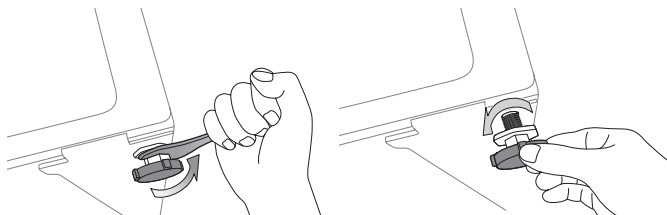

3. When your washing machine is level, tighten the nuts using the wrench supplied with your washing machine.

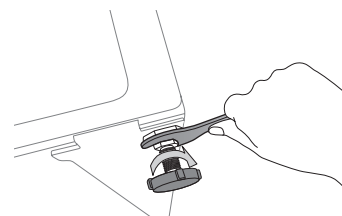

STEP 4

Connecting the water and drain

Connecting the water supply hose

1. Take the L-shaped arm fitting for the cold water supply hose and connect it to the cold water supply intake on the back of the machine. Tighten by hand.

 The water supply hose must be connected to the washing machine at one end and to the water tap at the other. Do not stretch the water supply hose. If the hose is too short, replace the hose with a longer, high pressure hose.

2. Connect the other end of the cold water supply hose to your sink's cold water tap and tighten it by hand. If necessary, you can reposition the water supply hose at the washing machine end by loosening the fitting, rotating the hose, and retightening the fitting.

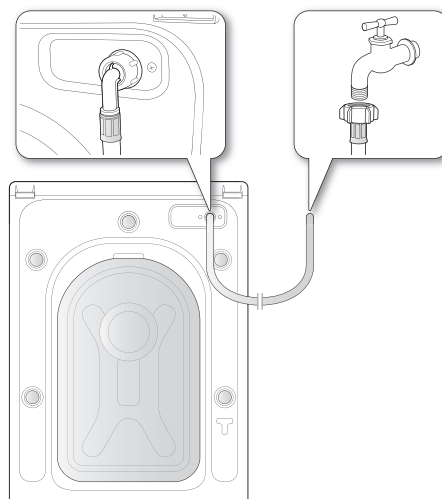

For selected models with an additional hot water intake:

1. Take the red L-shaped arm fitting for the hot water supply hose and connect it to the hot water supply intake on the back of the machine. Tighten by hand.
2. Connect the other end of the hot water supply hose to your sink's hot water tap and tighten it by hand.

setting up your washing machine

Connecting the water supply hose (selected models)

1. Remove the adaptor from the water supply hose.

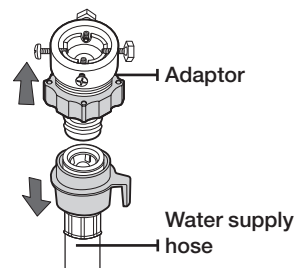

2. First, using a '+' type screwdriver, loosen the four screws on the adaptor. Next, take the adaptor and turn part (2) following the arrow until there is a 5 mm gap.

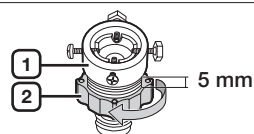

3. Connect the adaptor to the water tap by tightening the screws firmly while lifting the adaptor upwards. Turn part (2) following the arrow and connect (1) and (2).

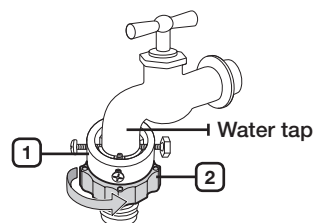

4. Connect the water supply hose to the adaptor. When you release part (3), the hose automatically connects to the adaptor making a 'click' sound.

 After you have connected the water supply hose to the adaptor, ensure that it is connected correctly by pulling the water supply hose downwards.

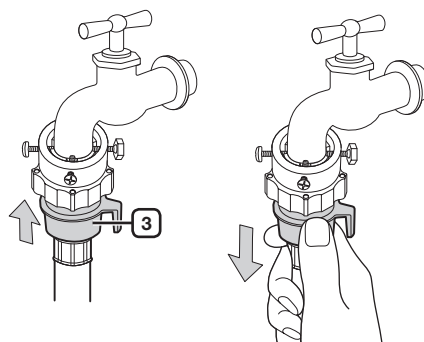

5. Connect the other end of the water supply hose to the inlet water valve at the rear of the washing machine. Screw the hose clockwise all the way in.

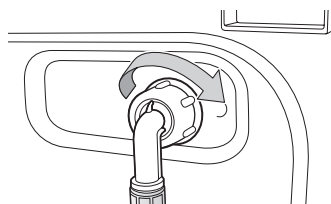

6. Turn on the water supply and ensure that no water leaks from the water valve, tap or adaptor. If there is a water leak, repeat the previous steps.



WARNING

Do not use your washing machine if there is a water leak. This may cause electric shock or injury.

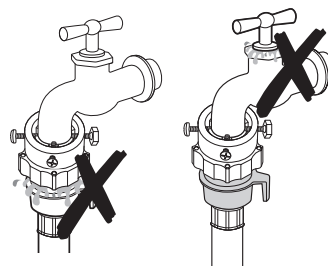

- If the water tap is a screw type tap, connect the water supply hose to the tap as shown.

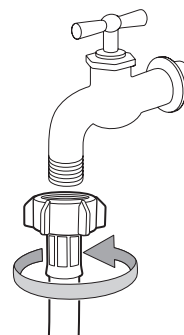

Use the most conventional type of tap for the water supply. In case the tap is square or too big, remove the spacing ring before inserting the tap into the adaptor.

setting up your washing machine

Connecting the drain hose

The end of the drain hose can be positioned in three ways:

1. **Over the edge of a wash basin:** The drain hose must be placed at a height of between 60 and 90 cm. To keep the drain hose spout bent, use the supplied plastic hose guide. Secure the guide to the wall with a hook or to the tap with a piece of string to prevent the drain hose from moving.

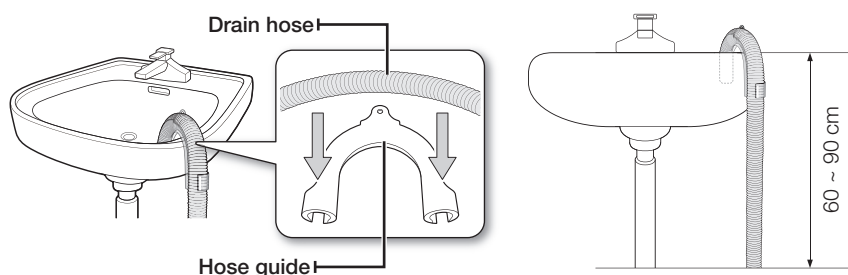

2. **In a sink drain pipe branch:** The drain pipe branch must be above the sink siphon so that the end of the hose is at least 60 cm above the ground.
3. **In a drain pipe:** We recommend using a 65 cm high vertical pipe; it must be no shorter than 60 cm and no longer than 90 cm.

STEP 5

Powering your washing machine

Plug the power cord into a wall socket, a 230 volt 50 Hz approved electrical outlet protected by a 15-amp fuse or comparable circuit breaker. (For more information on electrical and grounding requirements, see page 10.)

washing a load of laundry

With your new Samsung washing machine, the hardest part of doing laundry will be deciding which load to wash first.

WASHING FOR THE FIRST TIME

 Before washing laundry for the first time, you must run a complete empty cycle (i.e. no laundry).

1. Press the **Power** button.
2. Add a little detergent to the detergent compartment ② in the detergent drawer.
3. Turn on the water supply to the washing machine.
4. Turn the Fuzzy Control dial to **Drum Clean**.
5. Press the **Start/Pause** button.

 This will remove any water that might be left over in the machine from the manufacturer's test run.

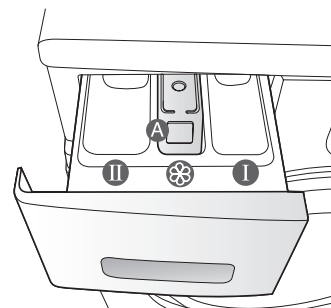

Compartment ①: Detergent for prewash, or starch.

Compartment ②: Detergent for the main wash, water softener, pre-soaking agent, bleach and stain removal product.

Compartment ③: Additives, e.g. fabric softener or former (fill no higher than lower edge (MAX) of "A")

BASIC INSTRUCTIONS

1. Load your laundry into the washing machine.

 **WARNING** Do not overload the washing machine. To determine the load capacity for each type of laundry, refer to the chart on page 23.

-  • Make sure that laundry is not caught in the door, as this may cause a water leak.
- Washing detergent may remain in the front rubber part of the washer after a wash cycle. Remove any remaining detergent, as they may cause a water leak.
- Do not wash waterproof items.
2. Close the door until it latches.
 3. Turn the power on.
 4. Add detergent and additives to the dispenser drawer.
 5. Select the appropriate cycle and options for the load.
The Wash Indicator light will illuminate and the estimated cycle time will appear in the display.
 6. Press the **Start/Pause** button.

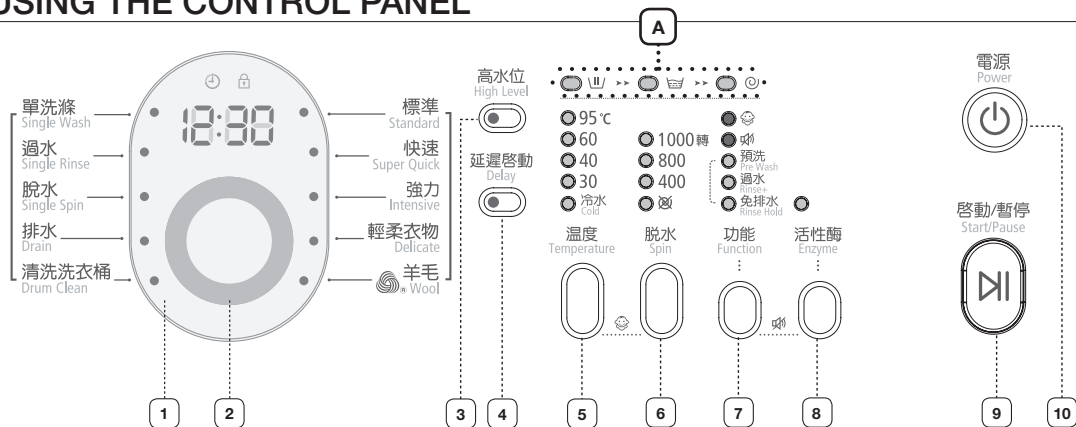

washing a load of laundry

USING THE CONTROL PANEL



A part indicates the washing process: (Wash)- (Rinse)- (Spin).

1 DIGITAL GRAPHIC DISPLAY	<p>Displays the remaining wash cycle time, all cycle information, and error messages.</p> <p>Select the tumble pattern and spin speed for the cycle.</p> <p> For detailed information, refer to “Washing clothes using the Fuzzy Control dial”.</p> <p>Standard - For averagely or lightly soiled cotton, bed linen, table linen, underwear, towels, shirts, etc.</p> <p>Super Quick - For lightly soiled garments that you require quickly.</p> <p>Intensive - Select the pattern when the laundry is heavily soiled and needs to be washed intensively. The cycle time is increased for each cycle.</p> <p>Delicates - For sheer fabrics, brassieres, lingerie, dresses, shirts and blouses. For best results, use liquid detergent.</p> <p>Wool - Only for machine-washable wool. A load should be less than 2.0 kg.</p> <p>Single Wash - It's used to wash clothes not heavily stained.</p> <p>Single Rinse - Use for a load that needs rinsing only or to add rinse-added fabric softener to a load.</p> <p>Single Spin - Performs an additional spin cycle to remove more water.</p> <p>Drain - Just drain the water from washing machine without spinning.</p> <p>Drum Clean - To keep the drum clean, a sanitization is needed at least every one to three months.</p> <ul style="list-style-type: none">• The default wash temperature is 60 °C.• The default spin speed is the maximum speed.• The Function button cannot be used at this time. But you can use Delay function if necessary. <p> Drum Clean Tips:</p> <p>The drum must be keep clean all the time. After long time using, many kinds of bacteria from water and air would adhere to the drum in the form of besmirsch, which does harm to your family's health. So please use the Drum Clean function once every one to three months, to keep the drum always under a clean and healthful condition for using.</p>
2 FUZZY CONTROL DIAL	

3 HIGH LEVEL SELECTION BUTTON	<p>When you have a large load of laundry, you can select High Level for a better washing performance.</p> <ul style="list-style-type: none"> High Level is available with program of Standard, Intensive, Super Quick, Delicate, Wool and Single Wash. 	
4 DELAY SELECTION BUTTON	<p>Press this button repeatedly to cycle through the available Delay End options (from 3 hours to 19 hours in one hour increment). The hour displayed indicates the time when the wash cycle will be finished.</p>	
5 TEMPERATURE SELECTION BUTTON	<p>Press this button repeatedly to cycle through the available water temperature options: (Cold, 30 °C, 40 °C , 60 °C and 95 °C).</p>	
6 SPIN SELECTION BUTTON	<p>Press the button repeatedly to cycle through the available speeds for the spin cycle.</p>	
	<table border="1"> <tr> <td>WF8600NG</td> <td>All Lamps Turn Off, , 400, 800, 1000 rpm</td> </tr> </table> <p>"No spin " - The laundry remains in the drum and no spin cycle is performed after the final drain.</p>	WF8600NG
WF8600NG	All Lamps Turn Off,  , 400, 800, 1000 rpm	
7 FUNCTION SELECTION BUTTON	<p>Press this button repeatedly to cycle through the wash options: (Rinse Hold) → (Rinse+) → (Pre Wash) → (Rinse Hold) + (Rinse+) → (Rinse Hold) + (Pre Wash) → (Rinse+) + (Pre Wash) → (Rinse Hold)+ (Rinse+) + (Pre Wash) → off</p> <p>"Rinse Hold" : The laundry remains soaking in the final rinse water.</p> <ul style="list-style-type: none"> It's available only with program of Standard, Super Quick, Intensive, Delicate, Wool and Single Rinse. <p>"Rinse+": Your machine will run through an additional rinsing cycle. The washing duration will be prolonged accordingly.</p> <ul style="list-style-type: none"> It's available only with program of Standard, Intensive, and Single Rinse. <p>"Pre Wash": For particularly dirty clothes, you can use Pre Wash to run a short cycle of washing and spinning before the main wash, in order to disintegrate the headachy besmirch.</p> <ul style="list-style-type: none"> It's available only with program of Standard and Intensive. 	
8 ENZYME SELECTION BUTTON	<p>Press this button to select Enzyme function. It can keep the wash temperature 40~95 °C to make the best condition for wash. It cannot be used when temperature is below 40 °C.</p> <ul style="list-style-type: none"> It's available only with program of Standard, Intensive, and Single Rinse(40 °C). 	
9 START/PAUSE SELECTION BUTTON	<p>Press to pause and restart a cycle.</p>	
10 POWER BUTTON	<p>Press it once to turn your washing machine on, press it again to turn your washing machine off. If the washing machine is left on for more than 10 minutes without any buttons being touched, the power automatically turns off.</p>	

washing a load of laundry

Child lock

The Child Lock function allows you to lock the buttons so that the wash cycle you've chosen can't be changed.

Activating/Deactivating

If you want to activate or deactivate the Child Lock function, press the **Temperature** and **Spin** buttons at the same time for 2 seconds. "Child Lock" will be lit when this feature is activated.

-  When the Child Lock function is activated, only the **Power** button works. The Child Lock function remains on even after the power is turned on and off or after the disconnecting and reconnecting the power cord.

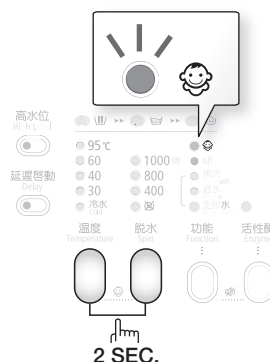

Sound off

The Sound Off function can be selected during all courses. When this function is selected, sound is turned off for all courses. Even if the power is turned on and off repeatedly, the setting is retained.

Activating/Deactivating

If you want to activate or deactivate the Sound Off function, press the **Function** and **Enzyme** buttons at the same time for 2 seconds. The "Sound Off" will be lit when this feature is activated.

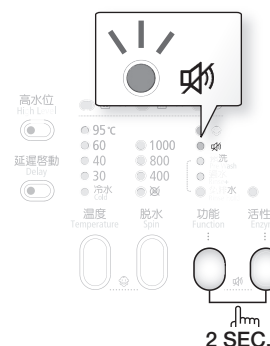

Delay end

You can set the washing machine to finish your wash automatically at a later time, choosing a delay of between 3 to 19 hours (in 1 hour increment). The hour displayed indicates the time at which the wash will be finished.

1. Manually or automatically set your washing machine according to the type of laundry you are washing.
2. Press the **Delay End** button repeatedly until the delay time is set.

-  When using delay function, if your selected washing cycle needs more than 3 hours, you should choose a delay time more than 3 hours.

3. Press the **Start/Pause** button. The "Delay End" indicator will be lit, and the clock will begin counting down until it reaches the set time.
4. To cancel a Delay End function, press the **Power** button and then turn the washing machine on again.

Washing clothes using fuzzy logic

Your new washing machine makes washing clothes easy, using Samsung's "Fuzzy Logic" automatic control system. When you select a wash program, the machine will set the correct temperature, washing time, and washing speed.

1. Turn on your sink's water tap.
2. Press the **Power** button.
3. Open the door.
4. Load the articles one at a time loosely into the drum, without overfilling it.
5. Close the door.
6. Add detergent, softener, and pre-wash detergent (if necessary) into the appropriate compartments.

 Pre-wash is only available when selecting the **Standard** and **Intensive** cycles. It is only necessary if your clothing is heavily soiled.

7. Use the **Fuzzy Control dial** to select the appropriate cycle according to the type of material: Standard, Super Quick, Intensive, Delicate, Wool, Drum Clean, Drain, Single Spin, Single Rinse, Single Wash.

The relevant indicators will illuminate on the control panel.

8. At this time, you can control the wash temperature, the spinning speed, and the delay time by pressing the appropriate option button.
9. Press the **Start/Pause** button and the wash will begin. The process indicator will light up and the remaining time for the cycle will appear in the display.

Pause Option

Within 5 minutes of starting a wash, it is possible to add/remove laundry items.

1. Press the **Start/Pause** button to unlock the door.

 The door cannot be opened when the water is too HOT or the water level is too HIGH.

2. After closing the door, press the **Start/Pause** button to restart the wash.

When the cycle is finished:

After the total cycle has finished, the power will turn off automatically.

1. Open the door.
2. Remove laundry.

washing a load of laundry

Washing clothes manually

You can wash clothes manually without using the **Fuzzy Control dial**.

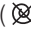
1. Turn the water supply on.
2. Press the **Power** button on the washing machine.
3. Open the door.
4. Load the articles loosely into the drum one at a time, without overfilling it.
5. Close the door.
6. Add detergent and, if necessary, softener or prewash detergent, into the appropriate compartments.
7. Use the **Fuzzy Control dial** to select the appropriate cycle.
8. Press the **Temp.** button to select the temperature. (Cold, 30 °C, 40 °C, 60 °C, 95 °C)
9. Press the **Spin** button to select the spin speed.
The rinse hold function allows you to remove items that are still wet from the washing machine. ( : No Spin, Lamp off: Rinse Hold)
10. Press the **Delay End** button repeatedly to cycle through the available Delay End options (from 3 hour to 19 hours in one hour increment). The hour displayed indicates the time at which the wash will be finished.
11. Press the **Start/Pause** button and the machine will begin the cycle.

LAUNDRY GUIDELINES

Follow these simple guidelines for the cleanest laundry and the most efficient wash.

 Always check the Care label on clothing before washing.

Sort and wash your laundry according to the following criteria:

- Care Label: Sort laundry into cottons, mixed fibres, synthetics, silks, wools and rayons.
- Colour: Divide whites and colours. Wash new colour items separately.
- Size: Placing items of different sizes in the same load will improve the wash action.
- Sensitivity: Wash delicate items separately, using the Delicate wash cycle for pure, new woollen items, curtains and silk articles. Check the labels on the items you are washing or refer to the fabric care chart in the appendix.

Emptying pockets

Before each wash, empty all the pockets of your laundry. Small, irregularly shaped hard objects, such as coins, knives, pins, and paperclips could damage your washing machine. Do not wash clothing with large buckles, buttons, or other heavy metal objects.

Metal on clothing may damage your clothing as well as the tub. Turn clothing with buttons and embroidered clothes inside out before washing them. If zips of pants and jackets are open while washing, the spin basket may be damaged. Zips should be closed and fixed with a string before washing.

Clothing with long strings may become entangled with other clothes damaging them. Be sure to fix the strings before starting the wash.

Prewashing cotton

Your new washing machine, combined with modern detergents, will give perfect washing results, thus saving energy, time, water and detergent. However, if your cotton is particularly dirty, prewash with a protein-based detergent.

Determining the load capacity

Do not overload the washing machine or your laundry may not wash properly. Use the chart below to determine the load capacity for the type of laundry you are washing.

Fabric Type	Load Capacity
Model	WF8600NG
Cotton - average/lightly soiled - heavily soiled	6.0 kg
Synthetics	2.5 kg
Baby Care	3.0 kg
Delicates	2.0 kg
Wool	1.5 kg

- When the laundry is unbalanced ("UE" lights up on the display), redistribute the load. If the laundry is unbalanced, the spin efficiency may be degraded.
- When washing Bedding or Duvets, the wash time may be lengthened or the spin efficiency may be degraded.
- For Bedding or Duvets, the recommended load capacity is 1.8(kg) or less.

Make sure to insert brassieres (water washable) into a laundry net (to be purchased additionally).

- The metal parts of the brassieres may break through the material and damage the laundry. Therefore make sure to place them inside a fine laundry net.
- Small, light clothing such as socks, gloves, stockings and handkerchiefs may become caught around the door. Place them inside a fine laundry net.

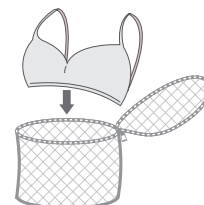

CAUTION

Do not wash the laundry net by itself without other laundry. This may cause abnormal vibrations that could move the washing machine and cause an accident resulting in injury.

washing a load of laundry

DETERGENT AND ADDITIVES INFORMATION

Which detergent to use

The type of detergent you should use is based on the type of fabric (cotton, synthetic, delicate items, wool), colour, wash temperature, and degree of soiling. Always use “low suds” laundry detergent, which is designed for automatic washing machines.

Follow the detergent manufacturer's recommendations based on the weight of the laundry, the degree of soiling, and the hardness of the water in your area. If you do not know how hard your water is, enquire at your local water authority.

-  Do not use detergent that has hardened or solidified as the detergent may remain in the rinse cycle. It may cause your washing machine to not rinse properly or result in the overflow becoming blocked.



Detergent drawer

Your washing machine has separate compartments for dispensing detergent and fabric softener. Add all laundry additives to the correct compartment before starting your washing machine.

-  Do NOT open the detergent drawer when your washing machine is running.

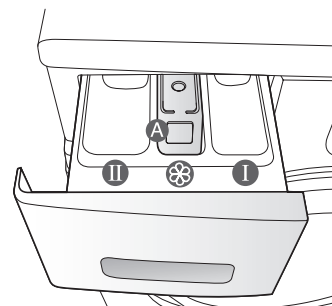
1. Pull out the detergent drawer on the left side of the control panel.
2. Add the recommended amount of laundry detergent directly into the detergent compartment ② before starting your washing machine.
3. Add the recommended amount of fabric softener into the softener compartment ③ if required.
4. When using the Prewash option, add the recommended amount of laundry detergent into the prewash compartment ①.



-  When washing large items do NOT use the following detergent types.
 - Tablet and capsule type detergents.
 - Detergents using a ball and net.
-  Concentrated or thick fabric softener and conditioner must be diluted with a little water before being poured into the dispenser (prevents the overflow from becoming blocked.)

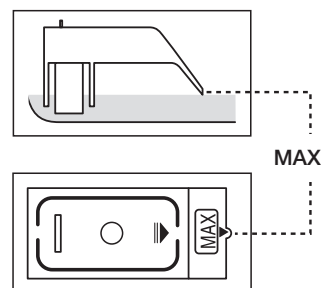

cleaning and maintaining your washing machine

Keeping your washing machine clean improves its performance, wards off unnecessary repairs, and lengthens its life.

DRAINING THE WASHING MACHINE IN AN EMERGENCY

1. Unplug the washing machine from the power supply.
2. Open the filter cover using a coin or a key.

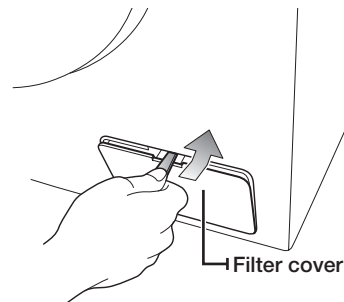

3. Pull forward the emergency drain tube to separate it from the guide hook.

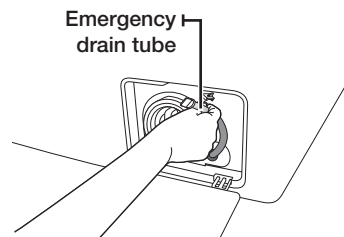

4. Take off the emergency drain cap closing the emergency drain tube.
5. Allow all the water to flow into a bowl.
6. Re-attach the cap to the emergency drain tube and then fix the emergency drain tube to the guide hook.
7. Replace the filter-cover.

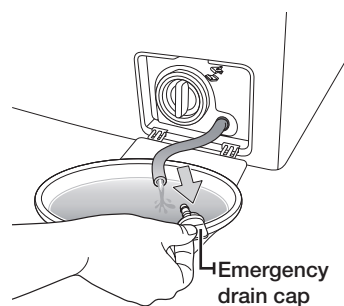

CLEANING THE EXTERIOR

1. Wipe the washing machine surfaces, including the control panel, with a soft cloth using a nonabrasive household detergent.
2. Use a soft cloth to dry the surfaces.
3. Do not pour water onto the washing machine.

cleaning and maintaining your washing machine

CLEANING THE DETERGENT DRAWER AND DRAWER RECESS

1. Press the release lever on the inside of the detergent drawer and pull the drawer out.
2. Remove the liquid detergent divider from the detergent drawer

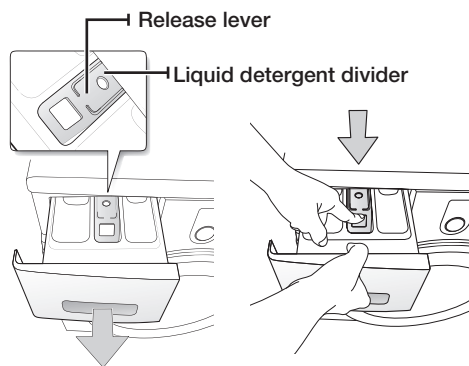

3. Wash all parts under running water.

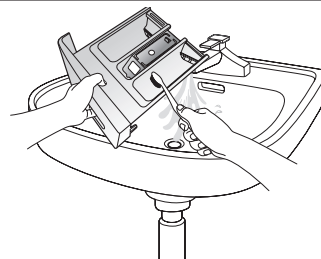

4. Clean the drawer recess with an old toothbrush.
5. Replace the liquid detergent divider by pushing it firmly into the drawer.
6. Push the drawer back into place.
7. To remove any remaining detergent, perform a rinse cycle without any laundry in the drum.

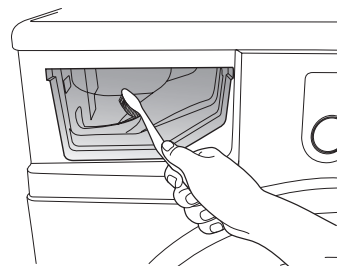

CLEANING THE DEBRIS FILTER

We recommend cleaning the debris filter 5 or 6 times a year, or when the error message of “5E” is displayed. (Refer to “Draining the washing machine in an emergency” in the previous page.)

1. Open the filter cover by using a key or coin.
2. Unscrew the emergency drain cap by turning it to the left and drain off all the water.
3. Unscrew the debris filter cap.

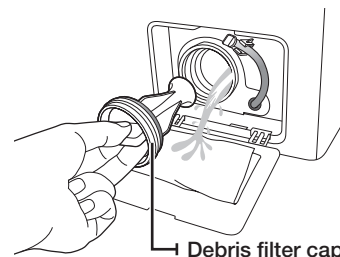

4. Wash any dirt or other material from the debris filter. Make sure the drain pump propeller behind the debris filter is not blocked.
5. Replace the debris filter cap.
6. Replace the filter cover.

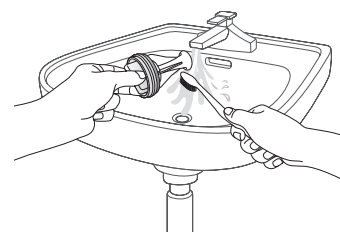

CLEANING THE WATER HOSE MESH FILTER

You should clean the water hose mesh filter at least once a year, or when the error message of “4E” is displayed:

1. Turn off the water supply to the washing machine.
2. Unscrew the hose from the back of the washing machine. To prevent water from gushing out due to the air pressure in the hose, cover the hose with a cloth.
3. Gently pull out the mesh filter from the end of the hose using a pair of pliers and rinse it under water until clean. Also clean inside and outside the threaded connector.
4. Push the filter back into place.
5. Screw the hose back onto the washing machine.
6. Make sure the connections are watertight and turn on the tap.

cleaning and maintaining your washing machine

REPAIRING A FROZEN WASHING MACHINE

If the temperature drops below freezing and your washing machine is frozen:

1. Unplug the washing machine.
2. Pour warm water over the tap to loosen the water supply hose.
3. Remove the water supply hose and soak it in warm water.
4. Pour warm water into the washing machine drum and let it sit for 10 minutes.
5. Reconnect the water supply hose to the water tap and check if the water supply and drain are operating normally.

STORING YOUR WASHING MACHINE

If you need to store your washing machine for an extended time, it's better to drain and disconnect it. Washing machines can be damaged if water is left in the hoses and internal components before storage.

1. Select spin function, you can get the water remained out of the washing machine
2. Turn the water taps off and disconnect the inlet hoses.
3. Unplug your washing machine from the electrical outlet, and leave your washing machine door open to allow air to circulate inside the tumbler.



If your washing machine has been stored in below-freezing temperatures, allow time for any leftover water in your washing machine to thaw out before using it.

troubleshooting and information codes

CHECK THESE POINTS IF YOUR WASHING MACHINE...

PROBLEM	SOLUTION
Will not start	<ul style="list-style-type: none">• Make sure your washing machine is plugged in.• Make sure the door is firmly closed.• Make sure the water source tap(s) are turned on.• Make sure to press the Start/Pause button.
Has no water or not enough water	<ul style="list-style-type: none">• Turn the water tap on fully.• Make sure the water source hose is not frozen.• Straighten the water intake hoses.• Clean the filter on the water intake hose.
Has detergent remains in the detergent drawer after the wash cycle is complete	<ul style="list-style-type: none">• Make sure your washing machine is running with sufficient water pressure.• Make sure the detergent is added to the center of the detergent drawer.
Vibrates or is too noisy	<ul style="list-style-type: none">• Make sure your washing machine is on a level surface. If the surface is not level, adjust the washing machine feet to level the appliance.• Make sure that the shipping bolts are removed.• Make sure your washing machine is not touching any other object.• Make sure the laundry load is balanced.
The washing machine does not drain and/or spin	<ul style="list-style-type: none">• Straighten the drain hose. Eliminate kinked hoses.• Make sure the debris filter is not clogged.
Door is locked shut or will not open.	<ul style="list-style-type: none">• Make sure the Child Lock function is not on.• Make sure all the water in your drum is drained out.• Make sure the door lock light is off. The door lock light will be off after water is drained out.

If the problem persists, contact your local Samsung Customer Service.

troubleshooting and information codes

INFORMATION CODES

When your washing machine malfunctions, you may see an information code on the display. If that happens, check this table and try the suggested solution before calling Customer Service.

CODE SYMBOL	SOLUTION
dE	<ul style="list-style-type: none">• Close the door.
4E	<ul style="list-style-type: none">• Make sure the source water tap is turned on.• Check the water pressure.
5E	<ul style="list-style-type: none">• Clean the debris filter.• Make sure the drainage hose is installed correctly.
UE	<ul style="list-style-type: none">• The laundry load is unbalanced. Redistribute the load. If only one item of clothing needs washing, such as a bathrobe or pair of jeans, the final spin result might be unsatisfactory and an "UE" error message will be shown in the display window.
LE	<ul style="list-style-type: none">• Check whether the bottom of the drain hose is too low.(Check if there's something wrong with the hose guide.)• Check whether the bottom of the drain hose is soaking in the water.

Before contacting After-Sales service:

1. Try to remedy the problem (See "Troubleshooting" on this page).
2. Restart the programme to see if the fault is repeated.
3. If the malfunction persists, call after-sales service and describe the problem.

cycle chart

CYCLE CHART

(● user option)

























PROGRAM	Max load(kg)	DETERGENT			Max Temp (°C)	Spin Speed(MAX) rpm	Delay end	High Level	Enzyme
	WF8600NG	Pre-wash	wash	Soft-ener		WF8600NG			
Standard	6.0	●	yes	●	95	1000	●	●	●
Super Quick	3.0	-	yes	●	30	1000	●	●	-
Intensive	6.0	●	yes	●	95	1000	●	●	●
Delicates	2.0	-	yes	●	30	800	●	●	-
Wool	2.0	-	yes	●	40	800	●	●	-
Single Wash	3.0	-	yes	-	40	-	●	●	●
Single Rinse	-	-	-	●	-	1000	●	-	-
Single Spin	-	-	-	-	-	1000	●	-	-
Drum Clean	-	-	yes	-	60	1000	●	-	-

1. A cycle with a prewash takes approx. 15 minutes longer.
2. The cycle duration data has been measured under the conditions specified in Standard IEC 60456 / EN 60456.
3. Course time in individual homes may differ from the values given in the table due to variations in the pressure and temperature of the water supply, the load and the type of laundry.
4. When the Intensive Wash function is selected, the cycle time is increased for each cycle.

appendix

FABRIC CARE CHART

The following symbols provide garment care directions. The care labels include five symbols in this order: washing, bleaching, drying and ironing, and dry cleaning when necessary. The use of symbols ensures consistency among garment manufacturers of domestic and imported items. Follow the care label directions to maximize garment life and reduce laundering problems.

	Resistant material		Can be ironed at 100 °C max
	Delicate fabric		Do not iron
	Item can be washed at 95 °C max		Can be dry cleaned using any solvent
	Item can be washed at 60 °C max		Dry clean with perchloride, lighter fuel, pure alcohol or R113 only
	Item can be washed at 40 °C max		Dry clean with aviation fuel, pure alcohol or R113 only
	Item can be washed at 30 °C max		Do not dry clean
	Item may be hand washed		Dry flat
	Dry clean only		Can be hung to dry
	Can be bleached in cold water		Dry on clothes hanger
	Do not bleach		Tumble dry, normal heat
	Can be ironed at 200 °C max		Tumble dry, reduced heat
	Can be ironed at 150 °C max		Do not tumble dry

PROTECTING THE ENVIRONMENT

- This appliance is manufactured from recyclable materials. If you decide to dispose of this appliance, please observe local waste disposal regulations. Cut off the power cord so that the appliance cannot be connected to a power source. Remove the door so that animals and small children cannot get trapped inside the appliance.
- Do not exceed the detergent quantities recommended in the detergent manufacturers' instructions.
- Use stain removal products and bleaches before the wash cycle only when strictly necessary.
- Save water and electricity by only washing full loads (the exact amount depends upon the program used).

DECLARATION OF CONFORMITY

This appliance complies with European safety standards, EC directive 93/68 and EN Standard 60335.

SPECIFICATIONS

TYPE			FRONT LOADING WASHER	
DIMENSIONS			WF8600NG	
			W598mm X D610mm X H845mm	
WATER PRESSURE			50 kPa ~ 800 kPa	
WATER VOLUME			72 ℓ	
NET WEIGHT			59 kg	
WASH AND SPIN CAPACITY			6.0 kg	
POWER CONSUMPTION	MODEL		WF8600NG	
	WASHING		220 V	150 W
			240 V	150 W
	WASH AND HEATING		220 V	2000 W
			240 V	2400 W
	SPIN	MODEL	WF8600NG	
		230V	500 W	
PUMPING		34 W		
SPIN REVOLUTIONS	MODEL		WF8600NG	
	rpm		1000	
WATERNOISE	SOUND PRESSURE LEVEL		47 dB (A)	
	SOUND POWER LEVEL		59 dB (A)	
SPINNOISE	SOUND PRESSURE LEVEL		56 dB (A)	
	SOUND POWER LEVEL		68 dB (A)	

The appearance and specifications of the product are subject to change without prior notice for purposes of product enhancement.

memo

memo



QUESTIONS OR COMMENTS?

Country	CALL	OR VISIT US ONLINE AT
HONG KONG	3698-4698	www.samsung.com/hk

Code No. DC68-02624G_EN

WF8600NG(A/C/D/F/G/H/R/S/T/V/W/Z)

三星滾桶洗衣機 使用說明書

無窮想像, 無限可能

感謝您購買三星產品。
為了您能夠獲得更完善的客服,
請在以下網站註冊您購買的產品
www.samsung.com/hk

SAMSUNG

功能特點

您的新洗衣機將徹底改變您對洗衣的印象。不管是其超大的洗滌容量還是出色的節能環保性能，您的三星洗衣機都完全具備為您化家務瑣事為樂趣的所有特質。

- **標準/強力**
該程序具有獨特的感知功能，可以在洗滌過程中自動感知衣物的容量，從而選擇合適的水位，更加環保節能。
- **童鎖**
該功能可以防止在洗滌過程中因兒童的誤操作使洗滌程序無法正常運行的情況。
- **延遲啓動**
該功能可以延遲洗滌程序啓動的時間。您可以從3到19個小時之間以每一小時的增量來選擇延遲啓動時間。
- **快速**
超快的洗滌程序。28分鐘的快速洗滌，讓您在繁忙的生活中擁有乾淨衛生的衣物。
- **輕柔衣物**
合適的水溫、輕柔的洗滌動作以及合適的水量為精細質地的衣物提供專門的保護。
- **活性酶**
選擇活性酶功能可以使洗滌溫度控制在40~95攝氏度之間一段時間，使洗滌達到最佳狀態。
- **陶瓷加熱器 (選項)**
我們具有革新意義的陶瓷加熱器比普通加熱器的耐用性增加了一倍。
這為您節省了很多修理的費用。而且，它減少了硬質水對洗滌的影響並節省了能源。
- **寬門設計**
新型的寬門設計，更便於您取放衣物，特別是大號的衣物，如床單毛巾等。

本說明書包含了您新的三星洗衣機的安裝、使用、保養方面的重要訊息。當您需要熟悉操作面板時，想要知道如何使用洗衣機或怎樣將它藝術級的特性和功能發揮得最好時，您都可以從這本冊子裡得到答案。另外，第27頁的“故障排除”將指導您在機器產生問題時如何應對。

安全注意事項

通過說明書, 您會看到警告⚠或注意⚠的注釋。

這些警告、注意事項以及隨後提示的重要安全說明並沒有包括所有可能發生的狀況。

所以在安裝、保養和使用洗衣機時, 請仔細閱讀這些說明內容並謹慎操作, 以便能夠充分利用洗衣機的功能, 延長本機的使用壽命。對於因使用不當而造成的損失, 三星公司不承擔責任。

重要安全標誌和注意事項

本使用說明書中圖示及符號的含義：

 警告	不安全的操作可能會導致嚴重人身傷亡。
 注意	不安全的操作可能會導致輕微人身傷害、財產損失。
 注意	為了減少因使用洗衣機而發生的火災、爆炸或人身傷害, 請遵守以下基本安全注意事項。
 不要嘗試。	
 不要拆卸。	
 不要觸摸。	
 請仔細閱讀說明書並謹慎操作。	
 請拔下電源插頭。	
 確保洗衣機接地, 以防觸電。	
 如有任何諮詢或建議, 請致電三星客服中心。	
 注意。	

在使用洗衣機之前請閱讀以下內容

 請仔細閱讀說明書並謹慎操作。

任何電器操作時都存在著潛在的危險。為了安全起見, 操作本洗衣機時請仔細閱讀說明書並謹慎操作。

洗衣機請安裝在乾燥、通風的室內。洗衣機不適宜安裝在浴室或非常潮濕的房間內。

請將洗衣機放置在堅硬、平坦、乾淨, 沒有水和油脂的地面上。

 電源插頭的規格應滿足用電負荷電流要求。請單獨使用220V的交流電源並可靠接地。

安全注意事項

 為了防止因使用洗衣機而發生的火災、爆炸或人身傷害：

注意 • 請不要洗滌浸泡過的，沾有汽油的或者其它易燃、易爆、有毒性溶劑的衣物。這些衣物會釋放出可能會著火或者爆炸的物質。請先用手洗滌這些衣物，確保所有這類液體、固體和微粒的痕跡都被除去，然後再將其放入洗衣機中。危險的物質包括丙酮，酒精，汽油，煤油，某些家用清潔劑的液體和去污劑，松脂，蠟以及除蠟劑。

- 不要把汽油，酒精，乾燥清潔劑或者其它易燃易爆的物質作為洗滌劑放入洗衣機中。
- 請僅選擇適合機洗的市場銷售的家用洗滌劑。

如果有氣體洩露，請立即通風且不要觸碰電源插頭。

 在保養您的洗衣機之前，切記拔掉洗衣機的電源插頭並關閉進水管水龍頭。

務必在每次洗衣前將所有衣物的口袋掏空。

堅硬鋒利的物品，例如硬幣、安全別針、釘子、螺絲或石子，都可能嚴重損壞洗衣機。

打開洗衣機門之前，檢查桶內是否留有存水。如果仍然有水，請勿打開洗衣機門。

 切勿嘗試自行維修洗衣機，或讓無經驗、不合格的人員進行維修。可能會嚴重損壞洗衣機並造成人身傷害。

請使用新的進水管連接水龍頭。舊的水管請勿重複使用，請定期更換新的水管。

進水管隨著時間會退化。請週期性地檢查水管的膨脹、扭絞、斷裂、磨損和洩露情況，並在有問題的時候及時更換，至少每五年一次。

在使用本洗衣機前，應卸下所有的包裝和裝運螺栓。否則，洗衣機運行後可能產生過大的振動和噪音，嚴重損壞洗衣機。參見“拆除裝運螺栓”。

 第一次洗滌之前，必須在沒有裝入衣物的情況下完成一次全過程洗滌。參見“首次洗滌”。

本洗衣機僅為家庭使用設計並僅允許使用冷自來水。

 **注意** 務必由合格的技術人員依據製造商的指示(參見“安裝洗衣機”)和當地的安全規範進行水管和電源的連接。

 在保養、清洗或維修洗衣機之前,請拔下電源插頭或將(電源)按鈕切換至“關閉”狀態。

洗衣結束後,切記拔掉洗衣機的電源插頭並關閉進水管水龍頭。

請勿洗滌帶搭扣、鈕扣、或其它帶有重金屬物質的衣物。

寵物和小孩可能會爬進洗衣機。因此有必要在每次使用前檢查洗衣機。

洗滌程序運行時,玻璃門可能會變得很燙。因此在洗衣機運行期間,切勿讓小孩靠近。

 第一次使用前,為了安全地使用洗衣機,使用者應該熟悉的瞭解洗衣機說明書,並在使用過程中格外小心。如果洗衣機有明顯的損壞,請勿通電。如有疑問,請立即與當地的產品服務代理商或經銷商聯繫。

如果電源線及插頭損壞,應由製造商、產品服務代理商或類似的合格人員進行更換,以免造成危險。

洗衣機僅由授權的服務中心進行維修,且僅應使用原廠配件。

本洗衣機不適合兒童或體弱者使用,除非有監護人進行適當監護,以確保洗衣機的使用安全。應對兒童(及動物)進行監督,確保兒童(及動物)不會在洗衣機周圍玩耍。

洗衣機應放置在靠近電源插座、水龍頭和有地漏(排水道)的房間內。

 **注意** 包裝材料可能對兒童有害,請把所有的包裝材料(塑膠袋、聚苯乙烯等)放在兒童不可觸及的地方。

請勿使用經乳液、護膚液等含油漬處理過的水。這種水常見於護膚品店或按摩診所。

- 否則,會引起密封件變形,造成功能異常或漏水。不銹鋼內桶通常不會生銹。然而,如果髮夾等某些金屬物品在桶內置留時間過長,洗衣內桶可能會生銹。
- 如果洗衣機內桶表面開始生銹,請在表面滴上清潔劑(中性),然後用海棉或軟布將鏽跡擦拭乾淨。(請勿使用金屬刷)
- 請勿讓水或含氯漂白劑在洗衣桶內置留時間過長。

如果洗衣機底板上留有通風孔,不得讓地毯等阻塞通風孔。

舊的水管請勿重複使用,請定期更換新的水管。

關於WEEE標記的說明



在機器或印刷物上可見的這個標識,說明當洗衣機廢棄時不可同其它生活垃圾一同進行處理。為了避免因隨意、不加控制的垃圾處理方式而可能導致的環境污染和對人類健康的危害,為了提高資源的可持續再利用,請您負責地將它同其它垃圾分開並進行循環再利用。

家庭使用者可以聯繫購買此產品的零售商或當地政府辦公室,就應該將機器送往哪裡並怎樣進行循環再利用的細節問題進行諮詢。

目錄

安裝洗衣機	7	洗衣機各部件說明
7	8	請遵循安裝要求
	8	供電和接地
	8	水供應
	9	室內地面
	9	周圍溫度
	9	滾桶洗衣機安裝環境要求
	9	安裝您的洗衣機
洗滌衣物	15	首次洗滌
15	15	洗滌基本注意事項：
	16	控制面板概觀
	18	童鎖
	18	靜音功能
	18	延遲啟動
	19	使用 FUZZY LOGIC 洗衣
	20	手動控制洗滌
	20	洗衣常識及竅門
	22	洗劑和添加劑的用法
	22	如何選擇洗劑
	22	洗滌劑如何放入
洗衣機的保養	23	緊急排水
23	23	清洗洗衣機外殼
	24	清洗洗滌劑盒
	25	清洗殘渣過濾器
	25	清洗進水閥過濾器
	26	處理已凍結的洗衣機
	26	儲藏洗衣機
故障排除	27	問題和解決方案
27	28	錯誤訊息說明
程序表	29	程序表
29		
附錄	30	衣物保養符號說明
30	30	環保資訊
	30	產品執行標準
	31	技術參數

安裝洗衣機

請嚴格執行說明書上相關的安裝洗衣機步驟，這樣您才能安全使用您的洗衣機。

洗衣機各部件說明

將洗衣機的包裝打開，並檢查洗衣機裝運時是否損壞。同時檢查下圖中的所有配件是否齊全。如果洗衣機在裝運過程中損壞或配件不全，請立即與三星經銷商聯繫。

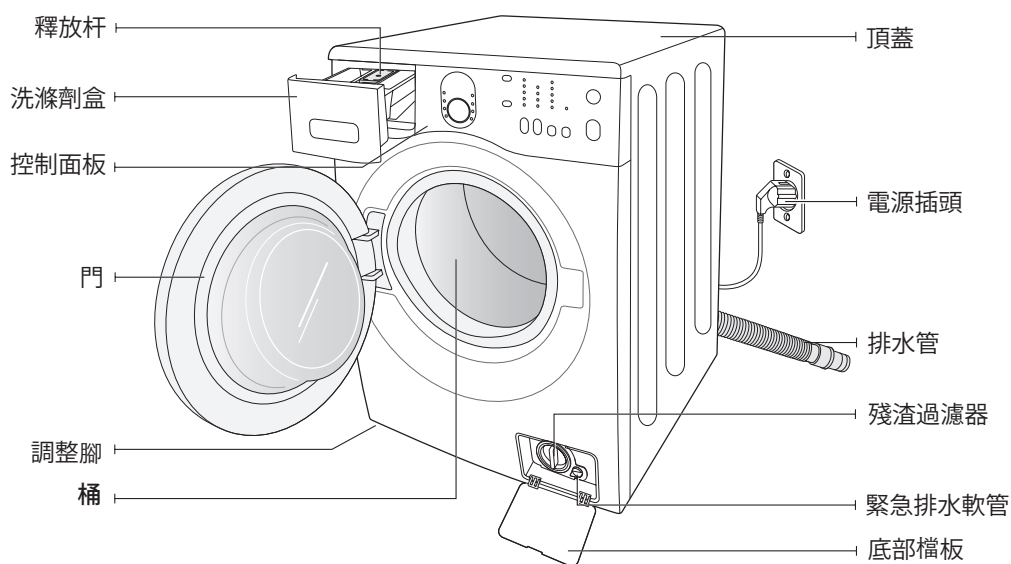

扳手

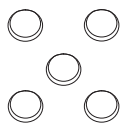

螺栓孔蓋



進水管

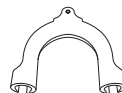

水管定位器



T型孔蓋

安裝洗衣機

請遵循安裝要求

供電和接地

為了避免不必要的火災、觸電或者人身傷害等危險，所有的電氣線路和接地都必須依照國家電氣標準來設置。為該電器提供適當的保養是電器所有者的責任。

 切勿使牆壁電源插座或延長線超載。超載可能會引起火災或導致觸電。

請僅使用洗衣機配備的電源線。

在準備安裝時，確保您的電源供給：

- 220到240伏特、50赫茲、15安培的保險絲或斷路器。
- 在使用加熱功能時洗衣機內通過的最大電流會達到10A，因此請確保您家中的供電裝置（電流、電壓和電纜）能夠滿足機器的正常負荷要求。
- 僅使用電源標籤上標明的電源類型。如果您不清楚家中的電壓，請和製造商、產品服務代理商或類似的合格人員聯繫。

您的洗衣機必須要接地。如果您的洗衣機發生故障或者不能運轉時，地面可以導走洗衣機上的電流，在最大程度上減小觸電的危險。

為了確保您的安全，請必須使用三芯插座，並注意檢查確保您的插座正確可靠接地。（您的洗衣機已經配備了三芯插頭。）

 保護電源線。

請勿任意放置電源線，以免被踩到，或被放在電源線上面或旁邊的物品壓到或夾住。請特別小心插頭上的電源線、電源插座及設備的電源線接點。

請不要把接地線連在塑膠管、煤氣管道或者熱水管道上。地線連接到不正確的接地導體，會導致觸電。

如果您不確定洗衣機是否正確接地，應由製造商、產品服務代理商或類似的合格人員進行檢查並確認。

如果電源線損壞，為避免危險，應由製造商、產品服務代理商或類似的合格人員進行更換。

不要改造洗衣機所配備的插頭。如果它與插座不匹配，請找製造商、產品服務代理商或類似的合格人員安裝相匹配的插座。

水供應

洗衣機注滿水的工作水壓為50～800千帕，當水壓低於50千帕時可能會導致水閥失靈，或者注滿水的時間比程序控制時間長，也會導致洗衣機自動關機。

進水龍頭必須在您洗衣機後部的122釐米範圍以內，以便進水管方便連接您的洗衣機和水龍頭。

你可以通過以下方式來預防漏水和水路損壞的風險：

- 洗衣機距離水龍頭要近。
- 當洗衣機不使用的時候，關掉水龍頭。
- 定期檢查內部回路的漏水情況。

 警告 在使用您的洗衣機前，應先檢查進水閥和水龍頭上所有的連接以防漏水。

室內地面

為了使洗衣機的性能發揮到最好, 您的洗衣機必須放置在堅硬、平坦、乾淨, 沒有水和油脂的地面上。如果將洗衣機安裝在不平或不乾淨的地面上, 就會產生噪音或振動。為了使振動或不平衡的負荷最小化, 木地板需要進一步加固。地毯和柔軟的地磚表面可以導致工作過程中振動的產生以及洗衣機的輕微移動。

不要把您的洗衣機放在平臺或者支撐較弱的結構上。

周圍溫度

不要把洗衣機放置在水易結冰的地方, 因為您的洗衣機的水閥、排水泵和水管等處會殘留一些水。在管道裡的結冰可能會導致皮帶, 排水泵和其它零部件的損壞。您應當將您的洗衣機放置在周圍溫度為 0°C ~ 40°C 的環境下, 空氣的相對濕度在95%以下(溫度為 25°C 時), 這樣您可以方便安全地使用您的洗衣機。

滾桶洗衣機安裝環境要求

為了安全而正確的操作, 您的洗衣機安置環境的空間為:

兩側 – 25毫米

後面 – 51毫米

頂部 – 25毫米

前面 – 465毫米

若您將洗衣機和乾衣機並排放置, 則您需要確保在機器前預留至少465毫米的暢通空間。若您只單獨放置一台洗衣機, 則不需要特定的空間要求。

安裝您的洗衣機

步驟一

選擇安裝環境:

安裝洗衣機之前, 首先要選擇一個符合以下條件的位置:

- 堅硬平坦的水平地面(如果地面不平, 參見如下“調整水平底腳”內容)
- 避免日光直射, 並通風良好。
- 室溫不低於 0°C 。
- 遠離如碳火或煤氣爐灶等熱源。
- 確保電源線未壓在洗衣機下麵。如果將洗衣機安裝在鋪有地毯的地面上, 小心不要讓地毯擋住通風口。

安裝洗衣機

步驟二

拆除運輸螺釘：

使用洗衣機前，必須拆除位於機背的所有運輸螺釘。

1. 拆除前，使用扳手擰鬆所有螺釘。

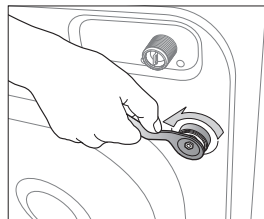

2. 捏著螺釘頭部並從孔的寬大部位將其拉出。重複以上動作將螺釘逐一拆除。

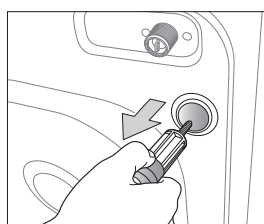

3. 用提供的塑膠蓋填塞每個小孔。

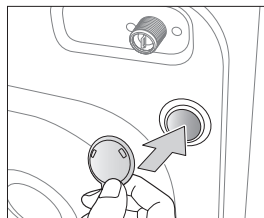

4. 存妥螺釘，以供日後使用。

⚠ 警告 包裝材料可能對兒童有危險，請把所有包裝材料(塑膠袋、泡沫塑料、裝運螺栓等)置於兒童不能觸及的地方。

✍ 電源插頭從機器後背箱殼上的T型孔取出後，請將隨機配件中的T型孔蓋蓋上。

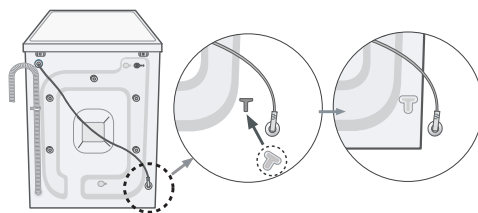

步驟三

調整平衡支腳：

 安裝洗衣機之前，請確定洗衣機的插頭已經通電，進水管已經連接，排水管放置正確。

1. 用扳手旋鬆鎖緊螺母。
2. 用手旋轉腳座螺釘，直至達到所需高度。

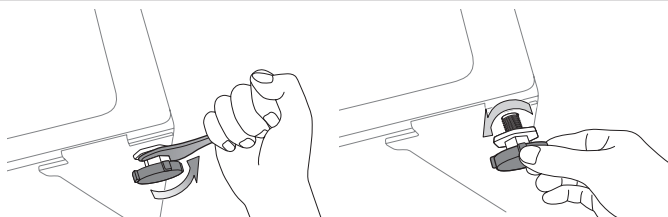

3. 確保您的洗衣機底腳水平後，用扳手將鎖緊螺母旋緊。

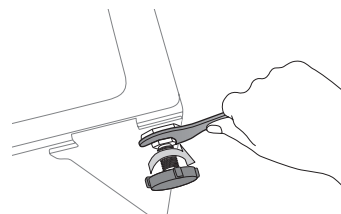

步驟四

連接進水管和排水管：

連接進水管

1. 將冷水進水管的 L 型裝配臂連接至機背的冷水進水口。然後用手擰緊。
 進水管的兩端，必須分別連接洗衣機及水龍頭。切勿拉扯進水管。若該水管太短，請使用更長的高壓水管更換該水管。
2. 將冷水進水管的另一端連接至水槽的冷水水龍頭，並用手擰緊。若有必要，您可以重新調整洗衣機背的進水管位置。方法是鬆開裝配臂，轉動水管，並再次擰緊裝配臂。

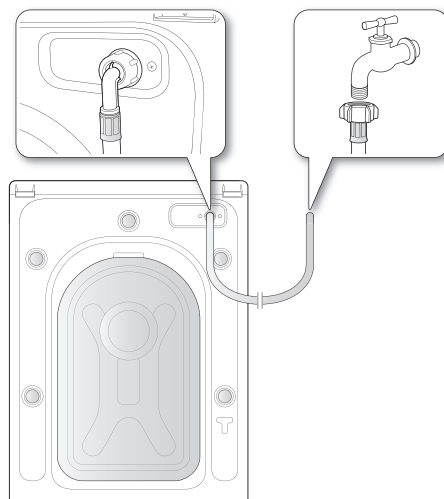

根據型號可選則：

1. 將熱水進水管的紅色的 L 型裝配臂連接至機背上紅色的熱水進水口。然後用手擰緊。
2. 將熱水進水管的另一端連接至水槽的熱水水龍頭，並用手擰緊。

安裝洗衣機

連接進水管(可選)

1. 取下進水管的連接器。

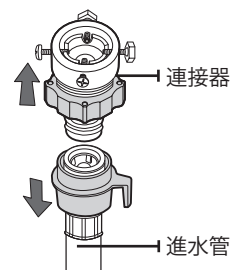

2. 首先, 用十字起將連接器上的四個螺絲擰鬆。接著, 緊握連接器並將 (2) 部分沿圖中箭頭方向旋開 5mm 的間距。

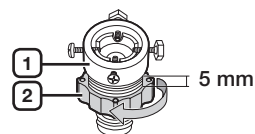

3. 將連接器连接到水龍頭上並旋緊螺絲。然後, 將 (2) 部分沿圖中箭頭方向旋緊使 (1) 和 (2) 部分相連。

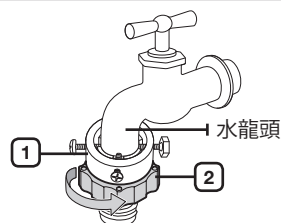

4. 將進水管接到連接器。往下拉進水管的 (3) 部分。在旋鬆 (3) 部分時, 隨著「嗒」聲響水管會自動接到連接器。

 請使用前確定已經正確連接在水龍頭上。

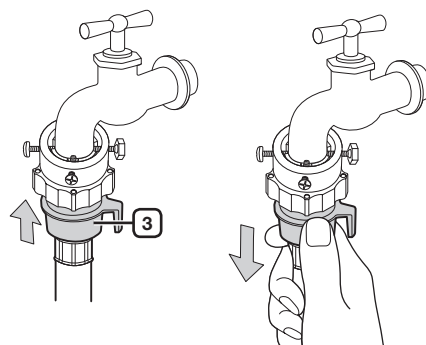

5. 將進水管的另一端連接到洗衣機後部的進水閥。沿順時針方向將水管旋到底。

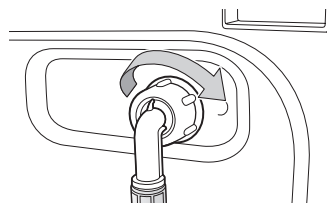

6. 完成連接後, 打開水龍頭查看是否水管漏水, 若漏水請重複上述步驟。

 請勿在漏水時使用您的洗衣機, 如使用會引起觸電, 導致您的生命安全受到傷害。

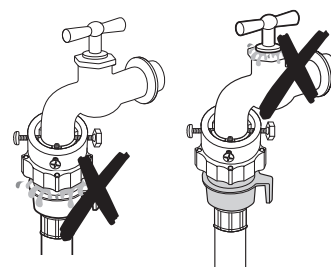

- 如果是水龍頭接口處帶有螺紋, 請按照右圖所示安裝進水管。

 請使用最常用的水龍頭供水。若水龍頭是正方形或太大, 請在將水龍頭插入連接器之前取出墊圈。

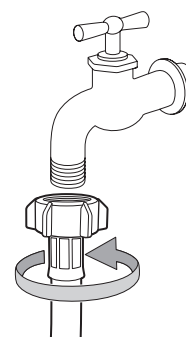

安裝洗衣機

放置排水管

排水管末端的擺放位置有以下三種：

1. 水槽邊緣之上：排水管放置的高度必須介於 60 至 90 cm 之間。欲令排水管保持合適的排水彎曲度，請使用提供的水管塑膠定位器。使用吊鉤將定位器固定在牆壁上，或用繩子將定位器繫在水龍頭上，以免排水管移位。

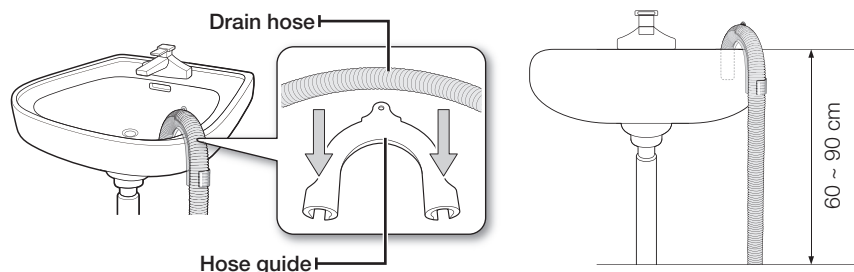

2. 連接水槽排水道分支：將排水管末端連接在水槽排水管的分支上。為了防止虹吸現象的發生，請保持您的排水通暢並確保固定排水管至少距離地面60cm。
3. 直接插入地漏：三星建議您使用機器配套的排水管，直接將此水管插入地漏。

步驟五

連接洗衣機電源

將電源線插頭插入牆上的插座；確保插座是被15安培或相當值的斷路器保護的經核准的230伏特、50赫茲電源插座。(更多有關電氣和接地要求的訊息，參見第8頁)

洗滌衣物

當您有了新的三星洗衣機, 洗衣服這件事中最難的部分變為了: 先洗哪一堆好?

首次洗滌

 第一次洗滌之前, 您需要在沒有裝入衣物的情況下完成一次全過程洗滌。

操作步驟:

1. 按下 \odot 電源鍵。
2. 在洗滌劑盒 $\textcircled{\text{II}}$ 內倒入少量洗滌劑。
3. 打開洗衣機的供水龍頭。
4. 選擇清洗洗衣桶程序。
5. 按下啟動/暫停鍵。

 這樣可以排出製造商在執行測試過程中殘留在洗衣機內的水。

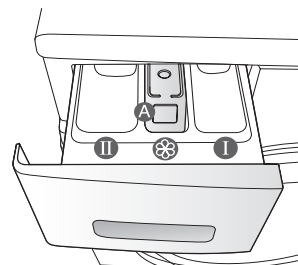

洗滌劑盒 $\textcircled{\text{I}}$: 用於預洗的洗滌劑。

洗滌劑盒 $\textcircled{\text{II}}$: 用於主洗的洗滌劑、漂白劑等。

洗滌劑盒 $\textcircled{\text{A}}$: 用於添加劑, 如衣物柔順劑等。

洗滌基本注意事項:

1. 將您需要洗滌的衣物一件一件鬆散地裝入洗衣桶內。

 **警告** 請勿過量裝入, 有關各類型衣物最大洗衣量的選取, 請參照21頁的表格。

- 
- 確保衣物不被機門卡到, 否則會導致漏水。
 - 洗衣結束後, 可能會有洗滌劑殘留在洗衣機的前部密封件上, 請清除殘留的洗滌劑, 否則也可能會導致漏水。
 - 請勿洗滌防水性的衣物。
2. 關上洗衣機門, 並確認洗衣機門安全鎖好。
 3. 按下 \odot 電源鍵。
 4. 在洗滌劑盒內添加適當的洗滌劑和添加劑(選項)等。
 5. 選擇合適的洗衣程序。指示燈亮起, 控制台上顯示剩餘洗滌時間。
 6. 按下啟動/暫停鍵。

洗滌衣物

控制面板概觀

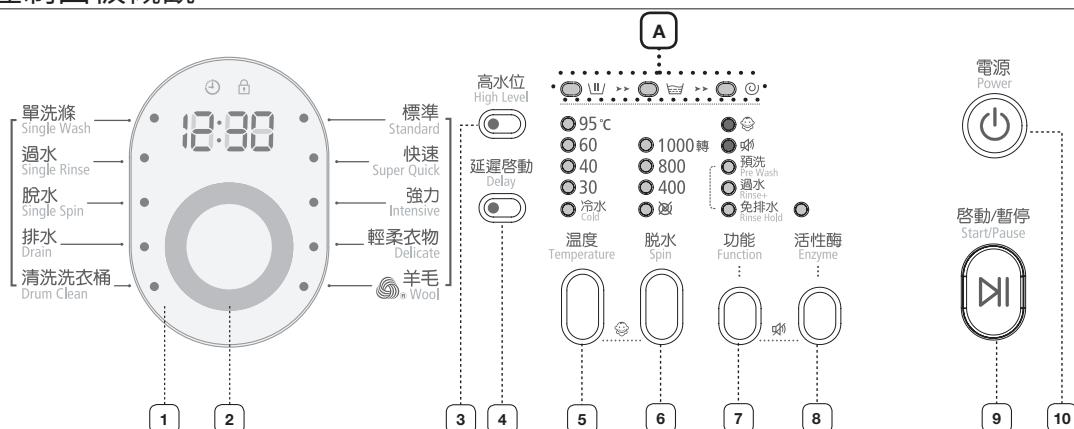

A 部分的解釋為：(洗滌)-(漂洗)-(脫水)；

<p>1 顯示面板</p>	<p>顯示洗滌的工作程序和錯誤訊息。 在程序執行期間，程序指示燈閃爍。</p>
<p>2 Fuzzy 操控盤選擇鍵</p>	<p>轉動旋鈕，從十種可選程序中選擇一種洗滌程序。</p> <p> 更具體訊息，請參看“洗滌功能介紹”。</p> <p>標準 - 一般或輕微弄髒的棉織品、亞麻床單、亞麻桌布、內衣、毛巾、襯衫等。</p> <p>快速 - 快速洗淨輕微弄髒的棉織品或亞麻女衫、襯衫、花色亞麻織物、牛仔褲等。</p> <p>強力 - 當衣物中度或嚴重弄髒需要強力洗時，請按下該鍵。選擇該程序後，洗滌時間會相應變長。</p> <p>輕柔衣物 - 一般或輕微弄髒的內衣、洋裝、襯衫等。適合使用業體清潔劑。</p> <p>羊毛 - 僅限帶有純羊毛標誌的可機洗羊毛織物。洗衣量不得超過2.0KG。</p> <p>單洗滌 - 僅用來洗滌不是很髒的衣物。</p> <p>過水 - 適合於只需對衣物進行漂洗、或是要為衣物添加漂洗用柔順劑時使用。</p> <p>脫水 - 運行一個額外的脫水過程，最大程度去除衣物中所含的水。</p> <p>排水 - 只排出桶內的水，不進行脫水。</p> <p>清洗洗衣桶 - 使用此功能保持洗滌內桶的乾淨和衛生。</p> <ul style="list-style-type: none"> 洗滌溫度只可選擇“60度”。 脫水轉速默認為最高轉速。 不可選擇功能鍵。可根據需要選擇延遲啟動功能。 <p> 桶清潔注意事項： 內桶必須長期保持清潔，洗衣機經過長期使用，水質和空氣中的多種細菌會粘附於內桶，產生黑色的污漬。從而給家人的健康帶來危害，所以請客戶利用本產品的桶清潔功能至少每1至3個月清洗一次，以確保內桶長期處於乾淨衛生的情況下使用。</p>
<p>3 高水位選擇鍵</p>	<p>當您洗滌的衣物較多時，為了有更好的洗滌效果，您可以選擇高水位。</p> <ul style="list-style-type: none"> 當您選擇了標準洗、強力洗、超快洗、輕柔洗、羊毛洗和單洗滌程序時，可以使用高水位。

4 延遲啟動選擇鍵	重複按此按鈕可依次選擇各種可用的延遲啟動選項 (由 3 小時至 19 小時, 每次以一小時遞增)。 顯示的小時數為洗衣程序完成的時間。
5 溫度選擇鍵	重複按鍵可選擇適當的洗滌水溫: 冷水(Cold), 30°C, 40°C, 60°C 和 95°C。
6 脫水轉速選擇鍵	重複按鍵, 可依次選擇各種可用的脫水速度。 WF8600NG 指示燈不顯示時, 400, 800, 1000 轉/分鐘 免脫水(40): 最後一次漂洗後, 進行排水但不進行脫水。
7 功能選擇鍵	重複按鍵, 可依次選擇各種可用的輔助洗滌功能。 (免排水)→(漂洗+)→(預洗)→(免排水)+(漂洗+)→(免排水)+(預洗) →(漂洗)+(預洗)→(免排水)+(漂洗)+(預洗)→關 “免排水”: 最後一次漂洗後不進行排水。 <ul style="list-style-type: none"> 當您選擇了標準洗、超快洗、強力洗、輕柔洗、羊毛洗和單洗滌程序時, 可以使用免排水功能。 “過水”: 您的洗衣機將運行一個額外的漂洗過程。洗滌總時間也會相應延長。 <ul style="list-style-type: none"> 當您選擇了標準洗、強力洗和單洗滌程序時, 可以使用過水功能。 “預洗”: 為了能夠對污漬較多的衣物有更好的洗滌效果, 在進入您所選擇的洗滌程序前, 先進行一次短暫的洗滌脫水程序, 以便瓦解衣物上頑固的污漬。 <ul style="list-style-type: none"> 當您選擇了標準洗和強力洗程序時, 可以使用預洗功能。
8 活性酶選擇鍵	按此按鈕選擇活性酶功能。它可以使洗滌溫度控制在40~95攝氏度之間一段時間, 使洗滌達到最佳狀態。當溫度低於40攝氏度時, 該功能將不能被選擇。 <ul style="list-style-type: none"> 當您選擇了標準洗、強力洗、單洗滌(40度)時, 則可以使用活性酶功能。
9 啟動/暫停鍵	按下此鍵可以啟動洗滌程序, 或暫停洗滌程序。
10 電源鍵	按下一次, 打開您的洗衣機, 再按一次, 關閉洗衣機。 如果電源鍵打開後十分鐘內沒有任何鍵被觸動, 電源將自動關閉。

洗滌衣物

童鎖

為了防止在洗滌過程中因兒童的誤操作而使洗滌程序無法正常運行，您可以選擇此功能。

設置/取消方法：

在洗滌過程中按下“童鎖”鍵(同時按下溫度 + 脫水鍵)並保持2 秒鐘，此功能就會被選擇。同時童鎖指示燈[☹]亮起。再次按下“童鎖”鍵並保持2 秒鐘，即可解除此功能。

 當設置了童鎖功能後，僅有電源鍵可以工作。如關閉電源後重新開啓，童鎖功能自動取消；如電源線拔掉和重新插上時，童鎖功能仍保持原設置。

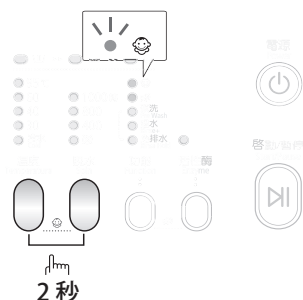

靜音功能

選擇此功能後，所有按鍵音關閉，包括洗衣結束後的提示音樂也同樣關閉。即便電源重複開啓關閉，該設置也會一直保持。

設置/取消方法：

同時按下(功能+活性酶)鍵並保持2秒鐘，此功能就會被選擇。同時此功能指示燈[🔇]亮起。再次同時按下(功能+活性酶)鍵並保持2秒鐘，即可解除此功能。

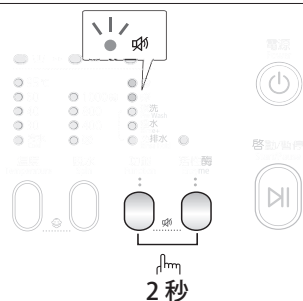

延遲啓動

當您需要延遲洗滌程序啓動的時間時，可以選擇此功能。您可以從3到19小時之間以每小時的增量來選擇一個您需要洗滌程序完成的時間。

1. 依照衣物種類，以手動或自動方式選擇一個洗滌程序。

2. 重複按鍵選擇您所需要的延遲啓動時間。

 當您選擇的洗滌程序所需時間大於3小時的時候，則應該選擇大於3小時的延遲啓動時間。

3. 按下啓動/暫停鍵。延遲啓動功能指示燈會亮起，時鐘開始倒數計時，直至到達完成時間為止。如果您選擇了3小時的延遲啓動時間則表示經過3小時後洗滌程序將全部結束。

4. 重複按鍵至顯示為所選程序的時間或按下電源鍵，即可解除此功能。

使用 FUZZY LOGIC 洗衣

這部全新的洗衣機採用 Samsung 的「Fuzzy Logic」自動操控系統，令洗衣工作變得更輕鬆。選擇某一洗滌程序時，洗衣機會自動設定合適的水溫、洗滌時間及洗滌速度。

1. 打開進水水龍頭。
2. 按下**電源鍵**啟動洗衣機。
3. 打開機門。
4. 將衣物一件一件鬆散地裝入洗衣桶內，不要過量裝入。
5. 關上機門。
6. 在相應的洗滌劑盒中加入洗滌劑、柔順劑、預洗洗滌劑(若有需要)。
-  預洗功能僅適用於標準洗和強力洗程序。僅在衣服較髒的情況下才有必要使用。
7. 選擇您所需的程序。共有十種程序可供選擇：標準洗、超快洗、強力洗、輕柔洗、羊毛洗、單洗滌、單漂洗、單脫水、單排水、桶清潔。
8. 此時，按適當的選項按鈕即可控制洗滌溫度、脫水速度及延遲時間。
9. 按 Fuzzy 操控面板上的**啟動/暫停**按鈕即可啟動洗滌過程。程序指示燈會亮起，同時洗滌過程的剩餘時間會顯示於顯示屏上。

暫停選項(停止和添加衣物功能)

在洗滌開始的五分鐘內，可以往洗衣桶內裝衣物或者向外取衣物。

1. 按下**啟動/暫停**鍵，打開門。
-  當水溫過高或者水位過高時，不可以打開門添加衣物。
2. 關上機門之後，繼續運行洗滌程序。

洗滌程序結束

程序結束時，提示音響起，同時LCD顯示幕上顯示程序運行結束提示“End”，等待5分鐘後，電源將自動關閉。

1. 打開門。
2. 取出衣物。

洗滌衣物

手動控制洗滌

您可以不使用Fuzzy Logic自動操控系統而進行手動控制洗滌。操作步驟：

1. 打開進水水龍頭。
2. 按下**電源鍵**啟動洗衣機。
3. 打開機門。
4. 將衣物一件一件鬆散地裝入洗衣桶內，不要過量裝入。
5. 關上機門。
6. 在相應的洗滌劑盒中加入洗滌劑、柔順劑、預洗洗滌劑(若有需要)。
7. 選擇您所需的程序。
8. 按下**溫度鍵**選擇適當的洗滌水溫：冷水(Clod), 30°C, 40°C, 60°C, 95°C。
9. 按下**脫水轉數鍵**選擇適當的脫水轉數。
免脫水功能可以讓您從洗衣機桶內直接取出濕衣服。(0：免脫水，指示燈不顯示時：免排水。)
10. 重複按鍵可依次選擇各種可用的**延遲啟動**選項。(延遲啟動時間從3小時至19小時不等，每次以一小時遞增)。程序將會在顯示的時間內完成。
11. 按下**啟動/暫停鍵**，開始運行洗滌程序。

洗衣常識及竅門

請按照下面的提示操作，這樣可以使您的衣物得到最好的洗滌效果。



檢查洗滌衣物上的標籤，或參閱附錄中的織物保養圖表，根據以下特性將衣物分類。

- 按面料保養標籤分類：衣物可分類為棉織品、混紡面料、合成纖維、絲綢、羊毛面料及人造纖維等。
- 按顏色分類：可分為白色和有色衣物。洗滌時應將白色和有色衣物分開洗滌。
- 按體積分類：把不同體積的衣物放在一起洗滌可改善洗滌效果。
- 按耐磨程度分類：單獨洗滌易損衣物，使用“羊毛洗”程序洗滌新的純毛衣物、窗簾及絲織品。

請取出口袋中的物品：

請您檢查並清空將要洗滌的衣物口袋，飾品、硬幣等堅硬的物體，可能導致洗衣機的損壞，或者發生異常故障。

帶金屬的內衣在洗滌過程中可能有金屬穿破內衣的現象，這樣會損傷衣物及內桶，因此要放在專用細密的洗滌網內進行洗滌。洗滌帶有拉鍊、鈕扣等有硬物品的牛仔褲、工作服時，請先扣好鈕扣再進行洗滌。

衣物上的飾品有可能損傷洗滌物，所以洗滌前請先將其取下。衣物上的帶子會纏繞其他衣物，所以請一定妥善系好。

洗滌劑選擇：

您的洗衣機配合使用合適的洗滌劑，可以達到最好的洗滌效果：節能、省時、節水、潔淨。如果當您要洗的棉織品比較髒時，請先使用專用洗滌劑進行預洗。

確定洗衣量：

請勿一次在洗衣機內裝入過多衣物，否則衣物將不能夠完全洗滌乾淨。根據下表確定各程序類別的洗滌容量。

程序	洗滌容量(公斤)
	WF8600NG
純綿 - 標準/一般 污染 - 強力污染	6.0 kg
化纖織品	2.5 kg
兒童護理	3.0 kg
輕柔織品	2.0 kg
羊毛織品	1.5 kg

-  當滾桶內的衣物放置不均衡時(面板上的“UE”指示燈會亮起)，請重新放置衣服。衣服放置不均衡，會使滾桶的旋轉效率下降。
 - 洗羽絨棉被時，會導致洗滌時間增加或者滾桶的旋轉效率降低。
 - 對於羽絨棉被，推薦的洗滌重量為1.8KG以下。

-  內衣等小件物品必須放在專用正規的洗滌網內洗滌。
 - 帶金屬的內衣在洗滌過程中可能有金屬穿破內衣的現象，這樣會損傷衣物及內桶，因此要放在專用細密的洗滌網內洗滌。
 - 襪子等小件物品可能會掉入門封中，建議裝入洗滌網(需另行購買)中洗滌。

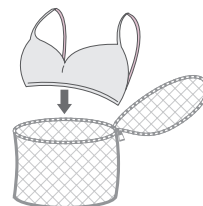

警告

根據衣物類別(綿織品、輕柔織物、化纖織物、羊毛面料)、顏色、洗滌溫度、髒汙程度和類型選擇洗滌劑進行洗滌。請勿將不同類型的衣物放入同一洗衣網內洗滌。如同時洗滌，會引起振動。請務必使用專用於滾桶洗衣機的“低泡”洗衣粉。

洗滌衣物

洗劑和添加劑的用法

如何選擇洗劑

您應根據衣料(棉質、合成纖維、輕柔衣物、羊毛)、顏色、水溫和髒汙程度選用適當的洗劑。切記使用專為自動洗衣機配製的“低泡”洗劑。

請參照洗劑製造商建議的衣物重量、髒汙程度及所在地區的水質硬度。若不清楚水質硬度情況，請向有關供水機構查詢。

 請勿使用經過硬化或凝固處理的洗劑，因為這種洗劑在漂洗過程仍可能留在桶內。它可能導致漂洗不能正常進行或洗劑流出受阻。

洗滌劑如何放入

您的洗衣機為洗劑和衣物柔順劑在洗滌劑盒中佈置了分格。確認在啟動洗衣程序之前，將所有洗劑、添加劑放入相應的格中。

 請不要在洗衣機運行過程中打開洗劑盒。

1. 拉開操作面板左側的洗滌劑盒。
2. 在程序啟動之前，直接往洗滌劑盒①中加入適量洗滌劑。
3. 如果您希望使用柔順劑，請在洗滌劑盒②中加入適量衣物柔順劑。
4. 如果您選擇了一個帶有預洗功能的洗滌程序，請在洗滌劑盒①中加入洗滌劑。

 當洗滌大件物品時，請勿使用下述類型的洗劑：

- 片狀和膠囊形的洗劑。
- 放在洗衣球或網裡使用的洗劑。

 在倒入前，必須用少量水稀釋濃縮或粘稠的織物柔順劑和調節劑，避免因堵塞而不能加入。柔順劑的使用不要過量，應不超過插件④“MAX”的基準下沿。

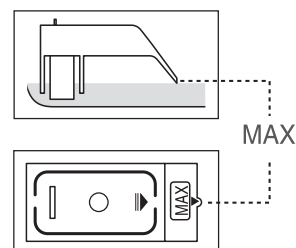
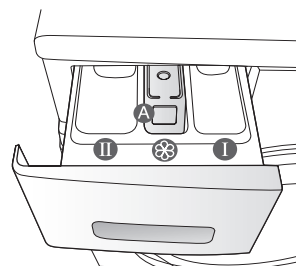

洗衣機的保養

保持您洗衣機的清潔可以提高它的工作性能, 減少不必要的修理, 並延長使用壽命。

緊急排水

1. 拔下洗衣機電源插頭。
2. 用一字起將洗衣機的底部擋板打開。

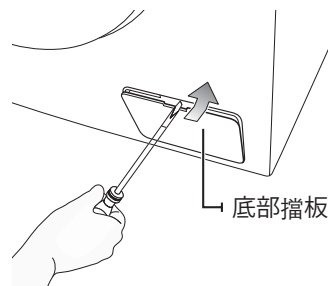

3. 向左旋轉並緩緩拉出緊急排水軟管。

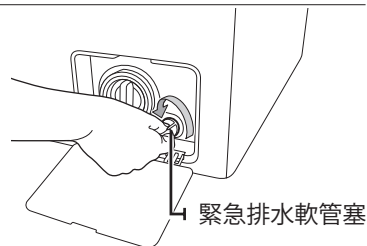

4. 打開緊急排水軟管的白色塞子。
5. 將殘留水排入容器內。
6. 蓋上塞子後將排水軟管推回原位。
7. 重新裝上底部擋板。

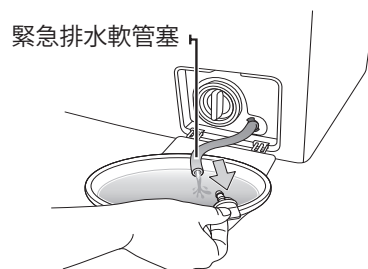

清洗洗衣機外殼

1. 用柔軟布料和不含磨蝕成分的家用清潔劑擦拭洗衣機外殼, 包括控制面板。
2. 用柔軟布料擦乾外殼。
3. 切勿用水沖洗外殼, 以免造成洗衣機部件的損壞。

洗衣機的保養

清洗洗滌劑盒

1. 按下洗滌劑抽屜內側上的釋放杆, 並拉出抽屜。
2. 除去抽屜裡的插件。

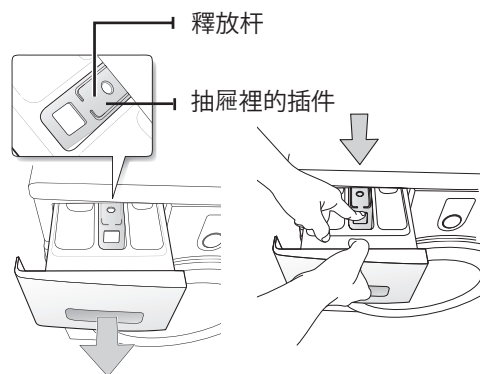

3. 用水清洗抽屜。

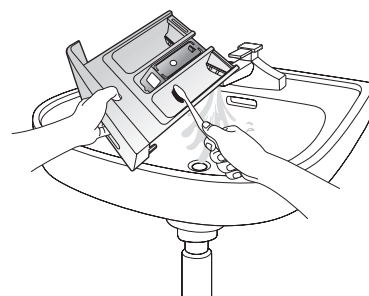

4. 用小刷子清理凹槽。
5. 將插件重新按入抽屜中。
6. 將洗滌劑抽屜裝回凹槽, 並確認推回到位。
7. 為了確保沒有洗滌劑殘留物, 請在沒有衣物的情況下, 運行一次過水程序。

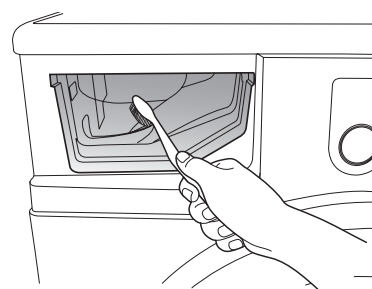

清洗殘渣過濾器

每年您應該至少清洗殘渣過濾器5-6次, 或者當顯示幕出現“5E”的錯誤訊息提示時清洗(參見前頁的“緊急排水”)。

1. 用一字起將洗衣機的底部擋板打開。
2. 向左旋轉並緩緩拉出緊急排水軟管, 打開白色塞子將殘留水排入容器內。
3. 向左旋轉擰開殘渣過濾器, 排除殘留水。

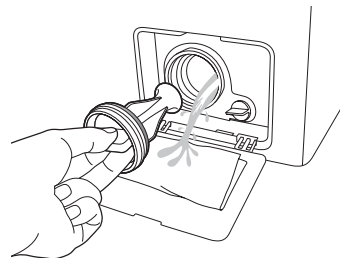

4. 清洗殘渣過濾器上的殘渣和污漬。並確保排水泵內部沒有被阻塞。
5. 將殘渣過濾器裝回原位。
6. 重新裝上底部擋板。

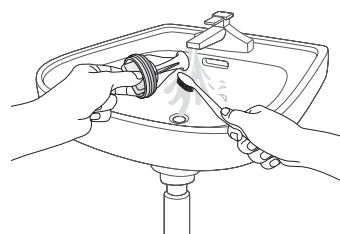

清洗進水閥過濾器

每年應該至少清洗進水閥過濾器一次, 或者當顯示幕出現“4E”的錯誤訊息提示時:

1. 關閉洗衣機進水水龍頭。
2. 從機器背面擰下進水管。
3. 使用夾嘴鉗輕輕地將進水閥過濾器從洗衣機進水閥連介面取下, 用水沖洗幹淨。同時也要清洗螺紋連接器的內側和外側。
4. 將進水閥過濾器安裝回原位。
5. 重新連接進水管。
6. 打開水龍頭, 確保水管連接處無漏水現象。

洗衣機的保養

處理已凍結的洗衣機

如果溫度低於攝氏零度，您的洗衣機被凍住，您可以：

1. 拔下洗衣機電源插頭。
2. 用溫水浸泡後的毛巾包裹水龍頭，再用溫水沖淋以使進水管解凍。
3. 卸下進水管，將其放入溫水浸泡。
4. 在洗衣桶內倒入溫水，並讓其置留10分鐘。
5. 重新將進水管連接到水龍頭上，檢查進水和排水是否正常。

儲藏洗衣機

如果需要長期儲存您的洗衣機，請將緊急排水軟管的白色塞子打開，把殘留水排出機器外。如果殘餘的水長期被留在洗衣機內，洗衣機可能會損害。

1. 選擇脫水程序，這樣可以排出殘留在洗衣機內的水。
2. 關掉水龍頭且分離進水管。
3. 拔掉洗衣機電源插頭，打開洗衣機門讓空氣流通。



如果你的洗衣機放置在零下的環境溫度中，在使用之前請先將洗衣機中注入溫水使其融化後使用。

故障排除

問題和解決方案

現象	解決方法
洗衣機無法啟動	<ul style="list-style-type: none">• 檢查電源插頭是否插好。• 檢查機門是否關緊。• 檢查供水龍頭是否已打開。• 檢查是否按了啟動/暫停鍵。
不進水或供水不足	<ul style="list-style-type: none">• 檢查供水龍頭是否已打開。• 檢查進水管是否結冰。• 檢查進水管是否被折彎。• 檢查進水閥過濾器是否被堵塞。
洗滌結束後, 洗滌劑仍留在洗滌劑盒內	<ul style="list-style-type: none">• 檢查洗滌時水壓是否足夠大。• 檢查洗滌劑是否放於洗滌劑盒的注入口。
洗衣機振動或噪音過大	<ul style="list-style-type: none">• 檢查洗衣機是否放置於不平坦的地面上。如果地面不平坦, 調整水平調整腳使其水平。• 檢查裝運螺栓是否被取下。• 檢查洗衣機是否碰到其他物品。• 檢查洗衣機內桶中的洗滌物放置是否均勻。
不排水或不脫水	<ul style="list-style-type: none">• 檢查排水管是否被壓住或折彎。• 檢查殘渣篩檢程序是否被堵塞。
洗衣機門無法打開	<ul style="list-style-type: none">• 檢查是否設置了童鎖功能。• 檢查桶內的水是否排幹。• 檢查門鎖燈是否熄滅。桶內的水排幹後, 門鎖燈熄滅。

若問題仍未解決, 請聯繫當地的三星客戶服務部門。

故障排除

錯誤訊息說明

當洗衣機產生故障時，螢幕上會顯示出相應的錯誤訊息代碼。那樣的情況下，您可以在聯繫客服之前依照此表嘗試解決問題。

錯誤代碼	解決方法
dE	<ul style="list-style-type: none">檢查機門是否開著，請關緊機門。。
4E	<ul style="list-style-type: none">檢查進水龍頭是否打開。檢查水壓。
5E	<ul style="list-style-type: none">清洗殘渣過濾器。檢查排水管是否被正確安裝。
UE	<ul style="list-style-type: none">機內衣物擺放不均勻，鬆開纏結衣物。 若只洗滌一件衣物，例如浴袍或牛仔褲，最後脫水效果可能不理想，顯示視窗會出現「UE」錯誤訊息。
LE	<ul style="list-style-type: none">檢查排水管末端是否太低。(檢查排水管托架是否損壞)檢查排水管末端是否浸泡在水裡。

在聯繫售後服務部門前：

1. 嘗試解決問題(請參閱本頁之「疑難排解」)。
2. 重新啟動程序，觀察是否再次出現同樣問題。
3. 若問題仍未解決，請致電售後服務供應商並說明故障情況。

程序表

程序表

(● 可隨意選擇, - 不可選擇, √ 必須選擇)

程序	最大洗衣量(公斤)	洗滌劑和柔軟劑			最高溫度 °C	最高脫水轉速 (轉/分鐘)	功能		
	WF8600NG	預 洗 劑	洗 滌 劑	柔 軟 劑		WF8600NG	延 遲 啓 動	高 水 位	活 性 酶
標準	6.0	●	√	●	95	1000	●	●	●
快速	3.0	-	√	●	30	1000	●	●	-
強力	6.0	●	√	●	95	1000	●	●	●
輕柔衣物	2.0	-	√	●	30	800	●	●	-
羊毛	2.0	-	√	●	40	800	●	●	-
單洗滌	3.0	-	√	-	40	-	●	●	●
過水	-	-	-	●	-	1000	●	-	-
脫水	-	-	-	-	-	1000	●	-	-
清洗洗衣桶	-	-	√	-	60	1000	●	-	-





1. 帶預洗的洗滌程序執行時間要比一般程序要長約15分鐘。
2. 程序運行時間按照標準 IEC 60456 / EN 60456 所列之條件測量而出。
3. 由於水壓和水溫、洗衣量及衣物類別不同, 各家庭的具體使用情況可能與表中所列的資料略有不同。
4. 當您選擇強力洗程序洗滌衣物時, 洗滌時間將相應延長。

附錄

衣物保養符號說明

以下的衣物保養符號指導您怎樣護理衣物。這些符號使用了五種基本圖形來依次表示洗滌, 漂白, 烘乾, 熨燙, 和乾洗(如果需要的話)。

這些符號的使用為國產和進口衣物的製造商建立了一致性。遵照這些指示可以最大化延長衣物的壽命, 並幫助您減少衣物洗滌過程中產生的問題。

	耐磨質料		最高熨衣溫度為 100°C	
	輕柔質料		不能熨衣	
		可於 95°C 水溫下洗滌之衣物		可使用任何溶劑乾洗
		可於 60°C 水溫下洗滌之衣物		僅可使用高氯化物、打火機油、純酒精或 R113 乾洗
		可於 40°C 水溫下洗滌之衣物		僅可使用飛機燃料、純酒精或 R113 乾洗
		可於 30°C 水溫下洗滌之衣物		不能乾洗
	可手洗之衣物		攤平晾乾	
	僅可乾洗		可掛起晾乾	
	可以氯漂		以衣架晾乾	
	不可漂白		可使用乾衣機, 一般熱度	
	最高熨衣溫度為 200°C		可使用乾衣機, 低熱	
	最高熨衣溫度為 150°C		不能使用乾衣機	

環保資訊

- 本產品使用循環再造物料製造。若要棄置本產品, 請遵守當地的廢物處理規則。棄置前請切斷電源線, 以免本產品連接電源, 拆除機門, 以免小動物或孩童困於機內。
- 遵照洗劑製造商的用量指引, 切勿過量使用洗劑。
- 若非必要, 不要在洗衣過程進行前使用除污產品或漂白劑。
- 用盡洗衣容量(確切數量視所用程序而定), 以節省水電。

產品執行標準

本產品符合歐洲安全標準、EC directive 93/68 及 EN Standard 60335。

技術參數

類型			前置式滾桶洗衣機	
外型尺寸			WF8600NG	
			寬598X厚610X高845 (毫米)	
水壓			50kp~800kp	
用水量			72升	
產品淨重			59 kg	
洗滌和脫水容量			6.0 kg	
消耗功率	型號		WF8600NG	
	洗滌		220 V	150 W
			240 V	150 W
	洗滌和加熱		220 V	2000 W
			240 V	2400 W
	脫水	型號	WF8600NG	
		230 V	500 W	
	排水泵		34 W	
最高脫水轉速	型號		WF8600NG	
	轉/分鐘		1000	
洗滌噪音	聲壓級 (A計權)		47dB	
	聲功率級 (A計權)		59dB	
脫水噪音	聲壓級 (A計權)		56dB	
	聲功率級 (A計權)		68dB	

今後可能由於為提高整機性能而對外觀及規格進行的更改, 恕不另行通知。



有疑問或意見？

國家	致電	或造訪我們的線上服務, 網址:
Hong Kong	3698-4698	www.samsung.com/hk

編號: DC68-02624G_HKTC