

- 세탁기를 잘 사용하기 위해 제품 사용전 반드시 모든 설명서를 잘 읽어보세요.
분실하실 경우 따로 구입해야 합니다. 보관에 주의하세요.
- 이 제품은 국내(대한민국)용입니다. 전원, 전압이 다른 국외에서는 사용할 수 없습니다.
- 세탁기를 처음 설치할 때 배수호스에서 물이 약간 나오는 것은 공장에서의 성능 검사 후 남아 있는 물입니다.
- 제품의 외관, 사양 등은 제품개량을 위해 사전예고 없이 변경될 수 있습니다.
- 공용 설명서로 설명서의 그림은 구입하신 제품과 일치 하지 않을 수 도 있습니다.

▪ 서비스센터 대표번호 전국 어디서나

1588-3366

▪ 사이버 서비스센터 홈페이지

www.samsungsvc.co.kr

제품 모델명, 고장상태, 연락처를 정확히 알려 주시면 고객 여러분의 궁금한점을 언제나 친절하게 상담, 빠른 서비스를 제공합니다. 고객이 직접 원하는 날짜와 시간에 서비스 접수 및 실시간 사이버 상담이 가능한 사이버 서비스센터를 운영하고 있습니다.

▪ 삼성전자주식회사

제 조 자 : 삼성광주전자(주)
제 조 국 가 : 대한민국

▪ 고객센터

02-541-3000 / 080-022-3000

▪ 인터넷 홈페이지 www.sec.co.kr / www.hauzen.com

▪ 인터넷 쇼핑몰 www.gosamsung.co.kr



AS마크란? 사후봉사가 우수한 기업에 대해 국가기관인 산업자원부 기술 표준원이 품질을 보증하는 인증마크입니다.

Hauzen

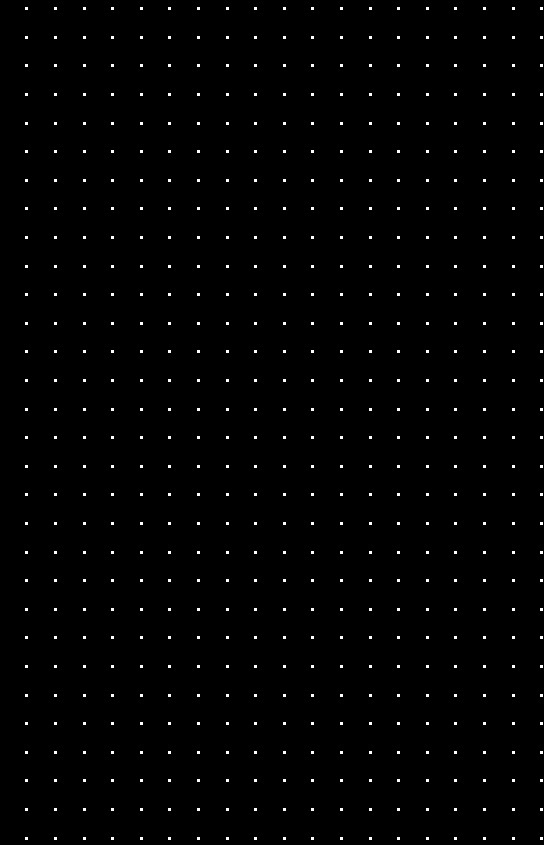

하우젠드럼세탁기
**SEW-5HW116A/5HW117A/
5HW118AB/5HW118SA**



가

(')가

/
13

1

Ag⁺
Nano System

(A g+)

가

가

가

가

59

가

95

가

가

1
가

!
주의

P 10

_____	3
_____	9
_____	10
_____	11
_____	12
_____	13
_____	15
_____	17
_____	21
_____	23
_____	25
_____	27
_____	29
_____	31
/ _____	32
/ _____	33
/ _____	34
_____	35
_____	36
/ _____	37
_____	38
_____	39
_____	40
_____	41
_____	42
_____	42
_____	43
가 _____	44
_____	45
_____	47
가 _____	49
_____	50
_____	51
_____	52

경고



220V 가

220V 가

경고

주의

가 가

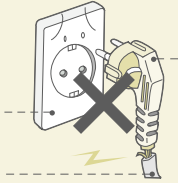

가

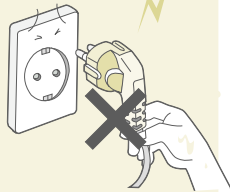

220V/15A

가

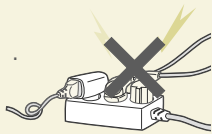

가

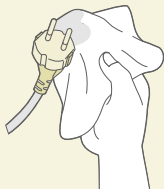

p11

주의

가

참고 용어*

6월

⊘

☰

가

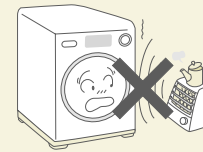

110V

220V

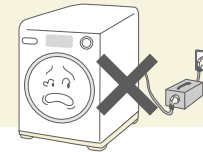

가

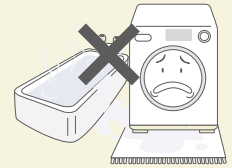

(,)

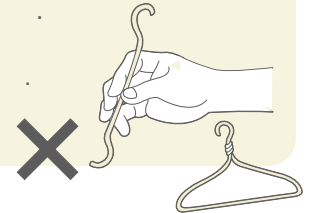

가



가

가

가



가

가
가
,
'가'
가



가



(/)

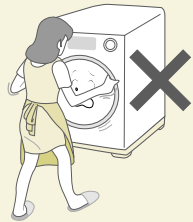

! 주의



2

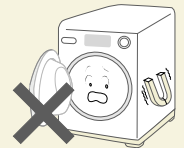
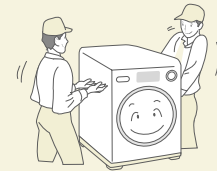

가

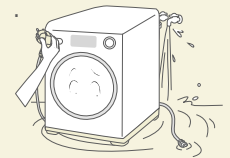

[/]



가
가

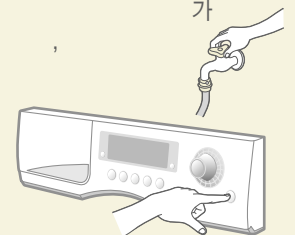

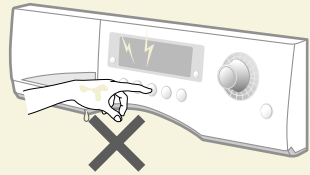

가

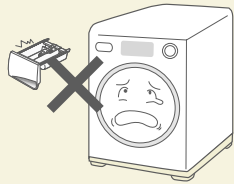

가

p 46



가

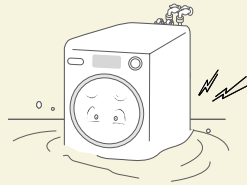

가

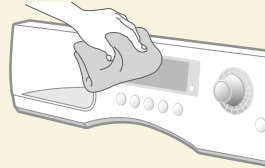

가



가 가

가

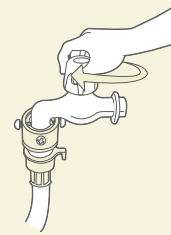

가



()

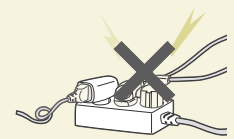

(, , ,)

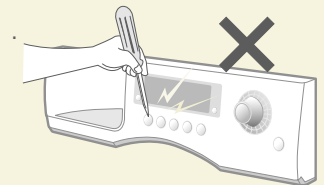
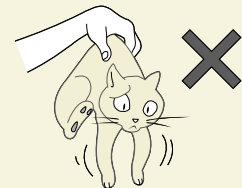

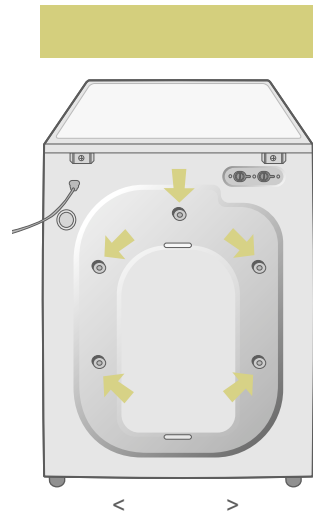
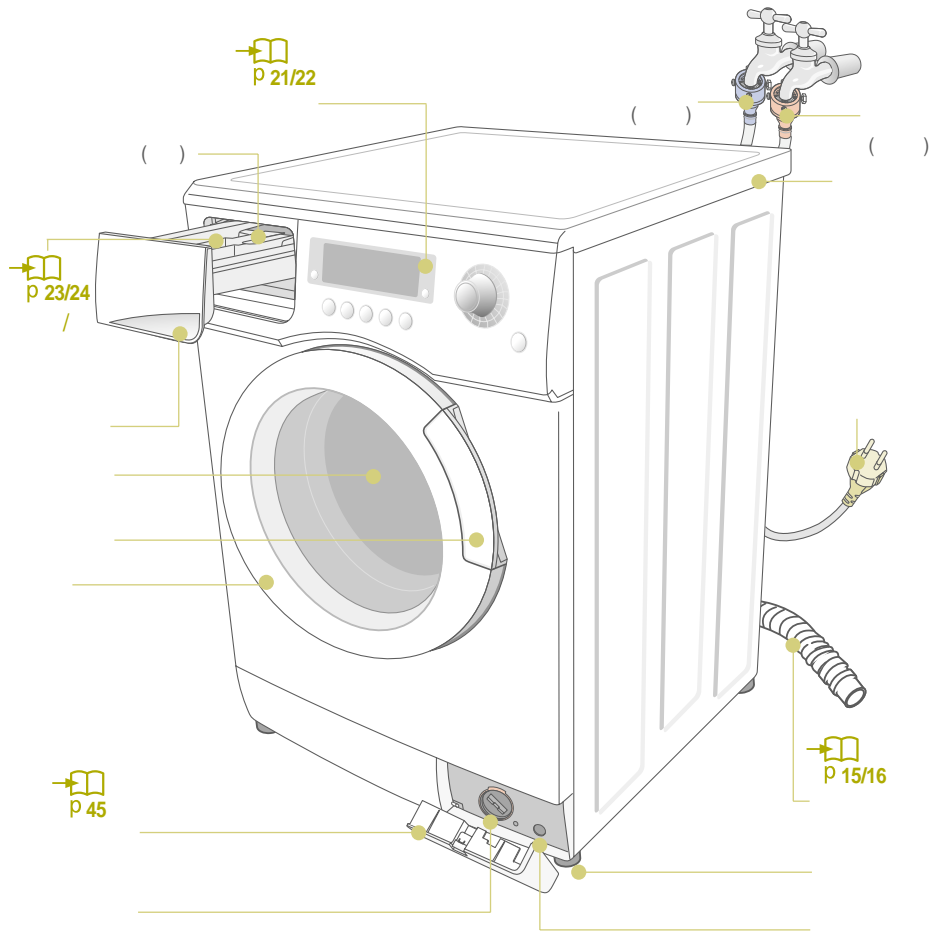

! 주의 5

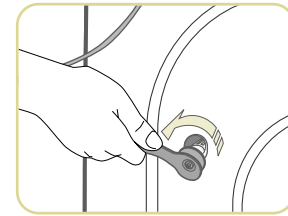

1.

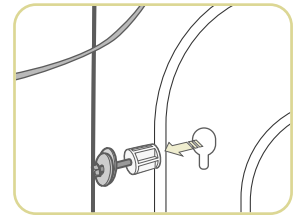

2.

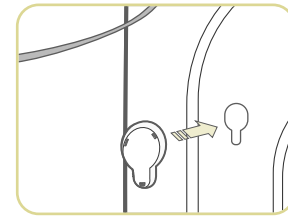

3.

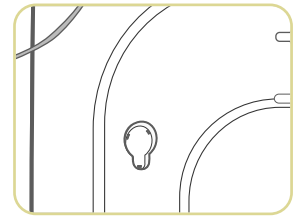

4. 5

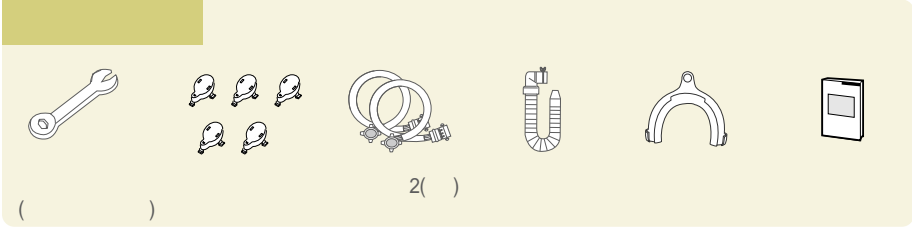

참고 가 () 가

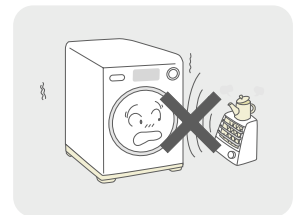
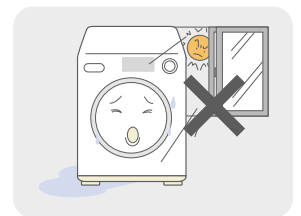
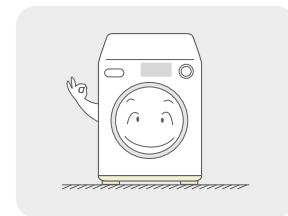

가 가 가

가

가
가
가

1

()

2-3

2

75cm

가

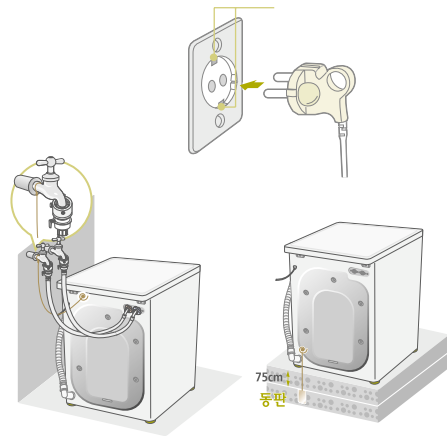

주의

가

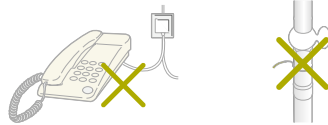

참고

1

10cm

10cm

10cm

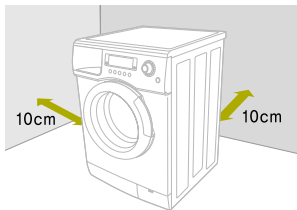

2

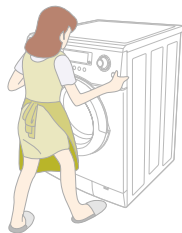

3

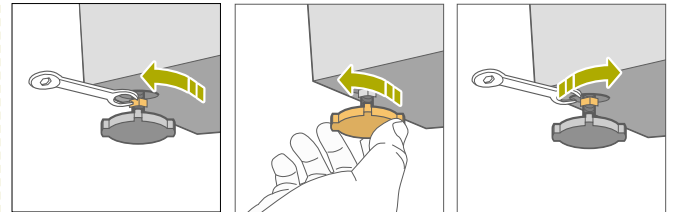
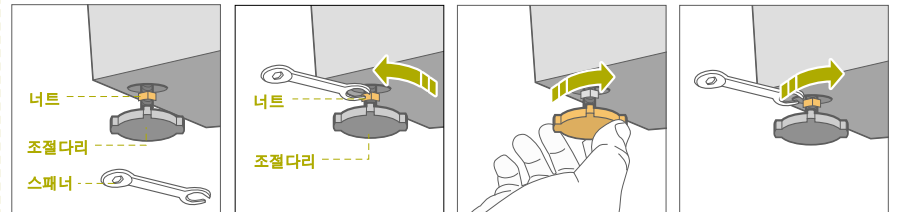

주의

가

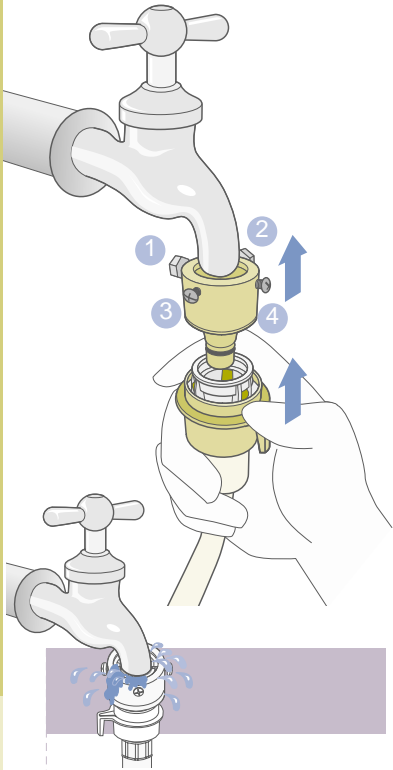

()

1

4

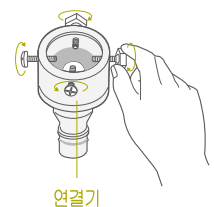

연결기

2

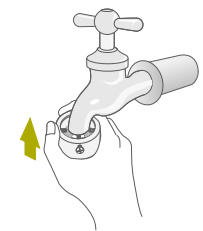

3

4

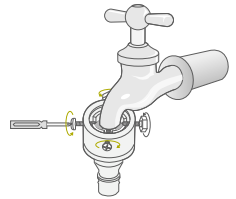

4

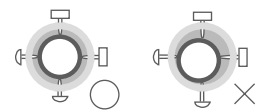

가

가

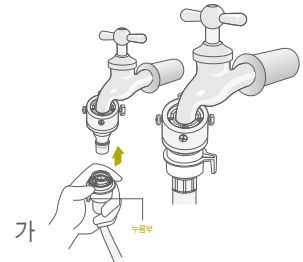

가

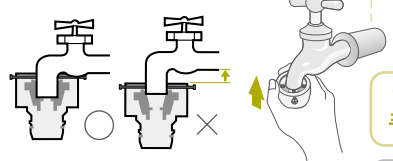

! 주의

참고 가 가

(/)

! 주의

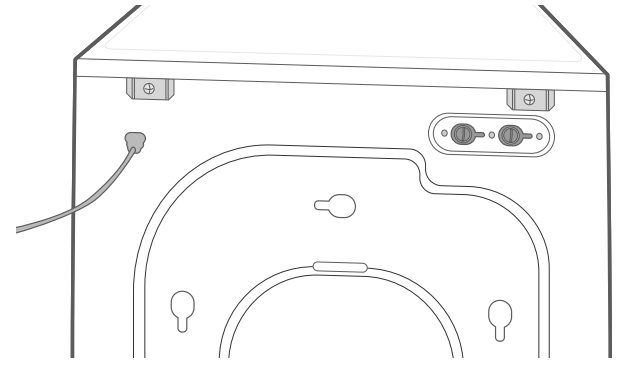

가

가

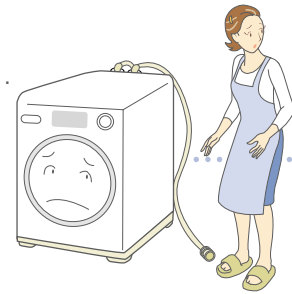

1

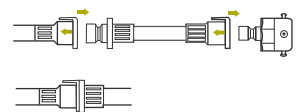

2

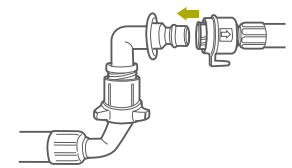



1

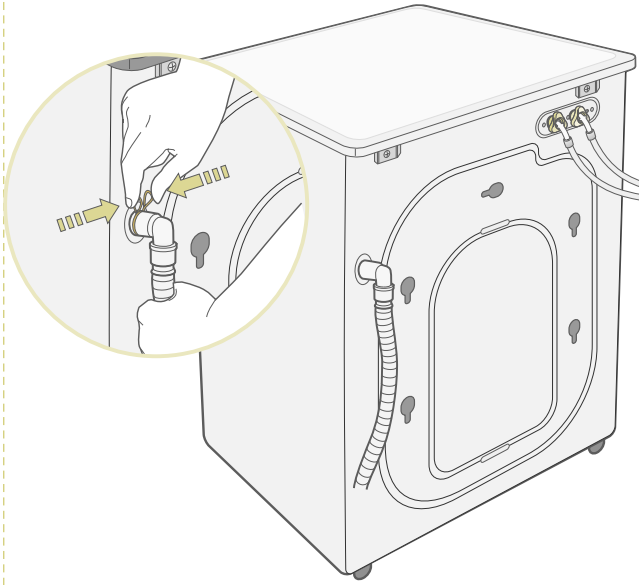
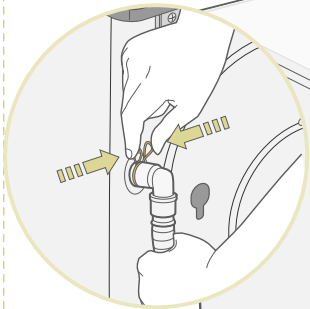

2

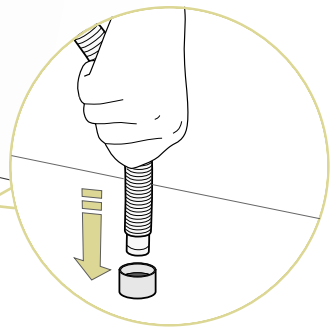
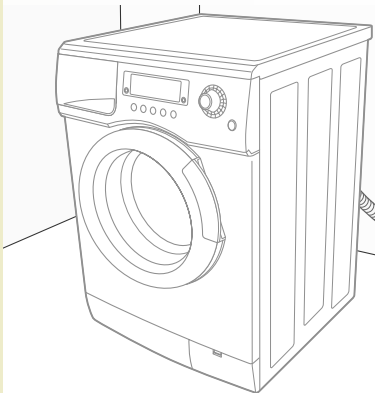

가

가

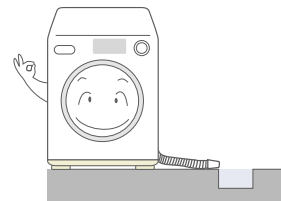
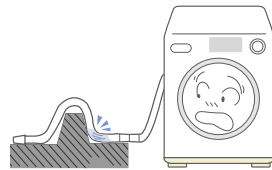
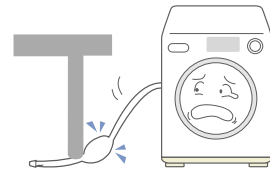

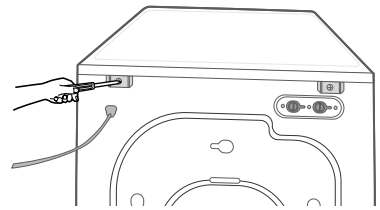

15mm

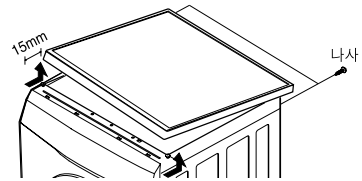

A

B

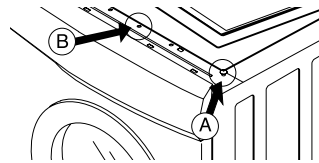

3



5mm

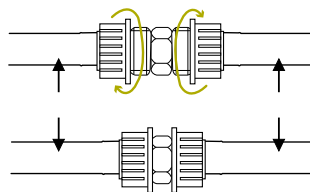
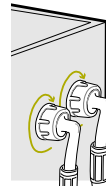
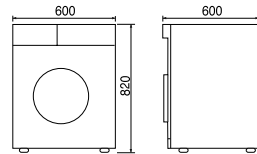

1588-3366

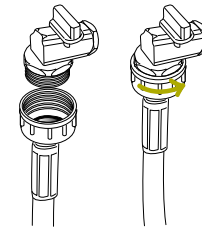

가
가

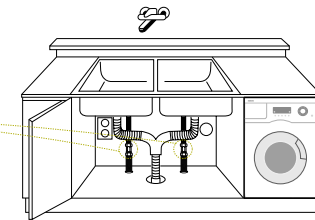
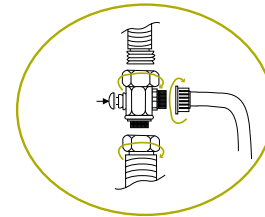

가
(ㄹ)

ø80mm

가

가

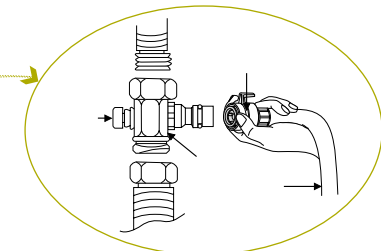
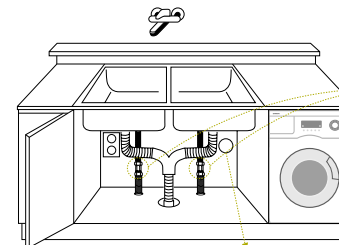

ø80mm

ASSY-VALVE

1

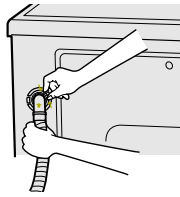

2

0.8m ~ 1m

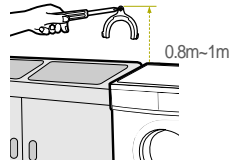

3

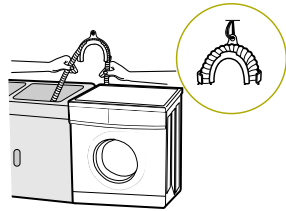

1

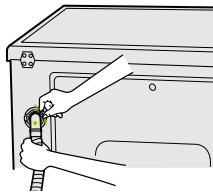

2

가

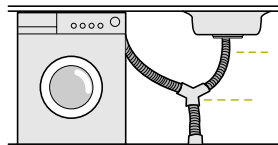

⋮

가

가

1

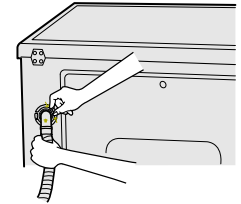

2

가

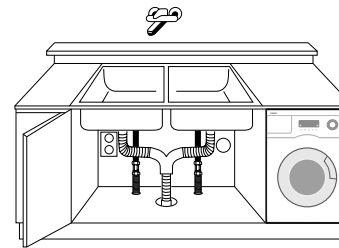

가

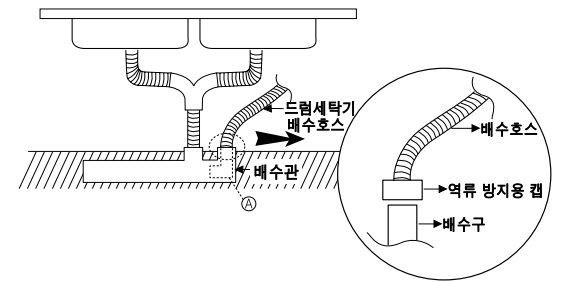

1

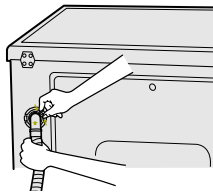

2

가

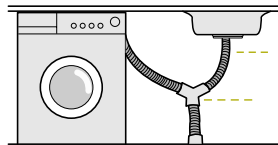

⋮

가

• P15~16

•

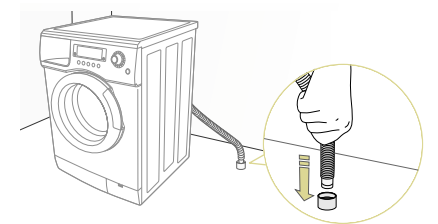
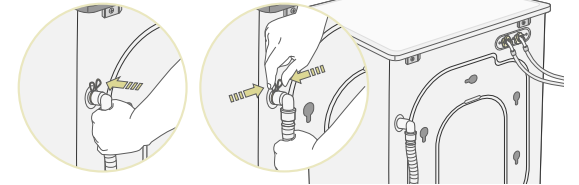

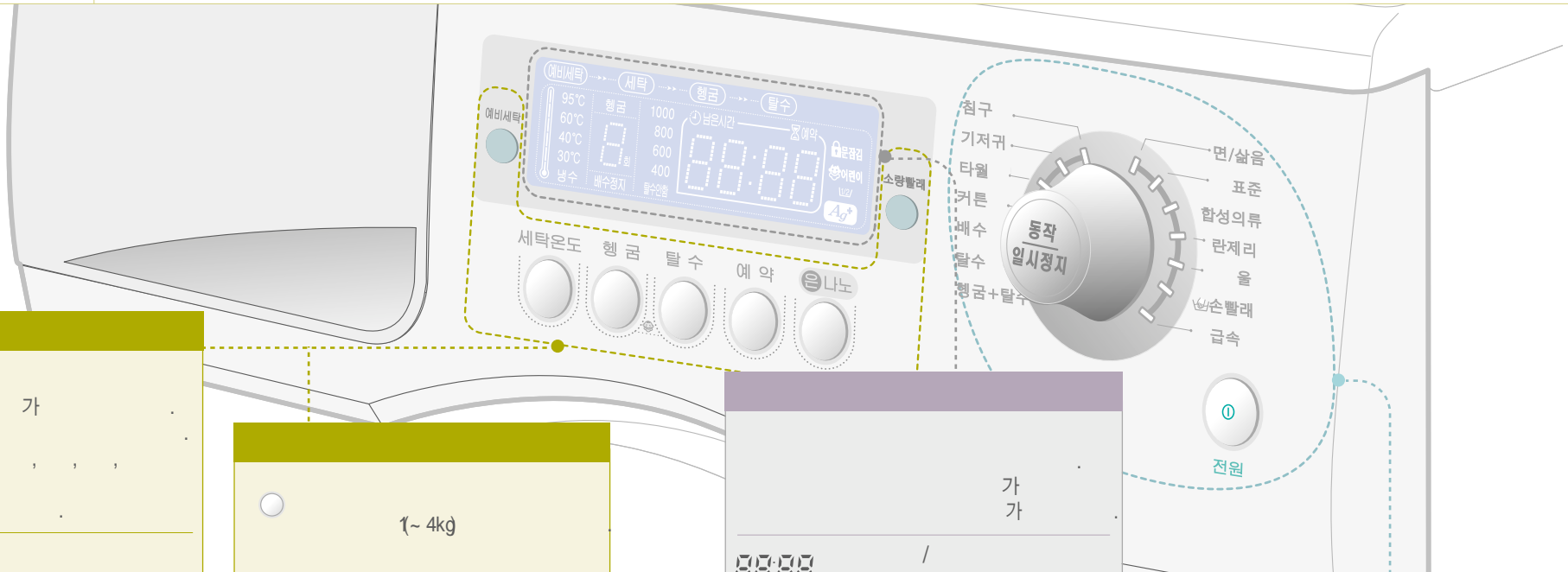

예비세탁
 P31 가
 +
 세탁온도
 40°C가
 60°C / 가
 헵굼
 5가
 탈수
 P42 400rpm [], 800rpm []

1~4kg
 나노
 가 가
 P39 가 가
 예약
 P43 3 1 가 가
 24 가
 off
 헵굼 가
 + [] []
 탈수 3

가 가
 00:00 /
 가 가
 P49 가 가
 1/2/
 Ag+

 P44 가 가

전변 () 가 ()
 10
 /
 가

주의

가

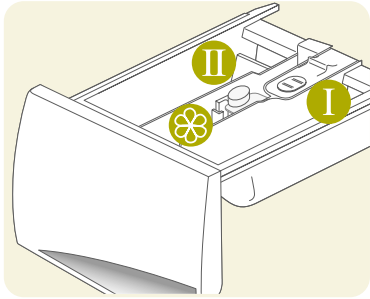

I

II

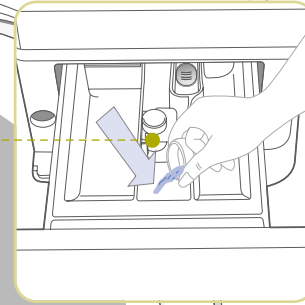
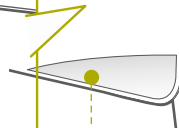
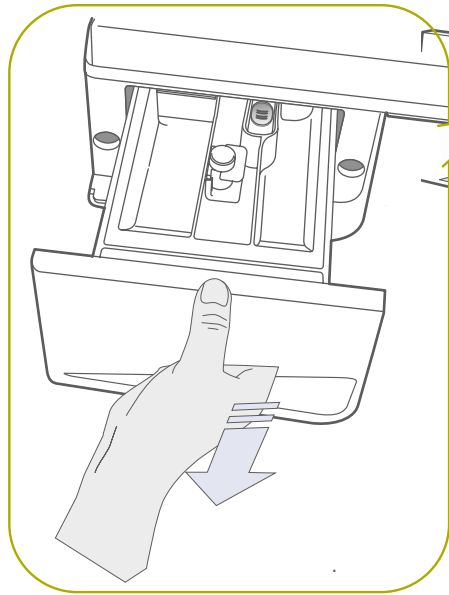

1

2

3

가

참고

가

가

가

주의

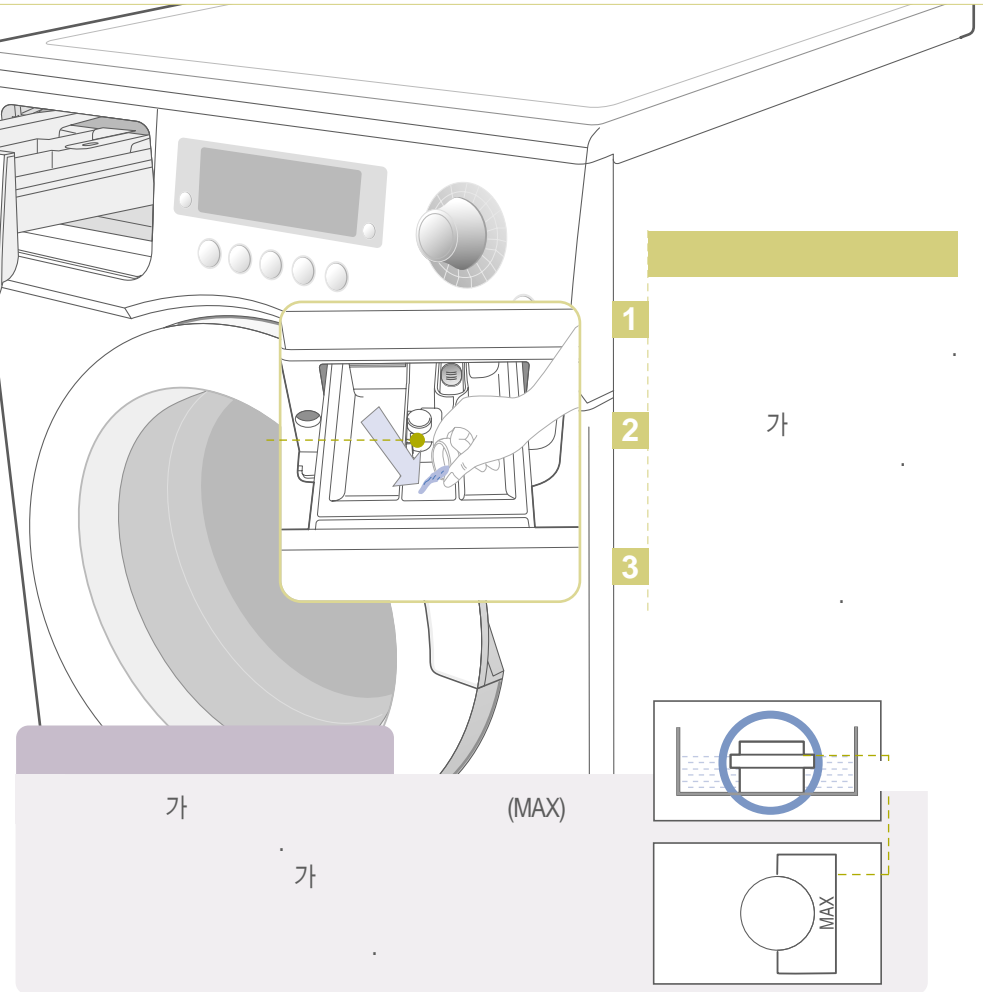

가

(MAX)

가

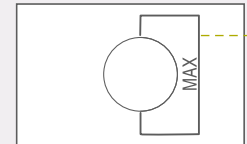
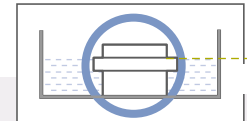

주의

가

1 1

p 45-46 ()

가

가	()			
	7kg	80g	35g	40g
7kg-5kg	70g	30g	35g	
5kg-3kg	35g	20g	25g	
3kg	20g	15g	20g	

15~20

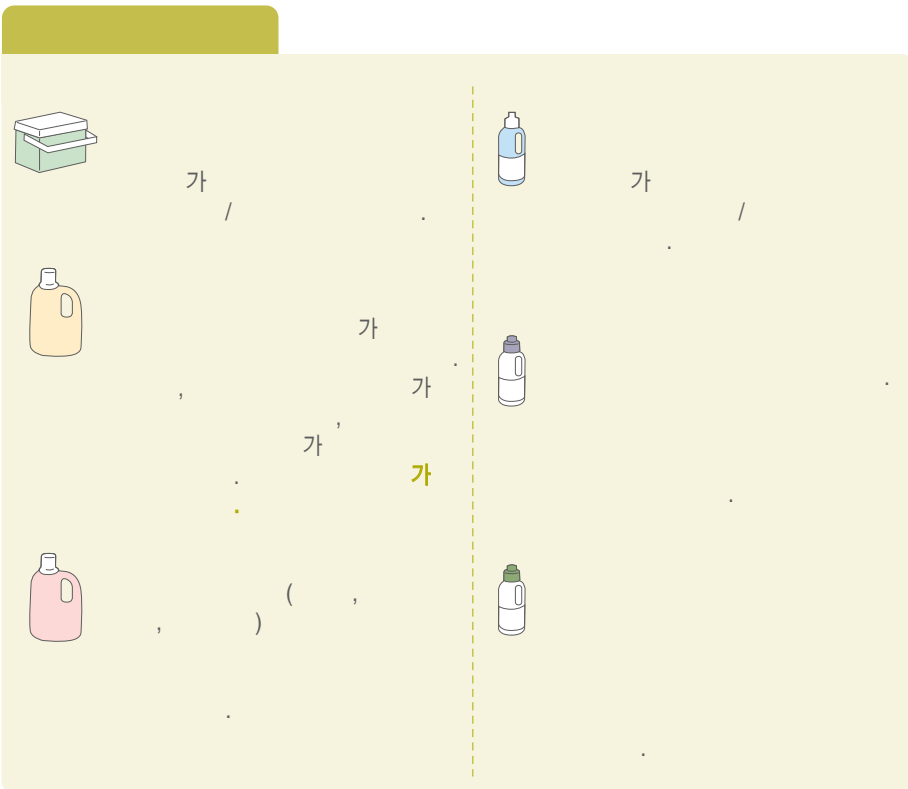

(KSK-K-0021)

주의

	• 95°C 가 • 가		• 60°C 가
	• 40°C 가 • 가		• 30°C •
	• 30°C 가 •		•

	• ()		•
	•		•
	• ,		• ,
	• 180-210°C		• 180-210°C
	• 140-160°C		• 140-160°C
	• 80-120°C		• 80-120°C
	•		
	•		•
	•		•
	•		•
	•		•

! 주의

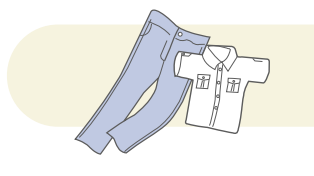
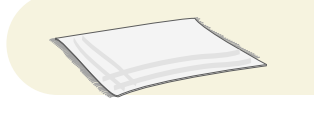
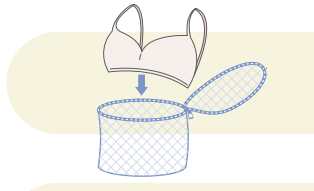
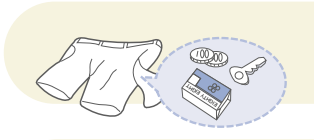

[Solid yellow bar]

가

가

가

(, ,)

가

(,)

가

가

가

가

가

가

가

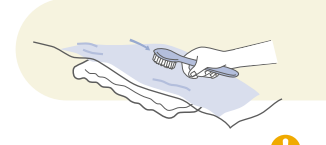
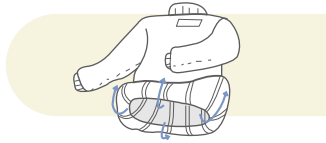

! 주의



가

가 (,)

가 , 가 , 가

가 ,가

가

가

(,)

1

주의
(
,
).

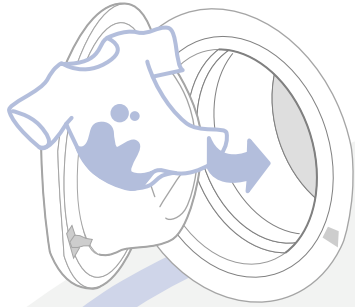

6



5

[/]

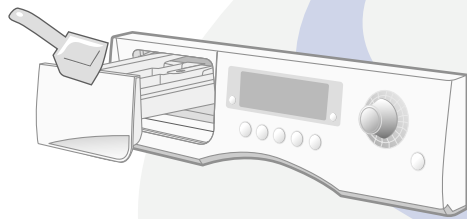

2

p 23~26



[]

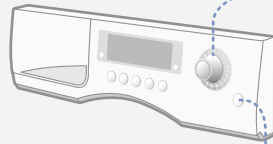

3

[]

(40°C)가



4

[]

p 31~43

1 / / 가

2 () (MAX) 가

3 [] 전원 800rpm 40°C, 3, , 30°C, 40°C, 60°C 가

4 [] 가 [] []

1 /

2

3 [] 전원 가

4 [] 800rpm 60°C, / 3

5 [/]

15

참고

주의

참고

주의 95°C (, , 100%) 가 가

1 [/]

2 [/]

3 [] 가 전원

4 []

40°C, 3, 800rpm
, 30°C, 40°C, 60°C, 400rpm, 600rpm, 800rpm
40°C, 3, 600rpm
, 30°C, 40°C, 400rpm, 600rpm

5 [/]

참고 [/] []

4kg 2kg

1 [/] 가

2 [/]

3 [] 가 전원

4 []

400rpm 30°C, 3,
, 30°C, 40°C, 400rpm

5 [/]

참고 [] 2kg

3kg

1 [] 가

2 []

3 [] 전원

4 [] 30°C, 800rpm 2, 30°C, 40°C, 60°C

5 [/] 동적 일시정지

1 []

2 []

3 [] 전원

4 [] 40°C, 3, 800rpm, 30°C, 40°C, 60°C, 400rpm, 600rpm, 800rpm

5 [/] 동적 일시정지

참고 [] 가 가

주의 [] ()

가 [] : 10%()

+ : 35kg

: 35kg(5kg)

: 0% (200cmx300cm)

1

2

3 [] 가

전원

4 []
800rpm, 60°C, 3

동작 일시정지

5 [/]

동작 일시정지

! 주의 95°C (, , 100%)
가

가

1

2

3 [] 가

전원

4 []
800rpm, 40°C, 3

동작 일시정지

5 [/]
, 30°C, 40°C, 60°C

동작 일시정지

참고 가 가

가

1	[]
2	[]
3	[]
4	[]
5	[] [] [] [] []
6	[/]

전원

동작 일시정지

나노

MAX 가

참고 : 가



가





1	[]
2	[]
3	[]
4	[]
5	[] [] [] []
6	[/]





전원

동작 일시정지

발수

 1 []	가
 2 []	
 3 [/]	가

 1	
 2 []	가
 3 [] [+]	1, 800m [] []
 4 [/]	5 가 가

 1	
 2 []	가
 3 []	800m
 4 [/]	가

1 []

2 []

3 [] 가

4 []

5 [] 3 ~24 1 가

6 [/])3 -3

전원

동작 일시정지

예 약

전원

참고

()	()	55° ↓
가	가	
가 55°C	가 (55°C 가)	
	[/]	
	가	

! 주의 가 ().



1

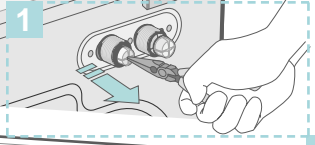
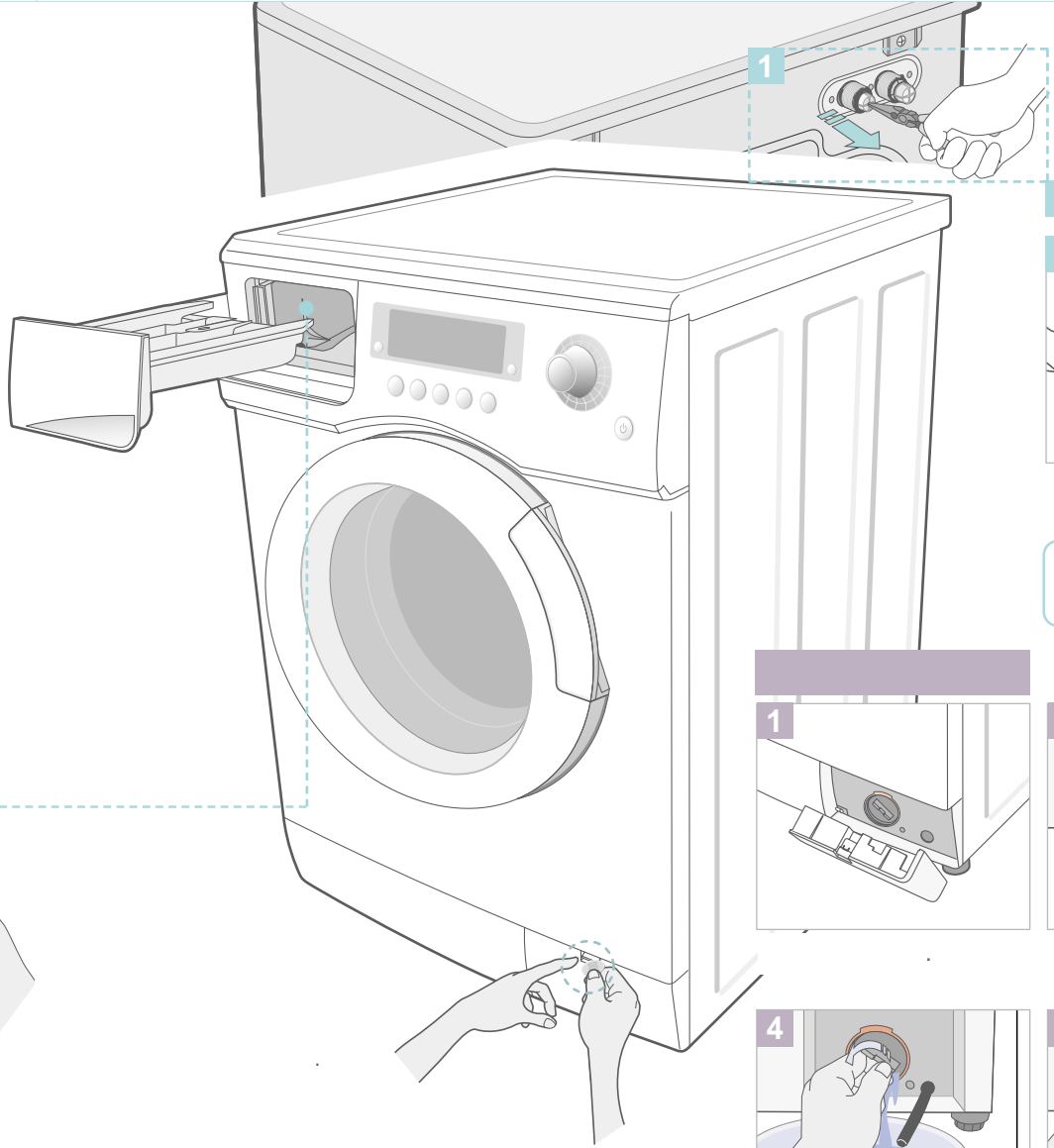
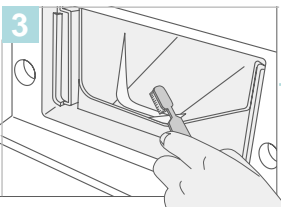
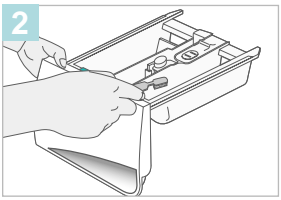
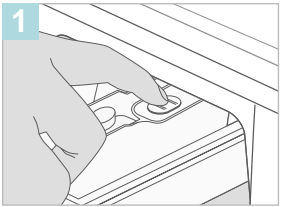

1

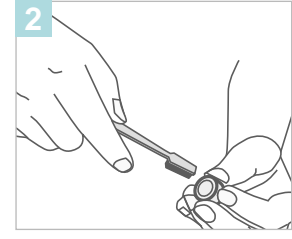

2

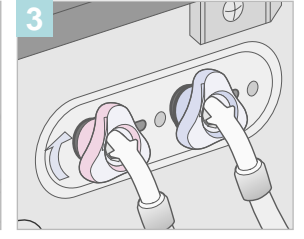

3

! 주의

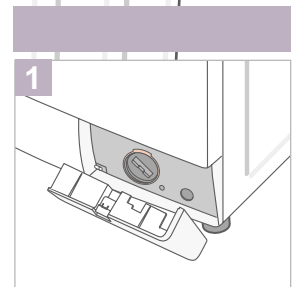

1

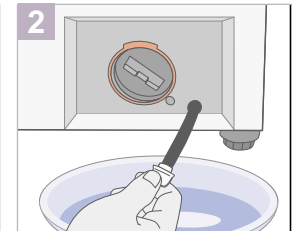

2

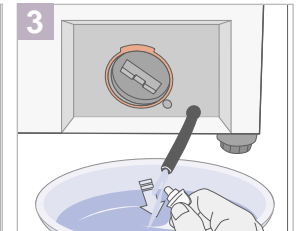

3



4

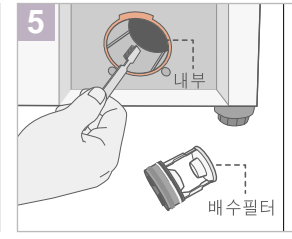

5

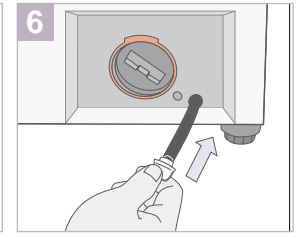

6



! 주의
가



	가 ?	
	가 ? 가	
	가 OFF 가 ?	ON
	110V 가 ?	220V
	가 ?	[]
	가 ?	
	가 ? 가	가 가
	() 가 ?	
	가 ?	가
	가 ?	50°C
	가 ?	

가	가 ?	가
	가 가 ?	60°C 10
	가 가	
	(,)	
가	()	
	1.	10
	5	
	2.	
	3. 가	
	4. 60°C 10	1
5.		
	가 가	[]
	2	()
가 ,	가 ?	(46)

가

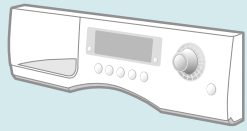

2007

2E

3E

4E

5E

3E...

가

가

가

가

[/]

가

[/]

4E가

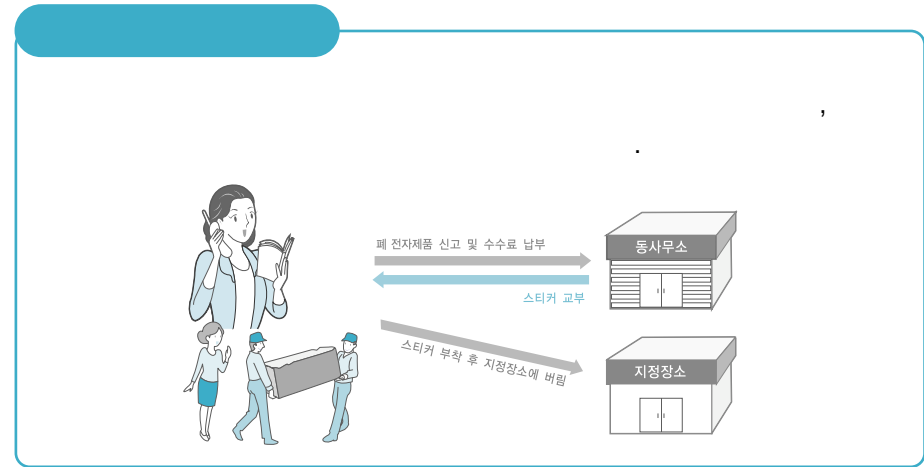
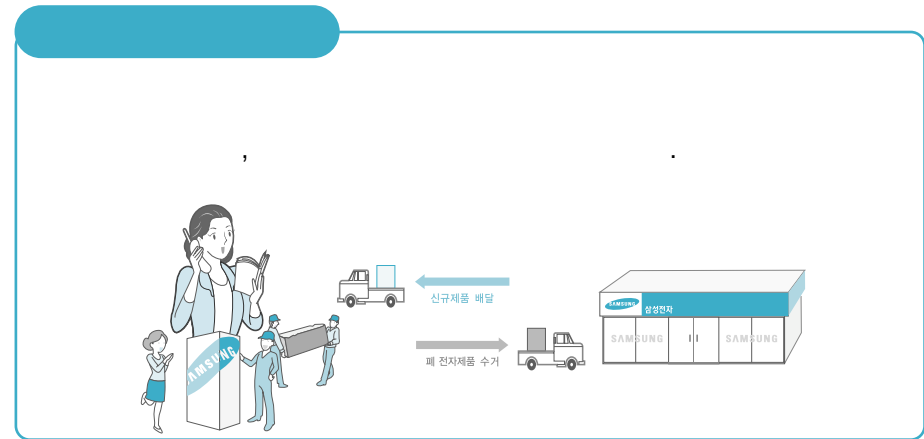

[]

6

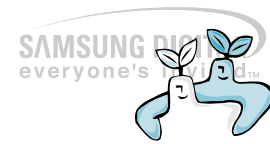

5 []

66

			9.0kg
	220V / 60Hz		9.0kg
			70
			50 /
	0.05~0.78Mpa(0.5~8kgf/cm ²)		
x x (mm)	600X600X850		
	75kg		
	: 150 W / 가	: 2150W	

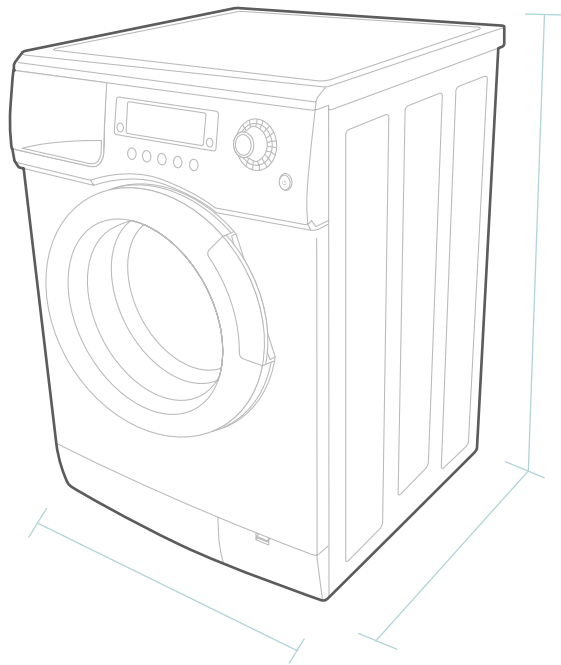

		SERIAL NO.	



()

5 7 14



	10	가	
	1		
	1	가	
가	3		
	4		
	5	가	가 10%
가 가			가
가 가	가		가
가 가			가



(가 가)

	2	
	1	() 가
	1	(, ,) ()