

**SAMSUNG**

# WASHING MACHINE

## *Silver Nano Health System User's Manual*

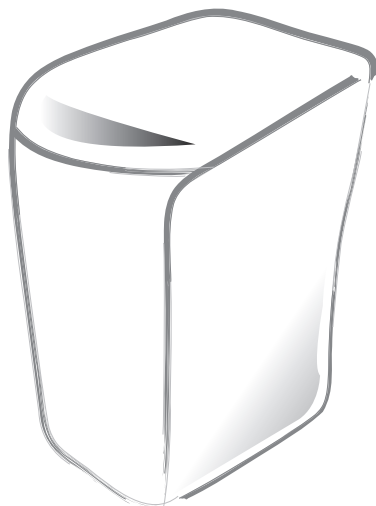

- *Please read this manual before using and note how to use in the proper manner.  
Please be careful of keeping the manual.  
Otherwise, it should be bought separately.*
- *The User's Manual is for common use.  
Make use of the User's Manual depending upon your washing machine model.*

<b>FEATURES</b> .....	2
<b>SAFETY INSTRUCTIONS</b> .....	3
<b>DESCRIPTION OF PARTS</b> .....	4
<b>CHECKING BEFORE WASHING AND CARING FOR GARMENTS</b> .....	5
<b>CONTROL PANEL</b> .....	6
<b>HOW TO WASH AUTOMATICALLY DEPENDS ON THE LAUNDRY</b> .....	7
Keeping the tub clean .....	8
<b>MANUAL FUNCTIONS</b> .....	9
<b>INSTALLATION &amp; MAINTENANCE</b> .....	10
ENVIRONMENT .....	10
LEVELLING .....	10
CONNECTING THE WATER SUPPLY HOSE .....	11
ASSEMBLING THE RAT PROTECTION PANEL .....	11
HOW TO CONNECT THE DRAIN HOSE .....	11
HOW TO ADD THE FABRIC SOFTENER .....	12
HOW TO PUT THE DETERGENT IN .....	12
WATER SUPPLY CONNECTOR FILTER .....	12
CLEANING THE FILTER .....	13
HOW TO CLEAN THE PUMP FILTER .....	13
<b>TROUBLESHOOTING</b> .....	13
<b>WASHING MACHINE WON'T WORK?</b> .....	14
<b>SPECIFICATIONS</b> .....	14

Register your product at  
[www.samsung.com/global/register](http://www.samsung.com/global/register)

CODE NO.: DC68-01970B-03\_EN

## FEATURES

### ■ Silver Nano Health System

This is a washing control system that protects the skin from harmful bacteria and that enables refreshing cleansing and sanitation through anti-bacteria coating and by killing bacteria that are hidden in clothes at the time of washing or rinsing.

Moreover, it prevents proliferation of bacteria through anti-bacteria coating of washed clothes.

- Sterilization algorithm
  - Nano-silver fast water during washing
  - Initial washing with powerful water stream
  - Soak for a fixed period of time (sterilize afterwards)
  - Finish after regular washing
- Anti-bacteria coating
  - Nano-silver fast water during the last rising from regular stroke
  - Soak for a fixed period of time during rinsing (anti-bacteria coating in between)
  - Finish rinsing

### ■ CAS SYSTEM option

- CHILD LOCK FUNCTION
- AUTO RESTART
  - The power is turned on automatically after power failure.
- SAVING ENERGY
  - The SPEEDY COURSE, it is a wash course to saving the energy reduces laundry time for frequent and soiled clothes.

### ■ DIGITAL (FUZZY) CONTROL

DIGITAL (FUZZY) control operates with best washing course by sensing the washload like artificial intelligence.

### ■ TRANSPARENT WINDOW option

This Transparent Window is the new concept to solve the curiosity of users to see inside of washing machine while operation.

While operation, the laundry progress inside of washing machine can be checked by looking through the transparent window.

### ■ PULSATOR option

The Pulsator helps water and detergent to go through fabrics efficiently while providing both the powerful water action to clean lager and heavier clothes and the gentle water action to clean all delicates with less wear and tear on clothes.

### ■ WATERFALL FLOW

The Waterfall Flow injected from under the pulsator cascades with full force back into the tub, pushing down any clothes that float right under the water surface. It is this Waterfall Flow that enables this washing machine to effectively wash large and heavy items, such as blue jeans and blankets.

### ■ MAGIC FILTER option

This unique magic Filter ensures that all the lint inside the tub is captured for top quality filtering results to deliver consistently effective cleaning results.

### ■ SOFTENER DISPENSER option

The Softener Dispenser releases the fabric softener at the appropriate time when the last rinsing proceeds.

### ■ SUPER CLEAN option

SUPER CLEAN adjust the level of water by 5 steps so as to enhance detergent efficiency by adjusting the density of detergent to normal density.

### ■ CHILD-LOCK FUNCTION

This is a device to protect children from being accidentally hurt while playing with the washer.

How to start Child-Lock function:

- Press the "Power" button to go to an initial washing mode.
- By pressing "Start/Hold" button, you start washing and in case Child Lock function is needed during the laundry
- Press both the "Water level" and "Wash" buttons in simultaneously and get the function started.

(Note: You cannot perform the function without the "Power" button on.)

To release the function of Child-Lock:

- In case the "Child-Lock" is programmed, press both the "Wash" and "Water level" buttons in simultaneously.

## SAFETY INSTRUCTIONS

Please note that the following precautions for safety intend to prevent unpredictable danger and damage by helping the proper use in safety. When using hot water in washing, please make sure that the water should not exceed 50°C.

- Plastic parts may be deformed or damaged, and an electric shock or a fire may take place.

### WARNING

***There might be serious injury or fatal accident when you violate this instruction.***

- If the plug (power supply cord) is damaged, it must be replaced by the manufacturer or its service agent or a similarly qualified person in order to avoid a hazard.
- Do not pull the cord off or touch it with moist hands.
  - An electric shock or a fire may take place.
- Do not bend the power supply cord by force or press it with heavy things.
  - An electric shock or a fire may take place.
- Do not install the washer nearby electric implement or don't put a candle light or cigarette light on the washer.
  - A fire may take place.
- During operation, do not put your hands or metal materials under the washer.
  - You may be hurt by spinning board beneath the washer.
- Stay away from the washer when the bottom of the washer sinks into the water.
  - There might be an electric shock. Please wait until the water drains out completely.
- Do not put laundry stained with gasoline, benzene, or alcohol in the washer, and keep the materials away from the washer.
  - An explosion or a fire may take place.
- During spinning, don't put your hand in the spinning tub..
  - It may hurt your hands. If it does not stop within 15 seconds after you open the lid, call service agent immediately.
- This appliance is not intended for use by young children or infirm persons unless they have been adequately supervised by a responsible person to ensure that they can use the appliance safely.  
Young children should be supervised to ensure that they do not play with the appliance.
- This appliance has to be connected to the plug endurable to proper power consumption.
- This appliance has to be positioned so that the plug is accessible after installation.
- No user-serviceable parts inside. Refer any servicing to qualified service personnel.
  - Otherwise this may cause a mechanical error, electric shock, fire or physical damage.
  - The product warranty does not cover problems resulting from disassembling the product.
- Do not use this product for business purposes.
- For washing machines with ventilation openings in the base, that a carpet must not obstruct the openings.

### CAUTIONS

***There might be a slight injury or damage when you violate this instruction.***

- Don't install it in the area with moisture or outdoor where it has rain or snow.
  - An electric shock or a fire may take place.
- Please unplug the power supply cord when you do not use it.
  - An electric shock or a fire may take place.
- If there is dust or water on the power supply plug and its connected part, please remove it completely.
  - An electric shock or a fire may take place.
- Do not make your kids look into the inside of the washer.
  - If your kid falls into the washer, his life could be in danger.
- Ventilate immediately without touching the power plug if gas is leaking.
  - An electric shock or a fire may take place if it catches flame.
- If the washer makes strange noise, smell or smoke, unplug it promptly and call service agent.
  - An electric shock or a fire may take place.
- When cleaning, don't spray water to the parts of the washer directly.
  - It may make it's life span shorten.  
Also an electric shock or fire may take place.
- Don't use several appliances together with an outlet.
  - A fire may take place due to unusual heat.
- Don't press the button with an awl or pin.
  - An electric shock or a fire may take place.
- Use the new hose-sets and old hose-sets should not be reused.
- If the damage is found on the current cord in use, it should be replaced by manufacturer, service center or authorized person in order to avoid the risk.
- Connect the grounding wire to the shell plate, and bury it under at least 25cm of earth:alternatively, connect the ground wire to the appropriate pin on a properly grounded power receptacle. Never connect the wire to a telephone line, lightning rod or gas pipe. **option**

## DESCRIPTION OF PARTS

The User's Manual is for common use.  
Make use of the User's Manual depending upon your washing machine model.

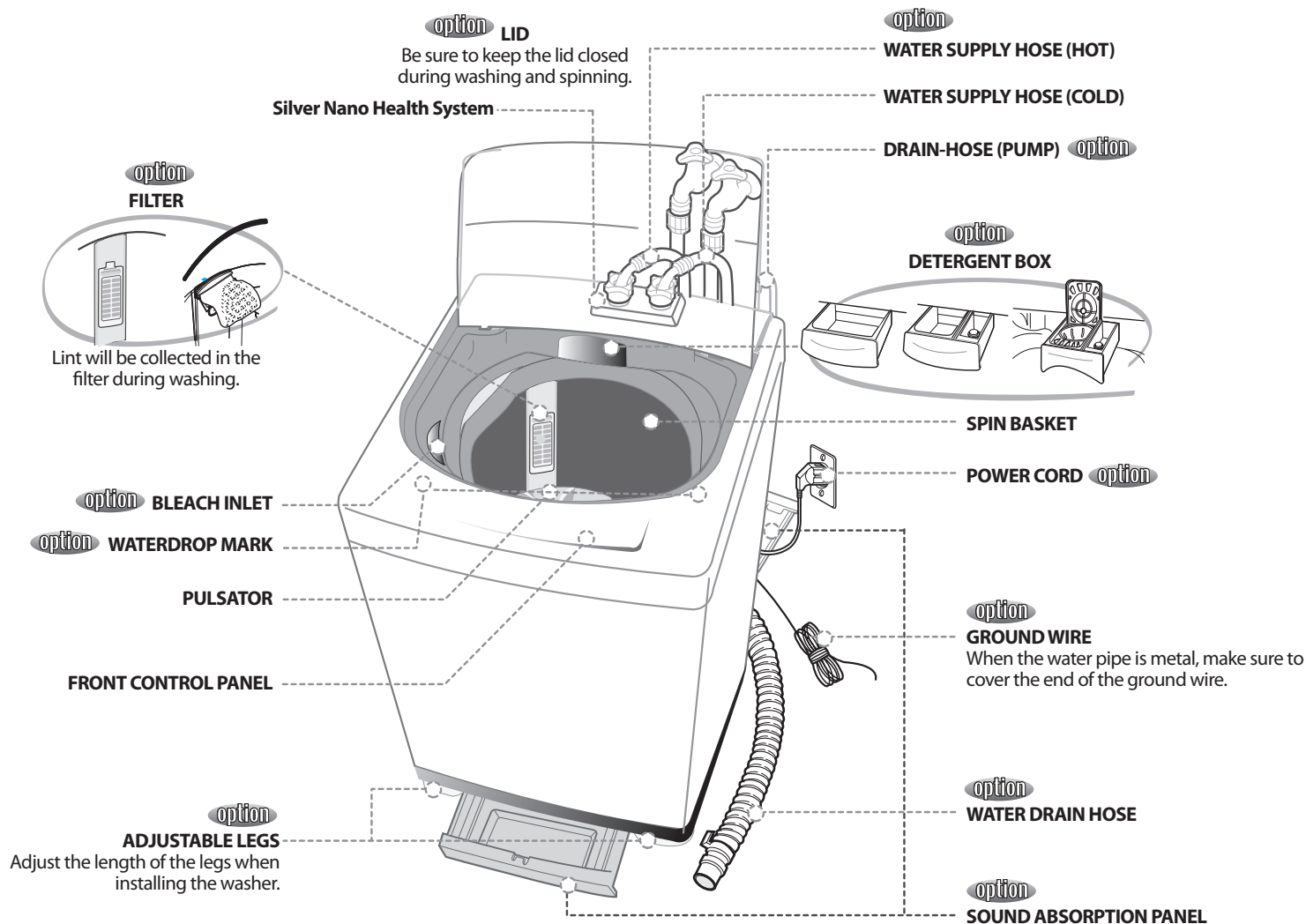

## CHECKING BEFORE WASHING AND CARING FOR GARMENTS

Must follow the checkpoints in order to avoid machine problems or damages on garments.

- ☞ If the below problems are caused by customer's faults, separate service fee will be charged.

### Checkpoints Before Starting Washing

*Check if the clothes are bleaching or not.*

- ☞ Add liquid detergent to a white towel and the garment where you can't notice well. Then, rub together strongly. Check if the color transferred to the towel.
- ☞ Be careful for scarves and imported clothes since they are easily discoloring.
- ☞ Check for stains or partial dirt.
- ☞ If stains are found, use the towel wet with detergents to rub on in a single direction.
- ☞ Before washing, the sleeves, collar, dress hem and pockets are pre-treated by brushing with detergents.

*The wrinkle-processed clothes made of wool are specially treated by fixing them with threads before washing. The threads shall be removed after the clothes are dried.*

### Not washable laundry

*Clothes those are easily transformable even by soaking in water.*

- ☞ Even by soaking in water, neckties, brassieres, jackets, suits and coats can be easily transformed like shrinking and discoloring on the garment surfaces because they are mostly made of rayon, polynosic, cuff and their blend fabrics.
- ☞ The wrinkle-processed, embossed, or resin processed products are easy to transform even by soaking in water.
- ☞ Easily discoloring products made of cotton and wool, wrinkled silk, leather products, leather accessory, leather ornamented clothes and its accessory.
- ☞ Don't wash those clothes without handling guideline or material indication tag.

### About Detergent

- ☞ When detergents are not dissolving well, use warm water (about 40°C) to dissolve the detergent.

#### Caution

- ☞ Use an appropriate amount.
- ☞ Even if excess amount of detergent is used, there is not much difference in washing result. It may cause damages to the garments because rinsing is not enough.
- ☞ The bleaching agent may cause damages to garments since it is strong alkali.
- ☞ Do sufficient rinsing because the powder detergent is easily remained on the garments causing bad odors.
- ☞ If too much detergent is used or cold water is used, it doesn't dissolve completely and remain on the garments, hose or spin basket, causing contamination on clothes.
- ☞ In case of reserved washing, detergents must be put in the detergent box. If the powder detergents are spread on laundry directly, it may cause discoloration.

## CARING FOR CLOTHES BEFORE WASHING

- ☞ Must follow the checkpoints in order to avoid machine problems or damages on garments.
- ☞ If the below problems are caused by customer's faults, separate service fee will be charged.

*Take out personal belongings from pockets.*

- ☞ Caution, Check the pockets! Hairpins and coins cause damages to clothes and washing machine. They make noise and problems to the machine. Must check the pocket.

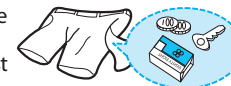

*If pants zippers are open while washing, the spin basket may be damaged. The zipper should be closed and fixed with a string before washing.*

- ☞ If blue jeans and working uniform's zippers or hooks are made of steel, they must be closed before washing.
- ☞ Wash winter jumpers, working uniforms, bed cover sheets, and blue jeans separately.
- ☞ Fold clothes well into the spin basket. Must remove the curtain hooks before washing.
- ☞ Turn inside out the button decorated and embroidered clothes before washing.



- ☞ Be careful those metal decorations because they cause heavy damages while washing.
- ☞ The long stringed clothes may tangle with other clothes. Must fix the strings before washing.
- ☞ The metal from brassieres may stick out and damage other clothes or the spin basket. Must use the commercial laundry net for washing brassieres. (Use a laundry net of fine mesh.)



*Waterproof clothes (Ski Wear, Diaper Covers, Footboards) are not allowed for washing.*

- ☞ The waterproof sheet, clothes, and non water permeable fabrics shouldn't be washed, rinsed, or put in a spin basket. The laundry may pop out and cause severe vibration so that a person may get damaged and the machine, wall, and floor may break out in addition to clothes. (Examples are diaper cover, waterproof wear, raincoat, umbrella cover, ski wears, car cover sheet, and sleeping bags.)

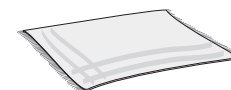

### Cautions During Spinning

- ☞ Spinning of regular garments
  - The water from garments is drained out through the spin basket holes.
- ☞ Spinning of waterproof clothes and fabrics
  - Even if the spin basket spins, water can't drain out from the waterproof clothes and fabrics. Therefore, water gathers to one side and this cause a severe vibration. If the spin basket spins at a high speed, water still can't drain out from the waterproof clothes and fabrics. As a result, garments move up and pop out with a big vibration.

Shake the dirt or soils from clothes.

- ☞ Soil and sands may rub delicate garments to cause damages and the washing result may be unsatisfactory.

For protection of baby skin

- ☞ Wash diapers and baby wears (baby clothes, baby towels etc) separately.

Dirt may get to baby's clothes from adult's clothes if washing them together.

Do pre-washing for white socks, sleeves, and collars before the main washing.

- ☞ Use powder and liquid detergents.
- ☞ Don't use soap. It may leave dirt to the spin basket.

Turn inside out for those nappy clothes before washing.

- ☞ If clothes have too much foreign matter, separate them for washing. Other clothes may pick up those dirty matters (dirt, thread).
- ☞ Wash black colored clothes and cotton towels separately. If they are washed together, towels may pick up dirty matters. Check before washing.

Cashmilon and those garments having big volume and lightweight (eg. Lasedecorated clothes, lingerie, nylon stocking, synthetic fabrics etc.) may rise and cause damages to the clothes and problems to the machine. Use the laundry net or wash them separately.

- ☞ Must put those long stringed clothes, lase-worked clothes, bed cover sheet, wool clothes into a laundry net before washing.
- ☞ Put delicate clothes in the laundry net.
- ☞ Use only those commercial laundry net for washing.

Curtains, floating garments or blue jeans shall be pressed not to float on the water.

- ☞ If they are floated on the water, press Start/Hold button to stop and press them to sock in the water. If the washing goes on with clothes floating on the water, it may cause damages to the clothes and the washing machine as well as unsatisfactory washing result.

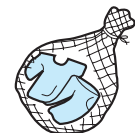
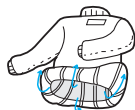

## CONTROL PANEL

For more details, see control panel of your washing machine.

### ■ POWER BUTTON

Press this button once to operate.  
Press once again to turn the power off.

### ■ START/HOLD BUTTON

Use to pause and restart the operation.  
To change the washing procedure during operation, press this button to stop, and once again to restart after changing the procedure.

### ■ DELAY START BUTTON

Press this button when delay start washing is needed.

### ■ COURSE SELECT BUTTON

With every press of this button, the washing course changes;  
DIGITAL (FUZZY) → BLANKET/HEAVY → SOAK → SUPER CLEAN → SPEEDY → WOOL → DIGITAL (FUZZY)

### ■ SILVER WASH BUTTON

- ☞ Sterilization and Anti-bacteria washing in progression during selection
- ☞ Manual use
  - wash+rinse+spin => Sterilization, Anti-bacteria
  - wash+spin => Sterilization
  - rinse+spin => Anti-bacteria
  - wash+rinse => Nano silver does not operate

### ■ WASH BUTTON

Determines wash time period whenever you press the button.

### ■ RINSE BUTTON

Determines rinse time period whenever you press the button.

### ■ SPIN BUTTON

Determines spin time period for drying laundry whenever you press the button.

### ■ WATER LEVEL SELECT BUTTON

According to the washload, select the water level;  
MEDIUM → HIGH → MAXIMUM → HIGH → MEDIUM → MED-LOW → LOW → EXTRA LOW

### ■ WATER SUPPLY SELECT BUTTON option

As you press this button, the type of water is selected as follows.  
COLD → COLD + HOT → HOT → COLD

### ■ REMAINING TIME INDICATOR LIGHT

The indicator light shows the remaining time (in minutes) of each wash cycle.  
At the end of the cycle, the power automatically switches off.





## HOW TO WASH AUTOMATICALLY DEPENDS ON THE LAUNDRY

### Before starting washing, check the following:

- Connect the water supply hose to the water tap. Leave a tap open. Plug the power cord in. Make sure to lay down the drain hose.

### ■ WASHING FOR THE FIRST TIME

Before washing clothes for the first time, you must run a complete cycle without clothes. To do this:

1. Press the POWER button.
2. Pour a little detergent into compartment  in the detergent drawer.
3. Turn on the water supply to the washing machine.
4. Press the Start/Hold button.  
This will remove any water from the manufacturer's test run remaining in the machine.

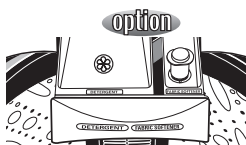

### SPECIAL NOTES!

#### Automatic Sensing Function

- At every course (except, wool course) the amount of laundry is automatically sensed and then appropriate water level, washing time, rinsing cycle, and spinning time are automatically selected for automatic washing.
- After the power is on, a course is selected and Start/Hold button is pressed. Then, the washing board starts spinning without water. This action senses how much laundry is in the washing basket, not a machine problem. After this sensing process, water supplies automatically.

#### Adding Detergent and Softener

- It senses the amount of laundry and indicates the water level and amount of detergent. Then, it starts water supply right away.
- During the water supply, it is possible to open the detergent box and add detergent. However, it is better to press Start/Hold button to stop water supply and add detergent. Close the lid and press Start/Hold button again. This way is much more convenient.
- If the softener is inserted in the softener dispenser, it automatically adds in at the last rinsing cycle.

#### Put the laundry into the washer and add detergent, too.

- Be careful not to overload. Use right detergent for the fabrics you are washing.



- If the lid is open while running, the washing machine is stopped automatically for safety. (Except, water supply continues while the lid is open.)
- When hot water is selected, both cold and hot water are supplied for the first 20 seconds in order to protect the clothes.
- Possible to control the washing time, rinsing cycle, and spinning time at every course during the washing.

### ■ DIGITAL(FUZZY) COURSE

Selects the best washing course automatically.

1. Press the POWER Button to "ON".
2. Press the START/HOLD button.  
*Water level is selected automatically. Washing rinsing, and spinning follow. If you want to pause, press the START/HOLD button again. You can change the course when paused.*
3. Close the lid.



### ■ BLANKET/HEAVY COURSE

(Big volume laundry like blanket and bed cover sheets)

1. Press the power button to "ON".
2. Press the course select button once.
3. Press the START/HOLD button.  
*Water level is selected automatically. Washing, rinsing, and spinning follow. If you want to pause, press the START/HOLD button again. You can change the course when paused.*
4. Close the lid.
  - Fold those big volume laundry (blanket and bed cover sheets) in the following way before adding into the spin basket.
  - Do not wash the electric blanket and carpets.
  - Get a laundry net for those light and big volume laundry (eg. Cashmeres) because they might rise in the water and get damaged.



### ■ SOAK COURSE



1. Press the POWER button.
2. Press the course select button twice.
3. Press the START/HOLD button once.  
*Water level is selected automatically. Washing, rinsing, and spinning follow.*
4. Close the lid.

### ■ SUPER CLEAN COURSE



Operates only in cold water

1. Press the power button to "ON".
2. Press the course select button three times.
3. Press the START/HOLD button and put the proper amount of detergent into tub.  
*Water level is selected automatically.  
Water level is only selected MAXIMUM ~ MED-LOW.*
4. Close the lid.  
*The washing finishes by the time you reserved.*

## ■ SPEEDY COURSE

If you want to wash those frequently used towels or less dirty laundry time. Because washing is speedy, it is good for light or less stained laundry.



1. Press the power button to "ON".
2. Press the course select button four times.
3. Press the START/HOLD button.

Water level is selected automatically. Washing, rinsing, and spinning follow. If you want to pause, press the START/HOLD button again. You can change the course when paused.

4. Close the lid.

## ■ WOOL COURSE

Washable sweater, cardigan, delicate clothes etc.



1. Press the power button to "ON".
2. Press the course select five times.
3. Press the START/HOLD button.

Washing, rinsing, and spinning follow. If you want to pause, press the START/HOLD button again. You can change the course when paused.

4. Close the lid.

### CAUTION...

- Do not use water above 30°C For WOOL washing.
- Refer to the tag attached on the clothes for washing information.
- Fasten buttons and turn inside out before washing.
- Use the detergent indicated in the laundry.
- When the degree of dirt is extreme, soak the laundry in warm water for about 10 minutes before pressing the WOOL course button in order to enhance washing efficiency.

## ■ DELAY START

How to reserve washing?

Select this course when you have to go out or do something else.



1. Press the power button to "ON".
2. Press the course select button.
3. Press the DELAY START button once.

You may change the delay start time with use the DEALY START button. (from 3 hours to 19 hours)

4. Press the START/HOLD button and put the proper amount of detergent into tub.

5. Close the lid.

The washing finishes by the time you reserved.

Add detergent and softener in proportion to the water level. Then, close the lid.

- Must add the detergent in the detergent box.
- If the detergent is spread on the laundry directly, some clothes may get discolored as the start delays.
- If the Delay Start needs to be canceled, press the power button.
- The reserved finish time may be changed depends on the water pressure.

## ■ SILVER WASH option



1. Press the power button to "ON".
2. Press the SILVER WASH button.
3. Press the START/HOLD button.

Water level is selected automatically. Washing rinsing, and spinning follow. If you want to pause, press the START/HOLD button again. You can change the course when paused.

4. Close the lid.

## ■ CLEANING THE TUB



1. Press the POWER button.
2. Press the COURSE button to select the BLANKET course.
3. Press the WATER LEVEL button to select MAXIMUM.
4. Press the START/HOLD button.
5. Add a dedicated detergent and close the lid.



- Never place laundry in the tub when cleaning inside the tub, as this can cause discoloration or damage to the laundry.
- When doing the laundry after cleaning the tub, you may find some impurities. These are just detergent residues and impurities after the tub cleaning. Perform the rinse cycle two to three times.





## ■ Keeping the tub clean





When using the machine under humid conditions for an extended time, various bacteria from the air may stick to the tub and form black dirt (fungi), causing damage to the human body. To keep the tub clean and hygienic at all times, it is recommended reading "Cleaning the Tub" above and using only dedicated or recommended detergents to clean the tub regularly at least once every one to three months.



## MANUAL FUNCTIONS

Sterilization and anti-bacteria coating are optional depending on the selection or no selection of stroke. (Nano silver system operates only when hydration is selected.)

	<p><b>WASH ONLY</b></p> <p>Press the POWER button. Press the WASH button. Press the START/HOLD button. Washing goes on for 20 minutes. When the WASH button is pressed during washing, the wash time can be changed to between 6 and 30 minutes in duration.</p>
	<p><b>RINSE ONLY</b></p> <p>Press the RINSE button. Press the START/HOLD button. Rinsing goes on for 2 times. When the RINSE button is pressed during rinsing, the rinse times can be changed to between 1 to 5 times in duration.</p>
	<p><b>SPIN ONLY</b></p> <p>Press the SPIN button. Press the START/HOLD button. Spin drying goes on for 10 minutes. When the FUNCTION button is pressed during spinning, the spin time can be changed to from 1 to 9 minutes.</p>
	<p><b>WASH AND RINSE</b></p> <p>Press the WASH and RINSE button. Press the START/HOLD button once. Detects the amount of laundry, and determines wash and rinse time period automatically. When the WASH and RINSE button is pressed during working. Wash time period is determined between 6 and 30 minutes; and rinse time is determined between 1 and 5 times.</p>
	<p><b>RINSE AND SPIN</b></p> <p>Press the RINSE and SPIN button. Press the START/HOLD button once. Rinsing and spin drying follow. When the RINSE and SPIN button is pressed during working. The number of rinse times is determined between 1 and 5, and spin time period for drying is determined between 1 and 9 minutes.</p>

	<p><b>WASH, RINSE AND SPIN</b></p> <p>Press the WASH, RINSE AND SPIN button. Press the START/HOLD button once. WASH, RINSE AND SPIN is performed.</p>
	<p><b>SILVER WASH with(WASH,RINSE AND SPIN)</b></p> <p>Press the SILVER WASH button. Press the START/HOLD button once. WASH, RINSE and SPIN is performed. Anti-bacteria coating is operation if silver wash is selected. Operates only in cold water. (Sterilization, Anti-bacteria coating)</p>
	<p><b>SILVER WASH with(RINSE AND SPIN)</b></p> <p>Press the SILVER WASH button. Press the RINSE button once. Press the START/HOLD button once. Rinsing and Spin drying follow. Anti-bacteria coating is operation if silver wash is selected. Operates only in cold water. (Anti-bacteria coating)</p>
	<p><b>SILVER WASH with(WASH AND SPIN)</b></p> <p>Press the SILVER WASH button. Press the WASH button once. Press the START/HOLD button once. Wash and spin drying follow. Anti-bacteria coating is operation if silver wash is selected. Operates only in cold water. (Sterilization)</p>

## INSTALLATION & MAINTENANCE

*The User's Manual is for common use.*

*Make use of the User's Manual depending upon your washing machine model.*

### ■ ENVIRONMENT

#### Leave some space

Maintain at least 10cm between the washer and the wall.

#### Place the washer on a sturdy flat surface.

If the washer is placed on an uneven or weak surface, noise or vibration occurs. (Allowable is 1°)

#### Adjust the legs for even placement.

#### Never install the washer near water.

Do not place the washer in steamy rooms or where the washer is directly exposed to rain. Moisture may destroy the electrical insulation causing an electrical shock hazard.

#### Avoid direct sunlight or heaters.

As plastic and electrical components are affected by direct heat, never place the washer near furnaces, boilers, etc. Do not place under direct sunlight.

### ■ LEVELLING

- If the washer is not leveled with the ground, it makes the machine tremble more or be out of order. So, make sure that the washer is leveled properly.

#### SEE IF THE MACHINE IS PLACED LEVEL BY CHECKING THE POSITION OF THE WASHING TUB.

- Open the lid of the machine, pour water into the tub up to the level just below the pulsator, and adjust the legs so that the pulsator is positioned at the center of the water as shown in the figure.
- Place the machine more than 10cm away from the wall.
- Adjust the legs on feet.

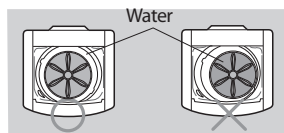

#### Leveling With the Leveling Screw (Manual Adjustable Feet)

<ul style="list-style-type: none"> <li>Gently lift up the machine and turn the adjustable feet to the left to find the optimal balance.</li> </ul>	<ul style="list-style-type: none"> <li>When done, put it down to the original position.</li> </ul>	<ul style="list-style-type: none"> <li>After adjusting the feet, do not forget to fasten the locking nut for safety purposes. (Failing to do so may cause it to loosen)</li> </ul>

### ADJUSTMENT THE HEIGHT OF THE MACHINE option



Adjust the legs to level the washer. Be careful not to put in your hand under the legs. Pull the handles located at the right and left of the front side and slide off. Adjust the height of the machine upward or downward. When the adjustment is finished, push the handles to fix the adjusting legs.

Waterdrop mark	Cause	How to level
	The front part is lower	Level it by adjustable legs.
	The back part is lower	Adjust the height by using the adjustable rubber or prop at the back.
	The left part is lower	Adjust the left part by using the adjustable legs at the front and the adjustable rubber at the back.
	The right part is lower	Adjust the right part of the washer by using the adjustable leg at the front and the adjustable rubber at the back.

## ■ CONNECTING THE WATER SUPPLY HOSE

1. Remove the adaptor from the water supply hose.

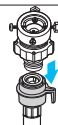

2. First, using a "+" type screw driver, loosen the four screws on the adaptor. Next, take the adaptor and turn part(b) following the arrow for gap about 5 mm between them.

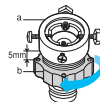

3. Connect adaptor to the water tap by tightening the screws firmly. Then, turn part(b) following the arrow and put (a) and (b) together.



4. Connect the water supply hose to the adaptor. Pull down the part (c) of the water supply hose. When the part (c) is released, the hose is automatically connected to the adaptor making a 'click' sound.

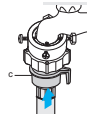

5. Connect the other end of the water supply hose to the inlet water valve at the back of the washer. Screw the hose clockwise all the way in.

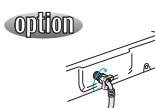

- 5-1. Connect the other end of the water supply hose to the inlet water valve at the top of the washer. Screw the hose clockwise all the way in.



- If the water tap is a screw type, assemble a water supply hose that fits to the tap as shown..

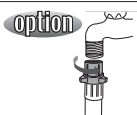

After completing connection, if water leaks from the hose, then repeat the same steps.  
Use the most conventional type of faucet for water supply.  
In case the faucet is square or too big, remove the spacing ring before inserting the faucet into the adaptor.

**Note:** The appliance is to be connected to the water mains using new hose-sets and that old hose-sets should not be used.

## ■ ASSEMBLING THE RAT PROTECTION PANEL option

Tilt the washer a little and lift up the panel until it clicks, finally fix the panel with screw to the base as shown in the figure.

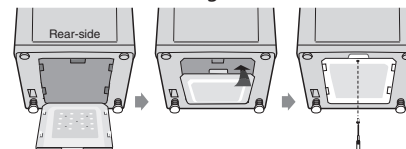

1. Insert the sound absorbing panel to the assembling hole on back side to the end

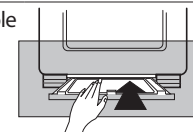

2. If you have difficulty inserting the panel lift up the washer a little and insert it.

\* THE PROTECTION PANEL IS NOT APPLIED IN SOME MODELS.

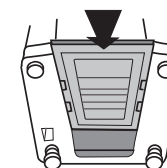

## ■ HOW TO CONNECT THE DRAIN HOSE option

IN CASE OF PUMP-DRAINED WASHER

Take out the cap-hose and connect the outlet-hose.

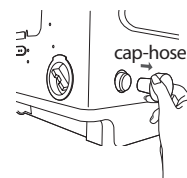

Be sure to join tightly the drain hose into the drain-outlet on the back of the machine.

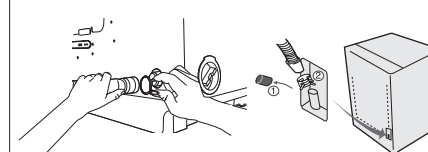

Be sure to join tightly the drain hose into the drain-outlet on the side of the machine.

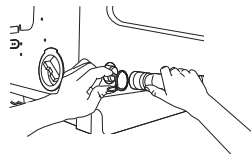

Install the drain hose in the position of about 90~100cm above the ground.

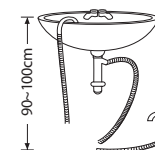

## IN CASE OF GENERAL WASHER

1. After pressing the joint ring, insert to the drain hose.

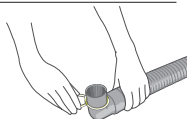

2. After directing the drain hose to a drain, join to the drain-outlet of the washing machine.

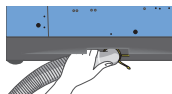

3. Be sure to join them tightly by pressing the joint ring and pushing it into the drain-outlet.
  - The length of drain hose is adjustable so that you can extend the length appropriately.

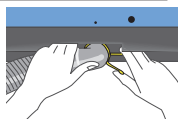

## HOW TO CHANGE THE DRAIN HOSE DIRECTION

- The handle of joint ring is pressed to pull out the drain hose. Change the direction of the drain hose and follow the above guideline again.

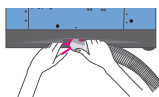

## CAUTIONS WHEN INSERTING THE DRAIN HOSE

1. Don't exceed more than 3m when the drain hose is used by connecting with other hoses.

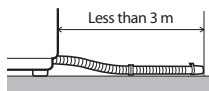

2. Be careful to drain water out at the end of the drain hose.

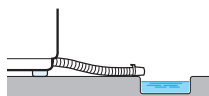

3. The doorsill shouldn't be more than 5cm.

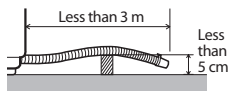

4. Don't install the drain hose underneath the wash machine.



## HOW TO ADD THE FABRIC SOFTENER option

- When a proper amount (one time does) of fabric softener is stored in the softener inlet, it is automatically put in at the last rinsing cycle.
- Do not use detergent, bleach or starch into the Softener Inlet.
- Using too much softener may produce unsatisfactory results.
- Do not open the lid during the Spin Dry cycle. If added too early, its effectiveness will decrease.
- Do not leave the softener into the Softener Dispenser for a long time. Because softner became stiff.

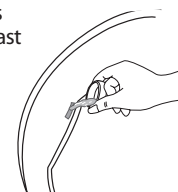

## HOW TO PUT THE DETERGENT IN option

1. Open the detergent box by pulling in the direction of the arrow as shown in the figure and then put the powder detergent in the detergent box.
2. Put in one-time amount of detergent evenly so the detergent may not brim over the box.

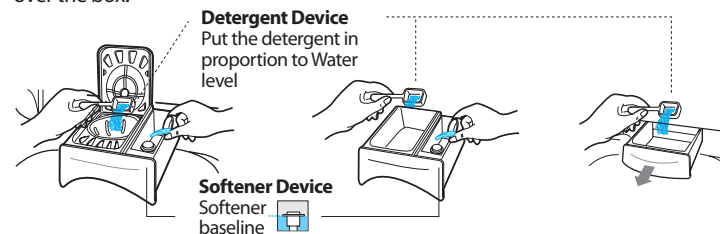

**CAUTION :** If softener is stored over the above base line, it may flow down at any time.

## WATER SUPPLY CONNECTOR FILTER

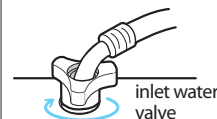
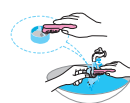

1. Pull out the filter and wash well.
2. Pull in the filter and connect the hose to the inlet water valve tightly.
3. Check if there is a leakage. Note to tighten up the connector.

## ■ CLEANING THE FILTER option

Clean the filter net often to keep the washer clean.

1. Push the upper part of the Magic filter and pull in.

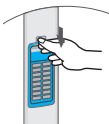

1. Push up and pull out the filter net.

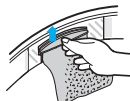

2. Open the cover as shown in the figure.

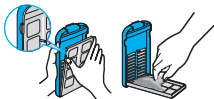

2. Remove the collected lint from the filter net.



3. Clean the Magic filter.



3. Clean the filter net.



4. Close the cover and insert the lower part of the filter in the basket first and then push the filter with "click" sound.



4. Pull down the filter net.

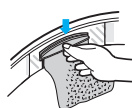

## ■ HOW TO CLEAN THE PUMP FILTER option

1. Place a rag under the washer filter not to wet the floor.
2. Rotate the filter counterclockwise and pull out the filter.
3. Remove dirt and rotate the filter clockwise until it locks in position.

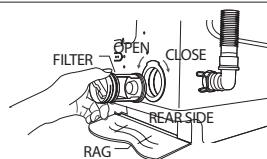

## TROUBLESHOOTING

### > Washing machine won't work

Is the water tap opened?  
Is the washer plugged in?  
Is the power cut off?  
Is there enough water?



### > Water dose not drain

Is the drain hose down?(No pump)  
Is the drain hose frozen?  
Is the drain hose clogged?

**If the water dose not drain in 15 minutes, a buzzer will sound, and the remaining time indicator will show "5E".**

5E

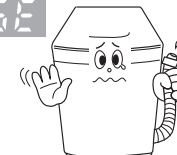

### > Water is not supplied

Is the water tap opened?  
Is the water cut off?  
Is the water supply hose or hose connection clogged?

**Is the water tap frozen?  
If water is not supplied in 1 hour, a buzzer will sound, and the remaining time indicator will show "4E".**

4E

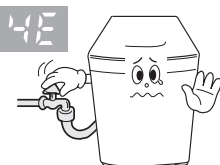

### > Spinning does not work

Is the laundry spread out evenly in the washer?  
Is the washer set on a sturdy flat surface?

4E

2E

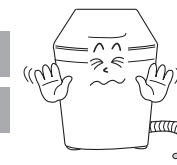

### > Water is overflowed

Restart after spinning.  
If the error sign still indicates, call agency.

1E

0E

## WASHING MACHINE WON'T WORK?

### The power is cut off.

- Check 1>** Is the electric voltage normal?  
**Check 2>** Is the washer plugged in? Plug in the electric cord.  
 → Water does not drain.  
**Check 3>** Is the drain hose down? Put the drain hose down.  
**Check 4>** Is the drain hose folded? Unfold the drain hose.  
**Check 5>** Is the drain hose outlet clogged? Remove the waste cleanly.

### Washing machine won't work.

- Check 1>** Is the washer lid open?  
 → Close the lid.  
**Check 2>** Is the Hold button on?  
 → Press the Start/Hold button one more time and check if the washer starts.  
**Check 3>** Is enough water filled to the water level?  
 → If the water pressure is low, it takes a long time to start washing.  
**Check 4>** Is the faucet closed?  
 → Open the faucet to supply water.

### If the drain hose and spin basket are frozen, do as follows.

- Add hot water to the frozen water tap and remove the drain hose. Soak into hot water.
- Pour hot water into the spin basket for about 10 minutes.
- Put a hot water towel on the drain hose connector.
- If the drain hose defrosts, connect again and check for proper water draining.

### The water drains out immediately.

- The drain is clogged with coins or pins. The drain hose is hung over the drain hose hook. Half fill the spin basket with water and try for spinning again.

### The water leaks at the water supply hose connector.

- Check 1>** If the faucet connecting part is loose, water may leak.  
 → Repeat the assembling steps again. (Refer to "Connecting the water supply hose")  
**Check 2>** Check if the rubber packing of water supply hose is in the right position.  
 → Screw tightly again.  
**Check 3>** Is the water supply hose folded?  
 → Unfold the hose.  
**Check 4>** If the water supply is too strong, water may leak.  
 → Close the faucet a little.  
**Check 5>** Is water leaking from the faucet itself?  
 → Fix the faucet. Water is not supplied.  
**Check 6>** Did you press the Start/Hold button after selecting the water supply?  
 → If the Start/Hold button is not pressed, water is not supplied. Press the Start/Hold button.  
**Check 7>** Is the faucet closed?  
 → Turn on the faucet.

- Check 8>** Is the filter net at the water supply hose connector clogged with dirty matters?  
 → Clean the filter net by brushing with a toothbrush.  
**Check 9>** Is the water supply cut off?  
 → If the water supply is suspended, turn off the faucet and power off.

### Spinning makes loud noises and vibrations.

- Check 1>** Check if the laundry is spread evenly in the washer.  
 → Spread out the laundry evenly and start again.  
**Check 2>** Check if the washing machine levels on a sturdy flat floor.  
 → Set the machine at level.  
**Check 3>** Is the handle for leveling legs loose?  
 → Adjust the legs on the feet for leveling.  
**Check 4>** Is around the washing machine filled with unnecessary stuffs?  
 → Remove those unnecessary things away from the wash machine.

## SPECIFICATIONS

POWER CONSUMPTION	WASH	500W / 550W
	SPIN	300W
DIMENSIONS(mm)		W630xD675xH1055(H) W630xD675xH1030(L)
WEIGHT		47kg / 53kg
WATER PRESSURE		0.05~0.78 MPa (0.5 ~ 8.0kg • f/cm <sup>2</sup> )
WASHING TYPE		Stirring Type
STANDARD WATER LEVEL	MAXIMUM	91 l
	HIGH	78 l
	MEDIUM	62 l
	MED-LOW	48 l
	E/LOW	32 l
WATER USAGE		235 l / 240 l
PULSATOR ROTATING SPEED		120 rpm
SPIN SPEED		710 rpm

**For operating VOLTAGE and FREQUENCY, see the LABEL-RATING on the back of washing machine.**



*MEMO*



**Contact SAMSUNG WORLD WIDE**

If you have any questions or comments relating to Samsung products, please contact the SAMSUNG customer care center.

Country	Customer Care Center	Web Site
AUSTRALIA	1300 362 603	<a href="http://www.samsung.com/au">www.samsung.com/au</a>
INDIA	3030 8282 1600 1100 11	<a href="http://www.samsung.com/in">www.samsung.com/in</a>
MALAYSIA	1800-88-9999	<a href="http://www.samsung.com/my">www.samsung.com/my</a>
PHILIPPINES	1800-10-SAMSUNG (7267864)	<a href="http://www.samsung.com/ph">www.samsung.com/ph</a>
SINGAPORE	1800-SAMSUNG (7267864)	<a href="http://www.samsung.com/sg">www.samsung.com/sg</a>
VIETNAM	1 800 588 889	<a href="http://www.samsung.com/vn">www.samsung.com/vn</a>
RUSSIA	8-800-200-0400	<a href="http://www.samsung.com/ru">www.samsung.com/ru</a>
SOUTH AFRICA	0860 7267864 (SAMSUNG)	<a href="http://www.samsung.com/za">www.samsung.com/za</a>