

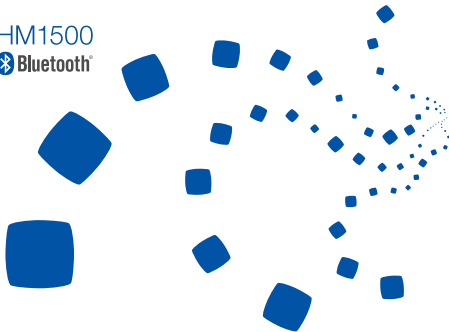

Stylish Clip-on

Mono Headset

HM1500



| | |
|--------------|----|
| 繁體中文 | 1 |
| English..... | 25 |

目錄

入門

| | |
|--------------|---|
| 耳機相關概述 | 4 |
| 按鈕功能 | 5 |
| 耳機充電 | 6 |
| 佩戴耳機 | 8 |

使用耳機

| | |
|--------------------|----|
| 開啓/關閉耳機電源 | 10 |
| 啓用震動模式 | 10 |
| 配對與連結耳機 | 11 |
| 透過主動配對功能進行配對 | 14 |
| 使用通話功能 | 16 |

附錄

| | |
|---------------|----|
| 常見問題 | 20 |
| 保固與零件更換 | 22 |
| 規格 | 23 |

開始使用全新的藍牙耳機之前，請先閱讀本使用手冊。

Bluetooth® 係 Bluetooth SIC, Inc. 的註冊商標 - Bluetooth QD ID： B016117

有關藍牙的詳細資訊，請上 www.bluetooth.com 查詢。



安全措施

- 切勿因任何原因拆卸或改裝本耳機。否則可能會造成耳機故障或燒壞。需維修時，請將藍牙耳機送至授權維修中心。
- 如需在開車時使用耳機，請遵守所在地區的法律。
- 請避免將耳機存放在高溫（50 °C/122 °F 以上）之處，例如高溫的車內或日光直射處，否則會損壞效能和降低電池使用壽命。
- 請勿讓耳機或任何隨附的零件淋雨或接觸液體。



耳機音量過大時，長時間使用可能會傷害聽力。將耳機插入音源前，請務必先降低音量，並只使用所需的最低音量來聆聽通話內容或音樂。



廢電池請回收

入門

本節說明藍牙耳機的正確使用方式。

耳機相關概述

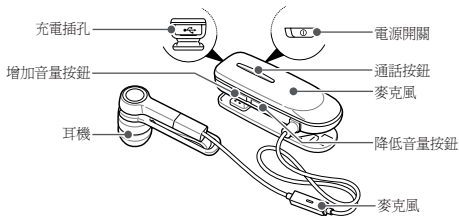

- 請確定耳機是否隨附下列配件：
旅行充電器、橡皮耳墊、使用手冊。
- 耳機隨附的物品可能視地區而有所不同。

按鈕功能



電源開關

請向上滑動或向下滑動，以開啓或關閉耳機電源。



通話按鈕

- 按住可進入 [配對] 模式。
- 按下即可撥打或接聽電話。
- 按下即可結束通話。



增加/降低音量按鈕

- 按下可調整音量。
- 同時按住可檢查電池使用壽命長短。
- 按住可開啓或關閉麥克風電源。



當耳機調到最小或最大音量時，您會聽到嗶聲。

耳機充電

本耳機內建無法取出的可重複充電電池。在第一次使用耳機前，請確定電池能量已經充滿。

- 1 將旅行充電器較小的一端插入充電插孔。

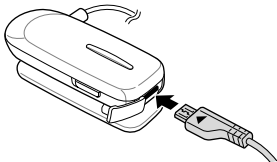

- 2 將旅行充電器較大的一端插入電源插座。
在充電期間，指示燈將會變成紅燈。若充電尚未開始，請將旅行充電器的插頭拔掉並再次插上。

- 3 耳機充滿電時，指示燈會變為藍色。請將旅行充電器的插頭從電源插座與耳機上拔下。



- 僅能使用 Samsung 核可的旅行充電器。未經授權的旅行充電器可能導致爆炸的危險或使耳機受損。
- 由於電池為耗材，在充電或放電後，電池會逐漸耗損。
- 充電時若有來電，請將耳機從旅行充電器拔出，然後再接聽來電。

當電池電量不足時

耳機會發出嗶聲，並閃爍紅色指示燈。請將電池重新充電。若在通話過程中耳機電源關閉，通話將會自動切換至手機。

檢查電池電量

請同時按住降低音量與增加音量按鈕。視電池電量而定，指示燈會以下列其中一種色彩閃爍 5 次：

| 電池電量 | 指示燈色彩 |
|--------|-------|
| 高於 80% | 藍色 |
| 80~20% | 紫紅色 |
| 低於 20% | 紅色 |

佩戴耳機

請將耳機塞入耳朵，並將耳機夾在衣服上。



未使用耳機時，可將耳機夾在衣服上。

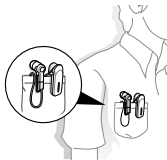

使用耳機

本節說明如何開啓耳機電源及與手機配對和連接，以及各種功能的使用。



- 可用的功能和特性可能會依手機的類型而有所不同。
- 有些設備，尤其是未經 **Bluetooth SIG** 測試及核准者，可能無法與您的手機相容。

開啟/關閉耳機電源

- 若要開啟耳機電源，請向上滑動電源開關。藍色指示燈會閃爍 4 次。
- 若要關閉耳機電源，請向下滑動電源開關。指示燈將會由藍色變為紅色後關閉。

啟用震動模式

您可以啟動 [震動] 模式，有來電時，就能收到震動提醒。

同時按住通話按鈕和增加音量按鈕。

若要停用 [震動] 模式，請同時按住通話按鈕和降低音量按鈕。

配對與連結耳機

配對作業將會在兩個藍牙啓用裝置之間（例如您的藍牙手機和藍牙耳機）建立唯一且加密的無線連結。

若要將耳機搭配其他藍牙裝置使用，必須先讓兩個裝置進行配對。配對時，請保持耳機與手機適當靠近。配對完成後，就可以連接這兩個裝置了。

將耳機與手機配對及連結

- 1 進入配對模式。
 - 啓動耳機並按住通話按鈕，直到藍色指示燈恆亮。
 - 第一次啓動耳機時，耳機即進入 [配對] 模式。
- 2 啓用手機的藍牙功能，並搜尋耳機（請參閱手機使用手冊）。
- 3 從手機的裝置清單中選擇耳機（HM1500）。

4 輸入藍牙 PIN 碼 (0000，4 個 0)，將耳機配對和連接至您的手機。



本耳機支援簡易配對功能，可讓耳機無需 PIN 即可與手機進行配對。與藍牙 2.1 版本或更新版本相容的手機皆具有此項功能。

也可以透過使用中配對功能來配對耳機，
請參閱第 14 頁。

連接兩個藍牙手機

啟用多點功能後，您的耳機便能同時連接兩個藍牙手機。

- 1** 連接第一個藍牙手機後，按住通話按鈕，直到藍色指示燈恆亮。
- 2** 按住增加音量按鈕以啟用多點功能。
- 3** 在第二個藍牙手機上啟用藍牙功能並搜尋耳機（請參閱手機的使用手冊）。

- 4 從第二個藍牙手機的裝置清單中選擇耳機 (HM1500)。
- 5 輸入藍牙 PIN 碼 (0000，4 個 0)，將耳機連接至手機。
- 6 從第一個藍牙手機重新連接耳機。



- 您可以將耳機設定為每次開啓電源時，都自動重新連結到最近接通的手機。
 - 若要重新連結到最近接通的兩個手機，請啓用多點功能。在 [配對] 模式中，按住增加音量按鈕，直到藍色指示燈閃爍兩次。
 - 若只要重新連結到最近接通的一個手機，請停用多點功能。在 [配對] 模式中，按住降低音量按鈕，直到紅色指示燈閃爍兩次。
- 如果耳機同時與兩支藍牙手機連線，某些手機可能無法作為第二支藍牙手機連線到耳機。

斷開耳機連結

若要斷開手機與耳機的連結：

- 關閉耳機。
- 使用手機上的藍牙功能表。

重新連線耳機

耳機與手機配對後，每次開啓耳機時，耳機即會自動嘗試重新連結。

若耳機未自動嘗試重新連結：

- 按下通話按鈕。
- 使用手機上的藍牙功能表。

透過主動配對功能進行配對

使用主動配對功能，您的耳機便能自動搜尋藍牙手機並嘗試與之連線。

- 1 啓動耳機。
- 2 按住通話按鈕以進入 [配對] 模式。

3 按住通話按鈕，直到紫紅色指示燈亮起。

耳機會切換為 [主動配對] 模式，搜尋範圍內的藍牙手機，並嘗試與之配對。



- 請確定您要連結的手機是在耳機的連結範圍內。請保持耳機和手機相當靠近，以避免與其他裝置配對。
- 耳機會嘗試進行主動配對達 20 秒。
- 您要連結的藍牙手機不得與其他裝置配對。如果手機已經與另一個裝置配對，請結束連結並重新啟動 [主動配對] 功能。
- 此功能可供行動電話使用，但電話的藍牙可見度選項必須設定為開啓。
- 視某些 PDA 而定，此功能可能無法使用。

使用通話功能

撥打電話

重撥最後一個號碼

按下通話按鈕，以重撥最近連結之手機的最後一個號碼。

按下通話按鈕兩次，以重撥其他手機的最後一個號碼。

聲控撥號

按住通話按鈕然後說出姓名，用語音撥打第一個電話號碼。



可用的通話功能可能會依手機而有所不同。

接聽來電

當聽到來電鈴聲時，按下通話按鈕即可接聽電話。

當兩個連結之手機同時來電時，您可以接聽第一個手機的來電。

結束通話

按下通話按鈕，即可結束通話。

拒接來電

有來電時，按住通話按鈕即可拒接來電。

當兩個連結之手機同時來電時，您可以拒絕第一個手機的來電。

在通話中使用選項

在通話過程中，您可使用以下功能控制通話。

調整音量

按下增加/降低音量按鈕來調整音量。

麥克風靜音

按住增加/降低音量按鈕即可將麥克風關閉，使通話對方無法聽到您的聲音。麥克風關閉時，耳機會定時發出嗶聲。再次按住增加/降低音量按鈕，即可取消麥克風靜音。

將通話從手機轉接至耳機

按下通話按鈕，即可將通話從手機切換至耳機。

保留來電

按住通話按鈕，即可保留目前的通話。



耳機與兩個手機連結時，此功能便無法使用。

接聽第二通來電

- 在聽到待接通話時，按下通話按鈕以結束第一通來電，並接聽同一個手機的第二通來電。
- 在聽到待接通話時，按住通話按鈕以保留第一通來電，並接聽同一個手機的第二通來電。
- 若要在目前的通話與保留的來電之間切換，請按住通話按鈕。



手機與兩個藍牙手機連結時，您便無法接聽同一個手機的第二通來電。

接通第二個手機的新來電

- 在聽到待接通話時，按下通話按鈕以結束第一通來電，並接聽其他手機的第二通來電。
- 在聽到待接通話時，按住通話按鈕以保留第一通來電，並接聽其他手機的第二通來電。
- 若要在目前的通話與保留的來電之間切換，請按住通話按鈕。

附錄

常見問題

| | |
|--------------------------|---|
| 本耳機是否適用於筆記型電腦、個人電腦和 PDA？ | 本耳機可搭配支援此耳機藍牙版本與模式的裝置使用。 如需規格的詳細資訊，請參閱第 23 頁。 |
| 通話中時，為何我聽到靜電或干擾聲音？ | 無線電話或無線網路設備等裝置都可能出現干擾情形，通常類似于靜電聲音。 為減少干擾，請讓耳機遠離會使用或可產生電波的裝置。 |
| 本耳機是否會干擾車上的電子設備、收音機或電腦？ | 本耳機所產生的功率比一般手機要小得多。 並且，耳機發射的信號符合國際藍牙標準規範。 因此，標準家用電子設備並不會受到任何干擾。 |

| | |
|------------------------|---|
| 其他的藍牙手機使用者是否會聽到我的通話內容？ | 耳機配對藍牙手機時，此兩個藍牙裝置之間會形成一個私人的無線溝通管道。由於藍牙無線信號的射頻功率比一般手機的射頻功率要小得多，因此本產品使用的無線藍牙技術不易遭第三者監聽。 |
| 通話中時，為何我聽到迴音？ | 請調整耳機音量，或移至其他區域再試一次。 |
| 我該如何清理耳機？ | 請使用柔軟的乾布擦拭。 |
| 藍牙耳機未充滿電。 | 旅行充電器未正確插入耳機。 請將耳機自旅行充電器上拔除，然後重新連接再充電。 |

保固與零件更換

自原購買日期起一年內，**Samsung** 保證此產品在素材、設計與工藝上皆無瑕疵（保固期視所在國家或地區可能有所不同）。

在保固期間，若此產品於正常使用與服務下證明有缺陷時，您應將產品退回原零售商或合格服務中心。**Samsung** 和指定維修公司之責任僅限於保固維修成本及/或元件更換。

- 限原消費者才能享有保固。
- 為享有適當的保固服務，您必須提供收據或其他購買證明。
- 若產品序號、日期碼標籤或產品標籤遭移除，或若產品曾遭未經授權之協力廠商濫用、不當安裝、修改或維修，則本公司無責任提供保固。
- 電池和其他配件等有使用期限的耗材皆不在保固範圍內。

Samsung 對於產品運送過程所造成的損失或損毀，不負任何損害賠償責任。對於未經授權的協力廠商對本公司產品所進行的任何維修工作，**Samsung** 不提供保固。

規格

| 項目 | 規格說明 |
|------|------------------|
| 藍牙版本 | 2.1+EDR |
| 藍牙版本 | 耳機模式、免持聽筒模式 |
| 操作範圍 | 可達 33 英尺 (10 公尺) |
| 待機時間 | 可達 250 小時* |
| 通話時間 | 可達 6 小時* |
| 充電時間 | 大約 2 小時* |

* 視手機的類型和使用狀態而定，實際時間可能有所不同。

Contents

Getting started

| | |
|-----------------------------|----|
| Your headset overview | 28 |
| Button functions..... | 29 |
| Charging the headset | 30 |
| Wearing the headset | 32 |

Using your headset

| | |
|--|----|
| Turning the headset on or off..... | 34 |
| Activate Vibration mode..... | 34 |
| Pairing and connecting the headset | 35 |
| Pairing via the Active pairing feature | 38 |
| Using call functions..... | 40 |

Appendix

| | |
|--------------------------------------|----|
| Frequently asked questions..... | 44 |
| Warranty and parts replacement | 46 |
| Specifications | 47 |

Read this user manual before you start to use your new Bluetooth headset.
Bluetooth® is a registered trademark of the Bluetooth SIG, Inc. worldwide —
Bluetooth QD ID: B016117
More information about Bluetooth is available at www.bluetooth.com.



Safety precautions

- Never disassemble or modify your headset for any reason. Doing this may cause the headset to malfunction or become combustible. Bring the headset to an authorised service centre to repair it.
- When using your headset while driving, follow local regulations in the region you are in.
- Avoid storage at high temperatures (above 50 °C/122 °F), such as in a hot vehicle or in direct sunlight, as this can damage performance and reduce battery life.
- Do not expose the headset or any of its supplied parts to rain or other liquids.



Excessive exposure to sound at high volumes can cause hearing damage. Always turn the volume down before plugging the earphones into an audio source and use only the minimum volume setting necessary to hear your conversation or music.

Getting started

This section explains what to remember for the proper use of your Bluetooth headset.

Your headset overview

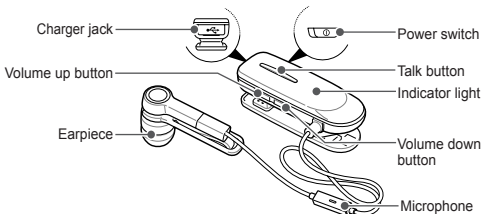

- Make sure you have the following items with your headset: Travel adapter, Ear rubbers, User manual.
- The items supplied with your headset may vary depending on your region.

Button functions



Power switch

Slide up or down to turn the headset on or off.



Talk button

- Press and hold to enter Pairing mode.
- Press to make or answer a call.
- Press to end a call.



Volume up or down button

- Press to adjust the volume.
- Press and hold at the same time to check the battery life time.
- Press and hold to turn the microphone on or off.



You can hear a beep when the volume level of the headset reaches to the lowest or highest level.

Charging the headset

This headset has a rechargeable internal battery which is non-removable. Ensure that you fully charge the battery before using the headset for the first time.

- 1 Plug the small end of the travel adapter into the charger jack.

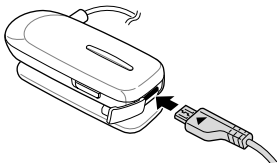

- 2 Plug the large end of the travel adapter into a power outlet.
During charging, the indicator light will turn red. If charging does not begin, unplug the travel adapter and plug it in again.

- 3 When the headset is fully charged, the indicator light changes to blue. Unplug the travel adapter from the power outlet and the headset.



- Use only a Samsung-approved travel adapter. Unauthorised travel adapters may cause an explosion or damage to the headset.
- The battery will gradually wear out while charging or discharging because it is a consumable part.
- When a call comes in while charging, disconnect your headset from the travel adapter and answer the call.

When the battery charge gets low

The headset beeps and the indicator light flashes red. Recharge the battery. If the headset powers off during a call, the call will be automatically transferred to the phone.

Checking the battery level

At the same time, press and hold the Volume up and down buttons. Depending on the battery level, the indicator light flashes 5 times in one of the following colours:

| Battery level | Indicator light colour |
|---------------|------------------------|
| Above 80% | Blue |
| 80 ~20% | Violet |
| Below 20% | Red |

Wearing the headset

Insert the earpiece in your ear and clip the headset to your clothes.



When you are not using the headset, you can clip the earpiece to your clothes.

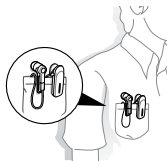

Using your headset

This section explains how to turn the headset on, pair and connect to the phone, and use various functions.



- Activated functions and features may differ depending on the phone type.
- Some devices, especially those that are not tested or approved by Bluetooth SIG, may be incompatible with your headset.

Turning the headset on or off

- To turn the headset on, slide up the power switch. The blue indicator light flashes 4 times.
- To turn the headset off, slide down the power switch. The indicator light turns off after the blue indicator light changes to red.

Activate Vibration mode

You can activate Vibration mode to receive a vibration alert when a call comes in.

Press and hold the Talk button and the Volume up button at the same time.

To deactivate Vibration mode, press and hold the Talk button and the Volume down button at the same time.

Pairing and connecting the headset

Pairing will create a unique and encrypted wireless link between two Bluetooth enabled devices, such as a Bluetooth phone and a Bluetooth headset.

To use the headset with other Bluetooth devices, the devices must be paired. When trying to pair the two devices, keep the headset and the phone reasonably close together. After pairing, you can connect the two devices.

Pairing and connecting the headset with a phone

- 1 Enter pairing mode.
 - Turn on your headset and press and hold the Talk button until the blue indicator light stays lit.
 - If you turn the headset on for the first time, it proceeds into Pairing mode immediately.
- 2 Activate the Bluetooth feature on your phone and search for the headset (see your phone's user manual).
- 3 Select the headset (HM1500) from the list of devices found by your phone.

- 4 Enter the Bluetooth PIN (0000, 4 zeros) to pair and connect the headset to your phone.



Your headset supports the Simple Pairing feature which allows the headset to be paired with a phone without requesting a PIN. This feature is available for phones that are compliant with Bluetooth version 2.1 or higher.

The headset also can be paired via the Active pairing feature, see page 38.

Connecting with two Bluetooth phones

With the Multi-point feature activated, your headset can be connected with two Bluetooth phones at the same time.

- 1 After connecting with the first Bluetooth phone, press and hold the Talk button until the blue indicator light stays lit.
- 2 Press and hold the Volume up button to activate the Multi-point feature.
- 3 Activate the Bluetooth feature on the second Bluetooth phone and search for the headset (see your phone's user manual).

- 4 Select the headset (HM1500) from the list of devices found by the second Bluetooth phone.
- 5 Enter the Bluetooth PIN (0000, 4 zeros) to connect the headset to the phone.
- 6 Reconnect to the headset from the first Bluetooth phone.



- You can set the headset automatically to reconnect to the recently connected phones each time you turn it on.
 - To reconnect to the two most recently connected phones, activate the Multi-point feature. Press and hold the Volume up button in Pairing mode until the blue indicator light flashes twice.
 - To reconnect to only the most recently connected phone, deactivate the Multi-point feature. Press and hold the Volume down button in Pairing mode until the red indicator light flashes twice.
- When the headset connects to two Bluetooth phones, some phones may not connect to the headset as the second Bluetooth phone.

Disconnecting the headset

To disconnect the headset from your phone,

- Turn off the headset.
- Use the Bluetooth menu on your phone.

Reconnecting the headset

When the headset is paired with a phone, it will attempt to automatically reconnect each time you turn it on.

If the headset does not automatically attempt to reconnect,

- Press the Talk button.
- Use the Bluetooth menu on your phone.

Pairing via the Active pairing feature

With the Active pairing feature, your headset can automatically search for a Bluetooth phone and try to make a connection with it.

- 1 Turn on the headset.
- 2 Press and hold the Talk button to enter Pairing mode.

- 3 Press and hold the Talk button until the violet indicator light turns on.
The headset will switch to Active Pairing mode, search a Bluetooth phone within range, and attempt to pair with it.



- Ensure the phone you wish to connect to is within range of the headset. Place the headset and phone close to each other to avoid pairing with other devices.
- The headset will attempt Active pairing for up to 20 seconds.
- The Bluetooth phone you want to connect with must not be paired with other devices. If the phone is already connected to another device, end the connection and restart Active pairing feature.
- This feature is available for mobile phones, but the phone's Bluetooth visibility option must be set to on.
- This feature may be unavailable depending on the some PDAs.

Using call functions

Making a call

Redialling the last number

Press the Talk button to redial the last number of the most recently connected phone.

Press the Talk button twice to redial the last number of the other phone.

Dialling a number by voice

Press and hold the Talk button to dial a number of the first phone by voice, and say a name.



Available call functions may vary by the phone.

Answering a call

Press the Talk button to answer a call when you hear incoming call tones.

When two calls from the two connected phones come in, you can answer the call of the first phone.

Ending a call

Press the Talk button to end a call.

Rejecting a call

Press and hold the Talk button to reject a call when a call comes in.

When two calls from the two connected phones come in, you can reject the call of the first phone.

Using options during a call

You can use the following functions to control your call during a call.

Adjusting the volume

Press the Volume up or down button to adjust the volume.

Muting the microphone

Press and hold the Volume up or down button to turn the microphone off so that the person with whom you are speaking cannot hear you. When the microphone is turned off, the headset beeps at regular intervals. Press and hold the Volume up or down button again to turn the microphone back on.

Transferring a call from the phone to the headset

Press the Talk button to transfer a call from the phone to the headset.

Placing a call on hold

Press and hold the Talk button to place the current call on hold.



When the headset is connected with two phones, this function is not available.

Answering a second call

- Press the Talk button to end the first call and answer a second call of the same phone when you hear call waiting tones.
- Press and hold the Talk button to place the first call on hold and answer a second call of the same phone when you hear call waiting tones.
- To switch between the current call and the held call, press and hold the Talk button.



When the headset is connected with two Bluetooth phones, you cannot answer a second call of the same phone.

Answering a new call of the second phone

- Press the Talk button to end the first call and answer a second call of the other phone when you hear call waiting tones.
- Press and hold the Talk button to place the first call on hold and answer a second call of the other phone when you hear call waiting tones.
- To switch between the current call and the held call, press and hold the Talk button.

Appendix

Frequently asked questions

| | |
|---|--|
| Will my headset work with laptops, PCs, and PDAs? | Your headset will work with devices that support your headset's Bluetooth version and profiles. For specifications, see page 47. |
| Why do I hear static or interference while on a call? | Appliances such as cordless phones and wireless networking equipment may cause interference, which usually sounds like static. To reduce any interference, keep the headset away from other devices that use or produce radio waves. |
| Will my headset interfere with my car's electronics, radio, or computer? | Your headset produces significantly less power than a typical mobile phone. It also only emits signals that are in compliance with the international Bluetooth standard. Therefore, you should not expect any interference with standard consumer-grade electronics equipment. |

| | |
|--|--|
| Can other Bluetooth phone users hear my conversation? | When you pair your headset to your Bluetooth phone, you are creating a private link between only these two Bluetooth devices. The wireless Bluetooth technology used in your headset is not easily monitored by third parties because Bluetooth wireless signals are significantly lower in radio frequency power than those produced by a typical mobile phone. |
| Why do I hear an echo while on a call? | Adjust the headset volume, or move to another area and try again. |
| How do I clean my headset? | Wipe it with a soft dry cloth. |
| The headset does not fully charge. | The headset and the travel adapter may not have been connected properly. Separate the headset from the travel adapter, reconnect, and charge the headset. |

Warranty and parts replacement

Samsung warrants this product as free of defects in material, design and workmanship for the period of one year from the original date of purchase. (Depending on your country, the length of warranty may vary.)

If during the period of warranty this product proves defective under normal use and service you should return the product to the retailer from whom it was originally purchased or qualified service centre. The liability of Samsung and its appointed maintenance company is limited to the cost of repair and/or replacement of the unit under warranty.

- The warranty is limited to the original purchaser.
- A copy of your receipt or other proof of purchase is required for a proper warranty service.
- The warranty is void if the serial number, date code label or product label is removed, or if the product has been subject to physical abuse, improper installation, modification, or repair by unauthorised third parties.
- Specifically exempt from any warranty are limited-life consumable components such as batteries and other accessories.

Samsung will not assume any responsibility for any loss or damage incurred in shipping. All repair work on Samsung products by unauthorised third parties voids any warranty.

Specifications

| Item | Specifications and description |
|-------------------|-------------------------------------|
| Bluetooth version | 2.1+EDR |
| Support profile | Headset Profile, Hands-Free Profile |
| Operating range | Up to 33 feet (10 metres) |
| Standby time | Up to 250 hours* |
| Talk time | Up to 6 hours* |
| Charging time | Approximately 2 hours* |

* Depending on the phone type and usage, the actual time may vary.

