

SAMSUNG

Operating Instructions

VACUUM CLEANER

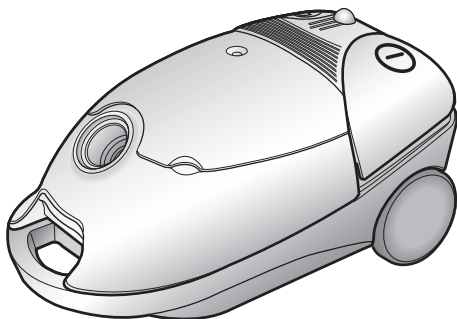

✻ Before operating this unit, please read the instructions carefully.

IMPORTANT SAFEGUARDS

- ▶ This appliance must be connected to the same mains voltage as shown on the rating plate.
- ▶ This vacuum cleaner is not suitable for removing any kind of liquid.
- ▶ Carpets treated with a liquid cleaner must be allowed to dry before being cleaned with the unit.
- ▶ Never operate the vacuum cleaner without a dust bag.
- ▶ The cover cannot be closed if a dust bag is not inserted. Please do not close forcibly.
- ▶ Keep children away from this vacuum cleaner. It must not be used on people or animals.
- ▶ Never use your appliance to vacuum matches, glowing embers, or cigarette-ends. Avoid vacuuming hard, pointed objects, since they may damage the appliance or dust bag.
- ▶ If your vacuum cleaner has a fault, please contact your electrical retailer or an authorized service agent.
- ▶ If the mains cable is defective, the complete cable winder must be replaced by a service agent.

PROTECTING THE ENVIRONMENT

- ▶ Once you have unpacked the unit, do not simply throw the packing into the household waste.
- ▶ Take them to the appropriate collecting points for recycling.

IDENTIFICATIONS OF PARTS

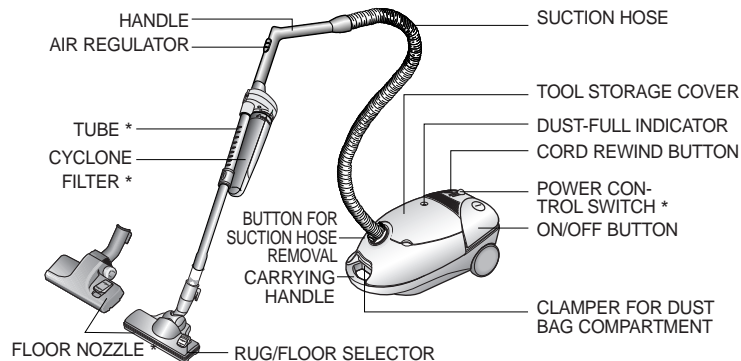

- ▶ Features marked with * may vary according to model.

ASSEMBLING THE VACUUM - CLEANER READY FOR USE

- 1) Connect the suction hose to the suction tube.
- 2) Connect the suction tubes together (depending on model).

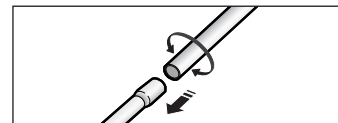
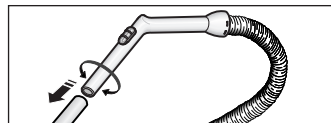

- 3) Connect the nozzle to the suction tube.

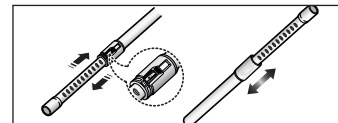
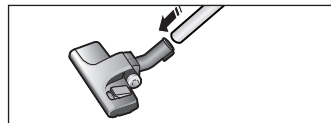

- 4) Connect the body connector to the body of the cleaner.

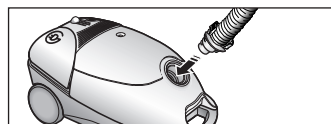

OPTION: Adjusting the telescopic tube (depending on model).

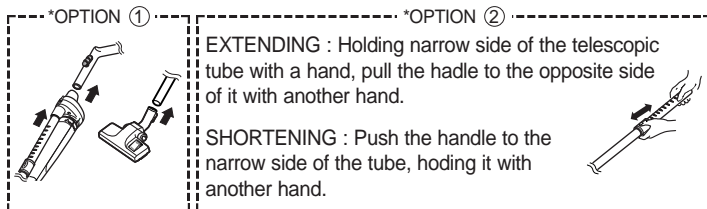

POWER CORD

1) PULLING OUT

The power cord is long enough to be drawn out for convenience.

2) REWINDING

When you have finished cleaning, disconnect the plug from the electrical outlet and simply press the cord rewind button lightly with your toe.

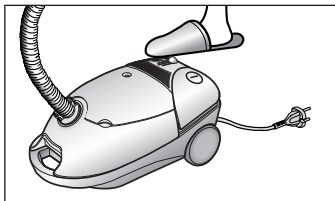

NOTE: When removing the power cord from the electrical outlet, grasp the plug, not the cord.

POWER CONTROL (VARIABLE CONTROL TYPE ONLY)

The vacuuming power can be adjusted to suit any situation with the electrical power control.

MIN = For delicate fabrics, e.g. net curtains.

MAX = For hard floors and heavily soiled carpets.

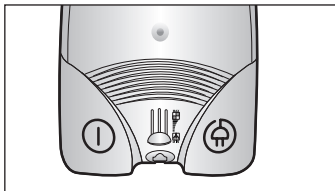

DUST-FULL INDICATOR

If the "Dust-Full" indicator changes to "RED" while you are cleaning, the dust bag requires replacement.

NOTE: If the "Dust-Full" indicator continues to display "RED" even after changing the dust bag, turn the cleaner off and check whether the hose, tube or nozzle is clogged.

USING THE ACCESSORIES

Pull the tool storage cover upward.

- Crevice tool for radiators, crevice, corners, between cushions.
- Upholstery brush for cushions and drapery.
- Dusting brush for furniture, shelves, books, etc.

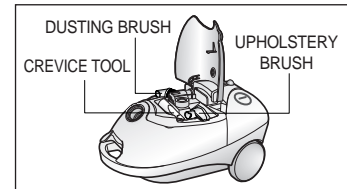

CREVICE

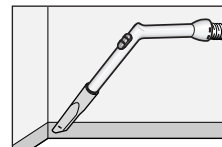

DUSTING

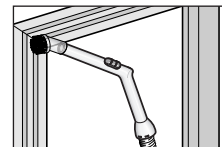

UPHOLSTERY

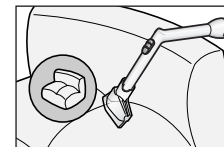

USING THE BLOWER

Located on the left rear side of the cleaner.

- 1) Disconnect the hose from the body of the cleaner.
- 2) Connect the hose clamber to the blow hole.

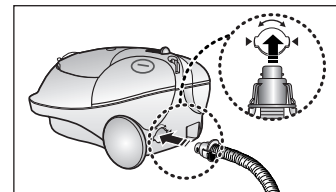

CYCLONIC FILTER(ONLY CYCLONIC FILTER TYPES)

You can use a dust bag in your cleaner for a long time thanks to the Cyclonic Filter system and it maintain the maximum cleaning efficiency.

The larger particle of dust filtered from Cyclonic Filter remain in Dust Barrel when suctioned air and dust revolves in the Cyclonic Filter. So the dust bag contains only smaller ones.

When the Dust Barrel is filled with dust up to the indicating line, it needs disposing and cleaning.

Dust Barrel can be cleaned in water.

1. Turn the Dust Barrel to the left and pull it.
2. Disconnect the Cyclonic Filter from extension wand and handle.
3. Remove thread and hair tangled around the net.
4. After cleaning the Dust Barrel and Cyclonic Filter, connect the Cyclonic Filter with extension wand and handle(washed part should be dried in the shade thoroughly before assembling).
5. Push and turn the Dust Barrel to the right.

Adjust indicating marks each other carved on Dust Barrel and Cyclonic Filter.

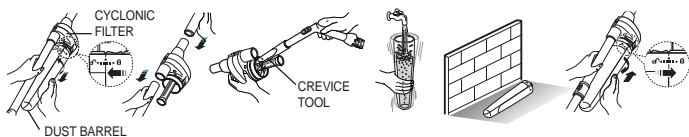

REPLACING THE DUST BAG

- 1) To open the dust cover of the dust bag compartment, press the clamber upward.
(The clamber is located at the front of the dust cover)

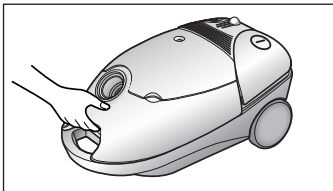

- 2) Remove the carrying bag from the cleaner.

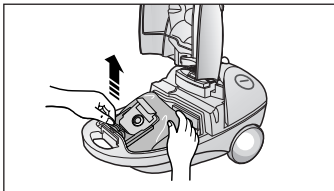

- 3) After removing the used dust bag, insert the cardboard bag collar of the new dust bag into the carrying bag, and then insert it in its original position

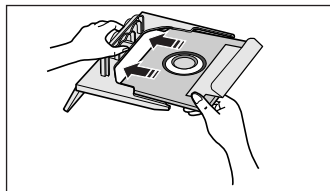

- 4) Press the dust cover down gently until the clamber relocks.

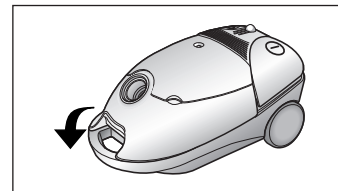

NOTE: Used dust bag can be sealed by removing the film from the paper and sticking the latter over the suction opening.
(ONLY PAPER BAG)

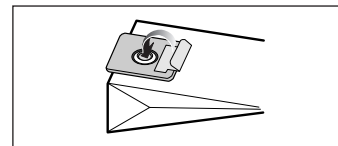

FOR CLOTH FILTER BAG

After using, if the cloth filter bag is full of dust, clean the cloth filter bag and use it again.

MAINTENANCE OR REPLACEMENT OF THE FILTERS

1) INLET-FILTER.

- Open the dust cover.
- After detaching the filter, wash it lightly with water, dry it in the shade, and then insert it in its original position.
- Close the dust cover.

2) OUTLET-FILTER.

- Open the dust cover, and then pull grille-filter forward.
- Remove and replace the exhausted outlet-filter.
- Push the grille filter, and then close the dust cover.

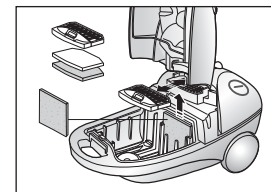

USAGE OF FLOOR NOZZLE

FOR RUG / FLOOR SELECTOR

Before use make sure that the position of the selector is in the right position for the type of surface to be cleaned.

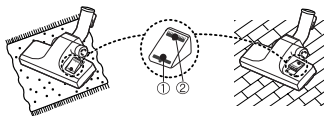

Select the carpet indicator ① when cleaning carpets.

Select flat surface indicator ② when cleaning the floors, tiles, etc.

NOTE: For optimum efficiency, clean floor brush with crevice tool.

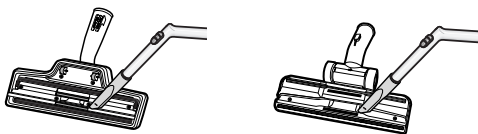

TROUBLE SHOOTING

PROBLEM	CAUSE	REMEDY
Motor does not start.	No power supply.	Check cable, plug and socket.
Suction force is gradually decreasing.	Filter, nozzle, suction hose or tube is blocked.	Remove the object.
Cord does not rewind fully.	Check that the cord is not twisted or wound unevenly.	Pull the cord out 2~3m & push down the cord rewind button.