



color laser printer

# Quick Reference Guide

简体中文 快速参考指南

繁體中文 便捷參考手冊

한글 요약 설명서



# Print Quality

ZH 打印质量  
TW 列印品質  
KO 인쇄 품질

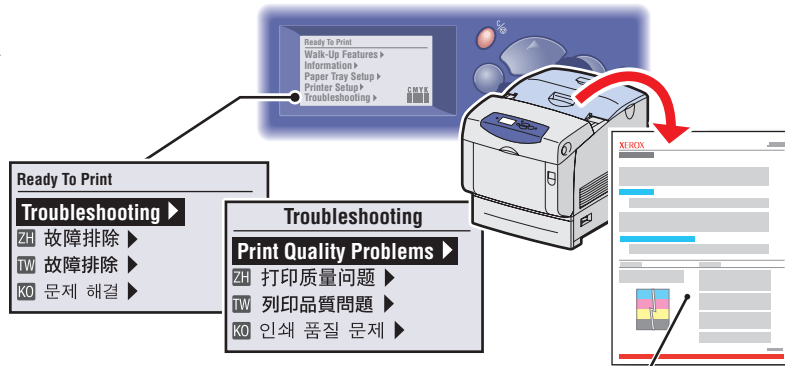

## For Print-Quality Solutions:

- See the **Print Quality Problems** menu and print the Troubleshooting Print-Quality page.
- See the **Print Quality** chapter in the *User Guide*.



### 简体中文 (ZH)

关于打印质量解决方案:

- 参见“打印质量”问题菜单并打印“故障排除打印质量”页。
- 参见*User Guide*中的**Print Quality**章节。

### 繁體中文 (TW)

關於解決列印-品質問題：

- 請參閱列印品質問題功能表，並列印列印-品質故障排除頁。
- 請參閱*User Guide*中**Print Quality**章節。

### 한글 (KO)

인쇄 품질 해결 방안:

- 인쇄 품질 문제 메뉴를 확인하고 인쇄 품질 문제 해결 쪽을 인쇄합니다.
- *User Guide* 의 **Print Quality** 장을 참조하십시오.

# Supplies Info

ZH 消耗品信息  
TW 耗材資訊  
KO 공급품 정보

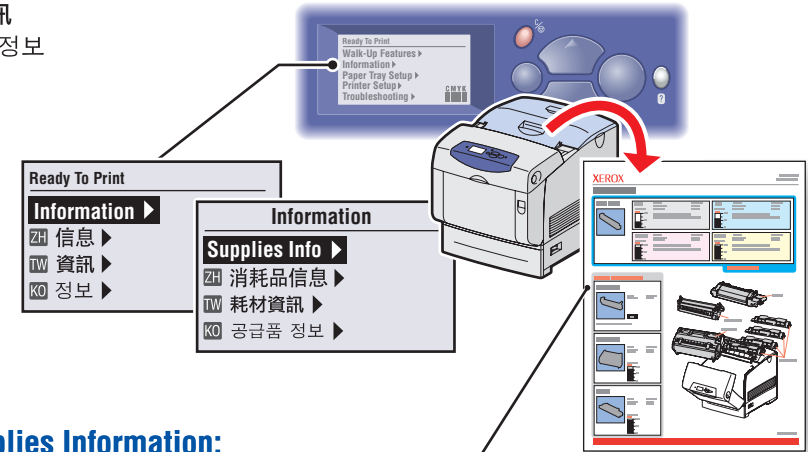

## For Supplies Information:

- See the **Supplies Info** menu and print the Supplies Usage page.
- See the **Supplies** tab in the Xerox Support Centre, contact your local reseller, or visit the Xerox Supplies web site.



### 简体中文 (ZH)

关于消耗品信息:

- 参见“消耗品信息”菜单并打印“消耗品使用”页。
- 参见“Xerox支持中心”的“消耗品”标签，联系您当地的经销商，或访问“Xerox消耗品”网站。

### 繁體中文 (TW)

關於耗材資訊：

- 請參閱耗材資訊功能表，並列印印耗材用量頁。
- 請參閱Xerox支援中心的耗材標籤、聯絡您當地的經銷商，或瀏覽原廠耗材網站。

### 한글 (KO)

공급품 정보:

- 공급품 정보 메뉴를 확인하고 공급품 사용 쪽을 인쇄합니다.
- Xerox 지원 센터의 공급품 탭을 확인하거나, 해당 대리점에 문의하거나 또는 Xerox 공급품 웹사이트를 방문하십시오.

[www.xerox.com/office/6300\\_6350supplies](http://www.xerox.com/office/6300_6350supplies)

# Control Panel Buttons

ZH 控制面板按钮  
TW 控制面板按钮  
KO 제어판 단추

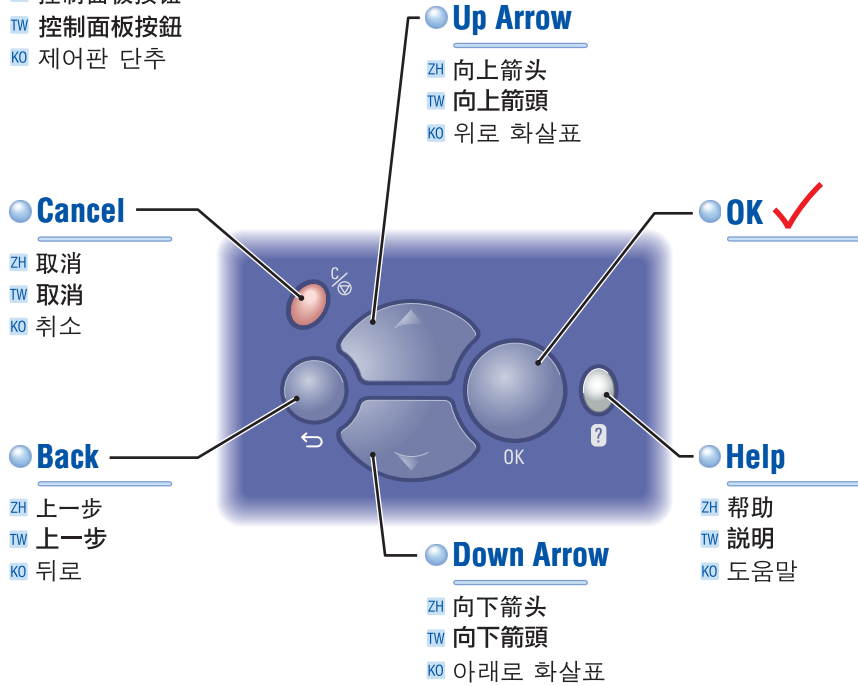

**Help Button:** Press at any time to display additional information about the message or menu.

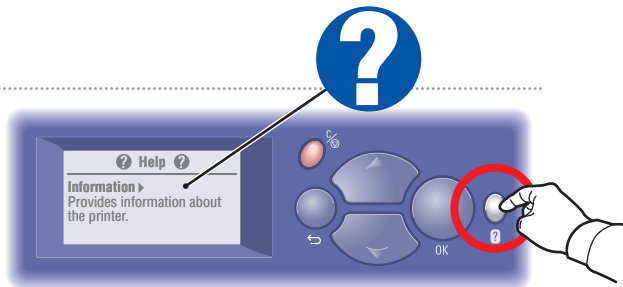

**简体中文 (ZH)**  
帮助按钮：随时按此按钮可显示关于信息或菜单的额外信息。

**繁體中文 (TW)**  
說明按鈕：隨時可按此按鈕顯示關於訊息或選單額外的資訊。

**한글 (KO)**  
도움말 단추: 메시지 또는 메뉴에 대한 추가 정보를 보시려면 언제든지 누르십시오.

# Information Pages

ZH 信息页  
TW 資訊頁  
KO 정보 쪽

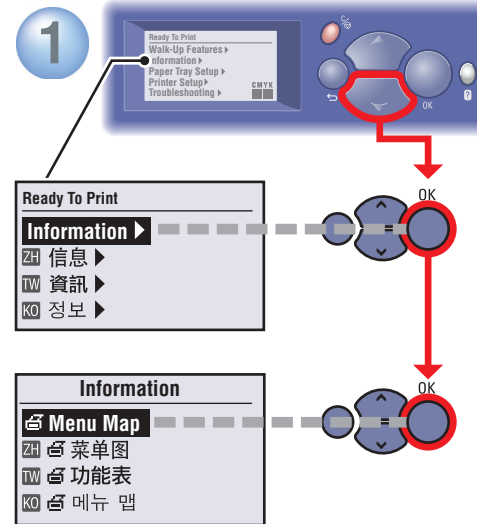

**☞ = Prints an information page.**

ZH ☞ = 打印信息页  
TW ☞ = 列印資訊頁。  
KO ☞ = 정보 쪽을 인쇄합니다.

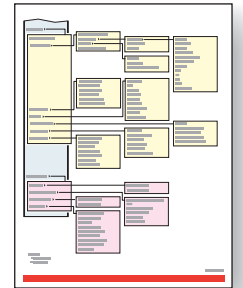
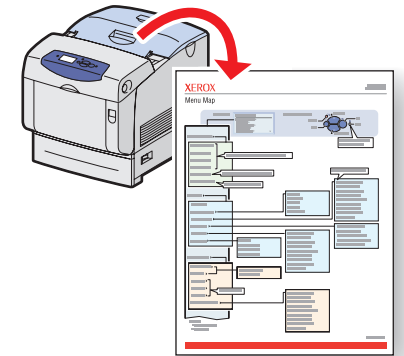
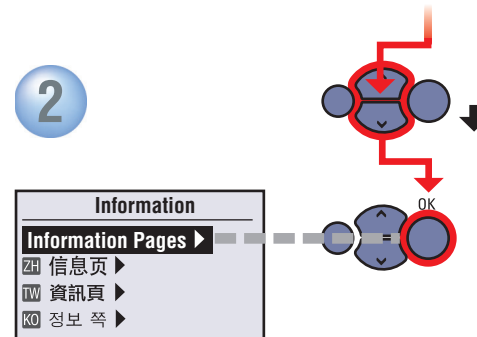

# Printer Tour

ZH 打印机浏览  
TW 印表機瀏覽  
KO 프린터 안내

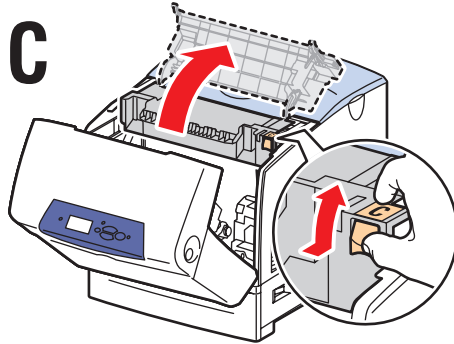
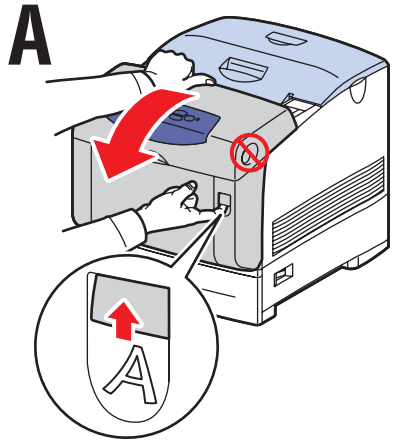
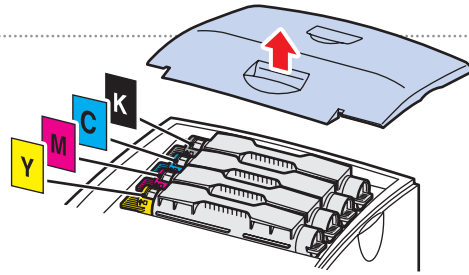

Imaging Unit

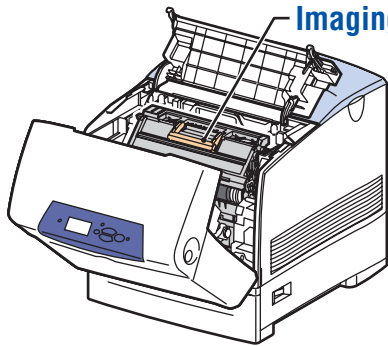

Transfer Roller

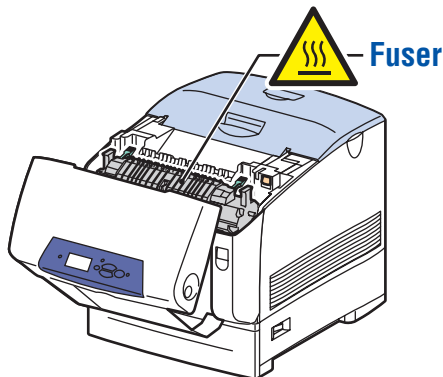
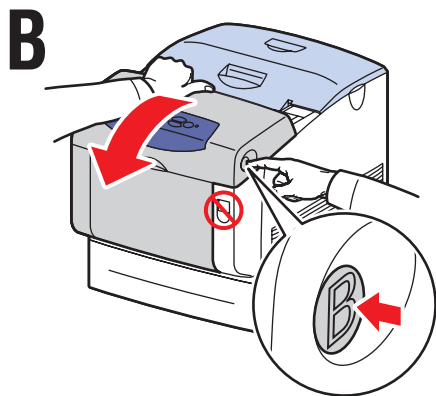
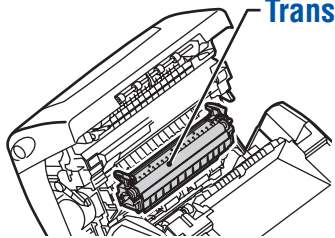

Fuser

# Supported Papers

ZH 支持的纸张  
TW 支援的紙張  
KO 지원되는 용지

Tray 1 (MPT), 2 - 5	
	65 - 163 g/m <sup>2</sup> (17 - 40 lb. Bond/ 50 - 60 lb. Cover)
Executive.....	7.25 x 10.5 in.
A/Letter.....	8.5 x 11.0 in.
US Folio.....	8.5 x 13.0 in.
Legal.....	8.5 x 14.0 in.
B5 JIS.....	182 x 257 mm
A5.....	148 x 210 mm
A4.....	210 x 297 mm

Tray 1 (MPT)	
	65 - 216 g/m <sup>2</sup> (17 - 40 lb. Bond/ 50 - 80 lb. Cover)
Statement.....	5.5 x 8.5 in.
A6.....	105 x 148 mm
ISO B5.....	176 x 250 mm
Custom.....	(W) x (H)
Width:	89 - 216 mm (3.5 - 8.5 in.)
Height:	140 - 900 mm (5.5 - 35.45 in.)

	Monarch.....	3.87 x 7.5 in.
	#10 Commercial.....	4.12 x 9.5 in.
	A7.....	5.25 x 7.25 in.
	DL.....	110 x 220 mm
	C6.....	114 x 162 mm
	C5.....	162 x 229 mm
	B5.....	176 x 250 mm

- Print the Paper Tips page for a complete listing.
- See the **Printing Basics** chapter in the *User Guide*.

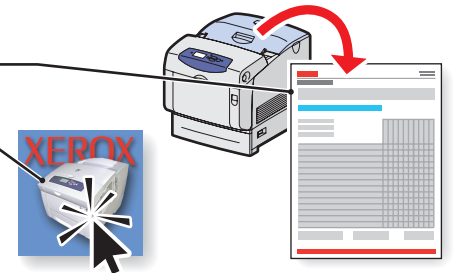

## 简体中文 (ZH)

- 打印“纸张提示”页获得完整的列表。
- 参见 User Guide 中的 Printing Basics 章节。

## 繁體中文 (TW)

- 列印紙張訣竅頁可獲得完整的清單。
- 請參閱 User Guide 中 Printing Basics 章節。

## 한글 (KO)

- 전체 목록을 확인하시려면 용지 정보 쪽을 인쇄합니다.
- User Guide 의 Printing Basics 장 을 참조하십시오.

# Basic Printing

- ZH 基本打印
- TW 基本列印
- KO 기본 인쇄

## Tray 1 (MPT) Facedown

- ZH 面朝下
- TW 面朝下
- KO 앞면이 아래로

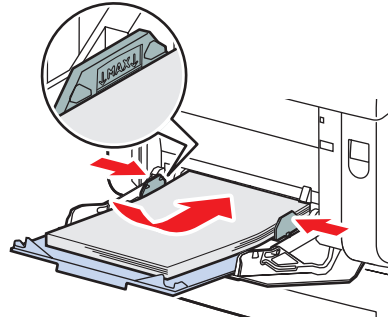
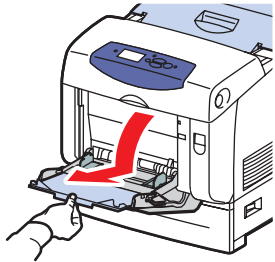
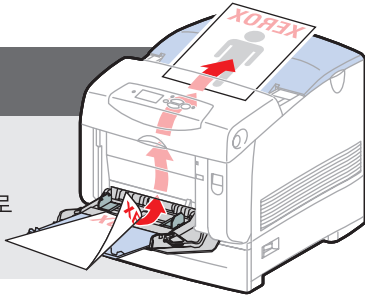

## Tray 2-5 Faceup

- ZH 面朝上
- TW 面朝上
- KO 앞면이 위로

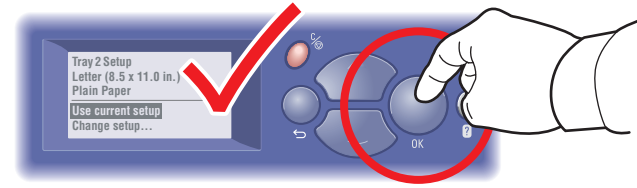
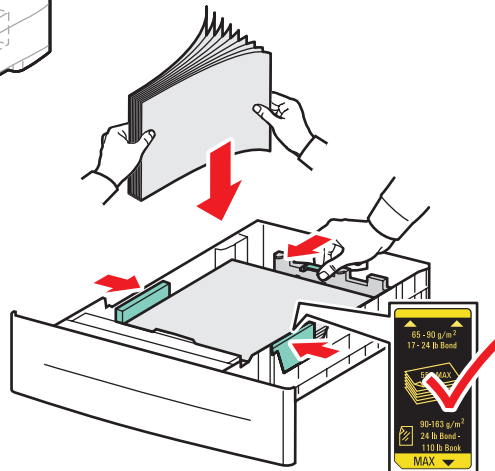
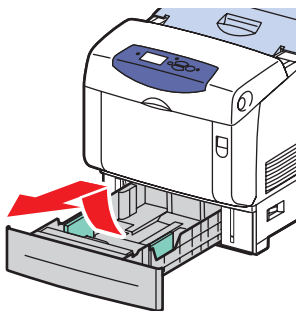

## When loading paper: Select appropriate settings on the control panel.

- ZH 装入纸张时：请在控制面板选择合适的设置。
- TW 装入紙張時：在控制面板選取適當的設定。
- KO 용지를 공급할 경우: 제어판에서 해당 설정을 선택합니다.

1 (MPT) 2 3 4 5	65-90 g/m <sup>2</sup> (17-24 lb. Bond)	85-120 g/m <sup>2</sup> (22-32 lb. Bond)	100-163 g/m <sup>2</sup> (36-60 lb. Cover)
	● Plain Paper	● Heavy Plain Paper	● Thin Card Stock
	ZH 普通紙張 TW 普通紙張 KO 일반 용지	ZH 重磅普通紙 TW 重磅普通紙 KO 중량 일반 용지	ZH 薄卡紙 TW 薄卡紙 KO 얇은 카드류

1 (MPT)	160-216 g/m <sup>2</sup> (59-80 lb. Cover)
	● Thick Card Stock
	ZH 厚卡紙 TW 厚卡紙 KO 두꺼운 카드류



PC



Mac



## When Printing: Select properties. Use Xerox printer driver.

- ZH 打印时：选择属性。使用Xerox打印机驱动程序。
- TW 列印時：選取內容。使用Xerox印表機驅動程式。
- KO 인쇄할 경우: 등록 정보를 선택합니다. Xerox 프린터 드라이버를 사용합니다.

# Xerox Support Centre

- ZH Xerox支持中心
- TW Xerox支援中心
- KO Xerox 지원 센터



**Utility** installs with the printer driver, or go to [www.xerox.com/office/6300\\_6350support](http://www.xerox.com/office/6300_6350support). Double-click the icon on the Windows desktop or Mac OS X dock.

- **User manuals and video tutorials**
- **Troubleshooting**
- **Printer and supplies status**
- **User safety**
- **Material Safety Data Sheets**

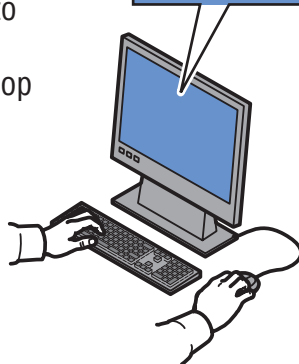

## 简体中文 (ZH)

实用程序和打印机驱动程序一同安装，或进入[www.xerox.com/office/6300-6350support](http://www.xerox.com/office/6300-6350support)来安装。双击Windows桌面或Mac OS X桌上的图标。

- 用户手册和视频指南
- 故障排除
- 打印机消耗品和状态
- 用户安全
- 材料安全数据图页 (仅英文版)。

## 繁體中文 (TW)

公用程式會和印表機驅動程式一起安裝，或者請前往 [www.xerox.com/office/6300support](http://www.xerox.com/office/6300support)。按兩下 Windows 桌面或 Mac OS X dock 上的圖示。

- 使用者手冊和教學影片
- 故障排除
- 印表機耗材與狀態
- 使用者安全
- 材料安全資料單 (僅英文)

## 한글 (KO)

유틸리티는 프린터 드라이버와 함께 설치됩니다. 또는 [www.xerox.com/office/6300-6350support](http://www.xerox.com/office/6300-6350support)를 방문하셔서 설치할 수도 있습니다. Windows 바탕화면 또는 Mac OS X dock에서 아이콘을 두 번 누르십시오.

- 사용자 설명서 및 비디오 자습서
- 문제 해결
- 프린터 공급품 및 상태
- 사용자 안전
- 물질 안전 보건 자료 (영어만 해당)