

Roma pump action espresso coffee maker

 Please read and keep these instructions

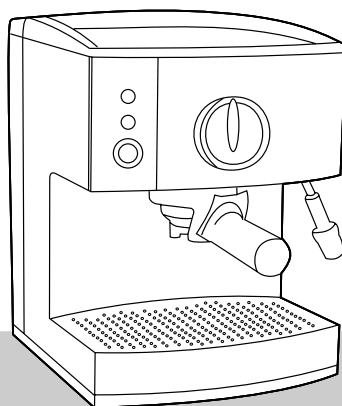

getting the best from your new coffee maker...

- **Safety first**

Caution must be used when handling hot water, coffee or steam.

- **Run water through your machine before first use**

It is important to run water through your coffee maker in order to rinse the machine. You can also run water through to warm your coffee machine.

- **Descale as appropriate for the hardness of the water in your area**

It is important to descale as the performance of your coffee maker may be impaired.

2year
guarantee

UK
08450 777700
HELPLINE
1800 409119
EIRE



Important safety instructions

The use of any electrical appliance requires the following basic common sense safety rules.

Primarily there is danger of injury or death and secondly the danger of damage to the appliance. These are indicated in the text by the following two conventions:

WARNING: Danger to the person!

IMPORTANT: Damage to the appliance! In addition we offer the following safety advice.

Location

- Remove all packaging and retain for future reference.
- Ensure the coffee maker is used on a firm, flat surface.
- Do not use the coffee maker outdoors or in a bathroom.
- Do not place the coffee maker on a highly polished wooden surface as damage may occur to the surface.
- Do not place the coffee maker on or near hot surfaces such as a hot plate or radiant rings or near a naked flame.

WARNING: Do not place the coffee maker onto a metal tray or metal surface whilst in use.

- Do not lift the coffee by gripping the water reservoir. Hold the body of the coffee maker.

Children

- Children do not understand the dangers associated with operating electrical appliances. Never allow children to use this appliance.

Other safety considerations

- Disconnect the coffee maker from the mains supply when filling, cleaning or not in use.
- Keep the outside of the coffee maker area clean and dry at all times.
- Do not touch hot surfaces. Always use handles or knobs.
- Do not immerse the coffee maker itself in water and always ensure the electrical connections are kept dry.
- Do not operate any appliance with a damaged cord or plug or after the appliance malfunctions or has been damaged in any manner. Ring the helpline number for advice on examination and repair.
- The use of attachments or tools not recommended or sold by Morphy Richards may cause fire, electric shock or injury.
- Do not use abrasive cleaners on the outside of the coffee maker, they may scratch the surface. Clean only with a soft damp cloth.
- Do not use the coffee maker for other than its intended use.

Product safety

- Never use warm or hot water to fill the water reservoir.
- Do not overfill the water reservoir.
- Operate the appliance only with the drip tray in place.

Treating scalds

- Run cold water over the affected area immediately. Do not stop to remove clothing, get medical help quickly.

Electrical requirements

Check that the voltage on the rating plate of your appliance corresponds with your house electricity supply which must be A.C. (Alternating Current).

If the socket outlets in your home are not suitable for the plug supplied with this appliance, the plug should be removed and the appropriate one fitted.

WARNING: The plug removed from the mains lead, if severed, must be destroyed as a plug with a bared flexible cord is hazardous if engaged into a live socket outlet.

WARNING: This appliance must be earthed.

Should the fuse in the 13amp plug require changing, a 13amp BS1362 fuse must be fitted.

Features

- 1 Warming plate
- 2 Warm up light
- 3 Power light
- 4 On/off switch
- 5 Brewing head
- 6 Filter lock
- 7 Filter holder
- 8 Drip tray water level indicator
- 9 Non slip rubber feet
- 10 1 cup filter
- 11 2 cup filter
- 12 Measuring spoon
- 13 Compactor
- 14 Removable drip tray
- 15 Froth attachment
- 16 Steam nozzle
- 17 Selector dial
- 18 1.7L removable water reservoir

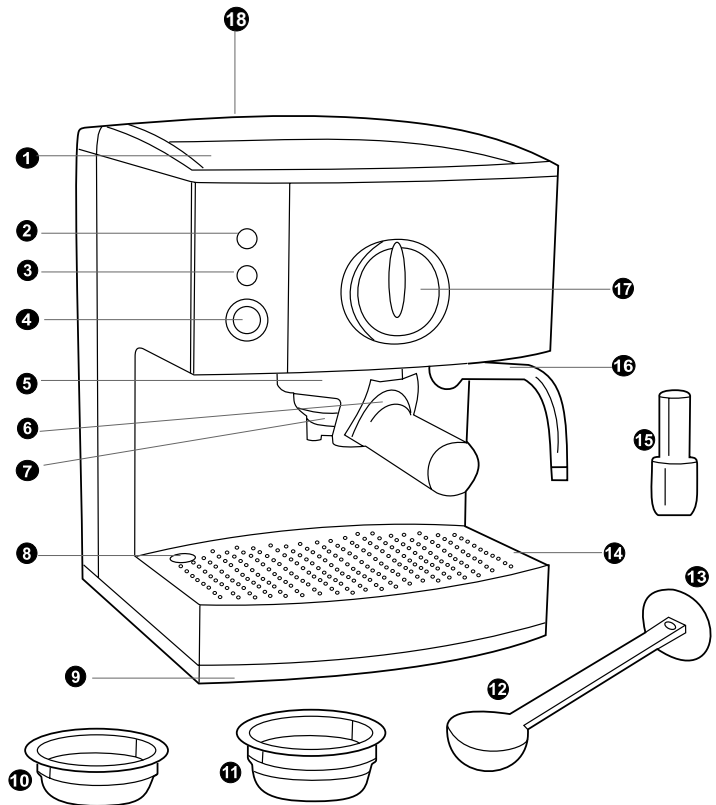

Before first use

Before using your coffee machine for the first time or if you have not used it for some time, rinse the machine by running water through. Follow the procedure for making espresso coffee below, without coffee in the filter holder.

Before making your cappuccino the cups should be warmed. This can be done on the warming plate but please note that this may take up to 20 minutes depending upon the type of cup used.

Espresso operation

Filling the water reservoir

- 1 Open the lid of the water reservoir **18** by pulling up and sliding backwards or you can slide the water tank upwards using the handle and remove to fill. **A**

IMPORTANT: Do not overfill or carry with the handle when full.

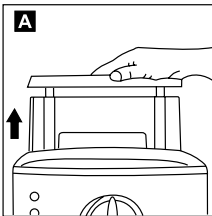

- 2 Fill the water reservoir **18** using cold tap water, 1.7 litres maximum. **B**
- 3 Replace the water reservoir by sliding it back into place. **C**

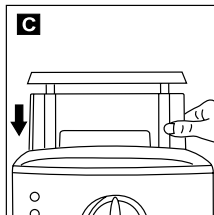
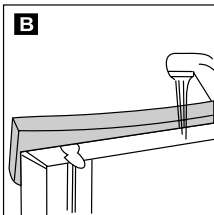

Operating your coffee maker

- 1 Plug the unit into the power outlet.
- 2 Switch the unit on by pressing the on/off switch **4**. The red 'power' light **3** and orange 'warm up' light **2** will illuminate.
- 3 Pre-heat your coffee cups by placing them upside down on the warming plate. **1**
- 4 Select the required filter **10** for 1 cup and **11** for 2 cups and place in the filter holder. **D**

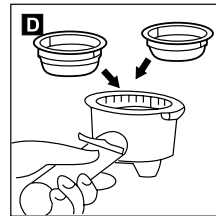

- 5 Using your measuring spoon **12** supplied, place one or two measures of ground coffee into the filter. With the other end of the measuring spoon, use the compactor **13** to tamp down the coffee. **E**

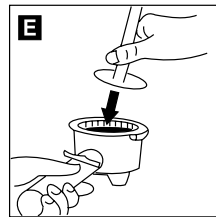

IMPORTANT: Be sure not to overfill the filter with too much coffee, and wipe around the edge of the filter to remove any coffee grounds.

- 6 Place the filter holder **7** on the brewing head **5** and position the handle so it points to the left. **F**

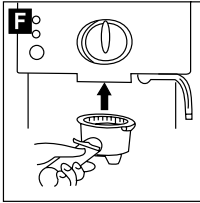

Ensure the filter holder is flat against the brewing head and turn the handle towards the right **G** as far as it will go. Note: Do not overtighten.

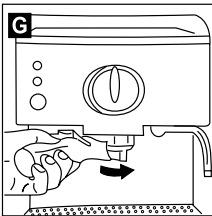

- 7 Place 1 or 2 pre-heated cups below each of the holes in the filter holder **H** and **I**. When the coffee maker is at the correct temperature the orange 'warm up' light will go out.
- 8 Turn the selector dial **7** to the coffee setting. You will hear the machine make a pumping noise, this is normal.

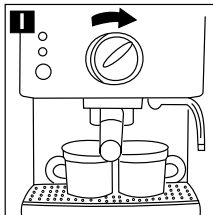
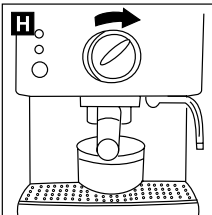

- 9 Once the cups are filled to the desired level turn the selector dial to the '0' off position. Water will still filter through for approximately 8 seconds after the machine has been turned off.

- 10 Remove the filter holder and filter by turning the filter holder handle to the left.
- 11 To remove the used coffee grounds from the filter, push the filter lock **6** forward over the edge of the filter and turn the filter holder upside down. Gently tap out the coffee. **J**

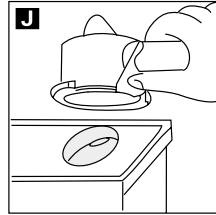

- 12 Once the orange 'warm up' light goes out your machine is ready to make the next espresso.

Steam function

The froth attachment makes it easy to produce frothy milk for cappuccino.

- Before using the steam nozzle, remove the filter holder.
 - Attach the froth attachment **15** to the end of the steam nozzle **16**. **K**
- IMPORTANT:** For the froth enhancing attachment to work you must ensure that it is pushed firmly onto the steam nozzle.

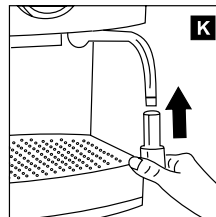



- Fill the water reservoir with cold tap water.
- Turn the unit on. The red 'power' light and orange 'warm up' light will both illuminate.
- Swing the steam nozzle with the froth attachment to the side of the machine.

- 6 Pour cold milk into a suitable jug. Use approximately 100ml for each cappuccino.

Note: For best results we recommend to use refrigerated milk and a stainless steel jug that is well chilled.

When the unit is the right temperature the orange 'warm up' light will go out.

- 7 Hold the jug under the steam nozzle so that the head of the froth attachment is immersed in milk and turn the selector dial to the  steam setting.  You will hear the machine make a pumping noise, this is normal.

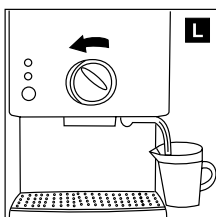

IMPORTANT: Do not allow the tip of the nozzle to touch the bottom of the jug because this could obstruct the passage of the steam.

- 8 Once the froth has been produced, turn the selector dial to the '0' off position and remove the jug.

Note: Do not be alarmed by the escaping steam from the base.

The milk is ready as soon as it forms a soft, thick layer of foam on the top. If the milk starts to make large popping bubbles, you have boiled the milk and it will therefore not froth. If this happens replace with chilled milk. Do not boil the milk.

Frothing tips

- For best results use fresh, cold milk from the refrigerator.

- Skimmed milk or fat reduced milk will make frothing easier.

Hot water drinks

You are able to make hot water drinks such as tea or instant soups using the steam nozzle.

- 1 Ensure the unit is cold before removing the froth attachment from the steam nozzle if attached.
- 2 Follow the 'steam function' and heat up hot water instead of milk.

Note: It is normal for the orange 'warm up' light to cycle on and off during the water heat up process.

Preheating coffee maker

To make hotter coffee and to warm your coffee cups you may preheat your machine. This can be achieved by following the 'espresso operation' by passing hot water through the coffee maker but without using coffee.

Cups should be placed upside down on the warming plate. Please note that this may take upto 20 minutes depending upon the type of cup used.

Cleaning and maintenance

You must clean the steam nozzle and froth attachment immediately after each use.

- 1 Simply wipe the steam nozzle, warming plate and exterior with a clean, damp cloth. **Do not use any abrasives or metal scourers as this will damage the finish on the unit.**

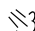
Briefly turn the selector dial to the  steam setting to clear any remaining milk out of the steam nozzle.

Warning: Steam from the nozzle is extremely hot and can scald.

- 2 Place the froth attachment under warm running water to remove any excess milk.

IMPORTANT: Never wash your coffee machine accessories in a dishwasher.

- 3 The filters, filter holder and water reservoir should be washed after each use by rinsing them under warm water. To assist in keeping the filters clean we recommend you periodically run the machine with the filter in place, without coffee, using water only.

Should the holes in the filters become blocked with coffee granules use a fine bristled brush.

When your coffee maker is not being used, we recommend that you do not leave the filter holder attached to the machine as this will reduce the life of the gasket.

Descaling

If you live in a hard water area, we recommend that your coffee maker is descaled at regular intervals, e.g. every 2-3 months. In areas of moderately hard water you should descale every 6 months. If the water filters through more slowly than usual, it is a sign that descaling is necessary.

We recommend you use proprietary liquid descaler which is especially made for coffee makers and plastic kettles. Follow the instructions on the bottle, and then operate the coffee maker with water only 3 times before making coffee.
ENSURE THE DESCALER IS SUITABLE FOR COFFEE MAKERS.

Drip tray

- 1 The water level indicator **6** appears through the grid to indicate that the drip tray is full.

- 2 Remove the grid of the drip tray by pushing gently at the back of the tray as indicated and lift off. **M**
This must be done regularly or as soon as the red water level indicator appears through the grid.

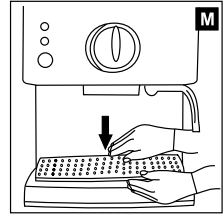

- 3 Lift the front of the drip tray up and slide it out. **N**
- 4 Lift off the plastic lining of the drip tray. **O** Clean the drip tray and its grid with water and a little washing up liquid, rinse and dry.

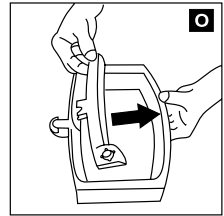
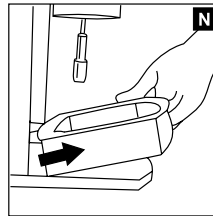

- 5 Reverse the procedure to reassemble.

Note: Ensure that when you are replacing the drip tray that the plastic lining is in the correct position.

Helpline

If you have any difficulty with your appliance, do not hesitate to call us. We're more likely able to help than the store from where you bought it.

Please have the following information ready to enable our staff to deal with your query quickly.

- Name of the product
- Model number as shown on the underside of the appliance.



Your two year guarantee

• **It is important to retain the retailers receipt as proof of purchase.** Staple your receipt to this back cover for future reference.

Please quote the following information if the product develops a fault. These numbers can be found on the base of the product.

Model No.

Serial No.

All Morphy Richards products are individually tested before leaving the factory. In the unlikely event of any appliance proving to be faulty within 28 days of purchase it should be returned to the place of purchase for it to be replaced.

If the fault develops after 28 days and within 24 months of original purchase, you should contact the Helpline number quoting Model number and Serial number on the product, or write to Morphy Richards at the address shown. You will be asked to return the product (in secure, adequate packaging) to the address below along with a copy of proof of purchase. Subject to the exclusions set out below (see 'Exclusions') the faulty appliance will then be repaired or replaced and dispatched usually within 7 working days of receipt.

If for any reason this item is replaced during the 2 year guarantee period, the guarantee on the new item will be calculated from original purchase date. Therefore it is vital to retain your original till receipt or invoice to indicate the date of initial purchase.

Morphy Richards products are intended for household use only.

Morphy Richards has a policy of continuous improvement in product quality and design.

The Company, therefore, reserves the right to change the specification of its models at any time.

To qualify for the 2 year guarantee the appliance must have been used according to the manufacturers instructions. For example kettles should have been regularly descaled.

EXCLUSIONS

Morphy Richards shall not be liable to replace or repair the goods under the terms of the Guarantee where:

- 1 The fault has been caused or is attributable to accidental use, misuse, negligent use or used contrary to the manufacturers recommendations or where the fault has been caused by power surges or damage caused in transit.
- 2 The appliance has been used on a voltage supply other than that stamped on the products.
- 3 Repairs have been attempted by persons other than our service staff (or authorised dealer).
- 4 Where the appliance has been used for hire purposes or non-domestic use.
- 5 Morphy Richards are not liable to carry out any type of servicing work, under the guarantee.
- 6 Plastic filters for all Morphy Richards kettles and coffee makers are not covered by the guarantee.

This guarantee does not confer any rights other than those expressly set out above and does not cover any claims for consequential loss or damage. This guarantee is offered as an additional benefit and does not affect your statutory rights as a consumer.

- This guarantee is valid in the UK and Ireland only.

morphy richards®

The After Sales Division,
Morphy Richards Ltd, Mexborough,
South Yorkshire, England, S64 8AJ

Helpline (office hours)
UK (local rate) 08450 777700,
Republic of Ireland 1800 409119