

DEALER SET-UP INSTRUCTIONS and PRE-SALE CHECKLIST for SNAPPER EUROPEAN LARGE FRAME SNOW THROWERS

INTRODUCTION: The Snapper Large Frame Snow Throwers are shipped almost fully assembled and require minimal set-up. Setting up the machine will require the handles to be unfolded and secured, and the attachment of the chute crank rod. Some models may also require the installation of the electric start kit to the engine. Complete each of the following steps carefully.

STEP 1: HANDLES: Cut both wire ties that secure the control cables to the handles. Be very careful and DO NOT cut the control cables. Cut the wire tie that secures the chute crank to the handle. See Figure 1.

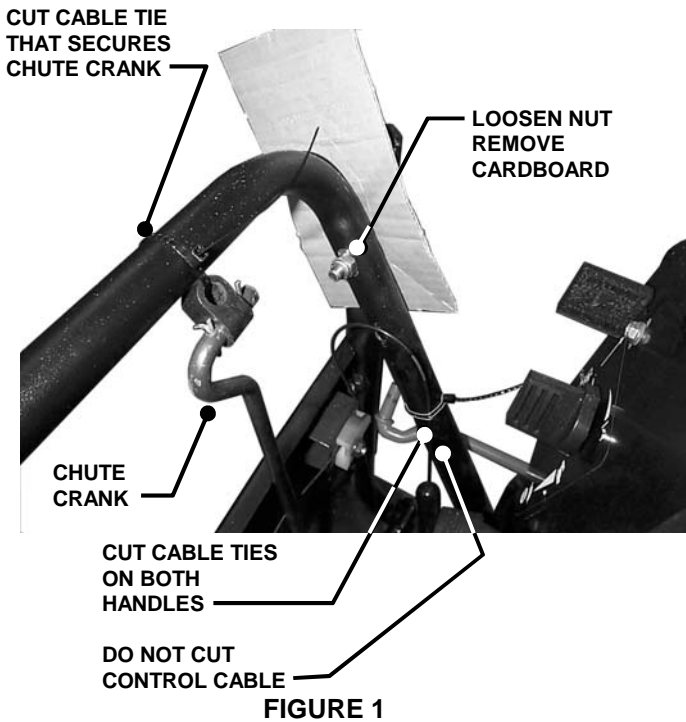

STEP 2: HANDLES: Loosen handle nuts and speed control rod nut. Rotate handles up to the operating position. Remove shipping cardboard from in between handles. See Figure 1. Insert bolts through both upper & lower handles and secure with nuts. Make sure the square necks of the bolts are recessed into the square holes of upper handles. Tighten nuts securely. See Figure 2.

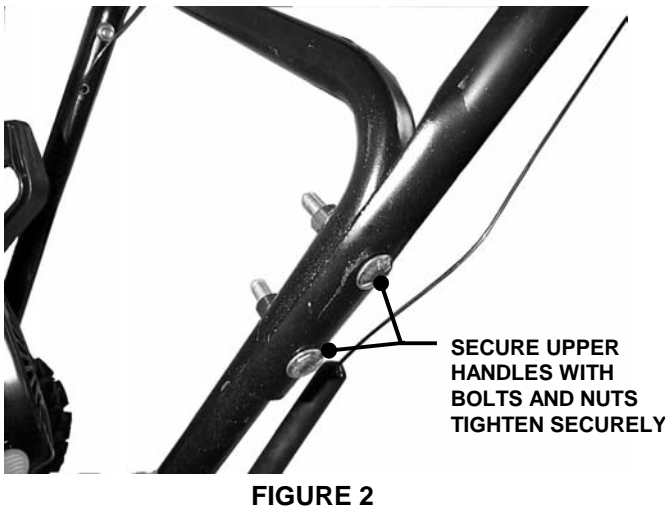

STEP 3: HANDLES: Cut both wire ties that secure the control levers to the handles. See Figure 3.

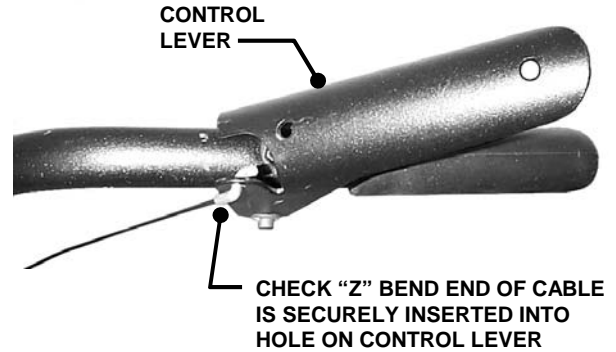

STEP 4: CABLES: Make sure that the cables are connected to the traction clutch rod and blower clutch bracket. IMPORTANT: Cables should have some slack and should not be under tension. Both controls must pivot freely. See Figure 4.

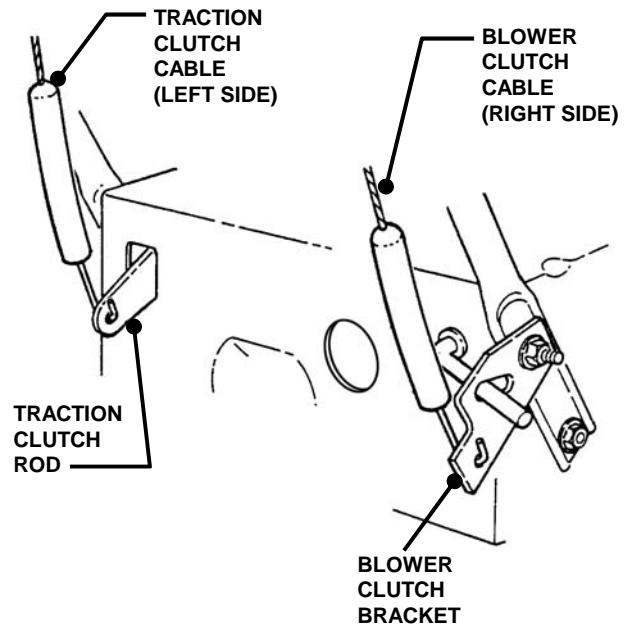

STEP 5: CONTROL ROD: : Cut wire ties that secure the ground speed control handle and control rods. Secure both halves of the ground speed control rod together. **IMPORTANT:** Make sure alignment tab and slot on the two rod halves are engaged together. Tighten nut securely. See Figure 5.

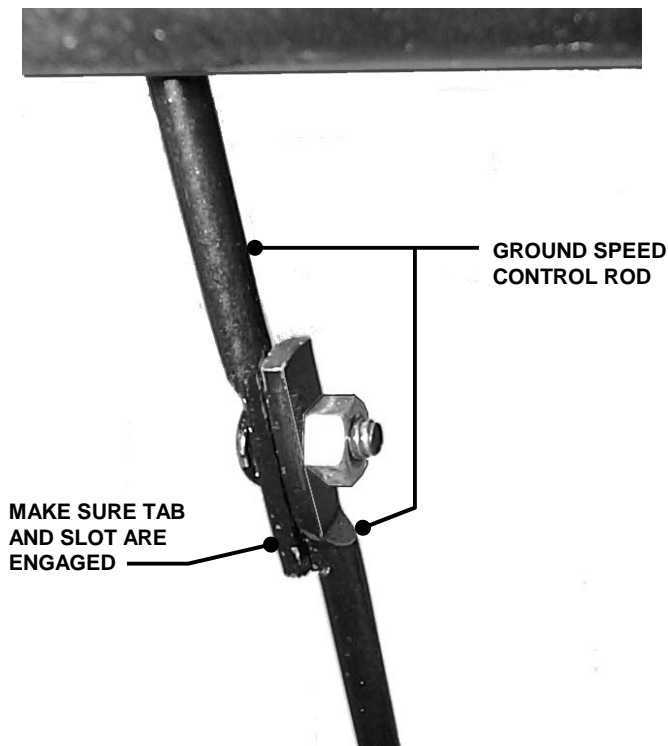

FIGURE 5

STEP 6: CHUTE CRANK: Connect chute crank to worm gear shaft and secure with cotter pin. See Figure 6.

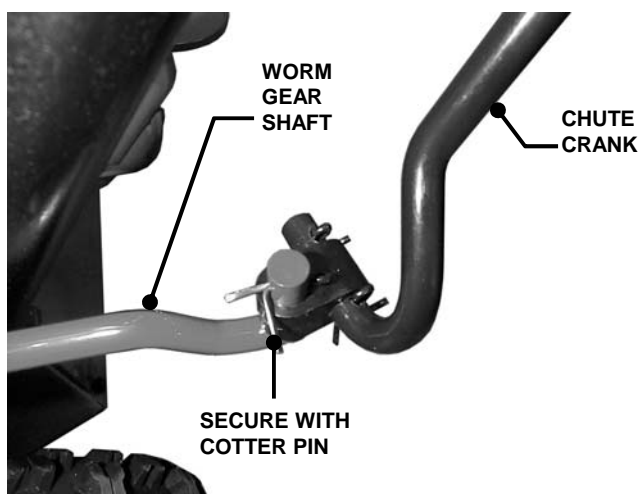

FIGURE 6

STEP 7: HEAD LIGHT: Use the wire ties supplied in kit to secure the head light wire to the handles. Connect headlight and engine harness together. See Figure 7.

STEP 8: DRIFT CUTTER Remove drift cutters from the side of the auger housing and attach as shown. Note: Bolts are inserted into rear holes of drift cutter. Tighten nuts securely. See Figure 8.

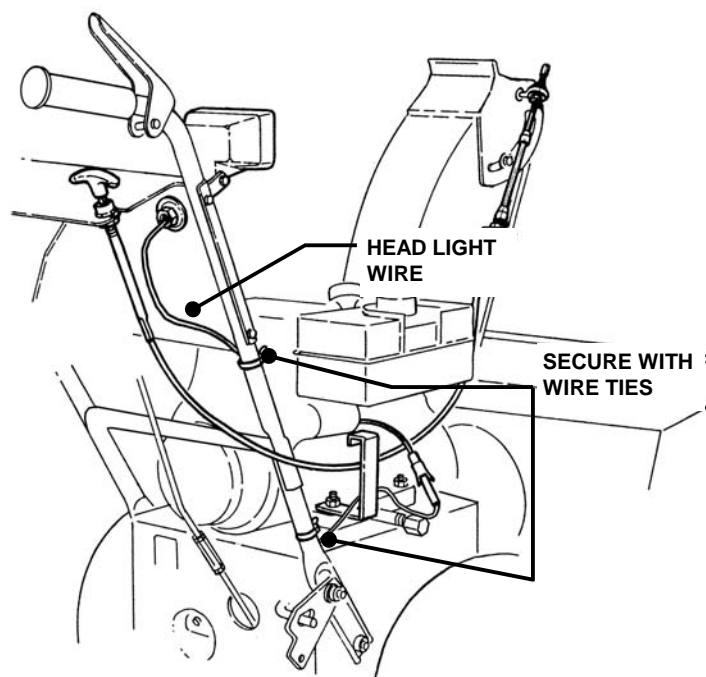

FIGURE 7

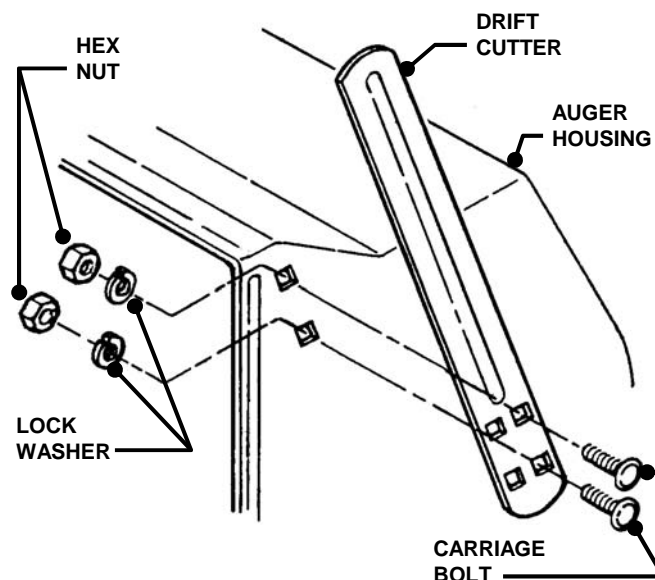

FIGURE 8

NOTE: Drift Cutters are optional on some model Snow Throwers. After set-up the hardware bag will contain: two shear bolts and two nuts and a cotter pin.

IMPORTANT: All necessary adjustments are made to the machine at the factory. The following steps are provided for reference only. Complete ALL items on the Dealer Pre-Sale Checklist.

STEP 9: ADJUSTMENT – CONTROL CABLES:

Both clutch cables should be slack when the control levers are released. The cable spring on each control should stretch 3/8" when each lever is depressed. To adjust cable, loosen locking nut and turn cable connector as needed to obtain the 3/8" extension. Tighten locking nut. See Figure 9.

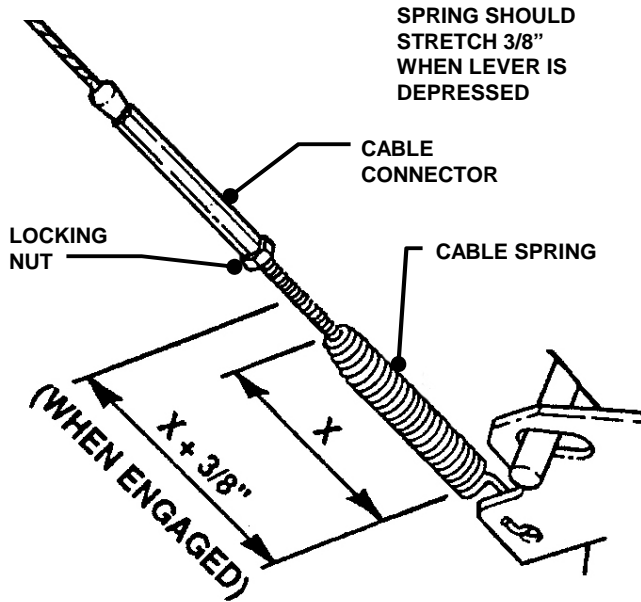

FIGURE 9

STEP 10: ADJUSTMENT - CLUTCH CONTROLS:

- A. Hold the traction clutch control lever down against the handle (L.H. Side) See Figure 10.
- B. Check position of the cam lock - it must align with the adjusting line on the cam lock bracket.
- C. To adjust, loosen the nuts on the cable guide support bracket and move bracket in or out until the cam lock aligns with the adjusting line. Tighten nuts.
- D. Hold the traction clutch lever down while pressing the blower clutch lever down into its engaged position and hold.
- E. Check the position of the cable ferrule shown in Figure 10.
- F. The ferrule shown in Figure 10 must be located 1/16" (.060) above the hook of the cam lock. To adjust, loosen the three nuts on the cam lock bracket and slide it up or down until adjustment is correct. Tighten nuts and release both control levers.

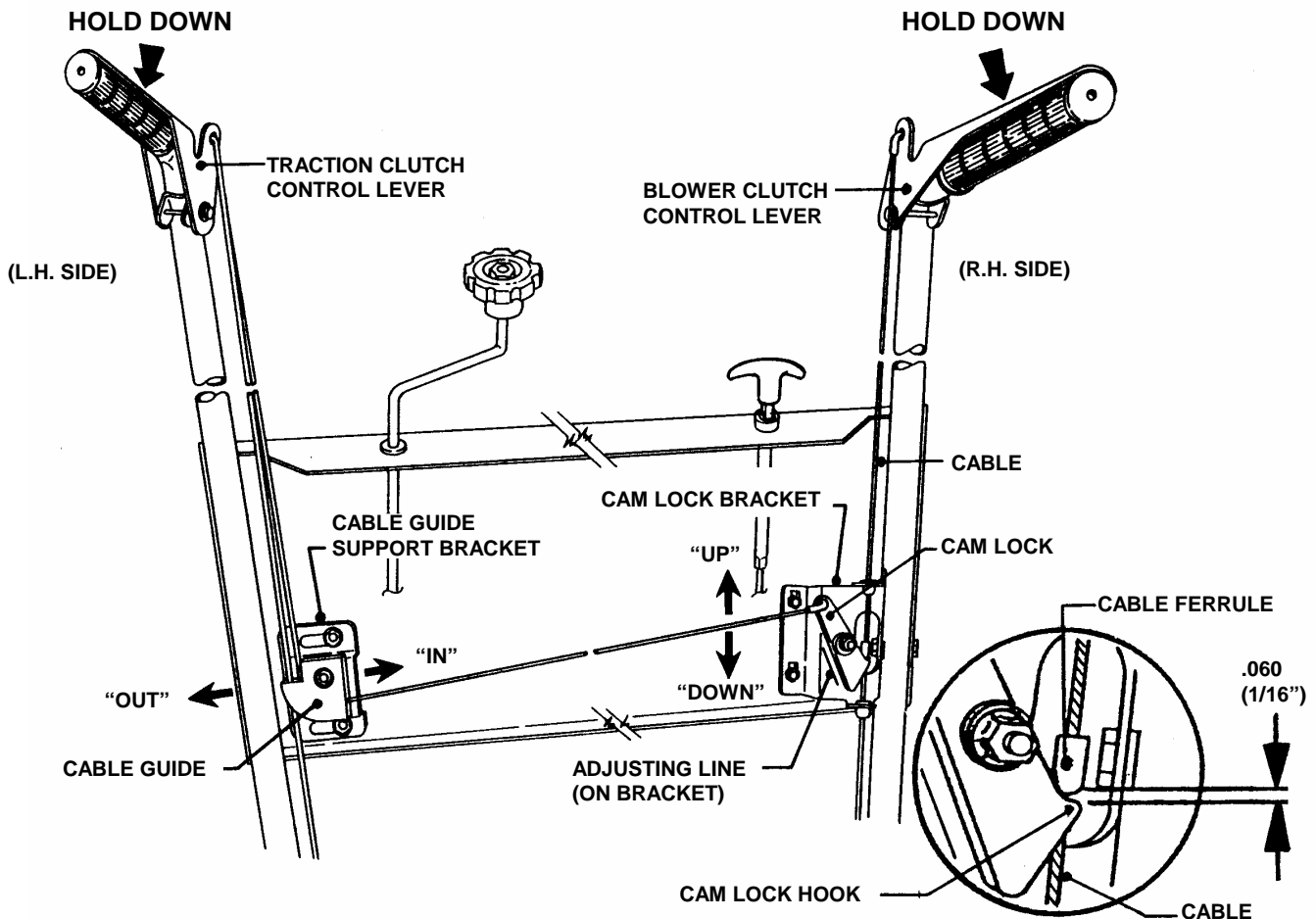

FIGURE 10

DEALER PRE-SALE CHECKLIST

The following must be accomplished upon the sale of the snow thrower. It is very important that the Dealer performs and accomplishes the set-up and the operational tests as listed below. Check (✓) items actually performed and signed on this page.

LUBRICATION

- _____ ENGINE OIL added to bring level up to full mark on 4-cycle engines (Refer to Engine Manual).
- _____ GEAR CASE grease level checked, add Benalene 900 grease (Snapper Part No. 2-9577) if needed.

OPERATIONAL TEST

- _____ AUGER DRIVE CONTROL checked for proper engagement and disengagement to insure auger stops within 5 seconds after auger clutch control is released.
- _____ WHEEL DRIVE CONTROL checked for proper engagement and disengagement of wheel drive.
- _____ ENGINE started, engine speed control settings checked and adjusted as needed.
- _____ IGNITION SWITCH checked to insure engine stops when turned to OFF position.
- _____ ENGINE ELECTRIC STARTER checked for proper operation.
- _____ FUEL SYSTEM checked for leaks around tank and connections.
- _____ DISCHARGE CHUTE CRANK checked for proper operation and free rotation.
- _____ AUGER and WHEEL DRIVE CONTROL CABLES checked and adjusted per instructions in the Operator's Manual.
- _____ GROUND SPEED CONTROL checked and adjusted per instructions in the Operator's Manual.
- _____ CHOKE CONTROL checked for proper operation during start up.
- _____ TIRE PRESSURE checked. 15 to 20 PSI if chains are to be installed or 12 PSI if chains are not being used.
- _____ AUGER DRIVE CONTROL stops auger when released.
- _____ WHEEL DRIVE CONTROL stops wheel drive when released.
- _____ CHECK LIGHT checked for proper operation.

DEMONSTRATION & INSTRUCTION

- _____ PERSONALLY HANDED Operator's Manual & Snow Thrower Safety Booklet to purchaser.
- _____ INSTRUCTED purchaser to read and follow instructions in Operator's Manual.
- _____ DEMONSTRATED proper starting procedure and operation of snow thrower to purchaser.
- _____ INSTRUCTED purchaser how to service air cleaner, maintain oil level (4-cycle).
- _____ ASSISTED purchaser in completing Product Registration Card.

DEALER'S RECORDS & CONSUMER/OPERATOR PRODUCT REGISTRATION CARD

Purchase Date _____ Model _____ Serial No. _____

Retailers Name _____ Signature _____

Address _____ City _____ State _____ Zip _____

MACHINE WILL BE USED COMMERCIALY? _____ YES _____ NO

Purchaser's Name _____ Signature _____

Address _____ City _____ State _____ Zip _____

IMPORTANT: This form is to be retained by the Dealer for future reference regarding Warranty, proof of purchase, traceability for product recall or service, etc. Complete the Product Registration Card and Mail to Customer Service Department at SNAPPER, P.O. Box 1379, McDonough, Georgia, 30253.