

# **BUNN**®

# ***FPG***



## **OPERATING & SERVICE MANUAL**

**BUNN-O-MATIC CORPORATION**

**POST OFFICE BOX 3227**

**SPRINGFIELD, ILLINOIS 62708-3227**

**PHONE: (217) 529-6601 FAX: (217) 529-6644**

## CONTENTS

User Notices .....	3
Electrical Requirements .....	3
Operating Controls.....	3
Cleaning.....	4
Coffee Grinding .....	4
Initial Set-Up.....	5
Adjustments .....	5
Wiring Schematics.....	6

## INTRODUCTION

The FPG will store up to six pounds of whole bean coffee and grind it to a preset grind and amount into an awaiting funnel and filter or French Press from most commercial drip coffee brewers. The equipment is only for indoor use on a sturdy counter or shelf. Adequate space must be available above the grinder to raise the lid when adding beans. Use only with whole bean coffee.

The grind is preset at the factory to drip specifications as set forth by the United States Department of Commerce and adopted by the Coffee Brewing Center of the Pan American Coffee Bureau. Adjustments may be made to alter both the amount and grind from the factory setting.

## WARRANTY

Bunn-O-Matic Corp. (“Bunn”) warrants the equipment manufactured by it to be commercially free from defects in material and workmanship existing at the time of manufacture and appearing within one year from the date of installation. In addition:

- 1.) Bunn warrants electronic circuit and/or control boards to be commercially free from defects in material and

## USER NOTICES

Carefully read and follow all notices on the grinder and in this manual. They were written for your protection. All notices on the grinder are to be kept in good condition. Replace any unreadable or damaged labels.

<b>⚠ CAUTION</b>
<b>PERSONAL INJURY HAZARD.</b>
<b>KEEP FINGERS AND FOREIGN OBJECTS OUT OF HOPPER OR CHUTE OPENING.</b>

**#05876.0000**

<b>⚠ WARNING</b>
<ul style="list-style-type: none"><li>◆ Use only on a properly protected circuit capable of the rated load.</li><li>◆ Electrically ground the chassis.</li><li>◆ Follow national/local electrical codes.</li><li>◆ Do not use near combustibles.</li></ul>
An extension cord, when used, must be shorter than 20 feet if 16-gage 3-conductor wire, or shorter than 10 feet if 18-gage 3-conductor wire.
<b>FAILURE TO COMPLY RISKS EQUIPMENT DAMAGE, FIRE, OR SHOCK HAZARD</b>
READ THE ENTIRE OPERATING MANUAL INCLUDING THE LIMIT OF WARRANTY AND LIABILITY BEFORE BUYING OR USING THIS PRODUCT
20545-0000 7/90 © 1990 Bunn-O-Matic Corporation

**#20545.0000**

### ELECTRICAL REQUIREMENTS

The grinder has an attached cordset and requires 2-wire, grounded service rated 120 volts ac, 15 amp, single phase, 60 Hz for 120V models; 100 volts ac, 15 amp single phase, 50Hz for 100V models; and 230 volts ac, 10 amp single phase, 50 Hz for 230V models.

### OPERATING CONTROLS

#### Off/On/Start Switch

**OFF** - (upper position) Switching to this position stops all operation of the grinder.

**ON** - (middle position) The switch will return to this position after a grind cycle has begun and will remain in this position after grinding has ceased.

**START** - (lower, momentary position) Pressing the switch to this position and releasing initiates a grind cycle.



#### Batch Selector Switch

Select Small, Medium or Large batch by turning the round selector knob on the left front of the grinder.

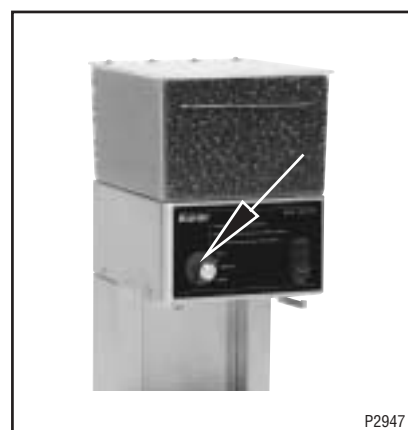

## CLEANING

### EXTERIOR SURFACES

The use of a damp cloth rinsed in any mild, nonabrasive, liquid detergent is recommended for cleaning all surfaces on Bunn-O-Matic equipment. Care should be taken not to scratch the hopper or windows with any abrasive material. Regular cleaning will keep your grinder looking new for years.

### GRIND CHAMBER

1. **WARNING** - Unplug grinder before removal of any panel or grind chamber housing parts.
2. Empty all beans from the hopper.
3. Plug-in the grinder, place funnel with filter into funnel rails. Press the Off/On/Start switch to the "START" lower position and release. Run a few grind cycles until all the coffee in the grind chamber is dispensed and disconnect grinder from the power source.
4. Remove the funnel with filter and carefully tip the grinder over on it's back.
5. Loosen the three #10-32 screws holding the cone. Rotate the cone clockwise and remove.
6. Remove the two #10-32 screws securing burr housing cap assembly to the burr housing and remove burr housing cap assembly.
7. Remove load disc and slide rotor with lower burr, spring and brass bushing off of the motor shaft.
8. Clean the grind chamber and all parts with a dry non metallic bristle brush and wipe with a dry clean cloth.
9. Reinstall brass bushing (flanged end first), spring and rotor with lower burr onto the motor shaft. Reinstall load disc flat side toward rotor and burr housing cap assembly to the burr housing.
10. Refer to Initial Set-up/Adjustments section to vary grind or weight of dispensed coffee if necessary.

### COFFEE GRINDING

1. Set the Rotary Batch Selector Switch for the desired batch size and visually inspect the hopper for an ample supply of whole bean coffee.
2. Carafe brewing: Place a paper filter into the brew funnel. Insert the funnel into the rails and push until it stops.
3. French Press brewing: Place French Press on grinder base and push towards rear until it stops.
4. Momentarily press Off/On/Start switch to the "START" lower position and release. The grinding action will stop automatically after the preset amount of ground coffee is dispensed into the funnel.
5. Remove the funnel from the grinder and level the bed of grounds by gently shaking.
6. The loaded funnel is now ready for use in any commercial drip coffee brewer according to the manufacturer's instructions.

## INITIAL SET-UP/ADJUSTMENTS

The grind can be set from fine to very coarse. The grind may be adjusted for use in most commercial coffee brewers. The following procedures should be used to make adjustments.

**NOTE** - A change in the burr adjustment will also change the amount dispensed. Any adjustment to the burrs should be followed by an adjustment of the timer dials.

### Burr Adjustment

1. Unplug the grinder and empty all beans from the hopper(s).
2. Plug-in the grinder, place funnel with filter into the funnel rails. Momentarily press the Off/On/Start switch to the "START" (lower) position (with desired hopper selected) and release, run a few grind cycles until all of the coffee in the grind chamber is dispensed.
3. Remove the funnel with filter and carefully tip the grinder over on it's back.
4. Place the Off/On/Start switch in the "START" (lower) position and, using the grind adjustment key provided, slowly turn the adjusting screw in a clockwise direction until a metallic whine is heard due to the rubbing of the grinding burrs. (It may be necessary to start more than one grind cycle to obtain the sound).
5. Make a mark with a pen on the decal to note the position of the arrow on the grind adjustment screw.
6. The following settings approximately correspond to the CBC recognized grinds. All are referenced from the arrow position marked in step #5.

**FINE GRIND:** Rotate the adjusting screw 7 hash marks in a counterclockwise direction.

**DRIP GRIND:** Rotate the adjusting screw 8 hash marks in a counterclockwise direction.

**REGULAR (COARSE) GRIND:** Rotate the adjusting screw 10 hash marks in a counterclockwise direction.

NOTE: Exact adjustment will vary according to bean roast or added flavoring.

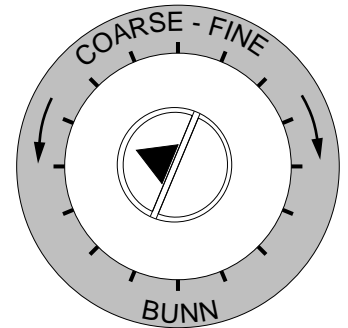

P1073

### Timer Adjustment

1. Unplug the grinder and remove the rear cover.
2. Set each timer to 5 seconds for each ounce of ground coffee desired.
3. Verify the setting by weighing a few samples.

**Use this 5 second per ounce figure as an APPROXIMATE guide only.**

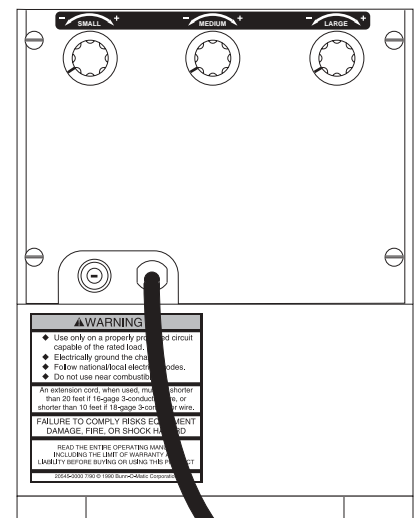

P2946

WIRING SCHEMATICS

**SCHEMATIC WIRING DIAGRAM  
FPG**

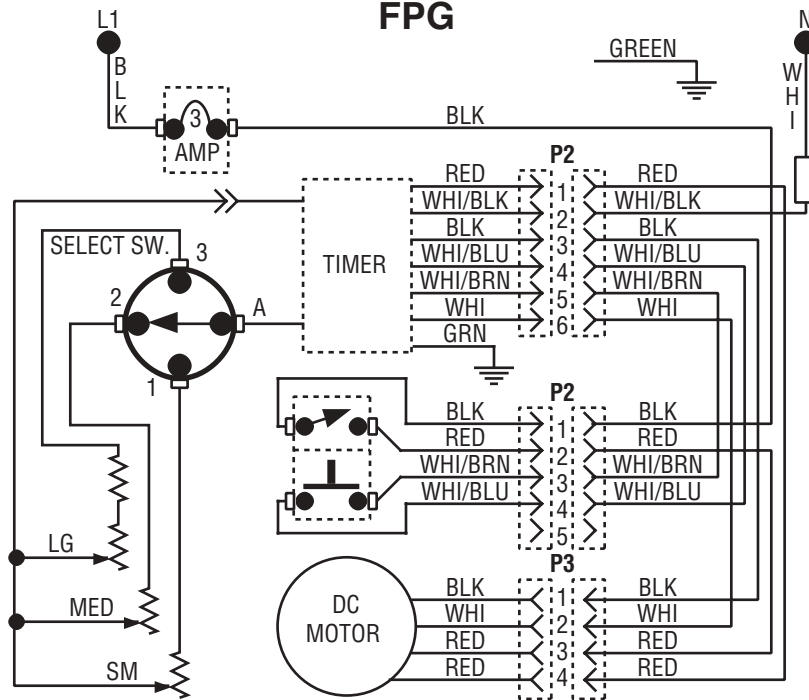

**120 VOLTS AC  
2 WIRE  
SINGLE PHASE  
60 HZ**

# SCHEMATIC WIRING DIAGRAM FPGA

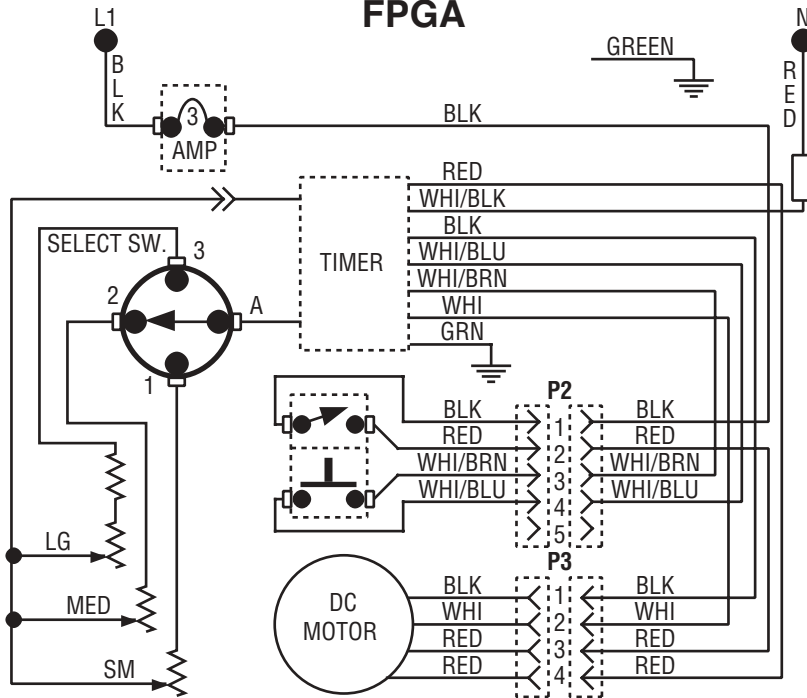

**230 VOLTS AC  
 2 WIRE  
 SINGLE PHASE  
 50/60 HZ**