

BRAUN

4745
4735



TriControl

www.braun.com/register

Type 5715
Type 5714

5-714-453/01/IX-03/G2
GB
Printed in Germany



Braun Infoline

GB

Helpline

Should you require any further assistance please call Braun (UK) Consumer Relations on 0800 783 70 10

IRL

Helpline

1 800 509 448

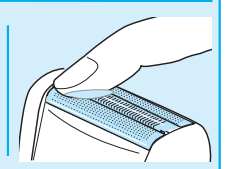
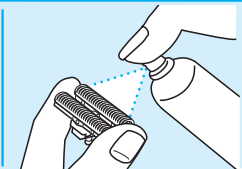
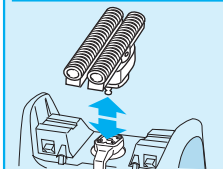
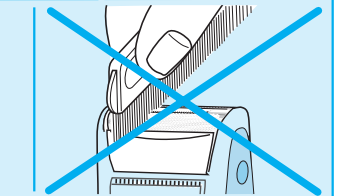
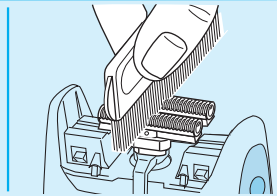
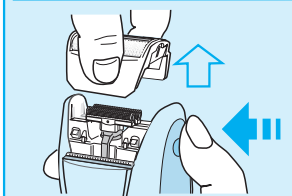
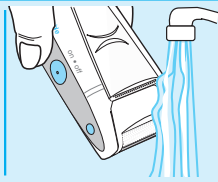
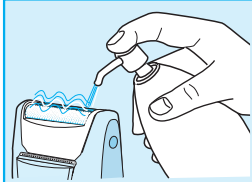
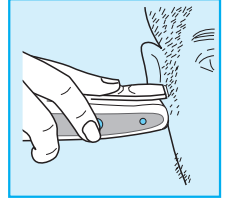
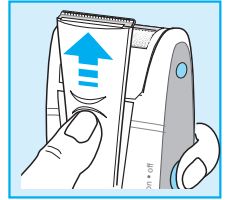
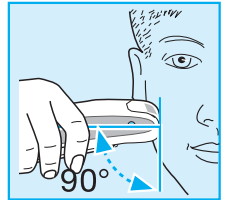
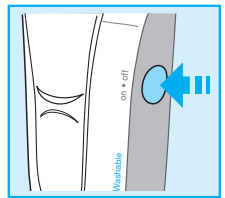
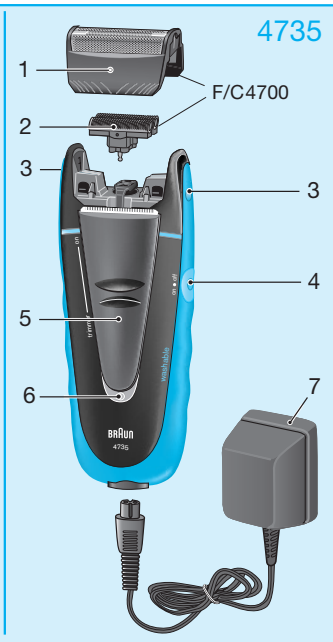

English

Our products are designed to meet the highest standards of quality, functionality and design. We hope you enjoy your new Braun shaver.

Warning

Your shaver is provided with a special cord set with integrated Safety Extra Low Voltage power supply. Do not exchange or manipulate any part of it. Otherwise there is risk of electric shock.

Description

- 1 Shaver foil
- 2 Cutter block
- 3 Release button
- 4 On/off switch
- 5 Long hair trimmer
- 6 Charging light
- 7 Special cord set

Charging

The best environmental temperature for charging is between 15°C and 35°C.

- Using the special cord set, connect the shaver to an electrical outlet with the motor switched off.
- When charging for the first time, leave the shaver to charge continuously for at least 8 hours.
- As soon as you start charging the shaver, the charging light (6) comes on.
- Once the shaver is completely charged, discharge the shaver through normal use. Then recharge to full capacity.
- A full charge will give up to 30 minutes of cordless shaving time depending on your beard growth. However, the maximum battery capacity will only be reached after several charging/discharging cycles.
- 4745 model only: If the rechargeable batteries are discharged, you can shave without charging by connecting the shaver to an electrical outlet via the special cord set.

Shaving

Press the on/off switch (4) to turn the shaver on.

Trimmer: When the long hair trimmer is activated, it allows the controlled trimming of moustache or sideburns.

Tips for the perfect shave

- We recommend that you shave before washing, as the skin tends to be slightly swollen after washing.
- Hold the shaver at right angles (90°) to the skin. Stretch the skin and shave against the direction of beard growth.
- To maintain 100% shaving performance, replace your foil and cutter block every 18 months or when worn.

Cleaning

Always unplug the appliance before cleaning.

Regular cleaning ensures better shaving performance. Rinsing the shaving head after each shave under hot running water is an easy and fast way to keep it clean:

- Switch the shaver on and rinse the shaving head under hot running water. A natural based soap may also be used provided it contains no particles or abrasive substances. Rinse off all foam and let the shaver run for a few more seconds.
- Next switch the shaver off and press the release buttons. Lift the shaver foil off and pull the cutter block out. Then leave the disassembled shaving parts to dry.

Alternatively, you may clean the shaver using the brush provided.

- Switch the shaver off. Press the release buttons and lift shaver foil off.
- Using the brush, clean the cutter block and the inner area of the shaver head. However, do not clean the shaver foil with the brush as this may damage the foil.

Keeping your shaver in top shape

About every four weeks, clean the cutter block with Braun cleaning agents. Put a drop of light machine oil onto the long hair trimmer and the shaver foil.

Preserving the batteries

In order to maintain the optimum capacity of the rechargeable batteries, the shaver has to be fully discharged (by shaving) every 6 months approximately. Then recharge the shaver to full capacity. Do not expose the shaver to temperatures higher than 50°C for extended periods of time.

Replacing the shaving parts

To maintain 100% shaving performance, replace your foil and cutter block every 18 months or when worn. Change both parts at the same time for a closer shave with less skin irritation.

(Shaver foil and cutter block: part no. 4700).

Environmental notice

This appliance is provided with nickel-cadmium rechargeable batteries. To protect the environment, do not dispose of this appliance in the household waste at the end of its useful life. Disposal can take place at a Braun Service Centre or appropriate collection sites.

However, if you prefer to dispose of the appliance yourself, remove the batteries as shown on page 6.

Subject to change without notice.

This product conforms to the EMC-Directive 89/336/EEC and to the Low Voltage Regulation (73/23 EEC).



Electric specifications see printing on the special cord set.

Guarantee

We grant 2 years guarantee on the product commencing on the date of purchase. Within the guarantee period we will eliminate, free of charge, any defects in the appliance resulting from faults in materials or workmanship, either by repairing or replacing the complete appliance as we may choose.

This guarantee extends to every country where this appliance is supplied by Braun or its appointed distributor.

This guarantee does not cover: damage due to improper use, normal wear or use as well as defects that have a negligible effect on the value or operation of the appliance. The guarantee becomes void if repairs are undertaken by unauthorised persons and if original Braun parts are not used.

To obtain service within the guarantee period, hand in or send the complete appliance with your sales receipt to an authorised Braun Customer Service Centre.

For UK only:

This guarantee in no way affects your rights under statutory law.

English

Battery removal at the end of the product's useful life

Open the handle as shown, remove the battery and dispose of it according to local environmental regulations.

Caution: Opening the handle will destroy the appliance and invalidate the guarantee.

