

Warming Drawer
MODEL WWD30

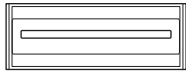

Model WWD30
L Series Drawer Front

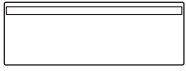

Model WWD30
E Series Drawer Front
(unframed shown)



Model WWD30
Integrated Drawer Front

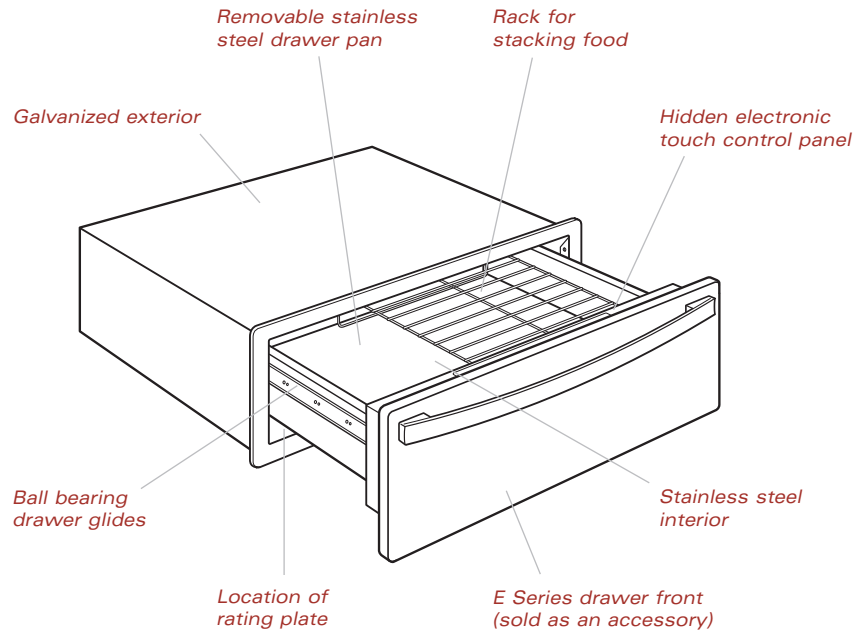

Model WWD30 with E Series stainless steel drawer front shown.

► The Wolf Model WWD30, 30" (762) warming drawer is sold as a base unit only, a drawer front accessory is required. 30" (762) stainless steel drawer front panels are available to match L Series and E Series built-in ovens. The integrated drawer front allows for a custom wood panel and handle hardware.



This appliance is certified by Star-K to meet strict religious regulations in conjunction with specific instructions found on www.star-k.org.

Warming drawers have a clear mission in life—to take good care of good food until it’s time for you to eat. Our superior air control helps keep moist foods moist and crisp foods crisp. In addition, The Wolf warming drawer is one of the most spacious on the market, so you will have little problem storing items.

There is a rack for stacking food plus an optional set of six stainless steel containers with lids that divide the drawer into sections, keeping different dishes warm at the same time.

From a design perspective, you have several choices for the drawer front. Electronic controls are hidden regardless of your panel selection. Stainless steel drawer fronts are available to match the look of the Wolf L Series and E Series built-in ovens. For the L Series drawer front, choose from the classic stainless steel look or the premium finishes of platinum or carbon stainless steel. E Series drawer fronts come in the classic stainless steel finish and framed and unframed door styles.

Also available is the integrated drawer front, which allows for a custom wood panel. Wolf offers optional decorative handles for the integrated drawer front.

Warming Drawer
MODEL WWD30

FEATURES

- ▶ L Series stainless steel drawer front with handle available in classic, platinum and carbon finishes
- ▶ E Series stainless steel drawer front with handle available in classic finish
- ▶ Integrated drawer front allows for custom wood panel application
- ▶ 850-watt heating element
- ▶ Hidden electronic touch control panel
- ▶ Preset and variable temperature control
- ▶ Preset automatic shut-off or extended operation in Sabbath Mode
- ▶ Stainless steel interior
- ▶ Rack for stacking food
- ▶ Removable stainless steel drawer pan
- ▶ Full-extension, ball bearing drawer glides
- ▶ CSA certified for US and Canada
- ▶ CSA approved for outdoor installations
- ▶ Two and five year residential warranty—exclusions apply; warranty information can be found on our website, wolfappliance.com

OVERALL DIMENSIONS ▼

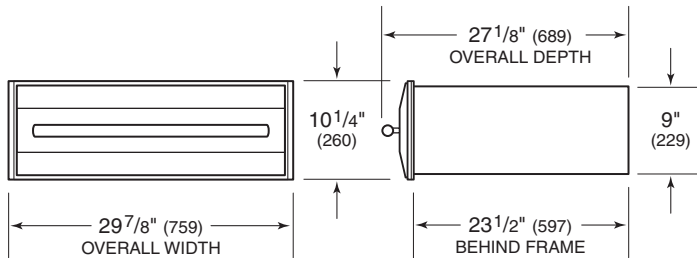

Model WWD30 with L Series stainless steel drawer front.

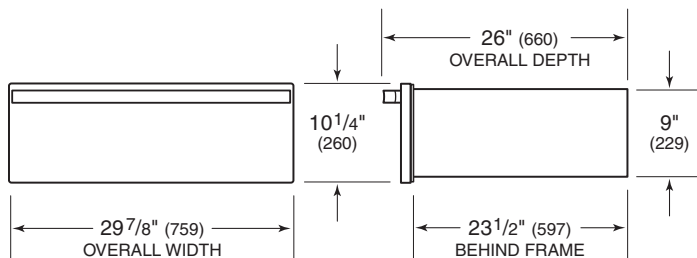

Model WWD30 with E Series stainless steel drawer front.

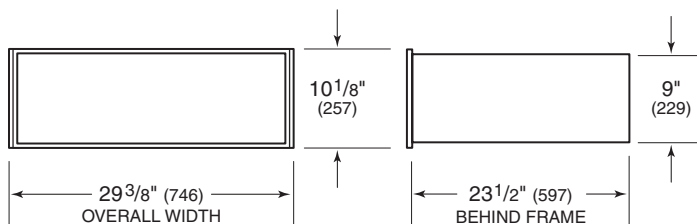

Model WWD30 with integrated drawer front.

Unit dimensions may vary by $\pm 1/8$ " (3).

Dimensions in parentheses are in millimeters unless otherwise specified.

Warming Drawer

MODEL WWD30

FRONT PANEL OPTIONS ▼

30" (762) L Series Drawer Front —

Classic Stainless	WWDFRONT/S
Platinum Stainless	WWDFRONT/P
Carbon Stainless	WWDFRONT/B

30" (762) E Series Drawer Front —

Framed / Classic	WWDFRONT-2F/S
Unframed / Classic	WWDFRONT-2U/S

Integrated Drawer Front —

Accepts Wood Panel	WWDFRONT/I
--------------------	------------

Model WWD30 is sold as a base unit only. A drawer front panel is required. Panels are available as sales accessories through your Wolf dealer. Stainless steel drawer front panels include a handle to match L Series or E Series built-in ovens.

ACCESSORIES

- ▶ Tubular handle for integrated drawer front in classic, platinum or carbon stainless steel
- ▶ Classic stainless steel handle for integrated drawer front to match E Series ovens
- ▶ Six-piece container set—includes six stainless steel pans with lids: one 6.7-quart pan, one 4.1-quart pan, two 3-quart pans, two 1.8-quart pans and pan rack

Accessories are available through your Wolf dealer. To obtain local dealer information, visit the Showroom Locator section of our website, wolfappliance.com.

SPECIFICATIONS ▼

Model WWD30 with L Series Drawer Front	
Overall Width	29 ⁷ / ₈ " (759)
Overall Height	10 ¹ / ₄ " (260)
Overall Depth (including handle)	27 ¹ / ₈ " (689)
Model WWD30 with E Series Drawer Front	
Overall Width	29 ⁷ / ₈ " (759)
Overall Height	10 ¹ / ₄ " (260)
Overall Depth (including handle)	26" (660)
Model WWD30 with Integrated Drawer Front	
Overall Width	29 ³ / ₈ " (746)
Overall Height	10 ¹ / ₈ " (257)
Overall Depth (behind frame)	23 ¹ / ₂ " (597)
Integrated Panel Dimensions (minimum)	
Overlay	30" (762) W x 10 ³ / ₈ " (264) H
Inset	29 ³ / ₈ " (746) W x 10 ¹ / ₈ " (257) H
Integrated Panel Thickness (minimum)	⁵ / ₈ " (16)
Integrated Panel Weight (maximum)	25 lbs (11 kg)
Heating Element	850 W
Electrical Supply Requirements	120 V AC, 60 Hz 15 or 20 amp circuit
Power Cord	3 ft (.9 m) power cord with grounded plug
Minimum Base Support	200 lbs (91 kg)
Shipping Weight	100 lbs (45 kg)
Special Note	Specifications vary for stainless steel and integrated drawer front applications

Specifications are subject to change without notice.

Unit dimensions may vary by ± 1/8" (3).

Dimensions in parentheses are in millimeters unless otherwise specified.

Warming Drawer
MODEL WWD30

INSTALLATION WITH L SERIES DRAWER FRONT

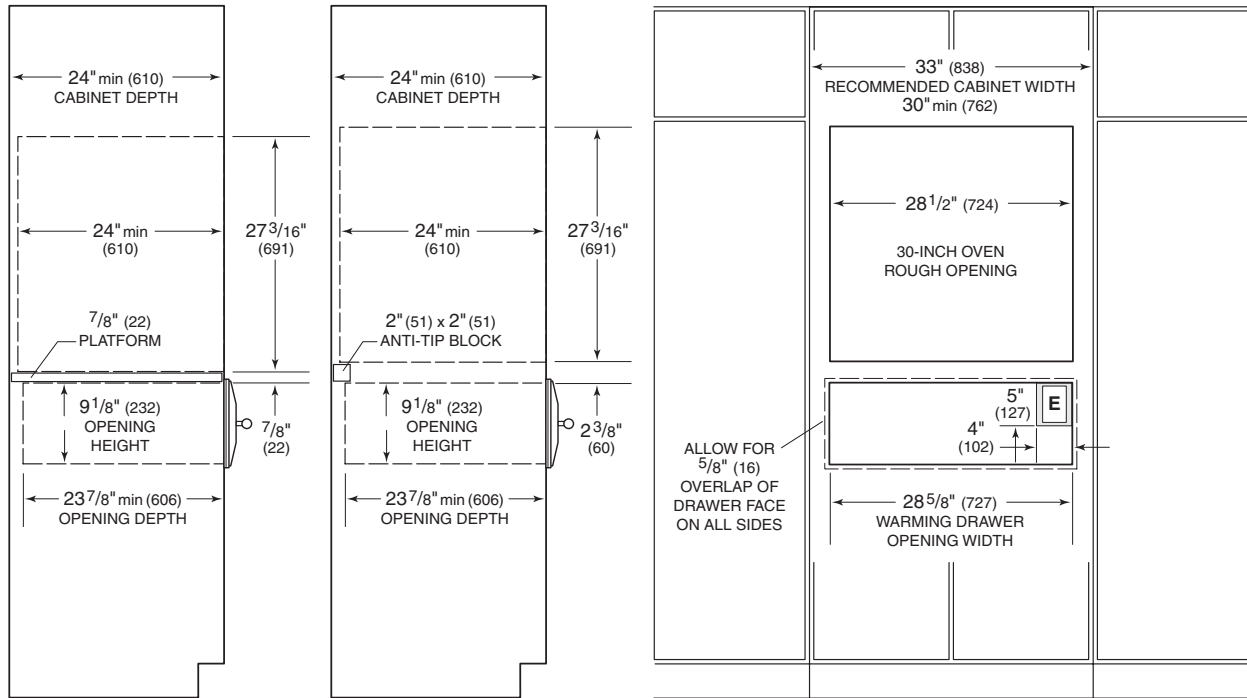

PLATFORM APPLICATION

ANTI-TIP BLOCK APPLICATION

NOTE: Refer to the 30" (762) L Series built-in oven specifications for electrical location.

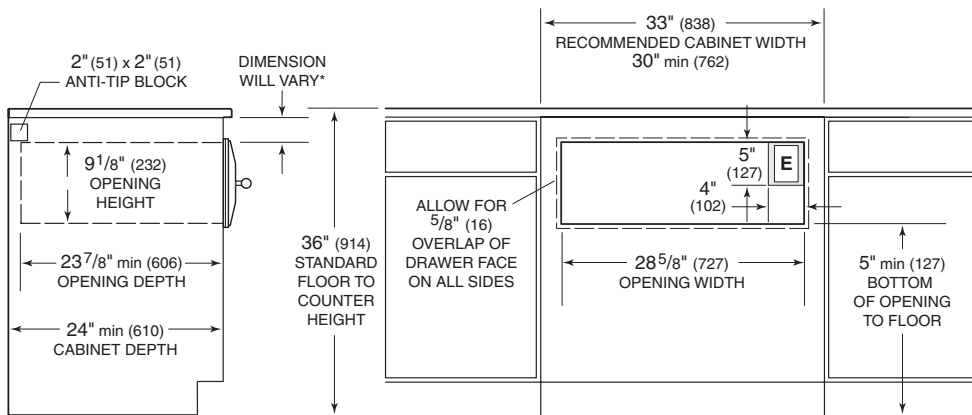

*Allow enough room for placement of anti-tip block and drawer face overlap.

DIMENSIONS

Recommended Cabinet Width	33" (838)
Minimum Cabinet Width	30" (762)
Rough Opening Width	28 ⁵ / ₈ " (727)
Rough Opening Height	9 ¹ / ₈ " (232)
Rough Opening Depth (minimum)	23 ⁷ / ₈ " (606)

See Installation Instructions shipped with drawer front for detailed specifications.

Dimensions in parentheses are in millimeters unless otherwise specified.

Warming Drawer
MODEL WWD30

INSTALLATION WITH E SERIES DRAWER FRONT

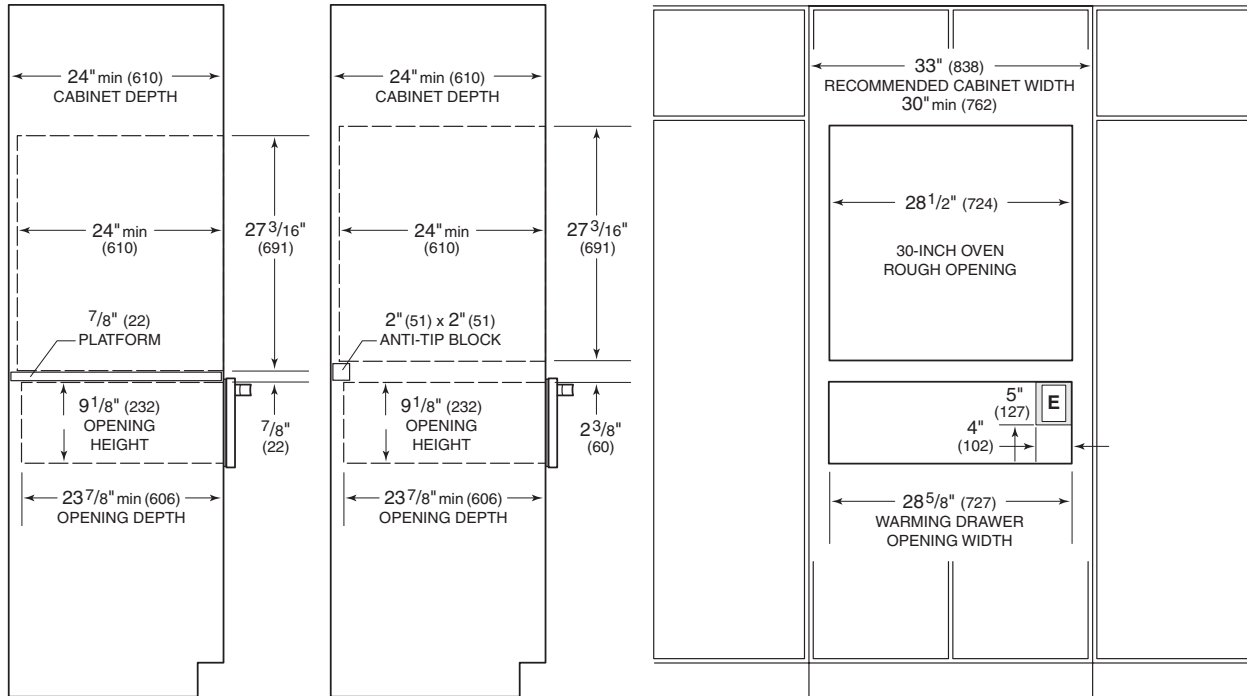

PLATFORM APPLICATION

ANTI-TIP BLOCK APPLICATION

NOTE: Refer to the 30" (762) E Series built-in oven specifications for electrical location

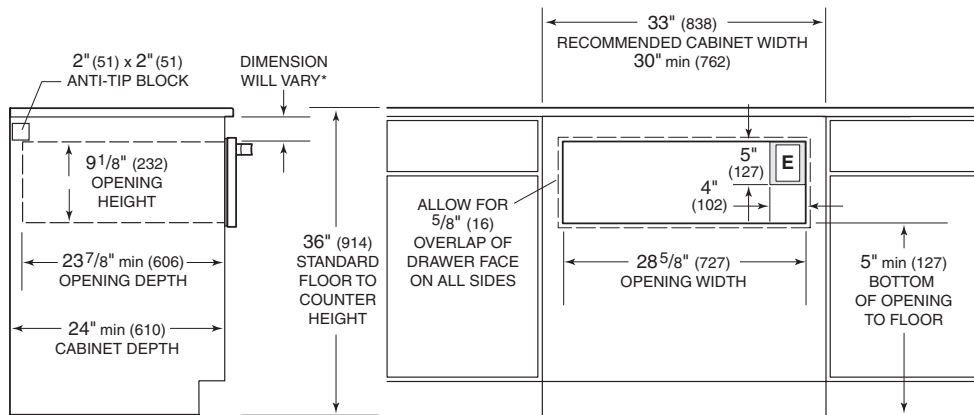

*Allow enough room for placement of anti-tip block and drawer face overlap.

DIMENSIONS

Recommended Cabinet Width	33" (838)
Minimum Cabinet Width	30" (762)
Rough Opening Width	28 ⁵ / ₈ " (727)
Rough Opening Height	9 ¹ / ₈ " (232)
Rough Opening Depth (minimum)	23 ⁷ / ₈ " (606)

See Installation Instructions shipped with drawer front for detailed specifications.

Dimensions in parentheses are in millimeters unless otherwise specified.

Warming Drawer
MODEL WWD30

INSTALLATION WITH INTEGRATED DRAWER FRONT

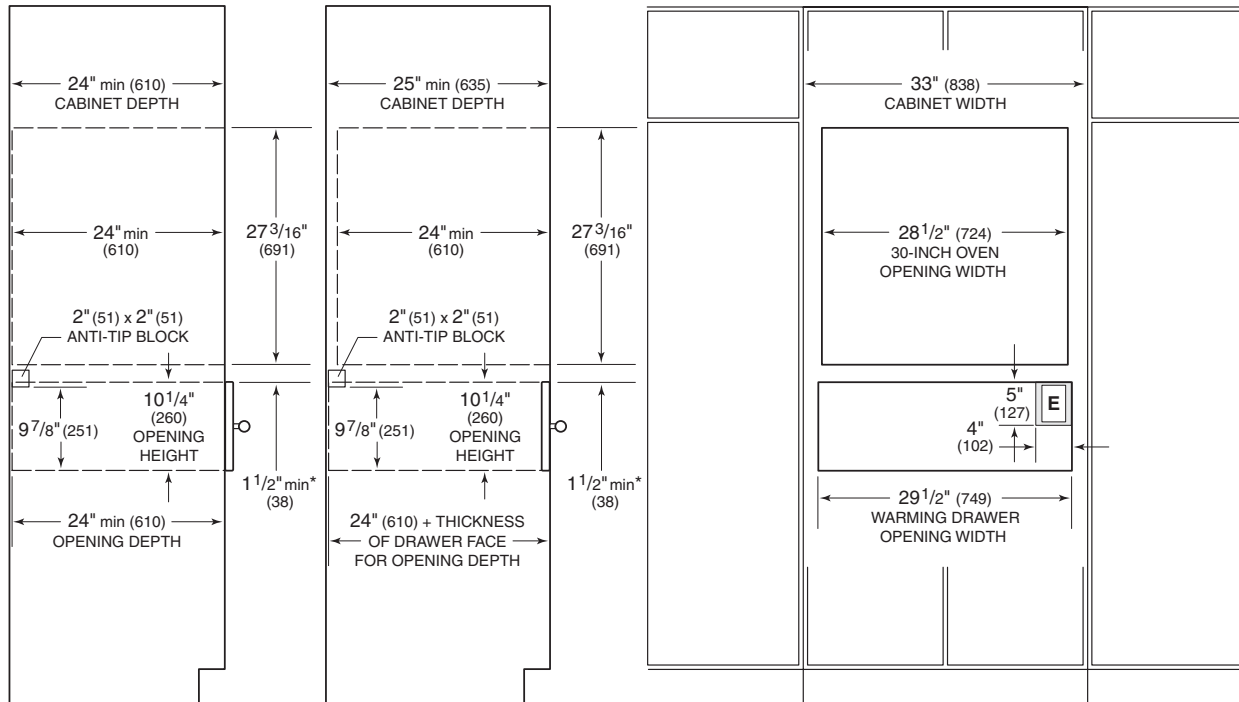

OVERLAY APPLICATION

FLUSH INSET APPLICATION

NOTE: Refer to the built-in 30" (762) single oven specifications for electrical location.

*Dimension may increase depending on the size of the drawer front panel.

Model WWD30 with integrated drawer front installed with 30" (762) L Series or E Series single built-in oven.

DIMENSIONS

Minimum Cabinet Width	33" (838)
Minimum Cabinet Depth—Overlay	24" (610)
Minimum Cabinet Depth—Flush Inset	25" (635)
Rough Opening Width	29 1/2" (749)
Rough Opening Height	10 1/4" (260)
Rough Opening Depth (for flush inset, add thickness of drawer face)	24" (610)

See Installation Instructions shipped with drawer front for detailed specifications.

Dimensions in parentheses are in millimeters unless otherwise specified.

Warming Drawer
MODEL WWD30

INSTALLATION WITH INTEGRATED DRAWER FRONT

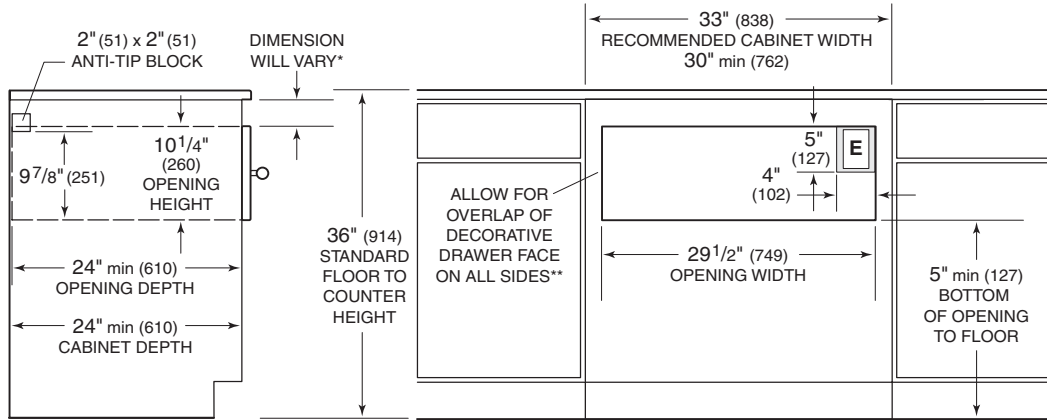

*Allow enough room for placement of anti-tip block and drawer face overlap.
**Overlap of decorative drawer face will vary depending on the size of the custom panel.

Overlay Application

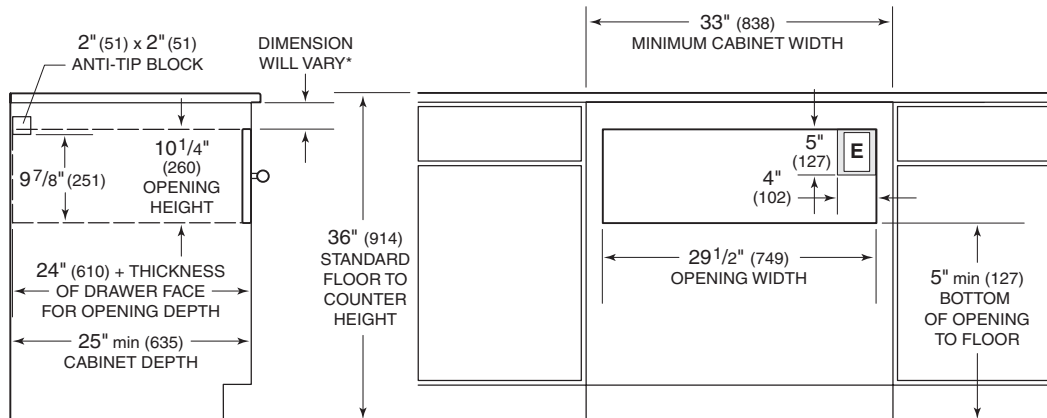

*Allow enough room for placement of anti-tip block.

Flush Inset Application

DIMENSIONS

Minimum Cabinet Width	33" (838)
Minimum Cabinet Depth—Overlay	24" (610)
Minimum Cabinet Depth—Flush Inset	25" (635)
Rough Opening Width	29 1/2" (749)
Rough Opening Height	10 1/4" (260)
Rough Opening Depth (for flush inset, add thickness of drawer face)	24" (610)

See Installation Instructions shipped with drawer front for detailed specifications.

Dimensions in parentheses are in millimeters unless otherwise specified.

Warming Drawer

MODEL WWD30

INSTALLATION NOTES

▶ Refer to the illustrations and specifications for overall dimensions, finished rough opening dimensions and installation specifics.

▶ Model WWD30 is shipped without any decorative drawer front. It must be installed with one of the accessory drawer fronts. Refer to the installation instructions provided with the warming drawer front for detailed specifications. These instructions can also be found on the Wolf website at wolfappliance.com.

▶ Wolf recommends using a 33" (838) wide cabinet for the warming drawer with stainless steel drawer front. A minimum 30" (762) wide by 24" (610) deep cabinet is required. A minimum 33" (838) wide cabinet is required for the warming drawer with integrated drawer front.

▶ The warming drawer with integrated drawer front can be used in an overlay application, or an inset panel application where it will be completely recessed into the cabinet. Keep in mind that the size of the custom panel for the warming drawer with integrated drawer front will vary according to the specific installation.

IMPORTANT NOTE: The inset panel application for the integrated drawer front requires the warming drawer to be recessed into the cabinet. A minimum 25" (635) deep cabinet is needed if you want the front panel to be flush with surrounding cabinetry.

▶ The warming drawer platform must be able to support 200 lbs (91 kg). It must be a minimum of 1" (25) above the toe kick to allow for the overlap of the warming drawer trim.

IMPORTANT NOTE: A platform or anti-tip block must be installed to prevent the unit from tipping forward when the drawer is opened.

▶ For undercounter installations, 23¹/₂" (597) from the bottom of the warming drawer opening to the floor is recommended.

▶ Model WWD30 requires a separate, grounded 120 V AC, 60 Hz power supply. The service should have its own 15 or 20 amp circuit breaker and a grounded 3-prong receptacle should be located within the reach of the 3' (.9 m) power cord. Locate electrical within the shaded area shown in the illustrations on pages 4–7.

▶ The Wolf warming drawer may be installed below an induction, electric or gas cooktop, provided the warming drawer is fully enclosed, top and bottom. Refer to the cooktop sections of our website, wolfappliance.com.

▶ The Wolf warming drawer may be installed above or below a built-in single oven or below a double oven, provided the warming drawer is fully enclosed, top and bottom. Model WWD30 is designed and agency approved for installation with Wolf built-in ovens. Refer to the built-in oven sections of our website, wolfappliance.com.

▶ When the warming drawer is installed below a built-in oven, a minimum of 2³/₈" (60) between warming drawer and oven openings—1¹/₂" (38) for integrated drawer front—is required for placement of the anti-tip block. To allow the warming drawer trim and the built-in oven trim to meet, a 7/₈" (22) platform may be used to separate the two openings. This will act as the support platform for the oven and the anti-tip device for the warming drawer.

IMPORTANT NOTE: Additional clearance between warming drawer and oven openings may be required. Check that oven supports do not obstruct the interior dimensions required for the warming drawer.

IMPORTANT NOTE: When the warming drawer is installed above a built-in oven, a 7/₈" (22) platform is required to allow for clearance of overlaps.

IMPORTANT NOTE: In an overlay application for the integrated drawer front, the amount of space between warming drawer and oven openings may need to be increased depending on the size of the overlay panel and the amount of overlap.

▶ The warming drawer with stainless steel drawer front may be installed next to or above another Wolf warming drawer.

▶ The Wolf warming drawer is designed and safe for use in outdoor applications. When installed outdoors, a ground fault circuit interrupter (GFCI) is required to reduce the risk of electrical shock. All other aspects of the installation are identical for indoor and outdoor use.

▶ You must follow all National Electrical Code regulations. In addition, be aware of local codes and ordinances when installing your service.

▶ The Wolf warming drawer may be installed in combination with a built-in single oven and microwave oven with trim. Be sure that the drawer front matches the series of oven and microwave trim you are using in your design. Refer to pages 9–11 for specifications.

▶ Refer to the installation instructions shipped with each Wolf product for detailed specifications.

Warming Drawer
MODEL WWD30

COMBINATION INSTALLATION

The Wolf warming drawer with L Series stainless steel drawer front may be installed in combination with a 30" (762) L Series single oven and convection microwave oven with 30" (762) L Series trim. Refer to the illustration below for specifications.

Wolf recommends using a 33" (838) wide cabinet for this installation. Also, you need a minimum 24" (610) of usable cabinet depth for the oven.

IMPORTANT NOTE: Unless you are using cabinets deeper than 24" (610), it is recommended that the electrical supply for the built-in oven be placed in an adjacent cabinet within reach of the conduit.

The base platform for the warming drawer must be able to support 200 lbs (91 kg), the platform for the oven must be able to support 250 lbs (113 kg) and the microwave platform must be able to support 125 lbs (57 kg).

An anti-tip block or platform must be installed to prevent the warming drawer from tipping forward when the drawer is opened. The warming drawer must be fully enclosed, top and bottom.

For electrical requirements and additional specifications, refer to the built-in ovens and microwave sections of our website, wolfappliance.com. Also refer to the installation instructions provided with the warming drawer front and microwave trim kit for detailed specifications.

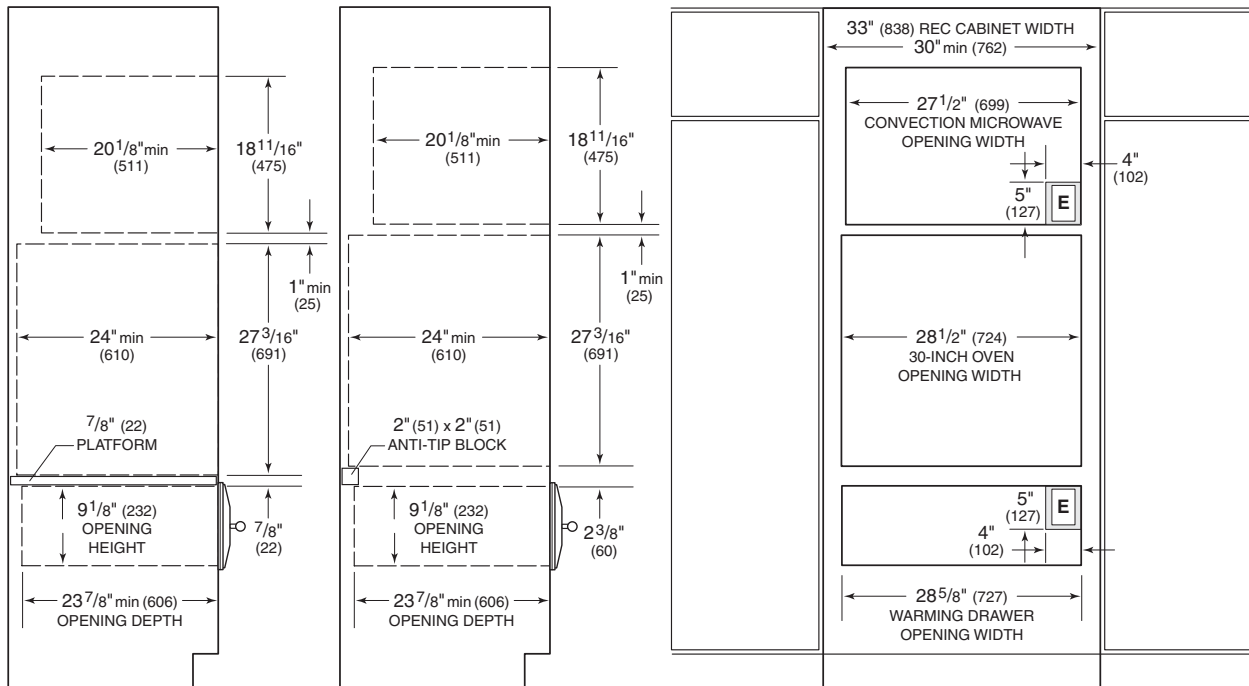

PLATFORM APPLICATION

ANTI-TIP BLOCK APPLICATION

NOTE: Refer to the 30" (762) built-in single oven specifications for electrical location.

Specifications for a warming drawer with L Series stainless steel drawer front installed with a 30" (762) L Series single oven and convection microwave with 30" (762) L Series trim.

Dimensions in parentheses are in millimeters unless otherwise specified.

Warming Drawer
MODEL WWD30

COMBINATION INSTALLATION

The Wolf warming drawer with E Series stainless steel drawer front may be installed in combination with a 30" (762) E Series single oven and convection microwave oven with 30" (762) E Series trim. Refer to the illustration below for specifications.

Wolf recommends using a 33" (838) wide cabinet for this installation. Also, you need a minimum 24" (610) of usable cabinet depth for the oven.

IMPORTANT NOTE: Unless you are using cabinets deeper than 24" (610), it is recommended that the electrical supply for the built-in oven be placed in an adjacent cabinet within reach of the conduit.

The base platform for the warming drawer must be able to support 200 lbs (91 kg), the platform for the oven must be able to support 250 lbs (113 kg) and the microwave platform must be able to support 125 lbs (57 kg).

An anti-tip block or platform must be installed to prevent the warming drawer from tipping forward when the drawer is opened. The warming drawer must be fully enclosed, top and bottom.

For electrical requirements and additional specifications, refer to the built-in ovens and microwave sections of our website, wolfappliance.com. Also refer to the installation instructions provided with the warming drawer front and microwave trim kit for detailed specifications.

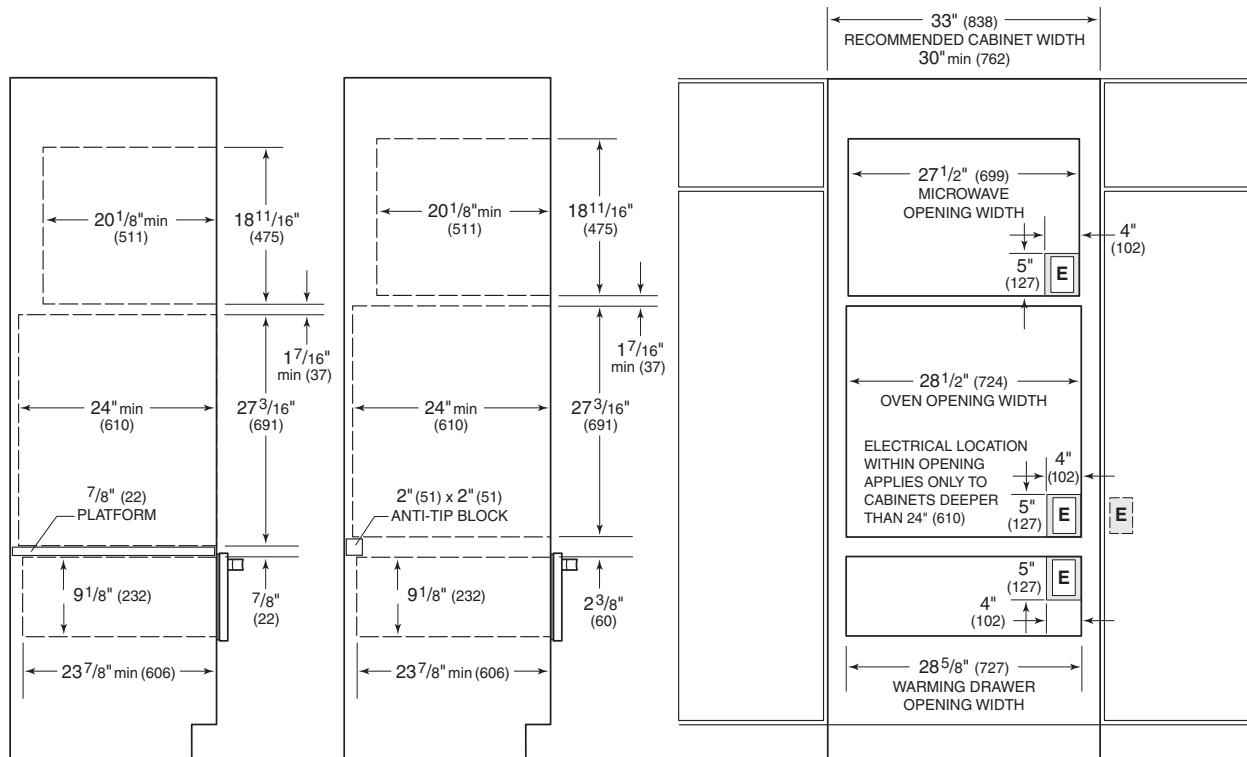

PLATFORM APPLICATION

ANTI-TIP BLOCK APPLICATION

NOTE: Unless you are using cabinets deeper than 24" (610), it is recommended that the electrical supply for the oven be placed in an adjacent cabinet within reach of the conduit.

Specifications for a warming drawer with E Series stainless steel drawer front installed with a 30" (762) E Series single oven and convection microwave with 30" (762) E Series trim.

Dimensions in parentheses are in millimeters unless otherwise specified.

Warming Drawer
MODEL WWD30

COMBINATION INSTALLATION

The Wolf warming drawer with integrated drawer front may be installed in combination with a 36" (914) L Series single oven and convection microwave oven with 36" (914) L Series trim. Refer to the illustration below for specifications.

IMPORTANT NOTE: Keep in mind that the width of the custom panel for the warming drawer with integrated drawer front will vary according to the specific installation.

Wolf recommends using a 39" (991) wide cabinet for this installation. Also, you need a minimum 24" (610) of usable cabinet depth for the oven.

IMPORTANT NOTE: Unless you are using cabinets deeper than 24" (610), it is recommended that the electrical supply for the built-in oven be placed in an adjacent cabinet within reach of the conduit.

The base platform for the warming drawer must be able to support 200 lbs (91 kg), the platform for the oven must be able to support 250 lbs (113 kg) and the microwave platform must be able to support 125 lbs (57 kg).

An anti-tip block or platform must be installed to prevent the warming drawer from tipping forward when the drawer is opened. The warming drawer must be fully enclosed, top and bottom.

For electrical requirements and additional specifications, refer to the built-in ovens and microwave sections of our website, wolfappliance.com. Also refer to the installation instructions provided with the warming drawer front and microwave trim kit for detailed specifications.

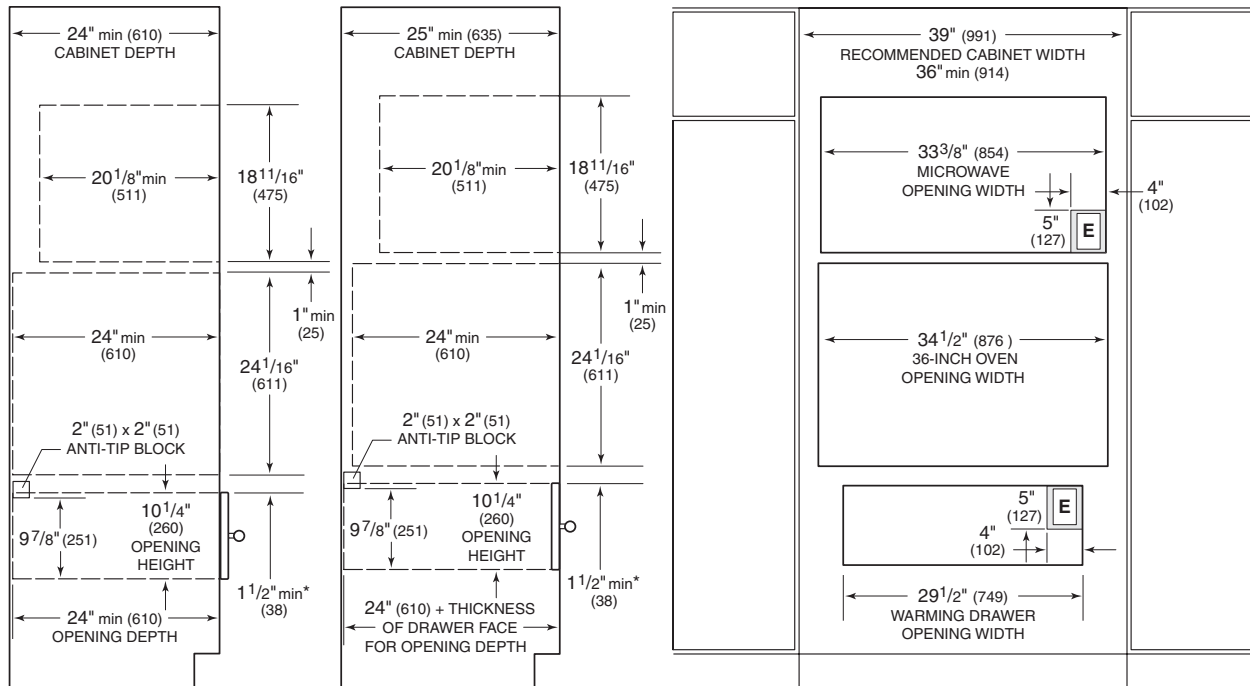

OVERLAY APPLICATION

FLUSH INSET APPLICATION

NOTE: Refer to the 36" (914) built-in single oven specifications for electrical location.

*Dimension may increase depending on the size of the drawer front panel.

The width of the custom panel for the warming drawer with integrated drawer front will vary according to the specific installation, but the rough opening width will remain 29 1/2" (749).

Specifications for a warming drawer with integrated drawer front installed with a 36" (914) L Series single oven and convection microwave with 36" (914) L Series trim.

Dimensions in parentheses are in millimeters unless otherwise specified.