

**KingCraft®**

# INSTRUCTION MANUAL

## Electric Staple Gun

Item# 6525

Model # A688



**PLEASE READ AND SAVE THESE INSTRUCTIONS TO ENSURE THE SAFE AND EFFECTIVE USE OF THIS TOOL**

## TABLE OF CONTENTS

Index	P. 2
Important Safeguards	P. 3
General Safety Rules	P.3, 4
List of Main Parts	P.5
Tech. Specifications, Contents of Packing	P.5
Operation	P.6
Determining Proper Staple or Nail Length	P.7
Maintenance	P.7
Trouble Shooting	P.8
Warranty Information	P.9
Warranty Card	P.11



## IMPORTANT SAFEGUARDS

1. Staple Gun must not be loaded with staples and nails at the same time.
2. Do not lubricate. The Staple Gun has been lubricated at the factory. Under normal use it will not need further lubrication
3. Do not hold the Staple Gun toward people, it could invite serious injuries.
4. Store Staple Gun a dry locked cabinet and keep it out of reach of children.

## SAVE ALL INSTRUCTIONS

### GENERAL SAFETY RULES



**WARNING!** Read and understand all instructions. Failure to follow all instructions listed below may result in electric shock, fire or serious personal injury. The warnings, cautions, and instruction discussed in this instruction manual cannot cover all possible conditions and situations that may occur. It must be understood by the operator that common sense and caution are a factor which cannot be built into this product, but must be supplied by the operator.

### WORK AREA

1. Keep your work area clean and well organized. Cluttered benches and dark areas invite accidents.
2. Do not operate power tools in explosive atmosphere, such as in the presence of flammable liquids, gases, or dust. Power tools create sparks which may ignite the dust or fumes.
3. Keep bystanders, children and visitors away while operating a power tool. Distractions can cause you to lose control.

### ELECTRICAL SAFETY

1. Double insulated tools are equipped with a polarized plug (one blade is wider than the other.) This Plug will fit in a polarized outlet only one way. If the plug dose not fit fully in the outlet, reverse the plug. If it still dose not fit, contact a qualified electrician to install a polarized outlet. Do no change the plug in any way.
2. Do not abuse the cord. Never use the cord to carry the tool. Keep cord away from heat, oil, sharp edges or moving parts. Replace damaged cords immediately. Damaged cords may create a risk of fire.
3. Avoid body contact with grounded surfaces such as pipes, radiators, ranges and refrigerators.
4. Don't expose Staple Gun to rain or wet conditions. Water entering a power tool will increase the risk of electric shock.
5. During normal operation, if anything happens, the power should be cut off at once and the tool should be checked and repaired

## PERSONAL SAFETY

1. Stay alert, watch what you are doing and use common sense when operating a power tool. Do not use tool while tired or under the influence of drugs, alcohol or medication. A moment of inattention while operating power tools may result in serious personal injury.
2. Dress properly. Do not wear loose clothing or jewelry. Contain long hair. Keep your hair, clothing and gloves away from moving parts. It is recommended to wear protective goggles, gloves, sturdy non-slipping shoes and an apron while operating the machine.
3. Avoid accidental starting. Be sure switch is in LOCK position before connecting the unit to a power outlet. Carrying tools with your finger on the switch invites accidents.
4. Remove adjusting wrench before turning the tool on. A wrench or a key that is left attached to a rotating part of the tool may result in personal injury.
5. Do not overreach. Keep proper footing and balance at all times. Proper footing and balance enables better control of the tool in unexpected situations.
6. Use safety equipment. Always wear eye protection. Dust mask, non-skid safety shoes, hard hat, or hearing protection must be used for appropriate conditions.



## TOOL USE AND CARE

1. Use clamps or other practical way to secure and support the work piece to a stable platform. Holding the work by hand or against your body is unstable and may lead to loss of control.
2. Do not force tool. Use the correct tool for your application. The correct tool will do the job better and safer at the rate for which it is designed.
3. Do not use tool if switch does not turn ON or OFF. Any tool that cannot be controlled with a switch is dangerous and must be repaired.
4. Disconnect battery pack from tool or place the switch in locked or OFF position before making any adjustments, changing accessories or storing the tool. Such preventive safety measures reduce the risk of starting the tool accidentally.
5. Store idle tools out of reach of children and other untrained persons. Tools are dangerous in the hands of untrained users. They should be kept away from work area.
6. Check for misalignment or binding of moving parts, breakage of parts and any other condition that may affect the tools operation. If damaged, have the tool serviced before using. Many accidents are caused by poorly maintained tools.
7. Use only accessories that are recommended by the manufacturer for your model. Accessories that may be suitable for one tool may become hazardous when used on another tool.

## SERVICE

1. Tool service must be performed only by qualified repair personnel. Service or maintenance performed by unqualified personnel could result in a risk of injury.
2. When servicing a tool, use only identical replacement parts. Follow instructions in the maintenance section of this manual. Use of unauthorized parts or failure to follow Maintenance Instructions may create a risk of electric shock or injury.

**SAVE AND READ ALL INSTRUCTIONS!**

## LIST OF MAIN PARTS

- 1) Switch Pin
- 2) Trigger
- 3) Power Cord
- 4) Open/Lock Switch
- 5) Staple Feeder
- 6) Staple Channel

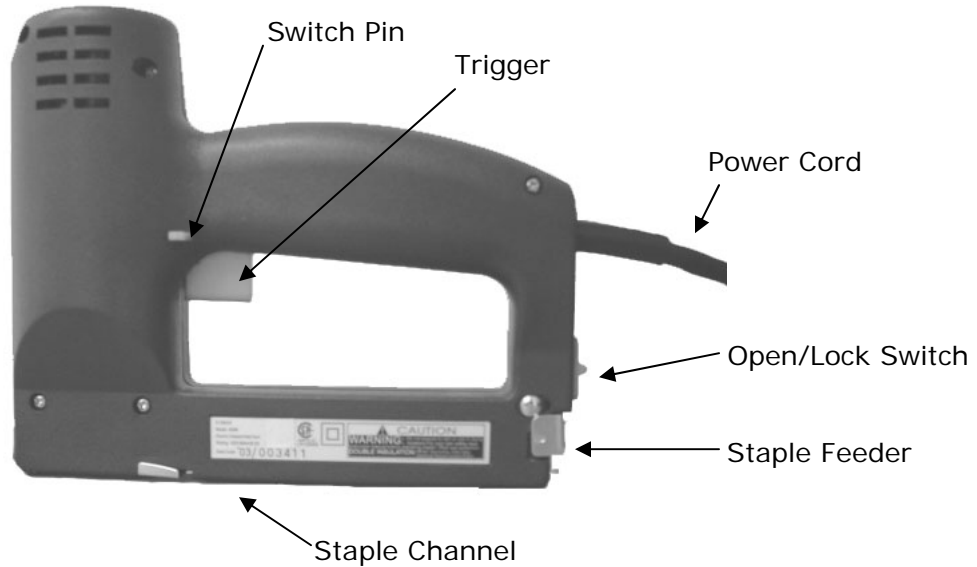

## TECHNICAL SPECIFICATIONS:

Model Number	A688
Rating Voltage	120Volts
Nominal power	6AMPS
Weight	2Lbs

## CONTENTS OF PACKAGING

- 1) Electric Staple Gun
- 2) 400 Staples (10mm)
- 3) 100 Nails (15mm)

If any of the above items are missing, please contact our service department at 1-888-367-7373 (<http://wwwk.wk-usa.com>) for replacement.

## OPERATION

For safety concerns, please follow Electric Staple Gun procedures below:

1. Connect the plug to a power outlet or extension cord.
2. Place the Staple Gun so that the bottom of the Staple Gun is lightly touching the work piece you have prepared to staple/nail.
3. Push the Switch Pin to the right.
4. Press the Trigger and the Staple Gun down simultaneously to ensure sufficient impact.

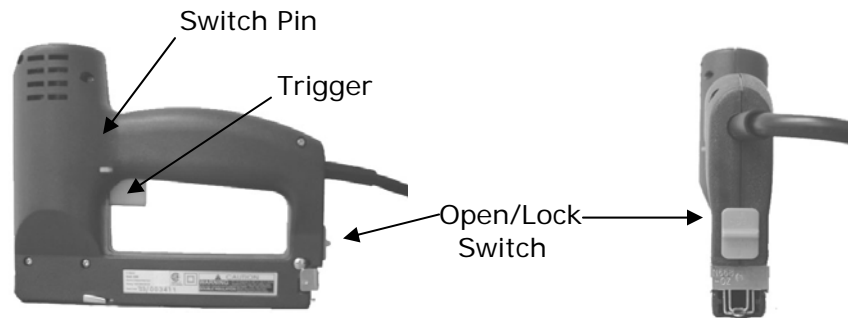

## STAPLE AND NAIL LOADING

1. First press sides of Staple Feeder down, then pull Staple Feeder away from Open/Lock Switch to pull out empty Staple Feeder (photo 1).
2. Pull the empty Staple Feeder all the way out of Staple Gun before loading staples/nails into Staple Channel (photo 2).
3. Load strip of staples into the Staple Channel (photo 3). Load nails into the side of the Staple Channel with the head of the nail facing up.
4. Slide Staple Feeder back into Staple Channel making sure that the Staple Feeder hook is pointed upward and the end bar is flat side up and open side down (photo 4).
5. Once Staple Feeder is placed into Staple Channel secure Staple Feeder by pressing downward and hooking Staple Feeder near Open/Lock Switch. This procedure will lock Staple Feeder into position.

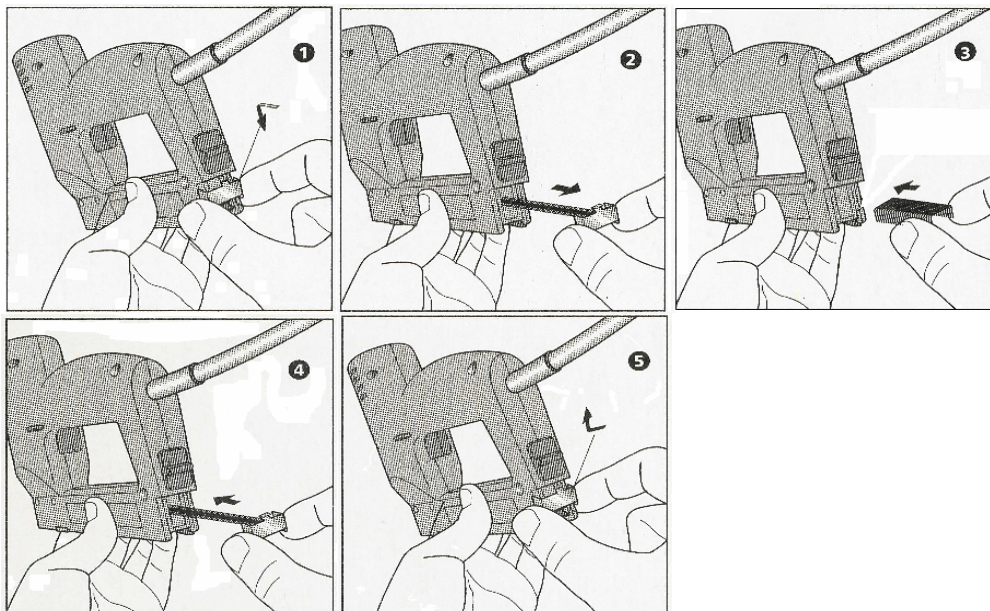

## DETERMINING PROPER STAPLE OR NAIL LENGTH

In choosing the proper staple or nail length for the job there are two basic things to consider:

1. Thickness of the material to be stapled
2. Hardness of the wood

As a general rule, in hardwood, approximate 3/16" to 1/4" penetration into the wood is sufficient and for soft wood up to approximately 3/8" should be sufficient. However, if the staple used "stands away" from the work - this means that the staple or nail is too long. In that case we recommend the next shorter length for desired results.

## BRANDS AND TYPES OF STAPLES AND NAILS AVAILABLE FOR THE STAPLE GUN

### Available Staples

- ARROW #T50

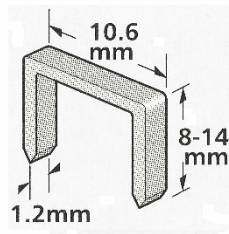

### Available Nails

- ARROW 5/8"
- STANLEY 5/8"

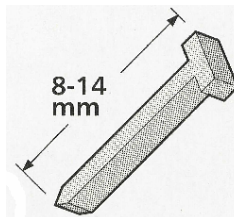

## MAINTENANCE

### **CAUTION:**

Always be sure that the tool is switched OFF.

### **CLEANING**

Clean dust and debris from the staple gun vents. Keep the staple gun clean, dry and free of oil and grease. Use only mild soap and a damp cloth to clean the staple gun. Certain cleaning agents and solvents are harmful to plastic and other insulated parts. Do not use gasoline, turpentine, lacquer thinner, paint thinner, chlorinated cleaning solvent, ammonia, or household cleaning detergents containing ammonia to clean staple gun.

## TROUBLE SHOOTING

### QUICK JAMMING RELEASE

- 1) Release Staple Feeder from Staple Channel (see OPERATION page 7).
- 2) Push Open/Lock Switch upward this will release Staple Channel (photo 6)
- 3) Open Staple Channel to remove jammed staples (photo 7).
- 4) Close Staple Channel and push down Open/Lock Switch. Lock will click ensuring that the lock switch is in locked position (photo 8).

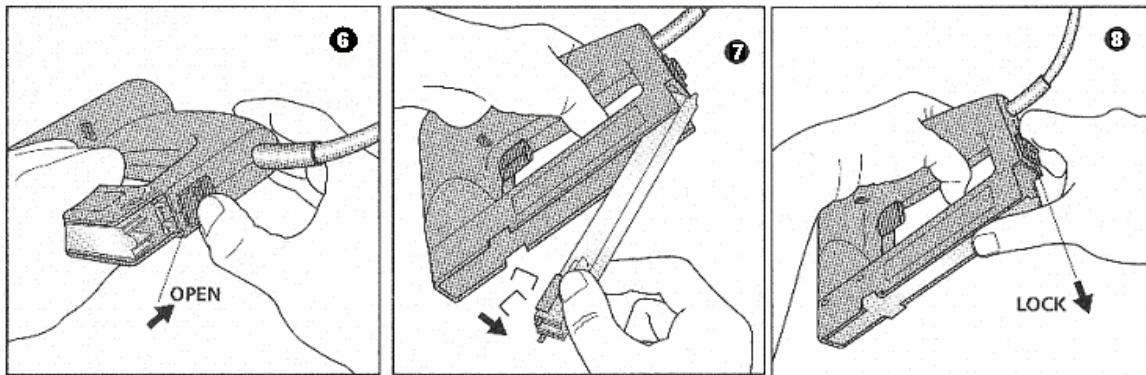

### ENVIRONMENTAL PROTECTION



If the tool should no longer work at all, please make sure that it is disposed in an environmentally friendly way, by handing it into a public collection point. Please do not put it with your household waste.



## LIMITED WARRANTY

Thank you for purchasing a top quality **KingCraft** product. This **Electric Staple Gun** item #65258 was tested and meets our stringent quality standards. This product is warranted to be free from manufacturing defects in original materials, including original parts, and workmanship until **March 13<sup>th</sup>. 2006 or 1 year with proof of purchase.**

The warranty is void if the defect is due to accidental damage, misuse, abuse, neglect, improper repair or alteration by unauthorized persons or failure to follow operation instructions provided with the product. This warranty does not apply to commercial use.

The warranty is non-transferable and applies only to the original purchase and does not extend to subsequent owners of the product. Liability under this warranty is limited to repair, replacement or refund. In no event shall liability exceed the purchase price paid by the purchaser of the product. Under no circumstances shall there be liability for any loss, direct, indirect, incidental, special or consequential damage arising out of in connection with use of this product. This warranty is valid only in the United States of America. This Warranty gives you specific legal rights. However you may have other rights that vary from state to state. Some states do not allow limitation on implied warranties or exclusion of consequential damages therefore these restrictions may not apply to you.

In case you find the product to be defective please send it within the warranty period to our service center. To avoid transport damages please send the product in the original packaging. In return you will either receive your repaired item, a new product or a refund. Please fill out the Warranty Card and send it together with the product and purchase receipt

To arrange pick-up of the defective item please call our service center:

**Wachsmuth & Krogmann Inc.**

**Tel: 1-888-367-7373 (Business hours Mon-Fri 9:00am-4:00 pm CT)**

**Website: <http://www.wk-usa.com>**

**123 Sivert Court,  
Bensenville, IL 60106,  
USA**

**WARRANTY INFORMATION**



# WARRANTY CARD

**Electric staple gun, item # 6525, model # A688**

In case you find this product to be defective please send it within the warranty period to our service center. To avoid transport damages please send the product in the original packaging. In return you will receive your repaired item, a new product or a refund.

This product is warranted to be free from manufacturing defects in original materials, including original parts, and workmanship until **March 13<sup>th</sup>. 2006 or 1 year with proof of purchase.**

Please fill in your details below and send it together with the product and purchase receipt. Please read the Limited Warranty conditions mentioned in this instruction manual.

<b>Customer Name</b>	
<b>Street</b>	
<b>City</b>	
<b>State</b>	
<b>ZIP Code</b>	
<b>Purchase Date</b>	
<b>Description of Defect :</b>	

To arrange pick-up of the defective item please call our service center:

Wachsmuth & Krogmann Inc.  
Tel: 1-888-367-7373 (Business hours Mon-Fri 9:00am-4:00 pm CT)  
Website: <http://www.wk-usa.com>  
123 Sivert Court,  
Bensenville, IL 60106,  
USA

PLEASE DETACH THIS SECTION AND RETURN IT WITH YOUR PRODUCT



WARRANTY CARD

