



# *Assembly Guide*



***R2600HRT***  
COMMERCIAL FITNESS BIKE

# Assembly Guide

## **R2600HRT** COMMERCIAL FITNESS BIKE

To avoid possible damage to this Fitness Bike, please follow these assembly steps in the correct order. Before proceeding, find your new Fitness Bike's serial number located on the front axle tube, and enter here:

---

Refer to this number when calling for service, and enter this serial number on your Warranty Card and in your own records. Be sure to read your Owner's Guide before using your new Fitness Bike.

If any parts, hardware or tools are missing, please call 1.800.335.4348, Extension 12

**NOTE:** It is recommended that you apply grease to the threads of each screw as you assemble your Fitness Bike to prevent loosening and noise. Also, during each assembly step, ensure that ALL screws are in place and partially threaded in before completely tightening any ONE screw.

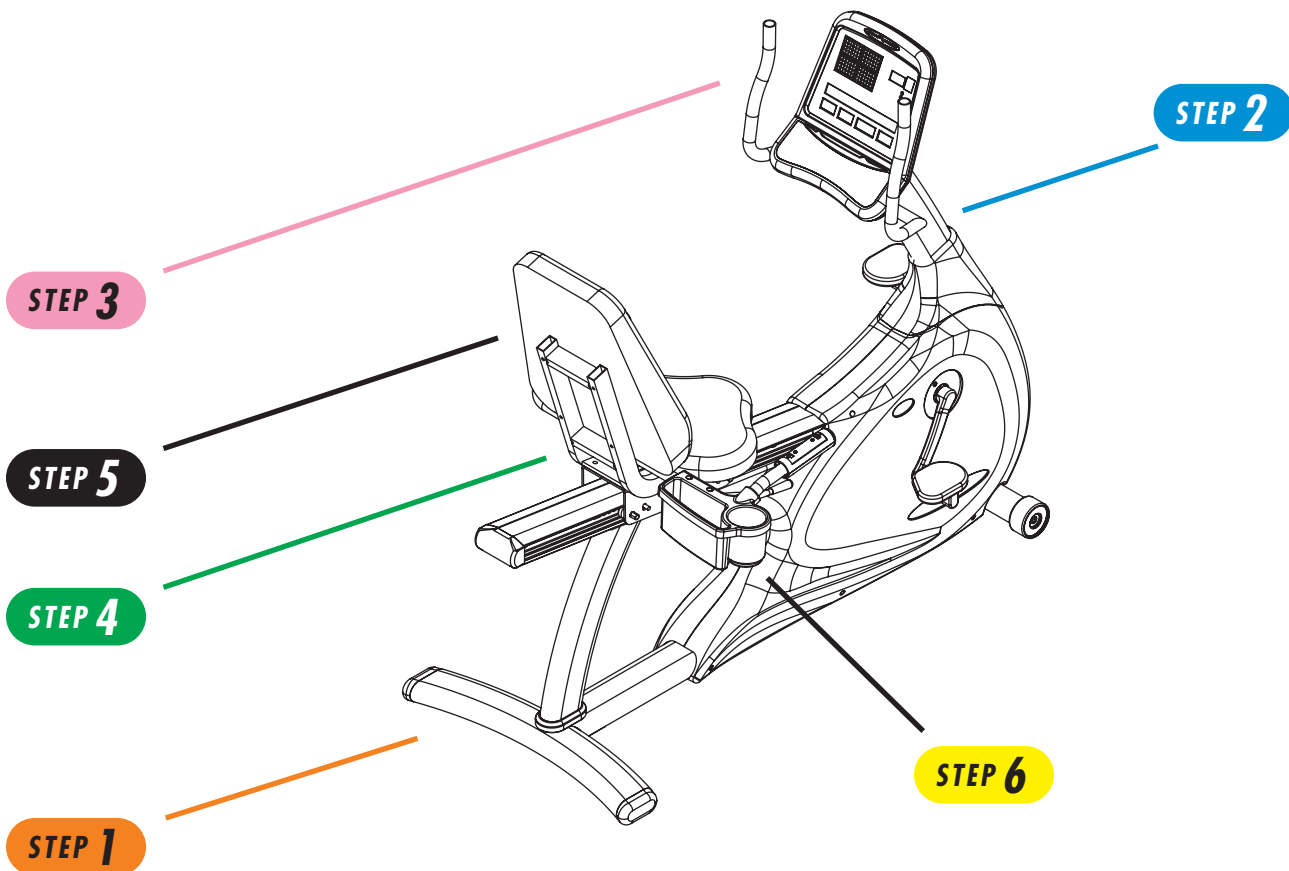

## TOOLS & PARTS INCLUDED

5mm Allen Wrench

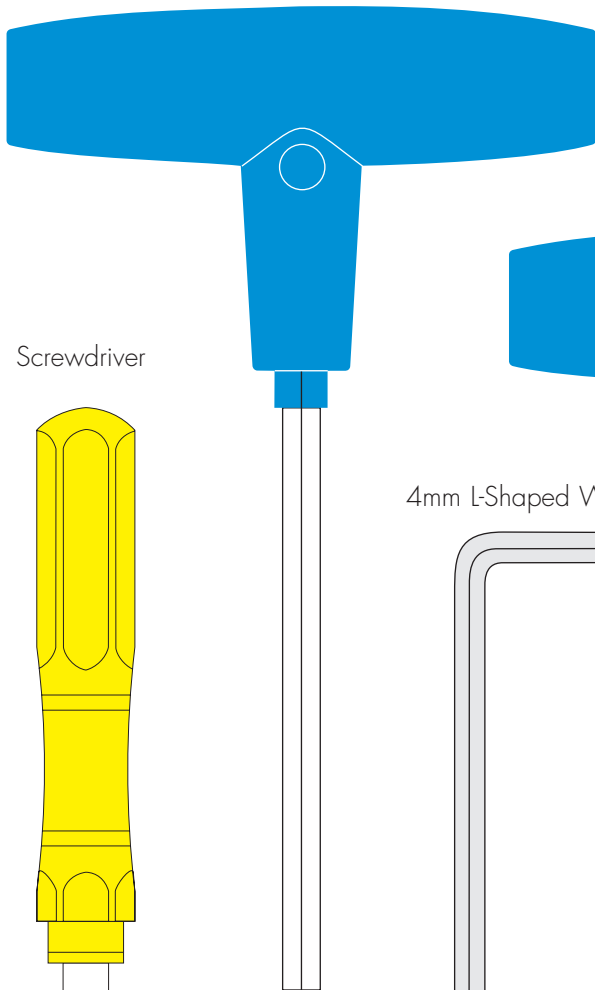

15mm Pedal Wrench

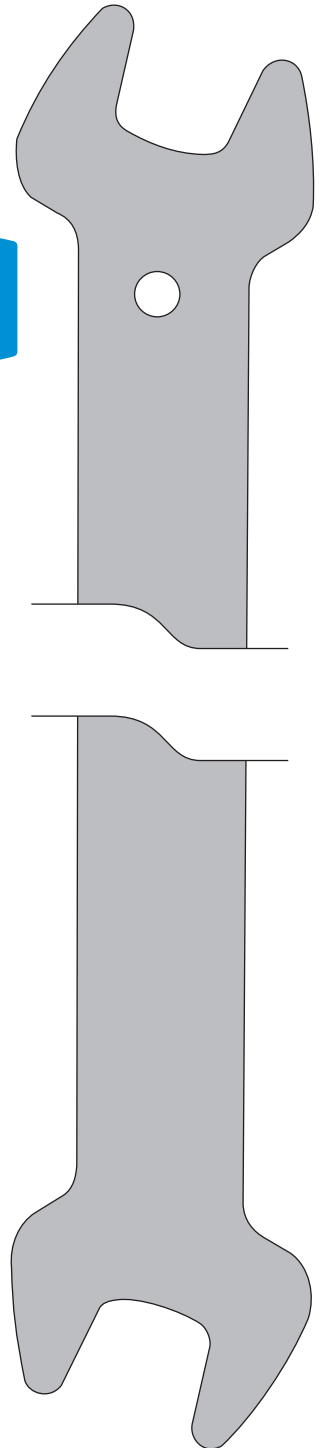

6mm Allen Wrench

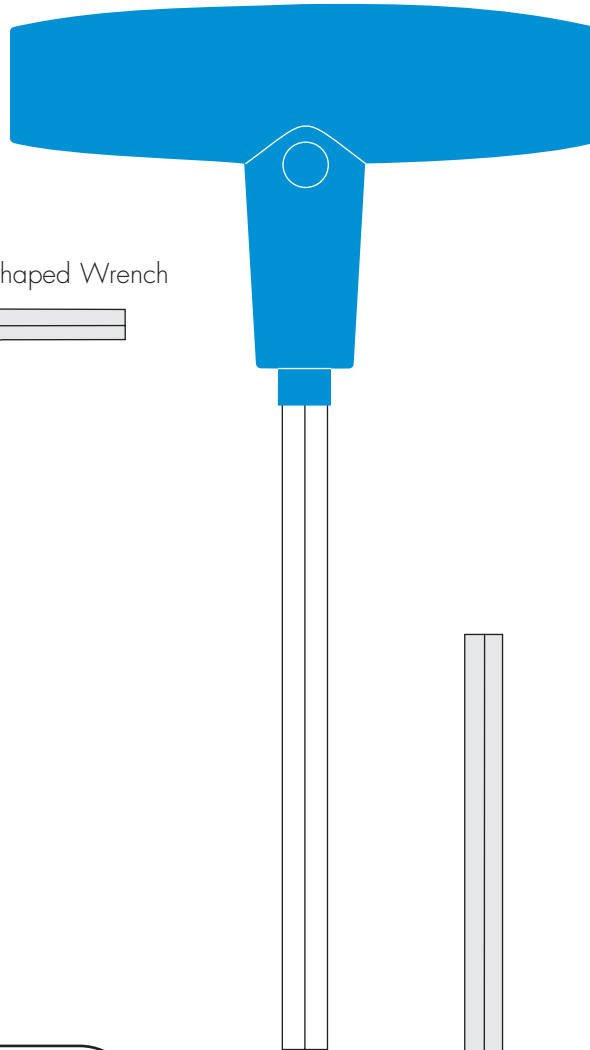

Screwdriver

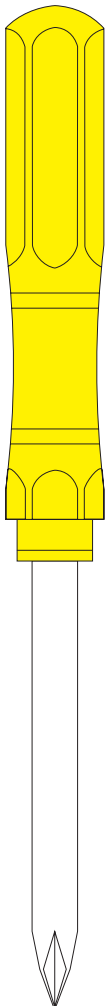

4mm L-Shaped Wrench

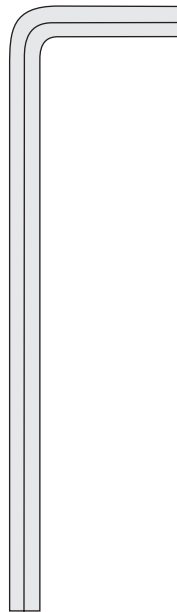

### ***PARTS BOX***

Console Mast Cover  
Water Bottle  
Heart Rate Chest Strap  
Color-coded Hardware Bags  
Pedals/Straps  
Owner's Guide  
Assembly Guide  
Warranty Card

5mm L-Shaped Wrench

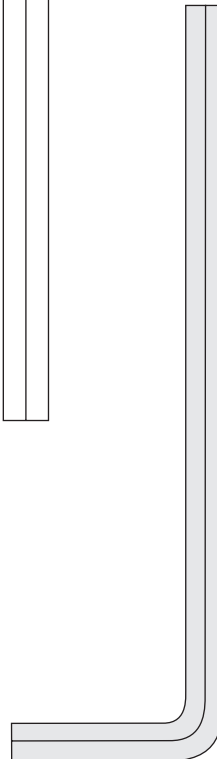

## HARDWARE INCLUDED

### ORANGE BAG

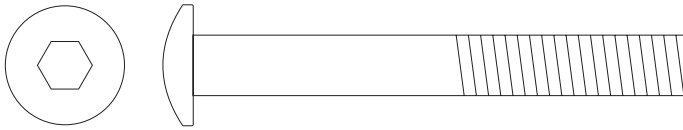

M8x65L Screw  
Quantity: 2

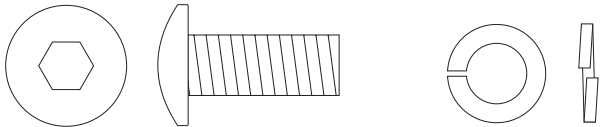

M8 x 20L Screw  
Quantity: 2

M8 Lock Washer  
Quantity: 4

### GREEN BAG

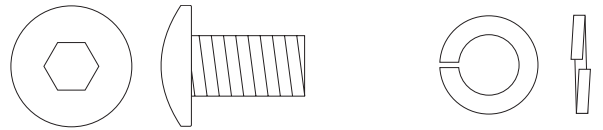

M8 x 15L Screw  
Quantity: 4

M8 Lock Washer  
Quantity: 8

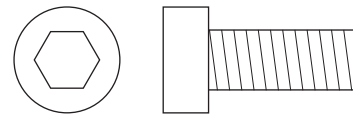

M8 x 20L Screw  
Quantity: 4

### BLUE BAG

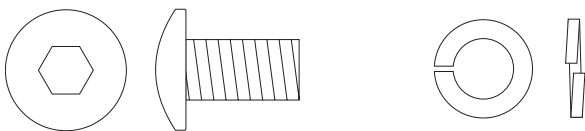

M8 x 15L Screw  
Quantity: 7

M8 Lock Washer  
Quantity: 6

### BLACK BAG

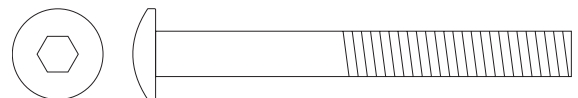

M6 x 55L Screw  
Quantity: 8



M6 Lock Washer  
Quantity: 8

### PINK BAG

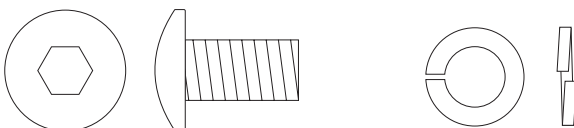

M8 x 15L Screw  
Quantity: 2

M8 Lock Washer  
Quantity: 2

### YELLOW BAG

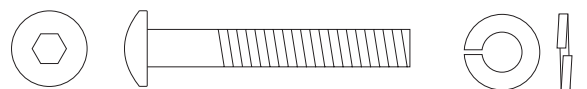

M5 x 35L Screw  
Quantity: 2

M5 Lock Washer  
Quantity: 2

**STEP 1****ORANGE BAG**

- Install the rear foot with the four lock washers (M8), two inside screws (M8x65L), and two outside screws (M8x20L). Tighten with the 5mm Allen wrench.

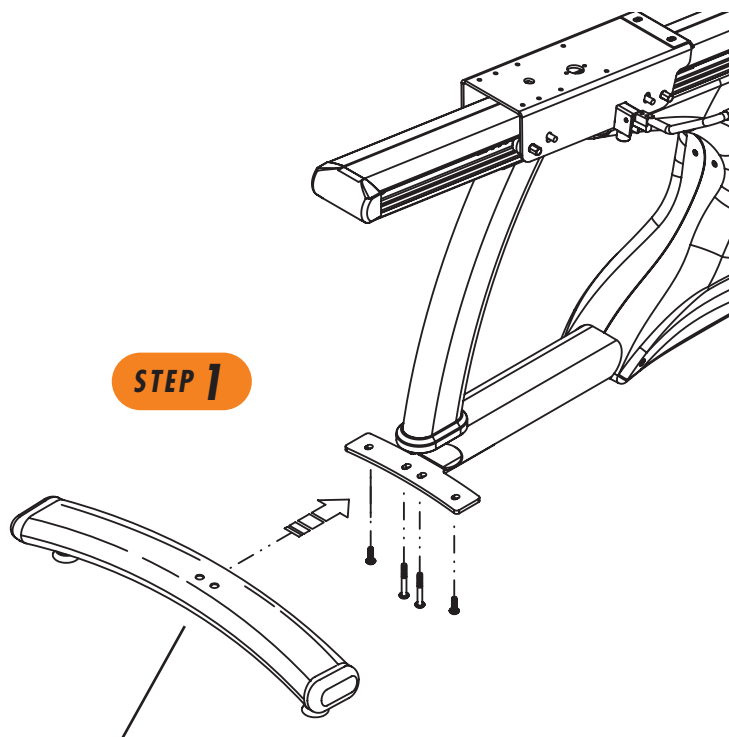
**STEP 1****Rear Foot****STEP 2****BLUE BAG**

- Slide the console mast boot onto the console mast.
- Unfold the wire harness and heart rate wires located in the console mast frame bracket. Attach the wire tie coming from the bottom of the console mast to the wire harness and heart rate wires. Pull the wire tie with wire harness and heart rate wires up through the top of the console mast while simultaneously sliding the mast into the frame bracket.
- Secure the console mast to the frame bracket with six lock washers (M8) and six screws (M8x15L). Tighten with the 5mm Allen wrench. Place the seventh screw (M8x15L) in the rear of the frame bracket and tighten until snug.
- Slide the console mast boot down and snap it into place on the side cover.

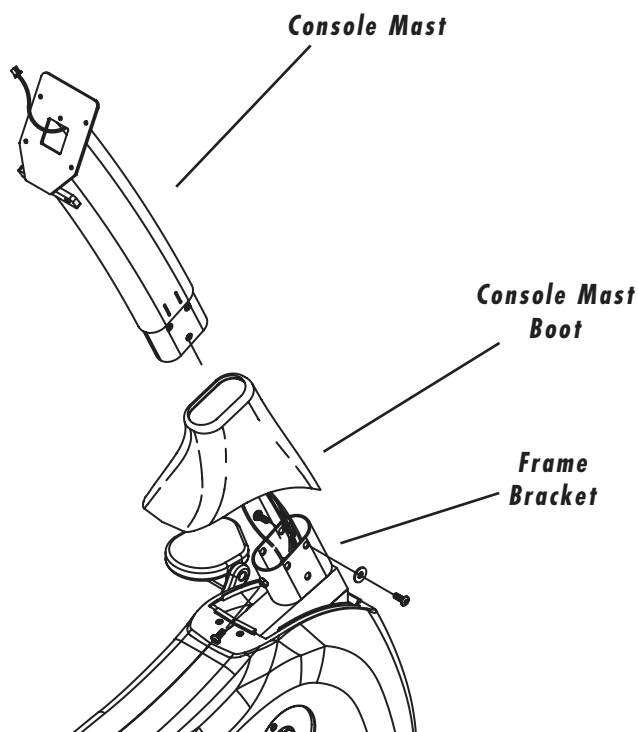
**STEP 2****Console Mast****Console Mast Boot****Frame Bracket**

### STEP 3

## PINK BAG

- Mount the upper handlebars to the console mast using two lock washers (M8) and two screws (M8x15L). Tighten with the 5mm Allen wrench.
- Remove the four mounting screws from the back of the console. Connect the wire harness and heart rate wires that come from the console mast into the plugs located in the back of the console. Make sure the 9-Volt battery is plugged in and in place on the console. Attach the console to the mast with the four screws removed earlier.

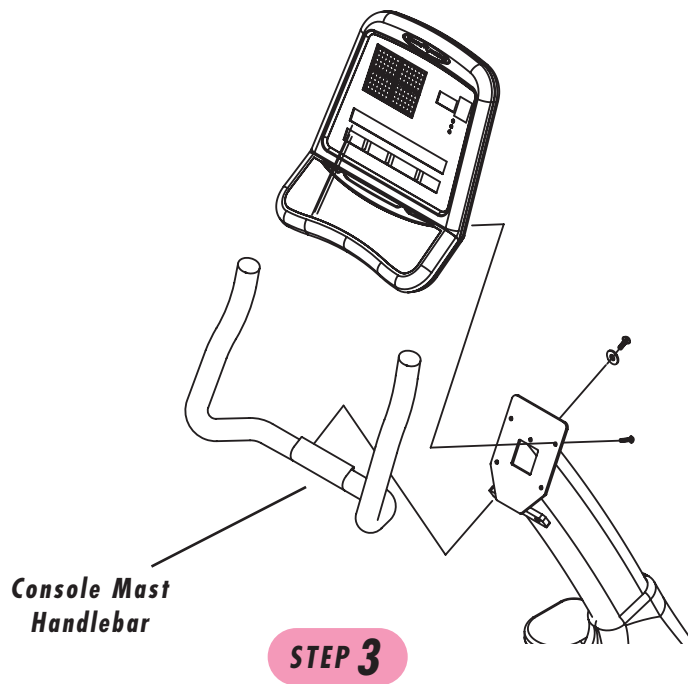

## STEP 4

## GREEN BAG

- Attach the seat frame to the sliding seat bracket using four lock washers (M8) and four socket head cap screws (M8x20L) and the 6mm Allen wrench.
- Connect Wires A on the seat handlebar to Wires B on the sliding seat bracket. Attach the seat handlebars to the sliding seat bracket using four lock washers (M8) and four screws (M8x15L). Tighten with the 5mm Allen wrench.

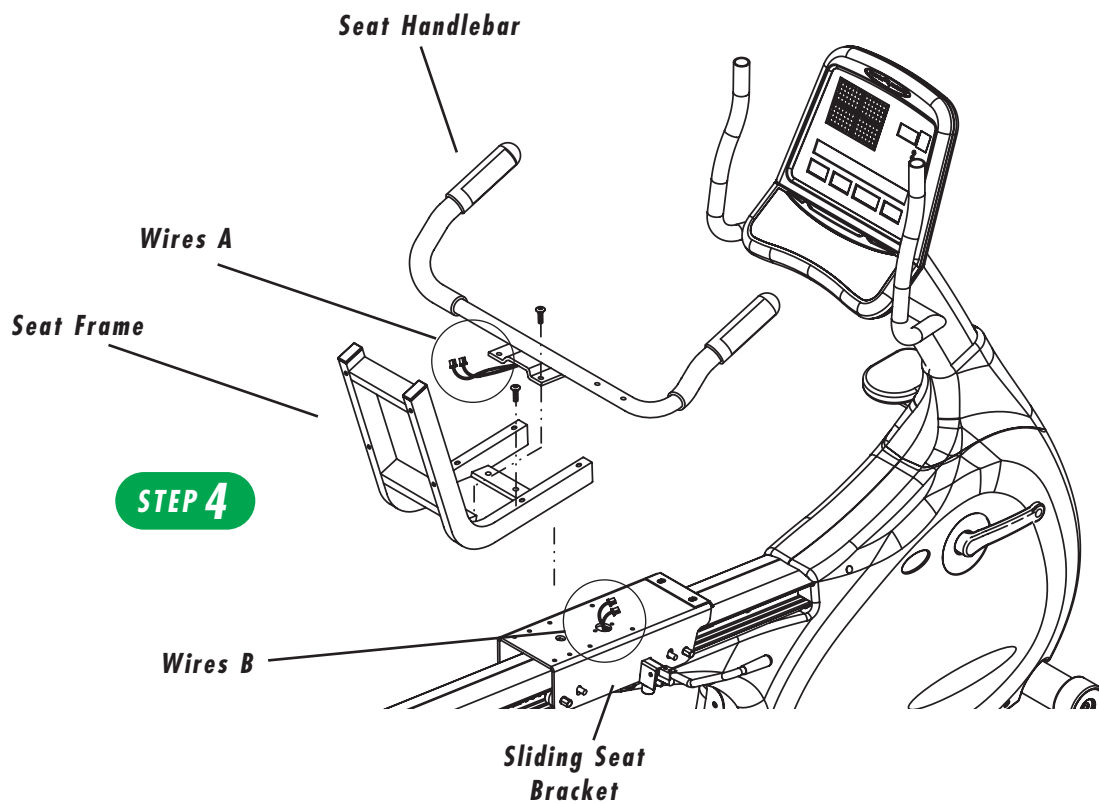

**STEP 5****BLACK BAG**

- Secure the Lumbar controlled seat back and the seat bottom to the seat frame with eight lock washers (M6) and eight screws (M6x55L). Tighten with the 4mm Allen wrench.
- Snap the plastic seat cover into place on the back of the Lumbar controlled seat.

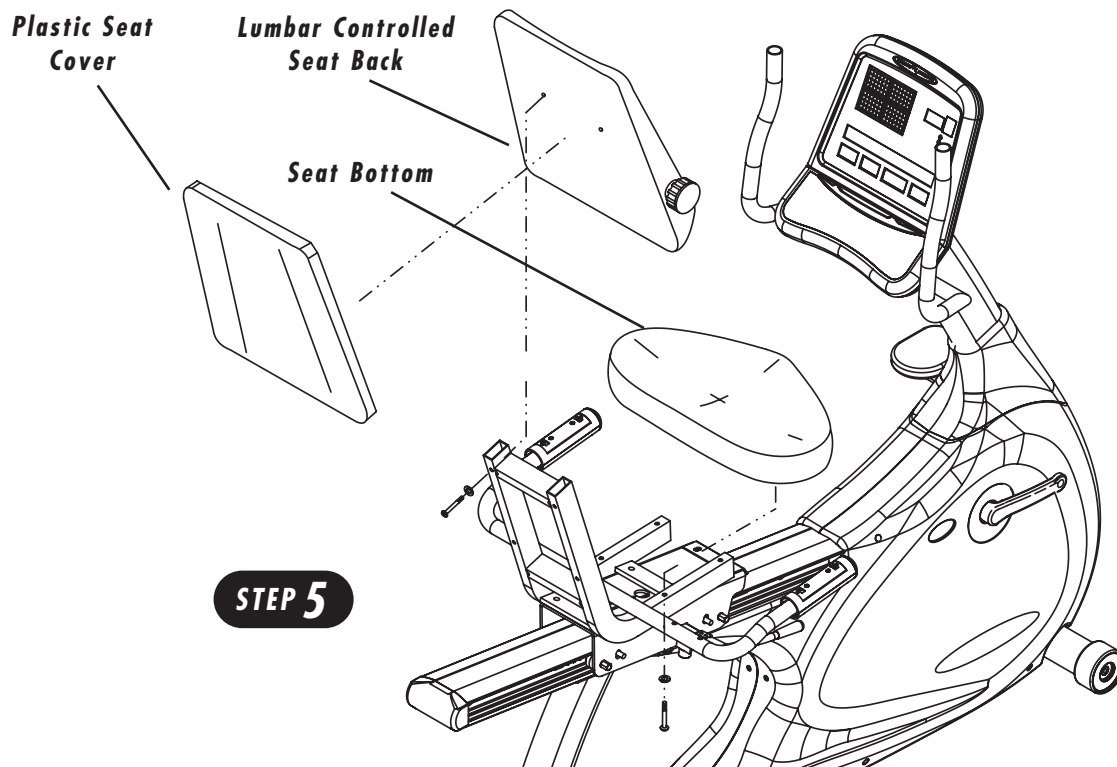



**STEP 6****YELLOW BAG**

- Attach the left and right pedals to the left and right crank arms. Tighten the pedals using the 15mm Pedal Wrench.
- Secure the Accessory Tray to the seat handlebar with two screws (M5x35L) and two lock washers (M5). Tighten with the screwdriver.

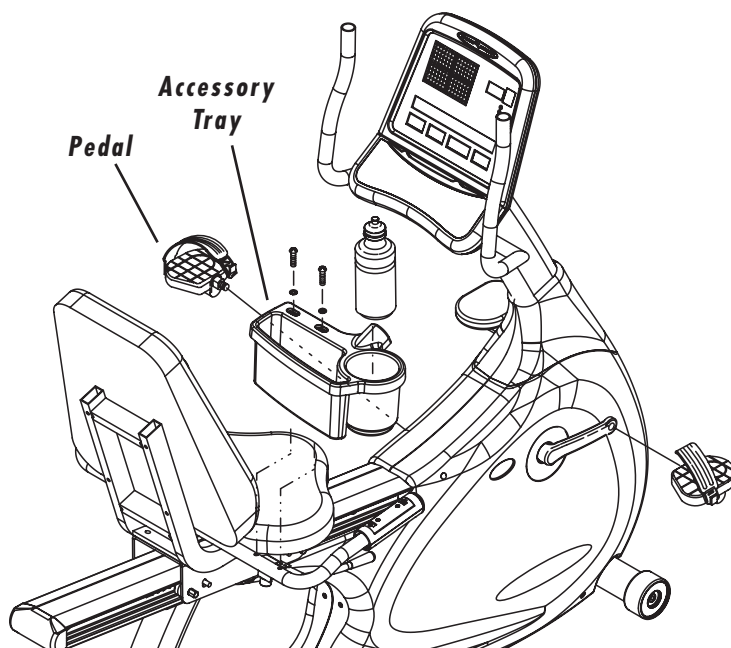
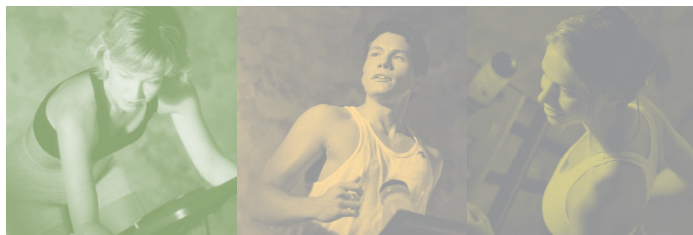
**STEP 6**

500 South CP Avenue • P.O. Box 280 • Lake Mills, WI 53551  
toll free 1.800.335.4348 • phone 1.920.648.4090 • fax 1.920.648.3373  
[www.visionfitness.com](http://www.visionfitness.com)

©2004 Vision Fitness. All Rights Reserved. 9.04 Part #Z26RB77-AG  
AG18.30PRD  
REV2