



Model SF-465

QuickSteam™ Professional



by Top Innovations, Inc.

**Please read instructions before use.
Mail in your warranty registration card.**



LETTER FROM THE CEO

Dear Valued Customer,

Thank you for purchasing the **QuickSteam™ Professional** steamer. This product is designed to quickly refresh and remove wrinkles from curtains, draperies, and the garments you wear. Turn your steamer on, and in less than one minute you are ready to remove wrinkles from your garments with Tailor-Quality Results, eliminating time-consuming and expensive trips to a professional dry cleaner. In addition to removing wrinkles, you will receive the many benefits that steam provides. Hot steam refreshes fabric and eliminates smoke and other unpleasant odors, as well as dust mites and other allergens.

Top Innovations, Inc. would like to invite you to take advantage of our Customer Support website at:

www.topinnovations.com

On this website you will find additional information about many other exciting Steam Fast products that are available, helpful tips on ways in which you can utilize your **SF-465 QuickSteam™ Professional**, and other useful information to assist you in maximizing the power of steam!

Enjoy your **QuickSteam™ Professional!**

A handwritten signature in cursive script, appearing to read "Benny Lee".

Benny Lee
Chairman and CEO
Top Innovations, Inc.

CUSTOMER SUPPORT

For problems with your steamer, please refer to the Troubleshooting Guide located on page 14 of this manual. Additional inquiries should be directed to our Customer Support services at 1-800-711-6617 ext. 102/130 or e-mailed to:

customerservice@topinnovations.com

Should there be any missing or defective parts or accessories, contact Customer Support. In most cases, it is not necessary to return the entire unit. We can ship most parts directly to your door.

To ensure prompt and accurate service, call for a Return Authorization number before returning any unit to Top Innovations. Failure to obtain a Return Authorization number will cause a delay in warranty or out-of-warranty service requests.

DETATCH ORDER FORM HERE

MODEL SF-465

ACCESSORY ORDER FORM

PART	PART DESCRIPTION	PRICE	QTY.	TOTAL (+ \$3.99 S&H)
A465-001	Lint Remover	\$6.99		
A465-002	Fabric Brush	\$6.99		
A465-015	Replaceable Water Filter	\$2.99		
A-465-K1	SF-465 Accessory Kit*	\$34.99		

*For more information on the SF-465 Accessory Kit, please visit www.topinnovations.com

Method of Payment (no C.O.D. orders)

Check or Money Order (payable to Top Innovations)

Charge to my VISA MASTERCARD

--	--	--	--	--	--	--	--	--	--	--	--	--	--	--	--	--	--	--	--

ACCOUNT NUMBER

--	--	--	--	--	--	--	--	--

EXPIRATION DATE

SIGNATURE: _____

NAME: _____

MAILING ADDRESS: _____

TELEPHONE: _____

TO ORDER:

By MAIL
Fill out this form and return to address on back of this manual

By PHONE
(800) 711-6617
EXT. # 102/130

By FAX
(816) 584-9066



IMPORTANT SAFETY GUIDELINES

Basic safety precautions should be used when using any electrical appliance.

Please read all of the following instructions before using your SF-465 QuickSteam™ Professional in order to reduce risk of fire, electric shock, or other injuries.

1. DO NOT leave your SF-465 QuickSteam™ Professional unattended when plugged in or not in use.

2.  **This unit is not a toy. Close supervision is required when using unit near children, pets, and plants. Steam produced by it is hot and pressurized. Care must be taken to avoid burns or other injuries. Never point nozzle at pets or people.**

3. Always unplug electrical cord when unit is not in use. DO NOT use this unit if electrical cord or outlet is damaged. DO NOT use unit if it is not working properly or has been dropped, damaged, or left outdoors. If such damage occurs, return unit to an approved service technician for repair.

4. This unit is an electrical appliance. DO NOT submerge it in water. DO NOT use steam hose or electrical cord as a handle. DO NOT allow cord to be crimped by closing it in doors or allowing the unit to roll over it. DO NOT pull or stretch cord around sharp corners or edges. Be sure to keep electrical cord away from all heated surfaces.

5. DO NOT use this unit with electrical cords or outlets that have inadequate current capacity. A three-prong outlet or a properly grounded adapter is necessary when using SF-465 QuickSteam™ Professional.

6. In order to unplug SF-465 QuickSteam™ Professional, grasp plug and pull smoothly and firmly from outlet. DO NOT attempt to unplug unit by pulling or tugging on cord.

7. Always keep steam nozzle elevated above water container. DO NOT lay hose on floor.

SAVE THESE INSTRUCTIONS!

FOR HOUSEHOLD USE ONLY



IMPORTANT SAFETY GUIDELINES

CAUTION: To reduce risk of electric shock and injury, connect to properly grounded electrical outlets only.

CAUTION: DO NOT immerse in water. This unit is NOT intended for space heating purposes. Use with base or wall receptacles only.

8. DO NOT handle or use this unit while hands are wet or when not wearing shoes. To avoid falls and other injuries, be sure to dry any wet areas on floors and to stand away from damp surfaces while using steam cleaner.

9. SF-465 QuickSteam™ Professional is only meant to be used with recommended SF-465 accessories. Other types of attachments such as those used with vacuum cleaners are not to be used with QuickSteam™ Professional. Doing so may cause injuries or damage to unit.

10. Nozzles and attachments become hot during use. To avoid injuries, DO NOT touch nozzles while using this appliance. DO NOT attempt to change attachments while Steam Trigger is depressed.

11. DO NOT turn unit on its side when in use.

12. When filling your QuickSteam™ Professional with water, DO NOT overfill Water Tank.

13. When Water Tank is empty, always take the following steps:

- (1) Turn appliance off
- (2) Unplug electrical cord

Failure to follow these steps may result in electric shock and injury.

14. Only water should be used in unit. Other cleaning agents will damage unit and can cause injuries.

15. DO NOT operate unit if steam opening is blocked. Should this occur, shut unit off and unplug.

16. Store your SF-465 QuickSteam™ Professional in a cool, dry place. Allow unit to cool completely, and empty before storage.

SAVE THESE INSTRUCTIONS!

FOR HOUSEHOLD USE ONLY



SF-465 QUICKSTEAM™ PROFESSIONAL PRODUCT INFORMATION

The following features and accessories come with your steamer. Carefully inspect packaging material as some parts are shipped inside Styrofoam packaging. To obtain possible missing parts, refer to the **Customer Support** section on page 3 of this manual.

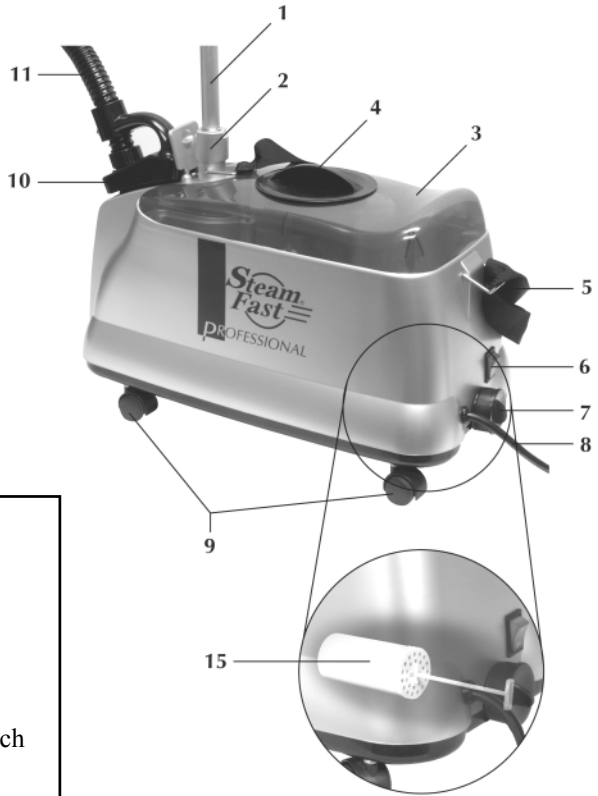

FEATURES AND ACCESSORIES

- 1.) Pole
- 2.) Pole Base
- 3.) Water Tank
- 4.) Water Tank Cap
- 5.) Carrying Strap
- 6.) Lighted On/Off Switch
- 7.) Drain Plug
- 8.) Power Cord
- 9.) Roller Casters
- 10.) Hose Base and Electrical Plug Receptacle
- 11.) Hose
- 12.) Handle
- 13.) Steam Trigger
- 14.) Steam Nozzle
- 15.) Water Filter



WARNING

Always turn unit off and unplug from electrical outlet before emptying Water Tank.

- The *Pole* (1) connects the *Pole Top* (not shown) to the main unit at the *Pole Base* (2). The *Pole Top* is comprised of the *Clothes Hanger Hook* and the *Steam Nozzle Holder*. The *Clothes Hanger Hook* allows you to steam garments that are hanging from a clean, rust-free hanger, while the *Steam Nozzle Holder* provides a safe and convenient place to hang the *Steam Nozzle*.
- The *Water Tank* (3) is the reservoir where water is placed for use by the steamer. Water is placed in the *Water Tank* by removing the *Water Tank Cap* (4), exposing the inlet into which water can be poured.
- The *Carrying Strap* (5) can be used to safely lift the unit off of the ground and carry it up flights of steps or other obstacles over which the unit cannot be rolled.
- The *Lighted On/Off Switch* (6) provides a visual indication of whether or not the steamer is in use.
- The *Drain Plug* (7) can be removed for easy drainage of the *Water Tank*.
- The *Power Cord* (8) plugs into a standard three-prong electrical outlet.
- The *Rolling Casters* (9) allow for quick and effortless movement of the steamer over flat, stable surfaces.
- The *Hose Base and Electrical Plug Receptacle* (10) is the point to which the *Hose* attaches to the main unit. The *Hose* (11) is the delivery system for the steam to be transmitted from the *Water Tank* to the *Steam Nozzle*.
- The *Handle* (12) is permanently attached to the *Steam Nozzle*, and provides a safe point to grip and direct the flow of steam.
- The *Steam Trigger* (13) must be depressed in order for steam to be emitted from the *Steam Nozzle*.
- The *Steam Nozzle* (14) is the aperture from which steam flows and is spread over a wide area.
- The *Water Filter* works to purify the water in the *Water Tank*, ensuring that the steam you use is as clean and pure as possible. The *Water Filter* is replaceable (see page 3 of this manual for information on ordering replacement filters).

Assembling Pole

1. Insert Pole Top into middle section of Pole and rotate it clockwise to tighten the two sections together (FIGURE 1).
2. Slide Screw Knob over top of bottom Pole section. It will come to rest on stopper ring towards bottom of Pole section (FIGURE 2).
3. Insert middle Pole section into bottom Pole section, rotating middle section clockwise to tighten the two sections together (FIGURE 3).
4. The Pole should now be completely assembled (FIGURE 4).

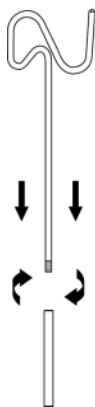

FIGURE 1



FIGURE 2



FIGURE 3



FIGURE 4

Attaching Pole to Main Unit

1. Insert bottom of Pole into Pole Base hole located on top of main unit (FIGURE 5).
2. Push Pole down as far as possible. Screw knob in a clockwise direction until Pole fits snugly and securely in place (FIGURE 6).

NOTE: To ensure maximum stability of your QuickSteam™ Professional, attach Pole in such a way so that Clothes Hanger Hook faces towards rear of unit.

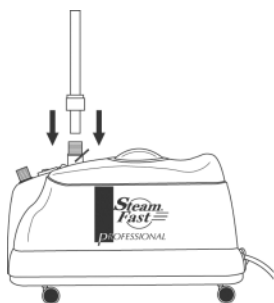

FIGURE 5



FIGURE 6

Attaching Hose and Electrical Inlet

NOTE: Unplug unit from electrical outlet before attaching Hose and Electrical Inlet.

1. Flip up cover on main unit to expose Electrical Plug Receptacle. Attach Hose and Electrical Inlet to Hose Base on main unit, lining up electrical plugs on Inlet with slots on Electrical Plug Receptacle on unit (FIGURE 7).
2. When Hose and Electrical Inlet appear to be firmly seated onto Hose Base and Electrical Plug Receptacle, rotate knob on Hose in a clockwise fashion to secure it firmly to main unit (FIGURE 8).

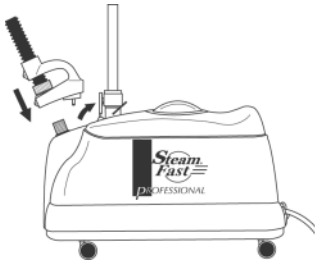

FIGURE 7

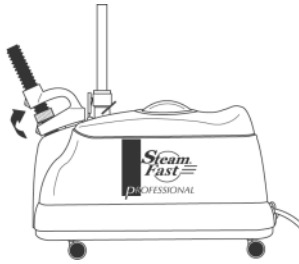

FIGURE 8

Attaching Accessories to Steam Nozzle

WARNING: DO NOT attempt to attach an accessory while steamer is still on. To avoid burns caused by hot steam, release Steam Trigger and wait until flow of steam from Steam Nozzle has completely ceased.

To attach any included accessories to Steam Nozzle, simply line up pegs on back of accessory (FIGURE 9) to slot on face of Steam Nozzle (FIGURE 10). Press accessory peg into slot gently but firmly, until it fits securely in place.

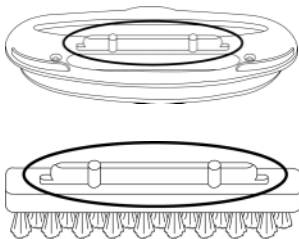

FIGURE 9



FIGURE 10



USING YOUR QUICKSTEAM™ PROFESSIONAL



WARNING: Always unplug unit from electrical outlet before filling or emptying Water Tank.

1. Fill Water Tank with cool water. To prolong the lifetime of your QuickSteam™ Professional, we recommend using distilled or de-mineralized water.
2. Plug unit into a properly grounded three-pronged electrical outlet, and set Lighted On/Off Switch to “On” position. Verify that light on switch is illuminated.
3. Hold Steam Nozzle over object that you desire to steam. Press Steam Trigger. Steam should begin flowing from Steam Nozzle in approximately 45 seconds.
4. When finished using QuickSteam™ Professional, set Lighted On/Off Switch to the “Off” position.

NOTE: It is normal for steam to flow from the Steam Nozzle for a period of time after the unit is turned off. This occurs because the Steam Trigger allows water to flow into the unit’s boiler. Once you release the Steam Trigger, the remaining water in the boiler will continue to flow from the Steam Nozzle for a period of time until the boiler is empty.

AUTO SHUT-OFF

The QuickSteam™ Professional is equipped with an Auto Shut-Off feature. This protects the unit from damage that can occur from operating with a dry Water Tank. If the water level inside the Water Tank drops below the Water Fill Line (which can be found inside the Water Tank), the unit will automatically shut down and cannot be restarted until water is added and level exceeds the Water Fill Line.





USING YOUR QUICKSTEAM™ PROFESSIONAL

STEAMING FABRIC

CAUTION: Be careful when handling garments on Clothes Hanger Hook. Pulling on the garment with too much force may cause unit to tip over.

1. To steam garment, place it on clean, rust-free clothes hanger, and place hanger on Clothes Hanger Hook.
2. Grasp Handle, and direct Steam Nozzle at the bottom of garment. Steam will rise along inside and outside of fabric, removing wrinkles. Slowly slide nozzle vertically, from bottom to top of garment.

NOTE: DO NOT allow kinks to form in Hose at any time.

3. Direct steam away from garment, and smooth fabric with free hand.
4. Repeat steps 2 and 3 as necessary until fabric is wrinkle-free.
5. Curtains and draperies can be steamed while still hanging.
6. To remove wrinkles from towels, handkerchiefs, and napkins, drape them over a rod or towel rack, and gently steam.
7. Heavier fabrics may require repeated steaming.
8. To remove stubborn wrinkles, steam both sides of fabric.

For special steaming needs, a Fabric Brush and Lint Remover have been included with your QuickSteam™ Professional. See the “Attaching Accessories to Steam Nozzle” section on page 9 for more information on attaching these accessories.



FABRIC BRUSH

May be used to assist you in removing exceptionally stubborn wrinkles from fabric



LINT REMOVER

Useful for removing lint and other small particles from garments, drapes, and curtains

NOTE: Refer to page 3 of this manual for information on acquiring replacement accessories.



CARE AND STORAGE GUIDELINES

QUICK STORAGE

1. Set Lighted On/Off Switch to “Off” position.
2. Unplug Power Cord from electrical outlet.
3. Wrap Hose loosely around Pole one time.
4. Hang Steam Nozzle from Steam Nozzle Holder.
5. Roll QuickSteam™ Professional to a convenient storage location.

CLEANING AND LONG-TERM STORAGE

It is recommended that you follow this procedure at least once per week. Use of distilled or de-mineralized water reduces the need for cleaning and prolongs the lifetime of your QuickSteam™ Professional.

1. Set Lighted On/Off Switch to “Off” position.
2. Unplug Power Cord from electrical outlet.
3. Wait for unit to cool completely (at least 30 minutes).
4. Remove Hose and Pole from unit, and set them aside.
5. Using Carrying Strap, carry the unit to a sink or tub.
6. Drain water from Water Tank into sink or tub. Rinse Water Tank with fresh water, and drain completely.
7. Drain steamer by removing Drain Plug and emptying the contents into sink or tub. Tilt unit towards Drain Plug to facilitate removal of water.
8. Flush unit by filling Water Tank and Hose Base with fresh water and draining completely. Replace Drain Plug.
9. Reattach Pole and Hose to unit (refer to assembly instructions on pages 8 and 9 for assistance).
10. Wrap Hose loosely around Pole one time.
11. Hand Steam Nozzle from Steam Nozzle Holder.
12. Roll QuickSteam™ Professional to a convenient storage location.

REPLACING THE WATER FILTER

The QuickSteam™ Professional incorporates a unique replaceable water filter in its steam delivery system. This filter removes most impurities found within water, ensuring that steam produced by the unit is as clean and pure as possible.

After a certain amount of use, the filter will no longer remove water impurities as efficiently. When this occurs, it is recommended that you replace it in order to continue getting the most out of your QuickSteam™ Professional. To do this, simply unscrew the Drain Plug Cap, grasp the filter by the handle, and pull it out. Then insert a new filter into the unit cylinder-first (refer to item 15 on page 6 for an illustration of correct filter orientation). See order form on page 3 of this manual for information on obtaining new water filters.



REMOVING MINERAL BUILDUP

One common problem with steamers is mineral build-up caused by a high mineral content in many municipal water supplies. Mineral residue inside of internal pipes and heater can cause intermittent steaming or, in some cases, no steaming at all.

NOTE: To reduce or eliminate occurrence of mineral build-up we recommend use of de-mineralized or distilled water in unit.

The procedure below can be used to reduce mineral build-up. If you are unable to use de-mineralized or distilled water, we recommend you follow this procedure monthly.

1. Turn unit off, and unplug power cord.
2. Remove Hose and Pole from unit.
3. Drain Water Tank by following steps 1-7 of the **Cleaning and Long-Term Storage** procedure on page 12 of this manual.
4. Mix a solution of 50% vinegar and 50% water. In most cases, 32oz. of this solution will be sufficient. (16oz. of each)
5. Slowly pour water-vinegar solution into Hose Base connector.
6. If standing water-vinegar solution becomes visible in Water Tank's inlet hole, continue to pour solution into Hose Base until mixture is visible in Water Tank.
7. If standing water-vinegar solution does not become visible in Water Tank's inlet hole, continue pouring solution into Hose Base until standing solution appears near top of Hose Base. Pour additional solution into Water Tank until a layer of solution covers bottom.
8. Allow to stand for 40 minutes.
9. Drain solution out of Water Tank by removing drain plug and allowing liquid to drain into a sink or tub.
10. Drain solution out of Hose Base by tilting unit over a sink or tub and pouring the water out of Hose Base.
11. Pour clean water in Hose Base and Water Tank inlet, and drain. Repeat this step until vinegar odor dissipates.
12. Reassemble unit and operate normally.

If this procedure does not return unit to normal operation, it may be in need of servicing. Please Contact our trained customer support team at (800) 711-6617 ext. 102/130.



TROUBLESHOOTING GUIDE

PROBLEM	POSSIBLE CAUSE	SOLUTION
Unit fails to steam. Light on the <i>On/Off Switch</i> does not illuminate.	Steamer is not plugged in.	Plug into electrical outlet.
	Household Circuit Breaker / Ground Fault Interrupter has tripped or blown a fuse.	Reset Circuit Breaker / Ground Fault Interrupter, or replace fuse. If you need assistance, contact a qualified electrician.
	Auto Shut-Off feature has activated.	Refill Water Tank so that water level exceeds Water Fill Line.
Unit fails to steam. Light on the <i>On/Off Switch</i> does illuminate.	Mineral buildup in unit.	Follow Removing Mineral Buildup procedure on page 13 of this manual.
	Water Tank is empty.	Refill Water Fill Tank using procedures on page 10 of this manual.
Water drips from nozzle.	Condensation has built up in hose.	Extend hose vertically to allow water to drain back into water reservoir.
Excessive gurgling of Hose and Steam Nozzle.	Condensation has built up in hose.	Some gurgling is a natural effect of the steaming process. For excessive gurgling, extend hose vertically to allow water to drain back into water reservoir.
Steam output is intermittent. NOTE: It is normal for unit to periodically stop steaming for a few seconds. Use these troubleshooting tips only if steam stays off for longer periods.	Mineral buildup in unit.	Follow Removing Mineral Buildup procedure on page 13 of this manual.
	Water Filter has become clogged or is no longer functioning at full capacity.	Rinse filter out with clean water. If problem persists, replace filter using order form on page 3 of this manual.



WARRANTY INFORMATION

ONE YEAR LIMITED WARRANTY

(If outside USA, additional shipping charges may apply)

Top Innovations, Inc. warrants this product to be free from defects in material and workmanship for a period of one (1) year from the date of purchase. This warranty does not cover damage caused by misuse, negligence, use by improper current or voltage, use contrary to operating instructions or disassembly, repair or alteration by any person other than Top Innovations, Inc. Warranty Service Department.

Top Innovations, Inc. will repair or replace, at its option. This warranty gives you specific legal rights and may have other rights, which may vary from state to state.

Performance of any obligation under this warranty may be obtained by:

1. Call (800) 711-6617 for Return Authorization Number before returning for repair
2. Include copy of purchase receipt
3. Include your name, address, telephone number, and Return Authorization Number on returned package

Please send product postage prepaid to:

TOP INNOVATIONS, INC.
WARRANTY SERVICE DEPARTMENT
400 NW PLATTE VALLEY DR.
RIVERSIDE, MO 64150

After 1 year limited warranty has expired, you will be advised of the cost of repair before any servicing is done unless you enclose a note indicating that you would like us to proceed with repairs.

If you have any questions about coverage under this warranty, you may contact warranty service department by telephone at (800) 711-6617 ext. 102/130 or e-mail customerservice@topinnovations.com



Top Innovations, Inc.

400 NW Platte Valley Dr.

Riverside, MO 64150

Tel: (800) 711-6617

www.topinnovations.com

sales@topinnovations.com



Printed In China