

---

# INSTALLATION MANUAL

---

## High Security Projector Ceiling Mount MODEL# ELPMBATA

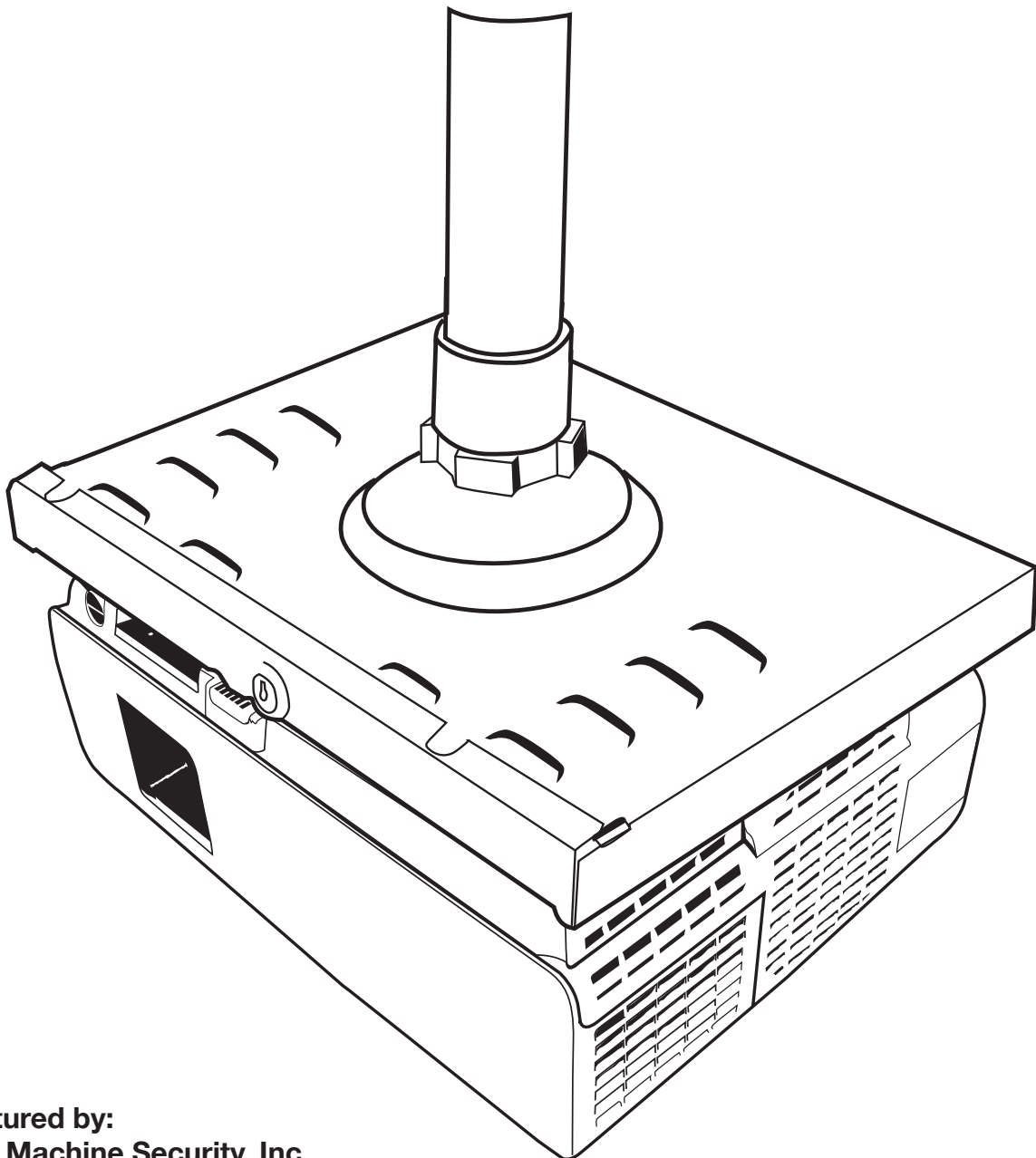

Manufactured by:  
Business Machine Security, Inc.  
520 W. Central Ave.  
Brea, CA 92821  
[www.LocDown.com](http://www.LocDown.com)

---

# Table of Contents

Limited Warranty Information.....3

Contact Business Machine Security.....3

Warning Statement..... 3

Parts List.....4

Mount Assembly.....5

Securing Receiver Tray to Pipe.....6

Mounting Projector to Grid Plate..... 7-9

Locking Grid Plate to Receiver Tray.....10

Adjusting Mount..... 11

---

## **Business Machine Security**

### **Limited Warranty Information**

Business Machine Security, Inc. warrants the original purchaser of Business Machine Security, Inc. products that they be free of defects in material and workmanship for life from the date of purchase. User assumes all risk and liability resulting from the use of the products, whether used singly or in combination with other goods. Business Machine Security, Inc. neither assumes nor authorizes any person to assume for it any liability in connection with the sale or use of the products sold and there are no oral agreements or warranties collateral to or affecting this limited warranty. Business Machine Security, Inc.'s only responsibility under this warranty is for the repair or replacement of any Business Machine Security, Inc. product found to be defective during the warranty period. Business Machine Security, Inc. assumes no responsibility whatsoever for special, indirect or consequential damages resulting from the use of Business Machine Security, Inc. products, and specifically assumes no liability for the loss or damage to equipment or data. The remedies set forth in this Limited Warranty are exclusive and the liability of Business Machine Security, Inc. with respect to any contract of sale or anything done in connection therewith, whether in contract, in tort, under any warranty or otherwise shall not, except as expressly provided herein, exceed the price of the equipment or part on which such liability is based. Any damage caused by the improper use, operation beyond capacity, substitution of parts or equipment not approved by Business Machine Security, Inc., improper packaging, failure to observe installation or other instructions, transit, or repair by one other than Business Machine Security, Inc., will not be covered by and shall void this Limited Warranty.

**THIS IS THE ONLY WARRANTY GIVEN, AND EXCLUDES ALL OTHER WARRANTIES, INCLUDING ANY WARRANTY OF MERCHANTABILITY OR FITNESS FOR A PARTICULAR PURPOSE.**

## **Contact Business Machine Security**

**Customer Service/ Technical Support at (800) 872-9562 or [customerservice@locdown.com](mailto:customerservice@locdown.com)**

### **Important Warnings and Cautions!**



- Warning** Failure to read, understand, and follow instructions can result in serious personal injury, damage to equipment, or voiding equipment warranty.
- Warning** Improper installation can result in serious personal injury or death. The mounting surface must support a weight factor of four times the combined total weight of the equipment and the mount. If not, reinforcement of the mounting surface will be necessary before installing the mount.
- Warning** It is the installer's responsibility to make sure the mounting surface can support the combined weight of the mount and equipment by a factor of four times.
- Warning** It is the installer's responsibility to make sure that mounting surface and subsurface is free and clear of all electrical wires, plumbing and gas pipes. Failure to provide adequate clearance of all electrical wires and pipes can result in fire, serious personal injury or death.
- Warning** Mount and equipment exceeding a combined weight of 60 lbs. can result in damage to the support structure, the mount, the equipment, and may cause serious personal injury.
- Warning** Business Machine Security, Inc. does not warrant its mounts against damage caused by the use of its mounts for any purpose other than for the purposes for which it has been designed. Business Machine Security, Inc. is not responsible for damage, or injury that may result in the use of any unauthorized modifications or attachment.
- Warning** Proper safety gear and practices should be adhered to at all times throughout the installation process.
- Warning** Do not install the mount near any heat source or air conditioning vent which may be prone to vibration.
- Warning** Maximum load capacity of mount: 25 lb
- Warning** When installing or adjusting the ceiling mount, do not use adhesives, lubricants, or oils to prevent the screws from loosening. If you use adhesives, lubricants, or oils to prevent the screws from loosening, the casing may crack and the projector may fall, causing serious injury and damage to the projector.

# Parts List

## Installation Tools

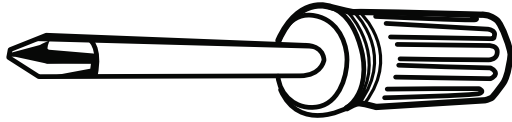

Phillips Head Screwdriver  
(not provided)



Pipe Adhesive  
(provided)

## Mounting Hardware



4mm X 10mm  
Pan Head Metric Screw  
(Qty 4)

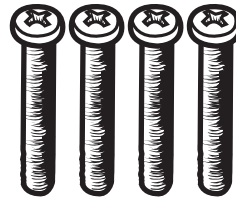

4mm X 20mm  
Pan Head Metric Screw  
(Qty 4)



#10 SAE Flat Washer  
(Qty 4)

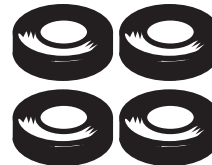

3/8" Thick  
Spacer  
(Qty 4)

# Mount Assembly

**PARTS LEGEND**

- A 1-1/2" Threaded Pipe (Not provided)
- B Pipe Adhesive
- C 1-1/2" Pipe Coupler
- D Tensioning Ring
- E Receiver Tray
- F Grid Plate
  
- G Pan Head Metric Screw\*  
4mm X 10mm  
4mm X 20mm
  
- H #10 SAE Flat Washer
- I Screw Lock
- J 3/8" Spacer
  
- P Projector (Not included)

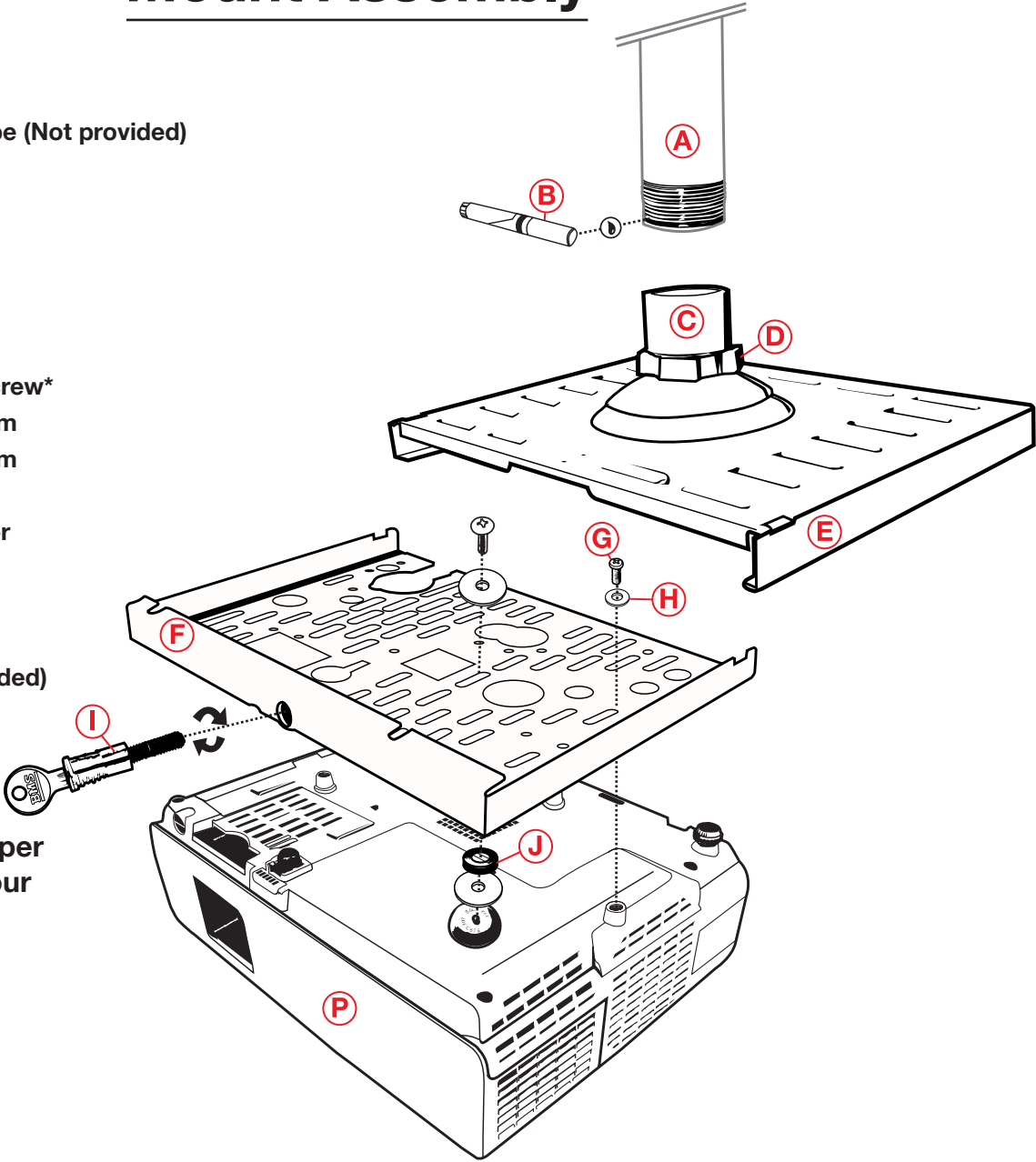

\*see pages 7-9 for proper hardware to use for your model projector

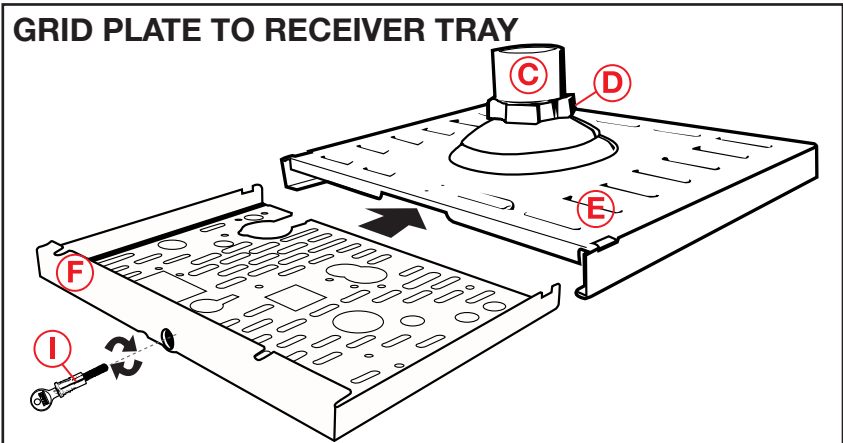

---

## Securing Receiver Tray to Pipe

Twist off the cap from the Pipe Thread Adhesive tube (B). Cut off the tip. Apply it to the inside of the coupler (C) at the top, for about 1/4" or approximately three threads. Screw the coupler (C) clockwise (as viewed from below), with the Receiver Tray (E) already assembled, onto the pre-installed 1-1/2" standard pipe threads (A). This connection should be as tight and stable as possible.

**WARNING:** It is the installers responsibility to be sure that the structure to which this mount will be attached, can support four times the combined weight of the equipment, mount and supporting hardware.

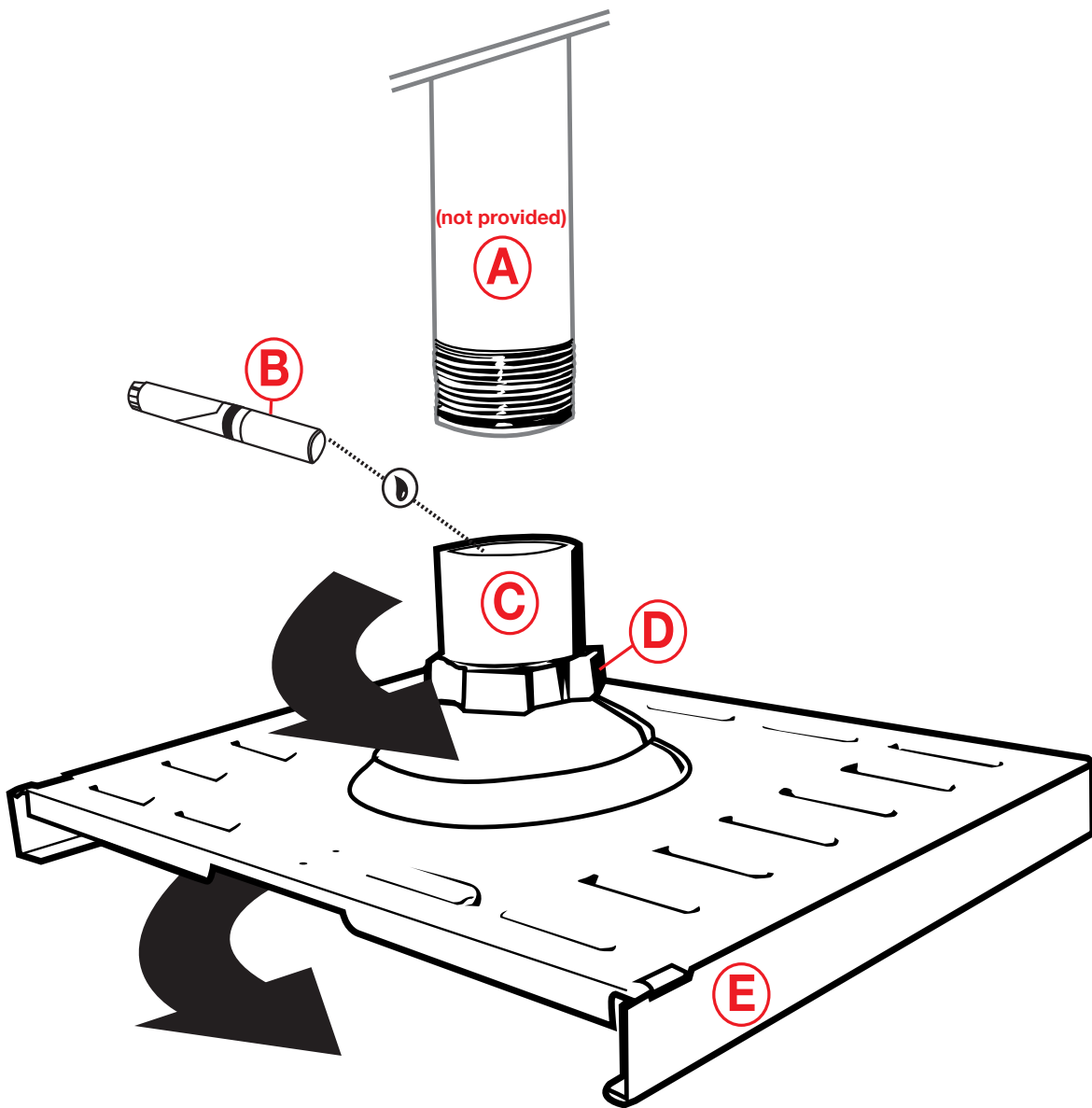

# Mounting Projector to Grid Plate

1. Turn the projector (P) upside down and place it flat on a soft cloth or packaging material. Remove or adjust the feet to be as flush as possible to the projector bottom.
2. Place the Grid Plate (F) on the bottom of the projector and line it up so the mounting inserts of the projector (P) can be seen through the holes of the Grid Plate (F). (NOTE: see pages 8-9 for which mounting holes to use for your model projector)
3. Select the screws (G) for your projector (see pages 8-9 for proper hardware to use for your model projector)
4. Attach the Grid Plate (F) to the projector using these screws (G) and washers (H). Turn until snug. Do not over tighten.

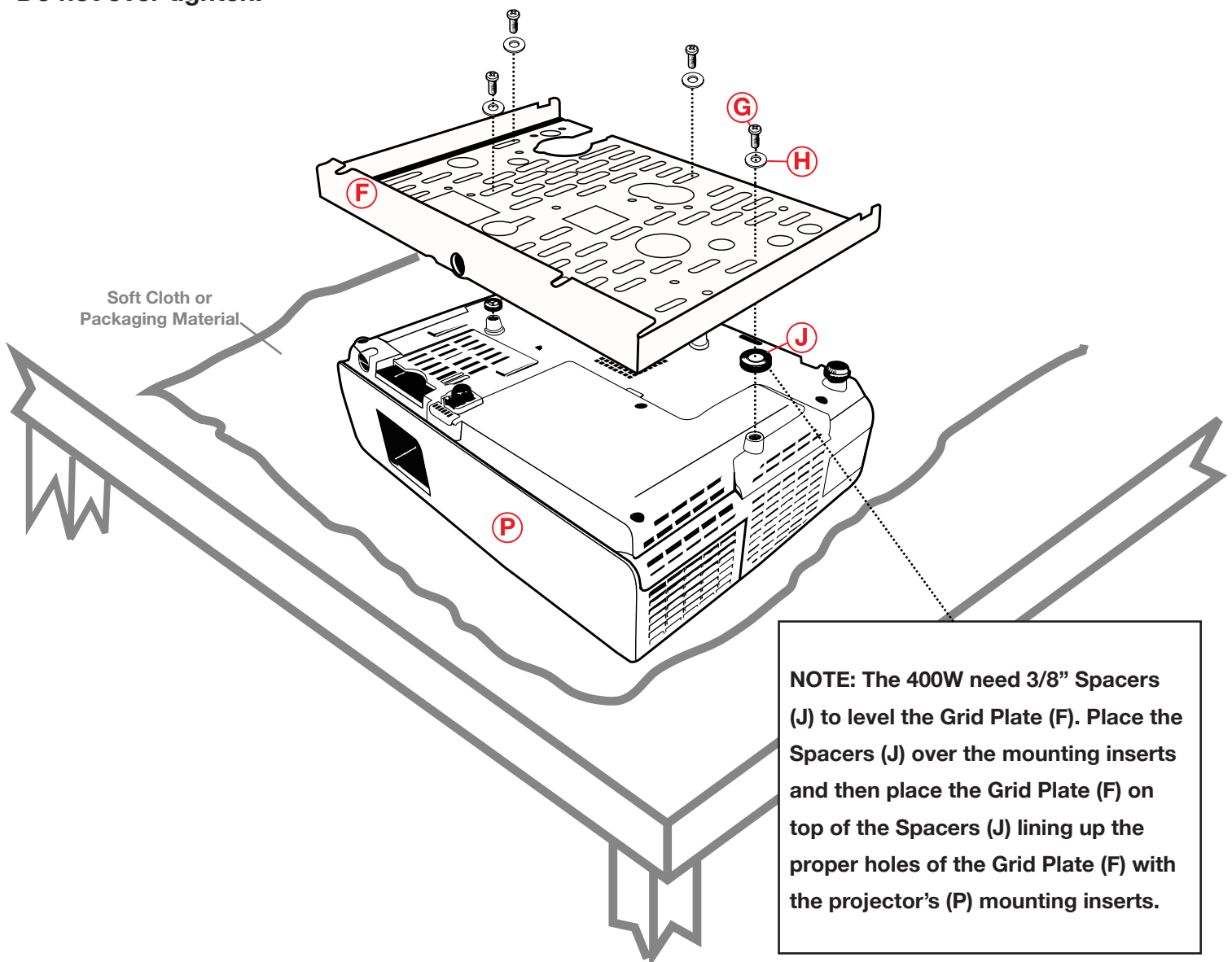

**Epson Projector Model#  
1700c, 1705c, 1710c, 1715c**

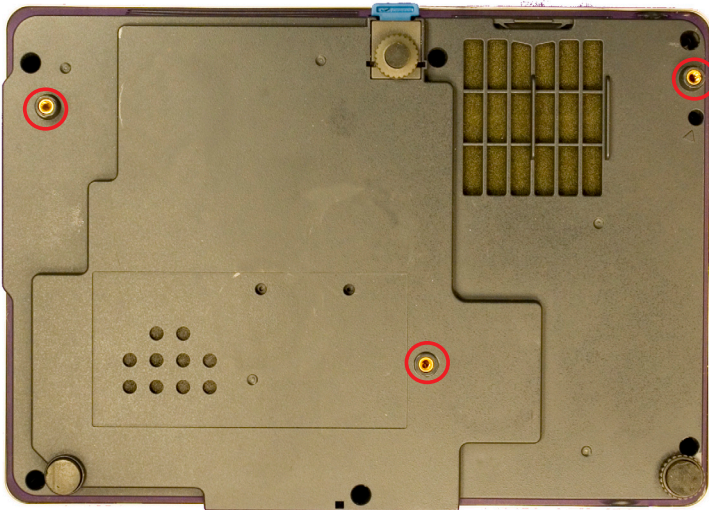

*Mounting Inserts*

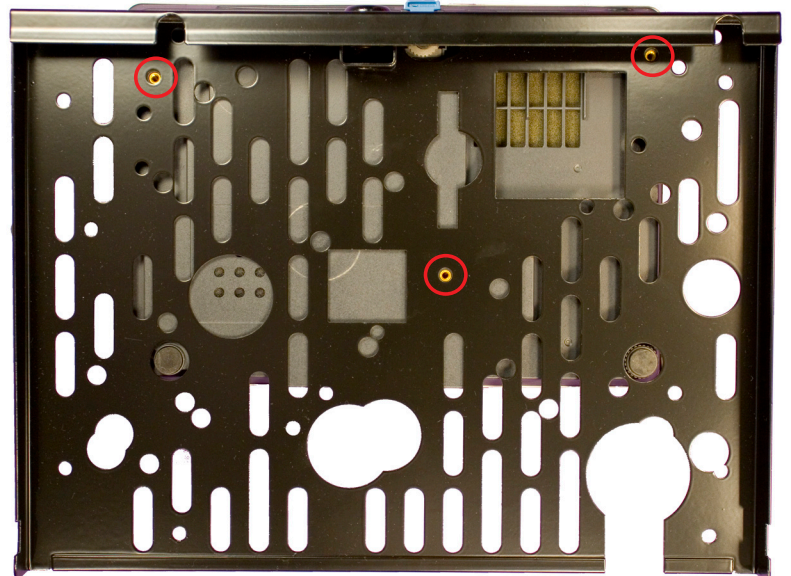

*Grid Plate Alignment*

**HARDWARE**

Mounting Inserts:

- #10 SAE Flat Washers (Qty 3)
- 4mm X 10mm Pan Head Metric Screws (Qty 3)

**Epson Projector Model#  
S5, 77c, 83+, 822+, 400W**

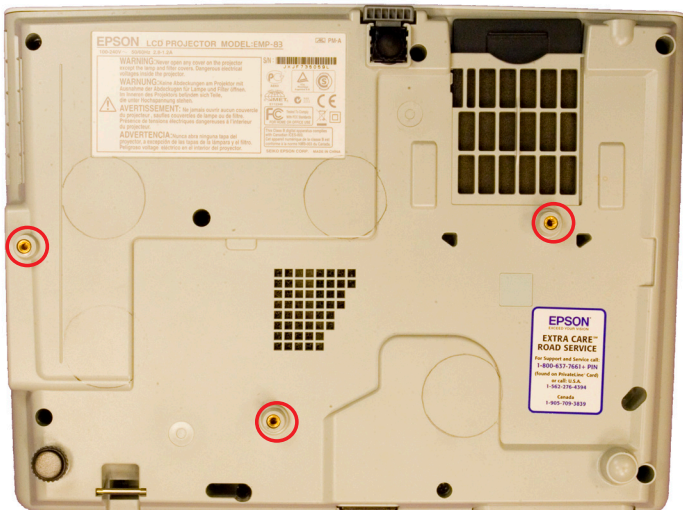

*Mounting Inserts*

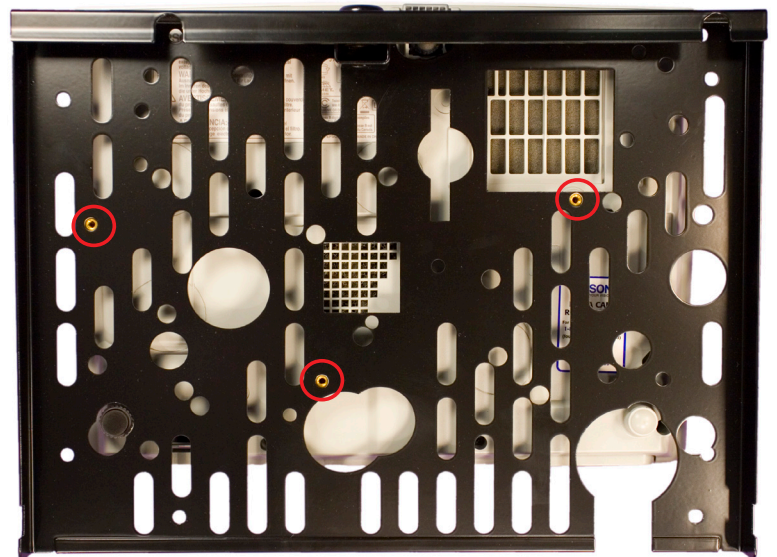

*Grid Plate Alignment*

**HARDWARE**

Mounting Inserts:

- #10 SAE Flat Washers (Qty 3)
- 4mm X 10mm Pan Head Metric Screws (Qty 3)
- 4mm X 20mm Pan Head Metric Screws (Qty 3) (400W model only)
- 3/8 Spacers (Qty 3) (400w model only)



**Epson Projector Model#  
6110i**

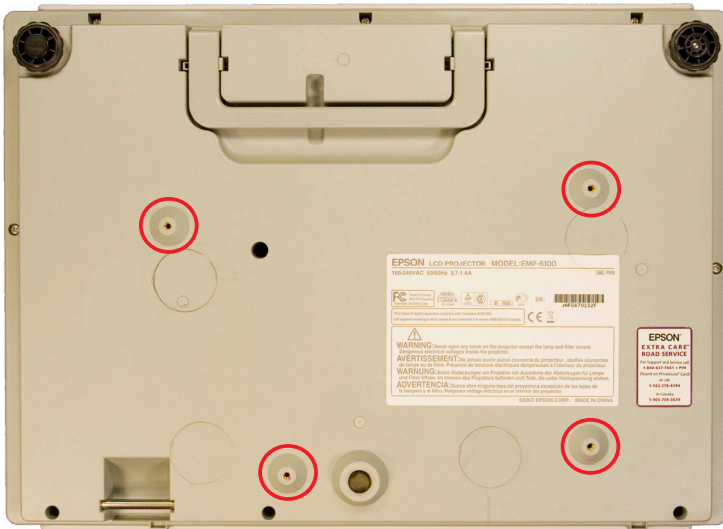

*Mounting Inserts*

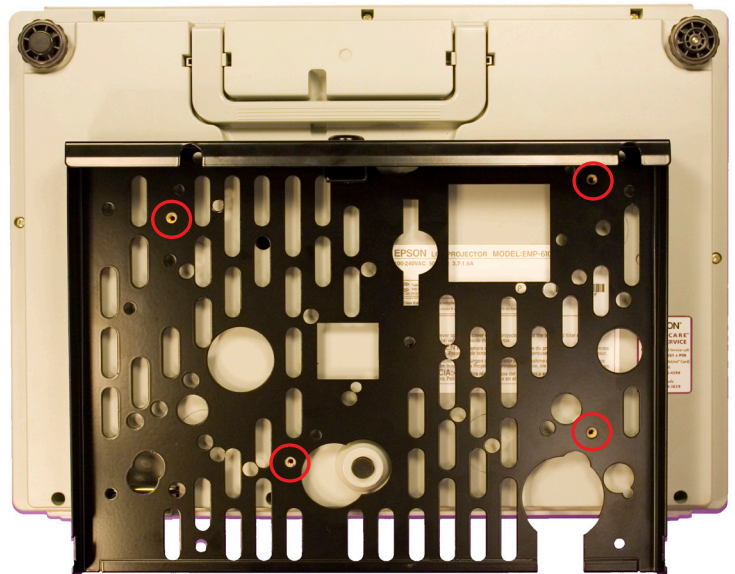

*Grid Plate Alignment*

**NOTE:** For updated information on compatibility with the latest Epson projector models, visit [www.epson.com](http://www.epson.com)"

**HARDWARE**

**Mounting Inserts:**

- #10 SAE Flat Washers (Qty 4)
- 4mm X 10mm Pan Head Metric Screws (Qty 4)

# Locking Grid Plate to Receiver Tray

1. After the Receiver Tray (E) has been attached to the ceiling and the projector has been attached to the Grid Plate (F), slide the Grid Plate (F) into the Receiver Tray (E).

Before completely closing the mount, route the cables that are running down the 1-1/2" Pipe (A) and out the center of the Receiver Tray (E). (See figure 6)

Slide the Grid Plate (F) in while guiding the cables into a slot located in the back of the Grid Plate (F). (See figure 7)

2. Put the Screw Lock (I) into the Grid Plate (F) and turn clockwise until it is snug.  
**WARNING: DO NOT OVER TIGHTEN THE LOCK.**

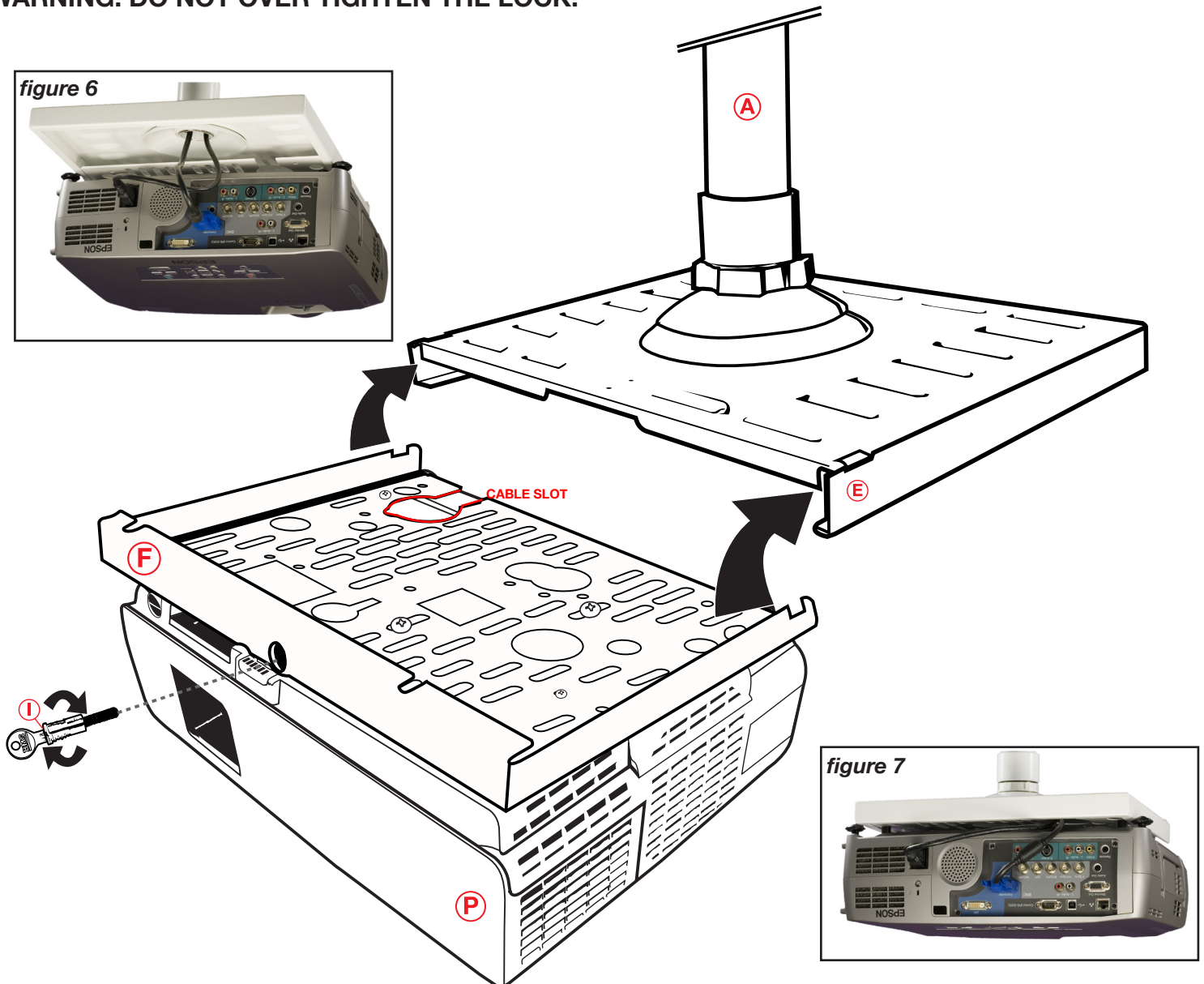

---

# Adjusting Mount

1. To align the projector, simply grab a hold of either side of the mount and gently adjust by lifting up and pushing down until you have the proper registration. If you wish to add or lessen the tension, turn the Tension Ring until the desired amount has been achieved. The Tension Ring can be turned to lock in the registration once the installation is complete.

