

Simplicity

36" ROTARY SNOW BLOWER

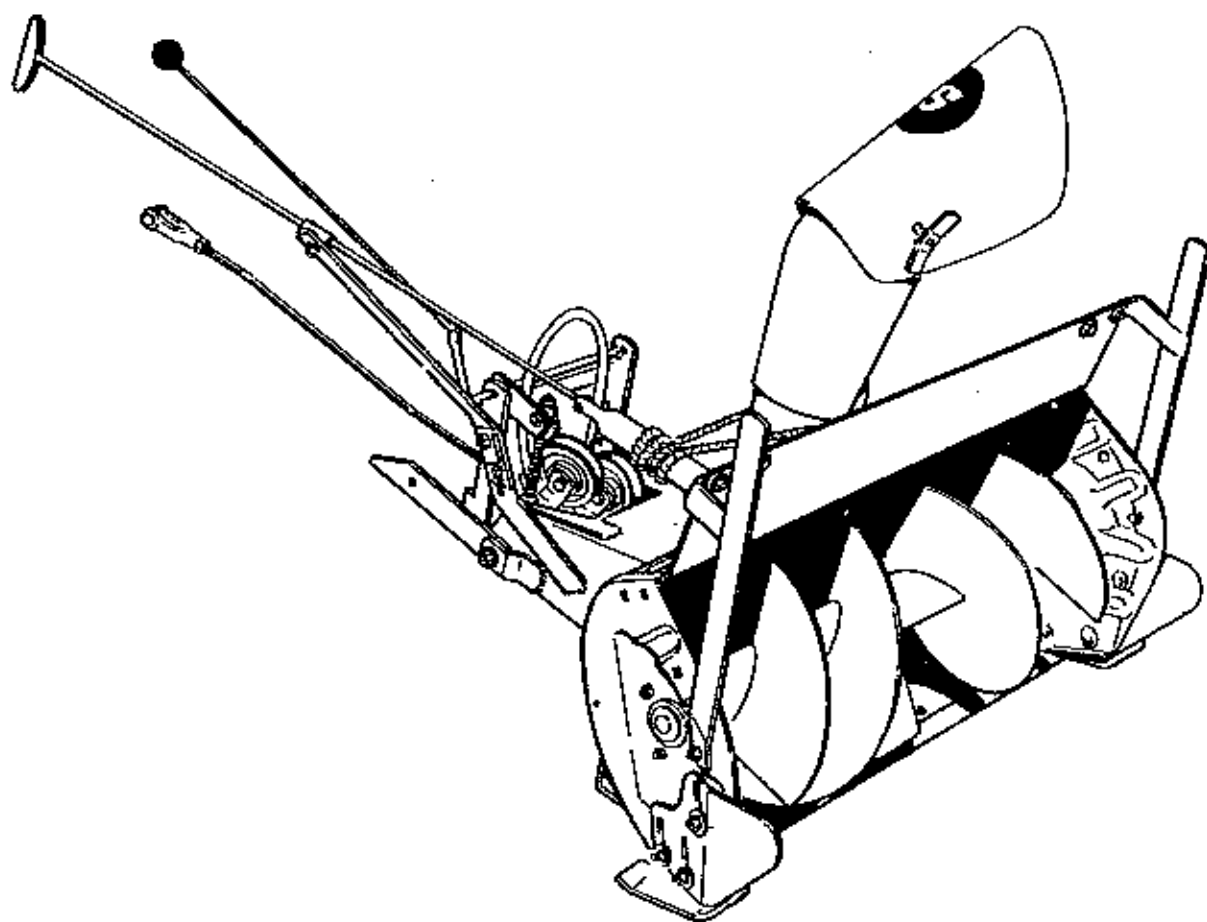

Mfrs. No. 345

1968 MODEL YEAR

7 1 1 5

SIMPLICITY MANUFACTURING COMPANY, INC.

TP - 1269

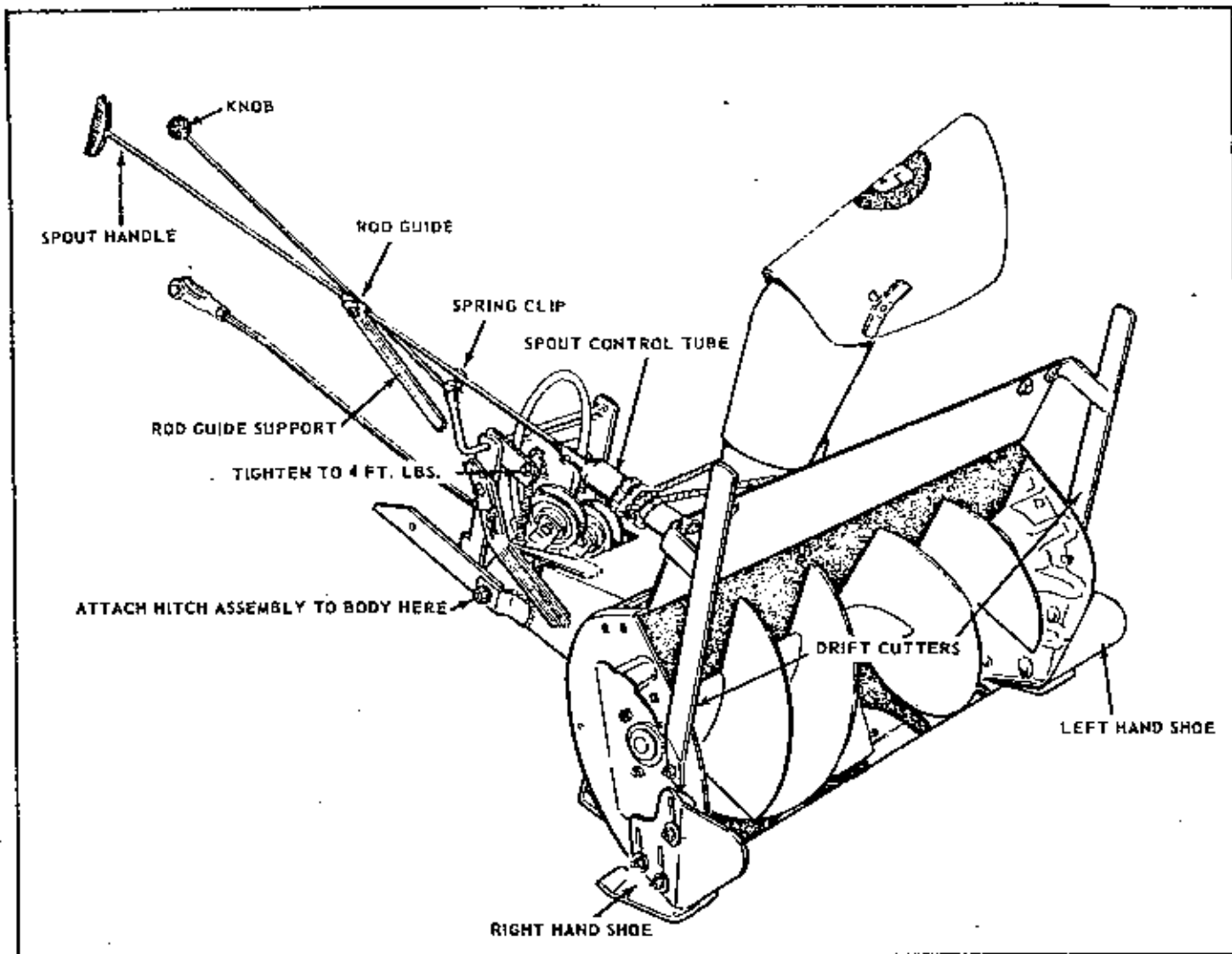

FIGURE 1

ASSEMBLY

1. Attach the Left and Right Hand Shoe to the body assembly with the 3/8-16NC-3/4 long carriage bolt, 3/8 plain and 3/8 lock washer. Secure with 3/8-16 NC hex full nut, which is on outside of shoe at desired elevation for your specific needs. See Figure #1.
2. Attach left and right hand drift cutters to the outside of body assembly with the 5/16-18NC-3/4 long hex capscrews, 5/16 plain and 5/16 lock washers. Secure with 5/16-18NC hex full nut. See Figure #1.
3. Attach hitch assembly to rotor body assembly with the 3/8-24NF-1-1/2 long hex head bolt, 3/8 plain and 3/8 spring washer. Secure in place with the 3/8-24NF hex full lock nut. See Figure #1. Tighten with sufficient pressure to keep Hitch from drooping when installing Blower to Tractor.
4. Place V-belt around pulley in rotor body housing. Position Belt Guard around pulley. Make sure guard hits underside of housing. (Ref. Letter AV Page 7)
5. Remove the 5/16-18-1-1/4" long hex capscrew lock and plain washer from tractor directly below the front mounted power take-off shaft. Insert through the two belt fingers and reassemble. **DO NOT TIGHTEN.** See Figure #2. Right hand belt finger next to bolt head. Left hand finger next to tractor.
6. Attach front mounted power take-off pulley #106761 to shaft. Secure the 3/8-24NF set screw down on the #159129 key. Position hub so 1/4" of Engine Shaft is exposed in front. See Figure #2.
7. Attach hitch assembly to tractor with the two pins and two spring clips. See Figure #2.
8. Place belt around front mounted power take-off pulley. See Figure #2.
9. Adjust belt fingers approximately 1/16" from belt when engaged. Secure the 3/16-18 x 1-1/4 long capscrew.
10. Apply a light coating of oil to the neck of the discharge spout. Install spout and extension as shown.

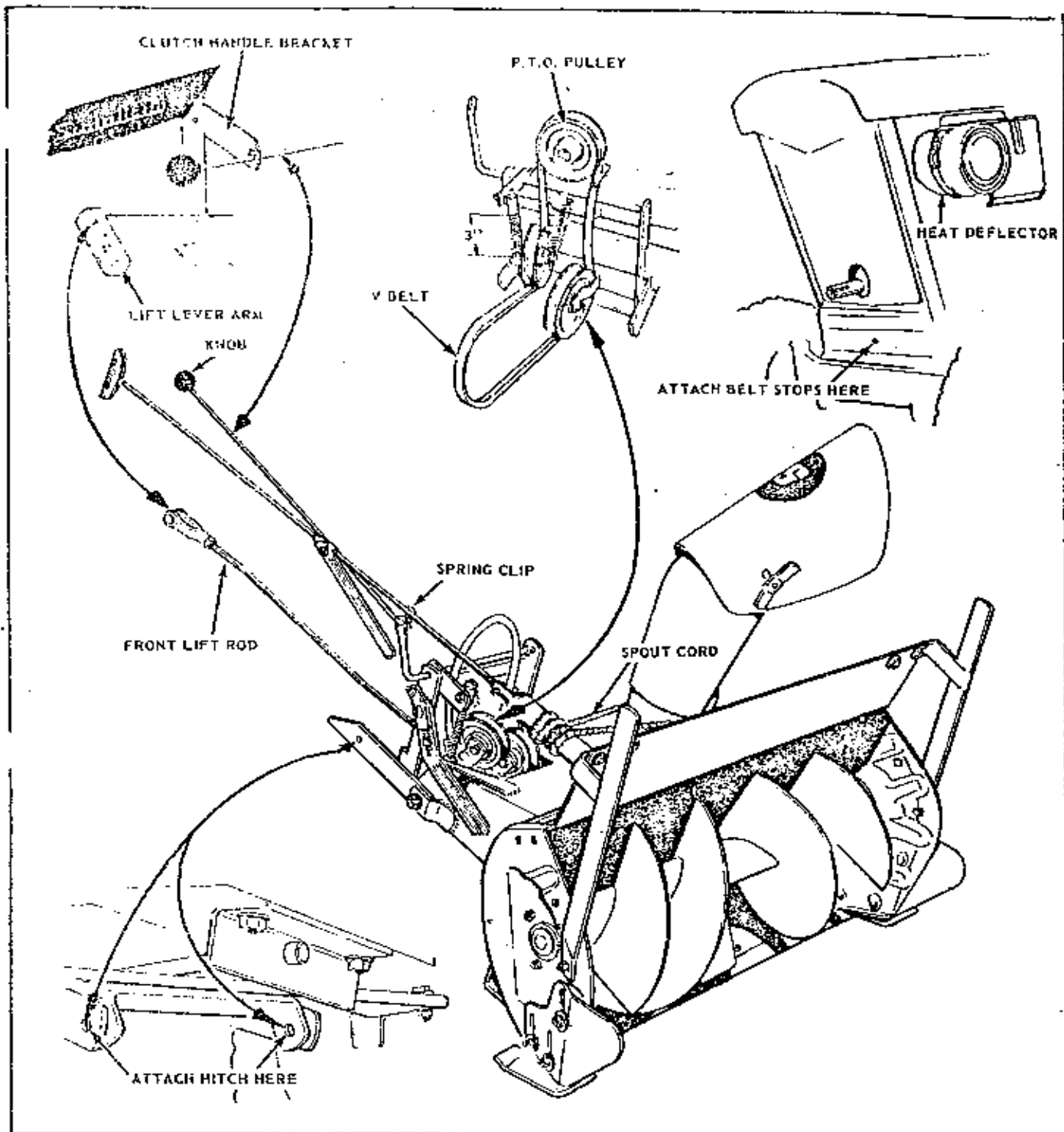

FIGURE 2

11. Attach rod guide support to top hole of lift rod bracket with 3/8-16NC-1-1/4 long capscrew, 3/8 lock washer and 3/8-16NC hex full nut. DO NOT TIGHTEN. See Figure #1.

12. Insert handle assembly into spout control tube assembly and secure with the 5/32 x 1" long cotter pin. Insert spout control tube assembly into bearing and secure in place with 2-1/8" x 3/4" long cotter pins. Insert handle assembly through rod guide. Install rod guide as shown. Tighten the 3/8-16NC hex full nut on rod guide support which is in top hole of lift rod bracket, at desired angle of the

operator while on seat. See Figure #1.

13. Position discharge spout directly forward. Position control tube so that the cord clamp faces away from the side of the spout. Provide one (1) coil on top and one (1) coil on bottom. Position the free ends of the cord around the spout and the clamp securely into position after removing all slack from the cord. The end of the cord closest to operator passes under the tube, end away from operator passes over the top of tube. See Figure #2.

14. Remove forward, top capscrew from right hand side panel. Insert clutch handle bracket between side panel and side member of fuel tank and steering post

support assembly. Secure with same capscrew and lockwasher. See Figure #2.

15. Insert clutch control rod through bracket and attach to clutch pivot and secure in place with spring clip. See Figure #2.

16. The lift lever quadrant on the side of the tractor contains a series of holes and a pin. Place the pin in the foremost hole of the quadrant and secure in place with spring clip. Release the lift lever and place in a forward position. Attach the yoke end of front lift rod to the lift lever arm using top hole, on the right hand side of the tractor, with yoke pin and spring clip. Insert lower end of lift rod into lift arm bracket of push bar and secure with spring clip. The lower end of the front lift rod is to point away from the tractor. See Figure #2.

At this point when the lift lever is about 1/4" away from the pin in the quadrant, the rotor housing should be in contact with the ground. This will allow the plow to follow the contours of the surface being plowed but the quadrant pin will prevent the lift lever from latching in the forward position if the plow is driven over a curbing.

17. Position heat deflector over the muffler and adjacent to the engine. Flap of deflector to be positioned against air cleaner. Secure with clamp provided. See Figure #2.

This deflector is provided for winter use only and must be removed in warm weather to prevent overheating and damaging of engine. The deflector directs a flow of warm air around the carburetor and allows for more efficient winter operation of the tractor engine.

ADJUSTMENT OF BELTS

With belt disengaged, the spring (Ref. letter AH Page 6) should be compressed to 3". See Fig. #2. Additional adjusting must be done by repositioning Set Collar. (Ref. Letter AF Page 6). If adequate belt slack cannot be achieved, only then, it is recommended to reposition Bearing Housing (Ref. Letter AL Page 7) towards operator.

OPERATION (For 9H.P. & Up)

Engagement of snow thrower is accomplished by pushing the clutch handle forward. Pull knob to operator for disengagement. IT IS IMPORTANT to maintain constant torque on the nut (Ref. letter AP Page 6). This will keep snow thrower disengaged when clutch handle is in the disengaged position.

For Previous Models - CLUTCH HANDLE BRACKET does not have a mount for the clutch handle. Engagement & disengagement must be accomplished with operator off of tractor seat.

LUBRICATION

There is one grease fitting on this snow thrower. (See Ref. letter AN on Page 7) Lubricate with a general purpose automotive type grease every 15 hours of operation. Remove chain guard (Ref. letter AS Page 7) and apply a coating of grease on chain every 15 hrs. also the occasional application of light motor oil as indicated on Page 6 will assist in operation of this thrower.

SAFE SNOW REMOVAL IS NO ACCIDENT

Improper use of snow removal equipment on the part of the operator can result in injury. To reduce this possibility, give complete and undivided attention to the job at hand.

PROTECT YOURSELF AND OTHERS BY FOLLOWING THESE SAFETY TIPS

1. Disengage power and stop motor before cleaning discharge, removing obstacles, making adjustments, or when leaving operating position.
2. Never direct discharge at bystanders nor allow anyone in front of machine---debris may be hidden in the snow.
3. Keep children and pets a safe distance away.
4. Do not allow children to operate machine nor allow adults to operate it without proper instruction.
5. Adjust height to clear gravel or crushed rock surface.
6. Exercise caution to avoid slipping or falling, especially when operating in reverse.
7. Know the controls and how to stop quickly---read the owner's manual.
8. Handle gasoline with care---it is highly flammable.
 - A. Use approved gasoline container.
 - B. Never add gasoline to a running motor---fill tank out of doors and wipe up spilled gasoline.
 - C. Replace gasoline cap securely.
 - D. Open doors if motor is run in garage---exhaust gases are dangerous.
9. Disengage all clutches and shift into neutral before starting motor. Keep hands, feet and clothing away from power driven parts.
10. Use a grounded three wire extension cord for all plug-in electric units.
11. Keep machine in good operating condition and keep safety devices in place.

HITCH & PULLEY GROUP

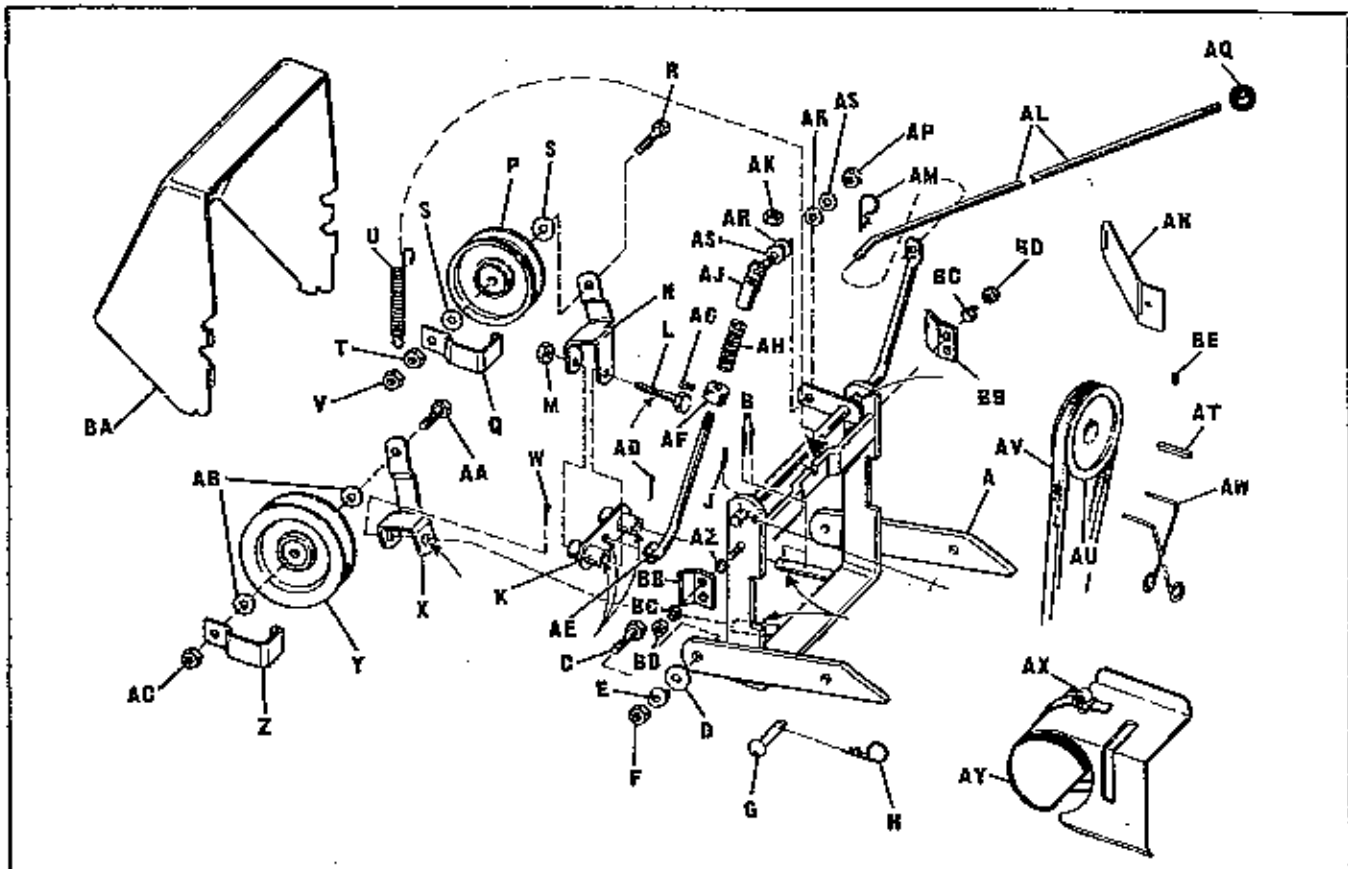

Ref. Let.	Part No.	Description
A	106726	Hitch Assembly
B	722006	Cotter Pin, 1/8" Dia. x 1"
C	121184	Hex. Cap Screw
D	719001	Plain Washer, 3/8"
E	721701	Spring Washer, 3/8"
F	717515	Full Lock Hex Nut, 3/8"-24
G	118053	Pin
H	106788	Spring Clip
J	722006	Cotter Pin, 1/8" Dia. x 1"
K	106674	Lever Ass'y Idler
L	705003	Hex. Cap Screw
M	717510	Full Lock Hex. Nut, 3/8"-16
N	106695	Idler Bracket
P	106716	Idler Pulley
Q	106717	Guide Belt
R	705009	Hex. Cap Screw, 3/8"-16 x 1-1/2"
S	719002	Plain Washer, 5/16"
T	717013	Hex. Jam Nut
U	106681	Return Spring
V	717510	Full Lock Nut, Hex. 3/8"-16
W	722006	Cotter Pin, 1/8" Dia. x 1"
X	106694	Idler Bracket
Y	101096	Idler Pulley
Z	106690	Belt Guide
AA	705016	Hex. Cap Screw, 3/8"-16 x 1-1/4"
AB	719002	Plain Washer, 5/16"
AC	717510	Full Lock Nut, Hex. 3/8"-16

Ref. Let.	Part No.	Description
AD	722001	Cotter Pin, 3/32" Dia. x 3/4"
AE	106770	Clutch Rod
AF	8191022	Set Collar
AG	713001	Set Sq. Hd. Cap Pt. Screw, 1/4"-20 x 3/8" lg.
AH	8191045	Spring
AJ	106768	Rod Assembly Guide
AK	717511	Hex. Full Lock Nut, 5/16"-18
AL	106710	Clutch Handle
AM	106787	Spring Clip
AN	106687	Bracket
AP	717525	Nut, Stop, 5/16"-18
AQ	122005	Knob
AR	159134	Nylon Washer
AS	719002	Plain Washer, 5/16"
AT	159129	Key
AU	106761	Engine Pulley
AV	106769	V-Belt
AW	106707	Belt Stop
AX	106692	Deflector Clamp
AY	106789	Heat Deflector
AZ	106731	Spacer
BA	106730	Cover, Pulley
BB	106728	Clip, Pulley Cover
BC	157127	Spring, Concial
BD	717511	Hex. Full Lock Nut, 5/16"-18
BE	715049	Set Screw

ROTOR, BODY & DRIVE GROUP

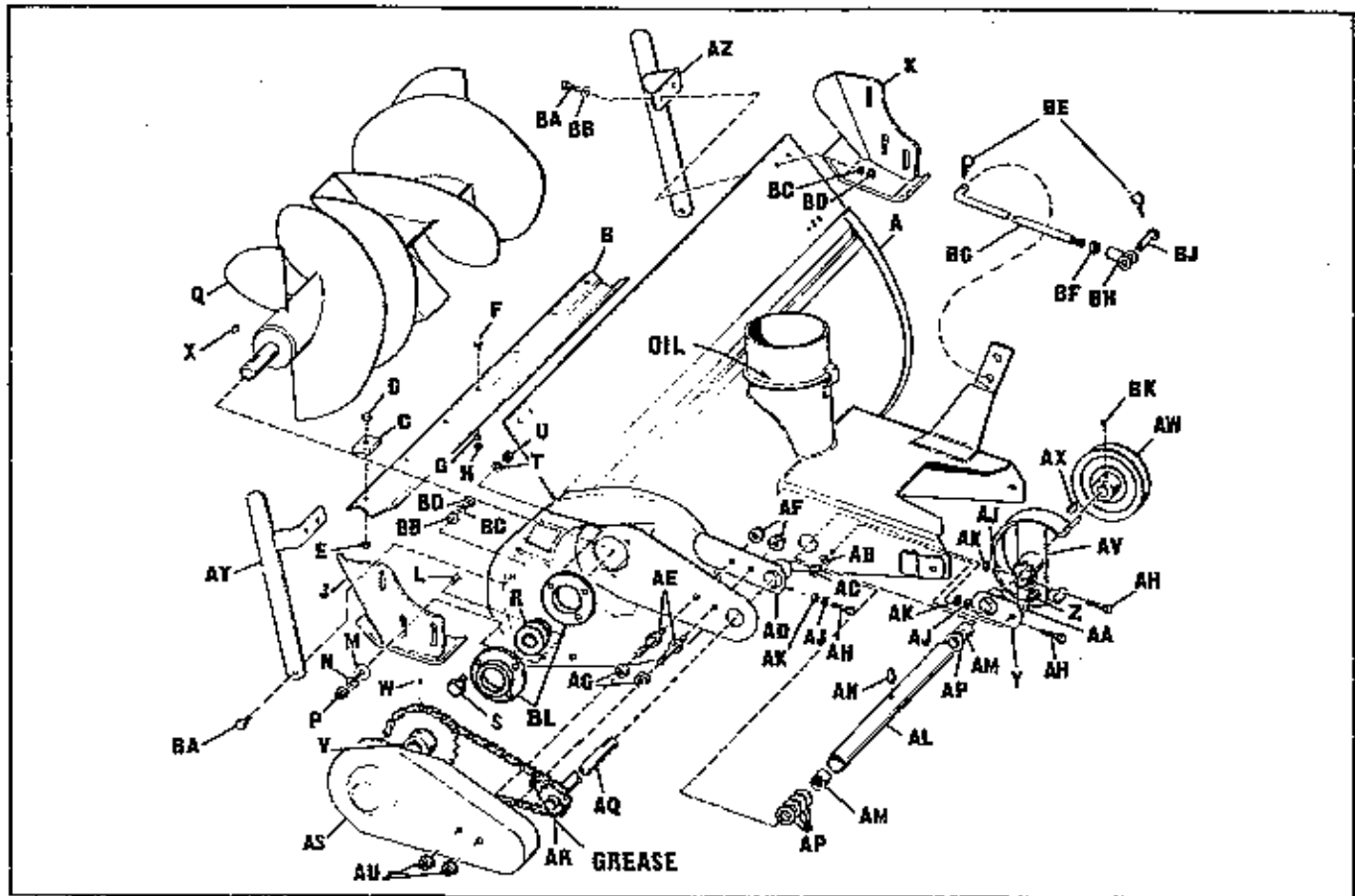

Ref. Let.	Part No.	Description	Ref. Let.	Part No.	Description
A	106645	Body Ass'y.	AG	717510	Full Lock Hex. Nut, 3/8"-16
B	106438	Scraper Body	AH	705018	Hex. Cap Screw, 5/16"-18 x 1-1/2"
C	106137	Scraper Clamp	AJ	720001	Lock Washer, 5/16"
D	715073	Hex. Cap Screw, 5/16"-18 x 7/8"	AK	717001	Full Hex. Nut, 5/16"-18
E	717511	Full Lock Hex. Nut, 5/16"-18	AL	106656	Bearing Housing
F	715018	Hex. Cap Screw, 1/4"-20 x 5/8"	AM	154258	Needle Bearing
G	720003	Lock Washer, 1/4"	AN	727002	Grease Fitting
H	717005	Full Hex. Nut, 1/4"-20	AP	8061012	Washer
J	106610	Shoe Ass'y L.H.	AQ	106557	Shaft Ass'y
K	106612	Shoe Ass'y R.H.	AR	106058	Chain
L	703004	Bolt-Carriage 3/8"-16 x 3/4"	AS	106659	Chain Guard
M	719001	Plain Washer, 3/8"	AU	718035	Whiz-Lock 3/8-16
N	720002	Lock Washer, 3/8"	AV	106660	Guard Ass'y, Belt
P	717003	Full Hex. Nut, 3/8"-16	AW	106663	Pulley
Q	106047	Rotor Ass'y	AX	725003	Key, 3/16" x 3/4" Dia.
R	106732	Bearing Cartridge	AY	106146	Cutter Ass'y L.H.
S	705017	Hex. Cap Screw, 5/16"-18 x 3/4"	AZ	106149	Cutter Ass'y R.H.
T	720001	Lock Washer, 5/16"	BA	705017	Hex. Cap Screw, 5/16"-18 x 3/4"
U	717001	Full Hex. Nut, 5/16"-18	BB	719002	Plain Washer, 5/16"
V	106653	Rotor Sprocket	BC	720001	Lock Washer, 5/16"
W	713503	Set Screw, 5/16"-18 N.C. x 5/16"	BD	717001	Full Hex. Nut, 5/16"-18
X	151040	Hi-Pro Key	BE	106788	Spring Clip
Y	106476	Support Ass'y Clamp	BF	717008	Full Hex. Nut, 1/2" x 20
Z	705005	Hex. Cap Screw, 3/8"-16 x 1"	BG	106773	Front Lift Rod
AA	719001	Plain Washer, 3/8"	BH	154304	Adjusting End Yoke
AB	720002	Lock Washer, 3/8"	BJ	154305	Yoke Pin
AC	717003	Full Hex. Nut, 3/8"-16	BK	713503	Set Screw, 5/16"-18 x 5/16"
AD	106479	Support Ass'y Clamp	BL	161069	Bearing Flange
AE	106481	Stud			
AF	718035	Nut, Flange "Whiz Lock", 3/8"-16			

SPOUT GROUP

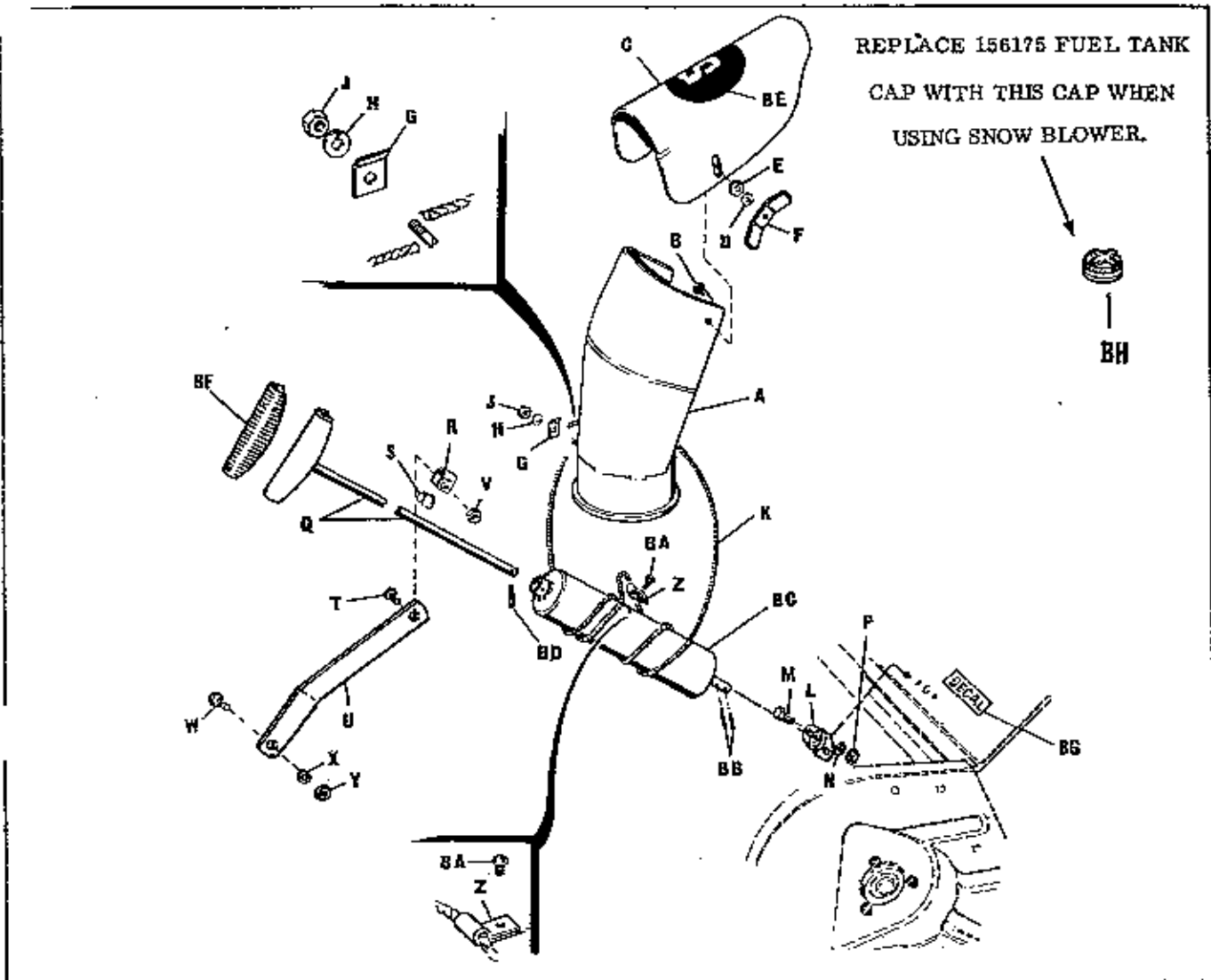

Ref. Let.	Part No.	Description
A	106338	Spout Assembly
B	703005	Carriage Bolt, 5/16"-18 x 3/4"
C	106489	Spout Extension
D	719001	Plain Washer, 3/8"
E	721601	Special Hex. Lock Washer, 3/8"
F	106229	Wing Nut
G	121042	Plate
H	720001	Lock Washer, 5/16"
J	717001	Full Hex. Nut, 5/16"-18
K	106592	Spout Cord
L	106491	Bearing
M	705015	Hex Capscrew, 1/4"-20 x 5/8"
N	720003	Lock Washer, 1/4"
P	717005	Full Hex. Nut, 1/4"-20
Q	106864	Handle
R	152050	Rod Guide

Ref. Let.	Part No.	Description
S	121175	Guide Liner
T	705019	Hex. Capscrew, 5/16"-18 x 1-1/4"
U	106606	Rod Guide Support
V	717511	Full Hex. Lock Nut, 5/16"-18
W	705016	Hex. Capscrew, 3/8"-16 x 1-1/4"
X	720002	Lockwasher, 3/8"
Y	717003	Hex. Nut, 3/8"-16
Z	154247	Clamp
BA	714016	Self-Tapping Screw, 1/4"-20 x 1/2"
BB	722016	Cotter Pin, 1/8" x 3/4"
BC	106603	Control Tube, w/Socket
BD	722015	Cotter Pin, 5/32" x 1"
BE	106512	Decal
BF	106516	Cover Handle
BG	103031	Safety Decal
BH	106798	Cap-Fuel, Tank

1
2
3
4
5
6
7
8
9
10
11
12
13
14
15
16
17
18
19
20
21
22
23
24
25
26
27
28
29
30
31
32
33
34
35
36
37
38
39
40
41
42
43
44
45
46
47
48
49
50
51
52
53
54
55
56
57
58
59
60
61
62
63
64
65
66
67
68
69
70
71
72
73
74
75
76
77
78
79
80
81
82
83
84
85
86
87
88
89
90
91
92
93
94
95
96
97
98
99
100

1
2
3
4
5
6
7
8
9
10
11
12
13
14
15
16
17
18
19
20
21
22
23
24
25
26
27
28
29
30
31
32
33
34
35
36
37
38
39
40
41
42
43
44
45
46
47
48
49
50
51
52
53
54
55
56
57
58
59
60
61
62
63
64
65
66
67
68
69
70
71
72
73
74
75
76
77
78
79
80
81
82
83
84
85
86
87
88
89
90
91
92
93
94
95
96
97
98
99
100