

Simplicity

Sno-Away.

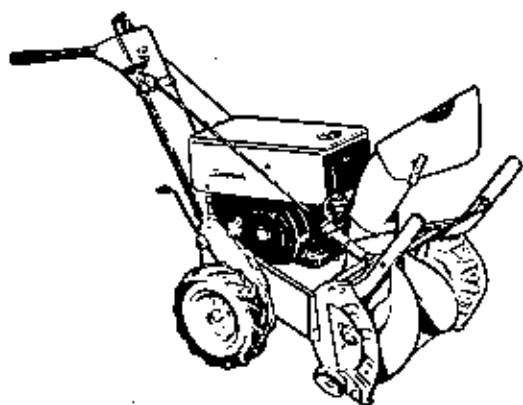

6 hp Mfg's. 428-RUBBER TIRES

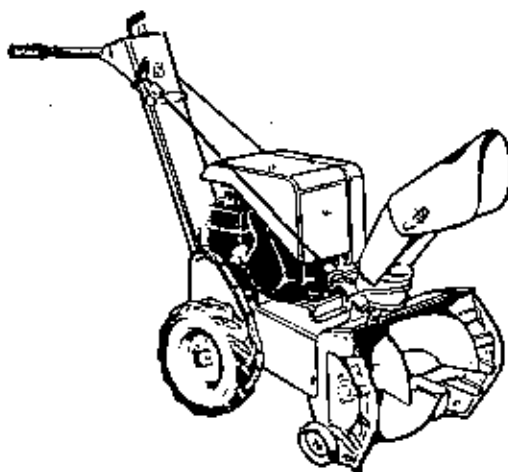

4 hp Mfg's. 426-RUBBER TIRES

SIMPLICITY MANUFACTURING COMPANY,

1288

Litho. in U.S.A.

SAFE SNOW REMOVAL IS NO ACCIDENT

Improper use of snow removal equipment on the part of the operator can result in injury. To reduce this possibility, give complete and undivided attention to the job at hand.

Protect Yourself and Others By Following These Safety Tips

1. Disengage power and stop motor before cleaning discharge, removing obstacles, making adjustments, or when leaving operating position.
2. Never direct discharge at bystanders nor allow anyone in front of machine -- debris may be hidden in the snow.
3. Keep children and pets a safe distance away.
4. Do not allow children to operate machine nor allow adults to operate it without proper instructions.
5. Adjust height to clear gravel or crushed rock surface.
6. Exercise caution to avoid slipping or falling, especially when operating in reverse.
7. Know the controls and how to stop quickly -- read the owner's manual.
8. Handle gasoline with care -- it is highly flammable.
 - a. Use approved gasoline container.
 - b. Never add gasoline to a running motor -- fill tank out of doors and wipe up spilled gasoline.
 - c. Replace gasoline cap securely.
 - d. Open doors if motor is run in garage -- exhaust gases are dangerous
9. Disengage all clutches and shift into neutral before starting motor. Keep hands, feet and clothing away from power driven parts.
10. Use a grounded three wire extension cord for all plug-in electric units.
11. Keep machine in good operating condition and keep safety devices in place.



Remember...

FOR YOUR SAFETY

- 1 ALWAYS STOP ENGINE BEFORE LEAVING MACHINE
- 2 ALWAYS STOP ENGINE BEFORE SERVICING OR ADJUSTING MACHINE OR EQUIPMENT
- 3 ALWAYS KEEP HANDS FEET AND CLOTHING AWAY FROM POWER DRIVEN PARTS

COUNTER-WEIGHT KIT

Article No. 260

For added traction in extreme icy conditions, and added handling ease, the above counterweight kit is available as optional equipment.

The bracket and weight are attached as shown in Fig. 7.

Order Steel Lug Wheels by Article Number 257.
Order Rubber Tire Wheels by Article Number 258.
Order Tire Chains for Rubber Tire Wheels only, by Article Number 259.

ASSEMBLY

To assemble the Sno-Away, the following steps should be followed:

1. Fasten the handle assembly to the mounting brackets as shown at #1 in Fig. 1, using the 3/8-16 x 2" capscrews, flat washers, lockwashers and hex nuts.
2. The throttle cable assembly is coiled around the engine for shipping purposes. Uncoil the cable and attach to the housing assembly. The cable is held in place by the clamp on the lower portion of the right handle as shown at #2 in Fig. 1.
3. Insert the lower end of transmission shift rod through the hole in the shift lever and fasten in place with a cotter pin as shown in Fig. 1.

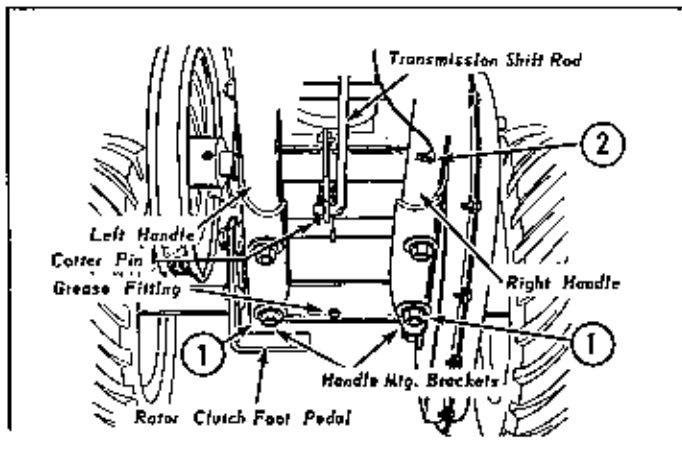

Figure 1

4. Insert the Touch-O-Matic extension wire through the wire clamp. For proper belt tension, adjust as shown in Fig. 2.

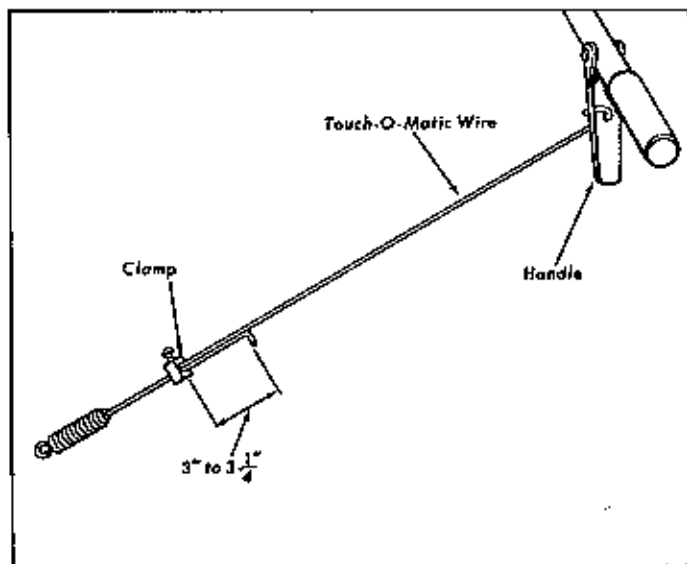

Figure 2

5. Attach the spout control cable as shown in Fig. 3. Insert the lower end of the spout control rod in the nylon bearing on the blower housing and hold in place with two cotter pins. The spout control rod support bracket is mounted in a reverse position for shipping purposes. Detach and mount as shown in Fig. 4. Tighten clamp as necessary to hold spout in desired position.

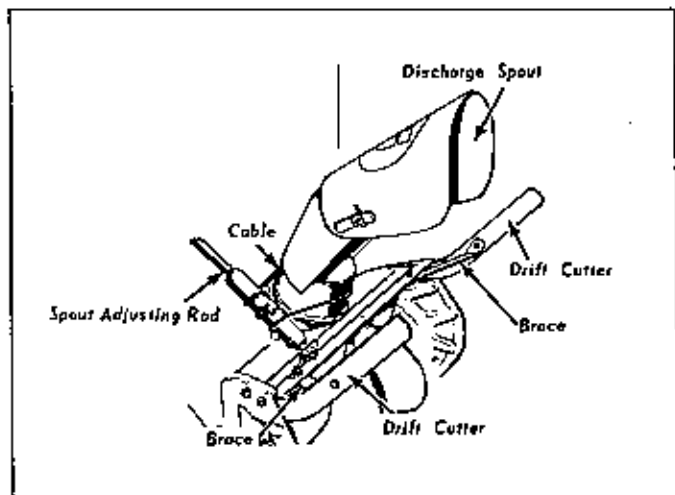

Figure 3

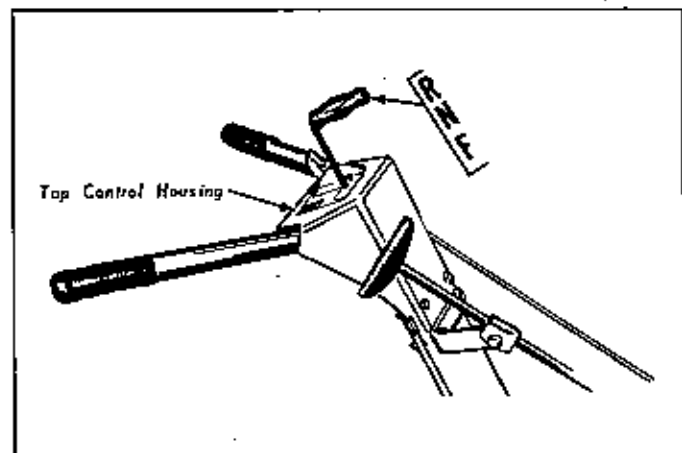

Figure 4

6. The 26" Sno-Away has as standard equipment, two drift cutters which are to be attached to the rotor housing. Assemble the right hand and left hand drift cutter loosely to the rotor housing as shown in Fig. 3, using two 3/8"-16 x 3/4" long hex capscrews and 3/8" lockwashers and 3/8"-16 hex nuts. Note that the cutters are attached to the inside surface of the rotor housing and the heads of the capscrews are on inside of rotor housing also. Loosely attach right hand and left hand cutters to inside top front edge of rotor housing with 5/16" -18 x 3/4" long hex cap screw, 5/16" lockwasher, and 5/16"-18 hex nut. Refer to the exploded view parts drawing on Page 10 for the relative position of these drift cutters and braces.

7. Now attach the braces to the drift cutters, using 5/16"-18 x 3/4" long hex capscrews, 5/16" lockwashers, and 5/16"-18 hex nuts. Securely tighten all attaching nuts and capscrews that previously were left loose.

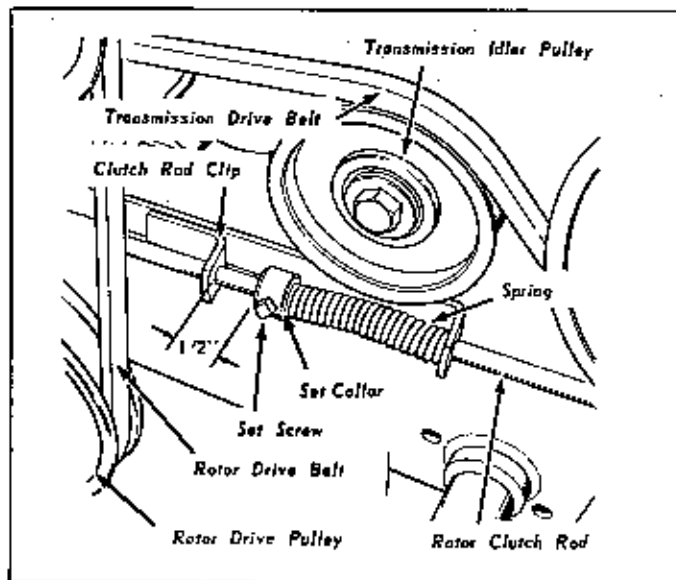

Figure 5

BELT TENSION

Belt tension for the rotor drive is regulated by the position of the set collar on the rotor clutch rod. Normally a clearance of 1/2" between the set collar and the clutch rod clip will properly tension this belt. Check this adjustment when the rotor clutch is engaged. Refer to Fig. 5.

Belt tension for transmission drive belt is regulated by the position of the wire clamp on the extension spring.

CHAIN TENSION

The tension on the rotor drive chain may be increased by loosening the two lock nuts "A" and turning the adjusting nuts "B" to the desired position. Be sure to retighten the lock nuts "A" after adjusting tension. Refer to Fig. 7.

BELT STOPS

On the drive pulley side of the engine, belt stops are mounted as shown in Fig. 7. Engage the rotor clutch and transmission clutch and check clearance between belts and belt stops. The belt stops will be properly adjusted when 1/16" clearance is visible between the stops and the belts. To adjust, loosen the hex capscrews and reposition the stops to proper clearance. Retighten hex capscrews to hold stops in proper position. Refer to Fig. 7.

LUBRICATION

The 23" Sno-Away is equipped with 4 grease fittings that require occasional lubrication with a general purpose automotive grease. The location of these fittings is shown in Figures 1, 6, & 7. The 26" Sno-Away has an additional fitting on the 2-speed axle cover. Refer to page 6 for oil draining procedure!

The bearings on the rotor shaft are a sealed type and do not require further lubrication. An occasional application

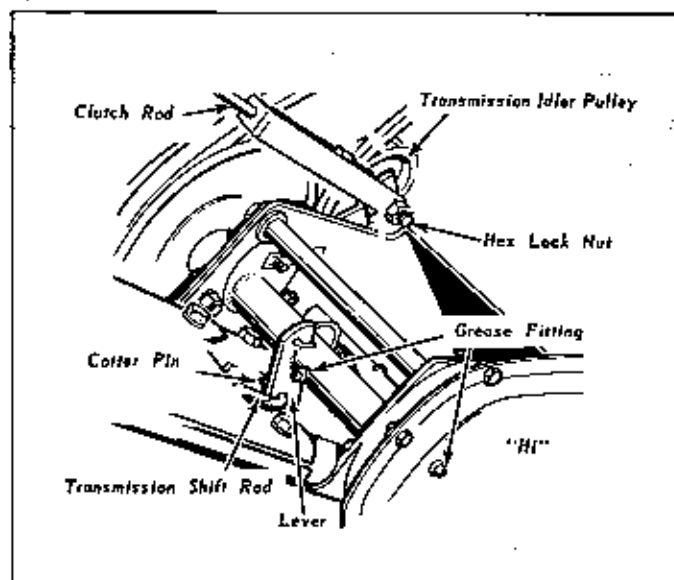

Figure 6

of light motor oil to the ends of the rotor shaft will aid in prolonging the life of the bearing seals.

OPERATION

Before attempting to start the engine or to operate the Sno-Away, refer to the engine manufacturers owners manual for the proper fuel, oil, and procedure for starting the engine.

The operation of the rotor is controlled by the rotor clutch. To engage the rotor clutch, raise the foot pedal shown in Fig. 7. To disengage the clutch, depress the foot pedal. Bear in mind that the rotor will operate independently of the forward travel of the Sno-Away, as long as the engine is running and the clutch is engaged. Exercise caution at all times, and never attempt to remove snow or ice from the rotor housing or discharge spout unless the engine is stopped and rotor clutch is disengaged. To stop the engine, move the throttle control lever all the way to the shut-off position.

If the engine fails to shut-off after moving the throttle control lever to the shut-off position, reposition the "shorting-wire" to make contact with the ignition shorting lever located on engine at end of throttle cable.

The direction of travel of the Sno-Away is controlled by the position of the transmission shift lever. Refer to Fig. 4. When shifting the transmission, always release Touch-O-Matic control. With the clutch disengaged, push down on the transmission shift lever and the transmission will shift into forward position and Sno-Away will travel forward when the clutch is engaged. To reverse the Sno-Away, disengage the clutch and pull up on shift lever and transmission will shift into the reverse position. Neutral position of the shift lever is half way between forward and reverse and the lever will be held in this position by a detent lever on the left side of the Sno-Away frame.

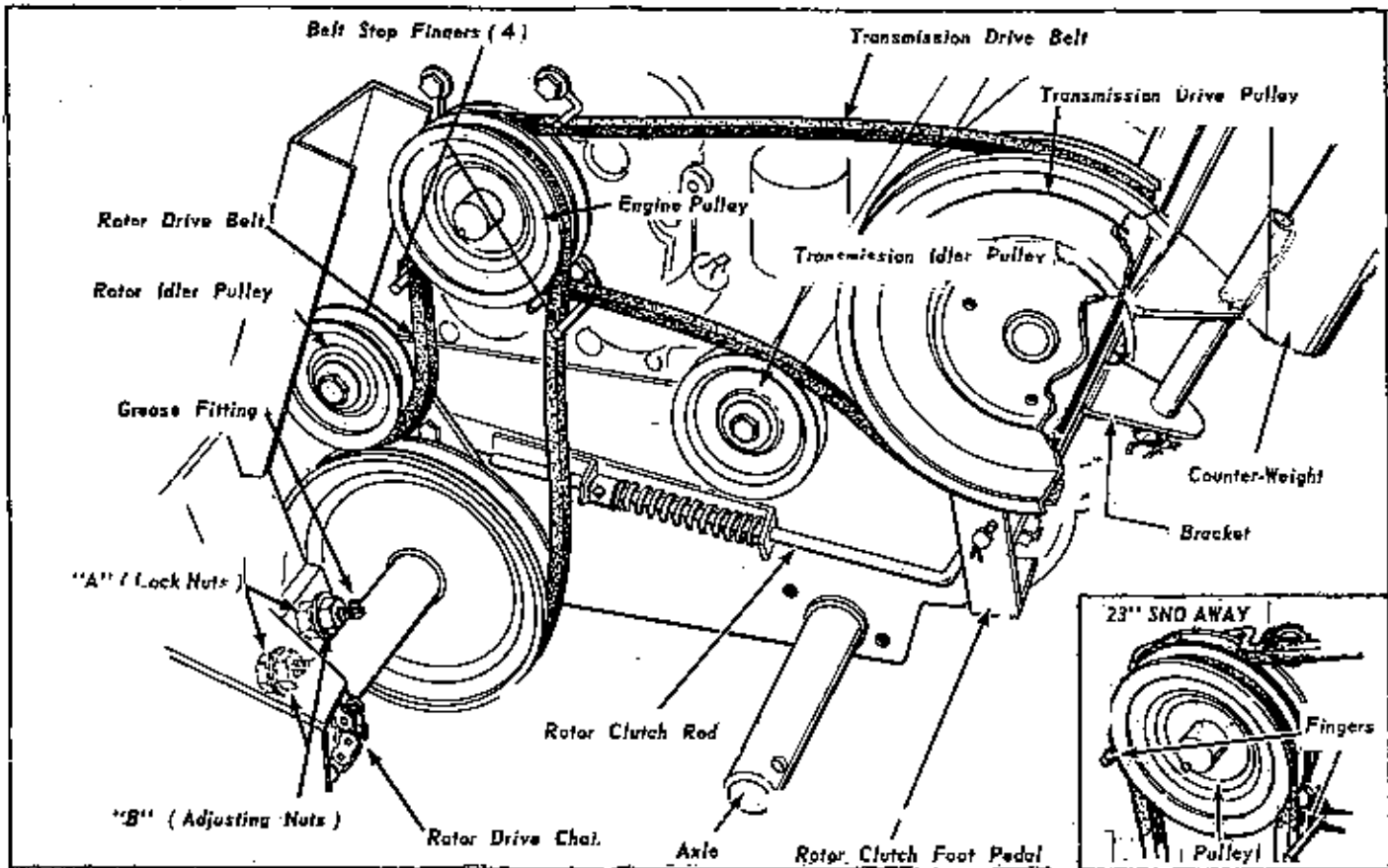

Figure 7

The roller wheels on each side of the rotor housing are adjustable either up or down to suit the surface over which the Sno-Away is to be operated. For smooth surface, loosen the nuts and set the shoes so that the lower edge of the rotor housing rides near the surface. For use over an uneven or rough surface adjust the shoes for maximum lift.

When using the Sno-Away, adjust the discharge spout so that the snow will be thrown with the wind and never into the wind. Throwing snow into the wind will be a source of discomfort to the operator. To alter the direction of discharge, rotate the spout by means of the spout adjusting handle. The distance that the snow may be thrown may be adjusted by loosening the two wing nuts on the discharge spout extension and raising or lowering the extension to give the desired angle. After adjusting, push the extension snugly against the spout assembly to prevent snow from being blown backwards against the engine and operator. Slotted holes beneath the wing nuts will allow this to be done before tightening the wing nuts to hold the extension in the desired position.

When operating the Sno-Away through heavy drifts of snow, depress the handles and raise the rotor housing while taking the first pass through the drift. Then back off and lower the rotor housing and go through again. After the first path through the drift has been opened, it may be convenient to use only a portion of the width of the plow on successive passes. Naturally, efficient plowing methods will vary from one snowfall to another and from location to location. The operator will soon learn to judge which methods produce the best results. When transporting the plow from one location to another, disengage the rotor clutch for safety.

IMPORTANT

After completion of plowing operation, allow the engine to operate in a sheltered area for about 5 minutes to dry itself and prevent the formation of ice. When possible, store the Sno-Away in a cold area so that clinging snow will not melt and re-freeze into ice.

OIL DRAINING PROCEDURE

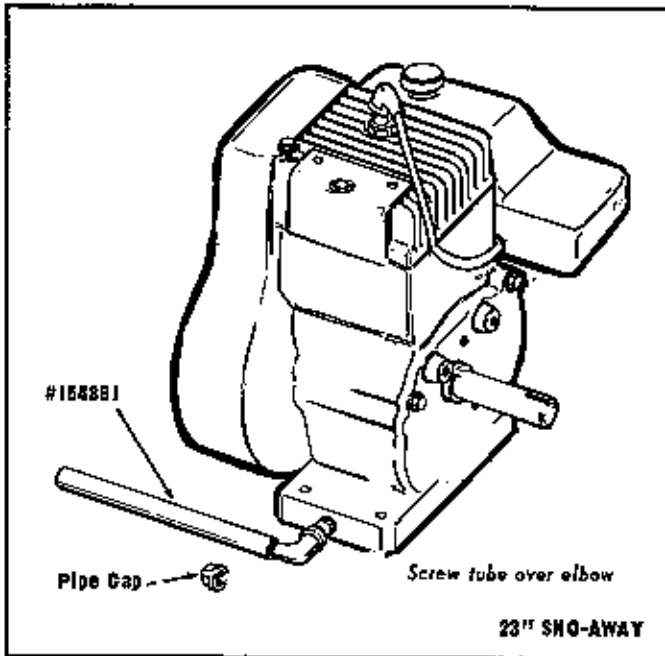

23" SNO-AWAY

1. Depress the handles toward the ground to effect a tilting of the engine, and, place a block or support under the blower housing to keep it tilted.
2. Remove the pipe cap from the end of the oil drain elbow.
3. Thread the plastic oil filler tube #154381 over the threaded end of the elbow until the threads of the elbow cut threads into the plastic tubing.
4. When the plastic tubing is firmly over the threaded end of the elbow, return the Sno-Away to its normal attitude and allow the oil to drain into a suitable container.
5. Refer to engine manufacturer's manual for proper grade and volume of oil for refilling engine crankcase.

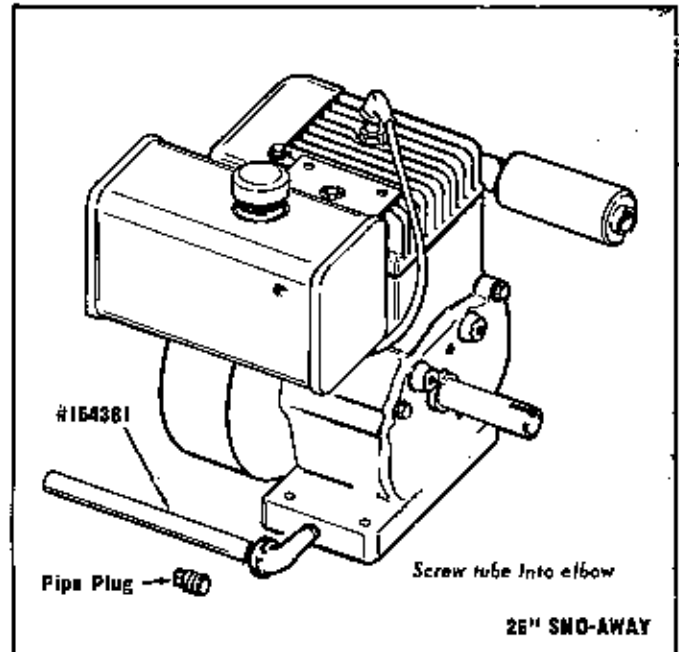

25" SNO-AWAY

1. Depress the handles toward the ground to effect a tilting of the engine, and, place a block or support under the blower housing to keep it tilted.
2. Remove the pipe plug from the oil drain elbow.
3. Thread the plastic oil filler tube #154381 into the opening in the elbow until the threads of the elbow cut threads on the plastic tubing.
4. When the plastic tubing is firmly in the elbow, return the Sno-Away to its normal attitude and allow the oil to drain into a suitable container.
5. Refer to engine manufacturer's manual for proper grade and volume of oil for refilling engine crankcase.

WARRANTY

The company warrants Simplicity Products to be free from defects in material and workmanship except the company makes no warranty express or implied with respect to tires, engines and engine accessories which generally are warranted by their respective manufacturers. Any part covered by this warranty which is proven defective within one year, under normal use, from date of purchase, will be replaced free of charge, f.o.b. Port Washington, Wisconsin, provided such part is returned to factory transportation charges prepaid and is found to be defective upon examination at the factory. The company is not obligated under this warranty to bear cost of labor or delivery charges in replacement of defective parts. This warranty does not apply to any Simplicity Products altered outside of Simplicity's factory. Such replacement of defective parts shall be the exclusive remedy and in no event shall Simplicity be liable for consequential damages. EXCEPT AS SPECIFICALLY PROVIDED HEREIN, THERE ARE NO WARRANTIES WHICH EXTEND BEYOND THE DESCRIPTION ON ANY SIMPLICITY PRODUCT.

SPOUT GROUP

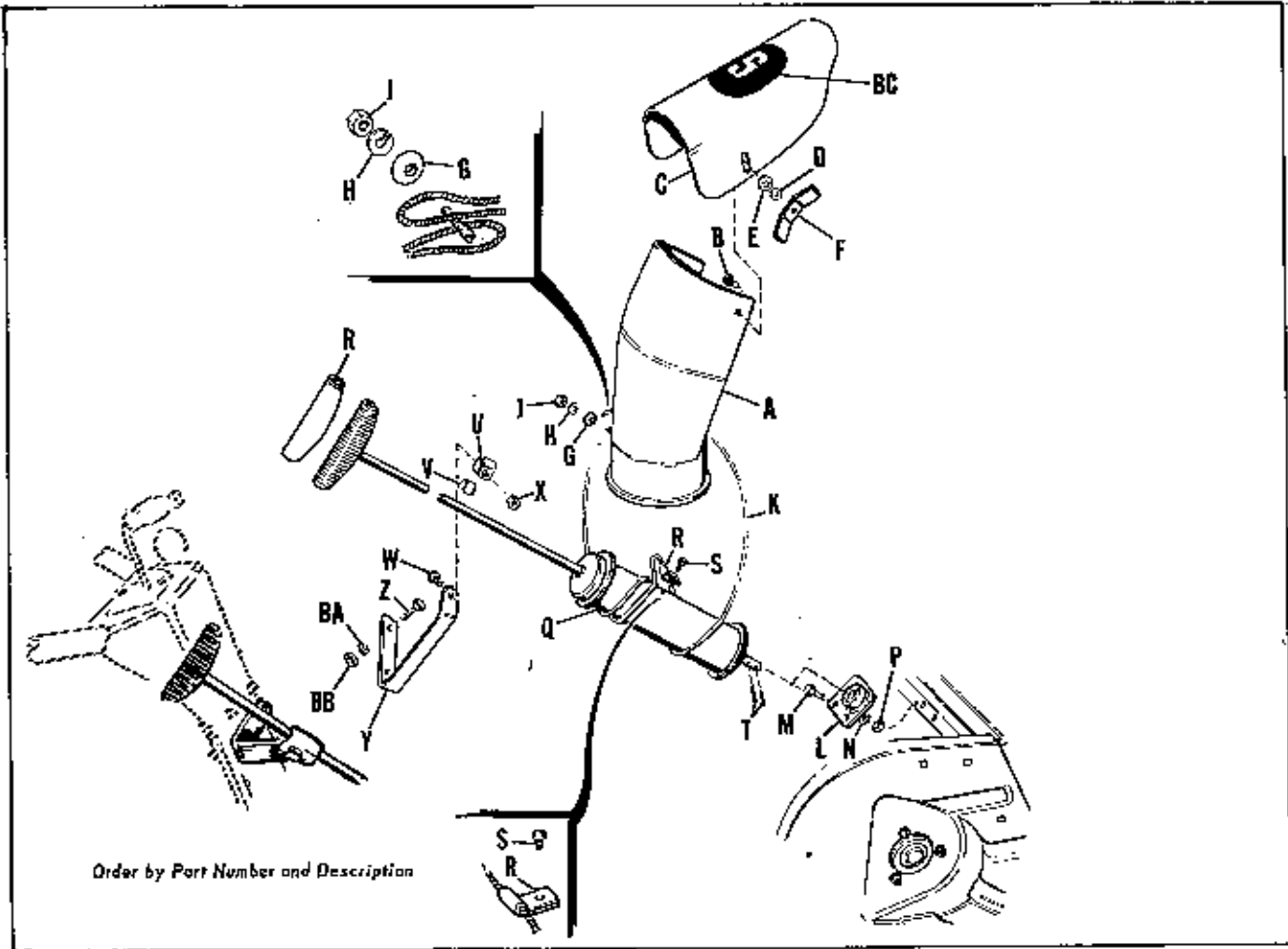

Order by Part Number and Description

REF. LET.	PART NUMBER		DESCRIPTION
	26" Sno Away	23" Sno Away	
A	106338	106338	Spout Assembly
B	703005	703005	Carriage Bolt, 5/16"-18 x 3/4" long
C	106489	106489	Spout Extension
D	719001	719001	Plain Washer, 3/8"
E	721601	721601	Lock Washer, 3/8"
F	106229	106229	Wing Nut
G	106785	106785	Cup Washer
H	720001	720001	Lock Washer, 5/16"
J	717001	717001	Hex Nut, Full, 5/16"-18
K	106784	106784	Cable Assy.
L	106551	106551	Bearing
M	705015	705015	Hex Capscrew, 1/4"-20 x 5/8" long
N	720003	720003	Lock Washer, 1/4"
P	717005	717005	Hex Nut, Full, 1/4"-20
Q	106791	106791	Tube Assembly, Spout Control
R	154247	154247	Cover, Handle
S	715067	715067	Self-Tapping Screw, 1/4"-20 x 3/8"
T	722009	722009	Cotter Pin, 1/8" x 3/4" long
U	106221	106221	Guide Rod
V	121175	121175	Liner, Guide
W	705019	705019	Hex Capscrew, 5/16"-18 x 1-1/4" long
X	717511	717511	Hex Nut, Full, Lock, 5/16"-18 NC
Y	106521	106521	Support, Spout Adj. Rod
Z	705053	705053	Hex Capscrew, 1/4"-20 x 1-3/4" long
BA	720003	720003	Lock Washer, 1/4"
BB	717005	717005	Hex Nut, Full, 1/4"-20
BC	106512	106512	Decal

HANDLES & CONTROLS

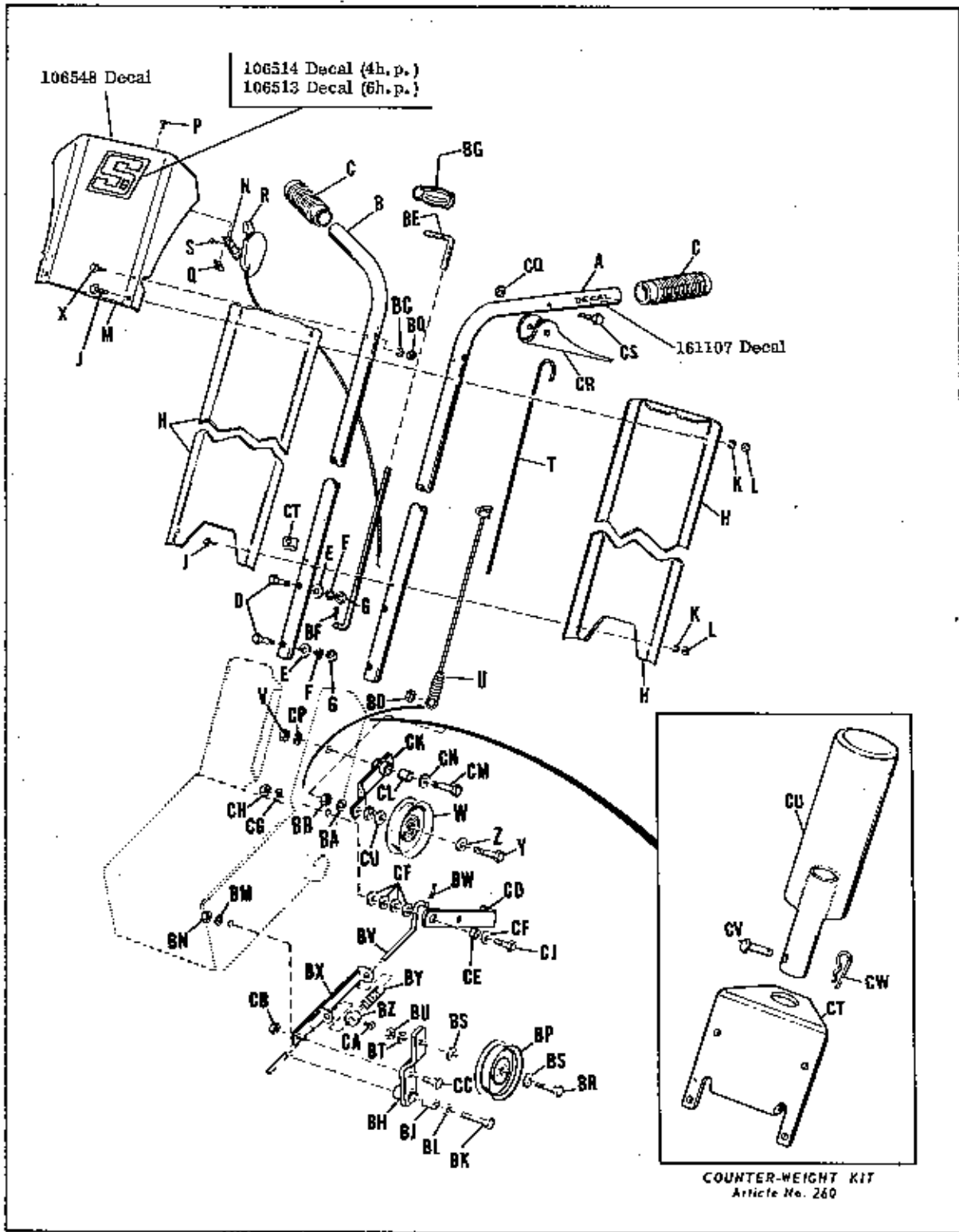

HANDLES & CONTROLS

REF. LET.	PART NUMBER		DESCRIPTION	REF. LET.	PART NUMBER		DESCRIPTION
	26" Sno Away	23" Sno Away			26" Sno Away	23" Sno Away	
A	106781	106781	Handle, LH	BL	719001	719001	Plain Washer, 3/8"
B	106782	106782	Handle, RH	BM	720002	720002	Lock Washer, 3/8"
C	106558	106558	Grip	BN	717003	717003	Hex Nut, Full, 3/8"-16
D	705006	705006	Hex Capscrew, 3/8"-16 x 2"	BP	154534	154534	Idler Pulley (Rotor Drive)
E	719001	719001	Washer, Plain, 3/8"	BQ	717005	717005	Hex Nut, Full, 1/4"-20
F	720002	720002	Lock Washer, 3/8"	BR.	705010	705010	Hex Capscrew, 3/8-16 x 1-3/4
G	717003	717003	Hex Nut, Full, 3/8"-16	BS	719001	719001	Plain Washer, 3/8"
H	106559	106559	Handle Cover	BT	720002	720002	Lock Washer, 3/8"
J	705025	705025	Hex Capscrew, 1/4-20 x 1-1/2	BU	717003	717003	Hex Nut, Full, 3/8"-16
K	720003	720003	Lock Washer, 1/4"	BV	106224	106224	Rotor Clutch Rod
L	717005	717005	Hex Nut, Full, 1/4"-20	BW	722001	722001	Cotter Pin, 3/32" x 3/4" lg.
M	106780	106780	Housing Assembly	BX	8081503	8081503	Clutch Rod Guide Assembly
N	106524	106524	Support, Throttle Control	BY	8191045	8191045	Spring
P	714003	714003	Hex Screw, self-tap. #10-32x1/2	BZ	8191022	8191022	Set Collar
Q	718019	718019	Speed Nut, Tinnerman	CA	713001	713001	Set Screw, Sq. Hd. 1/4-20 x 3/8
R	106563	106563	Throttle Control Assembly	CB	717510	717510	Hex Nut, Full, Lock, 3/8"-16
S	714005	714005	Screw, Self-Tap. #10-24x1/2	CC	705004	705004	Hex Capscrew, 3/8"-16 x 3/4
T	161090	161090	Extension Spring	CD	106223	106223	Foot Clutch Pedal
U	106778	106778	Spring Assy.	CE	8161215	8161215	Bushing
V	717003	717003	Hex Nut, Full, 3/8"-16	CF	719001	719001	Plain Washer, 3/8"
W	154534	154534	Idler Pulley (Trans. Drive)	CG	720002	720002	Lock Washer, 3/8"
X	705053	705053	Hex Capscrew, 1/4-20 x 1-3/4	CH	717003	717003	Hex Nut, Full, 3/8"-16
Y	705006	705006	Hex Capscrew, 3/8"-16 x 2"	CJ	705009	705009	Hex Capscrew, 3/8-16 x 1-1/2
Z	719001	719001	Plain Washer, 3/8"	CK	106204	106204	Idler Lever Assembly
BA	720002	720002	Lock Washer, 3/8"	CL	8171073	8171073	Race, Inner Bearing
BB	717003	717003	Hex Nut, Full, 3/8"-16	CM	705010	705010	Hex Capscrew, 3/8-16 x 1-3/4
BC	720003	720003	Lock Washer, 1/4"	CN	719001	719001	Plain Washer, 3/8"
BD	717510	717510	Hex Nut, Full, Lock, 3/8"-16	CP	720002	720002	Lock Washer, 3/8"
BE	106776	106776	Reverse Rod	CQ	717513	717513	Hex Nut, Full, Lock, 1/4-20
BF	722001	722001	Cotter Pin, 3/32" x 3/4"	CR	118056	118056	Clutch Grip
BG	106572	106572	Grip, Reverse Rod	CS	705025	705025	Hex Capscrew, 1/4-20 x 1-1/2
BH	106201	106201	Idler Lever Assembly	CT	106786	106786	Clip
BJ	8171073	8171073	Bearing Race, Inner				
BK	705010	705010	Hex Capscrew, 3/8-16 x 1-3/4				

COUNTER-WEIGHT KIT Article No. 260

REF. LET.	PART NUMBER		DESCRIPTION
	23" Sno Away	26" Sno Away	
CT	-----	106449	Bracket, Weight
CU	-----	154322	Weight Assembly
CV	-----	118053	Pin
CW	-----	8161045	Clip, Spring

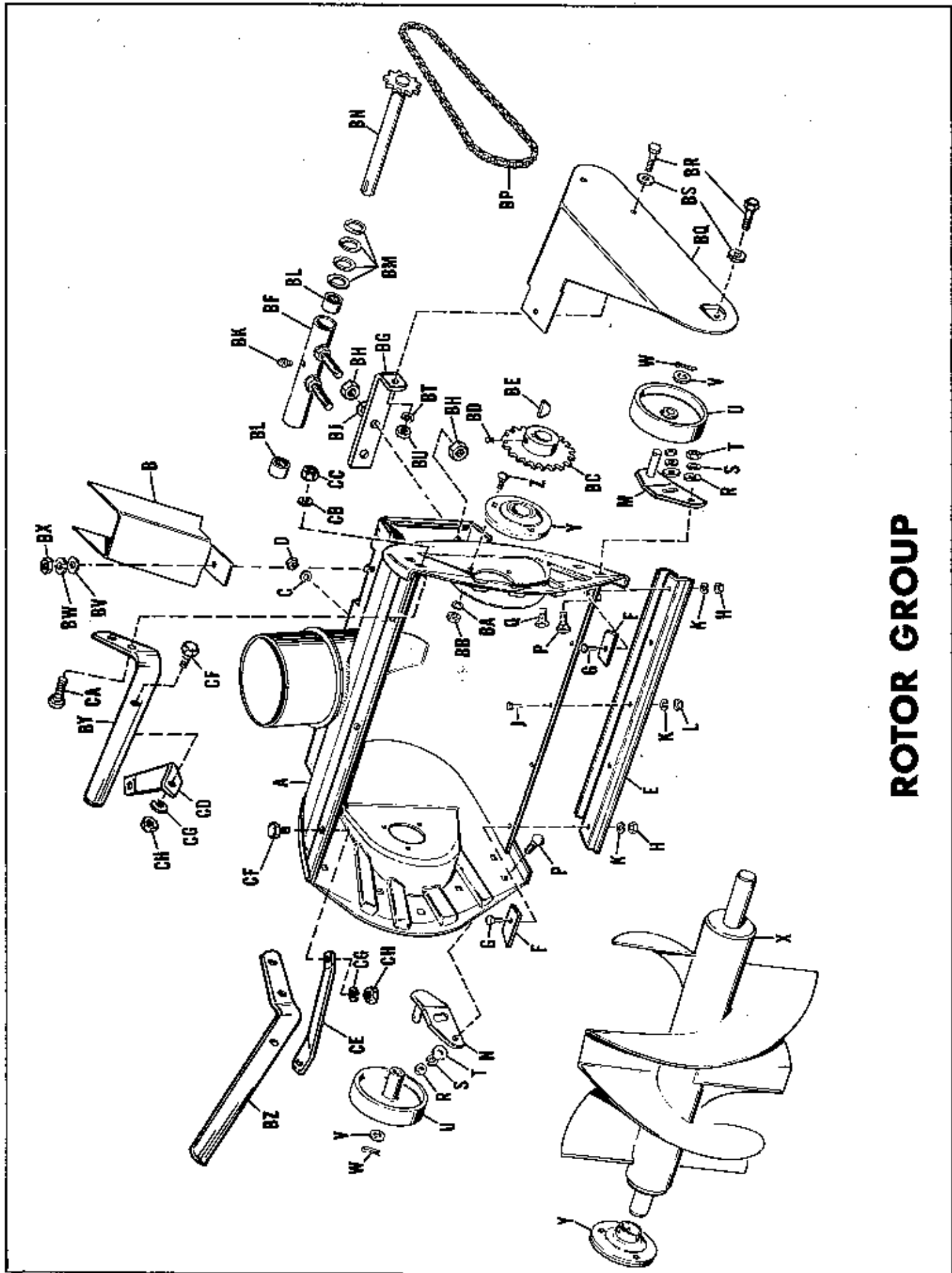

ROTOR GROUP

REF. LET.	PART NUMBER		DESCRIPTION
	26" Sno Away	23" Sno Away	
A	106518	106530	Body Assembly
B	106528	106528	Belt Cover
C	720002	720002	Lock Washer, 3/8"
D	717003	717003	Hex Nut, Full, 3/8"-16
E	106415	106428	Scraper Body
F	106137	106137	Clamp, Scraper
G	715073	715073	Hex. Capscrew, 5/16"-18 x 7/8" lg.
H	717511	717511	Hex Nut, Full, Lock, 5/16"-18
J	715018	715018	Hex Capscrew, 1/4"-20 x 5/8" lg.
K	720003	720003	Lock Washer, 1/4"
L	717005	717005	Hex Nut, Full, 1/4"-20
M	106209	106209	Roller Bracket Assembly, LH
N	106211	106211	Roller Bracket Assembly, RH
P	703004	703004	Carriage Bolt
Q	705031	705031	Hex Capscrew, 3/8"-16 x 7/8" lg.
R	719001	719001	Plain Washer, 3/8"
S	720002	720002	Lock Washer, 3/8"
T	717003	717003	Hex Nut, Full, 3/8"-16
U	106396	106396	Roller Assembly
V	121210	121210	Washer
W	722010	722010	Cotter Pin, 1/8" x 1-1/4" long
X	106378	106333	Rotor Assembly
Y	106532	106532	Ball Bearing
Z	705017	705017	Hex Capscrew, 5/16"-18 x 3/4" lg.
BA	720001	720001	Lock Washer, 5/16"
BB	717001	717001	Hex Nut, Full, 5/16"-18
BC	106052	106052	Rotor Sprocket
BD	713503	713503	Set Screw, Cup Pt., 5/16"-18 x 5/16"
BE	151040	151040	Key
BF	106197	106197	Housing Assembly, Bearing
BG	106213	106213	Chain Guard Bracket
BH	717006	717006	Hex Nut, Full, 1/2"-13
BJ	719004	719004	Washer, Plain, 1/2"
BK	727002	727002	Fitting, Grease
BL	154258	154258	Needle Bearing
BM	8061012	8061012	Washer
BN	106195	106195	Shaft Assembly
BP	106058	106058	Rotor Chain
BQ	106543	106543	Chain Guard
BR	705012	705012	Hex Capscrew, 5/16"-18 x 5/8" lg.
BS	719002	719002	Plain Washer, 5/16"
BT	720001	720001	Lock Washer, 5/16"
BU	717001	717001	Hex Nut, Full, 5/16"-18
BV	719001	719001	Plain Washer, 3/8"
BW	720002	720002	Lock Washer, 3/8"
BX	717003	717003	Hex Nut, Full, 3/8"-16
BY	106418	-----	Drift Cutter, LH
BZ	106417	-----	Drift Cutter, RH
CA	705004	-----	Hex Capscrew, 3/8"-16 x 3/4" lg.
CB	720002	-----	Lock Washer, 3/8"
CC	717003	-----	Hex Nut, Full, 3/8"-16
CD	106412	-----	Brace, LH
CE	106411	-----	Brace, RH
CF	705017	-----	Hex Capscrew, 5/16"-18 x 3/4" lg.
CG	720001	-----	Lock Washer, 5/16"
CH	717001	-----	Hex Nut, Full, 5/16"-18

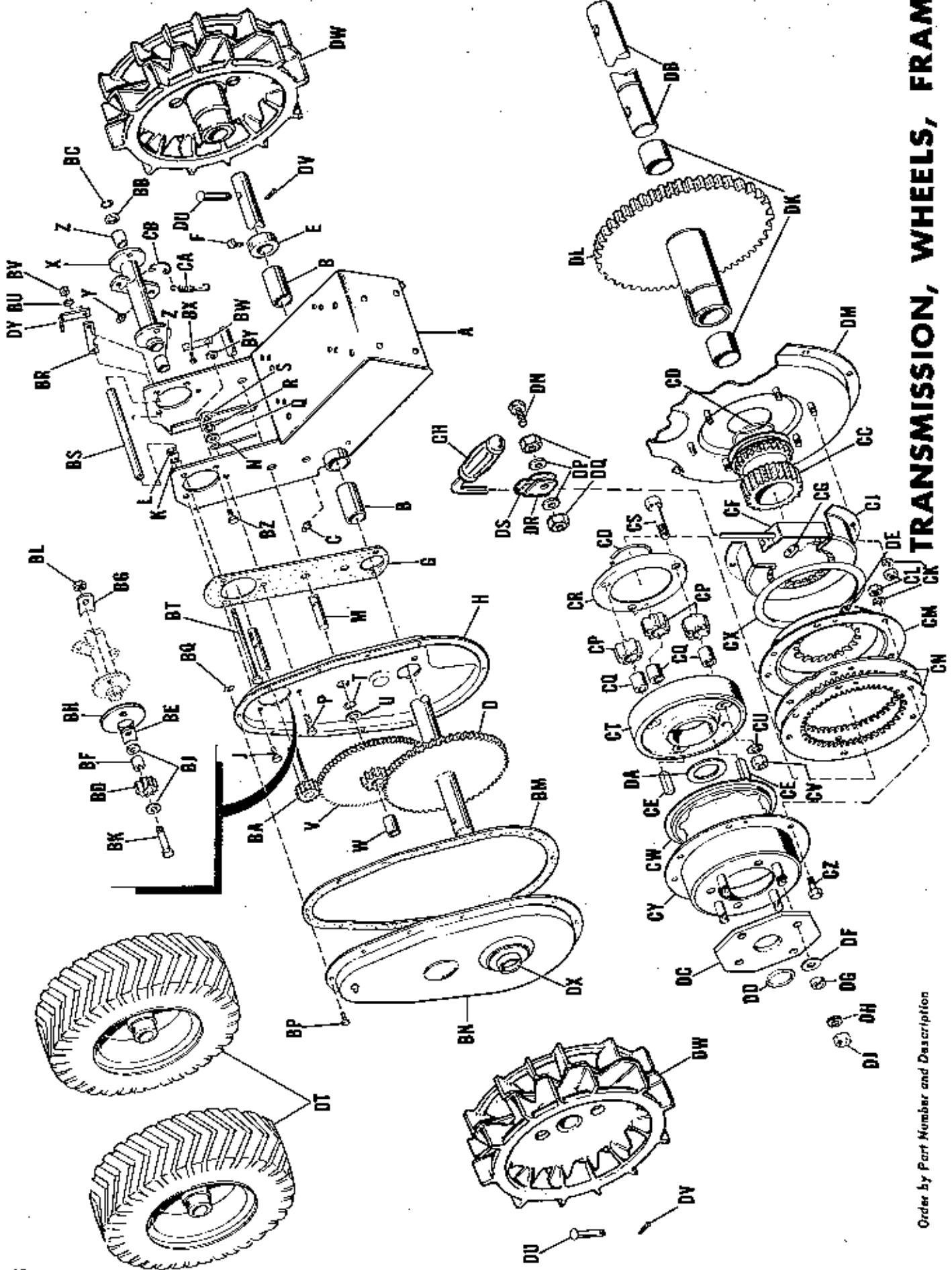

TRANSMISSION, WHEELS, FRAME

Order by Part Number and Description

TRANSMISSION, WHEELS, FRAME

REF. LET.	PART NUMBER		DESCRIPTION
	26" Sno Away	23" Sno Away	
A	106180	106180	Frame Assembly
B	153089	153089	Bearing
C	727002	727002	Grease Fitting
D	-----	106435	Axle & Gear Assembly
E	8061046	8061046	Set Collar
F	713006	713006	Set Screw, Sq Hd, 5/16-18x1/2
G	153114	153114	Gasket, Bearing Housing
H	153105	153105	Gear Case
J	705012	705012	Hex Capscrew, 5/16-18 x 5/8
K	720001	720001	Lock Washer, 5/16"
L	717001	717001	Hex Nut, Full, 5/16"-18
M	106193	106193	Shaft, Intermediate
N	121044	121044	Lock Pin
P	705005	705005	Hex Capscrew, 3/8"-16 x 1"
Q	719001	719001	Plain Washer, 3/8"
R	720002	720002	Lock Washer, 3/8"
S	717003	717003	Hex Nut, Full, 3/8"-16
T	153124	153124	Retaining Ring
U	153079	153079	Washer
V	121306	121306	Gear Assembly, Intermediate
W	153078	153078	Bearing, Intermediate
X	106199	106199	Housing Assembly, Bearing
Y	727002	727002	Grease Fitting
Z	8051038	8051038	Bearing
BA	121115	121115	Pulley Shaft Assembly
BB	153079	153079	Washer
BC	153124	153124	Retaining Ring
BD	121118	121118	Reverse Pinion
BE	121107	121107	Reverse Pinion Spacer
BF	121163	121163	Pinion Spacer
BG	121139	121139	Lock Plate
BH	153094	153094	Shield
BJ	719002	719002	Plain Washer, 5/16"
BK	715033	715033	Hex Head Bolt, L.H.
BL	153090	153090	Nut, Hex, Full, L.H.
BM	153115	153115	Gear Case Gasket
BN	153106	153106	Gear Case Cover Assembly
BP	714006	714006	Screw, Self-Tapping, #10 x 1/2"
BQ	718008	718008	Speed Nut
BR	106215	106215	Plate, Friction, Stop
BS	106217	106217	Spacer, Frame
BT	106216	106216	Bolt, Frame
BU	720001	720001	Washer, Lock, 5/16"
BV	717001	717001	Hex Nut, Full, 5/16"-18
BW	718021	718021	Detent, Neutral
BX	714014	714014	Screw, Self-Tapping, #10 x 3/8
BY	719006	719006	Washer, Plain, 1/4"

REF. LET.	PART NUMBER		DESCRIPTION
	26" Sno Away	23" Sno Away	
BZ	715018	715018	Hex Capscrew, 1/4"-20 x 5/8
CA	153121	153121	Spring, Reverse Lever
CB	153011	153011	Extension, Spring
CC	121187	-----	Sun Gear Assembly
CD	121167	-----	Snap Ring
CE	106394	-----	Key
CF	106410	-----	Shift Rod Assembly
CG	121169	-----	Shift Block
CH	106572	-----	Clevis Rod Grip
CJ	121146	-----	Housing Assembly
CK	720003	-----	Lock Washer, 1/4"
CL	717005	-----	Hex Nut, Full, 1/4"-20
CM	121148	-----	Cover Assembly
CN	121151	-----	Ring Gear
CP	121118	-----	Pinion
CQ	121163	-----	Pinion Spacer
CR	121162	-----	Bolt Ring
CS	121184	-----	Hex Head Bolt
CT	106416	-----	Spider
CU	721004	-----	Lock Washer, 3/8" Shakeproof
CV	718015	-----	Hex Nut, Full, 3/8"-24
CW	121185	-----	Thrust Plate
CX	121186	-----	Seal, Housing Assembly
CY	106407	-----	Carrier Assembly
CZ	705015	-----	Hex Capscrew, 1/4"-20 x 5/8
DA	106391	-----	Washer
DB	106406	-----	Axle Shaft
DC	106405	-----	Axle Plate, R.H.
DD	154291	-----	Snap Ring
DE	727002	-----	Grease Fitting
DF	719002	-----	Plain Washer, 5/16"
DG	106392	-----	Spacer
DH	720002	-----	Lock Washer, 3/8"
DJ	717003	-----	Hex Nut, Full, 3/8"-16
DK	153068	-----	Bearings
DL	106414	-----	Gear & Tube Assembly
DM	121144	-----	Cover, Gear Case Assembly
DN	715017	-----	Hex Capscrew, 5/16-18 x 1-1/4
DP	719002	-----	Plain Washer, 5/16"
DQ	717511	-----	Hex Nut, Full, 5/16"
DR	153074	-----	Guide, Rod
DS	121175	-----	Liner
DT	106419	106419	Wheel & Tire Assembly
DU	118053	118053	Pin
DV	8161045	8161045	Spring Clip
DW	106420	106420	Steel Wheels
DX	8061055	8061055	Seal, Felt
DY	-----	106777	Guide, Clutch Wire (4hp only)

SHIELD, DRIVE PULLEYS, ENGINE

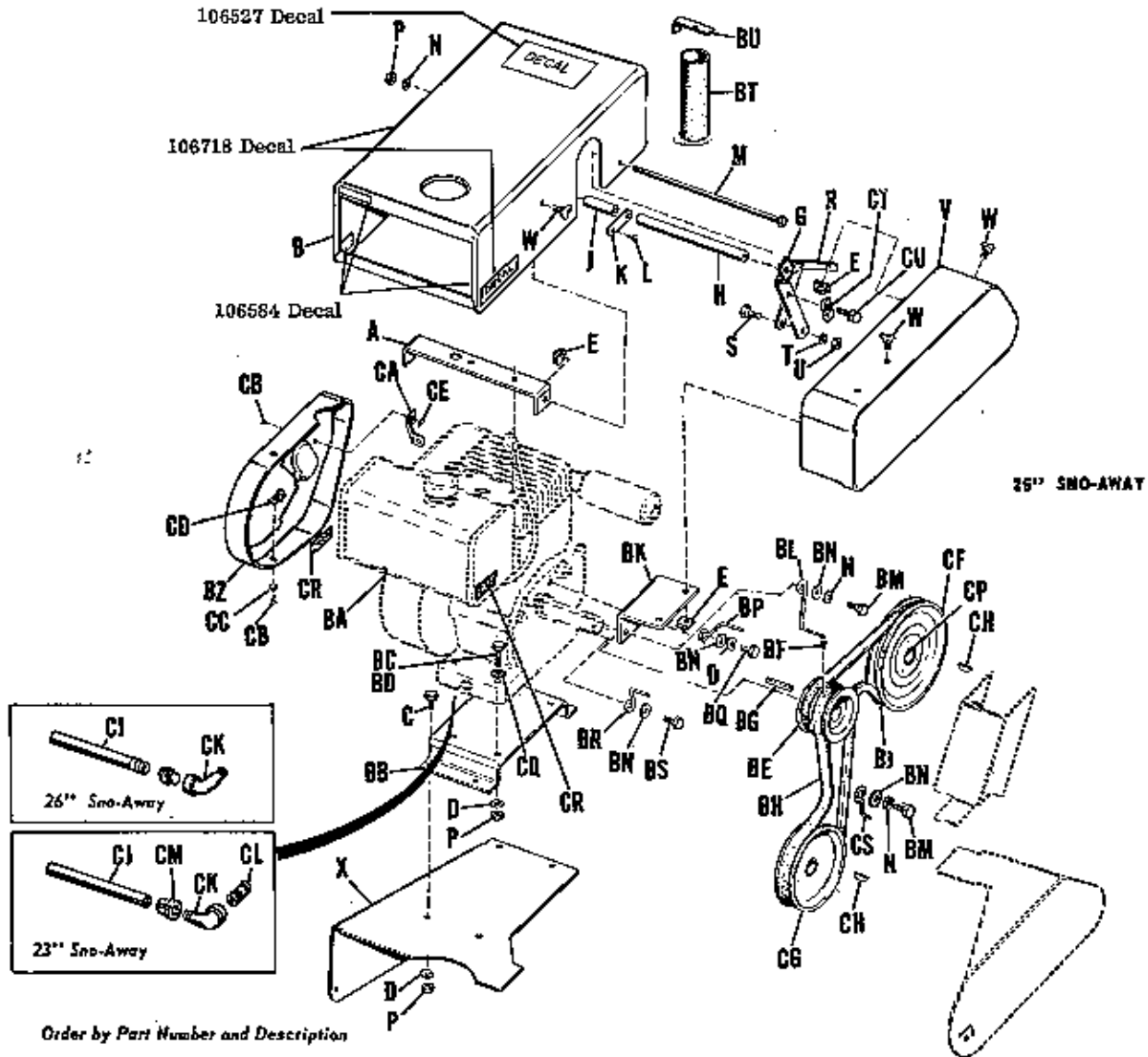
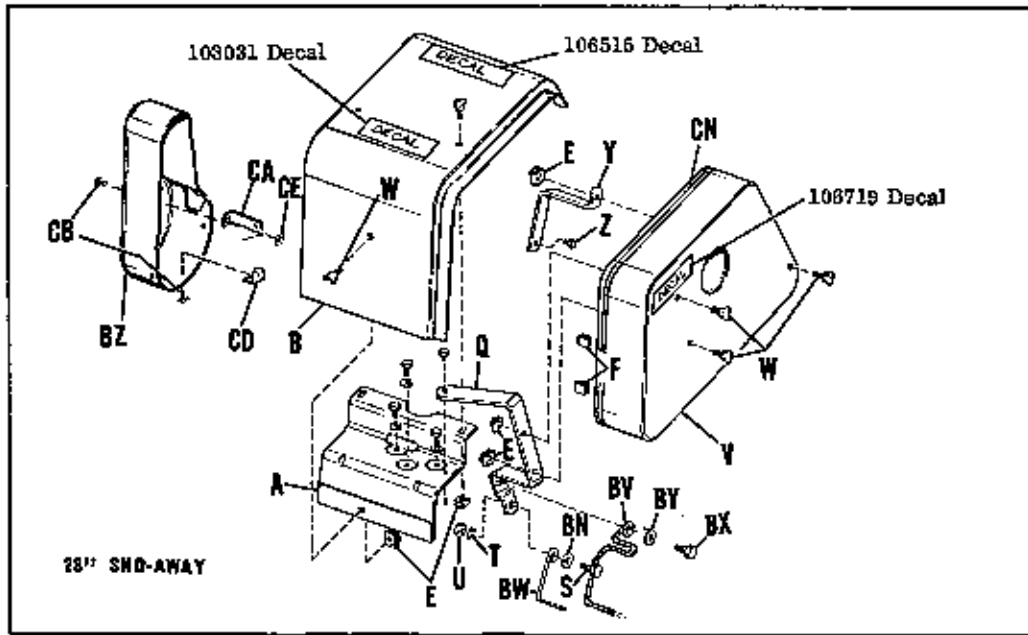

Order by Part Number and Description

SHIELD, DRIVE PULLEYS, ENGINE

REF. LET.	PART NUMBER		DESCRIPTION
	26" Sno Away	23" Sno Away	
A	106519	106533	Hood Support
B	106573	106534	Hood Assembly
C	705017	-----	Hex Capscrew, 5/16"-18 x 3/4" lg.
D	720001	-----	Lock Washer, 5/16"
E	718030	718030	Tinnerman Nut, #C31280-5618-1
F	-----	106372	Speed Clip
G	106523	-----	Rear Hood Support
H	106576	-----	Hood Spacer, LH
J	106577	-----	Hood Spacer, RH
K	106525	-----	Brace
L	710004	-----	Round Hd. Screw, #10-32 x 3/8"
M	106578	-----	Bolt, Hood Spacer
N	720001	-----	Lock Washer, 5/16"
P	717001	-----	Hex Nut, Full/Lock, 5/16"-18
Q	-----	106541	Belt Guard Support
R	106520	-----	Belt Guard Brace
S	705007	705031	Hex Capscrew, 3/8"-16 x 7/8"
T	720001	720001	Lock Washer, 5/16"
U	717001	717001	Hex Nut, Full, 5/16"-18
V	106579	106537	Belt Guard Assembly
W	715037	715037	Thumb Screw
X	106580	106542	Side Cover, RH
Y	-----	106540	Belt Guard Bracket
Z	-----	714007	Screw, Rec. Hex. Hd., Self-Tapping, 1/4"-20 x 3/8" lg.
BA	-----	-----	Engine
BB	-----	106433	Engine Base
BC	705023	-----	Hex Capscrew, 5/16"-18 x 1-3/4" lg.
BD	-----	705023	Hex Capscrew, 5/16"-18 x 1-3/4" lg.
BE	106402	106227	Engine Pulley
BF	713504	713504	Set Screw, Cup Pt., Socket Hd., 5/16"-18 x 3/8" lg.
BG	159129	8221042	Key
BH	106390	121228	V-Belt (Rotor Drive)
BJ	8161244	8021077	V-Belt (Transmission Drive)
BK	106522	-----	Guard Support
BL	8061089	-----	Belt Stop
BM	706001	-----	Hex Capscrew, 5/16"-24 x 3/4" lg.
BN	719002	719002	Plain Washer, 5/16"
BP	106347	-----	Belt Stop
BQ	705017	-----	Hex Capscrew, 5/16"-18 x 3/4" lg.
BR	106346	-----	Belt Stop
BS	706016	-----	Hex Capscrew, 5/16"-24 x 5/8" lg.
BT	106581	-----	Rubber Tube
BU	106385	-----	Tube Clamp
BV	-----	106624	Belt Stop
BW	-----	106545	Belt Stop
BX	-----	706017	Hex Capscrew, 1/2"-20 x 1" lg.
BY	-----	721506	Lock Washer, Int. Shakeproof, 1/2"
BZ	106585	106590	Cover, Air Cooling
CA	106586	106591	Cover Bracket
CB	714003	714003	Screw, Self-Tapping #10 x 1/2" lg.
CC	719007	-----	Plain Washer, 3/16"
CD	718031	718031	Speed Nut, Special
CE	718019	718019	Speed Nut
CF	106214	106214	Pulley, Transmission Drive
CG	154272	154272	Pulley
CH	725003	725003	Key, Woodruff
CJ	154381	154381	Tube, Oil Filler
CK	728501	728502	Street Elbow, 90°
CL	-----	106601	Nipple
CM	-----	726502	Pipe Cap
CN	-----	106547	Strip, White
CP	713503	713503	Screw, Set
CQ	718002	-----	Plain Washer, 5/16"
CR	106582	-----	Felt Pad
CS	8081035	-----	Belt Stop
CT	154247	-----	Clamp
CU	715067	-----	Hex Capscrew, Self-tapping

ATTACHMENTS AND ACCESSORIES FOR YOUR SNO-AWAY

- 410 ELECTRIC STARTER, Briggs and Stratton 110 volt (For No. 430 and No. 428) (On No. 428 requires No. 431)
- 431 RING GEAR KIT (For No. 410 when used with No. 428)
- 397 CHAINS, tire, pair (For No. 430)
- 257 WHEELS, steel traction, pair (For 4 H. P. and 6 H. P. Sno-Away)
- 258 TIRES and RIMS, rubber, pair (For 4 H. P. and 6 H. P. Sno-Away)
- 259 CHAINS, tire, pair (For 4 H. P. and 6 H. P. Sno-Away)
- 260 WEIGHT, counterbalance, (For 4 H. P. and 6 H. P. Sno-Away)

