Simplicity®

**OWNER'S
MANUAL**

**42" SNOW PLOW
& DOZER BLADE**

MFG. NO. 891

SIMPLICITY MANUFACTURING COMPANY, INC.



SER. FORM - 177864
LITHO IN U.S.A.

1364

ADJUSTMENTS

SKID SHOE ADJUSTMENT

Before using the Snow Plow - Dozer Blade, the skid shoes should be adjusted for the type of surface to be worked on:

Rough Surface Use: Raise the dozer blade and check to see that each skid shoe is mounted in the lower set of holes in the blade. (See Figure 4). If they are not, remove the two bolts holding each skid shoe to the blade and move the skid shoes to the lower set of holes. Replace the bolts and tighten securely. With the shoes in this position, the blade will ride above the surface. Use this position for leveling loose gravel, dirt, etc., and clearing uneven or gravel surfaced areas of snow.

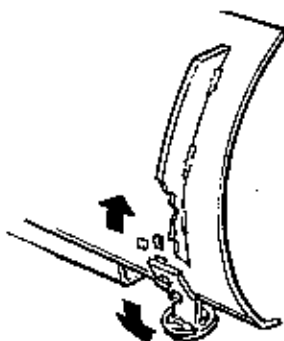

FIGURE 4

Smooth Surface Use: When you wish to dig or scrape next to any surface, the skid shoes should be mounted in the upper set of holes so the blade will rest on the blade edge. Use this position for clearing snow from a hard, smooth surface, digging or smoothing a hard packed surface.

Blade Angle Adjustment

The pivot pin can be placed in any of three positions so the blade can be faced straight forward, or angled to the left or right. Lock the blade in the raised position to make this adjustment.

Snow Plow - Dozer Blade Operation

After setting the skid shoes and blade angle for the work the blade will be doing, move to the work area. When the tractor is moving with the Snow Plow - Grader Blade in the raised position, be sure the lift lever is completely locked. This will prevent the blade from unexpectedly dropping to the operating position and causing damage. When working with the blade, use first or second gear to move forward. If you have excess wheel slippage when pushing deep snow or heavy material, such as dirt or gravel where good traction is not available, take a smaller "bite" by using less than the full blade width. When using chains, install them loosely and they will be self-cleaning.

MAINTENANCE

Occasionally place a few drops of light engine oil on all pivot points. After using, clean the blade and coat surfaces of the blade where the paint has been worn off with oil or good rust preventative.

42" SNOW PLOW AND DOZER BLADE

BLADE	WIDTH: 42 Inches (Straight) 36-1/2" Angled
	HEIGHT: 15-3/4 Inches
	MATERIAL: Heavy Gauge Steel
	FRONT SUPPORT: Adjustable Shoes
	MOUNTING: Front Axle
	POSITIONS: 3
	ANGLES: 30° Each Direction
	SCRAPER BAR: Hardened, Replaceable
	CLEARANCE, RAISED POSITION: 5-1/2 Inches Maximum
CONTROLS	RAISE & LOWER: Tractor Lift Lever
	ANGLE ADJUSTMENT: Pivot Pin at Front
DIMENSIONS	LENGTH: Including Tractor - 67-1/2 Inches
	67-1/2 Inches Serf
	67-1/2 Inches Yeoman 73-1/2 Inches Broadmoor
WEIGHT:	NET: 66 LBS. SHIPPING: 66 LBS.

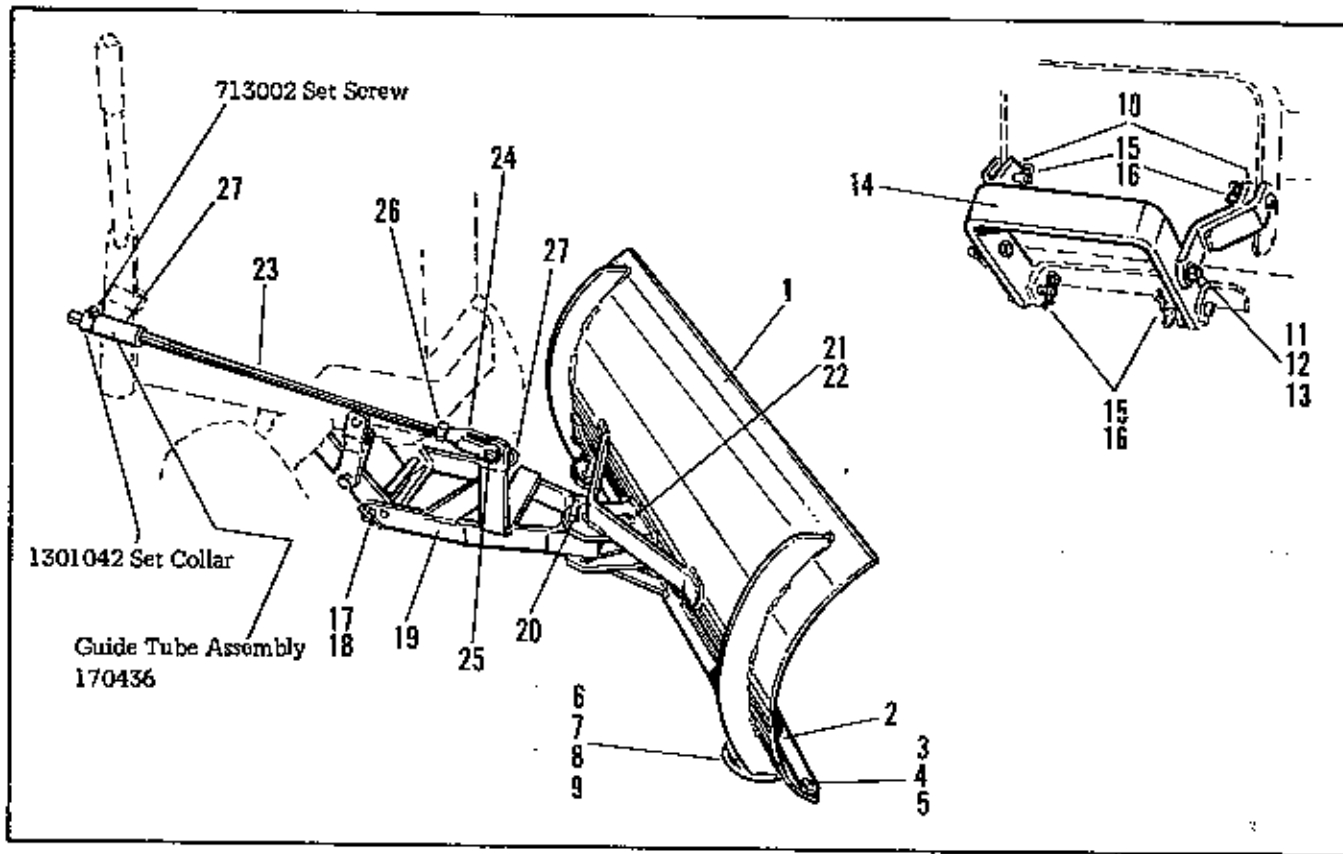

Ref. No.	Part No.	Qty. Req.	Description
1	107047	1	42" Blade Assembly
2	107045	1	Wear Plate
3	702003	6	Carriage Bolt, 3/8"-16 x 3/4" lg.
4	720002	6	Lock Washer, 3/8"
5	717003	6	Hex Nut, Full, 3/8"-16
6	107024	2	Shoe Assembly
7	702002	4	Carriage Bolt, 3/8"-16 x 1" lg.
8	720002	4	Lock Washer, 3/8"
9	717003	4	Hex Nut, Full, 3/8"-16
10	107072	2	Support Arm Assembly
11	705016	2	Hex Capscrew, 3/8"-16 x 1" lg.
12	720002	2	Lock Washer, 3/8"
13	717003	2	Hex Nut, Full, 3/8"-16
14	107074	1	Push Frame
15	118053	4	Pin
16	8161045	4	Spring Clip
17	107089	1	Pivot Rod
18	8161045	2	Spring Clip
19	107075	1	Push Bar Assembly
20	1603601	1	Pivot Pin
21	1603602	1	King Pin
22	8161045	1	Spring Clip
23	176202	1	Lift Rod
24	157631	1	Adjusting Yoke End
25	154305	1	Yoke Pin
26	717008	1	Hex Nut, Full, 1/2"-20
27	8161045	2	Spring Clip

SPECIFICATIONS SUBJECT TO CHANGE WITHOUT NOTICE

for use on Broadmoor, Yeoman and Serf

Required Accessories

- 1 - Mfg. No. 594 Lift Lever Kit (Serf only)
- 1 - Mfg. No. 586 Engine Winterizing Kit (Broadmoor and Yeoman only) For Winter Use Only

Recommended Accessories

- 2 - Mfg. No. 449 Rear Wheel Weights
- 1 - Mfg. No. 300 Rear Weight
- 2 - Mfg. No. 045 Weights
- 1 - Mfg. No. 582 Snow Tire and Wheel Set (Broadmoor and Yeoman only)
- 1 - Rear Tire Chain Set (See tractor manual for appropriate Mfg. No.)

OPERATION

All mounting holes are pre-drilled in the frame and front axle. Attach the mounting bracket to the tractor as follows:

1. Install the rear pins (A) in the axle ears first. Then install the front pins (B) at the frame holes. Note that bracket arms straddle the frame sides. The arm bolts may be loosened to position the arms. Secure the pins with the spring clips.
2. Attach the push bar to the bracket with the long pin (C) and two spring clips. (See Figure 1)

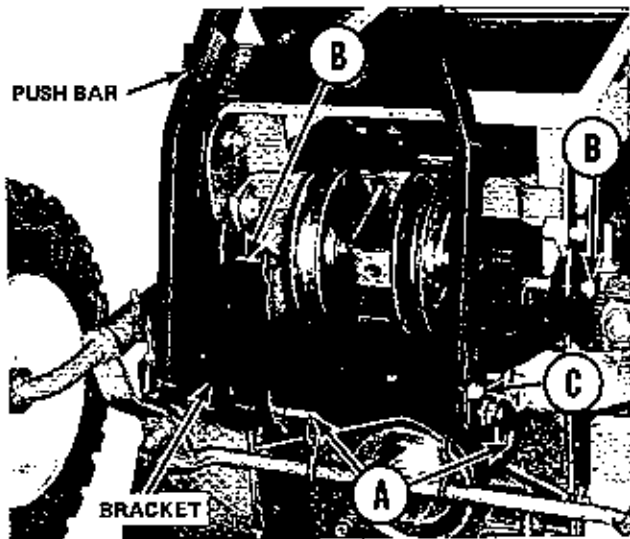

FIGURE 1

3. Insert the lift rod end into the lift lever hole and secure with a spring clip. Attach the rod clevis to the push bar upright arm with the remaining pin and spring clip. (See Figure 2)

4. Attach the blade to the push bar with the king pin inserted from the top. Secure the king pin with a spring clip. (See Figure 3)

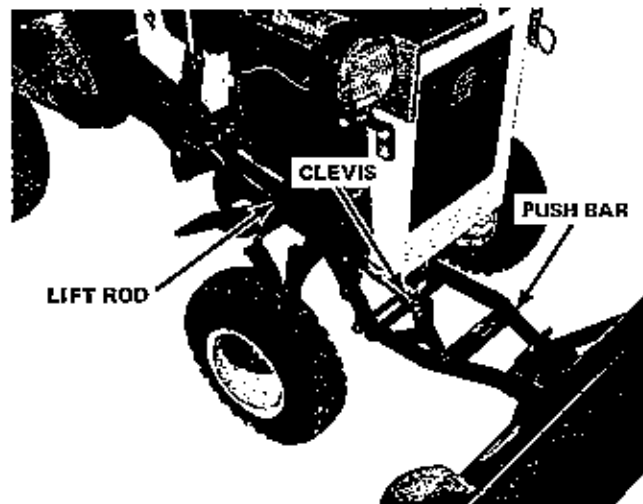

FIGURE 2

5. Install the pivot pin in the desired hole. (See Figure 3)

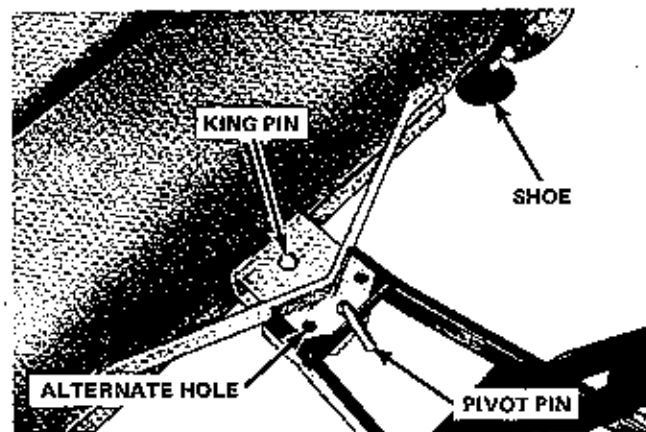

FIGURE 3