

Simplicity

2-22-67

2 STAGE SNO-AWAY 7 H.P.

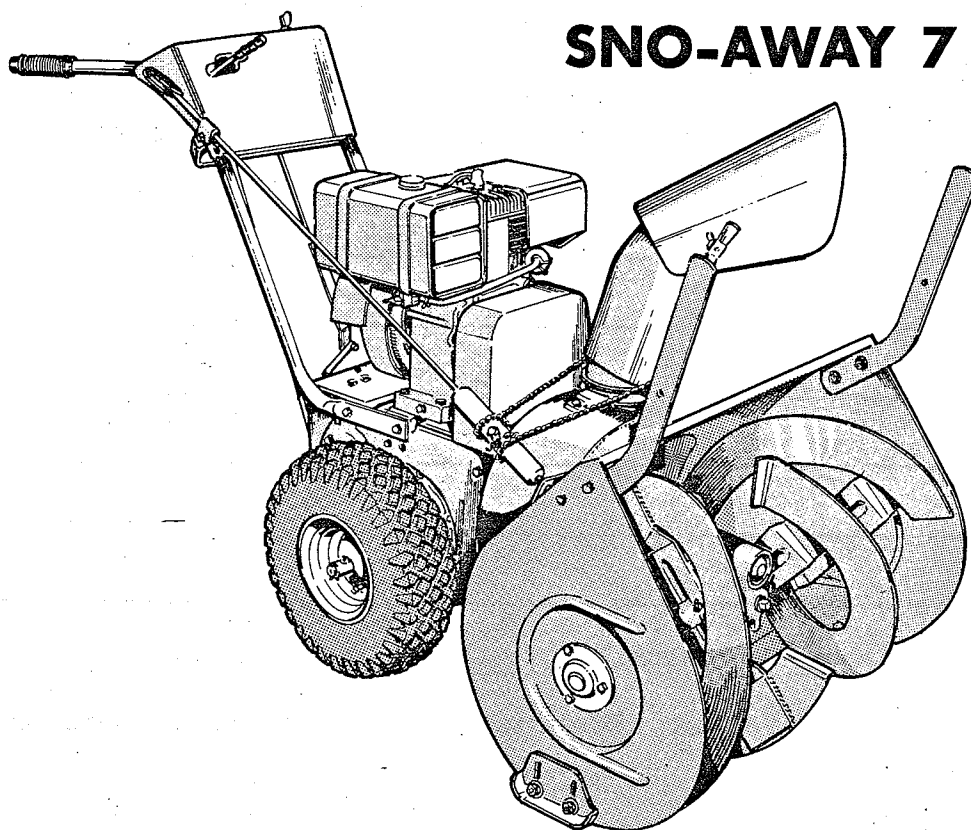

Mfr's. No. 372

2345678910

SIMPLICITY MANUFACTURING COMPANY, INC.

GUARANTEE

The company guarantees Simplicity Products to be free from defects in material and workmanship except the company makes no warranty express or implied with respect to tires, engines and engine accessories which generally are warranted by their respective manufacturers. Any part covered by this warranty which is proven defective within one year, under normal use, from date of purchase, will be replaced free of charge, f.o.b. Port Washington, Wisconsin, provided such part is returned to factory transportation charges prepaid and is found to be defective upon examination at the factory. The company is not obligated under this guarantee to bear cost of labor or delivery charges in replacement of defective parts. This guarantee does not apply to any Simplicity Products altered outside of Simplicity's factory. Such replacement of defective parts shall be the exclusive remedy and in no event shall Simplicity be liable for consequential damages. EXCEPT AS SPECIFICALLY PROVIDED HEREIN, THERE ARE NO WARRANTIES WHICH EXTEND BEYOND THE DESCRIPTION ON ANY SIMPLICITY PRODUCT.

This form is to be used in lieu of the Registration (Warranty) Card.

Should warranty service be necessary, the information below should be presented to the authorized SIMPLICITY Dealer.

Customer's Name _____

Address _____

Mfg. No. _____ Serial No. _____

Date Purchased _____

Purchased From _____

Address _____

Engine Model No. _____ Serial No. _____ Type No. _____

To obtain replacement parts from dealer, advise quantity, part number and description.

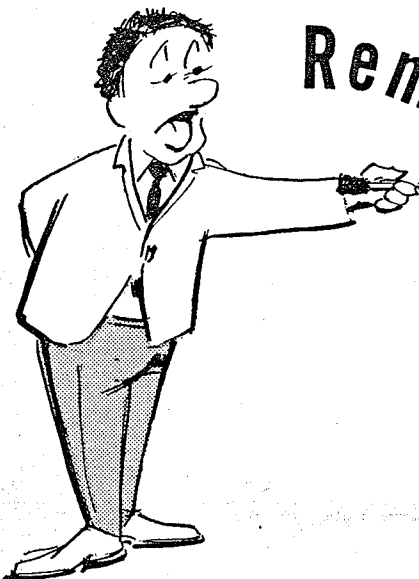

Remember...

FOR YOUR SAFETY

1. ALWAYS STOP ENGINE BEFORE LEAVING MACHINE
2. ALWAYS STOP ENGINE BEFORE SERVICING OR ADJUSTING MACHINE OR EQUIPMENT
3. ALWAYS KEEP HANDS, FEET AND CLOTHING AWAY FROM POWER-DRIVEN PARTS

ASSEMBLY

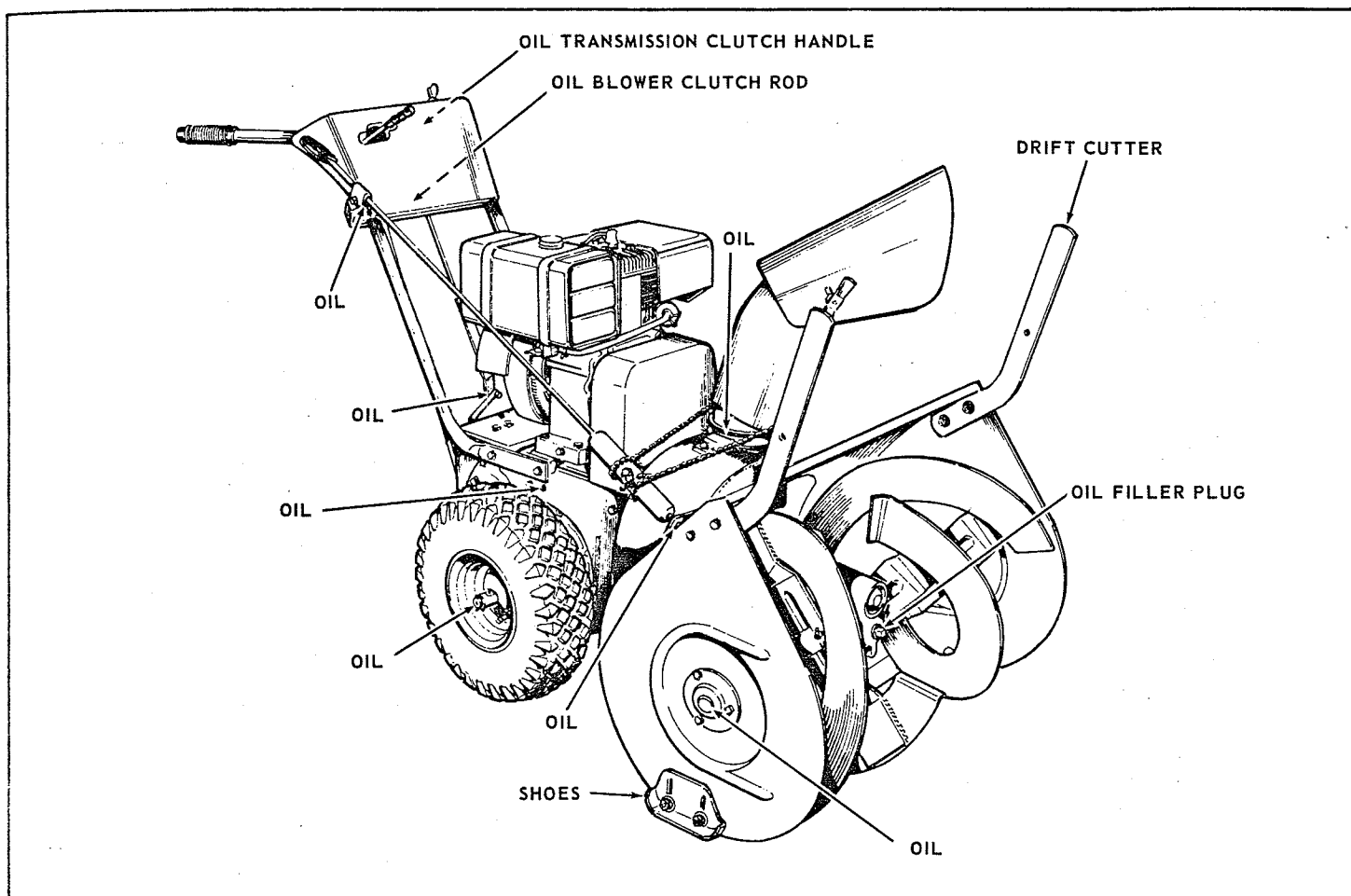

FIGURE 1

To assemble the Sno-Away, follow the sequence of steps as outlined below:

1. Attach the left and right hand shoe to the outside of body assembly with the 3/8"-16NC x 3/4" long carriage bolt, 3/8" plain and 3/8" lockwasher. Secure with 3/8"-16NC full hex nut, which is on outside of shoe at desired elevation for your specific needs. (Sno-Away should be raised when using on gravel). See Fig. 1.

2. Attach Left and Right Hand Drift Cutters to the inside of Body Assembly with the 3/8"-16 x 3/4" long hex capscrews, 3/8" plain and 3/8" lockwashers. Secure with 3/8"-16 full hex. nut. See Fig. 1.

3. Fasten the Left and Right Handles loosely to the sides of the Frame Assembly using the 3/8" x 7/8" capscrew and 3/8" lockwashers. Do Not tighten securely at this time. See Fig. 2.

4. Install the Control Housing Assembly to the handles using the 1/4" x 1-1/2" capscrews in the top holes and the 1/4" x 1-3/4" capscrews in the bottom holes. Do not attach nuts and lockwashers at this time. See Fig. 2.

3. Fasten the Throttle Cable Assembly to the Throttle Support using the (two) 10-24 x 1/2" round head

self tapping screws. Attach speed nuts to throttle control bracket. Mount throttle control assembly to the handle cover using the (two) 10-24 x 1/2" hex head self tapping screws. Install the cable clamps to the handle, approximately 5" from the control housing and 5" above the frame. See Fig. 2.

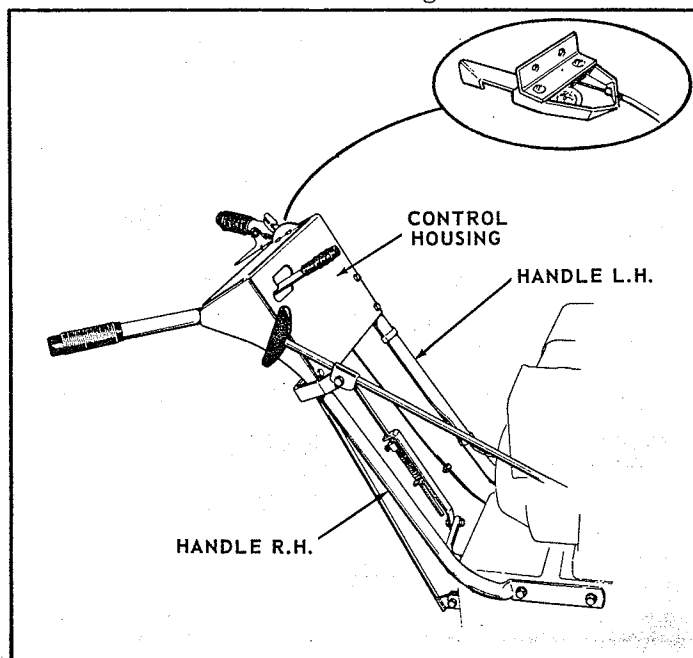

FIGURE 2

4. Assemble the Shift Rod Assembly to the handle cover using (two) 1/4" x 1/2" capscrews and 1/4" lockwashers. Secure with 1/4" nuts. Mount the handle cover to handles. Then attach the spout adjusting rod support to bottom holes and secure with 1/4" lockwashers and 1/4" nuts. See Fig. 3.

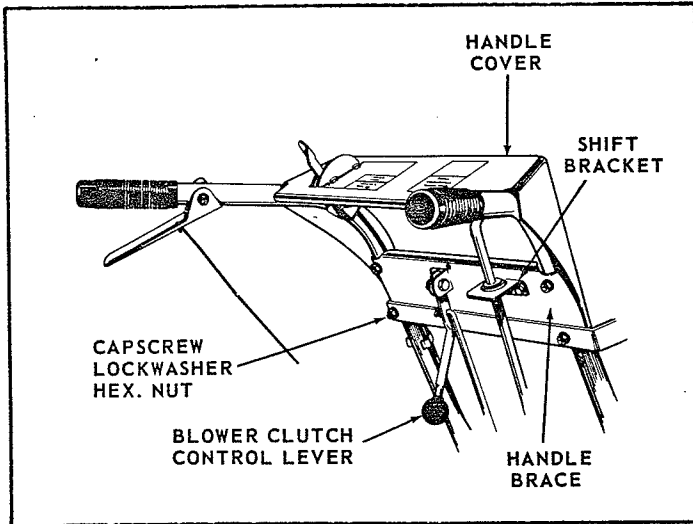

FIGURE 3

5. Attach the Shift Rod to the Shift Stem on the transmission using the 1/4" x 1" hardened capscrew and locknut. Tighten until there is no side play but that rod is free to pivot.

6. At this time tighten all nuts and bolts which were previously left loose. Handles should be held in raised position when tightening the (4) bolts holding handles.

7. Mount the clutch auger handle to the handle cover using the 5/16" x 3/4" capscrews, 1/4" flat washer, and (two) nylon washers. Secure with 5/16" locknut. Tighten so that when clutch auger handle is pulled up the nylon washers will hold it in this position, but not to the point where it is unable to pivot. See Fig. 4.

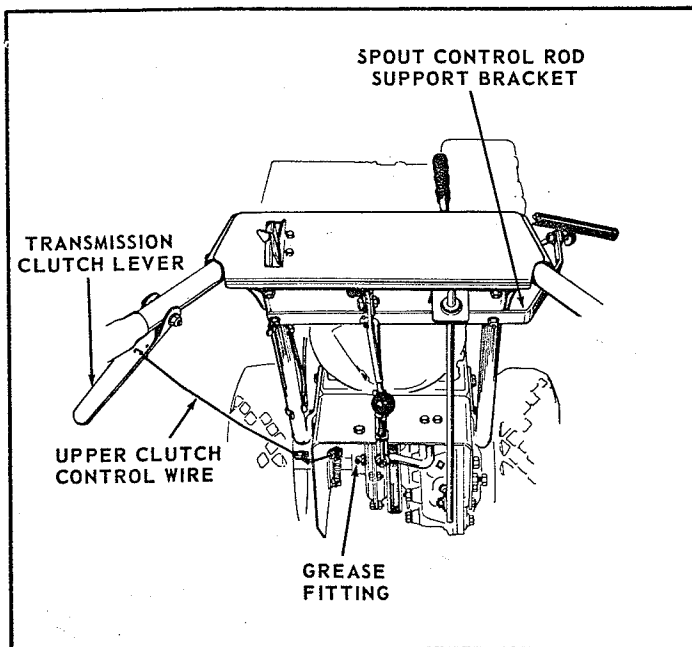

FIGURE 4

8. Attach the clutch rod assembly to the clutch auger handle using the 3/32" x 3/4" cotter pin. Attach the lower end of the clutch rod assembly to the clutch auger rod assembly using the 1/4" x 1" hardened capscrew and the 1/4" locknut. Tighten until there is no side play but that rod is free to pivot. See Fig. 5. Attach Knob. See Fig. 3.

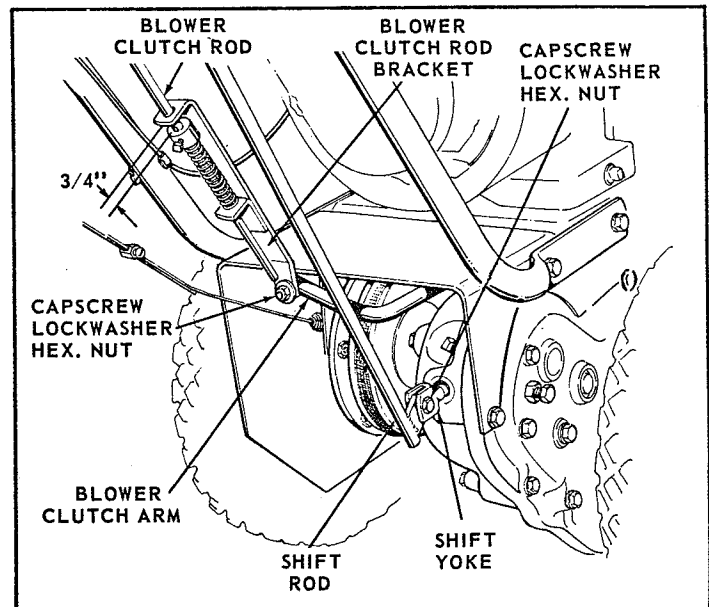

FIGURE 5

9. Remove the back cover by removing the (three) self tapping screws. Insert the wire extension thru the spring on the pivot assembly. See Fig. 5. Install wire extension thru upper left corner of back cover. Replace back cover. Insert spring extension thru bottom set of holes in clutch grip.

10. Install both the spring extension and the wire extension thru the wire clamp and fasten with the 10-24 x 3/8" round head screw. Remove slack from both wires and tighten.

11. Install spout extension to spout assembly using the 5/16" x 18 x 3/4" carriage bolts, 3/8" special hex lock washer, 3/8" plain washer and wing nuts. Adjust to suit. See page 16.

12. Position discharge spout directly forward. Position control tube so that the cord clamp faces away from the side of the spout. Place the tube so it rests on the gas tank. Provide one (1) coil on top and one (1) coil on bottom of the tube. Position the free ends of the cord around the spout and clamp securely into position after removing all slack from the cord. The end of the cord closest to operator passes under the tube, the end away from operator passes over the top of tube. Position the control tube so that it fits against the outside of the spout adjusting rod support and fasten using the rod guide with liner and one 5/16" x 18 x 1-1/2" long hex capscrew and 5/16"-18 locknut.

TO START ENGINE

1. Before attempting to start the engine or to operate the Sno-Away, refer to the engine manufacturers Owners Manual for the proper fuel and oil.
2. Be sure petcock under gas tank is open. Follow engine instructions to prepare engine for operation.
3. Disengage auger. Place shift lever in neutral.
4. Move throttle control lever to 1/2 throttle.
5. Put choke lever in "Choke" position.
6. Pull re-coil starter rope to start engine.

OPERATION

1. Engage auger control lever.
2. Shift transmission lever to Hi or Lo as desired.
3. Squeeze Touch-O-Matic Control Handle to start machine in motion. When operating in heavy snow drifts, machine may be slowed down by slipping clutch (Touch-O-Matic Handle) to avoid choking out engine.
4. To operate the Sno-Away in reverse, release the Touch-O-Matic Control Handle and shift into reverse gear, then squeeze Touch-O-Matic Control Handle for reverse motion.
5. When using the Sno-Away, adjust the discharge spout so that the snow will be thrown with the wind and never into the wind. Throwing snow into the wind will be a source of discomfort to the operator. To alter the direction of discharge, rotate the spout by means of the Spout Adjust Handle. The distance that the snow may be thrown may be adjusted by loosening the two wing nuts on the Discharge Spout Extension and raising or lowering the extension to give the desired angle. After adjusting, push the extension snugly against the Spout Assembly to prevent snow from being blown backwards against the engine and operator. Slotted holes beneath the wing nuts will allow this to be done. Before tightening the wing nuts to hold the extension in the desired position.
6. If unit creeps after releasing the Touch-O-Matic Control Handle, Idler Pulley may be adjusted to remove belt tension, further adjustment may be obtained by removing washers under the engine base to lower engine.
7. If one of the wheels slip while blowing snow, pressure should be applied to the handle on that side. In extreme slippery conditions tire chains are recommended.
8. The Auger Control should be released immediately if an object becomes lodged or hit by the Auger.
9. All controls are positioned at the handles for the operators safety.
10. After completion of plowing operation, allow the engine to operate in a sheltered area for about 5 min. to

dry itself and prevent the formation of ice. When possible, store the Sno-Away in a cold area so that clinging snow will not melt and refreeze into ice.

11. The following points should be followed when storing unit during off season.

1. Run engine to drain Fuel Tank. (old gas leaves deposits)
2. Lubricate bare metal to prevent rust.
3. Change engine oil - recommend use type 10W-30W.

LUBRICATION

1. There is one grease fitting on this Sno-Away (See Fig. 6). Lubricate with a general purpose automotive type grease every 15 hours of operation. Also the occasional application of light motor oil as indicated on Figs. 1 & 6 . will assist in operation of this Sno-Away.
2. Use of 10W30 automotive type motor oil is recommended for use in the transmission and auger worm drive in this Sno-Away.
3. Oil should be maintained to the proper level, under normal condition there is no need to drain and refill during the season.
4. The filler plug on the transmission is located at the rear of the unit on the top of the transmission. The transmission should be filled to the level of the oil level plug which is located on the right side of the transmission. (See Fig. 6) The drain plug is located at the bottom of the transmission.
5. The Auger Worm Drive Housing oil level should be kept level with the pipe plug hole located in the front of the housing.

TIRE PRESSURE

Ten (10) lbs of tire pressure is recommended.

BELT TENSION

Belt Tension for the Rotor Drive is regulated by the position of the set collar on the Rotor Clutch Rod. Normally a clearance of 3/4" between the set collar and top bracket will properly tension this belt. Check this adjustment when the rotor clutch is engaged. Refer to Fig. 5.

BELT STOPS

Belt Stops are used on this Sno-Away as shown in Fig. 6. Engage Rotor Clutch and Transmission Clutch and check clearance between belt and stop. The belt stop will be properly adjusted when 1/16" clearance is visible between the stop and the belt.

To adjust, loosen the hex capscrews and reposition the stops to proper clearance. Retighten hex capscrews to hold stops in proper position.

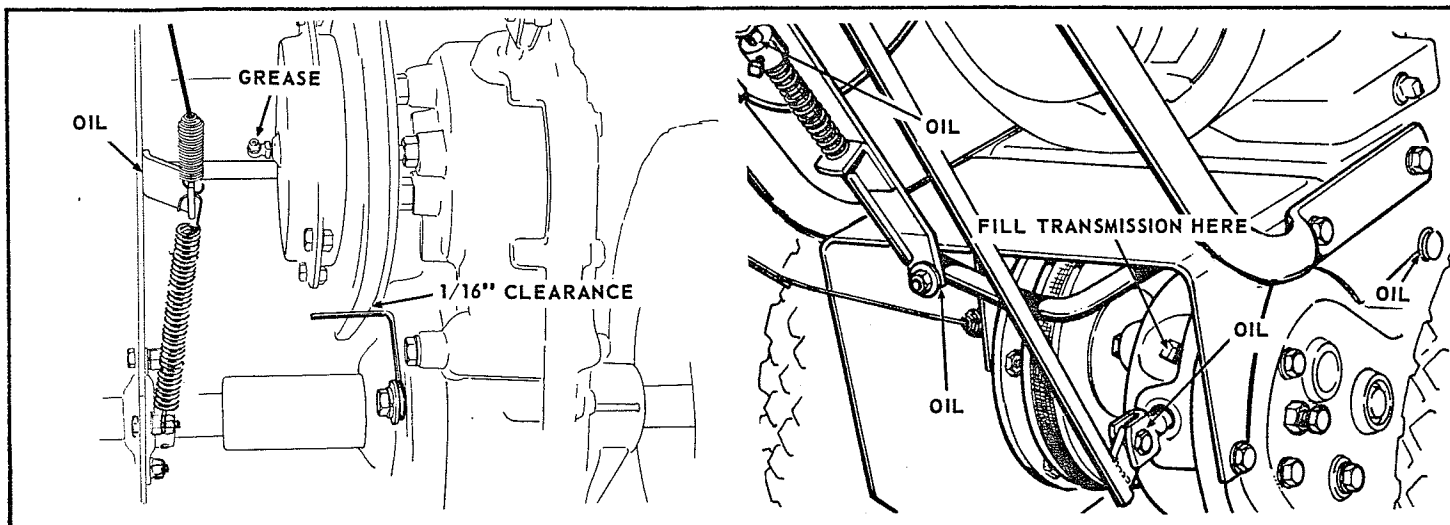

FIGURE 6

SAFE SNOW REMOVAL IS NO ACCIDENT

Improper use of snow removal equipment on the part of the operator can result in injury. To reduce this possibility, give complete and undivided attention to the job at hand.

Protect Yourself and Others By Following These Safety Tips

1. Disengage power and stop motor before cleaning discharge, removing obstacles, making adjustments, or when leaving operating position.
2. Never direct discharge at bystanders nor allow anyone in front of machine -- debris may be hidden in the snow.
3. Keep children and pets a safe distance away.
4. Do not allow children to operate machine nor allow adults to operate it without proper instructions.
5. Adjust height to clear gravel or crushed rock surface.
6. Exercise caution to avoid slipping or falling, especially when operating in reverse.
7. Know the controls and how to stop quickly -- read the owner's manual.
8. Handle gasoline with care -- it is highly flammable.
 - a. Use approved gasoline container.
 - b. Never add gasoline to a running motor -- fill tank out of doors and wipe up spilled gasoline.
 - c. Replace gasoline cap securely.
 - d. Open doors if motor is run in garage -- exhaust gases are dangerous
9. Disengage all clutches and shift into neutral before starting motor. Keep hands, feet and clothing away from power driven parts.
10. Use a grounded three wire extension cord for all plug-in electric units.
11. Keep machine in good operating condition and keep safety devices in place.

HANDLES and CONTROLS

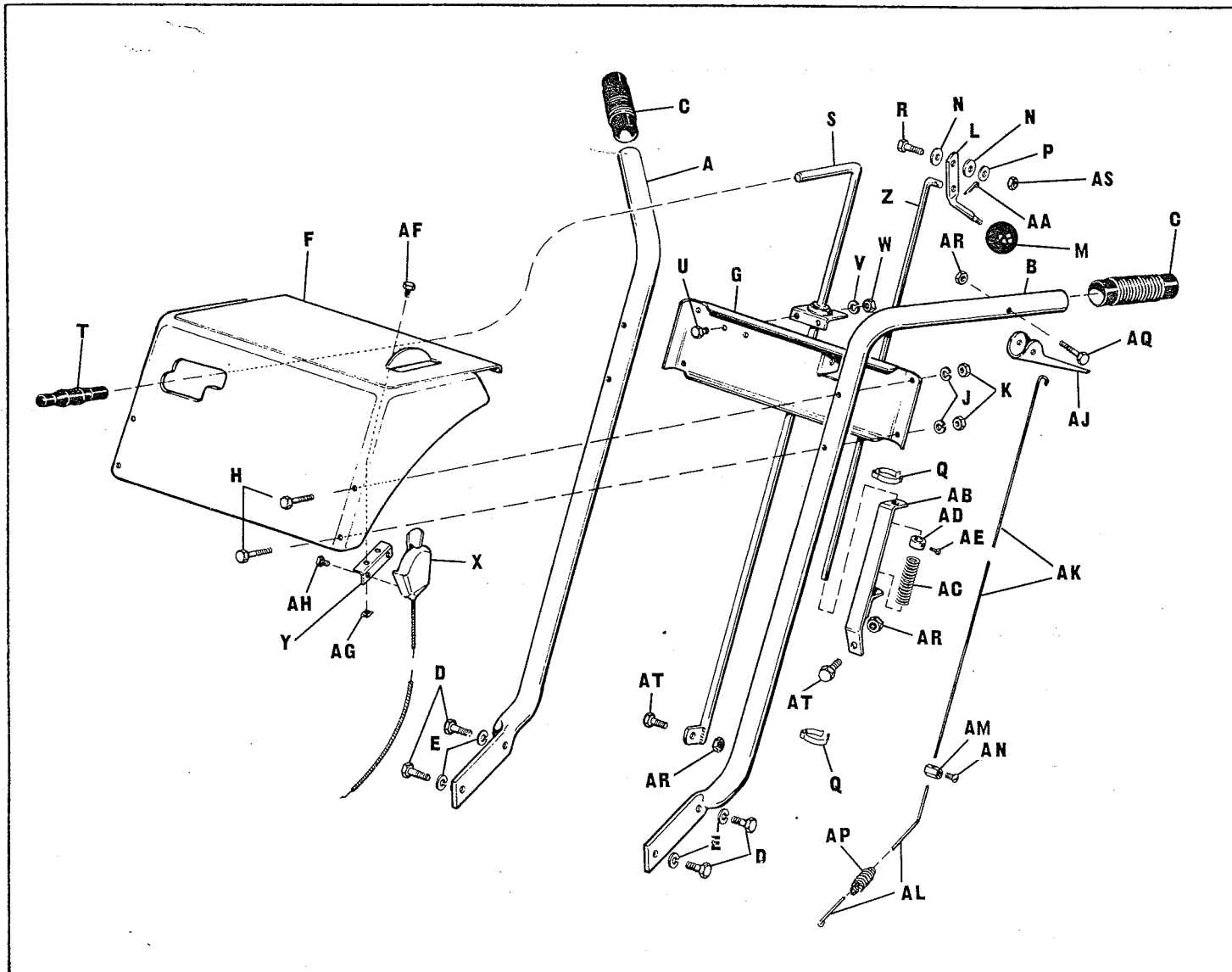

Ref. Let.	Part No.	Description
A	161050	R. H. Handle Bar
B	161051	L. H. Handle Bar
C	106558	Grip
D	705031	Hex. Cap Screw, 3/8"-16 x 7/8"
E	720002	Lock Washer, 3/8"
F	161049	Control Housing Assembly
G	161084	Handle Cover
H	705025	Hex. Cap Screw, 1/4"-20 x 1-1/2"
J	720003	Lock Washer, 1/4"
K	717005	Full Hex. Nut, 1/4"-20
L	161085	Clutch Auger Handle
M	8021050	Knob Ball
N	159134	Nylon Washer
P	719006	Plain Washer, 1/4"
Q	8061108	Cable Clip.
R	705001	Hex. Cap Screw, 5/16"-18 x 7/8"
S	161035	Shift Rod Assembly
T	161105	Handle Grip
U	705002	Hex. Cap Screw, 1/4"-20 x 1/2"
V	720003	Lock Washer, 1/4"
W	717005	Full Hex. Nut, 1/4"-20

Ref. Let.	Part No.	Description
X	161089	Throttle Control Assembly
Y	106524	Throttle Support
Z	161052	Clutch Rod
AA	722001	Cotter Pin, 3/32" Dia. x 3/4"
AB	161041	Guide Assembly
AC	8191045	Spring
AD	8191022	Set Collar
AE	713001	Set Screw, 1/4" - 20 x 3/8"
AF	714003	Self Tapping Screw, #10 x 1/2"
AG	718019	Speed Nut
AH	714005	Self Tapping Screw, #10-24 x 1/2"
AJ	118056	Clutch Grip
AK	161090	Extension, Spring
AL	161091	Extension Wire
AM	161092	Wire Clamp
AN	710006	Hd. Rnd. Screw, #10-24 x 3/8"
AP	161093	Spring
AQ	705025	Hex Cap Screw, 1/4"-20 x 1-1/2"
AR	717513	Full Lock Hex. Nut, 1/4"-20
AS	717525	Nut Stop, 5/16"-18 w/Nylon Insert
AT	715051	Hex. Cap Screw

ENGINE and FRAME PARTS LIST

Ref. Let.	Part No.	Description
A	161097	Engine
B	161029	Engine Base & Frame
C	705023	Hex. Cap Screw, 5/16"-18 x 1-3/4"
D	720001	Lock Washer, 5/16"
E	717001	Full Hex. Nut, 5/16"-18
F	718039	Retainer Nut
G	161005	Idler Bracket, 3/16" x 1-1/2" x 5-7/8"
H	705019	Hex. Cap Screw, 5/16"-18 x 1-1/4" lg.
J	720001	Lock Washer, 5/16"
K	717001	Full Hex. Nut, 5/16"-18
L	106716	Idler Pulley
M	161113	Belt Guard
N	719006	Plain Washer, 1/4"
P	705009	Hex. Cap Screw, 3/8"-16 x 1-1/2"
Q	719002	Plain Washer, 5/16"
R	720002	Lock Washer, 3/8"
S	717003	Full Hex. Nut, 3/8"-16
T	161032	Clutch Pulley Pivot Assembly
U	158399	Retaining Ring
V	101096	Idler Pulley
W	705010	Hex. Cap Screw, 3/8"-16 x 1-3/4"
X	159106	Spring
Y	106532	Ball Bearing
Z	705017	Hex. Cap Screw, 5/16"-18 x 3/4"
AA	705007	Hex. Cap Screw, 5/16"-18 x 1"
AB	720001	Lock Washer, 5/16"
AC	717001	Full Hex. Nut, 5/16"-18
AD	717511	Full Lock Hex. Nut, 5/16"-18
AE	161039	Engine Pulley
AF	713504	Set Screw, 5/16"-18 x 3/8"
AG	159129	Key
AH	161057	Belt Guard
AJ	706010	Hex. Cap Screw, 1/2"-20 x 3/4"
AK	721506	Int. Lock Washer, 1/2"
AL	106689	"V" Belt
AM	161098	"V" Belt
AN	161017	Engine Pulley Cover
AP	715037	Thumb Screw, 5/16"-18 x 3/4"
AQ	718030	Tinnerman Nut
AR	161081	Back Cover
AS	718038	Tinnerman Nut
AT	714020	Self Tapping Hex. Hd. Screw, #14AB x 5/8"
AU	161034	Clutch Auger Rod Assembly
AV	722015	Cotter Pin
AW	161058	Torsion Spring
AX	705016	Hex. Cap Screw, 3/8"-16 x 1-1/4"
AY	719002	Plain Washer, 5/16"
AZ	720002	Lock Washer, 3/8"
BA	717003	Full Hex. Nut, 3/8"-16
BB	154534	Idler Pulley
BC	161056	Angle Bracket
BD	705012	Hex. Cap Screw, 5/16"-18 x 5/8"
BE	720001	Lock Washer, 5/16"
BF	717001	Full Hex. Nut, 5/16"-18
BG	161080	Belt Stop
BH	705011	Hex Capscrew 3/8"-16x5/8"lg.
BJ	720002	Lock Washer 3/8"

TRANSMISSION PARTS LIST

Ref. Let.	Part No.	Description
A	157017	Sub Gear Case
B	723007	Roll Pin, 3/8" dia. x 1"
C	156072	Roller Bearing
D	156073	Roller Bearing
E	101042	Half Ball Bushing
F	156308	Sub Roll Pin Assembly
G	156031	Shift Rod Assembly
H	726003	Pipe Plug, 3/8"
J	726252	Pipe Plug
K	156077	Rev. Shift Shaft
L	8061048	Retaining Ring
M	156078	Hi-Lo Shift Shaft
N	717022	Full Hex. Nut, 7/16"-14
P	156079	Rev. Shift Fork
Q	156080	I & II Shift Fork
R	154262	Shift Lock Ball
S	154323	Spring
T	156081	Rev. Pinion Shaft
U	156020	Reverse Pinion
V	156082	Roller Bearing
W	156083	Pulley Shaft
X	156084	Oil Seal
Y	156085	Washer
Z	8061048	Retaining Ring
AA	156086	Key
AB	156087	Hi-Lo Pinion Assembly
AC	156089	Washer
AD	156090	Cluster Gear Assembly
AE	156292	Dowel Pin
AF	156094	Drive Gear Assembly
AG	121311	Differential Pinion
AH	121084	Differential Spacer
AJ	121083	Differential Pinion
AK	156002	Differential Plate
AL	705003	Hex. Cap Screw, 3/8"-16 x 2-1/4"
AM	717510	Full Lock Hex. Nut, 3/8"-16
AN	156096	Axle Housing Assembly
AP	118118	Oil Seal
AQ	105195	Roller Bearing
AR	156099	Oil Seal
AS	705031	Hex. Cap Screw, 3/8"-16 x 7/8"
AT	720002	Lock Washer, 3/8"
AU	105083	Washer
AV	161002	R. H. Axle Shaft Assembly
AW	161036	Gear Case Cover (w/Brg. AX, AY & AZ)
AX	156102	Roller Bearing
AY	156073	Roller Bearing
AZ	105195	Roller Bearing
BA	156103	Case Gasket
BB	705019	Hex. Cap Screw, 5/16"-18 x 1-1/4"
BC	720001	Lock Washer, 5/16"
BD	105083	Washer
BE	161024	L. H. Axle Shaft Assembly
BF	161096	Special Bolt
BG	717013	Jam Hex. Nut, 3/8"-16
BH	719001	Plain Washer
BJ	726002	Pipe Plug, 1/4"-18
BK	161072	Cluster Shaft
BL	161130	Special Screw
BM	705011	Hex. Cap Screw
BN	720002	Lock Washer
BP	713507	Set Screw

TRANSMISSION

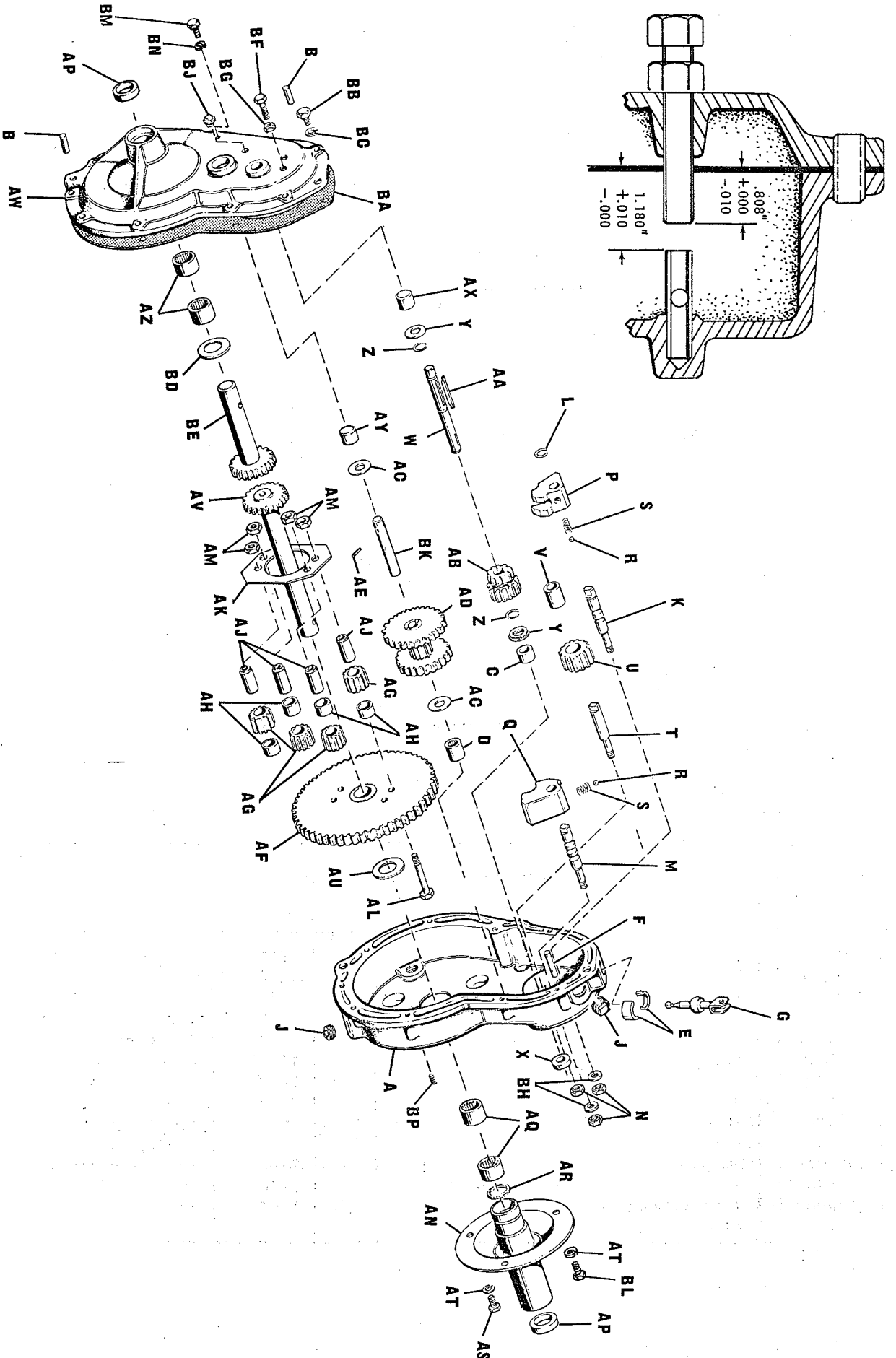

SPOUT and CONTROLS

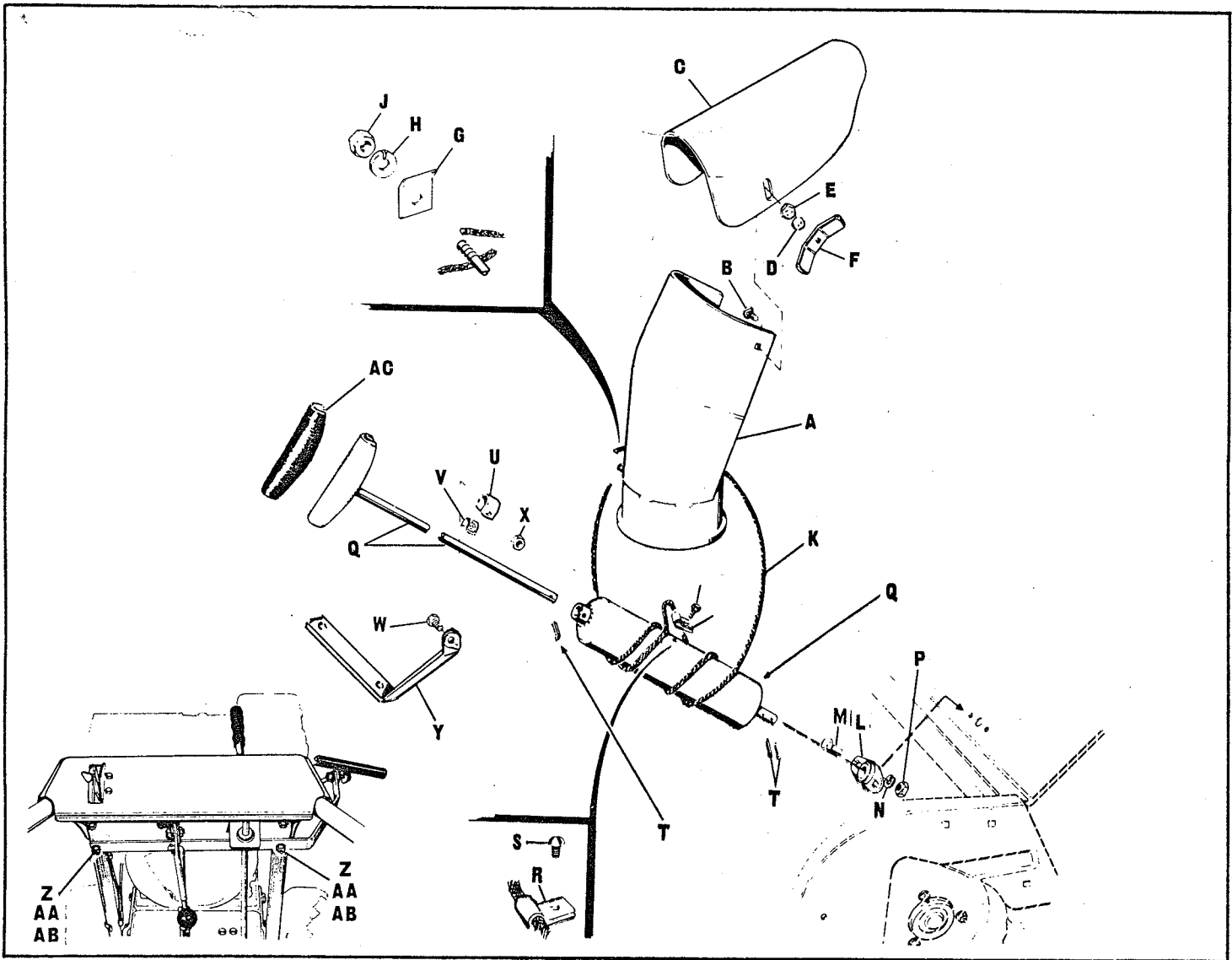

Ref. Let.	Part No.	Description
A	161099	Spout Assembly
B	703005	Carriage Bolt, 5/8-16 x 3/4"
C	106489	Spout Extension
D	719001	Plain Washer, 3/8"
E	721601	Lock Washer, 3/8" Shakeproof
F	106229	Wing Nut
G	161114	Friction Plate
H	720001	Lock Washer, 5/16"
J	717001	Hex Nut, Full, 5/16"-18
K	161118	Spout Cord
L	106551	Bearing
M	705015	Hex Capscrew, 1/4"-20 x 5/8" lg.
N	720003	Lock Washer, 1/4"
P	717005	Hex Nut, Full, 1/4"-20

Ref. Let.	Part No.	Description
Q	161100	Tube Assembly, Spout Control
R	154247	Clamp
S	714016	Screw, Self-tapping, 1/4-20 x 1/2"
T	722009	Cotter Pin, 1/8" x 3/4" lg.
U	106221	Rod Guide
V	121175	Guide Liner
W	705019	Hex Capscrew, 5/16"-18 x 1-1/4"
X	717511	Hex Lock Nut, Full, 5/16"-18
Y	161101	Spout Adjusting Rod Support
Z	705053	Hex Capscrew, 1/4-20 x 1-3/4" lg.
AA	720003	Lock Washer, 1/4"
AB	717005	Hex Nut, Full, 1/4"-20
AC	106516	Handle Cover

WHEELS and LOW SPEED PULLEY

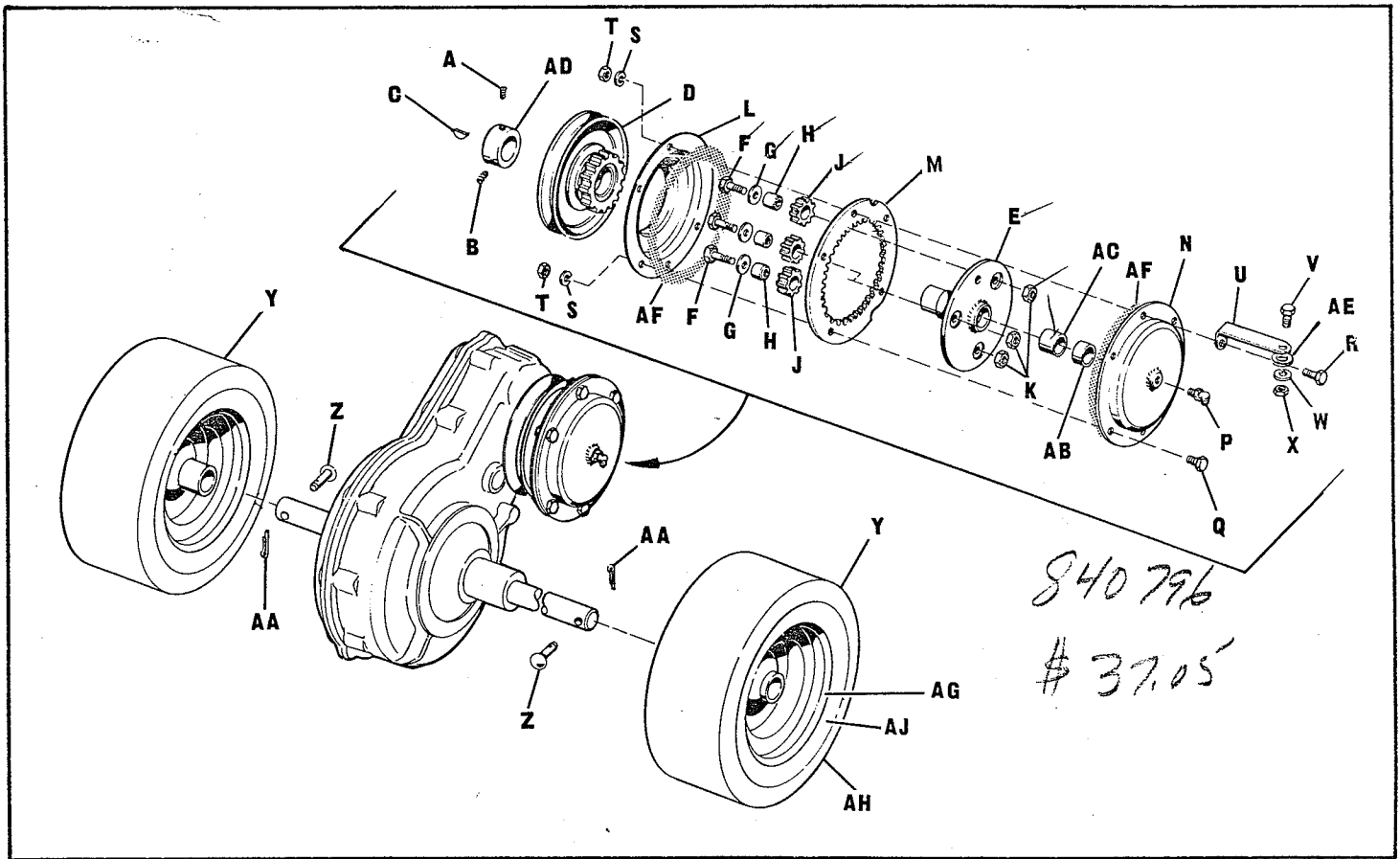

Ref. Let.	Part No.	Description
A	713501	Set Screw, 5/16''-18 x 1/2''
B	713504	Set Screw, 5/16''-18 x 3/8''
C	725003	Woodruff Key, 3/16'' x 3/4''
D	161045	Pulley & Gear Assembly
E	161076	Spider & Bearing Assembly
F	715038	Hex. Cap Screw, 3/8''-16 x 1''
G	719002	Plain Washer, 5/16''
H	161078	Pinion Spacer
J	161079	Pinion
K	717510	Full Lock Hex. Nut, 3/8''-16
L	161054	L. H. Cover
M	157382	Ring Gear
N	161055	R. H. Cover Assembly
P	727004	Grease Fitting
Q	715071	Hex. Cap Screw, 5/16''-18 x 5/8''
R	715020	Hex. Cap Screw, 5/16''-18 x 3/4''
S	720001	Lock Washer, 5/16''

Ref. Let.	Part No.	Description
T	717001	Full Hex. Nut, 5/16''-18
U	161022	Planetary Pulley Stop
V	705012	Hex. Cap Screw, 5/16''-18 x 5/8''
W	720001	Lock Washer, 5/16''
X	717001	Full Hex. Nut, 5/16''-18
Y	161094	Wheel & Tire Assembly
Z	118053	Pin
AA	722009	Cotter Pin, 1/8'' Dia. x 1''lg.
AB	156242	Bearing
AC	157330	Bearing
AD	154065	Set Collar
AE	719006	Plain Washer, 1/4''
AF	161129	Gasket
AG	161095	Wheel
AH	156213	Tire*
AJ	156214	Tube

*OBTAIN FROM TIRE MANUFACTURER

ROTOR DRIVE GROUP

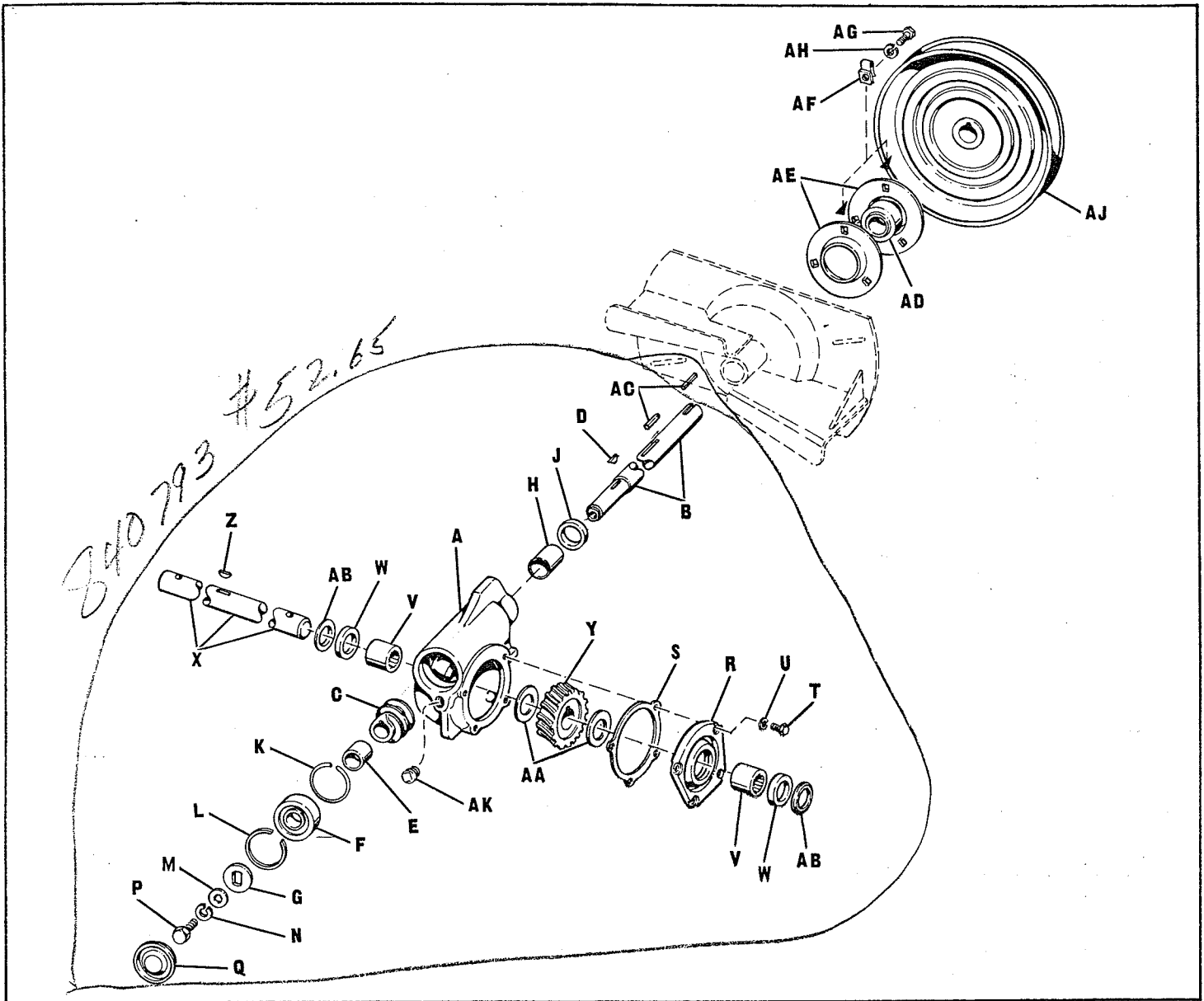

Ref. Let.	Part No.	Description
A	161018	Worm Drive Housing
B	161064	Worm Gear Shaft
C	161065	Worm
D	725502	Key
E	118060	Spacer
F	118011	Ball Bearing
G	118178	Washer
H	158337	Bushing
J	118117	Oil Seal
K	118094	Snap Ring
L	118061	Retaining Ring
M	719002	Plain Washer, 5/16"
N	720002	Lock Washer, 3/8"
P	715004	Hex Cap Screw, 3/8"-24 x 1"
Q	118179	Cup
R	118316	Cover
S	118024	Gasket

Ref. Let.	Part No.	Description
T	715018	Hex Cap Screw, 1/4"-20 x 5/8"
U	720003	Lock Washer, 1/4"
V	118020	Needle Bearing
W	118118	Oil Seal
X	161066	Worm Gear Shaft
Y	161067	Worm Gear
Z	725005	Woodruff Key
AA	118315	Thrust Washer
AB	118082	Washer
AC	8061081	Key
AD	161068	Cartridge Bearing
AE	161069	Bearing Flange
AF	718030	Retainer Nut
AG	705017	Hex Cap Screw 5/16"-18 x 3/4"
AH	720001	Lock Washer, 5/16"
AJ	161070	Pulley
AK	726003	Pipe Plug, 3/8"

BODY and ROTOR GROUP

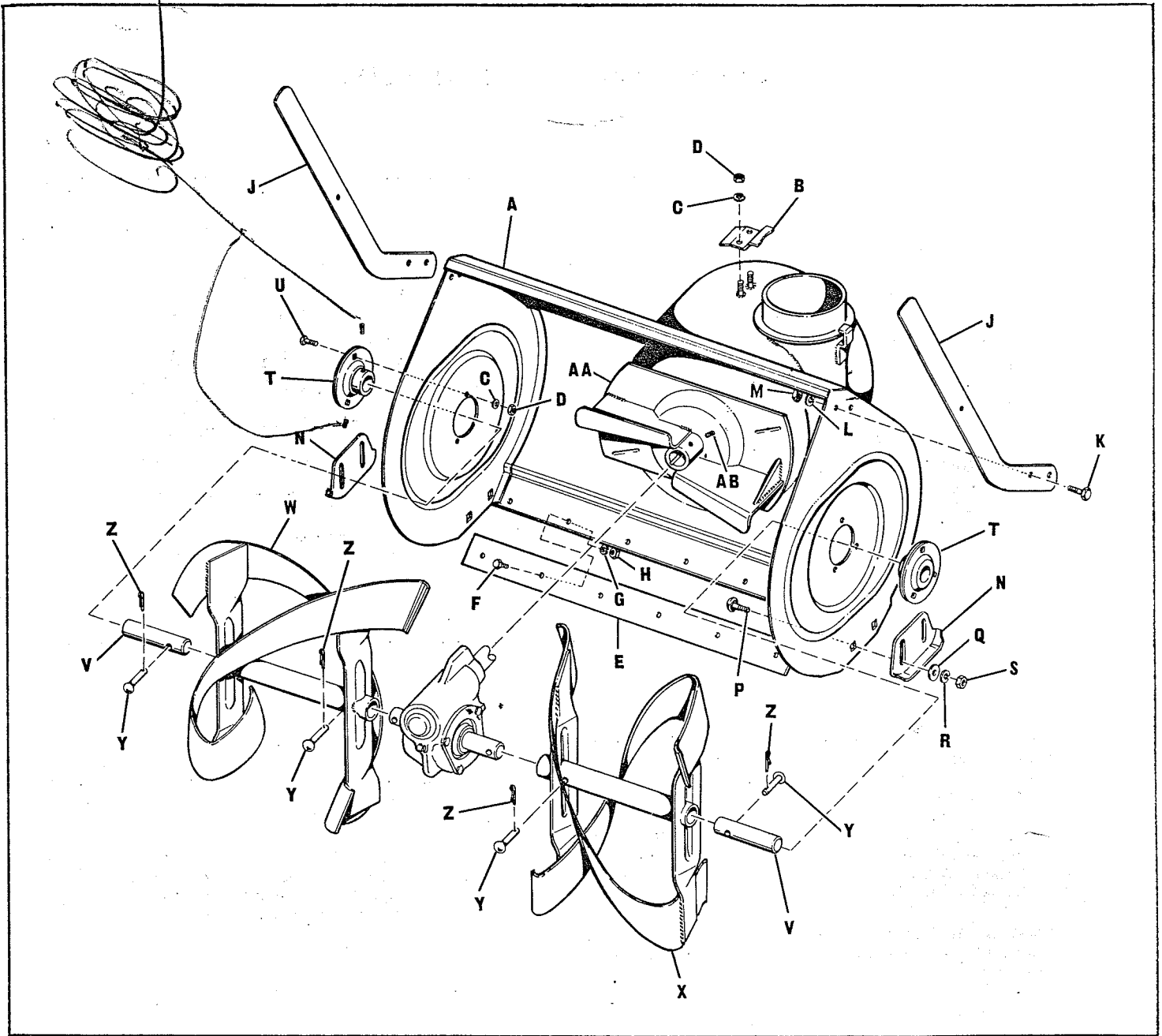

Ref. Let.	Part No.	Description
A	161001	Body Assembly
B	161116	Hold Down Clip
C	720001	Lock Washer, 5/16"
D	717001	Full Hex Nut, 5/16"-18
E	161059	Scraper Blade
F	715018	Hex Cap Screw, 1/4"-20 x 5/8"
G	720003	Lock Washer, 1/4"
H	717005	Full Hex Nut, 1/4"-20
J	161042	Cutter, Drift, 3/16" x 1-1/2 x 18-3/8
K	705004	Hex Cap Screw, 3/8"-16 x 3/4"
L	720002	Lock Washer, 3/8"
M	717003	Full Hex Nut, 3/8"-16
N	161006	Skid

Ref. Let.	Part No.	Description
P	703004	Carriage Bolt, 3/8"-16 x 3/4"
Q	719001	Plain Washer, 3/8"
R	720002	Lock Washer, 3/8"
S	717003	Full Hex Nut, 3/8"-16
T	106532	Ball Bearing
U	705017	Hex Cap Screw, 5/16"-18 x 3/4"
V	161060	Shaft Auger
W	161020	R.H. Auger Assembly
X	161019	L. H. Auger Assembly
Y	118053	Pin
Z	722006	Cotter Pin, 1/8" Dia. x 1" lg.
AA	161011	Impellar Assembly
AB	713002	Set Screw, 5/16"-18 x 3/8"

Spout Cord Installation

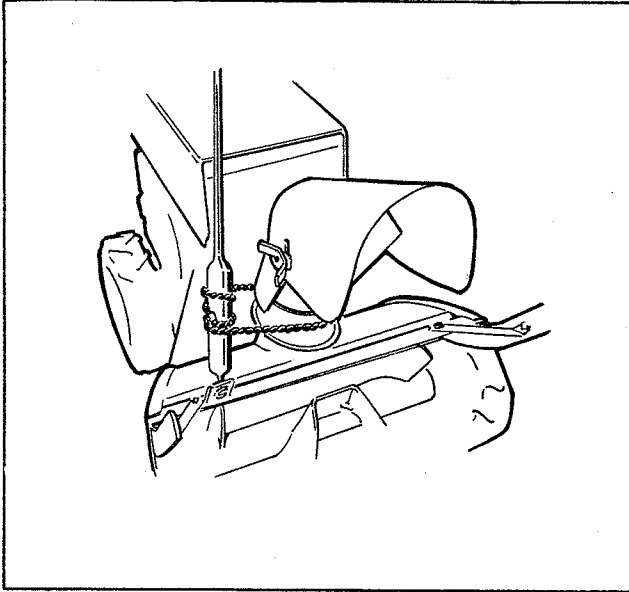

FIGURE "A"

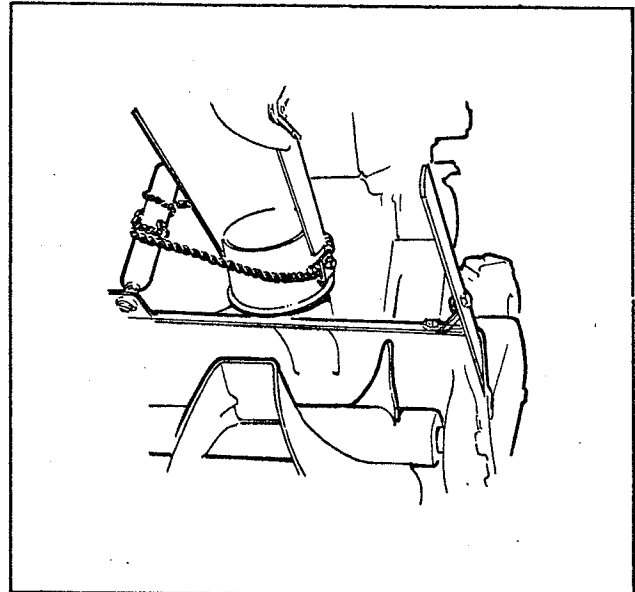

FIGURE "B"

1. Insert the end of the spout control assembly, through the bearing and secure with a cotter pin on both sides of the bearing. See Fig. "A". Lean the control assembly on the hood assembly as shown.
2. Position the spout to face forward and turn the cord drive tube so that the cord clamp faces the side of the spout as shown in Fig. "B". Notice that there is one loop above and below the clamp.
3. Position the free ends of the cord around the spout and clamp securely into position after removing all slack from the cord.

4. The upper end of the spout control rod #5, Fig. 4, is fastened to the spout control rod support bracket #1, Fig. 4 using the rod guide #4, Fig. 4, with plastic liner and one 5/16"-18 x 1-1/2" hex capscrew and 5/16"-18 hex nut.

5. Fasten the spout extension #4, Fig 5 to the spout assembly using the two 5/16"-18 x 3/4" long carriage bolts, 3/8" special hexagon lockwashers and 3/8" plain washers and wing nuts. Adjust as desired.

DECALS

106512	"S"
161107	"Control"
161108	"7 HP"
161109	Shifting Decal
161110	Instruction Decal
161111	"Safety"
161112	"Sno-Away"

11-16-66

Simplicity

2 STAGE SNO-AWAY 7 H.P.

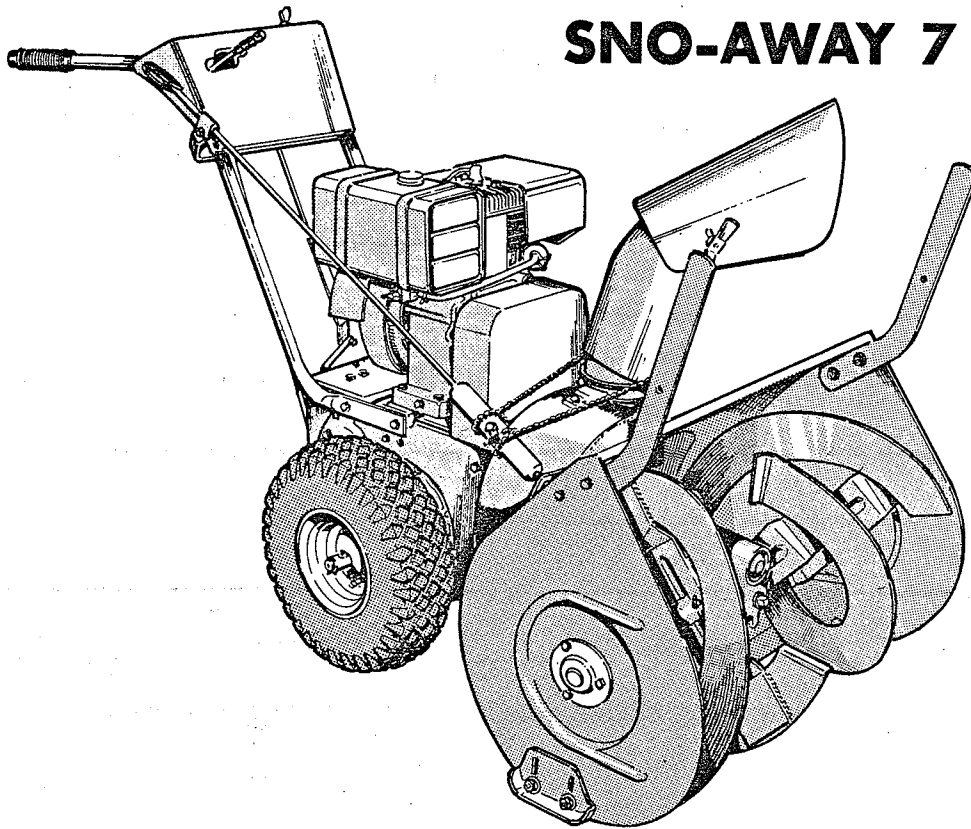

Mfr's. No. 372

12345678910

SIMPLICITY MANUFACTURING COMPANY, INC.

GUARANTEE

The company guarantees Simplicity Products to be free from defects in material and workmanship except the company makes no warranty express or implied with respect to tires, engines and engine accessories which generally are warranted by their respective manufacturers. Any part covered by this warranty which is proven defective within one year, under normal use, from date of purchase, will be replaced free of charge, f.o.b. Port Washington, Wisconsin, provided such part is returned to factory transportation charges prepaid and is found to be defective upon examination at the factory. The company is not obligated under this guarantee to bear cost of labor or delivery charges in replacement of defective parts. This guarantee does not apply to any Simplicity Products altered outside of Simplicity's factory. Such replacement of defective parts shall be the exclusive remedy and in no event shall Simplicity be liable for consequential damages. EXCEPT AS SPECIFICALLY PROVIDED HEREIN, THERE ARE NO WARRANTIES WHICH EXTEND BEYOND THE DESCRIPTION ON ANY SIMPLICITY PRODUCT.

This form is to be used in lieu of the Registration (Warranty) Card.

Should warranty service be necessary, the information below should be presented to the authorized SIMPLICITY Dealer.

Customer's Name _____

Address _____

Mfg. No. _____ Serial No. _____

Date Purchased _____

Purchased From _____

Address _____

Engine Model No. _____ Serial No. _____ Type No. _____

To obtain replacement parts from dealer, advise quantity, part number and description.

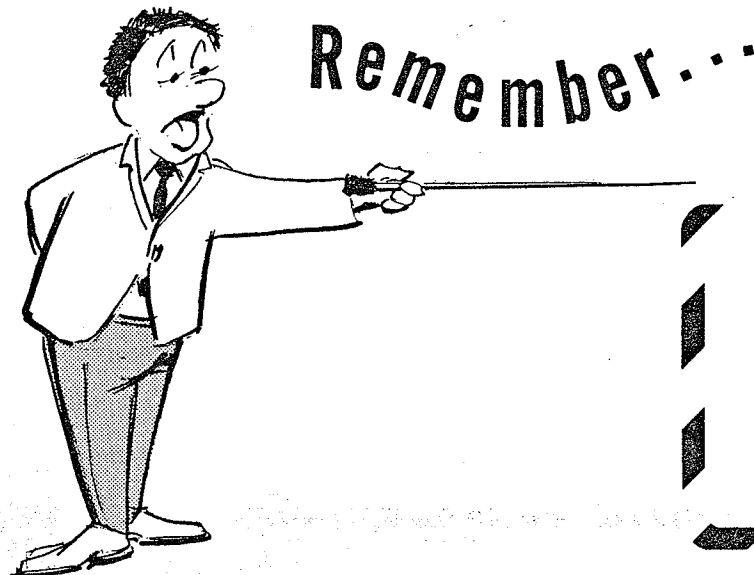

FOR YOUR SAFETY

1. ALWAYS STOP ENGINE BEFORE LEAVING MACHINE
2. ALWAYS STOP ENGINE BEFORE SERVICING OR ADJUSTING MACHINE OR EQUIPMENT
3. ALWAYS KEEP HANDS, FEET AND CLOTHING AWAY FROM POWER-DRIVEN PARTS

ASSEMBLY

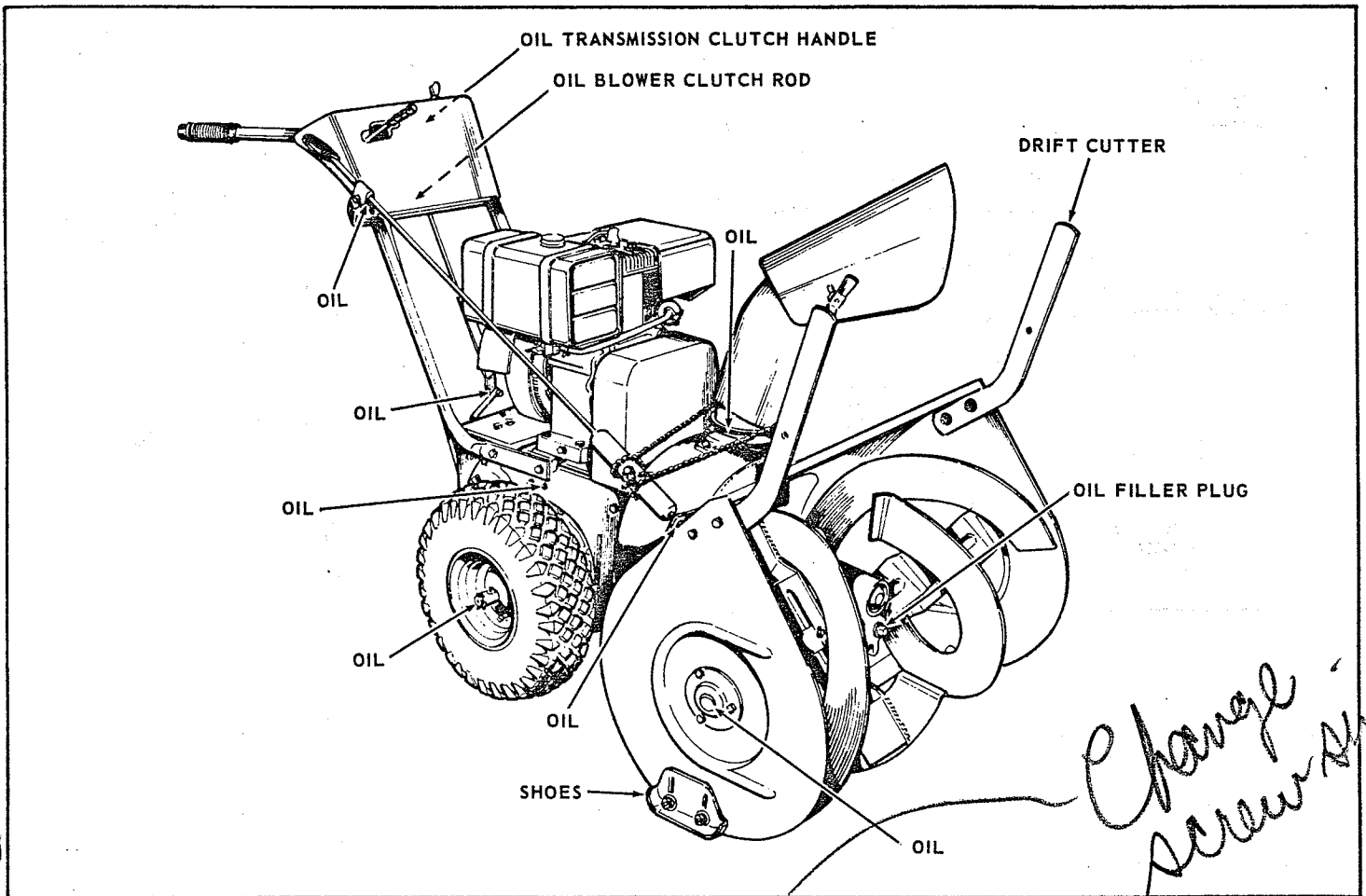

FIGURE 1: ATTACH SPEED RODS TO THROTTLE CONTROL BODY

To assemble the Sno-Away, follow the sequence of steps as outlined below:

1. Attach the left and right hand shoe to the outside of body assembly with the 3/8"-16NC x 3/4" long carriage bolt, 3/8" plain and 3/8" lockwasher. Secure with 3/8"-16NC full hex nut, which is on outside of shoe at desired elevation for your specific needs. (Sno-Away should be raised when using on gravel). See Fig. 1.

2. Attach Left and Right Hand Drift Cutters to the inside of Body Assembly with the 5/16"-18 x 3/4" long hex capscrews, 5/16" plain and 5/16" lockwashers. Secure with 5/16"-18NC full hex. nut. See Fig. 1.

3. Fasten the Left and Right Handles loosely to the sides of the Frame Assembly using the 3/8" x 7/8" capscrew and 3/8" lockwashers. Do Not tighten securely at this time. See Fig. 2.

4. Install the Control Housing Assembly to the handles using the 1/4" x 1-1/2" capscrews in the top holes and the 1/4" x 1-3/4" capscrews in the bottom holes. Do not attach nuts and lockwashers at this time. See Fig. 2.

3. Fasten the Throttle Cable Assembly to the Throttle Support using the (two) 10-24 x 1/2" round head

self tapping screws. Mount throttle control assembly to the handle cover using the (two) 10-24 x 1/2" hex head self tapping screws. Install the cable clamp the handle, approximately 5" above the frame. See Fig. 2.

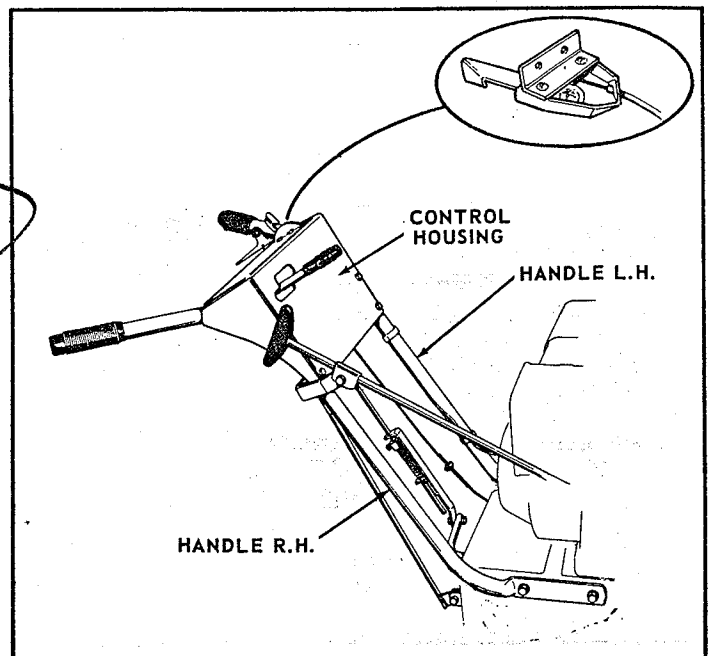

FIGURE 2

4. Assemble the Shift Rod Assembly to the handle cover using (two) 1/4" x 1/2" capscrews and 1/4" lockwashers. Secure with 1/4" nuts. Mount the handle cover to handles. Then attach the spout adjusting rod support to bottom holes and secure with 1/4" lockwashers and 1/4" nuts. See Fig. 3.

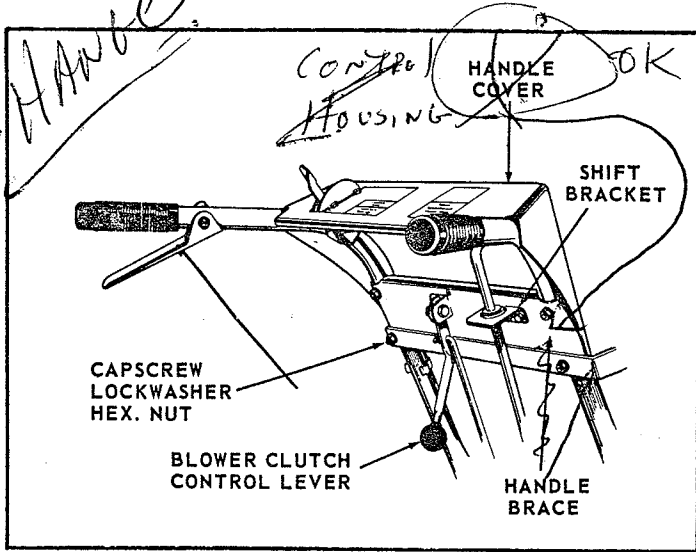

FIGURE 3

5. Attach the Shift Rod to the Shift Stem on the transmission using the 1/4" x 1" hardened capscrew and locknut. Tighten until there is no side play but that rod is free to pivot.

6. At this time tighten all nuts and bolts which were previously left loose. *When tightening with the 4 bolts holding the handle Assy to frame, handle should be held in up position while tightening.*

7. Mount the clutch auger handle to the handle cover using the 5/16" x 3/4" capscrews, 1/4" flat washer, and (two) nylon washers. Secure with 5/16" locknut. Tighten so that when clutch auger handle is pulled up the nylon washers will hold it in this position, but not to the point where it is unable to pivot. See Fig. 4.

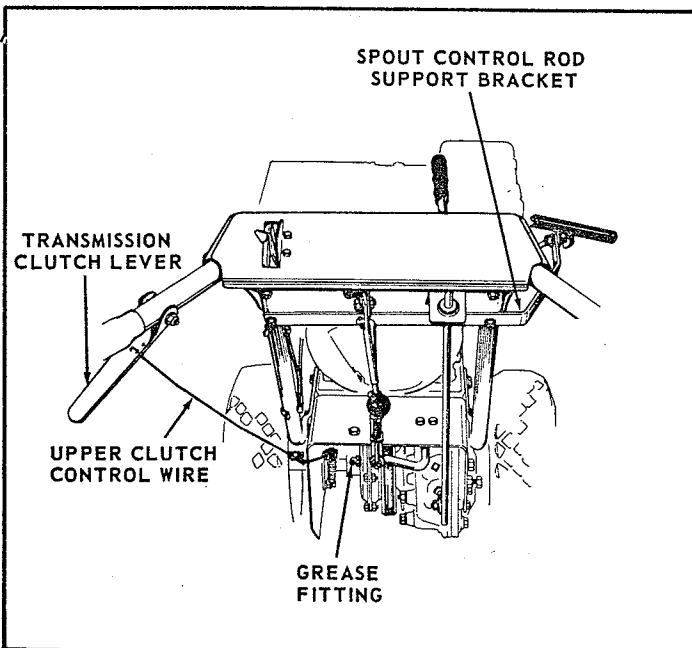

FIGURE 4

8. Attach the clutch rod assembly to the clutch auger handle using the 3/32" x 3/4" cotter pin. Attach the lower end of the clutch rod assembly to the clutch auger rod assembly using the 1/4" x 1" hardened capscrew and the 1/4" locknut. Tighten until there is no side play but that rod is free to pivot. See Fig. 5.

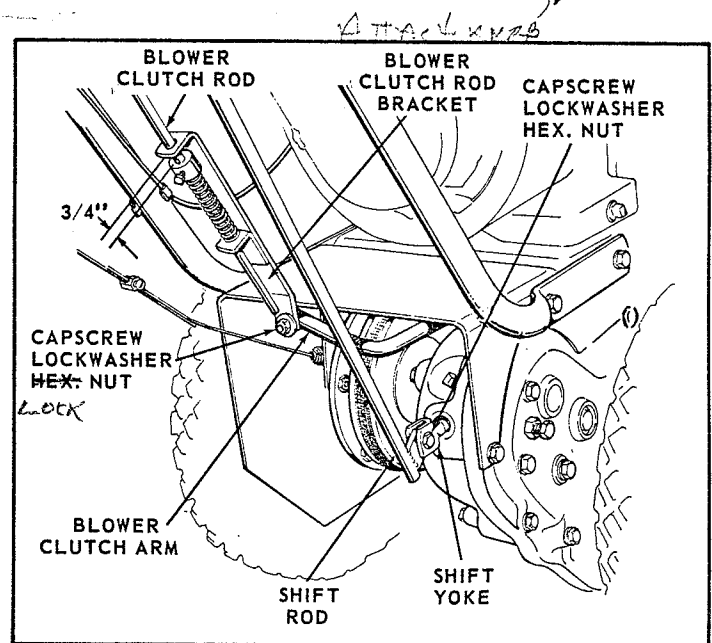

FIGURE 5

9. Remove the back cover by removing the (three) self tapping screws. Insert the wire extension thru the spring on the pivot assembly. See Fig. 5. Install wire extension thru upper left corner of back cover. Replace back cover. Insert spring extension thru bottom set of holes in clutch grip.

10. Install both the spring extension and the wire extension thru the wire clamp and fasten with the 10-24 x 3/8" round head screw. Remove slack from both wires and tighten.

11. Install spout extension to spout assembly using the 5/16" x 18 x 3/4" carriage bolts, 3/8" special hex lock washer, 3/8" plain washer and wing nuts. Adjust to suit. See page 16.

12. Position discharge spout directly forward. Position control tube so that the cord clamp faces away from the side of the spout. Place the tube so it rests on the gas tank. Provide one (1) coil on top and one (1) coil on bottom of the tube. Position the free ends of the cord around the spout and clamp securely into position after removing all slack from the cord. The end of the cord closest to operator passes under the tube, the end away from operator passes over the top of tube. Position the control tube so that it fits against the side of the spout adjusting rod support and fasten using the rod guide with liner and one 5/16" x 18 x 1-1/2" long hex capscrew and 5/16"-18 locknut.

TO START ENGINE

1. Before attempting to start the engine or to operate the Sno-Away, refer to the engine manufacturers Owners Manual for the proper fuel and oil.
2. Be sure petcock under gas tank is open. Follow engine instructions to prepare engine for operation.
3. Disengage auger. Place shift lever in neutral.
4. Move throttle control lever to 1/2 throttle.
5. Put choke lever in "Choke" position.
6. Pull re-coil starter rope to start engine.

OPERATION

1. Engage auger control lever.
2. Shift transmission lever to Hi or Lo as desired.
3. Squeeze Touch-O-Matic Control Handle to start machine in motion. When operating in heavy snow drifts, machine may be slowed down by slipping clutch (Touch-O-Matic Handle) to avoid choking out engine.
4. To operate the Sno-Away in reverse, release the Touch-O-Matic Control Handle and shift into reverse gear, then squeeze Touch-O-Matic Control Handle for reverse motion.
5. When using the Sno-Away, adjust the discharge spout so that the snow will be thrown with the wind and never into the wind. Throwing snow into the wind will be a source of discomfort to the operator. To alter the direction of discharge, rotate the spout by means of the Spout Adjust Handle. The distance that the snow may be thrown may be adjusted by loosening the two wing nuts on the Discharge Spout Extension and raising or lowering the extension to give the desired angle. After adjusting, push the extension snugly against the Spout Assembly to prevent snow from being blown backwards against the engine and operator. Slotted holes beneath the wing nuts will allow this to be done. Before tightening the wing nuts to hold the extension in the desired position.
6. If unit creeps after releasing the Touch-O-Matic Control Handle, Idler Pulley may be adjusted to remove belt tension, further adjustment may be obtained by removing washers under the engine base to lower engine.
7. If one of the wheels slip while blowing snow, pressure should be applied to the handle on that side. In extreme slippery conditions tire chains are recommended.
8. The Auger Control should be released immediately if an object becomes lodged or hit by the Auger.
9. All controls are positioned at the handles for the operators safety.
10. After completion of plowing operation, allow the engine to operate in a sheltered area for about 5 min. to

dry itself and prevent the formation of ice. When possible, store the Sno-Away in a cold area so that clinging snow will not melt and refreeze into ice.

11. The following points should be followed when storing unit during off season.

1. Run engine to drain Fuel Tank. (old gas leaves deposits)
2. Lubricate bare metal to prevent rust.
3. Change engine oil - recommend use type 10W-30W.

LUBRICATION

1. There is one grease fitting on this Sno-Away (See Fig. 6). Lubricate with a general purpose automotive type grease every 15 hours of operation. Also the occasional application of light motor oil as indicated on Figs. 1 & 6 . will assist in operation of this Sno-Away.
2. Use of 10W30 automotive type motor oil is recommended for use in the transmission and auger worm drive in this Sno-Away.
3. Oil should be maintained to the proper level, under normal condition there is no need to drain and refill during the season.
4. The filler plug on the transmission is located at the rear of the unit on the top of the transmission. The transmission should be filled to the level of the oil level plug which is located on the right side of the transmission. (See Fig. 6) The drain plug is located at the bottom of the transmission.
5. The Auger Worm Drive Housing oil level should be kept level with the pipe plug hole located in the front of the housing.

TIRE PRESSURE

Ten (10) lbs of tire pressure is recommended.

BELT TENSION

Belt Tension for the Rotor Drive is regulated by the position of the set collar on the Rotor Clutch Rod. Normally a clearance of 3/4" between the set collar and top bracket will properly tension this belt. Check this adjustment when the rotor clutch is engaged. Refer to Fig. 5.

BELT STOPS

Belt Stops are used on this Sno-Away as shown in Fig. 6. Engage Rotor Clutch and Transmission Clutch and check clearance between belt and stop. The belt stop will be properly adjusted when 1/16" clearance is visible between the stop and the belt.

To adjust, loosen the hex capscrews and reposition the stops to proper clearance. Retighten hex capscrews to hold stops in proper position.

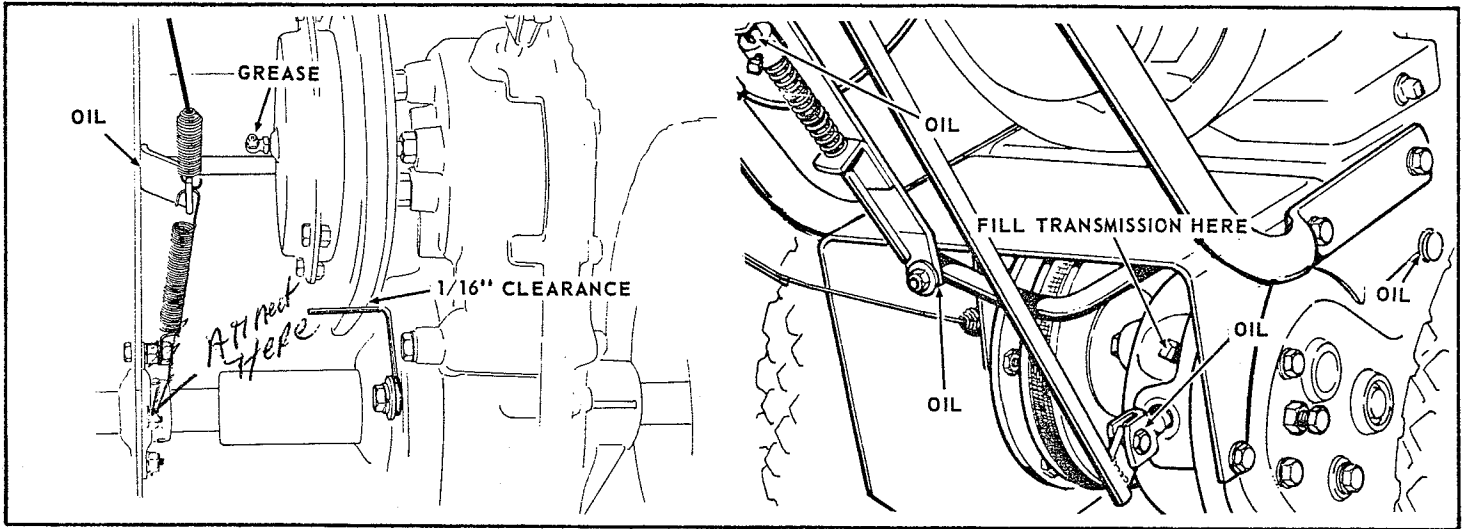

FIGURE 6

SAFE SNOW REMOVAL IS NO ACCIDENT

Improper use of snow removal equipment on the part of the operator can result in injury. To reduce this possibility, give complete and undivided attention to the job at hand.

Protect Yourself and Others By Following These Safety Tips

1. Disengage power and stop motor before cleaning discharge, removing obstacles, making adjustments, or when leaving operating position.
2. Never direct discharge at bystanders nor allow anyone in front of machine -- debris may be hidden in the snow.
3. Keep children and pets a safe distance away.
4. Do not allow children to operate machine nor allow adults to operate it without proper instructions.
5. Adjust height to clear gravel or crushed rock surface.
6. Exercise caution to avoid slipping or falling, especially when operating in reverse.
7. Know the controls and how to stop quickly -- read the owner's manual.
8. Handle gasoline with care -- it is highly flammable.
 - a. Use approved gasoline container.
 - b. Never add gasoline to a running motor -- fill tank out of doors and wipe up spilled gasoline.
 - c. Replace gasoline cap securely.
 - d. Open doors if motor is run in garage -- exhaust gases are dangerous
9. Disengage all clutches and shift into neutral before starting motor. Keep hands, feet and clothing away from power driven parts.
10. Use a grounded three wire extension cord for all plug-in electric units.
11. Keep machine in good operating condition and keep safety devices in place.

HANDLES and CONTROLS

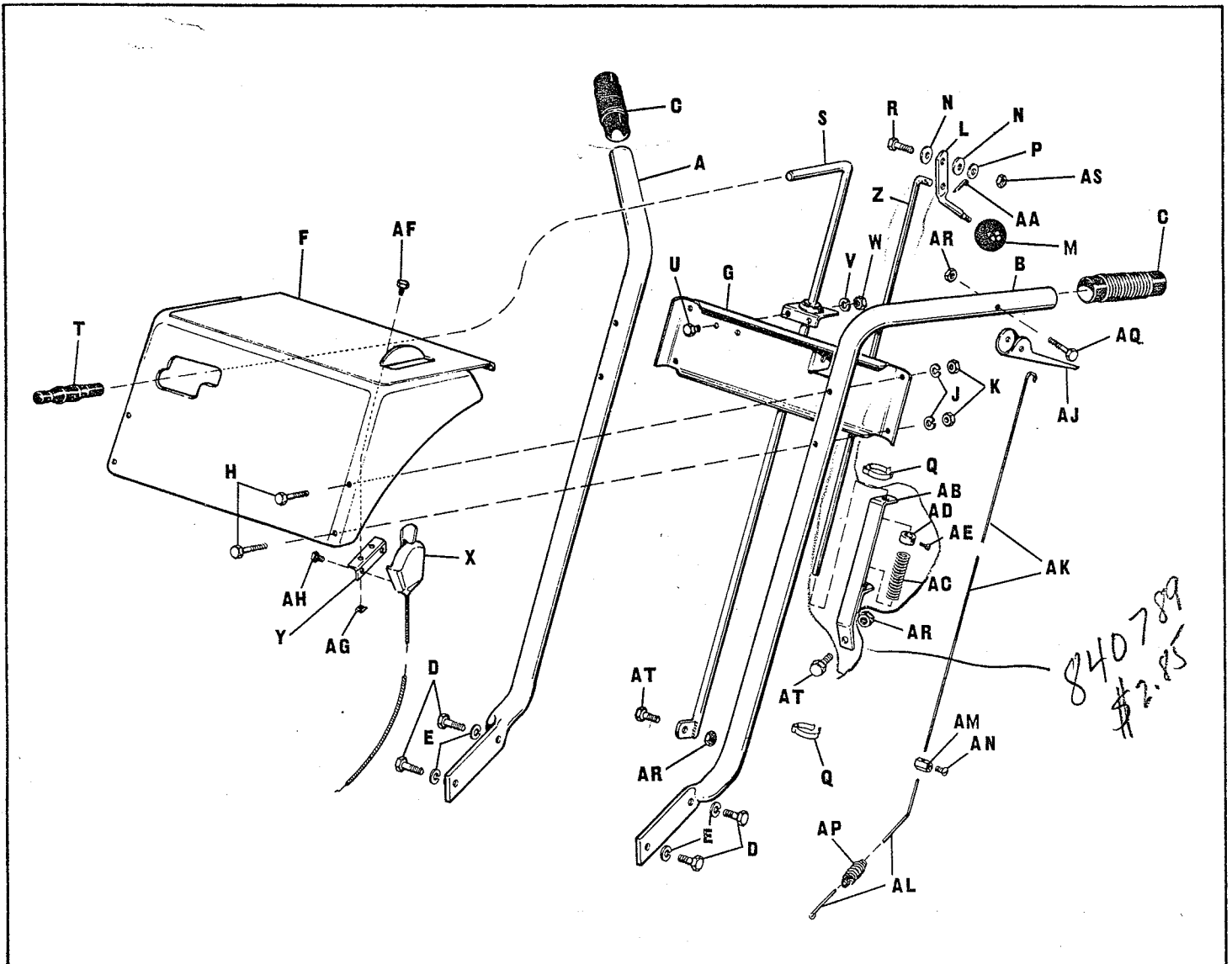

Ref. Let.	Part No.	Description
A	161050	R. H. Handle Bar
B	161051	L. H. Handle Bar
C	106558	Grip
D	705031	Hex. Cap Screw, 3/8"-16 x 7/8"
E	720002	Lock Washer, 3/8"
F	161049	Control Housing Assembly
G	161084	Handle Cover
H	705025	Hex. Cap Screw, 1/4"-20 x 1-1/2"
J	720003	Lock Washer, 1/4"
K	717005	Full Hex. Nut, 1/4"-20
L	161085	Clutch Auger Handle
M	8021050	Knob Ball
N	159134	Nylon Washer
P	719006	Plain Washer, 1/4"
Q	8061108	Cable Clip.
R	705017	Hex. Cap Screw, 5/16"-18 x 3/4" ^{7/8} 705001
S	161035	Shift Rod Assembly
T	161105	Handle Grip
U	705002	Hex. Cap Screw, 1/4"-20 x 1/2"
V	720003	Lock Washer, 1/4"
W	717005	Full Hex. Nut, 1/4"-20

Ref. Let.	Part No.	Description
X	161089	Throttle Control Assembly
Y	106524	Throttle Support
Z	161052	Clutch Rod
AA	722001	Cotter Pin, 3/32" Dia. x 3/4"
AB	161041	Guide Assembly
AC	8191045	Spring
AD	8191022	Set Collar
AE	713001	Set Screw, 1/4" - 20 x 3/8"
AF	714003	Self Tapping Screw, #10 x 1/2"
AG	718019	Speed Nut
AH	714005	Self Tapping Screw, #10-24 x 1/2"
AJ	118056	Clutch Grip
AK	161090	Extension, Spring
AL	161091	Extension Wire
AM	161092	Wire Clamp
AN	710006	Hd. Rnd. Screw, #10-24 x 3/8"
AP	161093	Spring
AQ	705025	Hex Cap Screw, 1/4"-20 x 1-1/2"
AR	717513	Full Lock Hex. Nut, 1/4"-20
AS	717511	Full Hex. Nut, 5/16"-18 ⁷¹⁷⁵²⁵
AT	717051	Hex. Cap Screw

715051

ENGINE and FRAME PARTS LIST

Ref. Let.	Part No.	Description
A	161097	Engine
B	161029	Engine Base & Frame
C	705023	Hex. Cap Screw, 5/16''-18 x 1-3/4''
D	720001	Lock Washer, 5/16''
E	717001	Full Hex. Nut, 5/16''-18
F	718039	Retainer Nut
G	161005	Idler Bracket, 3/16'' x 1-1/2'' x 5-7/8''
H	705019	Hex. Cap Screw, 5/16''-18 x 1-1/4'' lg.
J	720001	Lock Washer, 5/16''
K	717001	Full Hex. Nut, 5/16''-18
L	106716	Idler Pulley
M	161113	Belt Guard
N	719006	Plain Washer, 1/4''
P	705009	Hex. Cap Screw, 3/8''-16 x 1-1/2''
Q	719002	Plain Washer, 5/16''
R	720002	Lock Washer, 3/8''
S	717003	Full Hex. Nut, 3/8''-16
T	161032	Clutch Pulley Pivot Assembly
U	158399	Retaining Ring
V	101096	Idler Pulley
W	705010	Hex. Cap Screw, 3/8''-16 x 1-3/4''
X	159106	Spring
Y	106532	Ball Bearing
Z	705012	Hex. Cap Screw, 5/16''-18 x 5/8''
AA	705007	Hex. Cap Screw, 5/16''-18 x 1''
AB	720001	Lock Washer, 5/16''
AC	717001	Full Hex. Nut, 5/16''-18
AD	717511	Full Lock Hex. Nut, 5/16''-18
AE	161039	Engine Pulley
AF	713504	Set Screw, 5/16''-18 x 3/8''
AG	159129	Key
AH	161057	Belt Guard
AJ	706010	Hex. Cap Screw, 1/2''-20 x 3/4''
AK	721506	Int. Lock Washer, 1/2''
AL	106689	''V'' Belt
AM	161098	''V'' Belt
AN	161017	Engine Pulley Cover
AP	715037	Thumb Screw, 5/16''-18 x 3/4''
AQ	718030	Tinnerman Nut
AR	161081	Back Cover
AS	718038	Tinnerman Nut
AT	714020	Self Tapping Hex. Hd. Screw, #14AB x 5/8''
AU	161034	Clutch Auger Rod Assembly
AV	722015	Cotter Pin
AW	161058	Torsion Spring
AX	705016	Hex. Cap Screw, 3/8''-16 x 1-1/4''
AY	719002	Plain Washer, 5/16''
AZ	720002	Lock Washer, 3/8''
BA	717003	Full Hex. Nut, 3/8''-16
BB	154534	Idler Pulley
BC	161056	Angle Bracket
BD	705012	Hex. Cap Screw, 5/16''-18 x 5/8''
BE	720001	Lock Washer, 5/16''
BF	717001	Full Hex. Nut, 5/16''-18
BG	161080	Belt Stop
BH	705011	Hex Capscrew 3/8''-16x5/8''lg.
BJ	720002	Lock Washer 3/8''

TRANSMISSION PARTS LIST

Ref. Let.	Part No.	Description
A	157017	Sub Gear Case
B	723007	Roll Pin, 3/8" dia. x 1"
C	156072	Roller Bearing
D	156073	Roller Bearing
E	101042	Half Ball Bushing
F	156308	Sub Roll Pin Assembly
G	156031	Shift Rod Assembly
H	726003	Pipe Plug, 3/8"
J	726252	Pipe Plug
K	156077	Rev. Shift Shaft
L	8061048	Retaining Ring
M	156078	Hi-Lo Shift Shaft
N	717022	Full Hex. Nut, 7/16"-14
P	156079	Rev. Shift Fork
Q	156080	I & II Shift Fork
R	154262	Shift Lock Ball
S	154323	Spring
T	156081	Rev. Pinion Shaft
U	156020	Reverse Pinion
V	156082	Roller Bearing
W	156083	Pulley Shaft
X	156084	Oil Seal
Y	156085	Washer
Z	8061048	Retaining Ring
AA	156086	Key
AB	156087	Hi-Lo Pinion Assembly
AC	156089	Washer
AD	156090	Cluster Gear Assembly
AE	156292	Dowel Pin
AF	156094	Drive Gear Assembly
AG	121311	Differential Pinion
AH	121084	Differential Spacer
AJ	121083	Differential Pinion
AK	156002	Differential Plate
AL	705003	Hex. Cap Screw, 3/8"-16 x 2-1/4"
AM	717510	Full Lock Hex. Nut, 3/8"-16
AN	156096	Axle Housing Assembly
AP	118118	Oil Seal
AQ	105195	Roller Bearing
AR	156099	Oil Seal
AS	705031	Hex. Cap Screw, 3/8"-16 x 7/8"
AT	720002	Lock Washer, 3/8"
AU	105083	Washer
AV	161002	R. H. Axle Shaft Assembly
AW	161047 161030	Gear Case Cover <i>Assy comp with ARG</i>
AX	156102	Roller Bearing <i>161030 AX-AY-AZ</i>
AY	156073	Roller Bearing
AZ	105195	Roller Bearing
BA	156103	Case Gasket
BB	705019	Hex. Cap Screw, 5/16"-18 x 1-1/4"
BC	720001	Lock Washer, 5/16"
BD	105083	Washer
BE	161024	L. H. Axle Shaft Assembly
BF	161096	Special Bolt
BG	717013	Jam Hex. Nut, 3/8"-16
BH	719001	Plain Washer
BJ	726002	Pipe Plug, 1/4"-18
BK	161072	Cluster Shaft
BL	161103 161130	Special Screw
BM	705011	Hex. Cap Screw
BN	720002	Lock Washer

TRANSMISSION

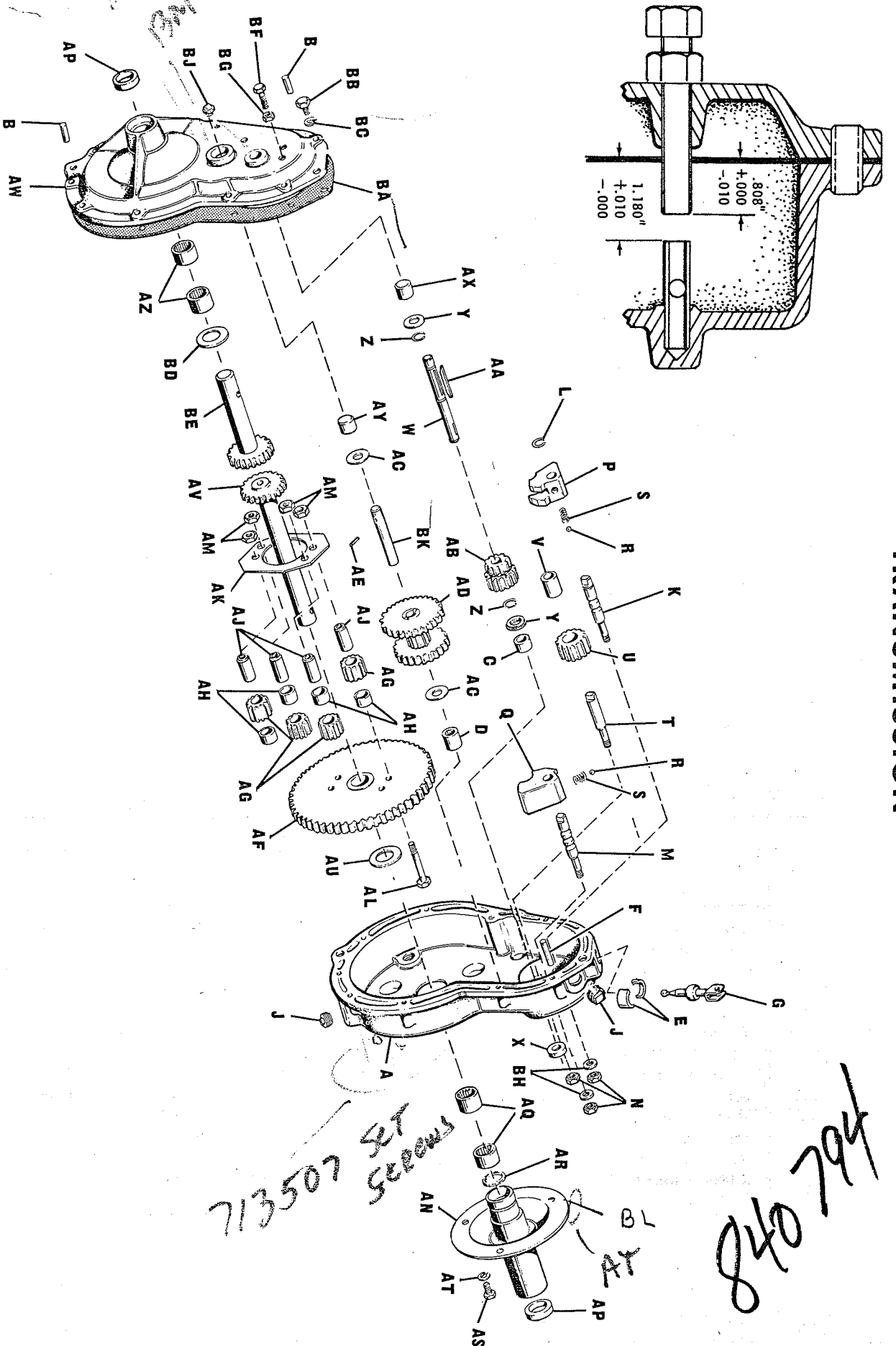

713507 SET SCREWS

840794

SPOUT and CONTROLS

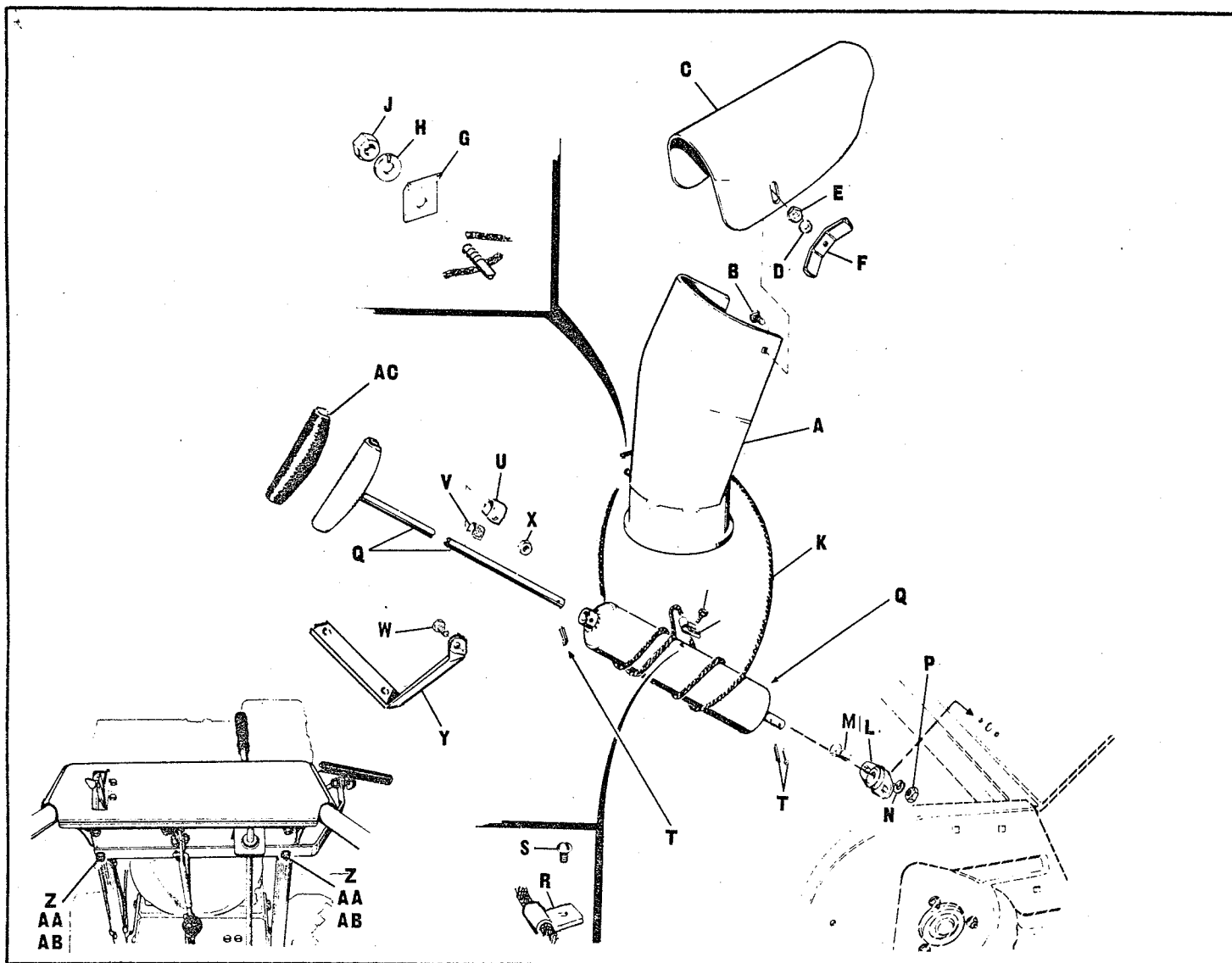

Ref. Let.	Part No.	Description
A	161099	Spout Assembly
B	703005	Carriage Bolt, 5/8-16 x 3/4"
C	106489	Spout Extension
D	719001	Plain Washer, 3/8"
E	721601	Lock Washer, 3/8" Shakeproof
F	106229	Wing Nut
G	161114	Friction Plate
H	720001	Lock Washer, 5/16"
J	717001	Hex Nut, Full, 5/16"-18
K	161118	Spout Cord $\frac{3}{4}$ "
L	106551	Bearing
M	705015	Hex Capscrew, 1/4"-20 x 5/8" lg.
N	720003	Lock Washer, 1/4"
P	717005	Hex Nut, Full, 1/4"-20

Ref. Let.	Part No.	Description
Q	161100	Tube Assembly, Spout Control
R	154247	Clamp
S	714016	Screw, Self-tapping, 1/4-20 x 1/2"
T	722009	Cotter Pin, 1/8" x 3/4" lg.
U	106221	Rod Guide
V	121175	Guide Liner
W	705019	Hex Capscrew, 5/16"-18 x 1-1/4"
X	717511	Hex Lock Nut, Full, 5/16"-18
Y	161101	Spout Adjusting Rod Support
Z	705053	Hex Capscrew, 1/4-20 x 1-3/4" lg.
AA	720003	Lock Washer, 1/4"
AB	717005	Hex Nut, Full, 1/4"-20
AC	106516	Handle Cover

WHEELS and LOW SPEED PULLEY

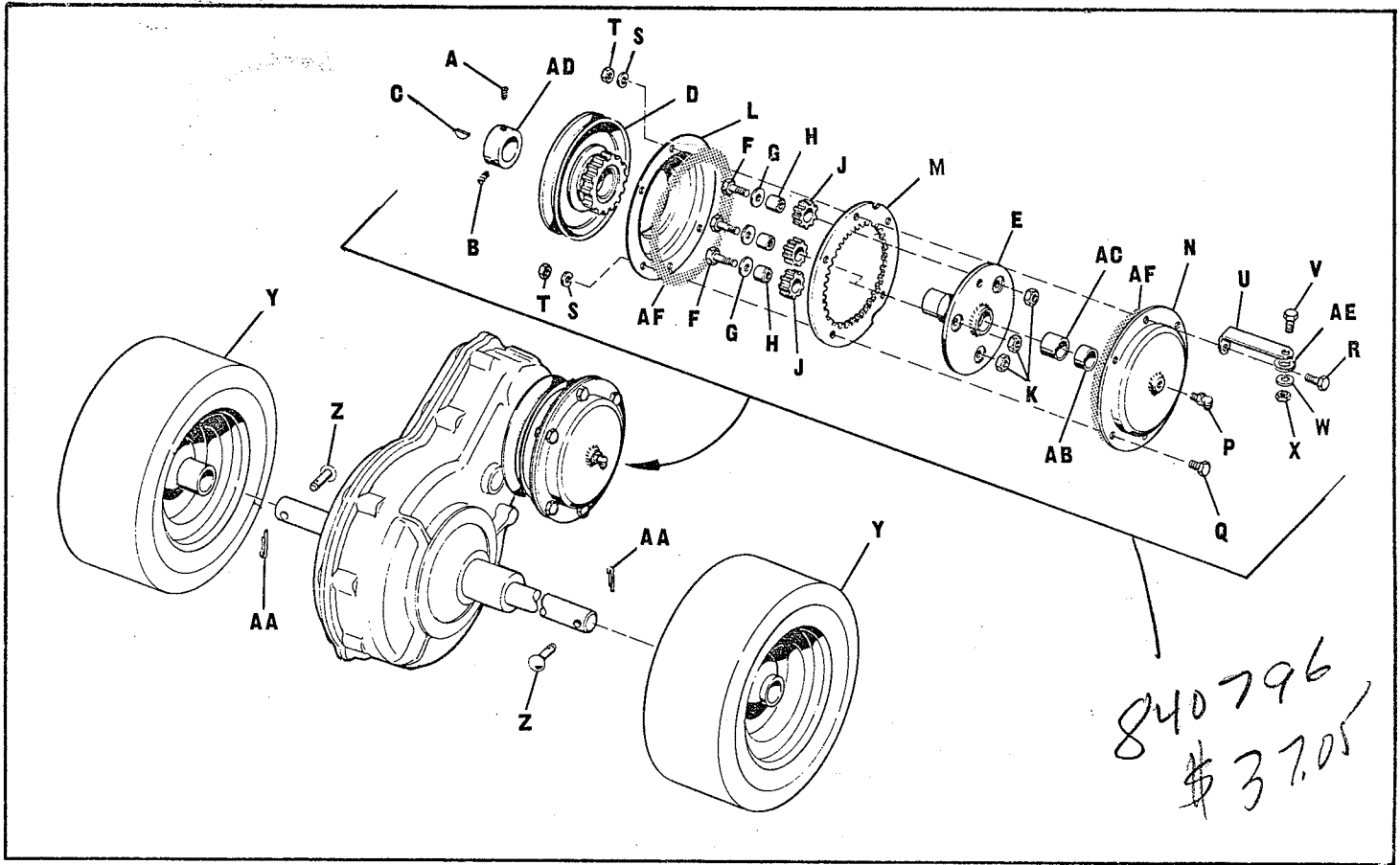

Ref. Let.	Part No.	Description
A	713501	Set Screw, 5/16"-18 x 1/2"
B	713504	Set Screw, 5/16"-18 x 3/8"
C	725003	Woodruff Key, 3/16" x 3/4"
D	161045	Pulley & Gear Assembly
E	161076	Spider & Bearing Assembly
F	715038	Hex. Cap Screw, 3/8"-16 x 1" <i>715038</i>
G	719002	Plain Washer, 5/16"
H	161078	Pinion Spacer
J	161079	Pinion
K	717510	Full-Lock Hex. Nut, 3/8"-16 <i>717510</i>
L	161054	L. H. Cover
M	157382	Ring Gear
N	161055	R. H. Cover Assembly
P	727004	Grease Fitting
Q	715071	Hex. Cap Screw, 5/16"-18 x 5/8"

Ref. Let.	Part No.	Description
R	715020	Hex. Cap Screw, 5/16"-18 x 3/4"
S	720001	Lock Washer, 5/16"
T	717001	Full Hex. Nut, 5/16"-18
U	161022	Planetary Pulley Stop
V	705012	Hex. Cap Screw, 5/16"-18 x 5/8"
W	720001	Lock Washer, 5/16"
X	717001	Full Hex. Nut, 5/16"-18
Y	161094	Wheel & Tire Assembly
Z	118053	Pin
AA	722009	Cotter Pin, 1/8" Dia. x 1"lg.
AB	156242	Bearing
AC	157330	Bearing
AD	154065	Set Collar
AE	719006	Plain Washer 1/4"
AF	161129	Gasket

ROTOR DRIVE GROUP

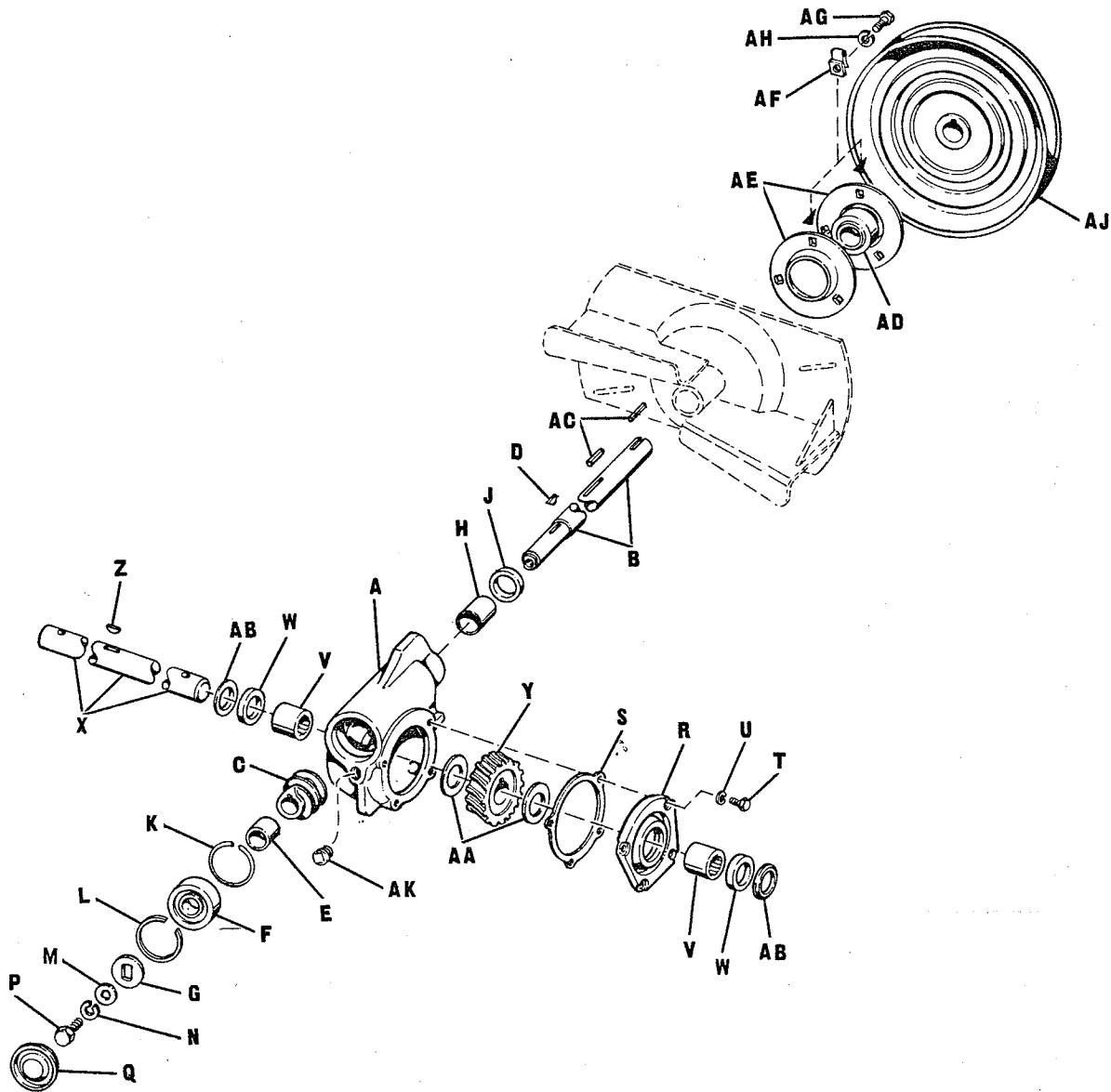

Ref. Let.	Part No.	Description
A	161018	Worm Drive Housing.
B	161064	Worm Gear Shaft
C	161065	Worm
D	725502	Key
E	118060	Spacer
F	118011	Ball Bearing
G	118178	Washer
H	158337	Bushing
J	118117	Oil Seal
K	118094	Snap Ring
L	118061	Retaining Ring
M	719002	Plain Washer, 5/16"
N	720002	Lock Washer, 3/8"
P	715004	Hex Cap Screw, 3/8"-24 x 1"
Q	118179	Cup
R	118316	Cover
S	118024	Gasket

Ref. Let.	Part No.	Description
T	715018	Hex Cap Screw, 1/4"-20 x 5/8"
U	720003	Lock Washer, 1/4"
V	118020	Needle Bearing
W	118118	Oil Seal
X	161066	Worm Gear Shaft
Y	161067	Worm Gear
Z	725005	Woodruff Key
AA	118315	Thrust Washer
AB	118082	Washer
AC	8061081	Key
AD	161068	Cartridge Bearing
AE	161069	Bearing Flange
AF	718030	Retainer Nut
AG	705017	Hex Cap Screw 5/16"-18 x 3/4"
AH	720001	Lock Washer, 5/16"
AJ	161070	Pulley
AK	726003	Pipe Plug, 3/8"

BODY and ROTOR GROUP

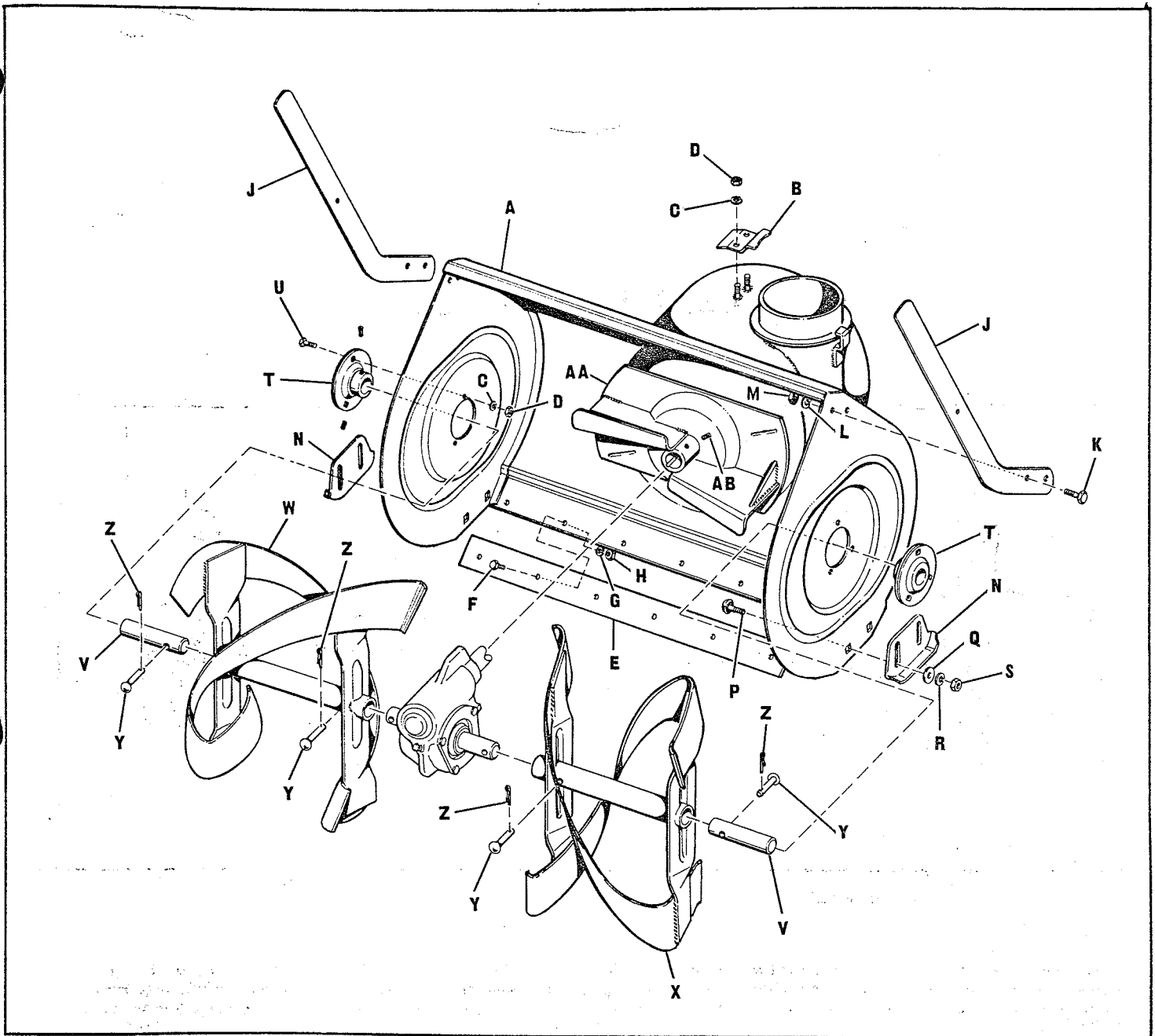

Ref. Let.	Part No.	Description
A	161001	Body Assembly
B	161116	Hold Down Clip
C	720001	Lock Washer, 5/16"
D	717001	Full Hex Nut, 5/16"-18
E	161059	Scraper Blade
F	715018	Hex Cap Screw, 1/4"-20 x 5/8"
G	720003	Lock Washer, 1/4"
H	717005	Full Hex Nut, 1/4"-20
J	161042	Cutter, Drift, 3/16" x 1-1/2 x 18-3/8
K	705004	Hex Cap Screw, 3/8"-16 x 3/4"
L	720002	Lock Washer, 3/8"
M	717003	Full Hex Nut, 3/8"-16
N	161006	Skid

Ref. Let.	Part No.	Description
P	703004	Carriage Bolt, 3/8"-16 x 3/4"
Q	719001	Plain Washer, 3/8"
R	720002	Lock Washer, 3/8"
S	717003	Full Hex Nut, 3/8"-16
T	106532	Ball Bearing
U	705012	Hex Cap Screw, 5/16"-18 x ^{3/4"} 3/4" 705017
V	161060	Shaft Auger
W	161020	R.H. Auger Assembly
X	161019	L. H. Auger Assembly
Y	118053	Pin
Z	722006	Cotter Pin, 1/8" Dia. x 1" lg.
AA	161011	Impeller Assembly
AB	713002	Set Screw, 5/16"-18 x 3/8"

Spout Cord Installation

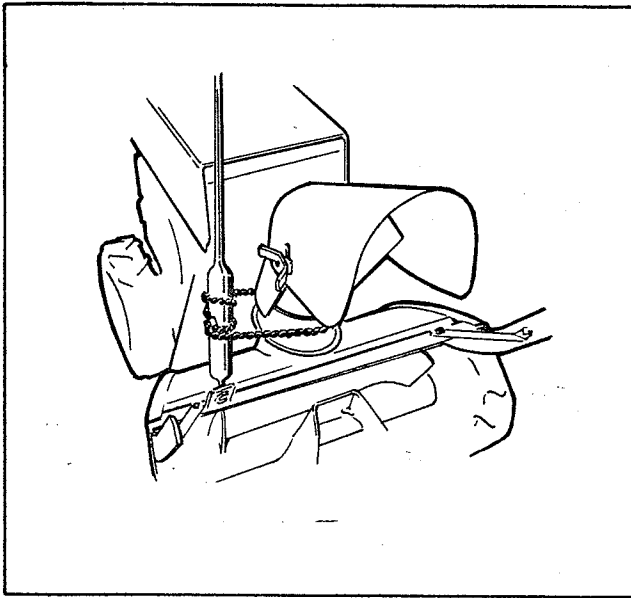

FIGURE "A"

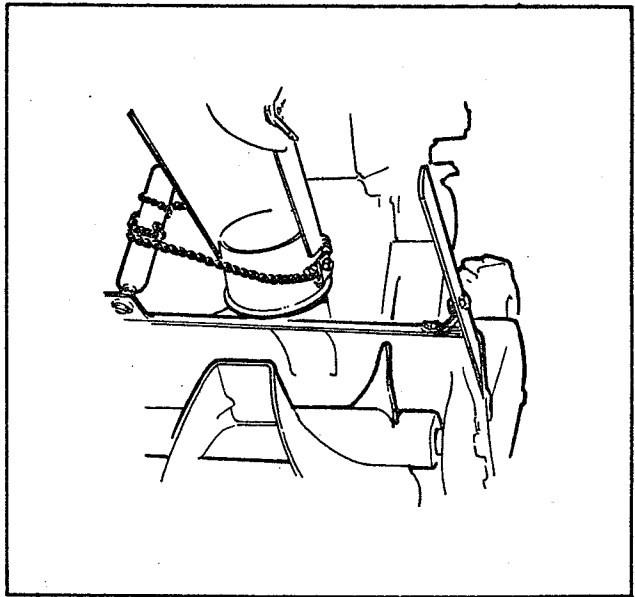

FIGURE "B"

1. Insert the end of the spout control assembly, through the bearing and secure with a cotter pin on both sides of the bearing. See Fig. "A". Lean the control assembly on the hood assembly as shown.

2. Position the spout to face forward and turn the cord drive tube so that the cord clamp faces the side of the spout as shown in Fig. "B". Notice that there is one loop above and below the clamp.

3. Position the free ends of the cord around the spout and clamp securely into position after removing all slack from the cord.

4. The upper end of the spout control rod #5, Fig. 4, is fastened to the spout control rod support bracket #1, Fig. 4 using the rod guide #4, Fig. 4, with plastic liner and one 5/16"-18 x 1-1/2" hex capcrew and 5/16"-18 hex nut.

5. Fasten the spout extension #4, Fig 5 to the spout assembly using the two 5/16"-18 x 3/4" long carriage bolts, 3/8" special hexagon lockwashers and 3/8" plain washers and wing nuts. Adjust as desired.