

Parts Manual Snowthrower Model 350

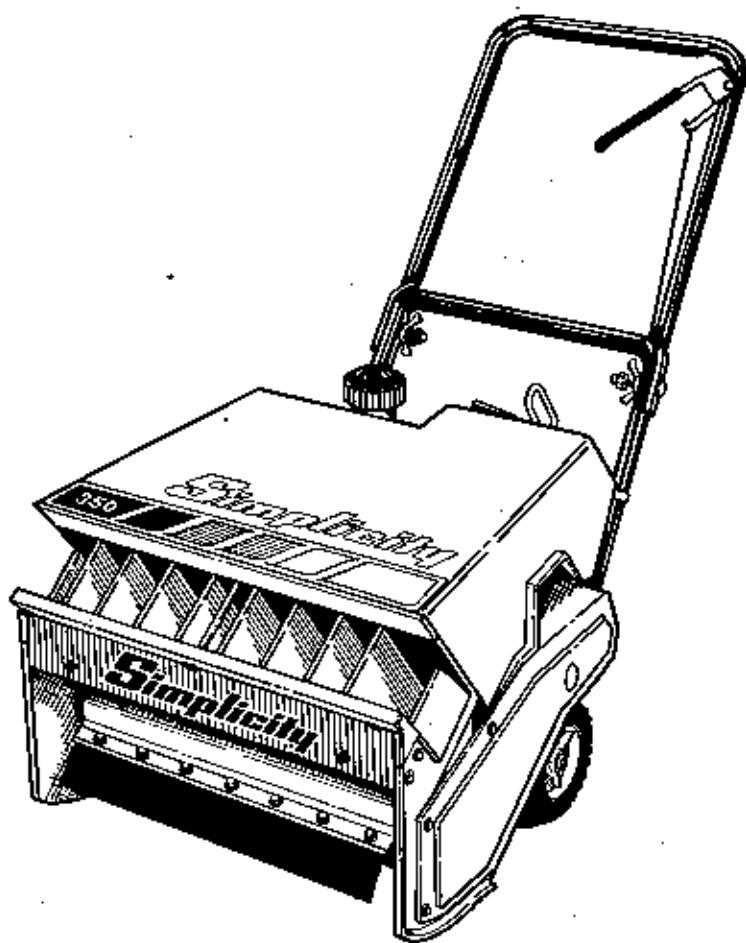

TP-1086-03
9/88

3 H.P. SNOWTHROWER
MANUAL START
MFG. NO. 1690901
MFG. NO. 1691405

3 H.P. SNOWTHROWER
ELECTRIC START
MFG. NO. 1690902
MFG. NO. 1691406

Simplicity®

Product Identification:

When ordering parts, keep your products serial number and manufacturer's number in mind. Variations may occur in a part between early and later model products, causing the product serial number to be listed in the parts description whenever these variations occur.

Record your I.D. numbers here for quick, future reference.

Product Mfg. No. _____ S/N _____ Mower Mfg. No. _____ S/N _____

Attention:

Standard torques appear in a chart at the end of the manual, while important individual torques are given on specific parts drawings.

CRITICAL and MAJOR notations point out important facts or instructions which relate to personal safety and proper machine operation. Any CRITICAL notation **C** which may appear in this book, pinpoints characteristics which, if not properly followed, can create a safety hazard. Any MAJOR notation **M** which may appear in this book, marks characteristics which, if not properly followed, may result in operating failure, shortened product life, or greatly reduced quality of the unit.

For your convenience, assembly notes are included in parts drawings to assist in repair and assembly of unit.

NOTE: Specifications may change without notice.

SIMPLICITY PRODUCTS FOR THE PROPER CARE OF EQUIPMENT
These genuine *Simplicity* products will help the owner extend the life of his equipment.

OILS - SPECIFICALLY BLENDED OF HIGH QUALITY BASE OILS & ADDITIVES.

Special Worm Gear (Roticul) Oil for use in all tillers and snowthrowers with worm gear auger drive. Required for protection of brass gears and mating parts. **Case of 12 Quarts, Part #1685100, Individual Quarts 118065.**

Multi-Purpose Hydraulic/Transmission Oil for use in most hydraulic applications, and hydrostatic and gear transmissions. Specific *Simplicity* applications: All hydrostatic transmissions, all bevel gear cases, all Broadmoor, Landlord, Sovereign, 4000, 6000, 7000 transmissions (except Peerless Gear Transmissions). (Not used in SunStar tractor transmission.) **Case of 12 Quarts, Part #1685516, 2½ Gallon Container, Part #1685539.**

2-Cycle Engine Oil, a premium lubricant for all 2-cycle air-cooled engines. **Case of 12 Part #1685517.**

SAE 5W 30 SF/CD Cold Weather Engine Oil for use in all four cycle and diesel engines at 30° temp. and under. **Case of 12 Quarts, Part # 1685576.**

SAE 15W40 SF/CD Engine Oil for gas and diesel engines, warm weather; see engine manufacturer recommendations. **Case of 12 Quarts, Part #1685554.**

Grease Gun Kit has 12" flexible hose to get into tight spots with ease. Kit contains: gun and 1-8 oz. tube of grease, **Part #1685510.** For replacement tube, order **Part # 103077.**

Pneumatic Tire Seal, seals all leaks including bead leaks and punctures up to 3/16 inch diameters. Prevents flats for tread life of tire. Available in following amounts.

Case of 12 - 11 Oz. Tubes 1685537
Case of 24 - 11 Oz. Tubes 1685525
5 Gallon Pail 1685527

Touch-Up Paint keeps equipment in showroom condition.

Spray Cans	Quarts	Daubers 12/Ctn.
*Simplicity Orange - 103262 (12 cans/1685179)	1685037	1685520 - Mixed (6 Simp. Orange, 6 White)
**Classic Orange - 1685558 (12 cans/1685559)	1685560	1685562 - Mixed (6 Classic Orange, 6-White)
White 103049 (12 cans/1685178)	1685032	1685562 - Mixed (6-Classic Orange, 6-White) 1685520 - Mixed (6-Simp. Orange, 6-White)
Black - 1685551 (12 Cans/1685552)	N.A.	N.A.
*For 1977 thru early 1986 products. **For products produced after 12/1/85.		

Simplicity Designer Seat Covers are double stitched, easy care vinyl. Keeps new seats new, makes worn seats look new.

- Small Cover for 4000, 5000,
& 6100 Tractors 1685540
- Large Cover for 6200, 7000 &
9000 Tractors 1685541
- SunStar Seat Cover 1685577

Extend Equipment Life - Use Only Genuine *Simplicity* Parts

TABLE OF CONTENTS

HOUSING & IMPELLER GROUP	2
FRAME, HANDLE & SHROUD GROUP (Mfg. No. 1690901 & 1690902)	4
FRAME, HANDLE & SHROUD GROUP (Mfg. No. 1691405 & 1691406)	8
ENGINE & DRIVE GROUP	10
DECAL GROUP	12
STANDARD HARDWARE TORQUE SPECIFICATION	Inside Back Cover

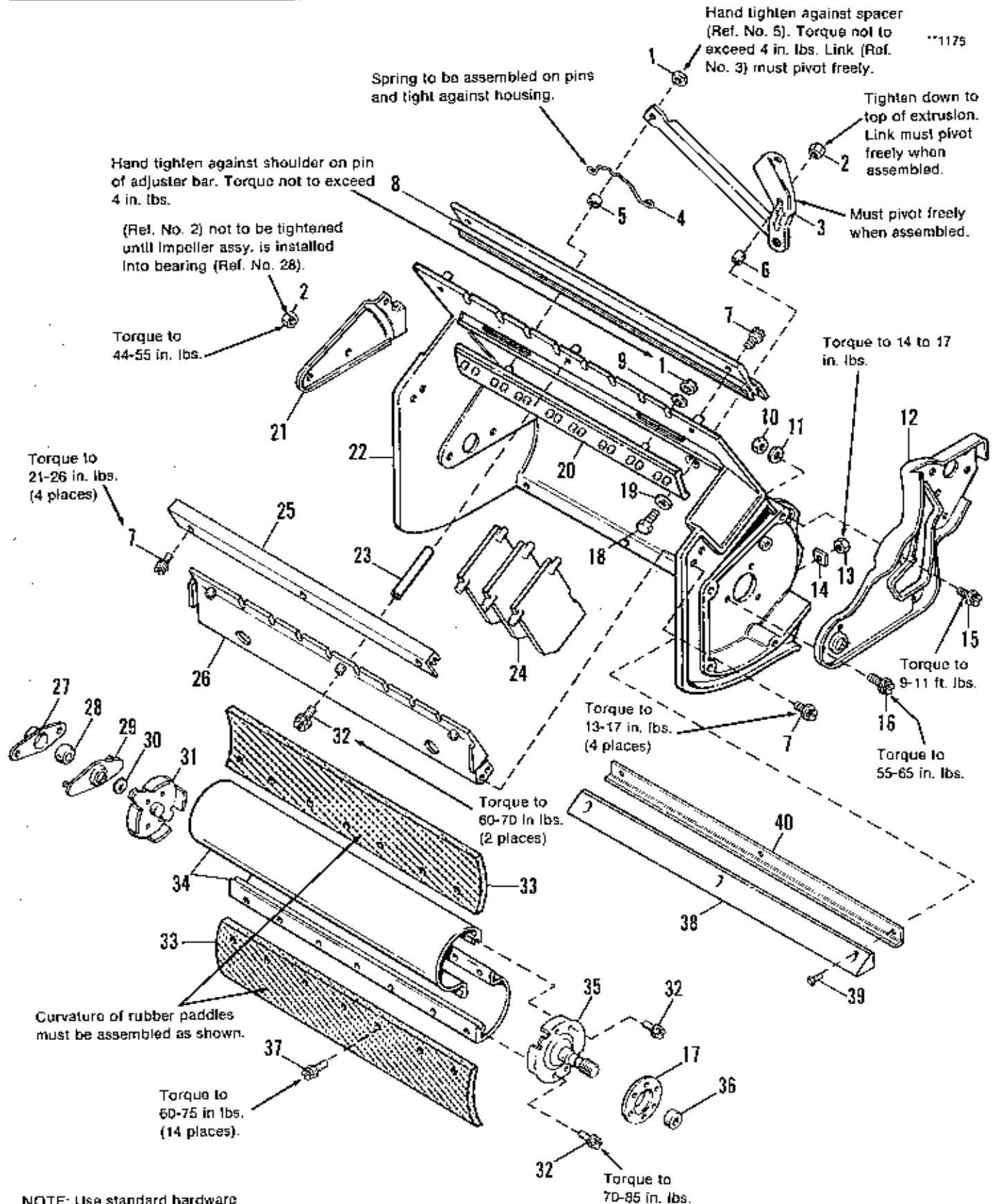

Ref. No.	Part No.	Qty.	Description
1	1960056	2	NUT, Self-Threading
2	1923358	2	LOCKNUT, Hex, 1/4-20
3	1666500	1	VANE ASSY., Control
4	1664000	1	SPRING, Detent
5	1664793	1	BUSHING
6	1664792	1	BUSHING
7	1960034	8	SCREW, Hex, Wash. Hd., Slotted, #10-14 x 1/2
8	1674130	1	MOLDING
9	960210	1	WASHER, Nylon
10	1923362	1	LOCKNUT, Hex, 5/16-18
11	1919326	1	WASHER, Plain, 5/16
12	1667784	1	BRACKET
13	1933896	3	NUT, Nylon Insert, #10-24
14	1666531	3	WASHER
15	1921332	1	CAPSCREW, Hex Hd., 5/16-18 x 3/4
16	1960001	3	SCREW, Hex, Wash. Hd., #10-14 x 5/8
17	1664016	1	RETAINER, Bearing
18	1921960	1	CAPSCREW, Hex Hd., 1/4-20 x 1
19	1921319	1	WASHER, Plain, 1/4
20	1664733	1	BAR, Adjustment
21	1663424	1	BRACKET, R.H.
22	1668341	1	HOUSING, Impeller
23	1665032	1	TUBE
24	1664773	8	VANE
25	1664785	1	MOLDING
26	1663406	1	MOUNT, Front
27	1664752	1	FLANGE
28	1664750	1	BEARING
29	1664751	1	FLANGE ASSY.
30	1919387	1	WASHER, Plain, 5/8
31	1664017	1	FLANGE & SHAFT ASSY., R.H.
32	1960134	6	SCREW, Hex Wash. Hd., Slotted, #10-14 x 1
33	1677173	2	PADDLE
34	1663869	2	DRUM, Impeller
35	1663952	1	FLANGE & SHAFT ASSY., L.H.
36	1666292	1	BEARING
37	1933958	14	SCREW, Hex Wash. Hd., Taplite, 1/4-20 x 1-1/8
38	1685280	1	SCRAPER BAR KIT (Incl. Ref. Nos. 13, 14, 39 & 40)
39	1932569	3	SCREW, Mach., Flat Hd., #10-24 x 1
40	1677090	1	BRACKET, Scraper

11176

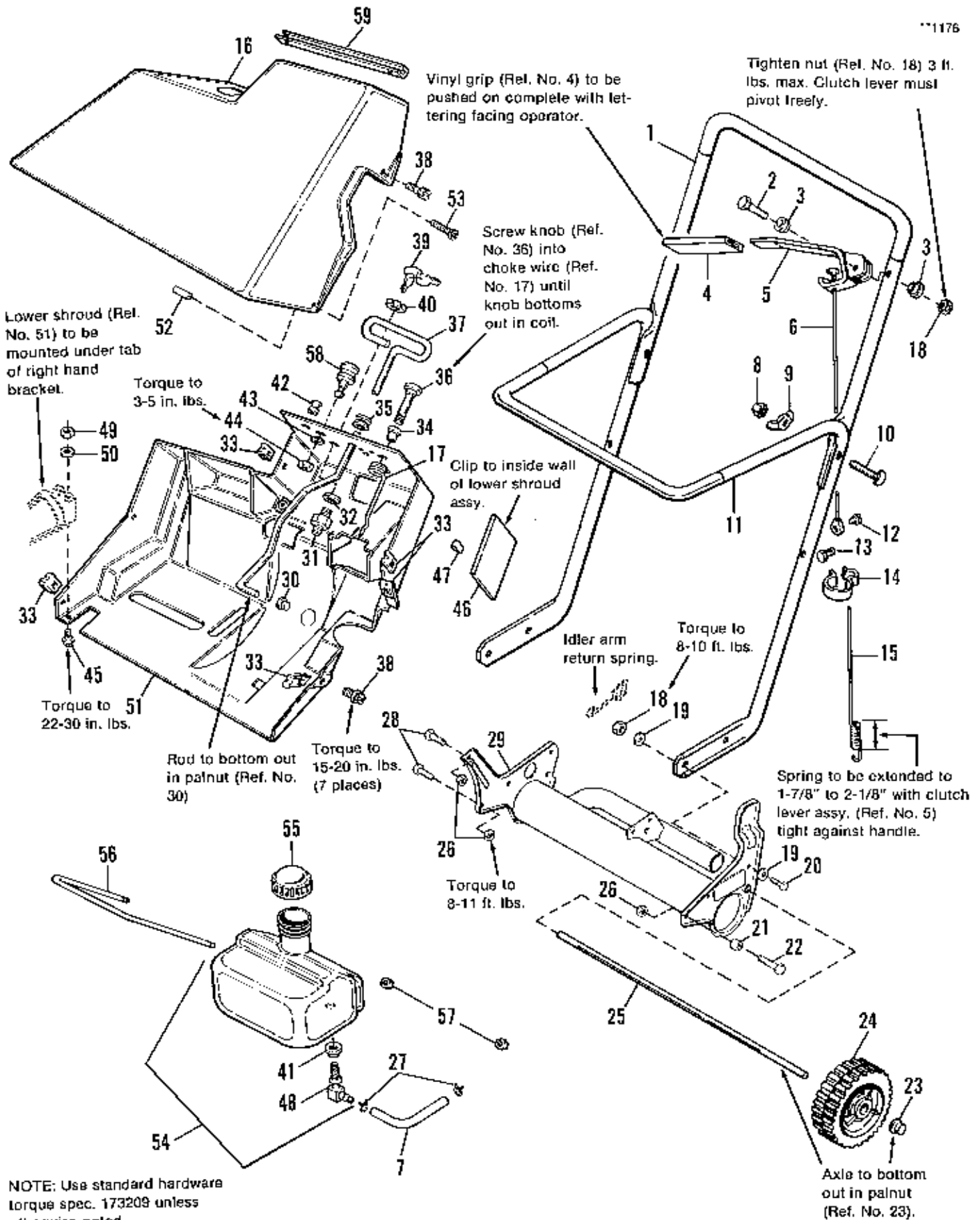

Ref. No.	Part No.	Qty.	Description
1	1665029	1	HANDLE, Upper, 21" Long
	1678622	1	HANDLE, Upper, 25" Long
	1685573	1	HANDLE KIT, Upper (Incl. 25" handle [1678622] & 23" Cable [1678531, Ref. No. 6])
2	1921962	1	CAPSCREW, Hex Hd., 1/4-20 x 1-3/4
3	1665369	2	SPACER
4	1664904	1	GRIP, Handle
5	1664814	1	LEVER ASSY., Clutch
6	1664673	1	CABLE ASSY., 18-3/4" Long (Used w/handle 1665029, Ref. No. 1)
	1678531	1	CABLE, Clutch, 23" Long (Used w/handle 1678622, Ref. No. 1)
7	1674227	1	HOSE, Fuel
8	1933707	2	NUT, Acorn, 5/16-18
9	1664794	2	NUT, Wing
10	1685221	2	BOLT, Curved Hd.
11	1665025	1	HANDLE, Lift
12	1912731	1	SCREW, Round Hd., #8-32 x 5/16
13	1664926	1	SWIVEL
14	108812	1	CLIP
15	1664465	1	SPRING, Tension
16	1674127	1	SHROUD, Upper
17	1664971	1	WIRE, Choke Control
18	1923358	5	LOCKNUT, Hex, 1/4-20
19	1917377	8	WASHER, Plain, 1/4
20	1924009	4	CAPSCREW, Hex Hd., 1/4-20 x 7/8
21	1663956	1	SPACER, L.H.
22	1921221	1	CAPSCREW, Hex Hd., 5/16-18 x 1-1/2
23	1960093	2	PUSHNUT, 3/8
24	1663428	2	WHEEL
25	1663429	1	AXLE
26	1923362	3	LOCKNUT, Hex, 5/16-18
27	1960112	2	HOSE, Clamp
28	1921332	2	CAPSCREW, Hex Hd., 5/16-18 x 3/4
29	1668340	1	SUPPORT ASSY., Engine & Frame
30	1663812	1	PUSHNUT, 1/4

NOTE: Ref. Nos. 31 thru 59 are on pages 6 & 7.

**1176

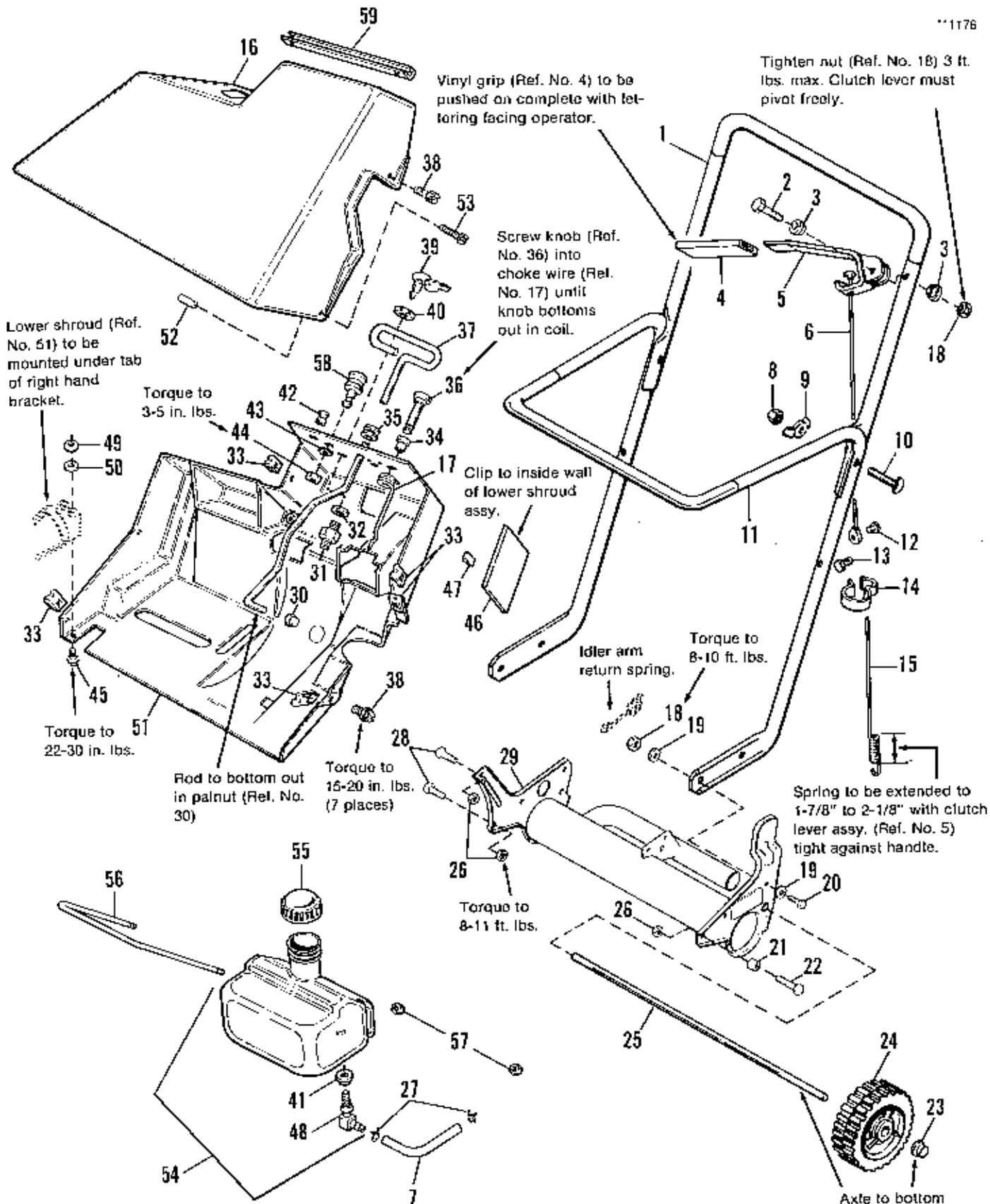

NOTE: Use standard hardware torque spec. 173209 unless otherwise noted.

Ref. No.	Part No.	Qty.	Description
31	1664804	1	SWITCH, Ignition
32	918906	1	LOCKWASHER, Int. Tooth, 5/8
33	933741	6	NUT, Speed, "U", #10
34	1664817	1	GUIDE, Choke Knob
35	1664022	1	GROMMET
36	1664582	1	KNOB, Choke Control
37	1664784	1	ROD, Vane Control
38	1960001	6	SCREW, Hex Wash. Hd., Slotted, #10-14 x 5/8
39	122203	1	KEY & RING ASSY., (2 Keys)
40	122234	1	NUT, Ignition Switch
41	1654930	1	BUSHING
42	1663453	1	GUIDE, Starter Rope
43	921860	1	LOCKWASHER, Ext. Tooth, 1/4
44	1920435	1	NUT, Hex, Jam, 1/4-20
45	933737	1	SCREW, Hex Wash. Hd., Slotted, #10-24 x 5/8
46	1675051	1	HEAT SHIELD
47	1675072	2	CLIP, Tinnerman
48	1674792	1	FITTING, Fuel Tank
49	933896	1	LOCKNUT, Center, #10-24
50	1923212	1	WASHER, Plain, #10
51	1611991	1	SHROUD, Lower
52	1674146	1	SPACER
53	1960129	1	SCREW, Plastite, #10-14 x 1-3/4
54	1674241	1	TANK ASSY., Fuel (Incl. Ref. Nos. 41 & 48)
55	1674145	1	GAS CAP
56	1674131	1	CLAMP, Tank
57	1674238	2	NUT, Hexlock, Nylon #8-32
*58		1	BULB, Primer
59	1677498	1	CHANNEL TRIM

*Order from your area Tecumseh engine parts supplier.

NOTE: Ref. Nos. 1 thru 30 are on pages 4 & 5.

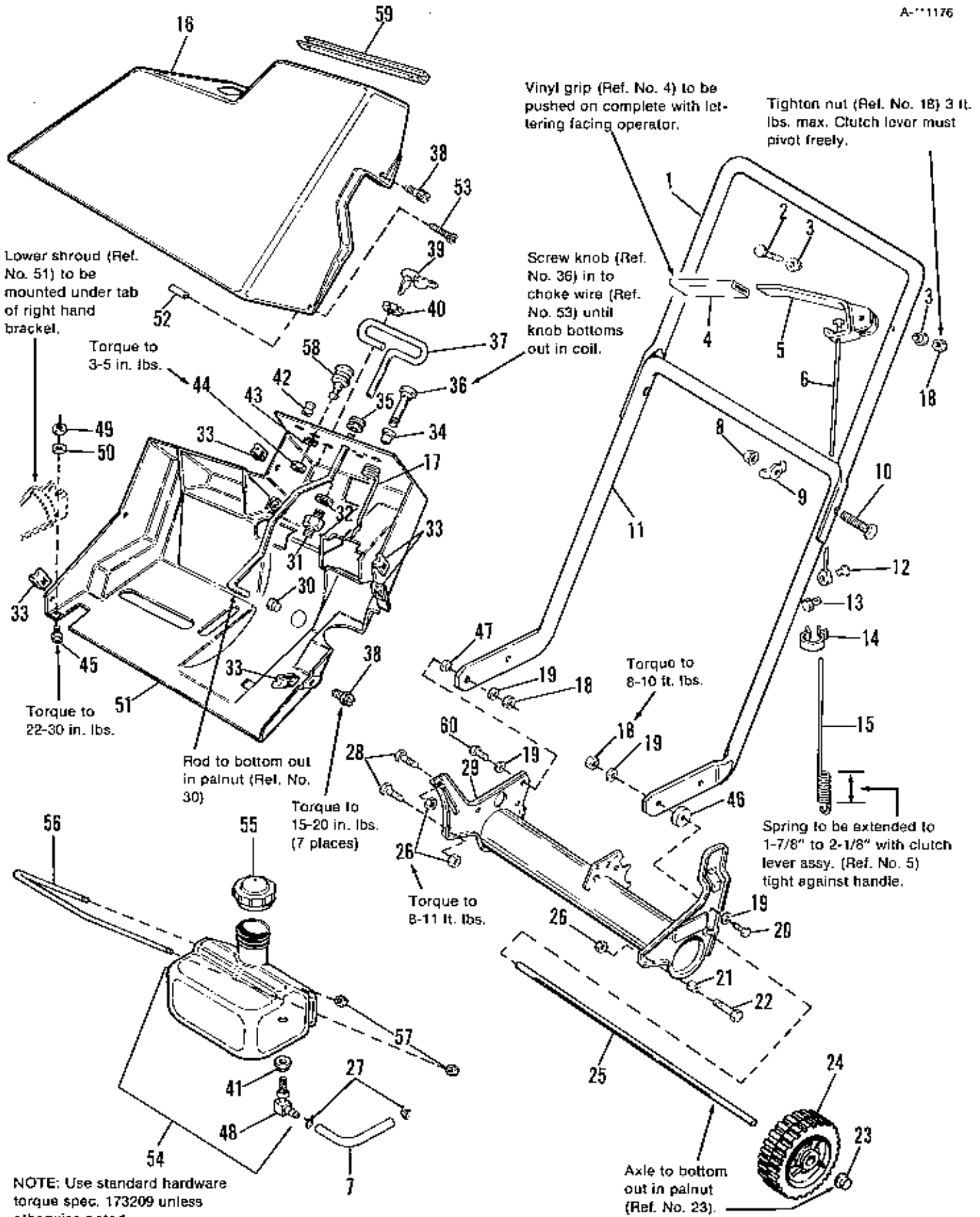

Ref. No.	Part No.	Qty.	Description
**1	1611802	1	HANDLE, Upper
2	1921962	1	CAPSCREW, Hex Hd., 1/4-20 x 1-3/4
3	1665369	2	SPACER
4	1664904	1	GRIP, Handle
5	1664814	1	LEVER ASSY., Clutch
**6	1678531	1	CABLE ASSY., Clutch Control
7	1674227	1	HOSE, Fuel
8	1933707	2	NUT, Acorn, 5/16-18
9	1664794	2	NUT, Wing
10	1665221	2	BOLT, Curved Hd.
**11	1611803	1	HANDLE, Lower
12	1912731	1	SCREW, Round Hd., #8-32 x 5/16
13	1664926	1	SWIVEL
14	108812	1	CLIP
15	1664465	1	SPRING, Tension
16	1674127	1	SHROUD, Upper
17	1664971	1	WIRE, Choke Control
18	1920397	6	LOCKNUT, Hex, 1/4-20
19	1917377	8	WASHER, Plain, 1/4
20	1921961	2	CAPSCREW, Hex Hd., 1/4-20 x 1/4
21	1663956	1	SPACER, L.H.
22	1921221	1	CAPSCREW, Hex Hd., 5/16-18 x 1-1/2
23	1960093	2	PUSHNUT, 3/8
24	1663428	2	WHEEL
25	1663429	1	AXLE
26	1923362	3	LOCKNUT, Hex, 5/16-18
27	1960112	2	HOSE, Clamp
28	1921332	2	CAPSCREW, Hex Hd., 5/16-18 x 3/4
29	1611674	1	SUPPORT ASSY., Engine & Frame
30	1663812	1	PUSHNUT, 1/4
31	1664804	1	SWITCH, Ignition
32	918906	1	LOCKWASHER, Int. Tooth, 5/8
33	933741	6	NUT, Speed, "U", #10
34	1664817	1	GUIDE, Choke Knob
35	1664022	1	GROMMET
36	1664582	1	KNOB, Choke Control
37	1664784	1	ROD, Vane Control
38	1960001	6	SCREW, Hex Wash. Hd., Slotted, #10-14 x 5/8
39	122203	1	KEY & RING ASSY., (2 Keys)
40	122234	1	NUT, Ignition Switch
41	1654930	1	BUSHING
42	1663453	1	GUIDE, Starter Rope
43	1921880	1	LOCKWASHER, Ext. Tooth, 1/4
44	1920435	1	NUT, Hex, Jam, 1/4-20
45	1933737	1	SCREW, Hex Wash. Hd., Slotted, #10-24 x 5/8
46	1611806	2	ISOLATOR
47	1611807	2	ISOLATOR
48	1674792	1	FITTING, Fuel Tank w/Screen
49	1933896	1	LOCKNUT, Center, #10-24
50	1923212	1	WASHER, Plain, #10
51	1611991	1	SHROUD, Lower
52	1674146	1	SPACER
53	1960129	1	SCREW, Plastite, #10-14 x 1-3/4
54	1674241	1	TANK ASSY., Fuel (Inc. Ref. Nos. 41 & 48)
55	1678045	1	GAS CAP
56	1674131	1	CLAMP, Tank
57	1674238	2	NUT, Hexlock, Nylon #8-32
*58		1	BULB, Primer
59	1677498	1	CHANNEL, Trim
60	1921960	2	CAPSCREW, 1/4-20 x 1

*Order from your area Tecumseh engine parts supplier.

**Available as KII Part Number 1685334 (incl. Ref. Nos. 1, 6 & 11)

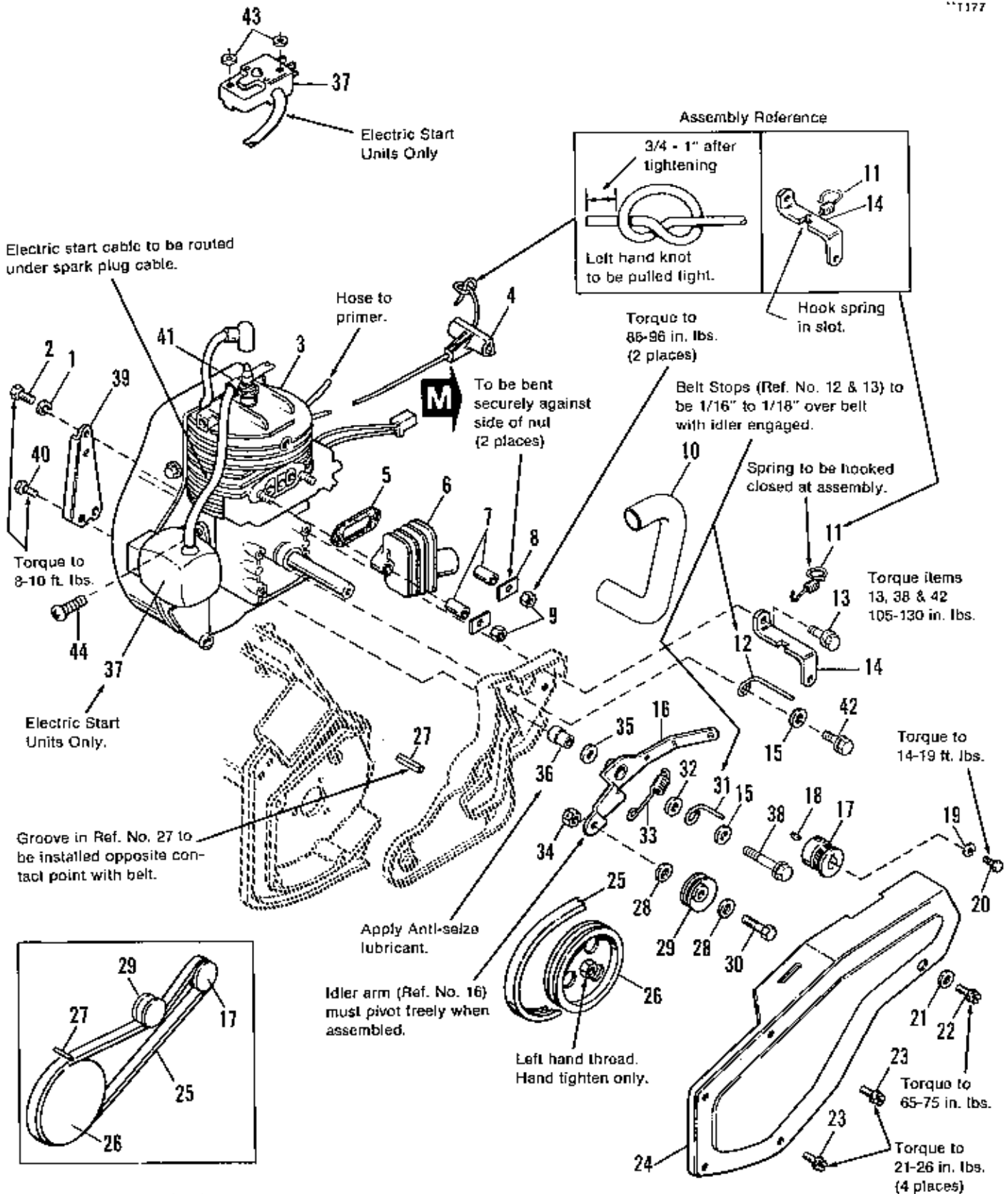

Ref. No.	Part. No.	Qty.	Description
1	1916964	1	LOCKWASHER, 1/4
2	1929486	1	CAPSCREW, Hex Hd., 1/4-20 x 3/8
3		1	*ENGINE, Manual Start
		1	*ENGINE, Elec. Start
4		1	*HANDLE, Pull
**5		1	*GASKET, Manifold
**6	1663425	1	MANIFOLD, Exhaust
**7	1664857	2	SPACER
**8	1666394	2	KEEPER-NUT
**9	1923358	2	LOCKNUT, Hex, 1/4-20
**10	1672526	1	PIPE, Exhaust
**11	1664988	1	SPRING, Extension
12	1663440	1	STOP, Belt
13	1934665	2	SCREW, Hex, Whizlock, 5/16-18 x 5/8
14	1664906	1	BRACKET, Cover
15	1919326	2	WASHER, Plain, 5/16
16	1667747	1	ARM ASSY., Idler
17	1665895	1	PULLEY, Drive
18	910224	1	KEY, Woodruff, 5/32 x 5/8
19	1917356	1	LOCKWASHER, 5/16
20	1921515	1	CAPSCREW, Hex Hd., 5/16-24 x 3/4
21	933897	1	WASHER, Shakeproof #10
22	1960001	1	SCREW, Wash. Hd., Hex, Slotted, #10-14 x 5/8
23	1960034	4	SCREW, Wash. Hd., Hex, Slotted, #10-14 x 1/2
24	1668338	1	COVER, Belt
25	1663885	1	BELT, Drive
26	1664033	1	PULLEY, Drive
27	1664726	1	GUIDE, Belt
28	1924940	2	WASHER, Plain, 3/8
29	118414	1	PULLEY, Idler
30	1921966	1	CAPSCREW, Hex Hd., 3/8-16 x 1-1/4
31	1664477	1	STOP, Belt
32	1919381	1	WASHER, Plain, 5/16
33	1664469	1	SPRING, Tension
34	1928731	1	LOCKNUT, Hex, Center, 3/8-16
35	1960027	1	WASHER
36	1667795	1	STUD
*37		1	KIT, Electric Start
38	1935159	1	SCREW, Hex, Whizlock, 5/16-18 x 2-1/4
39	1665935	1	BRACKET, Engine
40	1925003	2	SCREW, Hex, Taptite, 1/4-20 x 1/2
41	934683	1	CLIP, Tinnerman (Used on E.S. only)
42	1930591	1	SCREW, Hex, Whizlock, 5/16-18 x 3/4
43	1917458	2	WASHER, Plain #6 (E.S. Only)
44	1931917	2	SCREW, Pan Hd., Phil. Taptite, 1/4-20 x 3/4 (E.S. Only)

*Order from your area Tecumseh engine parts supplier.

**Used on Mfg. No. 1690901 & 1690902 only.

SAFETY DECAL

AD-377

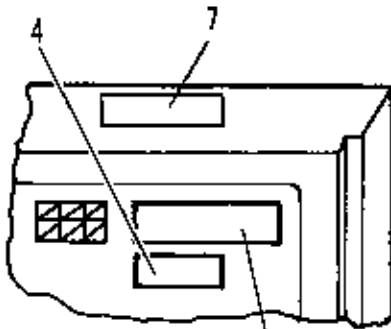

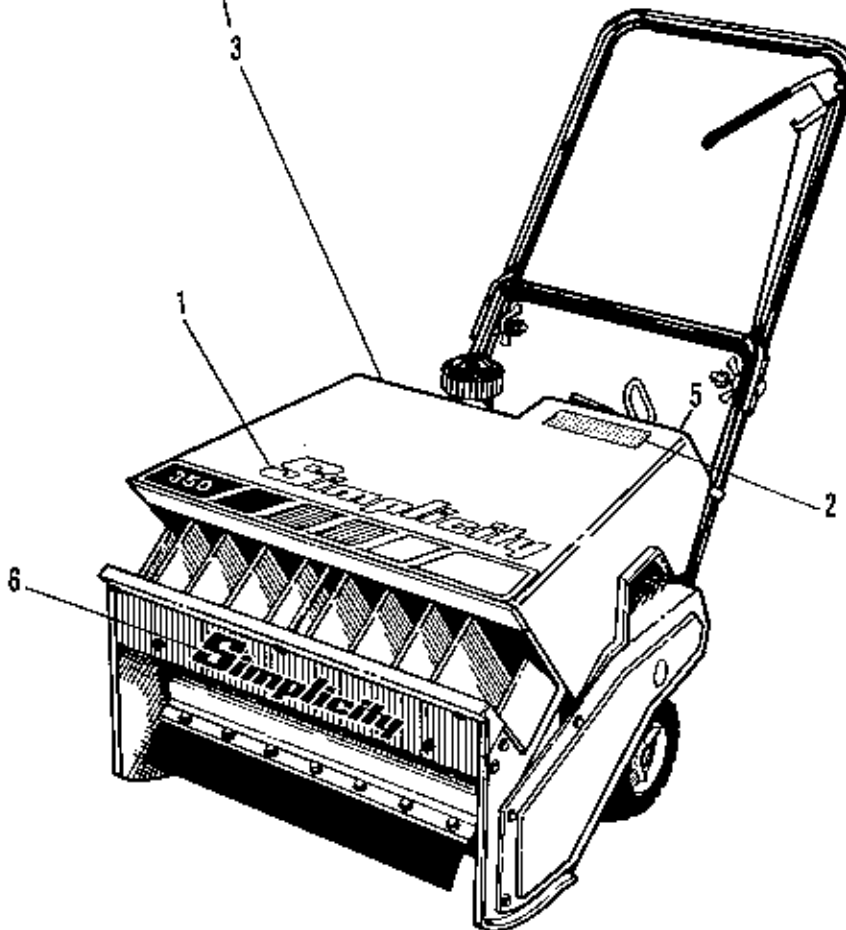

Ref. No. 2



Ref. No.	Part No.	Qty.	Description
1	1674154	1	DECAL, <i>Simplicity</i> 350
2	1674155	1	DECAL, Caution
3		1	DECAL, I.D.
4		1	DECAL, Patent
5	1674157	1	DECAL, Dash (Electric Start)
	1674156	1	DECAL, Dash (Manual Start)
6	1675536	1	DECAL, <i>Simplicity</i>
7	1675910	1	DECAL, Fuel Mixture

**TORQUE SPECIFICATIONS FOR
STANDARD MACHINE HARDWARE
TOLERANCE $\pm 20\%$**



SIZE	SAE GRADE #2 	SAE GRADE #5 	SAE GRADE #8 
8-32	19 In. Lbs.	30 In. Lbs.	41 In. Lbs.
8-36	20 "	31 "	43 "
10-24	27 "	43 "	60 "
10-32	31 "	49 "	68 "
1/4-20	66 "	8 Ft. Lbs	12 Ft. Lbs.
1/4-28	76 "	10 "	14 "
5/16-18	11 Ft. Lbs	17 "	25 "
5/16-24	12 "	19 "	25 "
3/8-16	20 "	30 "	45 "
3/8-24	23 "	35 "	50 "
7/16-14	30 "	50 "	70 "
7/16-20	35 "	55 "	80 "
1/2-13	50 "	75 "	110 "
1/2-20	55 "	90 "	120 "
9/16-12	65 "	110 "	150 "
9/16-18	75 "	120 "	170 "
5/8-11	90 "	150 "	220 "
5/8-18	100 "	180 "	240 "
3/4-10	160 "	260 "	386 "
3/4-16	180 "	300 "	420 "
7/8-9	140 "	400 "	600 "
7/8-14	155 "	440 "	660 "
1-8	220 "	580 "	900 "
1-12	240 "	640 "	1,000 "

NOTE:

1. These torque values are to be used for all *Simplicity* hardware excluding: locknuts, self-tapping screws, thread forming screws, sheet metal screws and socket head setscrews.
2. Recommended seating torque values for locknuts:
 - a. For prevailing torque locknuts - use 65% of grade 5 torques.
 - b. For flange whizlock nuts (and screws) - use 135% of grade 5 torques.
3. Unless otherwise noted on assembly drawings all torque values must meet this specification.

BOLT HEAD MARKING

S.A.E. GRADE:

- 2 
- 5 
- 8 

Simplicity Manufacturing, Inc.
500 N. Spring Street
P.O. Box 997
Port Washington, WI 53074-0997

Copyright © 1988 Simplicity Manufacturing, Inc.

PRINTED IN U.S.A.

