

Simplicity
REG. U.S. PAT. OFF.

**INSTRUCTIONS
AND PARTS LIST**

**Cultivator
for
Use with 2 Wheel Tractors**

990205

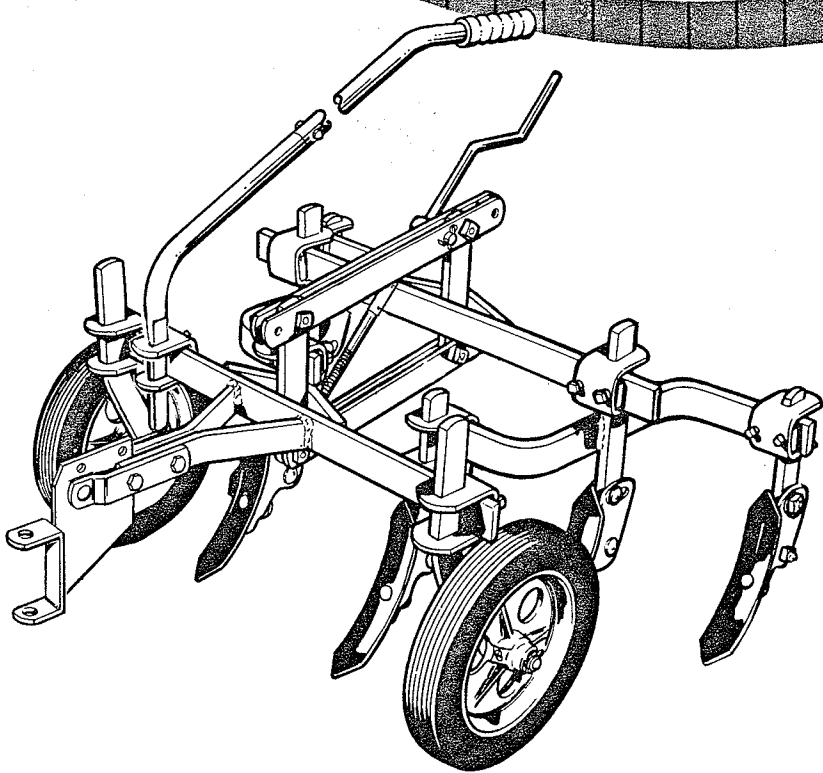

REAR CULTIVATOR

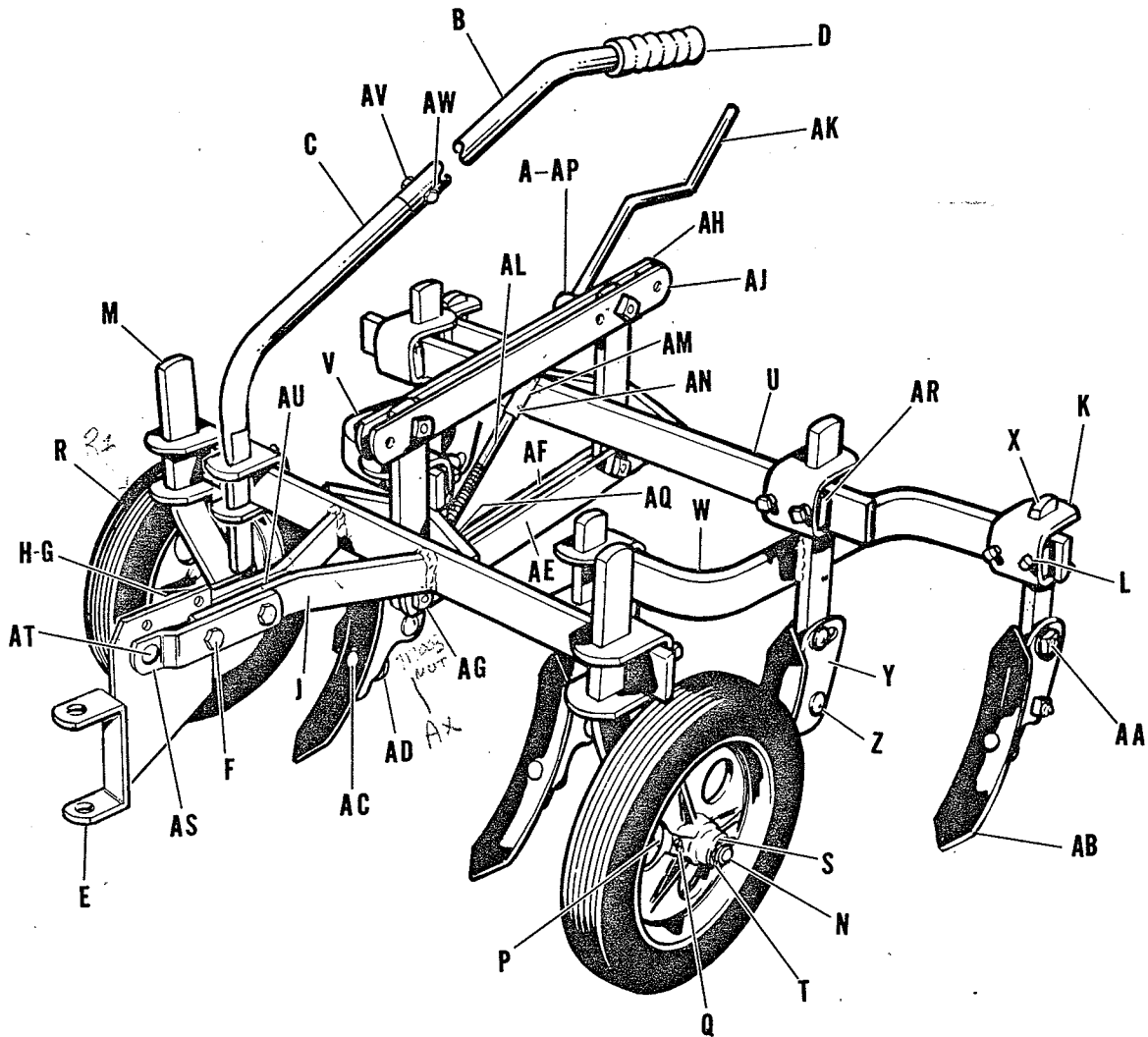

ORDER BY PART NUMBER

Reference Letter	Part No.	Description
- A	722006	Pin, Cotter, 1/8" dia. x 1" lg.
B	117005	Handle, Control, Upper
C	117006	Handle, Control, Lower
D	153043	Grip, Handle
E	117011	End Assembly, Drawbar
F	702006	Bolt, Carriage, 3/8"-16 NC x 1 3/4" lg.
G	720002	Washer, Lock, 3/8"
H	717003	Nut, Hex., Full, 3/8"-16 NC
J	117012	Drawbar Assembly
K	SSA-A23	Clamp, Shank - 8271023
L	713004	Screw, Set, Cup Point, Sq. Hd., 3/8"-16 NC x 1" lg.
M	112057	Standard, Wheel
N	112058	Spindle, Wheel
P	717018	Nut, Ham, Hex., 5/8"-11 NC
Q	727002	Fitting, Grease
R	SSA-AX6	Wheel, Complete 8271506
S	SS-A55	Washer - 8261055
T	722006	Pin, Cotter, 1/8" dia. x 1" lg.
U	SSA-BX2A	Tool Bar Assembly 8272502
V	SSA-CX3	Frame Assembly, Tool, R.H. 8273503
W	SSA-CX4	Frame Assembly, Tool, L.H. - 8273504
X	SSA-A18	Standard, Tool, Short - 8271018
Y	SSA-AX3	Tool Holder Assembly - 8271503
Z	703002	Bolt, Carriage, 3/8"-16 NC x 1 1/4" lg.
AA	719001	Washer, Plain, 3/8"
AB	SSA-A14A	Steel, Cultivator - 8271014
AC	704001	Bolt, Plow
AD	719001	Washer, Plain, 3/8"
AE	SSA-B2A	Bar, Parrallel, R.H. - 8272002
AF	SSA-B3A	Bar, Parallel, L.H. - 8272003
AG	705016	Screw, Cap, Hex., 3/8"-16 NC x 1 1/4" lg.
AH	117007	Bar, Parallel, R.H.
AJ	117008	Bar, Parallel, L.H.
- AK 8273008	SSA-B8	Screw, Upper
- AL 8271009	SSA-A9	Screw, Lower
- AM 8271017	SSA-A17	Coupling, Screw
- AN	724003	Rivet, Round Head
- AP 8271021	SSA-A21	Nut, Adj., Upper
- AQ 8271022	SSA-A22	Nut, Adj., Lower
AR	S2-A78	Nut, Special 8271073 8261073
AS	117014	Extension, Draw Bar
AT	702004	Bolt, Carriage, 3/8"-16 NC x 1 1/4" lg.
AU	119045	Washer 1/2" id. 1 1/16 o.d. 1/8" thick
AV	717011	Nut, Hex, Jam, 5/16"-18 NC
AW	705019	Capscrew, Hex Hd., 5/16"-18 NC x 1 1/4" lg.

R1

8271010

Time only 10x1.75

AX

717003

NOT

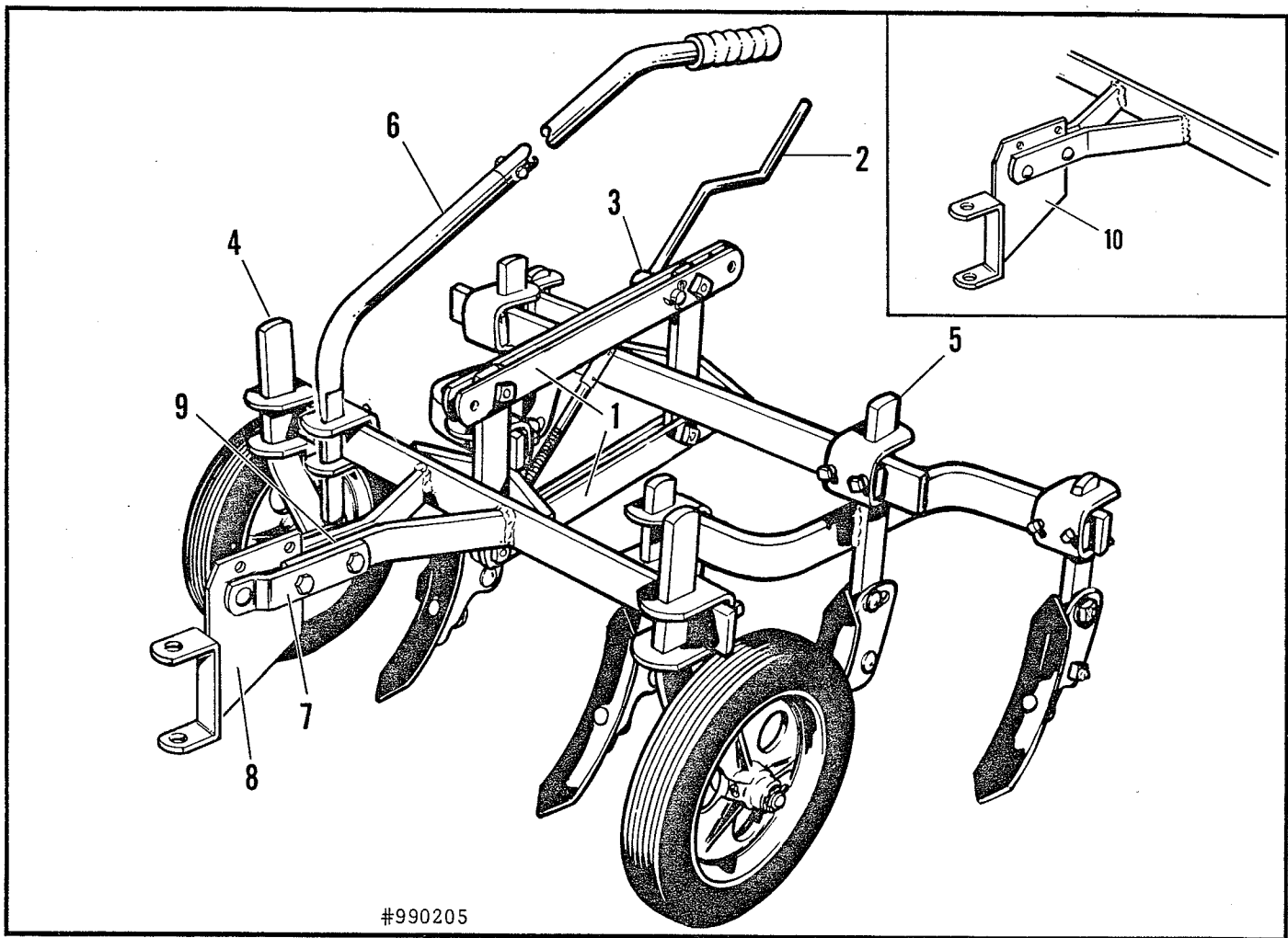

#990205

PACKING

The cultivator is packed in one carton disassembled for ease of shipment.

ASSEMBLY

1. Attach parallel bars to the draw bar assembly as shown at (1). Lock with jam nuts so bars are free to swing.
2. Attach the depth crank (2) as illustrated. Adjusting nuts (3) should be equally spaced on threads.
3. Clamp the wheel standards to the draw bar assembly as shown at (4).
4. Clamp the tool holders to the tool bar as shown at (5).
5. Attach the tool standards to the tool assemblies.
6. Assemble the lift handle to the cultivator as shown at (6).
7. For use with the model "LC" and older tractors, assemble draw bar extensions to draw bar as shown at (7). Insert 2 flat washers at (9).
8. Attach draw bar end assembly as shown at (8), using the lower set of mounting holes.
9. For use with the model "W" tractor, attach the draw bar end assembly as shown at (10). Do not install the draw bar extensions when using the cultivator with the model "W" tractor.

ATTACHMENT

To attach the assembled cultivator to the tractor, bring the cultivator up behind the tractor and connect the draw bar end assembly to tractor hitch with hitch pin.

ADJUSTMENTS

1. A hand screw (2) is provided to permit adjustment of the depth of the sturdy carbon steel knives, together.
2. Each knife may be adjusted separately in its bracket.
3. To transport the cultivator, turn the hand screw (2) until the knives are raised to a point where they will be clear of the surface of the ground.
4. Grease the wheel bearings daily.

OPERATION

The garden can be more easily cared for by planting row the long way of the plot.

Select the proper cultivating steels so the maximum results are obtained. Seedlings require different attention than sturdy plants.

NOTE: Since the principal purpose or function of cultivation is weed control, it follows that cultivation should be done at the most favorable for killing weeds, which is just as they are breaking through the surface. Practically all the benefits derived from cultivation are secured from shallow cultivation. Deep cultivation, if practiced, should be carried on during the early stages of growth and the depth lessened as the plants grow larger and the roots increase in length. All tools on this cultivator have an individual adjustment for depth and an individual adjustment for pitch.